

San Francisco Regional Office

1252 Quarry Lane
P.O. Box 9019
Pleasanton, CA 94566
(510) 426-2600
Fax (510) 426-0106

ENVIRONMENTAL
PROTECTION

96 DEC -5 PM 12:48

Clayton
ENVIRONMENTAL
CONSULTANTS

December 4, 1996

NOV 630

Mr. Barney Chan
ALAMEDA COUNTY DEPARTMENT OF ENVIRONMENTAL HEALTH
1131 Harbor Bay Parkway, 2nd Floor
Alameda, California 94502

Clayton Project No. 70-97066.00.000

Subject: Analytical Results and Sketch for the Recent UST Removal at 630 - 29
Street, Oakland, California

Dear Mr. Chan:

As you requested during our December 4, 1996, telephone conversation, a copy of the analytical report for the recent UST removal at the above-referenced site is attached. Sketches showing the tank layout and sample locations are also attached.

If you have any questions, please contact me at (510) 426-2629.

Sincerely,

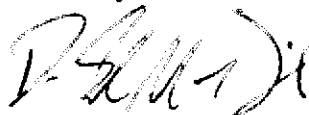

D. Edward MacDaniel
Project Geologist

DEM/

Attachments

K:\EMR\PROJECTS\97066\97066L00.WPD

1252 Quarry Lane
P.O. Box 9019
Pleasanton, CA 94566
(510) 426-2600
Fax (510) 426-0106

Clayton
ENVIRONMENTAL
CONSULTANTS

November 27, 1996

Mr. Ed MacDaniel
CLAYTON ENVIRONMENTAL CONS.
1252 Quarry Lane
Pleasanton, CA 94566

PARTIAL REPORT
Client Ref.: 70-97066.00.000
Clayton Project No.: 96112.87

Dear Mr. MacDaniel:

Attached is our analytical laboratory report for the samples received on November 21, 1996. Results for Comp. SP-1 thru SP-8 will be forwarded to you upon completion. Also enclosed is a copy of the Chain-of-Custody record acknowledging receipt of these samples.

Please note that any unused portion of the samples will be discarded after December 27, 1996, unless you have requested otherwise.

We appreciate the opportunity to assist you. If you have any questions concerning this report, please contact Suzanne Haus, Client Services Supervisor, at (510) 426-2657.

Sincerely,

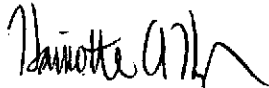

Harriotte A. Hurley, CIH
Director, Laboratory Services
San Francisco Regional Office

HAH/tjb

Attachments

Analytical Results
for
Clayton Environmental Consultants, Inc.
Client Reference: 70-97066.00.000
Clayton Project No. 96112.87

Sample Identification: S-1	Date Sampled: 11/21/96
Lab Number: 9611287-01A	Date Received: 11/21/96
Sample Matrix/Media: SOIL	Date Prepared: 11/21/96
Preparation Method: EPA 5030	Date Analyzed: 11/22/96
Method Reference: EPA 8015/8020	Analyst: DL

Analyte	CAS #	Concentration (mg/kg)	Limit of Detection (mg/kg)
<u>BTEX/Gasoline</u>			
Benzene	71-43-2	1.2	0.05
Ethylbenzene	100-41-4	12	0.05
Toluene	108-88-3	100	0.05
o-Xylene	95-47-6	20	0.05
p,m-Xylenes	--	46	0.05
Gasoline	--	1800	3
MTBE	--	ND	50

<u>Surrogates</u>		<u>Recovery (%)</u>	<u>QC Limits (%)</u>
a,a,a-Trifluorotoluene	98-08-8	D	50 - 150

ND: Not detected at or above limit of detection
--: Information not available or not applicable

Results are reported on a wet-weight basis, as received.
Note: Detection limits increased due to dilution necessary for quantitation.
D = Surrogate diluted out.

Analytical Results
 for
 Clayton Environmental Consultants, Inc.
 Client Reference: 70-97066.00.000
 Clayton Project No. 96112.87

Sample Identification: S-2	Date Sampled: 11/21/96
Lab Number: 9611287-02A	Date Received: 11/21/96
Sample Matrix/Media: SOIL	Date Prepared: 11/21/96
Preparation Method: EPA 5030	Date Analyzed: 11/22/96
Method Reference: EPA 8015/8020	Analyst: DL

Analyte	CAS #	Concentration (mg/kg)	Limit of Detection (mg/kg)
<u>BTEX/Gasoline</u>			
Benzene	71-43-2	0.39	0.05
Ethylbenzene	100-41-4	0.28	0.05
Toluene	108-88-3	0.70	0.05
o-Xylene	95-47-6	0.41	0.05
p,m-Xylenes	--	0.83	0.05
Gasoline	--	70	3
MTBE	--	ND	50

<u>Surrogates</u>	<u>Recovery (%)</u>	<u>QC Limits (%)</u>
a,a,a-Trifluorotoluene	98-08-8 D	50 - 150

ND: Not detected at or above limit of detection

--: Information not available or not applicable

Results are reported on a wet-weight basis, as received.

Note: Detection limits increased due to dilution necessary for quantitation.

D = Surrogate diluted out.

Analytical Results
for
Clayton Environmental Consultants, Inc.
Client Reference: 70-97066.00.000
Clayton Project No. 96112.87

Sample Identification: S-3	Date Sampled: 11/21/96
Lab Number: 9611287-03A	Date Received: 11/21/96
Sample Matrix/Media: SOIL	Date Prepared: 11/21/96
Preparation Method: EPA 5030	Date Analyzed: 11/22/96
Method Reference: EPA 8015/8020	Analyst: DL

Analyte	CAS #	Concentration (mg/kg)	Limit of Detection (mg/kg)
<u>BTEX/Gasoline</u>			
Benzene	71-43-2	2.1	0.05
Ethylbenzene	100-41-4	5.3	0.05
Toluene	108-88-3	11	0.05
o-Xylene	95-47-6	9.4	0.05
p,m-Xylenes	--	20	0.05
Gasoline	--	290	3
MTBE	--	ND	50
<u>Surrogates</u>		<u>Recovery (%)</u>	<u>QC Limits (%)</u>
a,a,a-Trifluorotoluene	98-08-8	D	50 - 150

ND: Not detected at or above limit of detection

--: Information not available or not applicable

Results are reported on a wet-weight basis, as received.

Note: Detection limits increased due to dilution necessary for quantitation.

D = Surrogate diluted out.

Analytical Results
for
Clayton Environmental Consultants, Inc.
Client Reference: 70-97066.00.000
Clayton Project No. 96112.87

Sample Identification: S-4	Date Sampled: 11/21/96
Lab Number: 9611287-04A	Date Received: 11/21/96
Sample Matrix/Media: SOIL	Date Prepared: 11/21/96
Preparation Method: EPA 5030	Date Analyzed: 11/22/96
Method Reference: EPA 8015/8020	Analyst: DL

Analyte	CAS #	Concentration (mg/kg)	Limit of Detection (mg/kg)
<u>BTEX/Gasoline</u>			
Benzene	71-43-2	16	0.5
Ethylbenzene	100-41-4	29	0.5
Toluene	108-88-3	380	0.5
o-Xylene	95-47-6	48	0.5
p,m-Xylenes	--	110	0.5
Gasoline	--	4300	30
MTBE	--	ND	1000
<u>Surrogates</u>		<u>Recovery (%)</u>	<u>QC Limits (%)</u>
a,a,a-Trifluorotoluene	98-08-8	D	50 - 150

ND: Not detected at or above limit of detection
--: Information not available or not applicable

Results are reported on a wet-weight basis, as received.
Note: Detection limits increased due to dilution necessary for quantitation.
D = Surrogate diluted out.

Analytical Results
for
Clayton Environmental Consultants, Inc.
Client Reference: 70-97066.00.000
Clayton Project No. 96112.87

Sample Identification: S-5	Date Sampled: 11/21/96	11/21/96
Lab Number: 9611287-05A	Date Received: 11/21/96	11/21/96
Sample Matrix/Media: SOIL	Date Prepared: 11/21/96	11/21/96
Preparation Method: EPA 5030	Date Analyzed: 11/22/96	11/22/96
Method Reference: EPA 8015/8020	Analyst: DL	DL

Analyte	CAS #	Concentration (mg/kg)	Limit of Detection (mg/kg)
<u>BTEX/Gasoline</u>			
Benzene	71-43-2	0.44	0.05
Ethylbenzene	100-41-4	1.1	0.05
Toluene	108-88-3	2.8	0.05
o-Xylene	95-47-6	1.5	0.05
p,m-Xylenes	--	3.8	0.05
Gasoline	--	220	3
MTBE	--	ND	50
<u>Surrogates</u>		<u>Recovery (%)</u>	<u>QC Limits (%)</u>
a,a,a-Trifluorotoluene	98-08-8	D	50 - 150

ND: Not detected at or above limit of detection

--: Information not available or not applicable

Results are reported on a wet-weight basis, as received.

Note: Detection limits increased due to dilution necessary for quantitation.

D = Surrogate diluted out.

Analytical Results
for
Clayton Environmental Consultants, Inc.
Client Reference: 70-97066.00.000
Clayton Project No. 96112.87

Sample Identification: S-6	Date Sampled: 11/21/96
Lab Number: 9611287-06A	Date Received: 11/21/96
Sample Matrix/Media: SOIL	Date Prepared: 11/21/96
Preparation Method: EPA 5030	Date Analyzed: 11/22/96
Method Reference: EPA 8015/8020	Analyst: DL

Analyte	CAS #	Concentration (mg/kg)	Limit of Detection (mg/kg)
<u>BTEX/Gasoline</u>			
Benzene	71-43-2	4.2	0.05
Ethylbenzene	100-41-4	19	0.05
Toluene	108-88-3	2.4	0.05
o-Xylene	95-47-6	1.3	0.05
p,m-Xylenes	--	59	0.05
Gasoline	--	2500	3
MTBE	--	ND	1000
<u>Surrogates</u>		<u>Recovery (%)</u>	<u>QC Limits (%)</u>
a,a,a-Trifluorotoluene	98-08-8	D	50 - 150

ND: Not detected at or above limit of detection

--: Information not available or not applicable

Results are reported on a wet-weight basis, as received.

Note: Detection limits increased due to dilution necessary for quantitation.

D = Surrogate diluted out.

Analytical Results
for
Clayton Environmental Consultants, Inc.
Client Reference: 70-97066.00.000
Clayton Project No. 96112.87

Sample Identification: S-1	Date Sampled: 11/21/96
Lab Number: 9611287-01A	Date Received: 11/21/96
Sample Matrix/Media: SOIL	Date Prepared: 11/21/96
Preparation Method: EPA 5030	Date Analyzed: 11/22/96
Method Reference: EPA 8015/8020	Analyst: DL

Analyte	CAS #	Concentration (mg/kg)	Limit of Detection (mg/kg)
<u>BTEX/Gasoline</u>			
Benzene	71-43-2	1.2	0.05
Ethylbenzene	100-41-4	12	0.05
Toluene	108-88-3	100	0.05
o-Xylene	95-47-6	20	0.05
p,m-Xylenes	--	46	0.05
Gasoline	--	1800	3
MTBE	--	ND	50
<u>Surrogates</u>		<u>Recovery (%)</u>	<u>QC Limits (%)</u>
a,a,a-Trifluorotoluene	98-08-8	D	50 - 150

ND: Not detected at or above limit of detection

--: Information not available or not applicable

Results are reported on a wet-weight basis, as received.

Note: Detection limits increased due to dilution necessary for quantitation.

D = Surrogate diluted out.

Analytical Results
for
Clayton Environmental Consultants, Inc.
Client Reference: 70-97066.00.000
Clayton Project No. 96112.87

Sample Identification: S-2	Date Sampled: 11/21/96
Lab Number: 9611287-02A	Date Received: 11/21/96
Sample Matrix/Media: SOIL	Date Prepared: 11/21/96
Preparation Method: EPA 5030	Date Analyzed: 11/22/96
Method Reference: EPA 8015/8020	Analyst: DL

Analyte	CAS #	Concentration (mg/kg)	Limit of Detection (mg/kg)
<u>BTEX/Gasoline</u>			
Benzene	71-43-2	0.39	0.05
Ethylbenzene	100-41-4	0.28	0.05
Toluene	108-88-3	0.70	0.05
o-Xylene	95-47-6	0.41	0.05
p,m-Xylenes	--	0.83	0.05
Gasoline	--	70	3
MTBE	--	ND	50
<u>Surrogates</u>			
		<u>Recovery (%)</u>	<u>QC Limits (%)</u>
1,1,1-Trifluorotoluene	98-08-8	D	50 - 150

ND: Not detected at or above limit of detection

--: Information not available or not applicable

Results are reported on a wet-weight basis, as received.

Note: Detection limits increased due to dilution necessary for quantitation.

D = Surrogate diluted out.

Analytical Results
for
Clayton Environmental Consultants, Inc.
Client Reference: 70-97066.00.000
Clayton Project No. 96112.87

Sample Identification: S-3	Date Sampled: 11/21/96
Lab Number: 9611287-03A	Date Received: 11/21/96
Sample Matrix/Media: SOIL	Date Prepared: 11/21/96
Preparation Method: EPA 5030	Date Analyzed: 11/22/96
Method Reference: EPA 8015/8020	Analyst: DL

Analyte	CAS #	Concentration (mg/kg)	Limit of Detection (mg/kg)
<u>BTEX/Gasoline</u>			
Benzene	71-43-2	2.1	0.05
Ethylbenzene	100-41-4	5.3	0.05
Toluene	108-88-3	11	0.05
o-Xylene	95-47-6	9.4	0.05
p,m-Xylenes	--	20	0.05
Gasoline	--	290	3
MTBE	--	ND	50

<u>Surrogates</u>		<u>Recovery (%)</u>	<u>QC Limits (%)</u>
a,a,a-Trifluorotoluene	98-08-8	D	50 - 150

NI: Not detected at or above limit of detection

--: Information not available or not applicable

Results are reported on a wet-weight basis, as received.

Note: Detection limits increased due to dilution necessary for quantitation.

D = Surrogate diluted out.

Analytical Results
for
Clayton Environmental Consultants, Inc.
Client Reference: 70-97066.00.000
Clayton Project No. 96112.87

Sample Identification: S-4	Date Sampled: 11/21/96
Lab Number: 9611287-04A	Date Received: 11/21/96
Sample Matrix/Media: SOIL	Date Prepared: 11/21/96
Preparation Method: EPA 5030	Date Analyzed: 11/22/96
Method Reference: EPA 8015/8020	Analyst: DL

Analyte	CAS #	Concentration (mg/kg)	Limit of Detection (mg/kg)
<u>BTEX/Gasoline</u>			
Benzene	71-43-2	16	0.5
Ethylbenzene	100-41-4	29	0.5
Toluene	108-88-3	380	0.5
o-Xylene	95-47-6	48	0.5
p,m-Xylenes	--	110	0.5
Gasoline	--	4300	30
MTBE	--	ND	1000
<u>Surrogates</u>		<u>Recovery (%)</u>	<u>QC Limits (%)</u>
a,a,a-Trifluorotoluene	98-08-8	D	50 - 150

ND: Not detected at or above limit of detection

--: Information not available or not applicable

Results are reported on a wet-weight basis, as received.

Note: Detection limits increased due to dilution necessary for quantitation.

D = Surrogate diluted out.

Analytical Results
for
Clayton Environmental Consultants, Inc.
Client Reference: 70-97066.00.000
Clayton Project No. 96112.87

Sample Identification: S-5	Date Sampled: 11/21/96
Lab Number: 9611287-05A	Date Received: 11/21/96
Sample Matrix/Media: SOIL	Date Prepared: 11/21/96
Preparation Method: EPA 5030	Date Analyzed: 11/22/96
Method Reference: EPA 8015/8020	Analyst: DL

Analyte	CAS #	Concentration (mg/kg)	Limit of Detection (mg/kg)
<u>BTEX/Gasoline</u>			
Benzene	71-43-2	0.44	0.05
Ethylbenzene	100-41-4	1.1	0.05
Toluene	108-88-3	2.8	0.05
o-Xylene	95-47-6	1.5	0.05
p,m-Xylenes	--	3.8	0.05
Gasoline	--	220	3
MTBE	--	ND	50
<u>Surrogates</u>		<u>Recovery (%)</u>	<u>QC Limits (%)</u>
a,a,a-Trifluorotoluene	98-08-8	D	50 - 150

ND: Not detected at or above limit of detection

--: Information not available or not applicable

Results are reported on a wet-weight basis, as received.

Note: Detection limits increased due to dilution necessary for quantitation.

D = Surrogate diluted out.

Analytical Results
for
Clayton Environmental Consultants, Inc.
Client Reference: 70-97066.00.000
Clayton Project No. 96112.87

Sample Identification: S-6	Date Sampled: 11/21/96
Lab Number: 9611287-06A	Date Received: 11/21/96
Sample Matrix/Media: SOIL	Date Prepared: 11/21/96
Preparation Method: EPA 5030	Date Analyzed: 11/22/96
Method Reference: EPA 8015/8020	Analyst: DL

Analyte	CAS #	Concentration (mg/kg)	Limit of Detection (mg/kg)
<u>BTEX/Gasoline</u>			
Benzene	71-43-2	4.2	0.05
Ethylbenzene	100-41-4	19	0.05
Toluene	108-88-3	2.4	0.05
o-Xylene	95-47-6	1.3	0.05
p,m-Xylenes	--	59	0.05
Gasoline	--	2500	3
MTBE	--	ND	1000
<u>Surrogates</u>		<u>Recovery (%)</u>	<u>OC Limits (%)</u>
a,a,a-Trifluorotoluene	98-08-8	D	50 - 150

ND: Not detected at or above limit of detection

--: Information not available or not applicable

Results are reported on a wet-weight basis, as received.

Note: Detection limits increased due to dilution necessary for quantitation.

D = Surrogate diluted out.

Analytical Results
for
Clayton Environmental Consultants, Inc.
Client Reference: 70-97066.00.000
Clayton Project No. 96112.87

Sample Identification: S-7	Date Sampled: 11/21/96
Lab Number: 9611287-07A	Date Received: 11/21/96
Sample Matrix/Media: SOIL	Date Prepared: 11/21/96
Preparation Method: EPA 5030	Date Analyzed: 11/22/96
Method Reference: EPA 8015/8020	Analyst: DL

Analyte	CAS #	Concentration (mg/kg)	Limit of Detection (mg/kg)
<u>BTEX/Gasoline</u>			
Benzene	71-43-2	0.10	0.05
Ethylbenzene	100-41-4	1.3	0.05
Toluene	108-88-3	0.43	0.05
o-Xylene	95-47-6	ND	0.05
p,m-Xylenes	--	1.3	0.05
Gasoline	--	310	3
MTBE	--	ND	50
<u>Surrogates</u>		<u>Recovery (%)</u>	<u>QC Limits (%)</u>
a,a,a-Trifluorotoluene	98-08-8	D	50 - 150

ND: Not detected at or above limit of detection

--: Information not available or not applicable

Results are reported on a wet-weight basis, as received.

Note: Detection limits increased due to dilution necessary for quantitation.

D = Surrogate diluted out.

Analytical Results
for
Clayton Environmental Consultants, Inc.
Client Reference: 70-97066.00.000
Clayton Project No. 96112.87

Sample Identification: METHOD BLANK	Date Sampled: --
Lab Number: 9611287-16A	Date Received: --
Sample Matrix/Media: SOIL	Date Prepared: 11/21/96
Preparation Method: EPA 5030	Date Analyzed: 11/21/96
Method Reference: EPA 8015/8020	Analyst: DL

Analyte	CAS #	Concentration (mg/kg)	Limit of Detection (mg/kg)
<u>BTEX/Gasoline</u>			
Benzene	71-43-2	ND	0.005
Ethylbenzene	100-41-4	ND	0.005
Toluene	108-88-3	ND	0.005
o-Xylene	95-47-6	ND	0.005
p,m-Xylenes	--	ND	0.005
Gasoline	--	ND	0.3
MTBE	--	ND	5
<u>Surrogates</u>		<u>Recovery (%)</u>	<u>QC Limits (%)</u>
a,a,a-Trifluorotoluene	98-08-8	103	50 - 150

ND: Not detected at or above limit of detection

--: Information not available or not applicable

Results are reported on a wet-weight basis, as received.

REQUEST FOR LABORATORY ANALYTICAL SERVICES

Lemire Sausage

For Clayton Use Only Page 1 of 2

Project No. _____

Batch No. **9611287**

Ind. Code _____ W.P. _____

Date Logged In _____ By _____

REPORT RESULTS TO	Name <i>Ed MacDaniel</i>	Title <i>Proj. Geologist</i>	Purchase Order No. _____	Client Job No. <i>70-99066-00.000</i>	
	Company <i>CEC</i>	Dept. <i>Envl</i>	Name _____	Dept. _____	
	Mailing Address _____		Address _____		
	City, State, Zip <i>Pt Hon</i>		City, State, Zip _____		
Telephone No. _____	Telefax No. _____		ANALYSIS REQUESTED (Enter an 'X' in the box below to indicate request; Enter a 'P' if Preservative added. *)		
Date Results Req.: <i>4/16/96</i>	Rush Charges Authorized? <input type="checkbox"/> Yes <input checked="" type="checkbox"/> No	Phone / Fax Results <input type="checkbox"/> <input type="checkbox"/>	Samples are: (check if applicable)	Number of Containers	
Special Instructions: (method, limit of detection, etc.)			<input type="checkbox"/> Drinking Water		
* Explanation of Preservative:			<input type="checkbox"/> Collected in the State of New York		
CLIENT SAMPLE IDENTIFICATION		DATE SAMPLED	MATRIX/MEDIA	AIR VOLUME (specify units)	FOR LAB USE ONLY
<i>S-1</i>		<i>1/21/96</i>	<i>SOIL</i>	<i>2 1/2" x 6" SSC</i>	<i>01 A</i>
<i>S-2</i>				<i>" ↓</i>	<i>02</i>
<i>S-3</i>				<i>16oz gl</i>	<i>03</i>
<i>S-4</i>				<i>2" x 6" SSC</i>	<i>04</i>
<i>S-5</i>				<i>↓</i>	<i>05</i>
<i>S-6</i>				<i>↓</i>	<i>06</i>
<i>S-7</i>				<i>↓</i>	<i>07</i>
<i>SP-1</i>				<i>16oz gl</i>	<i>08</i>
<i>SP-2</i>				<i>↓</i>	<i>09</i>
<i>SP-3</i>				<i>↓</i>	<i>10</i>
CHAIN OF CUSTODY	Collected by: <i>Ed MacDaniel</i>	(print)	Collector's Signature: <i>[Signature]</i>	Date/Time _____	
	Relinquished by: <i>[Signature]</i>	Date/Time <i>11-21-96/1357</i>	Received by: _____	Date/Time _____	
	Relinquished by: _____	Date/Time _____	Received at Lab by: <i>[Signature]</i>	Date/Time <i>11/21/96 1357 pm</i>	
	Method of Shipment: _____		Sample Condition Upon Receipt: <input checked="" type="checkbox"/> Acceptable <input type="checkbox"/> Other (explain)		
Authorized by: <i>[Signature]</i>	Date <i>11-21-96</i>	(Client Signature Must Accompany Request)			

Please return completed form and samples to one of the Clayton Environmental Consultants, Inc. labs listed below:

- | | | | |
|---|---|--|--|
| 22345 Roethel Drive
Novi, MI 48375
(810) 344-1770 | Raritan Center
160 Fieldcrest Ave.
Edison, NJ 08837
(908) 225-6040 | 400 Chastain Center Blvd., N.W.
Suite 490
Kennesaw, GA 30144
(404) 499-7500 | 1252 Quarry Lane
Pleasanton, CA 94566
(510) 426-2657 |
|---|---|--|--|

DISTRIBUTION:
WHITE - Clayton Laboratory
YELLOW - Clayton Accounting
PINK - Client Retains

REQUEST FOR LABORATORY ANALYTICAL SERVICES

For Clayton Use Only Page 2 of 2

Project No. _____

Batch No. **9611287**

Ind. Code _____ W.P. _____

Date Logged In _____ By _____

REPORT RESULTS TO	Name <u>Ed MacDance</u>	Title <u>Proj. Geologist</u>	Purchase Order No.	Client Job No. <u>90-97066.00.000</u>																																																																			
	Company <u>CEC</u>	Dept. <u>Env</u>	Name																																																																				
	Mailing Address		Company	Dept.																																																																			
	City, State, Zip		Address																																																																				
Telephone No. <u>714-441-1100</u>	Telefax No.	City, State, Zip																																																																					
Date Results Req.: <u>24h TAT</u>	Push Charges Authorized? <input type="checkbox"/> Yes <input checked="" type="checkbox"/> No	Phone / Fax Results <input type="checkbox"/> <input type="checkbox"/>	ANALYSIS REQUESTED (Enter an 'X' in the box below to indicate request; Enter a 'P' if Preservative added. *)																																																																				
Special Instructions: (method, limit of detection, etc.)		Samples are: (check if applicable) <input type="checkbox"/> Drinking Water <input type="checkbox"/> Collected in the State of New York	<table border="1"> <tr> <td rowspan="6">Number of Containers</td> <td colspan="10">/ HOLD</td> <td>FOR LAB USE ONLY</td> </tr> <tr> <td>1</td> <td></td><td></td><td></td><td></td><td></td><td></td><td></td><td></td><td></td> <td>11 A</td> </tr> <tr> <td></td><td></td><td></td><td></td><td></td><td></td><td></td><td></td><td></td><td></td> <td>12</td> </tr> <tr> <td></td><td></td><td></td><td></td><td></td><td></td><td></td><td></td><td></td><td></td> <td>13</td> </tr> <tr> <td></td><td></td><td></td><td></td><td></td><td></td><td></td><td></td><td></td><td></td> <td>14</td> </tr> <tr> <td></td><td></td><td></td><td></td><td></td><td></td><td></td><td></td><td></td><td></td> <td>15</td> </tr> </table>		Number of Containers	/ HOLD										FOR LAB USE ONLY	1										11 A											12											13											14											15
Number of Containers	/ HOLD										FOR LAB USE ONLY																																																												
	1													11 A																																																									
														12																																																									
														13																																																									
														14																																																									
											15																																																												
* Explanation of Preservative:																																																																							
CLIENT SAMPLE IDENTIFICATION		DATE SAMPLED	MATRIX/MEDIA	AIR VOLUME (specify units)																																																																			
SP-4		11/21/96	Soil	6609 g	1	X																																																																	
SP-5		↓	↓	↓	↓	↓																																																																	
SP-6		↓	↓	↓	↓	↓																																																																	
SP-7		↓	↓	↓	↓	↓																																																																	
SP-8		↓	↓	↓	↓	↓																																																																	
CHAIN OF CUSTODY	Collected by: <u>Ed MacDance</u>	(print)	Collector's Signature: <u>[Signature]</u>	Date/Time																																																																			
	Relinquished by: <u>[Signature]</u>	Date/Time <u>11-21-96/1357</u>	Received by:	Date/Time																																																																			
	Relinquished by:	Date/Time	Received at Lab by: <u>MUC</u>	Date/Time <u>11/21/96 1357</u>																																																																			
	Method of Shipment:		Sample Condition Upon Receipt: <input checked="" type="checkbox"/> Acceptable <input type="checkbox"/> Other (explain)																																																																				
Authorized by: <u>[Signature]</u>	Date <u>11-21-96</u>	(Client Signature Must Accompany Request)																																																																					

Please return completed form and samples to one of the Clayton Environmental Consultants, Inc. labs listed below:

22345 Roethel Drive Novi, MI 48375 (810) 344-1770	Faritan Center 160 Fieldcrest Ave. Edison, NJ 08837 (908) 225-6040	400 Chastain Center Blvd., N.W. Suite 490 Kennesaw, GA 30144 (404) 499-7500	1252 Quarry Lane Pleasanton, CA 94566 (510) 426-2657
---	---	--	--

DISTRIBUTION:

- WHITE - Clayton Laboratory
- YELLOW - Clayton Accounting
- PINK - Client Retains

SHEET NO. _____ OF _____
PROJECT _____
DATE _____
BY _____ CKD

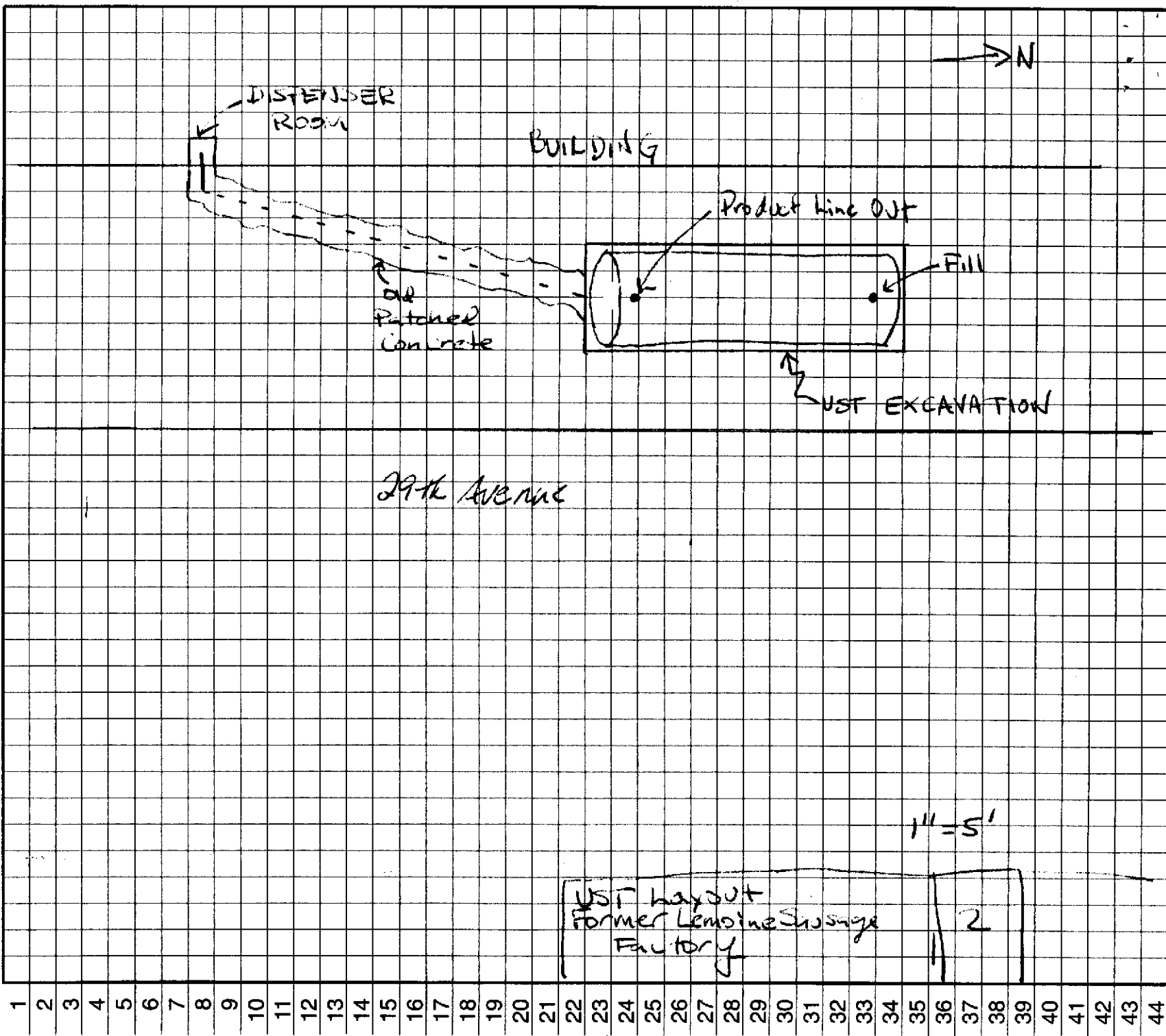

1
2
3
4
5
6
7
8
9
10
11
12
13
14
15
16
17
18
19
20
21
22
23
24
25
26
27
28
29
30
31
32
33
34
35
36
37
38
39
40
41
42
43
44

SHEET NO. _____ OF _____
PROJECT _____
DATE _____
BY _____ CKD _____

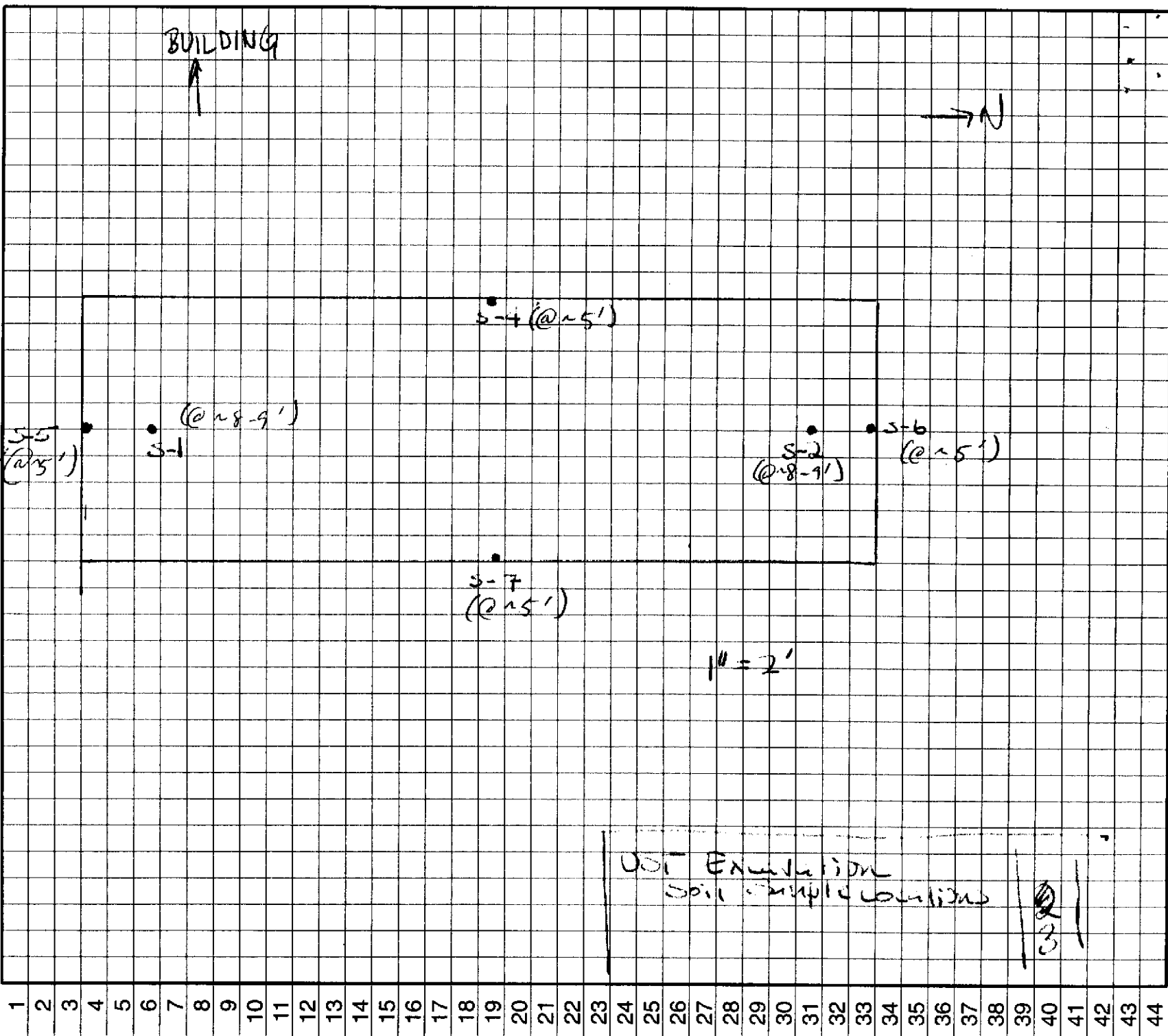

SHEET NO. _____ OF _____
PROJECT _____
DATE _____
BY _____ CKD _____

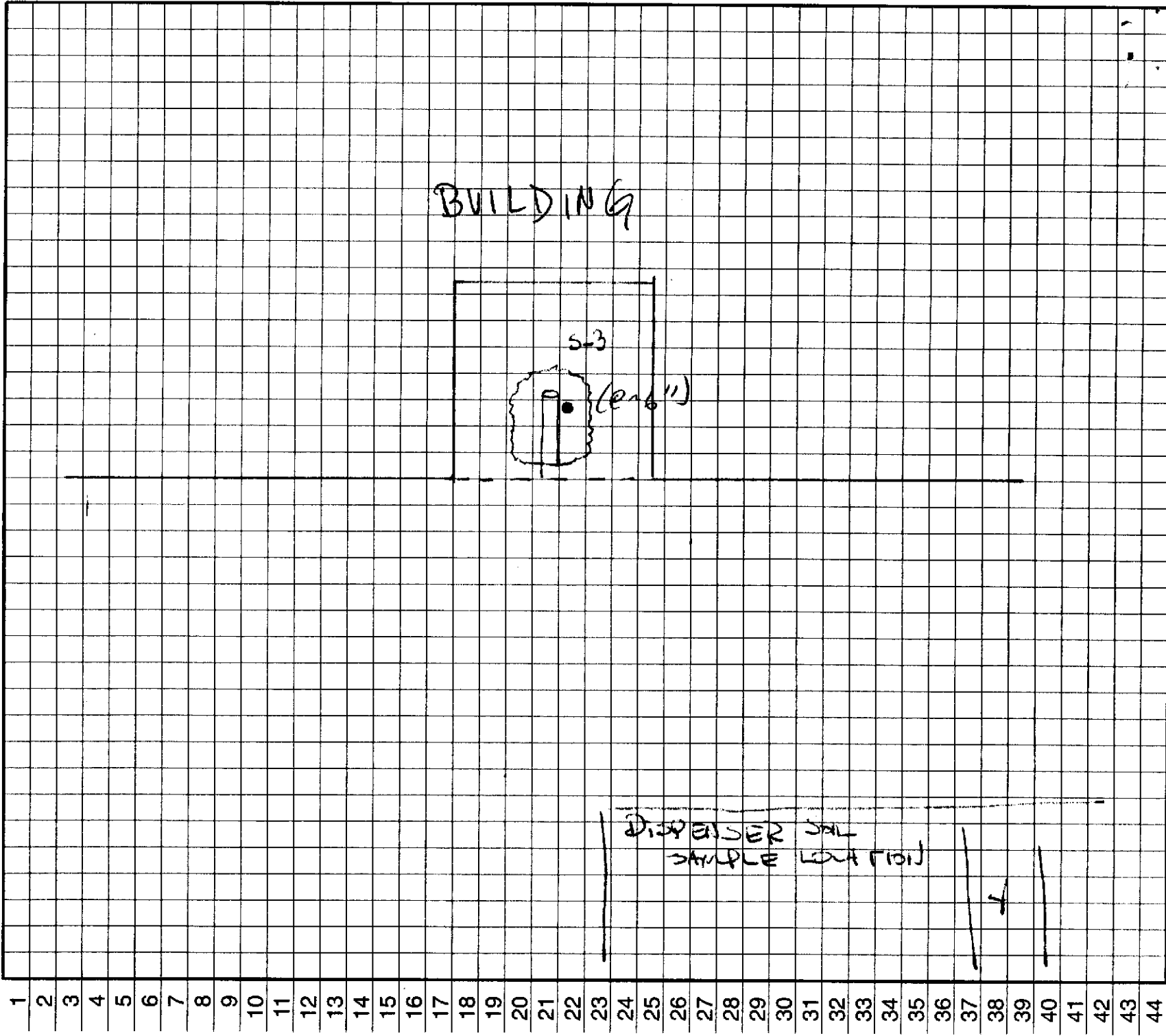

1
2
3
4
5
6
7
8
9
10
11
12
13
14
15
16
17
18
19
20
21
22
23
24
25
26
27
28
29
30
31
32
33
34
35
36
37
38
39
40
41
42
43
44