

GRIBI Associates *Geological and Environmental Consulting Services*

June 23, 2005

GA Project No. 147-01-03

Alameda County Department of
Environmental Health
1131 Harbor Bay Parkway, 2nd Floor
Alameda, CA 94502

Attention: Ms. Donna Drogos

Subject: Second Quarter 2005 Groundwater Monitoring Report
Dublin Toyota UST Site
6450 Dublin Court
Dublin, California
Alameda County LOP Site ID No. 699

Alameda County
OCT 18 2005
Environmental Health

Ladies and Gentlemen:

Gribi Associates is pleased to submit this Second Quarter 2005 Groundwater Monitoring Report on behalf of Dublin Toyota for the underground storage tank (UST) site located at 6450 Dublin Court in Dublin, California (see Figure 1 and Figure 2). This report summarizes groundwater monitoring activities conducted at the site on June 10, 2005.

DESCRIPTION OF SAMPLING ACTIVITIES

On June 10, 2005, Gribi Associates personnel conducted groundwater monitoring activities for three site wells (MW-1, MW-2 and MW-3). Groundwater monitoring was conducted in accordance with California LUFT Field Manual guidelines as follows:

- All wells were opened, and water levels were measured to the nearest 0.01 foot using an electronic probe.
- For each well, a single bail of groundwater was taken using a clean PVC bailer to check for the presence or absence of floating free product.
- Prior to sampling, each well was purged of approximately three well volumes using a submersible pump. During purging, temperature, pH, conductivity, and visible clarity were monitored and recorded. Groundwater sampling data sheets for each well are contained in Attachment A.
- After purging approximately three times a single well volume, groundwater was poured directly into laboratory-supplied containers. Each container was then tightly sealed, making sure that no air bubbles were present. Each container was then labeled and placed in cold storage for transport to the analytical laboratory under formal chain-of-custody.

RESULTS OF GROUNDWATER MONITORING

Hydrologic Conditions

Groundwater depths ranged from approximately 4.8 feet below surface at monitoring wells MW-2 and MW-3 to 6.2 feet below surface at monitoring well MW-1. Groundwater flow direction (see Figure 3) trends in a southwesterly direction and appears to be generally related to surface topography. Purged groundwater from monitoring wells MW-2 and MW-3 did not exhibit hydrocarbon odors and purged groundwater from MW-1 exhibited slight hydrocarbon odor. Purge groundwater from the three wells did not exhibit hydrocarbon sheens.

Laboratory Analytical Results

Groundwater samples from the three wells were analyzed for the following parameters with standard method turn around time on results.

- USEPA 8015M Total Petroleum Hydrocarbons as Gasoline (TPH-G)
- USEPA 8260B Benzene, Toluene, Ethylbenzene, Xylenes (BTEX)
- USEPA 8260B Methyl-t-butyl Ether (MTBE)
- USEPA 8260B Oxygenates (TBA, MTBE, DIPE, ETBE, and TAME)

Groundwater analytical results are summarized in Table 1. Groundwater MTBE results for this monitoring event are summarized on Figure 3. The laboratory analytical data report is contained in Attachment B.

CONCLUSIONS

Groundwater sampling results from this First Quarter 2005 groundwater monitoring event showed an increase in MTBE concentration in groundwater at monitoring well MW-1 relative to last quarter with groundwater concentrations increasing to 25,000 ppb MTBE from 6,900 ppb MTBE. The recent MTBE concentration at MW-1 is still well below the historic high MTBE groundwater concentrations for the well.

MTBE groundwater concentrations at monitoring wells MW-2 and MW-3 were similar to previous groundwater monitoring events with concentrations of 14 ppb MTBE and 230 ppb, respectively.

In May, Gribi Associates drilled 12 borings at the subject site as part of a soil/water investigation to further delineate MTBE soil and groundwater impacts. The borings ranged in depth from approximately 30 to 50 feet in depth. Approximately two soil samples (one shallow and one deep) and two groundwater samples (one shallow and one deep) were collected at each boring and submitted to a state-certified laboratory for analysis.

The results of the investigation revealed that there was a shallow MTBE groundwater plume near and downgradient of the source area, and a deeper MTBE groundwater plume further downgradient

Ms. Donna Drogos
Alameda County Department of Environmental Health
June 23, 2005
Page 3

of the source area. Gribi Associates has submitted a report to the Alameda County department of Environmental Health (County) documenting the activities and results of the investigation. In addition, Gribi Associates also proposed the installation of additional monitoring wells (both shallow and deep) that are pending approval from the County.

We appreciate this opportunity to provide this report for your review. Please contact us if there are questions or if additional information is required.

Very truly yours,

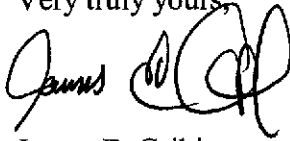

James E. Gribi
Registered Geologist
California No. 5843

Matthew A. Rosman
Engineer

Enclosure

cc: Mr. Scott Anderson, Dublin Toyota

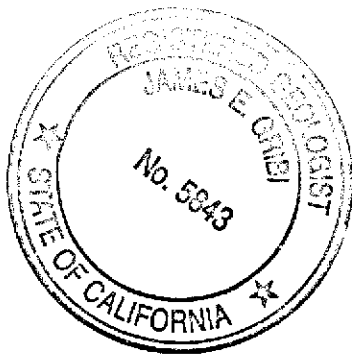

Alameda County

OCT 1 8 2005

Environmental Health

FIGURES

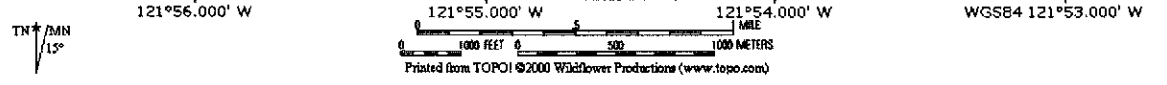
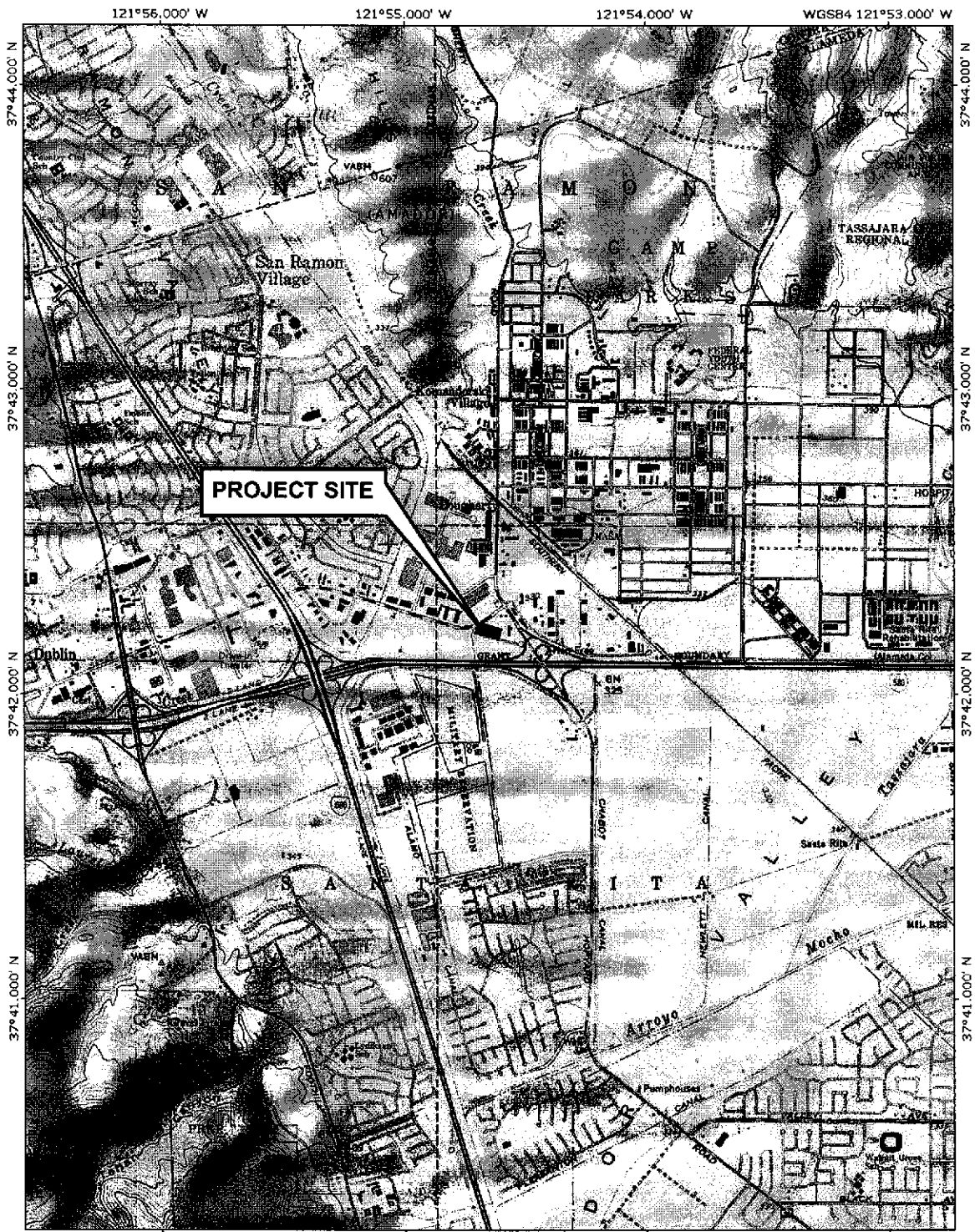

DESIGNED BY:	CHECKED BY:
DRAWN BY: EGH	SCALE:
PROJECT NO: 147-01-01	

SITE VICINITY MAP

DUBLIN TOYOTA
6450 DUBLIN COURT
DUBLIN, CALIFORNIA

DATE: 05/07/03	FIGURE: 1
GRIBI Associates	

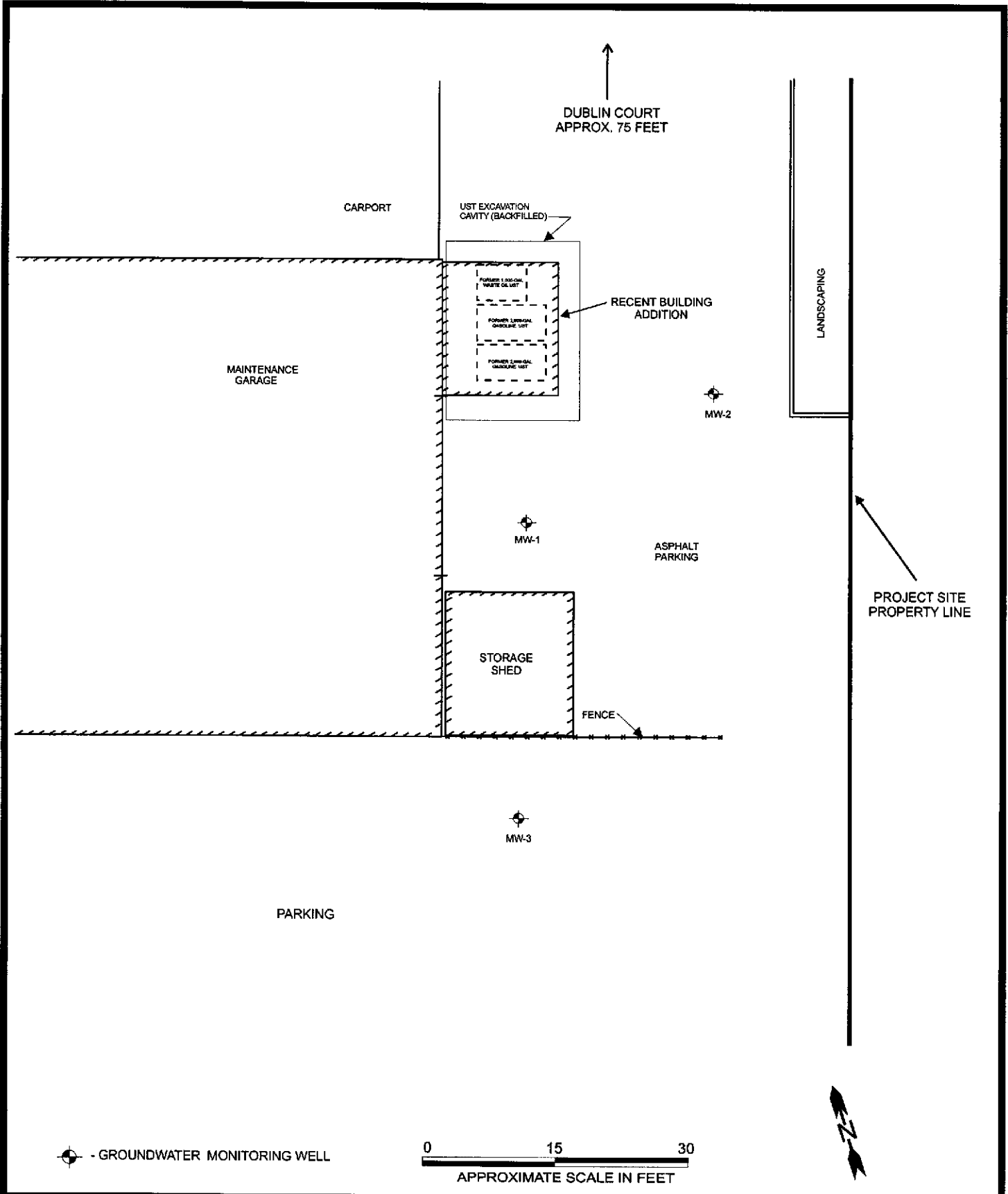

⊕ - GROUNDWATER MONITORING WELL

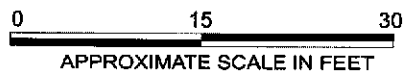

DESIGNED BY:	CHECKED BY:	SITE PLAN	DATE: 6/23/05	FIGURE: 2
DRAWN BY: MR	SCALE:		GRIBI Associates	
PROJECT NO: 147-01-03		DUBLIN TOYOTA UST SITE 6450 DUBLIN COURT DUBLIN, CALIFORNIA		

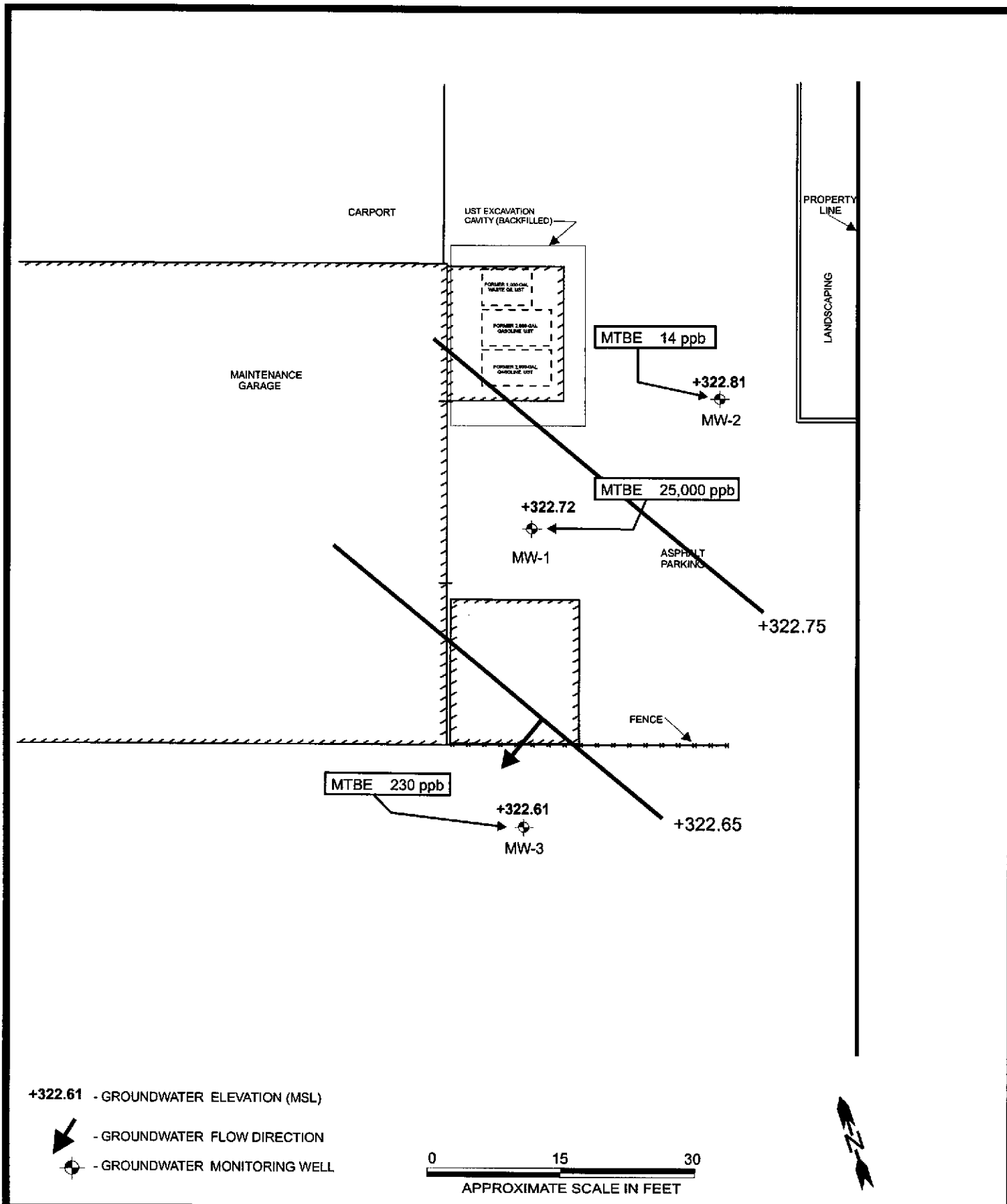

DESIGNED BY:	CHECKED BY:	GROUNDWATER GRADIENT & MTBE CONCENTRATIONS, 06/10/05 DUBLIN TOYOTA UST SITE 6450 DUBLIN COURT DUBLIN, CALIFORNIA	DATE: 6/23/05	FIGURE: 3
DRAWN BY: MR	SCALE:		GRIBI Associates	
PROJECT NO: 147-01-03				

Table 1
SUMMARY OF GROUNDWATER ANALYTICAL RESULTS
 Dublin Toyota UST Site

Sample ID	Sample Date	GW Elevation	Concentration (µg/l)											
			TPH-D	TPH-MO	TPH-G	B	T	E	X	TAME	TBA	DIPE	ETBE	MTBE
MW-1	12/15/98	323.15	<0.050	110	46,000	<100	<100	<100	<100	--	--	--	--	62,000
<328.89>	04/06/99	323.80	<50	<100	45,000	<50	<50	<50	<50	--	--	--	--	86,000 ¹
	07/14/99	322.71	<50	<100	2,800	<100	<100	<100	<100	--	--	--	--	65,000 ¹
	10/14/99	322.03	<50	<100	11,000	<17	<17	<17	<17	--	--	--	--	98,000 ¹
	08/18/00	321.91	<50	<100	36,000	<50	<50	<50	<50	--	--	--	--	66,000 ¹
	05/29/02	322.47	--	--	29,100	<15	<15	<15	<30	841	<500	<100	N50	27,800 ¹
	11/20/02	322.24	--	--	110	<0.5	<0.5	<0.5	<1.0	<20	<50	<20	<20	20,000
	04/06/03	322.94	--	--	1,300	<1.0	<1.0	<1.0	<1.0	10	360	<2.0	2.2	15,000
	07/13/03	322.34	--	--	74	<0.5	<0.5	<0.5	<1.0	10	42	<5.0	<5.0	15,000
	02/11/04	323.15	--	--	<50	<0.5	<0.5	<0.5	<1.0	10	420	<2.0	2.5	34,000
	06/16/04	322.52	--	--	180	<0.5	<0.5	<0.5	<1.0	6.8	290	<2.0	<2.0	7,600
	10/16/04	321.60	--	--	<50	<0.5	<0.5	<0.5	<1.0	<2.0	<10	<2.0	<2.0	6,720
	12/30/04	323.05	--	--	92	<0.5	<0.5	<0.5	<1.0	5.2	<10	<2.0	<2.0	2,600
	3/22/05	323.67	--	--	<50	<0.5	<0.5	<0.5	<1.0	7.3	<10	<2.0	<2.0	6,900
	6/10/05	322.72	--	--	100	<0.5	<0.5	<0.5	<1.0	9.8	<10	<2.0	<2.0	25,000
MW-2	12/15/98	323.34	<50	570	<50	<0.50	0.90	<0.50	1.5	--	--	--	--	<5.0
<327.64>	04/06/99	324.22	<50	<100	<50	<0.50	<0.50	<0.50	<0.50	--	--	--	--	<5.0
	7/14/99	322.88	<50	<100	<50	<0.50	<0.50	<0.50	<0.50	--	--	--	--	<5.0

Table 1
SUMMARY OF GROUNDWATER ANALYTICAL RESULTS
 Dublin Toyota UST Site

Sample ID	Sample Date	GW Elevation	Concentration (µg/l)											
			TPH-D	TPH-MO	TPH-G	B	T	E	X	TAME	TBA	DIFE	ETBE	MTBE
	10/14/99	322.16	<50	<100	<50	<0.50	<0.50	<0.50	<0.50	--	--	--	--	<5.0
	08/18/00	321.92	<50	<100	<50	<0.50	<0.50	<0.50	1.1	--	--	--	--	16
	05/29/02	322.46	--	--	<50	<0.3	<0.3	<0.3	3.9	<2.0	<10	<2.0	<2.0	2.6
	11/20/02	322.12	--	--	57	<0.5	<0.5	<0.5	<1.0	<20	<50	<20	<20	9.1
	04/06/03	323.05	--	--	<50	<1.0	<1.0	<1.0	<1.0	<2.0	<10	<2.0	<2.0	5.7
	07/13/03	322.40	--	--	<50	<0.5	<0.5	<0.5	<1.0	<5.0	<10	<5.0	<5.0	6.5
	02/11/04	323.19	--	--	<50	<0.5	<0.5	<0.5	<1.0	<2.0	<10	<2.0	<2.0	8.5
	06/16/04	322.71	--	--	<50	<0.5	<0.5	<0.5	<1.0	<2.0	<10	<2.0	<2.0	120
	10/16/04	321.67	--	--	78	<0.5	<0.5	<0.5	<1.0	4.1	<10	<2.0	<2.0	43.2
	12/30/04	322.90	--	--	<50	<0.5	<0.5	<0.5	<1.0	4.1	<10	<2.0	<2.0	14
	3/22/05	323.78	--	--	<50	<0.5	<0.5	<0.5	<1.0	<2.0	<10	<2.0	<2.0	13
	6/10/05	322.81	--	--	<50	<0.5	<0.5	<0.5	<1.0	<2.0	<10	<2.0	<2.0	14
MW-3	08/18/00	321.77	<50	<100	210	<0.50	0.58	<0.50	0.59	--	--	--	--	570 ¹
<327.44>	05/29/02	322.34	--	--	<50	<0.3	<0.3	<0.3	219	<2.0	<10	<2.0	<2.0	281
	11/20/02	321.88	--	--	200	<0.5	<0.5	<0.5	<1.0	<20	<50	<20	<20	460
	04/06/03	322.80	--	--	270	<1.0	<1.0	<1.0	<1.0	<2.0	<10	<2.0	<2.0	340
	07/13/03	321.96	--	--	<50	<0.5	<0.5	<0.5	<1.0	<5.0	<10	<5.0	<5.0	460
	02/11/04	322.97	--	--	<50	<0.5	<0.5	<0.5	<1.0	2.2	1,000	<2.0	<2.0	4,000

Table 1
SUMMARY OF GROUNDWATER ANALYTICAL RESULTS
 Dublin Toyota UST Site

Sample ID	Sample Date	GW Elevation	Concentration (µg/l)											
			TPH-D	TPH-MO	TPH-G	B	T	E	X	TAME	TBA	DIPE	ETBE	MTBE
	06/16/04	322.21	--	--	<50	<0.5	<0.5	<0.5	<1.0	<2.0	<10	<2.0	<2.0	240
	10/16/04	321.52	--	--	<50	<0.5	<0.5	<0.5	<1.0	<2.0	<10	<2.0	<2.0	210
	12/30/04	322.90	--	--	<50	<0.5	<0.5	<0.5	<1.0	<2.0	120	<2.0	<2.0	190
	3/22/05	323.54	--	--	<50	<0.5	<0.5	<0.5	<1.0	<2.0	<10	<2.0	<2.0	210
	6/10/05	322.61	--	--	<50	<0.5	<0.5	<0.5	<1.0	<2.0	<10	<2.0	<2.0	230

Table Notes:

GW Elevation = Groundwater mean sea level elevation.
 TPH-D = Total Petroleum Hydrocarbons as Diesel
 TPH-MO = Total Petroleum Hydrocarbons as Motor Oil
 TPH-G = Total Petroleum Hydrocarbons as Gasoline
 B = Benzene
 T = Toluene
 E = Ethylbenzene
 X = Xylenes
 TAME = Tert-amyl Methyl Ether
 TBA = tert-Butanol

DIPE = Diisopropyle ether ETBE = Ethyl-tert-butyl ether
 MTBE = Methyl-t-Butyl Ether
 NA = Not analyzed for particular parameter
 <0.050 = Not detected above the expressed value.
 <328.89> = Surveyed top of casing mean sea level elevation.
 1 = MTBE result was confirmed using USEPA Method 8260B.
 2 = MW-1 and MW-2 laboratory results reported by Sunstar Laboratories appear to be mistakenly switched. This has been corrected herein.

ATTACHMENT A

GROUNDWATER MONITORING FIELD DATA RECORDS

Groundwater Monitoring Field Sheet

Site Dublin Toyota
 Sampling Personnel M. Rosmer
 Weather Conditions clear, mild

Project No. 147-0403
 Date 6/10/05

128.10
 - 6.2

 13.8
 x 2

 27.6

Well ID MW-1 Casing Diameter (inches) 2"
 Depth to Water (ft) 6.17 Total Depth (ft) 20.0
 Water Column (ft) 13.8 One Well Volume (gal) 2.8
 3X Well Volume (gal) ~9

Notes:
 One Well Volume is determined by multiplying "Water Column" by:
 • 0.059 for 1/4 inch well, 0.17 for 2 inch well, 0.38 for 3 inch well, 0.66 for 4 inch well, 1.50 for 6 inch well

Field Methods (check appropriate box)

Activity	Bailer	Pump	Comments
Purge Method	X		
Sample Method	X		

Field Parameters Not Collected

Time	Volume Purged (gal)	Temp. (Celsius)	E.C. (mS/cm)	D.O. (mg/L)	pH	ORP (mv)	Comments
 							
 							
 							
 							
 							

Sample Observations

Characteristic	None	Slight	Moderate	Strong	Comments
Color		X			grey
Odor		X			hydrocarbon
Turbidity		X			
Sheen	X				
Floating Particles	X				
Precipitate	X				

Sample Time 1335

Sampler's Signature *M. Rosmer*

Groundwater Monitoring Field Sheet

Site Dublin Toyota
 Sampling Personnel M. Rasmussen
 Weather Conditions Clear, mild

Project No. 147-01-03
 Date 6/10/05

$$\begin{array}{r} 28.10 \\ - 4.8 \\ \hline 15.2 \\ \times 1.2 \\ \hline 3.64 \end{array}$$

Well ID MW-3 Casing Diameter (inches) 2"
 Depth to Water (ft) 4.83 Total Depth (ft) 20.0
 Water Column (ft) 15.2 One Well Volume (gal) ~30
 3X Well Volume (gal) ~9.0

Notes:
 One Well Volume is determined by multiplying "Water Column" by:
 • 0.059 for ¼ inch well, 0.17 for 2 inch well, 0.38 for 3 inch well, 0.66 for 4 inch well, 1.50 for 6 inch well

Field Methods (check appropriate box)

Activity	Bailer	Pump	Comments
Purge Method	<input checked="" type="checkbox"/>		
Sample Method	<input checked="" type="checkbox"/>		

Field Parameters Not Collected

Time	Volume Purged (gal)	Temp. (Celsius)	E.C. (mS/cm)	D.O. (mg/L)	pH	ORP (mv)	Comments

Sample Observations

Characteristic	None	Slight	Moderate	Strong	Comments
Color	<input checked="" type="checkbox"/>				
Odor	<input checked="" type="checkbox"/>				
Turbidity	<input checked="" type="checkbox"/>				
Sheen	<input checked="" type="checkbox"/>				
Floating Particles	<input checked="" type="checkbox"/>				
Precipitate	<input checked="" type="checkbox"/>				

Sample Time 1415

Sampler's Signature M. Rasmussen

Groundwater Monitoring Field Sheet

Site Dublin Toyota
 Sampling Personnel M. Rosman
 Weather Conditions Clear, mild

Project No. 147-01-03
 Date 6/10/05

Well ID MW-2 Casing Diameter (inches) 2"
 Depth to Water (ft) 4.83 Total Depth (ft) 20.0
 Water Column (ft) 15.2 One Well Volume (gal) 23
 3X Well Volume (gal) ~9

16.0
 - 4.8

 11.2
 x .2

 3.04

Notes:

One Well Volume is determined by multiplying "Water Column" by:
 • 0.059 for 1/4 inch well, 0.17 for 2 inch well, 0.38 for 3 inch well, 0.66 for 4 inch well, 1.50 for 6 inch well

Field Methods (check appropriate box)

Activity	Bailer	Pump	Comments
Purge Method	X		
Sample Method	X		

Field Parameters

Not Collected.

Time	Volume Purged (gal)	Temp. (Celsius)	E.C. (mS/cm)	D.O. (mg/L)	pH	ORP (mv)	Comments

Sample Observations

Characteristic	None	Slight	Moderate	Strong	Comments
Color		X			gray-brown
Odor	X				
Turbidity		X			
Sheen	X				
Floating Particles	X				
Precipitate	X				

Sample Time 1300

Sampler's Signature MAR

ATTACHMENT B

**LABORATORY DATA REPORTS AND
CHAIN-OF-CUSTODY RECORDS**

20 June 2005

Jim Gribi
Gribi Associates
1090 Adam Street, Suite K
Benicia, CA 94510
RE: Dublin Toyota

Enclosed are the results of analyses for samples received by the laboratory on 06/14/05 12:00. If you have any questions concerning this report, please feel free to contact me.

Sincerely,

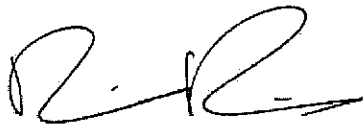
A handwritten signature in black ink, appearing to read "D. Doming", with a stylized flourish at the end.

Dennis Doming
Project Manager

SunStar Laboratories, Inc.
 3002 Dow Ave, Suite 212
 Tustin, CA 92780
 1-800-781-6777

Chain of Custody Record

T500714

Client: GRIBI ASSOCIATES
 Address: 1090 ADAMS STREET, SUITE K
 Phone: (707) 748-7743 Fax: (707) 748-7763
 Project Manager: JAMES GRIBI

Date: 6/13/05 Page: 1 Of 1
 Project Name: DUBLIN TOYOTA
 Collector: MATTHEW ROSMAN Client Project #: 147-01-03
 Batch #: _____ Proposal #: _____

Sample ID	Date Sampled	Time	Sample Type	Container Type	BTEX/TPH Gas/MTBE (80218/M8015)	TPH as Gas (M8015)	TPH as Diesel (M8015)	TPH as Motor Oil (M8015)	TPH Gas/BTEX/MTBE (8260B)	6 Oxygenates/BTEX (8260B)	7 Oxygenates/TPH Gas/BTEX (8260B)	5 Oxygenates (8260B)	Lead Scav (1,2 DCA & 1,2 EDB (8260B)	EPA 8260 (Full List)	Hydrogenated VOCs (8260B)	Laboratory ID #	Preservative	Comments	Total # of containers
MW-1	6/13/05	1335	Water	VOA	X				X							01	HCl		4
MW-2	↓	1300	Water	VOA	X				X							02	HCl		4
MW-3	↓	1415	Water	VOA	X				X							03	HCl		4

Relinquished by: (signature) <i>MRS</i>	Date / Time 6/13/05 / 1000	Received by: (signature) <i>Don Orata</i>	Date / Time 6/13/05 10:00 AM	Total # of containers	12	Notes
Relinquished by: (signature) 650	Date / Time 6/14/05	Received by: (signature) <i>Ami T. H...</i>	Date / Time 6/14/05 1200	Chain of Custody seals Y/N/NA		
Relinquished by: (signature)	Date / Time	Received by: (signature)	Date / Time	Seals intact? Y/N/NA		
Relinquished by: (signature)	Date / Time	Received by: (signature)	Date / Time	Received good condition?	13	
Turn around time: <i>STAY</i>						

Sample disposal Instructions: Disposal @ \$2.00 each _____ Return to client _____ Pickup _____

Gribi Associates
1090 Adam Street, Suite K
Benicia CA, 94510

Project: Dublin Toyota
Project Number: 147-01-03
Project Manager: Jim Gribi

Reported:
06/20/05 16:20

ANALYTICAL REPORT FOR SAMPLES

Sample ID	Laboratory ID	Matrix	Date Sampled	Date Received
MW-1	T500714-01	Water	06/10/05 13:35	06/14/05 12:00
MW-2	T500714-02	Water	06/10/05 13:00	06/14/05 12:00
MW-3	T500714-03	Water	06/10/05 14:15	06/14/05 12:00

SunStar Laboratories, Inc.



Dennis Dorning, Project Manager

The results in this report apply to the samples analyzed in accordance with the chain of custody document. This analytical report must be reproduced in its entirety.

Gribi Associates
 1090 Adam Street, Suite K
 Benicia CA, 94510

Project: Dublin Toyota
 Project Number: 147-01-03
 Project Manager: Jim Gribi

Reported:
 06/20/05 16:20

MW-1
T500714-01 (Water)

Analyte	Result	Reporting Limit	Units	Dilution	Batch	Prepared	Analyzed	Method	Notes
---------	--------	-----------------	-------	----------	-------	----------	----------	--------	-------

SunStar Laboratories, Inc.

Purgeable Petroleum Hydrocarbons by EPA 8015m

C6-C12 (GRO)	100	50	ug/l	1	5061510	06/15/05	06/15/05	EPA 8015m	
<i>Surrogate: 4-Bromofluorobenzene</i>		<i>96.2 %</i>	<i>65-135</i>		<i>"</i>	<i>"</i>	<i>"</i>	<i>"</i>	

Volatile Organic Compounds by EPA Method 8260B

Benzene	ND	0.50	ug/l	1	5061505	06/15/05	06/15/05	EPA 8260B	
Toluene	ND	0.50	"	"	"	"	"	"	
Ethylbenzene	ND	0.50	"	"	"	"	"	"	
m,p-Xylene	ND	1.0	"	"	"	"	"	"	
o-Xylene	ND	0.50	"	"	"	"	"	"	
Tert-amyl methyl ether	9.8	2.0	"	"	"	"	"	"	
Tert-butyl alcohol	ND	10	"	"	"	"	"	"	
Di-isopropyl ether	ND	2.0	"	"	"	"	"	"	
Ethyl tert-butyl ether	ND	2.0	"	"	"	"	"	"	
Methyl tert-butyl ether	25000	50	"	50	"	"	06/16/05	"	
<i>Surrogate: Toluene-d8</i>		<i>100 %</i>	<i>87.6-115</i>		<i>"</i>	<i>"</i>	<i>06/15/05</i>	<i>"</i>	
<i>Surrogate: 4-Bromofluorobenzene</i>		<i>107 %</i>	<i>80-112</i>		<i>"</i>	<i>"</i>	<i>"</i>	<i>"</i>	
<i>Surrogate: Dibromofluoromethane</i>		<i>101 %</i>	<i>78.6-122</i>		<i>"</i>	<i>"</i>	<i>"</i>	<i>"</i>	

SunStar Laboratories, Inc.

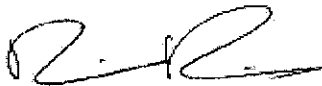

Dennis Dorning, Project Manager

The results in this report apply to the samples analyzed in accordance with the chain of custody document. This analytical report must be reproduced in its entirety.

Gribi Associates
1090 Adam Street, Suite K
Benicia CA, 94510

Project: Dublin Toyota
Project Number: 147-01-03
Project Manager: Jim Gribi

Reported:
06/20/05 16:20

MW-2
T500714-02 (Water)

Analyte	Result	Reporting Limit	Units	Dilution	Batch	Prepared	Analyzed	Method	Notes
---------	--------	-----------------	-------	----------	-------	----------	----------	--------	-------

SunStar Laboratories, Inc.

Purgeable Petroleum Hydrocarbons by EPA 8015m

C6-C12 (GRO)	ND	50	ug/l	1	5061510	06/15/05	06/15/05	EPA 8015m	
Surrogate: 4-Bromofluorobenzene		111 %	65-135		"	"	"	"	

Volatile Organic Compounds by EPA Method 8260B

Benzene	ND	0.50	ug/l	1	5061505	06/15/05	06/15/05	EPA 8260B	
Toluene	ND	0.50	"	"	"	"	"	"	
Ethylbenzene	ND	0.50	"	"	"	"	"	"	
m,p-Xylene	ND	1.0	"	"	"	"	"	"	
o-Xylene	ND	0.50	"	"	"	"	"	"	
Tert-amyl methyl ether	ND	2.0	"	"	"	"	"	"	
Tert-butyl alcohol	ND	10	"	"	"	"	"	"	
Di-isopropyl ether	ND	2.0	"	"	"	"	"	"	
Ethyl tert-butyl ether	ND	2.0	"	"	"	"	"	"	
Methyl tert-butyl ether	14	1.0	"	"	"	"	"	"	
Surrogate: Toluene-d8		102 %	87.6-115		"	"	"	"	
Surrogate: 4-Bromofluorobenzene		108 %	80-112		"	"	"	"	
Surrogate: Dibromofluoromethane		96.5 %	78.6-122		"	"	"	"	

SunStar Laboratories, Inc.



Dennis Dorning, Project Manager

The results in this report apply to the samples analyzed in accordance with the chain of custody document. This analytical report must be reproduced in its entirety.

Gribi Associates
 1090 Adam Street, Suite K
 Benicia CA, 94510

Project: Dublin Toyota
 Project Number: 147-01-03
 Project Manager: Jim Gribi

Reported:
 06/20/05 16:20

MW-3
T500714-03 (Water)

Analyte	Result	Reporting Limit	Units	Dilution	Batch	Prepared	Analyzed	Method	Notes
SunStar Laboratories, Inc.									
Purgeable Petroleum Hydrocarbons by EPA 8015m									
C6-C12 (GRO)	97	50	ug/l	1	5061510	06/15/05	06/15/05	EPA 8015m	
<i>Surrogate: 4-Bromofluorobenzene</i>		112 %	65-135		"	"	"	"	
Volatile Organic Compounds by EPA Method 8260B									
Benzene	ND	0.50	ug/l	1	5061505	06/15/05	06/15/05	EPA 8260B	
Toluene	ND	0.50	"	"	"	"	"	"	
Ethylbenzene	ND	0.50	"	"	"	"	"	"	
m,p-Xylene	ND	1.0	"	"	"	"	"	"	
o-Xylene	ND	0.50	"	"	"	"	"	"	
Tert-amyl methyl ether	ND	2.0	"	"	"	"	"	"	
Tert-butyl alcohol	ND	10	"	"	"	"	"	"	
Di-isopropyl ether	ND	2.0	"	"	"	"	"	"	
Ethyl tert-butyl ether	ND	2.0	"	"	"	"	"	"	
Methyl tert-butyl ether	230	1.0	"	"	"	"	"	"	
<i>Surrogate: Toluene-d8</i>		101 %	87.6-115		"	"	"	"	
<i>Surrogate: 4-Bromofluorobenzene</i>		108 %	80-112		"	"	"	"	
<i>Surrogate: Dibromofluoromethane</i>		100 %	78.6-122		"	"	"	"	

SunStar Laboratories, Inc.

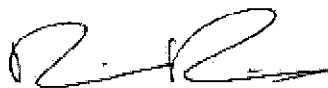

Dennis Dorning, Project Manager

The results in this report apply to the samples analyzed in accordance with the chain of custody document. This analytical report must be reproduced in its entirety.

Gribi Associates
 1090 Adam Street, Suite K
 Benicia CA, 94510

Project: Dublin Toyota
 Project Number: 147-01-03
 Project Manager: Jim Gribi

Reported:
 06/20/05 16:20

Purgeable Petroleum Hydrocarbons by EPA 8015m - Quality Control
SunStar Laboratories, Inc.

Analyte	Result	Reporting Limit	Units	Spike Level	Source Result	%REC	%REC Limits	RPD	RPD Limit	Notes
Batch 5061510 - EPA 5030 GC										
Blank (5061510-BLK1) Prepared & Analyzed: 06/15/05										
C6-C12 (GRO)	ND	50	ug/l							
Surrogate: 4-Bromofluorobenzene	53.5		"	50.0		107	65-135			
LCS (5061510-BS1) Prepared & Analyzed: 06/15/05										
C6-C12 (GRO)	4630	50	ug/l	5500	100	84.2	75-125			
Surrogate: 4-Bromofluorobenzene	49.7		"	50.0		99.4	65-135			
Matrix Spike (5061510-MS1) Source: T500714-01 Prepared: 06/15/05 Analyzed: 06/16/05										
C6-C12 (GRO)	5500	50	ug/l	5500	100	98.2	65-135			
Surrogate: 4-Bromofluorobenzene	54.5		"	50.0		109	65-135			
Matrix Spike Dup (5061510-MSD1) Source: T500714-01 Prepared: 06/15/05 Analyzed: 06/16/05										
C6-C12 (GRO)	5210	50	ug/l	5500	100	92.9	65-135	5.42	20	
Surrogate: 4-Bromofluorobenzene	49.0		"	50.0		98.0	65-135			

SunStar Laboratories, Inc.



Dennis Dorning, Project Manager

The results in this report apply to the samples analyzed in accordance with the chain of custody document. This analytical report must be reproduced in its entirety.

Gribi Associates
 1090 Adam Street, Suite K
 Benicia CA, 94510

Project: Dublin Toyota
 Project Number: 147-01-03
 Project Manager: Jim Gribi

Reported:
 06/20/05 16:20

Volatile Organic Compounds by EPA Method 8260B - Quality Control
SunStar Laboratories, Inc.

Analyte	Result	Reporting Limit	Units	Spike Level	Source Result	%REC	%REC Limits	RPD	RPD Limit	Notes
---------	--------	-----------------	-------	-------------	---------------	------	-------------	-----	-----------	-------

Batch 5061505 - EPA 5030 GCMS

Blank (5061505-BLK1)

Prepared & Analyzed: 06/15/05

Benzene	ND	0.50	ug/l							
Toluene	ND	0.50	"							
Ethylbenzene	ND	0.50	"							
m,p-Xylene	ND	1.0	"							
o-Xylene	ND	0.50	"							
Tert-amyl methyl ether	ND	2.0	"							
Tert-butyl alcohol	ND	10	"							
Di-isopropyl ether	ND	2.0	"							
Ethyl tert-butyl ether	ND	2.0	"							
Methyl tert-butyl ether	ND	1.0	"							
<i>Surrogate: Toluene-d8</i>	39.6		"	40.0		99.0	87.6-115			
<i>Surrogate: 4-Bromofluorobenzene</i>	43.4		"	40.0		108	80-112			
<i>Surrogate: Dibromofluoromethane</i>	39.1		"	40.0		97.8	78.6-122			

LCS (5061505-BS1)

Prepared & Analyzed: 06/15/05

Benzene	117	0.50	ug/l	100		117	75-125			
Toluene	112	0.50	"	100		112	75-125			
<i>Surrogate: Toluene-d8</i>	40.4		"	40.0		101	87.6-115			
<i>Surrogate: 4-Bromofluorobenzene</i>	43.6		"	40.0		109	80-112			
<i>Surrogate: Dibromofluoromethane</i>	40.6		"	40.0		102	78.6-122			

Matrix Spike (5061505-MS1)

Source: T500714-01

Prepared & Analyzed: 06/15/05

Benzene	114	0.50	ug/l	100	ND	114	75-125			
Toluene	112	0.50	"	100	ND	112	75-125			
<i>Surrogate: Toluene-d8</i>	41.2		"	40.0		103	87.6-115			
<i>Surrogate: 4-Bromofluorobenzene</i>	43.7		"	40.0		109	80-112			
<i>Surrogate: Dibromofluoromethane</i>	38.6		"	40.0		96.5	78.6-122			

SunStar Laboratories, Inc.



Dennis Dorning, Project Manager

The results in this report apply to the samples analyzed in accordance with the chain of custody document. This analytical report must be reproduced in its entirety.

Gribi Associates
1090 Adam Street, Suite K
Benicia CA, 94510

Project: Dublin Toyota
Project Number: 147-01-03
Project Manager: Jim Gribi

Reported:
06/20/05 16:20

Volatile Organic Compounds by EPA Method 8260B - Quality Control
SunStar Laboratories, Inc.

Analyte	Result	Reporting Limit	Units	Spike Level	Source Result	%REC	%REC Limits	RPD	RPD Limit	Notes
Batch 5061505 - EPA 5030 GCMS										
Matrix Spike Dup (5061505-MSD1)										
Source: T500714-01 Prepared & Analyzed: 06/15/05										
Benzene	115	0.50	ug/l	100	ND	115	75-125	0.873	20	
Toluene	105	0.50	"	100	ND	105	75-125	6.45	20	
Surrogate: Toluene-d8	40.6		"	40.0		102	87.6-115			
Surrogate: 4-Bromofluorobenzene	43.4		"	40.0		108	80-112			
Surrogate: Dibromofluoromethane	41.0		"	40.0		102	78.6-122			

SunStar Laboratories, Inc.



Dennis Dorning, Project Manager

The results in this report apply to the samples analyzed in accordance with the chain of custody document. This analytical report must be reproduced in its entirety.

Gribi Associates
1090 Adam Street, Suite K
Benicia CA, 94510

Project: Dublin Toyota
Project Number: 147-01-03
Project Manager: Jim Gribi

Reported:
06/20/05 16:20

Notes and Definitions

DET Analyte DETECTED
ND Analyte NOT DETECTED at or above the reporting limit
NR Not Reported
dry Sample results reported on a dry weight basis
RPD Relative Percent Difference

SunStar Laboratories, Inc.



Dennis Dorning, Project Manager

The results in this report apply to the samples analyzed in accordance with the chain of custody document. This analytical report must be reproduced in its entirety.