

✓ RO 327

C A M B R I A

February 7, 2005

Mr. Amir Gholami, Hazardous Materials Specialist
Alameda County Department of Environmental Health
1131 Harbor Bay Parkway, Suite 250
Alameda, California 94502-6577

Re: **Groundwater Monitoring Report - Fourth Quarter 2004**
Credit World Auto Sales Facility
2345 International Boulevard (Formerly E. 14th Street)
Oakland, California 94601
ACDEH Case No. 2116
Cambria Project No. 513-1000

Alameda County
FEB 14 2005
Environmental Health



Dear Mr. Gholami:

On behalf of Messrs. Stanley and Aaron Wong, Cambria Environmental Technology, Inc. has prepared this groundwater monitoring report for the above-referenced site. Presented in the report is a summary of the fourth quarter 2004 activities and the anticipated first quarter 2005 activities.

If you have any questions or comments regarding this report, please call me at (510) 420-3314.

Sincerely,
Cambria Environmental Technology, Inc.

Matthew A. Meyers
Project Geologist

Attachments: *Groundwater Monitoring Report - Fourth Quarter 2004*

cc: Mr. Stanley and Mr. Aaron Wong, 2200 E. 12th Street, Oakland, California 94606

**Cambria
Environmental
Technology, Inc.**

5900 Hollis Street
Suite A
Emeryville, CA 94608
Tel (510) 420-0700
Fax (510) 420-9170

CAMBRIA

GROUNDWATER MONITORING REPORT - FOURTH QUARTER 2004

Credit World Auto Sales Facility
2345 International Boulevard
(Formerly E. 14th Street)
Oakland, California 94601
ACDEH Case No. 2116
Cambria Project No. 513-1000

February 7, 2005

Prepared for:

Messrs. Stanley and Aaron Wong
2200 E. 12th Street
Oakland, California 94606

Prepared by:

Cambria Environmental Technology, Inc.
5900 Hollis Street, Suite A
Emeryville, California 94608

Written by:

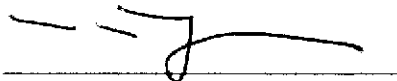

Matthew A. Meyers
Project Geologist

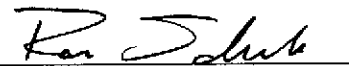
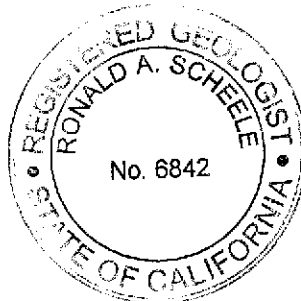

Ron Scheele, P.G.
Senior Geologist

Alameda County
FEB 14 2005
Environmental Health



GROUNDWATER MONITORING REPORT - FOURTH QUARTER 2004

World Credit Auto Sales Facility
2345 International Boulevard
(Formerly E. 14th Street)
Oakland, California 94601
ACDEH Case No. 2116
Cambria Project No. 513-1000

February 7, 2005



INTRODUCTION

On behalf of Messrs. Stanley and Aaron Wong, Cambria Environmental Technology, Inc. (Cambria) has prepared this *Groundwater Monitoring Report - Fourth Quarter 2004* for the World Credit Auto Sales facility (Figure 1). Presented in the report is a summary of the fourth quarter 2004 activities and the anticipated first quarter 2005 activities.

FOURTH QUARTER 2004 ACTIVITIES

Monitoring Activities

Field Activities: On December 10, 2004, Cambria conducted quarterly monitoring activities at the site. Cambria gauged water levels and measured separate-phase hydrocarbon (SPH) levels in monitoring wells MW-1, MW-2, MW-3, TMW-4, TMW-5, and MW-6 (Figure 2). Due to the presence of SPHs in each of the wells, no groundwater samples were collected for analysis. Groundwater monitoring field data sheets are presented in Appendix A. Cambria's well gauging data has been submitted to the GeoTracker database; see Appendix B for the GeoTracker electronic delivery confirmation.

Monitoring Results

Groundwater Flow Direction: Based on depth-to-water measurements collected on December 10, 2004, groundwater appears to be mounding in the vicinity of the former underground storage tanks (USTs). Similar groundwater mounding conditions have been observed during previous monitoring events. Depth to water and potentiometric surface elevation data are presented on Figure 2 and in Table 1.

C A M B R I A

SPH Distribution: During the December 10, 2004 field activities, SPH was detected in the site monitoring wells (MW-1, MW-2, MW-3, TMW-4, TMW-5, and MW-6). The maximum SPH thickness observed during this quarter was 0.62 feet in well MW-2. The SPH distribution is consistent with conditions observed during previous monitoring events

Corrective Action Activities

SPH Removal: On July 11, 2003, Mr. Amir Gholami of the Alameda County Department of Environmental Health (ACDEH) verbally approved a monthly SPH removal program where SPHs would be removed by hand bailing. The schedule for SPH removal was proposed in Cambria's *Site Summary, Conduit Study and Monitoring Report* (Summary Report) dated April 30, 2003. Based on previously observed SPH recovery rates, SPH removal frequency was increased to twice each month and passive SPH skimmers were installed in wells MW-2 and MW-3. SPHs were removed from onsite wells on October 5 and 21; November 2 and 12; and December 2 and 10, 2004. Collectively using hand bailing techniques and SPH skimmers, Cambria removed approximately 9.36 gallons of SPH during the fourth quarter of 2004 (Table 2). Approximately 62.23 gallons of SPHs have been removed from the wells since SPH removal activities were initiated in 1992.

ANTICIPATED FIRST QUARTER 2005 ACTIVITIES

Monitoring Activities

Cambria will gauge the groundwater and measure SPH thickness in each well. Groundwater samples will be collected from any well not containing SPHs. Groundwater samples will be analyzed for total petroleum hydrocarbons as gasoline (TPHg) by modified EPA Method 8015C, and benzene, toluene, ethylbenzene, xylenes (BTEX), and methyl tertiary-butyl ether (MTBE) by EPA Method 8021B. Detected MTBE concentrations will be confirmed with an analysis by EPA Method 8260. Cambria will summarize groundwater monitoring activities and results in a report to be submitted by April 31, 2005.

Corrective Action Activities

Cambria will continue to perform SPH removal activities during the first quarter 2005. The frequency of SPH removal will continue to be evaluated and modified based on SPH recovery rates. The gauged SPH thickness and amount removed will be tabulated and incorporated into the quarterly groundwater monitoring report.

Cambria submitted the *Site Assessment Work Plan* and *Feasibility Testing Work Plan* to the ACDEH on April 13, 2004 and August 24, 2004, respectively. To date, ACDEH has yet to respond to either submission. Shortly after receiving work plan approval, Cambria will initiate the site assessment activities and subsequently implement the feasibility testing scope of work.

ATTACHMENTS



Figure 1 – Vicinity Map

Figure 2 – Potentiometric Surface Contours and SPH Thickness Map

Table 1 – Potentiometric Surface Elevation and Analytical Data Summary

Table 2 – Separate-Phase Hydrocarbon Removal Summary

Appendix A – Groundwater Monitoring Field Data Sheets

Appendix B – GeoTracker Electronic Delivery Confirmation

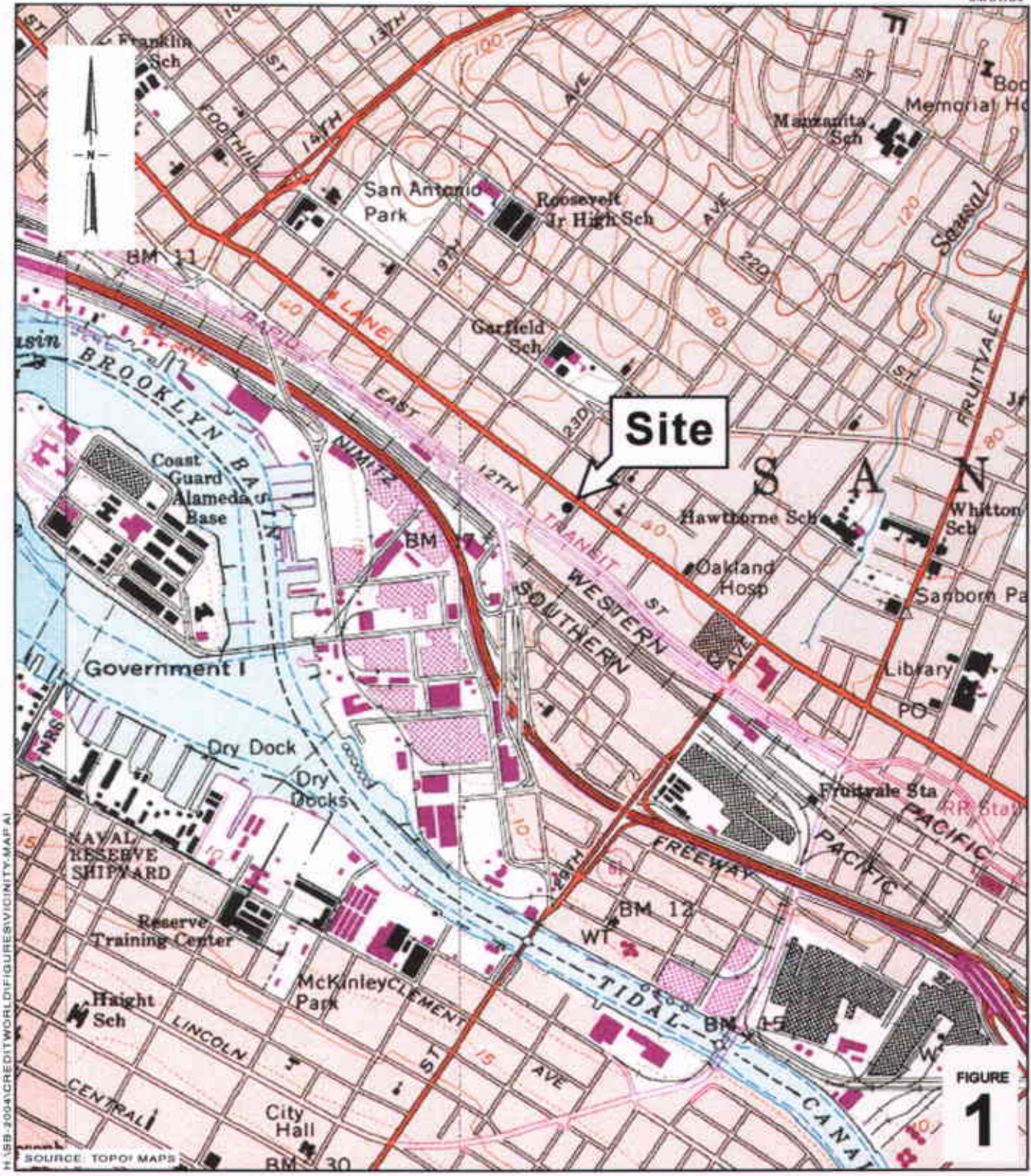

H:\BB-2004\CREDIT WORLD FIGURES\VICINITY.MAF.A1

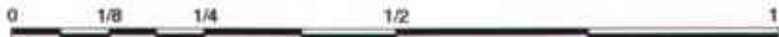

SCALE : 1" = 1/4 MILE

Credit World Auto Sales
 2345 International Boulevard
 Oakland, California



C A M B R I A

Vicinity Map

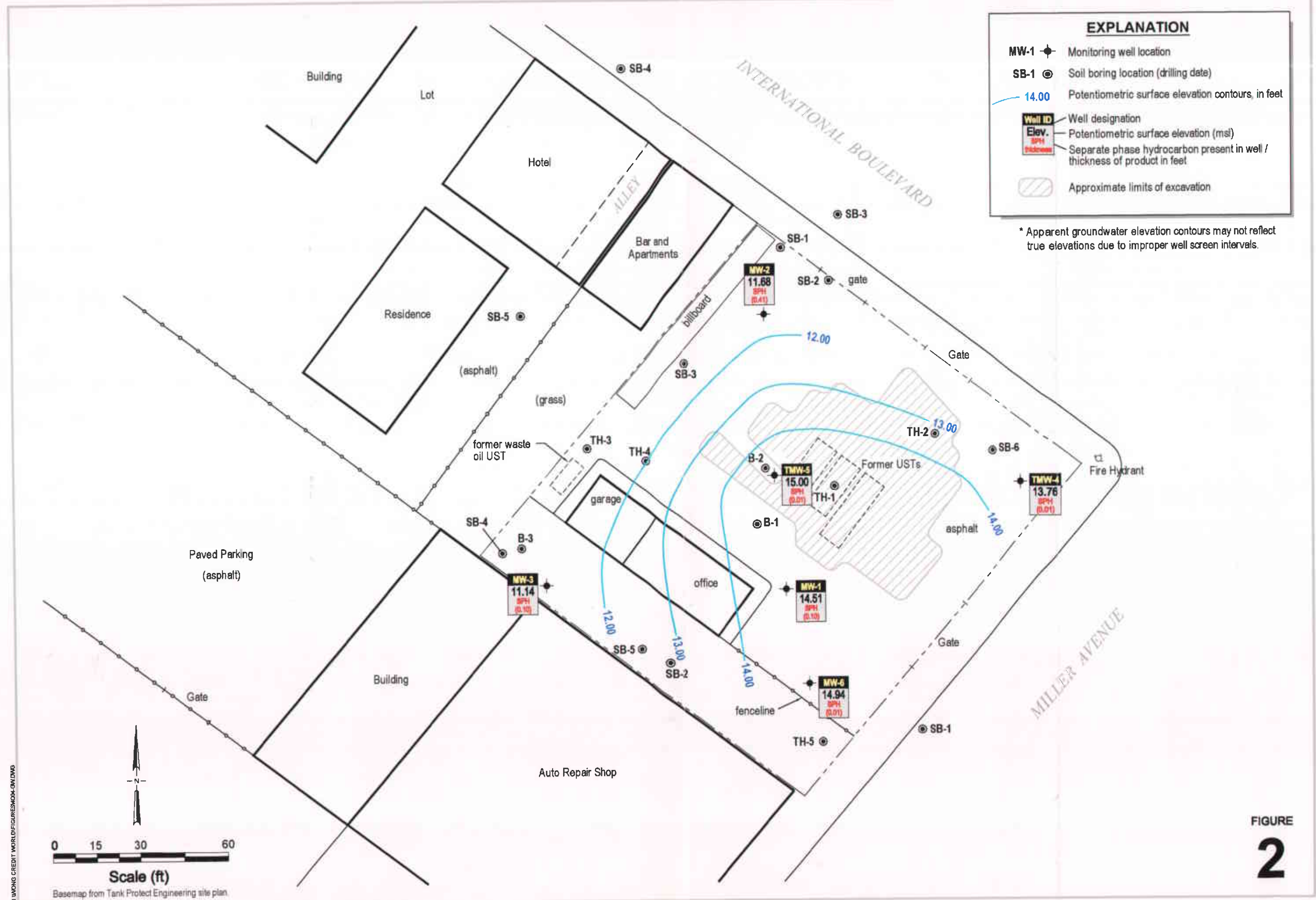

CAMBRIA

Table 1. Potentiometric Surface Elevation and Analytical Data Summary - Credit World Auto Sales, 2345 International Blvd., Oakland, CA

Well ID <i>TOC</i>	Date Sampled	Depth to Groundwater (feet)	SPH Thickness (feet)	Potentiometric Elevation (feet above msl)	TPHg (µg/L)	Benzene (µg/L)	Toluene (µg/L)	Ethylbenzene (µg/L)	Xylenes (µg/L)	MTBE (µg/L)
MW-1 <i>27.37"</i>	12/30/1997	10.96	0.17	16.51	61,000	4,300	1,800	1,600	6,900	1,400
	3/24/1998	9.33	0.00	18.04	24,000	1,000	1,000	1,300	4,300	2,000
	6/29/1998	12.20	0.00	15.17	130,000	3,800	370	1,200	4,200	3,300
	10/2/1998	13.46	0.00	13.91	22,000	66	21	26	140	<0.50
	12/10/1998	10.49	0.00	16.88	32,000	4,600	970	1,700	4,900	<250
	3/26/1999	9.44	0.00	17.93	230,000	370	290	280	720	<0.50
	6/11/1999	12.56	0.01	14.82	180,000	210	170	220	400	<0.50
	9/15/1999	14.85	1.00	13.32	21,000	3,800	280	590	2,200	<250
	12/28/1999	14.50	1.32	13.93	27,000	48	36	46	83	<0.5
	6/13/2001	15.83	4.36	12.03	--	--	--	--	--	--
	12/27/2002	8.31	0.16	16.19	--	--	--	--	--	--
	3/23/2003	10.65	0.05	16.72	--	--	--	--	--	--
	5/29/2003	12.11	0.28	15.44	--	--	--	--	--	--
	9/26/2003	12.84	0.29	14.72	--	--	--	--	--	--
	12/4/2003	12.50	0.10	14.91	--	--	--	--	--	--
	3/12/2004	10.45	0.52	17.30	--	--	--	--	--	--
	6/18/2004	12.01	0.46	15.69	--	--	--	--	--	--
9/23/2004	13.56	0.50	14.21	--	--	--	--	--	--	
	12/10/2004	12.94	0.10	14.51	--	--	--	--	--	--
MW-2 <i>26.16"</i>	8/23/1991	13.77	0.00	12.15	10,000	<5	<5	<5	<5	--
	4/16/1992	15.38	2.81	12.79	--	--	--	--	--	--
	6/11/1993	13.19	0.00	12.98	--	--	--	--	--	--
	8/17/1993	14.04	0.01	12.13	49,000	94	240	250	980	--
	3/28/1994	13.61	0.54	12.98	14,000	4,200	<250	910	1,400	--
	6/27/1994	14.24	0.80	12.56	24,000	4,400	72	1,100	1,700	--
	9/16/1994	17.82	4.46	11.91	40,000	2,300	250	2,000	4,100	--
	3/31/1995	16.72	7.44	15.39	28,000	4,000	<120	1,100	1,400	--
	6/28/1995	13.50	0.73	13.24	40,000	2,700	130	1,700	2,900	--
	9/28/1995	14.63	0.54	11.96	7,500	420	14	250	190	<62
	12/26/1995	12.58	0.90	14.30	22,000	1,300	88	950	1,800	<250

CAMBRIA

Table 1. Potentiometric Surface Elevation and Analytical Data Summary - Credit World Auto Sales, 2345 International Blvd., Oakland, CA

Well ID TOC	Date Sampled	Depth to Groundwater (feet)	SPH Thickness (feet)	Potentiometric Elevation (feet above msl)	TPHg (µg/L)	Benzene (µg/L)	Toluene (µg/L)	Ethylbenzene (µg/L)	Xylenes (µg/L)	MTBE (µg/L)
MW-2	3/22/1996	11.46	0.15	14.82	9,800	2,200	<120	400	<380	<1,200
(cont'd)	6/20/1996	13.08	0.37	13.38	35,000	770	<0.50	240	<0.50	550
	9/30/1996	16.67	3.75	12.49	58,000	1,600	230	2,200	4,000	<5.0
	12/27/1996	15.74	7.57	16.48	29,000	2,100	<0.50	1,200	1,800	<5.0
	3/7/1997	12.55	0.00	13.61	13,000	1,300	37	290	180	<5.0
	6/28/1997	11.98	0.04	14.21	12,000	840	<0.50	640	360	<5.0
	9/18/1997	13.44	0.00	12.72	12,000	680	<0.50	320	84	<5.0
	12/30/1997	11.31	0.00	14.85	13,000	1,100	40	350	220	<5.0
	3/25/1998	10.02	0.00	16.14	8,100	1,300	51	410	230	670
	6/29/1998	11.96	0.00	14.20	12,000	880	13	180	72	430
	10/2/1998	13.74	0.00	12.42	47,000	140	100	110	200	<0.50
	12/10/1998	12.91	2.10	14.93	26,000	1,000	210	1,500	1,900	<1,000
	3/26/1999	9.06	0.20	17.26	110,000	190	150	120	380	<0.50
	6/11/1999	12.18	0.00	13.98	190,000	310	250	320	540	<0.50
	9/15/1999	15.59	3.00	12.97	25,000	720	<100	1,300	1,600	<1,000
	12/28/1999	16.81	4.50	12.95	75,000	130	98	130	230	<0.50
	6/13/2001	14.84	3.15	10.84	--	--	--	--	--	--
	6/20/2002	14.80	0.70	8.92	53,000	2,200	140	3,300	3,000	<1,000
	10/21/2002	16.98	0.24	6.37	--	--	--	--	--	--
	12/27/2002	13.58	0.43	9.92	--	--	--	--	--	--
	3/23/2003	15.49	0.29	10.66	--	--	--	--	--	--
	5/29/2003	16.08	0.44	10.19	--	--	--	--	--	--
	9/26/2003	17.14	0.87	9.48	--	--	--	--	--	--
	12/4/2003	16.75	1.01	9.98	--	--	--	--	--	--
	3/12/2004	11.19	2.14	16.44	--	--	--	--	--	--
	6/18/2004	12.66	0.87	13.96	--	--	--	--	--	--
	9/23/2004	15.39	0.10	10.85	--	--	--	--	--	--
	12/10/2004	14.81	0.41	11.68	--	--	--	--	--	--

CAMBRIA

Table 1. Potentiometric Surface Elevation and Analytical Data Summary - Credit World Auto Sales, 2345 International Blvd., Oakland, CA

Well ID <i>TOC</i>	Date Sampled	Depth to Groundwater (feet)	SPH Thickness (feet)	Potentiometric Elevation (feet above msl)	TPHg (µg/L)	Benzene (µg/L)	Toluene (µg/L)	Ethylbenzene (µg/L)	Xylenes (µg/L)	MTBE (µg/L)
MW-3	8/23/1991	15.07	0.00	12.50	<5,000	<5	<5	<5	<5	--
27.57 ^a	4/16/1992	14.14	0.16	13.56	--	--	--	--	--	--
	6/11/1993	14.28	0.00	13.30	--	--	--	--	--	--
	8/17/1993	15.77	0.00	11.80	9,600	4.1	17	28	54	--
	3/28/1994	14.35	0.00	13.22	8,400	2,400	56	67	200	--
	6/27/1994	14.77	0.00	12.80	9,900	3,300	<22	<25	73	--
	9/16/1994	15.42	0.05	12.19	16,000	2,300	80	620	240	--
	3/31/1995	12.98	0.46	14.96	16,000	2,800	70	<25	920	--
	6/28/1995	14.20	0.05	13.41	11,000	2,300	32	81	240	--
	9/28/1995	15.17	0.00	12.40	6,300	1,900	<42	200	<120	<420
	12/26/1995	13.33	0.06	14.29	25,000	3,800	97	94	1,600	<250
	3/22/1995	12.81	0.04	14.79	16,000	3,100	75	69	350	250
	6/20/1996	13.95	0.07	13.68	8,500	1,400	28	140	15	220
	9/24/1996	14.86	0.04	12.74	12,000	2,400	87	340	110	<5.0
	12/27/1996	11.04	0.06	16.58	5,800	1,700	28	<0.50	42	240
	3/10/1997	13.80	0.00	13.77	9,000	1,700	<0.50	110	<0.50	<5.0
	6/28/1997	13.72	0.06	13.90	15,000	2,200	<0.50	160	190	<5.0
	9/18/1997	14.76	0.00	12.81	28,000	3,800	<0.50	100	<0.50	<5.0
	12/30/1997	12.97	0.00	14.60	21,000	2,200	<0.50	31	<0.50	300
	3/24/1998	11.75	0.00	15.82	2,300	870	7.2	20	<0.50	85
	6/29/1998	13.38	0.00	14.19	6,500	1,300	12	62	14	140
	10/2/1998	14.42	0.00	13.15	11,000	31	27	35	69	<0.50
	12/10/1998	12.55	0.00	15.02	<2,500	2,800	68	42	55	<250
	3/26/1999	10.54	0.00	17.03	10,000	21	14	10	41	<0.50
	6/15/1999	13.91	0.00	13.66	87,000	90	71	92	180	<0.50
	9/15/1999	14.70	0.00	12.87	8,700	2,100	71	110	66	<100
	12/28/1999	15.16	0.25	12.61	4,300	7.7	5.2	7.2	13	<0.50
	6/13/2001	14.70	0.40	13.19	8,400	1,300	25	64	32	<20
	6/20/2002	14.68	0.02	12.91	7,800	1,100	23	66	15	<50
	12/27/2002	11.37	0.17	16.34	--	--	--	--	--	--

CAMBRIA

Table 1. Potentiometric Surface Elevation and Analytical Data Summary - Credit World Auto Sales, 2345 International Blvd., Oakland, CA

Well ID TOC	Date Sampled	Depth to Groundwater (feet)	SPH Thickness (feet)	Potentiometric Elevation (feet above msl)	TPHg (µg/L)	Benzene (µg/L)	Toluene (µg/L)	Ethylbenzene (µg/L)	Xylenes (µg/L)	MTBE (µg/L)
MW-3	3/23/2003	--	--	--	--	--	--	--	--	--
(cont'd)	5/29/2003	13.99	0.08	13.64	--	--	--	--	--	--
	9/26/2003	14.51	0.05	13.10	--	--	--	--	--	--
	12/4/2003	14.28	0.10	13.37	--	--	--	--	--	--
	3/12/2004	11.95	0.42	15.96	--	--	--	--	--	--
	6/18/2004	13.33	0.55	14.68	--	--	--	--	--	--
	9/23/2004	16.17	0.02	11.42	--	--	--	--	--	--
	12/10/2004	16.51	0.10	11.14	--	--	--	--	--	--
TMW-4	8/17/1993	13.26	0.00	13.24	150	<0.50	0.8	1.4	3.7	--
26.50 ^a	3/28/1994	12.40	0.00	14.10	<50	<0.50	<0.50	<0.50	<1.5	--
	6/27/1994	12.84	0.00	13.66	<50	<0.50	<0.50	<0.50	<1.5	--
	9/16/1994	13.58	0.00	12.92	<50	<0.50	<0.50	<0.50	<1.5	--
	3/31/1995	10.23	0.00	16.27	<50	<0.50	<0.50	<0.50	<1.5	--
	6/28/1995	12.21	0.00	14.29	<50	<0.50	<0.50	<0.50	<1.5	--
	9/28/1995	13.38	0.00	13.12	<50	<0.50	<0.50	<0.50	<1.5	<5.0
	12/26/1995	11.32	0.00	15.18	<50	<0.50	<0.50	<0.50	<1.5	<5.0
	3/22/1996	10.54	0.00	15.96	<50	<0.50	<0.50	<0.50	<1.5	<5.0
	6/20/1996	12.14	0.00	14.36	<50	<0.50	<0.50	<0.50	<0.50	<5.0
	9/24/1996	13.01	0.00	13.49	<50	<0.50	<0.50	<0.50	<0.50	<5.0
	12/27/1996	9.51	0.00	16.99	<50	<0.50	<0.50	<0.50	<0.50	<5.0
	3/10/1997	11.92	0.00	14.58	<50	<0.50	<0.50	<0.50	<0.50	<5.0
	6/27/1997	10.70	0.00	15.80	<50	<0.50	<0.50	<0.50	<0.50	<5.0
	9/18/1997	12.94	0.00	13.56	<50	<0.50	<0.50	<0.50	<0.50	<5.0
	12/30/1997	10.92	0.00	15.58	<50	<0.50	<0.50	<0.50	<0.50	<5.0
	3/25/1998	9.60	0.00	16.90	<50	<0.50	<0.50	<0.50	<0.50	<5.0
	6/29/1998	11.32	0.00	15.18	<50	<0.50	<0.50	<0.50	<0.50	<5.0
	10/2/1998	12.56	0.00	13.94	<50	<0.50	<0.50	<0.50	<0.50	<5.0
	12/10/1998	10.44	0.00	16.06	<50	<0.50	<0.50	<0.50	<0.50	<5.0
	3/26/1999	9.38	0.00	17.12	<50	<0.50	<0.50	<0.50	<0.50	<5.0
	6/15/1999	11.58	0.00	14.92	<50	<0.50	<0.50	<0.50	<0.50	<5.0
	9/15/1999	12.89	0.00	13.61	<50	<0.50	<0.50	<0.50	<0.50	<5.0

CAMBRIA

Table 1. Potentiometric Surface Elevation and Analytical Data Summary - Credit World Auto Sales, 2345 International Blvd., Oakland, CA

Well ID TOC	Date Sampled	Depth to Groundwater (feet)	SPH Thickness (feet)	Potentiometric Elevation (feet above msl)	TPHg (µg/L)	Benzene (µg/L)	Toluene (µg/L)	Ethylbenzene (µg/L)	Xylenes (µg/L)	MTBE (µg/L)
TMW-4	12/28/1999	12.92	0.00	13.58	<50	<0.50	<0.50	<0.50	<0.50	<0.50
(cont'd)	10/21/2002	12.70	0.00	13.80	--	--	--	--	--	--
	12/27/2002	9.07	0.12	17.53	--	--	--	--	--	--
	3/23/2003	10.73	0.03	15.79	--	--	--	--	--	--
	5/29/2003	12.50	0.02	14.02	--	--	--	--	--	--
	9/26/2003	13.27	0.06	13.28	--	--	--	--	--	--
	12/4/2003	13.07	0.10	13.51	--	--	--	--	--	--
	3/12/2004	9.82	0.02	16.70	--	--	--	--	--	--
	6/18/2004	10.49	0.03	16.03	--	--	--	--	--	--
	9/23/2004	13.29	0.01	13.22	--	--	--	--	--	--
	12/10/2004	12.75	0.01	13.76	--	--	--	--	--	--
TMW-5	8/17/1993	12.98	0.03	13.55	120,000	640	730	790	3,600	--
26.85 ^a	3/28/1994	11.39	0.00	15.46	70,000	23,000	1,500	4,100	15,000	--
	6/28/1994	12.24	0.00	14.61	56,000	26,000	940	5,500	26,000	--
	9/16/1994	13.02	0.05	13.87	96,000	17,000	720	3,500	12,000	--
	3/31/1995	7.38	0.00	19.47	64,000	13,000	470	3,500	6,100	--
	6/28/1995	11.31	0.06	15.59	65,000	9,000	240	2,600	5,300	--
	9/28/1995	14.42	0.00	12.43	79,000	17,000	1,800	2,700	7,000	<1,200
	12/26/1995	10.16	0.05	16.73	110,000	11,000	800	2,300	4,500	<1,200
	3/22/1996	7.59	0.05	19.30	--	--	--	--	--	--
	6/26/1996	7.12	0.00	--	30,000	4,000	180	1,500	2,500	830
	9/30/1996	7.42	0.00	--	6,900	1,600	79	130	370	<5.0
	12/27/1996	6.38	0.00	--	78,000	12,000	1,900	2,900	9,700	<5.0
	3/10/1997	11.12	0.00	--	84,000	9,900	1,100	2,600	8,800	<5.0
	8/17/1997	12.98	0.03	--	--	--	--	--	--	--
	9/18/1997	12.00	0.00	--	65,000	8,000	<0.5	2,000	4,700	<5.0
	12/30/1997	8.97	0.00	--	79,000	6,400	340	2,300	5,500	<5.0
	3/25/1998	7.32	0.00	--	20,000	6,000	260	2,700	5,800	2,400
	6/29/1998	11.50	0.00	--	--	--	--	--	--	--
	10/8/1998	12.56	0.00	--	46,000	120	98	120	240	<0.50
	12/8/1998	10.14	0.00	--	46,000	5,900	320	2,200	5,400	<1,200

CAMBRIA

Table 1. Potentiometric Surface Elevation and Analytical Data Summary - Credit World Auto Sales, 2345 International Blvd., Oakland, CA

Well ID <i>TOC</i>	Date Sampled	Depth to Groundwater (feet)	SPH Thickness (feet)	Potentiometric Elevation (feet above msl)	TPHg (µg/L)	Benzene (µg/L)	Toluene (µg/L)	Ethylbenzene (µg/L)	Xylenes (µg/L)	MTBE (µg/L)
TMW-5	3/26/1999	7.08	0.00	--	35,000	69	61	37	120	<0.50
<i>(cont'd)</i>	6/11/1999	11.40	0.00	--	26,000	29	32	43	72	<0.50
	9/15/1999	12.52	0.00	--	37,000	7,300	400	2,400	6,000	<1,000
	12/28/1999	12.44	0.00	--	25,000	44	32	41	75	<0.50
	5/23/2001	11.31	0.00	12.54	--	--	--	--	--	--
	6/20/2002	11.29	0.05	15.60	51,000	5,100	290	2,300	5,800	<250
	10/21/2002	13.60	0.10	13.33	--	--	--	--	--	--
	12/27/2002	6.60	0.07	20.31	--	--	--	--	--	--
	3/23/2003	9.79	0.04	16.75	--	--	--	--	--	--
	5/29/2003	11.29	0.04	15.25	--	--	--	--	--	--
	9/26/2003	12.47	0.07	14.10	--	--	--	--	--	--
	12/4/2003	12.35	0.10	14.24	--	--	--	--	--	--
	3/12/2004	8.15	0.02	18.38	--	--	--	--	--	--
	6/18/2004	9.66	0.03	16.87	--	--	--	--	--	--
	9/23/2004	12.42	0.01	14.44	--	--	--	--	--	--
	12/10/2004	11.86	0.01	15.00	--	--	--	--	--	--
MW-6	5/23/2001	12.47	0.00	11.34	--	--	--	--	--	--
<i>26.81'</i>	6/13/2001	12.47	0.00	11.34	7,600	1,400	42	19	14	<10
	6/20/2002	12.45	0.00	14.36	79	5.7	<0.5	<0.5	<0.5	<5.0
	12/27/2002	7.24	0.04	19.60	--	--	--	--	--	--
	3/23/2003	--	--	--	--	--	--	--	--	--
	5/29/2003	11.95	0.02	14.88	--	--	--	--	--	--
	9/26/2003	13.11	0.03	10.72	--	--	--	--	--	--
	12/4/2003	13.14	0.10	10.75	--	--	--	--	--	--
	3/12/2004	8.93	0.02	14.90	--	--	--	--	--	--
	6/18/2004	10.30	0.03	13.53	--	--	--	--	--	--
	9/23/2004	12.44	0.01	14.38	--	--	--	--	--	--
	12/10/2004	11.88	0.01	14.94	--	--	--	--	--	--

CAMBRIA

Table 1. Potentiometric Surface Elevation and Analytical Data Summary - Credit World Auto Sales, 2345 International Blvd., Oakland, CA

Well ID TOC	Date Sampled	Depth to Groundwater (feet)	SPH Thickness (feet)	Potentiometric Elevation (feet above msl)	TPHg (µg/L)	Benzene (µg/L)	Toluene (µg/L)	Ethylbenzene (µg/L)	Xylenes (µg/L)	MTBE (µg/L)
----------------	-----------------	---------------------------------------	--------------------------------	---	--------------------	-----------------------	-----------------------	----------------------------	-----------------------	--------------------

Abbreviations and Methods:

TOC = Top of well casing elevation, measure in feet above mean sea level.

Depth to Groundwater measured from top of casing.

msl = Measured in feet above mean sea level.

SPH = Separate phase hydrocarbons

Potentiometric Elevation calculated according to the relationship Groundwater Elevation = TOC - (Depth to Groundwater) + (0.8)(SPH Thickness)

TPHg = Total petroleum hydrocarbons as gasoline by modified EPA Method 8015

Benzene, Toluene, Ethylbenzene, Xylenes by EPA Method 8020 (by 8260 if in parenthesis)

MTBE = Methyl tertiary butyl ether by EPA Method 8020

µg/L = Micrograms per liter

-- = Not available, not analyzed, or does not apply.

a = Top of casing elevation surveyed 6/13/01 to City of Oakland datum by Renner Survey Company of Burlingame, California for Sequoia Environmental.

Note:

November 2004 - Upon review of historical well survey data, modifications to well top of casing reference elevations and historical potentiometric surface elevations were made, as appropriate. Upon completing pending site assessment activities, the existing (MW-1, MW-2, MW-3, MW-4, MW-5, and MW-6) and newly installed wells will be resurveyed to the same benchmark.

CAMBRIA

Table 2. Separate-Phase Hydrocarbon Removal Summary - Credit World Auto Sales, 2345 International Blvd, Oakland, California

Well ID	Date Sampled	Depth to SPH (feet)	Depth to Groundwater (feet)	SPH Thickness (feet)	Hydrocarbons Removed (liters)	Hydrocarbons Removed (gallons)	Cumulative Hydrocarbons Removed (gallons)
MW-1	12/30/1997	10.79	10.96	0.17	0.10	0.03	0.03
	6/11/1999	12.55	12.56	0.01	0.01	0.00	0.03
	9/15/1999	13.85	14.85	1.00	0.60	0.16	0.19
	12/28/1999	8.15	8.31	0.16	0.10	0.03	0.21
	6/13/2001	8.15	8.31	0.16	0.10	0.03	0.24
	12/27/2003	8.15	8.31	0.16	3.00	0.79	1.03
	3/23/2003	10.60	10.65	0.05	1.26	0.33	1.36
	4/4/2003	10.19	10.23	0.04	0.94	0.25	1.61
	5/1/2003	9.80	9.85	0.05	0.49	0.13	1.74
	5/29/2003	11.83	12.11	0.28	1.00	0.26	2.00
	7/25/2003	11.99	12.24	0.25	0.50	0.13	2.13
	8/11/2003	12.07	12.37	0.30	0.50	0.13	2.27
	8/29/2003	12.07	12.40	0.33	0.50	0.13	2.40
	9/12/2003	12.59	12.90	0.31	0.48	0.13	2.53
	9/26/2003	12.55	12.84	0.29	0.50	0.13	2.66
	10/10/2003	12.61	12.72	0.11	0.11	0.03	2.69
	10/30/2003	12.68	12.75	0.07	0.08	0.02	2.71
	11/25/2003	12.59	12.69	0.10	0.10	0.03	2.73
	12/4/2003	12.40	12.50	0.10	0.10	0.03	2.76
	12/23/2003	11.97	12.08	0.11	0.10	0.03	2.79
	1/30/2004	9.64	10.05	0.41	0.75	0.20	2.99
	2/20/2004	9.50	9.97	0.47	0.50	0.13	3.12
	3/12/2004	9.93	10.45	0.52	1.00	0.26	3.38
	3/30/2004	10.35	11.21	0.86	1.11	0.29	3.67
	4/14/2004	11.77	12.65	0.88	1.00	0.26	3.94
	4/23/2004	11.60	12.11	0.51	1.00	0.26	4.20
	5/7/2004	11.63	12.05	0.42	1.00	0.26	4.47
	5/28/2004	11.68	12.08	0.40	1.00	0.26	4.73
	6/4/2004	11.51	11.94	0.43	0.50	0.13	4.86
	6/18/2004	11.55	12.01	0.46	0.33	0.09	4.95
	7/29/2004	12.65	13.25	0.60	1.00	0.26	5.21
8/13/2004	12.97	13.40	0.43	1.00	0.26	5.48	
8/27/2004	12.96	13.46	0.50	1.00	0.26	5.74	
9/10/2004	12.96	13.48	0.52	1.50	0.40	6.14	
9/23/2004	13.06	13.56	0.50	2.50	0.66	6.80	
10/5/2004	13.00	13.50	0.50	2.50	0.66	7.46	
10/21/2004	13.49	13.59	0.10	2.50	0.66	8.12	
11/2/2004	13.00	13.10	0.10	2.00	0.53	8.65	
11/12/2004	12.83	12.97	0.14	1.50	0.40	9.05	
12/2/2004	12.81	12.91	0.10	1.50	0.40	9.44	
12/10/2004	12.84	12.94	0.10	1.50	0.40	9.84	
MW-2	6/28/1995	12.77	13.50	0.73	0.44	0.12	2.12
	9/28/1995	14.09	14.63	0.54	0.32	0.09	2.20
	12/26/1995	11.68	12.58	0.90	0.54	0.14	2.35
	3/22/1996	11.31	11.46	0.15	0.09	0.02	2.37
	6/20/1996	12.71	13.08	0.37	0.22	0.06	2.43
	9/30/1996	12.92	16.67	3.75	2.25	0.59	3.02
	12/27/1996	8.17	15.74	7.57	4.54	1.20	4.22
	6/28/1997	11.94	11.98	0.04	0.02	0.01	4.23
	9/18/1997	13.44	13.44	0.00	0.00	0.00	4.23
	12/10/1998	10.81	12.91	2.10	1.26	0.33	4.56
	3/26/1999	8.86	9.06	0.20	0.12	0.03	4.59
	9/15/1999	12.59	15.59	3.00	1.80	0.48	5.07
	12/28/1999	12.31	16.81	4.50	2.70	0.71	5.78
	6/13/2001	11.69	14.84	3.15	1.89	0.50	6.28
	6/20/2002	14.10	14.80	0.70	0.42	0.11	6.39

CAMBRIA

Table 2. Separate-Phase Hydrocarbon Removal Summary - Credit World Auto Sales, 2345 International Blvd, Oakland, California

Well ID	Date Sampled	Depth to SPH (feet)	Depth to Groundwater (feet)	SPH Thickness (feet)	Hydrocarbons Removed (liters)	Hydrocarbons Removed (gallons)	Cumulative Hydrocarbons Removed (gallons)
MW-2	10/21/2002	16.74	16.98	0.24	0.14	0.04	6.43
(cont.)	12/27/2002	13.15	13.58	0.43	3.00	0.79	7.22
	3/23/2003	15.20	15.49	0.29	5.68	1.50	8.72
	4/4/2003	14.72	14.80	0.08	3.78	1.00	9.72
	5/1/2003	13.59	13.63	0.04	0.49	0.13	9.85
	5/29/2003	15.64	16.08	0.44	1.00	0.26	10.11
	7/25/2003	15.81	16.31	0.50	0.50	0.13	10.24
	8/11/2003	15.99	16.44	0.45	0.50	0.13	10.38
	8/29/2003	15.92	16.75	0.83	0.50	0.13	10.51
	9/12/2003	16.29	17.10	0.81	0.95	0.25	10.76
	9/26/2003	16.27	17.14	0.87	1.90	0.50	11.26
	10/10/2003	16.35	17.10	0.75	1.89	0.50	11.76
	10/30/2003	16.41	17.03	0.62	0.95	0.25	12.01
	11/25/2003	16.08	16.98	0.90	3.79	1.00	13.01
	12/4/2003	15.74	16.75	1.01	3.79	1.00	14.01
	12/11/2003	15.81	16.90	1.09	3.79	1.00	15.01
	12/23/2003	15.60	16.55	0.95	3.79	1.00	16.01
	1/30/2004	8.91	10.69	1.78	3.00	0.79	16.80
	2/20/2004	8.74	10.72	1.98	4.00	1.06	17.86
	3/12/2004	9.05	11.19	2.14	6.41	1.69	19.55
	3/30/2004	10.16	10.67	0.51	0.51	0.13	19.69
	4/14/2004	11.18	12.61	1.43	1.50	0.40	20.09
	4/23/2004	11.79	12.84	1.05	3.50	0.92	21.01
	5/7/2004	11.75	12.89	1.14	5.00	1.32	22.33
	5/28/2004	11.83	12.77	0.94	5.00	1.32	23.65
	6/4/2004	11.77	12.62	0.85	4.50	1.19	24.84
	6/18/2004	11.79	12.66	0.87	5.00	1.32	26.16
	7/29/2004	15.05	15.10	0.05	1.00	0.26	26.43
	8/13/2004	15.23	15.28	0.05	1.50	0.40	26.82
	8/27/2004	15.31	15.39	0.08	1.50	0.40	27.22
	9/10/2004	15.24	15.33	0.09	2.00	0.53	27.75
	9/23/2004	15.29	15.39	0.10	2.00	0.53	28.27
	10/5/2004	15.17	15.33	0.16	2.00	0.53	28.80
	10/21/2004	15.23	15.46	0.23	2.00	0.53	29.33
	11/2/2004	14.28	14.96	0.62	3.50	0.92	30.26
	11/12/2004	14.38	14.83	0.45	3.00	0.79	31.05
	12/2/2004	14.34	14.79	0.45	2.50	0.66	31.71
	12/10/2004	14.40	14.81	0.41	2.50	0.66	32.37
MW-3	4/16/1992	13.98	14.14	0.16	0.10	0.03	0.03
	9/16/1994	15.37	15.42	0.05	0.03	0.01	0.04
	3/31/1995	12.52	12.98	0.46	0.28	0.07	0.11
	6/28/1995	14.15	14.20	0.05	0.03	0.01	0.12
	12/26/1995	13.27	13.33	0.06	0.04	0.01	0.13
	3/22/1995	12.77	12.81	0.04	0.02	0.01	0.13
	6/20/1996	13.88	13.95	0.07	0.04	0.01	0.15
	9/24/1996	14.82	14.86	0.04	0.02	0.01	0.15
	12/27/1996	10.98	11.04	0.06	0.04	0.01	0.16
	6/28/1997	13.66	13.72	0.06	0.04	0.01	0.17
	12/28/1999	14.91	15.16	0.25	0.15	0.04	0.21
	6/13/2001	14.30	14.70	0.40	0.24	0.06	0.27
	6/20/2002	14.66	14.68	0.02	0.01	0.00	0.28
	12/27/2002	11.20	11.37	0.17	3.00	0.79	1.07
	5/29/2003	13.91	13.99	0.08	0.01	0.03	1.10
	7/25/2003	14.02	14.12	0.10	0.20	0.05	1.15
	8/11/2003	14.25	14.35	0.10	0.15	0.04	1.19
	8/29/2003	14.18	14.33	0.15	0.15	0.04	1.23
	9/12/2003	14.41	14.55	0.14	0.10	0.03	1.25

CAMBRIA

Table 2. Separate-Phase Hydrocarbon Removal Summary - Credit World Auto Sales, 2345 International Blvd, Oakland, California

Well ID	Date Sampled	Depth to SPH (feet)	Depth to Groundwater (feet)	SPH Thickness (feet)	Hydrocarbons Removed (liters)	Hydrocarbons Removed (gallons)	Cumulative Hydrocarbons Removed (gallons)
MW-3 (cont.)	9/26/2003	14.46	14.51	0.05	0.15	0.04	1.29
	10/10/2003	14.50	14.58	0.08	0.20	0.05	1.35
	10/30/2003	14.59	14.63	0.04	0.12	0.03	1.38
	11/25/2003	14.30	14.40	0.10	0.11	0.03	1.41
	12/4/2003	14.18	14.28	0.10	0.10	0.03	1.43
	12/23/2003	13.81	13.91	0.10	0.05	0.01	1.45
	1/30/2004	10.16	10.53	0.37	1.00	0.26	1.71
	2/20/2004	10.08	10.48	0.40	1.00	0.26	1.98
	3/12/2004	11.53	11.95	0.42	2.25	0.59	2.57
	3/30/2004	12.14	12.18	0.04	0.60	0.16	2.73
	4/14/2004	12.81	13.42	0.61	1.50	0.40	3.13
	4/23/2004	12.94	13.53	0.59	3.50	0.92	4.05
	5/7/2004	12.99	13.43	0.44	4.50	1.19	5.24
	5/28/2004	12.74	13.32	0.58	5.00	1.32	6.56
	6/4/2004	12.70	13.29	0.59	5.00	1.32	7.88
	6/18/2004	12.78	13.33	0.55	5.00	1.32	9.20
	7/29/2004	15.80	15.81	0.01	0.05	0.01	9.21
	8/13/2004	15.97	15.99	0.02	0.10	0.03	9.24
	8/27/2004	16.05	16.07	0.02	0.50	0.13	9.37
	9/10/2004	16.03	16.05	0.02	0.75	0.20	9.57
	9/23/2004	16.15	16.17	0.02	0.50	0.13	9.70
	10/5/2004	16.05	16.10	0.05	0.75	0.20	9.90
	10/21/2004	16.17	16.22	0.05	1.00	0.26	10.17
11/2/2004	16.58	16.68	0.10	1.00	0.26	10.43	
11/12/2004	16.50	16.60	0.10	1.50	0.40	10.83	
12/2/2004	16.40	16.53	0.13	2.00	0.53	11.35	
12/10/2004	16.41	16.51	0.10	2.00	0.53	11.88	
TMW-4	12/27/2002	8.95	9.07	0.12	1.50	0.40	0.40
	3/23/2003	10.70	10.73	0.03	0.95	0.25	0.65
	4/4/2003	10.35	10.40	0.05	0.95	0.25	0.90
	5/1/2003	10.07	10.09	0.02	0.49	0.13	1.02
	5/29/2003	12.48	12.50	0.02	0.00	0.00	1.02
	7/25/2003	12.61	12.67	0.06	0.05	0.01	1.03
	8/11/2003	14.49	14.59	0.10	0.10	0.03	1.06
	8/29/2003	12.93	12.95	0.02	0.05	0.01	1.07
	9/12/2003	13.24	13.29	0.05	0.03	0.01	1.08
	9/26/2003	13.21	13.27	0.06	0.04	0.01	1.09
	10/10/2003	13.31	13.40	0.09	0.05	0.01	1.11
	10/30/2003	13.30	13.38	0.08	0.04	0.01	1.12
	11/25/2003	13.09	13.19	0.10	0.02	0.01	1.12
	12/4/2003	12.97	13.07	0.10	0.05	0.01	1.14
	12/23/2003	13.59	13.69	0.10	0.05	0.01	1.15
	1/30/2004	9.45	9.47	0.02	0.01	0.00	1.15
	2/20/2004	9.37	9.39	0.02	0.01	0.00	1.15
	3/12/2004	9.80	9.82	0.02	0.01	0.00	1.16
	3/30/2004	10.11	10.12	0.01	0.00	0.00	1.16
	4/14/2004	10.89	10.93	0.04	0.01	0.00	1.16
	4/23/2004	10.68	10.71	0.03	0.01	0.00	1.16
	5/7/2004	10.50	10.53	0.03	0.04	0.01	1.17
	5/28/2004	10.56	10.60	0.04	0.01	0.00	1.18
6/4/2004	10.49	10.52	0.03	0.01	0.00	1.18	
6/18/2004	10.46	10.49	0.03	0.01	0.00	1.18	
7/29/2004	11.99	12.00	0.01	0.05	0.01	1.19	
8/13/2004	12.06	12.07	0.01	0.10	0.03	1.22	
8/27/2004	12.09	12.11	0.02	0.10	0.03	1.25	
9/10/2004	13.16	13.18	0.02	0.10	0.03	1.27	
9/23/2004	13.28	13.29	0.01	0.10	0.03	1.30	

CAMBRIA

Table 2. Separate-Phase Hydrocarbon Removal Summary - Credit World Auto Sales, 2345 International Blvd, Oakland, California

Well ID	Date Sampled	Depth to SPH (feet)	Depth to Groundwater (feet)	SPH Thickness (feet)	Hydrocarbons Removed (liters)	Hydrocarbons Removed (gallons)	Cumulative Hydrocarbons Removed (gallons)
TMW-4 (cont.)	10/5/2004	13.25	13.26	0.01	0.01	0.00	1.30
	10/21/2004	13.34	13.35	0.01	0.01	0.00	1.30
	11/2/2004	12.81	12.82	0.01	0.01	0.00	1.31
	11/12/2004	12.77	12.78	0.01	0.01	0.00	1.31
	12/2/2004	12.71	12.72	0.01	0.01	0.00	1.31
	12/10/2004	12.74	12.75	0.01	0.01	0.00	1.32
TMW-5	8/17/1993	12.95	12.98	0.03	0.02	0.00	0.00
	9/16/1994	12.97	13.02	0.05	0.03	0.01	0.01
	6/28/1995	11.25	11.31	0.06	0.04	0.01	0.02
	12/26/1995	10.11	10.16	0.05	0.03	0.01	0.03
	3/22/1996	7.54	7.59	0.05	0.03	0.01	0.03
	8/17/1997	12.95	12.98	0.03	0.02	0.00	0.04
	5/23/2001	--	11.31	0.00	0.00	0.00	0.04
	6/20/2002	11.24	11.29	0.05	0.03	0.01	0.05
	10/21/2002	13.50	13.60	0.10	0.06	0.02	0.06
	12/27/2002	13.50	13.60	0.10	1.50	0.40	0.46
	3/23/2003	9.75	9.79	0.04	0.95	0.25	0.71
	4/4/2003	9.40	9.45	0.05	0.49	0.13	0.83
	5/1/2003	8.93	8.95	0.02	0.38	0.10	0.93
	5/29/2003	11.25	11.29	0.04	0.01	0.01	0.95
	7/25/2003	11.33	11.37	0.04	0.02	0.01	0.95
	8/11/2003	11.47	11.49	0.02	0.01	0.00	0.95
	8/29/2003	12.10	12.17	0.07	0.02	0.01	0.96
	9/12/2003	12.45	12.50	0.05	0.03	0.01	0.97
	9/26/2003	12.40	12.47	0.07	0.02	0.01	0.97
	10/10/2003	12.51	12.61	0.10	0.02	0.01	0.98
	10/30/2003	12.65	12.70	0.05	0.01	0.00	0.98
	11/25/2003	12.39	12.49	0.10	0.01	0.00	0.98
	12/4/2003	12.25	12.35	0.10	0.01	0.00	0.98
	12/23/2003	13.78	13.88	0.10	0.01	0.00	0.99
	1/30/2004	7.63	7.65	0.02	0.01	0.00	0.99
	2/20/2004	7.65	7.67	0.02	0.01	0.00	0.99
	3/12/2004	8.13	8.15	0.02	0.01	0.00	1.00
	3/30/2004	9.09	9.09	0.00	0.00	0.00	1.00
	4/14/2004	9.69	9.73	0.04	0.01	0.00	1.00
	4/23/2004	9.74	9.77	0.03	0.01	0.00	1.00
	5/7/2004	9.61	9.64	0.03	0.04	0.01	1.01
	5/28/2004	9.69	9.72	0.03	0.01	0.00	1.01
6/4/2004	9.61	9.64	0.03	0.01	0.00	1.02	
6/18/2004	9.63	9.66	0.03	0.01	0.00	1.02	
7/29/2004	12.05	12.06	0.01	0.05	0.01	1.03	
8/13/2004	12.21	12.22	0.01	0.10	0.03	1.06	
8/27/2004	12.28	12.30	0.02	0.10	0.03	1.08	
9/10/2004	12.33	12.35	0.02	0.10	0.03	1.11	
9/23/2004	12.41	12.42	0.01	0.10	0.03	1.14	
10/5/2004	13.37	13.38	0.01	0.01	0.00	1.14	
10/21/2004	12.45	12.46	0.01	0.01	0.00	1.14	
11/2/2004	11.90	11.91	0.01	0.01	0.00	1.15	
11/12/2004	11.84	11.85	0.01	0.01	0.00	1.15	
12/2/2004	11.80	11.81	0.01	0.01	0.00	1.15	
12/10/2004	11.85	11.86	0.01	0.01	0.00	1.15	
MW-6	12/27/2002	7.20	7.24	0.04	1.50	0.39	0.39
	5/29/2003	11.93	11.95	0.02	0.01	0.01	0.40
	7/25/2003	12.05	12.07	0.02	0.02	0.01	0.41
	8/11/2003	12.18	12.20	0.02	0.01	0.00	0.41
	8/29/2003	12.74	12.77	0.03	0.05	0.01	0.42

CAMBRIA

Table 2. Separate-Phase Hydrocarbon Removal Summary - Credit World Auto Sales, 2345 International Blvd, Oakland, California

Well ID	Date Sampled	Depth to SPH (feet)	Depth to Groundwater (feet)	SPH Thickness (feet)	Hydrocarbons Removed (liters)	Hydrocarbons Removed (gallons)	Cumulative Hydrocarbons Removed (gallons)
MW-6	9/12/2003	13.09	13.15	0.06	0.05	0.01	0.44
(cont.)	9/26/2003	13.08	13.11	0.03	0.05	0.01	0.45
	10/10/2003	13.27	13.43	0.16	0.08	0.02	0.47
	10/30/2003	13.32	13.40	0.08	0.05	0.01	0.49
	11/25/2003	13.09	13.24	0.15	0.04	0.01	0.50
	12/4/2003	13.04	13.14	0.10	0.02	0.01	0.50
	12/23/2003	13.50	13.60	0.10	0.01	0.00	0.50
	1/30/2004	8.42	8.44	0.02	0.01	0.00	0.51
	2/20/2004	8.38	8.40	0.02	0.01	0.00	0.51
	3/12/2004	8.91	8.93	0.02	0.01	0.00	0.51
	3/30/2004	9.68	9.69	0.01	0.00	0.00	0.51
	4/14/2004	10.14	10.18	0.04	0.01	0.00	0.51
	4/23/2004	10.19	10.22	0.03	0.01	0.00	0.52
	5/7/2004	10.25	10.28	0.03	0.04	0.01	0.53
	5/28/2004	10.27	10.30	0.03	0.01	0.00	0.53
	6/4/2004	10.24	10.27	0.03	0.01	0.00	0.53
	6/18/2004	10.27	10.30	0.03	0.01	0.00	0.54
	7/29/2004	12.01	12.02	0.01	0.05	0.01	0.55
	8/13/2004	12.18	12.19	0.01	0.10	0.03	0.57
	8/27/2004	12.25	12.27	0.02	0.10	0.03	0.60
	9/10/2004	12.32	12.33	0.01	0.10	0.03	0.63
	9/23/2004	12.43	12.44	0.01	0.10	0.03	0.65
	10/5/2004	13.36	13.38	0.02	0.01	0.00	0.66
	10/21/2004	12.48	12.49	0.01	0.01	0.00	0.66
	11/2/2004	11.95	11.96	0.01	0.01	0.00	0.66
	11/12/2004	11.88	11.89	0.01	0.01	0.00	0.66
	12/2/2004	11.82	11.83	0.01	0.01	0.00	0.67
	12/10/2004	11.87	11.88	0.01	0.01	0.00	0.67

Hydrocarbons removed during the 4th Quarter 2004 (gallons) = 9.36

Cumulative hydrocarbons removed by bailing or purging (gallons) = 57.23

Hydrocarbons removed by Tank Protect (see below) (gallons) = 5.0

Cumulative estimated hydrocarbons removed to date (gallons) = 62.23

SPH = Separate phase hydrocarbons

Depths measured in feet from top of well casing.

SPH removal volumes were provided for 5/23/01, 6/13/01, and 12/27/02 data.

The volume of hydrocarbons removed prior to 12/27/2002 were estimated by multiplying the well casing volume (2" diameter casing = 0.60 liters/foot) by the SPH thickness (feet)

Note = approximately 3 to 5 gallons was reported to have been removed by Tank Protect between 8/20/97 and 1/14/98 with continuous free product removal system.

APPENDIX A

Groundwater Monitoring Field Data Sheets

SPH REMOVAL FIELD SHEET

Well ID	Time	DTP	DTW	Thickness	Volume Removed	Casing Diam.	Comments
MW-1		13.00	13.50	0.50	2.5L		
MW-2		15.17	15.33	0.16	2L		emptied full skimmer
MW-3		16.05	16.10	0.05	.75L		empti 1/2 full skimmer
TMW-4		13.25	13.26	0.01	10 ml		
TMW-5		13.37	13.38	0.01	10 ml		
TMW-6		13.36	13.38	0.02	10 ml		

Project Name: hans

Project Number: 513-1004

Technician: S. Hill

Date: 10-5-04

SPH REMOVAL FIELD SHEET

Well ID	Time	DTP	DTW	Thickness	Volume Removed	Casing Diam.	Comments
MW-1		13.49	13.59	0.10	2.5L		
MW-2		15.23	15.46	0.23	2L		emptied full skimmer
MW-3		16.17	16.22	0.05	1L		" " "
TMW-4		13.34	13.35	0.01	10ml		
TMW-5		12.45	12.46	0.01	10ml		
TMW-6		12.48	12.49	0.01	10ml		

Project Name: Wong

Project Number: 513-1004

Technician: S. J. J.

Date: 10-21-04

SPH REMOVAL FIELD SHEET **COPY**

Well ID	Time	DTP	DTW	Thickness	Volume Removed	Casing Diam.	Comments
MW-1		13.00	13.10	.10	2L		
MW-2		14.28	14.96	0.68	3.5		emptied ^{full} skimmer
MW-3		16.58	16.68	0.10	1L		" "
TMW-4		12.81	12.82	0.01	10ml		
TMW-5		11.90	11.91	0.01	10ml		
TMW-6		11.95	11.96	0.01	10ml		

Project Name: Wong
 Technician: P. J. W.

Project Number: 513-1004
 Date: 11-2-04

SPH REMOVAL FIELD SHEET COPY

Well ID	Time	DTP	DTW	Thickness	Volume Removed	Casing Diam.	Comments
MW-1		12.83	12.97	.14	1.5L		
MW-2		14.38	14.83	0.45	3L		emptied full skimmer
MW-3		16.50	16.60	0.10	1.5L		" "
TMW-4		12.77	12.78	0.01	10ml		
TMW-5		11.84	11.85	0.01	10ml		
TMW-6		11.88	11.89	0.01	10ml		

Project Name: Wagon
 Technician: S. Hill

Project Number: 513-1004
 Date: 11-12-04

SPH REMOVAL FIELD SHEET COPY

Well ID	Time	DTP	DTW	Thickness	Volume Removed	Casing Diam.	Comments
MW-1		12.81	12.91	0.10	1.5L		
MW-2		14.34	14.79	0.45	2.5L		emptied full Skimmer
MW-3		16.40	16.53	0.13	2L		" " "
TMW-4		12.71	12.72	0.01	10ml		
TMW-5		11.80	11.81	0.01	10ml		
TMW-6		11.82	11.83	0.01	10ml		

Project Name: Wang
 Technician: [Signature]

Project Number: 513-1004
 Date: 12-2-04

SPH REMOVAL FIELD SHEET **COPY**

Well ID	Time	DTP	DTW	Thickness	Volume Removed	Casing Diam.	Comments
MW-1		12.84	12.94	0.10	1.5L		
MW-2		14.40	14.81	0.41	2.5L		emptied full Skimmer
MW-3		16.41	16.51	0.10	2L		" " "
TMW-4		12.74	12.75	0.01	10ml		
TMW-5		11.85	11.86	0.01	10ml		
TMW-6		11.87	11.88	0.01	10ml		

Project Name: Wang
 Technician: [Signature]

Project Number: 513-1004
 Date: 12-10-04

APPENDIX B

GeoTracker Electronic Delivery Confirmation

Electronic Submittal Information

[Main Menu](#) | [View/Add Facilities](#) | [Upload EDD](#) | [Check EDD](#)

UPLOADING A GEO_WELL FILE

Processing is complete. No errors were found!
Your file has been successfully submitted!

Submittal Title: 4th Qtr 2004 GW Depth Data for 2345 International Blvd.,
Oakland

Submittal Date/Time: 1/25/2005 10:03:53 AM

Confirmation
Number: 6303303360

[Back to Main Menu](#)

Logged in as CAMBRIA-EM (AUTH_RP)

CONTACT SITE [ADMINISTRATOR](#).