

CAMBRIA

RO 327

June 3, 2003

Mr. Amir Gholami
Alameda County Department of Environmental Health
1131 Harbor Bay Parkway, Suit 250
Alameda, CA 94502-6577

Re: **Groundwater Monitoring Report, First Quarter 2003**
Credit World Auto Sales
2345 International Boulevard (Formerly E. 14th Street)
Oakland, California 94601
Case No. 2116
Cambria Project No. 129-0741

Alameda County
Environmental Health
JUN 09 2003



Dear Mr. Gholami:

On behalf of Mr. Stanley Wong, Cambria Environmental Technology, Inc. (Cambria) has prepared this groundwater monitoring report for the above-referenced site. Presented in the report are the first quarter 2002 activities and the anticipated second quarter 2003 activities.

If you have any questions or comments regarding this report, please call me at (510) 420-3307.

Sincerely,
Cambria Environmental Technology, Inc.

Mary C. Holland-Ford
Project Geologist

Attachments: Groundwater Monitoring Report, First Quarter 2003

cc: Mr. Stanley Wong, 2200 E. 12th St., Oakland, California 94606

**Cambria
Environmental
Technology, Inc.**

5900 Hollis Street
Suite A
Emeryville, CA 94608
Tel (510) 420-0700
Fax (510) 420-9170

GROUNDWATER MONITORING REPORT

FIRST QUARTER 2003

**Credit World Auto Sales
2345 International Boulevard
(Formerly E. 14th Street)
Oakland, California 94601
Case No. 2116
Cambria Project No. 513-1000**



June 3, 2003

Prepared for:

Mr. Stanley Wong
2200 E. 12th Street
Oakland, California 94606

Alameda County
JUN 09 2003
Environmental Health

Prepared by:

Cambria Environmental Technology, Inc.
5900 Hollis Street, Suite A
Emeryville, California 94608

Cambria
Environmental
Technology, Inc.

5900 Hollis Street
Suite A
Emeryville, CA 94608
Tel (510) 420-0700
Fax (510) 420-9170

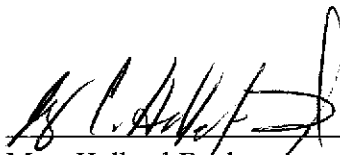
Mary Holland-Ford
Project Geologist

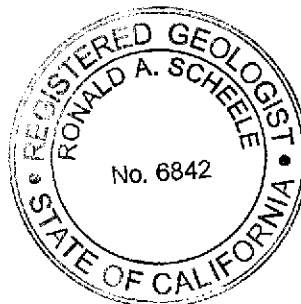

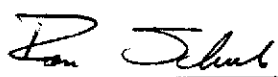
Ron Scheele, RG
Associate Geologist

GROUNDWATER MONITORING REPORT

FIRST QUARTER 2003

World Credit Auto Sales
2345 International Boulevard
(Formerly E. 14th Street)
Oakland, California 94601
Case No. 2116
Cambria Project No. 513-1000

June 3, 2003



INTRODUCTION

On behalf of Mr. Stanley Wong, Cambria Environmental Technology, Inc. (Cambria) has prepared this *Groundwater Monitoring Report, First Quarter 2003* for the above-referenced site. Presented in the report is the first quarter 2003 groundwater monitoring activities, results, and the anticipated second quarter 2003 activities.

FIRST QUARTER 2003 ACTIVITIES

Monitoring Activities

Field Activities: On March 23, 2003, Cambria conducted quarterly monitoring activities. Cambria gauged water levels and inspected for separate-phase hydrocarbon (SPH) in monitoring wells MW-1, MW-2, TMW-4, and TMW-5. Wells MW-3 and TMW-6 were not accessible during this sampling event. Due to the presence of SPH in all wells, no groundwater samples were collected for analysis. Field data sheets are presented in Appendix A.

Monitoring Results

Groundwater Flow Direction: Historically the groundwater flow for this site has been radial or towards the northwest. Based on Cambria's March 23, 2003 depth-to-water measurements, groundwater beneath the site flows towards the north with a gradient of 0.121 ft/ft. Groundwater elevation is presented in Table 1 and Figure 1.

SPH Removal Activities: During the March 23, 2003 monitoring event, SPH was encountered in wells MW-1, MW-2, TMW-4 and TMW-5 with thicknesses ranging from 0.03 ft to 0.29 ft. Cambria

removed approximately 2.33 gallons of SPH by hand bailing. An estimated 15.90 gallons have been removed from the wells since 1992. SPH removal data is summarized in Table 2.

ANTICIPATED SECOND QUARTER 2003 ACTIVITIES

Monitoring Activities



Cambria will gauge water levels in all wells, inspect wells for SPH, and collect groundwater samples from all wells not containing SPH. Groundwater samples will be analyzed for total petroleum hydrocarbons as gasoline by modified EPA Method 8015, and benzene, toluene, ethylbenzene, xylenes, and methyl tert butyl ether (MTBE) by EPA Method 8021B, with confirmation analysis for any MTBE concentrations by EPA Method 8260. Dissolved oxygen will be measured if no SPH is present. Cambria will summarize groundwater monitoring and corrective action activities in the *Groundwater Monitoring Report – Second Quarter 2003*.

Corrective Action Activities

Cambria is awaiting agency approval of our recommendations to perform additional assessment, feasibility testing and interim remedial activities. In the meantime, Cambria will continue to hand bail SPH from all wells with measurable SPH on a quarterly basis.

ATTACHMENTS

Figure 1 – Groundwater Elevation Contour and SPH Thickness Map

Table 1 – Groundwater Analytical Data

Table 2 – Separate Phase Hydrocarbon Removal

Appendix A – Groundwater Monitoring Field Data Sheets

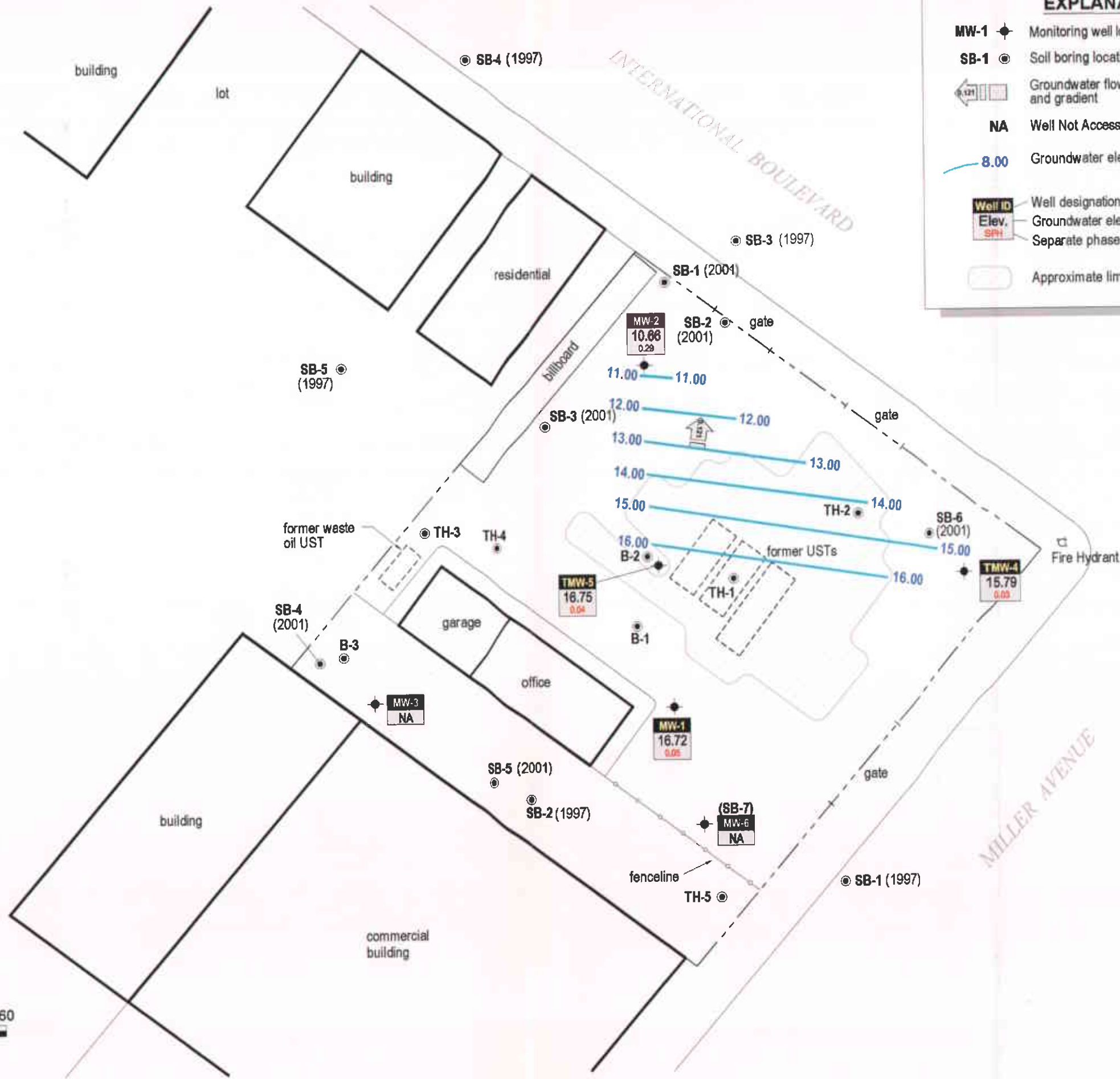
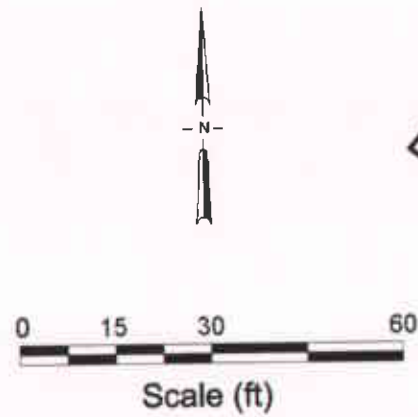

FIGURE 1

CAMBRIA

Table 1. Groundwater Analytical Data - Credit World Auto Sales, 2345 International Boulevard, Oakland, California

Well ID TOC (ft)	Date Sampled	Depth to GW (ft)	SPH Thickness (ft)	GW Elevation (ft)	TPHg (µg/L)	Benzene (µg/L)	Toluene (µg/L)	Ethylbenzene (µg/L)	Xylenes (µg/L)	MTBE (µg/L)
MW-1	12/30/1997	10.96	0.17	16.51	61,000	4,300	1,800	1,600	6,900	1,400
100.000 ^a	3/24/1998	9.33	0.00	18.00	24,000	1,000	1,000	1,300	4,300	2,000
27.33 ^b	6/29/1998	12.20	0.00	15.13	130,000	3,800	370	1,200	4,200	3,300
	10/2/1998	13.46	0.00	13.87	22,000	66	21	26	140	<0.50
	12/10/1998	10.49	0.00	16.84	32,000	4,600	970	1,700	4,900	<250
	3/26/1999	9.44	0.00	17.89	230,000	370	290	280	720	<0.50
	6/11/1999	12.56	0.01	14.78	180,000	210	170	220	400	<0.50
	9/15/1999	14.85	1.00	13.28	21,000	3,800	280	590	2,200	<250
	12/28/1999	14.50	1.32	13.89	27,000	48	36	46	83	<0.5
	6/13/2001	15.83	4.36	12.03	--	--	--	--	--	--
	12/27/2002	8.31	0.16	16.19	--	--	--	--	--	--
	3/23/2003	10.65	0.05	16.72	--	--	--	--	--	--
MW-2	8/23/1991	13.77	0.00	84.82	10,000	<5	<5	<5	<5	--
98.585 ^a	4/16/1992	15.38	2.81	12.79	--	--	--	--	--	--
25.92 ^b	6/11/1993	13.19	0.00	12.74	--	--	--	--	--	--
	8/17/1993	14.04	0.01	11.89	49,000	94	240	250	980	--
	3/28/1994	13.61	0.54	12.74	14,000	4,200	<250	910	1,400	--
	6/27/1994	14.24	0.80	12.32	24,000	4,400	72	1,100	1,700	--
	9/16/1994	17.82	4.46	11.67	40,000	2,300	250	2,000	4,100	--
	3/31/1995	16.72	7.44	15.15	28,000	4,000	<120	1,100	1,400	--
	6/28/1995	13.50	0.73	13.00	40,000	2,700	130	1,700	2,900	--
	9/28/1995	14.63	0.54	11.72	7,500	420	14	250	190	<62
	12/26/1995	12.58	0.90	14.06	22,000	1,300	88	950	1,800	<250
	3/22/1996	11.46	0.15	14.58	9,800	2,200	<120	400	<380	<1,200
	6/20/1996	13.08	0.37	13.14	35,000	770	<0.50	240	<0.50	550
	9/30/1996	16.67	3.75	12.25	58,000	1,600	230	2,200	4,000	<5.0
	12/27/1996	15.74	7.57	16.24	29,000	2,100	<0.50	1,200	1,800	<5.0
	3/7/1997	12.55	0.00	13.37	13,000	1,300	37	290	180	<5.0
	6/28/1997	11.98	0.04	13.97	12,000	840	<0.50	640	360	<5.0
	9/18/1997	13.44	0.00	12.48	12,000	680	<0.50	320	84	<5.0
	12/30/1997	11.31	0.00	14.61	13,000	1,100	40	350	220	<5.0
	3/25/1998	10.02	0.00	15.90	8,100	1,300	51	410	230	670
	6/29/1998	11.96	0.00	13.96	12,000	880	13	180	72	430

CAMBRIA

Table 1. Groundwater Analytical Data - Credit World Auto Sales, 2345 International Boulevard, Oakland, California

Well ID TOC (ft)	Date Sampled	Depth to GW (ft)	SPH Thickness (ft)	GW Elevation (ft)	TPHg (µg/L)	Benzene (µg/L)	Toluene (µg/L)	Ethylbenzene (µg/L)	Xylenes (µg/L)	MTBE (µg/L)	
MW-2 (cont)	10/2/1998	13.74	0.00	12.18	47,000	140	100	110	200	<0.50	
	12/10/1998	12.91	2.10	14.69	26,000	1,000	210	1,500	1,900	<1,000	
	3/26/1999	9.06	0.20	17.02	110,000	190	150	120	380	<0.50	
	6/11/1999	12.18	0.00	13.74	190,000	310	250	320	540	<0.50	
	9/15/1999	15.59	3.00	12.73	25,000	720	<100	1,300	1,600	<1,000	
	12/28/1999	16.81	4.50	12.71	75,000	130	98	130	230	<0.50	
	6/13/2001	14.84	3.15	10.84	--	--	--	--	--	--	
	6/20/2002	14.80	0.70	8.92	53,000	2,200	140	3,300	3,000	<1,000	
	10/21/2002	16.98	0.24	6.37	--	--	--	--	--	--	
	12/27/2002	13.58	0.43	9.92	--	--	--	--	--	--	
	3/23/2003	15.49	0.29	10.66	--	--	--	--	--	--	
	MW-3 99.25 ^a 27.57 ^b	8/23/1991	15.07	0.00	84.18	<5,000	<5	<5	<5	<5	--
		4/16/1992	14.14	0.16	13.56	--	--	--	--	--	--
6/11/1993		14.28	0.00	13.30	--	--	--	--	--	--	
8/17/1993		15.77	0.00	11.80	9,600	4.1	17	28	54	--	
3/28/1994		14.35	0.00	13.22	8,400	2,400	56	67	200	--	
6/27/1994		14.77	0.00	12.80	9,900	3,300	<22	<25	73	--	
9/16/1994		15.42	0.05	12.19	16,000	2,300	80	620	240	--	
3/31/1995		12.98	0.46	14.96	16,000	2,800	70	<25	920	--	
6/28/1995		14.20	0.05	13.41	11,000	2,300	32	81	240	--	
9/28/1995		15.17	0.00	12.40	6,300	1,900	<42	200	<120	<420	
12/26/1995		13.33	0.06	14.29	25,000	3,800	97	94	1,600	<250	
3/22/1995		12.81	0.04	14.79	16,000	3,100	75	69	350	250	
6/20/1996		13.95	0.07	13.68	8,500	1,400	28	140	15	220	
9/24/1996		14.86	0.04	12.74	12,000	2,400	87	340	110	<5.0	
12/27/1996		11.04	0.06	16.58	5,800	1,700	28	<0.50	42	240	
3/10/1997		13.80	0.00	13.77	9,000	1,700	<0.50	110	<0.50	<5.0	
6/28/1997		13.72	0.06	13.90	15,000	2,200	<0.50	160	190	<5.0	
9/18/1997		14.76	0.00	12.81	28,000	3,800	<0.50	100	<0.50	<5.0	
12/30/1997	12.97	0.00	14.60	21,000	2,200	<0.50	31	<0.50	300		
3/24/1998	11.75	0.00	15.82	2,300	870	7.2	20	<0.50	85		
6/29/1998	13.38	0.00	14.19	6,500	1,300	12	62	14	140		
10/2/1998	14.42	0.00	13.15	11,000	31	27	35	69	<0.50		
12/10/1998	12.55	0.00	15.02	<2,500	2,800	68	42	55	<250		

CAMBRIA

Table 1. Groundwater Analytical Data - Credit World Auto Sales, 2345 International Boulevard, Oakland, California

Well ID TOC (ft)	Date Sampled	Depth to GW (ft)	SPH Thickness (ft)	GW Elevation (ft)	TPHg (µg/L)	Benzene (µg/L)	Toluene (µg/L)	Ethylbenzene (µg/L)	Xylenes (µg/L)	MTBE (µg/L)
MW-3 (cont)	3/26/1999	10.54	0.00	17.03	10,000	21	14	10	41	<0.50
	6/15/1999	13.91	0.00	13.66	87,000	90	71	92	180	<0.50
	9/15/1999	14.70	0.00	12.87	8,700	2,100	71	110	66	<100
	12/28/1999	15.16	0.25	12.61	4,300	7.7	5.2	7.2	13	<0.50
	6/13/2001	14.70	0.40	13.19	8,400	1,300	25	64	32	<20
	6/20/2002	14.68	0.02	12.91	7,800	1,100	23	66	15	<50
	12/27/2002	11.37	0.17	16.34	--	--	--	--	--	--
	3/23/2003	--	--	--	--	--	--	--	--	--
TMW-4 26.50 ^b	8/17/1993	13.26	0.00	13.24	150	<0.50	0.8	1.4	3.7	--
	3/28/1994	12.40	0.00	14.10	<50	<0.50	<0.50	<0.50	<1.5	--
	6/27/1994	12.84	0.00	13.66	<50	<0.50	<0.50	<0.50	<1.5	--
	9/16/1994	13.58	0.00	12.92	<50	<0.50	<0.50	<0.50	<1.5	--
	3/31/1995	10.23	0.00	16.27	<50	<0.50	<0.50	<0.50	<1.5	--
	6/28/1995	12.21	0.00	14.29	<50	<0.50	<0.50	<0.50	<1.5	--
	9/28/1995	13.38	0.00	13.12	<50	<0.50	<0.50	<0.50	<1.5	<5.0
	12/26/1995	11.32	0.00	15.18	<50	<0.50	<0.50	<0.50	<1.5	<5.0
	3/22/1996	10.54	0.00	15.96	<50	<0.50	<0.50	<0.50	<1.5	<5.0
	6/20/1996	12.14	0.00	14.36	<50	<0.50	<0.50	<0.50	<0.50	<5.0
	9/24/1996	13.01	0.00	13.49	<50	<0.50	<0.50	<0.50	<0.50	<5.0
	12/27/1996	9.51	0.00	16.99	<50	<0.50	<0.50	<0.50	<0.50	<5.0
	3/10/1997	11.92	0.00	14.58	<50	<0.50	<0.50	<0.50	<0.50	<5.0
	6/27/1997	10.70	0.00	15.80	<50	<0.50	<0.50	<0.50	<0.50	<5.0
	9/18/1997	12.94	0.00	13.56	<50	<0.50	<0.50	<0.50	<0.50	<5.0
	12/30/1997	10.92	0.00	15.58	<50	<0.50	<0.50	<0.50	<0.50	<5.0
	3/25/1998	9.60	0.00	16.90	<50	<0.50	<0.50	<0.50	<0.50	<5.0
	6/29/1998	11.32	0.00	15.18	<50	<0.50	<0.50	<0.50	<0.50	<5.0
	10/2/1998	12.56	0.00	13.94	<50	<0.50	<0.50	<0.50	<0.50	<0.50
	12/10/1998	10.44	0.00	16.06	<50	<0.50	<0.50	<0.50	<0.50	<0.50
3/26/1999	9.38	0.00	17.12	<50	<0.50	<0.50	<0.50	<0.50	<0.50	
6/15/1999	11.58	0.00	14.92	<50	<0.50	<0.50	<0.50	<0.50	<0.50	

CAMBRIA

Table 1. Groundwater Analytical Data - Credit World Auto Sales, 2345 International Boulevard, Oakland, California

Well ID TOC (ft)	Date Sampled	Depth to GW (ft)	SPH Thickness (ft)	GW Elevation (ft)	TPHg (µg/L)	Benzene (µg/L)	Toluene (µg/L)	Ethylbenzene (µg/L)	Xylenes (µg/L)	MTBE (µg/L)
TMW-4 (con't)	9/15/1999	12.89	0.00	13.61	<50	<0.50	<0.50	<0.50	<0.50	<5.0
	12/28/1999	12.92	0.00	13.58	<50	<0.50	<0.50	<0.50	<0.50	<0.50
	10/21/2002	12.70	0.00	13.80	--	--	--	--	--	--
	12/27/2002	9.07	0.12	17.53	--	--	--	--	--	--
	3/23/2003	10.73	0.03	15.79	--	--	--	--	--	--
TMW-5 26.51 ^b	8/17/1993	12.98	0.03	13.55	120,000	640	730	790	3,600	--
	3/28/1994	11.39	0.00	15.12	70,000	23,000	1,500	4,100	15,000	--
	6/28/1994	12.24	0.00	14.27	56,000	26,000	940	5,500	26,000	--
	9/16/1994	13.02	0.05	13.53	96,000	17,000	720	3,500	12,000	--
	3/31/1995	7.38	0.00	19.13	64,000	13,000	470	3,500	6,100	--
	6/28/1995	11.31	0.06	15.25	65,000	9,000	240	2,600	5,300	--
	9/28/1995	14.42	0.00	12.09	79,000	17,000	1,800	2,700	7,000	<1,200
	12/26/1995	10.16	0.05	16.39	110,000	11,000	800	2,300	4,500	<1,200
	3/22/1996	7.59	0.05	18.96	--	--	--	--	--	--
	6/26/1996 ^d	7.12	0.00	--	30,000	4,000	180	1,500	2,500	830
	9/30/1996	7.42	0.00	--	6,900	1,600	79	130	370	<5.0
	12/27/1996	6.38	0.00	--	78,000	12,000	1,900	2,900	9,700	<5.0
	3/10/1997	11.12	0.00	--	84,000	9,900	1,100	2,600	8,800	<5.0
	8/17/1997	12.98	0.03	--	--	--	--	--	--	--
	9/18/1997	12.00	0.00	--	65,000	8,000	<0.5	2,000	4,700	<5.0
	12/30/1997	8.97	0.00	--	79,000	6,400	340	2,300	5,500	<5.0
	3/25/1998	7.32	0.00	--	20,000	6,000	260	2,700	5,800	2,400
	6/29/1998	11.50	0.00	--	--	--	--	--	--	--
	10/8/1998	12.56	0.00	--	46,000	120	98	120	240	<0.50
	12/8/1998	10.14	0.00	--	46,000	5,900	320	2,200	5,400	<1,200
	3/26/1999	7.08	0.00	--	35,000	69	61	37	120	<0.50
6/11/1999	11.40	0.00	--	26,000	29	32	43	72	<0.50	
9/15/1999	12.52	0.00	--	37,000	7,300	400	2,400	6,000	<1,000	
12/28/1999	12.44	0.00	--	25,000	44	32	41	75	<0.50	
5/23/2001	11.31	0.00	--	12.54	--	--	--	--	--	
6/20/2002	11.29	0.05	--	12.60	51,000	5,100	290	2,300	5,800	<250
10/21/2002	13.60	0.10	--	10.33	--	--	--	--	--	
12/27/2002	6.60	0.07	--	17.31	--	--	--	--	--	
3/23/2003	9.79	0.04	16.75	--	--	--	--	--	--	

CAMBRIA

Table 1. Groundwater Analytical Data - Credit World Auto Sales, 2345 International Boulevard, Oakland, California

Well ID	Date	Depth to	SPH	GW						
TOC (ft)	Sampled	GW	Thickness	Elevation	TPHg	Benzene	Toluene	Ethylbenzene	Xylenes	MTBE
		(ft)	(ft)	(ft)	(µg/L)	(µg/L)	(µg/L)	(µg/L)	(µg/L)	(µg/L)
MW-6	5/23/2001	12.47	0.00	11.34	--	--	--	--	--	--
23.81 ^c	6/13/2001	12.47	0.00	11.34	7,600	1,400	42	19	14	<10
	6/20/2002	12.45	0.00	11.36	79	5.7	<0.5	<0.5	<0.5	<5.0
	12/27/2002	7.24	0.04	16.60	--	--	--	--	--	--
	3/23/2003	--	--	--	--	--	--	--	--	--

Abbreviations and Methods:

bgs = below grade surface

(ug/L) = micrograms per Liter

TOC = elevation measured in feet below top of casing

Depth to GW = Depth to groundwater relative to top of casing

SPH = Separate phase hydrocarbons

TPHg = Total petroleum hydrocarbons as gasoline by modified EPA Method 8015

Benzene, Toluene, Ethylbenzene, Xylenes by EPA Method 8020, and by 8260 if in parenthesis

MTBE methyl tert butyl ether by EPA Method 8020

VOCs = volatile organic compounds by EPA Method 8260

ND* = not detected with the exception of reported concentrations for benzene, toluene, ethylbenzene and xylenes

GW Elevation = Groundwater elevation in relation to mean sea level; calculated according to the relationship $GW\ elevation = TOC - DTW + (0.8)(SPH\ thickness)$

a = Relative to site datum established by Earth Systems Engineering surveyed August 1981

b = Top of casing elevation surveyed 8/10/93 by professional engineer (unknown datum)

c = Top of casing elevation surveyed 6/13/01 to City of Oakland datum by Renner Survey Company of Burlingame, CA. for Sequoia Environmental.

APPENDIX A

Groundwater Monitoring Field Data Sheets

CAMBRIA

Table 2. Separate Phase Hydrocarbon Removal - Credit World Auto Sales, 2345 International Blvd, Oakland, California

Sample ID/ Well ID	Date Sampled	Depth to GW (feet bgs)	Depth to SPH (feet bgs)	SPH Thickness (feet)	GW Elevation (feet)	Hydrocarbons Removed (liters)	Hydrocarbons Removed (gallons)	Cumulative Hydrocarbons Removed (gallons.)
MW-1	12/30/1997	10.96	10.79	0.17	16.51	0.10	0.03	0.03
MW-1	6/11/1999	12.56	12.55	0.01	14.78	0.01	0.00	0.03
MW-1	9/15/1999	14.85	13.85	1.00	13.28	0.60	0.16	0.19
MW-1	12/28/1999	8.31	8.15	0.16	19.15	0.10	0.03	0.21
MW-1	6/13/2001	8.31	8.15	0.16	16.19	0.10	0.03	0.24
MW-1	12/27/2003	8.31	8.15	0.16	16.19	3.00	0.79	1.03
MW-1	3/23/2003	10.65	10.60	0.05	13.76	1.26	0.33	1.36
MW-2	6/28/1995	13.50	12.77	0.73	13.00	0.44	0.12	0.12
MW-2	9/28/1995	14.63	14.09	0.54	11.72	0.32	0.09	0.20
MW-2	12/26/1995	12.58	11.68	0.90	14.06	0.54	0.14	0.34
MW-2	3/22/1996	11.46	11.31	0.15	14.58	0.09	0.02	0.37
MW-2	6/20/1996	13.08	12.71	0.37	13.14	0.22	0.06	0.43
MW-2	9/30/1996	16.67	12.92	3.75	12.25	2.25	0.59	1.02
MW-2	12/27/1996	15.74	8.17	7.57	16.24	4.54	1.20	2.22
MW-2	6/28/1997	11.98	11.94	0.04	13.97	0.02	0.01	2.23
MW-2	9/18/1997	13.44	13.44	0.00	12.48	0.00	0.00	2.23
MW-2	12/10/1998	12.91	10.81	2.10	14.69	1.26	0.33	2.56
MW-2	3/26/1999	9.06	8.86	0.20	17.02	0.12	0.03	2.59
MW-2	9/15/1999	15.59	12.59	3.00	12.73	1.80	0.48	3.07
MW-2	12/28/1999	16.81	12.31	4.50	12.71	2.70	0.71	3.78
MW-2	6/13/2001	14.84	11.69	3.15	10.84	1.89	0.50	4.28
MW-2	6/20/2002	14.80	14.10	0.70	8.92	0.42	0.11	4.39
MW-2	10/21/2002	16.98	16.74	0.24	6.37	0.14	0.04	4.43
MW-2	12/27/2002	13.58	13.15	0.43	9.92	3.00	0.79	5.22
MW-2	3/23/2003	15.49	15.20	0.29	7.90	5.68	1.50	6.72
MW-3	4/16/1992	14.14	13.98	0.16	13.56	0.10	0.03	0.03
MW-3	9/16/1994	15.42	15.37	0.05	12.19	0.03	0.01	0.03
MW-3	3/31/1995	12.98	12.52	0.46	14.96	0.28	0.07	0.11
MW-3	6/28/1995	14.20	14.15	0.05	13.41	0.03	0.01	0.11
MW-3	12/26/1995	13.33	13.27	0.06	14.29	0.04	0.01	0.12
MW-3	3/22/1995	12.81	12.77	0.04	14.79	0.02	0.01	0.13
MW-3	6/20/1996	13.95	13.88	0.07	13.68	0.04	0.01	0.14
MW-3	9/24/1996	14.86	14.82	0.04	12.74	0.02	0.01	0.15
MW-3	12/27/1996	11.04	10.98	0.06	16.58	0.04	0.01	0.16
MW-3	6/28/1997	13.72	13.66	0.06	13.90	0.04	0.01	0.17
MW-3	12/28/1999	15.16	14.91	0.25	12.61	0.15	0.04	0.21
MW-3	6/13/2001	14.70	14.30	0.40	13.19	0.24	0.06	0.27
MW-3	6/20/2002	14.68	14.66	0.02	12.91	0.01	0.00	0.27
MW-3	12/27/2002	11.37	11.20	0.17	16.34	3.00	0.79	1.07
TMW-4	12/27/2002	9.07	8.95	0.12	17.53	1.50	0.40	0.40
TMW-4	3/23/2003	10.73	10.70	0.03	15.79	0.95	0.25	0.65
TMW-5	8/17/1993	12.98	12.95	0.03	13.55	0.02	0.00	0.00
TMW-5	9/16/1994	13.02	12.97	0.05	13.53	0.03	0.01	0.01
TMW-5	6/28/1995	11.31	11.25	0.06	15.25	0.04	0.01	0.02
TMW-5	12/26/1995	10.16	10.11	0.05	16.39	0.03	0.01	0.03
TMW-5	3/22/1996	7.59	7.54	0.05	18.96	0.03	0.01	0.04
TMW-5	8/17/1997	12.98	12.95	0.03	--	0.02	0.00	0.04
TMW-5	5/23/2001	11.31	--	0.00	12.54	0.00	0.00	0.04
TMW-5	6/20/2002	11.29	11.24	0.05	12.60	0.03	0.01	0.05
TMW-5	10/21/2002	13.60	13.50	0.10	10.33	0.06	0.02	0.07
TMW-5	12/27/2002	13.60	13.50	0.10	10.33	1.50	0.40	0.46
TMW-5	3/23/2003	9.79	9.75	0.04	14.09	0.95	0.25	0.71
MW-6	12/27/2002	7.24	7.20	0.04	16.60	1.50	0.39	0.39

Hydrocarbons Removed by bailing or purging (gallons) = 10.90

Estimated 5 gallons removed by Tank Protect (see Note) (gallons) = 5.0

Total Estimated Hydrocarbons removed (gallons) = 15.90

Note = approximately 3 to 5 gallons reported removed by Tank Protect between 8/20/97 and 1/14/98 with continuous free product removal system.

bgs = below ground surface

SPH removal volumes were provided for 5/23/01, 6/13/01, and 12/27/02 data.

The volume of hydrocarbons removed prior to 12/27/2002 were estimated by multiplying the well casing volume (2" diameter casing = 0.60L/B) by the SPH thickness (feet)

Product Bailing Sheet

Well ID	Order	DTP	DTW	DOT DTP	Amount of Product Removed	Casing Dia	Comment
MW-1	6		10.65	10.60	1/3 gallon	2	dark brown SPH
MW-2	5		15.49	15.20	1 1/2 gallons	2	" " "
MW-3	1		unaccessible covered by a car				
TMW-4	3		10.73	10.70	1/4 gallon	2	dark brown SPH
TMW-5	4		9.79	9.75	1/4 gallon	2	" " "
TMW-6	2		unaccessible covered by a car				

Project Name: World Credit Auto

Project Number: 513-1000

Technician: S. Hill

Date: 3-23-03

CAMBRIA
Supplemental Billing Form 2003
Standard, State Fund, and ChevronTexaco Rates

FILE COPY

Date: 3-23-03 Project Name: World Credit Auto

Employee Name: Sanjiv Gill Project Number: 513-1000 Task: 006

* Indicates ChevronTexaco eligible

Unit #	Item	Unit	Unit Cost (\$)	Qty Used
Equipment				
00003	Air Compressor	Day	35.00	
00060	Bailer (PVC)	Day	8.00	
00004	Bailer (products thickness)	Day	20.00	
00005	Bailer (Teflon)	Day	20.00	
00245*	Core Saw	Day	100.00	
00246*	Dual-Phase Extraction Trailer	Day	300.00	
00051*	Generator	Day	50.00	
00023	Hand Auger Kit w/ core sampler/hammer	Day	30.00	
00049	Meter - Combustible Gas/O2 Level	Day	50.00	
00001	Meter - Dissolved Oxygen Meter	Day	40.00	
00008	Meter - Interface	Day	40.00	1
00002	Meter - pH, Conductivity, Temperature	Day	40.00	
00052*	Meter - Photo-ionization Detector (PID)	Day	100.00	
00233*	Meter - Flame-ionization Detector (FID)	Day	150.00	
00037	Meter- Turbidity	Day	20.00	
00057	Meter - Vacuum/Pressure Gauges	Day	20.00	
00050	Meter - Vapor Flow Meter	Day	20.00	
00066	Meter - Water Level	Day	25.00	
00058	Pump - DC Purging 2" (3 gpm to 40ft deep)	Day	15.00	
00040	Pump - Hand Purging, 2" (3 gpm to 40 ft deep)	Day	15.00	
00244*	Pump - Submersible w/ Hose Assembly and Controller	Day	200.00	
00044	Pump - Submersible 2" (8 gpm)	Day	50.00	
00045	Pump - Submersible 4" (40 gpm)	Day	60.00	
00011	Pump - Trash (150 gpm)	Day	55.00	
00235	Traffic Control - Cones	Each 25	8.00	1
00037	Traffic Control - Signs, Barricades (no flagmen or lightboards)	Day	30.00	
Report Production				
00241	Report Production (Standard, <1/2 in)	Each	25.00	
00242	Report Production (Oversized, >1/2 in)	Each	50.00	
Field Supplies				
00056	Bailers (Disposable) Polypropylene	Each	8.00	2
00020	Personal Protective Equipment: Level C (per person/day)	Unit	40.00	
00010	Personal Protective Equipment: Level D (per person /day)	Unit	0.00	
00238	Padlocks	Each	10.00	
00038	Soil Sampling Liners (Brass)	Each	6.00	
00234	Soil Sampling Liners (Stainless Steel)	Each	10.00	
00239	Tedlar Bags (1 Liter)	Each	10.00	
00025	Film	Photo	2.00	
00035	55-Gallon Drum	Each	40.00	
00014	Miscellaneous field supplies (gloves, water, rope, caution tape, etc.)	Unit	25.00	1
Travel	Standard/ChevronTexaco			
00061	Mileage Standard	Mile	0.40	
00243*	Mileage ChevronTexaco (Company Truck)	Mile	0.36	
00063*	Truck (2WD Pick-up, van)	Day	55.00	
00236*	Specialized vehicle (4WD)	Day	75.00	
00015*	Per diem	Day	85.00	
	UST Fund			
00067	Mileage - Truck/Auto (2WD Pick-up, van) if miles/day under 120	Mile	0.50	15
00063	Truck (2WD Pick-up, van) if miles/day over 120	Day	60.00	
00061	Mileage - Specialized vehicle (4WD) if miles/day under 125	Mile	0.60	
00236	Specialized vehicle (4WD) if miles/day over 125	Day	75.00	
00015	Per diem	Day	85.00	