



**TANK PROTECT ENGINEERING**  
of Northern California, Inc.

**FROM:** TANK PROTECT ENGINEERING

**DATE:** 10/10/95

**TO:** ACHCSA

**ATTN:** BARNEY CHAN

**RE.:**

**NO. OF PAGES:** 5

(Include cover sheet)

**If all pages are not received please notify sender.**

**MESSAGE:**

Request permission to backfill.

Thank you.

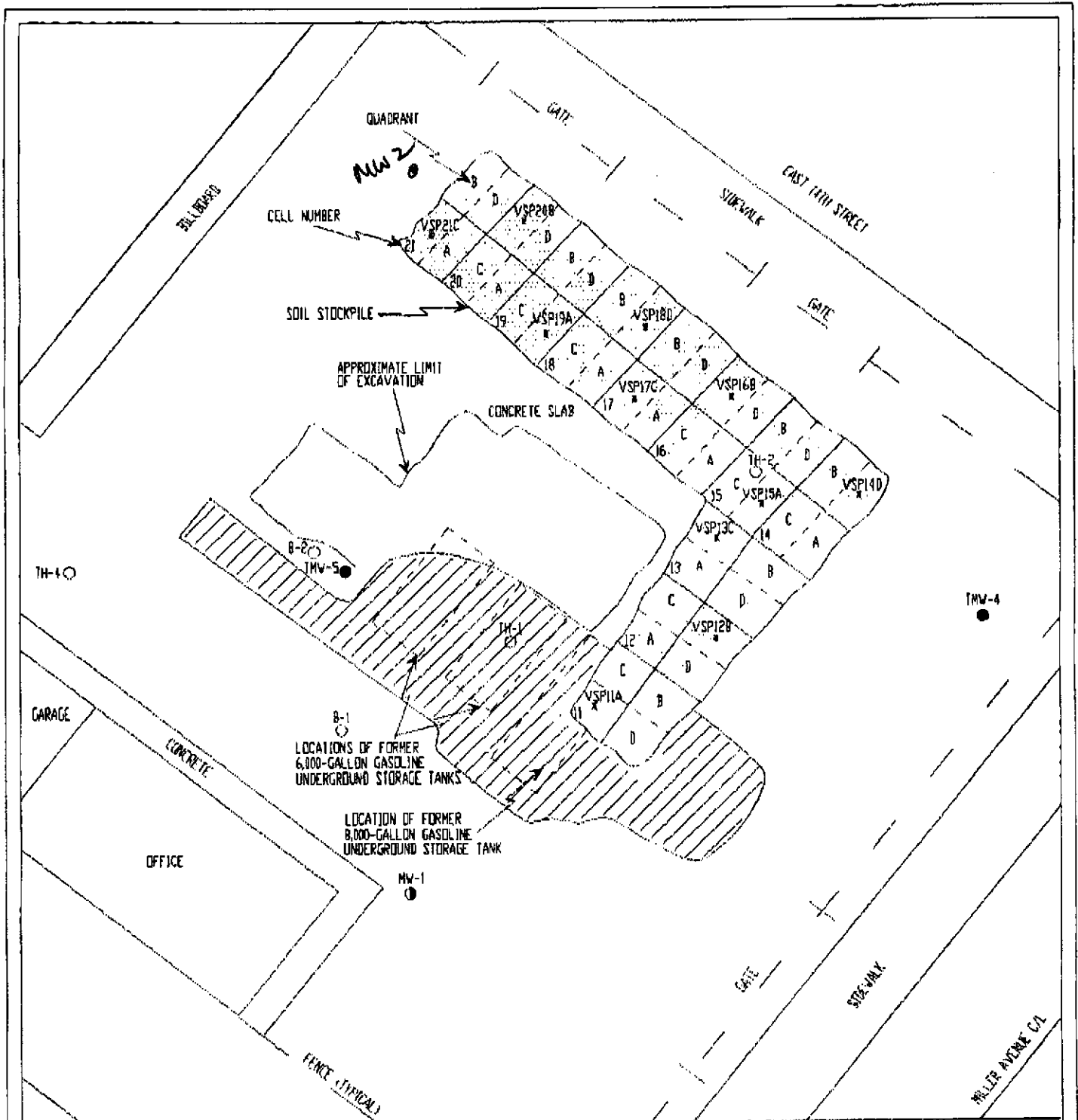

LEGEND

- TMW-4 NAME AND LOCATION OF GROUNDWATER MONITORING WELL INSTALLED BY TPE
- MW-1 NAME AND LOCATION OF GROUNDWATER MONITORING WELL INSTALLED BY OTHERS
- B-1 NAME AND APPROXIMATE LOCATION OF SOIL BORING DRILLED BY OTHERS
- \* VSP11A NAME AND LOCATION OF SOIL SAMPLE
- ▨ AREA BACKFILLED

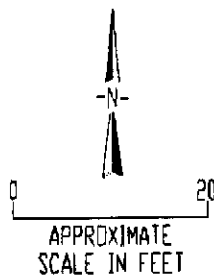

TANK PROTECT ENGINEERING

SITE PLAN:  
VERIFICATION STOCKPILE SAMPLING (10/2/95)

CREDIT WORLD AUTO SALES  
2345 E. 14TH STREET  
OAKLAND, CA 94601

DATE	10/4/95
FIGURE	2
FILE #	267-7N
DRAWN BY	VK
CHECKED BY	LNH



# PRIORITY ENVIRONMENTAL LABS

Precision Environmental Analytical Laboratory

October 06, 1995

PEL # 9510011

TANK PROTECT ENGINEERING

Attn: Lee Huckins

Re: Eleven soil samples for Gasoline/BTEX analysis.

Project name: Credit World Auto Sales

Project location: 2345 E. 14th St.

Project number: 267100395

Date sampled: Oct 03, 1995

Date submitted: Oct 04, 1995

Date extracted: Oct 04-05, 1995

Date analyzed: Oct 04-05, 1995

## RESULTS:

SAMPLE I.D.	Gasoline (mg/Kg)	Benzene (ug/Kg)	Toluene (ug/Kg)	Ethyl Benzene (ug/Kg)	Total Xylene (ug/Kg)
VSP 11A	N.D.	N.D.	N.D.	N.D.	N.D.
VSP 12B	N.D.	N.D.	N.D.	N.D.	N.D.
VSP 13C	N.D.	N.D.	N.D.	N.D.	N.D.
VSP 14D	N.D.	N.D.	N.D.	N.D.	N.D.
VSP 15A	N.D.	N.D.	N.D.	N.D.	N.D.
VSP 16B	N.D.	N.D.	N.D.	N.D.	N.D.
VSP 17C	N.D.	N.D.	N.D.	N.D.	N.D.
VSP 18D	N.D.	N.D.	N.D.	N.D.	N.D.
VSP 19A	N.D.	N.D.	N.D.	N.D.	N.D.
VSP 20B	N.D.	N.D.	N.D.	N.D.	N.D.
VSP 21C	N.D.	N.D.	N.D.	N.D.	N.D.
Blank	N.D.	N.D.	N.D.	N.D.	N.D.
Spiked Recovery	85.1%	92.2%	94.9%	107.4%	109.9%
Detection limit	1.0	5.0	5.0	5.0	5.0
Method of Analysis	5030 / 8015	8020	8020	8020	8020

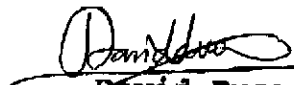
  
 David Duong  
 Laboratory Director



TANK PROTECT ENGINEERING

2021 WHIPPLE ROAD  
UNION CITY, CA 94587  
(415) 429-8088  
(900) 523-8088  
FAX (415) 429-8089

LAB: Priority

TURNAROUND: \_\_\_\_\_

P.O. #: 1125

CHAIN OF CUSTODY

PAGE 1 OF 2

PROJECT NO.		SITE NAME & ADDRESS				(1) TYPE OF CONTAINER	ANALYTES REQUESTED							PEL # 9510011 INV # 26396				
267-100895		Creditworth Auto Sales 2345 E 14th Street					TOTAL LIGHT HC	AROMATIC HC	TOTAL HEAVY HC	OIL & GREASE	PC-COM (621'0)	OTHER						
SAMPLER NAME, ADDRESS AND TELEPHONE NUMBER						ID NO.	DATE	TIME	SOIL	WATER	SAMPLING LOCATION							
Lee Huckins 2021 WHIPPLE ROAD, UNION CITY, CA 94587 (415) 429-8088																		
VSP1A	10/3	1030	X		1.5-2.0	Brass	X	X										
VSP12B	10/3	1057	X		2.0-2.5	Brass	X	X										
VSP13C	10/3	1044	X		3.0-3.5	Brass	X	X										
VSP14D	10/3	1049	X		1.5-2.0	Brass	X	X										
VSP15A	10/3	1051	X		2.0-2.5	Brass	X	X										
VSP16B	10/3	1055	X		3.0-3.5	Brass	X	X										
VSP17C	10/3	1053	X		1.5-2.0	Brass	X	X										
VSP18D	10/3	1057	X		2.0-2.5	Brass	X	X										
VSP19A	10/3	1058	X		3.0-3.5	Brass	X	X										
Relinquished by: (Signature)		Date / Time		Received by: (Signature)		Relinquished by: (Signature)		Date / Time		Received by: (Signature)								
<i>Lee Huckins</i>		10/10/1995		<i>[Signature]</i>														
Relinquished by: (Signature)		Date / Time		Received by: (Signature)		Relinquished by: (Signature)		Date / Time		Received by: (Signature)								
				<i>THANH LAN</i>														
Relinquished by: (Signature)		Date / Time		Received for Laboratory by: (Signature)		Date / Time		Remarks										
		10/10/1995		<i>PEL</i>														

DATE: \_\_\_\_\_



# TANK PROTECT ENGINEERING

2021 WHIPPLE ROAD  
UNION CITY, CA 94587  
(415) 429-8089  
(800) 529-8089  
FAX (415) 429-8089

LAB: Priority

TURNAROUND: \_\_\_\_\_

P.O. #: 1125

## CHAIN OF CUSTODY

PAGE 2 OF 2

PROJECT NO. <b>267100395</b>		SITE NAME & ADDRESS <b>Creditworth Auto Sales 2345 E 14th St</b>					(1) TYPE OF CONTAINER	ANALYTES REQUESTED						REMARKS
SAMPLER NAME, ADDRESS AND TELEPHONE NUMBER <b>Lee Hutchins 2021 WHIPPLE ROAD, UNION CITY, CA 94587 (415) 429-8089</b>								TOTAL LIGHT HC	AROMATIC HC	TOTAL HEAVY HC	OIL & GREASE	PCC SCAN (GPA's)	OTHER	
ID NO.	DATE	TIME	SOIL	WATER	SAMPLING LOCATION									
VSP20B	10/3	1102	X		<del>15-20</del>	Brass	X	X						
VSP21C	10/3	1100	X		20-25	Brass	X	X						
Relinquished by: (Signature) <i>Lee Hutchins</i>		Date / Time 10/4/95 / 14:15		Received by: (Signature) <i>[Signature]</i>		Relinquished by: (Signature)		Date / Time		Received by: (Signature)				
Relinquished by: (Signature)		Date / Time		Received by: (Signature) <i>THOMAS LAM</i>		Relinquished by: (Signature)		Date / Time		Received by: (Signature)				
Relinquished by: (Signature)		Date / Time 10/4/95 / 14:15		Received for Laboratory by: (Signature) <i>PEL</i>		Date / Time		Remarks						

DATE: \_\_\_\_\_

PAGE 05  
TANK PROTECT ENG  
510429800  
10/10/1995 08:52