

ASSESSOR'S MAP 49

Code Area Nos. 14-004, 17-046

619

SCALE: 1" = 200'

TR. 6368 209/27

REVISED: 10-31-84 BY  
04-29-84 EC  
02-02-05 LL

DRAWN: 10-06-93 JJ

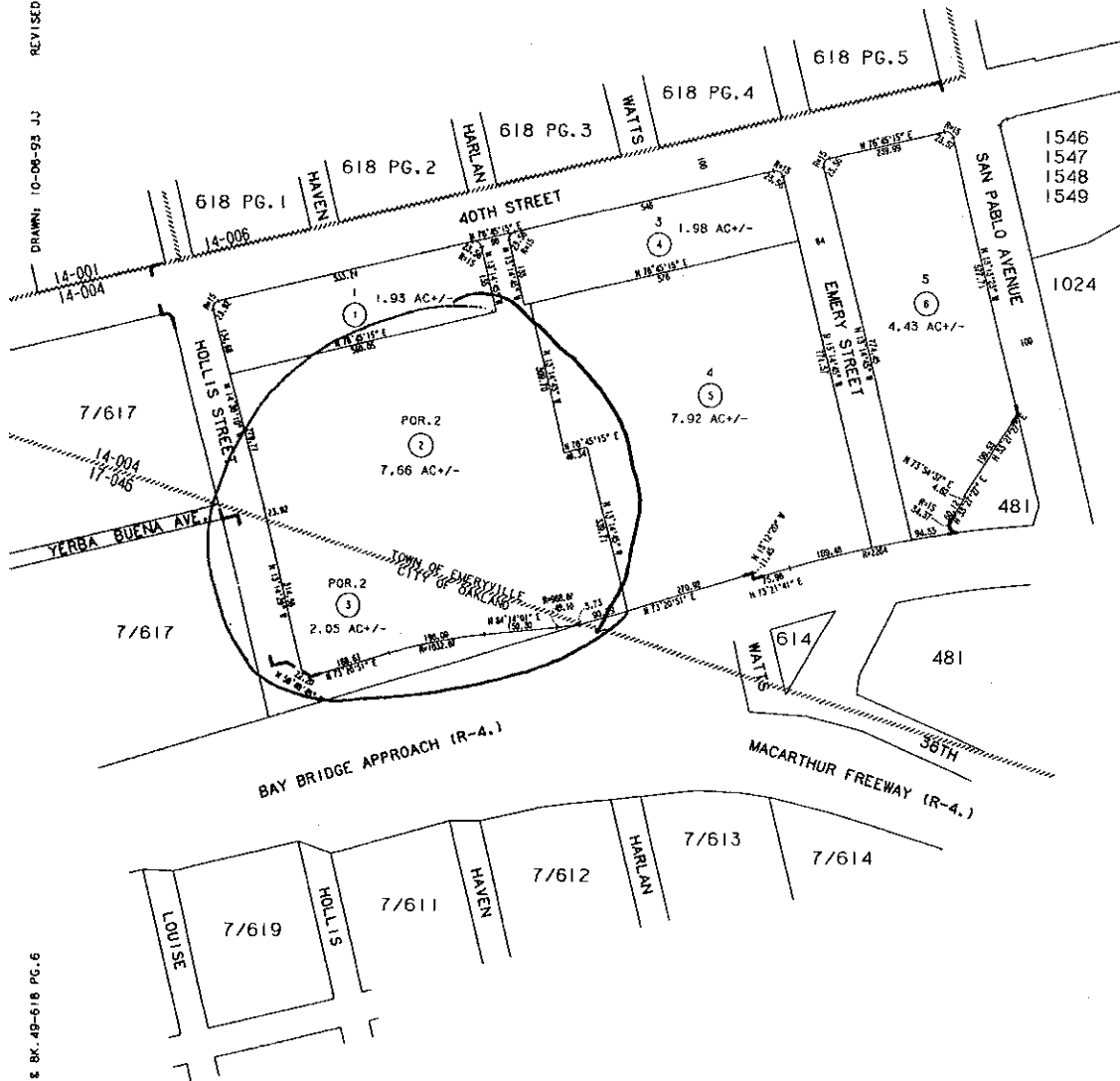

FORMERLY: BK. 7-517 PG. 1 & BK. 49-518 PG. 6

ACM: .

REF: .

HPN: 6

IND PG: 3



COUNTY OF ALAMEDA  
**Assessor's Office**  
**Property Value System**

[Help](#)

[New Query](#)

[History](#) | [Value](#) | [Transfer](#) | [Map](#) | [Glossary](#)

Parcel Number: **49-619-2**    Inactive: **N**    Lien Date: **01/01/2008**    Owner: **CATELLUS FINANCE 1 LLC**

Property Address: **3838 HOLLIS ST # LOT2, EMERYVILLE, CA 94608-3545**

Current Mailing Address as of 07/07/2008: **CATELLUS FINANCE 1 LLC, c/o THOMSON PRTY TAX SERVICES, 2235 FARADAY AVE STE O, CARLSBAD, CA 92008**

Economic Unit

Mailing Name	Historical Mailing Address	Document Date	Document Number	Value From Trans Tax	Parcel Count	Use
CATELLUS FINANCE 1 LLC c/o DELOITTE TAX LP Attn: RAYMOND	List Owners 2235 FARADAY AVE STE O, CARLSBAD, CA 92008	09/15/2005	TRAN-249546	81	3500	
CATELLUS FINANCE 1 LLC c/o PROPERTY TAXATION	List Owners 201 MISSION ST # 340, SAN FRANCISCO, CA 94105-1831	10/28/1998	1998-379429	3	3500	
CATELLUS DEVELOPMENT CORPORATION c/o CB COMM REAL EST GRP	List Owners 275 BATTERY ST , SAN FRANCISCO, CA 94111-3305	07/01/1994	TRAN-60982	1	3500	
CATELLUS DEVELOPMENT CORPORATION	List Owners 201 MISSION ST , SAN FRANCISCO, CA 94105-1831	08/21/1990	1990-225850	224	3500	

All information on this site is to be assumed accurate for property assessment purposes only, and is based upon the Assessor's knowledge of each property. Caution is advised for use other than its intended purpose.

The Alameda County Intranet site is best viewed in Internet Explorer Version 5.5 or later.  
[Click here](#) for more information regarding supported browsers.

Copyright © 2001 Alameda County

[Help](#)

[New Query](#)



COUNTY OF ALAMEDA  
**Assessor's Office**  
**Property Value System**

[History](#)

[Value](#)

[Transfer](#)

[Map](#)

[Glossary](#)

Parcel Number: **49-619-3** Inactive: **N** Lien Date: **01/01/2008** Owner: **CATELLUS FINANCE 1 LLC**

Property Address: **3838 HOLLIS ST # LOT2, OAKLAND, CA 94608-3545**  
 Current Mailing Address as of 07/07/2008: **CATELLUS FINANCE 1 LLC, c/o THOMSON PRTY TAX SERVICES, 2235 FARADAY AVE STE O, CARLSBAD, CA 92008**  
[Economic Unit](#) | [Parcel History](#)

Mailing Name	Historical Mailing Address	Document Date	Document Number	Value From Trans	Parcel Count	Use Tax
CATELLUS FINANCE 1 LLC c/o DELOITTE TAX LP Attn: RAYMOND	List Owners 2235 FARADAY AVE STE O, CARLSBAD, CA 92008	09/15/2005	TRAN-249546	81	3500	
CATELLUS FINANCE 1 LLC c/o PROPERTY TAXATION	List Owners 201 MISSION ST # 340, SAN FRANCISCO, CA 94105-1831	10/28/1998	1998-379429	3	3500	
CATELLUS DEVELOPMENT CORPORATION c/o CB COMM REAL EST GRP	List Owners 275 BATTERY ST , SAN FRANCISCO, CA 94111-3305	07/01/1994	TRAN-60983	1	3500	
CATELLUS DEVELOPMENT CORPORATION	List Owners 201 MISSION ST , SAN FRANCISCO, CA 94105-1831	08/21/1990	1990-225850	224	3500	

All information on this site is to be assumed accurate for property assessment purposes only, and is based upon the Assessor's knowledge of each property. Caution is advised for use other than its intended purpose.

The Alameda County Intranet site is best viewed in Internet Explorer Version 5.5 or later.  
[Click here](#) for more information regarding supported browsers.

Copyright © 2001 Alameda County