

June 20, 2001

JUN 22 2001

Mr. Barney M. Chan
Hazardous Materials Specialist
Alameda County Health Care Services
Environmental Health Services
Environmental Protection (LOP)
1131 Harbor Bay Parkway, Suite 250
Alameda, CA 94502-6577

Ro 319

**RE: ADDENDUM TO QUARTERLY MONITORING REPORT
FORMER WESTERN STUCCO PRODUCTS
5115 EAST EIGHTH STREET, OAKLAND, CALIFORNIA
EBA Project No. 00-805 (31)**

Dear Mr. Chan:

As we discussed in our telephone conversation on this date, I am submitting this addendum to the June 6, 2001 Quarterly Monitoring Report for the above mentioned site. Please find attached the potentiometric surface map developed from water level measurements recorded during the May 3, 2001 sampling event. This map indicates a groundwater flow direction ranging from approximately N 35° W to N 86° E, with a gradient of 0.06 to 0.03 feet/feet respectively.

Potentiometric surface maps showing groundwater flow direction and gradient will be submitted for all subsequent monitoring events. Please call (707) 544-0784 if you have any further questions regarding this sampling event.

Sincerely,



Erik Phenix
Environmental Technician

Attach: Figure 2: Potentiometric Surface Map, May 3, 2001

cc: Mr. Lewis Winchell, Sacramento Stucco
Mr. Al Avendano, 3228 Hyde Street, Oakland, CA 94601
SFB-RWQCB

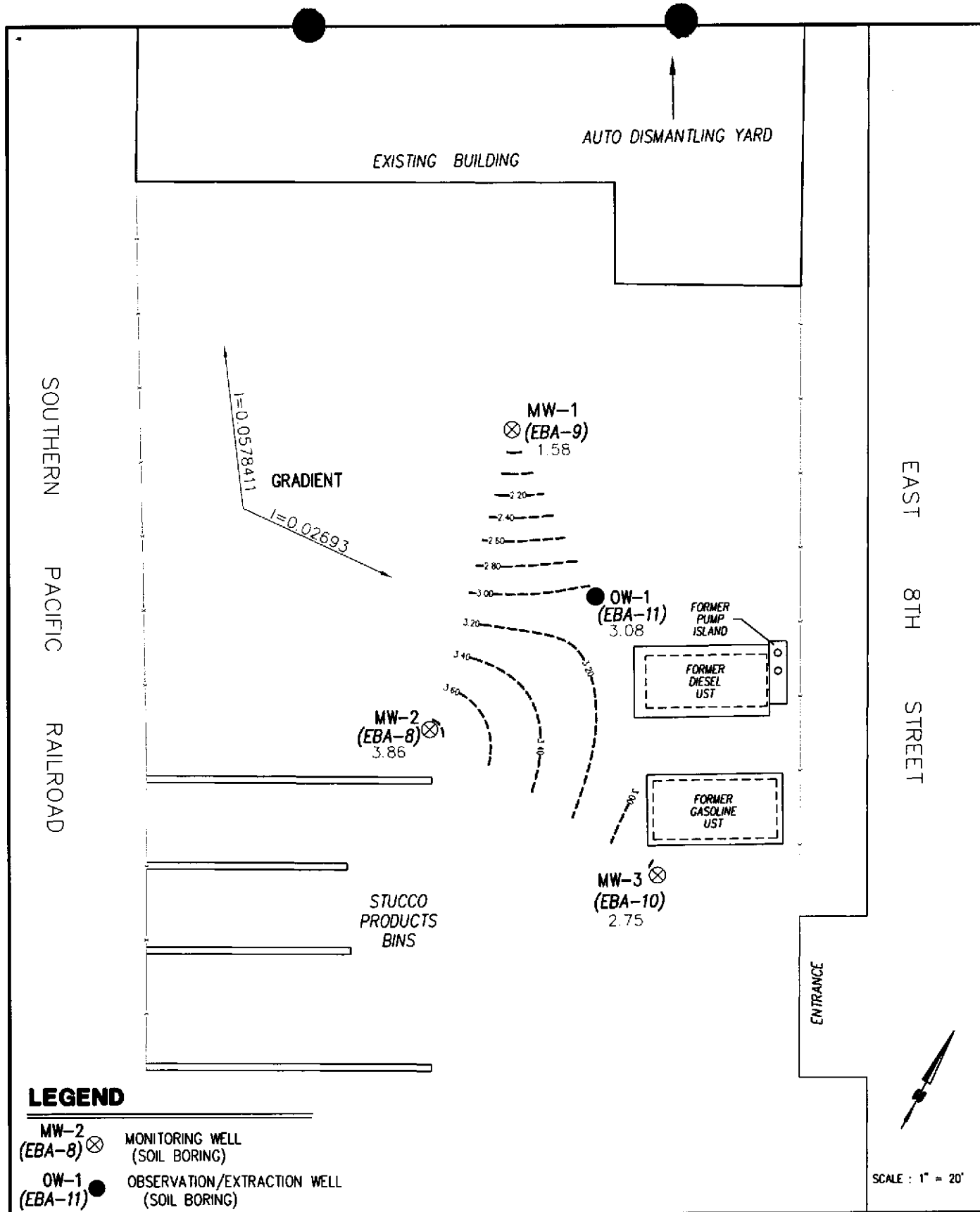

LEGEND

- MW-2 (EBA-8) ⊗ MONITORING WELL (SOIL BORING)
- OW-1 (EBA-11) ● OBSERVATION/EXTRACTION WELL (SOIL BORING)

SCALE : 1" = 20'



FORMER WESTERN STUCCO PRODUCTS
 5115 EAST 8TH STREET
 OAKLAND, CALIFORNIA
POTENTIOMETRIC SURFACE MAP
MAY 3, 2001

FIGURE
2
 MAY 2001
 Q:\00-805
 SURVEY.DWG