

February 25, 2005

Mr. Robert Shultz
Hazardous Materials Specialist
Alameda County Environmental Health
1131 Harbor Bay Parkway, Suite 250
Alameda, CA 94502-6577

**Re: First Quarter 2005 Status Report
Former BP Service Station #11266
1541 Park Street
Alameda, California
URS Project # 38487150**

Dear Mr. Shultz:

On behalf of Atlantic Richfield Company (RM), a BP affiliated company, URS Corporation (URS) is submitting the *First Quarter 2005 Status Report* for the Former BP Service Station #11266, located at 1541 Park Street, Alameda, California. URS originally submitted a Request for Site Closure Report to ACEH on February 21, 2003. To date, URS has not received a response to our request for case closure as a low risk groundwater site.

If you have any questions regarding this submission, please call me at (510) 874-1758.

Sincerely,

URS CORPORATION



Lynelle Onishi
Project Manager

Enclosure: First Quarter 2005 Status Report

cc: Mr. Kyle Christie, RM, (electronic copy uploaded to ENFOS)
Mr. Chris Jimmerson, Delta Environmental Consultants, 3146 Gold Camp Dr. Suite 200, Rancho Cordova, CA 95670-6021, (electronic copy uploaded to ENFOS)

Date: February 25, 2005

Quarter: 1Q 05

RM FIRST QUARTER 2005 STATUS REPORT

Former Facility No.: 11266 Address: 1541 Park Street, Oakland, CA
RM Environmental Business Manager: Kyle Christie
Consulting Co./Contact Person: URS Corporation / Lynelle Onishi
Consultant Project No.: 38487150
Primary Agency: Alameda County Environmental Health (ACEH)

WORK PERFORMED THIS QUARTER (First – 2005):

1. No environmental activities will take place during this quarter.
2. Prepared and submitted first quarter 2005 status report.

WORK PROPOSED FOR NEXT QUARTER (Second – 2005):

1. No environmental work is scheduled for second quarter 2005.
2. Prepare and submit second quarter 2005 status report.

Current Phase of Project: GW monitoring/sampling
Frequency of Groundwater Sampling: No Ongoing Sampling
Frequency of Groundwater Monitoring: No Ongoing Monitoring

DISCUSSION:

On February 21, 2003, URS submitted a request for case closure as a low risk groundwater site. At the time of this status report, URS has not received a response regarding this request. No groundwater monitoring activities are scheduled for this site.

R0318

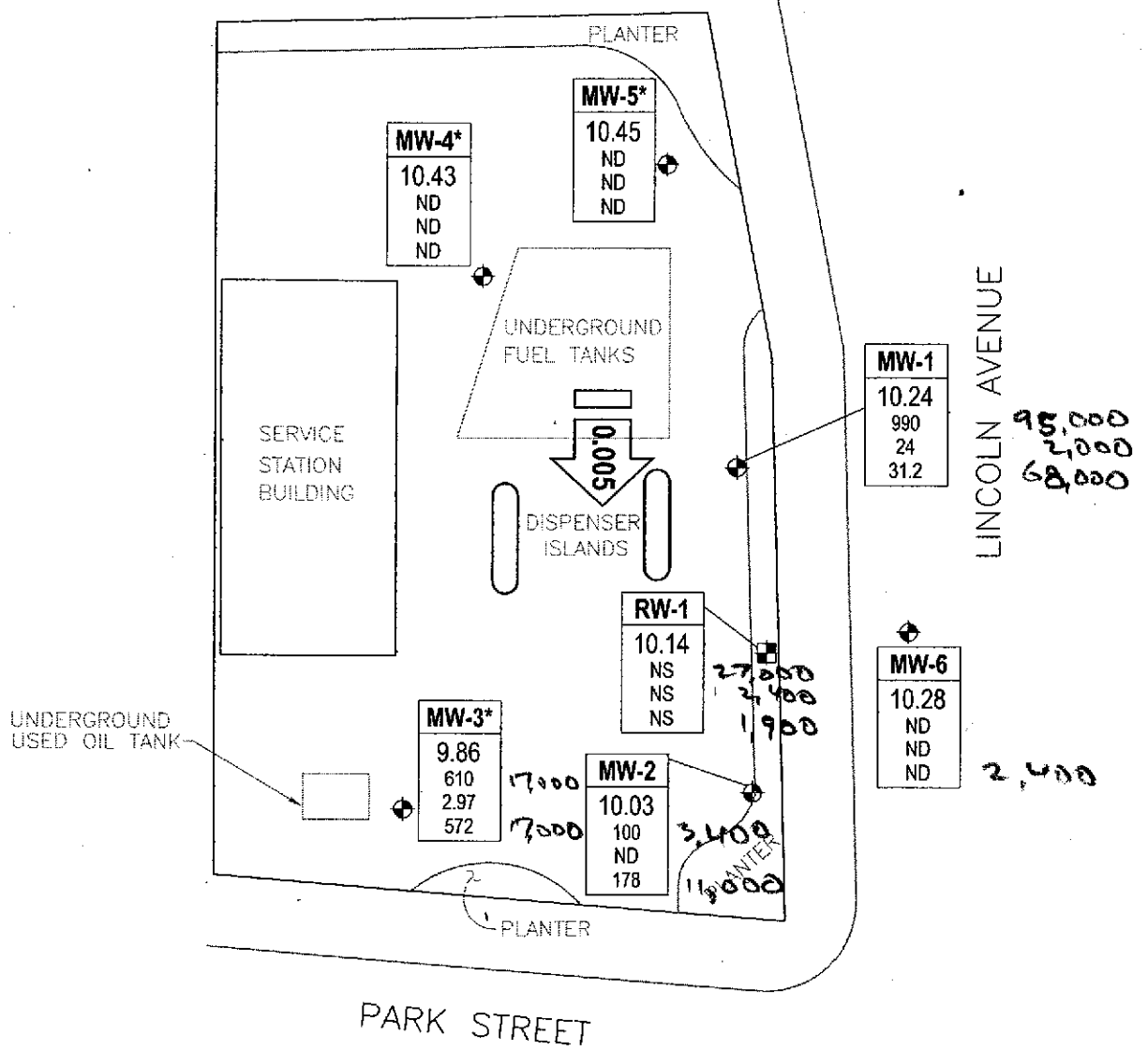

LEGEND

- GROUNDWATER MONITORING WELL
- GROUNDWATER RECOVERY WELL
- Well** — WELL DESIGNATION
- ELEV** — GROUNDWATER ELEVATION (FT/MSL)
- TPH-g** — TPH-g, BENZENE AND MTBE CONCENTRATIONS (µg/L)
- Benzene**
- MTBE**
- NS — NOT SAMPLED
- * — NOT SAMPLED ON 9/18/01
MOST RECENT DATA USED (3/21/02)
- APPROXIMATE GROUNDWATER FLOW DIRECTION AND GRADIENT (SOURCE: RRM, 9/18/01)

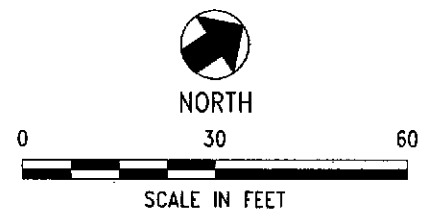

X:\x_env\waste\BP_GEM\Sites\PMH_Sites\BP_Heritage\11266\Reports\Monitoring\Dir_3_2001\12_CPHCGW_9-18.dwg

URS	Project No. 38485933	GROUNDWATER ELEVATIONS AND CONCENTRATIONS OF PETROLEUM HYDROCARBONS IN GROUNDWATER Third Quarter 2001 (September 18, 2001)	FIGURE 2
	Former BP Service Station #11266 1541 Park Street Alameda, California		