

**HYDRO
ENVIRONMENTAL
TECHNOLOGIES, INC.**

2394 Mariner Square Drive, Suite 2
Alameda, California 94501
Tel 510-521-2684
Fax 510-521-5078

Massachusetts
New York
Maryland

August 23, 1997

7-285.2

Ms. Madhulla Logan
Mr. Larry Seto
Alameda County Health Care Services Agency
Environmental Protection
Department of Environmental Health Services
1131 Harbor Bay Parkway, Second Floor
Alameda, CA 94502

Re: 2415 Mariner Square Drive, Alameda
Storm drain data, Location Maps for Proposed Hotel

Dear Ms. Logan and Mr. Seto

Hydro-Environmental Technologies, Inc. (HETI) is providing the attached figures of Mariner Square for your review. Both of these figures were generated by Mr. Beery of Mariner Square Associates.

The larger figure shows the location and depths of the catch basins and offsite discharge points. Except for storm drain along the south side of the parcel, the catch basins and associated piping are shallower than the ground water level.

The two smaller figures show the proposed configuration for the proposed hotel on the separate parcel. Two examples are shown with the outline of proposal parcel division outlined in yellow. Both examples do not impact any existing ground water monitoring well.

After review, Mr. Beery has requested a meeting to discuss any issues associated with the new configuration. The western building proposed for the remaining will be for dry boat storage and will impact two monitoring wells.

Please call me at (510) 521-2684, if you have any questions.

Sincerely,

HYDRO-ENVIRONMENTAL TECHNOLOGIES, INC.

Gary Pischke, C.E.G.
Senior Geologist

cc Mr. John Beery

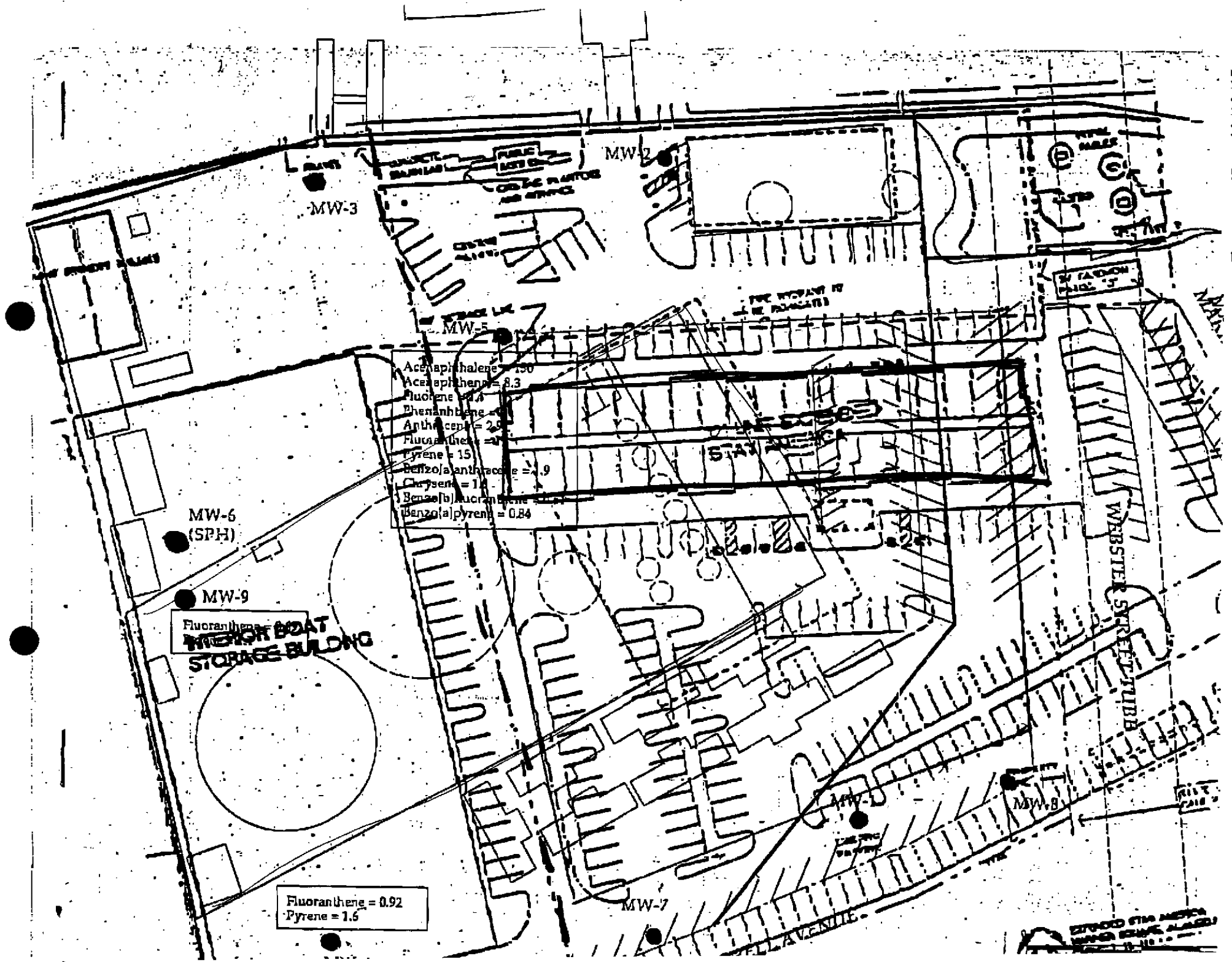

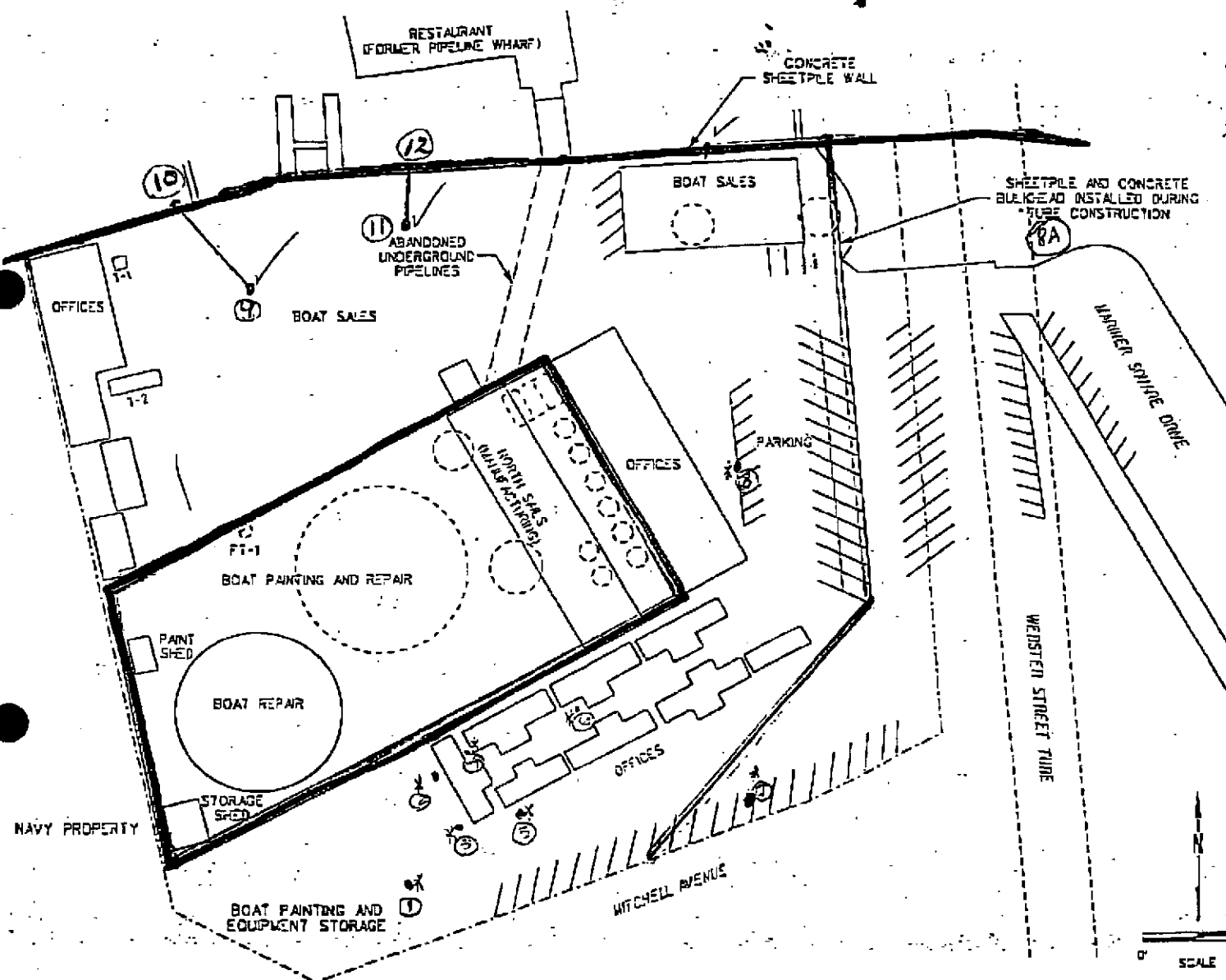

STORM DRAINS

DEPTH:

- 1: 30 Inches
- 2: 25 Inches
- 3: 24 Inches
- 4: 26 Inches
- 4A: 24 Inches
- 5: 12 Inches
- 6: 18 Inches
- 7: 60 Inches
- 8: 10 Inches
- 8A: 16 Inches
- 9: 42 Inches
- 10: 54 Inches
- 11: 32 Inches
- 12: 51 Inches

CONTAINMENT WALLS:

- RED: 10 Feet
- BLUE: 40 Feet
- GREEN: 40 Feet

original
11x17