

ASSESSOR'S MAP 97

Cover Area Nos. 16-001

50

Scale: 1" = 100'

MAP OF SOUTHERN ADDITION OF TOWN OF LIVERMORE (1882) (Bk. 7 Pg. 55)

Dr. 4-5-62 A.Y.

Corrected: 5-8-73 MP
10-12-88 VT

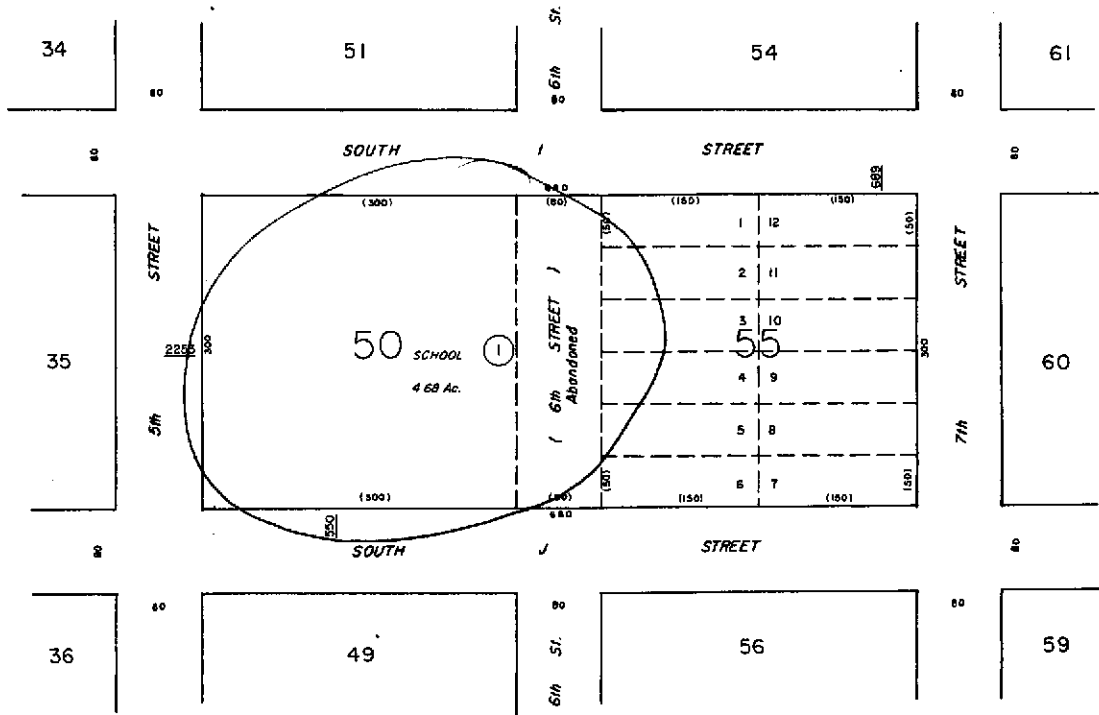

Property Detail**Alameda, CA RON THOMSEN, ASSESSOR**

Parcel # (APN): 097 -0050-001-00

Use Description:

Parcel Status:

Owner Name: LIVERMORE VALLEY JOINT UNIFIED SCHOOL DISTRICT

Mailing Address: 685 E J L B LIVERMORE CA 94551-1855

Situs Address: 2253 5TH ST LIVERMORE CA 94550

Legal

Description:

ASSESSMENT

Total Value:	Use Code: 030	Zoning:
Land Value:	Tax Rate Area: 16001	
Impr Value:	Year Assd: 2003	Improve Type:
Other Value:	Property Tax:	Price/SqFt:
% Improved	Delinquent Yr	
Exempt Amt:	HO Exempt?: N	

SALES HISTORY

	<u>Sale 1</u>	<u>Sale 2</u>	<u>Sale 3</u>	<u>Transfer</u>
Recording Date:				
Recorded Doc #:				
Recorded Doc Type:				
Transfer Amount:				
Sale 1 Seller (Grantor):				
1st Trst Dd Amt:	Code1:	2nd Trst Dd Amt:	Code2:	

PROPERTY CHARACTERISTICS

Lot Acres: 4.680	Year Built:	Fireplace:
Lot SqFt: 204,000	Effective Yr:	A/C:
Bldg/Liv Area:		Heating:
Units:	Total Rooms:	Pool:
Buildings:	Bedrooms:	
Stories:	Baths (Full):	Park Type:
Style:	Baths (Half):	Spaces:
Construct:		Site Inforce:
Quality:	Garage SqFt:	
Building Class:		Timber Preserve:
Condition:		Ag Preserve:
Other Rooms:		



COUNTY OF ALAMEDA
Assessor's Office

Property Value System

History

Value

Transfer

[New Query](#)

Parcel Number: 97-50-1 Lien Date: 01/01/2006 Owner: LIVERMORE VALLEY JOINT UNIFIED SCHOOL

DISTRICT

Property Address: 2253 5TH ST , LIVERMORE, CA 94550-4549

Mailing Name	Mailing Address	Document Date	Document Number	Value From Trans Tax	Parcel Count	Use
LIVERMORE VALLEY JOINT UNIFIED SCHOOL DISTRICT	685 E JACK LONDON BLVD , LIVERMORE, CA 94551-1855	03/01/1969	TRAN-142513		1	0300

All information on this site is to be assumed accurate for property assessment purposes only, and is based upon the Assessor's knowledge of each property. Caution is advised for use other than its intended purpose.

The Alameda County Intranet site is best viewed in Internet Explorer Version 5.5 or later.
 Click [here](#) for more information regarding supported browsers.

Copyright © 2001 Alameda County