

8" CONC. BLOCK REAR WALL, DESIGNED BY STEEL BLDG FABRICATOR, ERECTED BY GEN. CONTRACTOR. REAR SASH PER 52A STEEL BLDG. WALL TO BE 12'-0" ± ABOVE SALES RM. FL. ELEV.

NOTE: S-20-B BLDG HAS 2'-4" OVERHANG HOLD THIS CORNER 1'-10" FROM R TO CLEAR. BELOW IS NOT TO SCALE

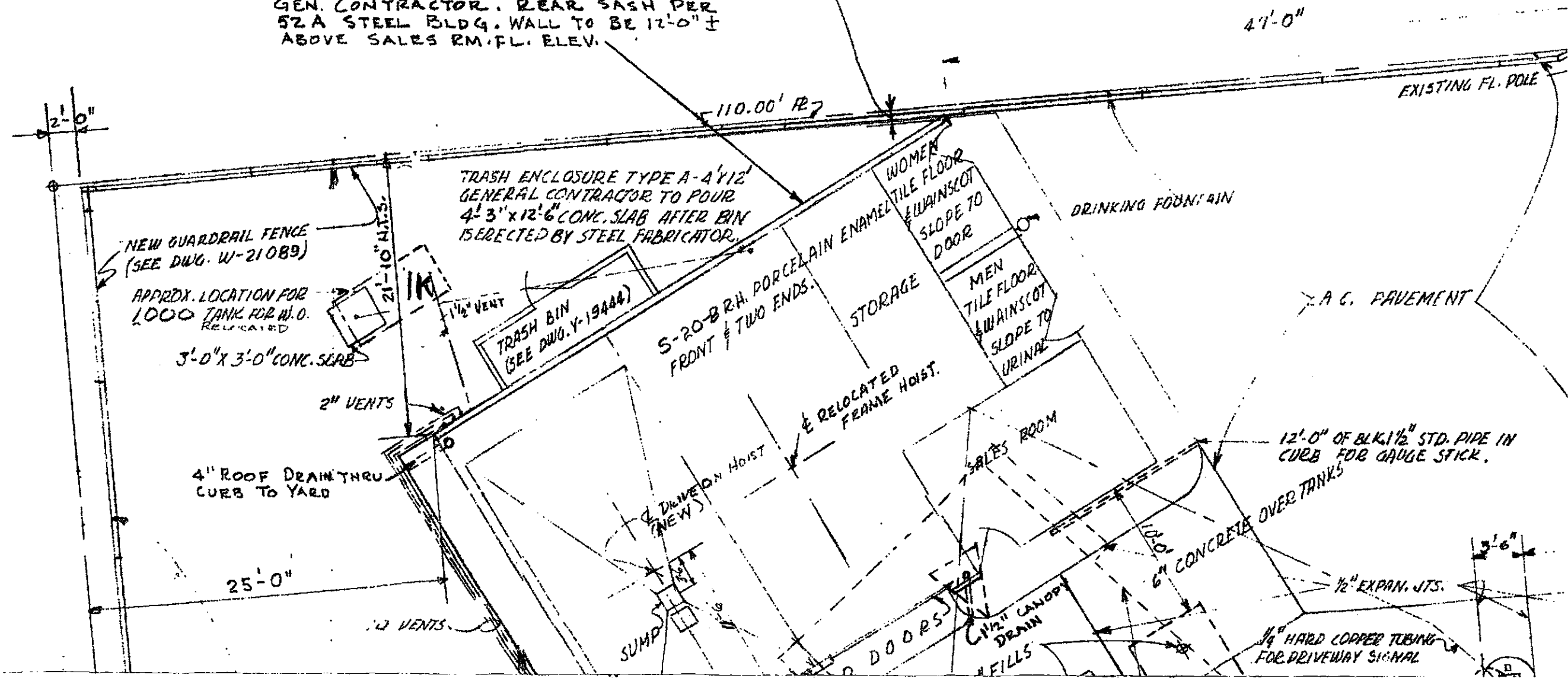

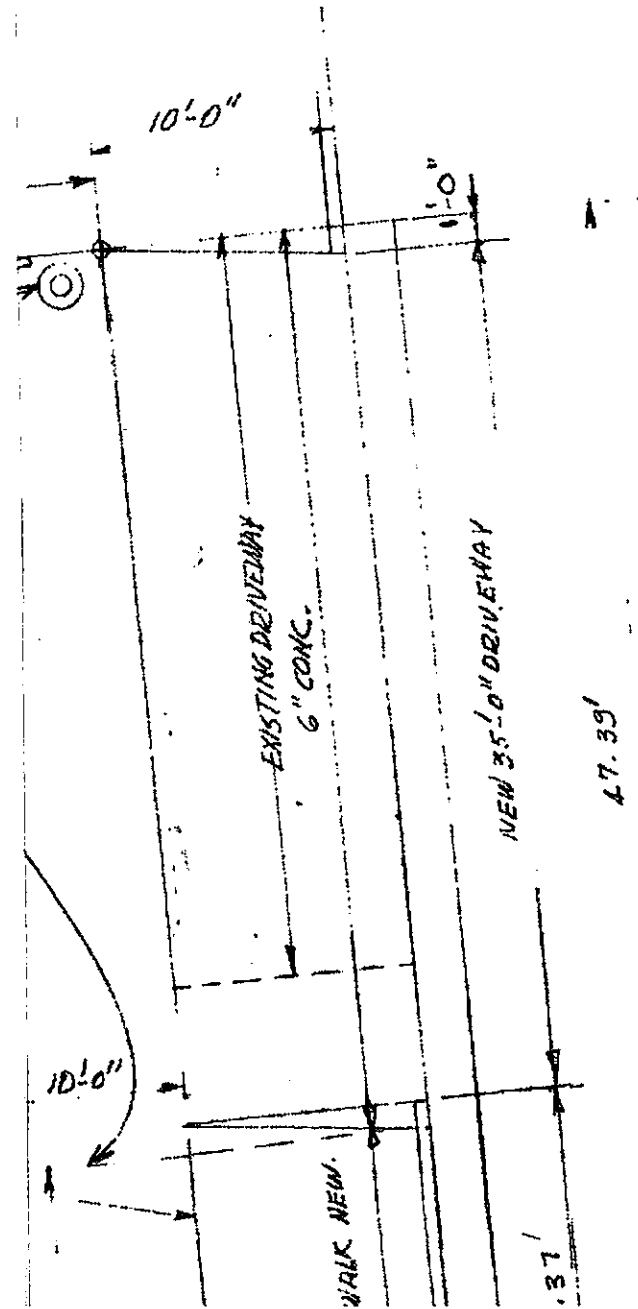

U
T
A
L
E
U

LIST OF DRAWINGS	
Y-28333	GRADING PLAN
D-13660	TYPICAL PLAN & ELEVATIONS <small>REF. SHEET</small>
D-13661	FOUNDATION PLAN - TYPICAL <small>REF. SHEET</small>
D-13684	MISC. INT. & EXT. DETAILS
Y-19728	WIRING DIAGRAM
D-12497	OVERHEAD DOOR
D-13651	ARRANGEMENT OF EQUIPMENT
W-16599	TYPICAL AIR, WATER & SEWER
W-21089	GUARDRAIL FENCE
Y-15272	5'-0" WORK BENCH
Y-15308	STOREROOM SHELVING
Y-21026	SALESROOM SHELVING & DESK
Y-19444	TRASH DISPOSAL BIN
W-21033	SELECTIVE MANIFOLD
U-19346	STEEL PIPE TIRE RACK
W-28304	PUMP ISLANDS
U-19329	YARD DETAILS
W-10510	COMPRESSOR
V-28316	UNDERGROUND TANKS
V-11675	POSTER FRAME
U-10940	HOLDER FOR F. COVER
U-15425	AIR, WATER & HOIST
U-15439	OIL TRAP & WASTE OIL
U-15370	WASTE OIL
W-28181	CASH BOX STANCHION
D-14865	FLOOR & FOUNDATION PLAN
D-14864	ELEV. WALL SECTIONS
D-14863	DETAILS OF PYLON
A-14852	PYLON LIGHTING

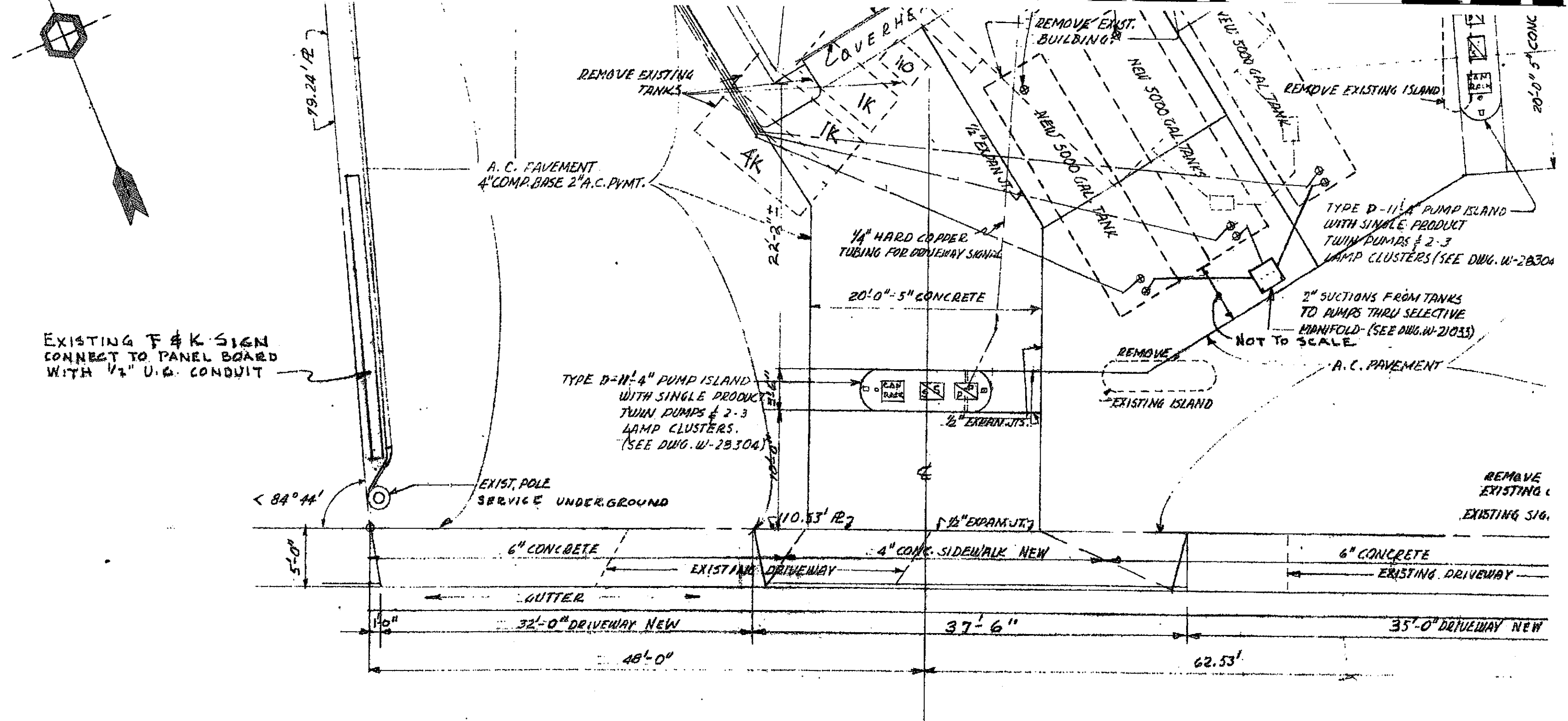

EXISTING F & K SIGN
CONNECT TO PANEL BOARD
WITH 1/2" U.G. CONDUIT

A.C. PAVEMENT
4" COMP. BASE 2" A.C. PVMT.

TYPE D-11 4" PUMP ISLAND
WITH SINGLE PRODUCT
TWIN PUMPS & 2-3
LAMP CLUSTERS.
(SEE DWG. W-28304)

TYPE D-11 4" PUMP ISLAND
WITH SINGLE PRODUCT
TWIN PUMPS & 2-3
LAMP CLUSTERS (SEE DWG. W-28304)

2" SUCTIONS FROM TANKS
TO PUMPS THRU SELECTIVE
MANIFOLD (SEE DWG. W-21033)

1/4" HARD COPPER
TUBING FOR DRIVEWAY SIGNING

20'-0" x 5" CONCRETE

REMOVE
EXISTING ISLAND

A.C. PAVEMENT

EXIST. POLE
SERVICE UNDERGROUND

REMOVE
EXISTING
EXISTING SIGN

6" CONCRETE

4" CONG. SIDEWALK NEW

6" CONCRETE

EXISTING DRIVEWAY

EXISTING DRIVEWAY

32'-0" DRIVEWAY NEW

37'-6"

35'-0" DRIVEWAY NEW

48'-0"

62.53'

F O O T H I L L

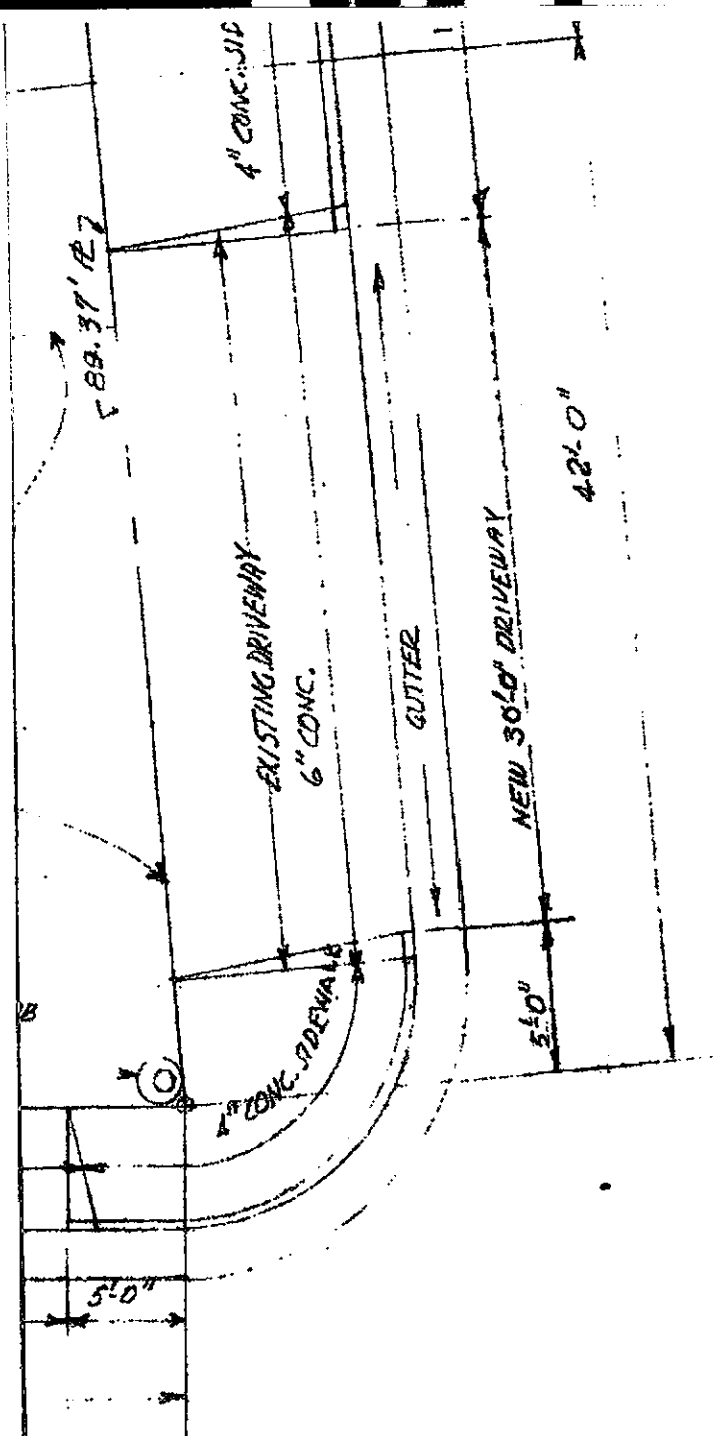

I
A

U

R

F

B

L

V

D

NOTE:
GENERAL CONTRACTOR TO BREAK UP
LOOSE FROM ITS FOUNDATION AND REMOVE ALL
MUD & RIGGERS SO THAT IT IS OPEN TO
BE REMOVED BY A STEEL FABRICATOR.
EXISTING FACILITIES ARE TO BE KEPT IN
OPERATION FOR AS LONG AS POSSIBLE
WITH A MINIMUM SHUTDOWN FOR CHANGE OVER.
ALL FUEL OIL, AIR & WATER PIPING TO BE
REMOVED.

EXISTING PUMPS, AIR COMPRESSOR, B-30 GAL
HYDRANT, 2-1000 GAL TANKS, 1 4000 GAL
TANK & 1 110 GAL TANK & OTHER EQUIPMENT
DEEMED SALVAGEABLE BY SHELL OIL COMPANY
TO BE REMOVED & RETURNED TO SHELL
OIL CO. AT 215 DERBY, OAKLAND.
GENERAL CONTRACTOR TO INSTALL
TEMPORARY HOIST PROVIDED BY SHELL
OIL CO.

Alameda County
Environmental Health
SEP 26 2002

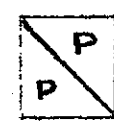

= SINGLE PRODUCT TWIN PREMIUM PUMP



= SINGLE PRODUCT TWIN SHELL PUMP.

MARK	DATE	DESCRIPTION	APPROVAL
(L)	7-1-57		

LIST OF CHANGES

SHELL OIL COMPANY
SAN FRANCISCO DIVISION

PLOT PLAN
MODERNIZATION OF S. S. L-530
FOOTHILL BOULEVARD & FRUITVALE AVE.
OAKLAND CALIFORNIA

SCALE: 1/8" = 1'-0"	APPROVED
DATE: 7-10-57	Y-28332
DRAWN BY: J. C. TRD BY:	
CHECKED BY:	

CHECKED AGAINST BOARD LAYOUT
BY: *Completed before check*