

ALAMEDA COUNTY  
HEALTH CARE SERVICES



AGENCY  
DAVID J. KEARS, Agency Director

ENVIRONMENTAL HEALTH SERVICES  
ENVIRONMENTAL PROTECTION  
1131 Harbor Bay Parkway, Suite 250  
Alameda, CA 94502-6577  
(510) 567-6700  
FAX (510) 337-9335

April 14, 2006

Denis Brown  
Shell Oil Products US  
20945 S. Wilmington Ave.  
Carson, CA 90810-1039

Fidel Casillas  
2910 East 16<sup>th</sup> Street  
Oakland, CA 94601

Subject: Fuel Leak Case No. [REDACTED], Shell, 2001 Fruitvale Avenue, Oakland, CA

Dear Mr. Brown and Mr. Casillas:

Alameda County Environmental Health (ACEH) and California Regional Water Quality Control Board staff have reviewed the fuel leak case file and case closure summary for the above-referenced site and concur that no further action related to the underground storage tank fuel release is required at this time. Prior to issuance of a remedial action completion certificate, the monitoring wells at the site are to be properly destroyed, should the monitoring wells have no further use at the site. Please decommission the monitoring wells and provide documentation of the well decommissioning to this office. A remedial action completion certificate will be issued following receipt of the documentation.

Well destruction permits may be obtained from the Alameda County Public Works Agency (<http://www.acgov.org/pwa/wells/index.shtml>). If you have any questions, please call me at (510) 567-6791.

Sincerely,

Jerry Wickham  
Hazardous Materials Specialist

Enclosure: ACEH Electronic Report Upload (ftp) Instructions

cc: Ana Friel, Cambria Environmental Technology, Inc., 270 Perkins Street, Sonoma, CA 95476

Donna Drogos, ACEH  
Jerry Wickham, ACEH

File

ALAMEDA COUNTY  
HEALTH CARE SERVICES

AGENCY  
DAVID J. KEARS, Agency Director



7

ENVIRONMENTAL HEALTH SERVICES  
ENVIRONMENTAL PROTECTION  
1131 Harbor Bay Parkway, Suite 250  
Alameda, CA 94502-6577  
(510) 567-6700  
FAX (510) 337-9335

February 8, 2006

Denis Brown  
Shell Oil Products US  
20945 S. Wilmington Ave.  
Carson, CA 90810-1039

Fidel Casillas  
2910 East 16<sup>th</sup> Street  
Oakland, CA 94601

Subject: Fuel Leak Case N [REDACTED], Shell, 2001 Fruitvale Avenue, Oakland, CA

Dear Mr. Brown and Mr. Casillas:

Alameda County Environmental Health (ACEH) staff has reviewed the case file for the above referenced site, including the reports entitled, "Groundwater Monitoring Report – Fourth Quarter 2005," dated December 27, 2005, and "Second Quarter 2004 Monitoring Report," dated June 25, 2004. Both reports were prepared on behalf of Shell by Cambria Environmental Technology, Inc. The June 25, 2004 "Second Quarter 2004 Monitoring Report" includes a request for case closure.

Continued groundwater monitoring is no longer required by ACEH for this site and may be discontinued while the site is further evaluated for case closure. No additional technical reports are required at this time unless directed by ACEH in future correspondence.

**AGENCY OVERSIGHT**

If it appears as though significant delays are occurring or reports are not submitted as requested, we will consider referring your case to the Regional Board or other appropriate agency, including the County District Attorney, for possible enforcement actions. California Health and Safety Code, Section 25299.76 authorizes enforcement including administrative action or monetary penalties of up to \$10,000 per day for each day of violation.

If you have any questions, please call me at (510) 567-6791.

Sincerely,

Jerry Wickham, P.G.  
Hazardous Materials Specialist

Denis Brown  
Fidel Casillas  
February 8, 2006  
Page 2

cc: Ana Friel  
Cambria Environmental Technology, Inc.  
270 Perkins Street  
Sonoma, CA 95476

Donna Drogos, ACEH  
Jerry Wickham, ACEH  
File

ALAMEDA COUNTY  
HEALTH CARE SERVICES

AGENCY  
DAVID J. KEARS, Agency Director



7-17-05  
out  
7-17-05

ENVIRONMENTAL HEALTH SERVICES  
ENVIRONMENTAL PROTECTION  
1131 Harbor Bay Parkway, Suite 250  
Alameda, CA 94502-6577  
(510) 567-6700  
FAX (510) 337-9335

July 13, 2005

Denis Brown  
Shell Oil Products US  
20945 S. Wilmington Ave.  
Carson, CA 90810-1039

Fidel Casillas  
2910 East 16<sup>th</sup> Street  
Oakland, CA 94601

Subject: Fuel Leak Case No. ~~FOUO 0005~~, Shell, 2001 Fruitvale Avenue, Oakland, CA – Reply to Request for Closure

Dear Mr. Brown and Mr. Casillas:

Alameda County Environmental Health (ACEH) staff has reviewed the case file and the reports entitled, "Groundwater Monitoring Report - First Quarter 2005," dated April 13, 2005 and "Second Quarter 2004 Monitoring Report," dated June 25, 2004, prepared on behalf of Shell by Cambria Environmental Technology, Inc. The June 25, 2004 "Second Quarter 2004 Monitoring Report" includes a recommendation for a reduction in groundwater monitoring frequency to annual sampling and a request for case closure. This site was also discussed during a meeting on June 8, 2005 in the ACEH offices between Denis Brown of Shell, Matt Derby, Ana Friel, and David Gibbs of Cambria Environmental Technology, Inc., and Donna Drogos and Jerry Wickham of ACEH.

Based on staff review of the case file and the documents referenced above, the case cannot be closed at this time. We request that you address the following technical comments, perform the proposed work, and send us the reports described below. Case closure may be considered in the future after the issues discussed in the technical comments below are addressed and the additional work requested below is performed.

**TECHNICAL COMMENTS**

1. **First Quarter 2005 Results for Well MW-2.** The concentration of total petroleum hydrocarbons as gasoline (TPHg) was consistently below 200 micrograms per liter ( $\mu\text{g/L}$ ) in groundwater samples collected from well MW-2 between May 1, 2003 and April 1, 2004. The concentration of TPHg in well MW-2 increased from 150  $\mu\text{g/L}$  during the April 1, 2004 sampling event to 1,600  $\mu\text{g/L}$  in the January 13, 2005 sampling event. ACEH is concerned with this ten-fold increase in TPHg concentrations. As described in comment 4 below, we request that two additional quarterly monitoring events be conducted to assess the increase in TPHg concentrations in well MW-2.
2. **Groundwater Flow Directions.** The hydraulic gradient observed at the site has varied significantly over time from west to northeast. Please include rose diagrams on all future

ALAMEDA COUNTY  
HEALTH CARE SERVICES

AGENCY

DAVID J. KEARS, Agency Director



December 20, 2002

Ms. Karen Petryna  
Shell Oil Products US  
P.O. Box 7869  
Burbank, CA 91501-7869

ENVIRONMENTAL HEALTH SERVICES  
ENVIRONMENTAL PROTECTION  
1131 Harbor Bay Parkway, Suite 250  
Alameda, CA 94502-6577  
(510) 567-6700  
FAX (510) 337-9335

Dear Ms. Petryna:

Subject: Fuel Leak Case ~~RC0000305~~, 2001 Fruitvale Ave., Oakland, CA 94601

Alameda County Environmental Health, Local Oversight Program (LOP), has reviewed the case file for the referenced site including the September 23, 2002 Agency Response, Closure Request, and Contingency Work Plan prepared by Cambria, your consultant. As you are aware, this report responds to items within my August 6, 2001 letter and again, requests agency recommendation for site closure. Upon review of this report, our office has the following technical comments:

- Our office agrees with the conclusion that the underground tanks, dispensers and piping previously "shown or proposed" in the 1957 Shell plot plan were likely installed and present at one time. Therefore, data characterizing these areas and any release from these areas is necessary for complete site assessment.
- The cross-sectional diagrams support the assumption that USTs were likely presence where assumed since fill material and sand and gravel appear in these locations. Clay is present down to about 20' bgs where groundwater is encountered in a sand and gravel lens. This lens would facilitate the migration of the TPH plume.
- The question of adequate UST and site characterization was addressed. An evaluation of human health and environmental risk must have representative sampling from an adequately characterized site. Cambria maintains that eight borings and a total of 29 soil samples (including samples from varying depths) adequately characterized the site. However, they note that normal sampling for the presumed USTs would have required 16 horizontally discrete soil samples. Please note, samples would also have been required beneath dispensers and along piping runs, therefore, considerably more samples would normally have been taken. Though samples were taken from within the UST areas, it is not certain that these represent the most impacted locations. Likewise, assumed gradient or one time gradient from temporary wells cannot be considered conclusive.
- Grab groundwater samples from SB-A, SB-B and SB-C indicate that the TPH plume is not defined within the property boundary.
- The relative lack of BTEX compounds is stated as showing evidence of natural attenuation. Cambria also states that it is not uncommon for fuel hydrocarbons to persist in soil and groundwater for extended periods in fine-grained soils. The highest TPHd concentration exhibited in water, 40,000 ppb in WSB2, potentially represents free product. As recommended by the Water Board, free product, to the extent possible, should be removed from the site.

Based upon these observations, our office requires that you implement the Contingency Work Plan provided. In addition, soil vapor sampling or some type of risk management would be recommended if site usage changes.

Ms. Karen Petryna  
December 20, 2002  
Fuel Leak Case RO0000305  
2001 Fruitvale Ave., Oakland, CA 94601  
Page 2.

Technical Response to Work Plan

- Please analyze the soil and groundwater sample from proposed well MW-1 for TPHd, TPHmo, SVOCs, VOCs by EPA Method 8260, inclusive of HVOCs, BTEX, MTBE and ether oxygenates and the lead scavengers, and the metals; cadmium, chromium, lead, nickel and zinc.

You may contact me at (510) 567-6765 if you have any questions.

Sincerely,



Barney M. Chan  
Hazardous Materials Specialist

✓ C: B. Chan, files

Mr. Matt Derby, Cambria Environmental, 1144 65<sup>th</sup> St., Suite B, Oakland, CA 94608  
Ms. Lotus Monroe, 11810 Alba Road, Ben Lomond, CA 95005  
Mr. and Mrs. Fidel Casillas, 2094 Harrington Ave., Oakland, CA 94601

2001FruitvaleAgencyResponse

ALAMEDA COUNTY  
HEALTH CARE SERVICES

AGENCY

DAVID J. KEARS, Agency Director



ENVIRONMENTAL HEALTH SERVICES

ENVIRONMENTAL PROTECTION  
1131 Harbor Bay Parkway, Suite 250  
Alameda, CA 94502-6577  
(510) 567-6700  
FAX (510) 337-9335

August 6, 2001  
SID 5806/ RO0000305

Ms. Karen Petryna  
Equiva Services LLC  
P.O. Box 7869  
Burbank, CA 91501-7869

**Re: Agency Response Letter, 2001 Fruitvale Ave., Oakland CA 94601**

Dear Ms. Petryna:

Our office has received and reviewed Cambria Environmental's July 13, 2001 Agency Response letter which responded to the County's June 22, 2001 letter. In our letter, you were notified that upon consultation with the San Francisco Regional Water Quality Control Board (SFRWQCB), our offices recommended the installation of permanent monitoring wells. Cambria's response letter disagreed with this need.

I have met with the SFRWQCB again to discuss Cambria's comment letter and the Water Board has the following comments and requests:

- Please provide summary tables for all soil and groundwater data.
- Please provide a to scale figure indicating the location of these samples and the assumed location of the former underground tanks, piping and dispensers.
- Please provide at least two cross-sectional diagrams (north-south, east-west) indicating soil concentrations and soil type.
- Examine the need to better characterize the site given the number and locations of the existing samples. Note how the number and location of samples compare to the number and location of samples normally taken during tank removals.
- Explain how an "old" petroleum release could exhibit the relatively high soil and groundwater concentrations reported. Is there still a source for the TPH being found?
- Evaluate the risk of TPHg, TPHd and TRPH using the SFRWQCB RBSLs.
- Is there enough data, particularly, shallow soil data to perform a HHRA? Is there any PNA data in soil?
- Please evaluate the need for a deed restriction if site closure were to be considered.

Contrary to Cambria's claim, our offices do not believe this site meets the conditions of a "low risk soil and groundwater case". Please provide the requested information and written comment to these items as soon as possible.

Ms. Karen Petryna  
2001 Fruitvale Ave., Oakland CA 94601  
StID 5806/ RO0000305  
August 6, 2001  
Page 2.

You may contact me at (510) 567-6765 if you have any questions.

Sincerely,

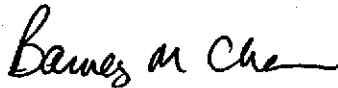

Barney M. Chan  
Hazardous Materials Specialist

C: B. Chan, files

Mr. Stephan Bork, Cambria Environmental, 1144 65<sup>th</sup> St., Suite B, Oakland CA 94608  
Ms. L. Monroe, 11810 Alba Rd., Ben Lomand, CA 95005  
✓ Mr. and Mrs. Casillas, 3094 Harrington Ave., Oakland CA 94601  
Mr. C. Headlee, SFRWQCB



CC:4580



ALAMEDA COUNTY  
**HEALTH CARE SERVICES AGENCY**  
Environmental Health Services Administration  
1131 Harbor Bay Parkway, Suite 250  
Alameda, CA 94502-6577



NO

Mr. and Mrs. Casillas  
3094 Harrington Ave.  
Oakland, CA 94601



# C A M B R I A

July 13, 2001

Barney Chan  
Alameda County Health Care Services Agency  
1131 Harbor Bay Parkway, Suite 250  
Alameda, CA 94502-6577

Re: **Agency Response**  
2001 Fruitvale Avenue  
Oakland, California  
Incident # 97109122  
Cambria Project # 243-1296

JUL 18 2001

Mr. Chan,

On behalf of Equiva Services LLC (Equiva), Cambria Environmental Technology Inc. (Cambria) is responding to your June 22, 2001 letter to Equiva regarding the referenced site.

You recently discussed the merits of site closure with the San Francisco Bay Regional Water Quality Control Board (SFBRWQCB). Your June 22 letter re-states the SFBRWQCB's opinion that "given the lack of information regarding the number and location of the former underground tanks, the lack of information regarding the tank removals, the presence of elevated Total Petroleum Hydrocarbons in soil and groundwater samples and the one-time only determination of groundwater gradient, permanent monitoring wells will be required at the site." Your letter also requests that wells be installed onsite near the locations where previous grab groundwater samples were collected.

We do not agree that the reasons given in your letter justify the need for groundwater monitoring. The first reason cites the "lack of information regarding the number and location of the former underground tanks." The two phases of assessment already performed at the site were based on the locations of fueling facilities shown on a Shell Oil Company plot plan. Soil and groundwater samples were collected in the locations of potential sources, which are expected to represent worst-case conditions of subsurface impact. If the Alameda County Health Care Services Agency (ACHCSA) has reason to believe other fuel-related facilities exist at the site, additional records research would be a more appropriate course of action than well installation.

Chain-of-title records indicate that Shell Oil Company leased the site on October 20, 1966 and quitclaimed the property on April 20, 1984. It is likely the fueling facilities were removed from the site prior to the quitclaim filing. At that time, it was not uncommon for tanks to be removed

Oakland, CA  
San Ramon, CA  
Sonoma, CA

**Cambria  
Environmental  
Technology, Inc.**

1144 65th Street  
Suite B  
Oakland, CA 94608  
Tel (510) 420-0700  
Fax (510) 420-9170





The request for additional assessment and monitoring at this site seems to counter the current policy of the SFBRWQCB which is to close low-risk hydrocarbon-only cases. In a memorandum dated January 5, 1996, the SFBRWQCB concurred with the findings and conclusions on the Lawrence Livermore National Laboratory's (LLNL) October 16, 1995 "*Recommendations to Improve the Cleanup Process for California's Leaking Underground Fuel Tanks.*" The LLNL found that "petroleum plumes tend to stabilize close to the source, ... and rarely impact drinking water wells in the state." A "Fact Sheet of Questions and Answers" provided with the SFBRWQCB memo states that "For old releases, the absence of current groundwater degradation often is a good indication that residual concentrations present in soil are not a source of pollution." The low concentrations of BTEX found in grab groundwater samples indicate the lack of an ongoing source at the site.

As described by the SFBRWQCB memo, a low-risk groundwater case has the following general characteristics:

- The leak has stopped and ongoing sources, including free product, have been removed or remediated;
- The site has been adequately characterized;
- The dissolved hydrocarbon plume is not migrating;
- No water wells, deeper drinking water aquifers, surface water, or other sensitive receptors are likely to be impacted; and
- The site presents no significant risk to human health or the environment.

We believe the site satisfies all of these criteria for a low-risk case and that monitoring well installation is unnecessary. However, in an effort to satisfy the ACHCSA's apparent concern that there are additional, unknown sources at the site, we propose to conduct a thorough review of available historic building department files, aerial photographs and other records to investigate the potential for any other onsite sources. If the ACHCSA has a particular suspicion of other sources onsite, please advise us of the basis for that suspicion. Also, please indicate what other specific relevant information you believe is missing given the lack of the tank reports.

without collecting soil samples beneath the tanks for chemical analysis or submitting a report of the tank removal activities. It is unclear what additional information "regarding the tank removals" is necessary. Subsequent soil and groundwater sampling in the area of all known removed sources is more than adequate to evaluate the extent of residual hydrocarbons in the subsurface.

Your letter identifies "the presence of elevated Total Petroleum Hydrocarbons [TPH] in soil and groundwater samples" as a reason for your request for wells. It is unclear what risk is perceived by the ACHCSA by the residual TPH. The representative chemical concentrations used for the analysis were collected in the locations of all known potential onsite sources and are expected to represent a worst-case scenario. Any samples collected at a distance from these potential sources will necessarily exhibit lower analyte concentrations. Cambria's recent risk-based corrective action analysis, which used these worst-case concentrations, concluded that there was no significant human health risk due to the residual hydrocarbons. *~ was TPH conc used in RBCA? It should.*

Soil and groundwater samples collected at the site show low concentrations of benzene, toluene, ethylbenzene and xylenes (BTEX) relative to TPH concentrations. The low concentrations of the more volatile, aromatic compounds suggest an older release source, consistent with an expected facilities removal date of 1984 or before. In the presence of an unknown, ongoing release, BTEX concentrations would likely be much higher.

Also, it is common industry knowledge that since dissolved hydrocarbons in groundwater tend to remain in the upper ten feet of the water column, grab groundwater samples typically exhibit higher hydrocarbon concentrations than samples from properly constructed monitoring wells. It is unclear what advantage, if any, there is to installing monitoring wells where previous grab groundwater samples showed only low BTEX concentrations

You also point to "the one time only determination of groundwater gradient" as a reason to install wells. The primary reasons to monitor groundwater are to observe trends in groundwater elevation fluctuation and flow direction. Significant fluctuations in groundwater elevation are not typically observed at other sites in the nearby areas, including Shell-branded stations at 4411 Foothill Boulevard, 4255 MacArthur Boulevard and 630 High Street, and are not expected at the site. Given the lack of known or expected drinking water receptors near the site, inference of groundwater flow direction from surface topography confirmed by a one-time gradient determination at the site provides more than adequate precision to estimate the groundwater flow direction. More importantly, the lack of a significant hydrocarbon plume in groundwater precludes the necessity to evaluate for a hypothetical plume migration direction.

C A M B R I A

Barney Chan  
July 13, 2001

Please call me at (510) 420-3344 if you have any questions or comments.

Sincerely,

**Cambria Environmental Technology, Inc.**



Stephan A. Bork, C.E.G., C.H.G.  
Associate Hydrogeologist

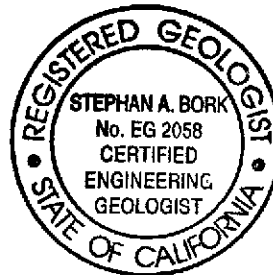

Cc: Ms. Karen Petryna, Equiva Services LLC, P.O. Box 7869, Burbank, CA 91501-7869  
Ms. Lotus Monroe, 11810 Alba Road, Ben Lomand, CA 95005  
Mr. Fidel P & Mrs. Dolores G Casillas, 2094 Harrington Ave., Oakland, CA 94601

G:\Oakland 2001 Fruitvale\2001 Fruitvale Agency Resp 7-5-01.doc

ALAMEDA COUNTY  
HEALTH CARE SERVICES

AGENCY

DAVID J. KEARS, Agency Director



ENVIRONMENTAL HEALTH SERVICES  
ENVIRONMENTAL PROTECTION  
1131 Harbor Bay Parkway, Suite 250  
Alameda, CA 94502-6577  
(510) 567-6700  
FAX (510) 337-9335

June 22, 2001  
StID # 5806/ RO0000305

Ms. Karen Petryna  
Equiva Services  
P.O. Box 7869  
Burbank, CA 91510-7869

**Re: Former Shell Station, 2001 Fruitvale Ave., Oakland CA 94601**

Dear Ms. Petryna:

Our office has met and conferred with the San Francisco Regional Water Quality Control Board (SFRWQCB) and discussed the merits of closure for the above referenced site. It is their opinion that given the lack of information regarding the number and location of the former underground tanks, the lack of information regarding the tank removals, the presence of elevated Total Petroleum Hydrocarbons in soil and groundwater samples and the one time only determination of groundwater gradient, permanent monitoring wells will be required at the site. The location of the monitoring wells, at a minimum, should be in the same general locations of the former soil borings, SBA, SBB and SBC.

**Please submit a work plan for the monitoring well installations to our office within 30 days or no later than July 23, 2001.**

Please contact me at (510) 567-6765 if you have any questions.

Sincerely,

A handwritten signature in black ink that reads "Barney M. Chan".

Barney M. Chan  
Hazardous Materials Specialist

C: Mr. F. Casillas, 2094 Harrington Ave., Oakland CA 94601  
Mr. S. Bork, Cambria Environmental, 1144 65<sup>th</sup> St., Suite B, Oakland CA 94608  
Ms. Lotus Monroe, 11810 Alba Road, Ben Lomand, CA 95005

Mwrq2001Fruitvale

February 6, 2001

Ms. Lotus Monroe

Re: Status of Underground Tank Investigation at 2662 Fruitvale Ave., Oakland 94601

Dear Ms. Monroe:

This note is to inform you of the status of the referenced site and project the time line to obtaining a No Further Action letter from our office. Due February 16, 2001 is Equiva Service's (Shell) Human Health Risk Assessment (HHRA). It is their and our office's belief that there is sufficient information at this site to determine human health risk. Assuming this information exists and no unacceptable human health risk exists (which is expected), our office will draft a site and case closure summary. This outlines the investigative results and summarizes the history of the site. Two internal reviews are necessary from our office. The recommendation, if approved by our office, is sent to the San Francisco Regional Water Quality Control Board for their concurrence. They are allowed one month for this review. Upon their written concurrence, a No Further Action letter is issued from our office. Conservatively, the process will take 2 ½ months from the time our office receives the HHRA. So we are looking at the first week of April 2001 for the entire closure process to be completed.

Please contact me if you have any further questions.

Sincerely,



Barney M. Chan  
Hazardous Materials Specialist

TRANSMIT REPORT

2001.02-06 17:06  
 510 337 9335  
 ALAMEDA CO EHS HAZ-OPS

COM No.	REMOTE STATION	START TIME	DURATION	PAGES	RESULT	USER ID	REMARKS
872	831	02-06 17:05	00' 28	01/01	OK		

7499402046

Post-it® Fax Note	7671	Date	2/6/01	# of pages	1
To	Ms. L. Monroe	From	B Chan		
Co./Dept.		Co.	ACEIT		
Phone #		Phone #	510-567-6765		
Fax #	831-476-2503	Fax #			

February 6, 2001

Ms. Lotus Monroe

Re: Status of Underground Tank Investigation at 2662 Fruitvale Ave., Oakland 94601

Dear Ms. Monroe:

This note is to inform you of the status of the referenced site and project the time line to obtaining a No Further Action letter from our office. Due February 16, 2001 is Equiva Service's (Shell) Human Health Risk Assessment (HHRA). It is their and our office's belief that there is sufficient information at this site to determine human health risk. Assuming this information exists and no unacceptable human health risk exists (which is expected), our office will draft a site and case closure summary. This outlines the investigative results and summarizes the history of the site. Two internal reviews are necessary from our office. The recommendation, if approved by our office, is sent to the San Francisco Regional Water Quality Control Board for their concurrence. They are allowed one month for this review. Upon their written concurrence, a No Further Action letter is issued from our office. Conservatively, the process will take 2 ½ months from the time our office receives the HHRA. So we are looking at the first week of April 2001 for the entire closure process to be completed.

Please contact me if you have any further questions.

Sincerely,



Barney M. Chan  
 Hazardous Materials Specialist



ALAMEDA COUNTY  
HEALTH CARE SERVICES

AGENCY

DAVID J. KEARS, Agency Director



ENVIRONMENTAL HEALTH SERVICES  
ENVIRONMENTAL PROTECTION  
1131 Harbor Bay Parkway, Suite 250  
Alameda, CA 94502-6577  
(510) 567-6700  
FAX (510) 337-9335

November 30, 2000  
StID # 5806

Ms. Karen Petryna  
Equiva Services LLC  
P.O. Box 7869  
Burbank, CA 91501-7869

**Re: 2001 Fruitvale Ave., Oakland CA 94601**

Dear Ms. Petryna:

Our office has received and reviewed the November 17, 2000 Agency Response letter prepared by Cambria Environmental Technology (Cambria). As you are aware, this letter proposes performing a Risk-Based Corrective Action (RBCA) evaluation for the site in lieu of installing the previously proposed groundwater monitoring wells. Cambria cites the current extent of soil and groundwater investigation data, the relative low concentrations of benzene in soil and groundwater and the absence of MTBE in groundwater as evidence that may allow for site closure as "low risk".

Our office concurs with this approach with the condition that along with the RBCA, a conduit and sensitive receptor survey is performed. **Please proceed with both of these reports. Your reports are due within 45 days or no later than January 16, 2001. Please notify our office of any delays.**

You may contact me at (510) 567-6765 if you have any comments or questions.

Sincerely,

Barney M. Chan  
Hazardous Materials Specialist

C.B. Chan, files

Mr. T. Buggle, Cambria Environmental, 1144 65<sup>th</sup> St., Suite B, Oakland CA 94608  
Mr. J. Dorado, 3808 International Blvd., Suite A, Oakland CA 94601  
Mr. F. Casillas, 2094 Harrington Ave., Oakland CA 94601  
Ms. Lotus Monroe, 11810 Alba Rd., Ben Lomand CA 95005

RBCA2001Fruitvale

CAMBRIA

ENVIRONMENTAL  
PROTECTION

#  
7806

00 NOV 21 PM 3: 58 November 17, 2000

Barney Chan  
Alameda County Health Care Services Agency  
1131 Harbor Bay Parkway, Suite 250  
Alameda, CA 94502-6577

Re: **Agency Response**  
2001 Fruitvale Avenue  
Oakland, California  
Incident # 97109122  
Cambria Project # 242-1296



Mr. Chan,

On behalf of Equiva Services LLC (Equiva), Cambria Environmental Technology Inc. (Cambria) is submitting this response to your October 19, 2000 letter to Equiva regarding the referenced site. Cambria has experienced significant delays in obtaining encroachment permits from the City of Oakland for the installation of two groundwater monitoring wells in City right-of-way adjacent to the site. Because of these delays, you and Troy Buggle (Cambria) discussed placing the wells within the site boundaries to accomplish the objective of defining the lateral extent of hydrocarbons in soil and groundwater. Your October 19, 2000 letter requested that we proceed with well installation on the property, as discussed.

After further review of our files, we believe that the site has been adequately assessed and that the current site conditions likely do not pose a significant risk to human health or the environment. During previous assessment, soil borings were drilled in the onsite locations where the monitoring wells were to be re-located and soil and groundwater samples were collected (Figure 1). Installation of monitoring wells in this area would only provide redundant information. In addition, the highest benzene concentrations detected in onsite soil and groundwater samples were 0.057 parts per million (ppm) and 13 parts per billion (ppb), respectively. Results indicate that methyl tertiary butyl ether (MTBE) is not a chemical of concern at the site.

TPH9=

Oakland, CA  
San Ramon, CA  
Sonoma, CA

**Cambria  
Environmental  
Technology, Inc.**

1144 65th Street  
Suite B  
Oakland, CA 94608  
Tel (510) 420-0700  
Fax (510) 420-9170

Given these relatively low concentrations of benzene in soil and groundwater at the site, Cambria proposes to perform a Risk Based Corrective Action (RBCA) analysis to estimate the potential risk to human health and the environment from residual hydrocarbons. Cambria will use Risk Based Screening Levels (RBSLs) established in the May 17, 1999 **Oakland Risk-Based Corrective Action: Technical Background Document**, prepared by Lynn R. Spence and Mark M. Gomez.

We believe that preparation of the RBCA will provide the most expeditious method to illustrate that the site does not pose a significant risk to site occupants. If representative concentrations of COCs are below Oakland's established RBSLs, we will request case closure for the site. Cambria will begin work on the RBCA upon approval from your office.

Please call Troy Buggle at (510) 420-3333 if you have any questions or comments.

Sincerely,

**Cambria Environmental Technology, Inc.**



Troy A. Buggle  
Project Scientist

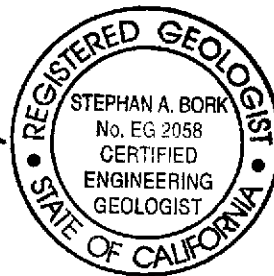

  
Stephan A. Bork, C.E.G., C.H.G.  
Associate Hydrogeologist  
(510) 420-3344

Figures: Figure 1 - Site Plan

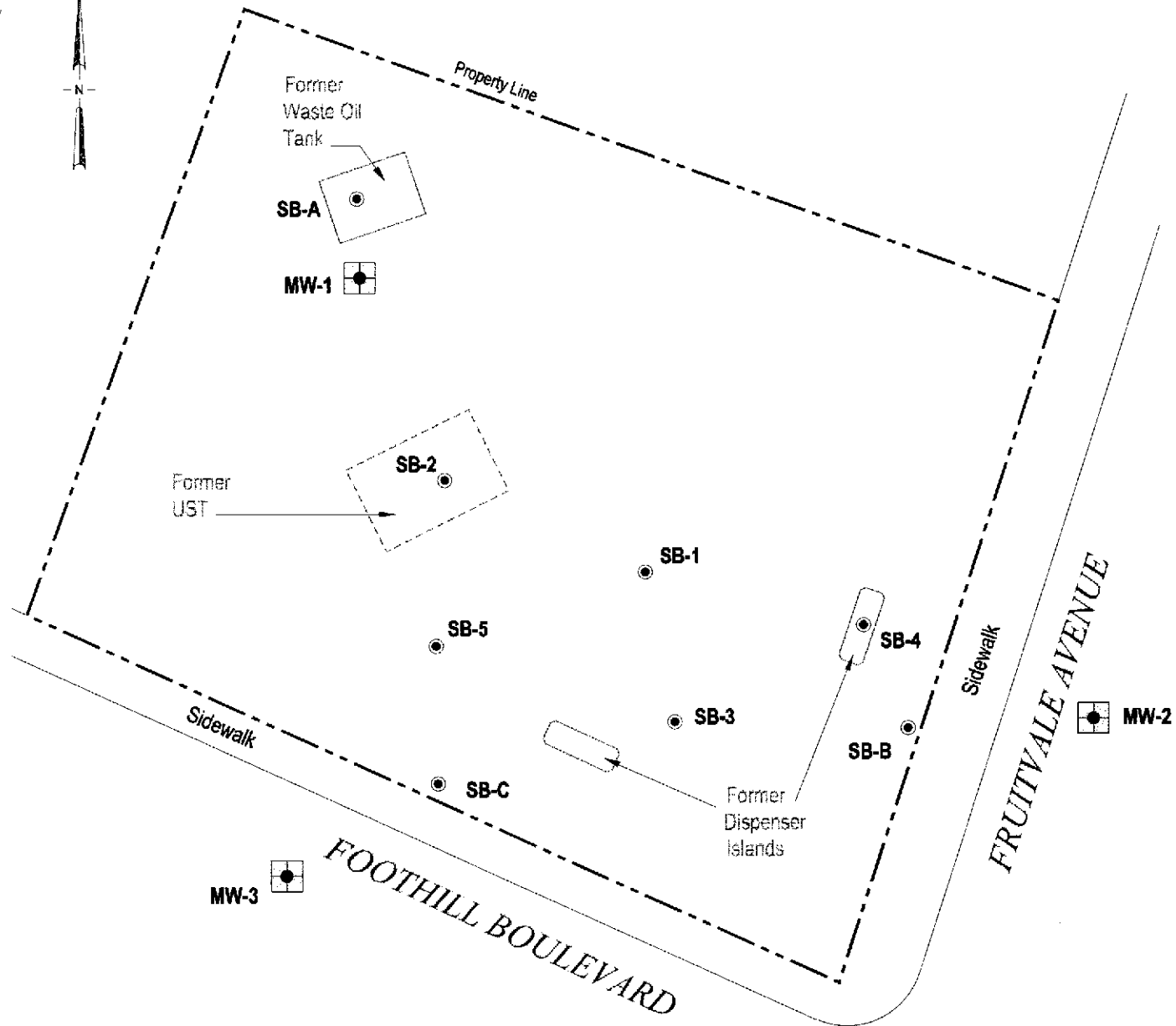
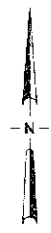
- Cc: Ms. Karen Petryna, Equiva Services LLC, P.O. Box 7869, Burbank, CA 91501-7869
- Mr. Tom Maher, Shell Oil Products Company, P.O. Box 2099, Houston, TX 77252
- Mr. David Harris, Trump, Alioto, Trump & Prescott LLP, 2280 Union Street, San Francisco, CA 94123
- Mr. Jose Dorado, 3808 International Blvd., Suite A, Oakland, CA 94601
- Mr. Fidel P & Mrs. Dolores G Casillas, 2094 Harrington Ave., Oakland, CA 94601



**EXPLANATION**

- MW-1**  Previously proposed monitoring well locations
- SB-1**  Soil boring location



**FIGURE 1**

**Former Shell Service Station**  
 2001 Fruitvale Avenue  
 Oakland, California  
 Incident #97109122



C A M B R I A

**Site Plan**

D:\C\AKSO\W\FIGURES\SITE2.DWG

ALAMEDA COUNTY  
HEALTH CARE SERVICES

AGENCY

DAVID J. KEARS, Agency Director



ENVIRONMENTAL HEALTH SERVICES

ENVIRONMENTAL PROTECTION  
1131 Harbor Bay Parkway, Suite 250  
Alameda, CA 94502-6577  
(510) 567-6700  
FAX (510) 337-9335

October 19, 2000  
StID #5806

Ms. Karen Petryna  
Equiva Services LLC  
P.O. Box 7869  
Burbank, CA 91501-7869

**Re: Installation of Monitoring Wells at Former Shell Station, 2001 Fruitvale Ave.,  
Oakland CA 94601**

Dear Ms. Petryna:

As you are aware, your consultant has encountered significant delays in obtaining a City of Oakland encroachment permit to install three proposed monitoring wells because two of the well locations are on City property. Your well installation work plan was approved by our office in September 1999, over a year ago.

I have spoke with Mr. Troy Buggle of Cambria Environmental, and we concur that the two wells in question can be relocated on the property without compromising the investigation significantly. Therefore, wells MW-2 and MW-3 should be moved to locations near the borings SB-C and SB-B, respectively. Please provide a work plan addendum that includes these new well locations and schedule their installation as soon as possible.

You may contact me at (510) 567-6765 if you have any questions.

Sincerely,

Barney M. Chan  
Hazardous Materials Specialist

C. B. Chan, files

Mr. T. Buggle, Cambria Environmental, 1144 65<sup>th</sup> St., Suite B, Oakland CA 94608

Mr. J. Dorado, 3808 International Blvd., Suite A, Oakland CA 94601

Wellreloc2001

CAMBRIA

Ro 305

ENVIRONMENTAL  
PROTECTION

00 MAY 17 PM 3: 28

May 12, 2000

Barney Chan  
Alameda County Health Care Services Agency  
1131 Harbor Bay Parkway, Suite 250  
Alameda, CA 94502-6577

Re: **Former Shell Service Station**  
2001 Fruitvale Avenue  
Oakland, California  
Incident # 97109122  
Cambria Project # 242-1296



Mr. Chan,

In response to your April 12, 2000 correspondence regarding the above referenced site, Cambria Environmental Technology, Inc. (Cambria) is currently in the process of obtaining the necessary drilling permits and encroachment permits in order to begin the subsurface investigation proposed in our September, 1999 work plan. Once the necessary permits have been acquired, Cambria will notify your office and proceed with the scheduling and coordination of drilling and sampling activities outlined in the previously submitted work plan.

Please call us at (510) 420-0700 if you have any questions or comments.

Sincerely,

**Cambria Environmental Technology, Inc.**

Troy A. Buggle  
Project Scientist

Oakland, CA  
San Ramon, CA  
Sonoma, CA  
Portland, OR

**Cambria  
Environmental  
Technology, Inc.**

1144 65th Street  
Suite B  
Oakland, CA 94608  
Tel (510) 420-0700  
Fax (510) 420-9170

Cc: Ms. Karen Petryna, Equiva Services LLC, P.O. Box 7869, Burbank, CA 91501-7869  
Mr. Tom Maher, Shell Oil Products Company, P.O. Box 2099, Houston, TX 77252  
Mr. David Harris, Trump, Alioto, Trump & Prescott LLP, 2280 Union Street, San Francisco, CA 94123  
Mr. Jose Dorado, 3808 International Blvd., Suite A, Oakland, CA 94601  
Mr. Fidel P & Mrs. Dolores G Casillas, 2094 Harrington Ave., Oakland, CA 94601

G:\Oakland2001\Response.Doc

CAMBRIA

ENVIRONMENTAL  
PROTECTION

00 MAY -8 AM 10: 02

A 5806

April 28, 2000

Barney Chan  
Alameda County Health Care Services Agency  
1131 Harbor Bay Parkway, Suite 250  
Alameda, CA 94502-6577

- 8/15/00 no news  
yet.

Re: **Former Shell Service Station**  
2001 Fruitvale Avenue  
Oakland, California  
Incident # 97109122  
Cambria Project # 242-1296



Mr. Chan,

In response to your April 12, 2000 correspondence regarding the above referenced site, Cambria Environmental Technology, Inc. (Cambria) is currently in the process of obtaining the necessary drilling permits and encroachment permits in order to begin the subsurface investigation proposed in our September, 1999 work plan. Once the necessary permits have been acquired, Cambria will notify your office and proceed with the scheduling and coordination of drilling and sampling activities outlined in the previously submitted work plan.

Please call us at (510) 420-0700 if you have any questions or comments.

Sincerely,

**Cambria Environmental Technology, Inc.**

Troy A. Buggle  
Project Scientist

Oakland, CA  
San Ramon, CA  
Sonoma, CA  
Portland, OR

**Cambria  
Environmental  
Technology, Inc.**

Cc: Ms. Karen Petryna, Equiva Services LLC, P.O. Box 7869, Burbank, CA 91501-7869  
Mr. Tom Maher, Shell Oil Products Company, P.O. Box 2099, Houston, TX 77252  
Mr. David Harris, Trump, Alioto, Trump & Prescott LLP, 2280 Union Street, San Francisco, CA 94123  
Mr. Jose Dorado, 3808 International Blvd., Suite A, Oakland, CA 94601  
Mr. Fidel P & Mrs. Dolores G Casillas, 2094 Harrington Ave., Oakland, CA 94601

1144 65th Street  
Suite B  
Oakland, CA 94608  
Tel (510) 420-0700  
Fax (510) 420-9170

G:\Oakland2001\Response.Doc

ALAMEDA COUNTY  
HEALTH CARE SERVICES

AGENCY

DAVID J. KEARS, Agency Director



ENVIRONMENTAL HEALTH SERVICES  
ENVIRONMENTAL PROTECTION (LOP)  
1131 Harbor Bay Parkway, Suite 250  
Alameda, CA 94502-6577  
(510) 567-6700  
FAX (510) 337-9335

April 12, 2000  
StID # 5806

Ms. Karen Petryna  
Equiva Services LLC  
~~P.O. Box 6349~~  
~~Carson, CA 90749-6249~~

PO Box 7869  
Burbank CA 91501-7869

**Re: Installation of Monitoring Wells at Former Shell Station, 2001 Fruitvale Ave.,  
Oakland CA 94601**

Dear Ms. Petryna:

This letter requests a time schedule for the implementation of the approved September 14, 1999 Cambria work plan for the installation of three monitoring wells at the above referenced site. As you are aware, our office reviewed and approved this work plan in my September 28, 1999 letter. To date, our office has not been provided a timetable or notified as to the schedule for the installation of the three wells. Please attempt to install these wells within the next 30 days, if possible or provide an alternative schedule.

You may contact me at (510) 567-6765 if you have any comments.

Sincerely,

Barney M. Chan  
Hazardous Materials Specialist

C: B. Chan, files

Mr. T. Buggle, Cambria Environmental Technology, 1144 65<sup>th</sup> St., Suite B, Oakland CA 94608  
Mr. J. Dorado, 3808 International Blvd., Suite A, Oakland CA 94601

Wells2001



C A M B R I A

# 5906 /

10305 AG

November 23, 1999

Mr. Barney Chan  
Alameda County Health Care Services Agency  
1131 Harbor Bay Parkway, 2nd Floor  
Alameda, California 94502

**Re: Certified List of Record Fee Title Owners for:**  
Former Shell Service Station  
2001 Fruitvale Ave.  
Oakland, CA  
Incident No. 97109122



Dear Mr. Chan:

In accordance with section 25297.15(a) of Chapter 6.7 of the Health Safety Code and on behalf of Equiva Services LLC, we certify that the following is a complete list of current record fee title owners and their mailing addresses for the above site.

Fidel P & Dolores G Casillas, 2094 Harrington Ave., Oakland, CA 94601

Sincerely,

Ailsa S. Le May, R.G.  
Senior Geologist

*Barbank*

cc: Karen Petryna, Equiva Services LLC, P.O. Box ~~6249~~, ~~Carson~~, California, ~~90749~~ 6249  
Fidel P & Dolores G Casillas, 2094 Harrington Ave., Oakland, CA 94601

Oakland, CA  
Sonoma, CA  
Portland, OR  
Seattle, WA

**Cambria  
Environmental  
Technology, Inc.**

1144 65th Street  
Suite B  
Oakland, CA 94608  
Tel (510) 420-0700  
Fax (510) 420-9170

ALAMEDA COUNTY  
HEALTH CARE SERVICES

AGENCY

DAVID J. KEARS, Agency Director



ENVIRONMENTAL HEALTH SERVICES

1131 Harbor Bay Parkway, Suite 250  
Alameda, CA 94502-6577  
(510) 567-6700  
(510) 337-9335 (FAX)

September 28, 1999  
StID # 5806

Ms. Karen Petryna  
Equiva Services LLC  
P.O. Box 6349  
Carson, CA 90749-6249

**Re: Work Plan for Monitoring Wells at Former Shell Station, 2001 Fruitvale Ave.,  
Oakland CA, 94601**

Dear Ms. Petryna:

Our office has received and reviewed the September 14, 1999 Cambria **Investigation Work Plan** for the above referenced site. This responds to my August 13, 1999 letter which comments on the August 5, 1999 Site Investigation Report by Cambria. This report identified petroleum contamination beneath the entire site. The work plan proposes to install three monitoring wells, one adjacent to the former waste oil tank in the northern part of the site and one well in Fruitvale Ave. and one in Foothill Boulevard, on the east and south sides of the site.

This work plan is accepted with the following provisions:

- Please add the analysis for TRPH (oil and grease) on the soil sample(s) taken from the boring adjacent to the former waste oil tank. TRPH should also be added to the analytes tested in all three wells.
- The groundwater sample from the well adjacent the former waste oil tank should also be analyzed for halogenated volatile organics and semi-volatile organics, which were found in the grab water sample collected in this same general area.
- The groundwater samples run for the analytes, TEPH and TRPH should be filtered and passed through a silica gel cleanup prior to analysis.
- Any soil or groundwater sample detecting MTBE should be re-analyzed by EPA Method 8260 or 8240 to confirm its presence.
- You are reminded that use of the Oakland or ASTM RBCA is contingent on adequate site characterization. Therefore, it should incorporate the data from this proposed work.

Our office has been informed of the intent to pave this site. Our office has no objections to this activity so long as access to the installation and sampling of the proposed monitoring well is not encumbered.

You may contact me at (510) 567-6765 if you have any questions.

Ms. Karen Petryna  
StID # 5806  
2001 Fruitvale Ave., Oakland 94601  
September 28, 1999  
Page 2.

Sincerely,



Barney M. Chan  
Hazardous Materials Specialist

c: B. Chan, files ✓

Mr. J. Dorado, 3808 International Blvd., Suite A, Oakland, CA 94601

Mr. T. Buggle, Cambria Environmental Technology, 1144 65<sup>th</sup> St., Suite B, Oakland CA 94608

**Mwap2001**

# C A M B R I A

September 21, 1999

Barney Chan  
Alameda County Health Care Services Agency  
1131 Harbor Bay Parkway, Suite 250  
Alameda, CA 94502-6577

Re: **Former Shell Service Station**  
2001 Fruitvale Avenue  
Oakland, California  
Incident # 97109122  
Cambria Project # 241-1296



Mr. Chan,

Cambria is currently managing the ongoing environmental activities at the above-referenced site. According to the current property owner's representative, Mr. Jose Dorado, paving activities are scheduled for this site. It does not appear that the planned activities will interfere with the ongoing environmental investigation. Cambria would like to request that if the ACHCSA is in agreement with this statement, they issue a letter to the City of Oakland building department.

Please call us at (510) 420-0700 if you have any questions or comments.

Sincerely,

**Cambria Environmental Technology, Inc.**

Ailsa S. Le May, R.G.  
Senior Geologist

Oakland, CA  
Sonoma, CA  
Portland, OR  
Seattle, WA

Cc: Ms. Karen Petryna, Equiva Services LLC, P.O. Box 6249, Carson, CA 90749-6249  
Mr. Tom Maher, Shell Oil Products Company, P.O. Box 2099, Houston, TX 77252  
Mr. David Harris, Trump, Alioto, Trump & Prescott LLP, 2280 Union Street, San Francisco, CA 94123  
Mr. Jose Dorado, 3808 International Blvd., Suite A, Oakland, CA 94601

**Cambria  
Environmental  
Technology, Inc.**

G:\Oakland2001\Response.Doc

1144 65th Street  
Suite B  
Oakland, CA 94608  
Tel (510) 420-0700  
Fax (510) 420-9170

ALAMEDA COUNTY  
HEALTH CARE SERVICES

AGENCY

DAVID J. KEARS, Agency Director



ENVIRONMENTAL HEALTH SERVICES

1131 Harbor Bay Parkway, Suite 250  
Alameda, CA 94502-6577  
(510) 567-6700  
(510) 337-9335 (FAX)

August 13, 1999  
StID # 5806

Ms. Karen Petryna  
Equiva Services LLC  
P.O. Box 6349  
Carson, CA 90749-6249

**Re: Site Investigation at Former Shell Station, 2001 Fruitvale Ave., Oakland CA 94601**

Dear Ms. Petryna:

Our office has received and reviewed the August 5, 1999 Site Investigation Report by Cambria Environmental Technology, Inc. (Cambria), your consultant. This report provided the results of soil and groundwater samples from three borings at this site. I have reviewed these results and the results of the 1996 AllCal Property Services, Inc. investigation. It appears that soil contamination is limited to the former waste oil tank pit and lesser amounts within the former underground tank pit. The highest concentrations of TRPH and TEPH are found in the soil sample within the former waste oil pit and at a depth of 10' bgs. Groundwater, which is encountered at approximately 16' bgs has been impacted throughout the entire site as indicated in the recent water samples from the three borings by Cambria.

At this time, our office will require the installation of monitoring wells to measure the impact to groundwater and determine whether the extent and stability of the plume has been found. The proposed risk based corrective action (RBCA) evaluation should be put on hold until the site has been better characterized. Please submit a work plan for monitoring well installation to our office within 30 days or by September 14, 1999.

You may contact me at (510) 567-6765 if you have any comments or questions.

Sincerely,

Barney M. Chan  
Hazardous Materials Specialist

C: B. Chan, files

Ms. A. Cool, Cambria Environmental Technology, 1144 65<sup>th</sup> St., Suite B, Oakland CA 94608  
Mr. Jose Dorado, 3808 International Blvd., Suite A, Oakland CA 94601

Mwwp2001

white -env.health  
yellow -facility  
pink -files

# ALAMEDA COUNTY, DEPARTMENT OF ENVIRONMENTAL HEALTH

1131 Harbor Bay Pkwy  
Alameda CA 94502  
510/567-6700

## Hazardous Materials Inspection Form

II, III

Site ID # 5806 Site Name J. Casillas farmstead Today's Date 3/31/99

Site Address Foot Hill & Fruitvale, 2001 Fruitvale Ave

City Oakland Zip 94608 Phone \_\_\_\_\_

\_\_\_\_ MAX AMT stored > 500 lbs, 55 gal., 200 cft.?

**Inspection Categories:**

\_\_\_\_ I. Haz. Mat/Waste GENERATOR/TRANSPORTER

\_\_\_\_ II. Hazardous Materials Business Plan, Acutely Hazardous Materials

\_\_\_\_ III. Under ground Storage Tanks

\* Calif. Administration Code (CAC) or the Health & Safety Code (HS&C)

**Comments:**

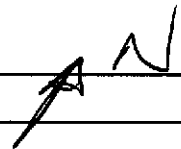

only 2 boroholes observed / grouted close ~150 pm w/ Cambria cones covering them, no workers onsite

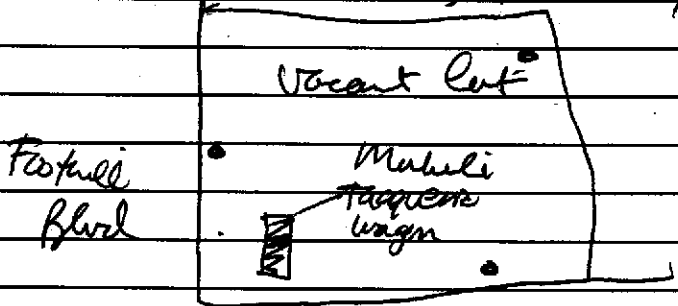

Later spoke w/ Tom Boggs of Cambria & confirmed that all 3 borings were drilled, soil splices collected every 5' & gw elevations readings taken after stabilization. The boring near the former waste oil tank was not covered w/ a cone.

Contact \_\_\_\_\_  
Title \_\_\_\_\_  
Signature \_\_\_\_\_

Inspector B. Chan  
Signature B. Chan

II, III

ALAMEDA COUNTY  
HEALTH CARE SERVICES

AGENCY  
DAVID J. KEARS, Agency Director



November 6, 1998  
StID # 5806

Mr. Tom Maher  
Shell Oil Products Co.  
P.O. Box 2099  
Houston, TX 7252

ENVIRONMENTAL HEALTH SERVICES  
ENVIRONMENTAL PROTECTION (LOP)  
1131 Harbor Bay Parkway, Suite 250  
Alameda, CA 94502-6577  
(510) 567-6700  
FAX (510) 337-9335

**Re: Investigation Work Plan for Former Shell Service Station, 2001 Fruitvale Ave.,  
Oakland, CA, 94601, WIC #204-5508-2105**

Dear Mr. Maher:

Our office has received and reviewed the October 27, 1998 **Investigation Work Plan** prepared by your consultant, Cambria. This work plan follows an initial soil and groundwater investigation by All Cal Property Services, which identified petroleum contamination in both media. This additional investigation serves to complete site characterization and offer the site for closure as a "low risk" soils and groundwater case, if warranted. A risk-based corrective action (RBCA) evaluation will also be provided to justify closure as a low risk site.

This work plan proposes to advance three additional soil borings and collect soil and groundwater samples. In general, our office approves of this approach, since I have previously discussed the site with Ms. Diane Lundquist of Cambria. Our office, however, has the additional requirements:

- One of the borings is proposed in the northwest corner of the site where a former waste oil tank had been. Because of the potential of polyaromatic hydrocarbon compounds to be found in heavy oils, please analyze a shallow boring for semi-volatile compounds using EPA Method 8270. This is in addition to other waste oil parameters; TPHg, TPHd, oil and grease, BTEX, MTBE, chlorinated solvents and the metals: cadmium, chromium, lead, nickel and zinc to be analyzed on the selected soil and groundwater samples.
- Because of the requirement to adequately characterize a site prior to site closure, it is important to determine site-specific groundwater gradient. Therefore, our office requests that prior to groundwater sampling, a temporary slotted well casing be installed within each borehole. Several groundwater elevation readings should be taken for gradient determination.

Please contact our office **72 working hours prior to this field work**. I may be reached at (510) 567-6765 if you have any questions.

Sincerely,

Barney M. Chan, Hazardous Materials Specialist

C: B. Chan, files

Ms. D. Lundquist, Cambria, 1144 65<sup>th</sup> St., Suite B, Oakland CA 94608  
Ms. K. Petryna, Equiva Services LLC, P.O. Box 6249, Carson, CA 90749-6249  
Mr. D. Harris, Trump, Alioto, Trump & Prescott LLP, 2280 Union St., SF, CA 94123

(wpap2001Fr)

ALAMEDA COUNTY  
HEALTH CARE SERVICES

AGENCY

DAVID J. KEARS, Agency Director



RAFAT A. SHAHID, DIRECTOR

February 27, 1996  
StID # 5806

DEPARTMENT OF ENVIRONMENTAL HEALTH  
1131 Harbor Bay Parkway  
Alameda, CA 94502-6577  
(510)567-6700

Mr. Fidel Casillas  
2094 Harrington Ave.  
Oakland CA 94601

**Re: 2001 Fruitvale Ave., Oakland CA 94601**

Dear Mr. Casillas:

Our office has received and reviewed the February 22, 1996 Work Plan for Groundwater Investigation from All Cal Property Services, prepared by Mr. John Mrakovich. This report proposes to install three monitoring wells to determine the extent of groundwater contamination and to determine the site specific gradient. This work plan is acceptable. You may schedule this work as soon as possible.

It has come to my attention that the drums of soil cuttings left on your site from the initial subsurface investigation are accessible to the public and have been recently disturbed by children in the neighborhood. I have spoken with Mr. Mrakovich and based on the analytical results of the soils within these drums, you may reuse the soils within these drums onsite. Your immediate attention to this matter is appreciated. Future drums of soil or groundwater from subsurface investigation should be secure from the public or disposed of in a timely fashion.

You may contact me at (510) 567-6765 if you have any questions.

Sincerely,

Barney M. Chan  
Hazardous Materials Specialist

c: J. Mrakovich, All Cal Property Services, 27973 High Country Drive, Hayward, CA 94542-2530  
Ms. K. Kenny, Trump, Alioto, Trump & Prescott, Fremont Office Center, 39300 Civic Center Drive, Suite 360, Fremont, CA 94538  
G. Coleman, file

wpap2001



**ALLCAL**

PROPERTY SERVICES

ENVIRONMENTAL INVESTIGATIONS • HOME INSPECTIONS

TO: ALAMEDA COUNTY HEALTH  
MR. BARNEY CHAN

FROM: JOHN MRAKOVICH  
510 581 5356  
2/2/96

WE ARE SENDING YOU  ATTACHED  UNDER SEPARATE COVER  
VIA \_\_\_\_\_ THE FOLLOWING ITEMS:

- LETTER(S)       PROPOSAL(S)       TABLE(S)       FIGURE(S)
- SPECIFICATION(S)     CHANGE ORDER(S)     REPORT(S)
- UNAUTHORIZED RELEASE SITE REPORT

COPIES	DATED	DESCRIPTION

THESE ARE TRANSMITTED FOR:

- YOUR REVIEW AND COMMENT
- YOUR REQUEST
- YOUR APPROVAL
- \_\_\_\_\_
- YOUR FILES
- APPROVED AS SUBMITTED
- APPROVED AS NOTED

REMARKS: \_\_\_\_\_  
\_\_\_\_\_  
\_\_\_\_\_  
\_\_\_\_\_  
\_\_\_\_\_

CC: KELLY S. KENNY

SIGNATURE: John M. Mraovich

AC/MT PINK COP

# UNDERGROUND STORAGE TANK UNAUTHORIZED RELEASE (LEAK) / CONTAMINATION SITE REPORT

EMERGENCY <input type="checkbox"/> YES <input checked="" type="checkbox"/> NO		HAS STATE OFFICE OF EMERGENCY SERVICES REPORT BEEN FILED? <input type="checkbox"/> YES <input checked="" type="checkbox"/> NO		FOR LOCAL AGENCY USE ONLY I HEREBY CERTIFY THAT I AM A DESIGNATED GOVERNMENT EMPLOYEE AND THAT I HAVE REPORTED THIS INFORMATION TO LOCAL OFFICIALS PURSUANT TO SECTION 25180.7 OF THE HEALTH AND SAFETY CODE. SIGNED: <u>Barney Chan</u> DATE: <u>2-5-96</u>	
REPORT DATE 0 <u>M</u> 2 <u>M</u> 0 <u>D</u> 1 <u>D</u> 9 <u>V</u> 6 <u>Y</u>		CASE #			
REPORTED BY	NAME OF INDIVIDUAL FILING REPORT <b>JOHN MRAKOVICH</b>		PHONE <b>(510) 581-2320</b>	SIGNATURE <u>John V. Mrazovich</u>	
	REPRESENTING <input checked="" type="checkbox"/> OWNER/OPERATOR <input type="checkbox"/> REGIONAL BOARD <input type="checkbox"/> LOCAL AGENCY <input type="checkbox"/> OTHER		COMPANY OR AGENCY NAME <b>ALLCAL PROPERTY SERVICES, INC.</b>		
	ADDRESS <b>27973 HIGH COUNTRY DRIVE, HAYWARD, CA 94542</b>				
RESPONSIBLE PARTY	NAME <b>Fidel Castillas - prop. owner</b>		CONTACT PERSON	PHONE <b>( )</b>	
	ADDRESS <b>2094 Harrington Ave</b>		CITY <b>Oakland</b>	STATE <b>CA</b>	ZIP <b>94601</b>
SITE LOCATION	FACILITY NAME (IF APPLICABLE)		OPERATOR	PHONE <b>( )</b>	
	ADDRESS <b>2001 FRUITVALE, AVE., OAKLAND, CA 94601</b>				
	CROSS STREET <b>FOOTHILL</b>	TYPE OF AREA <input checked="" type="checkbox"/> COMMERCIAL <input type="checkbox"/> INDUSTRIAL <input type="checkbox"/> RURAL <input type="checkbox"/> RESIDENTIAL <input type="checkbox"/> OTHER	TYPE OF BUSINESS <input type="checkbox"/> RETAIL FUEL STATION <input type="checkbox"/> FARM <input checked="" type="checkbox"/> OTHER <b>VACANT</b>		
IMPLEMENTING AGENCIES	LOCAL AGENCY AGENCY NAME <b>ALAMEDA COUNTY HEALTH DEPT.</b>		CONTACT PERSON <b>BARNEY CHAN</b>	PHONE <b>(510) 567-6765</b>	
	REGIONAL BOARD <b>SAN FRANCISCO BAY REGION</b>		CONTACT PERSON <b>Kevin Graves</b>	PHONE <b>(510) 286-1255</b>	
SUBSTANCES INVOLVED	(1) NAME <b>GASOLINE AND WASTE OIL PRODUCTS</b>		QUANTITY LOST (GALLONS) <input checked="" type="checkbox"/> UNKNOWN		
	(2)		<input type="checkbox"/> UNKNOWN		
DISCOVERY/ABATEMENT	DATE DISCOVERED 0 <u>M</u> 1 <u>M</u> 1 <u>D</u> 2 <u>D</u> 9 <u>V</u> 6 <u>Y</u>		HOW DISCOVERED <input type="checkbox"/> INVENTORY CONTROL <input type="checkbox"/> SUBSURFACE MONITORING <input type="checkbox"/> NUISANCE CONDITIONS <input type="checkbox"/> TANK TEST <input type="checkbox"/> TANK REMOVAL <input checked="" type="checkbox"/> OTHER <b>SOIL BORINGS</b>		
	DATE DISCHARGE BEGAN ____ M ____ D ____ Y ____ Y <input checked="" type="checkbox"/> UNKNOWN		METHOD USED TO STOP DISCHARGE (CHECK ALL THAT APPLY) <input type="checkbox"/> REMOVE CONTENTS <input type="checkbox"/> REPLACE TANK <input type="checkbox"/> CLOSE TANK <input type="checkbox"/> REPAIR TANK <input type="checkbox"/> REPAIR PIPING <input type="checkbox"/> CHANGE PROCEDURE <input type="checkbox"/> OTHER		
	HAS DISCHARGE BEEN STOPPED? <input type="checkbox"/> YES <input type="checkbox"/> NO IF YES, DATE ____ M ____ D ____ Y ____ Y				
SOURCE/CAUSE	SOURCE OF DISCHARGE <input type="checkbox"/> TANK LEAK <input checked="" type="checkbox"/> UNKNOWN <input type="checkbox"/> PIPING LEAK <input type="checkbox"/> OTHER		TANKS ONLY/CAPACITY ____ GAL. AGE ____ YRS <input checked="" type="checkbox"/> UNKNOWN	MATERIAL <input type="checkbox"/> FIBERGLASS <input type="checkbox"/> STEEL <input type="checkbox"/> OTHER	CAUSE(S) <input type="checkbox"/> OVERFILL <input type="checkbox"/> RUPTURE/FAILURE <input type="checkbox"/> CORROSION <input checked="" type="checkbox"/> UNKNOWN <input type="checkbox"/> SPILL <input type="checkbox"/> OTHER
	CHECK ONE ONLY <input checked="" type="checkbox"/> UNDETERMINED <input type="checkbox"/> SOIL ONLY <input type="checkbox"/> GROUNDWATER <input type="checkbox"/> DRINKING WATER - (CHECK ONLY IF WATER WELLS HAVE ACTUALLY BEEN AFFECTED)				
CURRENT STATUS	CHECK ONE ONLY <input checked="" type="checkbox"/> SITE INVESTIGATION IN PROGRESS (DEFINING EXTENT OF PROBLEM) <input type="checkbox"/> CLEANUP IN PROGRESS <input type="checkbox"/> SIGNED OFF (CLEANUP COMPLETED OR UNNECESSARY) <input type="checkbox"/> NO ACTION TAKEN <input type="checkbox"/> POST CLEANUP MONITORING IN PROGRESS <input type="checkbox"/> NO FUNDS AVAILABLE TO PROCEED <input type="checkbox"/> EVALUATING CLEANUP ALTERNATIVES				
	CHECK APPROPRIATE ACTION(S) (SEE BACK FOR DETAILS) <input type="checkbox"/> CAP SITE (CD) <input type="checkbox"/> EXCAVATE & DISPOSE (ED) <input type="checkbox"/> REMOVE FREE PRODUCT (FP) <input type="checkbox"/> ENHANCED BIO DEGRADATION (IT) <input type="checkbox"/> CONTAINMENT BARRIER (CB) <input type="checkbox"/> EXCAVATE & TREAT (ET) <input type="checkbox"/> PUMP & TREAT GROUNDWATER (GT) <input type="checkbox"/> REPLACE SUPPLY (RS) <input type="checkbox"/> TREATMENT AT HOOKUP (HU) <input type="checkbox"/> NO ACTION REQUIRED (NA) <input type="checkbox"/> OTHER (OT)				
COMMENTS					

# UNDERGROUND STORAGE TANK UNAUTHORIZED RELEASE (LEAK) / CONTAMINATION SITE REPORT

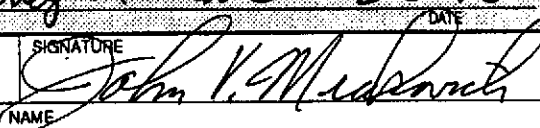
EMERGENCY <input type="checkbox"/> YES <input checked="" type="checkbox"/> NO		HAS STATE OFFICE OF EMERGENCY SERVICES REPORT BEEN FILED? <input type="checkbox"/> YES <input checked="" type="checkbox"/> NO		FOR LOCAL AGENCY USE ONLY I HEREBY CERTIFY THAT I AM A DESIGNATED GOVERNMENT EMPLOYEE AND THAT I HAVE REPORTED THIS INFORMATION TO LOCAL OFFICIALS PURSUANT TO SECTION 25180.7 OF THE HEALTH AND SAFETY CODE. SIGNED: <u>Barney Chan</u> DATE: <u>2-5-96</u>	
REPORT DATE <u>0</u> <u>2</u> <u>0</u> <u>1</u> <u>9</u> <u>6</u>		CASE #			
REPORTED BY	NAME OF INDIVIDUAL FILING REPORT <b>JOHN MRAKOVICH</b>		PHONE (510) 581-2320	SIGNATURE 	
	REPRESENTING <input checked="" type="checkbox"/> OWNER/OPERATOR <input type="checkbox"/> REGIONAL BOARD <input type="checkbox"/> LOCAL AGENCY <input type="checkbox"/> OTHER		COMPANY OR AGENCY NAME ALLCAL PROPERTY SERVICES, INC.		
	ADDRESS 27973 HIGH COUNTRY DRIVE, HAYWARD, CA 94542				
RESPONSIBLE PARTY	NAME <b>Fidel Casillas - Prop. owner</b>		CONTACT PERSON <input checked="" type="checkbox"/> UNKNOWN	PHONE ( )	
	ADDRESS <b>2094 Harrington Ave</b>		CITY Oakland	STATE CA	ZIP 94601
SITE LOCATION	FACILITY NAME (IF APPLICABLE)		OPERATOR		PHONE ( )
	ADDRESS 2001 FRUITVALE, AVE., OAKLAND, CA 94601				
	CROSS STREET FOOTHILL		TYPE OF AREA <input checked="" type="checkbox"/> COMMERCIAL <input type="checkbox"/> INDUSTRIAL <input type="checkbox"/> RURAL <input type="checkbox"/> RESIDENTIAL <input type="checkbox"/> OTHER		TYPE OF BUSINESS <input type="checkbox"/> RETAIL FUEL STATION <input type="checkbox"/> FARM <input checked="" type="checkbox"/> OTHER VACANT
IMPLEMENTING AGENCIES	LOCAL AGENCY ALAMEDA COUNTY HEALTH DEPT.		AGENCY NAME		CONTACT PERSON BARNEY CHAN
	REGIONAL BOARD SAN FRANCISCO BAY REGION		CONTACT PERSON Kenn Graves		PHONE (510) 567-6765  (510) 286-1255
SUBSTANCES INVOLVED	(1) NAME GASOLINE AND WASTE OIL PRODUCTS				QUANTITY LOST (GALLONS) <input checked="" type="checkbox"/> UNKNOWN
	(2)				<input type="checkbox"/> UNKNOWN
DISCOVERY/ABATEMENT	DATE DISCOVERED <u>0</u> <u>1</u> <u>1</u> <u>2</u> <u>9</u> <u>6</u>		HOW DISCOVERED <input type="checkbox"/> INVENTORY CONTROL <input type="checkbox"/> SUBSURFACE MONITORING <input type="checkbox"/> NUISANCE CONDITIONS <input type="checkbox"/> TANK TEST <input type="checkbox"/> TANK REMOVAL <input checked="" type="checkbox"/> OTHER SOIL BORINGS		
	DATE DISCHARGE BEGAN _____		METHOD USED TO STOP DISCHARGE (CHECK ALL THAT APPLY) <input type="checkbox"/> REMOVE CONTENTS <input type="checkbox"/> REPLACE TANK <input type="checkbox"/> CLOSE TANK <input type="checkbox"/> REPAIR TANK <input type="checkbox"/> REPAIR PIPING <input type="checkbox"/> CHANGE PROCEDURE <input type="checkbox"/> OTHER		
	HAS DISCHARGE BEEN STOPPED? <input type="checkbox"/> YES <input type="checkbox"/> NO IF YES, DATE _____				
SOURCE/CAUSE	SOURCE OF DISCHARGE <input type="checkbox"/> TANK LEAK <input checked="" type="checkbox"/> UNKNOWN		TANKS ONLY/CAPACITY _____ GAL.		MATERIAL <input type="checkbox"/> FIBERGLASS
	<input type="checkbox"/> PIPING LEAK  <input type="checkbox"/> OTHER		AGE _____ YRS <input checked="" type="checkbox"/> UNKNOWN		<input type="checkbox"/> STEEL <input type="checkbox"/> OTHER
CASE TYPE	CHECK ONE ONLY <input checked="" type="checkbox"/> UNDETERMINED <input type="checkbox"/> SOIL ONLY <input type="checkbox"/> GROUNDWATER <input type="checkbox"/> DRINKING WATER - (CHECK ONLY IF WATER WELLS HAVE ACTUALLY BEEN AFFECTED)				
	CHECK ONE ONLY <input checked="" type="checkbox"/> SITE INVESTIGATION IN PROGRESS (DEFINING EXTENT OF PROBLEM) <input type="checkbox"/> CLEANUP IN PROGRESS <input type="checkbox"/> SIGNED OFF (CLEANUP COMPLETED OR UNNECESSARY) <input type="checkbox"/> NO ACTION TAKEN <input type="checkbox"/> POST CLEANUP MONITORING IN PROGRESS <input type="checkbox"/> NO FUNDS AVAILABLE TO PROCEED <input type="checkbox"/> EVALUATING CLEANUP ALTERNATIVES				
REMEDIAL ACTION	CHECK APPROPRIATE ACTION(S) (SEE BACK FOR DETAILS)				
	<input type="checkbox"/> CAP SITE (CD)		<input type="checkbox"/> EXCAVATE & DISPOSE (ED)		<input type="checkbox"/> REMOVE FREE PRODUCT (FP)
<input type="checkbox"/> CONTAINMENT BARRIER (CB)		<input type="checkbox"/> EXCAVATE & TREAT (ET)		<input type="checkbox"/> PUMP & TREAT GROUNDWATER (GT)	
<input type="checkbox"/> TREATMENT AT HOOKUP (HU)		<input type="checkbox"/> NO ACTION REQUIRED (NA)		<input type="checkbox"/> ENHANCED BIO DEGRADATION (IT)	
				<input type="checkbox"/> REPLACE SUPPLY (RS)	
				<input type="checkbox"/> OTHER (OT)	
COMMENTS	_____				

**ALLCAL**

PROPERTY SERVICES

ENVIRONMENTAL INVESTIGATIONS • HOME INSPECTIONS

TO: BARNEY CHAN

FROM: JOHN MRAKOVICH

1/26/96

WE ARE SENDING YOU  ATTACHED  UNDER SEPARATE COVER  
VIA \_\_\_\_\_ THE FOLLOWING ITEMS:

- LETTER(S)       PROPOSAL(S)       TABLE(S)       FIGURE(S)
- SPECIFICATION(S)       CHANGE ORDER(S)       REPORT(S)
- \_\_\_\_\_

COPIES	DATED	DESCRIPTION
1		SHELL PLOT PLAN - 2001 FRUITVALE AVE

THESE ARE TRANSMITTED FOR:

- YOUR REVIEW AND COMMENT
- YOUR REQUEST
- YOUR APPROVAL
- \_\_\_\_\_
- YOUR FILES
- APPROVED AS SUBMITTED
- APPROVED AS NOTED

REMARKS: \_\_\_\_\_  
\_\_\_\_\_  
\_\_\_\_\_  
\_\_\_\_\_  
\_\_\_\_\_

CC: \_\_\_\_\_  
\_\_\_\_\_

SIGNATURE: \_\_\_\_\_

61-8-118 62-210-96  
NOV 29 1995  
7:30 AM

ALAMEDA COUNTY  
HEALTH CARE SERVICES

AGENCY

DAVID J. KEARS, Agency Director



RAFAT A. SHAHID, Assistant Agency Director

January 25, 1996  
StID # 5806

Mr. Fidel Casillas  
2094 Harrington Ave.  
Oakland CA 94601

Alameda County CC4580  
Environmental Health Services  
1131 Harbor Bay Pkwy., #250  
Alameda CA 94502-6577  
(510)567-6700 FAX(510)337-9335

**Re: Request for Groundwater Investigation at 2001 Fruitvale Ave.,  
Oakland CA 94601**

Dear Mr. Casillas:

Our office has recently received and reviewed a January 18, 1996 report from All Cal Property Services, prepared by John Mrakovich. This report gave the results of soil and groundwater sampling from five exploratory borings at this site. Although our office's information is limited to the contents of this report, it appears that there has been a release of petroleum hydrocarbon from the former underground fuel tanks at this site. Because of this verified release, this site has been transferred to the Local Oversight Program (LOP) Division of Alameda County Environmental Health. You should have been notified of this through a **Notice of Requirement to Reimburse** letter recently sent to your attention.

As a result of this petroleum release, you are required to complete the enclosed Unauthorized Release (Leak) Report (ULR) and return it to our office **within 10 days of its receipt.**

Additionally, you are requested to provide all documents describing previous hazardous materials storage, use and disposal at this site. Referenced in this report is a plot plan of Shell Oil Company which shows former tank locations. Please submit a copy of this plan at a minimum.

You are also required to submit a work plan for the installation of monitoring well(s) to determine the magnitude and extent of the groundwater contamination coming from this site. If groundwater gradient cannot be inferred from existing data from neighboring sites, at least three wells must be installed. Other areas of soil investigation may be required if there is a lack of information regarding past tank removals at this site. Please provide this work plan **within 45 days or by March 11, 1996.**

Note that since your site was immediately transferred to the Local Oversight Program, billing of all time spent on this site will come from the State Water Resources Control Board (SWRCB). You are also encouraged to contact the SWRCB Cleanup Fund at (916) 227-4529 to determine your eligibility for the Cleanup

Mr. F. Casillas  
StID # 5806, 2001 Fruitvale Ave.  
January 25, 1996  
Page 2.

Fund. This fund was designed to help individuals and businesses finance the majority of their expense incurred while investigating and remediating petroleum releases from underground storage tanks.

You may contact me at (510) 567-6765 if you have any questions.

Sincerely,



Barney M. Chan  
Hazardous Materials Specialist

enclosure

c: J. Mrakovich, All Cal Property Services, 27973 High Country Drive, Hayward, CA 94542-2530

sk Ms. K. Kenny, Trump, Alioto, Trump & Prescott, Fremont Office Center, 39300 Civic Center Drive, Suite 360, Fremont, CA 94538

G. Coleman, file  
wp2001F

TRUMP, ALIOTO, TRUMP & PRESCOTT  
ATTORNEYS AT LAW

2280 UNION STREET  
SAN FRANCISCO, CALIFORNIA 94123  
(415) 563-7200

TELEFAX (415) 346-0679

FREMONT OFFICE CENTER  
39300 CIVIC CENTER DRIVE, SUITE 360  
FREMONT, CALIFORNIA 94538  
(510) 790-0900

TELEFAX (510) 790-4856

January 24, 1996

PLEASE REPLY TO:

Fremont

Barney Chan  
Alameda County Health Agency  
1131 Harbor Bay Pkwy., 2nd Fl.  
Alameda, CA 94502

Via Facsimile  
510-337-9335  
and U.S. Mail

Re: Subject Property - 2001 Fruitvale Avenue, Oakland  
All Cal site investigation report for Fidel Casillas

Dear Mr. Chan:

John Mrakovich, All Cal Property Services, told me that he delivered the above-referenced report to you this afternoon but that before you can read the report you must receive written authorization for you to charge \$90/hour to do so. Also, he informed me that it rarely takes you more than one hour to read such reports.

Please consider this that authorization and send any bill for your time to my office. Please reference Fidel Casillas and 2001 Fruitvale Avenue, Oakland on all bills.

Mr. Makrovich also informed me that he has tentatively scheduled a meeting with you in your office on January 31, 1996 at 11:30 a.m.

Thank you for your cooperation and assistance and please call me if you have any questions or comments.

Very truly yours,

TRUMP, ALIOTO, TRUMP & PRESCOTT

  
KELLY S. KENNY

KSK/wpc

cc: John Mrakovich  
Fidel Casillas  
Manuel Uribe

UPDATED 3/31/00

Press [ESC] for the menu

UNDERGROUND STORAGE TANK CLEANUP SITE

LOP:A-Tremov:--SLIC:--

SITE ID: 5806	SOURCE OF FUNDS: F	SUBSTANCE :12034
SITE NAME: Fidel Casillas		DATE REPORTED :01/24/1996
SITE ADDRESS: 2001 -0 Fruitvale Ave		DATE CONFIRMED:01/24/1996
CITY: Oakland	ZIP CODE: 94601	MULTIPLE RPs : Y

CASE TYPE: O CONTRACT STAT: 4 PRIORITY: 3B2 DATE ER:-0-

RP SEARCH : S		DATE END: 01/25/1996
PRELIM ASSESSMENT : -	DATE BEGIN: -0-	DATE END: -0-
REMEDIAL INVEST : -	DATE BEGIN: -0-	DATE END: -0-
REMEDIAL ACTION : -	DATE BEGIN: -0-	DATE END: -0-
POST REMED MONITOR: -	DATE BEGIN: -0-	DATE END: -0-

ENFORCEMENT TYPE: 1	DATE ENFORCEMENT ACTION TAKEN: 01/25/1996
LUFT CATEGORY: HSCA	CASE CLOSED: - DATE CASE CLOSED: -0-
DT EXC START : -0-	REMEDIAL ACTIONS TAKEN: ED

PgDn for Screen #2

[ESC] Done [F2] Clear field [Shift-F2] Clear to end [Shift-F10] More  
 Form: SITE Table: SITE Field: Source Page: 1

STID: 5806

UNDERGROUND STORAGE TANK CLEANUP SITE - SCREEN #2

IN-HOUSE MANAGEMENT:

RISK ASSESSMENT :-0-	LOC-CleanUp Fund? -0-
DATE LAST CORSP :08/13/1999	INSPECTOR INIT: BC

CONTACT/RESPONSIBLE PARTY INFORMATION:

RP #1: CONTACT: Mr. Fidel Casillas	RP COST: \$0.00
RP COMPANY NAME: -0-	Ph: -0-
ADDRESS: 2094 Harrington Ave.	
CITY/ST/ZIP: Oakland C A 94601	

COMMENT: MTBE=ND from grab groundwater samples, three permanent wells a re scheduled for installation (4/00)

PgUp For Screen #1;PgDn For More RP'S

[ESC] Done [F2] Clear field [Shift-F2] Clear to end [Shift-F10] More  
 Form: SITE Table: SITE Field: FlagDate Page: 2

RP seq#: 2-9

ADDITIONAL RP'S -SCREEN # 3

RP #2		
CONTACT NAME: Ms. Karen Petryna		Ph: -0-
COMPANY NAME: Equiva Services L L C		



ADDRESS: P. O. Box 7869  
CITY/ST/ZIP: Burbank C A 91501-7869

RP #

CONTACT NAME:  
COMPANY NAME:  
ADDRESS:  
CITY/ST/ZIP:

Ph:

RP #

CONTACT NAME:  
COMPANY NAME:  
ADDRESS:  
CITY/ST/ZIP:

Ph:

PgUp for Screen #2;

<F7>/<F8> for Next / Previous RP

[ESC] Done [F2] Clear field

[Shift-F2] Clear to end [Shift-F10] More

Form: SITE Table: RPs

Field: RPseq# Page: 3

TRUMP, ALIOTO, TRUMP & PRESCOTT  
ATTORNEYS AT LAW

2280 UNION STREET  
SAN FRANCISCO, CALIFORNIA 94123  
(415) 563-7200

TELEFAX (415) 346-0679

FREMONT OFFICE CENTER  
39300 CIVIC CENTER DRIVE, SUITE 360  
FREMONT, CALIFORNIA 94538  
(510) 790-0900

TELEFAX (510) 790-4856

FAX TRANSMITTAL

PLEASE REPLY TO: **Fremont Office**

**TO:** Barney Chan **Date:** January 24, 1996

**FROM:** Ms. Kelly S. Kenny **Fax No.:** 510-337-9335

**RE:** 2001 Fruitvale Avenue, Oakland - ALL CAL Site Investigation Report

**TOTAL PAGES (INCLUDING THIS PAGE):** 2

**DOCUMENT(S) BEING SENT TO YOU:** Letter of even date authorizing you to read the site investigation report and to charge this firm \$90/hr to do so.

Fax Operator

**SENDER'S COMMENTS:**

**[ ] IF CHECKED, PLEASE SIGN BELOW AND FAX THIS COVER SHEET ONLY TO US AT (510) 790-4856, IN ORDER TO CONFIRM RECEIPT OF THIS TRANSMISSION.**

**Received by:** \_\_\_\_\_ **Date:** \_\_\_\_\_

**IF THERE ARE ANY PROBLEMS WITH THIS TRANSMISSION, PLEASE TELEPHONE US IMMEDIATELY AT (510) 790-0900. THANK YOU.**

**Note: The information contained in this fax is attorney privileged and confidential, intended only for the use of the individual named above. If the reader of this message is not the intended recipient, please understand that any dissemination, distribution or copying of this communication is strictly prohibited. If you have received this communication in error, PLEASE IMMEDIATELY NOTIFY US BY TELEPHONE, and return the original message to us at the address listed above, via U. S. Postal Service. Thank you.**

**TRUMP, ALIOTO, TRUMP & PRESCOTT**  
ATTORNEYS AT LAW2280 UNION STREET  
SAN FRANCISCO, CALIFORNIA 94123  
(415) 563-7200

TELEFAX (415) 346-0679

FREMONT OFFICE CENTER  
39300 CIVIC CENTER DRIVE, SUITE 360  
FREMONT, CALIFORNIA 94538  
(510) 790-0900

TELEFAX (510) 790-4856

January 24, 1996

PLEASE REPLY TO:

Fremont

Barney Chan  
Alameda County Health Agency  
1131 Harbor Bay Pkwy., 2nd Fl.  
Alameda, CA 94502Via Facsimile  
510-337-9335  
and U.S. MailRe: Subject Property - 2001 Fruitvale Avenue, Oakland  
All Cal site investigation report for Fidel Casillas

Dear Mr. Chan:

John Mrakovich, All Cal Property Services, told me that he delivered the above-referenced report to you this afternoon but that before you can read the report you must receive written authorization for you to charge \$90/hour to do so. Also, he informed me that it rarely takes you more than one hour to read such reports.

Please consider this that authorization and send any bill for your time to my office. Please reference Fidel Casillas and 2001 Fruitvale Avenue, Oakland on all bills.

Mr. Makrovich also informed me that he has tentatively scheduled a meeting with you in your office on January 31, 1996 at 11:30 a.m.

Thank you for your cooperation and assistance and please call me if you have any questions or comments.

Very truly yours,

TRUMP, ALIOTO, TRUMP &amp; PRESCOTT

  
KELLY S. KENNY

KSK/wpc

cc: John Mrakovich  
Fidel Casillas  
Manuel Uribe

Assessor's Record

Fidel + Dolores Casillas  
2094 Harrington Ave Oak 94601

FAY