

RECEIVED

By dehloptoxic at 9:11 am, Feb 08, 2007



Denis L. Brown

Shell Oil Products US

Jerry Wickham
Alameda County Health Care Services Agency
1131 Harbor Bay Parkway, Suite 250
Alameda, California 94502-6577

HSE -- Environmental Services
20945 S. Wilmington Ave.
Carson, CA 90810-1039
Tel (707) 865 0251
Fax (707) 865 2542
Email denis.l.brown@shell.com

Re: Shell-branded Service Station
230 West MacArthur Boulevard
Oakland, California
SAP Code 135676
Incident No. 98995741
ACHCSA Case No. RO0000303

Dear Mr. Wickham:

The attached document is provided for your review and comment. Upon information and belief, I declare, under penalty of perjury, that the information contained in the attached document is true and correct.

If you have any questions or concerns, please call me at (707) 865-0251.

Sincerely,

A handwritten signature in black ink that reads "Denis L. Brown". The signature is fluid and cursive, with a long horizontal line extending to the right.

Denis L. Brown
Project Manager

February 7, 2007

Mr. Jerry Wickham
Alameda County Health Care Services Agency
1131 Harbor Bay Parkway, Suite 250
Alameda, California 94502-6577

Re: **Groundwater Monitoring Report – Fourth Quarter 2006**
Shell-branded Service Station
230 West MacArthur Boulevard
Oakland, California
SAP Code 135676
Incident No. 98995741
ACHCSA Case No. RO0000303



Dear Mr. Wickham:

Cambria Environmental Technology, Inc. (Cambria) prepared this report on behalf of Equilon Enterprises LLC dba Shell Oil Products US (Shell) in accordance with the quarterly reporting requirements of 23 CCR 2652d.

If you have any questions regarding the contents of this document, please call Dennis Baertschi at (707) 268-3813.

Sincerely,
Cambria Environmental Technology, Inc.

Dennis Baertschi
Project Geologist

Ana Friel, PG
Associate Geologist

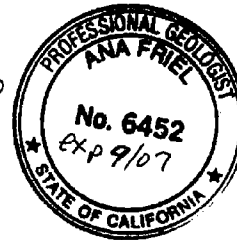

Enclosure: Groundwater Monitoring Report – Fourth Quarter 2006

**Cambria
Environmental
Technology, Inc.**

cc: Denis Brown, Shell
Bruce Ruttger, Stellar Environmental Solutions, 2198 6th Street, Berkeley, CA 94710

19449 Riverside Drive
Suite 230
Sonoma, CA 95476
Tel (707) 935-4850
Fax (707) 935-6649

C A M B R I A

GROUNDWATER MONITORING REPORT – FOURTH QUARTER 2006

Site Address	<u>230 West MacArthur Boulevard,</u> <u>Oakland</u>
Site Use	<u>Shell-branded Service Station</u>
Shell Project Manager	<u>Denis Brown</u>
Consultant and Contact Person	<u>Cambria, Dennis Baertschi</u>
Lead Agency and Contact	<u>ACHCSA, Jerry Wickham</u>
Agency Case No.	<u>RO0000303</u>
Shell SAP Code	<u>135676</u>
Shell Incident No.	<u>98995741</u>
Date of Most Recent Agency Correspondence	<u>January 20, 2006</u>



Current Quarter's Activities

1. Blaine Tech Services, Inc. (Blaine) gauged and sampled wells according to the established monitoring program for this site.
2. Cambria prepared a vicinity map (Figure 1) and a groundwater contour and chemical concentration map (Figure 2). The Blaine report, presenting the analytical data, is included in Attachment A.
3. Groundwater sampling was coordinated with sampling at the adjacent Oakland Auto Works site located at 240 West MacArthur Boulevard. The report for this site, presenting groundwater elevations and laboratory analytical data, is included in Attachment B.

Current Quarter's Findings

Groundwater Flow Direction	<u>Westerly</u>
Hydraulic Gradient	<u>0.01</u>
Depth to Water	<u>13.05 to 14.60 feet below top of well casing</u>

Proposed Activities for Next Quarter

1. Blaine will gauge and sample select wells during the third month of the quarter, according to the established monitoring program for this site.

C A M B R I A

Figures: 1 - Vicinity Map
2 - Groundwater Contour and Chemical Concentration Map

Attachment: A - Blaine Tech Services, Inc. - Groundwater Monitoring Report
B - Groundwater Monitoring Data – 240 West MacArthur



Cambria Environmental Technology, Inc. (Cambria) prepared this document for use by our client and appropriate regulatory agencies. It is based partially on information available to Cambria from outside sources and/or in the public domain, and partially on information supplied by Cambria and its subcontractors. Cambria makes no warranty or guarantee, expressed or implied, included or intended in this document, with respect to the accuracy of information obtained from these outside sources or the public domain, or any conclusions or recommendations based on information that was not independently verified by Cambria. This document represents the best professional judgment of Cambria. None of the work performed hereunder constitutes or shall be represented as a legal opinion of any kind or nature.

K:\Oakland 230 MacArthur\QM\2006\4Q06\230 W MacArthur Oakland 4Q06 Text.doc

EXPLANATION

- 1 ⊖ Unknown well
- H Hospital
- S School
- C Church
- ★ Subject site
- Study area

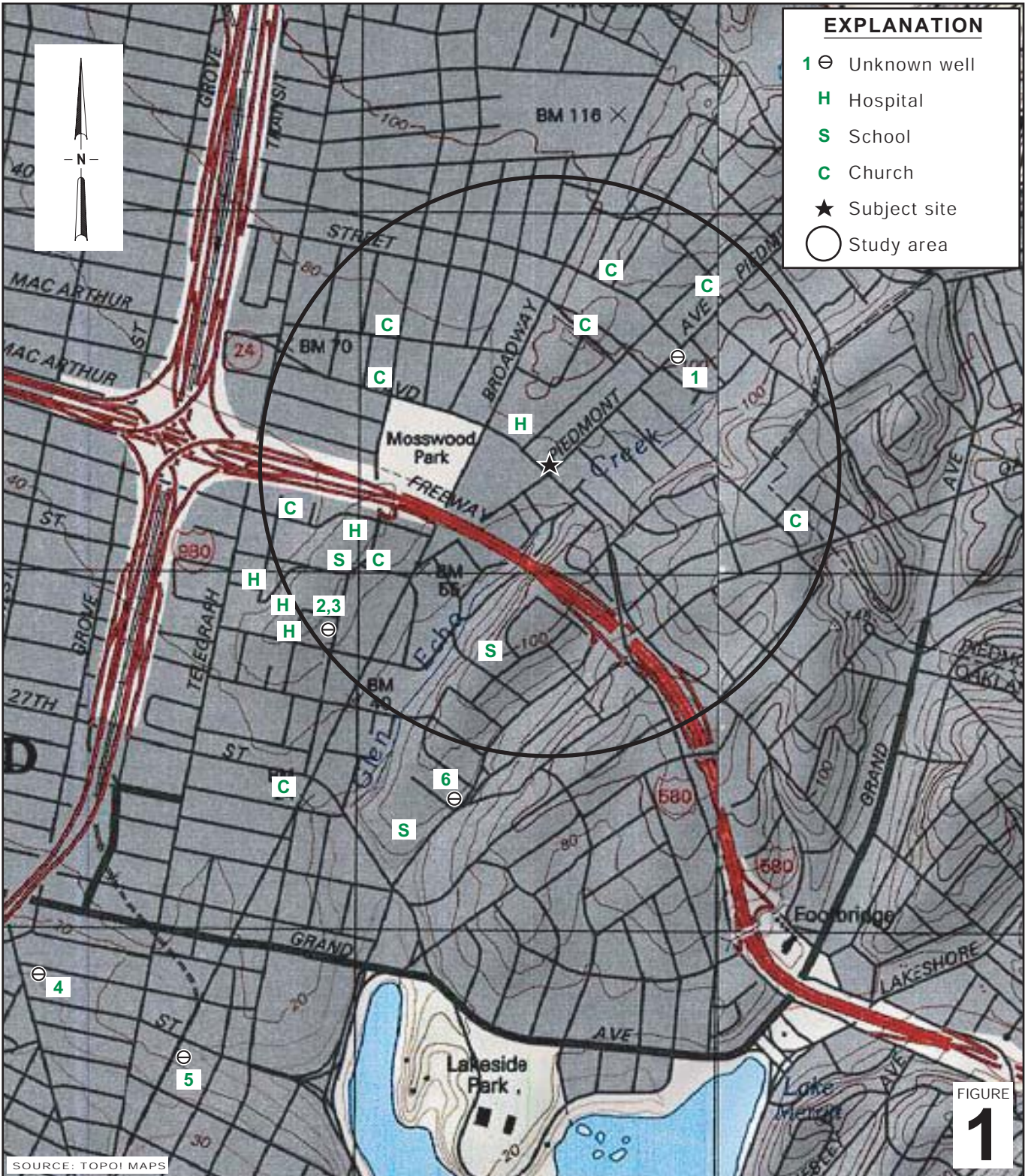
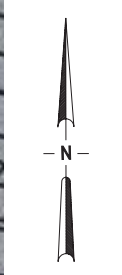

G:\OAKLAND\230MACARTHUR\FIGURES\VIC-WELL-SURVEY.AI

SOURCE: TOPO! MAPS

FIGURE
1

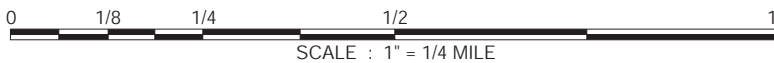

Shell-branded Service Station

230 West MacArthur Boulevard
Oakland, California
Incident No.9899574



C A M B R I A

Vicinity Map

(1/2-Mile Radius)



FIGURE 2

EXPLANATION

- SB-4 ● Soil boring location (4/4-6/06)
- SB-9 ⊕ Proposed soil boring location, uncompleted
- MW-1 ◆ Monitoring well location (Shell, 7/11-12/88)
- MW-1 ✦ Monitoring well location (240 W. MacArthur)
- Storm drain line (SD) ———
- Sanitary sewer line (SS) - - - - -
- Water line (W) ———
- Gas line (G) ———
- Electrical line (E) - - - - -
- Telecommunications line (T) ———
- Flow direction ►
- Storm drain inlet [Symbol]
- FL Flow line elevation, in feet above mean sea level
- fbg Feet below grade
- Product dispenser number
- Groundwater flow direction and gradient [Symbol]
- Groundwater elevation contour, in feet above mean sea level (msl), approximately located, dashed where inferred
- Well [Symbol]
- ELEV Groundwater elevation, in feet above msl
- Benzene MTBE Benzene and MTBE concentrations are in parts per billion and are analyzed by EPA Method 8260

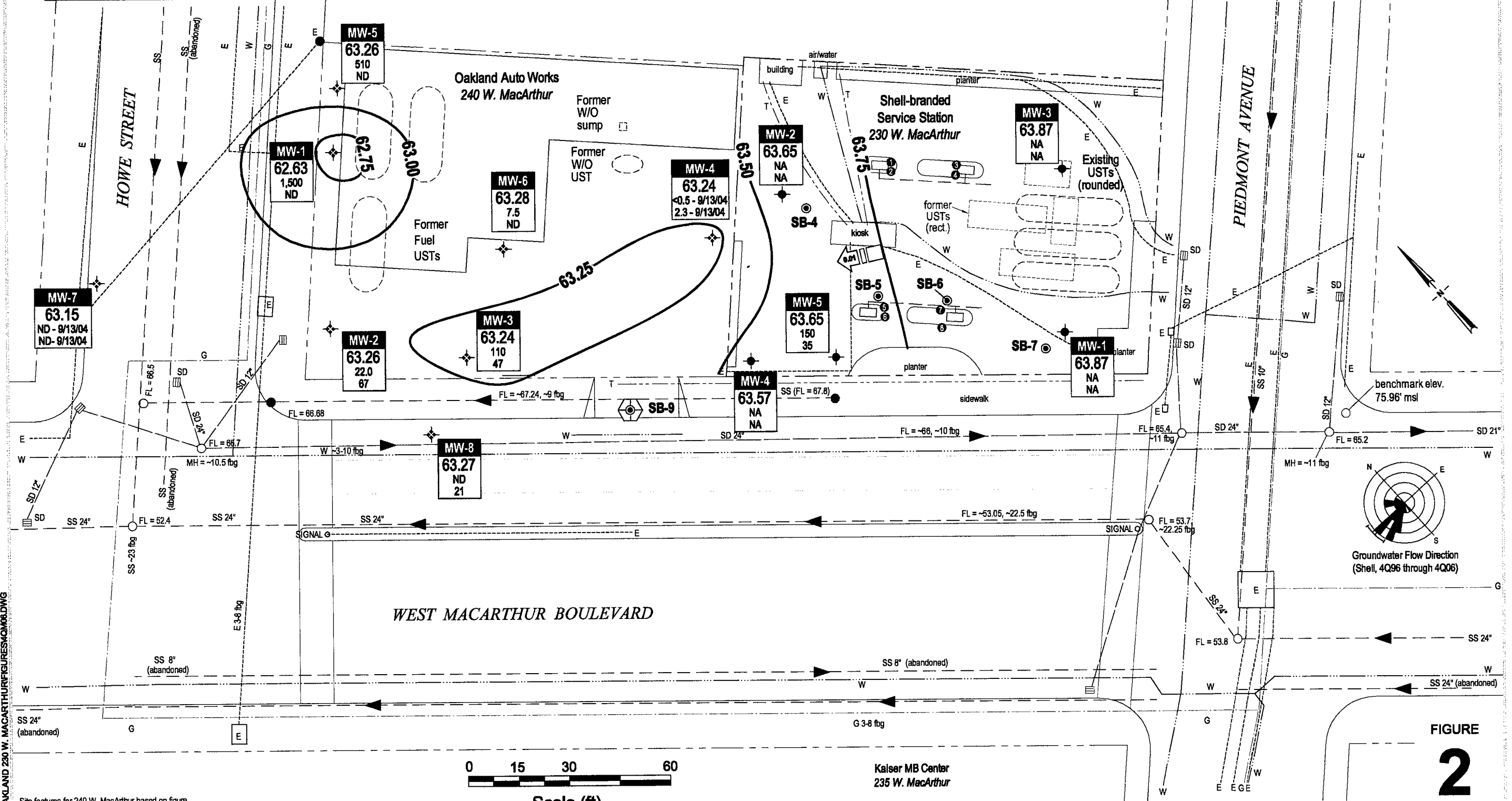

K:\OAKLAND 230 W. MACARTHUR\FIGURES\M08.DWG

Site features for 240 W. MacArthur based on figure provided by Stellar Environmental Solutions, Inc.

Attachment A

**Blaine Tech Services, Inc.
Groundwater Monitoring Report**

BLAINE
TECH SERVICES INC.

GROUNDWATER SAMPLING SPECIALISTS
SINCE 1985

January 10, 2007

Denis Brown
Shell Oil Products US
20945 South Wilmington Avenue
Carson, CA 90810

Fourth Quarter 2006 Groundwater Monitoring at
Shell-branded Service Station
230 West MacArthur Boulevard
Oakland, CA

Monitoring performed on December 26, 2006

Groundwater Monitoring Report **061226-DW-4**

This report covers the routine monitoring of groundwater wells at this Shell-branded facility. In accordance with standard procedures that conform to Regional Water Quality Control Board requirements, routine field data collection includes depth to water, total well depth, thickness of any separate immiscible layer, water column volume, calculated purge volume (if applicable), elapsed evacuation time (if applicable), total volume of water removed (if applicable), and standard water parameter instrument readings. Sample material is collected, contained, stored, and transported to the laboratory in conformance with EPA standards. Purgewater (if applicable) is, likewise, collected and transported to the Martinez Refining Company.

Basic field information is presented alongside analytical values excerpted from the laboratory report in the cumulative table of **WELL CONCENTRATIONS**. The full analytical report for the most recent samples and the field data sheets are attached to this report.

At a minimum, Blaine Tech Services, Inc. field personnel are certified on completion of a forty-hour Hazardous Materials and Emergency Response training course per 29 CFR 1910.120. Field personnel are also enrolled in annual eight-hour refresher courses.

Blaine Tech Services, Inc. conducts sampling and documentation assignments of this type as an independent third party. Our activities at this site consisted of objective data and sample collection only. No interpretation of analytical results, defining of hydrological conditions or formulation of recommendations was performed.

Please call if you have any questions.

Yours truly,

Mike Ninokata
Project Manager

MN/ks

attachments: Cumulative Table of WELL CONCENTRATIONS
Certified Analytical Report
Field Data Sheets

cc: Dennis Baertschi
Cambria Environmental Technology, Inc.
19449 Riverside Dr., Suite 230
Sonoma, CA 95476

WELL CONCENTRATIONS
Shell-branded Service Station
230 West MacArthur Boulevard
Oakland, CA

Well ID	Date	TPPH (ug/L)	B (ug/L)	T (ug/L)	E (ug/L)	X (ug/L)	MTBE 8020 (ug/L)	MTBE 8260 (ug/L)	DIPE (ug/L)	ETBE (ug/L)	TAME (ug/L)	TBA (ug/L)	1,2- DCA (ug/L)	EDB (ug/L)	TOC (MSL)	Depth to Water (ft.)	GW Elevation (MSL)
MW-1	07/14/1988	ND	ND	ND	ND	ND	NA	NA	NA	NA	NA	NA	NA	NA	73.89	13.30	60.59
MW-1	10/04/1988	ND	8	4.3	ND	9	NA	NA	NA	NA	NA	NA	NA	NA	73.89	13.65	60.24
MW-1	11/10/1988	ND	ND	ND	ND	ND	NA	NA	NA	NA	NA	NA	NA	NA	73.89	13.55	60.34
MW-1	12/09/1988	ND	ND	ND	ND	ND	NA	NA	NA	NA	NA	NA	NA	NA	73.89	13.22	60.67
MW-1	01/10/1989	ND	ND	ND	ND	NA	NA	NA	NA	NA	NA	NA	NA	NA	73.89	12.86	61.03
MW-1	01/20/1989	ND	ND	NA	NA	ND	NA	NA	NA	NA	NA	NA	NA	NA	73.89	12.91	60.98
MW-1	02/06/1989	ND	ND	ND	ND	ND	NA	NA	NA	NA	NA	NA	NA	NA	73.89	12.94	60.95
MW-1	03/10/1989	ND	ND	ND	ND	ND	NA	NA	NA	NA	NA	NA	NA	NA	73.89	12.59	61.30
MW-1	06/06/1989	ND	ND	ND	ND	ND	NA	NA	NA	NA	NA	NA	NA	NA	73.89	14.05	59.84
MW-1	09/07/1989	ND	ND	ND	ND	ND	NA	NA	NA	NA	NA	NA	NA	NA	73.89	14.92	58.97
MW-1	12/18/1989	ND	ND	ND	ND	ND	NA	NA	NA	NA	NA	NA	NA	NA	73.89	14.88	59.01
MW-1	03/08/1990	ND	ND	ND	ND	ND	NA	NA	NA	NA	NA	NA	NA	NA	73.89	14.08	59.81
MW-1	06/07/1990	ND	ND	ND	ND	ND	NA	NA	NA	NA	NA	NA	NA	NA	73.89	13.89	60.00
MW-1	09/05/1990	ND	ND	ND	ND	ND	NA	NA	NA	NA	NA	NA	NA	NA	73.89	14.83	59.06
MW-1	12/03/1990	ND	ND	ND	ND	ND	NA	NA	NA	NA	NA	NA	NA	NA	73.89	15.05	58.84
MW-1	03/01/1991	ND	ND	ND	ND	ND	NA	NA	NA	NA	NA	NA	NA	NA	73.89	14.34	59.55
MW-1	06/03/1991	ND	ND	ND	ND	ND	NA	NA	NA	NA	NA	NA	NA	NA	73.89	14.16	59.73
MW-1	09/04/1991	ND	ND	ND	ND	ND	NA	NA	NA	NA	NA	NA	NA	NA	73.89	14.60	59.29
MW-1	03/13/1992	ND	ND	ND	ND	ND	NA	NA	NA	NA	NA	NA	NA	NA	73.89	13.40	60.49
MW-1	06/03/1992	ND	ND	ND	ND	ND	NA	NA	NA	NA	NA	NA	NA	NA	73.89	13.76	60.13
MW-1	08/19/1992	87	ND	ND	ND	ND	NA	NA	NA	NA	NA	NA	NA	NA	73.89	14.57	59.32
MW-1	11/16/1992	ND	ND	ND	ND	ND	NA	NA	NA	NA	NA	NA	NA	NA	73.89	14.78	59.11
MW-1	02/18/1993	59 a	ND	ND	ND	ND	NA	NA	NA	NA	NA	NA	NA	NA	73.89	12.14	61.75
MW-1	06/01/1993	ND	ND	ND	ND	ND	NA	NA	NA	NA	NA	NA	NA	NA	73.89	13.30	60.59
MW-1	08/30/1993	ND	ND	ND	ND	ND	NA	NA	NA	NA	NA	NA	NA	NA	73.89	14.32	59.57
MW-1	12/13/1993	ND	ND	ND	ND	ND	NA	NA	NA	NA	NA	NA	NA	NA	73.89	14.06	59.83
MW-1	03/03/1994	100	ND	ND	ND	ND	NA	NA	NA	NA	NA	NA	NA	NA	73.89	13.12	60.77

WELL CONCENTRATIONS
Shell-branded Service Station
230 West MacArthur Boulevard
Oakland, CA

Well ID	Date	TPPH (ug/L)	B (ug/L)	T (ug/L)	E (ug/L)	X (ug/L)	MTBE 8020 (ug/L)	MTBE 8260 (ug/L)	DIPE (ug/L)	ETBE (ug/L)	TAME (ug/L)	TBA (ug/L)	1,2- DCA (ug/L)	EDB (ug/L)	TOC (MSL)	Depth to Water (ft.)	GW Elevation (MSL)
MW-1	06/06/1994	ND	ND	ND	ND	ND	NA	NA	NA	NA	NA	NA	NA	NA	73.89	14.20	59.69
MW-1	09/12/1994	ND	ND	ND	ND	ND	NA	NA	NA	NA	NA	NA	NA	NA	73.89	15.72	58.17
MW-1	12/15/1994	ND	ND	ND	ND	ND	NA	NA	NA	NA	NA	NA	NA	NA	73.89	12.98	60.91
MW-1	3/13/1995 b	60	4.7	9.8	ND	2.9	NA	NA	NA	NA	NA	NA	NA	NA	73.89	11.74	62.15
MW-1	04/21/1995	ND	ND	ND	ND	ND	NA	NA	NA	NA	NA	NA	NA	NA	73.89	NA	NA
MW-1	06/26/1995	ND	ND	ND	ND	ND	NA	NA	NA	NA	NA	NA	NA	NA	73.89	13.00	60.89
MW-1	09/12/1995	ND	ND	ND	ND	ND	NA	NA	NA	NA	NA	NA	NA	NA	73.89	14.14	59.75
MW-1	03/21/1996	<50	<0.5	<0.5	<0.5	<0.5	ND	NA	NA	NA	NA	NA	NA	NA	73.89	11.03	62.86
MW-1	06/28/1996	<50	<0.5	<0.5	<0.5	<0.5	<2.5	NA	NA	NA	NA	NA	NA	NA	73.89	13.53	60.36
MW-1	09/19/1996	<50	<0.5	<0.5	<0.5	<0.5	<2.5	NA	NA	NA	NA	NA	NA	NA	73.89	14.33	59.56
MW-1	12/19/1996	NA	NA	NA	NA	NA	NA	NA	NA	NA	NA	NA	NA	NA	73.89	13.20	60.69
MW-1	12/05/1997	NA	NA	NA	NA	NA	NA	NA	NA	NA	NA	NA	NA	NA	73.89	12.39	61.50
MW-1	12/24/1998	NA	NA	NA	NA	NA	NA	NA	NA	NA	NA	NA	NA	NA	73.89	13.59	60.30
MW-1	12/23/1999	NA	NA	NA	NA	NA	NA	NA	NA	NA	NA	NA	NA	NA	73.89	15.63	58.26
MW-1	12/11/2000	NA	NA	NA	NA	NA	NA	NA	NA	NA	NA	NA	NA	NA	73.89	15.36	58.53
MW-1	12/27/2001	NA	NA	NA	NA	NA	NA	NA	NA	NA	NA	NA	NA	NA	73.89	12.09	61.80
MW-1	03/12/2002	NA	NA	NA	NA	NA	NA	NA	NA	NA	NA	NA	NA	NA	73.89	12.33	61.56
MW-1	03/14/2002	<50	<0.50	<0.50	<0.50	<0.50	NA	<5.0	NA	NA	NA	NA	NA	NA	73.89	12.08	61.81
MW-1	06/13/2002	NA	NA	NA	NA	NA	NA	NA	NA	NA	NA	NA	NA	NA	73.89	13.47	60.42
MW-1	09/09/2002	NA	NA	NA	NA	NA	NA	NA	NA	NA	NA	NA	NA	NA	76.92	14.30	62.62
MW-1	12/12/2002	NA	NA	NA	NA	NA	NA	NA	NA	NA	NA	NA	NA	NA	76.92	14.48	62.44
MW-1	03/10/2003	<50	<0.50	<0.50	<0.50	<0.50	NA	<5.0	NA	NA	NA	NA	NA	NA	76.92	12.76	64.16
MW-1	06/10/2003	NA	NA	NA	NA	NA	NA	NA	NA	NA	NA	NA	NA	NA	76.92	13.17	63.75
MW-1	09/16/2003	NA	NA	NA	NA	NA	NA	NA	NA	NA	NA	NA	NA	NA	76.92	14.10	62.82
MW-1	12/03/2003	NA	NA	NA	NA	NA	NA	NA	NA	NA	NA	NA	NA	NA	76.92	13.93	62.99
MW-1	03/11/2004	<50	<0.50	<0.50	<0.50	<1.0	NA	<0.50	NA	NA	NA	NA	NA	NA	76.92	12.04	64.88
MW-1	06/17/2004	NA	NA	NA	NA	NA	NA	NA	NA	NA	NA	NA	NA	NA	76.92	13.75	63.17
MW-1	09/13/2004	NA	NA	NA	NA	NA	NA	NA	NA	NA	NA	NA	NA	NA	76.92	14.47	62.45

WELL CONCENTRATIONS
Shell-branded Service Station
230 West MacArthur Boulevard
Oakland, CA

Well ID	Date	TPPH (ug/L)	B (ug/L)	T (ug/L)	E (ug/L)	X (ug/L)	MTBE 8020 (ug/L)	MTBE 8260 (ug/L)	DIPE (ug/L)	ETBE (ug/L)	TAME (ug/L)	TBA (ug/L)	1,2- DCA (ug/L)	EDB (ug/L)	TOC (MSL)	Depth to Water (ft.)	GW Elevation (MSL)
---------	------	----------------	-------------	-------------	-------------	-------------	------------------------	------------------------	----------------	----------------	----------------	---------------	-----------------------	---------------	--------------	----------------------------	--------------------------

MW-1	12/07/2004	NA	NA	NA	NA	NA	NA	NA	NA	NA	NA	NA	NA	NA	76.92	13.04	63.88
MW-1	03/03/2005	<50	<0.50	<0.50	<0.50	<1.0	NA	<0.50	<2.0	<2.0	<2.0	<5.0	NA	NA	76.92	11.31	65.61
MW-1	06/14/2005	NA	NA	NA	NA	NA	NA	NA	NA	NA	NA	NA	NA	NA	76.92	11.87	65.05
MW-1	09/19/2005	NA	NA	NA	NA	NA	NA	NA	NA	NA	NA	NA	NA	NA	76.92	13.91	63.01
MW-1	03/30/2006	<50.0	<0.500	<0.500	<0.500	<0.500	NA	<0.500	NA	NA	NA	NA	<0.500	<0.500	76.92	10.60	66.32
MW-1	09/27/2006	NA	NA	NA	NA	NA	NA	NA	NA	NA	NA	NA	NA	NA	76.92	14.06	62.86
MW-1	09/28/2006	<50.0	<0.500	<0.500	<0.500	<0.500	NA	<0.500	<0.500	<0.500	<0.500	<10.0	NA	NA	76.92	NA	NA
MW-1	12/26/2006	NA	NA	NA	NA	NA	NA	NA	NA	NA	NA	NA	NA	NA	76.92	13.05	63.87

MW-2	07/14/1988	ND	7.9	2.6	1.1	4	NA	NA	NA	NA	NA	NA	NA	NA	75.24	15.18	60.06
MW-2	10/04/1988	90	ND	1.3	2.3	12	NA	NA	NA	NA	NA	NA	NA	NA	75.24	15.30	59.94
MW-2	11/10/1988	ND	ND	ND	ND	2	NA	NA	NA	NA	NA	NA	NA	NA	75.24	15.17	60.07
MW-2	12/09/1988	ND	ND	0.6	ND	3	NA	NA	NA	NA	NA	NA	NA	NA	75.24	14.82	60.42
MW-2	01/20/1989	ND	ND	ND	ND	ND	NA	NA	NA	NA	NA	NA	NA	NA	75.24	14.54	60.70
MW-2	02/06/1989	NA	ND	ND	ND	ND	NA	NA	NA	NA	NA	NA	NA	NA	75.24	14.59	60.65
MW-2	03/10/1989	ND	ND	ND	ND	ND	NA	NA	NA	NA	NA	NA	NA	NA	75.24	14.88	60.36
MW-2	06/06/1989	ND	ND	0.5	ND	ND	NA	NA	NA	NA	NA	NA	NA	NA	75.24	15.30	59.94
MW-2	09/07/1989	ND	ND	ND	ND	ND	NA	NA	NA	NA	NA	NA	NA	NA	75.24	16.76	58.48
MW-2	12/18/1989	ND	ND	ND	ND	ND	NA	NA	NA	NA	NA	NA	NA	NA	75.24	16.65	58.59
MW-2	03/08/1990	ND	ND	ND	ND	ND	NA	NA	NA	NA	NA	NA	NA	NA	75.24	15.92	59.32
MW-2	06/07/1990	ND	ND	ND	ND	ND	NA	NA	NA	NA	NA	NA	NA	NA	75.24	16.10	59.14
MW-2	09/05/1990	ND	ND	ND	ND	ND	NA	NA	NA	NA	NA	NA	NA	NA	75.24	16.61	58.63
MW-2	12/03/1990	ND	ND	ND	ND	ND	NA	NA	NA	NA	NA	NA	NA	NA	75.24	17.06	58.18
MW-2	03/01/1991	ND	ND	ND	ND	ND	NA	NA	NA	NA	NA	NA	NA	NA	75.24	16.62	58.62
MW-2	06/03/1991	ND	ND	ND	ND	ND	NA	NA	NA	NA	NA	NA	NA	NA	75.24	16.65	58.59
MW-2	09/04/1991	ND	ND	ND	ND	ND	NA	NA	NA	NA	NA	NA	NA	NA	75.24	16.57	58.67
MW-2	03/13/1992	ND	ND	ND	ND	ND	NA	NA	NA	NA	NA	NA	NA	NA	75.24	14.66	60.58
MW-2	06/03/1992	ND	ND	ND	ND	ND	NA	NA	NA	NA	NA	NA	NA	NA	75.24	15.90	59.34

WELL CONCENTRATIONS
Shell-branded Service Station
230 West MacArthur Boulevard
Oakland, CA

Well ID	Date	TPPH (ug/L)	B (ug/L)	T (ug/L)	E (ug/L)	X (ug/L)	MTBE 8020 (ug/L)	MTBE 8260 (ug/L)	DIPE (ug/L)	ETBE (ug/L)	TAME (ug/L)	TBA (ug/L)	1,2- DCA (ug/L)	EDB (ug/L)	TOC (MSL)	Depth to Water (ft.)	GW Elevation (MSL)
MW-2	08/19/1992	67	ND	ND	ND	ND	NA	NA	NA	NA	NA	NA	NA	NA	75.24	16.72	58.52
MW-2	11/16/1992	50	ND	ND	ND	1.2	NA	NA	NA	NA	NA	NA	NA	NA	75.24	16.66	58.58
MW-2	02/18/1993	52 a	ND	ND	ND	ND	NA	NA	NA	NA	NA	NA	NA	NA	75.24	13.88	61.36
MW-2 (D)	02/18/1993	52 a	ND	ND	ND	ND	NA	NA	NA	NA	NA	NA	NA	NA	75.24	13.88	61.36
MW-2	06/01/1993	ND	ND	ND	ND	ND	NA	NA	NA	NA	NA	NA	NA	NA	75.24	14.74	60.50
MW-2	08/30/1993	70 a	ND	ND	ND	ND	NA	NA	NA	NA	NA	NA	NA	NA	75.24	15.85	59.39
MW-2	12/13/1993	68 a	ND	ND	ND	ND	NA	NA	NA	NA	NA	NA	NA	NA	75.24	15.83	59.41
MW-2	03/03/1994	280 a	ND	ND	ND	ND	NA	NA	NA	NA	NA	NA	NA	NA	75.24	14.80	60.44
MW-2	06/06/1994	ND	ND	ND	ND	ND	NA	NA	NA	NA	NA	NA	NA	NA	75.24	16.65	58.59
MW-2	09/12/1994	ND	ND	ND	ND	ND	NA	NA	NA	NA	NA	NA	NA	NA	75.24	16.72	58.52
MW-2	12/15/1994	230 a	ND	ND	ND	ND	NA	NA	NA	NA	NA	NA	NA	NA	75.24	15.25	59.99
MW-2	03/13/1995	ND	2.9	6.3	ND	2.7	NA	NA	NA	NA	NA	NA	NA	NA	75.24	15.32	59.92
MW-2	04/21/1995	ND	ND	ND	ND	ND	NA	NA	NA	NA	NA	NA	NA	NA	75.24	NA	NA
MW-2	06/26/1995	ND	ND	ND	ND	ND	NA	NA	NA	NA	NA	NA	NA	NA	75.24	14.65	60.59
MW-2	09/12/1995	ND	ND	ND	ND	ND	NA	NA	NA	NA	NA	NA	NA	NA	75.24	15.78	59.46
MW-2	03/21/1996	<50	<0.5	<0.5	<0.5	<0.5	ND	NA	NA	NA	NA	NA	NA	NA	75.24	12.72	62.52
MW-2	06/28/1996	<50	<0.5	<0.5	<0.5	<0.5	160	NA	NA	NA	NA	NA	NA	NA	75.24	14.95	60.29
MW-2	09/19/1996	<50	<0.5	<0.5	<0.5	<0.5	27	NA	NA	NA	NA	NA	NA	NA	75.24	15.64	59.60
MW-2	12/19/1996	NA	NA	NA	NA	NA	NA	NA	NA	NA	NA	NA	NA	NA	75.24	14.47	60.77
MW-2	12/05/1997	NA	NA	NA	NA	NA	NA	NA	NA	NA	NA	NA	NA	NA	75.24	14.22	61.02
MW-2	12/24/1998	NA	NA	NA	NA	NA	NA	NA	NA	NA	NA	NA	NA	NA	75.24	14.97	60.27
MW-2	12/23/1999	NA	NA	NA	NA	NA	NA	NA	NA	NA	NA	NA	NA	NA	75.24	16.07	59.17
MW-2	12/11/2000	NA	NA	NA	NA	NA	NA	NA	NA	NA	NA	NA	NA	NA	75.24	15.78	59.46
MW-2	12/27/2001	NA	NA	NA	NA	NA	NA	95	NA	NA	NA	NA	NA	NA	75.24	14.25	60.99
MW-2	03/14/2002	120	<0.50	<0.50	<0.50	<0.50	NA	31	NA	NA	NA	NA	NA	NA	75.24	14.59	60.65
MW-2	06/13/2002	100	<0.50	<0.50	<0.50	<0.50	NA	32	NA	NA	NA	NA	NA	NA	75.24	14.58	60.66
MW-2	09/09/2002	90	<0.50	<0.50	<0.50	<0.50	NA	54	NA	NA	NA	NA	NA	NA	78.25	15.49	62.76
MW-2	12/12/2002	92	<0.50	<0.50	<0.50	<0.50	NA	21	NA	NA	NA	NA	NA	NA	78.25	16.21	62.04

WELL CONCENTRATIONS
Shell-branded Service Station
230 West MacArthur Boulevard
Oakland, CA

Well ID	Date	TPPH (ug/L)	B (ug/L)	T (ug/L)	E (ug/L)	X (ug/L)	MTBE 8020 (ug/L)	MTBE 8260 (ug/L)	DIPE (ug/L)	ETBE (ug/L)	TAME (ug/L)	TBA (ug/L)	1,2- DCA (ug/L)	EDB (ug/L)	TOC (MSL)	Depth to Water (ft.)	GW Elevation (MSL)
---------	------	----------------	-------------	-------------	-------------	-------------	------------------------	------------------------	----------------	----------------	----------------	---------------	-----------------------	---------------	--------------	----------------------------	--------------------------

MW-2	03/10/2003	110	<0.50	<0.50	<0.50	<0.50	NA	33	NA	NA	NA	NA	NA	NA	78.25	14.33	63.92
MW-2	06/10/2003	<50	<0.50	<0.50	<0.50	<1.0	NA	49	NA	NA	NA	NA	NA	NA	78.25	14.48	63.77
MW-2	09/16/2003	<50	<0.50	<0.50	<0.50	<1.0	NA	39	NA	NA	NA	NA	NA	NA	78.25	15.45	62.80
MW-2	12/03/2003	56 a	<0.50	<0.50	<0.50	<1.0	NA	3.6	NA	NA	NA	NA	NA	NA	78.25	15.60	62.65
MW-2	03/11/2004	58 a	<0.50	<0.50	<0.50	<1.0	NA	67	NA	NA	NA	NA	NA	NA	78.25	13.78	64.47
MW-2	06/17/2004	<50	<0.50	<0.50	<0.50	<1.0	NA	40	NA	NA	NA	NA	NA	NA	78.25	14.87	63.38
MW-2	09/13/2004	68 d	<0.50	<0.50	<0.50	<1.0	NA	44	<2.0	<2.0	<2.0	<5.0	NA	NA	78.25	15.85	62.40
MW-2	12/07/2004	<50 e	<0.50	<0.50	<0.50	<1.0	NA	54	NA	NA	NA	NA	NA	NA	78.25	15.17	63.08
MW-2	03/03/2005	110 e	<0.50	<0.50	<0.50	<1.0	NA	82	NA	NA	NA	NA	NA	NA	78.25	13.38	64.87
MW-2	06/14/2005	<50 e	<0.50	<0.50	<0.50	<1.0	NA	29	NA	NA	NA	NA	NA	NA	78.25	13.95	64.30
MW-2	09/19/2005	<50	<0.50	<0.50	<0.50	<1.0	NA	31	<2.0	<2.0	<2.0	5.6	NA	NA	78.25	14.78	63.47
MW-2	03/30/2006	<50.0	<0.500	<0.500	<0.500	<0.500	NA	39.1	NA	NA	NA	NA	<0.500	<0.500	78.25	11.60	66.65
MW-2	09/27/2006	NA	NA	NA	NA	NA	NA	NA	NA	NA	NA	NA	NA	NA	78.25	15.42	62.83
MW-2	09/28/2006	<50.0	<0.500	<0.500	<0.500	<0.500	NA	16.7	<0.500	<0.500	<0.500	<10.0	NA	NA	78.25	NA	NA
MW-2	12/26/2006	NA	NA	NA	NA	NA	NA	NA	NA	NA	NA	NA	NA	NA	78.25	14.60	63.65

MW-3	07/14/1988	ND	ND	ND	ND	ND	NA	NA	NA	NA	NA	NA	NA	NA	74.68	14.05	60.63
MW-3	10/04/1988	ND	ND	ND	ND	5	NA	NA	NA	NA	NA	NA	NA	NA	74.68	14.60	60.08
MW-3	11/10/1988	ND	ND	ND	ND	ND	NA	NA	NA	NA	NA	NA	NA	NA	74.68	14.35	60.33
MW-3	12/09/1988	ND	ND	ND	ND	ND	NA	NA	NA	NA	NA	NA	NA	NA	74.68	14.04	60.64
MW-3	01/10/1989	ND	ND	ND	ND	NA	NA	NA	NA	NA	NA	NA	NA	NA	74.68	13.70	60.98
MW-3	01/20/1989	NA	NA	ND	ND	ND	NA	NA	NA	NA	NA	NA	NA	NA	74.68	13.72	60.96
MW-3	02/06/1989	70	ND	ND	ND	ND	NA	NA	NA	NA	NA	NA	NA	NA	74.68	13.75	60.93
MW-3	03/10/1989	150	ND	ND	ND	ND	NA	NA	NA	NA	NA	NA	NA	NA	74.68	13.42	61.26
MW-3	06/06/1989	ND	ND	ND	ND	ND	NA	NA	NA	NA	NA	NA	NA	NA	74.68	14.52	60.16
MW-3	09/07/1989	ND	0.65	ND	ND	ND	NA	NA	NA	NA	NA	NA	NA	NA	74.68	15.52	59.16
MW-3	12/18/1989	46	1.3	ND	0.44	0.66	NA	NA	NA	NA	NA	NA	NA	NA	74.68	19.59	55.09
MW-3	03/08/1990	ND	ND	ND	ND	ND	NA	NA	NA	NA	NA	NA	NA	NA	74.68	14.72	59.96

WELL CONCENTRATIONS
Shell-branded Service Station
230 West MacArthur Boulevard
Oakland, CA

Well ID	Date	TPPH (ug/L)	B (ug/L)	T (ug/L)	E (ug/L)	X (ug/L)	MTBE 8020 (ug/L)	MTBE 8260 (ug/L)	DIPE (ug/L)	ETBE (ug/L)	TAME (ug/L)	TBA (ug/L)	1,2- DCA (ug/L)	EDB (ug/L)	TOC (MSL)	Depth to Water (ft.)	GW Elevation (MSL)
MW-3	06/07/1990	ND	ND	ND	ND	ND	NA	NA	NA	NA	NA	NA	NA	NA	74.68	14.65	60.03
MW-3	09/05/1990	ND	ND	ND	ND	ND	NA	NA	NA	NA	NA	NA	NA	NA	74.68	15.51	59.17
MW-3	12/03/1990	ND	ND	ND	ND	ND	NA	NA	NA	NA	NA	NA	NA	NA	74.68	14.85	59.83
MW-3	03/01/1991	1.9	59	ND	22	ND	NA	NA	NA	NA	NA	NA	NA	NA	74.68	14.92	59.76
MW-3	06/03/1991	ND	ND	ND	ND	ND	NA	NA	NA	NA	NA	NA	NA	NA	74.68	14.75	59.93
MW-3	09/04/1991	ND	ND	ND	ND	ND	NA	NA	NA	NA	NA	NA	NA	NA	74.68	15.14	59.54
MW-3	03/13/1992	ND	ND	ND	ND	ND	NA	NA	NA	NA	NA	NA	NA	NA	74.68	13.50	61.18
MW-3	06/03/1992	ND	ND	ND	ND	ND	NA	NA	NA	NA	NA	NA	NA	NA	74.68	14.39	60.29
MW-3	08/19/1992	92	ND	ND	ND	ND	NA	NA	NA	NA	NA	NA	NA	NA	74.68	15.08	59.60
MW-3 (D)	08/19/1992	76	ND	ND	ND	ND	NA	NA	NA	NA	NA	NA	NA	NA	74.68	15.08	59.60
MW-3	11/16/1992	200 a	ND	ND	ND	ND	NA	NA	NA	NA	NA	NA	NA	NA	74.68	15.43	59.25
MW-3 (D)	11/16/1992	140 a	ND	ND	ND	ND	NA	NA	NA	NA	NA	NA	NA	NA	74.68	15.43	59.25
MW-3	02/18/1993	680 a	ND	ND	ND	ND	NA	NA	NA	NA	NA	NA	NA	NA	74.68	12.96	61.72
MW-3	06/01/1993	160 a	ND	ND	ND	ND	NA	NA	NA	NA	NA	NA	NA	NA	74.68	13.98	60.70
MW-3 (D)	06/01/1993	150 a	ND	ND	ND	ND	NA	NA	NA	NA	NA	NA	NA	NA	74.68	13.98	60.70
MW-3	08/30/1993	110 a	ND	ND	ND	ND	NA	NA	NA	NA	NA	NA	NA	NA	74.68	14.82	59.86
MW-3	12/13/1993	140 a	ND	ND	ND	ND	NA	NA	NA	NA	NA	NA	NA	NA	74.68	14.70	59.98
MW-3 (D)	12/13/1993	110 a	ND	ND	ND	ND	NA	NA	NA	NA	NA	NA	NA	NA	74.68	14.70	59.98
MW-3	03/03/1994	61 a	ND	ND	ND	ND	NA	NA	NA	NA	NA	NA	NA	NA	74.68	13.92	60.76
MW-3	06/06/1994	ND	ND	ND	ND	ND	NA	NA	NA	NA	NA	NA	NA	NA	74.68	14.73	59.95
MW-3	09/12/1994	ND	ND	ND	ND	ND	NA	NA	NA	NA	NA	NA	NA	NA	74.68	15.42	59.26
MW-3	12/15/1994	ND	ND	0.9	ND	0.6	NA	NA	NA	NA	NA	NA	NA	NA	74.68	13.80	60.88
MW-3	03/13/1995	100 a	7.9	17	0.7	6.1	NA	NA	NA	NA	NA	NA	NA	NA	74.68	12.41	62.27
MW-3	04/21/1995	60	0.9	1.1	ND	1	NA	NA	NA	NA	NA	NA	NA	NA	74.68	NA	NA
MW-3	06/26/1995	ND	ND	ND	ND	ND	NA	NA	NA	NA	NA	NA	NA	NA	74.68	13.79	60.89
MW-3	09/12/1995 b	ND	ND	ND	ND	ND	NA	NA	NA	NA	NA	NA	NA	NA	74.68	14.77	59.91
MW-3	03/21/1996	<50	<0.5	<0.5	<0.5	<0.5	17	NA	NA	NA	NA	NA	NA	NA	74.68	11.80	62.88
MW-3	06/28/1996	<50	<0.5	<0.5	<0.5	<0.5	<0.5	NA	NA	NA	NA	NA	NA	NA	74.68	14.19	60.49

WELL CONCENTRATIONS
Shell-branded Service Station
230 West MacArthur Boulevard
Oakland, CA

Well ID	Date	TPPH (ug/L)	B (ug/L)	T (ug/L)	E (ug/L)	X (ug/L)	MTBE 8020 (ug/L)	MTBE 8260 (ug/L)	DIPE (ug/L)	ETBE (ug/L)	TAME (ug/L)	TBA (ug/L)	1,2- DCA (ug/L)	EDB (ug/L)	TOC (MSL)	Depth to Water (ft.)	GW Elevation (MSL)
MW-3	09/19/1996	<50	<0.5	<0.5	<0.5	<0.5	<2.5	NA	NA	NA	NA	NA	NA	NA	74.68	14.85	59.83
MW-3	12/19/1996	NA	NA	NA	NA	NA	NA	NA	NA	NA	NA	NA	NA	NA	74.68	13.61	61.07
MW-3	12/05/1997	NA	NA	NA	NA	NA	NA	NA	NA	NA	NA	NA	NA	NA	74.68	13.16	61.52
MW-3	12/24/1998	NA	NA	NA	NA	NA	NA	NA	NA	NA	NA	NA	NA	NA	74.68	14.08	60.60
MW-3	12/23/1999	NA	NA	NA	NA	NA	NA	NA	NA	NA	NA	NA	NA	NA	74.68	15.92	58.76
MW-3	12/11/2000	NA	NA	NA	NA	NA	NA	NA	NA	NA	NA	NA	NA	NA	74.68	15.31	59.37
MW-3	12/27/2001	NA	NA	NA	NA	NA	NA	NA	NA	NA	NA	NA	NA	NA	74.68	12.84	61.84
MW-3	03/12/2002	NA	NA	NA	NA	NA	NA	NA	NA	NA	NA	NA	NA	NA	74.68	12.54	62.14
MW-3	03/14/2002	<50	<0.50	<0.50	<0.50	<0.50	NA	40	NA	NA	NA	NA	NA	NA	74.68	12.78	61.90
MW-3	06/13/2002	NA	NA	NA	NA	NA	NA	NA	NA	NA	NA	NA	NA	NA	74.68	14.06	60.62
MW-3	09/09/2002	NA	NA	NA	NA	NA	NA	NA	NA	NA	NA	NA	NA	NA	77.69	14.77	62.92
MW-3	12/12/2002	NA	NA	NA	NA	NA	NA	NA	NA	NA	NA	NA	NA	NA	77.69	15.11	62.58
MW-3	03/10/2003	<50	<0.50	<0.50	<0.50	<0.50	NA	5.4	NA	NA	NA	NA	NA	NA	77.69	13.52	64.17
MW-3	06/10/2003	NA	NA	NA	NA	NA	NA	NA	NA	NA	NA	NA	NA	NA	77.69	13.82	63.87
MW-3	09/16/2003	NA	NA	NA	NA	NA	NA	NA	NA	NA	NA	NA	NA	NA	77.69	14.60	63.09
MW-3	12/03/2003	NA	NA	NA	NA	NA	NA	NA	NA	NA	NA	NA	NA	NA	77.69	14.53	63.16
MW-3	03/11/2004	<50	<0.50	<0.50	<0.50	<1.0	NA	3.5	NA	NA	NA	NA	NA	NA	77.69	12.38	65.31
MW-3	06/17/2004	NA	NA	NA	NA	NA	NA	NA	NA	NA	NA	NA	NA	NA	77.69	14.28	63.41
MW-3	09/13/2004	NA	NA	NA	NA	NA	NA	NA	NA	NA	NA	NA	NA	NA	77.69	14.78	62.91
MW-3	12/07/2004	NA	NA	NA	NA	NA	NA	NA	NA	NA	NA	NA	NA	NA	77.69	13.77	63.92
MW-3	03/03/2005	120	1.3	<0.50	<0.50	2.7	NA	2.3	<2.0	<2.0	<2.0	37	NA	NA	77.69	11.84	65.85
MW-3	06/14/2005	NA	NA	NA	NA	NA	NA	NA	NA	NA	NA	NA	NA	NA	77.69	12.29	65.40
MW-3	09/19/2005	NA	NA	NA	NA	NA	NA	NA	NA	NA	NA	NA	NA	NA	77.69	14.33	63.36
MW-3	03/30/2006	<50.0	<0.500	<0.500	<0.500	<0.500	NA	1.72	NA	NA	NA	NA	<0.500	<0.500	77.69	10.30	67.39
MW-3	09/27/2006	NA	NA	NA	NA	NA	NA	NA	NA	NA	NA	NA	NA	NA	77.69	14.62	63.07
MW-3	09/28/2006	610	<0.500	<0.500	<0.500	<0.500	NA	2.83	<0.500	<0.500	<0.500	<10.0	NA	NA	77.69	NA	NA
MW-3	12/26/2006	NA	NA	NA	NA	NA	NA	NA	NA	NA	NA	NA	NA	NA	77.69	13.82	63.87

WELL CONCENTRATIONS
Shell-branded Service Station
230 West MacArthur Boulevard
Oakland, CA

Well ID	Date	TPPH (ug/L)	B (ug/L)	T (ug/L)	E (ug/L)	X (ug/L)	MTBE 8020 (ug/L)	MTBE 8260 (ug/L)	DIPE (ug/L)	ETBE (ug/L)	TAME (ug/L)	TBA (ug/L)	1,2- DCA (ug/L)	EDB (ug/L)	TOC (MSL)	Depth to Water (ft.)	GW Elevation (MSL)
MW-4	01/23/1990	1,600	100	10	30	20	NA	NA	NA	NA	NA	NA	NA	NA	73.83	14.68	59.15
MW-4	03/08/1990	4,200	260	18	88	39	NA	NA	NA	NA	NA	NA	NA	NA	73.83	14.38	59.45
MW-4	06/07/1990	2,000	150	6.9	14	17	NA	NA	NA	NA	NA	NA	NA	NA	73.83	14.27	59.56
MW-4	09/05/1990	1,700	130	10	7.2	19	NA	NA	NA	NA	NA	NA	NA	NA	73.83	15.40	58.43
MW-4	12/03/1990	2,600	108	41	17	59	NA	NA	NA	NA	NA	NA	NA	NA	73.83	15.90	57.93
MW-4	06/03/1991	2,800	160	15	8.8	32	NA	NA	NA	NA	NA	NA	NA	NA	73.83	14.60	59.23
MW-4	09/04/1991	Sheen	NA	NA	NA	NA	NA	NA	NA	NA	NA	NA	NA	NA	73.83	15.25	58.58
MW-4	03/13/1992	2,700	180	70	5.9	29	NA	NA	NA	NA	NA	NA	NA	NA	73.83	12.72	61.11
MW-4	06/03/1992	1,700	190	ND	30	23	NA	NA	NA	NA	NA	NA	NA	NA	73.83	14.33	59.50
MW-4	08/19/1992	170	4.2	ND	0.6	1	NA	NA	NA	NA	NA	NA	NA	NA	73.83	15.18	58.65
MW-4	11/16/1992	2,600	92	49	50	81	NA	NA	NA	NA	NA	NA	NA	NA	73.83	15.39	58.44
MW-4	02/18/1993	7,400	120	38	51	87	NA	NA	NA	NA	NA	NA	NA	NA	73.83	12.62	61.21
MW-4	06/01/1993	7,000	1,800	1,700	1,600	1,700	NA	NA	NA	NA	NA	NA	NA	NA	73.83	13.68	60.15
MW-4	08/30/1993	2,100	80	11	ND	11	NA	NA	NA	NA	NA	NA	NA	NA	73.83	14.83	59.00
MW-4 (D)	08/30/1993	2,100	77	5.6	ND	5.5	NA	NA	NA	NA	NA	NA	NA	NA	73.83	14.83	59.00
MW-4	12/13/1993	2,000 a	20	ND	21	52	NA	NA	NA	NA	NA	NA	NA	NA	73.83	14.50	59.33
MW-4	03/03/1994	3,500	150	86	85	90	NA	NA	NA	NA	NA	NA	NA	NA	73.83	13.48	60.35
MW-4 (D)	03/03/1994	3,200	130	73	74	76	NA	NA	NA	NA	NA	NA	NA	NA	73.83	13.48	60.35
MW-4	06/06/1994	590	25	ND	ND	ND	NA	NA	NA	NA	NA	NA	NA	NA	73.83	14.26	59.57
MW-4 (D)	06/06/1994	400	16	ND	ND	ND	NA	NA	NA	NA	NA	NA	NA	NA	73.83	14.26	59.57
MW-4	09/12/1994	1,800	42	ND	3.7	4.7	NA	NA	NA	NA	NA	NA	NA	NA	73.83	15.42	58.41
MW-4 (D)	09/12/1994	2,000	40	ND	5.7	8	NA	NA	NA	NA	NA	NA	NA	NA	73.83	15.42	58.41
MW-4	12/15/1994	2,900	78	14	94	17	NA	NA	NA	NA	NA	NA	NA	NA	73.83	13.43	60.40
MW-4 (D)	12/15/1994	2,900	90	7	96	18	NA	NA	NA	NA	NA	NA	NA	NA	73.83	13.43	60.40
MW-4	03/13/1995	2,700	240	24	99	34	NA	NA	NA	NA	NA	NA	NA	NA	73.83	12.13	61.70
MW-4 (D)	03/13/1995	2,500	300	24	140	28	NA	NA	NA	NA	NA	NA	NA	NA	73.83	12.13	61.70
MW-4	06/25/1995	2,100	87	10	67	25	NA	NA	NA	NA	NA	NA	NA	NA	73.83	13.26	60.57
MW-4 (D)	06/25/1995	2,300	92	12	74	26	NA	NA	NA	NA	NA	NA	NA	NA	73.83	13.26	60.57

WELL CONCENTRATIONS
Shell-branded Service Station
230 West MacArthur Boulevard
Oakland, CA

Well ID	Date	TPPH (ug/L)	B (ug/L)	T (ug/L)	E (ug/L)	X (ug/L)	MTBE 8020 (ug/L)	MTBE 8260 (ug/L)	DIPE (ug/L)	ETBE (ug/L)	TAME (ug/L)	TBA (ug/L)	1,2- DCA (ug/L)	EDB (ug/L)	TOC (MSL)	Depth to Water (ft.)	GW Elevation (MSL)
MW-4	09/12/1995 b	1,300	33	13	9.3	15	NA	NA	NA	NA	NA	NA	NA	NA	73.83	14.64	59.19
MW-4 (D)	09/12/1995 b	1,500	2.1	16	11	17	NA	NA	NA	NA	NA	NA	NA	NA	73.83	14.64	59.19
MW-4	03/21/1996	2,100	50	3.2	40	5.4	ND	NA	NA	NA	NA	NA	NA	NA	73.83	11.55	62.28
MW-4 (D)	03/21/1996	1,700	24	<0.5	39	7.2	740	NA	NA	NA	NA	NA	NA	NA	73.83	11.55	62.28
MW-4	06/28/1996	1,300	61	6.2	53	11	1,000	NA	NA	NA	NA	NA	NA	NA	73.83	13.86	59.97
MW-4 (D)	06/28/1996	1,200	29	6.2	50	8.3	1,000	NA	NA	NA	NA	NA	NA	NA	73.83	13.86	59.97
MW-4	09/19/1996	820	12	<2.5	2.8	4.3	720	NA	NA	NA	NA	NA	NA	NA	73.83	14.72	59.11
MW-4 (D)	09/19/1996	580	9.6	<2.5	<2.5	<2.5	760	1,200	NA	NA	NA	NA	NA	NA	73.83	14.72	59.11
MW-4	12/19/1996	1,200	28	<5.0	<5.0	<5.0	<25	NA	NA	NA	NA	NA	NA	NA	73.83	13.06	60.77
MW-4	12/05/1997	1,900	36	9	16	18	630	NA	NA	NA	NA	NA	NA	NA	73.83	12.89	60.94
MW-4	12/24/1998	1,100	23	5.3	38	7.9	1,100	NA	NA	NA	NA	NA	NA	NA	73.83	13.92	59.91
MW-4	12/17/1999	1,100	22	21	13	11	3,800	3,200	NA	NA	NA	NA	NA	NA	73.83	14.28	59.55
MW-4	12/23/1999	NA	NA	NA	NA	NA	NA	NA	NA	NA	NA	NA	NA	NA	73.83	16.24	57.59
MW-4	12/11/2000	975	25.0	11.3	<5.00	<5.00	1,960	1,730 c	NA	NA	NA	NA	NA	NA	73.83	14.15	59.68
MW-4	12/27/2001	2,000	9.9	<5.0	18	<5.0	NA	1,400	NA	NA	NA	NA	NA	NA	73.83	12.61	61.22
MW-4	03/14/2002	1,700	6.6	<2.0	2.1	2.1	NA	1,100	NA	NA	NA	NA	NA	NA	73.83	12.35	61.48
MW-4	06/13/2002	1,200	4.7	<2.0	<2.0	<2.0	NA	1,100	NA	NA	NA	NA	NA	NA	73.83	13.72	60.11
MW-4	09/09/2002	620	3.7	<2.0	<2.0	<2.0	NA	760	NA	NA	NA	NA	NA	NA	76.82	14.56	62.26
MW-4	12/12/2002	1,500	3.9	<2.0	<2.0	<2.0	NA	880	NA	NA	NA	NA	NA	NA	76.82	14.82	62.00
MW-4	03/10/2003	2,300	5.7	0.95	3.8	0.63	NA	1,200	NA	NA	NA	NA	NA	NA	76.82	13.63	63.19
MW-4	06/10/2003	2,200	5.3	<5.0	<5.0	<10	NA	880	NA	NA	NA	NA	NA	NA	76.82	13.68	63.14
MW-4	09/16/2003	1,400	<5.0	<5.0	<5.0	<10	NA	420	NA	NA	NA	NA	NA	NA	76.82	14.35	62.47
MW-4	12/03/2003	2,600	5.0	<5.0	<5.0	<10	NA	840	NA	NA	NA	NA	NA	NA	76.82	14.27	62.55
MW-4	03/11/2004	1,900 a	6.3	<5.0	<5.0	<10	NA	800	NA	NA	NA	NA	NA	NA	76.82	12.62	64.20
MW-4	06/17/2004	1,000	7.4	<2.5	<2.5	<5.0	NA	460	NA	NA	NA	NA	NA	NA	76.82	13.90	62.92
MW-4	09/13/2004	1,100	4.6	<2.5	<2.5	<5.0	NA	300	<10	<10	<10	160	NA	NA	76.82	14.67	62.15
MW-4	12/07/2004	2,200	4.6	<2.5	<2.5	<5.0	NA	430	NA	NA	NA	NA	NA	NA	76.82	13.92	62.90
MW-4	03/03/2005	2,500	5.3	<2.5	<2.5	<5.0	NA	620	NA	NA	NA	NA	NA	NA	76.82	11.75	65.07

WELL CONCENTRATIONS
Shell-branded Service Station
230 West MacArthur Boulevard
Oakland, CA

Well ID	Date	TPPH (ug/L)	B (ug/L)	T (ug/L)	E (ug/L)	X (ug/L)	MTBE 8020 (ug/L)	MTBE 8260 (ug/L)	DIPE (ug/L)	ETBE (ug/L)	TAME (ug/L)	TBA (ug/L)	1,2- DCA (ug/L)	EDB (ug/L)	TOC (MSL)	Depth to Water (ft.)	GW Elevation (MSL)
---------	------	----------------	-------------	-------------	-------------	-------------	------------------------	------------------------	----------------	----------------	----------------	---------------	-----------------------	---------------	--------------	----------------------------	--------------------------

MW-4	06/14/2005	<50	<0.50	<0.50	<0.50	<1.0	NA	51	NA	NA	NA	NA	NA	NA	76.82	12.20	64.62
MW-4	09/19/2005	1,200	2.7	<0.50	<0.50	<1.0	NA	140	8.4	<2.0	<2.0	280	NA	NA	76.82	14.08	62.74
MW-4	03/30/2006	2,740	2.01	<0.500	<0.500	<0.500	NA	222	NA	NA	NA	NA	<0.500	<0.500	76.82	10.25	66.57
MW-4	09/27/2006	NA	NA	NA	NA	NA	NA	NA	NA	NA	NA	NA	NA	NA	76.82	14.18	62.64
MW-4	09/28/2006	1,660	0.950	<0.500	<0.500	<0.500	NA	73.3	6.92	<0.500	<0.500	77.0	NA	NA	76.82	NA	NA
MW-4	12/26/2006	NA	NA	NA	NA	NA	NA	NA	NA	NA	NA	NA	NA	NA	76.82	13.25	63.57

MW-5	09/22/2006	NA	NA	NA	NA	NA	NA	NA	NA	NA	NA	NA	NA	NA	76.97	14.21	62.76
MW-5	09/27/2006	NA	NA	NA	NA	NA	NA	NA	NA	NA	NA	NA	NA	NA	76.97	14.35	62.62
MW-5	09/28/2006	10,800	36.6	2.08	119	9.04	NA	15.1	3.61	<0.500	<0.500	<10.0	NA	NA	76.97	NA	NA
MW-5	12/26/2006	5,000	150	5.2	70	16	NA	35	NA	NA	NA	NA	NA	NA	76.97	13.32	63.65

WELL CONCENTRATIONS
Shell-branded Service Station
230 West MacArthur Boulevard
Oakland, CA

Well ID	Date	TPPH (ug/L)	B (ug/L)	T (ug/L)	E (ug/L)	X (ug/L)	MTBE 8020 (ug/L)	MTBE 8260 (ug/L)	DIPE (ug/L)	ETBE (ug/L)	TAME (ug/L)	TBA (ug/L)	1,2- DCA (ug/L)	EDB (ug/L)	TOC (MSL)	Depth to Water (ft.)	GW Elevation (MSL)
---------	------	----------------	-------------	-------------	-------------	-------------	------------------------	------------------------	----------------	----------------	----------------	---------------	-----------------------	---------------	--------------	----------------------------	--------------------------

Abbreviations:

TPPH = Total petroleum hydrocarbons as gasoline by EPA Method 8260B; prior to December 27, 2001, by EPA Method 8015.

BTEX = Benzene, toluene, ethylbenzene, xylenes by EPA Method 8260B; prior to December 27, 2001, by EPA Method 8020.

MTBE = Methyl tertiary butyl ether

DIPE = Di-isopropyl ether, analyzed by EPA Method 8260B

ETBE = Ethyl tertiary butyl ether, analyzed by EPA Method 8260B

TAME = Tertiary amyl methyl ether, analyzed by EPA Method 8260B

TBA = Tertiary butyl alcohol, analyzed by EPA Method 8260B

1,2-DCA = 1,2-Dichloroethane, analyzed by EPA Method 8260B

EDB = 1,2-Dibromoethane or Ethylene Dibromide, analyzed by EPA Method 8260B

TOC = Top of Casing Elevation

GW = Groundwater

ug/L = Parts per billion

MSL = Mean sea level

ft. = Feet

<n = Below detection limit

(D) = Duplicate sample

ND = Not detected at or above the quantitative limit.

NA = Not applicable

Notes:

a = Chromatogram pattern indicates the presence of an unidentified hydrocarbon/Hydrocarbon does not match pattern of laboratory's standard.

b = The laboratory noted the sample was analyzed after the method specified holding time.

c = This sample was analyzed outside of EPA recommended hold time.

d = Sample contains discrete peak in gasoline range.

e = The concentration reported reflects individual or discrete unidentified peaks not matching a typical fuel pattern.

Site surveyed January 30, 2002 by Virgil Chavez Land Surveying of Vallejo, CA.

Well MW-5 surveyed on May 10, 2006 by Virgil Chavez Land Surveying of Vallejo, CA.

8 January, 2007

Michael Ninokata
Blaine Tech Services (Shell)
1680 Rogers Avenue
San Jose, CA 95112

RE: 230 W. MacArthur Blvd, Oakland
Work Order: S612496

Enclosed are the results of analyses for samples received by the laboratory on 12/27/06 15:20. If you have any questions concerning this report, please feel free to contact me.

Sincerely,



Sylvia Krenn
Project Manager

CA ELAP Certificate # 2630

Blaine Tech Services (Shell) 1680 Rogers Avenue San Jose CA, 95112	Project: 230 W. MacArthur Blvd, Oakland Project Number: 98995741 Project Manager: Michael Ninokata	S612496 Reported: 01/08/07 01:02
--	--	---

ANALYTICAL REPORT FOR SAMPLES

Sample ID	Laboratory ID	Matrix	Date Sampled	Date Received
MW-5	S612496-01	Water	12/26/06 12:44	12/27/06 15:20

Blaine Tech Services (Shell)
1680 Rogers Avenue
San Jose CA, 95112

Project: 230 W. MacArthur Blvd, Oakland
Project Number: 98995741
Project Manager: Michael Ninokata

S612496
Reported:
01/08/07 01:02

Gasoline\BTEX\Oxygenates by GCMS\8260B
TestAmerica - Sacramento, CA

Analyte	Result	Reporting		Units	Dilution	Batch	Prepared	Analyzed	Method	Notes
		Limit								
MW-5 (S612496-01) Water Sampled: 12/26/06 12:44 Received: 12/27/06 15:20										
Methyl tert-butyl ether	35	0.50		ug/l	1	7010029	01/03/07	01/04/07	GCMS \ 8260B	
Benzene	150	0.50		"	"	"	"	"	"	
Ethylbenzene	70	0.50		"	"	"	"	"	"	
Toluene	5.2	0.50		"	"	"	"	"	"	
Xylenes (total)	16	1.0		"	"	"	"	"	"	
Gasoline Range Organics (C4-C12)	5000	50		"	"	"	"	"	"	
<i>Surrogate: 1,2-DCA-d4</i>		117 %		60-140		"	"	"	"	
<i>Surrogate: Toluene-d8</i>		112 %		60-140		"	"	"	"	
<i>Surrogate: 4-BFB</i>		107 %		60-140		"	"	"	"	

Blaine Tech Services (Shell)
1680 Rogers Avenue
San Jose CA, 95112

Project: 230 W. MacArthur Blvd, Oakland
Project Number: 98995741
Project Manager: Michael Ninokata

S612496
Reported:
01/08/07 01:02

Gasoline\BTEX\Oxygenates by GCMS\8260B - Quality Control
TestAmerica - Sacramento, CA

Analyte	Result	Reporting Limit	Units	Spike Level	Source Result	%REC	%REC Limits	RPD	RPD Limit	Notes
---------	--------	-----------------	-------	-------------	---------------	------	-------------	-----	-----------	-------

Batch 7010029 - EPA 5030B [P/T] / GCMS \ 8260B

Blank (7010029-BLK1)

Prepared: 01/03/07 Analyzed: 01/04/07

Ethanol	ND	50	ug/l							
Tert-butyl alcohol	ND	5.0	"							
Methyl tert-butyl ether	ND	0.50	"							
Di-isopropyl ether	ND	2.0	"							
Ethyl tert-butyl ether	ND	2.0	"							
Tert-amyl methyl ether	ND	2.0	"							
1,2-Dichloroethane	ND	0.50	"							
1,2-Dibromoethane (EDB)	ND	0.50	"							
Benzene	ND	0.50	"							
Ethylbenzene	ND	0.50	"							
Toluene	ND	0.50	"							
Xylenes (total)	ND	1.0	"							
Gasoline Range Organics (C4-C12)	ND	50	"							
<i>Surrogate: 1,2-DCA-d4</i>	<i>12.4</i>		<i>"</i>	<i>10.0</i>		<i>124</i>	<i>60-140</i>			
<i>Surrogate: Toluene-d8</i>	<i>9.24</i>		<i>"</i>	<i>10.0</i>		<i>92</i>	<i>60-140</i>			
<i>Surrogate: 4-BFB</i>	<i>9.95</i>		<i>"</i>	<i>10.0</i>		<i>100</i>	<i>60-140</i>			

Blank (7010029-BLK2)

Prepared & Analyzed: 01/04/07

Ethanol	ND	50	ug/l							
Tert-butyl alcohol	ND	5.0	"							
Methyl tert-butyl ether	ND	0.50	"							
Di-isopropyl ether	ND	2.0	"							
Ethyl tert-butyl ether	ND	2.0	"							
Tert-amyl methyl ether	ND	2.0	"							
1,2-Dichloroethane	ND	0.50	"							
1,2-Dibromoethane (EDB)	ND	0.50	"							
Benzene	ND	0.50	"							
Ethylbenzene	ND	0.50	"							
Toluene	ND	0.50	"							
Xylenes (total)	ND	1.0	"							
Gasoline Range Organics (C4-C12)	ND	50	"							
<i>Surrogate: 1,2-DCA-d4</i>	<i>10.6</i>		<i>"</i>	<i>10.0</i>		<i>106</i>	<i>60-140</i>			
<i>Surrogate: Toluene-d8</i>	<i>10.4</i>		<i>"</i>	<i>10.0</i>		<i>104</i>	<i>60-140</i>			
<i>Surrogate: 4-BFB</i>	<i>9.91</i>		<i>"</i>	<i>10.0</i>		<i>99</i>	<i>60-140</i>			

Blaine Tech Services (Shell)
1680 Rogers Avenue
San Jose CA, 95112

Project: 230 W. MacArthur Blvd, Oakland
Project Number: 98995741
Project Manager: Michael Ninokata

S612496
Reported:
01/08/07 01:02

Gasoline\BTEX\Oxygenates by GCMS\8260B - Quality Control
TestAmerica - Sacramento, CA

Analyte	Result	Reporting Limit	Units	Spike Level	Source Result	%REC	%REC Limits	RPD	RPD Limit	Notes
---------	--------	-----------------	-------	-------------	---------------	------	-------------	-----	-----------	-------

Batch 7010029 - EPA 5030B [P/T] / GCMS \ 8260B

Laboratory Control Sample (7010029-BS1)

Prepared: 01/03/07 Analyzed: 01/04/07

Methyl tert-butyl ether	38.4	0.50	ug/l	52.0		74	60-140			
Toluene	141	0.50	"	188		75	70-130			
Gasoline Range Organics (C4-C12)	2100	50	"	2200		95	70-130			
<i>Surrogate: 1,2-DCA-d4</i>	<i>11.1</i>		<i>"</i>	<i>10.0</i>		<i>111</i>	<i>60-140</i>			
<i>Surrogate: Toluene-d8</i>	<i>9.48</i>		<i>"</i>	<i>10.0</i>		<i>95</i>	<i>60-140</i>			
<i>Surrogate: 4-BFB</i>	<i>10.2</i>		<i>"</i>	<i>10.0</i>		<i>102</i>	<i>60-140</i>			

Laboratory Control Sample (7010029-BS2)

Prepared: 01/03/07 Analyzed: 01/04/07

Methyl tert-butyl ether	22.2	0.50	ug/l	20.0		111	60-140			
Benzene	20.4	0.50	"	20.0		102	70-130			
Toluene	18.1	0.50	"	20.0		90	70-130			
<i>Surrogate: 1,2-DCA-d4</i>	<i>12.0</i>		<i>"</i>	<i>10.0</i>		<i>120</i>	<i>60-140</i>			
<i>Surrogate: Toluene-d8</i>	<i>9.43</i>		<i>"</i>	<i>10.0</i>		<i>94</i>	<i>60-140</i>			
<i>Surrogate: 4-BFB</i>	<i>10.4</i>		<i>"</i>	<i>10.0</i>		<i>104</i>	<i>60-140</i>			

Laboratory Control Sample (7010029-BS3)

Prepared & Analyzed: 01/04/07

Methyl tert-butyl ether	31.6	0.50	ug/l	52.0		61	60-140			
Toluene	145	0.50	"	188		77	70-130			
Gasoline Range Organics (C4-C12)	2060	50	"	2200		94	70-130			
<i>Surrogate: 1,2-DCA-d4</i>	<i>10.9</i>		<i>"</i>	<i>10.0</i>		<i>109</i>	<i>60-140</i>			
<i>Surrogate: Toluene-d8</i>	<i>10.0</i>		<i>"</i>	<i>10.0</i>		<i>100</i>	<i>60-140</i>			
<i>Surrogate: 4-BFB</i>	<i>10.7</i>		<i>"</i>	<i>10.0</i>		<i>107</i>	<i>60-140</i>			

Laboratory Control Sample (7010029-BS4)

Prepared & Analyzed: 01/04/07

Methyl tert-butyl ether	18.7	0.50	ug/l	20.0		94	60-140			
Benzene	17.4	0.50	"	20.0		87	70-130			
Toluene	19.8	0.50	"	20.0		99	70-130			
<i>Surrogate: 1,2-DCA-d4</i>	<i>10.7</i>		<i>"</i>	<i>10.0</i>		<i>107</i>	<i>60-140</i>			
<i>Surrogate: Toluene-d8</i>	<i>10.2</i>		<i>"</i>	<i>10.0</i>		<i>102</i>	<i>60-140</i>			
<i>Surrogate: 4-BFB</i>	<i>10.4</i>		<i>"</i>	<i>10.0</i>		<i>104</i>	<i>60-140</i>			

Blaine Tech Services (Shell)
1680 Rogers Avenue
San Jose CA, 95112

Project: 230 W. MacArthur Blvd, Oakland
Project Number: 98995741
Project Manager: Michael Ninokata

S612496
Reported:
01/08/07 01:02

Gasoline\BTEX\Oxygenates by GCMS\8260B - Quality Control
TestAmerica - Sacramento, CA

Analyte	Result	Reporting Limit	Units	Spike Level	Source Result	%REC	%REC Limits	RPD	RPD Limit	Notes
---------	--------	-----------------	-------	-------------	---------------	------	-------------	-----	-----------	-------

Batch 7010029 - EPA 5030B [P/T] / GCMS \ 8260B

Matrix Spike (7010029-MS1)	Source: S612489-08			Prepared & Analyzed: 01/04/07						
Methyl tert-butyl ether	32.6	0.50	ug/l	52.0	ND	63	60-140			
Benzene	20.4	0.50	"	38.8	ND	53	70-130			M8
Toluene	150	0.50	"	188	ND	80	70-130			
Gasoline Range Organics (C4-C12)	2110	50	"	2200	39.9	94	60-140			
<i>Surrogate: 1,2-DCA-d4</i>	<i>10.2</i>		<i>"</i>	<i>10.0</i>		<i>102</i>	<i>60-140</i>			
<i>Surrogate: Toluene-d8</i>	<i>10.6</i>		<i>"</i>	<i>10.0</i>		<i>106</i>	<i>60-140</i>			
<i>Surrogate: 4-BFB</i>	<i>10.1</i>		<i>"</i>	<i>10.0</i>		<i>101</i>	<i>60-140</i>			
Matrix Spike Dup (7010029-MSD1)	Source: S612489-08			Prepared & Analyzed: 01/04/07						
Methyl tert-butyl ether	32.1	0.50	ug/l	52.0	ND	62	60-140	2	25	
Benzene	20.7	0.50	"	38.8	ND	53	70-130	1	25	M8
Toluene	151	0.50	"	188	ND	80	70-130	0.7	25	
Gasoline Range Organics (C4-C12)	2130	50	"	2200	39.9	95	60-140	0.9	25	
<i>Surrogate: 1,2-DCA-d4</i>	<i>10.5</i>		<i>"</i>	<i>10.0</i>		<i>105</i>	<i>60-140</i>			
<i>Surrogate: Toluene-d8</i>	<i>10.4</i>		<i>"</i>	<i>10.0</i>		<i>104</i>	<i>60-140</i>			
<i>Surrogate: 4-BFB</i>	<i>10.6</i>		<i>"</i>	<i>10.0</i>		<i>106</i>	<i>60-140</i>			

Blaine Tech Services (Shell)
1680 Rogers Avenue
San Jose CA, 95112

Project: 230 W. MacArthur Blvd, Oakland
Project Number: 98995741
Project Manager: Michael Ninokata

S612496
Reported:
01/08/07 01:02

Notes and Definitions

M8 The MS and/or MSD were below the acceptance limits. See Blank Spike (LCS).
DET Analyte DETECTED
ND Analyte NOT DETECTED at or above the reporting limit or MDL, if MDL is specified
NR Not Reported
dry Sample results reported on a dry weight basis
RPD Relative Percent Difference

- LAB:
- TA - Irvine, California
 - TA - Morgan Hill, California
 - TA - Sacramento, California
 - TA - Nashville, Tennessee
 - Calscience
 - Other _____



SHELL Chain Of Custody Record

NAME OF PERSON TO BILL: Denis Brown

ENVIRONMENTAL SERVICES CHECK BOX TO VERIFY IF NO INCIDENT # APPLIES

NETWORK DEV / FE BILL CONSULTANT

COMPLIANCE RMT/CRMT

INCIDENT # (ES ONLY): 9 8 9 9 5 7 4 1

DATE: 12-26-06

PAGE: 1 of 1

SAMPLING COMPANY: **Blaine Tech Services** LOG CODE: **BTSS**

ADDRESS: **1680 Rogers Avenue, San Jose, CA 95112**

PROJECT CONTACT (Hardcopy or PDF Report to): **Michael Ninokata**

TELEPHONE: **408-573-0555** FAX: **408-573-7771** E-MAIL: **mninokata@blainetech.com**

SITE ADDRESS: Street and City: **230 W. MacArthur Blvd., Oakland** State: **CA** GLOBAL ID NO.: **T0600101240**

EDF DELIVERABLE TO (Name, Company, Office Location): **Dennis Baertschi, Cambria, Sonoma Office** PHONE NO.: **(707) 268-3813** E-MAIL: **sonomaedf@cambria-env.com** CONSULTANT PROJECT NO.: **061226-0w-4**

SAMPLER NAME(S) (Print): **Dave Walter** LAB USE ONLY

TAT (STD IS 10 BUSINESS DAYS / RUSH IS CALENDAR DAYS): STD 5 DAY 3 DAY 2 DAY 24 HOURS RESULTS NEEDED ON WEEKEND

REQUESTED ANALYSIS: **S612496**

LA - RWQCB REPORT FORMAT UST AGENCY:

SPECIAL INSTRUCTIONS OR NOTES:

- EDD NOT NEEDED
- SHELL CONTRACT RATE APPLIES
- STATE REIMB RATE APPLIES
- RECEIPT VERIFICATION REQUESTED

LAB USE ONLY	Field Sample Identification	SAMPLING		MATRIX	NO. OF CONT.	TPH - Gas, Purgeable (8260B)	TPH - Diesel, Extractable (8015M)	BTEX (8260B)	5 Oxygenates (8260B) (MTBE, TBA, DIPE, TAME, ETBE)	MTBE (8260B)	TBA (8260B)	DIPE (8260B)	TAME (8260B)	ETBE (8260B)	1,2 DCA (8260B)	EDB (8260B)	Ethanol (8260B)	Methanol (8015M)	TEMPERATURE ON RECEIPT C°
		DATE	TIME																
	MW-5	12-26	1244	W	3	X	X	X											2.1

Relinquished by: (Signature) <i>David C. Selt</i>	Received by: (Signature) <i>David C. Selt Sample Custodian</i>	Date: 12-26-06	Time: 1630
Relinquished by: (Signature) <i>[Signature]</i>	Received by: (Signature) <i>[Signature]</i>	Date: 12/26/06	Time: 1650
Relinquished by: (Signature) <i>[Signature]</i>	Received by: (Signature) <i>[Signature]</i>	Date: 12/26/06	Time: 1825
		Date: 12/27/06	Time: 0800
		Date: 12/27/06	Time: 1520

Attachment B

**Groundwater Monitoring Data –
240 West MacArthur**

Table C-1
Historical Groundwater Monitoring Well Groundwater Analytical Results
Petroleum and Aromatic Hydrocarbons (µg/L)
240 W. MacArthur Boulevard, Oakland, Alameda, California

Well Purged?	Sampling Event No.	Date Sampled	TVH-g	TEH-d	Benzene	Toluene	Ethylbenzene	Total Xylenes	MTBE
MW-1									
Yes	1	Aug-97	1,140	< 1,000	110	16	15	112	NA
Yes	2	Dec-97	ND	NA	ND	ND	ND	31	NA
Yes	3	Mar-98	370	NA	8.9	< 0.5	< 0.5	2.2	18
Yes	4	Jul-98	6,400	NA	1,300	23	3.7	58	97
Yes	5	Oct-98	2,500	NA	360	44	1.3	150	< 0.5
Yes	6	Jan-99	2,700	NA	1,200	28	140	78	130
(a)	7	Jun-00	27,000	NA	5,200	500	320	3,100	1,300
(a)	8	Dec-00	976,000	NA	2,490	1,420	3,640	10,100	< 150
(a)	9	Feb-01	NA	NA	NA	NA	NA	NA	NA
(a)	10	May-01	20,000	NA	2,900	310	230	1,900	< 30
(a)	11	Jul-01	92,000	NA	2,900	580	2,800	20,000	560
Pre“hi-vac”	12	Oct 22-01	20,000	NA	3,700	560	410	4,600	2,600
Post “hi-vac”	12	Oct 26-01	< 0.05	NA	< 0.5	< 0.5	< 0.5	< 0.5	< 0.5
(a)	13	Dec-01	3,300	NA	200	12	5.7	43	44
No	14	Mar-02	4,600	NA	820	4.4	100	300	210
No	15	May-02	1,600	NA	100	23	20	190	7.7
No	16	Jul-02	2,300	NA	250	15	13	180	180
No	17	Oct-02	1,820	NA	222	16	< 0.3	59	58
No	18	Jan-03	2,880	NA	188	< 50	< 50	157	20
No	19	Mar-03	6,700	NA	607	64	64	288	< 0.18
No	20	Aug-03	4,900	5,000	740	45	85	250	14
Yes	21	Dec-03	8,930	800	1,030	55	127	253	212
Yes	22	Mar-04	11,300	1,100	483	97	122	452	67
Yes	23	Jun-04	9,300	4,000	1,700	75	92	350	6.0
Yes	24	Sep-04	9,100	97	920	19	82	201	7.2
Yes	25	Dec-04	11,000	3,300	830	21	74	118	7.9
Yes	26	Mar-05	4,700	3,500	450	28	42	97	6.7
Yes	27	Jun-05	21,000	6,800	1,900	270	320	2,800	< 13
Yes	28	Sep-05	23,000	2,500	2,100	100	200	880	< 2.5
Yes	29	Dec-05	4,300	3,000	500	22	72	228	5.5
Yes	30	Mar-06	11,000	3,000	340	45	89	630	4.3
Yes	31	Jun-06	21,000	8,500	1,600	160	170	1,000	< 2.5
Yes	32	Sep-06	13,000	6,200	1,700	76	110	440	< 13
Yes	33	Dec-06	16,000	4,100	1,500	100	160	670	< 13

(table continued on next page; footnotes on final page)

Well Purged?	Sampling Event No.	Date Sampled	TVH-g	TEH-d	Benzene	Toluene	Ethylbenzene	Total Xylenes	MTBE
MW-2									
Yes	1	Aug-97	5,350	< 1,000	108	36	33	144	NA
Yes	2	Dec-97	1,600	NA	73	ND	ND	ND	NA
Yes	3	Mar-98	3,400	NA	830	100	210	240	870
Yes	4	Jul-98	3,100	NA	25	2.2	< 0.5	0.9	1,900
Yes	5	Oct-98	4,300	NA	< 0.5	1.2	< 0.5	1	4,200
Yes	6	Jan-99	2,900	NA	160	8.9	6.9	78.4	2,100
(a)	7	Jun-00	2,700	NA	200	17	30	16	680
(a)	8	Dec-00	3,020	NA	56.7	< 1.5	< 1.5	< 3.0	3,040
(a)	9	Feb-01	NA	NA	NA	NA	NA	NA	NA
(a)	10	May-01	720	NA	49	< 3.0	4.6	< 3.0	380
(a)	11	Jul-01	8,400	NA	350	44	77	78	550
Pre "hi-vac"	12	Oct 22-01	850	NA	170	4.9	5.1	14	260
Post "hi-vac"	12	Oct 26-01	770	NA	86	5.5	9.6	8.5	310
(a)	13	Dec-01	1,300	NA	9.2	< 2.0	< 2.0	< 2.0	370
No	14	Mar-02	1,300	NA	76	3.8	21	15	460
No	15	May-02	320	NA	12	1.1	4.6	4.8	160
No	16	Jul-02	1,300	NA	130	1	9.4	5.6	420
No	17	Oct-02	1,060	NA	12	2.2	4.2	3.5	270
No	18	Jan-03	581	NA	6.5	< 5.0	< 5.0	< 5.0	130
No	19	Mar-03	1,250	NA	< 0.22	< 0.32	< 0.31	< 0.4	155
No	20	Aug-03	2,200	730	58	9.2	< 0.5	28	240
Yes	21	Dec-03	1,980	100	29	22.0	7.4	13	295
Yes	22	Mar-04	2,700	100	12	16.0	9	12	249
Yes	23	Jun-04	1,200	370	42	0.7	2.6	0.9	170
Yes	24	Sep-04	1,500	280	14	< 0.5	< 0.5	0.6	130
Yes	25	Dec-04	1,400	540	26	1.1	1.8	3.5	91
Yes	26	Mar-05	2,300	420	5.3	< 1.0	3.7	< 2.0	120
Yes	27	Jun-05	1,600	500	14	< 0.5	1.8	0.68	66
Yes	28	Sep-05	1,400	210	30	1.3	12	26	58
Yes	29	Dec-05	1,300	800	4.9	0.6	0.7	0.8	74
Yes	30	Mar-06	1,300	400	3.2	< 0.7	< 0.7	< 1.4	120
Yes	31	Jun-06	1,400	1,200	33.0	1.3	3.5	< 1.6	84
Yes	32	Sep-06	8,300	1,600	67.0	4.1	4.6	15.4	64
Yes	33	Dec-06	1,500	940	22.0	2.9	2.6	3.5	67

(table continued on next page; footnotes on final page)

Well Purged?	Sampling Event No.	Date Sampled	TVH-g	TEH-d	Benzene	Toluene	Ethylbenzene	Total Xylenes	MTBE
MW-3									
Yes	1	Aug-97	8,500	< 1,000	450	30	53	106	NA
Yes	2	Dec-97	5,200	NA	180	6	5	9.3	NA
Yes	3	Mar-98	1,000	NA	6	< 0.5	< 0.5	< 0.5	810
Yes	4	Jul-98	6,400	NA	490	57	23	78	220
Yes	5	Oct-98	2,100	NA	< 5.0	< 5.0	< 5.0	< 5.0	2,100
Yes	6	Jan-99	4,400	NA	450	65	26	42	1,300
(a)	7	Jun-00	1,700	NA	110	13	34	13	96
(a)	8	Dec-00	5,450	NA	445	< 7.5	23.8	< 7.5	603
(a)	9	Feb-01	NA	NA	NA	NA	NA	NA	NA
(a)	10	May-01	1,900	NA	180	12	< 3.0	19	330
(a)	11	Jul-01	10,000	NA	830	160	150	260	560
Pre“hi-vac”	12	Oct 22-01	1,400	NA	240	7.8	4.1	15	220
Post “hi-vac”	12	Oct 26-01	1,900	NA	200	16	51	30	290
(a)	13	Dec-01	5,800	NA	93	< 20	31	< 20	330
No	14	Mar-02	1,900	NA	220	16	31	24	400
No	15	May-02	1,600	NA	110	3.4	29	14	320
No	16	Jul-02	1,900	NA	210	27	30	55	200
No	17	Oct. 2002	3,030	NA	178	19	6.2	36	178
No	18	Jan-03	2,980	NA	47	< 5.0	7.6	6.3	105
No	19	Mar-03	3,620	NA	124	< 0.32	22	12	139
No	20	Aug-03	3,800	2,400	170	28	31	31	170
Yes	21	Dec-03	6,860	500	312	20	55	58	309
Yes	22	Mar-04	5,490	500	82	34	46	49	249
Yes	23	Jun-04	5,400	1,100	150	30	45	66	130
Yes	24	Sep-04	5,400	1,500	70	3.2	16	13	110
Yes	25	Dec-04	5,300	2,400	91	7.4	21	19	92
Yes	26	Mar-05	4,700	2,000	19	1.1	10	3.7	76
Yes	27	Jun-05	4,200	1,800	49	4.5	23	16	66
Yes	28	Sep-05	5,000	950	60	3.1	12	26	59
Yes	29	Dec-05	3,200	1,800	29	1.3	6.6	5.6	80
Yes	30	Mar-06	4,100	1,200	24	1.1	8.5	3.4	99
Yes	31	Jun-06	4,000	1,400	89.0	8.4	14.0	16.7	75
Yes	32	Sep-06	6,100	2,600	190	15.0	24.0	59.0	51
Yes	33	Dec-06	4,500	2,000	110	4.0	7.3	19.1	47

(table continued on next page; footnotes on final page)

Well Purged?	Sampling Event No.	Date Sampled	TVH-g	TEH-d	Benzene	Toluene	Ethylbenzene	Total Xylenes	MTBE
MW-4									
Yes	1	Aug-97	< 500	< 1,000	< 0.5	< 0.5	< 0.5	< 1.5	NA
Yes	2	Dec-97	ND	NA	ND	ND	ND	ND	NA
Yes	3	Mar-98	< 50	NA	< 0.5	< 0.5	< 0.5	< 0.5	< 0.5
Yes	4	Jul-98	< 50	NA	< 0.5	< 0.5	< 0.5	< 0.5	< 0.5
Yes	5	Oct-98	< 50	NA	< 0.5	< 0.5	< 0.5	< 0.5	< 0.5
Yes	6	Jan-99	< 50	NA	< 0.5	< 0.5	< 0.5	< 0.5	< 0.5
(a)	7	Jun-00	< 50	NA	< 0.5	< 0.5	< 0.5	< 0.5	< 0.5
(a)	8	Dec-00	< 500	NA	< 0.3	< 0.3	< 0.6	< 0.3	< 0.3
(a)	9	Feb-01	NA	NA	NA	NA	NA	NA	NA
(a)	10	May-01	< 50	NA	1.2	< 0.3	0.55	1.2	2.9
(a)	11	Jul-01	< 5.0	NA	< 0.5	< 0.5	< 0.5	< 0.5	< 0.5
Pre“hi-vac”	12	Oct 22-01	< 5.0	NA	< 0.5	< 0.5	< 0.5	< 0.5	< 0.5
Post “hi-vac”	12	Oct 26-01	< 5.0	NA	< 0.5	< 0.5	< 0.5	< 0.5	< 0.5
(a)	13	Dec-01	ND	NA	ND	ND	ND	ND	ND
No	14	Mar-02	< 50	NA	< 1	< 1	< 1	< 1	< 1
No	15	May-02	< 50	NA	< 0.5	< 0.5	< 0.5	< 0.5	< 0.5
No	16	Jul-02	< 50	NA	< 0.5	< 0.5	< 0.5	< 0.5	< 0.5
No	17	Oct-02	< 100	NA	< 0.3	< 0.3	< 0.3	< 0.6	< 0.3
No	18	Jan-03	< 100	NA	< 0.3	< 0.3	< 0.3	< 0.6	14
No	19	Mar-03	< 15	NA	< 0.4	< 0.02	< 0.02	< 0.06	5.2
No	20	Aug-03	< 50	NA	< 0.5	< 0.5	< 0.5	< 0.5	< 0.5
Yes	21	Dec-03	63	NA	< 0.3	< 0.3	< 0.3	< 0.6	< 5.0
Yes	22	Mar-04	< 50	NA	< 0.3	< 0.3	< 0.3	< 0.6	< 5.0
Yes	23	Jun-04	< 50	NA	< 0.5	< 0.5	< 0.5	< 0.5	0.9
Yes	24	Sep-04	< 50	NA	< 0.5	< 0.5	< 0.5	< 0.5	2.3
Yes	25	Dec-04	< 50	NA	NA	NA	NA	NA	NA
Yes	26	Mar-05	< 50	NA	NA	NA	NA	NA	NA
Yes	27	Jun-05	< 50	NA	NA	NA	NA	NA	NA
Yes	28	Sep-05	< 50	NA	NA	NA	NA	NA	NA
Yes	29	Dec-05	< 50	NA	NA	NA	NA	NA	NA
Yes	30	Mar-06	< 50	NA	NA	NA	NA	NA	NA
Yes	31	Jun-06	< 50	NA	NA	NA	NA	NA	NA
Yes	32	Sep-06	< 50	NA	NA	NA	NA	NA	NA
Yes	33	Dec-06	59	NA	NA	NA	NA	NA	NA

(table continued on next page; footnotes on final page)

Well Purged?	Sampling Event No.	Date Sampled	TVH-g	TEH-d	Benzene	Toluene	Ethylbenzene	Total Xylenes	MTBE
MW-5									
(a)	9	Feb-01	5,660	NA	76.9	21.1	47.3	312	< 0.3
(a)	10	May-01	22,000	NA	2,600	480	220	2,700	< 30
(a)	11	Jul-01	72,000	NA	3,500	1,100	4,300	22,000	2,500
Pre“hi-vac”	12	Oct 22-01	26,000	NA	2,800	980	6,000	950	2,300
Post “hi-vac”	12	Oct 26-01	17,000	NA	1,200	470	2,900	440	900
(a)	13	Dec-01	2,000	NA	620	190	110	910	< 20
No	14	Mar-02	8,800	NA	1,200	72	7.4	350	1,200
No	15	May-02	2,000	NA	150	38	21	260	13
No	16	Jul-02	4,200	NA	480	68	29	280	450
No	17	Oct-02	5,370	NA	236	45	23	39	135
No	18	Jan-03	8,270	NA	615	156	174	1,010	< 10
No	19	Mar-03	12,400	NA	824	195	213	1,070	< 0.18
No	20	Aug-03	18,000	10,000	950	290	330	1,820	< 2.0
Yes	21	Dec-03	11,900	800	627	263	288	1,230	595
Yes	22	Mar-04	20,700	850	867	266	305	678	145
Yes	23	Jun-04	12,000	1,700	920	240	260	1,150	< 3.1
Yes	24	Sep-04	13,000	1,900	580	240	260	1,260	< 4.2
Yes	25	Dec-04	16,000	3,300	730	200	250	1,100	< 4.2
Yes	26	Mar-05	6,300	4,600	190	28	42	280	< 1.7
Yes	27	Jun-05	16,000	4,100	1,100	260	380	1,590	< 7.1
Yes	28	Sep-05	15,000	3,600	810	210	300	1,300	< 1.3
Yes	29	Dec-05	9,600	3,600	270	80	110	710	< 1.7
Yes	30	Mar-06	9,800	5,100	240	47	97	590	< 2.0
Yes	31	Jun-06	28,000	4,900	920.0	250.0	350.0	1,480	< 2.0
Yes	32	Sep-06	12,000	2,400	580	170	230	980	< 3.6
Yes	33	Dec-06	15,000	3,400	510	160	260	1,190	<3.6

(table continued on next page; footnotes on final page)

Well Purged?	Sampling Event No.	Date Sampled	TVH-g	TEH-d	Benzene	Toluene	Ethylbenzene	Total Xylenes	MTBE
MW-6									
(a)	9	Feb-01	1,340	NA	17	0.967	11.1	51.4	< 0.3
(a)	10	May-01	610	NA	15	0.97	< 0.5	46	< 0.5
(a)	11	Jul-01	2,500	NA	130	4.7	53	170	120
Pre“hi-vac”	12	Oct 22-01	280	NA	18	1.2	6.2	4.7	6
Post “hi-vac”	12	Oct 26-01	3,600	NA	210	20	170	62	120
(a)	13	Dec-01	5,300	NA	69	5.6	14	17	< 2.0
No	14	Mar-02	71	NA	54	4.2	27	17	8.5
No	15	May-02	150	NA	9.3	< 0.5	< 0.5	< 0.5	1.5
No	16	Jul-02	2,200	NA	98	32	46	150	66
No	17	Oct-02	786	NA	48	5.0	2.2	44	16
No	18	Jan-03	497	NA	6.8	< 5.0	< 5.0	11	< 1.0
No	19	Mar-03	258	NA	5.4	< 0.32	3.3	< 1.1	< 0.18
No	20	Aug-03	1,600	2,800	37	4	23	58	< 0.5
Yes	21	Dec-03	365	200	2.5	3.8	1.4	6.1	< 5.0
Yes	22	Mar-04	215	140	4.0	1.2	1.4	1.4	3.7
Yes	23	Jun-04	710	830	14.0	0.7	5.2	6.6	< 0.5
Yes	24	Sep-04	350	600	< 0.5	2.4	< 0.5	< 0.5	< 0.5
Yes	25	Dec-04	280	1,100	4.9	< 0.5	1.4	4.4	< 0.5
Yes	26	Mar-05	300	980	5.4	< 0.5	3.3	2.3	< 0.5
Yes	27	Jun-05	150	1,100	< 0.5	< 0.5	< 0.5	0.77	28
Yes	28	Sep-05	680	200	13	0.9	6.6	13	< 0.5
Yes	29	Dec-05	240	890	3.6	< 0.5	0.7	2.4	0.5
Yes	30	Mar-06	530	950	8.3	< 0.5	4.0	2.1	0.6
Yes	31	Jun-06	460	1,300	8.3	< 0.5	1.4	2.6	< 0.5
Yes	32	Sep-06	530	730	10.0	0.8	4.1	7.5	< 0.5
Yes	33	Dec-06	500	750	7.5	< 0.5	2.6	2.5	< 0.5

(table continued on next page; footnotes on final page)

Well Purged?	Sampling Event No.	Date Sampled	TVH-g	TEH-d	Benzene	Toluene	Ethylbenzene	Total Xylenes	MTBE
MW-7									
(a)	9	Feb-01	ND	NA	ND	ND	ND	ND	ND
(a)	10	May-01	< 50	NA	0.75	0.77	0.48	2.4	1.1
(a)	11	Jul-01	< 5.0	NA	< 0.5	< 0.5	< 0.5	< 0.5	< 0.5
Pre“hi-vac”	12	Oct 22-01	< 5.0	NA	< 0.5	< 0.5	< 0.5	< 0.5	< 0.5
Post “hi-vac”	12	Oct 26-01	6,000	NA	170	550	110	120	970
(a)	13	Dec-01	< 50	NA	< 0.5	< 0.5	< 0.5	< 0.5	43
No	14	Mar-02	< 50	NA	< 1.0	< 1.0	< 1.0	< 1.0	< 1.0
No	15	May-02	< 50	NA	< 0.5	< 0.5	< 0.5	< 0.5	< 0.5
No	16	Jul-02	< 50	NA	< 0.5	< 0.5	< 0.5	< 0.5	< 0.5
No	17	Oct-02	< 100	NA	< 0.3	< 0.3	< 0.3	< 0.6	< 5.0
No	18	Jan-03	NA	NA	NA	NA	NA	NA	NA
No	19	Mar-03	< 15	NA	< 0.04	< 0.02	< 0.02	< 0.06	< 0.03
No	20	Aug-03	< 50	NA	< 0.5	< 0.5	< 0.5	< 0.5	< 0.5
Yes	21	Dec-03	< 50	NA	< 0.3	< 0.3	< 0.3	< 0.6	< 5.0
Yes	22	Mar-04	86	NA	< 0.3	< 0.3	< 0.3	< 0.6	57
Yes	23	Jun-04	< 50	NA	< 0.5	< 0.5	< 0.5	< 0.5	< 0.5
Yes	24	Sep-04	< 50	NA	< 0.5	< 0.5	< 0.5	< 0.5	< 0.5
Yes	25	Dec-04	< 50	NA	NA	NA	NA	NA	NA
Yes	26	Mar-05	< 50	NA	NA	NA	NA	NA	NA
Yes	27	Jun-05	< 50	NA	NA	NA	NA	NA	NA
Yes	28	Sep-05	< 50	NA	NA	NA	NA	NA	NA
Yes	29	Dec-05	< 50	NA	NA	NA	NA	NA	NA
Yes	30	Mar-06	< 50	NA	NA	NA	NA	NA	NA
Yes	31	Jun-06	< 50	NA	NA	NA	NA	NA	NA
Yes	32	Sep-06	< 50	NA	NA	NA	NA	NA	NA
Yes	33	Dec-06	< 50	NA	NA	NA	NA	NA	NA

(table continued on next page; footnotes on final page)

Well Purged?	Sampling Event No.	Date Sampled	TVH-g	TEH-d	Benzene	Toluene	Ethylbenzene	Total Xylenes	MTBE
MW-8									
(a)	9	Feb-01	1,000	NA	3.97	< 0.3	3.78	1.63	620
(a)	10	May-01	< 50	NA	< 0.5	< 0.5	< 0.5	< 0.5	4.4
(a)	11	Jul-01	< 5.0	NA	< 0.5	< 0.5	< 0.5	< 0.5	< 0.5
Pre"hi-vac"	12	Oct 22-01	< 5.0	NA	< 0.5	< 0.5	< 0.5	< 0.5	< 0.5
Post "hi-vac"	12	Oct 26-01	< 5.0	NA	< 0.5	< 0.5	< 0.5	< 0.5	< 0.5
(a)	13	Dec-01	< 50	NA	< 0.5	< 0.5	< 0.5	< 0.5	< 0.5
No	14	Mar-02	< 50	NA	< 1.0	< 1.0	< 1.0	< 1.0	< 1.0
No	15	May-02	< 50	NA	< 0.5	< 0.5	< 0.5	< 0.5	< 0.5
No	16	Jul-02	< 50	NA	< 0.5	< 0.5	< 0.5	< 0.5	< 0.5
No	17	Oct-02	458	NA	1.7	< 0.3	< 0.3	< 0.6	233
No	18	Jan-03	< 100	NA	< 0.3	< 0.3	< 0.3	< 0.6	< 5.0
No	19	Mar-03	< 15	NA	< 0.22	< 0.32	< 0.31	< 0.4	< 0.18
No	20	Aug-03	190	< 50	< 0.5	< 0.5	< 0.5	0.6	< 0.5
Yes	21	Dec-03	163	< 100	< 0.3	< 0.3	< 0.3	< 0.6	66
Yes	22	Mar-04	412	< 100	1.2	< 0.3	1.7	3.9	66
Yes	23	Jun-04	320	68	< 0.5	< 0.5	< 0.5	< 0.5	120
Yes	24	Sep-04	280	2600	< 0.5	< 0.5	< 0.5	< 0.5	120
Yes	25	Dec-04	270	84	< 0.5	< 0.5	< 0.5	< 0.5	94
Yes	26	Mar-05	270	120	< 0.5	< 0.5	< 0.5	< 1.0	66
Yes	27	Jun-05	510	63	6.8	< 0.5	2.4	5.3	< 0.5
Yes	28	Sep-05	520	< 50	< 0.5	< 0.5	< 0.5	< 1.0	65
Yes	29	Dec-05	65	57	< 0.5	< 0.5	< 0.5	< 1.0	29
Yes	30	Mar-06	140	120	< 0.5	< 0.5	< 0.5	0.6	24
Yes	31	Jun-06	710	170	< 0.5	< 0.5	< 0.5	< 1.0	81
Yes	32	Sep-06	330	260	< 0.5	< 0.5	< 0.5	< 0.5	44
Yes	33	Dec-06	63	< 50	< 0.5	< 0.5	< 0.5	< 0.5	21

Notes:

(a) Data not available to Ses as to whether the samples were collected "post-purge" or before purging.

"No Purge" means no purging was conducted before the groundwater sample was collected.

TVH-g = Total Volatile Hydrocarbons - gasoline range. TEH-d = Total Extractable Hydrocarbons - diesel range.

NA = Not analyzed for this constituent in this event.

ND = Not Detected (method reporting limit not specified in the information available to SES).

Table D-1
Historical Water Levels in Monitoring Wells
240 W. MacArthur Boulevard, Oakland, Alameda, California

Well I.D.	Sampling Event No.	Date Measured	Water Level Depth (a)	Water Level Elevation (b)
MW-1	1	Aug-97	16.83	62.32
	2	Dec-97	NA	NA
	3	Mar-98	13.58	65.57
	4	Jul-98	15.55	63.60
	5	Oct-98	15.70	63.45
	6	Jan-99	15.21	63.94
	7	Jun-00	15.41	63.74
	8	Dec-00	NA	NA
	9	Feb-01	NA	NA
	10	May-01	15.57	63.58
	11	Jul-01	16.42	62.73
	12	Oct-01	16.82	62.33
	13	Dec-01	15.08	64.07
	14	Mar-02	14.53	64.62
	15	May-02	NA	NA
	16	Jul-02	16.39	62.76
	17	Oct-02	17.03	62.12
	18	Jan-03	14.91	64.24
	19	Mar-03	15.26	63.89
	20	Aug-03	16.24	62.91
	21	Dec-03	16.90	62.25
	22	Mar-04	14.33	64.82
	23	Jun-04	16.28	62.87
	24	Sep-04	17.03	62.12
	25	Dec-04	16.38	62.77
	26	Mar-05	14.30	64.85
	27	Jun-05	15.53	63.82
	28	Sep-05	16.42	62.73
	29	Dec-05	15.67	63.48
	30	Mar-06	12.75	66.40
	31	Jun-06	14.60	64.55
	32	Sep-06	16.52	62.63
	33	Dec-06	15.89	62.63

Notes:

(a) Feet below well top of casing.

(b) Relative to mean sea level.

NA = Data Not Available

Data prior to August 2003 are likely not valid as well elevations were not surveyed.

Table D-1 (continued)

Well I.D.	Sampling Event No.	Date Measured	Water Level Depth (a)	Water Level Elevation (b)
MW-2				
	1	Aug-97	16.32	62.13
	2	Dec-97	NA	NA
	3	Mar-98	13.05	64.95
	4	Jul-98	14.95	63.50
	5	Oct-98	15.09	63.36
	6	Jan-99	14.61	63.84
	7	Jun-00	14.80	63.65
	8	Dec-00	NA	NA
	9	Feb-01	NA	NA
	10	May-01	14.98	63.47
	11	Jul-01	15.86	62.59
	12	Oct-01	16.69	61.76
	13	Dec-01	13.49	64.96
	14	Mar-02	13.07	65.38
	15	May-02	NA	NA
	16	Jul-02	15.86	62.59
	17	Oct-02	16.54	61.91
	18	Jan-03	14.37	64.08
	19	Mar-03	14.74	63.71
	20	Aug-03	15.75	62.70
	21	Dec-03	16.11	62.34
	22	Mar-04	13.83	64.82
	23	Jun-04	15.76	62.69
	24	Sep-04	16.48	61.97
	25	Dec-04	15.74	62.71
	26	Mar-05	13.48	64.97
	27	Jun-05	14.48	63.97
	28	Sep-05	16.00	62.45
	29	Dec-05	14.88	63.57
	30	Mar-06	12.20	66.25
	31	Jun-06	14.15	64.30
		32	Sep-06	16.00
	33	Dec-06	15.19	63.26

Notes:

(a) Feet below well top of casing.

(b) Relative to mean sea level.

NA = Data Not Available

Data prior to August 2003 are likely not valid as well elevations were not surveyed.

Table D-1 (continued)

Well I.D.	Sampling Event No.	Date Measured	Water Level Depth (a)	Water Level Elevation (b)
MW-3	1	Aug-97	15.36	62.22
	2	Dec-97	NA	NA
	3	Mar-98	12.18	65.40
	4	Jul-98	14.08	63.50
	5	Oct-98	14.24	63.34
	6	Jan-99	13.74	63.84
	7	Jun-00	13.94	63.64
	8	Dec-00	NA	NA
	9	Feb-01	NA	NA
	10	May-01	14.08	63.50
	11	Jul-01	14.99	62.59
	12	Oct-01	16.26	61.32
	13	Dec-01	13.62	63.96
	14	Mar-02	13.19	64.39
	15	May-02	NA	NA
	16	Jul-02	14.97	62.61
	17	Oct. 2002	15.44	62.14
	18	Jan-03	13.49	64.09
	19	Mar-03	13.83	63.75
	20	Aug-03	14.90	62.68
	21	Dec-03	15.10	62.48
	22	Mar-04	12.93	64.65
	23	Jun-04	14.90	62.68
	24	Sep-04	15.61	61.97
	25	Dec-04	14.77	62.81
	26	Mar-05	12.60	64.98
	27	Jun-05	13.73	63.85
	28	Sep-05	15.14	62.44
	29	Dec-05	13.94	63.64
	30	Mar-06	11.25	66.33
	31	Jun-06	13.27	64.31
	32	Sep-06	15.12	62.46
	33	Dec-06	14.34	63.24

Notes:

(a) Feet below well top of casing.

(b) Relative to mean sea level.

NA = Data Not Available

Data prior to August 2003 are likely not valid as well elevations were not surveyed.

Table D-1 (continued)

Well I.D.	Sampling Event No.	Date Measured	Water Level Depth (a)	Water Level Elevation (b)
MW-4	1	Aug-97	NA	NA
	2	Dec-97	NA	NA
	3	Mar-98	11.87	65.87
	4	Jul-98	13.90	63.84
	5	Oct-98	14.10	63.64
	6	Jan-99	13.56	64.18
	7	Jun-00	13.75	63.99
	8	Dec-00	NA	NA
	9	Feb-01	NA	NA
	10	May-01	13.65	64.09
	11	Jul-01	14.87	62.87
	12	Oct-01	15.78	61.96
	13	Dec-01	13.54	64.20
	14	Mar-02	13.02	64.72
	15	May-02	NA	NA
	16	Jul-02	14.81	62.93
	17	Oct-02	15.56	62.18
	18	Jan-03	13.39	64.35
	19	Mar-03	13.75	63.99
	20	Aug-03	14.75	62.99
	21	Dec-03	15.11	62.63
	22	Mar-04	12.78	64.96
	23	Jun-04	14.68	63.06
	24	Sep-04	15.17	62.57
	25	Dec-04	14.90	62.84
	26	Mar-05	12.57	65.17
	27	Jun-05	13.43	64.31
	28	Sep-05	15.13	62.61
	29	Dec-05	13.83	63.91
	30	Mar-06	10.90	66.84
	31	Jun-06	13.02	64.72
	32	Sep-06	15.16	62.58
	33	Dec-06	14.35	63.24

Notes:

(a) Feet below well top of casing.

(b) Relative to mean sea level.

NA = Data Not Available

Data prior to August 2003 are likely not valid as well elevations were not surveyed.

Table D-1 (continued)

Well I.D.	Sampling Event No.	Date Measured	Water Level Depth (a)	Water Level Elevation (b)
MW-5	9	Feb-01	NA	NA
	10	May-01	15.65	63.71
	11	Jul-01	16.50	62.86
	12	Oct-01	17.46	61.90
	13	Dec-01	15.28	64.08
	14	Mar-02	14.62	64.74
	15	May-02	NA	NA
	16	Jul-02	16.46	62.90
	17	Oct-02	17.18	62.18
	18	Jan-03	14.99	64.37
	19	Mar-03	15.33	64.03
	20	Aug-03	16.34	63.02
	21	Dec-03	16.90	62.46
	22	Mar-04	14.44	64.92
	23	Jun-04	16.43	62.93
	24	Sep-04	17.07	62.29
	25	Dec-04	16.59	62.77
	26	Mar-05	14.08	65.28
	27	Jun-05	15.33	64.03
	28	Sep-05	16.61	62.75
29	Dec-05	15.81	63.55	
30	Mar-06	12.75	66.61	
31	Jun-06	14.65	64.71	
	32	Sep-06	16.66	62.70
	33	Dec-06	16.10	63.26

Notes:

(a) Feet below well top of casing.

(b) Relative to mean sea level.

NA = Data Not Available

Data prior to August 2003 are likely not valid as well elevations were not surveyed.

Table D-1 (continued)

Well I.D.	Sampling Event No.	Date Measured	Water Level Depth (a)	Water Level Elevation (b)
MW-6	9	Feb-01	NA	NA
	10	May-01	15.54	62.89
	11	Jul-01	15.56	62.87
	12	Oct-01	16.41	62.02
	13	Dec-01	14.37	64.06
	14	Mar-02	13.75	64.68
	15	May-02	NA	NA
	16	Jul-02	15.55	62.88
	17	Oct-02	16.24	62.19
	18	Jan-03	14.17	64.26
	19	Mar-03	14.52	63.91
	20	Aug-03	15.50	62.93
	21	Dec-03	16.19	62.24
	22	Mar-04	13.51	64.92
	23	Jun-04	15.42	63.01
	24	Sep-04	16.13	62.30
	25	Dec-04	15.40	63.03
	26	Mar-05	13.28	65.15
	27	Jun-05	14.14	64.29
	28	Sep-05	15.61	62.82
29	Dec-05	14.90	63.53	
30	Mar-06	11.85	66.58	
31	Jun-06	13.73	64.70	
32	Sep-06	15.71	62.72	
33	Dec-06	15.15	63.28	

Notes:

(a) Feet below well top of casing.

(b) Relative to mean sea level.

NA = Data Not Available

Data prior to August 2003 are likely not valid as well elevations were not surveyed.

Table D-1 (continued)

Well I.D.	Sampling Event No.	Date Measured	Water Level Depth (a)	Water Level Elevation (b)
MW-7	9	Feb-01	NA	NA
	10	May-01	15.04	62.23
	11	Jul-01	15.69	62.58
	12	Oct-01	16.59	61.68
	13	Dec-01	14.30	63.97
	14	Mar-02	13.87	64.40
	15	May-02	NA	NA
	16	Jul-02	15.72	62.55
	17	Oct-02	16.36	61.91
	18	Jan-03	14.22	64.05
	19	Mar-03	14.57	63.70
	20	Aug-03	15.61	62.66
	21	Dec-03	16.04	62.23
	22	Mar-04	13.57	64.70
	23	Jun-04	15.63	62.64
	24	Sep-04	16.33	61.94
	25	Dec-04	15.70	62.57
	26	Mar-05	13.42	64.85
	27	Jun-05	14.53	63.74
	28	Sep-05	15.81	62.46
	29	Dec-05	14.88	63.39
	30	Mar-06	13.00	65.27
	31	Jun-06	13.98	64.29
	32	Sep-06	15.82	62.45
	33	Dec-06	15.12	63.15

Notes:

(a) Feet below well top of casing.

(b) Relative to mean sea level.

NA = Data Not Available

Data prior to August 2003 are likely not valid as well elevations were not surveyed.

Table D-1 (continued)

Well I.D.	Sampling Event No.	Date Measured	Water Level Depth (a)	Water Level Elevation (b)
MW-8	10	May-01	12.75	63.64
	11	Jul-01	13.84	62.55
	12	Oct-01	14.65	61.74
	13	Dec-01	12.39	64.00
	14	Mar-02	11.89	64.50
	15	May-02	NA	NA
	16	Jul-02	13.96	62.43
	17	Oct-02	14.48	61.91
	18	Jan-03	12.49	63.90
	19	Mar-03	12.85	63.54
	20	Aug-03	13.75	62.65
	21	Dec-03	14.50	61.89
	22	Mar-04	11.78	64.61
	23	Jun-04	13.71	62.68
	24	Sep-04	14.43	61.96
	25	Dec-04	13.64	62.75
	26	Mar-05	11.52	64.87
	27	Jun-05	12.50	63.89
	28	Sep-05	13.90	62.49
	29	Dec-05	12.75	63.64
	30	Mar-06	10.80	65.59
	31	Jun-06	12.10	64.29
	32	Sep-06	13.93	62.46
	33	Dec-06	13.12	63.27

Notes:

(a) Feet below well top of casing.

(b) Relative to mean sea level.

NA = Data Not Available

Data prior to August 2003 are likely not valid as well elevations were not surveyed.