



Denis L. Brown

October 19, 2005

Jerry Wickham
Alameda County Health Care Services Agency
1131 Harbor Bay Parkway, Suite 250
Alameda, CA 94502-6577

Shell Oil Products US
HSE - Environmental Services
20945 S. Wilmington Ave.
Carson, CA 90810-1039
Tel (707) 865 0251
Fax (707) 865 2542
Email denis.l.brown@shell.com

Re: Third Quarter 2005 Monitoring Report
Shell-branded Service Station
230 West MacArthur Boulevard
Oakland, California
SAP Code 135676
Incident No. 98995741

Alameda County
OCT 24 2005
Environmental Health

Dear Mr. Wickham:

Attached for your review and comment is a copy of the *Third Quarter 2005 Monitoring Report* for the above referenced site. Upon information and belief, I declare, under penalty of perjury, that the information contained in the attached document is true and correct.

If you have any questions or concerns, please call me at (707) 865-0251.

Sincerely,

Denis L. Brown
Sr. Environmental Engineer

October 19, 2005

Jerry Wickham
Alameda County Health Care Services Agency
1131 Harbor Bay Parkway, Suite 250
Alameda, California 94502-6577

Re: **Third Quarter 2005 Monitoring Report**
Shell-branded Service Station
230 West MacArthur Boulevard
Oakland, California
Incident # 98995741
Cambria Project # 247-0902-002
ACHCSA Case #3673

Alameda County
OCT 24 2005
Environmental Health



Dear Mr. Wickham:

On behalf of Equilon Enterprises LLC dba Shell Oil Products US (Shell), Cambria Environmental Technology, Inc. (Cambria) is submitting this groundwater monitoring report in accordance with the reporting requirements of 23 CCR 2652d.

THIRD QUARTER 2005 ACTIVITIES

Groundwater Monitoring: Blaine Tech Services, Inc. (Blaine) of San Jose, California gauged all site wells, sampled selected wells, calculated groundwater elevations, and compiled the analytical data. Cambria coordinated groundwater monitoring with the adjacent Oakland Auto Works site at 240 West MacArthur. Cambria prepared a site vicinity map that includes previously submitted well survey information (Figure 1) and a groundwater elevation contour map (Figure 2). Blaine's report, presenting the analytical laboratory reports, is included as Attachment A. Attachment B includes data that Stellar Environmental Solutions of Berkeley, California provided for 240 West MacArthur.

Additional Oxygenate Sampling: At Shell's request, during the third quarter 2005 monitoring event, wells MW-2 and MW-4 were also analyzed for di-isopropyl ether (DIPE), ethyl tertiary butyl ether (ETBE), tertiary amyl methyl ether (TAME), and tertiary butyl alcohol (TBA). ETBE and TAME were not detected in either sample. TBA was detected at concentrations of 5.6 parts per billion (ppb) in the sample from well MW-2 and 280 ppb in the sample from well MW-4. DIPE was detected at a concentration of 8.4 ppb in the sample from well MW-4.

**Cambria
Environmental
Technology, Inc.**

5900 Hollis Street
Suite A
Emeryville, CA 94608
Tel (510) 420-0700
Fax (510) 420-9170

Site Conceptual Model: Cambria submitted a site conceptual model to the Alameda County Health Care Services Agency on September 23, 2005. Cambria concluded that current groundwater conditions appear to be low-risk for all identified potential receptors and that current soil conditions in previously impacted and remediated areas are not known. Based on the site's history and current conditions, Cambria recommended additional soil sampling, a semi-annual groundwater monitoring schedule for all site wells, continued coordinated monitoring with 240 W. MacArthur Blvd., and the evaluation of site soil and groundwater conditions versus San Francisco Regional Water Quality Control Board environmental screening levels and City of Oakland risk-based screening levels.



ANTICIPATED FOURTH QUARTER 2005 ACTIVITIES

Groundwater Monitoring: Blaine will gauge all wells, sample selected wells, and tabulate the data. Cambria will coordinate monitoring with the adjacent Oakland Auto Works site at 240 West MacArthur Boulevard. Cambria will prepare a monitoring report that includes a groundwater contour map based on the coordinated monitoring data.

CLOSING

We appreciate the opportunity to work with you on this project. Please call David Gibbs at (510) 420-3363 if you have any questions or comments.

Sincerely,
Cambria Environmental Technology, Inc

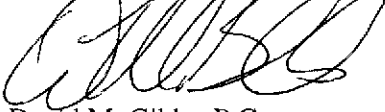

David M. Gibbs, P.G.
Project Geologist

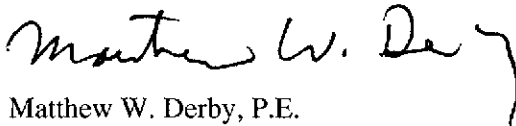

Matthew W. Derby, P.E.
Senior Project Engineer

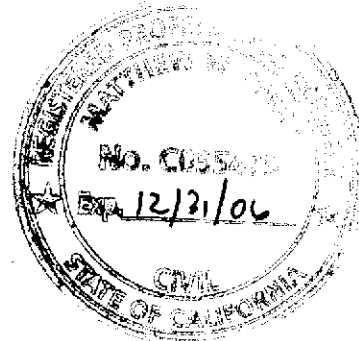

Figures: 1 - Vicinity/Area Well Survey Map
2 - Groundwater Elevation Contour Map

Attachments: A - Blaine Groundwater Monitoring Report
B - Groundwater Monitoring Data – 240 West MacArthur

cc: Denis Brown, Shell Oil Products US, 20945 S. Wilmington Ave., Carson, CA 90810
Bruce Ruttger, Stellar Environmental Solutions, 2198 6th Street, Berkeley, CA 94710

G:\Oakland 230 MacArthur\QM\3q05\3q05qm.doc

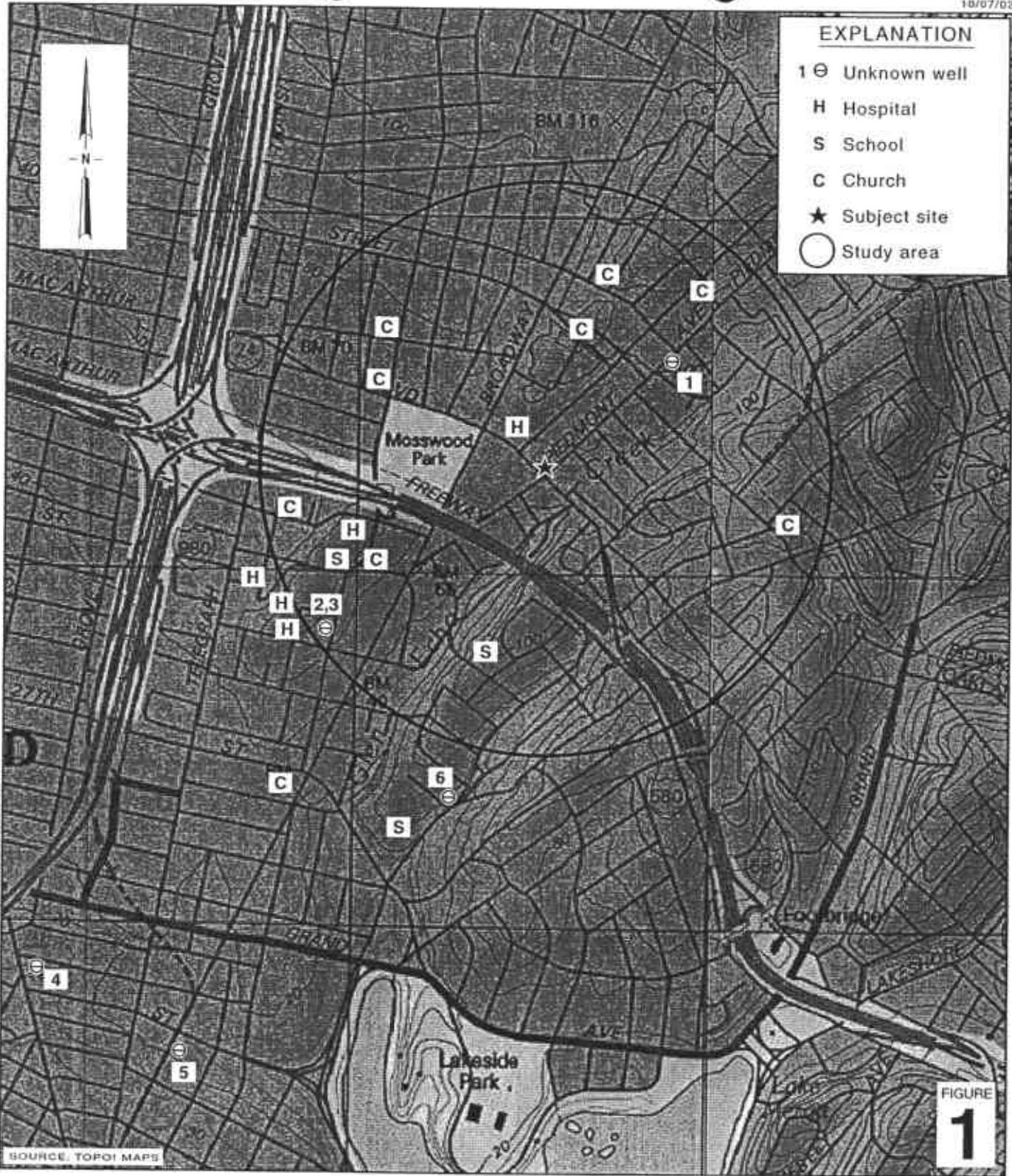

G:\OAKLAND\30MACARTHUR\FIGURES\VIC-WELL-SURVEY.A1

SOURCE: TOPOI MAPS

Shell-branded Service Station
 230 West MacArthur Boulevard
 Oakland, California
 Incident #98995741



**Vicinity/Area Well
 Survey Map**
 (1/2-Mile Radius)

G:\OAKLAND 230 MACARTHUR\FIGURES\30M05 AI

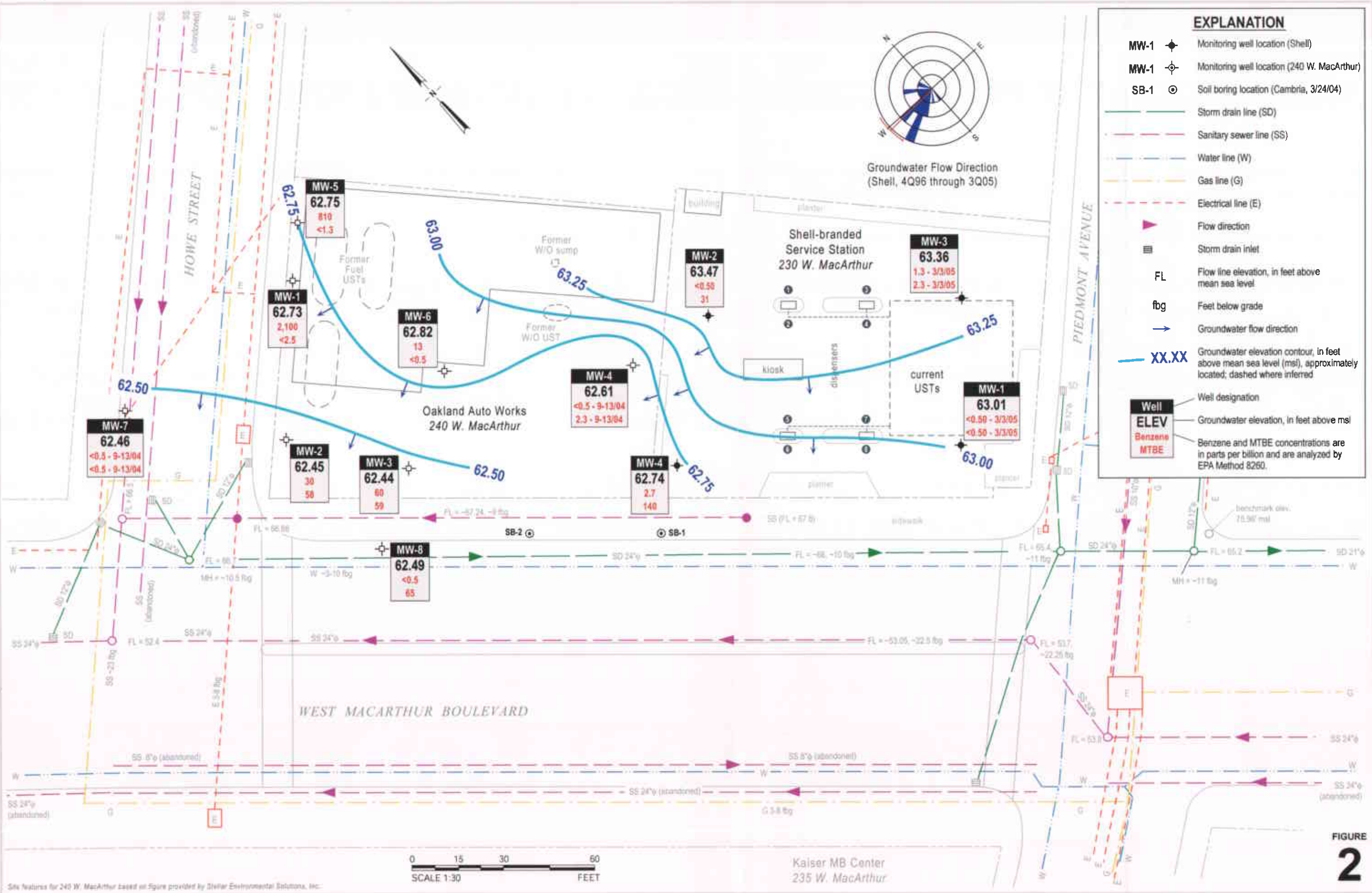

Groundwater Elevation Contour Map



Shell-branded Service Station
230 West MacArthur Boulevard
Oakland, California
Incident No. 98995741

September 19, 2005

Site features for 240 W. MacArthur based on Spire provided by Dellar Environmental Solutions, Inc.

ATTACHMENT A
Blaine Groundwater Monitoring Report

BLAINE
TECH SERVICES INC.

GROUNDWATER SAMPLING SPECIALISTS
SINCE 1985

October 3, 2005

Denis Brown
Shell Oil Products US
20945 South Wilmington Avenue
Carson, CA 90810

Third Quarter 2005 Groundwater Monitoring at
Shell-branded Service Station
230 West MacArthur Boulevard
Oakland, CA

Monitoring performed on September 19, 2005

Groundwater Monitoring Report **050919-MD-2**

This report covers the routine monitoring of groundwater wells at this Shell-branded facility. In accordance with standard procedures that conform to Regional Water Quality Control Board requirements, routine field data collection includes depth to water, total well depth, thickness of any separate immiscible layer, water column volume, calculated purge volume (if applicable), elapsed evacuation time (if applicable), total volume of water removed (if applicable), and standard water parameter instrument readings. Sample material is collected, contained, stored, and transported to the laboratory in conformance with EPA standards. Purgewater (if applicable) is, likewise, collected and transported to the Martinez Refining Company.

Basic field information is presented alongside analytical values excerpted from the laboratory report in the cumulative table of **WELL CONCENTRATIONS**. The full analytical report for the most recent samples and the field data sheets are attached to this report.

At a minimum, Blaine Tech Services, Inc. field personnel are certified on completion of a forty-hour Hazardous Materials and Emergency Response training course per 29 CFR 1910.120. Field personnel are also enrolled in annual eight-hour refresher courses.

Blaine Tech Services, Inc. conducts sampling and documentation assignments of this type as an independent third party. Our activities at this site consisted of objective data and sample collection only. No interpretation of analytical results, defining of hydrological conditions or formulation of recommendations was performed.

Please call if you have any questions.

Yours truly,

Leon Gearhart
Project Coordinator

LG/ks

attachments: Cumulative Table of WELL CONCENTRATIONS
Certified Analytical Report
Field Data Sheets

cc: Anni Kreml
Cambria Environmental Technology, Inc.
5900 Hollis Street, Suite A
Emeryville, CA 94608

WELL CONCENTRATIONS
Shell-branded Service Station
230 West MacArthur Boulevard
Oakland, CA

Well ID	Date	TPPH (ug/L)	B (ug/L)	T (ug/L)	E (ug/L)	X (ug/L)	MTBE 8020 (ug/L)	MTBE 8260 (ug/L)	DIPE (ug/L)	ETBE (ug/L)	TAME (ug/L)	TBA (ug/L)	TOC (MSL)	Depth to Water (ft.)	GW Elevation (MSL)
MW-1	07/14/1988	ND	ND	ND	ND	ND	NA	NA	NA	NA	NA	NA	73.89	13.30	60.59
MW-1	10/04/1988	ND	8	4.3	ND	9	NA	NA	NA	NA	NA	NA	73.89	13.65	60.24
MW-1	11/10/1988	ND	ND	ND	ND	ND	NA	NA	NA	NA	NA	NA	73.89	13.55	60.34
MW-1	12/09/1988	ND	ND	ND	ND	ND	NA	NA	NA	NA	NA	NA	73.89	13.22	60.67
MW-1	01/10/1989	ND	ND	ND	ND	NA	NA	NA	NA	NA	NA	NA	73.89	12.86	61.03
MW-1	01/20/1989	ND	ND	NA	NA	ND	NA	NA	NA	NA	NA	NA	73.89	12.91	60.98
MW-1	02/06/1989	ND	ND	ND	ND	ND	NA	NA	NA	NA	NA	NA	73.89	12.94	60.95
MW-1	03/10/1989	ND	ND	ND	ND	ND	NA	NA	NA	NA	NA	NA	73.89	12.59	61.30
MW-1	06/06/1989	ND	ND	ND	ND	ND	NA	NA	NA	NA	NA	NA	73.89	14.05	59.84
MW-1	09/07/1989	ND	ND	ND	ND	ND	NA	NA	NA	NA	NA	NA	73.89	14.92	58.97
MW-1	12/18/1989	ND	ND	ND	ND	ND	NA	NA	NA	NA	NA	NA	73.89	14.88	59.01
MW-1	03/08/1990	ND	ND	ND	ND	ND	NA	NA	NA	NA	NA	NA	73.89	14.08	59.81
MW-1	06/07/1990	ND	ND	ND	ND	ND	NA	NA	NA	NA	NA	NA	73.89	13.89	60.00
MW-1	09/05/1990	ND	ND	ND	ND	ND	NA	NA	NA	NA	NA	NA	73.89	14.83	59.06
MW-1	12/03/1990	ND	ND	ND	ND	ND	NA	NA	NA	NA	NA	NA	73.89	15.05	58.84
MW-1	03/01/1991	ND	ND	ND	ND	ND	NA	NA	NA	NA	NA	NA	73.89	14.34	59.55
MW-1	06/03/1991	ND	ND	ND	ND	ND	NA	NA	NA	NA	NA	NA	73.89	14.16	59.73
MW-1	09/04/1991	ND	ND	ND	ND	ND	NA	NA	NA	NA	NA	NA	73.89	14.60	59.29
MW-1	03/13/1992	ND	ND	ND	ND	ND	NA	NA	NA	NA	NA	NA	73.89	13.40	60.49
MW-1	06/03/1992	ND	ND	ND	ND	ND	NA	NA	NA	NA	NA	NA	73.89	13.76	60.13
MW-1	08/19/1992	87	ND	ND	ND	ND	NA	NA	NA	NA	NA	NA	73.89	14.57	59.32
MW-1	11/16/1992	ND	ND	ND	ND	ND	NA	NA	NA	NA	NA	NA	73.89	14.78	59.11
MW-1	02/18/1993	59a	ND	ND	ND	ND	NA	NA	NA	NA	NA	NA	73.89	12.14	61.75
MW-1	06/01/1993	ND	ND	ND	ND	ND	NA	NA	NA	NA	NA	NA	73.89	13.30	60.59
MW-1	08/30/1993	ND	ND	ND	ND	ND	NA	NA	NA	NA	NA	NA	73.89	14.32	59.57
MW-1	12/13/1993	ND	ND	ND	ND	ND	NA	NA	NA	NA	NA	NA	73.89	14.06	59.83
MW-1	03/03/1994	100	ND	ND	ND	ND	NA	NA	NA	NA	NA	NA	73.89	13.12	60.77

WELL CONCENTRATIONS
Shell-branded Service Station
230 West MacArthur Boulevard
Oakland, CA

Well ID	Date	TPPH (ug/L)	B (ug/L)	T (ug/L)	E (ug/L)	X (ug/L)	MTBE 8020 (ug/L)	MTBE 8260 (ug/L)	DIPE (ug/L)	ETBE (ug/L)	TAME (ug/L)	TBA (ug/L)	TOC (MSL)	Depth to Water (ft.)	GW Elevation (MSL)
MW-1	06/06/1994	ND	ND	ND	ND	ND	NA	NA	NA	NA	NA	NA	73.89	14.20	59.69
MW-1	09/12/1994	ND	ND	ND	ND	ND	NA	NA	NA	NA	NA	NA	73.89	15.72	58.17
MW-1	12/15/1994	ND	ND	ND	ND	ND	NA	NA	NA	NA	NA	NA	73.89	12.98	60.91
MW-1	3/13/1995 b	60	4.7	9.8	ND	2.9	NA	NA	NA	NA	NA	NA	73.89	11.74	62.15
MW-1	04/21/1995	ND	ND	ND	ND	ND	NA	NA	NA	NA	NA	NA	73.89	NA	NA
MW-1	06/26/1995	ND	ND	ND	ND	ND	NA	NA	NA	NA	NA	NA	73.89	13.00	60.89
MW-1	09/12/1995	ND	ND	ND	ND	ND	NA	NA	NA	NA	NA	NA	73.89	14.14	59.75
MW-1	03/21/1996	<50	<0.5	<0.5	<0.5	<0.5	ND	NA	NA	NA	NA	NA	73.89	11.03	62.86
MW-1	06/28/1996	<50	<0.5	<0.5	<0.5	<0.5	<2.5	NA	NA	NA	NA	NA	73.89	13.53	60.36
MW-1	09/19/1996	<50	<0.5	<0.5	<0.5	<0.5	<2.5	NA	NA	NA	NA	NA	73.89	14.33	59.56
MW-1	12/19/1996	NA	NA	NA	NA	NA	NA	NA	NA	NA	NA	NA	73.89	13.20	60.69
MW-1	12/05/1997	NA	NA	NA	NA	NA	NA	NA	NA	NA	NA	NA	73.89	12.39	61.50
MW-1	12/24/1998	NA	NA	NA	NA	NA	NA	NA	NA	NA	NA	NA	73.89	13.59	60.30
MW-1	12/23/1999	NA	NA	NA	NA	NA	NA	NA	NA	NA	NA	NA	73.89	15.63	58.26
MW-1	12/11/2000	NA	NA	NA	NA	NA	NA	NA	NA	NA	NA	NA	73.89	15.36	58.53
MW-1	12/27/2001	NA	NA	NA	NA	NA	NA	NA	NA	NA	NA	NA	73.89	12.09	61.80
MW-1	03/12/2002	NA	NA	NA	NA	NA	NA	NA	NA	NA	NA	NA	73.89	12.33	61.56
MW-1	03/14/2002	<50	<0.50	<0.50	<0.50	<0.50	NA	<5.0	NA	NA	NA	NA	73.89	12.08	61.81
MW-1	06/13/2002	NA	NA	NA	NA	NA	NA	NA	NA	NA	NA	NA	73.89	13.47	60.42
MW-1	09/09/2002	NA	NA	NA	NA	NA	NA	NA	NA	NA	NA	NA	76.92	14.30	62.62
MW-1	12/12/2002	NA	NA	NA	NA	NA	NA	NA	NA	NA	NA	NA	76.92	14.48	62.44
MW-1	03/10/2003	<50	<0.50	<0.50	<0.50	<0.50	NA	<5.0	NA	NA	NA	NA	76.92	12.76	64.16
MW-1	06/10/2003	NA	NA	NA	NA	NA	NA	NA	NA	NA	NA	NA	76.92	13.17	63.75
MW-1	09/16/2003	NA	NA	NA	NA	NA	NA	NA	NA	NA	NA	NA	76.92	14.10	62.82
MW-1	12/03/2003	NA	NA	NA	NA	NA	NA	NA	NA	NA	NA	NA	76.92	13.93	62.99
MW-1	03/11/2004	<50	<0.50	<0.50	<0.50	<1.0	NA	<0.50	NA	NA	NA	NA	76.92	12.04	64.88
MW-1	06/17/2004	NA	NA	NA	NA	NA	NA	NA	NA	NA	NA	NA	76.92	13.75	63.17
MW-1	09/13/2004	NA	NA	NA	NA	NA	NA	NA	NA	NA	NA	NA	76.92	14.47	62.45

WELL CONCENTRATIONS
Shell-branded Service Station
230 West MacArthur Boulevard
Oakland, CA

Well ID	Date	TPPH (ug/L)	B (ug/L)	T (ug/L)	E (ug/L)	X (ug/L)	MTBE 8020 (ug/L)	MTBE 8260 (ug/L)	DIPE (ug/L)	ETBE (ug/L)	TAME (ug/L)	TBA (ug/L)	TOC (MSL)	Depth to Water (ft.)	GW Elevation (MSL)
MW-1	12/07/2004	NA	NA	NA	NA	NA	NA	NA	NA	NA	NA	NA	76.92	13.04	63.88
MW-1	03/03/2005	<50	<0.50	<0.50	<0.50	<1.0	NA	<0.50	<2.0	<2.0	<2.0	<5.0	76.92	11.31	65.61
MW-1	06/14/2005	NA	NA	NA	NA	NA	NA	NA	NA	NA	NA	NA	76.92	11.87	65.05
MW-1	09/19/2005	NA	NA	NA	NA	NA	NA	NA	NA	NA	NA	NA	76.92	13.91	63.01
MW-2	07/14/1988	ND	7.9	2.6	1.1	4	NA	NA	NA	NA	NA	NA	75.24	15.18	60.06
MW-2	10/04/1988	90	ND	1.3	2.3	12	NA	NA	NA	NA	NA	NA	75.24	15.30	59.94
MW-2	11/10/1988	ND	ND	ND	ND	2	NA	NA	NA	NA	NA	NA	75.24	15.17	60.07
MW-2	12/09/1988	ND	ND	0.6	ND	3	NA	NA	NA	NA	NA	NA	75.24	14.82	60.42
MW-2	01/20/1989	ND	ND	ND	ND	ND	NA	NA	NA	NA	NA	NA	75.24	14.54	60.70
MW-2	02/06/1989	NA	ND	ND	ND	ND	NA	NA	NA	NA	NA	NA	75.24	14.59	60.65
MW-2	03/10/1989	ND	ND	ND	ND	ND	NA	NA	NA	NA	NA	NA	75.24	14.88	60.36
MW-2	06/06/1989	ND	ND	0.5	ND	ND	NA	NA	NA	NA	NA	NA	75.24	15.30	59.94
MW-2	09/07/1989	ND	ND	ND	ND	ND	NA	NA	NA	NA	NA	NA	75.24	16.76	58.48
MW-2	12/18/1989	ND	ND	ND	ND	ND	NA	NA	NA	NA	NA	NA	75.24	16.65	58.59
MW-2	03/08/1990	ND	ND	ND	ND	ND	NA	NA	NA	NA	NA	NA	75.24	15.92	59.32
MW-2	06/07/1990	ND	ND	ND	ND	ND	NA	NA	NA	NA	NA	NA	75.24	16.10	59.14
MW-2	09/05/1990	ND	ND	ND	ND	ND	NA	NA	NA	NA	NA	NA	75.24	16.61	58.63
MW-2	12/03/1990	ND	ND	ND	ND	ND	NA	NA	NA	NA	NA	NA	75.24	17.06	58.18
MW-2	03/01/1991	ND	ND	ND	ND	ND	NA	NA	NA	NA	NA	NA	75.24	16.62	58.62
MW-2	06/03/1991	ND	ND	ND	ND	ND	NA	NA	NA	NA	NA	NA	75.24	16.65	58.59
MW-2	09/04/1991	ND	ND	ND	ND	ND	NA	NA	NA	NA	NA	NA	75.24	16.57	58.67
MW-2	03/13/1992	ND	ND	ND	ND	ND	NA	NA	NA	NA	NA	NA	75.24	14.66	60.58
MW-2	06/03/1992	ND	ND	ND	ND	ND	NA	NA	NA	NA	NA	NA	75.24	15.90	59.34
MW-2	08/19/1992	67	ND	ND	ND	ND	NA	NA	NA	NA	NA	NA	75.24	16.72	58.52
MW-2	11/16/1992	50	ND	ND	ND	1.2	NA	NA	NA	NA	NA	NA	75.24	16.66	58.58
MW-2	02/18/1993	52a	ND	ND	ND	ND	NA	NA	NA	NA	NA	NA	75.24	13.88	61.36
MW-2 (D)	02/18/1993	52a	ND	ND	ND	ND	NA	NA	NA	NA	NA	NA	75.24	13.88	61.36

WELL CONCENTRATIONS
Shell-branded Service Station
230 West MacArthur Boulevard
Oakland, CA

Well ID	Date	TPPH (ug/L)	B (ug/L)	T (ug/L)	E (ug/L)	X (ug/L)	MTBE 8020 (ug/L)	MTBE 8260 (ug/L)	DIPE (ug/L)	ETBE (ug/L)	TAME (ug/L)	TBA (ug/L)	TOC (MSL)	Depth to Water (ft.)	GW Elevation (MSL)
MW-2	06/01/1993	ND	ND	ND	ND	ND	NA	NA	NA	NA	NA	NA	75.24	14.74	60.50
MW-2	08/30/1993	70a	ND	ND	ND	ND	NA	NA	NA	NA	NA	NA	75.24	15.85	59.39
MW-2	12/13/1993	68a	ND	ND	ND	ND	NA	NA	NA	NA	NA	NA	75.24	15.83	59.41
MW-2	03/03/1994	280a	ND	ND	ND	ND	NA	NA	NA	NA	NA	NA	75.24	14.80	60.44
MW-2	06/06/1994	ND	ND	ND	ND	ND	NA	NA	NA	NA	NA	NA	75.24	16.65	58.59
MW-2	09/12/1994	ND	ND	ND	ND	ND	NA	NA	NA	NA	NA	NA	75.24	16.72	58.52
MW-2	12/15/1994	230a	ND	ND	ND	ND	NA	NA	NA	NA	NA	NA	75.24	15.25	59.99
MW-2	03/13/1995	ND	2.9	6.3	ND	2.7	NA	NA	NA	NA	NA	NA	75.24	15.32	59.92
MW-2	04/21/1995	ND	ND	ND	ND	ND	NA	NA	NA	NA	NA	NA	75.24	NA	NA
MW-2	06/26/1995	ND	ND	ND	ND	ND	NA	NA	NA	NA	NA	NA	75.24	14.65	60.59
MW-2	09/12/1995	ND	ND	ND	ND	ND	NA	NA	NA	NA	NA	NA	75.24	15.78	59.46
MW-2	03/21/1996	<50	<0.5	<0.5	<0.5	<0.5	ND	NA	NA	NA	NA	NA	75.24	12.72	62.52
MW-2	06/28/1996	<50	<0.5	<0.5	<0.5	<0.5	160	NA	NA	NA	NA	NA	75.24	14.95	60.29
MW-2	09/19/1996	<50	<0.5	<0.5	<0.5	<0.5	27	NA	NA	NA	NA	NA	75.24	15.64	59.60
MW-2	12/19/1996	NA	NA	NA	NA	NA	NA	NA	NA	NA	NA	NA	75.24	14.47	60.77
MW-2	12/05/1997	NA	NA	NA	NA	NA	NA	NA	NA	NA	NA	NA	75.24	14.22	61.02
MW-2	12/24/1998	NA	NA	NA	NA	NA	NA	NA	NA	NA	NA	NA	75.24	14.97	60.27
MW-2	12/23/1999	NA	NA	NA	NA	NA	NA	NA	NA	NA	NA	NA	75.24	16.07	59.17
MW-2	12/11/2000	NA	NA	NA	NA	NA	NA	NA	NA	NA	NA	NA	75.24	15.78	59.46
MW-2	12/27/2001	NA	NA	NA	NA	NA	NA	95	NA	NA	NA	NA	75.24	14.25	60.99
MW-2	03/14/2002	120	<0.50	<0.50	<0.50	<0.50	NA	31	NA	NA	NA	NA	75.24	14.59	60.65
MW-2	06/13/2002	100	<0.50	<0.50	<0.50	<0.50	NA	32	NA	NA	NA	NA	75.24	14.58	60.66
MW-2	09/09/2002	90	<0.50	<0.50	<0.50	<0.50	NA	54	NA	NA	NA	NA	78.25	15.49	62.76
MW-2	12/12/2002	92	<0.50	<0.50	<0.50	<0.50	NA	21	NA	NA	NA	NA	78.25	16.21	62.04
MW-2	03/10/2003	110	<0.50	<0.50	<0.50	<0.50	NA	33	NA	NA	NA	NA	78.25	14.33	63.92
MW-2	06/10/2003	<50	<0.50	<0.50	<0.50	<1.0	NA	49	NA	NA	NA	NA	78.25	14.48	63.77
MW-2	09/16/2003	<50	<0.50	<0.50	<0.50	<1.0	NA	39	NA	NA	NA	NA	78.25	15.45	62.80
MW-2	12/03/2003	56 a	<0.50	<0.50	<0.50	<1.0	NA	3.6	NA	NA	NA	NA	78.25	15.60	62.65

WELL CONCENTRATIONS
Shell-branded Service Station
230 West MacArthur Boulevard
Oakland, CA

Well ID	Date	TPPH (ug/L)	B (ug/L)	T (ug/L)	E (ug/L)	X (ug/L)	MTBE 8020 (ug/L)	MTBE 8260 (ug/L)	DIPE (ug/L)	ETBE (ug/L)	TAME (ug/L)	TBA (ug/L)	TOC (MSL)	Depth to Water (ft.)	GW Elevation (MSL)
---------	------	----------------	-------------	-------------	-------------	-------------	------------------------	------------------------	----------------	----------------	----------------	---------------	--------------	----------------------------	--------------------------

MW-2	03/11/2004	58 a	<0.50	<0.50	<0.50	<1.0	NA	67	NA	NA	NA	NA	78.25	13.78	64.47
MW-2	06/17/2004	<50	<0.50	<0.50	<0.50	<1.0	NA	40	NA	NA	NA	NA	78.25	14.87	63.38
MW-2	09/13/2004	68 d	<0.50	<0.50	<0.50	<1.0	NA	44	<2.0	<2.0	<2.0	<5.0	78.25	15.85	62.40
MW-2	12/07/2004	<50 e	<0.50	<0.50	<0.50	<1.0	NA	54	NA	NA	NA	NA	78.25	15.17	63.08
MW-2	03/03/2005	110 e	<0.50	<0.50	<0.50	<1.0	NA	82	NA	NA	NA	NA	78.25	13.38	64.87
MW-2	06/14/2005	<50 e	<0.50	<0.50	<0.50	<1.0	NA	29	NA	NA	NA	NA	78.25	13.95	64.30
MW-2	09/19/2005	<50	<0.50	<0.50	<0.50	<1.0	NA	31	<2.0	<2.0	<2.0	5.6	78.25	14.78	63.47

MW-3	07/14/1988	ND	ND	ND	ND	ND	NA	NA	NA	NA	NA	NA	74.68	14.05	60.63
MW-3	10/04/1988	ND	ND	ND	ND	5	NA	NA	NA	NA	NA	NA	74.68	14.60	60.08
MW-3	11/10/1988	ND	ND	ND	ND	ND	NA	NA	NA	NA	NA	NA	74.68	14.35	60.33
MW-3	12/09/1988	ND	ND	ND	ND	ND	NA	NA	NA	NA	NA	NA	74.68	14.04	60.64
MW-3	01/10/1989	ND	ND	ND	ND	NA	NA	NA	NA	NA	NA	NA	74.68	13.70	60.98
MW-3	01/20/1989	NA	NA	ND	ND	ND	NA	NA	NA	NA	NA	NA	74.68	13.72	60.96
MW-3	02/06/1989	70	ND	ND	ND	ND	NA	NA	NA	NA	NA	NA	74.68	13.75	60.93
MW-3	03/10/1989	150	ND	ND	ND	ND	NA	NA	NA	NA	NA	NA	74.68	13.42	61.26
MW-3	06/06/1989	ND	ND	ND	ND	ND	NA	NA	NA	NA	NA	NA	74.68	14.52	60.16
MW-3	09/07/1989	ND	0.65	ND	ND	ND	NA	NA	NA	NA	NA	NA	74.68	15.52	59.16
MW-3	12/18/1989	46	1.3	ND	0.44	0.66	NA	NA	NA	NA	NA	NA	74.68	19.59	55.09
MW-3	03/08/1990	ND	ND	ND	ND	ND	NA	NA	NA	NA	NA	NA	74.68	14.72	59.96
MW-3	06/07/1990	ND	ND	ND	ND	ND	NA	NA	NA	NA	NA	NA	74.68	14.65	60.03
MW-3	09/05/1990	ND	ND	ND	ND	ND	NA	NA	NA	NA	NA	NA	74.68	15.51	59.17
MW-3	12/03/1990	ND	ND	ND	ND	ND	NA	NA	NA	NA	NA	NA	74.68	14.85	59.83
MW-3	03/01/1991	1.9	59	ND	22	ND	NA	NA	NA	NA	NA	NA	74.68	14.92	59.76
MW-3	06/03/1991	ND	ND	ND	ND	ND	NA	NA	NA	NA	NA	NA	74.68	14.75	59.93
MW-3	09/04/1991	ND	ND	ND	ND	ND	NA	NA	NA	NA	NA	NA	74.68	15.14	59.54
MW-3	03/13/1992	ND	ND	ND	ND	ND	NA	NA	NA	NA	NA	NA	74.68	13.50	61.18
MW-3	06/03/1992	ND	ND	ND	ND	ND	NA	NA	NA	NA	NA	NA	74.68	14.39	60.29

WELL CONCENTRATIONS
Shell-branded Service Station
230 West MacArthur Boulevard
Oakland, CA

Well ID	Date	TPPH (ug/L)	B (ug/L)	T (ug/L)	E (ug/L)	X (ug/L)	MTBE 8020 (ug/L)	MTBE 8260 (ug/L)	DIPE (ug/L)	ETBE (ug/L)	TAME (ug/L)	TBA (ug/L)	TOC (MSL)	Depth to Water (ft.)	GW Elevation (MSL)
MW-3	08/19/1992	92	ND	ND	ND	ND	NA	NA	NA	NA	NA	NA	74.68	15.08	59.60
MW-3 (D)	08/19/1992	76	ND	ND	ND	ND	NA	NA	NA	NA	NA	NA	74.68	15.08	59.60
MW-3	11/16/1992	200a	ND	ND	ND	ND	NA	NA	NA	NA	NA	NA	74.68	15.43	59.25
MW-3 (D)	11/16/1992	140a	ND	ND	ND	ND	NA	NA	NA	NA	NA	NA	74.68	15.43	59.25
MW-3	02/18/1993	680a	ND	ND	ND	ND	NA	NA	NA	NA	NA	NA	74.68	12.96	61.72
MW-3	06/01/1993	160a	ND	ND	ND	ND	NA	NA	NA	NA	NA	NA	74.68	13.98	60.70
MW-3 (D)	06/01/1993	150a	ND	ND	ND	ND	NA	NA	NA	NA	NA	NA	74.68	13.98	60.70
MW-3	08/30/1993	110a	ND	ND	ND	ND	NA	NA	NA	NA	NA	NA	74.68	14.82	59.86
MW-3	12/13/1993	140a	ND	ND	ND	ND	NA	NA	NA	NA	NA	NA	74.68	14.70	59.98
MW-3 (D)	12/13/1993	110a	ND	ND	ND	ND	NA	NA	NA	NA	NA	NA	74.68	14.70	59.98
MW-3	03/03/1994	61a	ND	ND	ND	ND	NA	NA	NA	NA	NA	NA	74.68	13.92	60.76
MW-3	06/06/1994	ND	ND	ND	ND	ND	NA	NA	NA	NA	NA	NA	74.68	14.73	59.95
MW-3	09/12/1994	ND	ND	ND	ND	ND	NA	NA	NA	NA	NA	NA	74.68	15.42	59.26
MW-3	12/15/1994	ND	ND	0.9	ND	0.6	NA	NA	NA	NA	NA	NA	74.68	13.80	60.88
MW-3	03/13/1995	100a	7.9	17	0.7	6.1	NA	NA	NA	NA	NA	NA	74.68	12.41	62.27
MW-3	04/21/1995	60	0.9	1.1	ND	1	NA	NA	NA	NA	NA	NA	74.68	NA	NA
MW-3	06/26/1995	ND	ND	ND	ND	ND	NA	NA	NA	NA	NA	NA	74.68	13.79	60.89
MW-3	09/12/1995 b	ND	ND	ND	ND	ND	NA	NA	NA	NA	NA	NA	74.68	14.77	59.91
MW-3	03/21/1996	<50	<0.5	<0.5	<0.5	<0.5	17	NA	NA	NA	NA	NA	74.68	11.80	62.88
MW-3	06/28/1996	<50	<0.5	<0.5	<0.5	<0.5	<0.5	NA	NA	NA	NA	NA	74.68	14.19	60.49
MW-3	09/19/1996	<50	<0.5	<0.5	<0.5	<0.5	<2.5	NA	NA	NA	NA	NA	74.68	14.85	59.83
MW-3	12/19/1996	NA	NA	NA	NA	NA	NA	NA	NA	NA	NA	NA	74.68	13.61	61.07
MW-3	12/05/1997	NA	NA	NA	NA	NA	NA	NA	NA	NA	NA	NA	74.68	13.16	61.52
MW-3	12/24/1998	NA	NA	NA	NA	NA	NA	NA	NA	NA	NA	NA	74.68	14.08	60.60
MW-3	12/23/1999	NA	NA	NA	NA	NA	NA	NA	NA	NA	NA	NA	74.68	15.92	58.76
MW-3	12/11/2000	NA	NA	NA	NA	NA	NA	NA	NA	NA	NA	NA	74.68	15.31	59.37
MW-3	12/27/2001	NA	NA	NA	NA	NA	NA	NA	NA	NA	NA	NA	74.68	12.84	61.84
MW-3	03/12/2002	NA	NA	NA	NA	NA	NA	NA	NA	NA	NA	NA	74.68	12.54	62.14

WELL CONCENTRATIONS
Shell-branded Service Station
230 West MacArthur Boulevard
Oakland, CA

Well ID	Date	TPPH (ug/L)	B (ug/L)	T (ug/L)	E (ug/L)	X (ug/L)	MTBE 8020 (ug/L)	MTBE 8260 (ug/L)	DIPE (ug/L)	ETBE (ug/L)	TAME (ug/L)	TBA (ug/L)	TOC (MSL)	Depth to Water (ft.)	GW Elevation (MSL)
---------	------	----------------	-------------	-------------	-------------	-------------	------------------------	------------------------	----------------	----------------	----------------	---------------	--------------	----------------------------	--------------------------

MW-3	03/14/2002	<50	<0.50	<0.50	<0.50	<0.50	NA	40	NA	NA	NA	NA	74.68	12.78	61.90
MW-3	06/13/2002	NA	NA	NA	NA	NA	NA	NA	NA	NA	NA	NA	74.68	14.06	60.62
MW-3	09/09/2002	NA	NA	NA	NA	NA	NA	NA	NA	NA	NA	NA	77.69	14.77	62.92
MW-3	12/12/2002	NA	NA	NA	NA	NA	NA	NA	NA	NA	NA	NA	77.69	15.11	62.58
MW-3	03/10/2003	<50	<0.50	<0.50	<0.50	<0.50	NA	5.4	NA	NA	NA	NA	77.69	13.52	64.17
MW-3	06/10/2003	NA	NA	NA	NA	NA	NA	NA	NA	NA	NA	NA	77.69	13.82	63.87
MW-3	09/16/2003	NA	NA	NA	NA	NA	NA	NA	NA	NA	NA	NA	77.69	14.60	63.09
MW-3	12/03/2003	NA	NA	NA	NA	NA	NA	NA	NA	NA	NA	NA	77.69	14.53	63.16
MW-3	03/11/2004	<50	<0.50	<0.50	<0.50	<1.0	NA	3.5	NA	NA	NA	NA	77.69	12.38	65.31
MW-3	06/17/2004	NA	NA	NA	NA	NA	NA	NA	NA	NA	NA	NA	77.69	14.28	63.41
MW-3	09/13/2004	NA	NA	NA	NA	NA	NA	NA	NA	NA	NA	NA	77.69	14.78	62.91
MW-3	12/07/2004	NA	NA	NA	NA	NA	NA	NA	NA	NA	NA	NA	77.69	13.77	63.92
MW-3	03/03/2005	120	1.3	<0.50	<0.50	2.7	NA	2.3	<2.0	<2.0	<2.0	37	77.69	11.84	65.85
MW-3	06/14/2005	NA	NA	NA	NA	NA	NA	NA	NA	NA	NA	NA	77.69	12.29	65.40
MW-3	09/19/2005	NA	NA	NA	NA	NA	NA	NA	NA	NA	NA	NA	77.69	14.33	63.36

MW-4	01/23/1990	1,600	100	10	30	20	NA	NA	NA	NA	NA	NA	73.83	14.68	59.15
MW-4	03/08/1990	4,200	260	18	88	39	NA	NA	NA	NA	NA	NA	73.83	14.38	59.45
MW-4	06/07/1990	2,000	150	6.9	14	17	NA	NA	NA	NA	NA	NA	73.83	14.27	59.56
MW-4	09/05/1990	1,700	130	10	7.2	19	NA	NA	NA	NA	NA	NA	73.83	15.40	58.43
MW-4	12/03/1990	2,600	108	41	17	59	NA	NA	NA	NA	NA	NA	73.83	15.90	57.93
MW-4	06/03/1991	2,800	160	15	8.8	32	NA	NA	NA	NA	NA	NA	73.83	14.60	59.23
MW-4	09/04/1991	Sheen	NA	NA	NA	NA	NA	NA	NA	NA	NA	NA	73.83	15.25	58.58
MW-4	03/13/1992	2,700	180	70	5.9	29	NA	NA	NA	NA	NA	NA	73.83	12.72	61.11
MW-4	06/03/1992	1,700	190	ND	30	23	NA	NA	NA	NA	NA	NA	73.83	14.33	59.50
MW-4	08/19/1992	170	4.2	ND	0.6	1	NA	NA	NA	NA	NA	NA	73.83	15.18	58.65
MW-4	11/16/1992	2,600	92	49	50	81	NA	NA	NA	NA	NA	NA	73.83	15.39	58.44
MW-4	02/18/1993	7,400	120	38	51	87	NA	NA	NA	NA	NA	NA	73.83	12.62	61.21

WELL CONCENTRATIONS
Shell-branded Service Station
230 West MacArthur Boulevard
Oakland, CA

Well ID	Date	TPPH (ug/L)	B (ug/L)	T (ug/L)	E (ug/L)	X (ug/L)	MTBE 8020 (ug/L)	MTBE 8260 (ug/L)	DIPE (ug/L)	ETBE (ug/L)	TAME (ug/L)	TBA (ug/L)	TOC (MSL)	Depth to Water (ft.)	GW Elevation (MSL)
MW-4	06/01/1993	7,000	1,800	1,700	1,600	1,700	NA	NA	NA	NA	NA	NA	73.83	13.68	60.15
MW-4	08/30/1993	2,100	80	11	ND	11	NA	NA	NA	NA	NA	NA	73.83	14.83	59.00
MW-4 (D)	08/30/1993	2,100	77	5.6	ND	5.5	NA	NA	NA	NA	NA	NA	73.83	14.83	59.00
MW-4	12/13/1993	2,000a	20	ND	21	52	NA	NA	NA	NA	NA	NA	73.83	14.50	59.33
MW-4	03/03/1994	3,500	150	86	85	90	NA	NA	NA	NA	NA	NA	73.83	13.48	60.35
MW-4 (D)	03/03/1994	3,200	130	73	74	76	NA	NA	NA	NA	NA	NA	73.83	13.48	60.35
MW-4	06/06/1994	590	25	ND	ND	ND	NA	NA	NA	NA	NA	NA	73.83	14.26	59.57
MW-4 (D)	06/06/1994	400	16	ND	ND	ND	NA	NA	NA	NA	NA	NA	73.83	14.26	59.57
MW-4	09/12/1994	1,800	42	ND	3.7	4.7	NA	NA	NA	NA	NA	NA	73.83	15.42	58.41
MW-4 (D)	09/12/1994	2,000	40	ND	5.7	8	NA	NA	NA	NA	NA	NA	73.83	15.42	58.41
MW-4	12/15/1994	2,900	78	14	94	17	NA	NA	NA	NA	NA	NA	73.83	13.43	60.40
MW-4 (D)	12/15/1994	2,900	90	7	96	18	NA	NA	NA	NA	NA	NA	73.83	13.43	60.40
MW-4	03/13/1995	2,700	240	24	99	34	NA	NA	NA	NA	NA	NA	73.83	12.13	61.70
MW-4 (D)	03/13/1995	2,500	300	24	140	28	NA	NA	NA	NA	NA	NA	73.83	12.13	61.70
MW-4	06/25/1995	2,100	87	10	67	25	NA	NA	NA	NA	NA	NA	73.83	13.26	60.57
MW-4 (D)	06/25/1995	2,300	92	12	74	26	NA	NA	NA	NA	NA	NA	73.83	13.26	60.57
MW-4	09/12/1995 b	1,300	33	13	9.3	15	NA	NA	NA	NA	NA	NA	73.83	14.64	59.19
MW-4 (D)	09/12/1995 b	1,500	2.1	16	11	17	NA	NA	NA	NA	NA	NA	73.83	14.64	59.19
MW-4	03/21/1996	2,100	50	3.2	40	5.4	ND	NA	NA	NA	NA	NA	73.83	11.55	62.28
MW-4 (D)	03/21/1996	1,700	24	<0.5	39	7.2	740	NA	NA	NA	NA	NA	73.83	11.55	62.28
MW-4	06/28/1996	1,300	61	6.2	53	11	1,000	NA	NA	NA	NA	NA	73.83	13.86	59.97
MW-4 (D)	06/28/1996	1,200	29	6.2	50	8.3	1,000	NA	NA	NA	NA	NA	73.83	13.86	59.97
MW-4	09/19/1996	820	12	<2.5	2.8	4.3	720	NA	NA	NA	NA	NA	73.83	14.72	59.11
MW-4 (D)	09/19/1996	580	9.6	<2.5	<2.5	<2.5	760	1,200	NA	NA	NA	NA	73.83	14.72	59.11
MW-4	12/19/1996	1,200	28	<5.0	<5.0	<5.0	<25	NA	NA	NA	NA	NA	73.83	13.06	60.77
MW-4	12/05/1997	1,900	36	9	16	18	630	NA	NA	NA	NA	NA	73.83	12.89	60.94
MW-4	12/24/1998	1,100	23	5.3	38	7.9	1,100	NA	NA	NA	NA	NA	73.83	13.92	59.91
MW-4	12/17/1999	1,100	22	21	13	11	3,800	3,200	NA	NA	NA	NA	73.83	14.28	59.55

WELL CONCENTRATIONS
Shell-branded Service Station
230 West MacArthur Boulevard
Oakland, CA

Well ID	Date	TPPH (ug/L)	B (ug/L)	T (ug/L)	E (ug/L)	X (ug/L)	MTBE 8020 (ug/L)	MTBE 8260 (ug/L)	DIPE (ug/L)	ETBE (ug/L)	TAME (ug/L)	TBA (ug/L)	TOC (MSL)	Depth to Water (ft.)	GW Elevation (MSL)
MW-4	12/23/1999	NA	NA	NA	NA	NA	NA	NA	NA	NA	NA	NA	73.83	16.24	57.59
MW-4	12/11/2000	975	25.0	11.3	<5.00	<5.00	1960	1730c	NA	NA	NA	NA	73.83	14.15	59.68
MW-4	12/27/2001	2,000	9.9	<5.0	18	<5.0	NA	1,400	NA	NA	NA	NA	73.83	12.61	61.22
MW-4	03/14/2002	1,700	6.6	<2.0	2.1	2.1	NA	1,100	NA	NA	NA	NA	73.83	12.35	61.48
MW-4	06/13/2002	1,200	4.7	<2.0	<2.0	<2.0	NA	1,100	NA	NA	NA	NA	73.83	13.72	60.11
MW-4	09/09/2002	620	3.7	<2.0	<2.0	<2.0	NA	760	NA	NA	NA	NA	76.82	14.56	62.26
MW-4	12/12/2002	1,500	3.9	<2.0	<2.0	<2.0	NA	880	NA	NA	NA	NA	76.82	14.82	62.00
MW-4	03/10/2003	2,300	5.7	0.95	3.8	0.63	NA	1,200	NA	NA	NA	NA	76.82	13.63	63.19
MW-4	06/10/2003	2,200	5.3	<5.0	<5.0	<10	NA	880	NA	NA	NA	NA	76.82	13.68	63.14
MW-4	09/16/2003	1,400	<5.0	<5.0	<5.0	<10	NA	420	NA	NA	NA	NA	76.82	14.35	62.47
MW-4	12/03/2003	2,600	5.0	<5.0	<5.0	<10	NA	840	NA	NA	NA	NA	76.82	14.27	62.55
MW-4	03/11/2004	1900 a	6.3	<5.0	<5.0	<10	NA	800	NA	NA	NA	NA	76.82	12.62	64.20
MW-4	06/17/2004	1,000	7.4	<2.5	<2.5	<5.0	NA	460	NA	NA	NA	NA	76.82	13.90	62.92
MW-4	09/13/2004	1,100	4.6	<2.5	<2.5	<5.0	NA	300	<10	<10	<10	160	76.82	14.67	62.15
MW-4	12/07/2004	2,200	4.6	<2.5	<2.5	<5.0	NA	430	NA	NA	NA	NA	76.82	13.92	62.90
MW-4	03/03/2005	2,500	5.3	<2.5	<2.5	<5.0	NA	620	NA	NA	NA	NA	76.82	11.75	65.07
MW-4	06/14/2005	<50	<0.50	<0.50	<0.50	<1.0	NA	51	NA	NA	NA	NA	76.82	12.20	64.62
MW-4	09/19/2005	1,200	2.7	<0.50	<0.50	<1.0	NA	140	8.4	<2.0	<2.0	280	76.82	14.08	62.74

WELL CONCENTRATIONS
Shell-branded Service Station
230 West MacArthur Boulevard
Oakland, CA

Well ID	Date	TPPH (ug/L)	B (ug/L)	T (ug/L)	E (ug/L)	X (ug/L)	MTBE 8020 (ug/L)	MTBE 8260 (ug/L)	DIPE (ug/L)	ETBE (ug/L)	TAME (ug/L)	TBA (ug/L)	TOC (MSL)	Depth to Water (ft.)	GW Elevation (MSL)
---------	------	----------------	-------------	-------------	-------------	-------------	------------------------	------------------------	----------------	----------------	----------------	---------------	--------------	----------------------------	--------------------------

Abbreviations:

TPPH = Total petroleum hydrocarbons as gasoline by EPA Method 8260B; prior to December 27, 2001, by EPA Method 8015.

BTEX = Benzene, toluene, ethylbenzene, xylenes by EPA Method 8260B; prior to December 27, 2001, by EPA Method 8020.

MTBE = Methyl tertiary butyl ether

DIPE = Di-isopropyl ether, analyzed by EPA Method 8260B

ETBE = Ethyl tertiary butyl ether, analyzed by EPA Method 8260B

TAME = Tertiary amyl methyl ether, analyzed by EPA Method 8260B

TBA = Tertiary butyl alcohol, analyzed by EPA Method 8260B

TOC = Top of Casing Elevation

GW = Groundwater

ug/L = Parts per billion

MSL = Mean sea level

ft. = Feet

<n = Below detection limit

(D) = Duplicate sample

ND = Not detected at or above the quantitative limit.

NA = Not applicable

Notes:

a = Chromatogram pattern indicates the presence of an unidentified hydrocarbon/Hydrocarbon does not match pattern of laboratory's standard.

b = The laboratory noted the sample was analyzed after the method specified holding time.

c = This sample was analyzed outside of EPA recommended hold time.

d = Sample contains discrete peak in gasoline range.

e = The concentration reported reflects individual or discrete unidentified peaks not matching a typical fuel pattern.

Site surveyed January 30, 2002 by Virgil Chavez Land Surveying of Vallejo, CA.

Blaine Tech Services, Inc.

September 28, 2005

1680 Rogers Avenue
San Jose, CA 95112-1105
Attn.: Leon Gearhart
Project#: 050919-MD2
Project: 98995741
Site: 230 W. MacArthur Blvd., Oakland

Dear Mr. Gearhart,

Attached is our report for your samples received on 09/20/2005 16:19
This report has been reviewed and approved for release. Reproduction of this report
is permitted only in its entirety.

Please note that any unused portion of the samples will be discarded after
11/04/2005 unless you have requested otherwise.

We appreciate the opportunity to be of service to you. If you have any questions,

You can also contact me via email. My email address is: mbrewer@stl-inc.com

Sincerely,

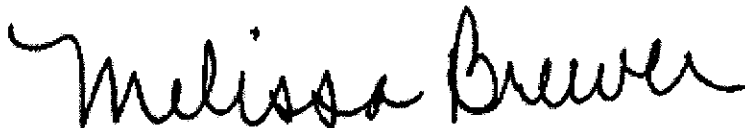

Melissa Brewer
Project Manager

Gas/BTEX Fuel Oxygenates by 8260B (C6-C12)

Blaine Tech Services, Inc.

Attn.: Leon Gearhart

1680 Rogers Avenue

San Jose, CA 95112-1105

Phone: (408) 573-0555 Fax: (408) 573-7771

Project: 050919-MD2

98995741

Received: 09/20/2005 16:19

Site: 230 W. MacArthur Blvd., Oakland

Samples Reported

Sample Name	Date Sampled	Matrix	Lab #
MW-2	09/19/2005 10:35	Water	1
MW-4	09/19/2005 11:00	Water	2

Gas/BTEX Fuel Oxygenates by 8260B (C6-C12)

Blaine Tech Services, Inc.

Attn.: Leon Gearhart

1680 Rogers Avenue

San Jose, CA 95112-1105

Phone: (408) 573-0555 Fax: (408) 573-7771

Project: 050919-MD2

98995741

Received: 09/20/2005 16:19

Site: 230 W. MacArthur Blvd., Oakland

Prep(s): 5030B Test(s): 8260B
 Sample ID: MW-4 Lab ID: 2005-09-0555 - 2
 Sampled: 09/19/2005 11:00 Extracted: 9/24/2005 02:26
 Matrix: Water QC Batch#: 2005/09/23-2B.64
 pH: <2

Compound	Conc.	RL	Unit	Dilution	Analyzed	Flag
Gasoline [Shell]	1200	50	ug/L	1.00	09/24/2005 02:26	
Benzene	2.7	0.50	ug/L	1.00	09/24/2005 02:26	
Toluene	ND	0.50	ug/L	1.00	09/24/2005 02:26	
Ethylbenzene	ND	0.50	ug/L	1.00	09/24/2005 02:26	
Total xylenes	ND	1.0	ug/L	1.00	09/24/2005 02:26	
tert-Butyl alcohol (TBA)	280	5.0	ug/L	1.00	09/24/2005 02:26	
Methyl tert-butyl ether (MTBE)	140	0.50	ug/L	1.00	09/24/2005 02:26	
Di-isopropyl Ether (DIPE)	8.4	2.0	ug/L	1.00	09/24/2005 02:26	
Ethyl tert-butyl ether (ETBE)	ND	2.0	ug/L	1.00	09/24/2005 02:26	
tert-Amyl methyl ether (TAME)	ND	2.0	ug/L	1.00	09/24/2005 02:26	
Surrogate(s)						
1,2-Dichloroethane-d4	102.8	73-130	%	1.00	09/24/2005 02:26	
Toluene-d8	112.1	81-114	%	1.00	09/24/2005 02:26	

Gas/BTEX Fuel Oxygenates by 8260B (C6-C12)

Blaine Tech Services, Inc.

Attn.: Leon Gearhart

1680 Rogers Avenue
San Jose, CA 95112-1105
Phone: (408) 573-0555 Fax: (408) 573-7771

Project: 050919-MD2
98995741

Received: 09/20/2005 16:19

Site: 230 W. MacArthur Blvd., Oakland

Batch QC Report

Prep(s): 5030B

Test(s): 8260B

Method Blank

Water

QC Batch # 2005/09/23-2B.64

MB: 2005/09/23-2B.64-000

Date Extracted: 09/23/2005 19:00

Compound	Conc.	RL	Unit	Analyzed	Flag
Gasoline [Shell]	ND	50	ug/L	09/23/2005 19:00	
tert-Butyl alcohol (TBA)	ND	5.0	ug/L	09/23/2005 19:00	
Methyl tert-butyl ether (MTBE)	ND	0.5	ug/L	09/23/2005 19:00	
Di-isopropyl Ether (DIPE)	ND	2.0	ug/L	09/23/2005 19:00	
Ethyl tert-butyl ether (ETBE)	ND	2.0	ug/L	09/23/2005 19:00	
tert-Amyl methyl ether (TAME)	ND	2.0	ug/L	09/23/2005 19:00	
Benzene	ND	0.5	ug/L	09/23/2005 19:00	
Toluene	ND	0.5	ug/L	09/23/2005 19:00	
Ethylbenzene	ND	0.5	ug/L	09/23/2005 19:00	
Total xylenes	ND	1.0	ug/L	09/23/2005 19:00	
Surrogates(s)					
1,2-Dichloroethane-d4	97.8	73-130	%	09/23/2005 19:00	
Toluene-d8	106.5	81-114	%	09/23/2005 19:00	

Gas/BTEX Fuel Oxygenates by 8260B (C6-C12)

Blaine Tech Services, Inc.

Attn.: Leon Gearhart

1680 Rogers Avenue
San Jose, CA 95112-1105
Phone: (408) 573-0555 Fax: (408) 573-7771

Project: 050919-MD2
98995741

Received: 09/20/2005 16:19

Site: 230 W. MacArthur Blvd., Oakland

Batch QC Report

Prep(s): 5030B

Test(s): 8260B

Laboratory Control Spike

Water

QC Batch # 2005/09/23-2B.64

LCS 2005/09/23-2B.64-039
LCSD

Extracted: 09/23/2005

Analyzed: 09/23/2005 18:39

Compound	Conc. ug/L		Exp.Conc.	Recovery %		RPD	Ctrl.Limits %		Flags	
	LCS	LCSD		LCS	LCSD		%	Rec.	RPD	LCS
Methyl tert-butyl ether (MTBE)	24.6		25	98.4			65-165	20		
Benzene	27.8		25	111.2			69-129	20		
Toluene	28.5		25	114.0			70-130	20		
Surrogates(s)										
1,2-Dichloroethane-d4	467		500	93.4			73-130			
Toluene-d8	552		500	110.4			81-114			

Severn Trent Laboratories, Inc.

STL San Francisco * 1220 Quarry Lane, Pleasanton, CA 94566

Tel 925 484 1919 Fax 925 484 1096 * www.stl-inc.com * CA DHS ELAP# 2496

09/26/2005 19:54

Gas/BTEX Fuel Oxygenates by 8260B (C6-C12)

Blaine Tech Services, Inc.

Attn.: Leon Gearhart

1680 Rogers Avenue

San Jose, CA 95112-1105

Phone: (408) 573-0555 Fax: (408) 573-7771

Project: 050919-MD2

98995741

Received: 09/20/2005 16:19

Site: 230 W. MacArthur Blvd., Oakland

Batch QC Report

Prep(s): 5030B

Test(s): 8260B

Matrix Spike (MS / MSD)

Water

QC Batch # 2005/09/23-2B.64

MS/MSD

Lab ID: 2005-09-0511 - 004

MS: 2005/09/23-2B.64-027

Extracted: 09/23/2005

Analyzed: 09/23/2005 19:27

Dilution: 1.00

MSD: 2005/09/23-2B.64-048

Extracted: 09/23/2005

Analyzed: 09/23/2005 19:48

Dilution: 1.00

Compound	Conc. ug/L			Spk.Level ug/L	Recovery %			Limits %		Flags	
	MS	MSD	Sample		MS	MSD	RPD	Rec.	RPD	MS	MSD
Methyl tert-butyl ether	22.3	20.3	ND	25	89.2	81.2	9.4	65-165	20		
Benzene	26.6	24.1	ND	25	106.4	96.4	9.9	69-129	20		
Toluene	26.5	24.6	ND	25	106.0	98.4	7.4	70-130	20		
Surrogate(s)											
1,2-Dichloroethane-d4	456	461		500	91.2	92.2		73-130			
Toluene-d8	530	536		500	106.0	107.2		81-114			

ATTACHMENT B
Groundwater Monitoring Data
240 West MacArthur

Table 1
Groundwater Monitoring Well Construction and Groundwater Elevation Data
240 W. MacArthur Boulevard, Oakland, California

Well	Well Depth (feet bgs)	Well Screened Interval		Groundwater Level Depth ^(a) September 19, 2005	Groundwater Elevation ^(b) September 19, 2005
		Depth (feet)	Elevation (feet)		
MW-1	25	19.5 to 24.5	54.5 to 49.5	16.42	62.73
MW-2	25	14.5 to 24.5	64.2 to 54.2	16.00	62.45
MW-3	25	14.5 to 24.5	63.4 to 53.4	15.14	62.44
MW-4	25	14.5 to 24.5	63.6 to 53.6	15.13	62.61
MW-5	20	9 to 19	70.6 to 60.6	16.61	62.75
MW-6	20	9 to 19	69.7 to 59.7	15.61	62.82
MW-7	20	9 to 19	69.6 to 59.6	15.81	62.46
MW-8	20	9 to 19	67.7 to 57.7	13.90	62.49

Notes:

^(a) Pre-purge measurement, feet below top of well casing.

^(b) Pre-purge measurement, feet above mean sea level.

Table 2
Groundwater Sample Analytical Results – September 19, 2005
Hydrocarbons, BTEX, and MTBE ^(a)
240 W. MacArthur Boulevard, Oakland, California

Well	TVHg	TEHd	Benzene	Toluene	Ethyl-benzene	Total Xylenes	MTBE
MW-1	23,000	2,500	2,100	100	200	880	< 2.5
MW-2	1,400	210	30	1.3	1.9	2.8	58
MW-3	5,000	950	60	3.1	12	25.8	59
MW-4	< 50	NA	NA	NA	NA	NA	NA
MW-5	15,000	3,600	810	210	300	1,300	< 1.3
MW-6	680	200	13	0.9	6.6	13.0	< 0.5
MW-7	< 50	NA	NA	NA	NA	NA	NA
MW-8	520	< 50	< 0.5	< 0.5	< 0.5	< 1.0	65
Environmental Screening Levels ^(b)							
	NLP	NLP	1.0	40	30	20	5.0
Drinking Water Standards ^(c)							
	100	100	1.0 ^(d)	40	30	13	5.0

Notes:

^(a) All concentrations in µg/L, equivalent to parts per billion (ppb).

^(b) For commercial/industrial sites where a known or potential drinking water resource is threatened.

^(c) Drinking water standards are State of California Secondary Maximum Contaminant Levels – Proposed, unless specified otherwise.

^(d) State of California Primary Maximum Contaminant Levels.

MTBE = methyl *tertiary*-butyl ether

TEHd = total extractable hydrocarbons - diesel range

TVHg = total volatile hydrocarbons - gasoline range

NA = Not analyzed for this contaminant.

NLP = No level published.