

R 0 303



Shell Oil Products US

July 29, 2004

Don Hwang
Alameda County Health Care Services Agency
1131 Harbor Bay Parkway, Suite 250
Alameda, California 94502-6577

Alameda County
AUG 08 2004
Environmental Services

Subject: Shell-branded Service Station
230 West MacArthur Boulevard
Oakland, California

Dear Mr. Hwang:

Attached for your review and comment is a copy of the *Second Quarter 2004 Monitoring Report* for the above referenced site. Upon information and belief, I declare, under penalty of perjury, that the information contained in the attached document is true and correct.

As always, please feel free to contact me directly at (559) 645-9306 with any questions or concerns.

Sincerely,

Shell Oil Products US

A handwritten signature in cursive script that reads "Karen Petryna".

Karen Petryna
Sr. Environmental Engineer

July 29, 2004

Don Hwang
Alameda County Health Care Services Agency
1131 Harbor Bay Parkway, Suite 250
Alameda, California 94502-6577

Re: **Second Quarter 2004 Monitoring Report**
Shell-branded Service Station
230 West MacArthur Boulevard
Oakland, California
Incident # 98995741
Cambria Project # 246-0902-002



Dear Mr. Hwang:

On behalf of Equilon Enterprises LLC dba Shell Oil Products US (Shell), Cambria Environmental Technology, Inc. (Cambria) is submitting this groundwater monitoring report in accordance with the reporting requirements of 23 CCR 2652d.

SECOND QUARTER 2004 ACTIVITIES

Groundwater Monitoring: Blaine Tech Services, Inc. (Blaine) of San Jose, California gauged all site wells, sampled selected site wells, calculated groundwater elevations, and compiled the analytical data. Cambria coordinated groundwater monitoring with the adjacent Oakland Auto Works site at 240 West MacArthur. Cambria prepared a site vicinity map that includes previously submitted well survey information (Figure 1) and a groundwater elevation contour map (Figure 2). Blaine's report, presenting the analytical laboratory reports, is included as Attachment A. Attachment B includes data that Stellar Environmental Solutions of Berkeley, California provided for 240 West MacArthur.

Subsurface Investigation Report: On July 2, 2004, Cambria submitted a *Subsurface Investigation Report* to Alameda County Health Care Services Agency documenting the results of installing off-site soil borings SB-1 and SB-2.

**Cambria
Environmental
Technology, Inc.**

5900 Hollis Street
Suite A
Emeryville, CA 94608
Tel (510) 420-0700
Fax (510) 420-9170

ANTICIPATED THIRD QUARTER 2004 ACTIVITIES

Groundwater Monitoring: The third quarter sampling event is scheduled for September 2004. At that time, Blaine will gauge all wells, sample selected wells, and tabulate the data. Cambria will coordinate monitoring with the adjacent Oakland Auto Works site at 240 West MacArthur Boulevard. Cambria will prepare a monitoring report that includes a groundwater contour map based on the coordinated monitoring data.



CLOSING

We appreciate the opportunity to work with you on this project. Please call Caryl Weekley at (510) 420-3324 if you have any questions or comments.

Sincerely,
Cambria Environmental Technology, Inc

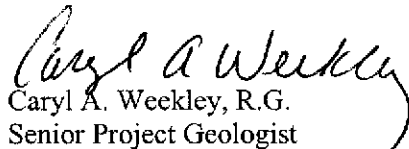
Caryl A. Weekley, R.G.
Senior Project Geologist

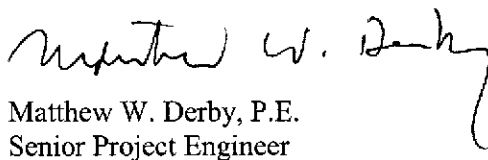
Matthew W. Derby, P.E.
Senior Project Engineer

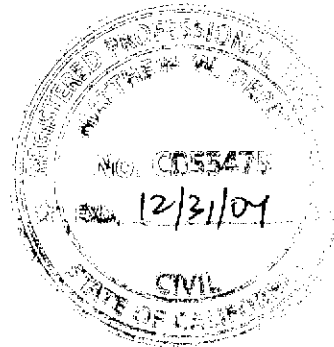

Figures: 1 - Vicinity/Area Well Survey Map
2 - Groundwater Elevation Contour Map

Attachments: A - Blaine Groundwater Monitoring Report
B - Groundwater Monitoring Data – 240 West MacArthur

cc: Karen Petryna, Shell Oil Products US, 20945 S. Wilmington Ave., Carson, CA 90810
Bruce Ruttger, Stellar Environmental Solutions, 2198 6th Street, Berkeley, CA 94710

G:\Oakland 230 MacArthur\QM\2q04\2q04qm.doc

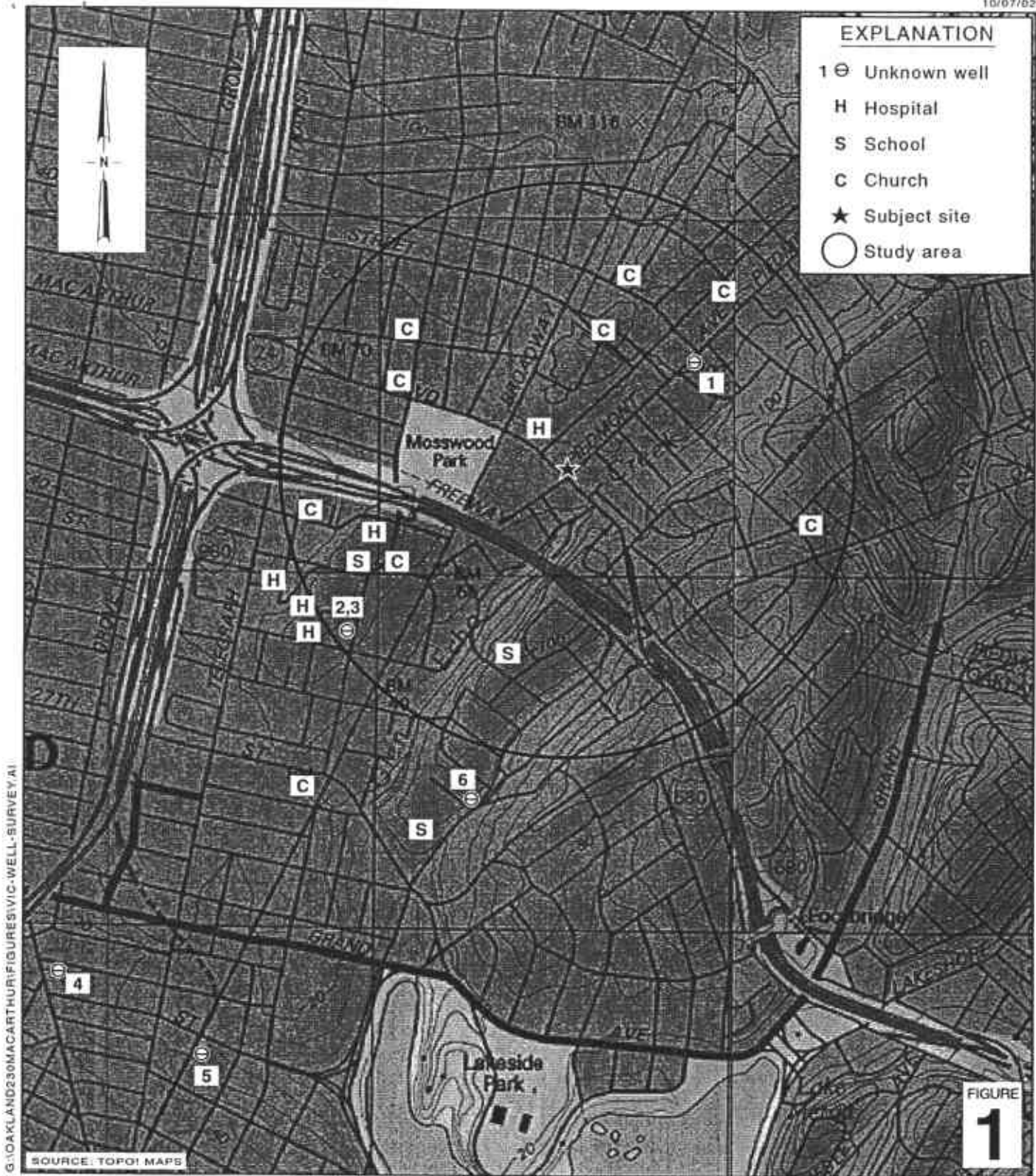

G:\OAKLAND\230MACARTHUR\FIGURES\VIC-WELL-SURVEY.A1

Shell-branded Service Station

230 West MacArthur Boulevard
Oakland, California
Incident #98995741



C A M B R I A

Vicinity/Area Well Survey Map

(1/2-Mile Radius)

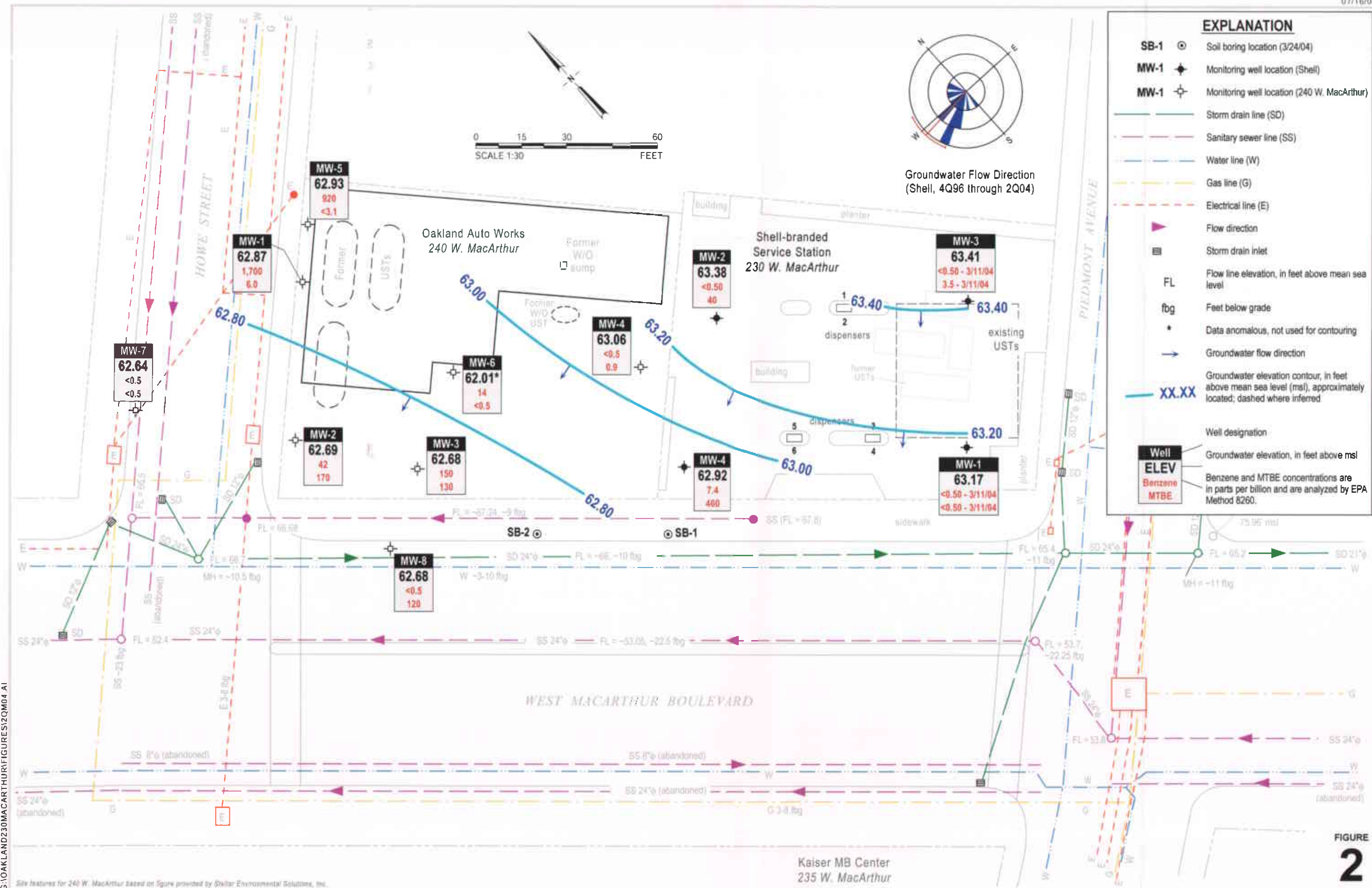

EXPLANATION

- SB-1: Soil boring location (3/24/04)
- MW-1: Monitoring well location (Shell)
- MW-1: Monitoring well location (240 W. MacArthur)
- SD: Storm drain line (SD)
- SS: Sanitary sewer line (SS)
- W: Water line (W)
- G: Gas line (G)
- E: Electrical line (E)
- Flow direction: Flow direction
- Storm drain inlet: Storm drain inlet
- FL: Flow line elevation, in feet above mean sea level
- fbg: Feet below grade
- Data anomalous: Data anomalous, not used for contouring
- Groundwater flow direction: Groundwater flow direction
- Groundwater elevation contour: Groundwater elevation contour, in feet above mean sea level (msl), approximately located; dashed where inferred
- Well designation: Well designation
- ELEV: Groundwater elevation, in feet above msl
- Benzene, MTBE: Benzene and MTBE concentrations are in parts per billion and are analyzed by EPA Method 8260.

Groundwater Elevation Contour Map



June 17, 2004

Shell-branded Service Station
 230 West MacArthur Boulevard
 Oakland, California
 Incident #98995741

FIGURE 2

G:\OAKLAND230MACARTHUR\FIGURES\20M04 A1

Site features for 240 W. MacArthur based on figure provided by Stellar Environmental Solutions, Inc.

ATTACHMENT A
Blaine Groundwater Monitoring Report

BLAINE
TECH SERVICES, INC.



1680 ROGERS AVENUE
SAN JOSE, CA 95112-1105
(408) 573-7771 FAX
(408) 573-0555 PHONE
CONTRACTOR'S LICENSE #746684
www.blainetech.com

July 8, 2004

Karen Petryna
Shell Oil Products US
P.O. Box 7869
Burbank, CA 92510-7869

Second Quarter 2004 Groundwater Monitoring at
Shell-branded Service Station
230 West MacArthur Boulevard
Oakland, CA

Monitoring performed on June 17, 2004

Groundwater Monitoring Report **040617-DW-2**

This report covers the routine monitoring of groundwater wells at this Shell-branded facility. In accordance with standard procedures that conform to Regional Water Quality Control Board requirements, routine field data collection includes depth to water, total well depth, thickness of any separate immiscible layer, water column volume, calculated purge volume (if applicable), elapsed evacuation time (if applicable), total volume of water removed (if applicable), and standard water parameter instrument readings. Sample material is collected, contained, stored, and transported to the laboratory in conformance with EPA standards. Purgewater (if applicable) is, likewise, collected and transported to the Martinez Refining Company.

Basic field information is presented alongside analytical values excerpted from the laboratory report in the cumulative table of **WELL CONCENTRATIONS**. The full analytical report for the most recent samples and the field data sheets are attached to this report.

At a minimum, Blaine Tech Services, Inc. field personnel are certified on completion of a forty-hour Hazardous Materials and Emergency Response training course per 29 CFR 1910.120. Field personnel are also enrolled in annual eight-hour refresher courses.

Blaine Tech Services, Inc. conducts sampling and documentation assignments of this type as an independent third party. Our activities at this site consisted of objective data and sample collection only. No interpretation of analytical results, defining of hydrological conditions or formulation of recommendations was performed.

Please call if you have any questions.

Yours truly,

Leon Gearhart
Project Coordinator

LG/ks

attachments: Cumulative Table of WELL CONCENTRATIONS
Certified Analytical Report
Field Data Sheets

cc: Anni Kreml
Cambria Environmental Technology, Inc.
5900 Hollis Street, Suite A
Oakland, CA 94608

WELL CONCENTRATIONS
Shell-branded Service Station
230 West MacArthur Boulevard
Oakland, CA

Well ID	Date	TPPH (ug/L)	B (ug/L)	T (ug/L)	E (ug/L)	X (ug/L)	MTBE 8020 (ug/L)	MTBE 8260 (ug/L)	TOC (MSL)	Depth to Water (ft.)	GW Elevation (MSL)
MW-1	07/14/1988	ND	ND	ND	ND	ND	NA	NA	73.89	13.30	60.59
MW-1	10/04/1988	ND	8	4.3	ND	9	NA	NA	73.89	13.65	60.24
MW-1	11/10/1988	ND	ND	ND	ND	ND	NA	NA	73.89	13.55	60.34
MW-1	12/09/1988	ND	ND	ND	ND	ND	NA	NA	73.89	13.22	60.67
MW-1	01/10/1989	ND	ND	ND	ND	NA	NA	NA	73.89	12.86	61.03
MW-1	01/20/1989	ND	ND	NA	NA	ND	NA	NA	73.89	12.91	60.98
MW-1	02/06/1989	ND	ND	ND	ND	ND	NA	NA	73.89	12.94	60.95
MW-1	03/10/1989	ND	ND	ND	ND	ND	NA	NA	73.89	12.59	61.30
MW-1	06/06/1989	ND	ND	ND	ND	ND	NA	NA	73.89	14.05	59.84
MW-1	09/07/1989	ND	ND	ND	ND	ND	NA	NA	73.89	14.92	58.97
MW-1	12/18/1989	ND	ND	ND	ND	ND	NA	NA	73.89	14.88	59.01
MW-1	03/08/1990	ND	ND	ND	ND	ND	NA	NA	73.89	14.08	59.81
MW-1	06/07/1990	ND	ND	ND	ND	ND	NA	NA	73.89	13.89	60.00
MW-1	09/05/1990	ND	ND	ND	ND	ND	NA	NA	73.89	14.83	59.06
MW-1	12/03/1990	ND	ND	ND	ND	ND	NA	NA	73.89	15.05	58.84
MW-1	03/01/1991	ND	ND	ND	ND	ND	NA	NA	73.89	14.34	59.55
MW-1	06/03/1991	ND	ND	ND	ND	ND	NA	NA	73.89	14.16	59.73
MW-1	09/04/1991	ND	ND	ND	ND	ND	NA	NA	73.89	14.60	59.29
MW-1	03/13/1992	ND	ND	ND	ND	ND	NA	NA	73.89	13.40	60.49
MW-1	06/03/1992	ND	ND	ND	ND	ND	NA	NA	73.89	13.76	60.13
MW-1	08/19/1992	87	ND	ND	ND	ND	NA	NA	73.89	14.57	59.32
MW-1	11/16/1992	ND	ND	ND	ND	ND	NA	NA	73.89	14.78	59.11
MW-1	02/18/1993	59a	ND	ND	ND	ND	NA	NA	73.89	12.14	61.75
MW-1	06/01/1993	ND	ND	ND	ND	ND	NA	NA	73.89	13.30	60.59
MW-1	08/30/1993	ND	ND	ND	ND	ND	NA	NA	73.89	14.32	59.57
MW-1	12/13/1993	ND	ND	ND	ND	ND	NA	NA	73.89	14.06	59.83
MW-1	03/03/1994	100	ND	ND	ND	ND	NA	NA	73.89	13.12	60.77

WELL CONCENTRATIONS
Shell-branded Service Station
230 West MacArthur Boulevard
Oakland, CA

Well ID	Date	TPPH (ug/L)	B (ug/L)	T (ug/L)	E (ug/L)	X (ug/L)	MTBE 8020 (ug/L)	MTBE 8260 (ug/L)	TOC (MSL)	Depth to Water (ft.)	GW Elevation (MSL)
MW-1	06/06/1994	ND	ND	ND	ND	ND	NA	NA	73.89	14.20	59.69
MW-1	09/12/1994	ND	ND	ND	ND	ND	NA	NA	73.89	15.72	58.17
MW-1	12/15/1994	ND	ND	ND	ND	ND	NA	NA	73.89	12.98	60.91
MW-1	3/13/1995 b	60	4.7	9.8	ND	2.9	NA	NA	73.89	11.74	62.15
MW-1	04/21/1995	ND	ND	ND	ND	ND	NA	NA	73.89	NA	NA
MW-1	06/26/1995	ND	ND	ND	ND	ND	NA	NA	73.89	13.00	60.89
MW-1	09/12/1995	ND	ND	ND	ND	ND	NA	NA	73.89	14.14	59.75
MW-1	03/21/1996	<50	<0.5	<0.5	<0.5	<0.5	ND	NA	73.89	11.03	62.86
MW-1	06/28/1996	<50	<0.5	<0.5	<0.5	<0.5	<2.5	NA	73.89	13.53	60.36
MW-1	09/19/1996	<50	<0.5	<0.5	<0.5	<0.5	<2.5	NA	73.89	14.33	59.56
MW-1	12/19/1996	NA	NA	NA	NA	NA	NA	NA	73.89	13.20	60.69
MW-1	12/05/1997	NA	NA	NA	NA	NA	NA	NA	73.89	12.39	61.50
MW-1	12/24/1998	NA	NA	NA	NA	NA	NA	NA	73.89	13.59	60.30
MW-1	12/23/1999	NA	NA	NA	NA	NA	NA	NA	73.89	15.63	58.26
MW-1	12/11/2000	NA	NA	NA	NA	NA	NA	NA	73.89	15.36	58.53
MW-1	12/27/2001	NA	NA	NA	NA	NA	NA	NA	73.89	12.09	61.80
MW-1	03/12/2002	NA	NA	NA	NA	NA	NA	NA	73.89	12.33	61.56
MW-1	03/14/2002	<50	<0.50	<0.50	<0.50	<0.50	NA	<5.0	73.89	12.08	61.81
MW-1	06/13/2002	NA	NA	NA	NA	NA	NA	NA	73.89	13.47	60.42
MW-1	09/09/2002	NA	NA	NA	NA	NA	NA	NA	76.92	14.30	62.62
MW-1	12/12/2002	NA	NA	NA	NA	NA	NA	NA	76.92	14.48	62.44
MW-1	03/10/2003	<50	<0.50	<0.50	<0.50	<0.50	NA	<5.0	76.92	12.76	64.16
MW-1	06/10/2003	NA	NA	NA	NA	NA	NA	NA	76.92	13.17	63.75
MW-1	09/16/2003	NA	NA	NA	NA	NA	NA	NA	76.92	14.10	62.82
MW-1	12/03/2003	NA	NA	NA	NA	NA	NA	NA	76.92	13.93	62.99
MW-1	03/11/2004	<50	<0.50	<0.50	<0.50	<1.0	NA	<0.50	76.92	12.04	64.88
MW-1	06/17/2004	NA	NA	NA	NA	NA	NA	NA	76.92	13.75	63.17

WELL CONCENTRATIONS
Shell-branded Service Station
230 West MacArthur Boulevard
Oakland, CA

Well ID	Date	TPPH (ug/L)	B (ug/L)	T (ug/L)	E (ug/L)	X (ug/L)	MTBE 8020 (ug/L)	MTBE 8260 (ug/L)	TOC (MSL)	Depth to Water (ft.)	GW Elevation (MSL)
MW-2	07/14/1988	ND	7.9	2.6	1.1	4	NA	NA	75.24	15.18	60.06
MW-2	10/04/1988	90	ND	1.3	2.3	12	NA	NA	75.24	15.30	59.94
MW-2	11/10/1988	ND	ND	ND	ND	2	NA	NA	75.24	15.17	60.07
MW-2	12/09/1988	ND	ND	0.6	ND	3	NA	NA	75.24	14.82	60.42
MW-2	01/20/1989	ND	ND	ND	ND	ND	NA	NA	75.24	14.54	60.70
MW-2	02/06/1989	NA	ND	ND	ND	ND	NA	NA	75.24	14.59	60.65
MW-2	03/10/1989	ND	ND	ND	ND	ND	NA	NA	75.24	14.88	60.36
MW-2	06/06/1989	ND	ND	0.5	ND	ND	NA	NA	75.24	15.30	59.94
MW-2	09/07/1989	ND	ND	ND	ND	ND	NA	NA	75.24	16.76	58.48
MW-2	12/18/1989	ND	ND	ND	ND	ND	NA	NA	75.24	16.65	58.59
MW-2	03/08/1990	ND	ND	ND	ND	ND	NA	NA	75.24	15.92	59.32
MW-2	06/07/1990	ND	ND	ND	ND	ND	NA	NA	75.24	16.10	59.14
MW-2	09/05/1990	ND	ND	ND	ND	ND	NA	NA	75.24	16.61	58.63
MW-2	12/03/1990	ND	ND	ND	ND	ND	NA	NA	75.24	17.06	58.18
MW-2	03/01/1991	ND	ND	ND	ND	ND	NA	NA	75.24	16.62	58.62
MW-2	06/03/1991	ND	ND	ND	ND	ND	NA	NA	75.24	16.65	58.59
MW-2	09/04/1991	ND	ND	ND	ND	ND	NA	NA	75.24	16.57	58.67
MW-2	03/13/1992	ND	ND	ND	ND	ND	NA	NA	75.24	14.66	60.58
MW-2	06/03/1992	ND	ND	ND	ND	ND	NA	NA	75.24	15.90	59.34
MW-2	08/19/1992	67	ND	ND	ND	ND	NA	NA	75.24	16.72	58.52
MW-2	11/16/1992	50	ND	ND	ND	1.2	NA	NA	75.24	16.66	58.58
MW-2	02/18/1993	52a	ND	ND	ND	ND	NA	NA	75.24	13.88	61.36
MW-2 (D)	02/18/1993	52a	ND	ND	ND	ND	NA	NA	75.24	13.88	61.36
MW-2	06/01/1993	ND	ND	ND	ND	ND	NA	NA	75.24	14.74	60.50
MW-2	08/30/1993	70a	ND	ND	ND	ND	NA	NA	75.24	15.85	59.39
MW-2	12/13/1993	68a	ND	ND	ND	ND	NA	NA	75.24	15.83	59.41
MW-2	03/03/1994	280a	ND	ND	ND	ND	NA	NA	75.24	14.80	60.44
MW-2	06/06/1994	ND	ND	ND	ND	ND	NA	NA	75.24	16.65	58.59

WELL CONCENTRATIONS
Shell-branded Service Station
230 West MacArthur Boulevard
Oakland, CA

Well ID	Date	TPPH (ug/L)	B (ug/L)	T (ug/L)	E (ug/L)	X (ug/L)	MTBE 8020 (ug/L)	MTBE 8260 (ug/L)	TOC (MSL)	Depth to Water (ft.)	GW Elevation (MSL)
MW-2	09/12/1994	ND	ND	ND	ND	ND	NA	NA	75.24	16.72	58.52
MW-2	12/15/1994	230a	ND	ND	ND	ND	NA	NA	75.24	15.25	59.99
MW-2	03/13/1995	ND	2.9	6.3	ND	2.7	NA	NA	75.24	15.32	59.92
MW-2	04/21/1995	ND	ND	ND	ND	ND	NA	NA	75.24	NA	NA
MW-2	06/26/1995	ND	ND	ND	ND	ND	NA	NA	75.24	14.65	60.59
MW-2	09/12/1995	ND	ND	ND	ND	ND	NA	NA	75.24	15.78	59.46
MW-2	03/21/1996	<50	<0.5	<0.5	<0.5	<0.5	ND	NA	75.24	12.72	62.52
MW-2	06/28/1996	<50	<0.5	<0.5	<0.5	<0.5	160	NA	75.24	14.95	60.29
MW-2	09/19/1996	<50	<0.5	<0.5	<0.5	<0.5	27	NA	75.24	15.64	59.60
MW-2	12/19/1996	NA	NA	NA	NA	NA	NA	NA	75.24	14.47	60.77
MW-2	12/05/1997	NA	NA	NA	NA	NA	NA	NA	75.24	14.22	61.02
MW-2	12/24/1998	NA	NA	NA	NA	NA	NA	NA	75.24	14.97	60.27
MW-2	12/23/1999	NA	NA	NA	NA	NA	NA	NA	75.24	16.07	59.17
MW-2	12/11/2000	NA	NA	NA	NA	NA	NA	NA	75.24	15.78	59.46
MW-2	12/27/2001	NA	NA	NA	NA	NA	NA	95	75.24	14.25	60.99
MW-2	03/14/2002	120	<0.50	<0.50	<0.50	<0.50	NA	31	75.24	14.59	60.65
MW-2	06/13/2002	100	<0.50	<0.50	<0.50	<0.50	NA	32	75.24	14.58	60.66
MW-2	09/09/2002	90	<0.50	<0.50	<0.50	<0.50	NA	54	78.25	15.49	62.76
MW-2	12/12/2002	92	<0.50	<0.50	<0.50	<0.50	NA	21	78.25	16.21	62.04
MW-2	03/10/2003	110	<0.50	<0.50	<0.50	<0.50	NA	33	78.25	14.33	63.92
MW-2	06/10/2003	<50	<0.50	<0.50	<0.50	<1.0	NA	49	78.25	14.48	63.77
MW-2	09/16/2003	<50	<0.50	<0.50	<0.50	<1.0	NA	39	78.25	15.45	62.80
MW-2	12/03/2003	56 a	<0.50	<0.50	<0.50	<1.0	NA	3.6	78.25	15.60	62.65
MW-2	03/11/2004	58 a	<0.50	<0.50	<0.50	<1.0	NA	67	78.25	13.78	64.47
MW-2	06/17/2004	<50	<0.50	<0.50	<0.50	<1.0	NA	40	78.25	14.87	63.38
MW-3	07/14/1988	ND	ND	ND	ND	ND	NA	NA	74.68	14.05	60.63
MW-3	10/04/1988	ND	ND	ND	ND	5	NA	NA	74.68	14.60	60.08

WELL CONCENTRATIONS
Shell-branded Service Station
230 West MacArthur Boulevard
Oakland, CA

Well ID	Date	TPPH (ug/L)	B (ug/L)	T (ug/L)	E (ug/L)	X (ug/L)	MTBE 8020 (ug/L)	MTBE 8260 (ug/L)	TOC (MSL)	Depth to Water (ft.)	GW Elevation (MSL)
MW-3	11/10/1988	ND	ND	ND	ND	ND	NA	NA	74.68	14.35	60.33
MW-3	12/09/1988	ND	ND	ND	ND	ND	NA	NA	74.68	14.04	60.64
MW-3	01/10/1989	ND	ND	ND	ND	NA	NA	NA	74.68	13.70	60.98
MW-3	01/20/1989	NA	NA	ND	ND	ND	NA	NA	74.68	13.72	60.96
MW-3	02/06/1989	70	ND	ND	ND	ND	NA	NA	74.68	13.75	60.93
MW-3	03/10/1989	150	ND	ND	ND	ND	NA	NA	74.68	13.42	61.26
MW-3	06/06/1989	ND	ND	ND	ND	ND	NA	NA	74.68	14.52	60.16
MW-3	09/07/1989	ND	0.65	ND	ND	ND	NA	NA	74.68	15.52	59.16
MW-3	12/18/1989	46	1.3	ND	0.44	0.66	NA	NA	74.68	19.59	55.09
MW-3	03/08/1990	ND	ND	ND	ND	ND	NA	NA	74.68	14.72	59.96
MW-3	06/07/1990	ND	ND	ND	ND	ND	NA	NA	74.68	14.65	60.03
MW-3	09/05/1990	ND	ND	ND	ND	ND	NA	NA	74.68	15.51	59.17
MW-3	12/03/1990	ND	ND	ND	ND	ND	NA	NA	74.68	14.85	59.83
MW-3	03/01/1991	1.9	59	ND	22	ND	NA	NA	74.68	14.92	59.76
MW-3	06/03/1991	ND	ND	ND	ND	ND	NA	NA	74.68	14.75	59.93
MW-3	09/04/1991	ND	ND	ND	ND	ND	NA	NA	74.68	15.14	59.54
MW-3	03/13/1992	ND	ND	ND	ND	ND	NA	NA	74.68	13.50	61.18
MW-3	06/03/1992	ND	ND	ND	ND	ND	NA	NA	74.68	14.39	60.29
MW-3	08/19/1992	92	ND	ND	ND	ND	NA	NA	74.68	15.08	59.60
MW-3 (D)	08/19/1992	76	ND	ND	ND	ND	NA	NA	74.68	15.08	59.60
MW-3	11/16/1992	200a	ND	ND	ND	ND	NA	NA	74.68	15.43	59.25
MW-3 (D)	11/16/1992	140a	ND	ND	ND	ND	NA	NA	74.68	15.43	59.25
MW-3	02/18/1993	680a	ND	ND	ND	ND	NA	NA	74.68	12.96	61.72
MW-3	06/01/1993	160a	ND	ND	ND	ND	NA	NA	74.68	13.98	60.70
MW-3 (D)	06/01/1993	150a	ND	ND	ND	ND	NA	NA	74.68	13.98	60.70
MW-3	08/30/1993	110a	ND	ND	ND	ND	NA	NA	74.68	14.82	59.86
MW-3	12/13/1993	140a	ND	ND	ND	ND	NA	NA	74.68	14.70	59.98
MW-3 (D)	12/13/1993	110a	ND	ND	ND	ND	NA	NA	74.68	14.70	59.98

WELL CONCENTRATIONS
Shell-branded Service Station
230 West MacArthur Boulevard
Oakland, CA

Well ID	Date	TPPH (ug/L)	B (ug/L)	T (ug/L)	E (ug/L)	X (ug/L)	MTBE 8020 (ug/L)	MTBE 8260 (ug/L)	TOC (MSL)	Depth to Water (ft.)	GW Elevation (MSL)
MW-3	03/03/1994	61a	ND	ND	ND	ND	NA	NA	74.68	13.92	60.76
MW-3	06/06/1994	ND	ND	ND	ND	ND	NA	NA	74.68	14.73	59.95
MW-3	09/12/1994	ND	ND	ND	ND	ND	NA	NA	74.68	15.42	59.26
MW-3	12/15/1994	ND	ND	0.9	ND	0.6	NA	NA	74.68	13.80	60.88
MW-3	03/13/1995	100a	7.9	17	0.7	6.1	NA	NA	74.68	12.41	62.27
MW-3	04/21/1995	60	0.9	1.1	ND	1	NA	NA	74.68	NA	NA
MW-3	06/26/1995	ND	ND	ND	ND	ND	NA	NA	74.68	13.79	60.89
MW-3	09/12/1995 b	ND	ND	ND	ND	ND	NA	NA	74.68	14.77	59.91
MW-3	03/21/1996	<50	<0.5	<0.5	<0.5	<0.5	17	NA	74.68	11.80	62.88
MW-3	06/28/1996	<50	<0.5	<0.5	<0.5	<0.5	<0.5	NA	74.68	14.19	60.49
MW-3	09/19/1996	<50	<0.5	<0.5	<0.5	<0.5	<2.5	NA	74.68	14.85	59.83
MW-3	12/19/1996	NA	NA	NA	NA	NA	NA	NA	74.68	13.61	61.07
MW-3	12/05/1997	NA	NA	NA	NA	NA	NA	NA	74.68	13.16	61.52
MW-3	12/24/1998	NA	NA	NA	NA	NA	NA	NA	74.68	14.08	60.60
MW-3	12/23/1999	NA	NA	NA	NA	NA	NA	NA	74.68	15.92	58.76
MW-3	12/11/2000	NA	NA	NA	NA	NA	NA	NA	74.68	15.31	59.37
MW-3	12/27/2001	NA	NA	NA	NA	NA	NA	NA	74.68	12.84	61.84
MW-3	03/12/2002	NA	NA	NA	NA	NA	NA	NA	74.68	12.54	62.14
MW-3	03/14/2002	<50	<0.50	<0.50	<0.50	<0.50	NA	40	74.68	12.78	61.90
MW-3	06/13/2002	NA	NA	NA	NA	NA	NA	NA	74.68	14.06	60.62
MW-3	09/09/2002	NA	NA	NA	NA	NA	NA	NA	77.69	14.77	62.92
MW-3	12/12/2002	NA	NA	NA	NA	NA	NA	NA	77.69	15.11	62.58
MW-3	03/10/2003	<50	<0.50	<0.50	<0.50	<0.50	NA	5.4	77.69	13.52	64.17
MW-3	06/10/2003	NA	NA	NA	NA	NA	NA	NA	77.69	13.82	63.87
MW-3	09/16/2003	NA	NA	NA	NA	NA	NA	NA	77.69	14.60	63.09
MW-3	12/03/2003	NA	NA	NA	NA	NA	NA	NA	77.69	14.53	63.16
MW-3	03/11/2004	<50	<0.50	<0.50	<0.50	<1.0	NA	3.5	77.69	12.38	65.31
MW-3	06/17/2004	NA	NA	NA	NA	NA	NA	NA	77.69	14.28	63.41

WELL CONCENTRATIONS
Shell-branded Service Station
230 West MacArthur Boulevard
Oakland, CA

Well ID	Date	TPPH (ug/L)	B (ug/L)	T (ug/L)	E (ug/L)	X (ug/L)	MTBE 8020 (ug/L)	MTBE 8260 (ug/L)	TOC (MSL)	Depth to Water (ft)	GW Elevation (MSL)
MW-4	01/23/1990	1,600	100	10	30	20	NA	NA	73.83	14.68	59.15
MW-4	03/08/1990	4,200	260	18	88	39	NA	NA	73.83	14.38	59.45
MW-4	06/07/1990	2,000	150	6.9	14	17	NA	NA	73.83	14.27	59.56
MW-4	09/05/1990	1,700	130	10	7.2	19	NA	NA	73.83	15.40	58.43
MW-4	12/03/1990	2,600	108	41	17	59	NA	NA	73.83	15.90	57.93
MW-4	06/03/1991	2,800	160	15	8.8	32	NA	NA	73.83	14.60	59.23
MW-4	09/04/1991	Sheen	NA	NA	NA	NA	NA	NA	73.83	15.25	58.58
MW-4	03/13/1992	2,700	180	70	5.9	29	NA	NA	73.83	12.72	61.11
MW-4	06/03/1992	1,700	190	ND	30	23	NA	NA	73.83	14.33	59.50
MW-4	08/19/1992	170	4.2	ND	0.6	1	NA	NA	73.83	15.18	58.65
MW-4	11/16/1992	2,600	92	49	50	81	NA	NA	73.83	15.39	58.44
MW-4	02/18/1993	7,400	120	38	51	87	NA	NA	73.83	12.62	61.21
MW-4	06/01/1993	7,000	1,800	1,700	1,600	1,700	NA	NA	73.83	13.68	60.15
MW-4	08/30/1993	2,100	80	11	ND	11	NA	NA	73.83	14.83	59.00
MW-4 (D)	08/30/1993	2,100	77	5.6	ND	5.5	NA	NA	73.83	14.83	59.00
MW-4	12/13/1993	2,000a	20	ND	21	52	NA	NA	73.83	14.50	59.33
MW-4	03/03/1994	3,500	150	86	85	90	NA	NA	73.83	13.48	60.35
MW-4 (D)	03/03/1994	3,200	130	73	74	76	NA	NA	73.83	13.48	60.35
MW-4	06/06/1994	590	25	ND	ND	ND	NA	NA	73.83	14.26	59.57
MW-4 (D)	06/06/1994	400	16	ND	ND	ND	NA	NA	73.83	14.26	59.57
MW-4	09/12/1994	1,800	42	ND	3.7	4.7	NA	NA	73.83	15.42	58.41
MW-4 (D)	09/12/1994	2,000	40	ND	5.7	8	NA	NA	73.83	15.42	58.41
MW-4	12/15/1994	2,900	78	14	94	17	NA	NA	73.83	13.43	60.40
MW-4 (D)	12/15/1994	2,900	90	7	96	18	NA	NA	73.83	13.43	60.40
MW-4	03/13/1995	2,700	240	24	99	34	NA	NA	73.83	12.13	61.70
MW-4 (D)	03/13/1995	2,500	300	24	140	28	NA	NA	73.83	12.13	61.70
MW-4	06/25/1995	2,100	87	10	67	25	NA	NA	73.83	13.26	60.57

WELL CONCENTRATIONS
Shell-branded Service Station
230 West MacArthur Boulevard
Oakland, CA

Well ID	Date	TPPH (ug/L)	B (ug/L)	T (ug/L)	E (ug/L)	X (ug/L)	MTBE 8020 (ug/L)	MTBE 8260 (ug/L)	TOC (MSL)	Depth to Water (ft.)	GW Elevation (MSL)
MW-4 (D)	06/25/1995	2,300	92	12	74	26	NA	NA	73.83	13.26	60.57
MW-4	09/12/1995 b	1,300	33	13	9.3	15	NA	NA	73.83	14.64	59.19
MW-4 (D)	09/12/1995 b	1,500	2.1	16	11	17	NA	NA	73.83	14.64	59.19
MW-4	03/21/1996	2,100	50	3.2	40	5.4	ND	NA	73.83	11.55	62.28
MW-4 (D)	03/21/1996	1,700	24	<0.5	39	7.2	740	NA	73.83	11.55	62.28
MW-4	06/28/1996	1,300	61	6.2	53	11	1,000	NA	73.83	13.86	59.97
MW-4 (D)	06/28/1996	1,200	29	6.2	50	8.3	1,000	NA	73.83	13.86	59.97
MW-4	09/19/1996	820	12	<2.5	2.8	4.3	720	NA	73.83	14.72	59.11
MW-4 (D)	09/19/1996	580	9.6	<2.5	<2.5	<2.5	760	1,200	73.83	14.72	59.11
MW-4	12/19/1996	1,200	28	<5.0	<5.0	<5.0	<25	NA	73.83	13.06	60.77
MW-4	12/05/1997	1,900	36	9	16	18	630	NA	73.83	12.89	60.94
MW-4	12/24/1998	1,100	23	5.3	38	7.9	1,100	NA	73.83	13.92	59.91
MW-4	12/17/1999	1,100	22	21	13	11	3,800	3,200	73.83	14.28	59.55
MW-4	12/23/1999	NA	NA	NA	NA	NA	NA	NA	73.83	16.24	57.59
MW-4	12/11/2000	975	25.0	11.3	<5.00	<5.00	1960	1730c	73.83	14.15	59.68
MW-4	12/27/2001	2,000	9.9	<5.0	18	<5.0	NA	1,400	73.83	12.61	61.22
MW-4	03/14/2002	1,700	6.6	<2.0	2.1	2.1	NA	1,100	73.83	12.35	61.48
MW-4	06/13/2002	1,200	4.7	<2.0	<2.0	<2.0	NA	1,100	73.83	13.72	60.11
MW-4	09/09/2002	620	3.7	<2.0	<2.0	<2.0	NA	760	76.82	14.56	62.26
MW-4	12/12/2002	1,500	3.9	<2.0	<2.0	<2.0	NA	880	76.82	14.82	62.00
MW-4	03/10/2003	2,300	5.7	0.95	3.8	0.63	NA	1,200	76.82	13.63	63.19
MW-4	06/10/2003	2,200	5.3	<5.0	<5.0	<10	NA	880	76.82	13.68	63.14
MW-4	09/16/2003	1,400	<5.0	<5.0	<5.0	<10	NA	420	76.82	14.35	62.47
MW-4	12/03/2003	2,600	5.0	<5.0	<5.0	<10	NA	840	76.82	14.27	62.55
MW-4	03/11/2004	1900 a	6.3	<5.0	<5.0	<10	NA	800	76.82	12.62	64.20
MW-4	06/17/2004	1,000	7.4	<2.5	<2.5	<5.0	NA	460	76.82	13.90	62.92

WELL CONCENTRATIONS
Shell-branded Service Station
230 West MacArthur Boulevard
Oakland, CA

Well ID	Date	TPPH (ug/L)	B (ug/L)	T (ug/L)	E (ug/L)	X (ug/L)	MTBE 8020 (ug/L)	MTBE 8260 (ug/L)	TOC (MSL)	Depth to Water (ft)	GW Elevation (MSL)
---------	------	----------------	-------------	-------------	-------------	-------------	------------------------	------------------------	--------------	---------------------------	--------------------------

Abbreviations:

TPPH = Total petroleum hydrocarbons as gasoline by EPA Method 8260B; prior to December 27, 2001, by EPA Method 8015.

BTEX = Benzene, toluene, ethylbenzene, xylenes by EPA Method 8260B; prior to December 27, 2001, by EPA Method 8020.

MTBE = Methyl tertiary butyl ether

TOC = Top of Casing Elevation

GW = Groundwater

ug/L = Parts per billion

MSL = Mean sea level

ft = Feet

<n = Below detection limit

D = Duplicate sample

ND = Not detected at or above the quantitative limit

NA = Not applicable

Notes:

a = Chromatogram pattern indicates the presence of an unidentified hydrocarbon/Hydrocarbon does not match pattern of laboratory's standard.

b = The laboratory noted the sample was analyzed after the method specified holding time.

c = This sample was analyzed outside of EPA recommended hold time.

Site surveyed January 30, 2002 by Virgil Chavez Land Surveying of Vallejo, CA.

Blaine Tech Services, Inc.

June 29, 2004

1680 Rogers Avenue
San Jose, CA 95112-1105
Attn.: Leon Gearhart
Project#: 040617-DW-2
Project: 98995741
Site: 230 W. MacArthur Blvd., Oakland

Dear Mr. Gearhart,

Attached is our report for your samples received on 06/18/2004 11:31
This report has been reviewed and approved for release. Reproduction of this report
is permitted only in its entirety.

Please note that any unused portion of the samples will be discarded after
08/02/2004 unless you have requested otherwise.

We appreciate the opportunity to be of service to you. If you have any questions,
please call me at (925) 484-1919.

You can also contact me via email. My email address is: vvancil@sti-inc.com

Sincerely,

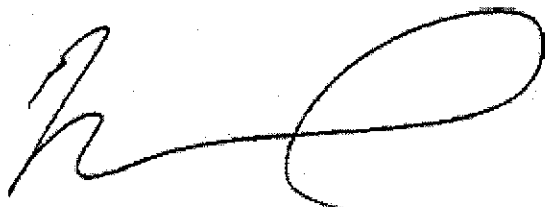

Vincent Vancil
Project Manager

Gas/BTEX/MTBE by 8260B (C6-C12)

Blaine Tech Services, Inc.

Attn.: Leon Gearhart

1680 Rogers Avenue
San Jose, CA 95112-1105
Phone: (408) 573-0555 Fax: (408) 573-7771

Project: 040617-DW-2
98995741

Received: 06/18/2004 11:31

Site: 230 W. MacArthur Blvd., Oakland

Samples Reported

Sample Name	Date Sampled	Matrix	Lab #
MW-2	06/17/2004 14:05	Water	1
MW-4	06/17/2004 14:20	Water	2

Gas/BTEX/MTBE by 8260B (C6-C12)

Blaine Tech Services, Inc.

Attn.: Leon Gearhart

1680 Rogers Avenue

San Jose, CA 95112-1105

Phone: (408) 573-0555 Fax: (408) 573-7771

Project: 040617-DW-2

98995741

Received: 06/18/2004 11:31

Site: 230 W. MacArthur Blvd., Oakland

Prep(s):	5030B	Test(s):	8260B
Sample ID:	MW-2	Lab ID:	2004-06-0648 - 1
Sampled:	06/17/2004 14:05	Extracted:	6/25/2004 08:26
Matrix:	Water	QC Batch#:	2004/06/25-1G.64

Compound	Conc.	RL	Unit	Dilution	Analyzed	Flag
Gasoline	ND	50	ug/L	1.00	06/25/2004 08:26	
Benzene	ND	0.50	ug/L	1.00	06/25/2004 08:26	
Toluene	ND	0.50	ug/L	1.00	06/25/2004 08:26	
Ethylbenzene	ND	0.50	ug/L	1.00	06/25/2004 08:26	
Total xylenes	ND	1.0	ug/L	1.00	06/25/2004 08:26	
Methyl tert-butyl ether (MTBE)	40	0.50	ug/L	1.00	06/25/2004 08:26	
Surrogate(s)						
1,2-Dichloroethane-d4	84.0	76-130	%	1.00	06/25/2004 08:26	
Toluene-d8	93.9	78-115	%	1.00	06/25/2004 08:26	

Gas/BTEX/MTBE by 8260B (C6-C12)

Blaine Tech Services, Inc.

Attn.: Leon Gearhart

1680 Rogers Avenue

San Jose, CA 95112-1105

Phone: (408) 573-0555 Fax: (408) 573-7771

Project: 040617-DW-2

98995741

Received: 06/18/2004 11:31

Site: 230 W. MacArthur Blvd., Oakland

Prep(s):	5030B	Test(s):	8260B
Sample ID:	MW-4	Lab ID:	2004-06-0648 - 2
Sampled:	06/17/2004 14:20	Extracted:	6/26/2004 02:24
Matrix:	Water	QC Batch#:	2004/06/25-2A.64
Analysis Flag: o (See Legend and Note Section)			

Compound	Conc.	RL	Unit	Dilution	Analyzed	Flag
Gasoline	1000	250	ug/L	5.00	06/26/2004 02:24	
Benzene	7.4	2.5	ug/L	5.00	06/26/2004 02:24	
Toluene	ND	2.5	ug/L	5.00	06/26/2004 02:24	
Ethylbenzene	ND	2.5	ug/L	5.00	06/26/2004 02:24	
Total xylenes	ND	5.0	ug/L	5.00	06/26/2004 02:24	
Methyl tert-butyl ether (MTBE)	460	2.5	ug/L	5.00	06/26/2004 02:24	
Surrogate(s)						
1,2-Dichloroethane-d4	114.0	76-130	%	5.00	06/26/2004 02:24	
Toluene-d8	93.2	78-115	%	5.00	06/26/2004 02:24	

Gas/BTEX/MTBE by 8260B (C6-C12)

Blaine Tech Services, Inc.

Attn.: Leon Gearhart

1680 Rogers Avenue
San Jose, CA 95112-1105
Phone: (408) 573-0555 Fax: (408) 573-7771

Project: 040617-DW-2
98995741

Received: 06/18/2004 11:31

Site: 230 W. MacArthur Blvd., Oakland

Batch QC Report					
Prep(s): 5030B				Test(s): 8260B	
Method Blank		Water		QC Batch # 2004/06/25-1C.64	
MB: 2004/06/25-1C.64-051				Date Extracted: 06/25/2004 07:51	

Compound	Conc.	RL	Unit	Analyzed	Flag
Gasoline	ND	50	ug/L	06/25/2004 07:51	
Methyl tert-butyl ether (MTBE)	ND	0.5	ug/L	06/25/2004 07:51	
Benzene	ND	0.5	ug/L	06/25/2004 07:51	
Toluene	ND	0.5	ug/L	06/25/2004 07:51	
Ethylbenzene	ND	0.5	ug/L	06/25/2004 07:51	
Total xylenes	ND	1.0	ug/L	06/25/2004 07:51	
Surrogates(s)					
1,2-Dichloroethane-d4	87.8	76-130	%	06/25/2004 07:51	
Toluene-d8	97.0	78-115	%	06/25/2004 07:51	

Severn Trent Laboratories, Inc.

STL San Francisco * 1220 Quarry Lane, Pleasanton, CA 94566

Tel 925 484 1919 Fax 925 484 1096 * www.stl-inc.com * CA DHS ELAP# 2496

06/29/2004 15:05

Gas/BTEX/MTBE by 8260B (C6-C12)

Blaine Tech Services, Inc.

Attn.: Leon Gearhart

1680 Rogers Avenue
San Jose, CA 95112-1105
Phone: (408) 573-0555 Fax: (408) 573-7771

Project: 040617-DW-2
98995741

Received: 06/18/2004 11:31

Site: 230 W. MacArthur Blvd., Oakland

Batch QC Report		
Prep(s): 5030B		Test(s): 8260B
Method Blank	Water	QC Batch # 2004/06/25-2A.64
MB: 2004/06/25-2A.64-032		Date Extracted: 06/25/2004 18:32

Compound	Conc.	RL	Unit	Analyzed	Flag
Gasoline	ND	50	ug/L	06/25/2004 18:32	
Methyl tert-butyl ether (MTBE)	ND	0.5	ug/L	06/25/2004 18:32	
Benzene	ND	0.5	ug/L	06/25/2004 18:32	
Toluene	ND	0.5	ug/L	06/25/2004 18:32	
Ethylbenzene	ND	0.5	ug/L	06/25/2004 18:32	
Total xylenes	ND	1.0	ug/L	06/25/2004 18:32	
Surrogates(s)					
1,2-Dichloroethane-d4	88.6	76-130	%	06/25/2004 18:32	
Toluene-d8	96.0	78-115	%	06/25/2004 18:32	

Severn Trent Laboratories, Inc.

STL San Francisco * 1220 Quarry Lane, Pleasanton, CA 94566

Tel 925 484 1919 Fax 925 484 1096 * www.stl-inc.com * CA DHS ELAP# 2496

06/29/2004 15:05

Gas/BTEX/MTBE by 8260B (C6-C12)

Blaine Tech Services, Inc.

Attn.: Leon Gearhart

1680 Rogers Avenue
San Jose, CA 95112-1105
Phone: (408) 573-0555 Fax: (408) 573-7771

Project: 040617-DW-2
98995741

Received: 06/18/2004 11:31

Site: 230 W. MacArthur Blvd., Oakland

Batch QC Report			
Prep(s): 5030B		Test(s): 8260B	
Laboratory Control Spike		Water	QC Batch # 2004/06/25-1C.64
LCS	2004/06/25-1C.64-006	Extracted: 06/25/2004	Analyzed: 06/25/2004 07:06
LCSD	2004/06/25-1C.64-029	Extracted: 06/25/2004	Analyzed: 06/25/2004 07:29

Compound	Conc. ug/L		Exp. Conc.	Recovery %		RPD	Ctrl.Limits %		Flags	
	LCS	LCSD		LCS	LCSD		%	Rec.	RPD	LCS
Methyl tert-butyl ether (MTBE)	22.7	22.8	25	90.8	91.2	0.4	65-165	20		
Benzene	25.2	25.3	25	100.8	101.2	0.4	69-129	20		
Toluene	25.6	25.5	25	102.4	102.0	0.4	70-130	20		
Surrogates(s)										
1,2-Dichloroethane-d4	412	419	500	82.4	83.8		76-130			
Toluene-d8	492	474	500	98.4	94.8		78-115			

Severn Trent Laboratories, Inc.

STL San Francisco * 1220 Quarry Lane, Pleasanton, CA 94566

Tel 925 484 1919 Fax 925 484 1096 * www.stl-inc.com * CA DHS ELAP# 2496

06/29/2004 15:05

Gas/BTEX/MTBE by 8260B (C6-C12)

Blaine Tech Services, Inc.

Attn.: Leon Gearhart

1680 Rogers Avenue
San Jose, CA 95112-1105
Phone: (408) 573-0555 Fax: (408) 573-7771

Project: 040617-DW-2
98995741

Received: 06/18/2004 11:31

Site: 230 W. MacArthur Blvd., Oakland

Batch QC Report			
Prep(s): 5030B			Test(s): 8260B
Laboratory Control Spike	Water		QC Batch # 2004/06/25-2A.64
LCS 2004/06/25-2A.64-048	Extracted: 06/25/2004		Analyzed: 06/25/2004 17:48
LCSD 2004/06/25-2A.64-010	Extracted: 06/25/2004		Analyzed: 06/25/2004 18:10

Compound	Conc. ug/L		Exp.Conc.	Recovery %		RPD	Ctrl.Limits %		Flags	
	LCS	LCSD		LCS	LCSD		%	Rec.	RPD	LCS
Methyl tert-butyl ether (MTBE)	23.5	21.3	25	94.0	85.2	9.8	65-165	20		
Benzene	25.9	23.6	25	103.6	94.4	9.3	69-129	20		
Toluene	26.8	24.4	25	107.2	97.6	9.4	70-130	20		
Surrogates(s)										
1,2-Dichloroethane-d4	434	436	500	86.8	87.2		76-130			
Toluene-d8	478	494	500	95.6	98.8		78-115			

Gas/BTEX/MTBE by 8260B (C6-C12)

Blaine Tech Services, Inc.

Attn.: Leon Gearhart

1680 Rogers Avenue

San Jose, CA 95112-1105

Phone: (408) 573-0555 Fax: (408) 573-7771

Project: 040617-DW-2
98995741

Received: 06/18/2004 11:31

Site: 230 W. MacArthur Blvd., Oakland

Legend and Notes

Analysis Flag

o

Reporting limits were raised due to high level of analyte present in the sample.

Address

City, State, Zip

Shell Project Manager to be Invoiced:

SCIENCE & ENGINEERING
 TECHNICAL SERVICES
 CRUIT HOUSTON

Karen Petryna

2004-06-0648

INCIDENT NUMBER (S&E ONLY)

9 8 9 9 5 7 4 1

SAP or CRMT NUMBER (TS/CRMT)

DATE: 6-17-04

PAGE: 1 of 1

SAMPLING COMPANY: Elaine Tech Services
LAB CODE: BTSS
SITE ADDRESS (Street and City): 230 W. MacArthur Blvd., Oakland
GLOBAL ID NO.: T0600101240
ADDRESS: 1680 Rogers Avenue, San Jose, CA 95112
EDF-DELEGATEABLE TO (Professional Party or Designee): Anni Kraml
PHONE NO.: (510) 420-3335
EMAIL: ShellOaklandEDF@cambridge-env.com
CONSULTANT PROJECT NO.: 040617-00-3
PROJECT CONTACT (Industry or PDF Reports): Leon Gearhart
TELEPHONE: 408-573-0555
FAX: 408-573-7771
EMAIL: lgearhart@elainetech.com
TURNAROUND TIME (BUSINESS DAYS): 10 DAYS 5 DAYS 72 HOURS 48 HOURS 24 HOURS LESS THAN 24 HOURS
LAB USE ONLY: LA - RECEIVE REPORT FORMAT USE AGENCY
GCMS METBE CONFIRMATION: HIGHEST _____ HIGHEST PERFORMANCE ALL _____
SPECIAL INSTRUCTIONS OR NOTES: CHECK BOX IF EDD IS NOT NEEDED

REQUESTED ANALYSIS

FIELD NOTES:

Container/Preservative or PID Readings or Laboratory Notes

40C
TEMPERATURE ON RECEIPT C

LAB USE ONLY	Field Sample Identification	SAMPLING		MATRIX	NO. OF CONT.	TPH - Gas, Purgeable	BTEX	MTBE (M021B - Spgs RL)	MTBE (S260B - 0.5 Spgs RL)	Oxygenates (S) by (S250B)	Ethanol (S260B)	Methanol	EDB & 1,2-DCA (S201B)										
		DATE	TIME																				
	MW-2	6/17	1405	W	3	X	X	X															
	MW-4	6/17	1420	W	3	X	X	X															

Requisitioned by (Signature): *David C. Smith* Date: 6/18/04 Time: 1:11
 Requisitioned by (Signature): *[Signature]* Date: 6/18/04 Time: 1:12
 Requisitioned by (Signature): *[Signature]* Date: 6/18/04 Time: 1:12

ATTACHMENT B

**Groundwater Monitoring Data
240 West MacArthur**

Table 1
Groundwater Monitoring Well Construction and Groundwater Elevation Data
240 W. MacArthur Boulevard, Oakland, California

Well	Well Depth (feet bgs)	Well Screened Interval		Groundwater Level Depth ^(a) June 17, 2004	Groundwater Elevation ^(b) June 17, 2004
		Depth (feet)	Elevation (feet)		
MW-1	25	19.5 to 24.5	54.5 to 49.5	16.28	62.87
MW-2	25	14.5 to 24.5	64.2 to 54.2	15.76	62.69
MW-3	25	14.5 to 24.5	63.4 to 53.4	14.90	62.68
MW-4	25	14.5 to 24.5	63.6 to 53.6	14.68	63.06
MW-5	20	9 to 19	70.6 to 60.6	16.43	62.93
MW-6	20	9 to 19	69.7 to 59.7	15.42	62.01
MW-7	20	9 to 19	69.6 to 59.6	15.63	62.64
MW-8	20	9 to 19	67.7 to 57.7	13.71	62.68

Notes:

^(a) Pre-purge measurement, feet below top of well casing.

^(b) Pre-purge measurement, feet above mean sea level.

Table 2
Groundwater Sample Analytical Results – June 17, 2004
Hydrocarbons, BTEX and MTBE
240 W. MacArthur Boulevard, Oakland, California ^(a)

Well	TVHg	TEHd	Benzene	Toluene	Ethyl-benzene	Total Xylenes	MTBE
MW-1	9,300	4,000	1,700	75	92	350	6.0
MW-2	1,200	370	42	0.7	2.6	0.9	170
MW-3	5,400	1,100	150	30	45	66	130
MW-4	< 50	NA	< 0.5	< 0.5	< 0.5	< 0.5	0.9
MW-5	12,000	1,700	920	240	260	1,150	< 3.1
MW-6	710	830	14	0.7	5.2	6.6	< 0.5
MW-7	< 50	NA	< 0.5	< 0.5	< 0.5	< 0.5	< 0.5
MW-8	320	68	< 0.5	< 0.5	< 0.5	< 0.5	120
RWQCB Environmental Screening Levels ^(b)							
	NLP	NLP	1.0	40	30	20	5.0
Drinking Water Standards ^(c)							
	100	100	1.0 ^(d)	40	30	13	5.0

Notes:

^(a) All concentrations in micrograms per liter (µg/L), equivalent to parts per billion (ppb).

^(b) For commercial/industrial sites where known or potential drinking water resource is threatened.

^(c) Drinking water standards are State of California Secondary Maximum Contaminant Levels (MCLs) – Proposed, unless specified otherwise.

^(d) State of California Primary MCL.

MTBE = Methyl *tertiary*-butyl ether

TEHd = Total extractable hydrocarbons - diesel range

TVHg = Total volatile hydrocarbons - gasoline range

NA = Not analyzed for this contaminant

NLP = No level published.

Table 3
Groundwater Sample Analytical Results – June 17, 2004
Lead Scavengers and Fuel Oxygenates
240 W. MacArthur Boulevard, Oakland, California ^(a)

Well	EDC	EDB	TBA	DIPE
MW-1	< 5.0	< 5.0	270	< 5.0
MW-2	2.0	< 0.5	190	1.1
MW-3	< 0.5	< 0.5	130	1.9
MW-4	< 0.5	< 0.5	< 10	< 0.5
MW-5	< 3.1	< 3.1	120	< 3.1
MW-6	19	< 0.5	54	1.0
MW-7	< 0.5	< 0.5	< 10	< 0.5
MW-8	< 0.5	< 0.5	61	1.0
Drinking Water Standards ^(b)				
	NLP	NLP	NLP	NLP
RWQCB Environmental Screening Levels ^(c)				
	0.5	0.05	12	NLP

Notes:

^(a) All concentrations in micrograms per liter ($\mu\text{g/L}$), equivalent to parts per billion (ppb).

^(b) Drinking water standards are State of California Secondary Maximum Contaminant Levels (MCLs) – Proposed, unless specified otherwise.

^(c) For commercial/industrial sites where known/potential drinking water resource is threatened.

DIPE – Isopropyl Ether

EDB = Ethylene dibromide (1,2-dibromoethane)

EDC = Ethylene dichloride (1,2-dichloroethane)

TBA = *tertiary*-Butyl Alcohol

NA = Not analyzed for this contaminant

NLP = No level published.

Table includes only detected fuel oxygenates. Appendix C contains the full list of analytical compounds