

URGENT
FAA

RUSH TO: Mr. Seery

FAX: *70W15103379335

FROM: Environmental Testing & Mgmt.

PAGES (INCLUDING THIS COVER): 2

This is the final. The map and results of the investigation is correct and the footnote you asked about does not change the sample identity in the data table. Thank you, Tom Price.

Sunday, February 4, 1996

LOCATION	TPHg	BENZENE	TOLUENE	ETHYL-BENZENE	XYLENES
ETM-1	110,000	1,600	2,200	4,000	5,900
ETM-1 ¹	410,000	2,300	1,800	10,000	37,000
ETM-2	140,000	1,700	2,300	6,200	16,000
ETM-3	6,200	47	110	130	120
ETM-4	1,200,000	12,000	24,000	25,000	94,000
ETM-5	170	<0.5	<0.5	<0.5	1.4
ETM-5 ²	170	<0.5	<0.5	<0.5	2.0
ETM-7	160,000	1,500	1,800	3,700	4,500
ETM-8 ³	1,300	18	24	37	36
ETM-9	2,500	22	36	68	45
ETM-9 ⁴	1,900	18	32	57	45
ETM-10	<50	<0.5	<0.5	<0.5	1.0
ETM-11	<50	<0.5	<0.5	<0.5	<0.5
ETM-11 ⁵	<50	<0.5	<0.5	<0.5	<0.5
ETM-12	200	5.9	3.9	3.0	44
ETM-13 ⁶	220	<0.5	<0.5	<0.5	<0.5
ETM-14	120,000	930	2,000	6,200	22,000
ETM-15	<50	<0.5	<0.5	<0.5	1.0

¹This sample was labelled ETM-30 and submitted to the laboratory as a blind duplicate.

²This sample was labelled ETM-31 and submitted to the laboratory as a blind duplicate.

³This sample was collected on 12/8/95, one week after the boring was created. The on-site boring was covered with a drum on 12/1/95 pending grouting due lack of supplies. Prior to grouting, the boring was gauged and groundwater was found to have risen into the boring. A sample was collected prior to grouting. The sample was labelled ETM-7 and submitted for analysis however, the identity of the sample has been changed to ETM-8 here to reflect the logical sequence of the samples collected during the investigation.

⁴This sample was labelled ETM-32 and submitted to the laboratory as a blind duplicate.

⁵This sample was labelled ETM-33 and submitted to the laboratory as a blind duplicate.

⁶The laboratory issued the following comment: "The concentration reported as gasoline for sample ETM-13 is primarily due to the presence of a discrete peak not indicative of gasoline." The sample was also submitted for EPA Method 8010 due to the immediate proximity of a dry cleaning business to the sampling location. The analysis indicates a concentration of 530 µg/L tetrachloroethene in the sample.

ETM-6 "dry"
ETM-16 "dry"

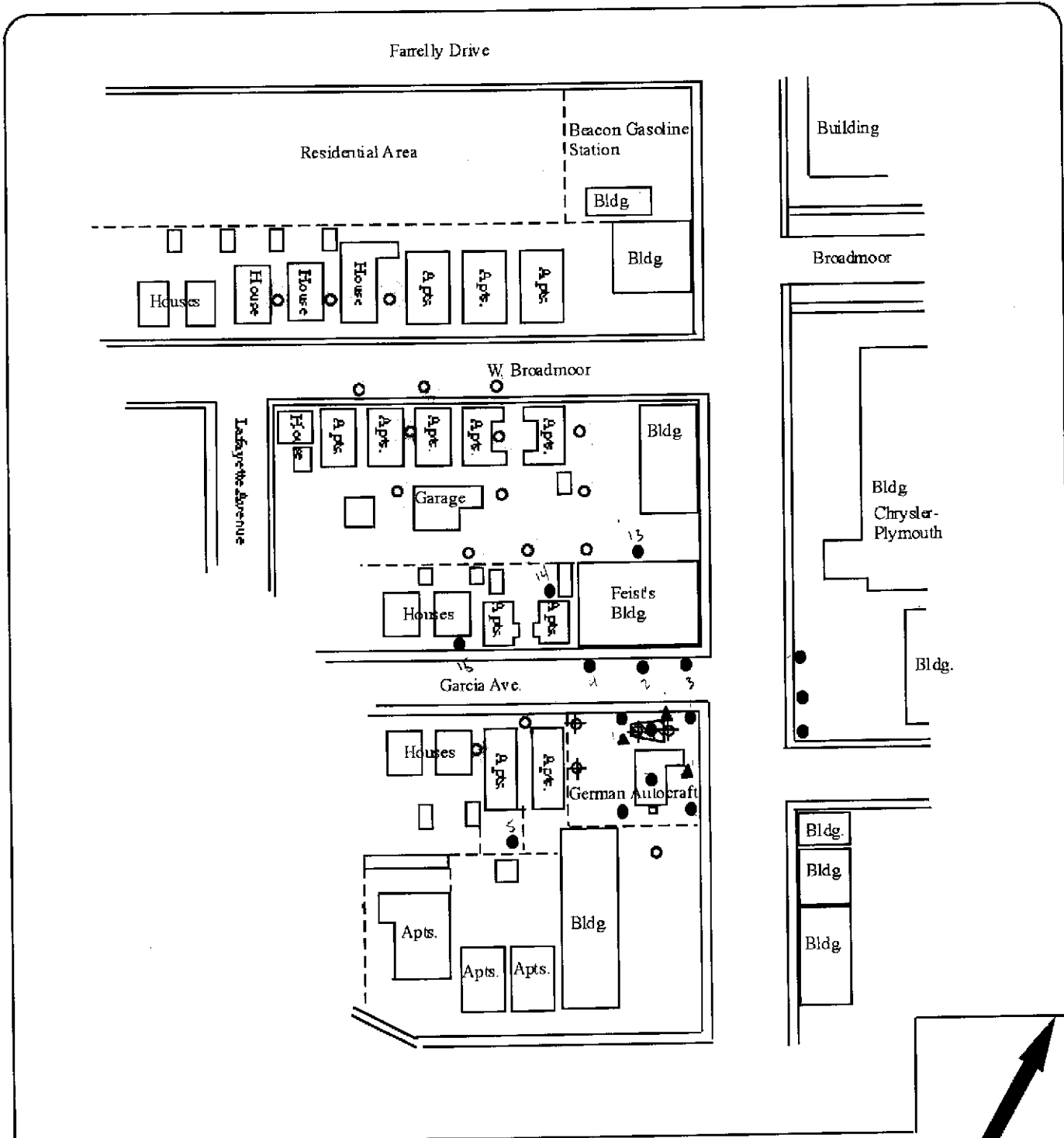

EXPLANATION:

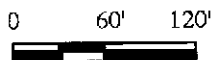

Scale: 1"=120'

--- Fence

⊕ Monitoring Well

▨ Former Tank Pit Areas

▲ Previous Groundwater Sampling Location (1990)

● Groundwater Sampling Location (1994-95)

○ Proposed Grab Groundwater Sampling Location

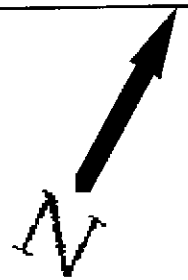

Environmental Testing
and Management
2916 Magliocco #2
San Jose, California

GREATER VICINITY MAP
German Autocraft
301 East 14th Street
San Leandro, California

Figure 1
Project No.
94-52
Date: 2/96