

RO 298



Customer-Focused Solutions

January 16, 2004

ConocoPhillips Company  
76 Broadway  
Sacramento, CA 95818

Alameda County  
JAN 30 2004  
Environmental Health

ATTN: MR. THOMAS KOSEL  
  
SITE: 76 STATION 4625  
3070 FRUITVALE AVENUE  
OAKLAND, CALIFORNIA  
  
RE: QUARTERLY MONITORING REPORT  
OCTOBER THROUGH DECEMBER 2003

Dear Mr. Kosel:

Please find enclosed our Quarterly Monitoring Report for 76 Station 4625, located at 3070 Fruitvale Avenue, Oakland, California. If you have any questions regarding this report, please call us at (949) 753-0101.

Sincerely,

TRC

Anju Farfan  
QMS Operations Manager

CC: Mr. Don Hwang, Alameda County Health Care Services  
Ms. Barbara Moed, TRC

Enclosures  
20-0400/4625R01.QMS



R 0 298



Customer-Focused Solutions

June 22, 2004

TRC Project No. 42014501

Don Hwang  
Alameda County Health Services  
1131 Harbor Bay Parkway  
Alameda, CA 94502-6577

Alameda County  
JUN 22 2004  
6:13:11 PM

**RE: Quarterly Status Report - Fourth Quarter 2003  
76 Service Station #4625, 3070 Fruitvale Avenue, Oakland, California  
Alameda County**

Dear Mr. Hwang:

On behalf of ConocoPhillips Company (ConocoPhillips), TRC is submitting the Fourth Quarter 2003 Quarterly Status Report for the subject site, shown on the attached Figure 3.

#### **PREVIOUS ASSESSMENTS**

The site is currently an active service station located on the southeast corner of Fruitvale Avenue and School Street in Oakland, California.

April/May 1998: The gasoline underground storage tanks (USTs), product piping and dispensers were removed and replaced. Concentrations of total petroleum hydrocarbons as gasoline (TPH-g), benzene, and methyl tertiary butyl ether (MTBE) ranged from non-detect to moderate levels.

May 1998: A waste oil UST and associated piping was also removed. Concentrations of TPH-g, benzene, total petroleum hydrocarbons as diesel (TPH-d), total oil and grease (TOG), volatile organic compounds (VOCs), semi-volatile organic compounds (SVOCs), and metals ranged from non-detect to moderate levels.

A total of approximately 1,166 tons of soil were over excavated and transported from the site to Allied Waste's Forward Landfill in Manteca, California. Additionally, 40,000 gallons of groundwater were pumped from the UST pit and transported to the Tosco Refinery in Rodeo, California for disposal. A conductor casing was installed in the backfill during installation of the replacement gasoline USTs. The waste oil tank was replaced with an aboveground tank.

April 2000: Four monitoring wells were installed at the site.

May 2003: Two monitoring wells were installed to 25 feet below ground surface (bgs) and two exploratory borings were advanced to approximately 15 feet bgs. Soil samples contained low maximum levels of benzene, MTBE, and tertiary butyl alcohol (TBA), and moderate levels of

TPH-g. Grab groundwater samples collected from the two soil borings were reported to contain elevated concentrations of petroleum hydrocarbons in both samples.

October 2003: Site environmental consulting responsibilities were transferred to TRC.

### **SENSITIVE RECEPTORS**

An irrigation well is located 1,700 feet south-southeast of the site.

### **MONITORING AND SAMPLING**

Currently, seven wells are monitored and six wells are sampled quarterly. The groundwater gradient and flow direction were 0.01 foot/foot to the west.

### **REMEDIATION STATUS**

May 1998: A total of approximately 1,166 tons of soil generated during replacement of fuel and waste oil USTs were over excavated and transported from the site to Allied Waste's Forward Landfill in Manteca, California. Additionally, 40,000 gallons of groundwater were pumped from the UST pit and transported to the Tosco Refinery in Rodeo, California for disposal.

Remediation is not currently being conducted at the site.

### **CHARACTERIZATION STATUS**

Total purgeable petroleum hydrocarbons (TPPH) were detected in four of the six wells sampled, at a maximum concentration of 2,900 micrograms per liter ( $\mu\text{g/l}$ ) in MW-6. These levels were lower than recent historical data.

Benzene was detected in the six wells sampled, at a maximum concentration of 420  $\mu\text{g/l}$  in MW-6. These levels were consistent with recent historical data.

MTBE was detected in the six wells sampled, at a maximum concentration of 450  $\mu\text{g/l}$  in MW-6. These levels were consistent with recent historical data.

### **RECENT CORRESPONDENCE**

No correspondence this quarter.

### **CURRENT QUARTER ACTIVITIES**

October 30, 2003: TRC performed groundwater monitoring and sampling. Wastewater generated from well purging and equipment cleaning was stored at TRC's groundwater

QSR – Fourth Quarter 2003  
76 Service Station #4625, Oakland, California  
June 22, 2004  
Page 3

monitoring facility in Concord, California, and transported by Onyx to the ConocoPhillips Refinery in Rodeo, California, for treatment and disposal.

**NEXT QUARTER ACTIVITIES**

Await agency directives for additional assessment work, if any.

Continue quarterly monitoring and sampling to assess plume stability and concentration trends at key wells.

If you have any questions regarding this report, please call Roger Batra at (925) 688-2466.

Sincerely,

TRC

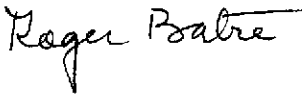

Roger Batra  
Senior Project Manager



Barbara Moed, R.G.  
Senior Project Geologist



Attachment:

Figure 3 – Dissolved-Phase Hydrocarbon Concentrations Map, October 30, 2003, from Fourth Quarter 2003 Fluid Level Monitoring and Sampling Report, dated January 16, 2004 by TRC.

cc: Thomas Kosel, ConocoPhillips (hard copy and electronic upload)



SCHOOL STREET

MW-6	
TPPH	2,900
B	420
MTBE	450

MW-2	
TPPH	180
B	17
MTBE	ND<2.0

MW-3	
TPH-D	ND<50
TPPH	ND<50
B	0.62
MTBE	ND<5.0

MW-5	
TPPH	1,400
B	75
MTBE	330

MW-1	
TPPH	300
B	35
MTBE	8.5

MW-4	
TPPH	ND<50
B	1.1
MTBE	ND<2.0

**NOTES:**

TPH-D = total petroleum hydrocarbons as diesel.  
 TPPH = total purgeable petroleum hydrocarbons.  
 B = benzene. MTBE = methyl tertiary butyl ether.  $\mu\text{g/l}$  = micrograms per liter. ND = not detected at limit indicated on official laboratory report. NA = not analyzed, measured, or collected. UST = underground storage tank.  
 TPH-D results obtained using EPA Method 8015. TPPH, Benzene and MTBE results obtained using EPA Method 8260B.

**LEGEND**

Well No.	
TPH-D	$\mu\text{g/l}$
TPPH	$\mu\text{g/l}$
B	$\mu\text{g/l}$
MTBE	$\mu\text{g/l}$

⊕ Monitoring Well with Dissolved-Phase Hydrocarbon Concentrations ( $\mu\text{g/l}$ )

USTW ⊕ UST Observation Well

FRUITVALE AVENUE

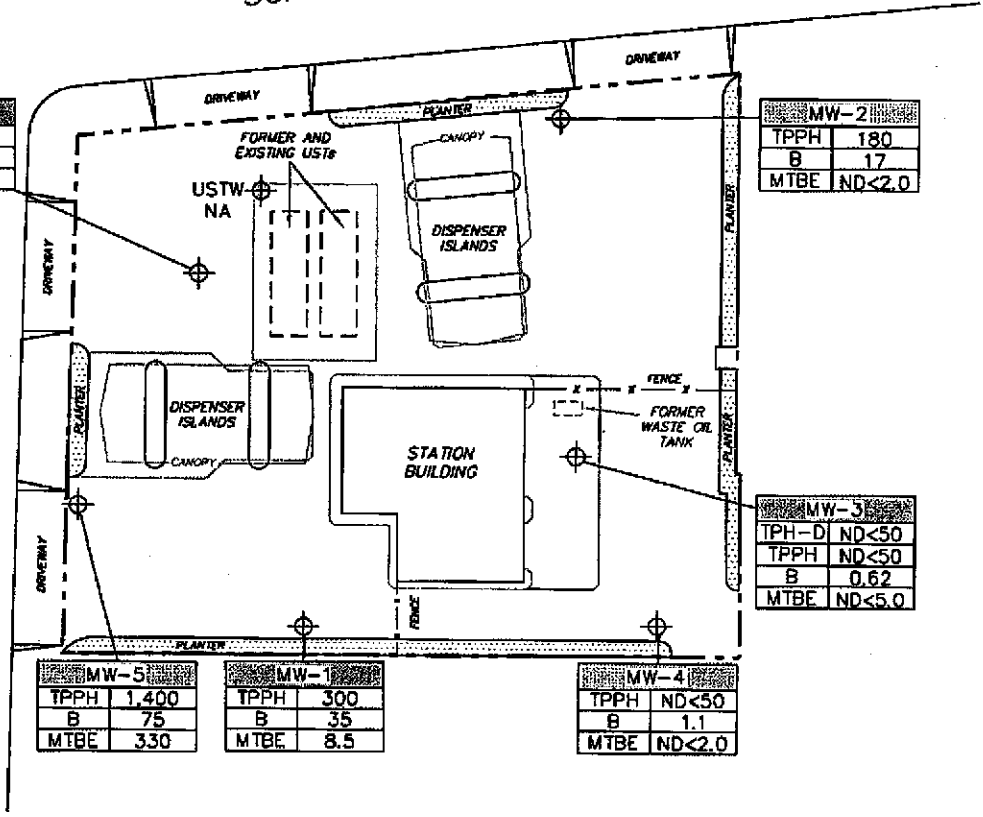

**DISSOLVED-PHASE HYDROCARBON CONCENTRATIONS MAP**  
 October 30, 2003

76 Station 4625  
 3070 Fruitvale Avenue  
 Oakland, California

**FIGURE 3**

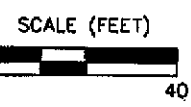

**TRC**



Customer-Focused Solutions

**FOURTH QUARTER 2003  
FLUID LEVEL MONITORING AND  
GROUNDWATER SAMPLING REPORT**

January 16, 2004

76 Station 4625  
3070 Fruitvale Avenue  
Oakland, California

Prepared For:

Mr. Thomas Kosel  
CONOCOPHILLIPS COMPANY  
76 Broadway  
Sacramento, California 95818

By:



Senior Project Geologist, Irvine Operations

## GROUNDWATER MONITORING REPORT

<b>LIST OF ATTACHMENTS</b>	
Summary Sheet	Summary of Gauging and Sampling Activities
Tables	Table Key Table 1: Summary of Groundwater Levels and Chemical Analysis Results Table 2: Historic Groundwater Levels and Chemical Analysis Results Table 3: Summary of Additional Chemical Analysis Results Table 3b: Summary of Additional Chemical Analysis Results Table 3c: Summary of Additional Chemical Analysis Results Table 3d: Summary of Additional Chemical Analysis Results Table 3e: Summary of Additional Chemical Analysis Results
Gettler-Ryan Inc. Historical Tables	Table 1: Groundwater Monitoring Data and Analytical Results Table 2: Groundwater Analytical Results Table 3: Groundwater Analytical Results-Oxygenate Compounds
Figures	Figure 1: Vicinity Map Figure 2: Groundwater Elevation Contour Map Figure 3: Dissolved-Phase Hydrocarbon Concentration Map
Graphs	Benzene Concentrations vs. Time Hydrographs
Field Activities	General Field Procedures Groundwater Sampling Field Notes
Laboratory Reports	Official Laboratory Reports Quality Control Reports Chain of Custody Records
Disposal Documents	Statement of Authorized Transportation and Disposal
Statement	Limitations

**Summary of Gauging and Sampling Activities  
 October 2003 through December 2003  
 76 Station 4625  
 3070 Fruitvale Avenue  
 Oakland, CA**

**Site Information:**

---

Site:	76 Station 3070 Fruitvale Avenue Oakland, CA
Project Coordinator/Phone Number:	Thomas Kosel/916-588-7666
Groundwater wells onsite:	7
Groundwater wells offsite:	0

**Field Activity:**

---

Sampling consultant:	TRC
Date(s) sampled:	10/30/03
Groundwater wells gauged:	7
Groundwater wells sampled:	6
Purging method:	diaphragm pump
Treatment/disposal method during sampling event:	Onyx/Rodeo Unit 100
Free product pumpouts other than sampling event:	No
Treatment/Disposal method during free product pumpouts:	N/A

**Site Hydrogeology:**

---

Minimum depth to groundwater (feet bgs):	8.74
Maximum depth to groundwater (feet bgs):	11.06
Average groundwater elevation (feet relative to mean sea level):	127.65
Average change in groundwater elevations since previous event (feet):	-2.04
Groundwater gradient and flow direction:	0.01 ft/ft, West

**Groundwater Condition (Benzene Maximum Contaminant Level [MCL] = 1.0 µg/l)**

---

Wells with benzene concentrations below MCL:	1
Wells with benzene concentrations at or above MCL:	5
Minimum benzene concentration (µg/l):	0.62
Maximum benzene concentration (µg/l):	420 (MW-6)
Minimum MTBE concentration (µg/l):	ND
Maximum MTBE concentration (µg/l):	450
Minimum TPPH concentration (µg/l):	ND
Maximum TPPH concentration (µg/l):	2900 (MW-6)
Groundwater wells with free product:	0
Minimum free product thickness (feet):	0
Maximum free product thickness (feet):	0

**Additional Information:**

---

USTW=Monitored Only,

This report presents the results of groundwater monitoring and sampling activities performed by TRC. Please contact the primary consultant for other specific information on this site.



# TABLES

## TABLE KEY

### ABBREVIATIONS / SYMBOLS

LPH	= liquid-phase hydrocarbons
µg/l	= micrograms per liter
mg/l	= milligrams per liter
ND	= not detected at or above laboratory detection limit
DTSC	= Department of Toxic Substances Control
N/A	= not applicable
Trace	= less than 0.01 foot of LPH in well
USTs	= underground storage tanks
--	= not analyzed, measured, or collected
TPH-G	= total petroleum hydrocarbons with gasoline distinction
BTEX	= benzene, toluene, ethylbenzene, and total xylenes
TPH-D	= total petroleum hydrocarbons with diesel distinction
TRPH	= total recoverable petroleum hydrocarbons
MTBE	= methyl tertiary butyl ether
TAME	= tertiary amyl methyl ether
ETBE	= ethyl tertiary butyl ether
DIPE	= di-isopropyl ether
TBA	= tertiary butyl alcohol
1,1-DCA	= 1,1-Dichloroethane
1,2-DCA	= 1,2-Dichloroethane
1,1-DCE	= 1,1-Dichloroethene
1,2-DCE	= cis- and trans-1,2-Dichloroethene
PCE	= tetrachloroethene
TCA	= trichloroethane
TCE	= trichloroethene
PCB	= polychlorinated biphenyls
TPPH	= total purgeable petroleum hydrocarbons

### NOTES

Elevations are in feet above mean sea level.

Groundwater elevation for wells with LPH is calculated as follows:

$$\text{Surface elevation} - \text{depth to water} + (0.75 \times \text{LPH thickness}).$$

Concentration Graphs have been modified to plot non-detect results at the reporting limit stated in the official laboratory report. All non-detect results prior to the Second Quarter 2000 were plotted at 0.1 µg/l for graphical display.

J = estimated concentration, value is between the Method Detection Limit (MDL) and the Practical Quantitation Limit (PQL)

### REFERENCE

TRC began groundwater monitoring and sampling activities in October 2003. Historical data for 76 Station 4625 was provided by Gettler-Ryan Inc., Dublin, California, in an excel table received in September 2003.

**Table 1**  
**SUMMARY OF GROUNDWATER LEVELS AND CHEMICAL ANALYSIS RESULTS**  
**October 30, 2003**  
**76 Station 4625**

Date Sampled	TOC Elevation (feet)	Depth to Water (feet)	LPH Thickness (feet)	Ground-water Elevation (feet)	Change in Elevation (feet)	TPH-G (µg/l)	TPPH 8260B (µg/l)	Benzene (µg/l)	Toluene (µg/l)	Ethyl-benzene (µg/l)	Total Xylenes (µg/l)	MTBE 8021B (µg/l)	MTBE 8260B (µg/l)	Comments
<b>MW-1</b>		<b>(Screen Interval in feet: 5.0-25.0)</b>												
10/30/2003	136.36	8.74	0.00	127.62	-2.47	--	300	35	41	21	71	--	8.5	
<b>MW-2</b>		<b>(Screen Interval in feet: 5.0-25.0)</b>												
10/30/2003	138.64	11.06	0.00	127.58	-2.64	--	180	17	4.8	6.1	13	--	ND<2.0	
<b>MW-3</b>		<b>(Screen Interval in feet: 5.0-25.0)</b>												
10/30/2003	137.68	10.05	0.00	127.63	-2.74	--	ND<50	0.62	0.83	ND<0.50	ND<1.0	--	ND<5.0	
<b>MW-4</b>		<b>(Screen Interval in feet: 5.0-25.0)</b>												
10/30/2003	136.60	9.04	0.00	127.56	-2.04	--	ND<50	1.1	2.3	2.2	7.0	--	ND<2.0	
<b>MW-5</b>		<b>(Screen Interval in feet: 5.0-25.0)</b>												
10/30/2003	137.66	10.58	0.00	127.08	-0.95	--	1400	75	43	39	140	--	330	
<b>MW-6</b>		<b>(Screen Interval in feet: 5.0-25.0)</b>												
10/30/2003	138.88	10.43	0.00	128.45	-1.38	--	2900	420	260	120	480	--	450	
<b>USTW</b>		<b>(Screen Interval in feet: DNA)</b>												
10/30/2003	--	10.44	0.00	--	--	--	--	--	--	--	--	--	--	Monitored Only

**Table 2**  
**HISTORIC GROUNDWATER LEVELS AND CHEMICAL ANALYSIS RESULTS**  
**August 2003 Through October 2003**

**76 Station 4625**

Date Sampled	TOC Elevation (feet)	Depth to Water (feet)	LPH Thickness (feet)	Ground-water Elevation (feet)	Change in Elevation (feet)	TPH-G (µg/l)	TPPH 8260B (µg/l)	Benzene (µg/l)	Toluene (µg/l)	Ethyl-benzene (µg/l)	Total Xylcnes (µg/l)	MTBE 8021B (µg/l)	MTBE 8260B (µg/l)	Comments
<b>MW-1 (Screen Interval in feet: 5.0-25.0)</b>														
8/1/2003	137.57	7.48	0.00	130.09	--	--	ND<50	ND<0.50	ND<0.50	ND<0.50	ND<1.0	--	9.7	
10/30/2003	136.36	8.74	0.00	127.62	-2.47	--	300	35	41	21	71	--	8.5	
<b>MW-2 (Screen Interval in feet: 5.0-25.0)</b>														
8/1/2003	139.85	9.63	0.00	130.22	--	--	270	55	ND<0.50	23	6.0	--	ND<2.0	
10/30/2003	138.64	11.06	0.00	127.58	-2.64	--	180	17	4.8	6.1	13	--	ND<2.0	
<b>MW-3 (Screen Interval in feet: 5.0-25.0)</b>														
8/1/2003	138.89	8.52	0.00	130.37	--	--	ND<50	ND<0.50	ND<0.50	ND<0.50	ND<1.0	--	ND<2.0	
10/30/2003	137.68	10.05	0.00	127.63	-2.74	--	ND<50	0.62	0.83	ND<0.50	ND<1.0	--	ND<5.0	
<b>MW-4 (Screen Interval in feet: 5.0-25.0)</b>														
8/1/2003	137.81	8.21	0.00	129.60	--	--	ND<50	ND<0.50	ND<0.50	ND<0.50	ND<1.0	--	ND<2.0	
10/30/2003	136.60	9.04	0.00	127.56	-2.04	--	ND<50	1.1	2.3	2.2	7.0	--	ND<2.0	
<b>MW-5 (Screen Interval in feet: 5.0-25.0)</b>														
8/1/2003	137.66	9.63	0.00	128.03	--	--	16000	2600	2300	740	2900	--	660	
10/30/2003	137.66	10.58	0.00	127.08	-0.95	--	1400	75	43	39	140	--	330	
<b>MW-6 (Screen Interval in feet: 5.0-25.0)</b>														
8/1/2003	138.88	9.05	0.00	129.83	--	--	14000	880	130	630	2000	--	630	
10/30/2003	138.88	10.43	0.00	128.45	-1.38	--	2900	420	260	120	480	--	450	
<b>USTW (Screen Interval in feet: DNA)</b>														
8/1/2003	--	8.99	--	--	--	--	--	--	--	--	--	--	--	
10/30/2003	--	10.44	0.00	--	--	--	--	--	--	--	--	--	--	Monitored Only

**Table 3**  
**SUMMARY OF ADDITIONAL CHEMICAL ANALYSIS RESULTS**  
**76 Station 4625**

Date Sampled	TPH-D (µg/l)	Styrene (µg/l)	cis-1,3-dichloro-propene (µg/l)	trans-1,3-Dichloro-propene (µg/l)	1,4-Dichloro-benzene (µg/l)	EDC (µg/l)	Vinyl acetate (µg/l)	MIBK (µg/l)	Chloro-benzene (µg/l)	2-Chloroethyl vinyl ether (µg/l)	DBCM (µg/l)	PCE (µg/l)	cis-1,2-DCE (µg/l)	trans-1,2-DCE (µg/l)	1,3-Dichloro-benzene (µg/l)
<b>MW-1</b>															
8/1/2003	--	--	--	--	--	--	--	--	--	--	--	--	--	--	--
10/30/2003	--	--	--	--	--	ND<2.0	--	--	--	--	--	--	--	--	--
<b>MW-2</b>															
8/1/2003	--	--	--	--	--	--	--	--	--	--	--	--	--	--	--
10/30/2003	--	--	--	--	--	--	--	--	--	--	--	--	--	--	--
<b>MW-3</b>															
8/1/2003	ND<50	--	--	--	--	--	--	--	--	--	--	--	--	--	--
10/30/2003	ND<50	ND<0.50	ND<0.50	ND<0.50	ND<0.50	ND<0.50	ND<25	ND<50	ND<0.50	ND<5.0	ND<0.50	ND<0.50	ND<0.50	ND<0.50	ND<0.50
<b>MW-4</b>															
8/1/2003	--	--	--	--	--	--	--	--	--	--	--	--	--	--	--
10/30/2003	--	--	--	--	--	--	--	--	--	--	--	--	--	--	--
<b>MW-5</b>															
8/1/2003	--	--	--	--	--	--	--	--	--	--	--	--	--	--	--
10/30/2003	--	--	--	--	--	ND<10	--	--	--	--	--	--	--	--	--
<b>MW-6</b>															
8/1/2003	--	--	--	--	--	--	--	--	--	--	--	--	--	--	--
10/30/2003	--	--	--	--	--	ND<20	--	--	--	--	--	--	--	--	--

**Table 3b**  
**SUMMARY OF ADDITIONAL CHEMICAL ANALYSIS RESULTS**  
**76 Station 4625**

Date Sampled	Carbon Tetrachloride (µg/l)	2-Hexanone (µg/l)	Acetone (µg/l)	Chloroform (µg/l)	1,1,1-TCE (µg/l)	Bromomethane (µg/l)	Chloromethane (µg/l)	Chloroethane (µg/l)	Vinyl chloride (µg/l)	Methylene chloride (µg/l)	Carbon Disulfide (µg/l)	Bromoform (µg/l)	BDCM (µg/l)	1,1-DCA (µg/l)	1,1-DCE (µg/l)
<b>MW-1</b>															
8/1/2003	--	--	--	--	--	--	--	--	--	--	--	--	--	--	--
10/30/2003	--	--	--	--	--	--	--	--	--	--	--	--	--	--	--
<b>MW-2</b>															
8/1/2003	--	--	--	--	--	--	--	--	--	--	--	--	--	--	--
10/30/2003	--	--	--	--	--	--	--	--	--	--	--	--	--	--	--
<b>MW-3</b>															
8/1/2003	--	--	--	--	--	--	--	--	--	--	--	--	--	--	--
10/30/2003	ND<0.50	ND<50	ND<50	ND<1.0	ND<0.50	ND<1.0	ND<1.0	ND<1.0	ND<0.50	ND<5.0	ND<5.0	ND<0.50	ND<1.0	ND<0.50	ND<0.50
<b>MW-4</b>															
8/1/2003	--	--	--	--	--	--	--	--	--	--	--	--	--	--	--
10/30/2003	--	--	--	--	--	--	--	--	--	--	--	--	--	--	--
<b>MW-5</b>															
8/1/2003	--	--	--	--	--	--	--	--	--	--	--	--	--	--	--
10/30/2003	--	--	--	--	--	--	--	--	--	--	--	--	--	--	--
<b>MW-6</b>															
8/1/2003	--	--	--	--	--	--	--	--	--	--	--	--	--	--	--
10/30/2003	--	--	--	--	--	--	--	--	--	--	--	--	--	--	--

**Table 3c**  
**SUMMARY OF ADDITIONAL CHEMICAL ANALYSIS RESULTS**  
**76 Station 4625**

Date Sampled	Trichloro-fluoro-methane (µg/l)	Trichloro-trifluoro-ethane (µg/l)	1,2-dichloro-propane (µg/l)	MEK (µg/l)	1,1,2-TCA (µg/l)	TCE (µg/l)	1,1,2,2-Tetrachloro-ethane (µg/l)	1,2-DCB (µg/l)	Dichloro-difluoro-methane (µg/l)	n-Propyl-benzene (µg/l)	n-Butyl-benzene (µg/l)	4-Chloro-toluene (µg/l)	EDB (µg/l)	1,3,5-Trimethyl-benzene (µg/l)	Bromo-benzene (µg/l)
<b>MW-1</b>															
8/1/2003	--	--	--	--	--	--	--	--	--	--	--	--	ND<2.0	--	--
10/30/2003	--	--	--	--	--	--	--	--	--	--	--	--	ND<2.0	--	--
<b>MW-2</b>															
8/1/2003	--	--	--	--	--	--	--	--	--	--	--	--	--	--	--
10/30/2003	--	--	--	--	--	--	--	--	--	--	--	--	--	--	--
<b>MW-3</b>															
8/1/2003	--	--	--	--	--	--	--	--	--	--	--	--	--	--	--
10/30/2003	ND<1.0	ND<0.50	ND<0.50	ND<50	ND<0.50	ND<0.50	ND<0.50	ND<0.50	ND<0.50	ND<1.0	ND<1.0	ND<0.50	ND<0.50	ND<0.50	ND<1.0
<b>MW-4</b>															
8/1/2003	--	--	--	--	--	--	--	--	--	--	--	--	ND<2.0	--	--
10/30/2003	--	--	--	--	--	--	--	--	--	--	--	--	--	--	--
<b>MW-5</b>															
8/1/2003	--	--	--	--	--	--	--	--	--	--	--	--	ND<80	--	--
10/30/2003	--	--	--	--	--	--	--	--	--	--	--	--	ND<10	--	--
<b>MW-6</b>															
8/1/2003	--	--	--	--	--	--	--	--	--	--	--	--	ND<20	--	--
10/30/2003	--	--	--	--	--	--	--	--	--	--	--	--	ND<20	--	--

**Table 3d**  
**SUMMARY OF ADDITIONAL CHEMICAL ANALYSIS RESULTS**  
**76 Station 4625**

Date Sampled	1,2,4-Trichlorobenzene (µg/l)	sec-Butylbenzene (µg/l)	1,3-Dichloropropane (µg/l)	1,1-Dichloropropene (µg/l)	2,2-Dichloropropane (µg/l)	1,1,1,2-Tetrachloroethane (µg/l)	Dibromomethane (µg/l)	Bromochloromethane (µg/l)	1,2,3-Trichlorobenzene (µg/l)	HCBD (µg/l)	2-Chlorotoluene (µg/l)	1,2,4-Trimethylbenzene (µg/l)	DBCP (µg/l)	tert-Butylbenzene (µg/l)	Isopropylbenzene (µg/l)
<b>MW-1</b>															
8/1/2003	--	--	--	--	--	--	--	--	--	--	--	--	--	--	--
10/30/2003	--	--	--	--	--	--	--	--	--	--	--	--	--	--	--
<b>MW-2</b>															
8/1/2003	--	--	--	--	--	--	--	--	--	--	--	--	--	--	--
10/30/2003	--	--	--	--	--	--	--	--	--	--	--	--	--	--	--
<b>MW-3</b>															
8/1/2003	--	--	--	--	--	--	--	--	--	--	--	--	--	--	--
10/30/2003	ND<1.0	ND<1.0	ND<1.0	ND<0.50	ND<0.50	ND<0.50	ND<0.50	ND<1.0	ND<1.0	ND<1.0	ND<0.50	ND<0.50	ND<1.0	ND<1.0	ND<0.50
<b>MW-4</b>															
8/1/2003	--	--	--	--	--	--	--	--	--	--	--	--	--	--	--
10/30/2003	--	--	--	--	--	--	--	--	--	--	--	--	--	--	--
<b>MW-5</b>															
8/1/2003	--	--	--	--	--	--	--	--	--	--	--	--	--	--	--
10/30/2003	--	--	--	--	--	--	--	--	--	--	--	--	--	--	--
<b>MW-6</b>															
8/1/2003	--	--	--	--	--	--	--	--	--	--	--	--	--	--	--
10/30/2003	--	--	--	--	--	--	--	--	--	--	--	--	--	--	--



**Table 3e**  
**SUMMARY OF ADDITIONAL CHEMICAL ANALYSIS RESULTS**  
**76 Station 4625**

Date Sampled	p-Isopropyl-toluene (µg/l)	Naphthalene (µg/l)	TAME 8260B (µg/l)	TBA 8260B (µg/l)	DIPE 8260B (µg/l)	ETBE 8260B (µg/l)	Ethanol 8260B (µg/l)	Chromium (mg/l)	TOG (mg/l)	1,2 DCE (µg/l)
<b>MW-1</b>										
8/1/2003	--	--	ND<2.0	ND<100	ND<2.0	ND<2.0	ND<500	--	--	ND<2.0
10/30/2003	--	--	ND<2.0	ND<100	ND<2.0	ND<2.0	ND<500	--	--	--
<b>MW-2</b>										
8/1/2003	--	--	--	--	--	--	ND<500	--	--	--
10/30/2003	--	--	--	--	--	--	ND<500	--	--	--
<b>MW-3</b>										
8/1/2003	--	--	--	--	--	--	ND<500	--	--	--
10/30/2003	ND<1.0	ND<1.0	--	--	--	--	ND<500	0.13	ND<1.0	--
<b>MW-4</b>										
8/1/2003	--	--	--	--	--	--	ND<500	--	--	--
10/30/2003	--	--	--	--	--	--	ND<500	--	--	--
<b>MW-5</b>										
8/1/2003	--	--	ND<80	ND<4000	ND<80	ND<80	ND<20000	--	--	ND<80
10/30/2003	--	--	ND<10	ND<500	ND<10	ND<10	ND<2500	--	--	--
<b>MW-6</b>										
8/1/2003	--	--	ND<20	ND<1000	ND<20	ND<20	ND<50000	--	--	ND<20
10/30/2003	--	--	ND<20	ND<1000	ND<20	ND<20	ND<5000	--	--	--

GETTLER-RYAN INC.  
HISTORICAL TABLES

**Table 1**  
**Groundwater Monitoring Data and Analytical Results**  
 Tosco (76) Service Station #4625  
 3070 Fruitvale Avenue  
 Oakland, California

WELL ID/ TOC*(ft)	DATE	DTW (ft.)	S.I. (ft.bgs)	GWE (msl)	TPH-D (ppb)	TPH-G (ppb)	B (ppb)	T (ppb)	E (ppb)	X (ppb)	MTBE (ppb)
<b>MW-1</b>											
136.36	05/03/00	11.81	5.0-25.0	124.55	--	ND	ND	ND	ND	ND	11/14 <sup>2</sup>
	07/28/00	7.79		128.57	--	ND	ND	ND	ND	ND	21/19 <sup>2</sup>
	10/29/00	7.90		128.46	--	62 <sup>1</sup>	ND	ND	ND	ND	6.5/3.9 <sup>2</sup>
	02/09/01	7.95		128.41	--	ND	ND	ND	ND	ND	9.0/9.0 <sup>2</sup>
	05/11/01	7.22		129.14	--	ND	ND	ND	ND	ND	12.7/16.3 <sup>2</sup>
	08/10/01	8.47		127.89	--	<50	<0.50	<0.50	<0.50	<0.50	17/19 <sup>7</sup>
	11/07/01	8.10		128.26	--	<50	<0.50	<0.50	<0.50	<0.50	22/26 <sup>2</sup>
	02/06/02	6.84		129.52	--	<50	<0.50	<0.50	<0.50	<0.50	14/18 <sup>2</sup>
	05/08/02	7.29		129.07	--	<50	<0.50	<0.50	<0.50	<0.50	20/19 <sup>2</sup>
	08/09/02 <sup>9</sup>	8.20		128.16	--	57 <sup>8</sup>	<0.50	<0.50	<0.50	<1.0	22
11/26/02 <sup>9</sup>	7.78		128.58	--	<50	<0.50	<0.50	<0.50	<1.0	23	
137.57	02/14/03 <sup>9</sup>	6.90		130.67	--	<50	<0.50	<0.50	<0.50	<1.0	8.8
	05/03/03 <sup>9</sup>	7.36		130.21	--	<50	<0.50	<0.50	<0.50	<1.0	3.4
<b>MW-2</b>											
138.64	05/03/00	8.59	5.0-25.0	130.05	--	2,400 <sup>1</sup>	53	ND <sup>3</sup>	ND <sup>3</sup>	240	<sup>3</sup> ND/ND <sup>2</sup>
	07/28/00	9.95		128.69	--	2,200 <sup>1</sup>	680	4.1	57	270	24/ND <sup>2</sup>
	10/29/00	8.38		130.26	--	490 <sup>1</sup>	67	ND <sup>3</sup>	23	22	ND <sup>3</sup>
	02/09/01	8.41		130.23	--	ND	3.1	ND	0.52	1.1	ND
	05/11/01	8.93		129.71	--	ND	1.99	ND	ND	ND	ND
	08/10/01	10.68		127.96	--	96 <sup>1</sup>	20	<0.50	2.1	9.4	<5.0
	11/07/01	10.01		128.63	--	480 <sup>1</sup>	110	<1.0	26	42	<10
	02/06/02	8.10		130.54	--	69 <sup>1</sup>	13	<0.50	0.84	4.4	<5.0
	05/08/02	9.16		129.48	--	53 <sup>1</sup>	13	<0.50	1.2	1.5	<5.0
	08/09/02 <sup>9</sup>	10.39		128.25	--	140	20	<0.50	10	11	<2.0
11/26/02 <sup>9</sup>	9.81		128.83	--	340	87	<0.50	33	23	<2.0	
139.85	02/14/03 <sup>9</sup>	8.19		131.66	--	130	12	<0.50	7.4	5.4	<2.0
	05/03/03 <sup>9</sup>	6.77		133.08	--	<50	2.5	<0.50	1.7	<1.0	<2.0

**Table 1**  
**Groundwater Monitoring Data and Analytical Results**  
Tosco (76) Service Station #4625  
3070 Fruitvale Avenue  
Oakland, California

WELL ID/ TOC* (ft.)	DATE	DTW (ft.)	S.I. (ft.bgs)	GWE (msl)	TPH-D (ppb)	TPH-G (ppb)	B (ppb)	T (ppb)	E (ppb)	X (ppb)	MTBE (ppb)
<b>MW-3</b>											
137.68	05/03/00	7.60	5.0-25.0	130.08	93 <sup>5</sup>	ND	ND	ND	ND	ND	ND/ND <sup>4</sup>
	07/28/00	8.82		128.86	ND <sup>3</sup>	ND	ND	ND	ND	ND	ND/ND <sup>4</sup>
	10/29/00	7.33		130.35	ND	ND	ND	ND	ND	ND	ND
	02/09/01	7.40		130.28	72 <sup>6</sup>	ND	ND	ND	ND	ND	ND
	05/11/01	7.90		129.78	ND	ND	ND	ND	ND	ND	ND
	08/10/01	9.09		128.59	63 <sup>8</sup>	<50	<0.50	<0.50	<0.50	<0.50	<5.0
	11/07/01	9.03		128.65	88 <sup>8</sup>	<50	<0.50	<0.50	<0.50	<0.50	<5.0
	02/06/02	7.16		130.52	<310	<50	<0.50	<0.50	<0.50	<0.50	<5.0
	05/08/02	8.04		129.64	<53	<50	<0.50	<0.50	<0.50	<0.50	<5.0
	08/09/02 <sup>9</sup>	9.27		128.41	<50	<50	<0.50	<0.50	<0.50	<1.0	<2.0
	11/26/02 <sup>9</sup>	8.79		128.89	<50	<50	<0.50	<0.50	<0.50	<1.0	<2.0
138.89	02/14/03 <sup>9</sup>	7.18		131.71	<50	<50	<0.50	<0.50	<0.50	<1.0	<2.0
	05/03/03 <sup>9</sup>	5.88		133.01	<50	<50	<0.50	<0.50	<0.50	<1.0	<2.0
<b>MW-4</b>											
136.60	05/03/00	6.48	5.0-25.0	130.12	--	ND	ND	ND	ND	ND	ND/ND <sup>2</sup>
	07/28/00	7.55		129.05	--	ND	ND	ND	ND	ND	ND
	10/29/00	6.12		130.48	--	ND	ND	ND	ND	ND	ND
	02/09/01	6.14		130.46	--	ND	ND	ND	ND	ND	ND
	05/11/01	7.51		129.09	--	ND	ND	ND	ND	ND	ND
	08/10/01	8.66		127.94	--	<50	<0.50	<0.50	<0.50	<0.50	<5.0
	11/07/01	7.92		128.68	--	<50	<0.50	<0.50	<0.50	<0.50	<5.0
	02/06/02	7.18		129.42	--	<50	<0.50	<0.50	<0.50	<0.50	<5.0
	05/08/02	6.86		129.74	--	<50	<0.50	<0.50	<0.50	<0.50	<5.0
	08/09/02 <sup>9</sup>	7.67		128.93	--	<50	<0.50	<0.50	<0.50	<1.0	<2.0
	11/26/02 <sup>9</sup>	8.08		128.52	--	<50	<0.50	<0.50	<0.50	<1.0	<2.0
137.81	02/14/03 <sup>9</sup>	7.43		130.38	--	<50	<0.50	<0.50	<0.50	<1.0	<2.0
	05/03/03 <sup>9</sup>	6.05		131.76	--	<50	<0.50	<0.50	<0.50	<1.0	<2.0

**Table 1**  
**Groundwater Monitoring Data and Analytical Results**  
 Tosco (76) Service Station #4625  
 3070 Fruitvale Avenue  
 Oakland, California

WELL ID/ TOC* (ft.)	DATE	DTW (ft.)	S.I. (ft.bgs)	GWE (msl)	TPH-D (ppb)	TPH-G (ppb)	B (ppb)	T (ppb)	E (ppb)	X (ppb)	MTBE (ppb)
<b>MW-5</b>											
	11/26/02 <sup>9,10</sup>	9.89	5.0-25.0	--	--	2,500	350	39	32	640	470
137.66	02/14/03 <sup>9</sup>	8.65		129.01	--	6,600	920	210	430	1,300	960
	05/03/03 <sup>9</sup>	8.23		129.43	--	33,000	2,400	2,200	2,000	7,600	1,500
<b>MW-6</b>											
	11/26/02 <sup>9,10</sup>	9.19	5.0-25.0	--	--	11,000	1,200	2,000	400	2,300	490
138.88	02/14/03 <sup>9</sup>	7.76		131.12	--	13,000	2,300	1,900	560	2,300	360
	05/03/03 <sup>9</sup>	6.62		132.26	--	4,300	1,000	640	260	990	300
<b>UST OBSERVATION WELL</b>											
	05/03/00	8.00	--	--	--	--	--	--	--	--	--
	07/28/00	9.28		--	--	--	--	--	--	--	--
	10/29/00	7.75		--	--	--	--	--	--	--	--
	02/09/01	6.14		--	--	--	--	--	--	--	--
	05/11/01	7.96		--	--	--	--	--	--	--	--
	08/10/01	9.54		--	--	--	--	--	--	--	--
	11/07/01	9.33		--	--	--	--	--	--	--	--
	02/06/02	8.08		--	--	--	--	--	--	--	--
	05/08/02	8.51		--	--	--	--	--	--	--	--
	08/09/02	9.56		--	--	--	--	--	--	--	--
	11/26/02	9.16		--	--	--	--	--	--	--	--
	02/14/03	-- <sup>11</sup>		--	--	--	--	--	--	--	--
	05/03/03	6.25		--	--	--	--	--	--	--	--
<b>Trip Blank</b>											
TB-LB	05/03/00	--	--	--	--	ND	ND	ND	ND	ND	ND
	07/28/00	--		--	--	ND	ND	ND	ND	ND	ND
	10/29/00	--		--	--	ND	ND	ND	ND	ND	ND
	02/09/01	--		--	--	ND	ND	ND	ND	ND	ND

**Table 1**  
**Groundwater Monitoring Data and Analytical Results**  
 Tosco (76) Service Station #4625  
 3070 Fruitvale Avenue  
 Oakland, California

WELL ID/ TOC*(ft.)	DATE	DTW (ft.)	S.I. (ft.hgs)	GWE (msl)	TPH-D (ppb)	TPH-G (ppb)	B (ppb)	T (ppb)	E (ppb)	X (ppb)	MTBE (ppb)
TB-LB	05/11/01	--	--	--	--	ND	ND	ND	ND	ND	ND
(cont)	08/10/01	--	--	--	--	<50	<0.50	<0.50	<0.50	<0.50	<5.0
	11/07/01	--	--	--	--	<50	<0.50	<0.50	<0.50	<0.50	<5.0
	02/06/02	--	--	--	--	<50	<0.50	<0.50	<0.50	<0.50	<5.0
	05/08/02	--	--	--	--	<50	<0.50	<0.50	<0.50	<0.50	<5.0
QA	08/09/02 <sup>9</sup>	--	--	--	--	<50	<0.50	<0.50	<0.50	<1.0	<2.0
	11/26/02 <sup>9</sup>	--	--	--	--	<50	<0.50	<0.50	<0.50	<1.0	<2.0
	02/14/03 <sup>9</sup>	--	--	--	--	<50	<0.50	<0.50	<0.50	<1.0	<2.0
	05/03/03 <sup>9</sup>	--	--	--	--	<50	<0.50	<0.50	<0.50	<1.0	<2.0

**Table 1**  
**Groundwater Monitoring Data and Analytical Results**  
Tosco (76) Service Station #4625  
3070 Fruitvale Avenue  
Oakland, California

**EXPLANATIONS:**

TOC = Top of Casing

(ft.) = Feet

DTW = Depth to Water

S.I. = Screen Interval

(ft.bgs) = Feet Below Ground Surface

GWE = Groundwater Elevation

(msl) = Mean sea level

TPH-D = Total Petroleum Hydrocarbons as Diesel

TPH-G = Total Petroleum Hydrocarbons as Gasoline

B = Benzene

T = Toluene

E = Ethylbenzene

X = Xylenes

MTBE = Methyl tertiary butyl ether

(ppb) = Parts per billion

ND = Not Detected

-- = Not Measured/Not Analyzed

QA = Quality Assurance/Trip Blank

\* TOC elevations were resurveyed on January 6, 2003, by Virgil Chavez Land Surveying. The benchmark for this survey was a City of Oakland Benchmark, being a disk monument at approximate centerline of easterly southwest of Fruitvale and Montana Streets, (Benchmark Elevation = 157.127 feet NGVD 29).

TOC elevations were surveyed based on a cut square on School Street, City of Oakland Benchmark No. 3783, (Elevation = 136.99 feet, msl).

<sup>1</sup> Laboratory report indicates gasoline C6-C12.

<sup>2</sup> MTBE by EPA Method 8260.

<sup>3</sup> Detection limit raised. Refer to analytical reports.

<sup>4</sup> MTBE by EPA Method 8240.

<sup>5</sup> Laboratory report indicates unidentified hydrocarbons C9-C24.

<sup>6</sup> Laboratory report indicates discrete peaks.

<sup>7</sup> MTBE by EPA Method 8260 was analyzed beyond the EPA recommended holding time.

<sup>8</sup> Laboratory report indicates hydrocarbon pattern is present in the requested fuel quantitation range but does not resemble the pattern of the requested fuel.

<sup>9</sup> TPH-G, BTEX and MTBE by EPA Method 8260.

<sup>10</sup> Well development performed.

<sup>11</sup> Field technician inadvertently missed well.

**Table 2**  
**Groundwater Analytical Results**  
 Tosco (76) Service Station #4625  
 3070 Fruitvale Avenue  
 Oakland, California

WELL ID	DATE	VOCs by EPA 8240 (ppb)	VOCs by EPA 8021 (ppb)	VOCs by EPA 8260 (ppb)	SVOCs by EPA 8270 (ppb)	Chromium (ppm)	TOG (ppm)
<b>MW-3</b>							
	05/03/00	ND	--	--	ND	ND	ND
	07/28/00	ND <sup>1</sup>	--	--	ND	1.8	ND
	10/29/00	ND	--	--	ND	ND	7.0
	02/09/01	ND	--	--	ND	0.038	ND
	05/11/01	ND	--	--	ND	ND	ND
	08/10/01	<2.0-<20	<0.50-<5.0	--	<5.0-<50	<0.010	<5.0
	11/07/01	<2.0-<20	<0.50-<5.0 <sup>2</sup>	--	<5.0-<50	<0.010	<5.0
	02/06/02	<2.0-<20	<0.50-<5.0	--	<5.0-<50	0.11	<5.0
	05/08/02	<2.0-<20	--	<0.50 <sup>3</sup>	<5.2-<100	0.037	<5.2
	08/09/02	--	--	<0.50-<50	<2.0-<10	0.70	<1.0
	11/26/02	--	--	<0.50-<50	<2.0-<10	0.34	<1.0
	02/14/03	--	--	<0.50-<50	<2.0-<10	0.074	<1.0
	05/03/03	--	--	<0.50-<50	<10-<50	0.48	<1.0

**EXPLANATIONS:**

VOCs = Volatile Organic Compounds

SVOCs = Semi-Volatile Organic Compounds

TOG = Total Oil and Grease

(ppb) = Parts per billion

(ppm) = Parts per million

ND = Not Detected

-- = Not Analyzed

<sup>1</sup> All VOCs by EPA Method 8240 were ND, except for Tetrachloroethene (PCE) was detected at 2.7 ppb.

<sup>2</sup> All VOCs by EPA Method 8021 were less than the reporting limit, except for Trichloroethane (TCE) was detected at 0.55 ppb.

<sup>3</sup> All VOCs by EPA Method 8260 were less than the reporting limit, except for cis-1,2-Dichloroethene (c-1,2-DCE) was detected at 0.69 ppb, PCE at 0.56 ppb, and TCE at 0.86 ppb.

**ANALYTICAL METHODS:**

EPA 200 Series Methods for Chromium

EPA Method SM5520 for Total Oil and Grease

NOTE: All EPA Method 8240, 8021, 8260, and 8270 constituents were ND, unless noted.



**Table 3**  
**Groundwater Analytical Results - Oxygenate Compounds**  
 Tosco (76) Service Station #4625  
 3070 Fruitvale Avenue  
 Oakland, California

WELL ID	DATE	ETHANOL (ppb)	TBA (ppb)	MTBE (ppb)	DIPE (ppb)	ETBE (ppb)	TAME (ppb)	1,2-DCA (ppb)	EDB (ppb)
MW-1	02/09/01	ND	ND	9.0	ND	ND	ND	ND	ND
	05/11/01	ND	ND	16.3	ND	ND	ND	ND	ND
	08/10/01 <sup>1</sup>	<1,000	<100	19	<2.0	<2.0	<2.0	<2.0	<2.0
	11/07/01	<500	<20	26	<1.0	<1.0	<1.0	<1.0	<1.0
	02/06/02	<500	<100	18	<2.0	<2.0	<2.0	<2.0	<2.0
	05/08/02	<500	<100	19	<2.0	<2.0	<2.0	<2.0	<2.0
	08/09/02	<500	<100	22	<2.0	<2.0	<2.0	<2.0	<2.0
	11/26/02	<500	<100	23	<2.0	<2.0	<2.0	<2.0	<2.0
	02/14/03	<500	<100	8.8	<2.0	<2.0	<2.0	<2.0	<2.0
	05/03/03	<500	<100	3.4	<2.0	<2.0	<2.0	<2.0	<2.0
MW-2	11/26/02	--	--	<2.0	--	--	--	--	--
	02/14/03	--	--	<2.0	--	--	--	--	--
	05/03/03	--	--	<2.0	--	--	--	--	--
MW-3	07/28/00	--	ND	ND	ND	ND	ND	ND	ND
	11/26/02	--	--	<2.0	--	--	--	--	--
	02/14/03	--	--	<2.0	--	--	--	--	--
	05/03/03	--	--	<2.0	--	--	--	--	--
MW-4	11/26/02	--	--	<2.0	--	--	--	--	--
	02/14/03	<500	<100	<2.0	<2.0	<2.0	<2.0	<2.0	<2.0
	05/03/03	--	--	<2.0	--	--	--	--	--
MW-5	11/26/02	<5,000	<1,000	470	<20	<20	<20	<20	<20
	02/14/03	<5,000	<1,000	960	<20	<20	<20	<20	<20
	05/03/03	<50,000	<10,000	1,500	<200	<200	<200	<200	<200

**Table 3**  
**Groundwater Analytical Results - Oxygenate Compounds**  
 Tosco (76) Service Station #4625  
 3070 Fruitvale Avenue  
 Oakland, California

WELL ID	DATE	ETHANOL (ppb)	TBA (ppb)	MTBE (ppb)	DIPE (ppb)	ETBE (ppb)	TAME (ppb)	1,2-DCA (ppb)	EDB (ppb)
MW-6	11/26/02	<10,000	<2,000	490	<40	<40	<40	<40	<40
	02/14/03	<10,000	<2,000	360	<40	<40	<40	<40	<40
	05/03/03	<25,000	<5,000	300	<100	<100	<100	<100	<100

**Table 3**  
**Groundwater Analytical Results - Oxygenate Compounds**  
Tosco (76) Service Station #4625  
3070 Fruitvale Avenue  
Oakland, California

**EXPLANATIONS:**

TBA = Tertiary butyl alcohol

MTBE = Methyl tertiary butyl ether

DIPE = Di-isopropyl ether

ETBE = Ethyl tertiary butyl ether

TAME = Tertiary amyl methyl ether

1,2-DCA = 1,2-Dichloroethane

EDB = Ethylene dibromide/1,2-Dibromoethane

(ppb) = Parts per billion

-- = Not Analyzed

ND = Not Detected

**ANALYTICAL METHOD:**

EPA Method 8260 for Oxygenate Compounds

<sup>1</sup> Laboratory report indicates sample was analyzed beyond the EPA recommended holding time.

# FIGURES



0 1/4 1/2 3/4 1 MILE

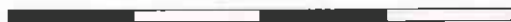

SCALE 1: 24,000



QUADRANGLE  
LOCATION

**VICINITY MAP**

76 Station 4625  
3070 Fruitvale Avenue  
Oakland, California

**SOURCE:**

United States Geological Survey  
7.5 Minute Topographic Map:  
Oakland East Quadrangle

**TRC**

**FIGURE 1**



SCHOOL STREET

FRUITVALE AVENUE

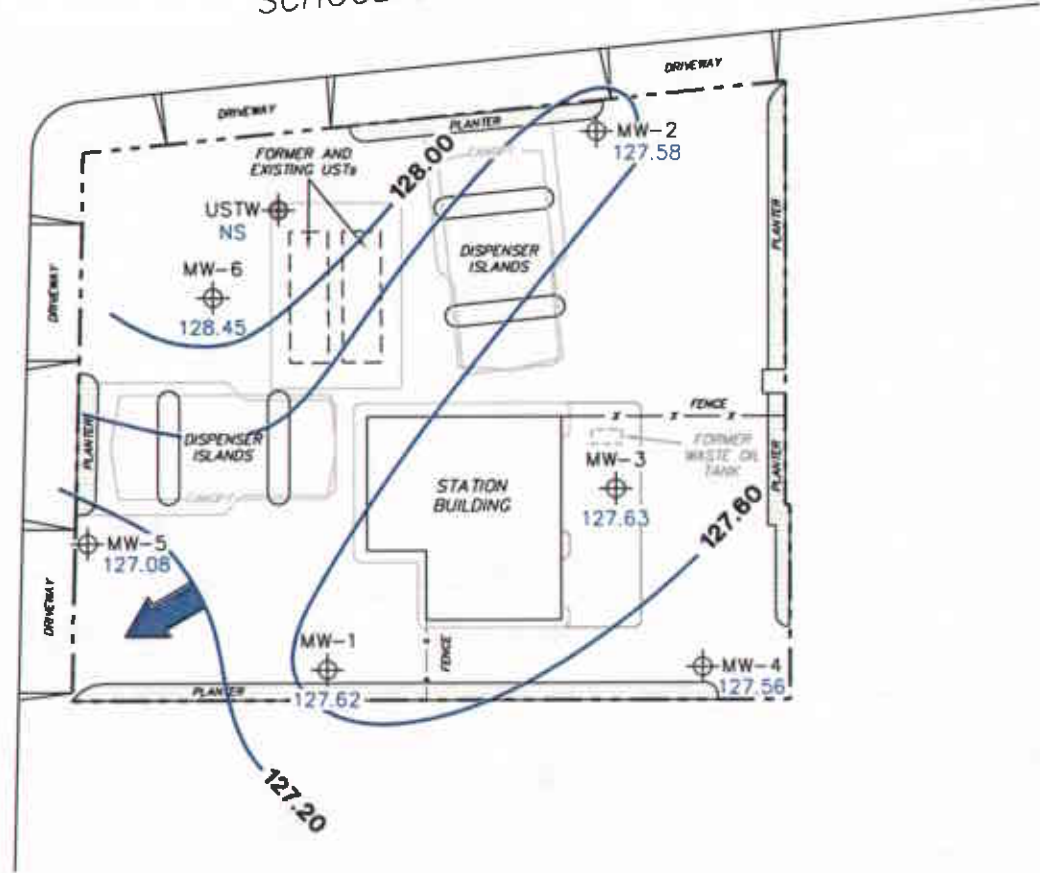

**NOTES:**

Contour lines are interpretive and based on fluid levels measured in monitoring wells. Elevations are in feet above mean sea level. NS = not surveyed. UST = underground storage tank.

**LEGEND**

MW-6 ⊕ Monitoring Well with Groundwater Elevation (feet)

USTW ⊕ UST Observation Well

128.00 — Groundwater Elevation Contour

➔ General Direction of Groundwater Flow

**GROUNDWATER ELEVATION  
CONTOUR MAP  
October 30, 2003**

76 Station 4625  
3070 Fruitvale Avenue  
Oakland, California

SCALE (FEET)



**FIGURE 2**

**TRC**

PS=1:1



SCHOOL STREET

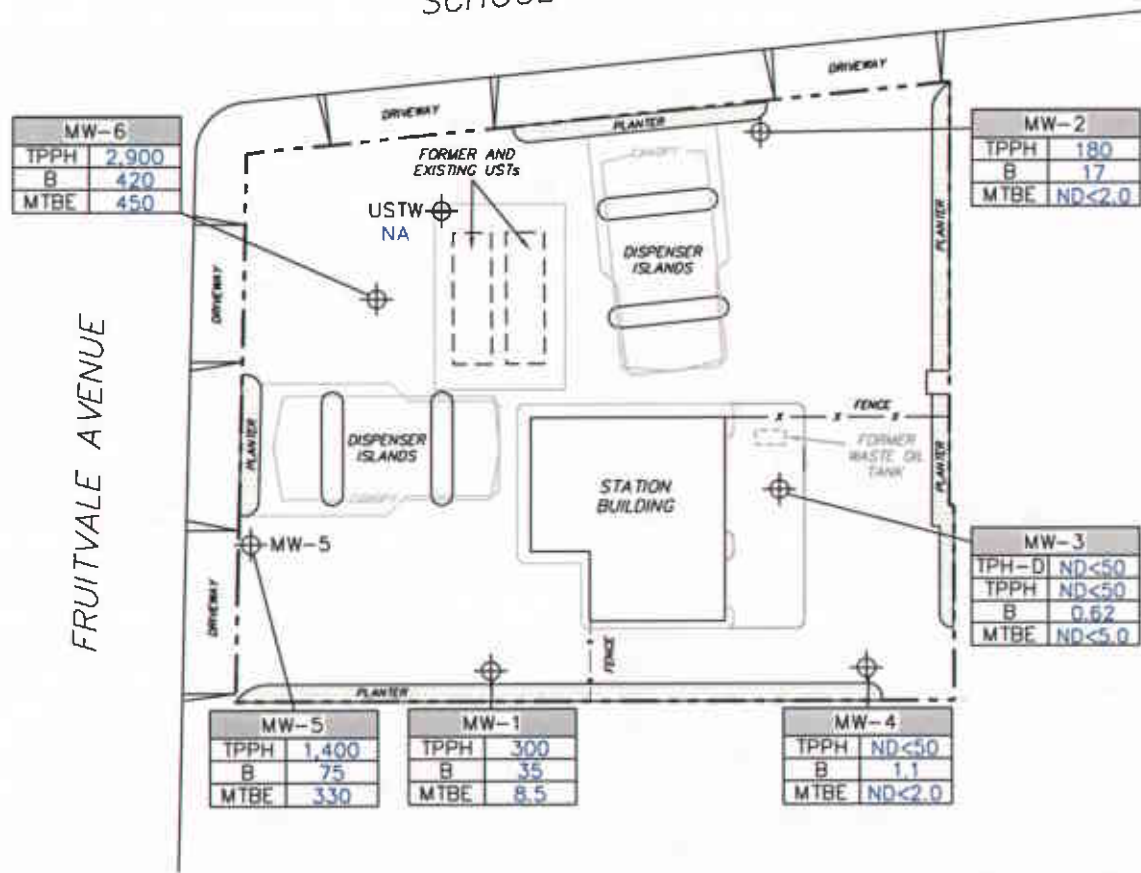

MW-6	
TPPH	2,900
B	420
MTBE	450

MW-2	
TPPH	180
B	17
MTBE	ND<2.0

MW-3	
TPH-D	ND<50
TPPH	ND<50
B	0.62
MTBE	ND<5.0

MW-5	
TPPH	1,400
B	75
MTBE	330

MW-1	
TPPH	300
B	35
MTBE	8.5

MW-4	
TPPH	ND<50
B	1.1
MTBE	ND<2.0

**NOTES:**

TPH-D = total petroleum hydrocarbons as diesel.  
 TPPH = total purgeable petroleum hydrocarbons.  
 B = benzene. MTBE = methyl tertiary butyl ether.  $\mu\text{g/l}$  = micrograms per liter. ND = not detected at limit indicated on official laboratory report. NA = not analyzed, measured, or collected. UST = underground storage tank.  
 TPH-D results obtained using EPA Method 8015.  
 TPPH, Benzene and MTBE results obtained using EPA Method 8260B.

**LEGEND**

Well No.	
TPH-D	$\mu\text{g/l}$
TPPH	$\mu\text{g/l}$
B	$\mu\text{g/l}$
MTBE	$\mu\text{g/l}$

⊕ Monitoring Well with Dissolved-Phase Hydrocarbon Concentrations ( $\mu\text{g/l}$ )

USTW ⊕ UST Observation Well

**DISSOLVED-PHASE HYDROCARBON CONCENTRATIONS MAP**  
 October 30, 2003

76 Station 4625  
 3070 Fruitvale Avenue  
 Oakland, California

SCALE (FEET)

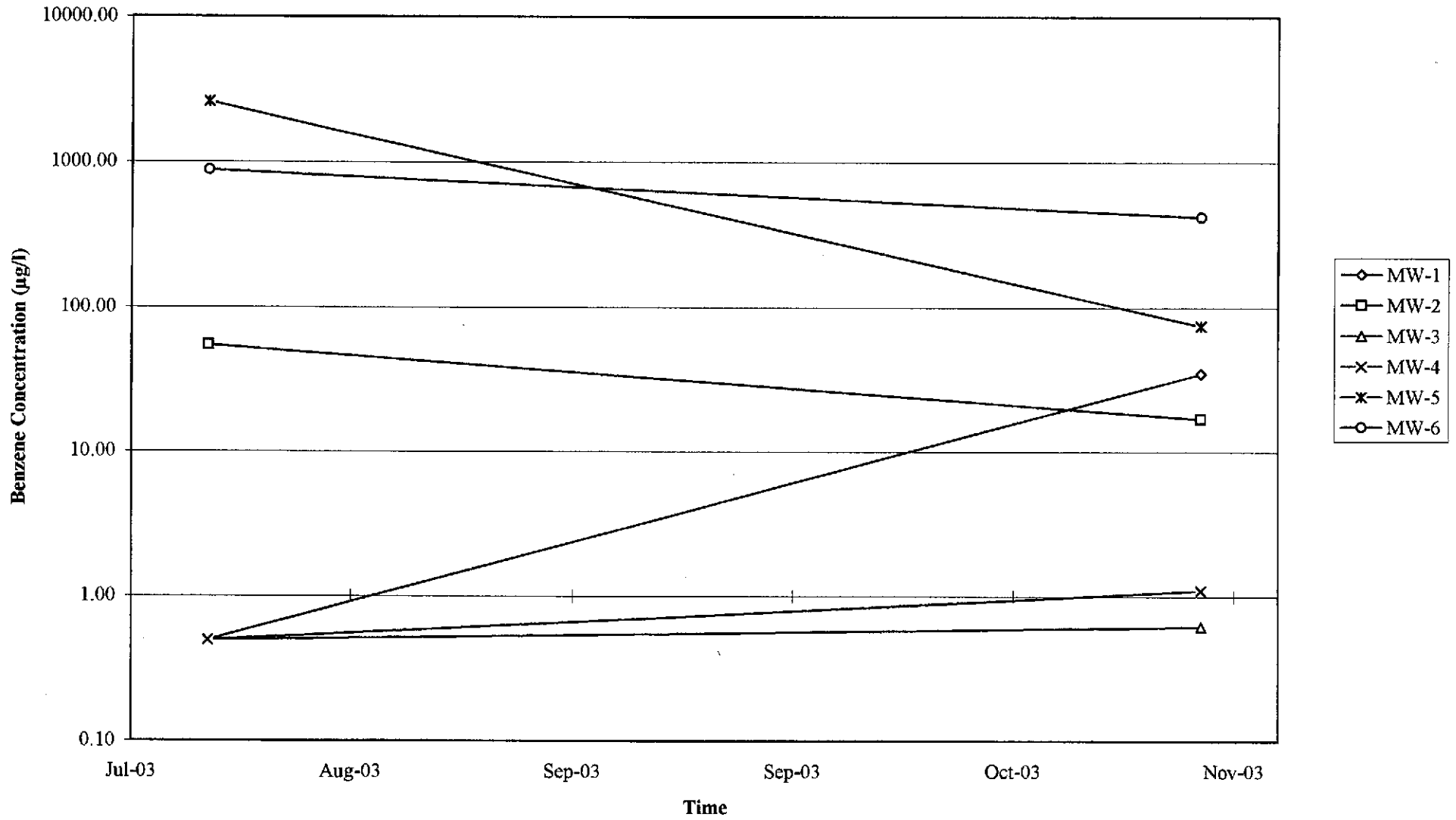

**FIGURE 3**

# GRAPHS



Graph 1  
Benzene Concentrations vs. Time  
76 Station 4625



Graph 2  
Benzene Concentrations vs. Time  
76 Station 4625

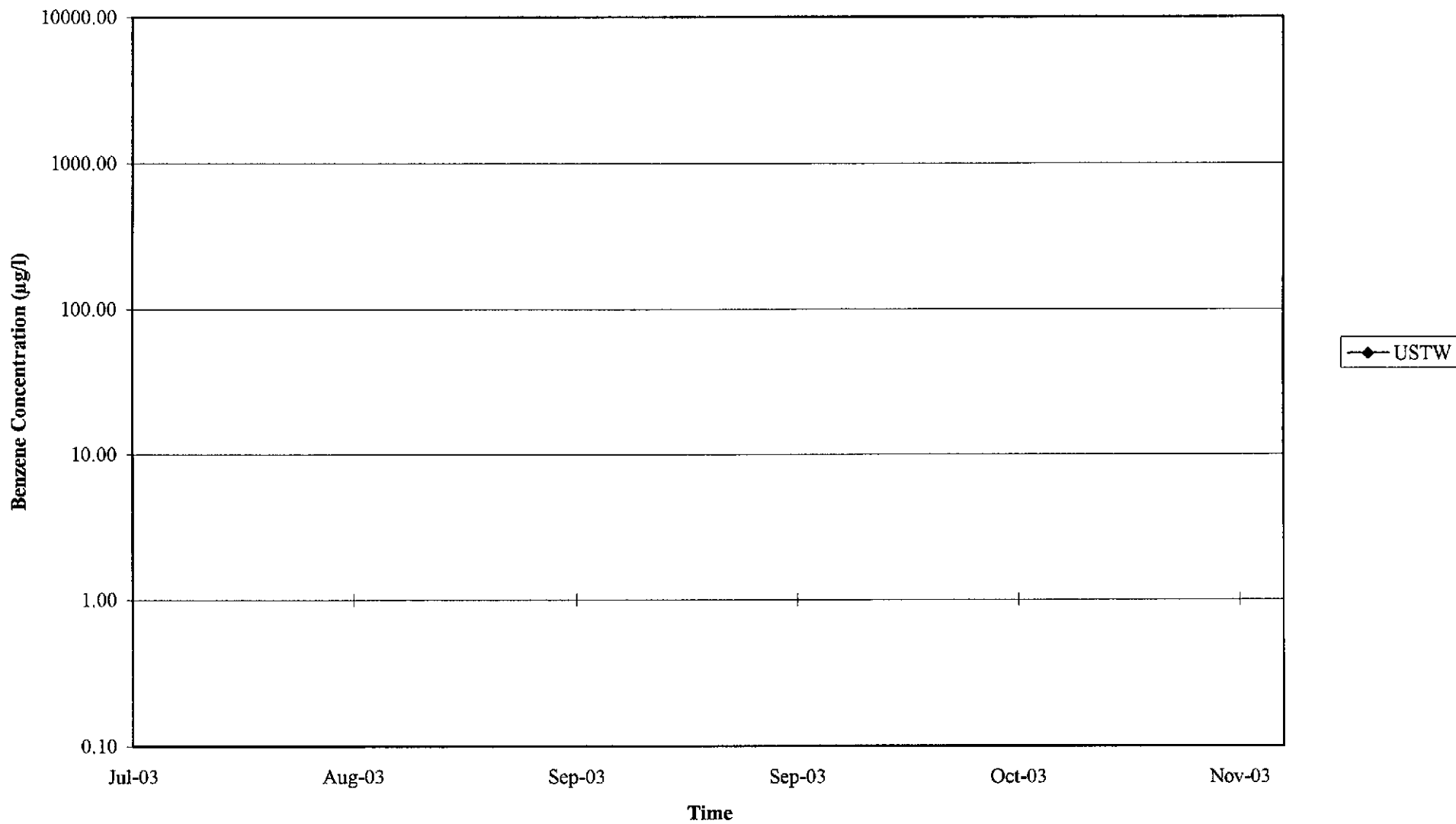

Graph 3  
Hydrograph  
76 Station 4625

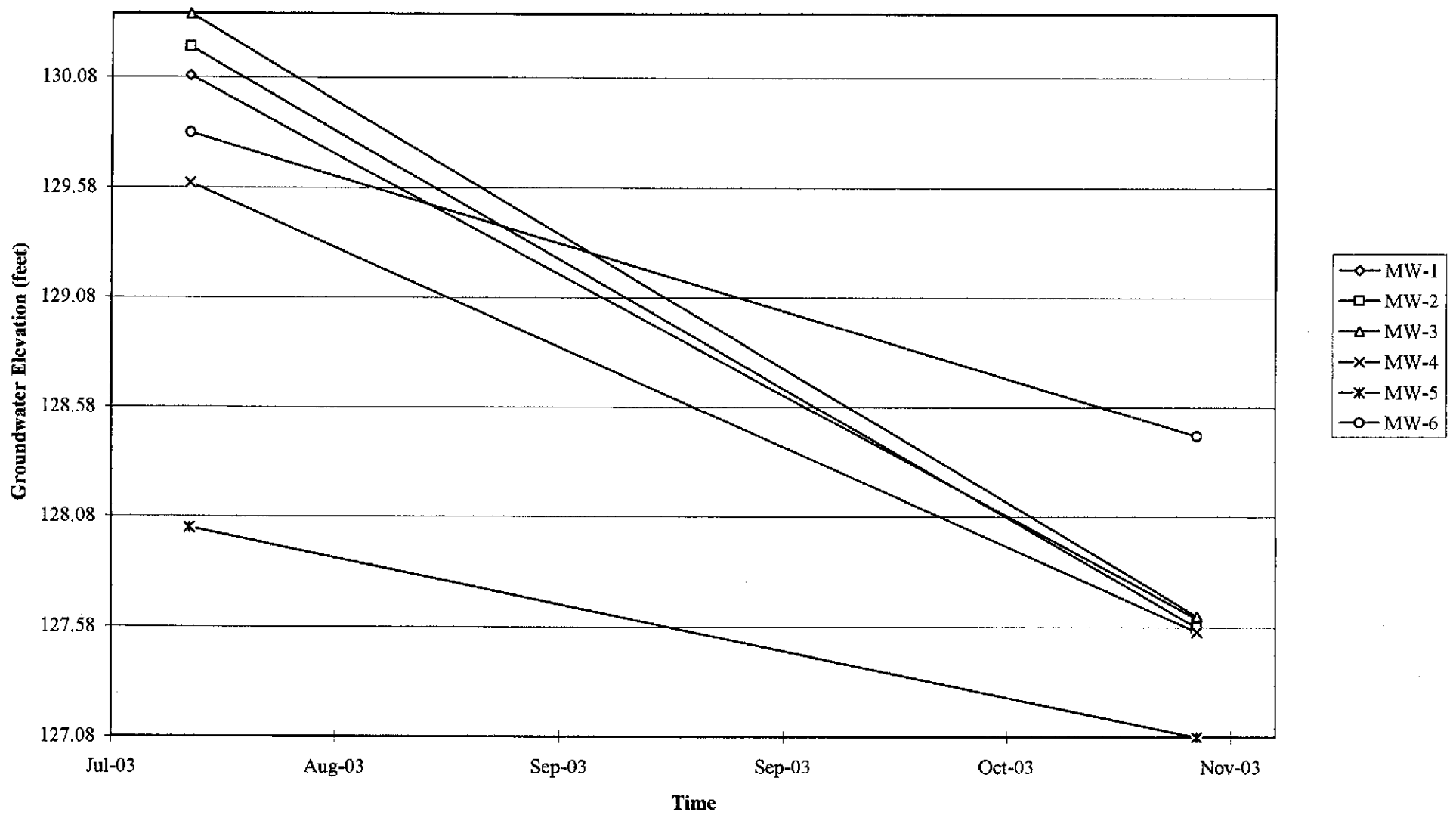

Graph 4  
Hydrograph  
76 Station 4625

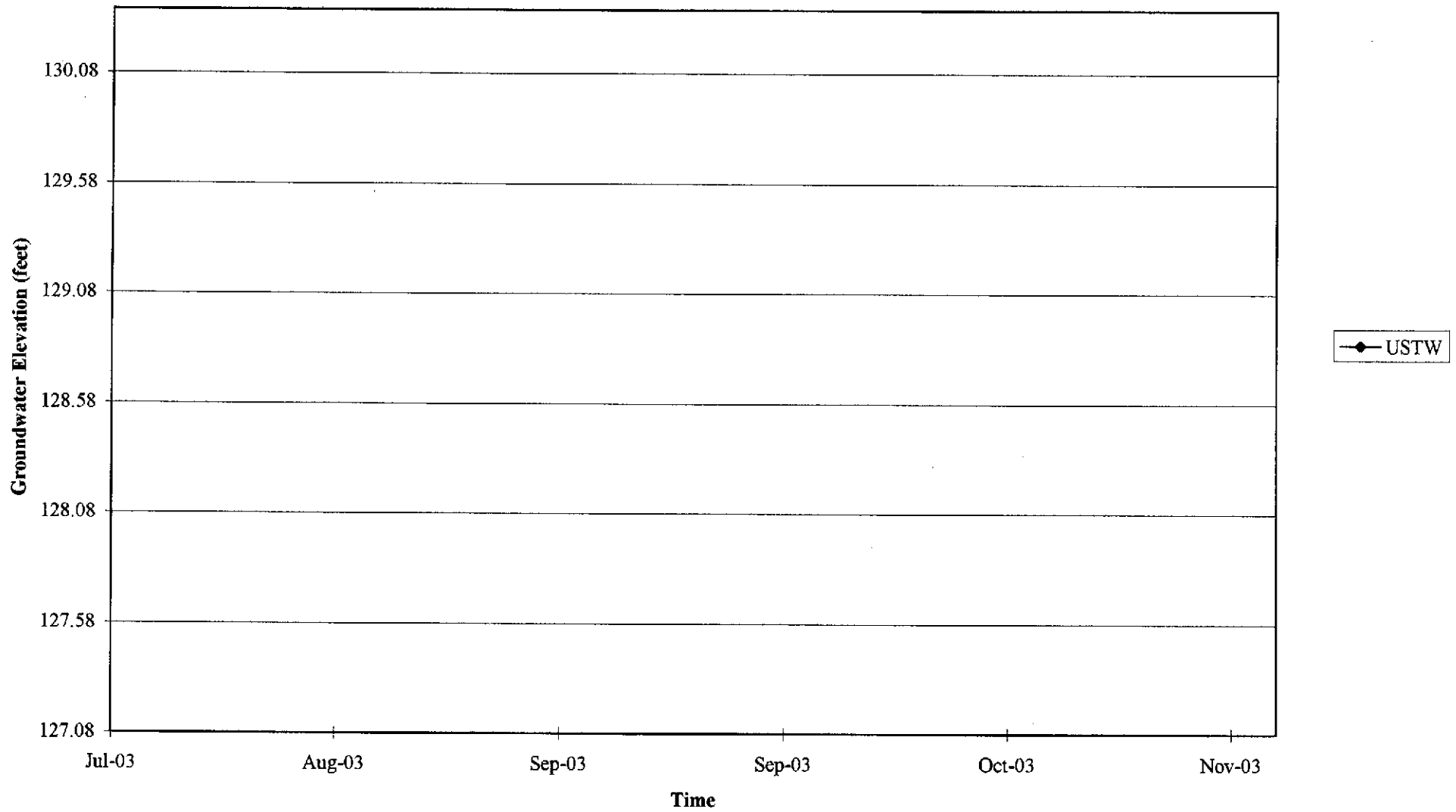

Graph 5  
Hydrograph  
76 Station 4625

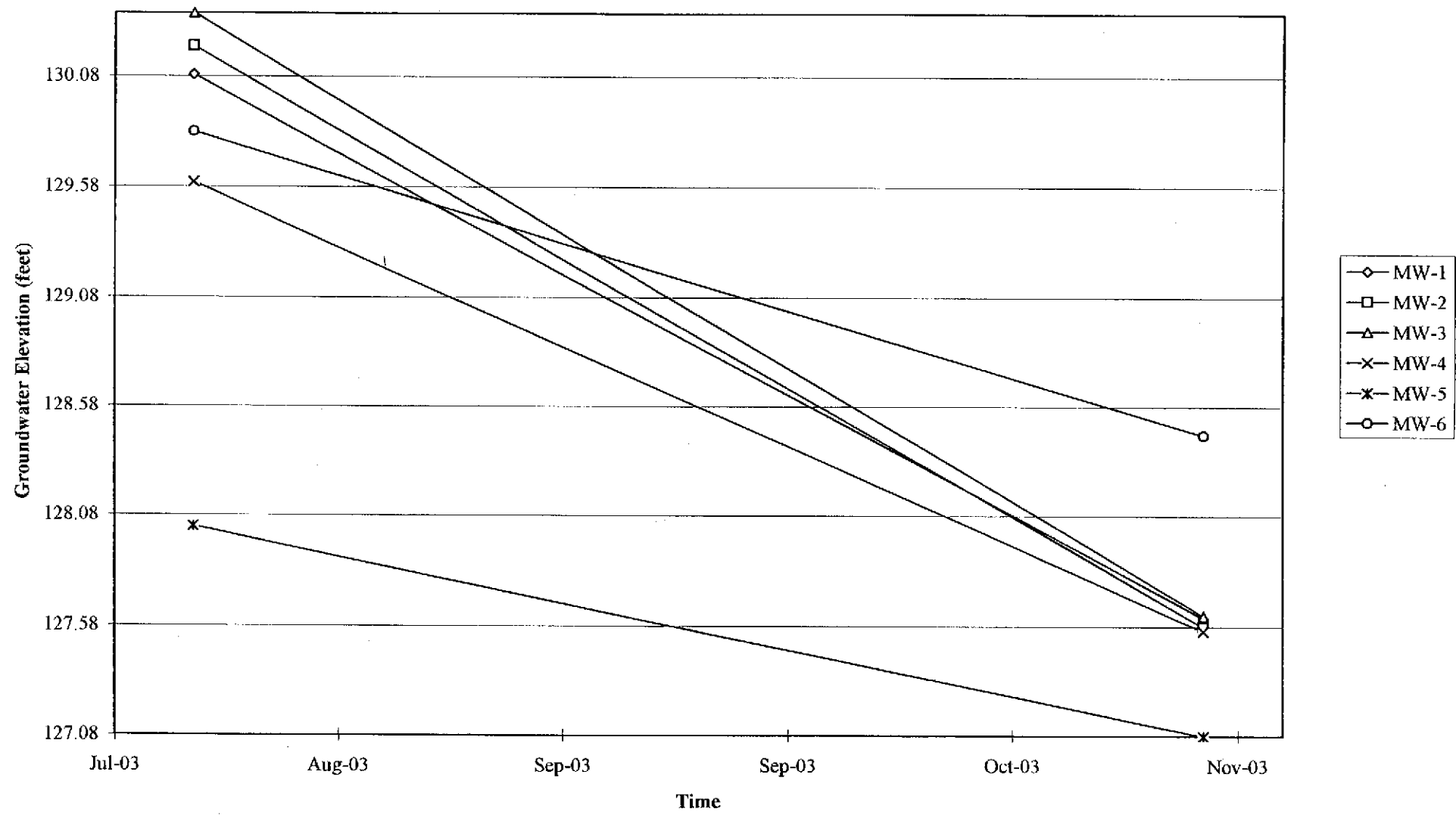

Graph 6  
Hydrograph  
76 Station 4625

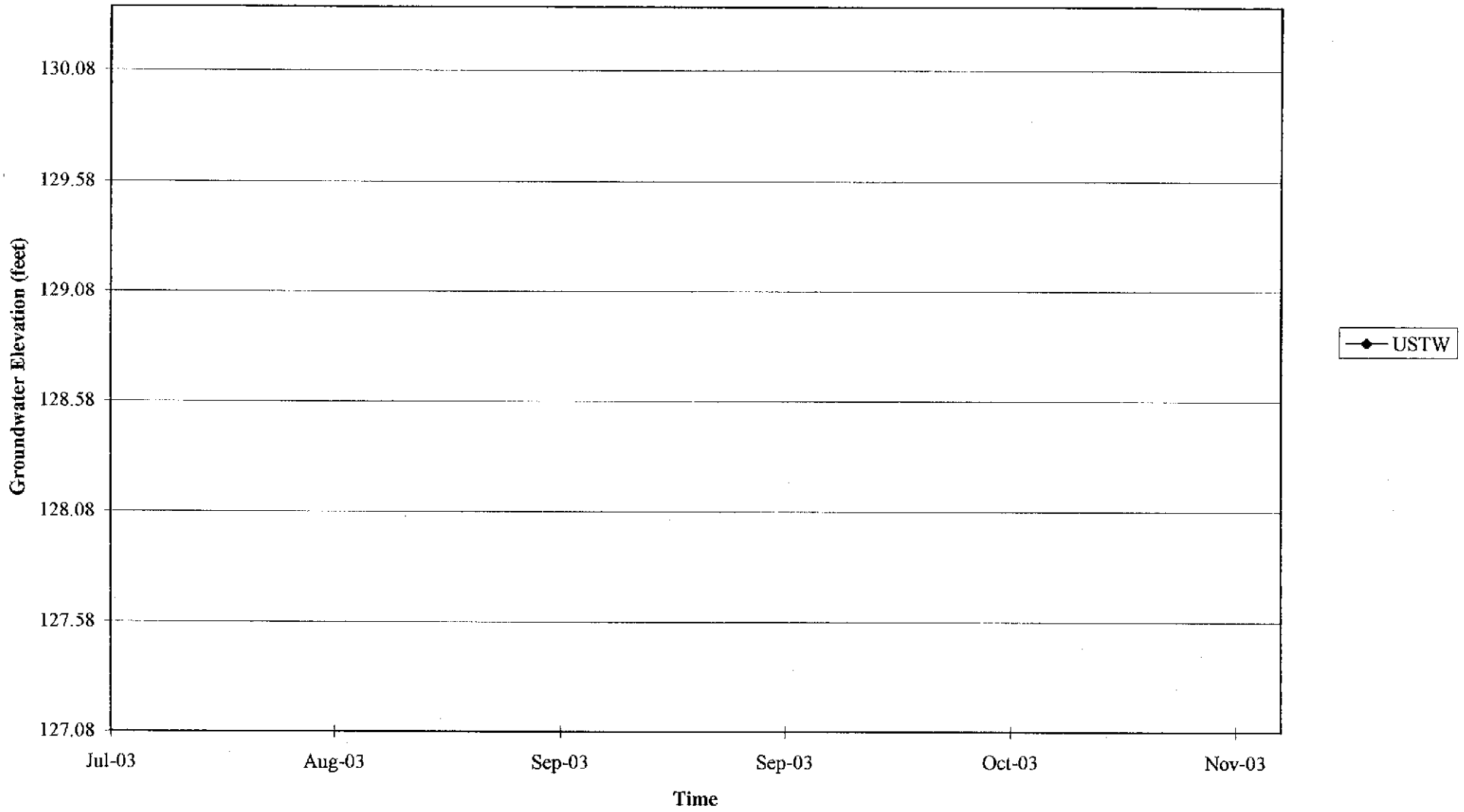

# FIELD MONITORING DATA SHEET



Technician: R. Cormier

Job #/Task #: 410500-01 FA20

Date: 10-30-03

Site # 4625

Project Manager Kathie Deskin

Page 1 of 1

Well #	Grade	TOC	Total Depth	Depth to Water	Depth to Product	Product Thickness (feet)	Time Sampled	Misc. Well Notes
MW-5		X	24.34	10.58	Ø	Ø	0807	2"
MW-6		X	23.33	10.43	Ø	Ø	0636	2"
MW-1		X	24.85	8.74	Ø	Ø	0859	2"
MW-2		X	24.73	11.06	Ø	Ø	0708	2"
MW-3		X	23.03	10.05	Ø	Ø	1131	2"
MW-4			24.20	9.04	Ø	Ø	1121	2"
USTW		X	15.14	10.44	Ø	Ø	N/A	6" monitor only

FIELD DATA COMPLETE      QA/QC      QOC      WELL BOX CONDITION SHEETS

WTT CERTIFICATE      MANIFEST      DRUM INVENTORY      TRAFFIC CONTROL

GROUNDWATER SAMPLING FIELD NOTES

Technician: R. Cormier  
 Site: 4625 Project No.: 410500-01 Date: 10-30-03

Well No.: MW-4 Purge Method: Dia  
 Depth to Water (feet): 9.04 Depth to Product (feet): 0  
 Total Depth (feet): 24.20 LPH & Water Recovered (gallons): 0  
 Water Column (feet): 15.16 Casing Diameter (Inches): 2"  
 80% Recharge Depth (feet): 12.07 1 Well Volume (gallons): 3

Time Start	Time Stop	Depth To Water (feet)	Volume Purged (gallons)	Conductivity (uS/cm)	Temperature (F, C)	pH	Turbidity	D.O.
0909			3	869	22.0	6.95		
			6	888	18.5	6.95		
	0916		9	879	18.2	6.96		
Static at Time Sampled		Total Gallons Purged			Time Sampled			
1776		9			1121			
Comments: <u>Well didnt recover within 2hr period</u>								

Well No.: MW-3 Purge Method: Dia  
 Depth to Water (feet): 10.05 Depth to Product (feet): 0  
 Total Depth (feet): 23.03 LPH & Water Recovered (gallons): 0  
 Water Column (feet): 12.98 Casing Diameter (Inches): 2"  
 80% Recharge Depth (feet): 12.64 1 Well Volume (gallons): 2

Time Start	Time Stop	Depth To Water (feet)	Volume Purged (gallons)	Conductivity (uS/cm)	Temperature (F, C)	pH	Turbidity	D.O.
0923			2	503	20.1	6.99		
			4	599	19.5	6.97		
	0928		6	430	21.0	6.98		
Static at Time Sampled		Total Gallons Purged			Time Sampled			
1003		6			1131			
Comments:								



GROUNDWATER SAMPLING FIELD NOTES

Site: 4625

Technician: R. Cormier

Project No.: 410 500-01

Date: 10-30-03

Well No.: MW-1

Purge Method: Via

Depth to Water (feet): 8.74

Depth to Product (feet): Ø

Total Depth (feet): 24.85

LPH & Water Recovered (gallons): Ø

Water Column (feet): 16.11

Casing Diameter (Inches): 2"

80% Recharge Depth (feet): 11.96

1 Well Volume (gallons): 3

Time Start	Time Stop	Depth To Water (feet)	Volume Purged (gallons)	Conductivity (uS/cm)	Temperature (F, C)	pH	Turbidity	D.O.
0642			3	855	16.6	7.01		
			6	880	17.1	7.00		
	0651		9	882	18.0	7.00		
Static at Time Sampled		Total Gallons Purged			Time Sampled			
1625		9			0859			
Comments: <u>Well didnt recover within 2hr period</u>								

Well No.: MW-2

Purge Method: Via

Depth to Water (feet): 11.06

Depth to Product (feet): Ø

Total Depth (feet): 24.73

LPH & Water Recovered (gallons): Ø

Water Column (feet): 13.67

Casing Diameter (Inches): 2"

80% Recharge Depth (feet): 13.79

1 Well Volume (gallons): 2

Time Start	Time Stop	Depth To Water (feet)	Volume Purged (gallons)	Conductivity (uS/cm)	Temperature (F, C)	pH	Turbidity	D.O.
0657			2	394	15.6	7.03		
			4	369	19.1	6.99		
	0703		6	362	20.1	6.99		
Static at Time Sampled		Total Gallons Purged			Time Sampled			
1125		6			0708			
Comments:								

GROUNDWATER SAMPLING FIELD NOTES

Technician: R Cormier

Site: 4625

Project No.: 410500-01

Date: 10-30-03

Well No.: MW-5

Purge Method: Dia

Depth to Water (feet): 10.58

Depth to Product (feet): 0

Total Depth (feet): 24.34

LPH & Water Recovered (gallons): 0

Water Column (feet): 13.76

Casing Diameter (Inches): 2"

80% Recharge Depth (feet): 13.33

1 Well Volume (gallons): 2

Time Start	Time Stop	Depth To Water (feet)	Volume Purged (gallons)	Conductivity (uS/cm)	Temperature (F, C)	pH	Turbidity	D.O.
0607			2	823	17.5	7.01		
			4	605	18.0	7.00		
	0615		6	619	19.6	6.99		
Static at Time Sampled		Total Gallons Purged			Time Sampled			
10.70		6			0807			
Comments:								

Well No.: MW-6

Purge Method: Dia

Depth to Water (feet): 10.43

Depth to Product (feet): 0

Total Depth (feet): 23.33

LPH & Water Recovered (gallons): 0

Water Column (feet): 12.90

Casing Diameter (Inches): 2"

80% Recharge Depth (feet): 13.01

1 Well Volume (gallons): 2

Time Start	Time Stop	Depth To Water (feet)	Volume Purged (gallons)	Conductivity (uS/cm)	Temperature (F, C)	pH	Turbidity	D.O.
0621			2	763	16.3	7.01		
			4	716	18.9	6.99		
	0629		6	488	19.7	6.99		
Static at Time Sampled		Total Gallons Purged			Time Sampled			
10.75		6			0636			
Comments:								



STL

Submission#: 2003-11-0068

TRC Alton Geoscience

November 17, 2003

21 Technology Drive  
Irvine, CA 92718

Attn.: Anju Farfan

Project#: 41050001/FA20

Project: Conoco Phillips #4625

Site: 3070 Fruitvale Ave., Oakland CA

Attached is our report for your samples received on 10/31/2003 16:20

This report has been reviewed and approved for release. Reproduction of this report is permitted only in its entirety.

Please note that any unused portion of the samples will be discarded after 12/15/2003 unless you have requested otherwise.

We appreciate the opportunity to be of service to you. If you have any questions,

You can also contact me via email. My email address is: [dsharma@stl-inc.com](mailto:dsharma@stl-inc.com)

Sincerely,

Dimple Sharma  
Project Manager

Severn Trent Laboratories, Inc.

STL San Francisco \* 1220 Quarry Lane, Pleasanton, CA 94566

Tel 925 484 1919 Fax 925 484 1096 \* [www.stl-inc.com](http://www.stl-inc.com) \* CA DHS ELAP# 2496



STL

Submission #: 2003-11-0068

Oil & Grease (Total) by EPA 1664

TRC Alton Geoscience

Attn.: Anju Farfan

21 Technology Drive

Irvine, CA 92718

Phone: (949) 341-7440 Fax: (949) 753-0111

Project: 41050001/FA20

Conoco Phillips #4625

Received: 10/31/2003 16:20

Site: 3070 Fruitvale Ave., Oakland CA

Samples Reported

Sample Name	Date Sampled	Matrix	Lab #
MW-3	10/30/2003 11:31	Water	5

Severn Trent Laboratories, Inc.

STL San Francisco \* 1220 Quarry Lane, Pleasanton, CA 94566

Tel 925 484 1919 Fax 925 484 1096 \* www.stl-inc.com \* CA DHS ELAP# 2496

11/10/2003 10:38

**Oil & Grease (Total) by EPA 1664**

TRC Alton Geoscience

Attn.: Anju Farfan

21 Technology Drive

Irvine, CA 92718

Phone: (949) 341-7440 Fax: (949) 753-0111

Project: 41050001/FA20

Conoco Phillips #4625

Received: 10/31/2003 16:20

Site: 3070 Fruitvale Ave., Oakland CA

Prep(s):	1664	Test(s):	1664
Sample ID:	MW-3	Lab ID:	2003-11-0068 - 5
Sampled:	10/30/2003 11:31	Extracted:	11/4/2003 00:00
Matrix:	Water	QC Batch#:	2003/11/04-01.23

Compound	Conc.	RL	Unit	Dilution	Analyzed	Flag
Oil & Grease (total)	ND	1.0	mg/L	1.00	11/06/2003	

**Oil & Grease (Total) by EPA 1664**

TRC Alton Geoscience

Attn.: Anju Farfan

21 Technology Drive

Irvine, CA 92718

Phone: (949) 341-7440 Fax: (949) 753-0111

Project: 41050001/FA20

Conoco Phillips #4625

Received: 10/31/2003 16:20

Site: 3070 Fruitvale Ave., Oakland CA

**Batch QC Report**

Prep(s): 1664

Test(s): 1664

Method Blank

Water

QC Batch # 2003/11/04-01:23

MB: 2003/11/04-01.23-001

Date Extracted: 11/04/2003

Compound	Conc.	RL	Unit	Analyzed	Flag
Oil & Grease (total)	ND	1	mg/L	11/05/2003	

**Oil & Grease (Total) by EPA 1664**

TRC Alton Geoscience

Attn.: Anju Farfan

21 Technology Drive

Irvine, CA 92718

Phone: (949) 341-7440 Fax: (949) 753-0111

Project: 41050001/FA20

Conoco Phillips #4625

Received: 10/31/2003 16:20

Site: 3070 Fruitvale Ave., Oakland CA

**Batch QC Report**

Prep(s): 1664

Test(s): 1664

**Laboratory Control Spike**

**Water**

**QC Batch # 2003/11/04-01.23**

LCS 2003/11/04-01.23-002

Extracted: 11/04/2003

Analyzed: 11/05/2003

LCSD 2003/11/04-01.23-003

Extracted: 11/04/2003

Analyzed: 11/05/2003

Compound	Conc. mg/L		Exp. Conc.	Recovery %		RPD	Ctrl. Limits %		Flags	
	LCS	LCSD		LCS	LCSD		%	Rec.	RPD	LCS
Oil & Grease (total)	37.6	36.9	40.0	94.0	92.3	1.8	79-114	18		

Severn Trent Laboratories, Inc.

STL San Francisco \* 1220 Quarry Lane, Pleasanton, CA 94566

Tel 925 484 1919 Fax 925 484 1096 \* www.stl-inc.com \* CA DHS ELAP# 2496

11/10/2003 10:38

**Volatile Organic Compounds by 8260B (Low Level)**

TRC Alton Geoscience

Attn.: Anju Farfan

21 Technology Drive

Irvine, CA 92718

Phone: (949) 341-7440 Fax: (949) 753-0111

Project: 41050001/FA20

Conoco Phillips #4625

Received: 10/31/2003 16:20

Site: 3070 Fruitvale Ave., Oakland CA

**Samples Reported**

Sample Name	Date Sampled	Matrix	Lab #
MW-3	10/30/2003 11:31	Water	5



Volatile Organic Compounds by 8260B (Low Level)

TRC Alton Geoscience

Attn.: Anju Farfan

21 Technology Drive

Irvine, CA 92718

Phone: (949) 341-7440 Fax: (949) 753-0111

Project: 41050001/FA20

Conoco Phillips #4625

Received: 10/31/2003 16:20

Site: 3070 Fruitvale Ave., Oakland CA

Prep(s): 5030B Test(s): 8260B  
 Sample ID: MW-3 Lab ID: 2003-11-0068 - 5  
 Sampled: 10/30/2003 11:31 Extracted: 11/12/2003 17:20  
 Matrix: Water QC Batch#: 2003/11/12-01.06

Compound	Conc.	RL	Unit	Dilution	Analyzed	Flag
MTBE	ND	5.0	ug/L	1.00	11/12/2003 17:20	
Acetone	ND	50	ug/L	1.00	11/12/2003 17:20	
Benzene	ND	0.50	ug/L	1.00	11/12/2003 17:20	
Bromodichloromethane	ND	0.50	ug/L	1.00	11/12/2003 17:20	
Bromobenzene	ND	1.0	ug/L	1.00	11/12/2003 17:20	
Bromochloromethane	ND	1.0	ug/L	1.00	11/12/2003 17:20	
Bromoform	ND	0.50	ug/L	1.00	11/12/2003 17:20	
Bromomethane	ND	1.0	ug/L	1.00	11/12/2003 17:20	
2-Butanone(MEK)	ND	50	ug/L	1.00	11/12/2003 17:20	
n-Butylbenzene	ND	1.0	ug/L	1.00	11/12/2003 17:20	
sec-Butylbenzene	ND	1.0	ug/L	1.00	11/12/2003 17:20	
tert-Butylbenzene	ND	1.0	ug/L	1.00	11/12/2003 17:20	
Carbon disulfide	ND	5.0	ug/L	1.00	11/12/2003 17:20	
Carbon tetrachloride	ND	0.50	ug/L	1.00	11/12/2003 17:20	
Chlorobenzene	ND	0.50	ug/L	1.00	11/12/2003 17:20	
Chloroethane	ND	1.0	ug/L	1.00	11/12/2003 17:20	
2-Chloroethylvinyl ether	ND	5.0	ug/L	1.00	11/12/2003 17:20	
Chloroform	ND	1.0	ug/L	1.00	11/12/2003 17:20	
Chloromethane	ND	1.0	ug/L	1.00	11/12/2003 17:20	
2-Chlorotoluene	ND	0.50	ug/L	1.00	11/12/2003 17:20	
4-Chlorotoluene	ND	0.50	ug/L	1.00	11/12/2003 17:20	
Dibromochloromethane	ND	0.50	ug/L	1.00	11/12/2003 17:20	
1,2-Dichlorobenzene	ND	0.50	ug/L	1.00	11/12/2003 17:20	
1,3-Dichlorobenzene	ND	0.50	ug/L	1.00	11/12/2003 17:20	
1,4-Dichlorobenzene	ND	0.50	ug/L	1.00	11/12/2003 17:20	
1,3-Dichloropropane	ND	1.0	ug/L	1.00	11/12/2003 17:20	
2,2-Dichloropropane	ND	0.50	ug/L	1.00	11/12/2003 17:20	
1,1-Dichloropropene	ND	0.50	ug/L	1.00	11/12/2003 17:20	
1,2-Dibromo-3-chloropropane	ND	1.0	ug/L	1.00	11/12/2003 17:20	

Severn Trent Laboratories, Inc.

STL San Francisco \* 1220 Quarry Lane, Pleasanton, CA 94566

Tel 925 484 1919 Fax 925 484 1096 \* www.stl-inc.com \* CA DHS ELAP# 2496

11/13/2003 17:18

Volatile Organic Compounds by 8260B (Low Level)

TRC Alton Geoscience

Attn.: Anju Farfan

21 Technology Drive

Irvine, CA 92718

Phone: (949) 341-7440 Fax: (949) 753-0111

Project: 41050001/FA20

Conoco Phillips #4625

Received: 10/31/2003 16:20

Site: 3070 Fruitvale Ave., Oakland CA

Prep(s): 5030B Test(s): 8260B  
 Sample ID: MW-3 Lab ID: 2003-11-0068 - 5  
 Sampled: 10/30/2003 11:31 Extracted: 11/12/2003 17:20  
 Matrix: Water QC Batch#: 2003/11/12-01.06

Compound	Conc.	RL	Unit	Dilution	Analyzed	Flag
1,2-Dibromoethane	ND	0.50	ug/L	1.00	11/12/2003 17:20	
Dibromomethane	ND	0.50	ug/L	1.00	11/12/2003 17:20	
Dichlorodifluoromethane	ND	0.50	ug/L	1.00	11/12/2003 17:20	
1,1-Dichloroethane	ND	0.50	ug/L	1.00	11/12/2003 17:20	
1,2-Dichloroethane	ND	0.50	ug/L	1.00	11/12/2003 17:20	
1,1-Dichloroethene	ND	0.50	ug/L	1.00	11/12/2003 17:20	
cis-1,2-Dichloroethene	ND	0.50	ug/L	1.00	11/12/2003 17:20	
trans-1,2-Dichloroethene	ND	0.50	ug/L	1.00	11/12/2003 17:20	
1,2-Dichloropropane	ND	0.50	ug/L	1.00	11/12/2003 17:20	
cis-1,3-Dichloropropene	ND	0.50	ug/L	1.00	11/12/2003 17:20	
trans-1,3-Dichloropropene	ND	0.50	ug/L	1.00	11/12/2003 17:20	
Ethylbenzene	ND	0.50	ug/L	1.00	11/12/2003 17:20	
Hexachlorobutadiene	ND	1.0	ug/L	1.00	11/12/2003 17:20	
2-Hexanone	ND	50	ug/L	1.00	11/12/2003 17:20	
Isopropylbenzene	ND	0.50	ug/L	1.00	11/12/2003 17:20	
p-Isopropyltoluene	ND	1.0	ug/L	1.00	11/12/2003 17:20	
Methylene chloride	ND	5.0	ug/L	1.00	11/12/2003 17:20	
4-Methyl-2-pentanone (MIBK)	ND	50	ug/L	1.00	11/12/2003 17:20	
Naphthalene	ND	1.0	ug/L	1.00	11/12/2003 17:20	
n-Propylbenzene	ND	1.0	ug/L	1.00	11/12/2003 17:20	
Styrene	ND	0.50	ug/L	1.00	11/12/2003 17:20	
1,1,1,2-Tetrachloroethane	ND	0.50	ug/L	1.00	11/12/2003 17:20	
1,1,2,2-Tetrachloroethane	ND	0.50	ug/L	1.00	11/12/2003 17:20	
Tetrachloroethene	ND	0.50	ug/L	1.00	11/12/2003 17:20	
Toluene	0.50	0.50	ug/L	1.00	11/12/2003 17:20	
1,2,3-Trichlorobenzene	ND	1.0	ug/L	1.00	11/12/2003 17:20	
1,2,4-Trichlorobenzene	ND	1.0	ug/L	1.00	11/12/2003 17:20	
1,1,1-Trichloroethane	ND	0.50	ug/L	1.00	11/12/2003 17:20	
1,1,2-Trichloroethane	ND	0.50	ug/L	1.00	11/12/2003 17:20	

Severn Trent Laboratories, Inc.

STL San Francisco \* 1220 Quarry Lane, Pleasanton, CA 94566

Tel 925 484 1919 Fax 925 484 1096 \* www.stl-inc.com \* CA DHS ELAP# 2496

11/13/2003 17:18

Volatile Organic Compounds by 8260B (Low Level)

TRC Alton Geoscience

Attn.: Anju Farfan

21 Technology Drive

Irvine, CA 92718

Phone: (949) 341-7440 Fax: (949) 753-0111

Project: 41050001/FA20

Conoco Phillips #4625

Received: 10/31/2003 16:20

Site: 3070 Fruitvale Ave., Oakland CA

Prep(s): 5030B Test(s): 8260B  
 Sample ID: MW-3 Lab ID: 2003-11-0068 - 5  
 Sampled: 10/30/2003 11:31 Extracted: 11/12/2003 17:20  
 Matrix: Water QC Batch#: 2003/11/12-01.06

Compound	Conc.	RL	Unit	Dilution	Analyzed	Flag
Trichloroethene	ND	0.50	ug/L	1.00	11/12/2003 17:20	
Trichlorofluoromethane	ND	1.0	ug/L	1.00	11/12/2003 17:20	
Trichlorotrifluoroethane	ND	0.50	ug/L	1.00	11/12/2003 17:20	
1,2,4-Trimethylbenzene	ND	0.50	ug/L	1.00	11/12/2003 17:20	
1,3,5-Trimethylbenzene	ND	0.50	ug/L	1.00	11/12/2003 17:20	
Vinyl acetate	ND	25	ug/L	1.00	11/12/2003 17:20	
Vinyl chloride	ND	0.50	ug/L	1.00	11/12/2003 17:20	
Total xylenes	ND	1.0	ug/L	1.00	11/12/2003 17:20	
<b>Surrogate(s)</b>						
4-Bromofluorobenzene	107.8	86	%	1.00	11/12/2003 17:20	
1,2-Dichloroethane-d4	116.3	76	%	1.00	11/12/2003 17:20	sh
Toluene-d8	108.8	88	%	1.00	11/12/2003 17:20	

**Volatile Organic Compounds by 8260B (Low Level)**

TRC Alton Geoscience

Attn.: Anju Farfan

21 Technology Drive

Irvine, CA 92718

Phone: (949) 341-7440 Fax: (949) 753-0111

Project: 41050001/FA20

Conoco Phillips #4625

Received: 10/31/2003 16:20

Site: 3070 Fruitvale Ave., Oakland CA

**Batch QC Report**

Prep(s): 5030B

Test(s): 8260B

Method Blank

Water

QC Batch # 2003/11/12-01.06

MB: 2003/11/12-01.06-005

Date Extracted: 11/12/2003 13:40

Compound	Conc.	RL	Unit	Analyzed	Flag
MTBE	ND	5.0	ug/L	11/12/2003 13:40	
Acetone	ND	50	ug/L	11/12/2003 13:40	
Benzene	ND	0.5	ug/L	11/12/2003 13:40	
Bromodichloromethane	ND	0.5	ug/L	11/12/2003 13:40	
Bromobenzene	ND	1.0	ug/L	11/12/2003 13:40	
Bromochloromethane	ND	1.0	ug/L	11/12/2003 13:40	
Bromoform	ND	0.5	ug/L	11/12/2003 13:40	
Bromomethane	ND	1.0	ug/L	11/12/2003 13:40	
2-Butanone(MEK)	ND	50	ug/L	11/12/2003 13:40	
n-Butylbenzene	ND	1.0	ug/L	11/12/2003 13:40	
sec-Butylbenzene	ND	1.0	ug/L	11/12/2003 13:40	
tert-Butylbenzene	ND	1.0	ug/L	11/12/2003 13:40	
Carbon disulfide	ND	5.0	ug/L	11/12/2003 13:40	
Carbon tetrachloride	ND	0.5	ug/L	11/12/2003 13:40	
Chlorobenzene	ND	0.5	ug/L	11/12/2003 13:40	
Chloroethane	ND	1.0	ug/L	11/12/2003 13:40	
2-Chloroethylvinyl ether	ND	5.0	ug/L	11/12/2003 13:40	
Chloroform	ND	1.0	ug/L	11/12/2003 13:40	
Chloromethane	ND	1.0	ug/L	11/12/2003 13:40	
2-Chlorotoluene	ND	0.5	ug/L	11/12/2003 13:40	
4-Chlorotoluene	ND	0.5	ug/L	11/12/2003 13:40	
Dibromochloromethane	ND	0.5	ug/L	11/12/2003 13:40	
1,2-Dichlorobenzene	ND	0.5	ug/L	11/12/2003 13:40	
1,3-Dichlorobenzene	ND	0.5	ug/L	11/12/2003 13:40	
1,4-Dichlorobenzene	ND	0.5	ug/L	11/12/2003 13:40	
1,3-Dichloropropane	ND	1.0	ug/L	11/12/2003 13:40	
2,2-Dichloropropane	ND	0.5	ug/L	11/12/2003 13:40	
1,1-Dichloropropene	ND	0.5	ug/L	11/12/2003 13:40	
1,2-Dibromo-3-chloropropane	ND	1.0	ug/L	11/12/2003 13:40	

Severn Trent Laboratories, Inc.

11/13/2003 17:18

STL San Francisco \* 1220 Quarry Lane, Pleasanton, CA 94566

**Volatile Organic Compounds by 8260B (Low Level)**

TRC Alton Geoscience

Attn.: Anju Farfan

21 Technology Drive

Irvine, CA 92718

Phone: (949) 341-7440 Fax: (949) 753-0111

Project: 41050001/FA20

Conoco Phillips #4625

Received: 10/31/2003 16:20

Site: 3070 Fruitvale Ave., Oakland CA

**Batch QC Report**

Prep(s): 5030B

Test(s): 8260B

Method Blank

Water

QC Batch # 2003/11/12-01:06

MB: 2003/11/12-01:06-005

Date Extracted: 11/12/2003 13:40

Compound	Conc.	RL	Unit	Analyzed	Flag
1,2-Dibromoethane	ND	0.5	ug/L	11/12/2003 13:40	
Dibromomethane	ND	0.5	ug/L	11/12/2003 13:40	
Dichlorodifluoromethane	ND	0.5	ug/L	11/12/2003 13:40	
1,1-Dichloroethane	ND	0.5	ug/L	11/12/2003 13:40	
1,2-Dichloroethane	ND	0.5	ug/L	11/12/2003 13:40	
1,1-Dichloroethene	ND	0.5	ug/L	11/12/2003 13:40	
cis-1,2-Dichloroethene	ND	0.5	ug/L	11/12/2003 13:40	
trans-1,2-Dichloroethene	ND	0.5	ug/L	11/12/2003 13:40	
1,2-Dichloropropane	ND	0.5	ug/L	11/12/2003 13:40	
cis-1,3-Dichloropropene	ND	0.5	ug/L	11/12/2003 13:40	
trans-1,3-Dichloropropene	ND	0.5	ug/L	11/12/2003 13:40	
Ethylbenzene	ND	0.5	ug/L	11/12/2003 13:40	
Hexachlorobutadiene	ND	1.0	ug/L	11/12/2003 13:40	
2-Hexanone	ND	50	ug/L	11/12/2003 13:40	
Isopropylbenzene	ND	0.5	ug/L	11/12/2003 13:40	
p-Isopropyltoluene	ND	1.0	ug/L	11/12/2003 13:40	
Methylene chloride	ND	5.0	ug/L	11/12/2003 13:40	
4-Methyl-2-pentanone (MIBK)	ND	50	ug/L	11/12/2003 13:40	
Naphthalene	ND	1.0	ug/L	11/12/2003 13:40	
n-Propylbenzene	ND	1.0	ug/L	11/12/2003 13:40	
Styrene	ND	0.5	ug/L	11/12/2003 13:40	
1,1,1,2-Tetrachloroethane	ND	0.5	ug/L	11/12/2003 13:40	
1,1,2,2-Tetrachloroethane	ND	0.5	ug/L	11/12/2003 13:40	
Tetrachloroethene	ND	0.5	ug/L	11/12/2003 13:40	
Toluene	ND	0.5	ug/L	11/12/2003 13:40	
1,2,3-Trichlorobenzene	ND	1.0	ug/L	11/12/2003 13:40	
1,2,4-Trichlorobenzene	ND	1.0	ug/L	11/12/2003 13:40	
1,1,1-Trichloroethane	ND	0.5	ug/L	11/12/2003 13:40	
1,1,2-Trichloroethane	ND	0.5	ug/L	11/12/2003 13:40	

Severn Trent Laboratories, Inc.

11/13/2003 17:18

STL San Francisco \* 1220 Quarry Lane, Pleasanton, CA 94566

Volatile Organic Compounds by 8260B (Low Level)

TRC Alton Geoscience

Attn.: Anju Farfan

21 Technology Drive

Irvine, CA 92718

Phone: (949) 341-7440 Fax: (949) 753-0111

Project: 41050001/FA20

Conoco Phillips #4625

Received: 10/31/2003 16:20

Site: 3070 Fruitvale Ave., Oakland CA

Batch QC Report

Prep(s): 5030B

Test(s): 8260B

Method Blank

Water

QC Batch # 2003/11/12-01.06

MB: 2003/11/12-01.06-005

Date Extracted: 11/12/2003 13:40

Compound	Conc.	RL	Unit	Analyzed	Flag
Trichloroethene	ND	0.5	ug/L	11/12/2003 13:40	
Trichlorofluoromethane	ND	1.0	ug/L	11/12/2003 13:40	
Trichlorotrifluoroethane	ND	0.5	ug/L	11/12/2003 13:40	
1,2,4-Trimethylbenzene	ND	0.5	ug/L	11/12/2003 13:40	
1,3,5-Trimethylbenzene	ND	0.5	ug/L	11/12/2003 13:40	
Vinyl acetate	ND	25	ug/L	11/12/2003 13:40	
Vinyl chloride	ND	0.5	ug/L	11/12/2003 13:40	
Total xylenes	ND	1.0	ug/L	11/12/2003 13:40	
<b>Surrogates(s)</b>					
4-Bromofluorobenzene	109.4	86-115	%	11/12/2003 13:40	
1,2-Dichloroethane-d4	111.5	76-114	%	11/12/2003 13:40	
Toluene-d8	107.1	88-110	%	11/12/2003 13:40	

Volatile Organic Compounds by 8260B (Low Level)

TRC Alton Geoscience

Attn.: Anju Farfan

21 Technology Drive

Irvine, CA 92718

Phone: (949) 341-7440 Fax: (949) 753-0111

Project: 41050001/FA20

Conoco Phillips #4625

Received: 10/31/2003 16:20

Site: 3070 Fruitvale Ave., Oakland CA

Batch QC Report

Prep(s): 5030B

Test(s): 8260B

Laboratory Control Spike

Water

QC Batch # 2003/11/12-01.06

LCS 2003/11/12-01.06-003

Extracted: 11/12/2003

Analyzed: 11/12/2003 12:27

LCSD 2003/11/12-01.06-004

Extracted: 11/12/2003

Analyzed: 11/12/2003 13:04

Compound	Conc. ug/L		Exp.Conc.	Recovery %		RPD	Ctrl.Limits %		Flags	
	LCS	LCSD		LCS	LCSD		%	Rec.	RPD	LCS
Benzene	16.3	18.1	20.0	81.5	90.5	10.5	69-129	20		
Chlorobenzene	18.5	20.3	20.0	92.5	101.5	9.3	61-121	20		
1,1-Dichloroethene	16.9	18.5	20.0	84.5	92.5	9.0	65-125	20		
Toluene	16.3	17.8	20.0	81.5	89.0	8.8	70-130	20		
Trichloroethene	15.6	17.1	20.0	78.0	85.5	9.2	74-134	20		
<b>Surrogates(s)</b>										
4-Bromofluorobenzene	543	538	500	108.6	107.6		86-115			
1,2-Dichloroethane-d4	521	557	500	104.2	111.4		76-114			
Toluene-d8	528	531	500	105.6	106.2		88-110			

Volatile Organic Compounds by 8260B (Low Level)

TRC Alton Geoscience

Attn.: Anju Farfan

21 Technology Drive

Irvine, CA 92718

Phone: (949) 341-7440 Fax: (949) 753-0111

Project: 41050001/FA20

Conoco Phillips #4625

Received: 10/31/2003 16:20

Site: 3070 Fruitvale Ave., Oakland CA

---

Legend and Notes

---

**Result Flag**

sh

Surrogate recovery was higher than QC limit due to matrix interference.





**STL**

Submission #: 2003-11-0068

**Diesel**

TRC Alton Geoscience

Attn.: Anju Farfan

21 Technology Drive

Irvine, CA 92718

Phone: (949) 341-7440 Fax: (949) 753-0111

Project: 41050001/FA20

Conoco Phillips #4625

Received: 10/31/2003 16:20

Site: 3070 Fruitvale Ave., Oakland CA

**Samples Reported**

Sample Name	Date Sampled	Matrix	Lab #
MW-3	10/30/2003 11:31	Water	5

Severn Trent Laboratories, Inc.

STL San Francisco \* 1220 Quarry Lane, Pleasanton, CA 94566

Tel 925 484 1919 Fax 925 484 1096 \* www.stl-inc.com \* CA DHS ELAP# 2496

11/13/2003 16:45

Diesel

TRC Alton Geoscience

Attn.: Anju Farfan

21 Technology Drive  
Irvine, CA 92718

Phone: (949) 341-7440 Fax: (949) 753-0111

Project: 41050001/FA20  
Conoco Phillips #4625

Received: 10/31/2003 16:20

Site: 3070 Fruitvale Ave., Oakland CA

Prep(s):	3511	Test(s):	8015M
Sample ID:	MW-3	Lab ID:	2003-11-0068 - 5
Sampled:	10/30/2003 11:31	Extracted:	11/7/2003 12:23
Matrix:	Water	QC Batch#:	2003/11/07-04:10

Compound	Conc.	RL	Unit	Dilution	Analyzed	Flag
Diesel	ND	50	ug/L	1.00	11/11/2003 15:33	
<i>Surrogate(s)</i>						
o-Terphenyl	120.0	50-150	%	1.00	11/11/2003 15:33	

Severn Trent Laboratories, inc.

STL San Francisco \* 1220 Quarry Lane, Pleasanton, CA 94566

Tel 925 484 1919 Fax 925 484 1096 \* www.stl-inc.com \* CA DHS ELAP# 2496

11/13/2003 16:45

Diesel

TRC Alton Geoscience

Attn.: Anju Farfan

21 Technology Drive

Irvine, CA 92718

Phone: (949) 341-7440 Fax: (949) 753-0111

Project: 41050001/FA20

Conoco Phillips #4625

Received: 10/31/2003 16:20

Site: 3070 Fruitvale Ave., Oakland CA

Batch QC Report

Prep(s): 3511

Method Blank

MB: 2003/11/07-04:10-002

Water

Test(s): 8015M

QC Batch # 2003/11/07-04:10

Date Extracted: 11/07/2003 12:23

Compound	Conc.	RL	Unit	Analyzed	Flag
Diesel	ND	50	ug/L	11/10/2003 12:55	
Surrogates(s) o-Terphenyl	140.0	50-150	%	11/10/2003 12:55	

Diesel

TRC Alton Geoscience

Attn.: Anju Farfan

21 Technology Drive

Irvine, CA 92718

Phone: (949) 341-7440 Fax: (949) 753-0111

Project: 41050001/FA20

Conoco Phillips #4625

Received: 10/31/2003 16:20

Site: 3070 Fruitvale Ave., Oakland CA

Batch QC Report

Prep(s): 3511

Test(s): 8015M

Laboratory Control Spike

Water

QC Batch # 2003/11/07-04.10

LCS 2003/11/07-04.10-003

Extracted: 11/07/2003

Analyzed: 11/10/2003.14:48

LCSD 2003/11/07-04.10-004

Extracted: 11/07/2003

Analyzed: 11/10/2003.15:15

Compound	Conc. ug/L		Exp.Conc.	Recovery %		RPD	Ctrl.Limits %		Flags	
	LCS	LCSD		LCS	LCSD		%	Rec.	RPD	LCS
Diesel	932	817	680	137.1	120.1	13.2	60-150	25		
Surrogates(s) o-Terphenyl	1.70	1.68	1.25	136.0	134.4		50-150	0		

Severn Trent Laboratories, Inc.

STL San Francisco \* 1220 Quarry Lane, Pleasanton, CA 94566

Tel 925 484 1919 Fax 925 484 1096 \* www.stf-inc.com \* CA DHS ELAP# 2496

11/13/2003 16:45



STL

Submission #: 2003-11-0068

Gas/BTEX Fuel Oxygenates by 8260B

TRC Alton Geoscience

Attn.: Anju Farfan

21 Technology Drive

Irvine, CA 92718

Phone: (949) 341-7440 Fax: (949) 753-0111

Project: 41050001/FA20

Conoco Phillips #4625

Received: 10/31/2003 16:20

Site: 3070 Fruitvale Ave., Oakland CA

Samples Reported

Sample Name	Date Sampled	Matrix	Lab #
MW-5	10/30/2003 08:07	Water	1
MW-6	10/30/2003 06:36	Water	2
MW-1	10/30/2003 08:59	Water	3
MW-2	10/30/2003 07:08	Water	4
MW-3	10/30/2003 11:31	Water	5
MW-4	10/30/2003 11:21	Water	6

Severn Trent Laboratories, Inc.

STL San Francisco \* 1220 Quarry Lane, Pleasanton, CA 94566

Tel 925 484 1919 Fax 925 484 1096 \* www.stl-inc.com \* CA DHS ELAP# 2496

11/14/2003 09:22

**Gas/BTEX Fuel Oxygenates by 8260B**

TRC Alton Geoscience

Attn.: Anju Farfan

21 Technology Drive

Irvine, CA 92718

Phone: (949) 341-7440 Fax: (949) 753-0111

Project: 41050001/FA20

Conoco Phillips #4625

Received: 10/31/2003 16:20

Site: 3070 Fruitvale Ave., Oakland CA

Prep(s): 5030B Test(s): 8260B  
 Sample ID: MW-5 Lab ID: 2003-11-0068 - 1  
 Sampled: 10/30/2003 08:07 Extracted: 11/7/2003 22:56  
 Matrix: Water QC Batch#: 2003/11/07-02.64  
 Analysis Flag: o ( See Legend and Note Section )

Compound	Conc.	RL	Unit	Dilution	Analyzed	Flag
Gasoline	1400	250	ug/L	5.00	11/07/2003 22:56	
Benzene	75	2.5	ug/L	5.00	11/07/2003 22:56	
Toluene	43	2.5	ug/L	5.00	11/07/2003 22:56	
Ethylbenzene	39	2.5	ug/L	5.00	11/07/2003 22:56	
Total xylenes	140	5.0	ug/L	5.00	11/07/2003 22:56	
tert-Butyl alcohol (TBA)	ND	500	ug/L	5.00	11/07/2003 22:56	
Methyl tert-butyl ether (MTBE)	330	10	ug/L	5.00	11/07/2003 22:56	
Di-isopropyl Ether (DIPE)	ND	10	ug/L	5.00	11/07/2003 22:56	
Ethyl tert-butyl ether (ETBE)	ND	10	ug/L	5.00	11/07/2003 22:56	
tert-Amyl methyl ether (TAME)	ND	10	ug/L	5.00	11/07/2003 22:56	
1,2-DCA	ND	10	ug/L	5.00	11/07/2003 22:56	
EDB	ND	10	ug/L	5.00	11/07/2003 22:56	
Ethanol	ND	2500	ug/L	5.00	11/07/2003 22:56	
<b>Surrogate(s)</b>						
1,2-Dichloroethane-d4	98.8	76	%	5.00	11/07/2003 22:56	
Toluene-d8	92.5	88	%	5.00	11/07/2003 22:56	

Gas/BTEX Fuel Oxygenates by 8260B

TRC Alton Geoscience

Attn.: Anju Farfan

21 Technology Drive

Irvine, CA 92718

Phone: (949) 341-7440 Fax: (949) 753-0111

Project: 41050001/FA20

Conoco Phillips #4625

Received: 10/31/2003 16:20

Site: 3070 Fruitvale Ave., Oakland CA

Prep(s): 5030B Test(s): 8260B  
 Sample ID: MW-6 Lab ID: 2003-11-0068 - 2  
 Sampled: 10/30/2003 06:36 Extracted: 11/7/2003 23:18  
 Matrix: Water QC Batch#: 2003/11/07-02.64  
 Analysis Flag: o ( See Legend and Note Section )

Compound	Conc.	RL	Unit	Dilution	Analyzed	Flag
Gasoline	2900	500	ug/L	10.00	11/07/2003 23:18	
Benzene	420	5.0	ug/L	10.00	11/07/2003 23:18	
Toluene	260	5.0	ug/L	10.00	11/07/2003 23:18	
Ethylbenzene	120	5.0	ug/L	10.00	11/07/2003 23:18	
Total xylenes	480	10	ug/L	10.00	11/07/2003 23:18	
tert-Butyl alcohol (TBA)	ND	1000	ug/L	10.00	11/07/2003 23:18	
Methyl tert-butyl ether (MTBE)	450	20	ug/L	10.00	11/07/2003 23:18	
Di-isopropyl Ether (DIPE)	ND	20	ug/L	10.00	11/07/2003 23:18	
Ethyl tert-butyl ether (ETBE)	ND	20	ug/L	10.00	11/07/2003 23:18	
tert-Amyl methyl ether (TAME)	ND	20	ug/L	10.00	11/07/2003 23:18	
1,2-DCA	ND	20	ug/L	10.00	11/07/2003 23:18	
EDB	ND	20	ug/L	10.00	11/07/2003 23:18	
Ethanol	ND	5000	ug/L	10.00	11/07/2003 23:18	
<b>Surrogate(s)</b>						
1,2-Dichloroethane-d4	100.9	76	%	10.00	11/07/2003 23:18	
Toluene-d8	94.9	88	%	10.00	11/07/2003 23:18	

Sewern Trent Laboratories, Inc.

STL San Francisco \* 1220 Quarry Lane, Pleasanton, CA 94566

Tel 925 484 1919 Fax 925 484 1096 \* www.stl-inc.com \* CA DHS ELAP# 2496

11/14/2003 09:22

Gas/BTEX Fuel Oxygenates by 8260B

TRC Alton Geoscience

Attn.: Anju Farfan

21 Technology Drive

Irvine, CA 92718

Phone: (949) 341-7440 Fax: (949) 753-0111

Project: 41050001/FA20

Conoco Phillips #4625

Received: 10/31/2003 16:20

Site: 3070 Fruitvale Ave., Oakland CA

Prep(s): 5030B Test(s): 8260B  
 Sample ID: MW-1 Lab ID: 2003-11-0068 - 3  
 Sampled: 10/30/2003 08:59 Extracted: 11/7/2003 23:40  
 Matrix: Water QC Batch#: 2003/11/07-02.64

Compound	Conc.	RL	Unit	Dilution	Analyzed	Flag
Gasoline	300	50	ug/L	1.00	11/07/2003 23:40	
Benzene	35	0.50	ug/L	1.00	11/07/2003 23:40	
Toluene	41	0.50	ug/L	1.00	11/07/2003 23:40	
Ethylbenzene	21	0.50	ug/L	1.00	11/07/2003 23:40	
Total xylenes	71	1.0	ug/L	1.00	11/07/2003 23:40	
tert-Butyl alcohol (TBA)	ND	100	ug/L	1.00	11/07/2003 23:40	
Methyl tert-butyl ether (MTBE)	8.5	2.0	ug/L	1.00	11/07/2003 23:40	
Di-isopropyl Ether (DIPE)	ND	2.0	ug/L	1.00	11/07/2003 23:40	
Ethyl tert-butyl ether (ETBE)	ND	2.0	ug/L	1.00	11/07/2003 23:40	
tert-Amyl methyl ether (TAME)	ND	2.0	ug/L	1.00	11/07/2003 23:40	
1,2-DCA	ND	2.0	ug/L	1.00	11/07/2003 23:40	
EDB	ND	2.0	ug/L	1.00	11/07/2003 23:40	
Ethanol	ND	500	ug/L	1.00	11/07/2003 23:40	
Ethanol	ND	500	ug/L	1.00	11/07/2003 23:40	
<b>Surrogate(s)</b>						
1,2-Dichloroethane-d4	96.3	76	%	1.00	11/07/2003 23:40	
Toluene-d8	97.9	88	%	1.00	11/07/2003 23:40	

Severn Trent Laboratories, Inc.

STL San Francisco \* 1220 Quarry Lane, Pleasanton, CA 94566

Tel 925 484 1919 Fax 925 484 1096 \* www.stl-inc.com \* CA DHS ELAP# 2496

11/14/2003 09:22



Gas/BTEX Fuel Oxygenates by 8260B

TRC Alton Geoscience

Attn.: Anju Farfan

21 Technology Drive

Irvine, CA 92718

Phone: (949) 341-7440 Fax: (949) 753-0111

Project: 41050001/FA20

Conoco Phillips #4625

Received: 10/31/2003 16:20

Site: 3070 Fruitvale Ave., Oakland CA

Prep(s):	5030B	Test(s):	8260B
Sample ID:	MW-2	Lab ID:	2003-11-0068 - 4
Sampled:	10/30/2003 07:08	Extracted:	11/8/2003 17:46
Matrix:	Water	QC Batch#:	2003/11/08-01.64

Compound	Conc.	RL	Unit	Dilution	Analyzed	Flag
Gasoline	180	50	ug/L	1.00	11/08/2003 17:46	
Benzene	17	0.50	ug/L	1.00	11/08/2003 17:46	
Toluene	4.8	0.50	ug/L	1.00	11/08/2003 17:46	
Ethylbenzene	6.1	0.50	ug/L	1.00	11/08/2003 17:46	
Total xylenes	13	1.0	ug/L	1.00	11/08/2003 17:46	
Methyl tert-butyl ether (MTBE)	ND	2.0	ug/L	1.00	11/08/2003 17:46	
Ethanol	ND	500	ug/L	1.00	11/08/2003 17:46	
<b>Surrogate(s)</b>						
1,2-Dichloroethane-d4	90.9	76	%	1.00	11/08/2003 17:46	
Toluene-d8	93.9	88	%	1.00	11/08/2003 17:46	

Gas/BTEX Fuel Oxygenates by 8260B

TRC Alton Geoscience

Attn.: Anju Farfan

21 Technology Drive

Irvine, CA 92718

Phone: (949) 341-7440 Fax: (949) 753-0111

Project: 41050001/FA20

Conoco Phillips #4625

Received: 10/31/2003 16:20

Site: 3070 Fruitvale Ave., Oakland CA

Prep(s):	5030B	Test(s):	8260B
Sample ID:	MW-3	Lab ID:	2003-11-0068 - 5
Sampled:	10/30/2003 11:31	Extracted:	11/8/2003 01:09
Matrix:	Water	QC Batch#:	2003/11/07-02.64

Compound	Conc.	RL	Unit	Dilution	Analyzed	Flag
Gasoline	ND	50	ug/L	1.00	11/08/2003 01:09	
Benzene	0.62	0.50	ug/L	1.00	11/08/2003 01:09	
Toluene	0.83	0.50	ug/L	1.00	11/08/2003 01:09	
Ethylbenzene	ND	0.50	ug/L	1.00	11/08/2003 01:09	
Total xylenes	1.6	1.0	ug/L	1.00	11/08/2003 01:09	
Methyl tert-butyl ether (MTBE)	ND	2.0	ug/L	1.00	11/08/2003 01:09	
Ethanol	ND	500	ug/L	1.00	11/08/2003 01:09	
<b>Surrogate(s)</b>						
1,2-Dichloroethane-d4	94.8	76	%	1.00	11/08/2003 01:09	
Toluene-d8	88.7	88	%	1.00	11/08/2003 01:09	

Gas/BTEX Fuel Oxygenates by 8260B

TRC Alton Geoscience

Attn.: Anju Farfan

21 Technology Drive

Irvine, CA 92718

Phone: (949) 341-7440 Fax: (949) 753-0111

Project: 41050001/FA20

Conoco Phillips #4625

Received: 10/31/2003 16:20

Site: 3070 Fruitvale Ave., Oakland CA

Prep(s): 5030B Test(s): 8260B  
 Sample ID: MW-4 Lab ID: 2003-11-0068 - 6  
 Sampled: 10/30/2003 11:21 Extracted: 11/8/2003 01:31  
 Matrix: Water QC Batch#: 2003/11/07-02.64

Compound	Conc.	RL	Unit	Dilution	Analyzed	Flag
Gasoline	ND	50	ug/L	1.00	11/08/2003 01:31	
Benzene	1.1	0.50	ug/L	1.00	11/08/2003 01:31	
Toluene	2.3	0.50	ug/L	1.00	11/08/2003 01:31	
Ethylbenzene	2.2	0.50	ug/L	1.00	11/08/2003 01:31	
Total xylenes	7.0	1.0	ug/L	1.00	11/08/2003 01:31	
Methyl tert-butyl ether (MTBE)	ND	2.0	ug/L	1.00	11/08/2003 01:31	
Ethanol	ND	500	ug/L	1.00	11/08/2003 01:31	
<b>Surrogate(s)</b>						
1,2-Dichloroethane-d4	94.3	76	%	1.00	11/08/2003 01:31	
Toluene-d8	91.3	88	%	1.00	11/08/2003 01:31	

Gas/BTEX Fuel Oxygenates by 8260B

TRC Alton Geoscience

Attn.: Anju Farfan

21 Technology Drive

Irvine, CA 92718

Phone: (949) 341-7440 Fax: (949) 753-0111

Project: 41050001/FA20

Conoco Phillips #4625

Received: 10/31/2003 16:20

Site: 3070 Fruitvale Ave., Oakland CA

Batch QC Report

Prep(s): 5030B

Test(s): 8260B

Method Blank

Water

QC Batch # 2003/11/07-02.64

MB: 2003/11/07-02.64-034

Date Extracted: 11/07/2003 22:34

Compound	Conc.	RL	Unit	Analyzed	Flag
Gasoline	ND	50	ug/L	11/07/2003 22:34	
Benzene	ND	0.5	ug/L	11/07/2003 22:34	
Toluene	ND	0.5	ug/L	11/07/2003 22:34	
Ethylbenzene	ND	0.5	ug/L	11/07/2003 22:34	
Total xylenes	ND	1.0	ug/L	11/07/2003 22:34	
tert-Butyl alcohol (TBA)	ND	100	ug/L	11/07/2003 22:34	
Methyl tert-butyl ether (MTBE)	ND	2.0	ug/L	11/07/2003 22:34	
Di-isopropyl Ether (DIPE)	ND	2.0	ug/L	11/07/2003 22:34	
Ethyl tert-butyl ether (ETBE)	ND	2.0	ug/L	11/07/2003 22:34	
tert-Amyl methyl ether (TAME)	ND	2.0	ug/L	11/07/2003 22:34	
1,2-DCA	ND	2.0	ug/L	11/07/2003 22:34	
EDB	ND	2.0	ug/L	11/07/2003 22:34	
Ethanol	ND	500	ug/L	11/07/2003 22:34	
<b>Surrogates(s)</b>					
1,2-Dichloroethane-d4	92.7	76-114	%	11/07/2003 22:34	
Toluene-d8	95.0	88-110	%	11/07/2003 22:34	

Gas/BTEX Fuel Oxygenates by 8260B

TRC Alton Geoscience

Attn.: Anju Farfan

21 Technology Drive

Irvine, CA 92718

Phone: (949) 341-7440 Fax: (949) 753-0111

Project: 41050001/FA20

Conoco Phillips #4625

Received: 10/31/2003 16:20

Site: 3070 Fruitvale Ave., Oakland CA

Batch QC Report

Prep(s): 5030B

Method Blank

MB: 2003/11/08-01.64-054

Water

Test(s): 8260B

QC Batch # 2003/11/08-01.64

Date Extracted: 11/08/2003 10:54

Compound	Conc.	RL	Unit	Analyzed	Flag
Gasoline	ND	50	ug/L	11/08/2003 10:54	
Benzene	ND	0.5	ug/L	11/08/2003 10:54	
Toluene	ND	0.5	ug/L	11/08/2003 10:54	
Ethylbenzene	ND	0.5	ug/L	11/08/2003 10:54	
Total xylenes	ND	1.0	ug/L	11/08/2003 10:54	
tert-Butyl alcohol (TBA)	ND	100	ug/L	11/08/2003 10:54	
Methyl tert-butyl ether (MTBE)	ND	2.0	ug/L	11/08/2003 10:54	
Di-isopropyl Ether (DIPE)	ND	2.0	ug/L	11/08/2003 10:54	
Ethyl tert-butyl ether (ETBE)	ND	2.0	ug/L	11/08/2003 10:54	
tert-Amyl methyl ether (TAME)	ND	2.0	ug/L	11/08/2003 10:54	
1,2-DCA	ND	2.0	ug/L	11/08/2003 10:54	
EDB	ND	2.0	ug/L	11/08/2003 10:54	
Ethanol	ND	500	ug/L	11/08/2003 10:54	
<b>Surrogates(s)</b>					
1,2-Dichloroethane-d4	92.6	76-114	%	11/08/2003 10:54	
Toluene-d8	93.1	88-110	%	11/08/2003 10:54	

Severn Trent Laboratories, Inc.

STL San Francisco \* 1220 Quarry Lane, Pleasanton, CA 94566

Tel 925 484 1919 Fax 925 484 1096 \* www.stl-inc.com \* CA DHS ELAP# 2496

11/14/2003 09:22

Gas/BTEX Fuel Oxygenates by 8260B

TRC Alton Geoscience

Attn.: Anju Farfan

21 Technology Drive

Irvine, CA 92718

Phone: (949) 341-7440 Fax: (949) 753-0111

Project: 41050001/FA20

Conoco Phillips #4625

Received: 10/31/2003 16:20

Site: 3070 Fruitvale Ave., Oakland CA

Batch QC Report

Prep(s): 5030B

Test(s): 8260B

Laboratory Control Spike

Water

QC Batch # 2003/11/07-02.64

LCS 2003/11/07-02.64-050

Extracted: 11/07/2003

Analyzed: 11/07/2003 21:50

LCSD 2003/11/07-02.64-012

Extracted: 11/07/2003

Analyzed: 11/07/2003 22:12

Compound	Conc. ug/L		Exp.Conc.	Recovery %		RPD	Ctrl.Limits %		Flags	
	LCS	LCSD		LCS	LCSD		%	Rec.	RPD	LCS
Benzene	27.2	27.0	25.0	108.8	108.0	0.7	69-129	20		
Toluene	24.4	25.3	25.0	97.6	101.2	3.6	70-130	20		
Methyl tert-butyl ether (MTBE)	27.0	28.6	25.0	108.0	114.4	5.8	65-165	20		
<b>Surrogates(s)</b>										
1,2-Dichloroethane-d4	493	495	500	98.6	99.0		76-114			
Toluene-d8	469	461	500	93.8	92.2		88-110			

Severn Trent Laboratories, Inc.

STL San Francisco \* 1220 Quarry Lane, Pleasanton, CA 94566

Tel 925 484 1919 Fax 925 484 1096 \* www.stl-inc.com \* CA DHS ELAP# 2496

11/14/2003 09:22

Gas/BTEX Fuel Oxygenates by 8260B

TRC Alton Geoscience

Attn.: Anju Farfan

21 Technology Drive

Irvine, CA 92718

Phone: (949) 341-7440 Fax: (949) 753-0111

Project: 41050001/FA20

Conoco Phillips #4625

Received: 10/31/2003 16:20

Site: 3070 Fruitvale Ave., Oakland CA

Batch QC Report

Prep(s): 5030B

Test(s): 8260B

Laboratory Control Spike

Water

QC Batch # 2003/11/08-01.64

LCS 2003/11/08-01.64-010

Extracted: 11/08/2003

Analyzed: 11/08/2003 10:10

LCSD 2003/11/08-01.64-032

Extracted: 11/08/2003

Analyzed: 11/08/2003 10:32

Compound	Conc. ug/L		Exp.Conc.	Recovery %		RPD	Ctrl.Limits %		Flags	
	LCS	LCSD		LCS	LCSD		%	Rec.	RPD	LCS
Benzene	26.7	25.8	25.0	106.8	103.2	3.4	69-129	20		
Toluene	24.7	24.5	25.0	98.8	98.0	0.8	70-130	20		
Methyl tert-butyl ether (MTBE)	27.2	26.2	25.0	108.8	104.8	3.7	65-165	20		
<b>Surrogates(s)</b>										
1,2-Dichloroethane-d4	482	485	500	96.4	97.0		76-114			
Toluene-d8	467	469	500	93.4	93.8		88-110			

Severn Trent Laboratories, Inc.

STL San Francisco \* 1220 Quarry Lane, Pleasanton, CA 94566

Tel 925 484 1919 Fax 925 484 1096 \* www.stl-inc.com \* CA DHS ELAP# 2496

11/14/2003 09:22

**Gas/BTEX Fuel Oxygenates by 8260B**

TRC Alton Geoscience

Attn.: Anju Farfan

21 Technology Drive

Irvine, CA 92718

Phone: (949) 341-7440 Fax: (949) 753-0111

Project: 41050001/FA20

Conoco Phillips #4625

Received: 10/31/2003 16:20

Site: 3070 Fruitvale Ave., Oakland CA

**Batch QC Report**

Prep(s): 5030B

Test(s): 8260B

**Matrix Spike ( MS / MSD )**

**Water**

**QC Batch # 2003/11/07-02.64**

MW-1 >> MS

Lab ID: 2003-11-0068 - 003

MS: 2003/11/07-02.64-002

Extracted: 11/08/2003

Analyzed: 11/08/2003 00:02

Dilution: 1.00

MSD: 2003/11/07-02.64-025

Extracted: 11/08/2003

Analyzed: 11/08/2003 00:25

Dilution: 1.00

Compound	Conc. ug/L			Spk.Level ug/L	Recovery %			Limits %		Flags	
	MS	MSD	Sample		MS	MSD	RPD	Rec.	RPD	MS	MSD
Benzene	66.2	57.8	35.1	25.0	124.4	90.8	31.2	69-129	20		mso
Toluene	70.9	64.0	41.3	25.0	118.4	90.8	26.4	70-130	20		mso
Methyl tert-butyl ether	36.8	35.7	8.48	25.0	113.3	108.9	4.0	65-165	20		
<b>Surrogate(s)</b>											
1,2-Dichloroethane-d4	454	494		500	90.8	98.8		76-114			
Toluene-d8	464	447		500	92.8	89.5		88-110			

Severn Trent Laboratories, Inc.

STL San Francisco \* 1220 Quarry Lane, Pleasanton, CA 94566

Tel 925 484 1919 Fax 925 484 1096 \* www.stl-inc.com \* CA DHS ELAP# 2496

11/14/2003 09:22





**STL**

Submission #: 2003-11-0068

**Gas/BTEX Fuel Oxygenates by 8260B**

TRC Alton Geoscience

Attn.: Anju Farfan

21 Technology Drive

Irvine, CA 92718

Phone: (949) 341-7440 Fax: (949) 753-0111

Project: 41050001/FA20

Conoco Phillips #4625

Received: 10/31/2003 16:20

Site: 3070 Fruitvale Ave., Oakland CA

---

**Legend and Notes**

---

**Analysis Flag**

o

Reporting limits were raised due to high level of analyte present in the sample.

**Result Flag**

mso

MS/MSD spike recoveries were out of QC limits due to matrix interference.  
Precision and Accuracy were verified by LCS/LCSD.

Severn Trent Laboratories, Inc.

STL San Francisco \* 1220 Quarry Lane, Pleasanton, CA 94566

Tel 925 484 1919 Fax 925 484 1096 \* www.stl-inc.com \* CA DHS ELAP# 2496

11/14/2003 09:22

**Metals**

TRC Alton Geoscience

Attn.: Anju Farfan

21 Technology Drive

Irvine, CA 92718

Phone: (949) 341-7440 Fax: (949) 753-0111

Project: 41050001/FA20

Conoco Phillips #4625

Received: 10/31/2003 16:20

Site: 3070 Fruitvale Ave., Oakland CA

**Samples Reported**

Sample Name	Date Sampled	Matrix	Lab #
MW-3	10/30/2003 11:31	Water	5

Severn Trent Laboratories, Inc.

STL San Francisco \* 1220 Quarry Lane, Pleasanton, CA 94566

Tel 925 484 1919 Fax 925 484 1096 \* www.stl-inc.com \* CA DHS ELAP# 2496

11/13/2003 14:17

**Metals**

TRC Alton Geoscience

Attn.: Anju Farfan

21 Technology Drive

Irvine, CA 92718

Phone: (949) 341-7440 Fax: (949) 753-0111

Project: 41050001/FA20

Conoco Phillips #4625

Received: 10/31/2003 16:20

Site: 3070 Fruitvale Ave., Oakland CA

Prep(s):	3010A	Test(s):	6010B
Sample ID:	MW-3	Lab ID:	2003-11-0068 - 5
Sampled:	10/30/2003 11:31	Extracted:	11/4/2003 07:45
Matrix:	Water	QC Batch#:	2003/11/04-01.15

Compound	Conc.	RL	Unit	Dilution	Analyzed	Flag
Chromium	0.13	0.0050	mg/L	1.00	11/13/2003 03:20	

Metals

TRC Alton Geoscience

Attn.: Anju Farfan

21 Technology Drive

Irvine, CA 92718

Phone: (949) 341-7440 Fax: (949) 753-0111

Project: 41050001/FA20

Conoco Phillips #4625

Received: 10/31/2003 16:20

Site: 3070 Fruitvale Ave., Oakland CA

Batch QC Report

Prep(s): 3010A

Method Blank

MB: 2003/11/04-01.15-186

Water

Test(s): 6010B

QC Batch # 2003/11/04-01.15

Date Extracted: 11/04/2003 07:45

Compound	Conc.	RL	Unit	Analyzed	Flag
Chromium	ND	0.0050	mg/L	11/13/2003 02:58	

**Metals**

TRC Alton Geoscience

Attn.: Anju Farfan

21 Technology Drive

Irvine, CA 92718

Phone: (949) 341-7440 Fax: (949) 753-0111

Project: 41050001/FA20

Conoco Phillips #4625

Received: 10/31/2003 16:20

Site: 3070 Fruitvale Ave., Oakland CA

**Batch QC Report**

Prep(s): 3010A

Test(s): 6010B

**Laboratory Control Spike**

**Water**

**QC Batch # 2003/11/04-01.15**

LCS 2003/11/04-01.15-187

Extracted: 11/04/2003

Analyzed: 11/13/2003 03:03

LCSD 2003/11/04-01.15-188

Extracted: 11/04/2003

Analyzed: 11/13/2003 03:07

Compound	Conc. mg/L		Exp.Conc.	Recovery %		RPD	Ctrl.Limits %		Flags	
	LCS	LCSD		LCS	LCSD		%	Rec.	RPD	LCS
Chromium	0.479	0.474	0.500	95.8	94.8	1.0	80-120	20		

Severn Trent Laboratories, Inc.

STL San Francisco \* 1220 Quarry Lane, Pleasanton, CA 94566

Tel 925 484 1919 Fax 925 484 1096 \* www.st-inc.com \* CA DHS ELAP# 2496

11/13/2003 14:17

STL San Francisco

### Sample Receipt Checklist

Submission #: 2003- 11 - 0068

Checklist completed by: (initials) JM Date: 11/03 /03

Courier name:  STL San Francisco  Client \_\_\_\_\_

Custody seals intact on shipping container/samples Yes \_\_\_ No \_\_\_ Not Present

Chain of custody present? Yes  No \_\_\_

Chain of custody signed when relinquished and received? Yes  No \_\_\_

Chain of custody agrees with sample labels? Yes  No \_\_\_

Samples in proper container/bottle? Yes  No \_\_\_

Sample containers intact? Yes  No \_\_\_

Sufficient sample volume for indicated test? Yes  No \_\_\_

All samples received within holding time? Yes  No \_\_\_

Container/Temp Blank temperature in compliance ( $4^{\circ}C \pm 2$ )? Temp 2.9 °C Yes  No \_\_\_

Ice Present Yes  No \_\_\_

Water - VOA vials have zero headspace? No VOA vials submitted Yes  No \_\_\_

(if bubble is present, refer to approximate bubble size and itemize in comments as S (small ~ O), M (medium ~ O) or L (large ~ O))

Water - pH acceptable upon receipt?  Yes  No

pH adjusted- Preservative used:  HNO<sub>3</sub>  HCl  H<sub>2</sub>SO<sub>4</sub>  NaOH  ZnOAc -Lot #(s) \_\_\_\_\_

For any item check-listed "No", provided detail of discrepancy in comment section below:

**Comments:**  
\_\_\_\_\_  
\_\_\_\_\_

#### Project Management [Routing for instruction of indicated discrepancy(ies)]

Project Manager: (initials) \_\_\_\_\_ Date: \_\_\_\_/\_\_\_\_/03

Client contacted:  Yes  No

Summary of discussion:  
\_\_\_\_\_  
\_\_\_\_\_

Corrective Action (per PM/Client):  
\_\_\_\_\_  
\_\_\_\_\_

# ConocoPhillips Chain Of Custody Record

2003-11-06879753

STL-San Francisco

1220 Quarry Lane

Pleasanton, CA 94566

(925) 484-1919 (925) 484-1097 fax

ConocoPhillips Site Manager:

INVOICE REMITTANCE ADDRESS:

CONOCOPHILLIPS  
Attn: Dee Hutchinson  
3611 South Harbor, Suite 200  
Santa Ana, CA. 92704

ConocoPhillips Work Order Number

ConocoPhillips Cost Object

DATE: 10-30-03

PAGE: 1 of 1

SAMPLING COMPANY: RC	Valid Value ID:	CONOCOPHILLIPS SITE NUMBER: 4625	GLOBAL ID NO.: T0600102156
-------------------------	-----------------	-------------------------------------	-------------------------------

ADDRESS: 1 Technology Drive, Irvine, CA 92618	SITE ADDRESS (Street and City): 3070 Fruitvale Ave Oakland CA
--	--

PROJECT CONTACT (Hardcopy or PDF Report to): Anju Farfan	EDF DELIVERABLE TO (RP or Designee): Peter Thomson, pthomson@trcsolutions.com	PHONE NO.: 949-753-0101	E-MAIL:  LAB USE ONLY
---	---	----------------------------	-----------------------------

OPERATOR NAME(S) (Print): Fernando Cormier	CONSULTANT PROJECT NUMBER: 41050001/FA20	REQUESTED ANALYSES
---	---	--------------------

TURNAROUND TIME (CALENDAR DAYS):  
 14 DAYS  7 DAYS  72 HOURS  48 HOURS  24 HOURS  LESS THAN 24 HOURS

SPECIAL INSTRUCTIONS OR NOTES: CHECK BOX IF EDD IS NEEDED   
 Run 80XYS by 8260 on all 8260  
 MIBE hits

8015m - TPHd Extractable	8260B - TPHg/BTEX/MIBE	8260B - TPHg/BTEX/8	Oxygenates	8260B - TPHg/BTEX/8 oxygenates + methanol (8015M)	8260B - Full Scan VOCs (does not include oxygenates)	8270C - Semi-Volatiles	8015M / 8021B - TPHg/BTEX/MIBE	Lead <input type="checkbox"/> Total <input type="checkbox"/> STLC <input type="checkbox"/> TCLP	TPH by 8260B	BTEX/MIBE by 8260B	Ethanol by 8260B	TPH-D by 8260	106 VOCs by 8240	SVOCs by 8270 chromatogram	80XYS by 8260B
--------------------------	------------------------	---------------------	------------	--	---	------------------------	--------------------------------	---	--------------	--------------------	------------------	---------------	------------------	----------------------------	----------------

FIELD NOTES:  
 Container/Preservative  
 or PID Readings  
 or Laboratory Notes

3.1°C

TEMPERATURE ON RECEIPT °C

\* Field Point name only required if different from Sample ID

SAMPLE ID	Name*	SAMPLING		MATRIX	NO. OF CONT.
		DATE	TIME		
MW-5		10/31/03	0807	GW	3Vials
MW-6			0636		3Vials
MW-1			0859		2 vials w/ HCL
MW-2			0708		3Vials w/ HCL 2 vials
MW-3			1131		3Vials w/ HCL 2 vials
MW-4			1121		3Vials w/ HCL 2 vials

①  
②  
③  
④

TPH-D by 8015, NOT 8260!  
 TOG - total, not petro.  
 Not enough sample for 8270!  
 VOC by 8260, NOT 8240.

and 1 230ml preserved  
w/ HCL, 1lb Amber V/ HCL

Released by: (Signature) *Fernando Cormier*  
 Date: 10/31/03 1620

Received by: (Signature) *[Signature]*  
 Received by: (Signature) *[Signature]*  
 Received by: (Signature) *Nouha K.*

Date: 10/31/03 Time: 1427  
 Date: 10/31/03 Time: 1620

# ConocoPhillips Chain Of Custody Record

STL-San Francisco

1220 Quarry Lane  
Pleasanton, CA 94566  
(925) 484-1919 (925) 484-1096 fax

ConocoPhillips Site Manager:  
INVOICE REMITTANCE ADDRESS: CONOCOPHILLIPS  
Attn: Dee Hutchinson  
3611 South Harbor, Suite 200  
Santa Ana, CA. 92704

ConocoPhillips Work Order Number  
  
ConocoPhillips Cost Object

DATE: 10-30-03  
PAGE: 1 of 1

SAMPLING COMPANY: TRC		Valid Value ID:	CONOCOPHILLIPS SITE NUMBER 4625		GLOBAL ID NO.: T0600102156
ADDRESS: 21 Technology Drive, Irvine, CA 92618		SITE ADDRESS (Street and City): 3070 Fruitvale Ave Oakland CA			
PROJECT CONTACT (Hardcopy or PDF Report to): Anju Farfan		EDF DELIVERABLE TO (RP or Designee): Peter Thomson, pthomson@trcsolutions.com		PHONE NO.: 949-753-0101	E-MAIL:  LAB USE ONLY
TELEPHONE: 949-341-7440	FAX: 949-753-0111	E-MAIL: afarfan@trcsolutions.com			

SAMPLER NAME(S) (Print): Rexaldo Cormier	CONSULTANT PROJECT NUMBER: 41050001/FA20	REQUESTED ANALYSES			
---	---	--------------------	--	--	--

TURNAROUND TIME (CALENDAR DAYS):  
 14 DAYS  7 DAYS  72 HOURS  48 HOURS  24 HOURS  LESS THAN 24 HOURS

SPECIAL INSTRUCTIONS OR NOTES: CHECK BOX IF EDD IS NEEDED   
 Run 80XYS by 8260 on all 8260  
 MTEBE hits

8015m - TPHd Extractable	8260B - TPHg/BTEX/MTBE	8260B - TPHg / BTEX / 8 Oxygenates	8260B - TPHg / BTEX / 8 oxygenates + methanol (8015M)	8260B - Full Scan VOCs (does not include oxygenates)	8270C - Semi-Volatiles	8015M / 8021B - TPHg/BTEX/MTBE	Lead <input type="checkbox"/> Total <input type="checkbox"/> STLC <input type="checkbox"/> DTCLP	TPPH by 8260B	BTEX/MTBE by 8260B	Ethanol by 8260B	TPH-D by 8260	TGC VOCs by 8240 Total	SVOCs by 8270C Chromatogram	80XYS by 8260B
								X	X					X
								X	X					X
								X	X	X				
								X	X	X	X	X	X	
								X	X	X				

FIELD NOTES:  
 Container/Preservative  
 or PID Readings  
 or Laboratory Notes  
  
 3.1°C  
 TEMPERATURE ON RECEIPT C°

LAB USE ONLY	Sample Identification/Field Point Name*	SAMPLING		MATRIX	NO. OF CONT.
		DATE	TIME		
	MW-5	10/31/03	0807	GW	3Voc's
	MW-6		0638		3Voc's
	MW-1		0859		3Voc's HCL 2unpre
	MW-2		0708		3Voc's HCL 2unpre
	MW-3		1131		3Voc's HCL 2unpre
	MW-4		1121		3Voc's HCL 2unpre

Relinquished by: (Signature) <i>Rexaldo Cormier</i>	Received by: (Signature) <i>[Signature]</i>	Date: 10/31/03	Time: 1427
Relinquished by: (Signature) <i>[Signature]</i>	Received by: (Signature) <i>[Signature]</i>	Date: 10/31/03	Time: 1620
Relinquished by: (Signature) <i>[Signature]</i>	Received by: (Signature) <i>Youna K.</i>	Date: 10/31/03	Time: 1620



TRC Customer Focused Solutions  
5052 Commercial Circle  
Concord, CA 94520-1248

## Statement of Authorized Transportation and Disposal

This is to certify that non-hazardous groundwater produced during purging and sampling of monitoring wells at ConocoPhillips site number 4625 was accumulated at TRC's groundwater monitoring facility at Concord, California, for transportation by Onyx Transportation, Inc. to the ConocoPhillips Refinery at Rodeo California for disposal. TRC records indicate that approximately 42 gallons of purge water from the site were transferred to the purge water holding tank on 10/30/03. The contents of the holding tank were transported to the Unit 100 Water Treatment Facility at the Rodeo Refinery on 11/3/03.

Disposal at the facility was authorized by ConocoPhillips in accordance with "ESD Standard Operating Procedures - Water Quality and Compliance", as revised on February 7, 2003. The procedure requires that TRC dispose only of monitoring well purge water from sites for which TRC services are under contract by ConocoPhillips. The non-hazardous nature of the purge water is confirmed quarterly by analysis by an independent certified laboratory of a random sample from the TRC holding facility. The sample is analyzed for all analytes and parameters that might affect the ConocoPhillips NPDES permit for ultimate disposal of the water. Documentation of compliance with ConocoPhillips requirements is provided by an ESD Form R-149, which is on file with ConocoPhillips.

If any purge water collected at the site is suspected of containing potentially hazardous material such as liquid-phase hydrocarbons, that water was accumulated separately in a drum for transportation and disposal by Filter Recycling, Inc.

In witness of this statement

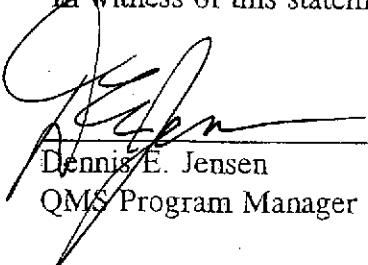
  
Dennis E. Jensen  
QMS Program Manager

1/17/04  
date

## LIMITATIONS

The fluid level monitoring and groundwater sampling activities summarized in this report have been performed under the responsible charge of a California Registered Geologist or Registered Civil Engineer and have been conducted in accordance with current practice and the standard of care exercised by geologists and engineers performing similar tasks in this area. No warranty, express or implied, is made regarding the conclusions and professional opinions presented in this report. The conclusions are based solely upon an analysis of the observed conditions. If actual conditions differ from those described in this report, our office should be notified.