

MEMORANDUM

DATE: April 14, 1994

TO: Richard Hiett, RWQCB

FROM: Scott Seery, ACDEH

SUBJ: Perchloroethylene occurrences: 20457 Redwood Road and 3369
Castro Valley Blvd., Castro Valley

Attached please find a copy of an annotated map showing the locations where perchloroethylene (PCE) has been discovered in wells associated with gasoline UST investigations near the intersection of Redwood Road and Castro Valley Boulevard. The attached map was provided by the Castro Valley Sanitary District (CVSD), and depicts the locations of sewer lines, depths of line burial, manways, piping diameter and effluent flow directions, among other information.

Sewer lines are highlighted green. Arrows are pointed in the direction of flow. Manway covers are depicted as open circles (o). Areas of concern have been circled in red. Monitoring wells are depicted as red circles/dots (⊙). Concentrations (ppb) of PCE are shown next to well symbols. Sewer laterals from potential source areas are in red. North is towards the top of the page.

Other useful sewer line information is explained graphically, below:

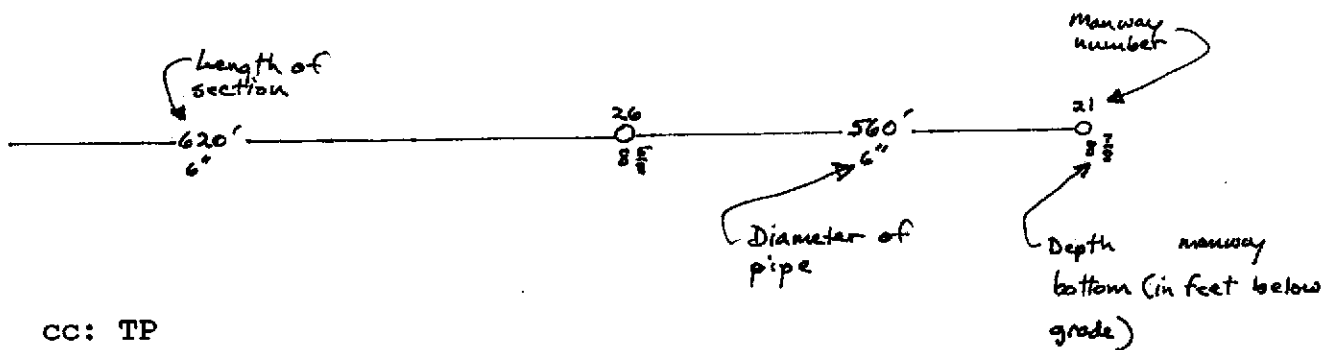
CC: TP
BJ

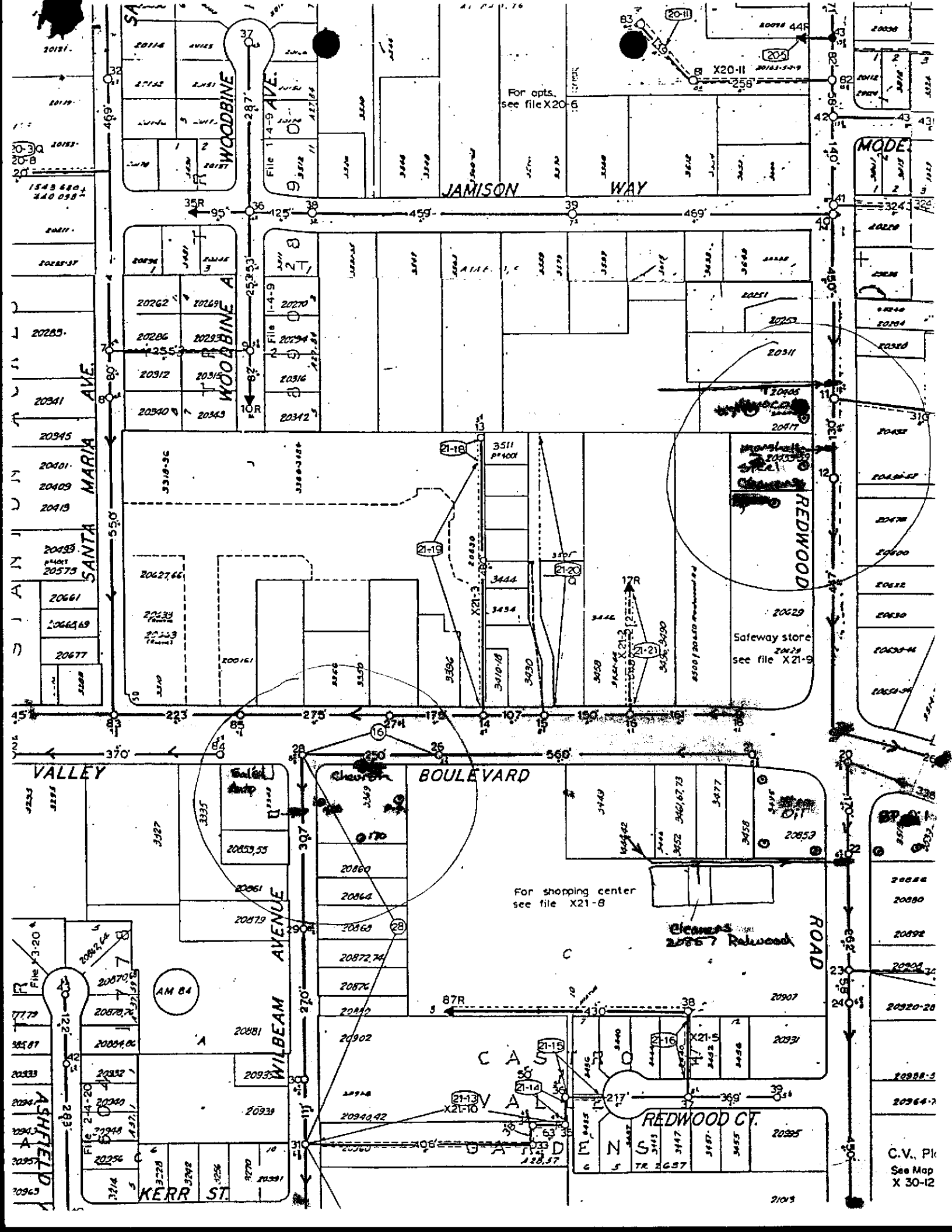

For opts. see file X20-11

Safeway store
20428
see file X21-9

For shopping center
see file X21-8

20857 Redwood

C.V. Pl.
See Map
X 30-12