

**Life  
Springs  
Environmental, Inc.**

3275 Stevens Creek Blvd., #208, San Jose, CA 95117

ENVIRONMENTAL CONSULTING ENGINEERS  
General Engineering Contractor's License No. 709780

408-243-9292  
FAX 408-243-9696

October 26, 1999

Mr. Scott Seery  
Alameda County Environmental Health Services  
1131 Harbor Bay Parkway, Suite 250  
Alameda, CA 94502-6577

Regarding: Soil Remediation ~~Status Report~~ **Report No. 2**  
R.T. Nahas Property, Castro Valley

ENVIRONMENTAL  
PROTECTION  
99 OCT 27 PM 4:22

Dear Mr. Seery:

This report is presented as a further update on the status of soil remediation, and to provide results of additional analyses of soil samples collected from impacted areas of the subject site, since submitting our August 17, 1999 status report. We again request guidance from the Alameda County Environmental Health Services (ACEHS) relative to acceptable levels of contaminant concentrations for soil that may remain, after treatment on site.

A **Regional Map, Figure 1**, which shows the site location with respect to nearby streets and the I-580 Freeway, is attached. Also attached is a **Site Sampling Plan, Figure 2**. This plan shows the initial soil sampling locations (following UST removal), sump and waste oil excavation stockpiles and related sampling locations, remediated soil stockpiles and related sampling locations, and resampling locations within the waste oil pit.

We initially contacted you on May 28, 1999 to report the results of additional Sump and Waste Oil Pit soil sample analyses, at which time you expressed less concern about diesel fuel (TPHD) and oil and grease (TOG) in in-situ soil samples, than the potential presence of chlorinated hydrocarbons. You recommended resampling of the pit bottoms and analysis of these samples for Semi Volatile and Volatile Organic Compounds [EPA Methods 8240 (now 8260) and 8270]. This resampling activity was carried out on August 3, 1999, and the results were reported in our previous (8/17/99) status report.

Previous analytical results indicated TPHD to be present below the Sump (7' depth) and Waste Oil (10' depth) pits at respective concentrations of 84 and 560 mg/Kg. TOG also was present at respective concentrations of 88 and 1,400 mg/Kg. Several EPA 8270 analytes were detected at trace levels in the WO-10 sample [Fluoranthene at 0.13 mg/Kg, Pyrene at 0.20 mg/Kg, and bis(2-Ethylhexyl) phthalate at 0.82 mg/Kg]. There were no EPA 8260 analytes detected in either sample.

## ADDITIONAL WORK PERFORMED

### Re-Excavated Material Analysis

Previous analysis of soil re-excavated from the Waste Oil pit had indicated the presence of total lead at 55 mg/Kg, which is greater than 10 times the allowable Soluble Threshold Limit Concentration (STLC) level of 5.0 mg/L for lead. Since this analysis was performed in anticipation of disposing this soil at the BFI Vasco Road Landfill in Livermore, it was deemed necessary to re-sample and re-analyze this stockpile for lead. A single soil sample was collected August 19, 1999 and analyzed for total and soluble lead. Total lead concentration (TTLC) was 81 mg/Kg, and soluble lead concentration (STLC) was 1.8 mg/L, which was well below the 5.0 mg/L threshold. These analytical results have been added to Table 3; the analytical results and COC are attached.

### Pit Bottom Sampling

Soil underlying the Waste Oil UST at a depth of 11.5-feet was sampled on September 8, 1999. A hand auger was used reach native soil at this depth roughly 2.5-feet below the existing pit bottom. The sample was collected using a slide hammer sampler driving a sampler head containing a 2-inch diameter by 6-inch long brass sleeve. After sampling, the sleeve was retrieved from the sampler, and the sleeve ends were covered with aluminum foil and tightly fitting plastic caps. The sample was properly labeled, a Chain of Custody (COC) was prepared, and the sample was placed in a cooler on ice, pending transport to the laboratory.

This sample was analyzed for TPHG/BTEX, TPHD, TOG and Semi-Volatile Organic Compounds (EPA 8270). The only compound detected was TPHD at 1.2 mg/Kg; no EPA 8270 analytes were detected in this slightly deeper soil sample. Some of these historic analytical results are summarized on Table 3, attached (Tables 1 and 2 were presented previously in the Tank Closure Technical Report dated February 18, 1999). Copies of the analytical results and the COC for the August 19, 1999 sampling event are attached.

### Soil Aeration

Soil with TPHG/BTEX and minor TPHD contamination was initially stockpiled on the northerly side of the site following UST removal last November. This stockpile, estimated at 175 cubic yards, was placed on and covered with 6-mil Visqueen; the cover was maintained during the 1998-'99 winter season. In April 1999, we began spreading the stockpiled material in thin (12"-18") aeration beds. On each weekly return to the site, the previously prepared beds were thoroughly rototilled using a Howard Rotavator attached to a Kubota tractor. The last portion of this stockpile was spread on August 3, 1999.

On August 10 we began re-stockpiling material from the aeration beds, completing this activity August 19, 1999. On September 8, 1999 four discrete samples were collected from each (north, east and west) remediated soil stockpile. These were composited by the laboratory into one sample for analysis per stockpile. Analytical results for these remediated soil stockpiles indicate no detectable TPHG or BTEX compounds. TPHD was detected in each stockpile at respective concentrations of 5.7, 8.0 and 3.3 mg/Kg. Analytical results for these remediated soil stockpile samples have been added to Table 3; analytical results and the COC are attached.

3 stockpiles  
from  
"aeration  
beds"

## DISCUSSION

The most recent Waste Oil UST pit bottom sampling and analysis confirms the absence of Semi-Volatile and Volatile Organic Compounds, as well as TPHG/BTEX, TPHD and TOG at the 11.5-foot depth. **Additional excavation of the Waste Oil pit to an 11.5-foot depth is planned.** All excavated material will be manifested and disposed as non-hazardous waste at the BFI Vasco Road Landfill in Livermore.

W.O.  
pit

Supplemental, deeper sampling and analysis of the Sump pit has not been performed, so the latest data we for a 7-foot deep sample (TPHD at 84 mg/Kg and TOG at 88 mg/Kg) governs our decisions regarding re-excavation in this pit. **Considering the rapid diminishment with depth, of contaminant concentrations in the Waste Oil pit, we consider it prudent to excavate the sump down to a 9-foot maximum depth to remove all contaminants.** A confirmation sample will be collected from the excavation bottom, and analyzed for TPHD and TOG.

Sump

The low levels (<10ppm) of TPHD remaining in the remediated soil stockpiles are believed to show that sufficient remediation by aeration has been accomplished, and this material may now be re-used in completing the backfilling of remaining pits and depressions on the site. You may recall that the main UST pit was backfilled to within 2-3 feet of grade last November, using clean imported crushed rock. We would appreciate confirmation and/or guidance from the ACEHS relative to acceptance of this remediated soil for re-use on site.

fuel  
USTs

Your review of the data presented herein, and a written response to our request for guidance, is appreciated.

Sincerely,

*Life Springs Environmental, Inc.*

Kenneth L. Meleen  
Licensed Civil Engineer No. C 17487  
License Expires 6/30/2001



cc: Mr. Randy Nahas

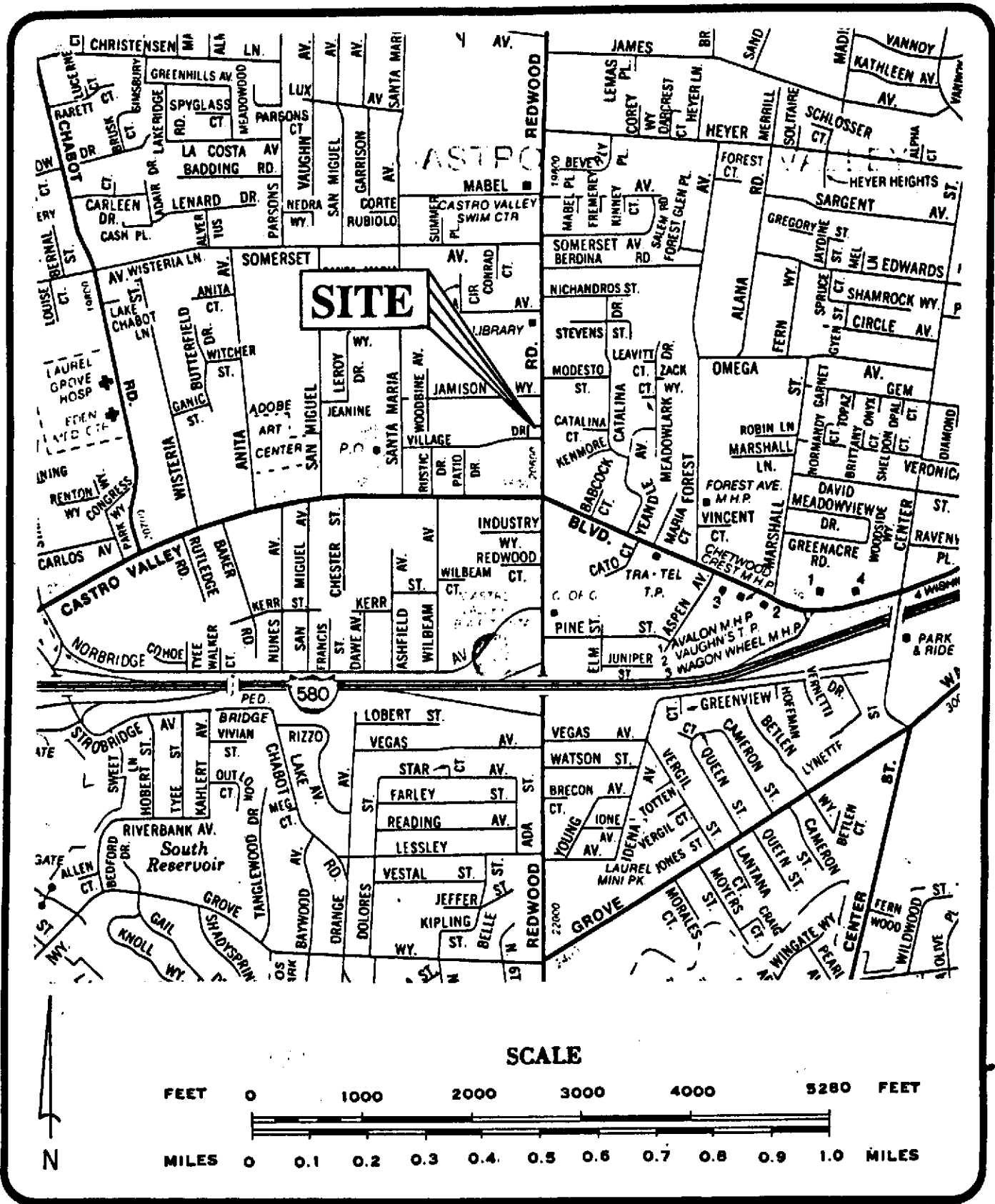

Life  
 Springs  
 Environmental, Inc.

**REGIONAL MAP**  
**R.T. NAHAS COMPANY UST SITE**  
 20405 Redwood Road  
 Castro Valley, California

Figure No.  
 1  
 98041.2  
 Project No.

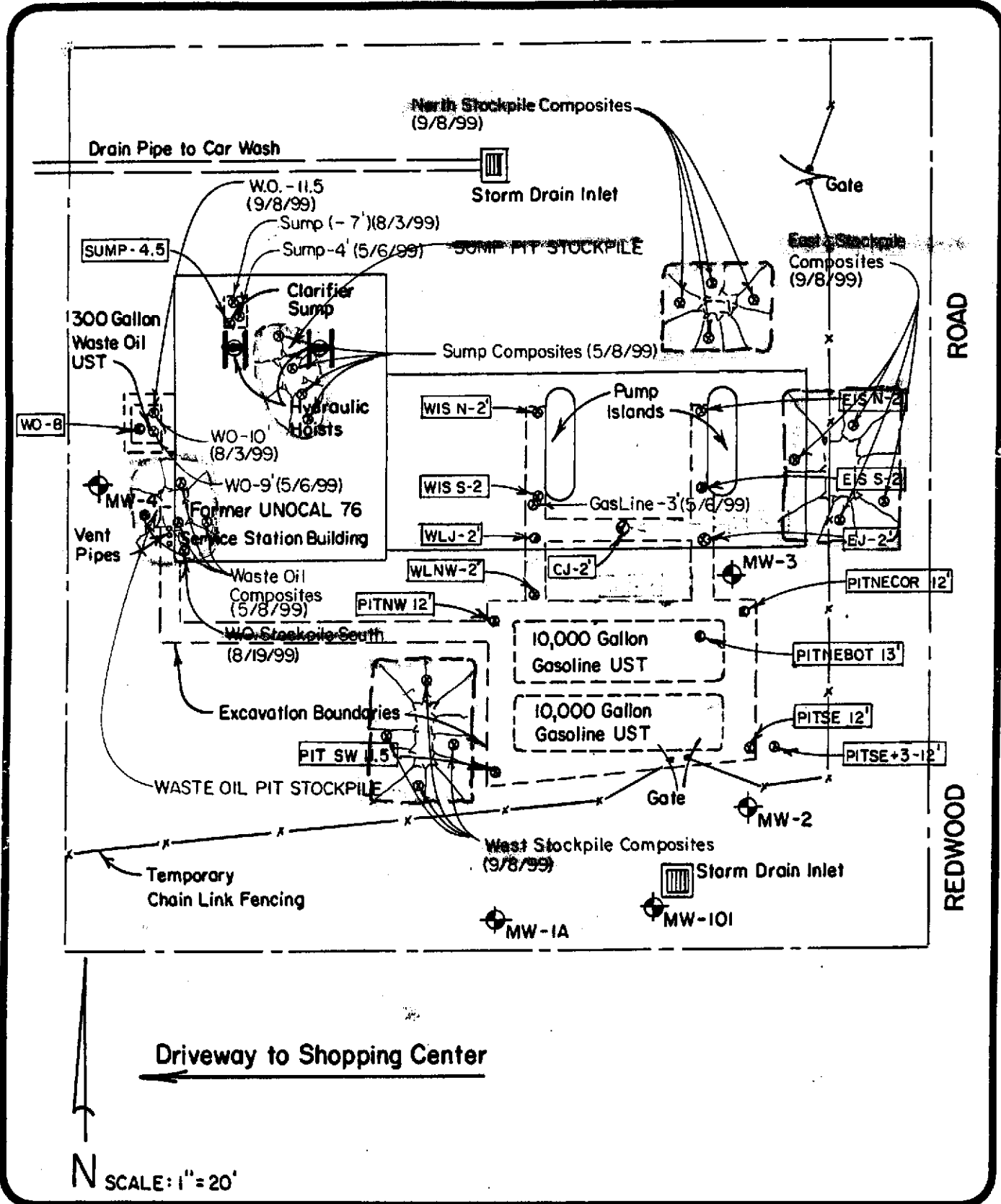

Life Springs Environmental, Inc.

**SITE SAMPLING PLAN**  
**R.T. NAHAS COMPANY UST SITE**  
 20405 Redwood Road  
 Castro Valley, California

Figure No.  
 2  
 98041.2  
 Project No.

**TABLE 3**  
**LABORATORY ANALYTICAL RESULTS - SOIL SAMPLES**  
**R.T. NAHAS COMPANY SOIL REMEDIATION**

20405 Redwood Road  
 Castro Valley, California

Sample Description	Sampling Date	PID Result (ppm)	Laboratory Analytical Results (mg/Kg) <sup>f</sup>									
			TPHG	Benzene	Toluene	Ethyl Benzene	Total Xylenes	MTBE	TPHD	TOG	Pb (TTLIC)	Pb (STLC)
WO-8	11/18/98		<1.0	<0.005	0.0061	0.027	0.079	<0.005	270	2300	9	
West Hoist 8.5'	11/19/98	870							1000 <sup>a</sup>			
East Hoist 8.5'	11/19/98	27							<1.0 <sup>b</sup>			
Sump 4.5'	11/19/98		<1.0	<0.005	<0.005	<0.005	<0.005	<0.005	120	96	7.9	
GasLine-3'	05/06/99		<1.0	<0.005	<0.005	<0.005	<0.005	<0.005				
SUMP-4'	05/06/99								2700	4800		
WO-9'	05/06/99								38	140		
Sump Composites <sup>c</sup>	05/08/99									270	11	
Waste Oil Composites <sup>d</sup>	05/08/99									140	55	
Sump (-7')	08/03/99								84	88		
WO-10	08/03/99								560	1400		
WO Stockpile South	08/19/99										81	1.8
WO-11.5	08/19/99		<1.0	<0.005	<0.005	<0.005	<0.005		1.2 <sup>e</sup>	<50		
North Stockpile Composite	08/19/99		<1.0	<0.005	<0.005	<0.005	<0.005		5.7 <sup>e</sup>			
East Stockpile Composite	08/19/99		<1.0	<0.005	<0.005	<0.005	<0.005		8.0 <sup>e</sup>			
West Stockpile Composite	08/19/99		<1.0	<0.005	<0.005	<0.005	<0.005		3.3 <sup>e</sup>			

<sup>a</sup> West Hoist also had 2000 mg/Kg Hydraulic Oil

<sup>b</sup> East Hoist had no detectable TPHD (<1.0 mg/Kg) or Hydraulic Oil (<50 mg/Kg)

<sup>c</sup> Four Samples from Sump Stockpile, Composited into one sample for analysis

<sup>d</sup> Four Samples from Waste Oil Stockpile, Composited into one sample for analysis

<sup>e</sup> Hydrocarbon reported does not match the pattern of the Chromalab, Inc. Diesel standard

<sup>f</sup> STLC results for lead are in units of mg/L

fuel  
 used

**Life Springs Environmental**  
3275 Stevens Creek Blvd., Suite 208  
San Jose, CA 95117-1148

Attn.: Mr. Kenneth Meleen

Project: 98041.2  
R.T. Nahas Co.

Dear Mr. Meleen,

Attached is our report for your samples received on Friday August 20, 1999.  
This report has been reviewed and approved for release. Reproduction of this report  
is permitted only in its entirety.

Please note that any unused portion of the samples will be discarded after September 19, 1999  
unless you have requested otherwise. We appreciate the opportunity to be of service to you.  
If you have any questions, please call me at (925) 484-1919.

Sincerely,

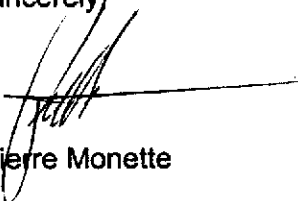

Pierre Monette

Total Lead

<b>Life Springs Environmental</b>	✉ 3275 Stevens Creek Blvd., Suite 208 San Jose, CA 95117-1148
Attn: Kenneth Melehen	Phone: (408) 243-9292 Fax: (408) 243-9696
Project #: 98041.2	Project: R.T. Nahas Co.

Samples Reported

Sample ID	Matrix	Date Sampled	Lab #
W.O. Stockpile South	Soil	08/19/1999 12:00	1



# CHROMALAB, INC.

Submission #: 1999-08-0336

Environmental Services (SDB)

To: Life Springs Environmental

Test Method: 6010B

Attn.: Kenneth Meleen

Prep Method: 3050B

## Total Lead

Sample ID:	<b>W.O. Stockpile South</b>	Lab Sample ID:	<b>1999-08-0336-001</b>
Project:	98041.2 R.T. Nahas Co.	Received:	08/20/1999 07:27
Sampled:	08/19/1999 12:00	Extracted:	08/23/1999 14:21
Matrix:	Soil	QC-Batch:	1999/08/23-05.15

Compound	Result	Rep.Limit	Units	Dilution	Analyzed	Flag
Lead	81	5.0	mg/Kg	1.00	08/23/1999 21:24	

1220 Quarry Lane \* Pleasanton, CA 94566-4756  
Telephone: (925) 484-1919 \* Facsimile: (925) 484-1096

Environmental Services (SDB)

To: Life Springs Environmental  
Attn.: Kenneth Meleen

Test Method: 6010B  
Prep Method: 3050B

**Batch QC Report**  
Total Lead

<b>Method Blank</b>	<b>Soil</b>	<b>QC Batch # 1999/08/23-05.15</b>
MB: 1999/08/23-05.15-099		Date Extracted: 08/23/1999 14:21

Compound	Result	Rep.Limit	Units	Analyzed	Flag
Lead	ND	1.0	mg/Kg	08/24/1999 16:16	

Environmental Services (SDB)

To: Life Springs Environmental

Test Method: 6010B

Attn: Kenneth Meleen

Prep Method: 3050B

**Batch QC Report**

Total Lead

Laboratory Control Spike (LCS/LCSD)	Soil	QC Batch # 1999/08/23-05.15
LCS: 1999/08/23-05.15-100	Extracted: 08/23/1999 14:21	Analyzed: 08/24/1999 16:20
LCSD: 1999/08/23-05.15-101	Extracted: 08/23/1999 14:21	Analyzed: 08/24/1999 16:25

Compound	Conc. [mg/Kg]		Exp. Conc. [mg/Kg]		Recovery [%]			RPD		Ctrl. Limits [%]		Flags	
	LCS	LCSD	LCS	LCSD	LCS	LCSD	RPD	Recovery	RPD	LCS	LCSD	LCS	LCSD
Lead	99.9	94.8	100.0	100.0	99.9	94.8	5.2	80-120	20				

CAM W.E.T. (STLC) Lead

<b>Life Springs Environmental</b>	☒ 3275 Stevens Creek Blvd., Suite 208 San Jose, CA 95117-1148
Attn: Kenneth Meleen	Phone: (408) 243-9292 Fax: (408) 243-9696
Project #: 98041.2	Project: R.T. Nahas Co.

**Samples Reported**

Sample ID	Matrix	Date Sampled	Lab #
W.O. Stockpile South	Soil	08/19/1999 12:00	1

Environmental Services (SDB)

To: **Life Springs Environmental**

Test Method: 6010B

Attn.: Kenneth Meleen

Prep Method: 3005A

CAM W.E.T. (STLC) Lead

Sample ID:	<b>W.O. Stockpile South</b>	Lab Sample ID:	<b>1999-08-0336-001</b>
Project:	98041.2 R.T. Nahas Co.	Received:	08/20/1999 07:27
Sampled:	08/19/1999 12:00	Extracted:	08/27/1999 07:48
Matrix:	Soil	QC-Batch:	1999/08/27-02.15

Compound	Result	Rep.Limit	Units	Dilution	Analyzed	Flag
Lead	1.8	1.0	mg/L	1.00	08/27/1999 11:29	

1220 Quarry Lane \* Pleasanton, CA 94566-4756

Telephone: (925) 484-1919 \* Facsimile: (925) 484-1096

Environmental Services (SDB)

To: Life Springs Environmental  
Attn.: Kenneth Meleen

Test Method: 6010B  
Prep Method: 3005A

**Batch QC Report**  
CAM W.E.T. (STLC) Lead

<b>Method Blank</b>	<b>Soil</b>	<b>QC Batch # 1999/08/27-02.15</b>
MB: 1999/08/27-02.15-001		Date Extracted: 08/27/1999

Compound	Result	Rep.Limit	Units	Analyzed	Flag
Lead	ND	1.0	mg/L	08/27/1999	

Environmental Services (SDB)

To: Life Springs Environmental  
Attn.: Kenneth Meleen

Test Method: 6010B  
Prep Method: 3005A

**Batch QC Report**  
CAM W.E.T. (STLC) Lead

<b>Method Blank</b>	<b>Soil</b>	<b>QC Batch # 1999/08/27-02.15</b>
MB: 1999/08/27-02.15-021		Date Extracted: 08/27/1999 07:48

Compound	Result	Rep.Limit	Units	Analyzed	Flag
Lead	ND	0.50	mg/L	08/27/1999 11:17	

Environmental Services (SDB)

To: Life Springs Environmental

Test Method: 6010B

Attn: Kenneth Meleen

Prep Method: 3005A

**Batch QC Report**

CAM W.E.T. (STLC) Lead

Laboratory Control Spike (LCS/LCSD)		Soil		QC Batch # 1999/08/27-02.15	
LCS:	1999/08/27-02.15-002	Extracted:	08/27/1999	Analyzed:	08/27/1999
LCSD:	1999/08/27-02.15-003	Extracted:	08/27/1999	Analyzed:	08/27/1999

Compound	Conc. [mg/L]		Exp. Conc. [mg/L]		Recovery [%]			Ctrl. Limits [%]		Flags	
	LCS	LCSD	LCS	LCSD	LCS	LCSD	RPD [%]	Recovery	RPD	LCS	LCSD
Lead	4.61	4.72	5.0	5.0	92.2	94.4	2.4	80-120	20		



Environmental Services (SDB)

To: **Life Springs Environmental**

Test Method: 6010B

Attn: Kenneth Meleen

Prep Method: 3005A

**Batch QC Report**

CAM W.E.T. (STLC) Lead

Laboratory Control Spike (LCS/LCSD)		Soil		QC Batch # 1999/08/27-02.15	
LCS:	1999/08/27-02.15-022	Extracted:	08/27/1999 07:48	Analyzed:	08/27/1999 11:21
LCSD:	1999/08/27-02.15-023	Extracted:	08/27/1999 07:48	Analyzed:	08/27/1999 11:25

Compound	Conc. [ mg/L ]		Exp. Conc. [ mg/L ]		Recovery [%]		RPD	Ctrl. Limits [%]		Flags	
	LCS	LCSD	LCS	LCSD	LCS	LCSD		Recovery	RPD	LCS	LCSD
Lead	4.61	4.72	5.00	5.00	92.2	94.4	2.4	80-120	20		

Environmental Services (SDB)

To: Life Springs Environmental  
 Attn.: Kenneth Meleen

Test Method: 6010B  
 Prep Method: 3005A

**Batch QC Report**  
 CAM W.E.T. (STLC) Lead

<b>Matrix Spike ( MS / MSD )</b>	<b>Soil</b>	<b>QC Batch # 1999/08/27-02.15</b>
Sample ID: <b>W.O. Stockpile South</b>		Lab Sample ID: 1999-08-0336-001
MS: 1999/08/27-02.15-004 Extracted: 08/27/1999	Analyzed: 08/27/1999	Dilution: 1.0
MSD: 1999/08/27-02.15-005 Extracted: 08/27/1999	Analyzed: 08/27/1999	Dilution: 1.0

Compound	Conc [ mg/L ]			Exp.Conc. [ mg/L ]		Recovery [%]		RPD [%]	Ctrl. Limits [%]		Flags	
	MS	MSD	Sample	MS	MSD	MS	MSD		Recovery	RPD	MS	MSD
Lead	6.30	6.24	1.85	5.	5.0	89.0	87.8	1.4	75-125	20		

Environmental Services (SDB)

To: **Life Springs Environmental**

Test Method: 6010B

Attn.: Kenneth Meleen

Prep Method: 3005A

**Batch QC Report**

CAM W.E.T. (STLC) Lead

<b>Matrix Spike ( MS / MSD )</b>	<b>Soil</b>	<b>QC Batch # 1999/08/27-02.15</b>
Sample ID: <b>W.O. Stockpile South</b>		Lab Sample ID: 1999-08-0336-001
MS: 1999/08/27-02.15-025	Extracted: 08/27/1999 07:48	Analyzed: 08/27/1999 11:34 Dilution: 1.0
MSD: 1999/08/27-02.15-026	Extracted: 08/27/1999 07:48	Analyzed: 08/27/1999 11:38 Dilution: 1.0

Compound	Conc [ mg/L ]			Exp.Conc. [ mg/L ]		Recovery [%]		RPD [%]	Ctrl. Limits [%]		Flags	
	MS	MSD	Sample	MS	MSD	MS	MSD		Recovery	RPD	MS	MSD
Lead	6.30	6.24	1.85	5.00	5.00	89.0	87.8	1.4	75-125	20		

# CHROMALAB, INC.

Environmental Services (SDB) (DOI IS 1084)

## 99-08-0336

1220 Quarry Lane • Placenton, California 94566-4756  
510/404-1919 • Facsimile 510/404-1098

Reference #: 47566

### Chain of Custody

DATE August 19, 1999 PAGE 1 OF 1

PROJ MGR <u>Kenneth L. Meleen</u> COMPANY <u>Life Springs Environmental, Inc.</u> ADDRESS <u>3275 Stevens Creek Blvd., #208</u> <u>San Jose, CA 95117</u>					<b>ANALYSIS REPORT</b>																								
SAMPLES (SIGNATURE) <u>Kenneth L. Meleen</u> (PHONE NO.) (408) 243-9292 (FAX NO.) (408) 243-9696					<input type="checkbox"/> TPH-EPA 8015, 8020 <input type="checkbox"/> Gas w/ <input type="checkbox"/> STEX DMTRE	<input type="checkbox"/> PURGEABLE AROMATICS <input type="checkbox"/> STEX (EPA 8020)	<input type="checkbox"/> TPH-Diesel (EPA 8015M)	<input type="checkbox"/> TPH (EPA 8015M) <input type="checkbox"/> Chlorinated, Chlorinated, O.M.G.	<input type="checkbox"/> PURGEABLE HALOCARBOHS, <input type="checkbox"/> (BYOCH) (EPA 8016)	<input type="checkbox"/> VOLATILE ORGANICS <input type="checkbox"/> (VOCs) (EPA 8260)	<input type="checkbox"/> SEMI-VOLATILES <input type="checkbox"/> (EPA 8270)	<input type="checkbox"/> TOTAL OIL AND GREASE <input type="checkbox"/> (SM 5520 B+F, E+F)	<input type="checkbox"/> PESTICIDES (EPA 9090) <input type="checkbox"/> PCB'S (EPA 9090)	<input type="checkbox"/> PMA's by <input type="checkbox"/> 8270 <input type="checkbox"/> 8310	<input type="checkbox"/> Spec. Cond. <input type="checkbox"/> TSS <input type="checkbox"/> TDS	<input checked="" type="checkbox"/> LUFT METALS: <u>TTLc 4</u> <input type="checkbox"/> Cd, Cr, (Pb), Ni, Zn, <u>STLc</u>	<input type="checkbox"/> CAM 17 METALS <input type="checkbox"/> (EPA 8010/7470/7471)	<input type="checkbox"/> TOTAL LEAD	<input type="checkbox"/> DWL (STLc) <input type="checkbox"/> TOLP	<input type="checkbox"/> Equivalent Characterization <input type="checkbox"/> PE (24 hr hold time for F20)	<input type="checkbox"/> NUMBER OF CONTAINERS								
SAMPLE ID.	DATE	TIME	MATRIX	PRESERV.																									
<u>W.D. Stankpile South</u>	<u>8/19/99</u>	<u>12:00</u>	<u>Soil</u>	<u>---</u>																	<u>1</u>								
<b>PROJECT INFORMATION</b>					<b>SAMPLE RECEIPT</b>					<b>RELINQUISHED BY 1</b>					<b>RELINQUISHED BY 2</b>					<b>RELINQUISHED BY 3</b>									
PROJECT NAME <u>R.T. Mahan Co.</u>					TOTAL NO. OF CONTAINERS <u>1</u>					SIGNATURE <u>Kenneth L. Meleen 14/6</u> (TIME)					SIGNATURE <u>F. Mowatt 8/20</u> (TIME)					SIGNATURE <u>Ken Kewenart 8/20/99</u> (TIME)									
PROJECT NUMBER <u>980412</u>					HEAD SPACE					PRINTED NAME <u>Kenneth L. Meleen 8/20/99</u> (DATE)					PRINTED NAME <u>F. Mowatt 8/20</u> (DATE)					PRINTED NAME <u>Ken Kewenart 8/20/99</u> (DATE)									
P.O.# <u>L55-197-99</u>					TEMPERATURE					COMPANY <u>Life Springs Environmental</u>					COMPANY <u>C/L</u>					COMPANY									
TAT <input checked="" type="checkbox"/> STANDARD 5-DAY					CONFORMS TO RECORD					OTHER					RECEIVED BY <u>F. Mowatt 14.16</u> (TIME)					RECEIVED BY <u>Ken Kewenart 1700</u> (TIME)					RECEIVED BY (I ADDITORY) 3				
Report: <input type="checkbox"/> Routine <input type="checkbox"/> Level 2 <input type="checkbox"/> Level 3 <input type="checkbox"/> Level 4 <input type="checkbox"/> Electronic Report					SPECIAL INSTRUCTIONS/COMMENTS: <u>Analyze Sample for Lead only</u>					COMPANY <u>C/L</u>					COMPANY <u>C/L</u>					COMPANY <u>LAB</u>									

**Life Springs Environmental**  
3275 Stevens Creek Blvd., Suite 208  
San Jose, CA 95117-1148

Attn.: Mr. Kenneth Meleen

Project: 98041.2  
R.T. Nahas Co.

Dear Mr. Meleen,

Attached is our report for your samples received on Wednesday September 8, 1999. This report has been reviewed and approved for release. Reproduction of this report is permitted only in its entirety.

Please note that any unused portion of the samples will be discarded after October 8, 1999 unless you have requested otherwise. We appreciate the opportunity to be of service to you. If you have any questions, please call me at (925) 484-1919.

Sincerely,

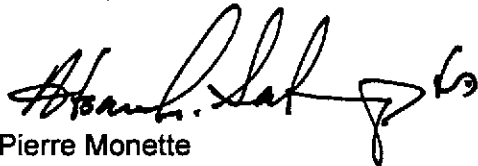

Pierre Monette

Total Oil & Grease

**Life Springs Environmental**



3275 Stevens Creek Blvd., Suite 208  
San Jose, CA 95117-1148

Attn: Kenneth Meleen

Phone: (408) 243-9292 Fax: (408) 243-9696

Project #: 98041.2

Project: R.T. Nahas Co.

**Samples Reported**

Sample ID	Matrix	Date Sampled	Lab #
WO-11.5	Soil	09/08/1999 10:40	4

To: **Life Springs Environmental**

Test Method: 5520 E

Attn.: Kenneth Meleen

Prep Method: 5520 E

Total Oil & Grease

Sample ID: <b>WO-11.5</b>	Lab Sample ID: <b>1999-09-0094-004</b>
Project: 98041.2 R.T. Nahas Co.	Received: 09/08/1999 12:50
Sampled: 09/08/1999 10:40	Extracted: 09/14/1999
Matrix: Soil	QC-Batch: 1999/09/14-01.23

Compound	Result	Rep.Limit	Units	Dilution	Analyzed	Flag
Oil & Grease (total)	ND	50	mg/Kg	1.00	09/15/1999	

To: **Life Springs Environmental**  
Attn.: Kenneth Meleen

Test Method: 5520 E  
Prep Method: 5520 E

**Batch QC Report**  
Total Oil & Grease

<b>Method Blank</b>	<b>Soil</b>	<b>QC Batch # 1999/09/14-01.23</b>
MB: 1999/09/14-01.23-001		Date Extracted: 09/14/1999

Compound	Result	Rep.Limit	Units	Analyzed	Flag
Oil & Grease (total)	ND	50	mg/Kg	09/15/1999	



To: Life Springs Environmental

Test Method: 5520 E

Attn: Kenneth Meleen

Prep Method: 5520 E

**Batch QC Report**

Total Oil & Grease

Laboratory Control Spike (LCS/LCSD)		Soil		QC Batch # 1999/09/14-01.23	
LCS:	1999/09/14-01.23-002	Extracted:	09/14/1999	Analyzed:	09/15/1999
LCSD:	1999/09/14-01.23-003	Extracted:	09/14/1999	Analyzed:	09/15/1999

Compound	Conc. [ mg/Kg ]		Exp.Conc. [ mg/Kg ]		Recovery [%]			RPD		Ctrl. Limits [%]		Flags	
	LCS	LCSD	LCS	LCSD	LCS	LCSD	RPD	Recovery	RPD	LCS	LCSD		
Oil & Grease (total)	410	444	400	400	102.5	111.0	8.0	80-120	20				

Diesel

**Life Springs Environmental**



3275 Stevens Creek Blvd., Suite 208  
San Jose, CA 95117-1148

Attn: Kenneth Meleñ

Phone: (408) 243-9292 Fax: (408) 243-9696

Project #: 98041.2

Project: R.T. Nahas Co.

### Samples Reported

Sample ID	Matrix	Date Sampled	Lab #
North Stockpile Composite	Soil	09/08/1999	1
East Stockpile Composite	Soil	09/08/1999	2
West Stockpile Composite	Soil	09/08/1999	3
WO-11.5	Soil	09/08/1999 10:40	4

# CHROMALAB, INC.

Environmental Services (SDB)

Submission #: 1999-09-0094

To: Life Springs Environmental

Test Method: 8015m

Attn.: Kenneth Meleen

Prep Method: 3550/8015M

Diesel

Sample ID:	North Stockpile Composite	Lab Sample ID:	1999-09-0094-001
Project:	98041.2 R.T. Nahas Co.	Received:	09/08/1999 12:50
Sampled:	09/08/1999	Extracted:	09/13/1999 09:00
Matrix:	Soil	QC-Batch:	1999/09/13-01.10

Compound	Result	Rep.Limit	Units	Dilution	Analyzed	Flag
Diesel	5.7	1.0	mg/Kg	1.00	09/13/1999 16:38	ndp
<i>Surrogate(s)</i> o-Terphenyl	92.8	60-130	%	1.00	09/13/1999 16:38	

1220 Quarry Lane \* Pleasanton, CA 94566-4756  
Telephone: (925) 484-1919 \* Facsimile: (925) 484-1096

To: **Life Springs Environmental**

Test Method: 8015m

Attn.: Kenneth Meleen

Prep Method: 3550/8015M

Diesel

Sample ID: <b>East Stockpile Composite</b>	Lab Sample ID: <b>1999-09-0094-002</b>
Project: 98041.2 R.T. Nahas Co.	Received: 09/08/1999 12:50
Sampled: 09/08/1999	Extracted: 09/13/1999 09:00
Matrix: Soil	QC-Batch: 1999/09/13-01.10

Compound	Result	Rep.Limit	Units	Dilution	Analyzed	Flag
Diesel	8.0	1.0	mg/Kg	1.00	09/13/1999 15:51	ndp
<b>Surrogate(s)</b> o-Terphenyl	101.9	60-130	%	1.00	09/13/1999 15:51	

To: **Life Springs Environmental**

Test Method: 8015m

Attn.: Kenneth Meleen

Prep Method: 3550/8015M

Diesel

Sample ID: <b>West Stockpile Composite</b>	Lab Sample ID: <b>1999-09-0094-003</b>
Project: 98041.2 R.T. Nahas Co.	Received: 09/08/1999 12:50
Sampled: 09/08/1999	Extracted: 09/13/1999 09:00
Matrix: Soil	QC-Batch: 1999/09/13-01.10

Compound	Result	Rep.Limit	Units	Dilution	Analyzed	Flag
Diesel	3.3	1.0	mg/Kg	1.00	09/13/1999 15:04	ndp
<b>Surrogate(s)</b> o-Terphenyl	81.4	60-130	%	1.00	09/13/1999 15:04	

# CHROMALAB, INC.

Environmental Services (SDB)

Submission #: 1999-09-0094

To: **Life Springs Environmental**

Test Method: 8015m

Attn.: Kenneth Meleen

Prep Method: 3550/8015M

Diesel

Sample ID: <b>WO-11.5</b>	Lab Sample ID: <b>1999-09-0094-004</b>
Project: 98041.2 R.T. Nahas Co.	Received: 09/08/1999 12:50
Sampled: 09/08/1999 10:40	Extracted: 09/13/1999 09:00
Matrix: Soil	QC-Batch: 1999/09/13-01.10

Compound	Result	Rep.Limit	Units	Dilution	Analyzed	Flag
Diesel	1.2	1.0	mg/Kg	1.00	09/13/1999 14:17	ndp
<b>Surrogate(s)</b> o-Terphenyl	63.5	60-130	%	1.00	09/13/1999 14:17	

1220 Quarry Lane \* Pleasanton, CA 94566-4756

Telephone: (925) 484-1919 \* Facsimile: (925) 484-1096

To: **Life Springs Environmental**  
Attn.: Kenneth Meleen

Test Method: 8015m  
Prep Method: 3550/8015M

**Batch QC Report**  
Diesel

<b>Method Blank</b>	<b>Soil</b>	<b>QC Batch # 1999/09/13-01.10</b>
MB: 1999/09/13-01.10-001		Date Extracted: 09/13/1999 09:00

Compound	Result	Rep.Limit	Units	Analyzed	Flag
Diesel	ND	1	mg/Kg	09/13/1999 14:15	
<b>Surrogate(s)</b> o-Terphenyl	87.5	60-130	%	09/13/1999 14:15	

To: Life Springs Environmental

Test Method: 8015m

Attn: Kenneth Meleen

Prep Method: 3550/8015M

## Batch QC Report

Diesel

Laboratory Control Spike (LCS/LCSD)	Soil	QC Batch # 1999/09/13-01.10
LCS: 1999/09/13-01.10-002	Extracted: 09/13/1999 09:00	Analyzed: 09/13/1999 11:27
LCSD: 1999/09/13-01.10-003	Extracted: 09/13/1999 09:00	Analyzed: 09/13/1999 12:00

Compound	Conc. [ mg/Kg ]		Exp.Conc. [ mg/Kg ]		Recovery [%]		RPD	Ctrl. Limits [%]		Flags	
	LCS	LCSD	LCS	LCSD	LCS	LCSD		Recovery	RPD	LCS	LCSD
Diesel	34.6	28.1	41.7	41.7	83.0	67.4	20.7	60-130	25		
<b>Surrogate(s)</b> o-Terphenyl	23.4	21.5	20.0	20.0	117.0	107.5		60-130			



To: **Life Springs Environmental**  
Attn: Kenneth Meleen

Test Method: 8015m  
Prep Method: 3550/8015M

## Legend & Notes

Diesel

### Analyte Flags

ndp

Hydrocarbon reported does not match the pattern of our Diesel standard

Semi-volatile Organic Compounds

<b>Life Springs Environmental</b>	☒ 3275 Stevens Creek Blvd., Suite 208 San Jose, CA 95117-1148
Attn: Kenneth Meleen	Phone: (408) 243-9292 Fax: (408) 243-9696
Project #: 98041.2	Project: R.T. Nahas Co.

**Samples Reported**

Sample ID	Matrix	Date Sampled	Lab #
WO-11.5	Soil	09/08/1999 10:40	4

To: Life Springs Environmental

Test Method: 8270A

Attn.: Kenneth Meleen

Prep Method: 3550/8270A

Semi-volatile Organic Compounds

Sample ID: <b>WO-11.5</b>	Lab Sample ID: <b>1999-09-0094-004</b>
Project: 98041.2 R.T. Nahas Co.	Received: 09/08/1999 12:50
Sampled: 09/08/1999 10:40	Extracted: 09/09/1999 14:22
Matrix: Soil	QC-Batch: 1999/09/09-02.11

Compound	Result	Rep.Limit	Units	Dilution	Analyzed	Flag
Phenol	ND	0.10	mg/Kg	1.00	09/09/1999 18:12	
Bis(2-chloroethyl)ether	ND	0.10	mg/Kg	1.00	09/09/1999 18:12	
2-Chlorophenol	ND	0.10	mg/Kg	1.00	09/09/1999 18:12	
1,3-Dichlorobenzene	ND	0.10	mg/Kg	1.00	09/09/1999 18:12	
1,4-Dichlorobenzene	ND	0.10	mg/Kg	1.00	09/09/1999 18:12	
Benzyl alcohol	ND	0.20	mg/Kg	1.00	09/09/1999 18:12	
1,2-Dichlorobenzene	ND	0.10	mg/Kg	1.00	09/09/1999 18:12	
2-Methylphenol	ND	0.10	mg/Kg	1.00	09/09/1999 18:12	
Bis(2-chloroisopropyl) ether	ND	0.10	mg/Kg	1.00	09/09/1999 18:12	
4-Methylphenol	ND	0.20	mg/Kg	1.00	09/09/1999 18:12	
N-Nitroso-di-n-propylamine	ND	0.10	mg/Kg	1.00	09/09/1999 18:12	
Hexachloroethane	ND	0.10	mg/Kg	1.00	09/09/1999 18:12	
Nitrobenzene	ND	0.10	mg/Kg	1.00	09/09/1999 18:12	
Isophorone	ND	0.10	mg/Kg	1.00	09/09/1999 18:12	
2-Nitrophenol	ND	0.10	mg/Kg	1.00	09/09/1999 18:12	
2,4-Dimethylphenol	ND	0.10	mg/Kg	1.00	09/09/1999 18:12	
Bis(2-chloroethoxy) methane	ND	0.10	mg/Kg	1.00	09/09/1999 18:12	
2,4-Dichlorophenol	ND	0.10	mg/Kg	1.00	09/09/1999 18:12	
1,2,4-Trichlorobenzene	ND	0.10	mg/Kg	1.00	09/09/1999 18:12	
Naphthalene	ND	0.10	mg/Kg	1.00	09/09/1999 18:12	
4-Chloroaniline	ND	0.20	mg/Kg	1.00	09/09/1999 18:12	
Hexachlorobutadiene	ND	0.10	mg/Kg	1.00	09/09/1999 18:12	
4-Chloro-3-methylphenol	ND	0.20	mg/Kg	1.00	09/09/1999 18:12	
2-Methylnaphthalene	ND	0.10	mg/Kg	1.00	09/09/1999 18:12	
Hexachlorocyclopentadiene	ND	0.10	mg/Kg	1.00	09/09/1999 18:12	
2,4,6-Trichlorophenol	ND	0.10	mg/Kg	1.00	09/09/1999 18:12	
2,4,5-Trichlorophenol	ND	0.10	mg/Kg	1.00	09/09/1999 18:12	
2-Chloronaphthalene	ND	0.10	mg/Kg	1.00	09/09/1999 18:12	
2-Nitroaniline	ND	0.50	mg/Kg	1.00	09/09/1999 18:12	
Dimethyl phthalate	ND	0.50	mg/Kg	1.00	09/09/1999 18:12	
Acenaphthylene	ND	0.10	mg/Kg	1.00	09/09/1999 18:12	
3-Nitroaniline	ND	0.10	mg/Kg	1.00	09/09/1999 18:12	
Acenaphthene	ND	0.10	mg/Kg	1.00	09/09/1999 18:12	
2,4-Dinitrophenol	ND	0.50	mg/Kg	1.00	09/09/1999 18:12	
4-Nitrophenol	ND	0.50	mg/Kg	1.00	09/09/1999 18:12	

1220 Quarry Lane \* Pleasanton, CA 94566-4756

Telephone: (925) 484-1919 \* Facsimile: (925) 484-1096

To: Life Springs Environmental

Test Method: 8270A

Attn.: Kenneth Meleen

Prep Method: 3550/8270A

Semi-volatile Organic Compounds

Sample ID: <b>WO-11.5</b>	Lab Sample ID: <b>1999-09-0094-004</b>
Project: 98041.2 R.T. Nahas Co.	Received: 09/08/1999 12:50
Sampled: 09/08/1999 10:40	Extracted: 09/09/1999 14:22
Matrix: Soil	QC-Batch: 1999/09/09-02.11

Compound	Result	Rep.Limit	Units	Dilution	Analyzed	Flag
Dibenzofuran	ND	0.10	mg/Kg	1.00	09/09/1999 18:12	
2,4-Dinitrotoluene	ND	0.10	mg/Kg	1.00	09/09/1999 18:12	
2,6-Dinitrotoluene	ND	0.20	mg/Kg	1.00	09/09/1999 18:12	
Diethyl phthalate	ND	0.50	mg/Kg	1.00	09/09/1999 18:12	
4-Chlorophenyl phenyl ether	ND	0.10	mg/Kg	1.00	09/09/1999 18:12	
Fluorene	ND	0.10	mg/Kg	1.00	09/09/1999 18:12	
4-Nitroaniline	ND	0.50	mg/Kg	1.00	09/09/1999 18:12	
2-Methyl-4,6-dinitrophenol	ND	0.50	mg/Kg	1.00	09/09/1999 18:12	
N-Nitrosodiphenylamine	ND	0.10	mg/Kg	1.00	09/09/1999 18:12	
4-Bromophenyl phenyl ether	ND	0.10	mg/Kg	1.00	09/09/1999 18:12	
Hexachlorobenzene	ND	0.10	mg/Kg	1.00	09/09/1999 18:12	
Pentachlorophenol	ND	0.50	mg/Kg	1.00	09/09/1999 18:12	
Phenanthrene	ND	0.10	mg/Kg	1.00	09/09/1999 18:12	
Anthracene	ND	0.10	mg/Kg	1.00	09/09/1999 18:12	
Di-n-butyl phthalate	ND	2.0	mg/Kg	1.00	09/09/1999 18:12	
Fluoranthene	ND	0.10	mg/Kg	1.00	09/09/1999 18:12	
Pyrene	ND	0.10	mg/Kg	1.00	09/09/1999 18:12	
Butyl benzyl phthalate	ND	0.50	mg/Kg	1.00	09/09/1999 18:12	
3,3-Dichlorobenzidine	ND	0.20	mg/Kg	1.00	09/09/1999 18:12	
Benzo(a)anthracene	ND	0.10	mg/Kg	1.00	09/09/1999 18:12	
bis(2-Ethylhexyl) phthalate	ND	0.50	mg/Kg	1.00	09/09/1999 18:12	
Chrysene	ND	0.10	mg/Kg	1.00	09/09/1999 18:12	
Di-n-octyl phthalate	ND	0.50	mg/Kg	1.00	09/09/1999 18:12	
Benzo(b)fluoranthene	ND	0.10	mg/Kg	1.00	09/09/1999 18:12	
Benzo(k)fluoranthene	ND	0.20	mg/Kg	1.00	09/09/1999 18:12	
Benzo(a)pyrene	ND	0.020	mg/Kg	1.00	09/09/1999 18:12	
Indeno(1,2,3-c,d)pyrene	ND	0.20	mg/Kg	1.00	09/09/1999 18:12	
Dibenzo(a,h)anthracene	ND	0.20	mg/Kg	1.00	09/09/1999 18:12	
Benzo(g,h,i)perylene	ND	0.20	mg/Kg	1.00	09/09/1999 18:12	
Benzoic acid	ND	0.50	mg/Kg	1.00	09/09/1999 18:12	
<b>Surrogate(s)</b>						
Nitrobenzene-d5	89.9	23-120	%	1.00	09/09/1999 18:12	
2-Fluorobiphenyl	81.0	30-115	%	1.00	09/09/1999 18:12	
p-Terphenyl-d14	91.1	18-137	%	1.00	09/09/1999 18:12	
Phenol-d5	73.2	24-113	%	1.00	09/09/1999 18:12	

1220 Quarry Lane \* Pleasanton, CA 94566-4756

Telephone: (925) 484-1919 \* Facsimile: (925) 484-1096

# CHROMALAB, INC.

Environmental Services (SDB)

Submission #: 1999-09-0094

To: Life Springs Environmental

Test Method: 8270A

Attn.: Kenneth Meleen

Prep Method: 3550/8270A

## Semi-volatile Organic Compounds

Sample ID: <b>WO-11.5</b>	Lab Sample ID: <b>1999-09-0094-004</b>
Project: 98041.2 R.T. Nahas Co.	Received: 09/08/1999 12:50
Sampled: 09/08/1999 10:40	Extracted: 09/09/1999 14:22
Matrix: Soil	QC-Batch: 1999/09/09-02.11

Compound	Result	Rep.Limit	Units	Dilution	Analyzed	Flag
<b>Surrogate(s)</b>						
2-Fluorophenol	63.6	25-121	%	1.00	09/09/1999 18:12	
2,4,6-Tribromophenol	102.8	19-122	%	1.00	09/09/1999 18:12	

1220 Quarry Lane \* Pleasanton, CA 94566-4756  
Telephone: (925) 484-1919 \* Facsimile: (925) 484-1096

To: **Life Springs Environmental**  
 Attn.: Kenneth Meleen

Test Method: 8270A  
 Prep Method: 3550/8270A

**Batch QC Report**  
 Semi-volatile Organic Compounds

<b>Method Blank</b>	<b>Soil</b>	<b>QC Batch # 1999/09/09-02.11</b>
MB: 1999/09/09-02.11-001		Date Extracted: 09/09/1999

Compound	Result	Rep.Limit	Units	Analyzed	Flag
Phenol	ND	0.10	mg/Kg	09/09/1999 12:55	
Bis(2-chloroethyl)ether	ND	0.10	mg/Kg	09/09/1999 12:55	
2-Chlorophenol	ND	0.10	mg/Kg	09/09/1999 12:55	
1,3-Dichlorobenzene	ND	0.10	mg/Kg	09/09/1999 12:55	
1,4-Dichlorobenzene	ND	0.10	mg/Kg	09/09/1999 12:55	
Benzyl alcohol	ND	0.20	mg/Kg	09/09/1999 12:55	
1,2-Dichlorobenzene	ND	0.10	mg/Kg	09/09/1999 12:55	
2-Methylphenol	ND	0.10	mg/Kg	09/09/1999 12:55	
Bis(2-chloroisopropyl) ether	ND	0.10	mg/Kg	09/09/1999 12:55	
4-Methylphenol	ND	0.20	mg/Kg	09/09/1999 12:55	
N-Nitroso-di-n-propylamine	ND	0.10	mg/Kg	09/09/1999 12:55	
Hexachloroethane	ND	0.10	mg/Kg	09/09/1999 12:55	
Nitrobenzene	ND	0.10	mg/Kg	09/09/1999 12:55	
Isophorone	ND	0.10	mg/Kg	09/09/1999 12:55	
2-Nitrophenol	ND	0.10	mg/Kg	09/09/1999 12:55	
2,4-Dimethylphenol	ND	0.10	mg/Kg	09/09/1999 12:55	
Bis(2-chloroethoxy) methane	ND	0.10	mg/Kg	09/09/1999 12:55	
2,4-Dichlorophenol	ND	0.10	mg/Kg	09/09/1999 12:55	
1,2,4-Trichlorobenzene	ND	0.10	mg/Kg	09/09/1999 12:55	
Naphthalene	ND	0.10	mg/Kg	09/09/1999 12:55	
4-Chloroaniline	ND	0.20	mg/Kg	09/09/1999 12:55	
Hexachlorobutadiene	ND	0.10	mg/Kg	09/09/1999 12:55	
4-Chloro-3-methylphenol	ND	0.20	mg/Kg	09/09/1999 12:55	
2-Methylnaphthalene	ND	0.10	mg/Kg	09/09/1999 12:55	
Hexachlorocyclopentadiene	ND	0.10	mg/Kg	09/09/1999 12:55	
2,4,6-Trichlorophenol	ND	0.10	mg/Kg	09/09/1999 12:55	
2,4,5-Trichlorophenol	ND	0.10	mg/Kg	09/09/1999 12:55	
2-Chloronaphthalene	ND	0.10	mg/Kg	09/09/1999 12:55	
2-Nitroaniline	ND	0.50	mg/Kg	09/09/1999 12:55	
Dimethyl phthalate	ND	0.50	mg/Kg	09/09/1999 12:55	

1220 Quarry Lane \* Pleasanton, CA 94566-4756

Telephone: (925) 484-1919 \* Facsimile: (925) 484-1096

To: Life Springs Environmental  
 Attn.: Kenneth Meleen

Test Method: 8270A  
 Prep Method: 3550/8270A

**Batch QC Report**  
 Semi-volatile Organic Compounds

<b>Method Blank</b>	<b>Soil</b>	<b>QC Batch # 1999/09/09-02.11</b>
MB: 1999/09/09-02.11-001		Date Extracted: 09/09/1999

Compound	Result	Rep.Limit	Units	Analyzed	Flag
Acenaphthylene	ND	0.10	mg/Kg	09/09/1999 12:55	
3-Nitroaniline	ND	0.10	mg/Kg	09/09/1999 12:55	
Acenaphthene	ND	0.10	mg/Kg	09/09/1999 12:55	
2,4-Dinitrophenol	ND	0.50	mg/Kg	09/09/1999 12:55	
4-Nitrophenol	ND	0.50	mg/Kg	09/09/1999 12:55	
Dibenzofuran	ND	0.10	mg/Kg	09/09/1999 12:55	
2,4-Dinitrotoluene	ND	0.10	mg/Kg	09/09/1999 12:55	
2,6-Dinitrotoluene	ND	0.20	mg/Kg	09/09/1999 12:55	
Diethyl phthalate	ND	0.50	mg/Kg	09/09/1999 12:55	
4-Chlorophenyl phenyl ether	ND	0.10	mg/Kg	09/09/1999 12:55	
Fluorene	ND	0.10	mg/Kg	09/09/1999 12:55	
4-Nitroaniline	ND	0.50	mg/Kg	09/09/1999 12:55	
2-Methyl-4,6-dinitrophenol	ND	0.50	mg/Kg	09/09/1999 12:55	
N-Nitrosodiphenylamine	ND	0.10	mg/Kg	09/09/1999 12:55	
4-Bromophenyl phenyl ether	ND	0.10	mg/Kg	09/09/1999 12:55	
Hexachlorobenzene	ND	0.10	mg/Kg	09/09/1999 12:55	
Pentachlorophenol	ND	0.50	mg/Kg	09/09/1999 12:55	
Phenanthrene	ND	0.10	mg/Kg	09/09/1999 12:55	
Anthracene	ND	0.10	mg/Kg	09/09/1999 12:55	
Di-n-butyl phthalate	ND	2.0	mg/Kg	09/09/1999 12:55	
Fluoranthene	ND	0.10	mg/Kg	09/09/1999 12:55	
Pyrene	ND	0.10	mg/Kg	09/09/1999 12:55	
Butyl benzyl phthalate	ND	0.50	mg/Kg	09/09/1999 12:55	
3,3-Dichlorobenzidine	ND	0.20	mg/Kg	09/09/1999 12:55	
Benzo(a)anthracene	ND	0.10	mg/Kg	09/09/1999 12:55	
bis(2-Ethylhexyl) phthalate	ND	0.50	mg/Kg	09/09/1999 12:55	
Chrysene	ND	0.10	mg/Kg	09/09/1999 12:55	
Di-n-octyl phthalate	ND	0.50	mg/Kg	09/09/1999 12:55	
Benzo(b)fluoranthene	ND	0.10	mg/Kg	09/09/1999 12:55	
Benzo(k)fluoranthene	ND	0.20	mg/Kg	09/09/1999 12:55	

To: **Life Springs Environmental**  
 Attn.: Kenneth Meleen

Test Method: 8270A  
 Prep Method: 3550/8270A

**Batch QC Report**  
 Semi-volatile Organic Compounds

<b>Method Blank</b>	<b>Soil</b>	<b>QC Batch # 1999/09/09-02.11</b>
MB: 1999/09/09-02.11-001		Date Extracted: 09/09/1999

Compound	Result	Rep.Limit	Units	Analyzed	Flag
Benzo(a)pyrene	ND	0.02	mg/Kg	09/09/1999 12:55	
Indeno(1,2,3-c,d)pyrene	ND	0.20	mg/Kg	09/09/1999 12:55	
Dibenzo(a,h)anthracene	ND	0.20	mg/Kg	09/09/1999 12:55	
Benzo(g,h,i)perylene	ND	0.20	mg/Kg	09/09/1999 12:55	
Benzoic acid	ND	0.50	mg/Kg	09/09/1999 12:55	
<b>Surrogate(s)</b>					
Nitrobenzene-d5	85.6	23-120	%	09/09/1999 12:55	
2-Fluorobiphenyl	78.8	30-115	%	09/09/1999 12:55	
p-Terphenyl-d14	90.0	18-137	%	09/09/1999 12:55	
Phenol-d5	77.6	24-113	%	09/09/1999 12:55	
2-Fluorophenol	63.6	25-121	%	09/09/1999 12:55	
2,4,6-Tribromophenol	89.6	19-122	%	09/09/1999 12:55	



To: Life Springs Environmental

Test Method: 8270A

Attn: Kenneth Meleen

Prep Method: 3550/8270A

## Batch QC Report

### Semi-volatile Organic Compounds

Laboratory Control Spike (LCS/LCSD)		Soil	QC Batch # 1999/09/09-02.11
LCS:	1999/09/09-02.11-002	Extracted: 09/09/1999	Analyzed: 09/09/1999 13:46
LCSD:	1999/09/09-02.11-003	Extracted: 09/09/1999	Analyzed: 09/09/1999 14:37

Compound	Conc. [ mg/Kg ]		Exp.Conc. [ mg/Kg ]		Recovery [%]		RPD	Ctrl. Limits [%]		Flags	
	LCS	LCSD	LCS	LCSD	LCS	LCSD		Recovery	RPD	LCS	LCSD
Phenol	1.41	1.38	2.00	2.00	70.5	69.0	2.2	20-90	35		
2-Chlorophenol	1.33	1.37	2.00	2.00	66.5	68.5	3.0	27-123	35		
1,4-Dichlorobenzene	0.646	0.680	1.000	1.000	64.6	68.0	5.1	28-104	30		
N-Nitroso-di-n-propylamin	0.710	0.678	1.000	1.000	71.0	67.8	4.6	25-114	39		
1,2,4-Trichlorobenzene	0.606	0.617	1.000	1.000	60.6	61.7	1.8	38-107	35		
4-Chloro-3-methylphenol	1.41	1.46	2.00	2.00	70.5	73.0	3.5	26-103	33		
Acenaphthene	0.711	0.747	1.000	1.000	71.1	74.7	4.9	49-102	30		
4-Nitrophenol	1.71	1.77	2.00	2.00	85.5	88.5	3.4	17-109	35		
2,4-Dinitrotoluene	0.863	0.874	1.000	1.000	86.3	87.4	1.3	28-89	38		
Pentachlorophenol	1.47	1.50	2.00	2.00	73.5	75.0	2.0	11-114	35		
Pyrene	0.840	0.835	1.000	1.000	84.0	83.5	0.6	25-117	35		
<b>Surrogate(s)</b>											
Nitrobenzene-d5	21.5	21.7	25	25	86.0	86.8		23-120			
2-Fluorobiphenyl	21.4	22.3	25	25	85.6	89.2		30-115			
p-Terphenyl-d14	23.4	24.9	25	25	93.6	99.6		18-137			
Phenol-d5	37.3	40.7	50	50	74.6	81.4		24-113			
2-Fluorophenol	29.2	33.9	50	50	58.4	67.8		25-121			
2,4,6-Tribromophenol	51.9	54.8	50	50	103.8	109.6		19-122			

To: Life Springs Environmental

Attn.: Kenneth Meleen

Test Method: 8270A

Prep Method: 3550/8270A

## Batch QC Report

### Semi-volatile Organic Compounds

Matrix Spike ( MS / MSD )

Soil

QC Batch # 1999/09/09-02.11

Sample ID: WO-11.5

Lab Sample ID: 1999-09-0094-004

MS: 1999/09/09-02.11-004 Extracted: 09/09/1999

Analyzed: 09/09/1999 19:03 Dilution: 1.0

MSD: 1999/09/09-02.11-005 Extracted: 09/09/1999

Analyzed: 09/09/1999 19:53 Dilution: 1.0

Compound	Conc [ mg/Kg ]			Exp.Conc. [ mg/Kg ]		Recovery [%]		RPD [%]	Ctrl. Limits [%]		Flags	
	MS	MSD	Sample	MS	MSD	MS	MSD		Recovery	RPD	MS	MSD
Phenol	1.32	1.28	ND	2.00	2.00	66.0	64.0	3.1	20-90	35		
2-Chlorophenol	1.32	1.16	ND	2.00	2.00	66.0	58.0	12.9	27-123	35		
1,4-Dichlorobenzene	0.641	0.617	ND	1.000	1.000	64.1	61.7	3.8	28-104	30		
N-Nitroso-di-n-propylami	0.731	0.620	ND	1.000	1.000	73.1	62.0	16.4	25-114	39		
1,2,4-Trichlorobenzene	0.615	0.570	ND	1.000	1.000	61.5	57.0	7.6	38-107	35		
4-Chloro-3-methylphenol	1.39	1.36	ND	2.00	2.00	69.5	68.0	2.2	26-103	33		
Acenaphthene	0.683	0.642	ND	1.000	1.000	68.3	64.2	6.2	49-102	30		
4-Nitrophenol	1.59	1.54	ND	2.00	2.00	79.5	77.0	3.2	17-109	35		
2,4-Dinitrotoluene	0.788	0.771	ND	1.000	1.000	78.8	77.1	2.2	28-89	38		
Pentachlorophenol	1.39	1.31	ND	2.00	2.00	69.5	65.5	5.9	11-114	35		
Pyrene	0.759	0.733	ND	1.000	1.000	75.9	73.3	3.5	25-117	35		
<b>Surrogate(s)</b>												
Nitrobenzene-d5	19.3	20.6		25	25	77.2	82.4		23-120			
2-Fluorobiphenyl	17.3	18.8		25	25	69.2	75.2		30-115			
p-Terphenyl-d14	23.2	22.1		25	25	92.8	88.4		18-137			
Phenol-d5	36.8	32.6		50	50	73.6	65.2		24-113			
2-Fluorophenol	28.5	30.4		50	50	57.0	60.8		25-121			
2,4,6-Tribromophenol	49.1	48.3		50	50	98.2	96.6		19-122			

Gas/BTEX

<b>Life Springs Environmental</b>	☒ 3275 Stevens Creek Blvd., Suite 208 San Jose, CA 95117-1148
Attn: Kenneth Meleen	Phone: (408) 243-9292 Fax: (408) 243-9696
Project #: 98041.2	Project: R.T. Nahas Co.

**Samples Reported**

Sample ID	Matrix	Date Sampled	Lab #
North Stockpile Composite	Soil	09/08/1999	1
East Stockpile Composite	Soil	09/08/1999	2
West Stockpile Composite	Soil	09/08/1999	3
WO-11.5	Soil	09/08/1999 10:40	4

To: Life Springs Environmental

Test Method: 8015M  
8020

Attn.: Kenneth Meleen

Prep Method: 5030

Gas/BTEX

Sample ID:	North Stockpile Composite	Lab Sample ID:	1999-09-0094-001
Project:	98041.2 R.T. Nahas Co.	Received:	09/08/1999 12:50
Sampled:	09/08/1999	Extracted:	09/08/1999 20:56
Matrix:	Soil	QC-Batch:	1999/09/08-01.04

Compound	Result	Rep.Limit	Units	Dilution	Analyzed	Flag
Gasoline	ND	1.0	mg/Kg	1.00	09/08/1999 20:56	
Benzene	ND	0.0050	mg/Kg	1.00	09/08/1999 20:56	
Toluene	ND	0.0050	mg/Kg	1.00	09/08/1999 20:56	
Ethyl benzene	ND	0.0050	mg/Kg	1.00	09/08/1999 20:56	
Xylene(s)	ND	0.0050	mg/Kg	1.00	09/08/1999 20:56	
<b>Surrogate(s)</b>						
4-Bromofluorobenzene	69.1	58-124	%	1.00	09/08/1999 20:56	
4-Bromofluorobenzene-FID	65.6	58-124	%	1.00	09/08/1999 20:56	

To: Life Springs Environmental

Test Method: 8015M  
8020

Attn.: Kenneth Meleen

Prep Method: 5030

Gas/BTEX

Sample ID:	<b>East Stockpile Composite</b>	Lab Sample ID:	<b>1999-09-0094-002</b>
Project:	98041.2 R.T. Nahas Co.	Received:	09/08/1999 12:50
Sampled:	09/08/1999	Extracted:	09/08/1999 21:23
Matrix:	Soil	QC-Batch:	1999/09/08-01.04

Compound	Result	Rep.Limit	Units	Dilution	Analyzed	Flag
Gasoline	ND	1.0	mg/Kg	1.00	09/08/1999 21:23	
Benzene	ND	0.0050	mg/Kg	1.00	09/08/1999 21:23	
Toluene	ND	0.0050	mg/Kg	1.00	09/08/1999 21:23	
Ethyl benzene	ND	0.0050	mg/Kg	1.00	09/08/1999 21:23	
Xylene(s)	ND	0.0050	mg/Kg	1.00	09/08/1999 21:23	
<b>Surrogate(s)</b>						
Trifluorotoluene	66.9	53-125	%	1.00	09/08/1999 21:23	
Trifluorotoluene-FID	66.6	53-125	%	1.00	09/08/1999 21:23	

To: Life Springs Environmental

Test Method: 8015M  
8020

Attn.: Kenneth Meleen

Prep Method: 5030

## Gas/BTEX

Sample ID:	<b>West Stockpile Composite</b>	Lab Sample ID:	<b>1999-09-0094-003</b>
Project:	98041.2 R.T. Nahas Co.	Received:	09/08/1999 12:50
Sampled:	09/08/1999	Extracted:	09/09/1999 11:05
Matrix:	Soil	QC-Batch:	1999/09/09-01.04

Compound	Result	Rep.Limit	Units	Dilution	Analyzed	Flag
Gasoline	ND	1.0	mg/Kg	1.00	09/09/1999 11:05	
Benzene	ND	0.0050	mg/Kg	1.00	09/09/1999 11:05	
Toluene	ND	0.0050	mg/Kg	1.00	09/09/1999 11:05	
Ethyl benzene	ND	0.0050	mg/Kg	1.00	09/09/1999 11:05	
Xylene(s)	ND	0.0050	mg/Kg	1.00	09/09/1999 11:05	
<b>Surrogate(s)</b>						
Trifluorotoluene	83.8	53-125	%	1.00	09/09/1999 11:05	
4-Bromofluorobenzene-FID	61.6	58-124	%	1.00	09/09/1999 11:05	

To: **Life Springs Environmental**

Test Method: 8015M  
8020

Attn.: Kenneth Meleen

Prep Method: 5030

Gas/BTEX

Sample ID: <b>WO-11.5</b>	Lab Sample ID: <b>1999-09-0094-004</b>
Project: 98041.2 R.T. Nahas Co.	Received: 09/08/1999 12:50
Sampled: 09/08/1999 10:40	Extracted: 09/09/1999 04:52
Matrix: Soil	QC-Batch: 1999/09/08-01.04

Compound	Result	Rep.Limit	Units	Dilution	Analyzed	Flag
Gasoline	ND	1.0	mg/Kg	1.00	09/09/1999 04:52	
Benzene	ND	0.0050	mg/Kg	1.00	09/09/1999 04:52	
Toluene	ND	0.0050	mg/Kg	1.00	09/09/1999 04:52	
Ethyl benzene	ND	0.0050	mg/Kg	1.00	09/09/1999 04:52	
Xylene(s)	ND	0.0050	mg/Kg	1.00	09/09/1999 04:52	
<b>Surrogate(s)</b>						
Trifluorotoluene	86.3	53-125	%	1.00	09/09/1999 04:52	
4-Bromofluorobenzene-FID	72.9	58-124	%	1.00	09/09/1999 04:52	

To: Life Springs Environmental

Test Method: 8020  
8015M

Attn.: Kenneth Meleen

Prep Method: 5030

**Batch QC Report**  
Gas/BTEX

<b>Method Blank</b>	<b>Soil</b>	<b>QC Batch # 1999/09/08-01.04</b>
MB: 1999/09/08-01.04-001		Date Extracted: 09/08/1999 06:25

Compound	Result	Rep.Limit	Units	Analyzed	Flag
Gasoline	ND	1.0	mg/Kg	09/08/1999 06:25	
Benzene	ND	0.0050	mg/Kg	09/08/1999 06:25	
Toluene	ND	0.0050	mg/Kg	09/08/1999 06:25	
Ethyl benzene	ND	0.0050	mg/Kg	09/08/1999 06:25	
Xylene(s)	ND	0.0050	mg/Kg	09/08/1999 06:25	
<b>Surrogate(s)</b>					
Trifluorotoluene	99.4	53-125	%	09/08/1999 06:25	
4-Bromofluorobenzene-FID	87.6	58-124	%	09/08/1999 06:25	



To: Life Springs Environmental

Test Method: 8020  
8015M

Attn.: Kenneth Meleen

Prep Method: 5030

**Batch QC Report**  
Gas/BTEX

<b>Method Blank</b>	<b>Soil</b>	<b>QC Batch # 1999/09/09-01.04</b>
MB: 1999/09/09-01.04-001		Date Extracted: 09/09/1999 07:03

Compound	Result	Rep.Limit	Units	Analyzed	Flag
Gasoline	ND	1.0	mg/Kg	09/09/1999 07:03	
Benzene	ND	0.0050	mg/Kg	09/09/1999 07:03	
Toluene	ND	0.0050	mg/Kg	09/09/1999 07:03	
Ethyl benzene	ND	0.0050	mg/Kg	09/09/1999 07:03	
Xylene(s)	ND	0.0050	mg/Kg	09/09/1999 07:03	
<b>Surrogate(s)</b>					
Trifluorotoluene	102.8	53-125	%	09/09/1999 07:03	
4-Bromofluorobenzene-FID	93.8	58-124	%	09/09/1999 07:03	

To: **Life Springs Environmental**

Test Method: 8020  
8015M

Attn: Kenneth Meleen

Prep Method: 5030

**Batch QC Report**

**Gas/BTEX**

Laboratory Control Spike (LCS/LCSD)		Soil		QC Batch # 1999/09/08-01.04	
LCS:	1999/09/08-01.04-002	Extracted:	09/08/1999 06:52	Analyzed:	09/08/1999 06:52
LCSD:	1999/09/08-01.04-003	Extracted:	09/08/1999 07:19	Analyzed:	09/08/1999 07:19

Compound	Conc. [ mg/Kg ]		Exp. Conc. [ mg/Kg ]		Recovery [%]		RPD [%]	Ctrl. Limits [%]		Flags	
	LCS	LCSD	LCS	LCSD	LCS	LCSD		Recovery	RPD	LCS	LCSD
Gasoline	0.453	0.412	0.500	0.500	90.6	82.4	9.5	75-125	35		
Benzene	0.0920	0.0918	0.1000	0.1000	92.0	91.8	0.2	77-123	35		
Toluene	0.0892	0.0890	0.1000	0.1000	89.2	89.0	0.2	78-122	35		
Ethyl benzene	0.0881	0.0878	0.1000	0.1000	88.1	87.8	0.3	70-130	35		
Xylene(s)	0.263	0.263	0.300	0.300	87.7	87.7	0.0	75-125	35		
<b>Surrogate(s)</b>											
Trifluorotoluene	500	499	500	500	100.0	99.8		53-125			
4-Bromofluorobenzene-FI	457	398	500	500	91.4	79.6		58-124			

To: Life Springs Environmental

Test Method: 8020  
8015M

Attn: Kenneth Meleen

Prep Method: 5030

## Batch QC Report

Gas/BTEX

Laboratory Control Spike (LCS/LCSD)		Soil		QC Batch # 1999/09/09-01.04	
LCS:	1999/09/09-01.04-002	Extracted:	09/09/1999 07:30	Analyzed:	09/09/1999 07:30
LCSD:	1999/09/09-01.04-003	Extracted:	09/09/1999 07:57	Analyzed:	09/09/1999 07:57

Compound	Conc. [ mg/Kg ]		Exp. Conc. [ mg/Kg ]		Recovery [%]		RPD	Ctrl. Limits [%]		Flags	
	LCS	LCSD	LCS	LCSD	LCS	LCSD		Recovery	RPD	LCS	LCSD
Gasoline	0.484	0.495	0.500	0.500	96.8	99.0	2.2	75-125	35		
Benzene	0.0920	0.0830	0.1000	0.1000	92.0	83.0	10.3	77-123	35		
Toluene	0.0890	0.0800	0.1000	0.1000	89.0	80.0	10.7	78-122	35		
Ethyl benzene	0.0870	0.0780	0.1000	0.1000	87.0	78.0	10.9	70-130	35		
Xylene(s)	0.261	0.237	0.300	0.300	87.0	79.0	9.6	75-125	35		
<b>Surrogate(s)</b>											
Trifluorotoluene	497	472	500	500	99.4	94.4		53-125			
4-Bromofluorobenzene-FI	481	493	500	500	96.2	98.6		58-124			

# CHROMALAB, INC.

Environmental Services (SDB) (DOIS 1094)

## 99-09-0094

1220 Quarry Lane • Pleasanton, California 94566-4758  
510/404-1919 • Facsimile 510/404-1096

Reference #: \_\_\_\_\_

# Chain of Custody

DATE 9/8/99 PAGE 1 OF 2

<b>PROJ MGR</b> <u>Kenneth Meleen</u> <b>COMPANY</b> <u>Life Springs Environmental, Inc.</u> <b>ADDRESS</b> <u>3275 Stevens Creek Blvd #209</u> <u>San Jose, CA 95117</u>		<b>ANALYSIS REPORT</b>																								
<b>SAMPLE EIS (SIGNATURE)</b>  <u>Kenneth J. Meleen</u>		<b>(PHONE NO.)</b> <u>(408) 243-9292</u>		<b>(FAX NO.)</b> <u>(408) 243-9696</u>		<b>TPH-EPA 8015, 8020</b> <small>Gas w/ 2, 4, 6, 8, 10, 12</small>	<b>PURGEABLE AROMATICS</b> <b>BTEX (EPA 8020)</b>	<b>TPH-Diesel (EPA 8015M)</b>	<b>TEPH (EPA 8015M)</b> <small>Chlorinated, Chlorinated, O.M.O.</small>	<b>FORCIBLY HALOCARBONS</b> <b>(EVOCs) (EPA 8010)</b>	<b>VOLATILE ORGANICS</b> <b>(VOCs) (EPA 8260)</b>	<b>SEMIVOLATILES</b> <b>(EPA 8270)</b>	<b>TOTAL OIL AND GREASE</b> <b>(SM 5520 B + F, E + F)</b>	<input type="checkbox"/> PESTICIDES (EPA 8080)	<input type="checkbox"/> PCB'S (EPA 8080)	<b>PNA's by</b> <input type="checkbox"/> 8270 <input type="checkbox"/> 8310	<input type="checkbox"/> Spec. Cond.	<input type="checkbox"/> TSS <input type="checkbox"/> TDS	<b>LUFT METALS:</b> <b>Cd, Cr, Pb, Ni, Zn</b>	<b>CAM 17 METALS</b> <b>(EPA 8010/7470/471)</b>	<b>TOTAL LEAD</b>	<input type="checkbox"/> W.E.T. (STLQ)	<input type="checkbox"/> DTCLP	<input type="checkbox"/> Resonant Chromation	<input type="checkbox"/> pH (24 hr hold time for H2O)	<b>NUMBER OF CONTAINERS</b>

SAMPLE ID.	DATE	TIME	MATRIX	PRESERV.	TPH-EPA 8015, 8020	PURGEABLE AROMATICS BTEX (EPA 8020)	TPH-Diesel (EPA 8015M)	TEPH (EPA 8015M)	FORCIBLY HALOCARBONS (EVOCs) (EPA 8010)	VOLATILE ORGANICS (VOCs) (EPA 8260)	SEMIVOLATILES (EPA 8270)	TOTAL OIL AND GREASE (SM 5520 B + F, E + F)	<input type="checkbox"/> PESTICIDES (EPA 8080)	<input type="checkbox"/> PCB'S (EPA 8080)	PNA's by <input type="checkbox"/> 8270 <input type="checkbox"/> 8310	<input type="checkbox"/> Spec. Cond.	<input type="checkbox"/> TSS <input type="checkbox"/> TDS	LUFT METALS: Cd, Cr, Pb, Ni, Zn	CAM 17 METALS (EPA 8010/7470/471)	TOTAL LEAD	<input type="checkbox"/> W.E.T. (STLQ)	<input type="checkbox"/> DTCLP	<input type="checkbox"/> Resonant Chromation	<input type="checkbox"/> pH (24 hr hold time for H2O)	NUMBER OF CONTAINERS		
North Stockpile Composite	9/8/99		SUB	N/A	X		X																			4	
N.SP-N, N.SP-W		9:15																									
N.SP-S, N.SP-E		9:20																									
N.SP-E, N.SP-W		9:25																									
East Stockpile Composite	9/8/99	9:30			X		X																				4
E.SP-N, E.SP-W		9:40																									
E.SP-S, E.SP-E		9:45																									
E.SP-E, E.SP-W		9:50																									
West Stockpile Composite		9:55			X		X																				4
W.SP-N, W.SP-W		10:05																									
W.SP-S, W.SP-E		10:10																									
		10:15																									
		10:20																									

PROJECT INFORMATION		SAMPLE RECEIPT		RELIQUISHED BY			RELIQUISHED BY			RELIQUISHED BY					
<b>PROJECT NAME</b>	<u>RT Nahas Co.</u>	<b>TOTAL NO. OF CONTAINERS</b>	<u>12</u>	<b>(SIGNATURE)</b>	<u>Kenneth Meleen</u>	<b>(TIME)</b>	<u>12:50</u>	<b>(SIGNATURE)</b>		<b>(TIME)</b>		<b>(SIGNATURE)</b>		<b>(TIME)</b>	
<b>PROJECT NUMBER</b>	<u>98041.2</u>	<b>HEAD SPACE</b>		<b>(PRINTED NAME)</b>	<u>Kenneth Meleen</u>	<b>(DATE)</b>	<u>9/8/99</u>	<b>(PRINTED NAME)</b>		<b>(DATE)</b>		<b>(PRINTED NAME)</b>		<b>(DATE)</b>	
<b>P.O. #</b>	<u>LSE-199-99</u>	<b>TEMPERATURE</b>	<u>5.6°C</u>	<b>(COMPANY)</b>	<u>Life Springs Environmental</u>	<b>(COMPANY)</b>		<b>(COMPANY)</b>		<b>(DATE)</b>		<b>(COMPANY)</b>		<b>(DATE)</b>	
<b>TAT</b>	<input checked="" type="checkbox"/> STANDARD <input type="checkbox"/> 5 DAY	<b>CONFORMS TO RECORD</b>		<b>RECEIVED BY</b>		<b>(SIGNATURE)</b>		<b>RECEIVED BY</b>		<b>(SIGNATURE)</b>		<b>RECEIVED BY (LABORATORY)</b>		<b>(SIGNATURE)</b>	
<b>Report:</b> <input type="checkbox"/> Routine <input type="checkbox"/> Level 2 <input type="checkbox"/> Level 3 <input type="checkbox"/> Level 4 <input type="checkbox"/> Electronic Report				<b>(PRINTED NAME)</b>		<b>(TIME)</b>		<b>(PRINTED NAME)</b>		<b>(DATE)</b>		<b>(SIGNATURE)</b>	<u>D. Harrington</u>	<b>(TIME)</b>	<u>12:50</u>
<b>SPECIAL INSTRUCTIONS/COMMENTS:</b> <u>Composite each group of 4 samples per stockpile, and analyze the Laboratory composite as indicated</u>				<b>(DATE)</b>		<b>(DATE)</b>		<b>(PRINTED NAME)</b>		<b>(DATE)</b>		<b>(PRINTED NAME)</b>	<u>Chromalab</u>	<b>(DATE)</b>	<u>9/8/99</u>
				<b>(COMPANY)</b>		<b>(COMPANY)</b>		<b>(COMPANY)</b>		<b>(COMPANY)</b>		<b>(LAB)</b>			

# CHROMALAB, INC.

Environmental Services (SDB) (DOIIS 1094)

## 99-09-0094

1220 Quarry Lane • Plensnton, California 94566-4758  
510/484-1910 • Facsimile 510/404-1088

Reference #: \_\_\_\_\_

### Chain of Custody

DATE 9/8/99 PAGE 2 OF 2

<b>PROJ MOR</b> <u>Kenneth Meleen</u>	<b>ANALYSIS REPORT</b>													
<b>COMPANY</b> <u>Life Springs Environmental, Inc</u>														
<b>ADDRESS</b> <u>3275 Stevens Creek Blvd # 208</u> <u>San Jose, CA 95117</u>														
<b>SAMPLES (SIGNATURE)</b> <u>Kenneth S. Meleen</u>	<b>(PHONE NO.)</b> <u>(408) 243-9292</u>	<b>(FAX NO.)</b> <u>(408) 243-9696</u>												

SAMPLE ID.	DATE	TIME	MATRIX	PRESERV.	TPH-EPA 8015, 8020 <input checked="" type="checkbox"/> Gas w/ <input type="checkbox"/> BTEX QMTRSE	PURGEABLE AROMATICS BTEX (EPA 8020)	TPH-Diesel (EPA 8015M)	TEPH (EPA 8015M) Chlorobenz., DChlorob., DMLO.	PURGEABLE HALOCARBONS, (EPOCS) (EPA 8010)	VOLATILE ORGANICS (VOCs) (EPA 8260)	SEMIVOLATILES (EPA 8270)	TOTAL OIL AND GREASE (SM 5520 B+F, E+F)	<input type="checkbox"/> PESTICIDES (EPA 8060) <input type="checkbox"/> PCB'S (EPA 8090)	PNA's by <input type="checkbox"/> 8270 <input type="checkbox"/> 8310	<input type="checkbox"/> Spec. Cond. <input type="checkbox"/> TSS <input type="checkbox"/> TDS	LUFT METALS: Cd, Cr, Pb, Ni, Zn	CAM 17 METALS (EPA 8010/7470/7471)	TOTAL LEAD	D.W.E.T. (STLC) D TCLP	<input type="checkbox"/> Recrystall Chromium <input type="checkbox"/> pH (24 hr hold time for H2O)	NUMBER OF CONTAINERS	
VO-11.5	9/8/99	10:45	Soil	N/A	X		X			X	X											1

PROJECT INFORMATION		SAMPLE RECEIPT		RELINQUISHED BY		RELINQUISHED BY		RELINQUISHED BY		
<b>PROJECT NAME</b> <u>R.T. Nicholas Co.</u>	<b>TOTAL NO. OF CONTAINERS</b> <u>1</u>	<b>HEAD SPACE</b>		<b>(SIGNATURE)</b> <u>Kenneth Meleen</u>	<b>(TIME)</b> <u>12:50</u>	<b>(SIGNATURE)</b>	<b>(TIME)</b>	<b>(SIGNATURE)</b>	<b>(TIME)</b>	
<b>PROJECT NUMBER</b> <u>98041.2</u>	<b>TEMPERATURE</b>	<b>CONFORMS TO RECORD</b>		<b>(PRINTED NAME)</b> <u>Kenneth Meleen</u>	<b>(DATE)</b> <u>9/8/99</u>	<b>(PRINTED NAME)</b>	<b>(DATE)</b>	<b>(PRINTED NAME)</b>	<b>(DATE)</b>	
<b>P.O.#</b> <u>LSE-199-99</u>	<b>TAT</b> <input checked="" type="checkbox"/> STANDARD <input type="checkbox"/> 5-DAY	<input type="checkbox"/> 24	<input type="checkbox"/> 48	<input type="checkbox"/> 72	<input type="checkbox"/> OTHER	<b>(COMPANY)</b> <u>Life Springs Environmental, Inc</u>	<b>(COMPANY)</b>	<b>(COMPANY)</b>	<b>(DATE)</b>	
<b>Report:</b> <input type="checkbox"/> Routine <input type="checkbox"/> Level 2 <input type="checkbox"/> Level 3 <input type="checkbox"/> Level 4 <input type="checkbox"/> Electronic Report				<b>RECEIVED BY</b>		<b>RECEIVED BY</b>		<b>RECEIVED BY (LABORATORY)</b>		
<b>SPECIAL INSTRUCTIONS/COMMENTS:</b>				<b>(SIGNATURE)</b>	<b>(TIME)</b>	<b>(SIGNATURE)</b>	<b>(TIME)</b>	<b>(SIGNATURE)</b> <u>Deeise Harrington</u>	<b>(TIME)</b>	
				<b>(PRINTED NAME)</b>	<b>(DATE)</b>	<b>(PRINTED NAME)</b>	<b>(DATE)</b>	<b>(PRINTED NAME)</b> <u>D. Harrington</u>	<b>(DATE)</b> <u>12:50</u>	<b>(DATE)</b>
				<b>(COMPANY)</b>	<b>(COMPANY)</b>	<b>(COMPANY)</b> <u>Chromalab</u>	<b>(DATE)</b> <u>9/8/99</u>	<b>(LAB)</b>		