

August 17, 1999

**Life
Springs
Environmental, Inc.**

ENVIRONMENTAL
PROTECTION

99 AUG 18 PM 2:24

3275 Stevens Creek Blvd., #208, San Jose, CA 95117

ENVIRONMENTAL CONSULTING ENGINEERS
General Engineering Contractor's License No. 709780

408-243-9292
FAX 408-243-9696

August 17, 1999

Mr. Scott Seery
Alameda County Environmental Health Services
1131 Harbor Bay Parkway, Suite 250
Alameda, CA 94502-6577

Regarding: Soil Remediation Status Report
R.T. Nahas Property, Castro Valley

Dear Mr. Seery:

This report is presented to bring you up to date on the status of soil remediation, and to provide results of recent analyses of soil samples collected from impacted areas of the subject site. We are also desirous of receiving guidance from the Alameda County Environmental Health Services (ACEHS) relative to acceptable levels of contaminant concentrations for soil that may remain untreated on site. A **Regional Map, Figure 1**, which shows the site location with respect to nearby streets and the I-580 Freeway, is attached. Also attached is a **Site Sampling Plan, Figure 2**. This plan shows the initial soil sampling locations (following UST removal), recently established sump and waste oil excavation stockpiles and related sampling locations, and resampling locations within the sump and waste oil pits.

When we contacted you on May 28, 1999 to report the results of additional Sump and Waste Oil Pit sample analyses, you indicated that you were not as concerned about diesel fuel (TPHD) and oil and grease (TOG) in these samples, as you were about the potential presence of chlorinated hydrocarbons. You advised resampling of the pit bottoms and analysis of these samples for semivolatile and volatile organic compounds [EPA Methods 8240 (now 8260) and 8270].

On August 3, 1999, soil samples were collected from these two pits at respective depths of 7 and 10 feet (Sump-7 and WO-10). Sample locations are shown on the Site Sampling Plan, Figure 2. These two samples were analyzed for TPHD, TOG, semivolatile and volatile organic compounds. Analytical results indicated that TPHD is present below the Sump and Waste Oil pits at respective concentrations of 84 and 560 mg/Kg; TOG also is present at respective concentrations of 88 and 1,400 mg/Kg.

VOC
HWOC

There were no EPA 8270 analytes detected in the Sump samples; several trace elements were detected in the WO-10 sample (Fluoranthene at 0.13 mg/Kg, Pyrene at 0.20 mg/Kg, and bis(2-Ethylhexyl) phthalate at 0.82 mg/Kg. There were no EPA 8260 analytes detected in either sample. Some of these historic analytical results are summarized on Table 3, attached (Tables 1 and 2 were presented previously in the Tank Closure Technical Report dated February 18, 1999). Copies of the analytical results and the Chain of Custody (COC) for the May 6 and August 3, 1999 sampling events also are attached.

OTHER WORK PERFORMED

Soil Aeration

Soil with TPHG/BTEX contamination was stockpiled on the northerly side of the site following UST removal last November. This stockpile, estimated at 175 cubic yards, was placed on and covered with 6-mil Visqueen; the cover was maintained during the 1998-'99 winter season. In April 1999, we began spreading the stockpiled material in thin (12"-18") aeration beds. On each return to the site, the previously prepared beds were thoroughly rototilled using a Howard Rotavator attached to a Kubota tractor. The last portion of this stockpile was spread on August 3, 1999. We are now attending the site weekly, and using the Kubota tractor to rototill the existing beds. On August 10 we began re-stockpiling material in the oldest aeration beds, in preparation for confirmation sampling and ultimate reuse of this material on site.

Sump and Waste Oil Pit Re-Excavation

The clarifier sump and waste oil pits were backfilled at the time of UST removal, and these areas were covered with Visqueen over the recent winter. On May 6, 1999, these pits were re-excavated and the material placed on Visqueen, at the locations shown on the Site Sampling Plan, Figure 2. These stockpiles remain covered with Visqueen.

When these excavations reached slightly deeper than the previous pit bottom levels, soil samples were collected from soil freshly excavated and brought up in the backhoe bucket. These samples were analyzed only for TPHD and TOG; the analytical results are included in Table 3.

At the same time (May 6), the trench area where a pocket of gasoline (TPHG) contaminated soil was discovered last November, was re-excavated to a 3-foot depth, and a soil sample was collected from the bottom of the excavation. The excavated soil was spread in a thin bed on Visqueen, for subsequent remediation by aeration; this bed has been rototilled several times. The soil sample was analyzed for TPHG/BTEX/MTBE and found to have no detectable concentrations of these contaminants (see Table 3). Analytical results from the May 6 sampling episode, and the related COC, are attached.

Re-Excavated Material Analysis

The stockpiles of soil re-excavated from the Sump and Waste Oil pits were sampled on May 8, 1999. Discrete soil samples were collected from quarter-sections of each stockpile (see Figure 2). These were composited in the laboratory into individual samples representing each stockpile; the composited samples were analyzed for TOG, CAM-17 Metals (EPA 6010A and 7471A), semi-volatile and volatile organic compounds (EPA 8270 and 8260, respectively).

These analyses were performed in anticipation of disposing this soil at the BFI Vasco Road Landfill in Livermore. No EPA 8270 or EPA 8260 analytes were detected in either composite sample. The ~~Sump~~ composite had 270 mg/Kg of TOG and ~~_____~~. The ~~_____~~ composite had 140 mg/Kg of TOG, and ~~_____~~. The TOG and lead analysis results are included on Table 3; the remaining analytical results were intended only for submittal with the disposal application, and thus are not included in this report. They can be made available, upon request.

Pit Bottom Sampling

Soil underlying the bottom of each pit (Sump and Waste Oil UST) was sampled on August 3, 1999. A hand auger was used initially, to excavate slough and expose native soil at a depth roughly 1-foot below the existing pit bottom. This resulted in collection of samples within native soil at slightly greater depths than had been sampled previously. Samples were collected using a slide hammer sampler driving a sampler head containing a 2-inch diameter by 6-inch long brass sleeve. After sampling, the sleeve was retrieved from the sampler, and the sleeve ends were covered with aluminum foil and tightly fitting plastic caps. Samples were properly labeled, a COC was prepared, and the samples were placed in a cooler on ice, pending pickup by the laboratory courier.

As mentioned previously in this report, these two samples were analyzed for TPHD, TOG, semi-volatile and volatile organic compounds. Analytical results have been discussed previously in this report. Some of the analytical results are included on Table 3; all of the analytical results and the COC are attached to this report.

DISCUSSION

The most recent pit bottom sampling and analysis, as well as the analysis of re-excavated stockpile material, confirms the absence of semi-volatile and volatile chlorinated hydrocarbons. Results do indicate elevated levels of TPHD and TOG, mainly beneath the Waste Oil UST pit. Additional excavation below the Waste Oil UST, and disposal of this material at the Vasco Road Landfill, may be appropriate. We would appreciate a directive from the ACEHS in this regard.

It is important for us to receive guidance from the ACEHS relative to acceptable, or target levels of TPHD and TOG concentrations that may remain in soils beneath this site. Your review of the data presented herein, and a written response to our request for guidance, is appreciated.

Sincerely,

Life Springs Environmental, Inc.

Kenneth L. Meleen, P.E.

cc: Mr. Randy Nahas

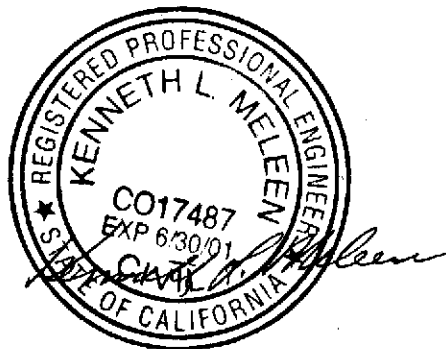

TABLE 3
LABORATORY ANALYTICAL RESULTS - SOIL SAMPLES
R.T. NAHAS COMPANY SOIL REMEDIATION

20405 Redwood Road
 Castro Valley, California

Sample Description	Sampling Date	PID Result (ppm)	Laboratory Analytical Results (mg/Kg)								
			TPHG	Benzene	Toluene	Ethyl Benzene	Total Xylenes	MTBE	TPHD	TOG	Pb
WO-8	11/18/98		<1.0	<0.005	0.0061	0.027	0.079	<0.005	270	2300	9
West Hoist 8.5'	11/19/98	870							1000 ^a		
East Hoist 8.5'	11/19/98	27							<1.0 ^b		
Sump 4.5'	11/19/98		<1.0	<0.005	<0.005	<0.005	<0.005	<0.005	120	96	7.9
GasLine-3'	05/06/99		<1.0	<0.005	<0.005	<0.005	<0.005	<0.005			
SUMP-4'	05/06/99								2700	4800	
WO-9'	05/06/99								38	140	
Sump Composites ^c	05/08/99									270	11
Waste Oil Composites ^d	05/08/99									140	55
Sump (-7')	08/03/99								84	88	
WO-10	08/03/99								560	1400	

^a West Hoist also had 2000 mg/Kg Hydraulic Oil

^b East Hoist had no detectable TPHD (<1.0 mg/Kg) or Hydraulic Oil (<50 mg/Kg)

^c Four Samples from Sump Stockpile, Composited into one sample for analysis

^d Four Samples from Waste Oil Stockpile, Composited into one sample for analysis

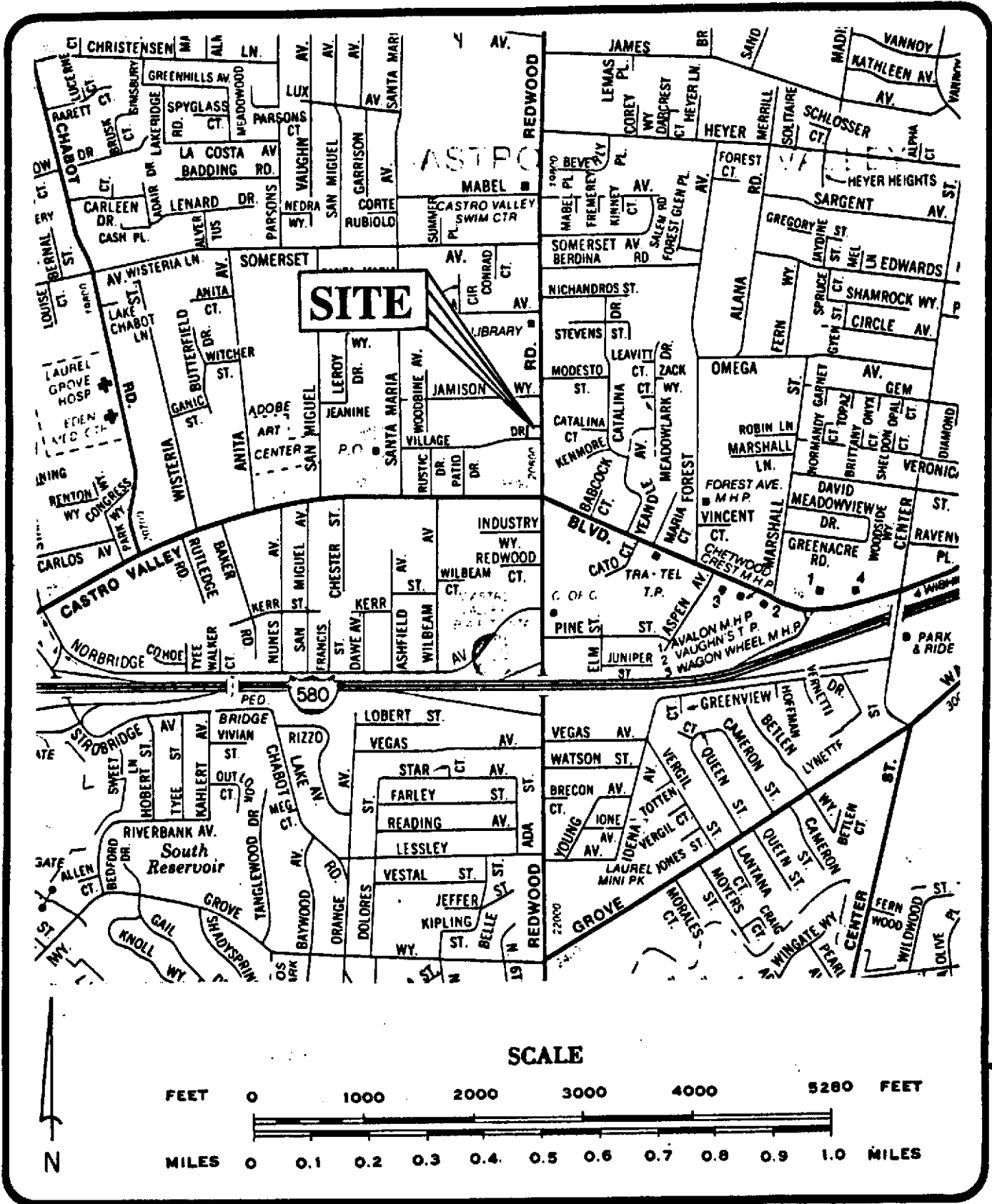

*Life
Springs
Environmental, Inc.*

REGIONAL MAP
R.T. NAHAS COMPANY UST SITE
 20405 Redwood Road
 Castro Valley, California

Figure No.
 1
 98041.2
 Project No.

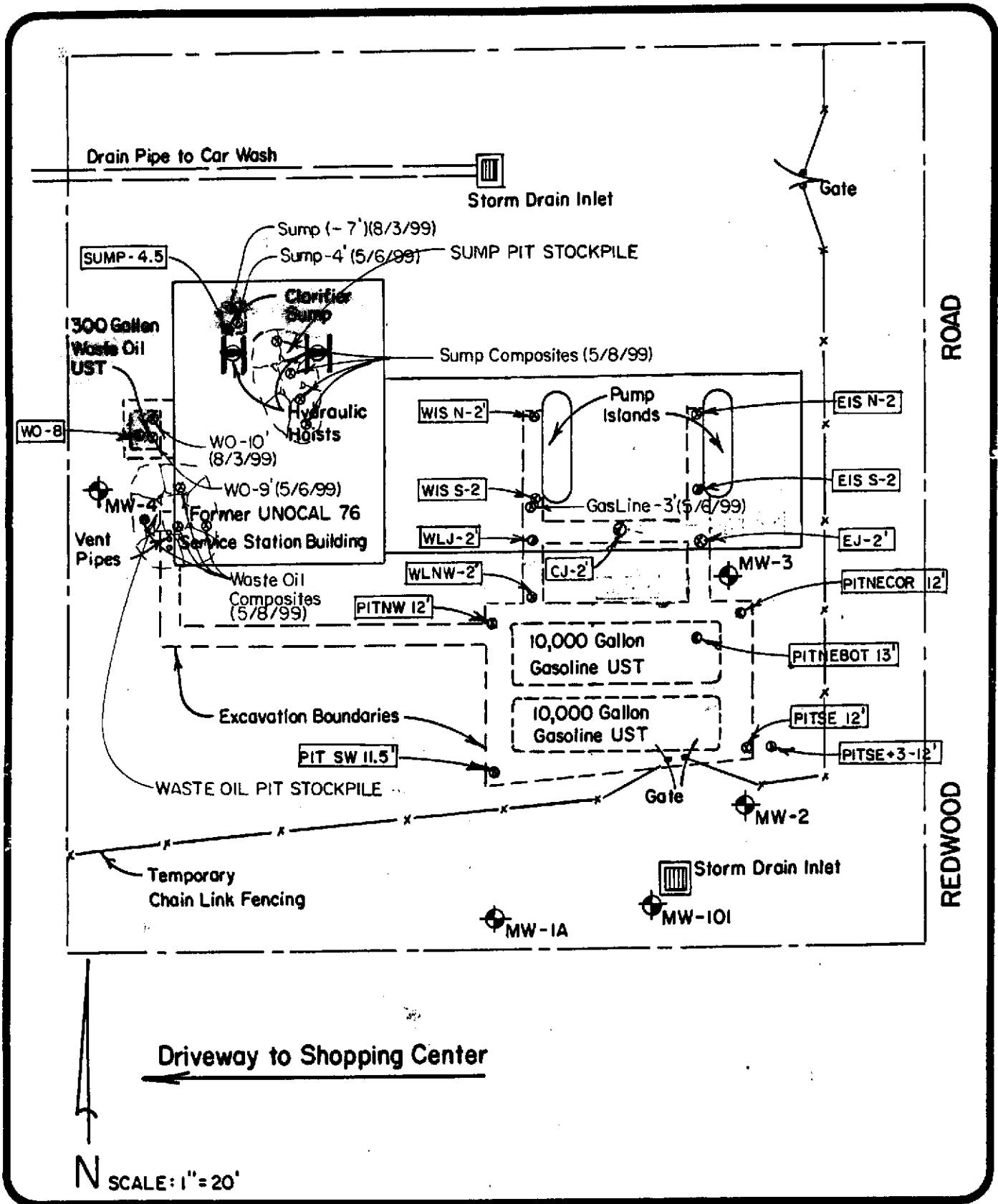

Life Springs Environmental, Inc.

SITE SAMPLING PLAN
R.T. NAHAS COMPANY UST SITE
 20405 Redwood Road
 Castro Valley, California

Figure No.
 2
 98041.2
 Project No.

CHROMALAB, INC.

Environmental Services (SDB)

May 11, 1999

Submission #: 9905080

LIFE SPRINGS ENVIRONMENTAL

Atten: Kenneth Meleen

Project: NAHAS REMED.
Received: May 6, 1999

Project#: 98041.1

re: One sample for Gasoline BTEX MTBE analysis.
Method: SW846 8020A Nov 1990 / 8015Mod

Client Sample ID: GASLINE-3

Spl#: 239917

Matrix: SOIL

Sampled: May 6, 1999

Run#:18736

Analyzed: May 10, 1999

ANALYTE	RESULT (mg/Kg)	REPORTING LIMIT (mg/Kg)	BLANK RESULT (mg/Kg)	BLANK SPIKE (%)	DILUTION FACTOR
GASOLINE	N.D.	1.0	N.D.	102	1
MTBE	N.D.	0.0050	N.D.	123	1
BENZENE	N.D.	0.0050	N.D.	102	1
TOLUENE	N.D.	0.0050	N.D.	100	1
ETHYL BENZENE	N.D.	0.0050	N.D.	97	1
XYLENES	N.D.	0.0050	N.D.	97	1

Craig Huntzinger
Analyst

Eric Tam
Laboratory Director

CHROMALAB, INC.

Environmental Services (SDB)

May 13, 1999

Submission #: 9905080

LIFE SPRINGS ENVIRONMENTAL

Atten: Kenneth Meleen

Project: NAHAS REMED.
Received: May 6, 1999

Project#: 98041.1

re: One sample for TEPH analysis.
Method: EPA 8015M

Client Sample ID: SUMP-4

Spl#: 239918

Matrix: SOIL

Extracted: May 11, 1999

Sampled: May 6, 1999

Run#:18750

Analyzed: May 13, 1999

<u>ANALYTE</u>	<u>RESULT</u> <u>(mg/Kg)</u>	<u>REPORTING</u> <u>LIMIT</u> <u>(mg/Kg)</u>	<u>BLANK</u> <u>RESULT</u> <u>(mg/Kg)</u>	<u>BLANK</u> <u>SPIKE</u> <u>(%)</u>	<u>DILUTION</u> <u>FACTOR</u>
DIESEL	2700	100	N.D.	77.6	100
<i>Note: Hydrocarbon reported is in the late Diesel Range and does not match our Diesel Standard. Surrogate diluted out.</i>					
MOTOR OIL	4800	2000	N.D.	--	100
KEROSENE	N.D.	100	N.D.	--	100

Carolyn House
Analyst

Bruce Havlik
Analyst

CHROMALAB, INC.

Environmental Services (SDB)

May 13, 1999

Submission #: 9905080

LIFE SPRINGS ENVIRONMENTAL

Atten: Kenneth Meleen

Project: NAHAS REMED.
Received: May 6, 1999

Project#: 98041.1

re: One sample for TEPH analysis.
Method: EPA 8015M

Client Sample ID: WO-9

Spl#: 239919

Sampled: May 6, 1999

Matrix: SOIL

Run#: 18750

Extracted: May 11, 1999

Analyzed: May 12, 1999

<u>ANALYTE</u>	<u>RESULT</u> (mg/Kg)	<u>REPORTING</u> <u>LIMIT</u> (mg/Kg)	<u>BLANK</u> <u>RESULT</u> (mg/Kg)	<u>BLANK</u> <u>SPIKE</u> (%)	<u>DILUTION</u> <u>FACTOR</u>
DIESEL	38	1.0	N.D.	77.6	1
Note: Hydrocarbon reported is in the late Diesel Range and does not match our Diesel Standard.					
MOTOR OIL	140	50	N.D.	--	1
KEROSENE	N.D.	1.0	N.D.	--	1

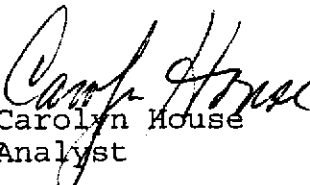
Carolyn House
Analyst

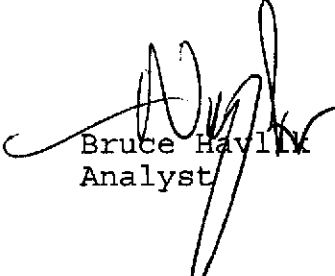
Bruce Havill
Analyst

CHROMALAB, INC.

Environmental Services (SDB) (DOHS 1084)

1220 Quarry Lane • Plensanton, California 94566-4758
510/484-1818 • Facsimile 510/484-1098

Reference #: 45910

Chain of Custody

DATE 5/6/99 PAGE 1 OF 1

PROJ MGR Kenneth L. Meleen
 COMPANY Life Springs Environmental, Inc.
 ADDRESS 3275 Stevens Creek Blvd., #208
San Jose, CA 95117

SAMPLER'S (SIGNATURE) Kenneth L. Meleen (PHONE NO.) (408) 243-9292
 (FAX NO.) (408) 243-9696

ANALYSIS REPORT

SAMPLE ID.	DATE	TIME	MATRIX	PRESERV.	TPH (EPA 8015, 8020) PA Gas w/ 8 STEXYMITE	PURGEABLE AROMATICS STEX (EPA 8020)	TPH-Diesel (EPA 8015M)	TPH (EPA 8015M) Air, water, sediment, sludge	PURGEABLE HALOCARBONS, (BYOCs) (EPA 8010)	VOLATILE ORGANICS (VOCs) (EPA 8260)	SEMI-VOLATILES (EPA 8270)	TOTAL OIL AND GREASE ISM 8520 B+F, E+F)	PESTICIDES (EPA 8080) PCB'S (EPA 8060)	PNA's by <input type="checkbox"/> 8270 <input type="checkbox"/> 8210	<input type="checkbox"/> Spec. Cond. <input type="checkbox"/> TSS <input type="checkbox"/> TDS	LUFT METALS: Cd, Cr, Pb, Ni, Zn	CAM 17 METALS (EPA 8010/7470/7471)	TOTAL LEAD	W.E.T. (STLC) DTCLP	Relevant Chromium pB (24 hr hold time for R20)	NUMBER OF CONTAINERS	
Gas Line - 3	5/6/99	2:10	Soil	-	X																	1
Scump - 4		2:25		-				X														1
WO - 9		3:15		-				X														1

SUB# : 9905060 REF: PH
 CLIENT: LIFESPRINGS
 DUE: 05/13/99
 REF #: 45910

PROJECT INFORMATION
 PROJECT NAME NAHAS REMED.
 PROJECT NUMBER 98041.1
 P.O.# LSE-192-79

SAMPLE RECEIPT
 TOTAL NO. OF CONTAINERS 3
 HEAD SPACE
 TEMPERATURE
 CONFORMS TO RECORD

1st STANDARD 5-DAY
 2d 2d 4d 7d OTHER
 Report: Hardline Level 2 Level 3 Level 4 Electronic Report
 SPECIAL INSTRUCTIONS/COMMENTS:

RELINQUISHED BY 1
Kenneth L. Meleen 5/6/99
 (SIGNATURE) (TIME)
Kenneth L. Meleen 5/6/99
 (PRINTED NAME) (DATE)
 Life Springs Environmental
 (COMPANY)

RECEIVED BY 1
 (SIGNATURE) (TIME)
 (PRINTED NAME) (DATE)
 (COMPANY)

RELINQUISHED BY 2
 (SIGNATURE) (TIME)
 (PRINTED NAME) (DATE)
 (COMPANY)

RECEIVED BY 2
 (SIGNATURE) (TIME)
 (PRINTED NAME) (DATE)
 (COMPANY)

RELINQUISHED BY 3
 (SIGNATURE) (TIME)
 (PRINTED NAME) (DATE)
 (COMPANY)

RECEIVED BY (LABORATORY) 3
Denise Harrington 5/6/99
 (SIGNATURE) (TIME)
D. Harrington 1630
 (PRINTED NAME) (DATE)
Chromalab 5/6/99
 (COMPANY)

CHROMALAB, INC.
Environmental Services (SDB)

Submission #: 1999-08-0032

Date: August 10, 1999

Life Springs Environmental
3275 Stevens Creek Blvd., Suite 208
San Jose, CA 95117-1148

Attn.: Mr. Kenneth Meleen

Project: 98041.2
R.T. Nahas Co.

Dear Mr. Meleen,

Attached is our report for your samples received on Tuesday August 3, 1999.
This report has been reviewed and approved for release. Reproduction of this report
is permitted only in its entirety.

Please note that any unused portion of the samples will be discarded after September 2, 1999
unless you have requested otherwise. We appreciate the opportunity to be of service to you.
If you have any questions, please call me at (925) 484-1919.

Sincerely,

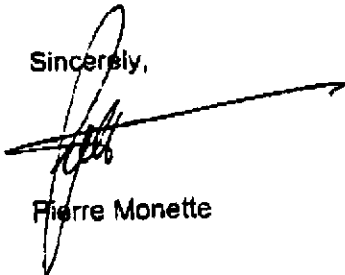

Pierre Monette

CHROMALAB, INC.

Submission #: 1999-08-0032

Environmental Services (SDB)

Semi-volatile Organic Compounds

Life Springs Environmental	✉ 3275 Stevens Creek Blvd., Suite 208 San Jose, CA 95117-1148
Attn: Kenneth Meleen	Phone: (408) 243-9292 Fax: (408) 243-9696
Project #: 98041.2	Project: R.T. Nahas Co.

Samples Reported

Sample ID	Matrix	Date Sampled	Lab #
SUMP	Soil	08/03/1999 08:00	1
WO-10	Soil	08/03/1999 08:00	2

CHROMALAB, INC.

Submission #: 1999-08-0032

Environmental Services (SDB)

To: Life Springs Environmental
Attn.: Kenneth MeleenTest Method: 8270A
Prep Method: 3550/8270A

Semi-volatile Organic Compounds

Sample ID: SUMP	Lab Sample ID: 1999-08-0032-001
Project: 98041.2 R.T. Nahas Co.	Received: 08/03/1999 16:40
Sampled: 08/03/1999 08:00	Extracted: 08/04/1999 15:12
Matrix: Soil	QC-Batch: 1999/08/04-01.11

Compound	Result	Rep.Limit	Units	Dilution	Analyzed	Flag
Phenol	ND	0.10	mg/Kg	1.00	08/04/1999 20:33	
Bis(2-chloroethyl)ether	ND	0.10	mg/Kg	1.00	08/04/1999 20:33	
2-Chlorophenol	ND	0.10	mg/Kg	1.00	08/04/1999 20:33	
1,3-Dichlorobenzene	ND	0.10	mg/Kg	1.00	08/04/1999 20:33	
1,4-Dichlorobenzene	ND	0.10	mg/Kg	1.00	08/04/1999 20:33	
Benzyl alcohol	ND	0.20	mg/Kg	1.00	08/04/1999 20:33	
1,2-Dichlorobenzene	ND	0.10	mg/Kg	1.00	08/04/1999 20:33	
2-Methylphenol	ND	0.10	mg/Kg	1.00	08/04/1999 20:33	
Bis(2-chloroisopropyl) ether	ND	0.10	mg/Kg	1.00	08/04/1999 20:33	
4-Methylphenol	ND	0.20	mg/Kg	1.00	08/04/1999 20:33	
N-Nitroso-di-n-propylamine	ND	0.10	mg/Kg	1.00	08/04/1999 20:33	
Hexachloroethane	ND	0.10	mg/Kg	1.00	08/04/1999 20:33	
Nitrobenzene	ND	0.10	mg/Kg	1.00	08/04/1999 20:33	
Isophorone	ND	0.10	mg/Kg	1.00	08/04/1999 20:33	
2-Nitrophenol	ND	0.10	mg/Kg	1.00	08/04/1999 20:33	
2,4-Dimethylphenol	ND	0.10	mg/Kg	1.00	08/04/1999 20:33	
Bis(2-chloroethoxy) methane	ND	0.10	mg/Kg	1.00	08/04/1999 20:33	
2,4-Dichlorophenol	ND	0.10	mg/Kg	1.00	08/04/1999 20:33	
1,2,4-Trichlorobenzene	ND	0.10	mg/Kg	1.00	08/04/1999 20:33	
Naphthalene	ND	0.10	mg/Kg	1.00	08/04/1999 20:33	
4-Chloroaniline	ND	0.20	mg/Kg	1.00	08/04/1999 20:33	
Hexachlorobutadiene	ND	0.10	mg/Kg	1.00	08/04/1999 20:33	
4-Chloro-3-methylphenol	ND	0.20	mg/Kg	1.00	08/04/1999 20:33	
2-Methylnaphthalene	ND	0.10	mg/Kg	1.00	08/04/1999 20:33	
Hexachlorocyclopentadiene	ND	0.10	mg/Kg	1.00	08/04/1999 20:33	
2,4,6-Trichlorophenol	ND	0.10	mg/Kg	1.00	08/04/1999 20:33	
2,4,5-Trichlorophenol	ND	0.10	mg/Kg	1.00	08/04/1999 20:33	
2-Chloronaphthalene	ND	0.10	mg/Kg	1.00	08/04/1999 20:33	
2-Nitroaniline	ND	0.50	mg/Kg	1.00	08/04/1999 20:33	
Dimethyl phthalate	ND	0.50	mg/Kg	1.00	08/04/1999 20:33	
Acenaphthylene	ND	0.10	mg/Kg	1.00	08/04/1999 20:33	
3-Nitroaniline	ND	0.10	mg/Kg	1.00	08/04/1999 20:33	
Acenaphthene	ND	0.10	mg/Kg	1.00	08/04/1999 20:33	
2,4-Dinitrophenol	ND	0.50	mg/Kg	1.00	08/04/1999 20:33	
4-Nitrophenol	ND	0.50	mg/Kg	1.00	08/04/1999 20:33	

1220 Quarry Lane * Pleasanton, CA 94566-4756

Telephone: (925) 484-1919 * Facsimile: (925) 484-1096

CHROMALAB, INC.

Submission #: 1999-08-0032

Environmental Services (SDB)

To: Life Springs Environmental
Attn.: Kenneth MeleenTest Method: 8270A
Prep Method: 3550/8270A

Semi-volatile Organic Compounds

Sample ID: SUMP	Lab Sample ID: 1999-08-0032-001
Project: 98041.2 R.T. Nahas Co.	Received: 08/03/1999 16:40
Sampled: 08/03/1999 08:00	Extracted: 08/04/1999 15:12
Matrix: Soil	QC-Batch: 1999/08/04-01.11

Compound	Result	Rep. Limit	Units	Dilution	Analyzed	Flag
Dibenzofuran	ND	0.10	mg/Kg	1.00	08/04/1999 20:33	
2,4-Dinitrotoluene	ND	0.10	mg/Kg	1.00	08/04/1999 20:33	
2,6-Dinitrotoluene	ND	0.20	mg/Kg	1.00	08/04/1999 20:33	
Diethyl phthalate	ND	0.50	mg/Kg	1.00	08/04/1999 20:33	
4-Chlorophenyl phenyl ether	ND	0.10	mg/Kg	1.00	08/04/1999 20:33	
Fluorene	ND	0.10	mg/Kg	1.00	08/04/1999 20:33	
4-Nitroaniline	ND	0.50	mg/Kg	1.00	08/04/1999 20:33	
2-Methyl-4,6-dinitrophenol	ND	0.50	mg/Kg	1.00	08/04/1999 20:33	
N-Nitrosodiphenylamine	ND	0.10	mg/Kg	1.00	08/04/1999 20:33	
4-Bromophenyl phenyl ether	ND	0.10	mg/Kg	1.00	08/04/1999 20:33	
Hexachlorobenzene	ND	0.10	mg/Kg	1.00	08/04/1999 20:33	
Pentachlorophenol	ND	0.50	mg/Kg	1.00	08/04/1999 20:33	
Phenanthrene	ND	0.10	mg/Kg	1.00	08/04/1999 20:33	
Anthracene	ND	0.10	mg/Kg	1.00	08/04/1999 20:33	
Di-n-butyl phthalate	ND	2.0	mg/Kg	1.00	08/04/1999 20:33	
Fluoranthene	ND	0.10	mg/Kg	1.00	08/04/1999 20:33	
Pyrene	ND	0.10	mg/Kg	1.00	08/04/1999 20:33	
Butyl benzyl phthalate	ND	0.50	mg/Kg	1.00	08/04/1999 20:33	
3,3-Dichlorobenzidine	ND	0.20	mg/Kg	1.00	08/04/1999 20:33	
Benzo(a)anthracene	ND	0.10	mg/Kg	1.00	08/04/1999 20:33	
bis(2-Ethylhexyl) phthalate	ND	0.50	mg/Kg	1.00	08/04/1999 20:33	
Chrysene	ND	0.10	mg/Kg	1.00	08/04/1999 20:33	
Di-n-octyl phthalate	ND	0.50	mg/Kg	1.00	08/04/1999 20:33	
Benzo(b)fluoranthene	ND	0.10	mg/Kg	1.00	08/04/1999 20:33	
Benzo(k)fluoranthene	ND	0.20	mg/Kg	1.00	08/04/1999 20:33	
Benzo(a)pyrene	ND	0.020	mg/Kg	1.00	08/04/1999 20:33	
Indeno(1,2,3-c,d)pyrene	ND	0.20	mg/Kg	1.00	08/04/1999 20:33	
Dibenzo(a,h)anthracene	ND	0.20	mg/Kg	1.00	08/04/1999 20:33	
Benzo(g,h,i)perylene	ND	0.20	mg/Kg	1.00	08/04/1999 20:33	
Benzoic acid	ND	0.50	mg/Kg	1.00	08/04/1999 20:33	
Surrogate(s)						
Nitrobenzene-d5	69.2	23-120	%	1.00	08/04/1999 20:33	
2-Fluorobiphenyl	83.4	30-115	%	1.00	08/04/1999 20:33	
p-Terphenyl-d14	86.7	18-137	%	1.00	08/04/1999 20:33	
Phenol-d5	61.3	24-113	%	1.00	08/04/1999 20:33	

1220 Quarry Lane * Pleasanton, CA 94566-4756

Telephone: (925) 484-1919 * Facsimile: (925) 484-1096

CHROMALAB, INC.

Submission #: 1999-08-0032

Environmental Services (SDB)

To: Life Springs Environmental
Attn.: Kenneth MeleenTest Method: 8270A
Prep Method: 3550/8270A

Semi-volatile Organic Compounds

Sample ID: SUMP	Lab Sample ID: 1999-08-0032-001
Project: 98041 2 R.T. Nahas Co.	Received: 08/03/1999 16:40
Sampled: 08/03/1999 08:00	Extracted: 08/04/1999 15:12
Matrix: Soil	QC-Batch: 1999/08/04-01.11

Compound	Result	Rep.Limit	Units	Dilution	Analyzed	Flag
Surrogate(s)						
2-Fluorophenol	59.0	25-121	%	1.00	08/04/1999 20:33	
2,4,6-Tribromophenol	75.3	19-122	%	1.00	08/04/1999 20:33	

1220 Quarry Lane * Pleasanton, CA 94566-4756
Telephone: (925) 484-1919 * Facsimile: (925) 484-1095

CHROMALAB, INC.

Submission #: 1999-08-0032

Environmental Services (SDB)

To: Life Springs Environmental
Attn: Kenneth MeleenTest Method: 8270A
Prep Method: 3550/8270A

Semi-volatile Organic Compounds

Sample ID: WO-10	Lab Sample ID: 1999-08-0032-002
Project: 98041.2 R.T. Nahas Co.	Received: 08/03/1999 16:40
Sampled: 08/03/1999 08:00	Extracted: 08/04/1999 15:12
Matrix: Soil	QC-Batch: 1999/08/04-01.11

Compound	Result	Rep.Limit	Units	Dilution	Analyzed	Flag
Phenol	ND	0.10	mg/Kg	1.00	08/04/1999 19:43	
Bis(2-chloroethyl) ether	ND	0.10	mg/Kg	1.00	08/04/1999 19:43	
2-Chlorophenol	ND	0.10	mg/Kg	1.00	08/04/1999 19:43	
1,3-Dichlorobenzene	ND	0.10	mg/Kg	1.00	08/04/1999 19:43	
1,4-Dichlorobenzene	ND	0.10	mg/Kg	1.00	08/04/1999 19:43	
Benzyl alcohol	ND	0.20	mg/Kg	1.00	08/04/1999 19:43	
1,2-Dichlorobenzene	ND	0.10	mg/Kg	1.00	08/04/1999 19:43	
2-Methylphenol	ND	0.10	mg/Kg	1.00	08/04/1999 19:43	
Bis(2-chloroisopropyl) ether	ND	0.10	mg/Kg	1.00	08/04/1999 19:43	
4-Methylphenol	ND	0.20	mg/Kg	1.00	08/04/1999 19:43	
N-Nitroso-di-n-propylamine	ND	0.10	mg/Kg	1.00	08/04/1999 19:43	
Hexachloroethane	ND	0.10	mg/Kg	1.00	08/04/1999 19:43	
Nitrobenzene	ND	0.10	mg/Kg	1.00	08/04/1999 19:43	
Isophorone	ND	0.10	mg/Kg	1.00	08/04/1999 19:43	
2-Nitrophenol	ND	0.10	mg/Kg	1.00	08/04/1999 19:43	
2,4-Dimethylphenol	ND	0.10	mg/Kg	1.00	08/04/1999 19:43	
Bis(2-chloroethoxy) methane	ND	0.10	mg/Kg	1.00	08/04/1999 19:43	
2,4-Dichlorophenol	ND	0.10	mg/Kg	1.00	08/04/1999 19:43	
1,2,4-Trichlorobenzene	ND	0.10	mg/Kg	1.00	08/04/1999 19:43	
Naphthalene	ND	0.10	mg/Kg	1.00	08/04/1999 19:43	
4-Chloroaniline	ND	0.20	mg/Kg	1.00	08/04/1999 19:43	
Hexachlorobutadiene	ND	0.10	mg/Kg	1.00	08/04/1999 19:43	
4-Chloro-3-methylphenol	ND	0.20	mg/Kg	1.00	08/04/1999 19:43	
2-Methylnaphthalene	ND	0.10	mg/Kg	1.00	08/04/1999 19:43	
Hexachlorocyclopentadiene	ND	0.10	mg/Kg	1.00	08/04/1999 19:43	
2,4,6-Trichlorophenol	ND	0.10	mg/Kg	1.00	08/04/1999 19:43	
2,4,5-Trichlorophenol	ND	0.10	mg/Kg	1.00	08/04/1999 19:43	
2-Chloronaphthalene	ND	0.10	mg/Kg	1.00	08/04/1999 19:43	
2-Nitroaniline	ND	0.50	mg/Kg	1.00	08/04/1999 19:43	
Dimethyl phthalate	ND	0.50	mg/Kg	1.00	08/04/1999 19:43	
Acenaphthylene	ND	0.10	mg/Kg	1.00	08/04/1999 19:43	
3-Nitroaniline	ND	0.10	mg/Kg	1.00	08/04/1999 19:43	
Acenaphthene	ND	0.10	mg/Kg	1.00	08/04/1999 19:43	
2,4-Dinitrophenol	ND	0.50	mg/Kg	1.00	08/04/1999 19:43	
4-Nitrophenol	ND	0.50	mg/Kg	1.00	08/04/1999 19:43	

1220 Quarry Lane * Pleasanton, CA 94566-4756

Telephone: (925) 484-1919 * Facsimile: (925) 484-1096

CHROMALAB, INC.

Submission #: 1999-08-0032

Environmental Services (SDB)

To: Life Springs Environmental

Test Method: 8270A

Attn.: Kenneth Meleen

Prep Method: 3550/8270A

Semi-volatile Organic Compounds

Sample ID: WO-10	Lab Sample ID: 1999-08-0032-002
Project: 98041.2 R.T. Nahas Co.	Received: 08/03/1999 16:40
Sampled: 08/03/1999 08:00	Extracted: 08/04/1999 15:12
Matrix: Soil	QC-Batch: 1999/08/04-01.11

Compound	Result	Rep.Limit	Units	Dilution	Analyzed	Flag
Dibenzofuran	ND	0.10	mg/Kg	1.00	08/04/1999 19:43	
2,4-Dinitrotoluene	ND	0.10	mg/Kg	1.00	08/04/1999 19:43	
2,6-Dinitrotoluene	ND	0.20	mg/Kg	1.00	08/04/1999 19:43	
Diethyl phthalate	ND	0.50	mg/Kg	1.00	08/04/1999 19:43	
4-Chlorophenyl phenyl ether	ND	0.10	mg/Kg	1.00	08/04/1999 19:43	
Fluorene	ND	0.10	mg/Kg	1.00	08/04/1999 19:43	
4-Nitroaniline	ND	0.50	mg/Kg	1.00	08/04/1999 19:43	
2-Methyl-4,6-dinitrophenol	ND	0.50	mg/Kg	1.00	08/04/1999 19:43	
N-Nitrosodiphenylamine	ND	0.10	mg/Kg	1.00	08/04/1999 19:43	
4-Bromophenyl phenyl ether	ND	0.10	mg/Kg	1.00	08/04/1999 19:43	
Hexachlorobenzene	ND	0.10	mg/Kg	1.00	08/04/1999 19:43	
Pentachlorophenol	ND	0.50	mg/Kg	1.00	08/04/1999 19:43	
Phenanthrene	ND	0.10	mg/Kg	1.00	08/04/1999 19:43	
Anthracene	ND	0.10	mg/Kg	1.00	08/04/1999 19:43	
Di-n-butyl phthalate	ND	2.0	mg/Kg	1.00	08/04/1999 19:43	
Fluoranthene	0.13	0.10	mg/Kg	1.00	08/04/1999 19:43	
Pyrene	0.20	0.10	mg/Kg	1.00	08/04/1999 19:43	
Butyl benzyl phthalate	ND	0.50	mg/Kg	1.00	08/04/1999 19:43	
3,3-Dichlorobenzidine	ND	0.20	mg/Kg	1.00	08/04/1999 19:43	
Benzo(a)anthracene	ND	0.10	mg/Kg	1.00	08/04/1999 19:43	
bis(2-Ethylhexyl) phthalate	0.82	0.50	mg/Kg	1.00	08/04/1999 19:43	
Chrysene	ND	0.10	mg/Kg	1.00	08/04/1999 19:43	
Di-n-octyl phthalate	ND	0.50	mg/Kg	1.00	08/04/1999 19:43	
Benzo(b)fluoranthene	ND	0.10	mg/Kg	1.00	08/04/1999 19:43	
Benzo(k)fluoranthene	ND	0.20	mg/Kg	1.00	08/04/1999 19:43	
Benzo(a)pyrene	ND	0.020	mg/Kg	1.00	08/04/1999 19:43	
Indeno(1,2,3-c,d)pyrene	ND	0.20	mg/Kg	1.00	08/04/1999 19:43	
Dibenzo(a,h)anthracene	ND	0.20	mg/Kg	1.00	08/04/1999 19:43	
Benzo(g,h,i)perylene	ND	0.20	mg/Kg	1.00	08/04/1999 19:43	
Benzoic acid	ND	0.50	mg/Kg	1.00	08/04/1999 19:43	
Surrogate(s)						
Nitrobenzene-d5	51.6	23-120	%	1.00	08/04/1999 19:43	
2-Fluorobiphenyl	60.4	30-115	%	1.00	08/04/1999 19:43	
p-Terphenyl-d14	97.2	18-137	%	1.00	08/04/1999 19:43	
Phenol-d5	58.1	24-113	%	1.00	08/04/1999 19:43	

1220 Quarry Lane * Pleasanton, CA 94566-4756

Telephone: (925) 484-1919 * Facsimile: (925) 484-1096

CHROMALAB, INC.

Submission #: 1999-08-0032

Environmental Services (SDB)

To: Life Springs Environmental
Attn.: Kenneth MeleenTest Method: 8270A
Prep Method: 3550/8270A

Semi-volatile Organic Compounds

Sample ID: WO-10	Lab Sample ID: 1999-08-0032-002
Project: 98041.2 R.T. Nahas Co.	Received: 08/03/1999 16:40
Sampled: 08/03/1999 08:00	Extracted: 08/04/1999 15:12
Matrix: Soil	QC-Batch: 1999/08/04-01.11

Compound	Result	Rep. Limit	Units	Dilution	Analyzed	Flag
Surrogate(s)						
2-Fluorophenol	48.7	25-121	%	1.00	08/04/1999 19:43	
2,4,6-Tribromophenol	74.8	19-122	%	1.00	08/04/1999 19:43	

CHROMALAB, INC.

Submission #: 1999-08-0032

Environmental Services (SDB)

Volatile Organic Compounds

Life Springs Environmental

☒ 3275 Stevens Creek Blvd., Suite 208
San Jose, CA 95117-1148

Attn: Kenneth Meleen

Phone: (408) 243-9292 Fax: (408) 243-9696

Project #: 98041.2

Project: R.T. Nahas Co.

Samples Reported

Sample ID	Matrix	Date Sampled	Lab #
SUMP	Soil	08/03/1999 08:00	1
WO-10	Soil	08/03/1999 08:00	2

CHROMALAB, INC.

Submission #: 1999-08-0032

Environmental Services (SOB)

To: Life Springs Environmental
Attn.: Kenneth MeleenTest Method: 8260A
Prep Method: 5030

Volatile Organic Compounds

Sample ID: SUMP	Lab Sample ID: 1999-08-0032-001
Project: 98041.2 R.T. Nahas Co.	Received: 08/03/1999 16:40
Sampled: 08/03/1999 08:00	Extracted: 08/05/1999 15:35
Matrix: Soil	QC-Batch: 1999/08/05-01.07
Sample/Analysis Flag: In (See Legend & Note section)	

Compound	Result	Rep Limit	Units	Dilution	Analyzed	Flag
Acetone	ND	110	ug/Kg	2.19	08/05/1999 15:35	
Benzene	ND	11	ug/Kg	2.19	08/05/1999 15:35	
Bromodichloromethane	ND	11	ug/Kg	2.19	08/05/1999 15:35	
Bromoform	ND	11	ug/Kg	2.19	08/05/1999 15:35	
Bromomethane	ND	22	ug/Kg	2.19	08/05/1999 15:35	
Carbon tetrachloride	ND	11	ug/Kg	2.19	08/05/1999 15:35	
Chlorobenzene	ND	11	ug/Kg	2.19	08/05/1999 15:35	
Chloroethane	ND	22	ug/Kg	2.19	08/05/1999 15:35	
2-Butanone(MEK)	ND	110	ug/Kg	2.19	08/05/1999 15:35	
2-Chloroethylvinyl ether	ND	110	ug/Kg	2.19	08/05/1999 15:35	
Chloroform	ND	11	ug/Kg	2.19	08/05/1999 15:35	
Chloromethane	ND	22	ug/Kg	2.19	08/05/1999 15:35	
Dibromochloromethane	ND	11	ug/Kg	2.19	08/05/1999 15:35	
1,2-Dichlorobenzene	ND	11	ug/Kg	2.19	08/05/1999 15:35	
1,3-Dichlorobenzene	ND	11	ug/Kg	2.19	08/05/1999 15:35	
1,4-Dichlorobenzene	ND	11	ug/Kg	2.19	08/05/1999 15:35	
1,2-Dibromo-3-chloropropane	ND	110	ug/Kg	2.19	08/05/1999 15:35	
1,2-Dibromoethane	ND	22	ug/Kg	2.19	08/05/1999 15:35	
Dibromomethane	ND	22	ug/Kg	2.19	08/05/1999 15:35	
Dichlorodifluoromethane	ND	22	ug/Kg	2.19	08/05/1999 15:35	
1,1-Dichloroethane	ND	11	ug/Kg	2.19	08/05/1999 15:35	
1,2-Dichloroethane	ND	11	ug/Kg	2.19	08/05/1999 15:35	
1,1-Dichloroethene	ND	11	ug/Kg	2.19	08/05/1999 15:35	
1,2-Dichloroethene (cis)	ND	11	ug/Kg	2.19	08/05/1999 15:35	
1,2-Dichloroethene (trans)	ND	11	ug/Kg	2.19	08/05/1999 15:35	
1,2-Dichloropropane	ND	11	ug/Kg	2.19	08/05/1999 15:35	
cis-1,3-Dichloropropene	ND	11	ug/Kg	2.19	08/05/1999 15:35	
trans-1,3-Dichloropropene	ND	11	ug/Kg	2.19	08/05/1999 15:35	
Ethylbenzene	ND	11	ug/Kg	2.19	08/05/1999 15:35	
2-Hexanone	ND	110	ug/Kg	2.19	08/05/1999 15:35	
Methylene chloride	ND	11	ug/Kg	2.19	08/05/1999 15:35	
4-Methyl-2-pentanone (MIBK)	ND	110	ug/Kg	2.19	08/05/1999 15:35	
Naphthalene	ND	22	ug/Kg	2.19	08/05/1999 15:35	
Styrene	ND	11	ug/Kg	2.19	08/05/1999 15:35	

1220 Quarry Lane * Pleasanton, CA 94566-4756

Telephone: (925) 484-1919 * Facsimile: (925) 484-1096

CHROMALAB, INC.

Submission #: 1999-08-0032

Environmental Services (SD9)

To: Life Springs Environmental
Attn: Kenneth MeleenTest Method: 8260A
Prep Method: 5030

Volatile Organic Compounds

Sample ID: SUMP	Lab Sample ID: 1999-08-0032-001
Project: 98041.2 R.T. Nahas Co.	Received: 08/03/1999 16:40
Sampled: 08/03/1999 08:00	Extracted: 08/05/1999 15:35
Matrix: Soil	QC-Batch: 1999/08/05-01.07
Sample/Analysis Flag: irn (See Legend & Note section)	

Compound	Result	Rep.Limit	Units	Dilution	Analyzed	Flag
1,1,2,2-Tetrachloroethane	ND	11	ug/Kg	2.19	08/05/1999 15:35	
Tetrachloroethene	ND	11	ug/Kg	2.19	08/05/1999 15:35	
Toluene	ND	11	ug/Kg	2.19	08/05/1999 15:35	
1,1,1-Trichloroethane	ND	11	ug/Kg	2.19	08/05/1999 15:35	
1,1,2-Trichloroethane	ND	11	ug/Kg	2.19	08/05/1999 15:35	
Trichloroethane	ND	11	ug/Kg	2.19	08/05/1999 15:35	
1,1,1,2-Tetrachloroethane	ND	11	ug/Kg	2.19	08/05/1999 15:35	
Vinyl acetate	ND	110	ug/Kg	2.19	08/05/1999 15:35	
Vinyl chloride	ND	11	ug/Kg	2.19	08/05/1999 15:35	
Total xylenes	ND	22	ug/Kg	2.19	08/05/1999 15:35	
Trichlorotrifluoroethane	ND	11	ug/Kg	2.19	08/05/1999 15:35	
Carbon disulfide	ND	11	ug/Kg	2.19	08/05/1999 15:35	
Isopropylbenzene	ND	11	ug/Kg	2.19	08/05/1999 15:35	
Bromobenzene	ND	11	ug/Kg	2.19	08/05/1999 15:35	
Bromochloromethane	ND	44	ug/Kg	2.19	08/05/1999 15:35	
Trichlorofluoromethane	ND	11	ug/Kg	2.19	08/05/1999 15:35	
Surrogate(s)						
4-Bromofluorobenzene	99.5	74-121	%	1.00	08/05/1999 15:35	
1,2-Dichloroethane-d4	106.3	70-121	%	1.00	08/05/1999 15:35	
Toluene-d8	115.5	81-117	%	1.00	08/05/1999 15:35	

1220 Quarry Lane * Pleasanton, CA 94566-4756
Telephone: (925) 484-1919 * Facsimile: (925) 484-1096

CHROMALAB, INC.

Submission #: 1999-08-0032

Environmental Services (SDB)

To: Life Springs Environmental
Attn: Kenneth MeleenTest Method: 8260A
Prep Method: 5030

Volatile Organic Compounds

Sample ID: WO-10	Lab Sample ID: 1999-08-0032-002
Project: 96041.2 R.T. Nahas Co.	Received: 08/03/1999 16:40
Sampled: 08/03/1999 08:00	Extracted: 08/05/1999 16:13
Matrix: Soil	QC-Batch: 1999/08/05-01.07
Sample/Analysis Flag: lm (See Legend & Note section)	

Compound	Result	Rep.Limit	Units	Dilution	Analyzed	Flag
Acetone	ND	97	ug/Kg	1.93	08/05/1999 16:13	
Benzene	ND	9.7	ug/Kg	1.93	08/05/1999 16:13	
Bromodichloromethane	ND	9.7	ug/Kg	1.93	08/05/1999 16:13	
Bromoform	ND	9.7	ug/Kg	1.93	08/05/1999 16:13	
Bromomethane	ND	19	ug/Kg	1.93	08/05/1999 16:13	
Carbon tetrachloride	ND	9.7	ug/Kg	1.93	08/05/1999 16:13	
Chlorobenzene	ND	9.7	ug/Kg	1.93	08/05/1999 16:13	
Chloroethane	ND	19	ug/Kg	1.93	08/05/1999 16:13	
2-Butanone(MEK)	ND	97	ug/Kg	1.93	08/05/1999 16:13	
2-Chloroethylvinyl ether	ND	97	ug/Kg	1.93	08/05/1999 16:13	
Chloroform	ND	9.7	ug/Kg	1.93	08/05/1999 16:13	
Chloromethane	ND	19	ug/Kg	1.93	08/05/1999 16:13	
Dibromochloromethane	ND	9.7	ug/Kg	1.93	08/05/1999 16:13	
1,2-Dichlorobenzene	ND	9.7	ug/Kg	1.93	08/05/1999 16:13	
1,3-Dichlorobenzene	ND	9.7	ug/Kg	1.93	08/05/1999 16:13	
1,4-Dichlorobenzene	ND	9.7	ug/Kg	1.93	08/05/1999 16:13	
1,2-Dibromo-3-chloropropane	ND	97	ug/Kg	1.93	08/05/1999 16:13	
1,2-Dibromoethane	ND	19	ug/Kg	1.93	08/05/1999 16:13	
Dibromomethane	ND	19	ug/Kg	1.93	08/05/1999 16:13	
Dichlorodifluoromethane	ND	19	ug/Kg	1.93	08/05/1999 16:13	
1,1-Dichloroethane	ND	9.7	ug/Kg	1.93	08/05/1999 16:13	
1,2-Dichloroethane	ND	9.7	ug/Kg	1.93	08/05/1999 16:13	
1,1-Dichloroethene	ND	9.7	ug/Kg	1.93	08/05/1999 16:13	
1,2-Dichloroethene (cis)	ND	9.7	ug/Kg	1.93	08/05/1999 16:13	
1,2-Dichloroethene (trans)	ND	9.7	ug/Kg	1.93	08/05/1999 16:13	
1,2-Dichloropropane	ND	9.7	ug/Kg	1.93	08/05/1999 16:13	
cis-1,3-Dichloropropene	ND	9.7	ug/Kg	1.93	08/05/1999 16:13	
trans-1,3-Dichloropropene	ND	9.7	ug/Kg	1.93	08/05/1999 16:13	
Ethylbenzene	ND	9.7	ug/Kg	1.93	08/05/1999 16:13	
2-Hexanone	ND	97	ug/Kg	1.93	08/05/1999 16:13	
Methylene chloride	ND	9.7	ug/Kg	1.93	08/05/1999 16:13	
4-Methyl-2-pentanone (MIBK)	ND	97	ug/Kg	1.93	08/05/1999 16:13	
Naphthalene	ND	19	ug/Kg	1.93	08/05/1999 16:13	
Styrene	ND	9.7	ug/Kg	1.93	08/05/1999 16:13	

1220 Quarry Lane * Pleasanton, CA 94566-4756

Telephone: (925) 484-1919 * Facsimile: (925) 484-1096

CHROMALAB, INC.

Submission #: 1999-08-0032

Environmental Services (SDB)

To: Life Springs Environmental
Attn: Kenneth MeleenTest Method: 8260A
Prep Method: 5030

Volatile Organic Compounds

Sample ID: WO-10	Lab Sample ID: 1999-08-0032-002
Project: 98041.2 R.T. Nahas Co.	Received: 08/03/1999 16:40
Sampled: 08/03/1999 08:00	Extracted: 08/05/1999 16:13
Matrix: Soil	QC-Batch: 1999/08/05-01.07
Sample/Analysis Flag: lm (See Legend & Note section)	

Compound	Result	Rep.Limit	Units	Dilution	Analyzed	Flag
1,1,2,2-Tetrachloroethane	ND	9.7	ug/Kg	1.93	08/05/1999 16:13	
Tetrachloroethene	ND	9.7	ug/Kg	1.93	08/05/1999 16:13	
Toluene	ND	9.7	ug/Kg	1.93	08/05/1999 16:13	
1,1,1-Trichloroethane	ND	9.7	ug/Kg	1.93	08/05/1999 16:13	
1,1,2-Trichloroethane	ND	9.7	ug/Kg	1.93	08/05/1999 16:13	
Trichloroethene	ND	9.7	ug/Kg	1.93	08/05/1999 16:13	
1,1,1,2-Tetrachloroethane	ND	9.7	ug/Kg	1.93	08/05/1999 16:13	
Vinyl acetate	ND	9.7	ug/Kg	1.93	08/05/1999 16:13	
Vinyl chloride	ND	9.7	ug/Kg	1.93	08/05/1999 16:13	
Total xylenes	ND	19	ug/Kg	1.93	08/05/1999 16:13	
Trichlorotrifluoroethane	ND	9.7	ug/Kg	1.93	08/05/1999 16:13	
Carbon disulfide	ND	9.7	ug/Kg	1.93	08/05/1999 16:13	
Isopropylbenzene	ND	9.7	ug/Kg	1.93	08/05/1999 16:13	
Bromobenzene	ND	9.7	ug/Kg	1.93	08/05/1999 16:13	
Bromochloromethane	ND	39	ug/Kg	1.93	08/05/1999 16:13	
Trichlorofluoromethane	ND	9.7	ug/Kg	1.93	08/05/1999 16:13	
<i>Surrogate(s)</i>						
4-Bromofluorobenzene	94.5	74-121	%	1.00	08/05/1999 16:13	
1,2-Dichloroethane-d4	104.9	70-121	%	1.00	08/05/1999 16:13	
Toluene-d8	111.7	81-117	%	1.00	08/05/1999 16:13	

1220 Quarry Lane * Pleasanton, CA 94566-4756
Telephone: (925) 484-1919 * Facsimile: (925) 484-1096

CHROMALAB, INC.

Submission #: 1999-08-0032

Environmental Services (SDB)

Petroleum Oil & Grease

Life Springs Environmental

✉ 3275 Stevens Creek Blvd., Suite 208
San Jose, CA 95117-1148

Attn: Kenneth Meleen

Phone: (408) 243-9292 Fax: (408) 243-9696

Project #: 98041.2

Project: R.T. Nahas Co.

Samples Reported

Sample ID	Matrix	Date Sampled	Lab #
SUMP	Soil	08/03/1999 08:00	1
WO-10	Soil	08/03/1999 08:00	2

1220 Quarry Lane * Pleasanton, CA 94566-4756
Telephone: (925) 484-1919 * Facsimile: (925) 484-1096

CHROMALAB, INC.

Submission #: 1999-08-0032

Environmental Services (SES)

To: Life Springs Environmental
Attn.: Kenneth MeleenTest Method: 5520 E & F
Prep Method: 5520 E & F

Petroleum Oil & Grease

Sample ID:	SUMP	Lab Sample ID:	1999-08-0032-001
Project:	98041.2 R.T. Nahas Co.	Received:	08/03/1999 16:40
Sampled:	08/03/1999 08:00	Extracted:	08/06/1999
Matrix:	Soil	QC-Batch:	1999/08/06-01.23

Compound	Result	Rep.Limit	Units	Dilution	Analyzed	Flag
Oil & Grease (Petroleum)	88	50	mg/Kg	1.00	08/09/1999	

CHROMALAB, INC.

Submission #: 1999-08-0032

Environmental Services (SDB)

To: Life Springs Environmental
Attn: Kenneth MeleenTest Method: 5520 E & F
Prep Method: 5520 E & F

Petroleum Oil & Grease

Sample ID: WO-10	Lab Sample ID: 1999-08-0032-002
Project: 98041.2 R.T. Nahas Co.	Received: 08/03/1999 16:40
Sampled: 08/03/1999 08:00	Extracted: 08/06/1999
Matrix: Soil	QC-Batch: 1999/08/06-01.23

Compound	Result	Rep.Limit	Units	Dilution	Analyzed	Flag
Oil & Grease (Petroleum)	1400	50	mg/Kg	1.00	08/09/1999	

CHROMALAB, INC.

Submission #: 1999-08-0032

Environmental Services (SDB)

Diesel with Silica Gel Clean-up

Life Springs Environmental✉ 3275 Stevens Creek Blvd., Suite 208
San Jose, CA 95117-1148

Attn: Kenneth Meleen

Phone: (408) 243-9292 Fax: (408) 243-9696

Project #: 88041.2

Project: R.T. Nahas Co.

Samples Reported

Sample ID	Matrix	Date Sampled	Lab #
SUMP	Soil	08/03/1999 08:00	1
WO-10	Soil	08/03/1999 08:00	2

1220 Quarry Lane * Pleasanton, CA 94566-4756

Telephone: (925) 484-1919 * Facsimile: (925) 484-1096

CHROMALAB, INC.

Submission #: 1999-08-0032

Environmental Services (SDB)

To: Life Springs Environmental
Attn.: Kenneth MeleenTest Method: 8015m
Prep Method: 3550/8015M

Diesel with Silica Gel Clean-up

Sample ID:	SUMP	Lab Sample ID:	1999-08-0032-001
Project:	98041.2 R.T. Nahas Co.	Received:	08/03/1999 16:40
Sampled:	08/03/1999 08:00	Extracted:	08/09/1999 10:50
Matrix:	Soil	QC-Batch:	1999/08/09-03.10
Sample/Analysis Flag: shc (See Legend & Note section)			

Compound	Result	Rep.Limit	Units	Dilution	Analyzed	Flag
Diesel	84	1.0	mg/Kg	1.00	08/09/1999 16:59	ndp
Surrogate(s) o-Terphenyl	159.3	60-130	%	1.00	08/09/1999 16:59	

CHROMALAB, INC.

Submission #: 1999-08-0032

Environmental Services (SDB)

To: **Life Springs Environmental**
Attn: Kenneth MeleenTest Method: 8015m
Prep Method: 3550/8015M

Diesel with Silica Gel Clean-up

Sample ID: WD-10	Lab Sample ID: 1999-08-0032-002
Project: 98041.2 R.T. Nahas Co.	Received: 08/03/1999 16:40
Sampled: 08/03/1999 08:00	Extracted: 08/09/1999 10:50
Matrix: Soil	QC-Batch: 1999/08/09-03.10
Sample/Analysis Flag: shc (See Legend & Note section)	

Compound	Result	Rep.Limit	Units	Dilution	Analyzed	Flag
Diesel	560	20	mg/Kg	20.00	08/10/1999 12:31	ndp
Surrogate(s) o-Terphenyl	235.3	60-130	%	20.00	08/10/1999 12:31	

CHROMALAB, INC.

Environmental Services (SDB) (DOI IS 1094)

99-08-0076
 1220 Quarry Lane • Pleasanton, California 94566-4750
 510/404-1919 • Facsimile 510/404-1989

Reference #: 47268

Chain of Custody

DATE August 3, 1999 PAGE 1 OF 1

PROJECT INFORMATION					ANALYSIS REPORT																
PROJ MGR <u>Kenneth L. Meleen</u> COMPANY <u>Life Springs Environmental, Inc</u> ADDRESS <u>3275 Stevens Creek Blvd., #20B</u> <u>San Jose, CA 95117</u>					TPA-1 (EPA 8015, 8020) PURGEABLE AROMATICS STX (EPA 8020) TPA-2 (EPA 8015M) TPA-3 (EPA 8015M) FURAN/THIOPHENE/THIOPHENE (EPOC) (EPA 8016) VOLATILE ORGANICS (VOC) (EPA 8260) SEMI-VOLATILES (EPA 8270) TOTAL OIL AND GREASE (SEM 8020 B+F, E+F) METALS: (EPA 8000) (EPA 8210) PMA's by (EPA 8220) (EPA 8230) (EPA 8240) (EPA 8250) (EPA 8260) (EPA 8270) (EPA 8280) (EPA 8290) (EPA 8300) (EPA 8310) (EPA 8320) (EPA 8330) (EPA 8340) (EPA 8350) (EPA 8360) (EPA 8370) (EPA 8380) (EPA 8390) (EPA 8400) (EPA 8410) (EPA 8420) (EPA 8430) (EPA 8440) (EPA 8450) (EPA 8460) (EPA 8470) (EPA 8480) (EPA 8490) (EPA 8500) (EPA 8510) (EPA 8520) (EPA 8530) (EPA 8540) (EPA 8550) (EPA 8560) (EPA 8570) (EPA 8580) (EPA 8590) (EPA 8600) (EPA 8610) (EPA 8620) (EPA 8630) (EPA 8640) (EPA 8650) (EPA 8660) (EPA 8670) (EPA 8680) (EPA 8690) (EPA 8700) (EPA 8710) (EPA 8720) (EPA 8730) (EPA 8740) (EPA 8750) (EPA 8760) (EPA 8770) (EPA 8780) (EPA 8790) (EPA 8800) (EPA 8810) (EPA 8820) (EPA 8830) (EPA 8840) (EPA 8850) (EPA 8860) (EPA 8870) (EPA 8880) (EPA 8890) (EPA 8900) (EPA 8910) (EPA 8920) (EPA 8930) (EPA 8940) (EPA 8950) (EPA 8960) (EPA 8970) (EPA 8980) (EPA 8990) (EPA 9000)																
SAMPLES (SIGNATURE) <u>Kenneth L. Meleen</u> (PHONE NO.) (408) 243-9292 (FAX NO.) (408) 243-9696					TPA-1 (EPA 8015, 8020) PURGEABLE AROMATICS STX (EPA 8020) TPA-2 (EPA 8015M) TPA-3 (EPA 8015M) FURAN/THIOPHENE/THIOPHENE (EPOC) (EPA 8016) VOLATILE ORGANICS (VOC) (EPA 8260) SEMI-VOLATILES (EPA 8270) TOTAL OIL AND GREASE (SEM 8020 B+F, E+F) METALS: (EPA 8000) (EPA 8210) PMA's by (EPA 8220) (EPA 8230) (EPA 8240) (EPA 8250) (EPA 8260) (EPA 8270) (EPA 8280) (EPA 8290) (EPA 8300) (EPA 8310) (EPA 8320) (EPA 8330) (EPA 8340) (EPA 8350) (EPA 8360) (EPA 8370) (EPA 8380) (EPA 8390) (EPA 8400) (EPA 8410) (EPA 8420) (EPA 8430) (EPA 8440) (EPA 8450) (EPA 8460) (EPA 8470) (EPA 8480) (EPA 8490) (EPA 8500) (EPA 8510) (EPA 8520) (EPA 8530) (EPA 8540) (EPA 8550) (EPA 8560) (EPA 8570) (EPA 8580) (EPA 8590) (EPA 8600) (EPA 8610) (EPA 8620) (EPA 8630) (EPA 8640) (EPA 8650) (EPA 8660) (EPA 8670) (EPA 8680) (EPA 8690) (EPA 8700) (EPA 8710) (EPA 8720) (EPA 8730) (EPA 8740) (EPA 8750) (EPA 8760) (EPA 8770) (EPA 8780) (EPA 8790) (EPA 8800) (EPA 8810) (EPA 8820) (EPA 8830) (EPA 8840) (EPA 8850) (EPA 8860) (EPA 8870) (EPA 8880) (EPA 8890) (EPA 8900) (EPA 8910) (EPA 8920) (EPA 8930) (EPA 8940) (EPA 8950) (EPA 8960) (EPA 8970) (EPA 8980) (EPA 8990) (EPA 9000)																
SAMPLE ID	DATE	TIME	MATRIX	PRIORITY	TPA-1 (EPA 8015, 8020)	PURGEABLE AROMATICS STX (EPA 8020)	TPA-2 (EPA 8015M)	TPA-3 (EPA 8015M)	FURAN/THIOPHENE/THIOPHENE (EPOC) (EPA 8016)	VOLATILE ORGANICS (VOC) (EPA 8260)	SEMI-VOLATILES (EPA 8270)	TOTAL OIL AND GREASE (SEM 8020 B+F, E+F)	METALS: (EPA 8000) (EPA 8210)	PMA's by (EPA 8220) (EPA 8230) (EPA 8240) (EPA 8250)	LIPT METALS: Cd, Cr, Pb, Ni, Zn	CAN 17 METALS (EPA 8210/8270/8271)	TOTAL LEAD	DWELL (STLC) (TCLP)	RESIDUAL CHROMIUM (Pb (24 hr hold time for SDB))	NUMBER OF CONTAINERS	
Sump -	8/3/99	0800	Soil	1			X			X	X	X									1
WO-10	8/3/99	0800	Soil	1			X			X	X	X									1

PROJECT INFORMATION				SAMPLE RECEIPT				RELINQUISHED BY				RELINQUISHED BY			
PROJECT NAME <u>RT. Neches Co.</u>		TOTAL NO. OF CONTAINERS <u>2</u>		RELINQUISHED BY <u>Kenneth L. Meleen 8/3/99</u>		RELINQUISHED BY <u>[Signature] 8/3/99</u>									
PROJECT NUMBER <u>98041.2</u>		HEAD SPACE		SIGNATURE <u>Kenneth L. Meleen 8/3/99</u>		SIGNATURE <u>[Signature] 8/3/99</u>									
P.O. # <u>LSE-196-99</u>		TEMPERATURE <u>3.8°C</u>		PRINTED NAME <u>Life Springs Environmental</u>		PRINTED NAME <u>[Signature]</u>									
CONFORMS TO RECORD		COMPANY <u>Inc.</u>		COMPANY <u>Inc.</u>		COMPANY <u>Inc.</u>									
RECEIVED BY <u>[Signature] 8/3/99</u>				RECEIVED BY <u>[Signature] 8/3/99</u>				RECEIVED BY (LABORATORY) <u>Denise Harrington 8/3/99</u>							
SIGNATURE <u>[Signature]</u>				SIGNATURE <u>[Signature]</u>				SIGNATURE <u>[Signature]</u>							
PRINTED NAME <u>[Signature]</u>				PRINTED NAME <u>[Signature]</u>				PRINTED NAME <u>Chromalab 8/3/99</u>							
COMPANY <u>[Signature]</u>				COMPANY <u>[Signature]</u>				COMPANY <u>[Signature]</u>							

FROM 9-13-99 2:21PM