

Detterman, Mark, Env. Health

From: Detterman, Mark, Env. Health
Sent: Tuesday, March 29, 2016 11:51 AM
To: 'Baker, Keith'; ralambert@waterboards.ca.gov
Subject: RE: PG&E COURTSEY NOTIFICATION FOR GAS DISTRIBUTION VALVE REPLACEMENT - 28TH STREET AND CHESTNUT STREET, OAKLAND, ALAMEDA COUNTY
Attachments: PG&E - 28th Street and Chestnut Street Oakland.pdf

Keith,

Thanks for the notification. Based on the location of the work and the location of the City of Oakland McClymond High School at 2607 Myrtle Street (T0600102303, RWQCB CASE#: 01-2249; LOP CASE# RO0000292) site, ACDEH does not have any concerns with the potential for contamination associated with the site to be encountered at your work location. Based on topography, groundwater should generally flow to the southwest or west. Based on proximity I would guess, as you may be aware, that there may be some potential to encounter some contamination associated with the Brook's Auto Service located at 1101 28th Street (T0600102303, RWQCB CASE#: 01-2304; LOP Case#: RO0000222); however, ACDEH is not familiar or associated with the case at this time, nor can we speak for the Regional Board.
Good luck with the project,

Mark Detterman
Senior Hazardous Materials Specialist, PG, CEG
Alameda County Department of Environmental Health
1131 Harbor Bay Parkway
Alameda, CA 94502
Direct: 510.567.6876
Fax: 510.337.9335
Email: mark.detterman@acgov.org

PDF copies of case files can be downloaded at:

<http://www.acgov.org/aceh/lop/ust.htm>

From: Baker, Keith [<mailto:KMBT@pge.com>]
Sent: Tuesday, March 29, 2016 11:24 AM
To: Detterman, Mark, Env. Health; ralambert@waterboards.ca.gov
Subject: PG&E COURTSEY NOTIFICATION FOR GAS DISTRIBUTION VALVE REPLACEMENT - 28TH STREET AND CHESTNUT STREET, OAKLAND, ALAMEDA COUNTY

RALPH LAMBERT
SAN FRANCISCO BAY RWQCB (REGION 2)
1515 CLAY ST. SUITE 1500
OAKLAND, CA 94612

MARK DETTERMAN
ALAMEDA COUNTY LOP
1131 HARBOR BAY PARKWAY
ALAMEDA, CA 945026577

PG&E COURTSEY NOTIFICATION FOR GAS DISTRIBUTION VALVE REPLACEMENT 28TH STREET AND CHESTNUT STREET, OAKLAND, ALAMEDA COUNTY

Dear Mr. Lambert AND Mr. Detterman;

PG&E is issuing a courtesy notification to the San Francisco Bay Regional Water Quality Control Board (RWQCB) and the Alameda County Local Oversight Program (LOP) for a gas distribution valve replacement project located at the intersection of 28th Street and Chestnut Street in Oakland. The project is located nearby Brook's Auto Service located at 1101 28th Street (T0600102303, RWQCB CASE#: 01-2304; LOP Case#: RO0000222), as well as the City of Oakland McClymond High School at 2607 Myrtle Street (T0600102303, RWQCB CASE#: 01-2249; LOP CASE# RO0000292).

The project will require four excavations and trenching up to 8 feet below ground surface (see approximate location below), including one excavation that will be approximately 14' by 14', and three excavations that will be approximately 8' by 10'. Based on the depth of excavation compared to the depth of groundwater in the area, it is possible that groundwater might be encountered during excavation. Based on a review of available Geotracker data, there is a potential that the groundwater in the vicinity of the project may be impacted with TVHg and TEHd (Brook's Auto Service site) and TPHd (McClymond High School site). If contaminated groundwater is encountered, a hazardous waste contractor will be mobilized to perform dewatering. Spoils from all excavations will be hauled away, and properly characterized prior to disposal. The project is expected to generate an estimated 77 cubic yards of excess soil. I have attached a Permit Sketch to illustrate the proposed locations of the excavations (bell holes).

Could you please indicate if additional information is needed; and, if you have any issues or concerns. PG&E appreciates Alameda County LOP and the SFRWQCB's consideration and assistance in this matter.



Keith Baker : *Sr. Environmental Field Specialist*
Environmental Management – Distribution
Pacific Gas & Electric Company
3401 Crow Canyon Road, Bldg 414
San Ramon, CA 94583
408-205-0191 cell
KMBT@pge.com

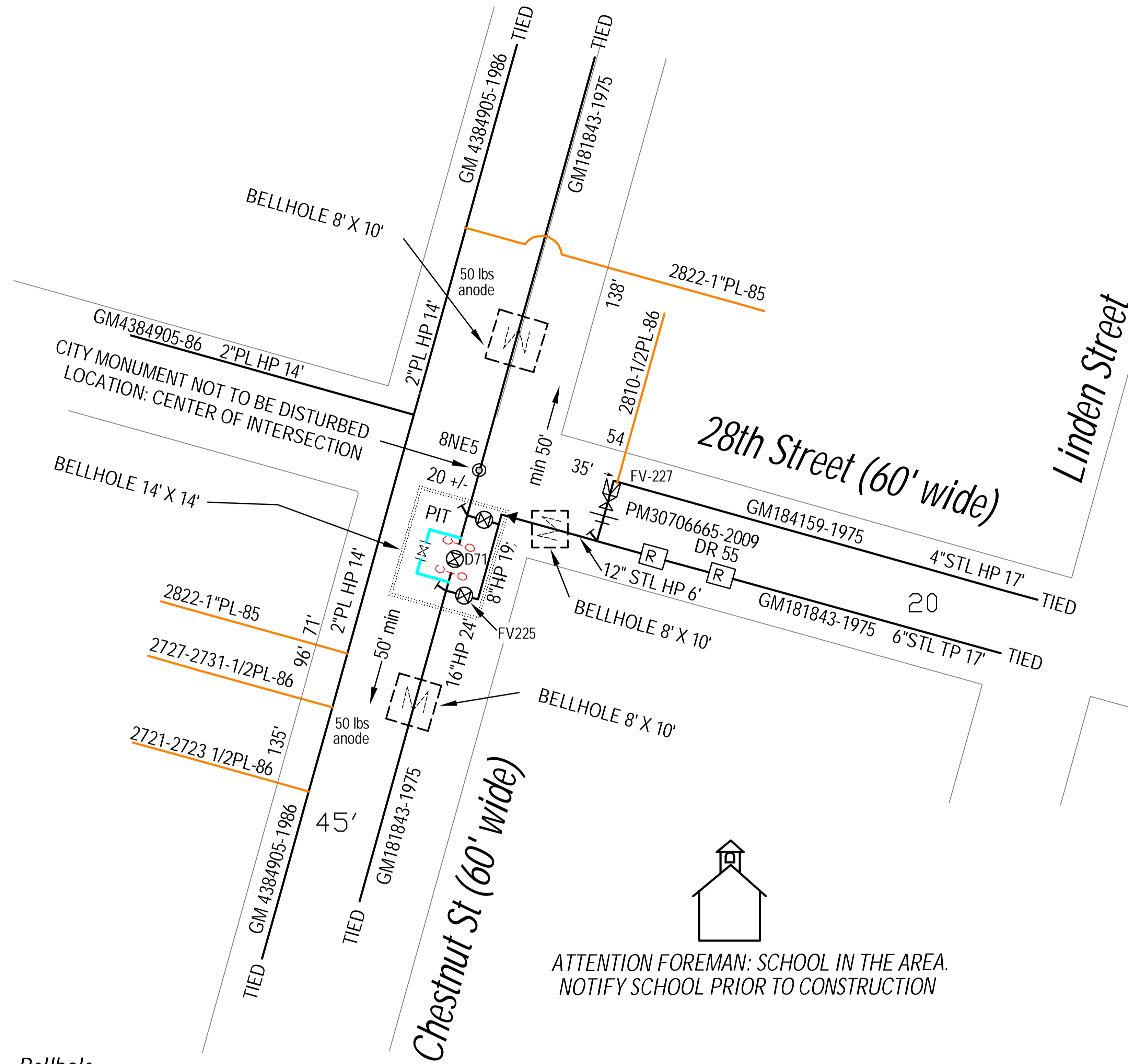

Bellhole

- PGE to replace existing ball valve D-71, due to inoperable.
- PGE to trench and backfil all, obtain excavation permit.

PERMIT SKETCH : LINDA HERRAS (510) 437-2451

ATTENTION FOREMAN: SCHOOL IN THE AREA.
NOTIFY SCHOOL PRIOR TO CONSTRUCTION

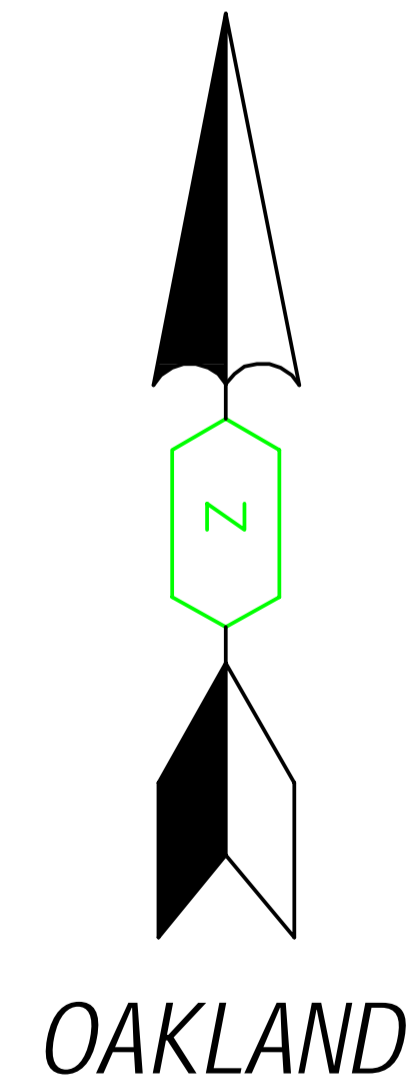

EST:	CO:
ADE:	SD:
SUPV:	NOTIF.:
REP:	OTHER:
PLNR:	SHT:
SCALE: 1/4" = 1'-0"	PM:
DATE:	REV.
	31211170
PERMIT SKETCH CHESTNUT & 28TH STREET OAKLAND, CA	
PACIFIC GAS AND ELECTRIC COMPANY	