

ALCO
HAZMAT

94 FEB 16 AM 11:48



Chevron

February 15, 1994

Ms. Jennifer Eberle
Alameda County Health Care Services
80 Swan Way, Room 200
Oakland, CA 94621

Chevron U.S.A. Products Company
2410 Camino Ramon
San Ramon, CA 94583
P.O. Box 5004
San Ramon, CA 94583-0804

Marketing Department
Phone 510 842 9500

**Re: Former Chevron Service Station #9-4816
301 14th Street, Oakland**

Dear Ms. Eberle:

Enclosed we are forwarding the Quarterly Ground Water Monitoring report dated January 28, 1994, prepared by our consultant Groundwater Technology, Inc. for the above referenced site. As indicated in the report, ground water samples collected were analyzed for total petroleum hydrocarbons as gasoline and BTEX. Benzene was detected at concentrations ranging from ND to 47,000 ppb. Separate-phase hydrocarbons again were not observed during this monitoring event. Depth to ground water was measured at approximately 20.5-feet below grade, and the direction of flow is to the northwest.

We look forward to your response to the work plan submitted to your office on February 2, 1994, proposing the installation of one (1) off-site ground water monitoring well down-gradient (northwest) of C-5. Chevron will continue to monitor this site and report the findings on a quarterly basis. If you have any questions or comments, please do not hesitate to contact me at (510) 842-9581.

Sincerely,
CHEVRON U.S.A. PRODUCTS COMPANY



Nancy Vukelich
Site Assessment and Remediation Engineer

Enclosure

cc: Mr. Rich Hiatt, RWQCB
Mr. Mike Cooke, Weiss Associates
Mr. J.N. Robbins, CHVPK/V1156
Ms B.C. Owen
File (9-4816Q10)

Ms. Beth D. Castleberry
Ware & Freidenrich
400 Hamilton Avenue
Palo Alto, CA 94301-1825

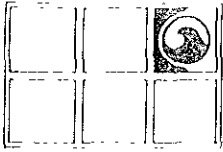
FEB 7 '94 J.M.M.



GROUNDWATER TECHNOLOGY, INC.

4057 Port Chicago Highway, Concord, CA 94520 (415) 671-2387

FAX: (415) 685-9148

January 28, 1994

Project No. 020104084

Ms. Nancy Vukelich
Chevron U.S.A. Products Company
2410 Camino Ramon
San Ramon, CA 94583-0804

SUBJECT: *Groundwater Monitoring and Sampling Activities*
Chevron Service Station No.9-4816
301 14th Street, Oakland, California

Dear Ms. Vukelich:

Groundwater Technology, Inc. presents the attached quarterly groundwater monitoring and sampling data collected on December 21, 1993. Eleven groundwater monitoring wells at this site were gauged to measure depth to groundwater (DTW) and to check for the presence of separate-phase hydrocarbons. Separate-phase hydrocarbons were not detected in the monitoring wells. A potentiometric surface map (Figure 1) and a summary of groundwater monitoring data (Table 1) are presented in Attachments 1 and 2, respectively. After the DTW was measured, each monitoring well was purged and sampled. Field data sheets are presented in Attachment 3. The groundwater samples collected were analyzed for benzene, toluene, ethylbenzene, and xylenes and for total petroleum hydrocarbons-as-gasoline. Results of the chemical analyses are summarized in Table 1. The laboratory report and chain-of-custody record are included in Attachment 4. Monitoring-well purge water was transported by Groundwater Technology to the Chevron Terminal in Richmond, California, for recycling.

Groundwater Technology is pleased to assist Chevron on this project. If you have any questions or comments, please contact our Concord office at (510) 671-2387.

Sincerely,
Groundwater Technology, Inc.
Written/Submitted by



Tim Watchers
Project Geologist

PR ____

Attachment 1 Figure
Attachment 2 Table
Attachment 3 Field Data Sheets
Attachment 4 Laboratory Report

For:
Wendell C. Lattz
Vice President, General Manager
West Region

ATTACHMENT 1

Figure

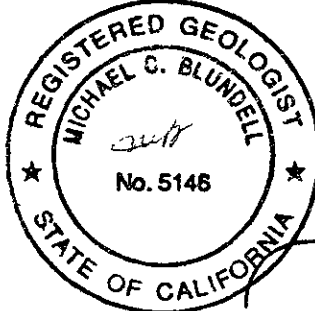
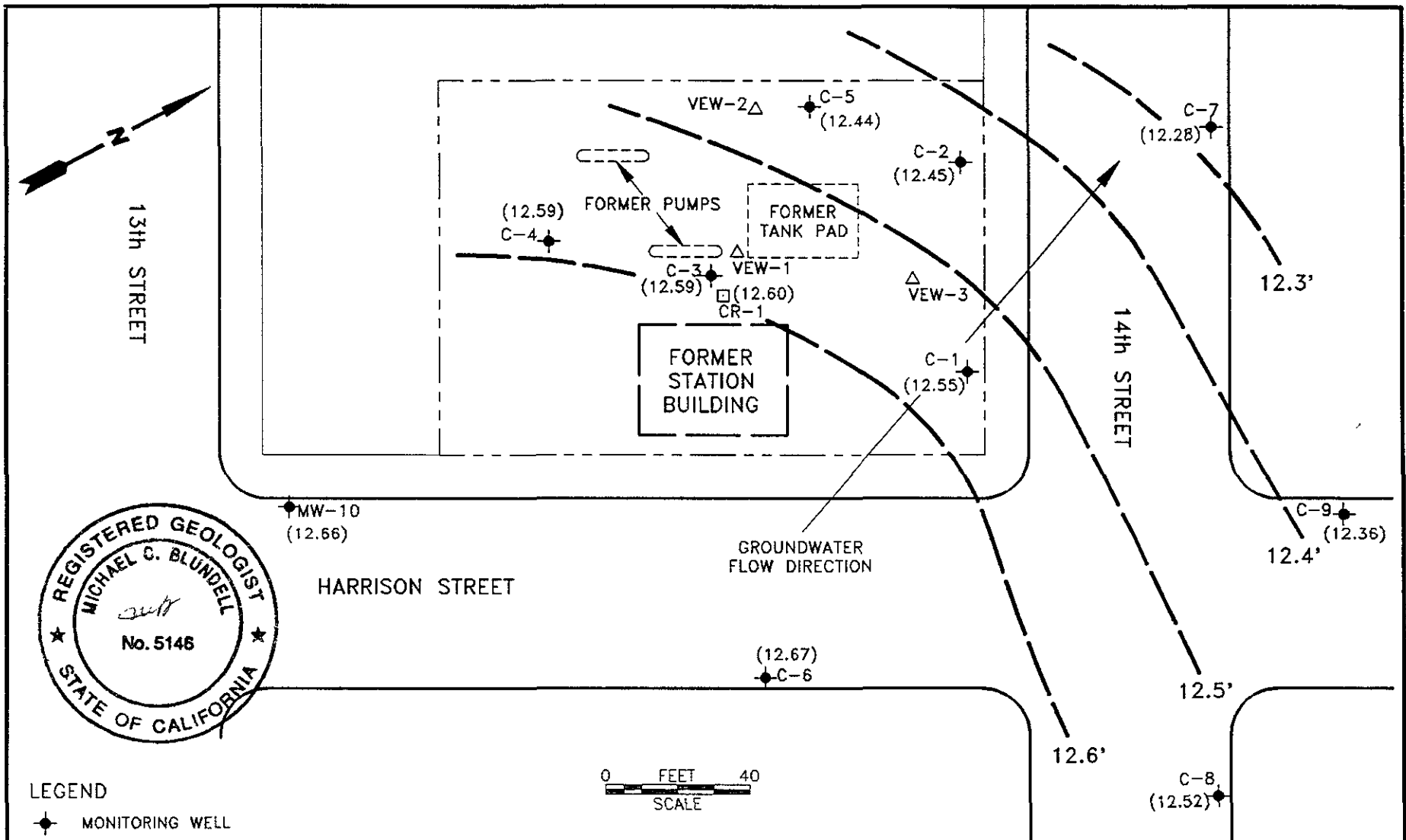

LEGEND

- ◆ MONITORING WELL
- RECOVERY WELL
- △ VAPOR EXTRACTION WELL
- () POTENTIOMETRIC SURFACE ELEVATION
- - - POTENTIOMETRIC SURFACE CONTOUR



 GROUNDWATER TECHNOLOGY		4057 PORT CHICAGO HWY CONCORD, CA 94520 (510) 671-2387		POTENTIOMETRIC SURFACE MAP (12/21/93)		
CLIENT: CHEVRON U.S.A. PRODUCTS Co. SERVICE STATION No. 9-4816			LOCATION: 301 14th STREET OAKLAND, CALIFORNIA		REV. NO.: 0	DATE: 1/11/94
PM <i>LAW</i>	PE/RG <i>Blundell</i>	DESIGNED TW	DETAILED ML	ACAD FILE: PSMd2193/SP493	PROJECT NO.: 020204084	FIGURE: 1

ATTACHMENT 2

Table

TABLE 1
HISTORICAL GROUNDWATER ANALYTICAL RESULTS AND MONITORING DATA
Chevron Service Station No. 9-4816
301 14th Street, Oakland, California

Well ID/ Elevation	Date	TPH-G	Benzene	Toluene	Ethyl- benzene	Xylenes	DTW (ft)	SPT (ft)	WTE (ft)
C-1	06/13/90	26,000	2,800	5,100	400	2,600	21.97	—	8.85
	10/30/90	67,000	6,700	8,700	900	5,000	21.72	—	9.10
30.82	01/04/91	—	—	—	—	—	21.84	—	8.98
	01/07/91	100,000	12,000	20,000	1,600	11,000	21.95	—	8.87
	01/11/91	—	—	—	—	—	21.99	—	8.83
	02/15/91	—	—	—	—	—	22.12	—	8.70
	05/02/91	59,000	5,600	7,700	700	5,200	22.06	—	8.76
	05/30/91	—	—	—	—	—	22.04	—	8.78
	06/13/91	—	—	—	—	—	21.80	—	9.02
	07/12/91	—	—	—	—	—	22.01	—	8.81
	08/07/91	7,900	2,000	150	240	330	—	—	—
	09/24/91	—	—	—	—	—	—	—	—
30.87	10/18/91	—	—	—	—	—	22.42	—	8.45
	11/05/91	8,700	1,500	1,200	150	580	22.36	—	8.51
	01/06/92	—	—	—	—	—	22.34	—	8.53
	01/16/92	—	—	—	—	—	22.28	0.03	8.61
	01/22/92	—	—	—	—	—	22.43	0.09	8.51
	01/28/92	—	—	—	—	—	22.28	0.02	8.61
	02/04/92	—	—	—	—	—	22.24	0.01	8.64
	02/14/92	—	—	—	—	—	22.16	Sheen	8.71
	02/21/92	—	—	—	—	—	22.07	Sheen	8.80
	02/25/92	—	—	—	—	—	21.95	Sheen	8.92
	03/06/92	—	—	—	—	—	21.85	0.00	9.02
	03/19/92	—	—	—	—	—	20.54	0.00	10.33
	05/06/92	—	—	—	—	—	21.39	Sheen	9.48
	08/31/92	—	—	—	—	—	21.51	Sheen	9.36
12/01/92	—	—	—	—	—	21.88	Sheen	8.99	
32.81	03/15/93	130,000	8,900	13,000	1,800	11,000	20.90	0.00	11.91
	06/08/93	23,000	2,300	2,900	540	3,300	19.46	0.00	13.35
	09/07/93	14,000	1,300	2,100	340	2,800	19.83	0.00	12.98
	12/21/93	5,100	380	400	83	370	20.26	0.00	12.55

TABLE 1
HISTORICAL GROUNDWATER ANALYTICAL RESULTS AND MONITORING DATA
Chevron Service Station No. 9-4816
301 14th Street, Oakland, California

Well ID/ Elevation	Date	TPH-G	Benzene	Toluene	Ethyl- benzene	Xylenes	DTW (ft)	SPT (ft)	WTE (ft)
C-2	06/13/90	15,000	1,100	1,900	260	1,700	22.08		8.83
	10/30/90	13,000	2,800	1,900	240	1,000	21.81	--	9.10
30.91	01/04/91	--	--	--	--	--	21.90	--	9.01
	01/07/91	15,000	3,400	2,500	340	1,400	22.03	--	8.88
	01/11/91	--	--	--	--	--	22.13	--	8.78
	02/15/91	--	--	--	--	--	22.36	--	8.55
	05/02/91	19,000	4,500	3,200	660	2,900	22.44	--	8.47
	05/02/91	21,000	3,200	2,200	410	2,000	22.44	--	8.47
	05/30/91	--	--	--	--	--	22.44	--	8.47
	06/13/91	--	--	--	--	--	--	--	--
	07/12/91	--	--	--	--	--	22.57	--	8.35
	30.72	08/07/91	--	--	--	--	--	--	0.01
09/24/91		--	--	--	--	--	--	0.11	--
10/18/91		--	--	--	--	--	22.34	--	8.44
11/05/91		--	--	--	--	--	22.26	0.07	8.49
01/06/92		--	--	--	--	--	22.25	0.04	8.47
01/16/92		--	--	--	--	--	22.16	--	8.57
01/22/92		--	--	--	--	--	22.25	0.01	8.49
01/28/92		--	--	--	--	--	22.18	0.02	8.55
02/04/92		--	--	--	--	--	22.15	0.01	8.58
02/14/92		--	--	--	--	--	22.09	0.01	8.63
02/21/92		--	--	--	--	--	22.06	0.00	8.66
02/25/92		--	--	--	--	--	21.96	Sheen	8.76
03/06/92		--	--	--	--	--	21.80	0.00	8.92
03/19/92		--	--	--	--	--	21.12	0.00	9.60
05/06/92		--	--	--	--	--	21.30	0.00	9.42
33.27	08/31/92	--	--	--	--	--	21.43	Sheen	9.29
	12/01/92	--	--	--	--	--	21.74	Sheen	8.98
	03/15/93	66,000	2,200	3,900	1,300	7,300	20.92	Sheen	12.35
	06/08/93	23,000	1,400	2,300	680	4,000	20.05	0.00	13.22
	09/07/93	22,000	1,900	2,000	620	4,000	20.37	0.00	12.90
	12/21/93	19,000 ✓	2,900 ✓	1,300	540	2,300	20.82	0.00	12.45

TABLE 1
HISTORICAL GROUNDWATER ANALYTICAL RESULTS AND MONITORING DATA
 Chevron Service Station No. 9-4816
 301 14th Street, Oakland, California

Well ID/ Elevation	Date	TPH-G	Benzene	Toluene	Ethyl- benzene	Xylenes	DTW (ft)	SPT (ft)	WTE (ft)
C-3	06/13/90	--	--	--	--	--	24.75	3.00	--
	10/30/90	--	--	--	--	--	23.81	2.50	--
	01/04/91	--	--	--	--	--	24.15	2.70	--
	01/07/91	--	--	--	--	--	24.13	2.50	--
	01/11/91	--	--	--	--	--	24.35	2.66	--
	02/15/91	--	--	--	--	--	24.70	2.93	--
	05/02/91	--	--	--	--	--	--	--	--
	05/30/91	--	--	--	--	--	24.08	2.49	--
	06/13/91	--	--	--	--	--	--	--	--
	07/12/91	--	--	--	--	--	--	--	--
30.79	08/07/91	--	--	--	--	--	--	2.64	--
	09/24/91	--	--	--	--	--	--	--	--
	10/18/91	--	--	--	--	--	24.44	2.50	--#
	11/05/91	--	--	--	--	--	24.31	2.46	--#
	01/06/92	--	--	--	--	--	24.25	2.39	--#
	01/16/92	--	--	--	--	--	24.02	2.29	--#
	01/22/92	--	--	--	--	--	24.10	2.28	--#
	01/28/92	--	--	--	--	--	24.06	2.29	--#
	02/04/92	--	--	--	--	--	24.04	2.31	--#
	02/14/92	--	--	--	--	--	23.93	2.31	--#
	02/21/92	--	--	--	--	--	24.61	3.05	--#
	02/25/92	--	--	--	--	--	23.69	2.23	--#
	03/06/92	--	--	--	--	--	23.69	2.23	--#
03/19/92	--	--	--	--	--	22.98	2.26	--#	
05/06/92	--	--	--	--	--	22.74	1.93	--#	
08/31/92	--	--	--	--	--	21.77	1.93	--#	
12/01/92	--	--	--	--	--	22.63	1.32	--#	
33.28	03/15/93	530,000	69,000	58,000	6,000	32,000	20.76	0.00	12.52
	06/08/93	310,000	56,000	58,000	7,000	41,000	19.97	0.00	13.31
	09/07/93	160,000	48,000	43,000	3,300	24,000	20.28	0.00	13.00
	12/21/93	210,000 /	47,000 /	40,000	4,400	26,000	20.69	0.00	12.59

TABLE 1
HISTORICAL GROUNDWATER ANALYTICAL RESULTS AND MONITORING DATA
 Chevron Service Station No. 9-4816
 301 14th Street, Oakland, California

Well ID/ Elevation	Date	TPH-G	Benzene	Toluene	Ethyl- benzene	Xylenes	DTW (ft)	SPT (ft)	WTE (ft)
C-4	06/13/90	440	47	47	3	61	22.73		8.69
	10/30/90	210	72	13	1	11	22.48	—	8.94
31.42	01/04/91	—	—	—	—	—	22.64	—	8.78
	01/07/91	890	100	130	15	88	22.74	—	8.68
	01/11/91	—	—	—	—	—	22.81	—	8.61
	02/15/91	—	—	—	—	—	22.55	—	8.87
	05/02/91	330	140	11	2	9	22.54	—	8.88
	05/30/91	—	—	—	—	—	22.55	—	8.87
	06/13/91	—	—	—	—	—	—	—	—
	07/12/91	—	—	—	—	—	—	—	—
	08/07/91	1,500	400	79	13	61	—	—	—
	09/24/91	—	—	—	—	—	—	—	—
31.20	10/18/91	—	—	—	—	—	22.97	—	8.23
	11/05/91	310	130	11	2.6	6.8	22.90	—	8.30
	01/06/92	—	—	—	—	—	22.84	—	8.36
	01/16/92	—	—	—	—	—	22.75	—	8.45
	01/22/92	—	—	—	—	—	22.81	—	8.39
	01/28/92	—	—	—	—	—	22.77	—	8.43
	02/04/92	300	100	26	2.4	14	22.72	—	8.48
	02/14/92	—	—	—	—	—	22.58	—	8.62
	02/21/92	—	—	—	—	—	22.60	—	8.60
	02/25/92	—	—	—	—	—	22.50	—	8.70
	03/06/92	—	—	—	—	—	—	—	—
	03/19/92	—	—	—	—	—	21.75	—	9.45
	05/06/92	200	26	<0.5	1.2	1.4	21.82	—	9.38
08/31/92	190	20	1.2	1.7	1.7	21.88	—	9.32	
12/01/92	72	5	0.5	ND<0.5	1.3	22.23	—	8.97	
33.85	03/15/93	84	2.1	0.9	<0.5	<1.5	33.85	—	12.47
	06/08/93	74	1	<0.5	<0.5	0.5	20.55	—	13.30
	09/07/93	<50	1	<0.5	<0.5	<0.5	20.85	0.00	13.00
	12/21/93	310 ✓	14 ✓	52	11	93	21.26	0.00	12.59



TABLE 1
HISTORICAL GROUNDWATER ANALYTICAL RESULTS AND MONITORING DATA
Chevron Service Station No. 9-4816
301 14th Street, Oakland, California

Well ID/ Elevation	Date	TPH-G	Benzene	Toluene	Ethyl- benzene	Xylenes	DTW (ft)	SPT (ft)	WTE (ft)
C-5	10/30/90	20,000	2,500	3,300	320	2,200	22.11	—	9.14
	01/04/91	—	—	—	—	—	22.55	0.31	—
31.25	01/07/91	—	—	—	—	—	22.36	0.04	9.26
	01/11/91	—	—	—	—	—	23.08	0.73	—
	02/15/91	—	—	—	—	—	24.70	2.74	—
	05/02/91	—	—	—	—	—	22.02	2.00	—
	05/30/91	—	—	—	—	—	24.78	2.70	—
	06/13/91	—	—	—	—	—	24.70	2.77	—
	07/12/91	—	—	—	—	—	25.10	2.72	—
30.16	08/07/91	—	—	—	—	—	—	2.69	—
	09/24/91	—	—	—	—	—	—	—	—
	10/18/91	—	—	—	—	—	24.71	2.51	—#
	11/05/91	—	—	—	—	—	24.47	2.29	—#
	01/06/92	—	—	—	—	—	24.68	—	—#
	01/16/92	—	—	—	—	—	24.03	1.82	—#
	01/22/92	—	—	—	—	—	24.01	1.67	—#
	01/28/92	—	—	—	—	—	23.79	1.46	—#
	02/04/92	—	—	—	—	—	23.81	1.54	—#
	02/14/92	—	—	—	—	—	22.79	1.59	—#
	02/21/92	—	—	—	—	—	24.40	2.22	—#
	02/25/92	—	—	—	—	—	23.25	1.03	—#
	03/06/92	—	—	—	—	—	23.20	1.19	—#
	03/19/92	—	—	—	—	—	—	—	—
	05/06/92	—	—	—	—	—	—	—	—
08/31/92	—	—	—	—	—	21.86	Sheen	—	
12/01/92	—	—	—	—	—	22.24	Sheen	—	
33.85	03/15/93	—	—	—	—	—	20.96	—	20.96
	06/08/93	90,000	26,000	11,000	2,000	16,000	20.65	0.00	13.20
	09/07/93	—	—	—	—	—	—	—	—
	12/21/93	130,000 ✓	38,000 ✓	17,000	2,600	13,000	21.41	0.00	12.44

TABLE 1
HISTORICAL GROUNDWATER ANALYTICAL RESULTS AND MONITORING DATA
Chevron Service Station No. 9-4816
301 14th Street, Oakland, California

Well ID/ Elevation	Date	TPH-G	Benzene	Toluene	Ethyl- benzene	Xylenes	DTW (ft)	SPT (ft)	WTE (ft)
C-6 30.41	05/02/91	<50	<0.5	<0.5	<0.5	<0.5	21.84	--	8.57
	05/30/91	--	--	--	--	--	--	--	--
	07/12/91	--	--	--	--	--	22.86	--	7.55
	08/07/91	--	--	--	--	--	--	--	--
	09/24/91	--	--	--	--	--	21.88	--	8.53
	10/18/91	--	--	--	--	--	22.18	--	8.23
	11/05/91	<50	<0.5	<0.5	<0.5	<0.5	22.14	--	8.27
	01/06/92	--	--	--	--	--	22.09	--	8.32
	01/16/92	--	--	--	--	--	22.04	--	8.37
	01/22/92	--	--	--	--	--	22.04	--	8.37
	01/28/92	--	--	--	--	--	21.99	--	8.42
	02/04/92	<50	<0.5	<0.5	<0.5	0.6	21.94	--	8.47
	02/14/92	--	--	--	--	--	21.87	--	8.54
	02/21/92	--	--	--	--	--	21.83	--	8.58
	02/25/92	--	--	--	--	--	21.71	--	8.70
	03/06/92	--	--	--	--	--	21.53	--	8.88
	03/19/92	--	--	--	--	--	20.92	--	9.49
05/06/92	<50	<0.5	<0.5	<0.5	<0.5	21.02	--	9.39	
08/31/92	80	<0.5	<0.5	<0.5	<0.5	21.14	--	9.27	
01/21/93	<50	<0.5	<0.5	<0.5	<0.5	20.91	--	9.50	
33.09	03/15/93	<50	<0.5	<0.5	<0.5	<1.5	20.00	--	13.09
	06/08/93	<50	<0.5	<0.5	<0.5	<0.5	19.72	0.00	13.37
	09/07/93	<50	<0.5	<0.5	<0.5	<0.5	19.75	0.00	13.34
	12/21/93	<50 ✓	<0.5 ✓	<0.5	<0.5	<0.5	20.42	0.00	12.67

TABLE 1
HISTORICAL GROUNDWATER ANALYTICAL RESULTS AND MONITORING DATA
Chevron Service Station No. 9-4816
301 14th Street, Oakland, California

Well ID/ Elevation	Date	TPH-G	Benzene	Toluene	Ethyl- benzene	Xylenes	DTW (ft)	SPT (ft)	WTE (ft)
C-7	05/02/91	<50	<0.5	<0.5	<0.5	<0.5	21.81	—	8.75
	05/30/91	—	—	—	—	—	—	—	—
30.56	07/12/91	—	—	—	—	—	22.15	—	8.41
	08/07/91	<50	<0.5	<0.5	<0.5	<0.5	—	—	—
	09/24/91	—	—	—	—	—	21.53	—	9.03
	10/18/91	—	—	—	—	—	22.07	—	8.49
	11/05/91	<50	<0.5	<0.5	<0.5	<0.5	22.01	—	8.55
	01/06/92	—	—	—	—	—	22.03	—	8.53
	01/16/92	—	—	—	—	—	21.98	—	8.58
	01/22/92	—	—	—	—	—	22.05	—	8.51
	01/28/92	—	—	—	—	—	22.01	—	8.55
	02/14/92	—	—	—	—	—	21.94	—	8.62
	02/21/92	—	—	—	—	—	21.94	—	8.62
	02/25/92	—	—	—	—	—	21.82	—	8.74
	03/06/92	—	—	—	—	—	21.65	—	8.91
	03/19/92	—	—	—	—	—	20.92	—	9.64
	05/06/92	<50	<0.5	<0.5	<0.5	<0.5	21.21	—	9.35
08/31/92	<50	<0.5	0.7	<0.5	0.9	21.39	—	9.17	
12/01/92	<50	<0.5	<0.5	<0.5	0.9	21.79	—	8.77	
33.06	03/15/93	<50	<0.5	<0.5	<0.5	<1.5	20.94	—	12.12
	06/08/93	<50	<0.5	<0.5	<0.5	<0.5	19.99	0.00	13.07
	09/07/93	2,800	63	36	41	40	20.00	0.00	13.06
	12/21/93	<50 ✓	<0.5 ✓	<0.5	<0.5	<0.5	20.78	0.00	12.28

TABLE 1
HISTORICAL GROUNDWATER ANALYTICAL RESULTS AND MONITORING DATA
Chevron Service Station No. 9-4816
301 14th Street, Oakland, California

Well ID/ Elevation	Date	TPH-G	Benzene	Toluene	Ethyl- benzene	Xylenes	DTW (ft)	SPT (ft)	WTE (ft)
C-8 30.12	05/02/91	5,000	<0.5	17	140	470	21.24	--	8.88
	05/30/91	--	--	--	--	--	--	--	--
	07/12/91	--	--	--	--	--	--	--	--
	08/07/91	6,300	<0.5	28	100	120	--	--	--
	09/24/91	--	--	--	--	--	21.33	--	8.79
	10/18/91	--	--	--	--	--	21.76	--	8.36
	11/05/91	5,100	<0.5	20	92	74	21.70	--	8.42
	01/06/92	--	--	--	--	--	21.73	--	8.39
	01/16/92	--	--	--	--	--	21.63	--	8.49
	01/22/92	--	--	--	--	--	21.70	--	8.42
	01/28/92	--	--	--	--	--	21.65	--	8.47
	02/04/92	5,300	<2.5	2.5	97	61	21.62	--	8.50
	02/14/92	--	--	--	--	--	21.53	--	8.59
	02/21/92	--	--	--	--	--	21.51	--	8.61
	02/25/92	--	--	--	--	--	21.39	--	8.73
	03/06/92	--	--	--	--	--	21.21	--	8.91
	03/19/92	--	--	--	--	--	20.57	--	9.55
32.77	05/06/92	3,700	<0.5	29	110	130	20.77	--	9.35
	08/31/92	1,100	1.3	2.0	31	48	20.91	--	9.21
	12/01/92	3,400	<0.5	19	140	290	21.17	--	8.95
	03/15/93	4,200	<0.5	20	54	33	19.76	--	13.01
	06/08/93	3,700	53	6	74	120	19.38	0.00	13.39
	09/07/93	2,900	70	46	39	55	19.38	0.00	13.39
	12/21/93	3,500 ✓	18 ✓	57	60	140	20.25	0.00	12.52

TABLE 1
HISTORICAL GROUNDWATER ANALYTICAL RESULTS AND MONITORING DATA
Chevron Service Station No. 9-4816
301 14th Street, Oakland, California

Well ID/ Elevation	Date	TPH-G	Benzene	Toluene	Ethyl- benzene	Xylenes	DTW (ft)	SPT (ft)	WTE (ft)
C-9	05/02/91	<50	<0.5	<0.5	<0.5	0.8	21.27	—	8.88
	05/30/91	—	—	—	—	—	—	—	—
30.15	07/12/91	—	—	—	—	—	21.57	—	8.58
	08/07/91	<50	<0.5	<0.5	<0.5	<0.5	—	—	—
	08/07/91	<50	<0.5	<0.5	<0.5	<0.5	—	—	—
	09/24/91	—	—	—	—	—	21.10	—	9.05
	10/18/91	—	—	—	—	—	21.67	—	8.48
	11/05/91	<50	<0.5	<0.5	<0.5	<0.5	21.65	—	8.50
	11/05/91	<50	<0.5	<0.5	<0.5	<0.5	21.65	—	8.50
	01/06/92	—	—	—	—	—	21.65	—	8.50
	01/16/92	—	—	—	—	—	21.58	—	8.57
	01/22/92	—	—	—	—	—	21.65	—	8.50
	01/28/92	—	—	—	—	—	21.63	—	8.52
	02/04/92	<50	<0.5	0.7	<0.5	0.7<0.5	21.58	—	8.57
	02/04/92	<50	<0.5	<0.5	<0.5	—	21.58	—	8.57
	02/14/92	—	—	—	—	—	21.54	—	8.61
	02/21/92	—	—	—	—	—	21.52	—	8.63
	02/25/92	—	—	—	—	—	21.39	—	8.76
	03/06/92	—	—	—	—	—	21.21	—	8.94
03/19/92	—	—	—	—	—	20.47	—	9.68	
05/06/92	<50	<0.5	<0.5	<0.5	<0.5	20.81	—	9.34	
08/31/92	<50	<0.5	<0.5	<0.5	<0.5	20.97	—	9.18	
12/01/92	<50	<0.5	<0.5	<0.5	<1.5	21.27	—	8.88	
32.70	03/15/93	<50	<0.5	<0.5	<0.5	<0.5	20.42	—	12.28
	06/08/93	<50	<0.5	<0.5	<0.5	<0.5	19.43	0.00	13.27
	09/07/93	<50	<0.5	<0.5	<0.5	<0.5	19.40	0.00	13.30
	12/21/93	<50	<0.5	<0.5	<0.5	<0.5	20.34	0.00	12.36

TABLE 1
HISTORICAL GROUNDWATER ANALYTICAL RESULTS AND MONITORING DATA
Chevron Service Station No. 9-4816
301 14th Street, Oakland, California

Well ID/ Elevation	Date	TPH-G	Benzene	Toluene	Ethyl- benzene	Xylenes	DTW (ft)	SPT (ft)	WTE (ft)
CR-1	10/30/90	---	---	---	---	---	23.81	2.50	---
	01/04/91	---	---	---	---	---	24.08	2.70	---
30.17	01/07/91	---	---	---	---	---	23.30	3.00	---
	01/11/91	---	---	---	---	---	24.24	2.64	---
	02/15/91	---	---	---	---	---	24.72	2.92	---
	05/02/91	---	---	---	---	---	---	---	---
	05/30/91	---	---	---	---	---	23.07	2.42	---
	06/13/91	---	---	---	---	---	---	---	---
	07/12/91	---	---	---	---	---	---	---	---
	08/07/91	---	---	---	---	---	---	2.69	---
	09/24/91	---	---	---	---	---	---	---	---
	10/18/91	---	---	---	---	---	23.75	2.50	---#
	11/05/91	---	---	---	---	---	23.64	2.43	---#
	01/06/92	---	---	---	---	---	23.57	---	---#
	01/16/92	---	---	---	---	---	23.41	2.30	---#
	01/22/92	---	---	---	---	---	23.44	2.24	---#
	01/28/92	---	---	---	---	---	23.40	2.29	---#
	02/14/92	---	---	---	---	---	23.31	2.34	---#
	02/21/92	---	---	---	---	---	24.10	3.19	---#
	02/25/92	---	---	---	---	---	23.15	1.03	---#
	03/06/92	---	---	---	---	---	---	---	---
	03/19/92	---	---	---	---	---	---	---	---
05/06/92	---	---	---	---	---	---	---	---	
08/31/92	---	---	---	---	---	21.84	0.41	---	
12/01/92	---	---	---	---	---	22.06	0.21	---	
33.40	03/15/93	410,000	28,000	42,000	5,200	37,000	20.34	---	---
	06/08/93	85,000	10,000	21,000	3,200	20,000	20.07	0.00	13.33
	09/07/93	180,000	50,000	48,000	5,100	33,000	20.07	0.00	13.33
	12/21/93	170,000 ✓	34,000 ✓	41,000	4,600	31,000	20.80	0.00	12.60

TABLE 1
HISTORICAL GROUNDWATER ANALYTICAL RESULTS AND MONITORING DATA
Chevron Service Station No. 9-4816
301 14th Street, Oakland, California

Well ID/ Elevation	Date	TPH-G	Benzene	Toluene	Ethyl- benzene	Xylenes	DTW (ft)	SPT (ft)	WTE (ft)
MW-10 31.59 33.28	01/21/93	<50	<0.5	<0.5	<0.5	<0.5	21.27	—	10.32
	03/15/93	<50	<0.5	<0.5	<0.5	<1.5	21.10	—	12.18
	06/08/93	<50	<0.5	<0.5	<0.5	1	19.95	0.00	13.33
	09/07/93	<250	<2.5	<2.5	<2.5	<2.5	19.93	0.00	13.35
	12/21/93	<50 ✓	<0.5 ✓	<0.5	<0.5	<0.5	20.62	0.00	12.66
TB-LB	05/02/91	<50	<0.5	<0.5	<0.5	<0.5	NA	NA	NA
	08/07/91	<50	<0.5	<0.5	<0.5	<0.5	NA	NA	NA
	11/05/91	<50	<0.5	<0.5	<0.5	<0.5	NA	NA	NA
	02/04/92	<50	<0.5	<0.5	<0.5	<0.5	NA	NA	NA
	05/06/92	<50	<0.5	<0.5	<0.5	<0.5	NA	NA	NA
	08/31/92	<50	<0.5	<0.5	<0.5	<0.5	NA	NA	NA
	12/01/92	<50	<0.5	<0.5	<0.5	<0.5	NA	NA	NA
	03/15/93	<50	<0.5	<0.5	<0.5	<1.5	NA	NA	NA
	06/08/93	<50	<0.5	<0.5	<0.5	<0.5	—	—	—
	09/07/93	<50	<0.5	<0.5	<0.5	<0.5	—	—	—
12/21/93	<50 ✓	<0.5 ✓	<0.5	<0.5	<0.5	—	—	—	
RINSATE	08/07/91	<50	<0.5	<0.5	<0.5	<0.5	NA	NA	NA
	11/05/91	<50	<0.5	<0.5	<0.5	<0.5	NA	NA	NA
	02/04/92	<50	<0.5	1.1	<0.5	<0.5	NA	NA	NA
	05/06/92	<50	<0.5	<0.5	<0.5	<0.5	NA	NA	NA
	08/31/92	<50	<0.5	<0.5	<0.5	<0.5	NA	NA	NA
	12/01/92	<50	<0.5	<0.5	<0.5	<0.5	NA	NA	NA
12/21/93	<50	<0.5	<0.5	<0.5	<0.5	—	—	—	

TPH-G = Total petroleum hydrocarbons-as-gasoline
DTW = Depth to groundwater
SPT = Separate-phase hydrocarbon thickness
WTE = Water-table elevation
TB-LB = Trip blank, lab blank

vGroundwater elevation not computed for wells containing greater than 0.20 feet of separate-phase hydrocarbons

Groundwater elevations not compiled for wells containing greater than 0.20 feet of separate-phase hydrocarbons

Concentrations in parts per billion

Data from June 13, 1990 to March 15, 1993 are from Alton GeoSciences report dated April 27, 1993.

ATTACHMENT 3

Field Data Sheets

Project Name: Chevron - 14th St.

Date: 12 / 93

Site Address: 301 14th St., Oakland

Page _____ of _____

Project Number: 020204084.0610

Project Manager: Tim Watchers

Well ID: MW10

DTW Measurements:

Well Diameter: 2"

Initial: _____ Calc Well Volume: _____ gal
Recharge: _____ Well Volume: 7 gal

Purge Method _____ Pump Depth _____ ft.
 Peristaltic _____ Hand Bailed _____
 Gear Drive _____ Air Lift _____
 Submersible X Other _____

Instruments Used
 YSI: _____ Other: _____
 Hydac: _____
 Omega: _____
Horiba X

Time	Temp <u>X</u> C F	Conductivity	pH	Purge Volume Gallons	Turbidity	Comments
8:22	10.2	.382	8.16	2		cloudy
8:23	15.6	.302	8.18	4		↓
8:24	17.5	.303	8.21	6		
8:24	18.1	.303	8.22	7		

Project Name: Chevron - 14th St.

Date: 12/21/93

Site Address: 301 14th St., Oakland

Page _____ of _____

Project Number: 020204084.0610

Project Manager: Tim Watchers

Well ID: CR-1

DTW Measurements:

Well Diameter: 6"

Initial: _____ Calc Well Volume: _____ gal

Recharge: _____ Well Volume: 37 gal

Purge Method _____ Pump Depth _____ ft.
 Peristaltic _____ Hand Bailed _____
 Gear Drive _____ Air Lift _____
 Submersible _____ Other _____

Instruments Used
 YSI: _____ Other: _____
 Hydac: _____
 Omega: _____

Time	Temp <u>X</u> C ____ F	Conductivity	pH	Purge Volume Gallons	Turbidity	Comments
9:28	18.9	1.06	8.34	10		cloudy
9:32	19.9	1.09	8.29	20		↓
9:36	20.1	1.09	8.31	30		
9:38	20.3	1.10	8.30	37		
						ODOR

Project Name: Chevron - 14th St.

Date: 12-31/93

Site Address: 301 14th St, Oakland

Page _____ of _____

Project Number: 020204084.0610

Project Manager: Tim Watchers

Well ID: C4

DTW Measurements:

Well Diameter: 2"

Initial: _____ Calc Well Volume: _____ gal

Recharge: _____ Well Volume: 6 gal

Purge Method Pump Depth _____ ft.

Peristaltic _____ Hand Bailed _____

Gear Drive _____ Air Lift _____

Submersible X Other _____

Instruments Used

YSI: _____ Other: _____

Hydac: _____

Omega: _____

Horiba X

Time	Temp <u>X</u> C F	Conductivity	pH	Purge Volume Gallons	Turbidity	Comments
9:46	16.8	.831	8.38	2		milky
9:47	18.0	.808	8.35	4		
9:47	18.4	.879	8.34	5		
9:48	18.7	.898	8.34	6		
9:48	18.8	.901	8.35	7		ODOR

Project Name: Chevron - 14th St.

Date: 12/1/93

Site Address: 301 14th St., Oakland

Page _____ of _____

Project Number: 020204084.0610

Project Manager: Tim Watchers

Well ID: C.8

DTW Measurements:

Well Diameter: 2"

Initial: _____ Calc Well Volume: _____ gal

Recharge: _____ Well Volume: 7 gal

Purge Method Pump Depth _____ ft.

Peristaltic _____ Hand Bailed _____

Gear Drive _____ Air Lift _____

Submersible X Other _____

Instruments Used

YSI: _____ Other: _____

Hydac: _____

Omega: _____

Horiba X

Time	Temp <u>X</u> C F	Conductivity	pH	Purge Volume Gallons	Turbidity	Comments
10:08	15.8	.688	8.43	2		cloudy
10:09	18.3	.757	8.33	4		↓
10:10	18.8	.781	8.34	6		
10:10	18.9	.762	8.35	7		↓
						ODOR

Project Name: Chevron - 14th St.

Date: 11/21/93

Site Address: 301 14th St., Oakland

Page _____ of _____

Project Number: 020204084.0610

Project Manager: Tim Watchers

Well ID: C.3

DTW Measurements:

Well Diameter: 2"

Initial: _____ Calc Well Volume: _____ gal
Recharge: _____ Well Volume: 4 gal

Purge Method Pump Depth _____ ft.
Peristaltic _____ Hand Bailed _____
Gear Drive _____ Air Lift _____
Submersible X Other _____

Instruments Used
YSI: _____ Other: _____
Hydac: _____
Omega: _____

Horiba X

Time	Temp <u>X</u> C F	Conductivity	pH	Purge Volume Gallons	Turbidity	Comments
10:27	13.0	.804	8.47	1		cloudy
10:27	16.0	.103	8.33	2		↓
10:28	17.2	.097	8.32	3		
10:28	18.0	1.07	8.25	4	Dry	

Project Name: Chevron - 14th St.

Date: 1-21/93

Site Address: 301 14th St., Oakland

Page _____ of _____

Project Number: 020204084.0610

Project Manager: Tim Watchers

Well ID: C2

DTW Measurements:

Well Diameter: 2"

Initial: _____ Calc Well Volume: _____ gal

Recharge: _____ Well Volume: 4 gal

Purge Method _____ Pump Depth _____ ft.
 Peristaltic _____ Hand Bailed _____
 Gear Drive _____ Air Lift _____
 Submersible X Other _____

Instruments Used
 YSI: _____ Other: _____
 Hydac: _____
 Omega: _____
Horiba X

Time	Temp <u>X</u> C F	Conductivity	pH	Purge Volume Gallons	Turbidity	Comments
10:47	16.0	.885	8.34	1		cloudy
10:47	17.4	.981	8.27	2		↓
10:48	18.6	.982	8.21	3		↓
10:48	19.6	1.05	8.19	4		almost
10:49	19.9	1.07	8.23	5		clear
10:49	20.0	1.08	8.24	6		↓

Project Name: Chevron - 14th St.

Date: 12/21/93

Site Address: 301 14th St., Oakland

Page _____ of _____

Project Number: 020204084.0610

Project Manager: Tim Watchers

Well ID: C1

DTW Measurements:

Well Diameter: 2"

Initial: _____ Calc Well Volume: _____ gal
Recharge: _____ Well Volume: 5 gal

Purge Method _____ Pump Depth _____ ft.
Peristaltic _____ Hand Bailed _____
Gear Drive _____ Air Lift _____
Submersible Other _____

Instruments Used
YSI: _____ Other: _____
Hydac: _____
Omega: _____

Horiba

Time	Temp <input checked="" type="checkbox"/> C _____ F	Conductivity	pH	Purge Volume Gallons	Turbidity	Comments
10:59	17.0	.376	8.49	2		cloudy ↓
10:59	18.2	.369	8.45	3		
11:00	19.0	.384	8.41	4		
11:00	19.7	.392	8.42	5		
11:01	20.0	.404	8.43	6		
11:01	20.2	.414	8.45	7		
11:02	20.2	.427	8.48	8		

Project Name: Chevron - 14th St.

Date: 12/21/93

Site Address: 301 14th St., Oakland

Page _____ of _____

Project Number: 020204084.0610

Project Manager: Tim Watchers

Well ID: C5

DTW Measurements:

Well Diameter: 2"

Initial: _____ Calc Well Volume: _____ gal

Recharge: _____ Well Volume: 6 gal

Purge Method _____ Pump Depth _____ ft.
 Peristaltic _____ Hand Bailed _____
 Gear Drive _____ Air Lift _____
 Submersible _____ Other _____

Instruments Used
 YSI: _____ Other: _____
 Hydac: _____
 Omega: _____

Horsehair

Time	Temp <u>X</u> C F	Conductivity	pH	Purge Volume Gallons	Turbidity	Comments
11:17	17.6	934	8.38	2		Milky
11:18	19.1	1.15	8.26	4	728	Black
11:18	19.9	1.16	8.22	5	117	sheen
11:19	20.3	1.15	8.24	6	82	↓
11:19	20.4	1.14	8.25	7		cloudy
						ODOR

D.O. = 1.11 mg/L

Sal. = 0.05 %

ATTACHMENT 4
Laboratory Report



4080 Pike Lane
Concord, CA 94520
(510) 685-7852
(800) 544-3422 Inside CA
(800) 423-7143 Outside CA
(510) 825-0720 FAX

Client Number: 020204084
Consultant Project Number: 020204084.0610
Facility Number: 9-4186
Project ID: 301 14th St.
Oakland, CA
Work Order Number: C3-12-0451

January 6, 1994

Tim Watchers
Groundwater Technology, Inc.
4057 Port Chicago Hwy.
Concord, CA 94520

Enclosed please find the analytical results for samples received by GTEL Environmental Laboratories, Inc. on 12/22/93.

A formal Quality Assurance/Quality Control (QA/QC) program is maintained by GTEL, which is designed to meet or exceed the EPA requirements. Analytical work for this project met QA/QC criteria, unless otherwise stated in the footnotes.

GTEL is certified by the California State Department of Health Services, Laboratory certification number E1075, to perform analyses for drinking water, wastewater, and hazardous waste materials according to EPA protocols.

If you have any questions concerning this analysis or if we can be of further assistance, please call our Customer Service Representative.

Sincerely,
GTEL Environmental Laboratories, Inc.

A handwritten signature in black ink, appearing to read 'Rashmi Shah', is written over a horizontal line.

Rashmi Shah
Laboratory Director

Client Number: 020204084
 Consultant Project Number: 020204084.0610
 Facility Number: 9-4186
 Project ID: 301 14th St.
 Oakland, CA
 Work Order Number: C3-12-0451

Table 1
ANALYTICAL RESULTS
 Volatile Organics in Water

EPA Methods 5030, 8020, and Modified 8015^a

GTEL Sample Number		01	02	03	05
Client Identification		TBLB	RBMW10	MW10	C6
Date Sampled		12/21/93	12/21/93	12/21/93	12/21/93
Date Analyzed		01/02/94	01/02/94	01/03/94	01/02/94
Analyte	Detection Limit, ug/L	Concentration, ug/L			
Benzene	0.5	<0.5	<0.5	<0.5	<0.5
Toluene	0.5	<0.5	<0.5	<0.5	<0.5
Ethylbenzene	0.5	<0.5	<0.5	<0.5	<0.5
Xylene, total	0.5	<0.5	<0.5	<0.5	<0.5
TPH as Gasoline	50	<50	<50	<50	<50
Detection Limit Multiplier		1	1	1	1
BFB surrogate, % recovery		91.3	91.8	113	92.8

a. Test Methods for Evaluating Solid Waste, SW-846, Third Edition, Revision 0, US EPA November 1986. Modification for TPH as gasoline as per California State Water Resources Board LUFT Manual procedures. Bromofluorobenzene surrogate recovery acceptability limits are 70-130%.

Client Number: 020204084
 Consultant Project Number: 020204084.0610
 Facility Number: 9-4186
 Project ID: 301 14th St.
 Oakland, CA
 Work Order Number: C3-12-0451

Table 1 (continued)

ANALYTICAL RESULTS

Volatile Organics in Water

EPA Methods 5030, 8020, and Modified 8015a

GTEL Sample Number		06	08	10	12
Client Identification		C8	C9	C7	CR1
Date Sampled		12/21/93	12/21/93	12/21/93	12/21/93
Date Analyzed		01/02/94	01/02/94	01/03/94	01/02/94
Analyte	Detection Limit, ug/L	Concentration, ug/L			
Benzene	0.5	18	<0.5	<0.5	34000
Toluene	0.5	57	<0.5	<0.5	41000
Ethylbenzene	0.5	60	<0.5	<0.5	4600
Xylene, total	0.5	140	<0.5	<0.5	31000
TPH as Gasoline	50	3500	<50	<50	170000
Detection Limit Multiplier		2	1	1	200
BFB surrogate, % recovery		94.5	91.1	97.1	88.9

- a. Test Methods for Evaluating Solid Waste, SW-846, Third Edition, Revision 0, US EPA November 1986. Modification for TPH as gasoline as per California State Water Resources Board LUFT Manual procedures. Bromofluorobenzene surrogate recovery acceptability limits are 70-130%.

Client Number: 020204084
 Consultant Project Number: 020204084.0610
 Facility Number: 9-4186
 Project ID: 301 14th St.
 Oakland, CA
 Work Order Number: C3-12-0451

Table 1 (continued)

ANALYTICAL RESULTS

Volatile Organics in Water

EPA Methods 5030, 8020, and Modified 8015a

GTEL Sample Number		14	16	18	20
Client Identification		C4	C3	C2	C1
Date Sampled		12/21/93	12/21/93	12/21/93	12/21/93
Date Analyzed		01/02/94	01/03/94	01/02/94	01/02/94
Analyte	Detection Limit, ug/L	Concentration, ug/L			
Benzene	0.5	14	47000	2900	380
Toluene	0.5	52	40000	1300	400
Ethylbenzene	0.5	11	4400	540	83
Xylene, total	0.5	93	26000	2300	370
TPH as Gasoline	50	310	210000	19000	5100
Detection Limit Multiplier		1	200	25	25
BFB surrogate, % recovery		92.2	88.7	90.5	89.7

- a. Test Methods for Evaluating Solid Waste, SW-846, Third Edition, Revision 0, US EPA November 1986. Modification for TPH as gasoline as per California State Water Resources Board LUFT Manual procedures. Bromofluorobenzene surrogate recovery acceptability limits are 70-130%.

Client Number: 020204084
 Consultant Project Number: 020204084.0610
 Facility Number: 9-4186
 Project ID: 301 14th St.
 Oakland, CA
 Work Order Number: C3-12-0451

Table 1 (continued)

ANALYTICAL RESULTS

Volatile Organics in Water

EPA Methods 5030, 8020, and Modified 8015^a

GTEL Sample Number		22	M1294		
Client Identification		C5	METHOD BLANK		
Date Sampled		12/21/93	--		
Date Analyzed		01/02/94	01/02/94		
Analyte	Detection Limit, ug/L	Concentration, ug/L			
Benzene	0.5	38000	<0.5		
Toluene	0.5	17000	<0.5		
Ethylbenzene	0.5	2600	<0.5		
Xylene, total	0.5	13000	<0.5		
TPH as Gasoline	50	130000	<50		
Detection Limit Multiplier		200	1		
BFB surrogate, % recovery		88.9	90.3		

- a. Test Methods for Evaluating Solid Waste, SW-846, Third Edition, Revision 0, US EPA November 1986. Modification for TPH as gasoline as per California State Water Resources Board LUFT Manual procedures. Bromofluorobenzene surrogate recovery acceptability limits are 70-130%.

Client Number: 020204084
Consultant Project Number: 020204084.0610
Facility Number: 9-4186
Project ID: 301 14th St.
Oakland, CA
Work Order Number: C3-12-0451

QC Matrix Spike and Duplicate Spike Results

Matrix: Water

Analyte	Sample ID	Spike Amount	Units	Recovery, %	Duplicate Recovery, %	RPD, %	Control Limits
Modified EPA 8020:							
Benzene	C3120450-04	20.0	ug/L	94.0	100	6.2	55 - 129
Toluene	C3120450-04	20.0	ug/L	95.0	101	6.1	72 - 149
Ethylbenzene	C3120450-04	20.0	ug/L	92.5	98.0	5.8	75 - 138
Xylene, total	C3120450-04	60.0	ug/L	93.8	99.3	5.7	74 - 147

copy of Lab Report and COC to Chevron Contact: Yes No

Chain-of-Custody-Record

Chevron U.S.A. Inc.
P.O. BOX 5004
San Ramon, CA 94583
FAX (415)842-9591

Chevron Facility Number 9-4814
Facility Address 301 14th St Oakland CA.
Consultant Project Number 820204084. 0610
Consultant Name Groundwater Technology, Inc.
Address 4057 Port Chicago Hwy, Concord, CA. 94520
Project Contact (Name) Tim Watchers
(Phone) 510-671-2387 (Fax Number) _____

Chevron Contact (Name) N. Vukelich
(Phone) _____
Laboratory Name G-TFL
Laboratory Release Number 913-6857
Samples Collected by (Name) Randy Ray Pallejos
Collection Date 12/21/93
Signature Randy Ray Pallejos

Sample Number	Lab Sample Number	Number of Containers	Matrix		Type	Time	Sample Preservation	Iced (Yes or No)	Analyses To Be Performed										Remarks	
			S = Soil	W = Water					A = Air	C = Charcoal	G = Grab	C = Composite	D = Discrete	BTEX + TPH GAS (8020 + 8015)	TPH Diesel (8015)	Oil and Grease (8520)	Purgeable Halocarbons (8010)	Purgeable Aromatics (8020)		Purgeable Organics (8240)
RBC3	15	1u	W		G	1:50	Hcl	Yes										X	Hold	
C3	16	2u				↓			X											
RBC2	17	1u				2:00												X		
C2	18	2u				↓			X											
RBC1	19	1u				2:10												X		
C1	20	2u				↓			X											
RBC5	21	1u				2:20												X		
C5	22	2u	↓		↓	↓	↓	↓	X											Very Hot!

NOTE:
Do NOT BILL TB-LB SAMPLES
SEAN WISAKS, GC
ICR AT JCC

C3, 2, 045,

Relinquished By (Signature) <u>Randy Ray Pallejos</u>	Organization <u>GTI</u>	Date/Time <u>12/22/93</u>	Received By (Signature) <u>John Weber</u>	Organization <u>GTI</u>	Date/Time <u>12/22/93 8:00</u>	Turn Around Time (Circle Choice) 24 Hrs. 48 Hrs. 5 Days 10 Days As Contracted
Relinquished By (Signature) <u>John Weber</u>	Organization <u>GTI</u>	Date/Time <u>12/23/93 1:30</u>	Received By (Signature) <u>John Weber</u>	Organization <u>GTEL</u>	Date/Time <u>12/22/93 1:30</u>	
Relinquished By (Signature) <u>[Signature]</u>	Organization <u>[Organization]</u>	Date/Time <u>1/7/20</u>	Received For Laboratory By (Signature) <u>[Signature]</u>	Organization <u>[Organization]</u>	Date/Time <u>1/1/93 5:00</u>	

Fac. copy of Lab Report and COC to Chevron Contact: Yes No

Chain-of-Custody-Record

Chevron Facility Number 9-4186
 Facility Address 301 14th St Oakland CA.
 Consultant Project Number 020204084.0610.
 Consultant Name Groundwater Technology, Inc.
 Address 4057 Port Chicago Hwy, Concord, CA. 94520
 Project Contact (Name) Tim Watchers
 (Phone) 510-671-2387 (Fax Number)

Chevron Contact (Name) N. Vokelich
 (Phone)
 Laboratory Name G-TEL
 Laboratory Release Number 913-6850
 Samples Collected by (Name) Randy Ray Phillips
 Collection Date 12/21/93
 Signature Randy Ray Phillips

Sample Number	Lot Sample Number	Number of Containers	Matrix S = Soil W = Water A = Air C = Charcoal	Type G = Grab C = Composite D = Discrete	Time	Sample Preservation	Leak (Yes or No)	Analyses To Be Performed											Remarks					
								BTX + TPH GAS (8020 + 8015)	TPH Diesel (8015)	Oil and Grease (5520)	Purgeable Halocarbons (8010)	Purgeable Aromatics (8020)	Purgeable Organics (8240)	Extractable Organics (8270)	Metals Cd, Cr, Pb, Zn, Ni (ICAP or AA)									
TBLB	01	2v	W	G		Hcl	Yes	X																
RBMW10	02	1v			12:30			X																
MW10	03	2v						X																
RBC6	04	1v			12:45			X																
C6	05	2v						X																
C8	06	2v			1:00			X																
RBC9	07	1v			1:15			X																
C9	08	2v						X																
RBC7	09	1v			1:20			X																
C7	10	2v						X																
RBCR1	11	1v			1:30			X																
CR1	12	2v						X																
RBC4	13	1v			1:40			X																
CH	14	2v	✓	✓			✓	X																

NOTE:
 Do NOT BILL TB-LB SAMPLES
 SEAL INSTEAD
 OWICEAS J.P.

Relinquished By (Signature) <u>Randy Ray Phillips</u>	Organization <u>G.T.I.</u>	Date/Time <u>12/22/93</u>	Received By (Signature) <u>R.M. Shurna</u>	Organization <u>GTI</u>	Date/Time <u>12/22/93</u>	Turn Around Time (Circle Choice) <u>8:00</u>
Relinquished By (Signature) <u>R.M. Shurna</u>	Organization <u>GTI</u>	Date/Time <u>12/22/93</u>	Received By (Signature) <u>John Weber</u>	Organization <u>G-TEL</u>	Date/Time <u>12/22/93</u>	24 Hrs. 48 Hrs. 5 Days 10 Days As Contracted
Relinquished By (Signature) <u>John Weber</u>	Organization <u>B.T.F.C.</u>	Date/Time <u>12/22/93</u>	Received For Laboratory By (Signature) <u>B.T.F.C.</u>		Date/Time <u>12/22/93</u>	5:00