

Meeting on 12/08/95
Oro Loma Sanitary District
2600 Grant Ave, San Lorenzo CA 94580
StId 1996

Attendees: Mike Cortez (OLSD), John Sutton and Bob Murawski (Consultant, Sutton Group), Amy Leech (ALCO)

Meeting held to discuss ALCO's letter dated November 9, 1995 and direction of investigations prior to submitting the next work plan.

Mr. Sutton presented soil investigations in the vicinity of the gasoline UST. He indicated that they believe they have a good idea of the extent of the soil contamination in this area. He has prepared a draft work plan to remove contaminated soil down to approx. 10' in the affected area. He indicated that the first 5' of soil is predominately not impacted but soil from 5-10' is where the source of contamination exists.

We discussed looking at cleanup goals with risk vs cost benefit using ASTM's RBCA tiered approach. By January 10th they proposed to do the following:

- Define potential receptors at risk, e.g. human, surface waters, groundwater. Compare data we currently have at site to ASTM's RBCA
- Prepare a work plan for defining the extent of groundwater contamination in the vicinity of the gasoline UST. (Will also include soil/groundwater investigation in the diesel impacted area.) This plan would not necessarily propose permanent monitoring wells at this time since extensive overexcavation may be necessary in this area.
- Will look into the need for collecting soil and groundwater data under the buildings surrounding the gasoline impacted area by completing angle borings .

I told them I would contact the Cleanup Fund to check on the timing of a LOC for this site. Also, I will contact Kevin Graves and Ravi Arulanantham w/RWQCB to check if they would like to have input in regard to evaluation of risk assessment and setting cleanup goals.

Note: Discuss Case w/ J. Shin.

12/27/95 Discussed case w/ J. Shin. She concurred w/ plan of action. She suggested that Madhulla Logan review risk assessment and then schedule a meeting w/ the RP and Kevin Graves prior to approving the work plan.

*paper for John Sutton
1-800-501-1570*

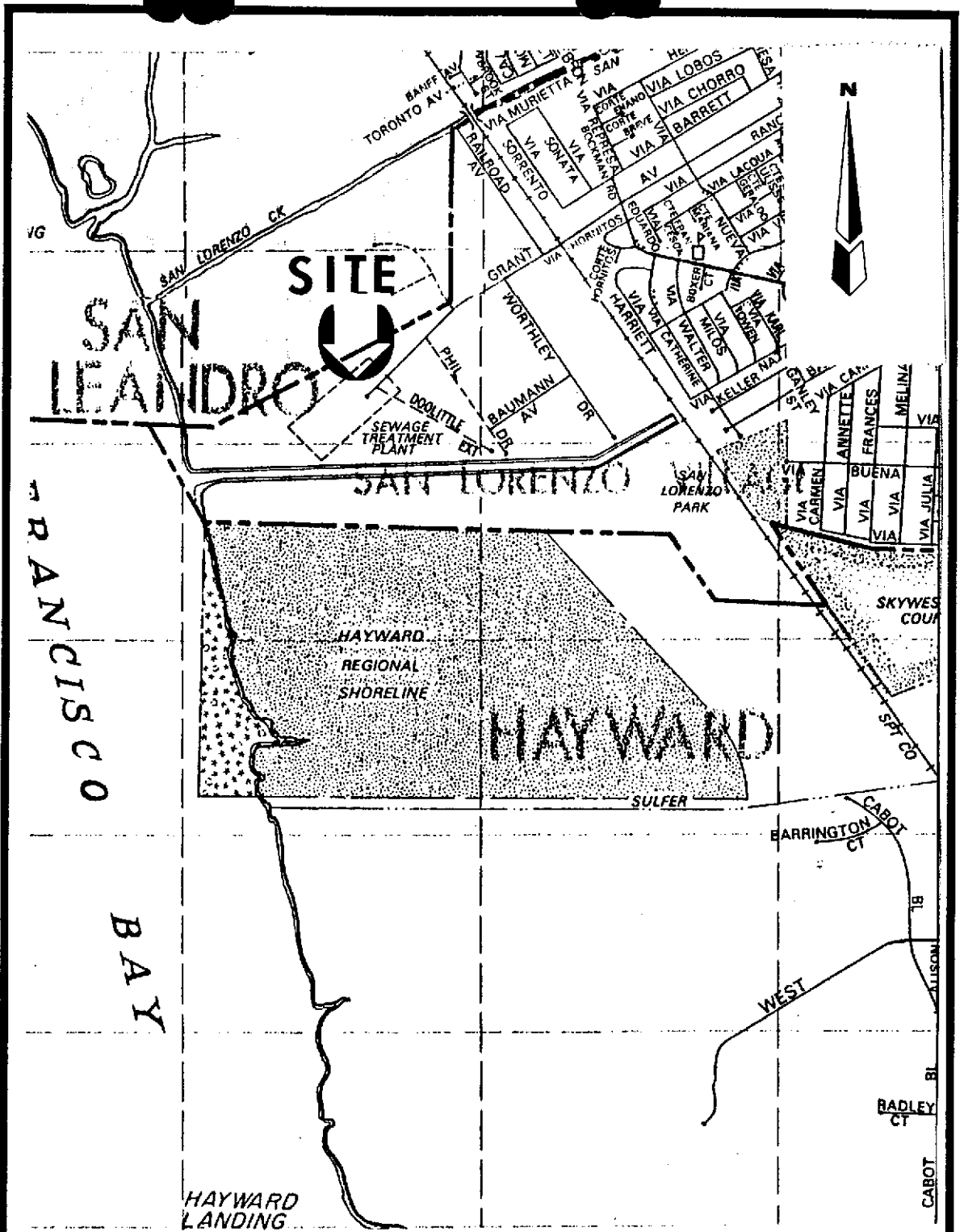

SOURCE: THOMAS BROS MAPS, ALAMEDA COUNTY, CALIFORNIA

Scale 1" = 1615 feet

THE SUTTON GROUP
 Engineering and Environmental Services
 51 Shuey Drive
 Moraga, California 94556-2620
 phone (510) 631-1688
 fax (510) 631-1371

**SITE LOCATION
 MAP**
 1,000 GALLON TANK REMOVAL
 CORRECTIVE ACTION PLAN
 ORO LOMA SANITARY DISTRICT
 SAN LORENZO, CALIFORNIA

PROJECT NO. 3022
 PHASE 6
FIGURE 1
 Revision-0, 10/25/95

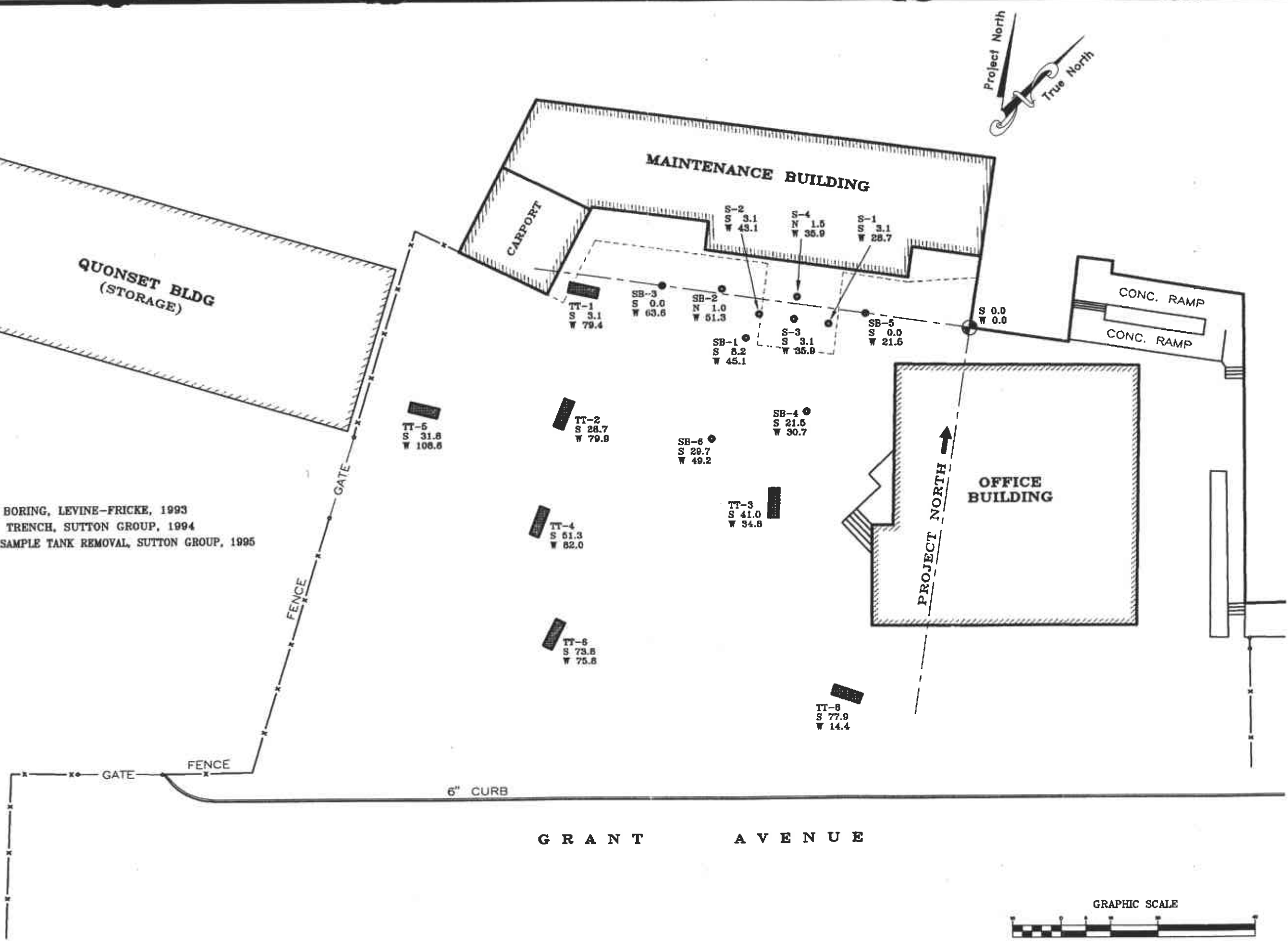
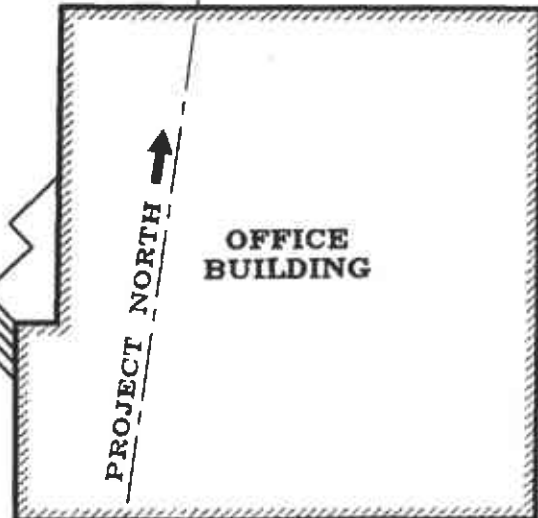
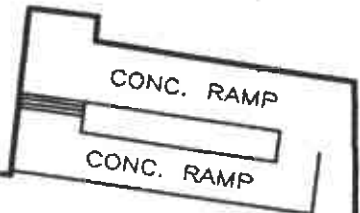
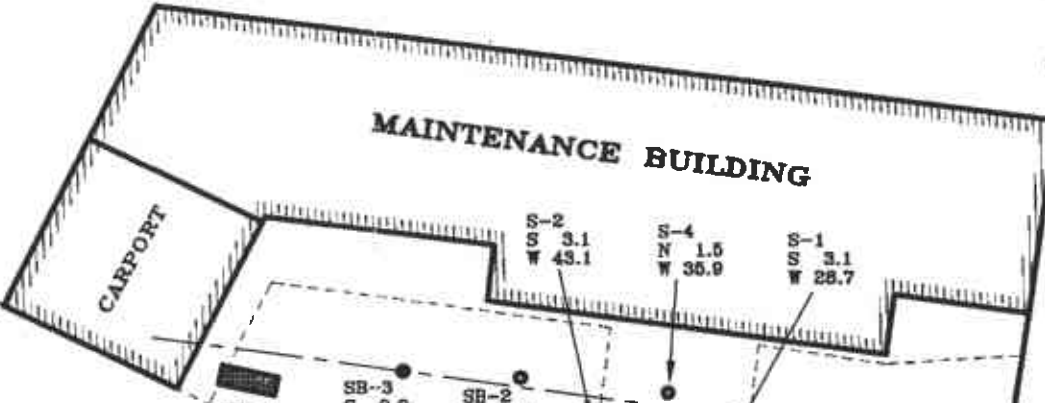
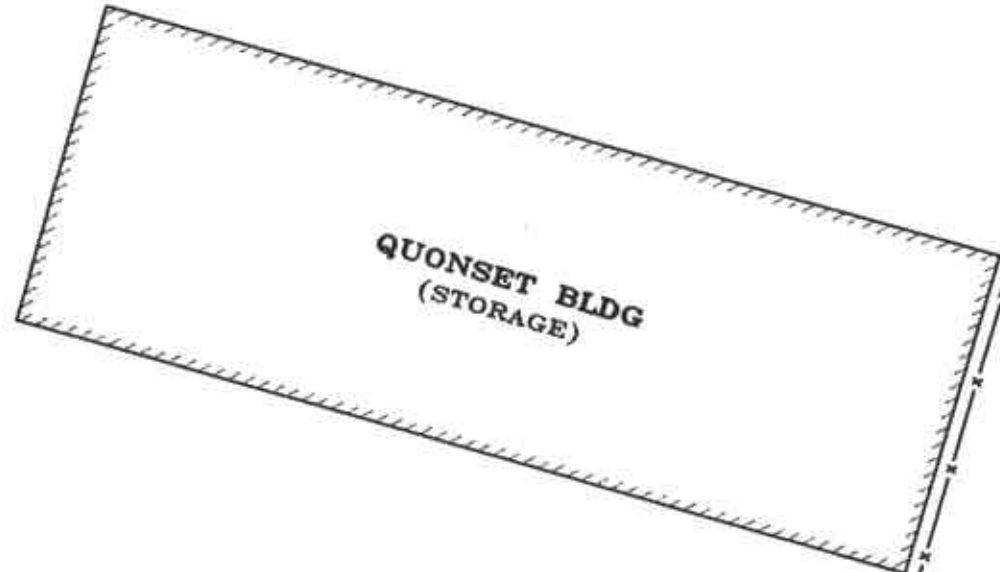

LEGEND

- SB SOIL BORING, LEVINE-FRICKE, 1993
- TT TEST TRENCH, SUTTON GROUP, 1994
- S SOIL SAMPLE TANK REMOVAL, SUTTON GROUP, 1995

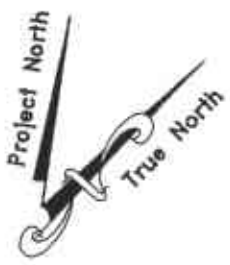

PROJECT NORTH ↑

GRANT AVENUE

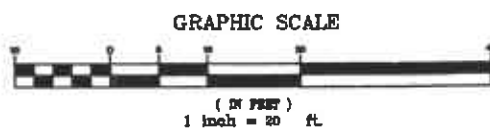

PROJECT NO. 3022
PHASE 6
FIGURE 2
Revision-2, 12/01/95

BORING AND TRENCH PLAN
1,000 GALLON TANK REMOVAL
CORRECTIVE ACTION PLAN
ORO LOMA SANITARY DISTRICT
SAN LORENZO, CALIFORNIA

THE SUTTON GROUP
Engineering and Environmental Services
51 Shuey Drive
Moraga, California 94556-2620
phone (510) 631-1888
fax (510) 631-1371

Depth (ft)	Graphic Symbol	USCS Symbol	Soil Description
0			ASPHALT , 2 to 2.5" thick
.2		GP/GM	FILL: Base Course (¾") Gravel, well graded, dry, brown (typ 1.0 ft thick) on 1.3 to 3 ft crushed quarry stone to 1½" max gravelly sand to sandy gravel with some clayey phases, brown, tan or blue. Total fill thickness is 2.5 to 7 ft. 0.5 to 1 ft bridging fill: broken concrete, construction debris in clay or sand matrix. Occasional odor of aged
2.5 to 7 ▽		CL/CH, CL, CH	CLAY very soft to soft, moderately high to high plasticity with peat zones clays, moist to very moist, black, gray or green, BAY MUD groundwater noted at 7 ft depth in trenches Dry Density 59 to 78 pcf Moisture contents 40 to 70% LL=39 to 48, PI = 15 to 23
21		CL, CH, SC	CLAYS and Clayey SANDS , stiff, shell cemented, moderately high to high plasticity, gray-green Dry Density 103 to 111 pcf Moisture contents 18 to 24% LL=53, PI = 31
25		CL	CLAY , silty, medium stiff to stiff, brown Dry Density 90 to 112 pcf Moisture contents 19 to 29% LL=40, PI=20 @ 32 to 45 feet: some fine sand zones
51.5			Maximum depth investigated

<p>THE SUTTON GROUP Engineering and Environmental Services 51 Shuey Drive Moraga, California 94556-2620 phone (510) 631-1688 fax (510) 631-1371</p>	<p>GENERALIZED SUBSURFACE PROFILE 1,000 GALLON TANK REMOVAL CORRECTIVE ACTION PLAN ORO LOMA SANITARY DISTRICT SAN LORENZO, CALIFORNIA</p>	<p>PROJECT NO. 3022 PHASE 6 FIGURE 3 Revision-2, 12/5/95</p>
---	--	---

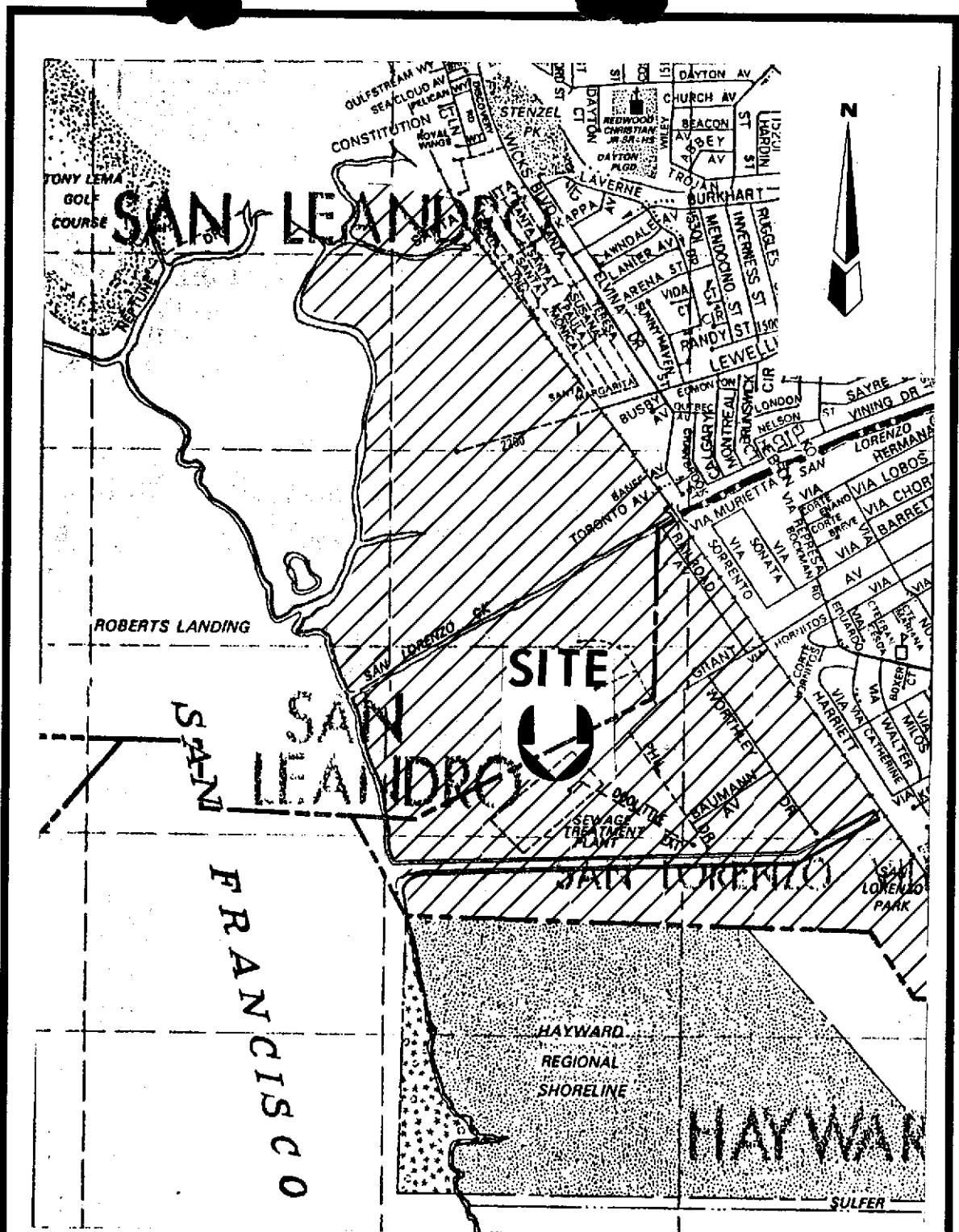

SOURCE: THOMAS BROS MAPS, ALAMEDA COUNTY, CALIFORNIA

Scale 1" = 1615 feet

THE SUTTON GROUP
 Engineering and Environmental Services
 51 Shuey Drive
 Moraga, California 94556-2620
 phone (510) 631-1688
 fax (510) 631-1371

RECLAIMED BAYLAND
 1,000 GALLON TANK REMOVAL
 CORRECTIVE ACTION PLAN
 ORO LOMA SANITARY DISTRICT
 SAN LORENZO, CALIFORNIA

PROJECT NO. 3022
 PHASE 6
FIGURE
 4
 Revision-0. 10/25/95

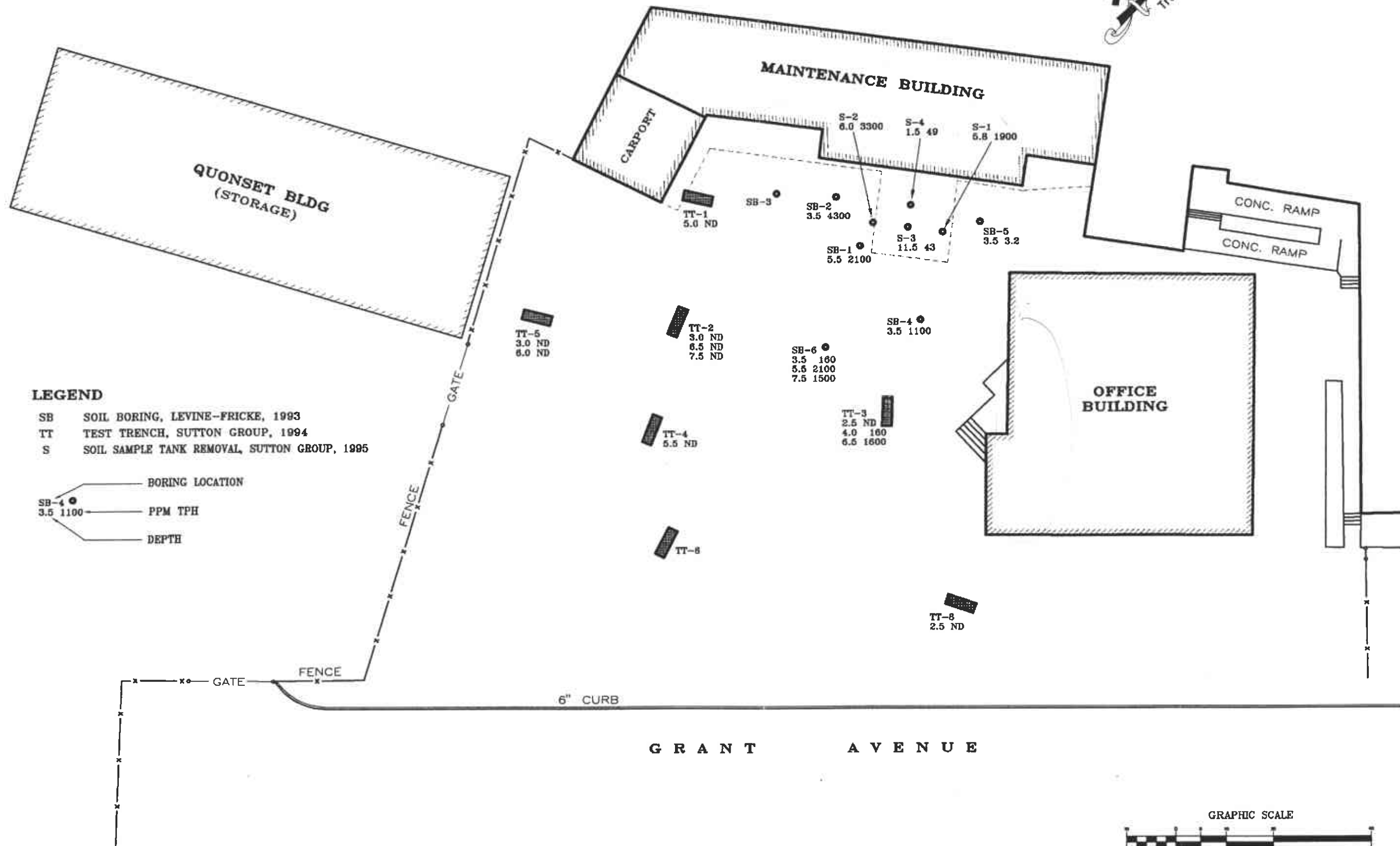

PROJECT NO. 3022
 PHASE 6
FIGURE 5
 Revision-2, 12/01/95

HORIZONTAL CONTAMINATION
 1,000 GALLON TANK REMOVAL
 CORRECTIVE ACTION PLAN
 ORO LOMA SANITARY DISTRICT
 SAN LORENZO, CALIFORNIA

THE SUTTON GROUP
 Engineering and Environmental Services
 51 Shuey Drive
 Moraga, California 94556-2620
 phone (510) 631-1688
 fax (510) 631-1371

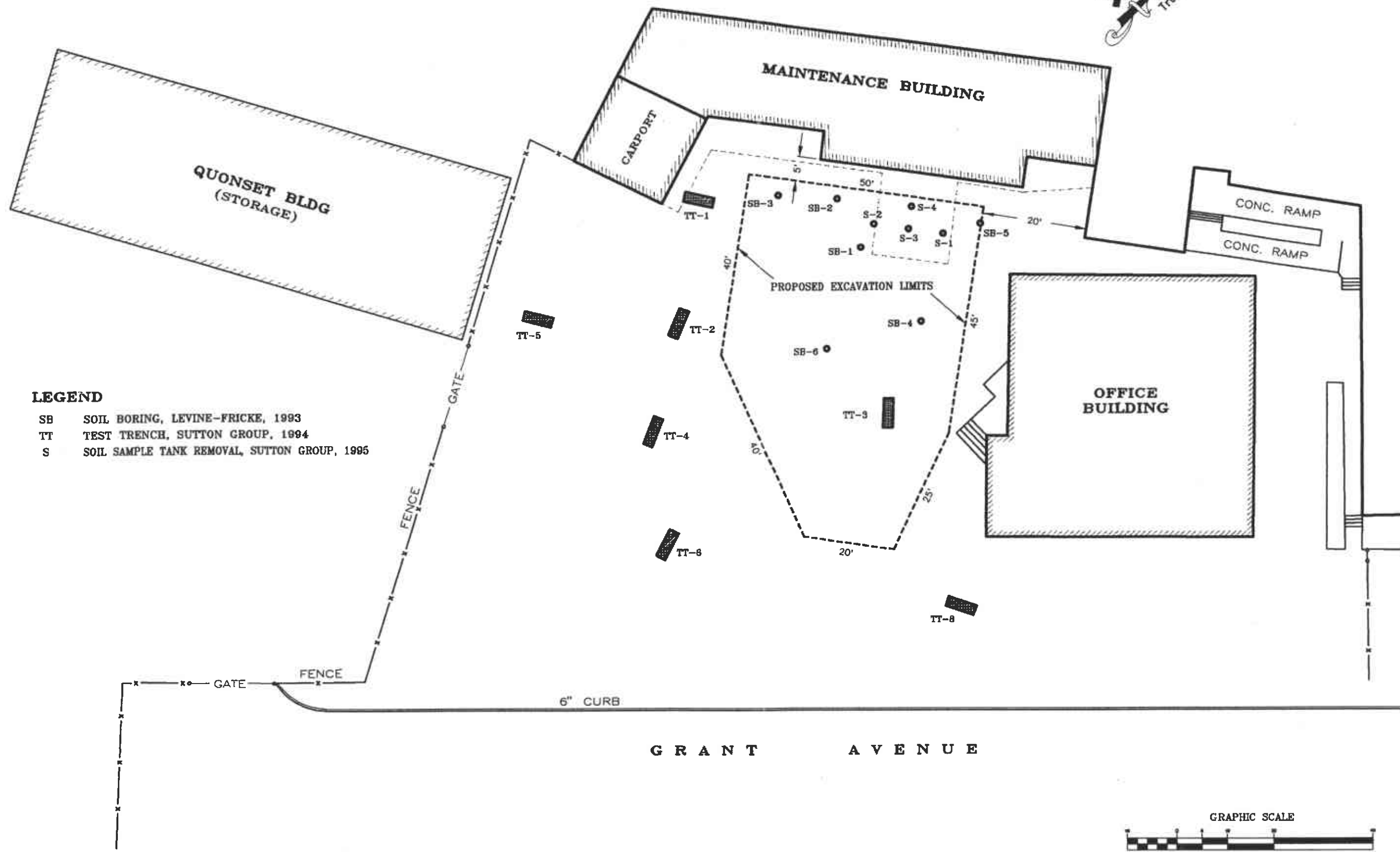

LEGEND

- SB SOIL BORING, LEVINE-FRICKE, 1993
- TT TEST TRENCH, SUTTON GROUP, 1994
- S SOIL SAMPLE TANK REMOVAL, SUTTON GROUP, 1995

PROJECT NO. 3022
 PHASE 6
FIGURE 6
 Revision-2, 12/01/95

PROPOSED EXCAVATION LIMITS
 1,000 GALLON TANK REMOVAL
 CORRECTIVE ACTION PLAN
 ORO LOMA SANITARY DISTRICT
 SAN LORENZO, CALIFORNIA

THE SUTTON GROUP
 Engineering and Environmental Services
 51 Shuey Drive
 Moraga, California 94556-2620
 phone (510) 631-1688
 fax (510) 631-1371

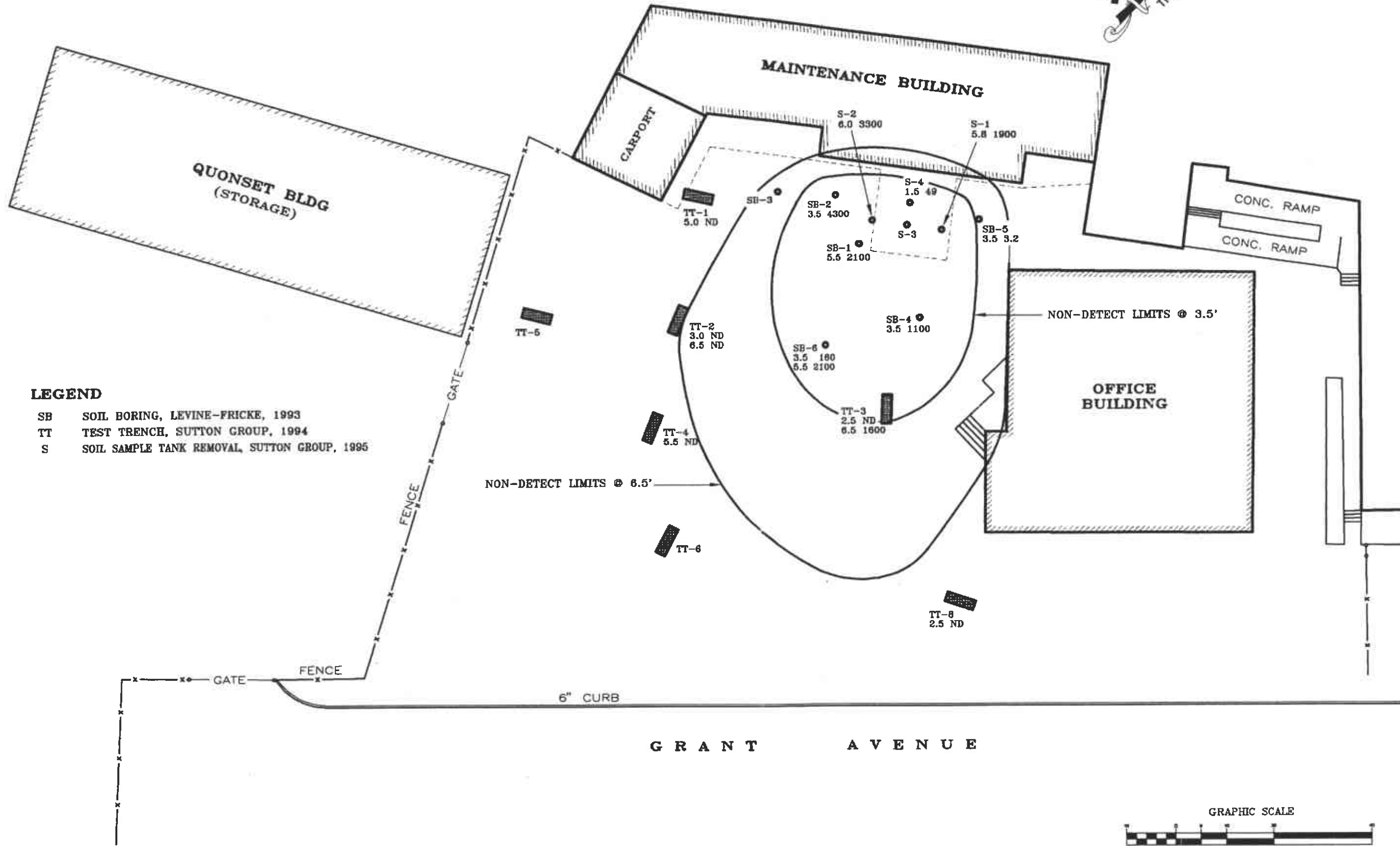

LEGEND

- SB SOIL BORING, LEVINE-FRICKE, 1993
- TT TEST TRENCH, SUTTON GROUP, 1994
- S SOIL SAMPLE TANK REMOVAL, SUTTON GROUP, 1995

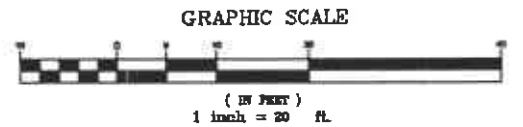

CONTAMINATION CONCENTRATION GRADIENT

PROJECT NO. 3022
PHASE 6
FIGURE 7

1,000 GALLON TANK REMOVAL
CORRECTIVE ACTION PLAN
ORO LOMA SANITARY DISTRICT
SAN LORENZO, CALIFORNIA

THE SUTTON GROUP
Engineering and Environmental Services

51 Shuey Drive
Morega, California 94556-2620
phone (510) 631-1688
fax (510) 631-1371

Revision -2, 12/01/95