

# P & D ENVIRONMENTAL

A Division of Paul H. King, Inc.  
4020 Panama Court  
Oakland, CA 94611  
(510) 658-6916

## FAX TRANSMITTAL COVER SHEET

Date: 10/12/99 Job #: \_\_\_\_\_

To: Scott Seery

Company: Alameda County

From: Paul H. King  
P&D ENVIRONMENTAL

Number of pages in this transmittal, including this cover sheet: \_\_\_\_\_

SUBJECT: XTRA OEL Castro Valley work Plan Update

MESSAGE: Scott, attached are the following for

0014.W6

Text 3pp

Figs 2pp

Please let me know if you need additional info.

- Paul

If transmittal is incomplete, please call (510) 658-6916.  
P&D Environmental fax number: (510) 658-9074.

DESTINATION FAX NUMBER: 337-9335

**P & D ENVIRONMENTAL**

A Division of Paul H. King, Inc.  
4020 Panama Court  
Oakland, CA 94611  
(510) 658-6916

October 11, 1999  
Letter 0014.L81

Mr. Tim Sharrock  
BSR Realty  
22320 Foothill Blvd. Suite 100  
Hayward, CA 94541

**SUBJECT: REQUEST FOR PROPERTY ACCESS**  
Garden Parks Apartments  
20928 Wilbeam Avenue  
3495 Castro Valley Boulevard Vicinity  
Castro Valley, CA

Dear Mr. Sharrock:

P&D Environmental, a division of Paul H. King, Inc. (P&D), requests permission for property access at 20928 Wilbeam Avenue in Castro Valley, California. Site access is requested for the collection of one groundwater grab sample from the back yard of one of the apartments at the subject facility. The groundwater grab sample is to be collected as part of a groundwater quality investigation for the vicinity of the subject site. This investigation has been requested by Mr. Scott Seery of the Alameda County Department of Environmental Health (510-567-6783). A Site Location Map is attached as Figure 1, and a Site Vicinity Map showing the proposed groundwater grab sample collection location (P22) is attached as Figure 2.

One borehole, designated as P22, will be hand augered at the location shown on Figure 2. A 3.5-inch diameter hand auger will be used to auger to a depth of approximately 6 feet below the ground surface. Based on previous subsurface investigations near the site, first encountered groundwater is anticipated at a depth of approximately 4 feet. Following collection of the groundwater grab sample, the borehole will be filled with neat cement and resurfaced with the existing type of cover material. Soil and water generated during hand augering will be removed from the site for storage at 3495 Castro Valley Boulevard pending characterization and appropriate disposal.

Should you have any questions, please do not hesitate to contact us at (510) 658-6916.

Sincerely,

P&D Environmental

  
Paul H. King  
Hydrogeologist

Attachments: Site Location Map - Figure 1  
Site Vicinity Map - Figure 2

cc: Mr. Scott Seery, Alameda County Department of Environmental Health  
Mr. Keith Simas, XTRA OIL Company

PHK  
0014.L81



4020 Panama Court  
Oakland, CA 94611  
Telephone (510) 658-6916

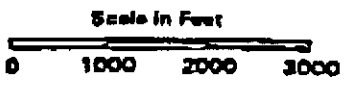
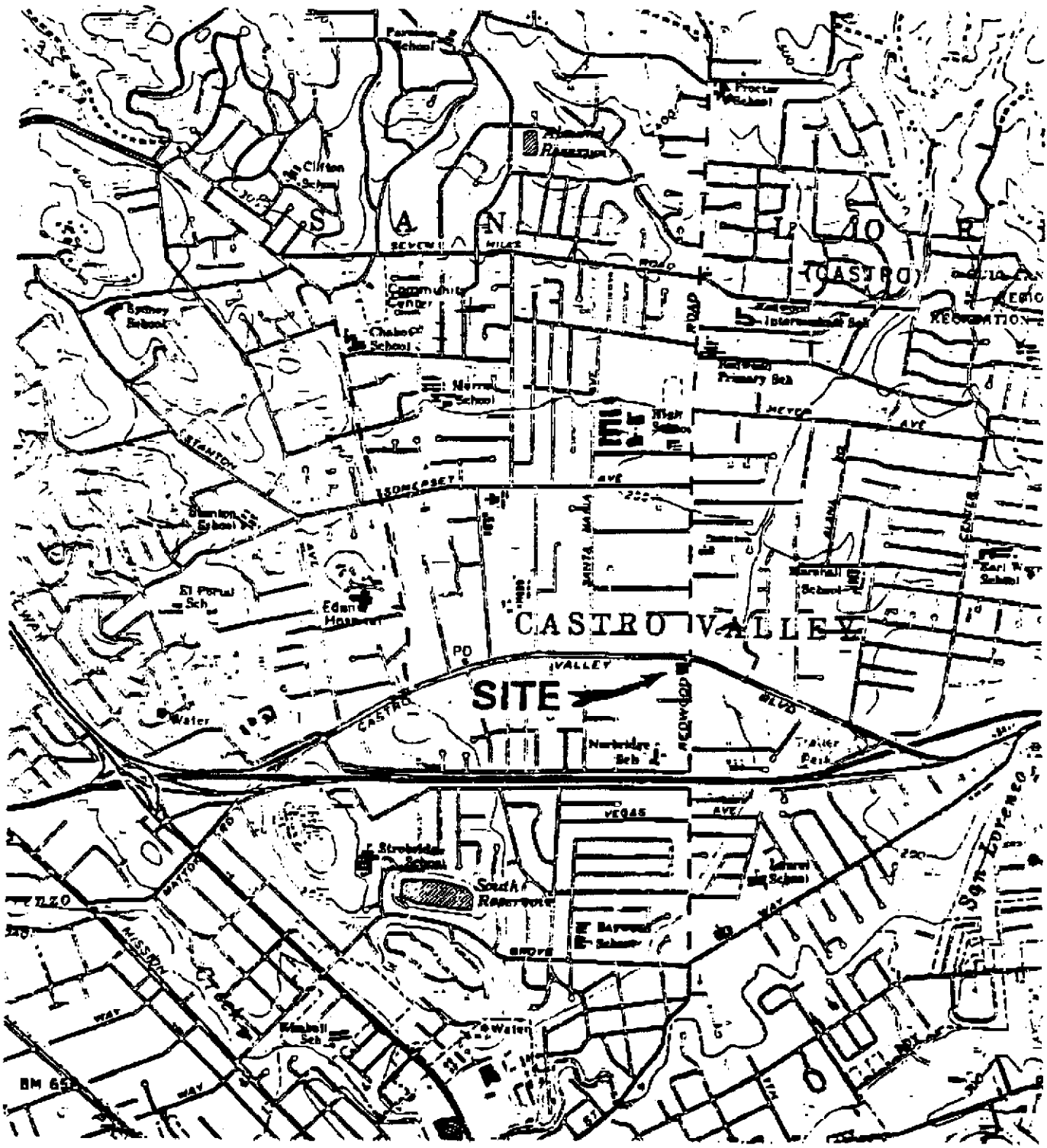

Base Map from:  
U.S. Geological Survey  
Hayward, Calif.  
7.5 Minute Quadrangle  
Photorevised 1980

Figure 1  
SITE LOCATION MAP  
XTRA OIL Company  
3195 Castro Valley Blvd.  
Alameda, California

P & D Environmental  
4020 Panama Court  
Oakland, CA 94611  
Telephone (510) 658-6916

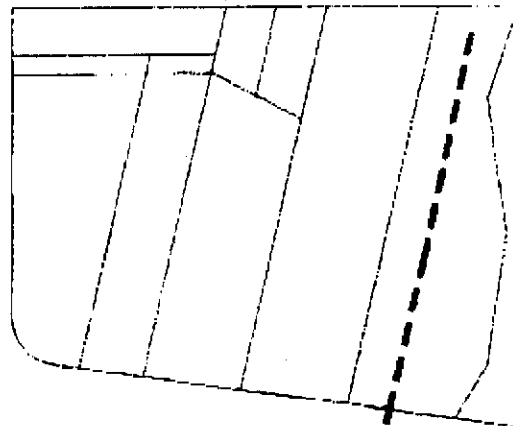
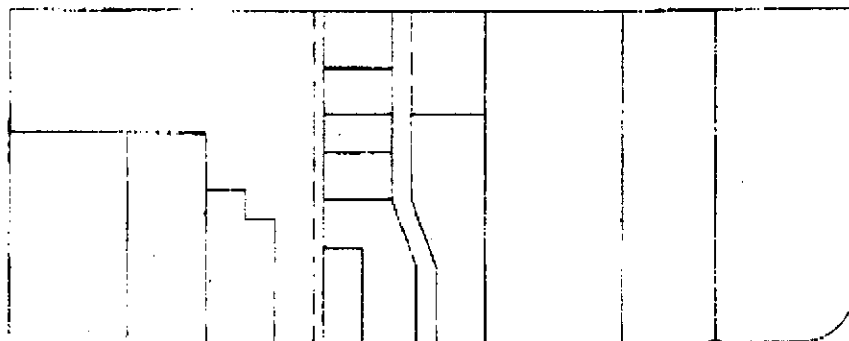

CASTRO VALLEY BOULEVARD

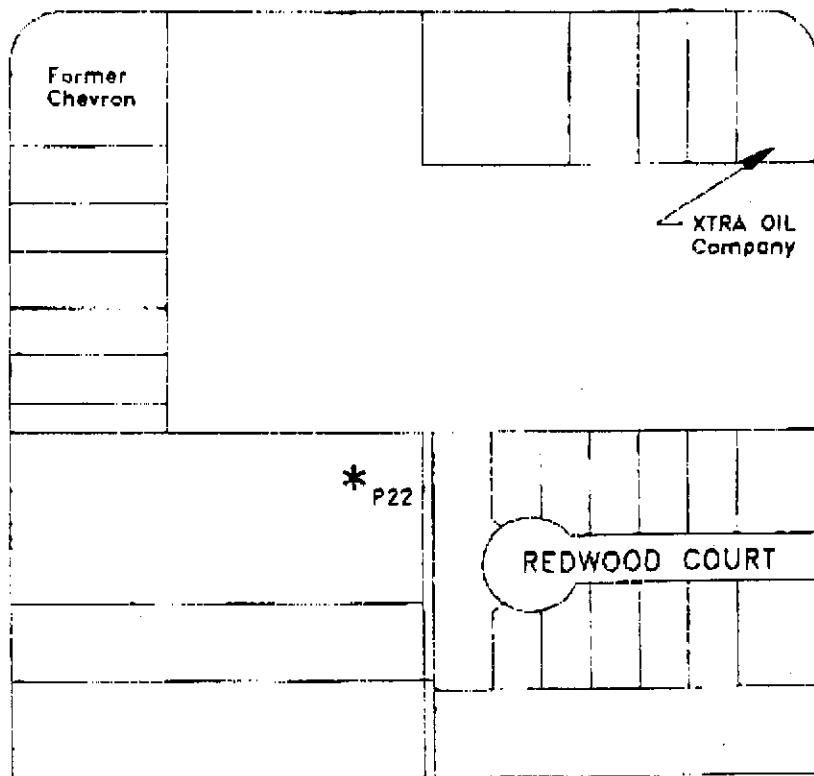

REDWOOD ROAD

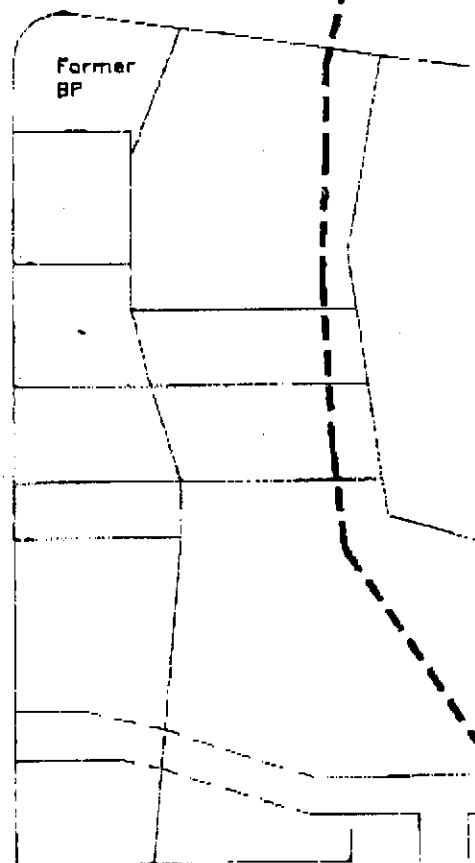

Legend

\* Proposed Groundwater Grab Sample Collection Location

◆ Proposed Observation Well Location

--- Approximate Creek Location

Base Map From:  
Castro Valley Sanitation District  
Undated  
(8/1083)

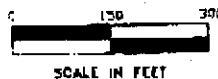

Figure 2  
SITE VICINITY MAP  
XTRA OIL Company  
3495 Castro Valley Blvd.  
Castro Valley, California

October 8, 1999  
Work Plan 0014.W6

2

#### Regulatory Agency Coordination and Site Access Permission

Following approval of this work plan, and receipt of written permission for access to the subject property, a permit application will be submitted to the Alameda County Public Works Agency office for the hand augering of the boreholes.

After the permit has been approved, Underground Service Alert will be notified for underground utility location. Prior to the beginning of field work, a health and safety plan will be prepared.

#### Hand Augering of Two Boreholes and Groundwater Grab Sample Collection

Two boreholes, designated as P27 and P28, will be hand augered at the locations shown on Figure 2.

A 3.5-inch diameter hand auger will be used to auger to a depth of approximately 8 to 12 feet below the ground surface. Based on previous subsurface investigations near the site, first encountered groundwater is anticipated at a depth of approximately 6 to 10 feet. The total anticipated depth of exploration is approximately 12 feet. The hand augers will be washed with an Alconox solution followed by a clean water rinse prior to use in each borehole. The soil from the borehole samples will be logged in the field in accordance with standard geologic field techniques and the Unified Soil Classification System and with a photoionization detector.

Groundwater grab samples will be collected from each borehole with a Teflon bailer. The Teflon bailer will be washed with an Alconox solution followed by a clean water rinse prior to use in each borehole. The samples will be transferred from the bailer to 40-milliliter glass Volatile Organic Analysis (VOA) vials and 1-liter amber glass bottles and sealed with Teflon-lined screw caps. The VOA vials will be overturned and tapped to assure that no air bubbles are present. The sample bottles will then be labeled and placed into a cooler with ice pending delivery to a State-certified hazardous waste testing laboratory. Chain of custody procedures will be observed for all sample handling.

The boreholes will be filled with neat cement and resurfaced with asphalt. Soil and water generated during hand augering will be removed from the site for storage at 3495 Castro Valley Boulevard pending characterization and appropriate disposal.

#### Groundwater Sample Analysis

The groundwater samples from the boreholes will be analyzed at McCampbell Analytical Inc. of Pacheco, California for TPH-D using EPA Method 3550 in conjunction with Modified EPA 8015, TPH-G using EPA Method 5030 in conjunction with Modified EPA Method 8015, MTBE, and for BTEX using EPA Method 8020 on a normal turn around basis. McCampbell Analytical, Inc. is a State-accredited laboratory.

#### Report Preparation

Upon receipt of the laboratory analytical results, a report will be prepared. The report will contain documentation of field activities associated with the collection of the groundwater grab samples; copies of the laboratory analytical reports and chain of custody documentation; a tabulated summary of the laboratory analytical results; a discussion of the local geology and hydrogeology; a discussion of the results and recommendations based upon the laboratory analytical results; and the signature and stamp of an appropriately registered professional.