

RECEIVED

2:06 pm, Mar 19, 2008

Alameda County
Environmental Health

2307 Pacific Ave., Alameda, CA 94501
Phone: 510-865-9503
Fax: 510-865-1889
E-mail: xtraoil@prodigy.net

.....

Xtra Oil Company

February 5, 2008

Mr. Steven Plunkett
Alameda County Environmental Health Department
1131 Harbor Bay Parkway, Suite 250
Alameda, CA 94502

**SUBJECT: QUARTERLY GROUNDWATER MONITORING AND SAMPLING REPORT
(DECEMBER 2007 THROUGH FEBRUARY 2008) CERTIFICATION**
County Case # RO 285
Xtra Oil Company
3495 Castro Valley Blvd.
Castro Valley, CA

Dear Mr. Plunkett:

P&D Environmental, Inc. has prepared the following document:

- Quarterly Groundwater Monitoring and Sampling Report (December 2007 Through February 2008) dated February 5, 2008 (document 0014.R69).

I declare under penalty of perjury that the contents and conclusions in the document are true and correct to the best of my knowledge.

Should you have any questions, please do not hesitate to contact me at (510) 865-9506.

Sincerely,

Xtra Oil Company

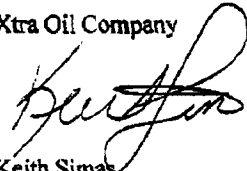

Keith Simas

0014.L149

P&D ENVIRONMENTAL, INC.

55 Santa Clara Ave, Suite 240
Oakland, CA 94610
(510) 658-6916

February 5, 2008
Report 0014.R69

Mr. Ted Simas
Mr. Keith Simas
Xtra Oil Company
2307 Pacific Ave.
Alameda, CA 94501

**SUBJECT: QUARTERLY GROUNDWATER MONITORING AND SAMPLING REPORT
(DECEMBER 2007 THROUGH FEBRUARY 2008)**
County Case # RO 285
Xtra Oil Company
3495 Castro Valley Blvd.
Castro Valley, California

Gentlemen:

P&D Environmental, Inc. (P&D) is pleased to present this report documenting the results of the most recent quarterly monitoring and sampling of both the on- and off-site wells for the subject property. This work was performed in accordance with P&D's proposal 020599.P1 dated February 5, 1999. Offsite observation wells OW1 and OW2 and onsite wells MW1, MW3, MW4, and EW1 were monitored and wells MW1, MW3, EW1, OW1, and OW2 were sampled on January 17, 2008. The reporting period is for December 2007 through February 2008. A Site Location Map (Figure 1), a Site Plan showing onsite well locations (Figure 2), and a Site Vicinity Map showing offsite observation well locations (Figure 3) are attached with this report. Figure 3 has been updated to show the correct location of OW2. Norbridge School shown on Figure 1 to the south of the subject site has been demolished and been replaced with the Castro Valley BART station and associated parking lot.

BACKGROUND

The site is currently used as a gasoline station. Four 12,000 gallon underground fuel storage tanks are present at the site. Three of the tanks contain gasoline and the fourth tank contains diesel fuel. A 550 gallon waste oil tank was removed from the site in November 1988. The fuel tanks were replaced during August 1992.

Three monitoring wells, designated MW1, MW2 and MW3, were installed at the site on February 14 and 15, 1990 by Western Geo-Engineers. The subsurface materials encountered in the boreholes consisted primarily of silt and clay. The locations of the monitoring wells are shown on Figure 2. Soil samples collected during drilling of the boreholes for the monitoring wells revealed the presence of total petroleum hydrocarbons as gasoline (TPH-G) and total petroleum hydrocarbons as diesel (TPH-D).

TPH-G was encountered in borehole MW1 at depths of 5 and 10 feet below grade at concentrations of 40 and 1,400 mg/kg, respectively; in borehole MW2 at depths of 10 and 15 feet below grade at concentrations of 230 and 95 mg/kg, respectively; and in borehole MW3 at depths of 5, 10, and 15 feet at concentrations of 140, 250 and 25 mg/kg, respectively. In addition, 120 mg/kg TPH-D was detected in borehole MW3 at a depth of 5 feet. Soil samples collected at a depth of 20 feet in borehole MW1 and at a depth of 18 feet in boreholes in MW2 and MW3 did not show any detectable concentration of TPH-G or TPH-D. Groundwater was encountered in the boreholes at depths of approximately 15 to 16 feet below grade.

On February 15, 1990 Western Geo-Engineers drilled three exploratory boreholes at the site designated as SB1, SB2 and SB3. The subsurface materials encountered in the boreholes consisted primarily of silt and clay. The approximate locations of the boreholes are shown on Figure 2. It is P&D's understanding that soil samples were collected from the exploratory boreholes at depths of 10 and 12 feet and evaluated in the field using a photoionization detector. In borehole SB1, TPH-G was detected at the depths of 10 and 12 feet at concentrations of 1,700 and 450 mg/kg, respectively. In boreholes SB2 and SB3, TPH-G was detected at the depths of 10 and 12 feet in both boreholes at concentrations of 800 mg/kg and greater than 2,000 mg/kg, respectively. A groundwater monitoring and sampling program was initiated at the site on February 20, 1990.

It is P&D's understanding that during fuel tank replacement activities in August, 1992 soil surrounding the tank pit was removed and disposed of offsite. An extraction well, designated as EW1, was designed and constructed in one corner of the new tank pit by K&B Environmental at the time of installation of the new tanks. The location of EW1 is shown on Figure 2.

On February 7, 1996 well MW2 was destroyed associated with the widening of Redwood Road. The destruction was overseen by ACC Environmental Consultants of Oakland, California.

On August 15, 1997 P&D personnel oversaw the installation of one groundwater monitoring well, designated as MW4, at the subject site. The location of the monitoring well is shown on the attached Site Plan, Figure 2. This work was performed in accordance with P&D's work plan 0014.W4 dated June 27, 1997. The work plan was approved by the Alameda County Department of Environmental Health (ACDEH) in a telephone conversation with Mr. Scott Seery on August 14, 1997. During the conversation, Mr. Seery indicated that he would record his approval of the work plan in the county file for the site. In accordance with an October 25, 2002 letter from Mr. Seery, groundwater samples are to be analyzed for fuel oxygenates methyl tertiary-butyl ether (MTBE), tertiary amyl methyl ether (TAME), ethyl tertiary-butyl ether (ETBE), diisopropyl ether (DIPE), and tertiary-butyl alcohol (TBA), and lead scavengers ethylene dibromide (EDB), 1,2-dichloroethane (1,2-DCA) using EPA Method 8260; and data for observation wells OW1 and OW2, located in Redwood Road, are to be incorporated into monitoring and sampling reports for the subject site. Documentation of the well installation is provided in P&D's Monitoring Well Installation Report dated September 30, 1997 (document 0014.R25).

On May 31, 2005, P&D submitted an Interim Source Area Remediation Plan (ISARP) to ACDEH proposing free product removal at the site (document 0014.W9). P&D proposed using existing extraction well EW1 in the existing UST pit to dewater the existing pit and the previous UST pit. Monitoring of existing wells MW1, MW3, and MW4 to evaluate the effectiveness of water table drawdown at the site for plume control and associated free product recovery was also proposed.

February 5, 2008
Report 0014.R69

In January 2007, P&D installed a groundwater extraction system consisting of a pump in well EW1, associated piping for discharge of water from the well, and a carbon filtration system. System operation began in February 2007. Documentation of the system installation and operation is provided in P&D's Interim Source Area Remediation Plan Progress Evaluation Report dated October 25, 2007 (document 0014.R67).

In response to a February 6, 2007 letter request from the ACDEH, P&D submitted a Groundwater Monitoring Well Installation Work Plan (MW5 Through MW13) dated March 5, 2007 (document 0014.W10) to the ACDEH proposing the installation of nine offsite groundwater monitoring wells in the vicinity of the subject site designated as MW5 through MW13. The ACDEH conditionally approved the work plan in an April 4, 2007 letter. P&D subsequently submitted a Groundwater Monitoring Well Installation Work Plan Amendment (MW5 Through MW12) dated May 3, 2007 (document 0014.W10A) to the ACDEH proposing the installation of eight offsite groundwater monitoring wells in the vicinity of the subject site designated as MW5 through MW12. Documentation of the implementation of the work plan and work plan amendment is provided in P&D's Groundwater Monitoring Well Installation Report (MW5 Through MW12) dated January 30, 2008 (document 0014.R68).

FIELD ACTIVITIES

Offsite observation wells OW1 and OW2 and onsite wells MW1, MW3, MW4, and EW1 were monitored, and wells MW1, MW3, EW1, OW1, and OW2 were sampled on January 17, 2008. The monitoring and sampling was performed in conjunction with monitoring and sampling by SOMA Environmental Engineering, Inc. of Pleasanton, California at the Former BP site at 3519 Castro Valley Boulevard. Historic monitoring and sampling data for that site are attached with this report as Appendix A.

The wells at the subject site were monitored for depth to water and the presence of free product or sheen. In well MW4 the depth to water and depth to free product was measured to the nearest 1/32-inch with a steel tape and water-finding and product-finding paste. The passive hydrocarbon collection device in well MW4 was removed by P&D personnel and placed in storage near MW1 during pressure transducer installation in well MW4 on November 2, 2006. In wells OW1, OW2, MW1, MW3, and EW1, the depth to water was measured to the nearest 0.01 foot using an electric water level indicator. The presence of free product and sheen was also evaluated using a transparent bailer in wells MW1, MW3, and EW1. Approximately 0.17 feet of free product was measured in well MW4. Although the measured depth to water in offsite well OW1 was recorded as 4.00 feet, the cap was observed to not be securely attached to the top of the PVC well casing, and water was observed to fill the well box to a height equivalent to the top of the PVC well casing. For this reason it appears that water from the well box entered the PVC casing and the depth to water level measurement is suspect. No water level measurement was recorded for offsite well OW2, even though a small amount of water sample was collected for sample analysis.

No sample was collected from MW4 due to the presence of free product in the well.

Prior to well sampling, onsite wells MW1, MW3, and EW1 were purged of a minimum of three casing volumes of water or until the wells had been purged dry. Petroleum hydrocarbon odors were detected from the purge water from all three of the onsite sampled wells, and petroleum hydrocarbon

sheen was detected on the purge water from well MW1. Petroleum hydrocarbon odors were also detected on the samples collected from offsite observation wells OW1 and OW2, and petroleum hydrocarbon sheen was observed on the sample collected from offsite well OW1. Wells OW1 and OW2 were not purged prior to sample collection because of the limited volume available in each well.

During purging operations, the field parameters of electrical conductivity, temperature, and pH were monitored. Once the field parameters were observed to stabilize, a minimum of three casing volumes had been purged, or the wells had purged dry and partially recovered, water samples were collected using a clean Teflon bailer. Records of the field parameters measured during well purging are included with this report.

The water samples were transferred to 40-milliliter glass VOA vials and 1-liter amber glass bottles that were sealed with Teflon-lined screw caps. The VOA vials were overturned and tapped to ensure that no air bubbles were present.

The VOA vials and bottles were then transferred to a cooler with ice, until they were transported to McCampbell Analytical, Inc. in Pittsburg, California. McCampbell Analytical, Inc. is a State-certified hazardous waste testing laboratory. Chain of custody documentation accompanied the samples to the laboratory.

HYDROGEOLOGY

Water levels were measured in all of the wells once during the reporting period.

On January 17, 2008, the measured depth to water in wells MW1, MW3, MW4, and EW1 was 8.01, 8.90, 7.50, and 11.41 feet, respectively. A separate phase hydrocarbon layer measuring approximately 0.17 feet in thickness was measured in well MW4. Using a specific gravity of 0.75, the corrected depth to water in well MW4 is 7.37 feet. The measured depth to water in well OW1 was 4.00 feet, and was measured shortly after a precipitation event. However, the cap was observed to not be securely attached to the top of the PVC well casing, and water was observed to fill the well box to a height equivalent to the top of the PVC well casing. For this reason it appears that water from the well box entered the PVC casing and the depth to water level measurement is suspect. No water level measurement was recorded for offsite well OW2, even though a small amount of water sample was collected for sample analysis. Since the previous monitoring on October 16, 2007, the groundwater elevations have increased in wells MW1, MW3, MW4, and EW1 by 0.64, 0.53, 0.94 (the reported change in water level has been corrected for free product presence), and 0.54 feet, respectively. The measured depth to water in the wells and the separate phase layer thickness measured in well MW4 are summarized in Table 1.

Based on the measured depth to groundwater in the groundwater monitoring wells, the apparent groundwater flow direction at the site on January 17, 2008 was calculated to be to the south-southwest with a gradient of 0.022. During the previous quarterly monitoring and sampling event on October 16, 2007, the groundwater flow direction was calculated to be to the south-southwest with a gradient of 0.015. The groundwater flow direction at the site on January 18, 2008 is shown on Figure 2. The groundwater flow direction and gradient are consistent with the flow direction and gradient observed at the site during the previous monitoring and sampling event on October 16,

2007. The flow direction and gradient are different from other historic values, and are attributed to be the result of groundwater pumping at well EW1 in the former UST pit which began in February 2007.

LABORATORY RESULTS

All of the groundwater samples collected on January 17, 2008 were analyzed for TPH Multirange (TPH-G, TPH-D, and TPH-MO) using EPA Methods 5030B and 3510C in conjunction with Modified EPA Method 8015C; and for benzene, toluene, ethylbenzene, and total xylenes (BTEX), fuel oxygenates MTBE, TAME, ETBE, TAME, and TBA, and for lead scavengers EDB and 1,2-DCA/EDC using EPA Method 5030B in conjunction with EPA Method 8260B.

The laboratory analytical results for the samples from onsite wells MW1, MW3, and EW1 show that TPH-D was detected at concentrations of 3.8, 9.9, and 13 mg/L, respectively; TPH-G was detected at concentrations of 22, 110, and 24 mg/L, respectively; benzene was detected at concentrations of 0.31, 34, and 4.6 mg/L, respectively; and MTBE was detected at concentrations of 0.074, 9.3, and 16 mg/L, respectively.

In offsite wells OW1 and OW2, TPH-D was detected at concentrations of 29, and 0.33 mg/L, respectively; TPH-G was detected at concentrations of 6.9 and 0.14 mg/L, respectively; benzene was detected at a concentration of 0.48 mg/L in OW1 and was not detected in OW2; and MTBE was not detected in OW1 and was detected in OW2 at a concentration of 0.0022 mg/L.

No other fuel oxygenates or lead scavengers were detected in any of the wells except for TBA in wells MW3, EW1, OW1, and OW2 at concentrations of 8.0, 19, 0.097 and 0.011 mg/L, respectively.

Review of the laboratory analytical reports shows that the TPH-D results for all of the samples are described as consisting of both diesel- and gasoline-range compounds. In addition, the laboratory identified sheen on the samples collected from wells MW3 and OW1.

Since the previous sampling on October 16, 2007, all analyte concentrations have increased in well EW1, decreased or remained unchanged in MW1 except for TPH-D and ethylbenzene which increased, and have either increased, decreased, or remained unchanged in well MW3. The laboratory analytical results for the groundwater samples are summarized in Table 2. Copies of the laboratory analytical reports and chain of custody documentation are included with this report.

DISCUSSION AND RECOMMENDATIONS

Offsite observation wells OW1 and OW2 and onsite wells MW1, MW3, MW4, and EW1 were monitored, and wells MW1, MW3, EW1, OW1, and OW2 were sampled on January 17, 2008. Separate phase hydrocarbons were detected in well MW4 at a thickness of 0.17 feet. The passive hydrocarbon collection device in well MW4 was removed on November 2, 2006, by P&D personnel during pressure transducer installation associated with preparation for dewatering the former UST pit. Dewatering of the former UST pit began February 2007 in UST pit extraction well EW1. The decrease in water level in EW1 is associated with the dewatering of the UST pit.

Similarly, the change in groundwater flow direction from a historic southeasterly flow direction to a southwesterly flow direction with a higher gradient is attributed to the UST pit dewatering.

The laboratory analytical results for the groundwater samples from onsite wells MW1, MW3, and EW1 showed TPH-D concentrations ranging from 3.8 to 13 mg/L, TPH-G concentrations ranging from 22 to 110 mg/L, and benzene concentrations ranging from 0.31 to 34 mg/L. Review of the results for the fuel oxygenate and lead scavenger analysis shows that MTBE was detected in onsite wells MW1, MW3, and EW1, at concentrations of 0.074, 9.3, and 16 mg/L, respectively, and TBA was detected in wells MW3 and EW1 at a concentrations of 8 and 19 mg/L, respectively. No other fuel oxygenates or lead scavengers were detected in any of the wells. The UST pit dewatering pump is located in well EW1, and the increase in petroleum hydrocarbon concentrations in well EW1 when compared to water quality data prior to 2007 is attributed to groundwater with elevated concentrations of petroleum hydrocarbons moving into the UST pit as a result of the UST pit dewatering. Wellhead survey data from August 20, 2007 for the onsite and offsite wells discussed in this report that was obtained during the surveying of offsite groundwater monitoring wells MW5 through MW12 is not incorporated in this report pending resolution of discrepancies with historic wellhead survey data.

The measured depth to water in well OW1 was 4.00 feet, and was measured shortly after a precipitation event. Review of Table 1 shows that historically groundwater is encountered very infrequently in this well. In addition, the cap was observed to not be securely attached to the top of the PVC well casing, and water was observed to fill the well box to a height equivalent to the top of the PVC well casing. For these reasons it appears that water from the well box entered the PVC casing and the depth to water level measurement and water quality results are suspect. Review of historic and current water quality results for wells OW1 and OW2 show that petroleum hydrocarbons are present in the sanitary sewer trench at well OW1, and that comparatively low concentrations of petroleum hydrocarbons are present in the sanitary sewer trench at well OW2.

Based on the laboratory analytical results of the water samples collected from the monitoring wells, P&D recommends that groundwater monitoring and sampling be continued. In addition, P&D recommends that future monitoring and sampling efforts continue to be coordinated with the Former BP site at 3519 Castro Valley Boulevard, and that the next quarterly well sampling event include offsite groundwater monitoring wells MW5 through MW12. A copy of the historic water level and water quality data and a site map showing the well locations for 3519 Castro Valley Boulevard are attached with this report as Appendix A.

DISTRIBUTION

A copy of this report will be uploaded to the ACDEH website, in accordance with ACDEH requirements. In addition, a copy of this report will be uploaded to the GeoTracker database.

LIMITATIONS

This report was prepared solely for the use of Xtra Oil Company. The content and conclusions provided by P&D in this assessment are based on information collected during our investigation, which may include, but not be limited to, visual site inspections; interviews with the site owner, regulatory agencies and other pertinent individuals; review of available public documents;

subsurface exploration and our professional judgment based on said information at the time of preparation of this document. Any subsurface sample results and observations presented herein are considered to be representative of the area of investigation; however, geological conditions may vary between borings and may not necessarily apply to the general site as a whole. If future subsurface or other conditions are revealed which vary from these findings, the newly revealed conditions must be evaluated and may invalidate the findings of this report.

This report is issued with the understanding that it is the responsibility of the owner, or his representative, to ensure that the information contained herein is brought to the attention of the appropriate regulatory agencies, where required by law. Additionally, it is the sole responsibility of the owner to properly dispose of any hazardous materials or hazardous wastes left onsite, in accordance with existing laws and regulations.

This report has been prepared in accordance with generally accepted practices using standards of care and diligence normally practiced by recognized consulting firms performing services of a similar nature. P&D is not responsible for the accuracy or completeness of information provided by other individuals or entities which is used in this report. This report presents our professional judgment based upon data and findings identified in this report and interpretation of such data based upon our experience and background, and no warranty, either express or implied, is made. The conclusions presented are based upon the current regulatory climate and may require revision if future regulatory changes occur.

Should you have any questions, please do not hesitate to contact us at (510) 658-6916.

Sincerely,

P&D Environmental, Inc.

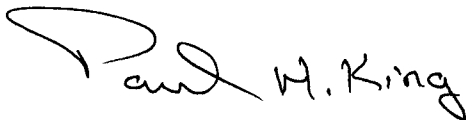

Paul H. King
Professional Geologist #5901
Expires: 12/31/09

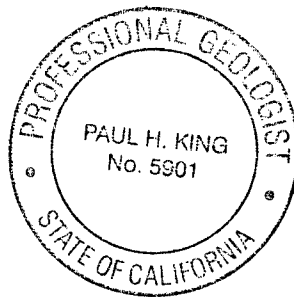

Attachments: Tables 1 & 2
Site Location Map (Figure 1)
Site Plan (Figure 2)
Site Vicinity Map (Figure 3)
Well Monitoring and Purge Data Sheets
Laboratory Analytical Reports and Chain of Custody Documentation
Appendix A - Historic Water Level and Water Quality Data
For 3519 Castro Valley Boulevard

PHK/ sjc
0014.R69

TABLES

TABLE 1
WELL MONITORING DATA

Well No.	Date Monitored	Top of Casing Elev. (ft.)	Depth to Water (ft.)	Water Table Elev. (ft.)
MW1	01/17/08	177.37*	8.01	169.36
	10/16/07		8.65	168.72
	07/25/07		8.49	168.88
	04/17/07		8.30	169.07
	01/18/07		7.85	169.52
	11/14/06		7.38	169.99
	06/29/06		7.80	169.57
	02/03/06		6.65	170.72
	11/18/05		8.17	169.20
	07/28/05		7.98	169.39
	04/13/05		6.90	170.47
	01/31/05		7.20	170.17
	10/15/04		8.52	168.85
	07/13/04		8.33	169.04
	04/06/04		7.93	169.44
	12/18/03		7.65	169.72
	09/18/03		8.15	169.22
	06/19/03		8.13	169.24
	03/18/03		7.77	169.60
	12/21/02		5.74	171.63
	9/10/02		8.28	169.09
	3/30/02		7.43	169.94
	12/22/01		6.92	170.45
	9/23/01		8.53	168.84
	6/22/01		8.30	169.07
	4/22/01		7.77	169.60
	12/14/00		8.49	168.88
	9/18/00		8.56	168.81
	6/08/00		7.97	169.40
	3/09/00		6.68	170.69
	12/09/99		8.15	169.22
	8/31/99		8.36	169.01
	4/29/99		7.68	169.69

NOTES:

* = Surveyed on August 20, 1997

TABLE 1
 WELL MONITORING DATA

Well No.	Date Monitored	Top of Casing Elev. (ft.)	Depth to Water (ft.)	Water Table Elev. (ft.)
MW1 (Continued)	1/29/99	177.37*	6.99	170.38
	4/26/98		7.50	169.87
	1/24/98		6.61	170.76
	11/06/97		8.79	168.58
	8/26/97	177.37*	8.51	168.86
	7/24/97		8.71	168.72
	4/25/97		7.98	169.45
	1/20/97		7.12	170.31
	7/26/96		8.39	169.04
	7/09/96		8.16	169.27
	4/23/96		7.47	169.96
	2/07/96		6.09	171.34
	1/29/96		6.17	171.26
	10/26/95		8.45	168.98
	7/28/95		8.27	169.16
	5/02/95		6.96	170.47
	2/23/95		7.72	169.71
	11/18/94		7.14	170.29
	8/22/94		8.67	168.76
	5/19/94	177.43**	8.05	169.38
	2/28/94		7.44	169.99
	11/24/93		8.74	168.69
	8/30/93		8.78	168.65
	5/18/93		8.12	169.31
	2/23/93		7.34	170.09
	11/13/92	200.00***	9.13	190.87
	5/29/92	175.73	8.59	167.14
	1/14/92		8.57	167.16
	12/23/91		9.65	166.08
	11/25/91		9.41	166.32
10/10/91		9.70	166.03	
9/17/91		9.50	166.23	
8/19/91		9.31	166.42	

NOTES:

* = Surveyed on August 20, 1997

** = Surveyed on March 24, 1993

*** = Surveyed on December 5, 1992

TABLE 1
 WELL MONITORING DATA

Well No.	Date Monitored	Top of Casing Elev. (ft.)	Depth to Water (ft.)	Water Table Elev. (ft.)
MW2	NOT MEASURED (DESTROYED ON FEBRUARY 7, 1996)			
	02/07/96	176.04**	5.70	170.34
	01/29/96		5.16	170.88
	10/26/95		8.21	167.83
	07/28/95		7.99	168.05
	05/02/95		6.79	169.25
	02/23/95		7.51	168.53
	11/18/94		6.92	169.12
	08/22/94		8.59	167.45
	05/19/94		7.70	168.34
	02/28/94		6.99	169.05
	11/24/93		8.47	167.57
	08/30/93		8.64	167.40
	05/18/93		7.73	168.31
	02/23/93		6.39	169.65
	11/13/92	198.61***	8.70	189.91
	05/29/92	175.45	9.31	166.14
	01/14/92		8.97	166.48
	12/23/91		10.39	165.06
	11/25/91		9.81	165.64
	10/10/91		10.39	165.06
	09/17/91		10.23	165.22
	08/19/91		9.60	165.85

NOTES:

* = Surveyed on August 20, 1997

** = Surveyed on March 24, 1993

*** = Surveyed on December 5, 1992

TABLE 1
 WELL MONITORING DATA

Well No.	Date Monitored	Top of Casing Elev. (ft.)	Depth to Water (ft.)	Water Table Elev. (ft.)
MW3	01/17/08	176.40*	8.90	167.50
	11/16/07		9.43	166.97
	07/25/07		9.35	167.05
	04/17/07		8.88	167.52
	01/18/07		7.32	169.08
	11/14/06		7.53	168.87
	06/29/06		7.58	168.82
	02/03/06		6.10	170.30
	11/18/05		7.63	168.77
	07/28/05		7.58	168.82
	04/13/05		6.35	170.05
	01/31/05		6.79	169.61
	10/15/04		8.28	168.12
	07/13/04		8.11	168.29
	04/06/04		7.41	168.99
	12/18/03		6.99	169.41
	09/18/03		7.91	168.49
	06/19/03		7.60	168.80
	03/18/03		7.35	169.05
	12/21/02		5.43	170.97
	9/10/02		7.97	168.43
	3/30/02		6.97	169.43
	12/22/01		6.44	169.96
	9/23/01		8.17	168.23
	6/22/01		8.06	168.34
	4/22/01		7.50	168.90
12/14/00		8.13	168.27	
9/18/00		7.83	168.57	
9/26/00		7.77	168.63	
6/08/00		7.50	168.90	
3/09/00		6.08	170.32	
12/09/99		7.90	168.50	

NOTES:

- * = Surveyed on August 20, 1997
- ** = Surveyed on March 24, 1993
- *** = Surveyed on December 5, 1992

TABLE 1
 WELL MONITORING DATA

Well No.	Date Monitored	Top of Casing Elev. (ft.)	Depth to Water (ft.)	Water Table Elev. (ft.)
MW3	8/31/99	176.41**	7.95	168.45
(Continued)	4/29/99		7.09	169.31
	1/29/99		6.42	169.98
	4/26/98		6.85	169.55
	1/24/98		5.90	170.50
	11/06/97		7.80	168.80
	8/26/97		7.67	168.93
	7/24/97	176.41**	7.90	168.51
	4/25/97		7.12	169.29
	1/20/97		6.35	170.06
	7/26/96		7.84	169.57
	7/09/96		7.61	168.80
	4/23/96		6.81	169.60
	2/07/96		5.05	170.36
	1/29/96		5.77	170.64
	10/26/95		7.72	168.69
	7/28/95		7.80	168.61
	5/02/95		6.50	169.91
	2/23/95		7.24	169.17
	11/18/94		6.05	170.36
	8/22/94	190.97***	7.65	168.76
	5/19/94		7.15	169.26
	2/24/94		6.68	169.73
	11/24/93		7.55	168.86
	8/30/93		7.64	168.77
	5/18/93		7.12	169.29
	2/23/93		8.01	168.40
	11/13/92		7.86	191.12
	5/29/92	175.00	8.45	166.55
	1/14/92		8.24	166.55
	12/23/91		9.37	165.63
	11/25/91		9.19	165.81
	10/10/91		9.43	165.57
	9/17/91		9.20	165.80
	8/19/91		8.95	166.05

NOTES:

* = Surveyed on August 20, 1997

** = Surveyed on March 24, 1993

*** = Surveyed on December 5, 1992

TABLE 1
 WELL MONITORING DATA

Well No.	Date Monitored	Top of Casing Elev. (ft.)	Depth to Water (ft.)	Water Table Elev. (ft.)
MW4	1/17/08	176.35*	7.50(0.17)#	168.98
	10/16/07		8.50(0.25)#	168.04
	07/25/07		8.04(0.17)#	168.44
	04/17/07		7.94(0.19)#	168.55
	01/18/07		7.38(0.21)#	169.13
	11/14/06		7.36(0.25)#	169.18
	06/29/06		Unknown	Unknown
	02/03/06		5.86	170.49
	11/18/05		7.99 (0.51)#	168.36
	07/28/05		7.59	168.76
	04/13/05		6.78 (0.01)#	169.58
	01/31/05		7.34 (0.19)#	169.15
	10/15/04		8.73 (0.15)#	167.73
	07/13/04		8.44 (0.03)#	167.93
	04/06/04		9.58 (2.83)#	168.89
	02/11/04		9.43 (2.70)#	168.95
	12/18/03		9.75 (1.51)#	167.73
	9/18/03		9.13 (1.80)#	168.57
	6/19/03		8.56 (0.31)#	168.02
	3/18/03		7.49 (0.06)#	168.91
12/21/02	8.58 (4.39)#	171.06		

NOTES:

* = Surveyed on August 20, 1997

= Indicates free product thickness in feet. The water table elevation has been corrected for the presence of free product by assuming a free product specific gravity of 0.75.

TABLE 1
 WELL MONITORING DATA

Well No.	Date Monitored	Top of Casing Elev. (ft.)	Depth to Water (ft.)	Water Table Elev. (ft.)
MW4 (Continued)				
	9/10/02		9.09 (1.60)#	168.46
	3/30/02		9.86 (2.49)#	168.36
	12/22/01		7.79 (1.75)#	169.87
	9/23/01		8.97 (1.17)#	168.26
	6/22/01		7.79	168.56
	4/22/01		9.07 (2.20)#	168.93
	12/14/00		8.87 (0.72)#	168.02
	9/18/00		8.50 (0.45)#	168.19
	6/08/00		7.34	169.01
	3/09/00		6.61 (0.46)#	170.08
	12/09/99		8.80	167.55
	8/31/99		8.28	168.07
	4/29/99		7.14	169.21
	1/29/99		6.68	169.67
	4/26/98		6.87	169.48
	1/24/98		6.61	169.74
	11/06/97		9.16	167.19
	8/26/97		8.92	167.43
	8/20/97		7.66 (prior to development)	

NOTES:

* = Surveyed on August 20, 1997

= Indicates free product thickness in feet. The water table elevation has been corrected for the presence of free product by assuming a free product specific gravity of 0.75.

TABLE 1
WELL MONITORING DATA

Well No.	Date Monitored	Top of Casing Elev. (ft.)	Depth to Water (ft.)
EW1	1/17/08	Not Surveyed	11.41
	11/16/07		11.95
	07/25/07		11.57
	04/17/07		11.35
	01/18/07		6.60
	11/14/06		6.11
	06/29/06		6.88
	02/03/06		5.23
	11/18/05		6.63
	07/28/05		6.94
	04/13/05		5.23
	01/31/05		6.25
	10/15/04		7.65
	07/13/04		7.51
	04/06/04		6.63
	12/18/03		6.72
	09/18/03		7.29

NOTES:

TABLE 1
 WELL MONITORING DATA

Well No.	Date Monitored	Top of Casing Elev. (ft.)	Depth to Water (ft.)	Total Well Depth (ft.)
OW1	01/17/08	Not Surveyed	4.00	Not measured
	11/16/07		No Water or Product	7.41
	07/25/07		No Water or Product	7.41
	04/17/07		No Water or Product	7.41
	01/18/07		No Water or Product	7.41
	11/14/06		No Water (sheen)	7.41
	06/29/06		7.13	7.42
	02/03/06		6.97	7.45
	11/18/05		7.43 (0.13)#	7.50
	07/28/05		7.06 (0.01)#	7.45
	04/13/05		6.99	7.44
	01/31/05		7.03	7.44
	10/15/04		7.19 (0.08)#	7.44
	07/14/04		7.02	7.44
	04/06/04		7.01	7.44
	02/11/04		7.01	7.44
	10/06/03		7.07 (0.01)#	7.44
	11/02/00		7.12,+	
	01/29/99		7.12	
	12/09/99		7.27	

NOTES:

= Indicates free product thickness in feet. The water table elevation has been corrected for the presence of free product by assuming a free product specific gravity of 0.75.

+ = Petroleum hydrocarbon odor reported on probe for water level indicator.

TABLE 1
 WELL MONITORING DATA

Well No.	Date Monitored	Top of Casing Elev. (ft.)	Depth to Water (ft.)	Total Well Depth (ft.)
OW2	1/17/08	Not Surveyed	No Water Detected	Not measured
	11/16/07		No Water or Product	7.28
	07/25/07		No Water or Product	7.28
	04/17/07		No Water or Product	7.28
	01/18/07		No Water or Product	7.28
	11/14/06		7.27	7.28
	06/29/06		7.30	7.33
	02/03/06		7.08	7.35
	11/18/05		7.33	7.35
	07/28/05		7.27	7.32
	04/13/05		7.06	7.35
	01/31/05		7.29	7.37
	10/15/04		No Water or Product	7.35
	07/14/04		No Water or Product	7.35
	04/06/04		7.27	7.33
	02/11/04		7.19	7.33
	10/06/03		7.29	7.34
	11/02/00		7.19	
	01/29/99		7.19	
	12/09/99		7.17	

NOTES:

= Indicates free product thickness in feet. The water table elevation has been corrected for the presence of free product by assuming a free product specific gravity of 0.75.
 + = Petroleum hydrocarbon odor reported on probe for water level indicator.

TABLE 2
SUMMARY OF LABORATORY ANALYTICAL RESULTS
Well MW1

Date	TPH-D	TPH-G	MTBE	Benzene	Toluene	Ethyl-benzene	Total Xylenes	Other Fuel Additives by 8260*
1/17/08	3.8, b	22	0.074	0.31	0.22	1.2	1.7	ND
10/16/07	2.5, a, b	23, a	0.13	0.48	0.23	1.1	1.7	ND
07/25/07	3.9, b	15, f	0.13	0.25	0.023	ND<0.01	1.5	ND
04/17/07	6.2, b	23	0.26	0.78	0.32	1.1	2.0	ND<0.025, except TBA ND<0.25
01/18/07	6.4, b	29	ND<1.0	1.8	0.87	1.6	3.3	ND<0.05, except TBA ND<0.5
11/14/06	7.2, b	30	0.44	2.2	0.60	1.8	2.9	ND<0.05, except TBA ND<0.5, Ethanol ND<5.0, Methanol ND<50.0

NOTES:

TPH-G = Total Petroleum Hydrocarbons as Gasoline.

TPH-D = Total Petroleum Hydrocarbons as Diesel.

MTBE = Methyl tert-Butyl Ether.

ND = Not Detected.

-- = Not Analyzed.

a = Laboratory analytical report note: lighter than water immiscible sheen present on the sample.

b = Laboratory analytical report note: TPH-D results consist of both diesel-range and gasoline-range compounds.

c = Laboratory analytical report note: TPH-D results consist of gasoline-range compounds.

d = Laboratory analytical report note: TPH-D results consist of both oil-range and gasoline-range compounds.

e = Laboratory analytical report note: TPH-D results consist of oil-, gas, and diesel-range compounds.

f = Laboratory analytical report note: TPH-G results have no recognizable pattern.

+ = Analyzed by EPA Method 8260.

* = This column summarizes results for analysis using EPA Method 8260 for non-MTBE fuel oxygenates (TAME, DIPE, ETBE, and TBA) or lead scavengers (EDB, 1,2-DCA/EDC).

Results in milligrams per liter (mg/L), unless otherwise indicated.

TABLE 2
SUMMARY OF LABORATORY ANALYTICAL RESULTS
Well MW1 (Continued)

Date	TPH-D	TPH-G	MTBE	Benzene	Toluene	Ethyl- benzene	Total Xylenes	Other Fuel Additives by 8260*
6/29/06	22,b	45	1.2	3.1	0.94	2.0	3.9	ND<0.05, TBA ND<0.5
02/03/06	9.7,c	37	0.62	2.2	1.2	2.0	3.5	ND<0.05, TBA ND<0.5
11/18/05	4.3,b	25	0.14	1.6	0.43	1.8	2.7	ND<0.05, TBA ND<0.5
7/28/05	16,a,b	30,a	0.26,+	2.5	0.76	2.1	4.8	ND<0.05, TBA ND<0.5
4/13/05	9.3,b	30	0.3	1.9	0.6	1.7	3	ND<0.05, TBA ND<0.5
1/31/05	14,b	29	0.27	2.2	1.2	1.9	5.0	ND<0.05, TBA ND<0.5
10/15/04	16,a,b	36,a	ND<0.05	1.5	1.0	2.1	5.1	ND<0.05, TBA ND<0.5

NOTES:

TPH-G = Total Petroleum Hydrocarbons as Gasoline.

TPH-D = Total Petroleum Hydrocarbons as Diesel.

MTBE = Methyl tert-Butyl Ether.

ND = Not Detected.

-- = Not Analyzed.

a = Laboratory analytical report note: lighter than water immiscible sheen present on the sample.

b = Laboratory analytical report note: TPH-D results consist of both diesel-range and gasoline-range compounds.

c = Laboratory analytical report note: TPH-D results consist of gasoline-range compounds.

d = Laboratory analytical report note: TPH-D results consist of both oil-range and gasoline-range compounds.

e = Laboratory analytical report note: TPH-D results consist of oil-, gas, and diesel-range compounds.

+ = Analyzed by EPA Method 8260.

* = This column summarizes results for analysis using EPA Method 8260 for non-MTBE fuel oxygenates (TAME, DIPE, ETBE, and TBA) or lead scavengers (EDB, 1,2-DCA/EDC).

Results in milligrams per liter (mg/L), unless otherwise indicated.

TABLE 2
SUMMARY OF LABORATORY ANALYTICAL RESULTS
Well MW1 (Continued)

Date	TPH-D	TPH-G	MTBE	Benzene	Toluene	Ethyl- benzene	Total Xylenes	Other Fuel Additives by 8260*
7/13/04	22a,b	34,a	0.053	2.1	0.59	2.1	4.4	ND<0.5, TBA
4/6/04	18,a,b	28,a	0.11	2.3	0.8	0.99	4.5	ND<0.5 ND<0.1 TBA
12/18/03	13,b	33	0.038	2.1	0.77	1.8	4.4	ND<1 ND<0.005 TBA
9/18/03	15,a,b	32	0.052	2.2	0.62	1.8	3.8	ND<0.05 ND<0.017 , TBA ND<0.17

NOTES:

TPH-G = Total Petroleum Hydrocarbons as Gasoline.

TPH-D = Total Petroleum Hydrocarbons as Diesel.

MTBE = Methyl tert-Butyl Ether.

ND = Not Detected.

-- = Not Analyzed.

a = Laboratory analytical report note: lighter than water immiscible sheen present on the sample.

b = Laboratory analytical report note: TPH-D results consist of both diesel-range and gasoline-range compounds.

c = Laboratory analytical report note: TPH-D results consist of gasoline-range compounds.

d = Laboratory analytical report note: TPH-D results consist of both oil-range and gasoline-range compounds.

e = Laboratory analytical report note: TPH-D results consist of oil-, gas, and diesel-range compounds.

+ = Analyzed by EPA Method 8260.

* = This column summarizes results for analysis using EPA Method 8260 for non-MTBE fuel oxygenates (TAME, DIPE, ETBE, and TBA) or lead scavengers (EDB, 1,2-DCA/EDC).

Results in milligrams per liter (mg/L), unless otherwise indicated.

Results in milligrams per liter (mg/L), unless otherwise indicated.

TABLE 2
SUMMARY OF LABORATORY ANALYTICAL RESULTS
Well MW1 (Continued)

Date	TPH-D	TPH-G	MTBE	Benzene	Toluene	Ethyl- benzene	Total Xylenes	Other Fuel Additives by 8260*
6/26/03	67,a,b	45	ND<0.05	2.1	0.72	2.3	5.5	ND
3/18/03	7.3,a,b	33	ND<0.05	2.4	0.9	1.6	1.0	ND
12/21/02	11,a,b	32	ND<0.1	2.6	0.98	2.2	5.5	ND
9/10/02	18,c	31	ND<0.25	2.2	0.65	1.7	4.8	--
3/30/02	12,a,b	99	ND	4.1	1.2	2.5	6.4	--
12/22/01	22,a,b	60	ND	3.2	1.9	2	6.2	--
9/23/01	16,a,c	49	ND	4	1.4	2.2	6.2	--
6/22/01	85,a,b	35	ND	3.1	0.75	1.2	4.0	--
4/22/01	16,a	43	ND	3.6	1.2	1.6	5.8	--
12/14/00	11,a,d	49	ND	5.8	1.6	2	6.9	--
9/18/00	15,a,b	86	ND	7.2	2	3.2	13	--
6/8/00	6.5,a,c	50	ND	5.7	1.5	1.8	7	--
3/9/00	7.4,a,b	48	ND	5.3	3.1	1.6	8.1	--
12/9/99	12,a,b	65	ND	9.3	2.9	2.2	8.8	--
8/31/99	22,b	66	0.71	8.7	2.7	2.4	10	--
4/29/99	22,b	48	ND	8.4	2.8	2.0	8.1	--
1/29/99	9.1,b	47	ND	9.0	2.9	1.9	8.0	--
4/26/98	7.8,c	60	ND	9.3	5.7	2.1	9.1	--
1/24/98	24,b	57	ND	6.9	5.5	2.0	8.7	--
11/6/97	17,c	63	ND	7.4	6.7	2.3	9.9	--
7/27/97	28,c	66	1.8	8.6	8.1	2.2	10	--
4/25/97	170,b	77	ND	7.4	7.9	2.1	9.8	--
1/21/97	57,c	80	0.25	7.8	8.3	1.9	8.9	--
7/26/96	11,c	76	ND	11	13	2.4	10	--
4/23/96	5.7,c	73	ND	8.6	12	2.2	9.8	--

NOTES:

TPH-G = Total Petroleum Hydrocarbons as Gasoline.

TPH-D = Total Petroleum Hydrocarbons as Diesel.

MTBE = Methyl tert-Butyl Ether.

ND = Not Detected.

-- = Not Analyzed.

a = Laboratory analytical report note: lighter than water immiscible sheen present on the sample.

b = Laboratory analytical report note: TPH-D results consist of both diesel-range and gasoline-range compounds.

c = Laboratory analytical report note: TPH-D results consist of gasoline-range compounds.

d = Laboratory analytical report note: TPH-D results consist of both oil-range and gasoline-range compounds.

e = Laboratory analytical report note: TPH-D results consist of oil-, gas, and diesel-range compounds.

+ = Analyzed by EPA Method 8260.

* = This column summarizes results for analysis using EPA Method 8260 for non-MTBE fuel oxygenates (TAME, DIPE, ETBE, and TBA) or lead scavengers (EDB, 1,2-DCA/EDC).

Results in milligrams per liter (mg/L), unless otherwise indicated.

Results in milligrams per liter (mg/L), unless otherwise indicated.

TABLE 2
SUMMARY OF LABORATORY ANALYTICAL RESULTS
Well MW1 (Continued)

Date	TPH-D	TPH-G	MTBE	Benzene	Toluene	Ethyl- benzene	Total Xylenes	Other Fuel Additives by 8260*
1/29/96	6.6,c	81	0.25	7.6	13	1.9	8.9	--
10/26/95	62,c	89	ND	7.8	12	2.4	11	--
7/28/95	2.0,c	35	--	3.8	8.7	1.1	6.5	--
5/2/95	6.5,c	86	--	8.9	14	2.3	11	--
2/24/95	9.1	90	--	7.5	12	1.5	11	--
11/18/94	10	96	--	9.3	14	2.5	11	--
8/22/94	8.3	100	--	9.0	11	2.1	9.4	--
5/19/94	30	100	--	12	14	3.5	17	--
2/28/94	110	90	--	11	9.6	2.1	9.9	--
11/24/93	8.2	66	--	8.3	8.9	2.0	121	--
8/30/93	9.4	77	--	6.4	11	2.2	12	--
5/18/93	30	92	--	4.0	11	2.5	15	--
2/23/93	14	100	--	4.5	11	2.1	12	--
11/13/92	4.4	120	--	5.8	10	2.1	13	--
5/27/92	11	120	--	8.8	16	2.3	15	--
1/24/92	19	39	--	7.3	8.7	1.3	8.9	--
12/23/91	34	78	--	9.3	7.3	0.54	13	--

NOTES:

TPH-G = Total Petroleum Hydrocarbons as Gasoline.

TPH-D = Total Petroleum Hydrocarbons as Diesel.

MTBE = Methyl tert-Butyl Ether.

ND = Not Detected.

-- = Not Analyzed.

a = Laboratory analytical report note: lighter than water immiscible sheen present on the sample.

b = Laboratory analytical report note: TPH-D results consist of both diesel-range and gasoline-range compounds.

c = Laboratory analytical report note: TPH-D results consist of gasoline-range compounds.

d = Laboratory analytical report note: TPH-D results consist of both oil-range and gasoline-range compounds.

e = Laboratory analytical report note: TPH-D results consist of oil-, gas, and diesel-range compounds.

+ = Analyzed by EPA Method 8260.

* = This column summarizes results for analysis using EPA Method 8260 for non-MTBE fuel oxygenates (TAME, DIPE, ETBE, and TBA) or lead scavengers (EDB, 1,2-DCA/EDC).

Results in milligrams per liter (mg/L), unless otherwise indicated.

TABLE 2
SUMMARY OF LABORATORY ANALYTICAL RESULTS
Well MW1 (Continued)

Date	TPH-D	TPH-G	MTBE	Benzene	Toluene	Ethyl- benzene	Total Xylenes	Other Fuel Additives by 8260*
11/25/91	36	170	--	5.5	5.6	1.6	8.4	--
10/10/91	19	28	--	4.1	4.7	1.0	4.8	--
9/17/91	19	39	--	4.9	4.1	1.2	5.9	--
8/19/91	47	48	--	13	8.4	0.99	29	--
7/20/91	49	100	--	11	14	2.3	17	--
6/20/91	42	76	--	4.7	7.1	1.5	9.8	--
5/17/91	26	72	--	7.7	9.9	ND	11	--
4/15/91	--	56	--	6.5	8.5	0.41	9.9	--
3/21/91	--	36	--	4.5	5.7	0.087	7.3	--
2/15/91	--	120	--	7.4	6.6	ND	13	--
1/15/91	--	33	--	3.9	2.9	0.21	5.3	--
9/27/90	--	28	--	3.7	3.5	0.01	6.5	--
8/23/90	--	40	--	5.1	4.9	0.35	6.0	--
7/20/90	44	--	--	5.1	4.2	ND	9.1	--
3/19/90	--	40	--	3.7	1.1	ND	3.3	--
2/20/90**	--	7.6	--	1.6	ND	ND	1.3	--

NOTES:

TPH-G = Total Petroleum Hydrocarbons as Gasoline.

TPH-D = Total Petroleum Hydrocarbons as Diesel.

MTBE = Methyl tert-Butyl Ether.

ND = Not Detected.

-- = Not Analyzed.

a = Laboratory analytical report note: lighter than water immiscible sheen present on the sample.

b = Laboratory analytical report note: TPH-D results consist of both diesel-range and gasoline-range compounds.

c = Laboratory analytical report note: TPH-D results consist of gasoline-range compounds.

d = Laboratory analytical report note: TPH-D results consist of both oil-range and gasoline-range compounds.

e = Laboratory analytical report note: TPH-D results consist of oil-, gas, and diesel-range compounds.

+ = Analyzed by EPA Method 8260.

* = This column summarizes results for analysis using EPA Method 8260 for non-MTBE fuel oxygenates (TAME, DIPE, ETBE, and TBA) or lead scavengers (EDB, 1,2-DCA/EDC).

Results in milligrams per liter (mg/L), unless otherwise indicated.

TABLE 2
SUMMARY OF LABORATORY ANALYTICAL RESULTS
Well MW2

Date	TPH-D	TPH-G	MTBE	Benzene	Toluene	Ethyl- benzene	Total Xylenes	Other Fuel Additives by 8260*
2/7/96				MW2 Destroyed				
1/29/96	4.6,c	38	0.0071	1.9	5.7	1.1	5.9	--
10/26/95	900	74	ND	2.9	5.9	2.0	10	--
7/28/95	2.0,c	15	--	1.4	2.3	0.62	3.2	--
5/2/95	6.6,b	55	--	3.3	10	1.8	10	--
2/24/95	22	67	--	4.9	11	1.8	11	--
11/18/94	5.0	86	--	11	17	1.8	12	--
8/22/94	4.1	91	--	10	13	1.5	9.0	--
5/19/94	5.8	62	--	92	13	1.3	8.4	--
2/28/94	13	91	--	13	16	1.5	9.0	--
11/24/93	79	12	--	13	17	2.5	17	--
8/30/93	110	110	--	11	14	1.8	11	--
5/18/93	44	67	--	9.2	12	1.4	9.3	--
2/23/93	7.0	76	--	12	17	1.6	9.6	--
11/13/92	8.2	79	--	10	13	1.4	8.6	--
5/27/92	130	89	--	18	19	1.7	14	--
1/14/92	1600	59	--	17	14	1.8	15	--
12/23/91	700	2100	--	36	130	79	560	--
11/25/91	130	230	--	11	9.7	1.4	9.7	--
10/10/91	360	85	--	21	25	2.1	14	--
9/17/91	56	74	--	10	11	1.4	8.1	--
8/19/91	19	69	--	26	22	2.1	18	--
7/20/91	100	51	--	9.9	7.7	1.2	7.5	--
6/20/91	69	87	--	8.1	8.4	1.1	8.9	--
5/17/91	33	62	--	5.9	6.3	1.2	9.0	--
4/15/91	--	82	--	5.3	7.4	1.0	9.4	--
3/21/91	--	62	--	9.3	11	0.35	9.7	--
2/15/91	--	200	--	12	12	1.7	14	--
1/14/91	--	78	--	11	8.7	0.58	8.0	--
9/27/90	--	59	--	8.4	12	0.88	9.0	--
8/23/90	--	96	--	8.1	8.4	1.5	8.6	--
7/20/90	86	--	--	9.1	14	0.94	13	--
3/19/90	--	50	--	7.7	8.7	0.075	5.6	--
2/20/90**	--	38	--	7.3	3.1	0.075	6.8	--

NOTES:

TPH-G = Total Petroleum Hydrocarbons as Gasoline.

TPH-D = Total Petroleum Hydrocarbons as Diesel.

MTBE = Methyl tert-Butyl Ether.

ND = Not Detected.

-- = Not Analyzed.

b = Laboratory analytical report note: TPH-D results consist of both diesel-range and gasoline-range compounds.

c = Laboratory analytical report note: TPH-D results consist of gasoline-range compounds.

* = This column summarizes results for analysis using EPA Method 8260 for non-MTBE fuel oxygenates (TAME, DIPE, ETBE, and TBA) or lead scavengers (EDB, 1,2-DCA/EDC).

** Inorganic lead not detected in sample.

Results in milligrams per liter (mg/L), unless otherwise indicated.

TABLE 2
SUMMARY OF LABORATORY ANALYTICAL RESULTS
Well MW3

Date	TPH-D	TPH-G	MTBE	Benzene	Toluene	Ethyl- benzene	Total Xylenes	Other Fuel Additives by 8260*
1/17/08	9.9, a, b	110, a	9.3	34	ND<0.50	2.5	9.5	ND, except TBA= 8.0
10/16/07	13, a, b	69, a	13	18	ND<0.5	ND<0.5	5.0	ND, except TBA= 10
07/25/07	6.7, a, e	52, a	12	23	ND<0.25	ND<0.25	6.0	ND, except TBA= 8.6
04/17/07	7.9, a, b	92, a	14	23	ND<0.5	1.5	5.9	ND<0.5, except TBA = 8.0
01/18/07	6.4, b	94	22	29	1.3	2.1	9.6	ND<0.5, except TBA = 12
11/14/06	21, a, b	100, a	23	37	1.0	2.2	11	ND<0.5 except, TBA= 16, Ethanol ND<5.0, Methanol ND<50.0

NOTES:

TPH-G = Total Petroleum Hydrocarbons as Gasoline.

TPH-D = Total Petroleum Hydrocarbons as Diesel.

MTBE = Methyl tert-Butyl Ether.

ND = Not Detected.

-- = Not Analyzed.

a = Laboratory analytical report note: lighter than water immiscible sheen present on the sample.

b = Laboratory analytical report note: TPH-D results consist of both diesel-range and gasoline-range compounds.

c = Laboratory analytical report note: TPH-D results consist of gasoline-range compounds.

d = Laboratory analytical report note: TPH-D results consist of both oil-range and gasoline-range compounds.

e = Laboratory analytical report note: TPH-D results consist of oil-, gas, and diesel-range compounds with no recognizable pattern.

+ = Analyzed by EPA Method 8260.

* = This column summarizes results for analysis using EPA Method 8260 for non-MTBE fuel oxygenates (TAME, DIPE, ETBE, and TBA) or lead scavengers (EDB, 1,2-DCA/EDC).

Results in milligrams per liter (mg/L), unless otherwise indicated.

TABLE 2
SUMMARY OF LABORATORY ANALYTICAL RESULTS
Well MW3 (Continued)

Date	TPH-D	TPH-G	MTBE	Benzene	Toluene	Ethyl-benzene	Total Xylenes	Other Fuel Additives by 8260*
6/29/06	12,b	36	27	14	ND<0.5	ND<0.5	ND<0.5	ND<0.5, except TBA = 11
02/03/06	22,b	86	24	26	ND<0.5	1.7	6	ND<0.5, except TBA = 11
11/18/05	32,a,b	87,a	22	35	ND<1	2	11	ND<1.0, except TBA ND<10
7/28/05	77,a,b	100,a	32,+	30	1.1	2.3	12	ND<0.5, except TBA = 13
4/13/05	19,a,b	96,a	28	31	4	2.3	12	ND<0.5, except TBA = 12
1/31/05	13,a,b	93,a	31	36	1.5	2.5	11	ND<1, except TBA = 24
10/15/04	13,a,b	76,a	24	28	ND<0.5	1.1	3.6	ND<0.5, except TBA = 18
7/13/04	57,a,b	98,a	15	28	2.9	1.7	8.9	ND<0.5, except TBA = 11
4/6/04	32,a,b	81,a	17	34	5.9	1.5	9.9	ND<0.5, except TBA = 8.8
12/18/03	32,a,b	130,a	32	33	5.4	0.72	11	ND<0.5, except TBA = 17

NOTES:

TPH-G = Total Petroleum Hydrocarbons as Gasoline.

TPH-D = Total Petroleum Hydrocarbons as Diesel.

MTBE = Methyl tert-Butyl Ether.

ND = Not Detected.

-- = Not Analyzed.

a = Laboratory analytical report note: lighter than water immiscible sheen present on the sample.

b = Laboratory analytical report note: TPH-D results consist of both diesel-range and gasoline-range compounds.

c = Laboratory analytical report note: TPH-D results consist of gasoline-range compounds.

* = This column summarizes results for analysis using EPA Method 8260 for non-MTBE fuel oxygenates (TAME, DIPE, ETBE, and TBA) or lead scavengers (EDB, 1,2-DCA/EDC).

***Review of laboratory analytical reports indicate that oxygenated volatile organic compounds (including TAME, DIPE, ETBE, methanol, ethanol, EDB, and 1,2-DCA) were not detected except MTBE at 21 ppm and tert-butanol at 19 ppm.

Results in milligrams per liter (mg/L), unless otherwise indicated.

TABLE 2
SUMMARY OF LABORATORY ANALYTICAL RESULTS
Well MW3 (Continued)

Date	TPH-D	TPH-G	MTBE	Benzene	Toluene	Ethyl-benzene	Total Xylenes	Other Fuel Additives by 8260*
9/18/03	140,a,b	130	23	34	11	2.5	14	ND<0.5, except TBA = 10
6/26/03	27,a,b	96	21	29	5.2	2.0	10	ND, except TBA = 8.9
3/18/03	11,a,b	120	16	36	12	1.8	2.4	ND, except TBA = 5.1
12/21/02	21,a,b	110	33	34	9.3	2.0	13	ND, except TBA = 14
9/10/02	43,b	70	19	21	2.2	1.6	7.6	--
3/30/02	8.5,a,b	170	26	40	17	2.6	16	--
12/22/01	9.2,a,b	140	27	37	20	2.6	15	--
9/23/01	47,a,b	130	26	32	9.1	2.4	12	--
6/22/01	33,a,b	110	25	31	7.2	1.9	11	--
4/22/01	61,a	140	24	25	5.4	1.7	11	--
12/14/00	120,a,b	140	35	37	16	2.4	15	--
9/18/00	43,a,b	130	33	39	91	2.3	14	--
7/26/00	--	--	21	--	--	--	--	ND***, except tert-butanol = 19
6/8/00	74,a,b	130	23	41	16	1.9	13	--
3/9/00	14,a,b	180	24	39	22	2.5	16	--
12/9/99	17,a,b	120	16	35	6.7	2.4	12	--
8/31/99	22,b	120	4.7	35	3.7	2.4	14	--
4/29/99	48,b	100	2.5	33	8.0	2.1	14	--
1/29/99	240,b	84	1.3	31	2.8	1.8	12	--
4/26/98	380,b	100	9.7	29	7.1	1.8	14	--
1/24/98	77,b	97	ND	28	7.1	1.8	11	--
11/6/97	120,b	140	ND	37	19	2.4	14	--
7/24/97	91,c	120	1.4	33	17	2.2	12	--
4/25/97	760,b	240	1.6	24	18	4.1	24	--
1/21/97	34,c	150	1.3	40	14	2.6	12	--
7/26/96	24,c	130	0.89	40	22	2.4	12	--

NOTES:

TPH-G = Total Petroleum Hydrocarbons as Gasoline.

TPH-D = Total Petroleum Hydrocarbons as Diesel.

MTBE = Methyl tert-Butyl Ether.

ND = Not Detected.

-- = Not Analyzed.

b = Laboratory analytical report note: TPH-D results consist of both diesel-range and gasoline-range compounds.

c = Laboratory analytical report note: TPH-D results consist of gasoline-range compounds.

* = This column summarizes results for analysis using EPA Method 8260 for non-MTBE fuel oxygenates (TAME, DIPE, ETBE, and TBA) or lead scavengers (EDB, 1,2-DCA/EDC).

** Inorganic lead not detected in sample.

Results in milligrams per liter (mg/L), unless otherwise indicated.

TABLE 2
SUMMARY OF LABORATORY ANALYTICAL RESULTS
Well MW3 (Continued)

Date	TPH-D	TPH-G	MTBE	Benzene	Toluene	Ethyl- benzene	Total Xylenes	Other Fuel Additives by 8260*
4/23/96	280,c	170	0.72	34	22	2.2	14	--
1/29/96	45,c	150	0.54	32	21	1.9	12	--
10/26/95	33	130	0.69	37	21	0.21	11	--
7/28/95	1.9,b	86	--	1.4	2.3	0.62	3.2	--
5/2/95	9.7,b	170	--	43	30	2.5	14	--
2/24/95	9.2	130	--	31	19	1.8	10	--
11/18/94	23	140	--	38	22	2.0	11	--
7/22/94	5.3	170	--	35	20	1.8	10	--
5/19/94	30	150	--	38	25	2.4	14	--
2/28/94	210	110	--	36	21	1.9	11	--
11/24/93	24	160	--	48	26	2.2	12	--
7/30/93	32	130	--	36	21	1.9	8.2	--
5/18/93	7.2	130	--	36	21	2.1	12	--
2/23/93	8.1	110	--	31	18	1.9	11	--
11/13/92	4.7	140	--	38	24	2.0	12	--
5/27/92	27	370	--	91	57	3.0	21	--
7/14/92	270	130	--	76	30	3.4	21	--
12/23/91	540	740	--	30	61	31	180	--
11/25/91	74	150	--	65	31	3.4	18	--
10/10/91	39	140	--	57	31	2.2	14	--
9/17/91	140	180	--	47	25	2.6	15	--
8/19/91	150	170	--	82	31	4.4	22	--
7/20/91	270	450	--	46	29	3.5	21	--
6/20/91	210	920	--	39	49	13	69	--
5/17/91	70	170	--	32	22	2.2	18	--
4/15/91	--	110	--	31	15	0.88	7.4	--
3/21/91	--	87	--	30	14	0.69	5.4	--
2/15/91	--	230	--	44	40	ND	31	--
1/14/91	--	160	--	48	25	1.0	16	--
9/27/90	--	25	--	7.2	6.4	0.42	3.4	--
8/23/90	--	220	--	67	46	27	18	--
7/20/90	86	--	--	9.1	14	0.94	13	--
3/19/90	--	210	--	38	28	1.8	12	--
2/20/90**	--	46	--	20	15	1.8	9.7	--

NOTES:

TPH-G = Total Petroleum Hydrocarbons as Gasoline.

TPH-D = Total Petroleum Hydrocarbons as Diesel.

MTBE = Methyl tert-Butyl Ether.

ND = Not Detected.

-- = Not Analyzed.

b = Laboratory analytical report note: TPH-D results consist of both diesel-range and gasoline-range compounds.

c = Laboratory analytical report note: TPH-D results consist of gasoline-range compounds.

* = This column summarizes results for analysis using EPA Method 8260 for non-MTBE fuel oxygenates (TAME, DIPE, ETBE, and TBA) or lead scavengers (EDB, 1,2-DCA/EDC).

** Inorganic lead not detected in sample.

Results in milligrams per liter (mg/L), unless otherwise indicated.

TABLE 2
SUMMARY OF LABORATORY ANALYTICAL RESULTS
Well MW4

Date	TPH-D	TPH-G	MTBE	Benzene	Toluene	Ethyl-benzene	Total Xylenes	Other Fuel Additives by 8260*	
1/17/08			Not Sampled (Free Product Present in Well)						
10/16/07			Not Sampled (Free Product Present in Well)						
07/25/07			Not Sampled (Free Product Present in Well)						
04/17/07			Not Sampled (Free Product Present in Well)						
01/18/07			Not Sampled (Free Product Present in Well)						
11/14/06			Not Sampled (Free Product Present in Well)						
6/29/06	83,a,b	140,a	31	44	13	2.6	19	ND<1.0, except TBA = ND<10	
2/3/06	83,a,b	150,a	22	35	12	3.2	14	ND<0.5, except TBA = 7	
11/18/05			Not Sampled (Free Product Present in Well)						ND<0.5, except TBA = 8.4
7/28/05	94,a,b	130,a	27,+	32	8.9	2.9	14		

NOTES:

TPH-G = Total Petroleum Hydrocarbons as Gasoline.

TPH-D = Total Petroleum Hydrocarbons as Diesel.

MTBE = Methyl tert-Butyl Ether.

ND = Not Detected.

a = Laboratory analytical report note: lighter than water immiscible sheen present on the sample.

b = Laboratory analytical report note: TPH-D results consist of both diesel-range and gasoline-range compounds.

+ = Analyzed by EPA Method 8260.

* = This column summarizes results for analysis using EPA Method 8260 for non-MTBE fuel oxygenates (TAME, DIPE, ETBE, and TBA) or lead scavengers (EDB, 1,2-DCA/EDC).

Results in milligrams per liter (mg/L), unless otherwise indicated.

TABLE 2
SUMMARY OF LABORATORY ANALYTICAL RESULTS
Well MW4 (Continued)

Date	TPH-D	TPH-G	MTBE	Benzene	Toluene	Ethyl-benzene	Total Xylenes	Other Fuel Additives by 8260*
4/13/05			Not Sampled (Free Product Present in Well)					
1/31/05			Not Sampled (Free Product Present in Well)					
10/15/04			Not Sampled (Free Product Present in Well)					
7/13/04			Not Sampled (Free Product Present in Well)					
2/11/04	Free Product sampled. Laboratory fuel fingerprint notes a pattern resembling diesel, with a less significant gasoline-range pattern.							
12/18/03			Not Sampled (Free Product Present in Well)					
9/18/03			Not Sampled (Free Product Present in Well)					
6/26/03			Not Sampled (Free Product Present in Well)					
3/18/03			Not Sampled (Free Product Present in Well)					
12/21/02			Not Sampled (Free Product Present in Well)					
9/10/02			Not Sampled (Free Product Present in Well)					
3/30/02			Not Sampled (Free Product Present in Well)					
12/22/01			Not Sampled (Free Product Present in Well)					
9/23/01			Not Sampled (Free Product Present in Well)					
6/22/01	440,a,b	140	15	35	19	2.0	10	--
4/22/01			Not Sampled (Free Product Present in Well)					
12/14/00			Not Sampled (Free Product Present in Well)					
9/18/00			Not Sampled (Free Product Present in Well)					
6/8/00			Not Sampled (Free Product Present in Well)					
3/9/00	2,100,a,b	130	6.9	35	13	2.1	11	--
12/9/99	9,000,a,b	120	8.1	33	6	2.4	12	--
8/31/99	9.4,b	190	4.4	46	30	2.8	15	--
4/29/99	9.4,b	210	3.2	42	35	2.8	15	--
1/29/99	7.3,b	190	2.4	44	40	3.1	17	--
4/26/98	13,b	190	ND	49	37	3.2	18	--
1/24/98	20,b	200	ND	50	40	3.1	17	--
11/6/97	110,b	160	ND	48	30	2.8	16	--
8/26/97	5.5,b	210	1.7	48	42	3.4	19	--
8/15/97			MW4 Installed					

NOTES:

TPH-G = Total Petroleum Hydrocarbons as Gasoline.

TPH-D = Total Petroleum Hydrocarbons as Diesel.

MTBE = Methyl tert-Butyl Ether.

ND = Not Detected.

-- = Not Analyzed.

a = Laboratory analytical report note: lighter than water immiscible sheen present on the sample.

b = Laboratory analytical report note: TPH-D results consist of both diesel-range and gasoline-range compounds.

+ = Analyzed by EPA Method 8260.

* = This column summarizes results for analysis using EPA Method 8260 for non-MTBE fuel oxygenates (TAME, DIPE, ETBE, and TBA) or lead scavengers (EDB, 1,2-DCA/EDC).

Results in milligrams per liter (mg/L), unless otherwise indicated.

TABLE 2
SUMMARY OF LABORATORY ANALYTICAL RESULTS
Well EW1

Date	TPH-D	TPH-G	MTBE	Benzene	Toluene	Ethyl- benzene	Total Xylenes	Other Fuel Additives by 8260*
1/17/08	13, b	24	16	4.6	1.2	0.52	3.7	ND, except TBA = 19
10/16/07	12, a, b	14, a	8.3	2.6	0.31	0.27	3.0	ND, except TBA = 15
07/25/07	7.7, a, e	11, a	14	3.2	ND<0.025	ND<0.025	2.6	ND, except TBA = 17
04/17/07	5.8, b	21	9.6	3.7	1.4	0.49	1.6	ND<0.1, except TBA = 18
01/18/07	0.93, b	0.93, d	0.60	0.0034	0.0050	ND< 0.0005	0.0041	ND< 0.050, except TBA= 6.8

NOTES:

TPH-G = Total Petroleum Hydrocarbons as Gasoline.

TPH-D = Total Petroleum Hydrocarbons as Diesel.

MTBE = Methyl tert-Butyl Ether.

ND = Not Detected.

-- = Not Analyzed.

a = Laboratory analytical report note: lighter than water immiscible sheen present on the sample.

b = Laboratory analytical report note: TPH-D results consist of both diesel-range and gasoline-range compounds.

c = Laboratory analytical report note: TPH-D results consist of gasoline-range compounds.

d = Laboratory analytical report note: TPH-D results consist of both oil-range and gasoline-range compounds.

e = Laboratory analytical report note: TPH-D results consist of oil-, gas, and diesel-range compounds with no recognizable pattern.

+ = Analyzed by EPA Method 8260.

* = This column summarizes results for analysis using EPA Method 8260 for non-MTBE fuel oxygenates (TAME, DIPE, ETBE, and TBA) or lead scavengers (EDB, 1,2-DCA/EDC).

Results in milligrams per liter (mg/L), unless otherwise indicated.

TABLE 2
 SUMMARY OF LABORATORY ANALYTICAL RESULTS
 Well EW1 (Continued)

Date	TPH-D	TPH-G	MTBE	Benzene	Toluene	Ethyl- benzene	Total Xylenes	Other Fuel Additives by 8260*
11/14/06	1.8, b	0.87, d	0.17	ND<0.025	ND<0.025	ND<0.025	ND<0.025	ND<0.025, except TBA= 5.9, Ethanol ND<2.5, Methanol ND<25.0
6/29/06	0.71,b	0.29	0.021	ND<0.01	ND<0.01	ND<0.01	ND<0.01	ND<0.01, Except TBA = 2.0
2/3/06	1.2,b	0.79	3.1	ND<0.05	ND<0.05	ND<0.05	ND<0.05	ND<0.05, Except TBA = 13
11/18/05	1.2,a	0.9	2	ND<0.05	ND<0.05	ND<0.05	ND<0.05	ND<0.05, Except TBA = 18
7/28/05	1.8,b	1.2	17,+	0.033	0.0051	0.00056	0.0059	ND<0.25, except TBA = 22
4/13/05	2.2,b	0.38	2.7	ND<0.05	ND<0.05	ND<0.05	ND<0.05	ND<0.05, except TBA = 1.6

NOTES:

TPH-G = Total Petroleum Hydrocarbons as Gasoline.

TPH-D = Total Petroleum Hydrocarbons as Diesel.

MTBE = Methyl tert-Butyl Ether.

ND = Not Detected.

-- = Not Analyzed.

+ = Analyzed by EPA Method 8260.

a = Laboratory analytical report note: lighter than water immiscible sheen present on the sample.

b = Laboratory analytical report note: TPH-D results consist of both diesel-range and gasoline-range compounds.

e = Laboratory analytical report note: reporting limit raised due to high MTBE content

* = This column summarizes results for analysis using EPA Method 8260 for non-MTBE fuel oxygenates (TAME, DIPE, ETBE, and TBA) or lead scavengers (EDB, 1,2-DCA/EDC).

Results in milligrams per liter (mg/L), unless otherwise indicated.

TABLE 2
SUMMARY OF LABORATORY ANALYTICAL RESULTS
Well EW1 (Continued)

Date	TPH-D	TPH-G	MTBE	Benzene	Toluene	Ethyl- benzene	Total Xylenes	Other Fuel Additives by 8260*	
1/31/05	3.4,b	1.9	38	ND<1	ND<1	ND<1	ND<1	ND<1, except TBA = 32	
10/15/04	4.1,a,b	ND<5.0,a,e	96	ND<1.7	ND<1.7	ND<1.7	ND<1.7	ND<1.7, except TBA = 97	
7/13/04	3.3,a,b	2.6,a	73	ND<1.2	ND<1.2	ND<1.2	ND<1.2	ND<1.2, except TBA = 40	
4/6/04	3.4,a,b	2.6,a	72	ND<1	ND<1	ND<1	ND<1	ND<1, except TBA = 34	
12/18/03	3.0,b	ND<5.0,e	160	0.22	ND<50	ND<50	0.073	ND<5, except TBA = 64	
9/18/03	8.2,a,b	7.5	220	0.33	ND<0.05	ND<0.05	ND<0.05	ND<2.5, except TBA = 51	
2/23/93	9.6	66	--	14	8.5	1.4	9.8	--	
11/13/92	13	62	--	11	9.2	1.1	9.6	--	
8/92				EW1 Installed					

NOTES:

TPH-G = Total Petroleum Hydrocarbons as Gasoline.

TPH-D = Total Petroleum Hydrocarbons as Diesel.

MTBE = Methyl tert-Butyl Ether.

ND = Not Detected.

-- = Not Analyzed.

+ = Analyzed by EPA Method 8260.

a = Laboratory analytical report note: lighter than water immiscible sheen present on the sample.

b = Laboratory analytical report note: TPH-D results consist of both diesel-range and gasoline-range compounds.

e = Laboratory analytical report note: reporting limit raised due to high MTBE content

* = This column summarizes results for analysis using EPA Method 8260 for non-MTBE fuel oxygenates (TAME, DIPE, ETBE, and TBA) or lead scavengers (EDB, 1,2-DCA/EDC).

Results in milligrams per liter (mg/L), unless otherwise indicated.

TABLE 2
SUMMARY OF LABORATORY ANALYTICAL RESULTS
Well OW1

Date	TPH-D	TPH-G	TPH-MO	Benzene	Toluene	Ethyl-benzene	Total Xylenes	Other Fuel Additives by 8260, including MTBE**
1/17/08	29, a,b	6.9, a, i	8.8	0.48	ND<0.01	0.041	0.023	ND, except TBA = 0.097
10/16/07				No sample recovered				
07/25/07				No sample recovered				
04/17/07				No sample recovered				
01/18/07				No sample recovered				
11/14/06				No sample recovered				
6/29/06	290,b	24	--	--	--	--	--	--
2/3/06	710a,g	31,a	210	--	--	--	--	--
11/18/05	820,b	370	--	0.13	ND<0.025	0.4	0.29	ND<0.025 TBA<0.25
7/28/05	230,a,b	10,a	--	1.3	0.03	0.19	0.072	ND<0.05, TBA ND<0.5
4/13/05	590a,b,d	35,a	--	2	ND<0.05	0.46	0.14	ND<0.05, TBA ND<0.5

NOTES:

TPH-G = Total Petroleum Hydrocarbons as Gasoline.

TPH-D = Total Petroleum Hydrocarbons as Diesel.

MTBE = Methyl tert-Butyl Ether.

ND = Not Detected.

-- = Not Analyzed.

a = Laboratory analytical report note: lighter than water immiscible sheen present on the sample.

b = Laboratory analytical report note: TPH-D results consist of both diesel-range and gasoline-range compounds.

d = Laboratory analytical report note: TPH-D results consist of both oil-range and gasoline-range compounds.

f = Laboratory analytical report note: unmodified or weakly modified gasoline is significant.

g = Fuel oil.

** = This column summarizes results for analysis using EPA Method 8260 for fuel oxygenates (MTBE, TAME, DIPE, ETBE, and TBA) or lead scavengers (EDB, 1,2-DCA/EDC).

Results in milligrams per liter (mg/L), unless otherwise indicated.

TABLE 2
SUMMARY OF LABORATORY ANALYTICAL RESULTS
Well OW1 (Continued)

Date	TPH-D	TPH-G	TPH-MO	Benzene	Toluene	Ethyl- benzene	Total Xylenes	Other Fuel Additives by 8260, including MTBE**
1/31/05				No sample recovered				
10/15/04				No sample recovered				
7/14/04	240,a,b	66,a	ND<0.05	1.8	ND<0.05	1.8	0.056	ND<0.05, TBA ND<0.5
4/6/04	74,a,b	50,a	--	3.1	ND<0.1	0.21	0.14	ND<0.1, TBA ND<1
2/11/04	450,a,b	15,a	130	2.2	0.031	0.16	0.054	ND<0.025, TBA ND<0.25
11/21/03	1,900,a,b	38,f	570	2.0	0.059	0.19	0.095	ND<0.05, TBA ND<0.5
6/10/98				OW1 Installed				

NOTES:

TPH-G = Total Petroleum Hydrocarbons as Gasoline.

TPH-D = Total Petroleum Hydrocarbons as Diesel.

MTBE = Methyl tert-Butyl Ether.

ND = Not Detected.

-- = Not Analyzed.

a = Laboratory analytical report note: lighter than water immiscible sheen present on the sample.

b = Laboratory analytical report note: TPH-D results consist of both diesel-range and gasoline-range compounds.

d = Laboratory analytical report note: TPH-D results consist of both oil-range and gasoline-range compounds.

f = Laboratory analytical report note: unmodified or weakly modified gasoline is significant.

g = Fuel oil.

** = This column summarizes results for analysis using EPA Method 8260 for fuel oxygenates (MTBE, TAME, DIPE, ETBE, and TBA) or lead scavengers (EDB, 1,2-DCA/EDC).

Results in milligrams per liter (mg/L), unless otherwise indicated.

TABLE 2
SUMMARY OF LABORATORY ANALYTICAL RESULTS
Well OW2

Date	TPH-D	TPH-G	TPH-MO	Benzene	Toluene	Ethyl-benzene	Total Xylenes	Other Fuel Additives by 8260, incl. MTBE**
1/17/08	--	0.14	--	ND<0.0005	ND<0.0005	ND<0.0005	ND<0.0005	ND, Except MTBE = 0.0022 TBA = 0.011
10/16/07				No sample recovered				
07/25/07				No sample recovered				
04/17/07				No sample recovered				
01/18/07				No sample recovered				
11/14/06				No sample recovered				
6/29/06				No sample recovered				
2/3/06	0.37,b	0.14,h	ND<0.25	--	--	--	--	--
11/18/05				No sample recovered				
7/28/05				No sample recovered				
4/13/05	0.22,b	0.065	--	ND <0.0005	ND <0.0005	ND <0.0005	ND <0.0005	ND<0.0005, except MTBE = 0.0097

NOTES:

TPH-G = Total Petroleum Hydrocarbons as Gasoline.

TPH-D = Total Petroleum Hydrocarbons as Diesel.

MTBE = Methyl tert-Butyl Ether.

ND = Not Detected.

-- = Not Analyzed.

a = Laboratory analytical report note: lighter than water immiscible sheen present on the sample.

b = Laboratory analytical report note: TPH-D results consist of both diesel-range and gasoline-range compounds.

h = Laboratory analytical report note: heavier gasoline range compounds are significant (aged gasoline?).

* = This column summarizes results for analysis using EPA Method 8260 for fuel oxygenates (MTBE, TAME, DIPE, ETBE, and TBA) or lead scavengers (EDB, 1,2-DCA/EDC).

Results in milligrams per liter (mg/L), unless otherwise indicated.

TABLE 2
SUMMARY OF LABORATORY ANALYTICAL RESULTS
Well OW2 (Continued)

Date	TPH-D	TPH-G	TPH-MO	Benzene	Toluene	Ethyl- benzene	Total Xylenes	Other Fuel Additives by 8260, incl. MTBE**
1/31/05				No sample recovered				
10/15/04				No sample recovered				
07/14/04				No sample recovered				
4/6/04	--	0.069,a	--	ND <0.00062	ND <0.00062	ND <0.00062	ND <0.00062	--
2/11/04	--	0.21	--	ND <0.0005	ND <0.0005	ND <0.0005	ND <0.0005	ND<0.0005, except MTBE = 0.0064 TBA = 0.0070
11/21/03				No sample recovered.				
6/10/98				OW2 Installed				

NOTES:

TPH-G = Total Petroleum Hydrocarbons as Gasoline.

TPH-D = Total Petroleum Hydrocarbons as Diesel.

MTBE = Methyl tert-Butyl Ether.

ND = Not Detected.

-- = Not Analyzed.

a = Laboratory analytical report note: lighter than water immiscible sheen present on the sample.

b = Laboratory analytical report note: TPH-D results consist of both diesel-range and gasoline-range compounds.

h = Laboratory analytical report note: heavier gasoline range compounds are significant (aged gasoline?).

* = This column summarizes results for analysis using EPA Method 8260 for fuel oxygenates (MTBE, TAME, DIPE, ETBE, and TBA) or lead scavengers (EDB, 1,2-DCA/EDC).

Results in milligrams per liter (mg/L), unless otherwise indicated.

FIGURES

P&D ENVIRONMENTAL, INC.

55 Santa Clara Avenue, Suite 240

Oakland, CA 94610

(510) 658-6916

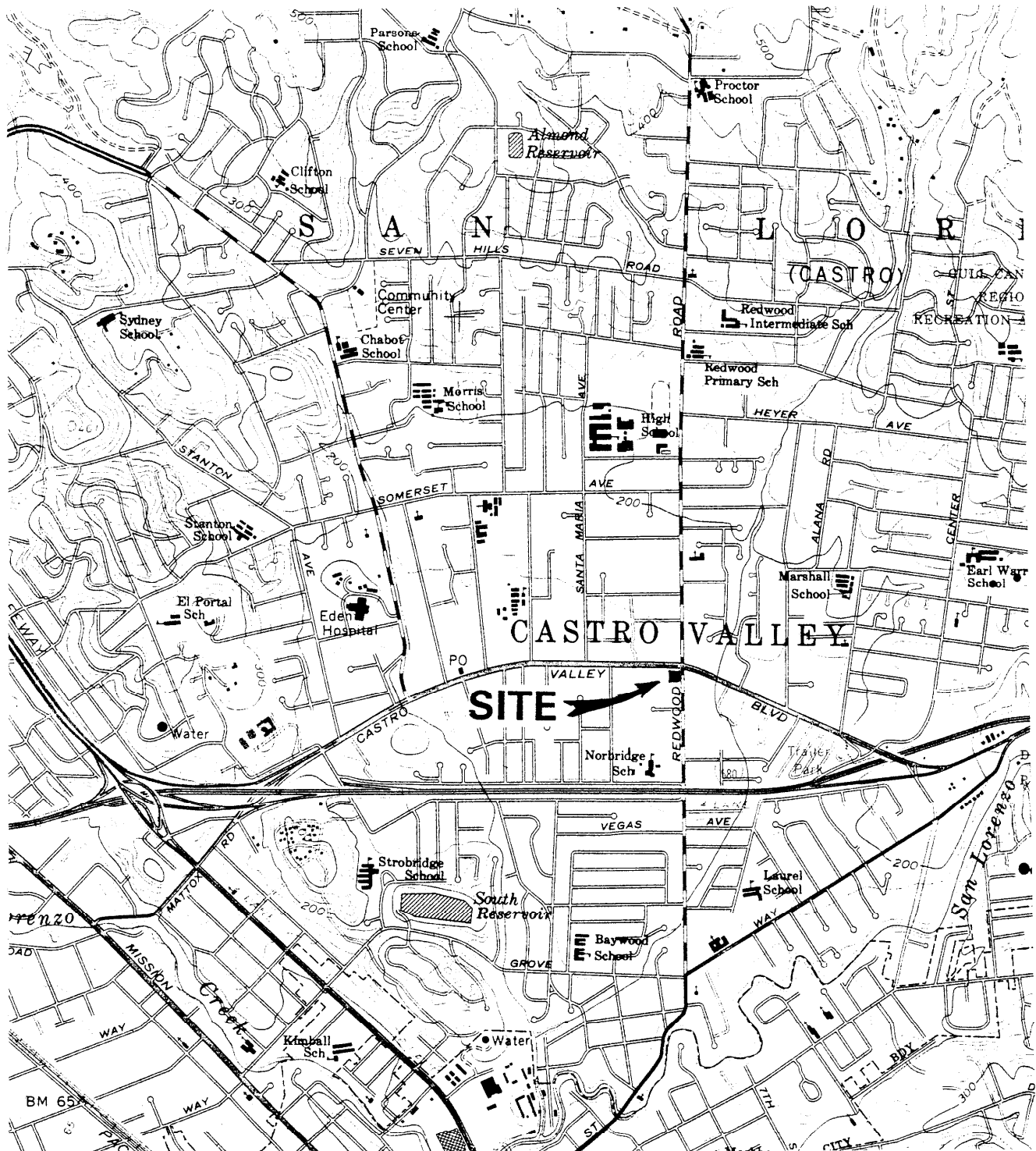

Base Map From:
U.S. Geological Survey
Hayward, Calif.
7.5 Minute Quadrangle
Photorevised 1980

North

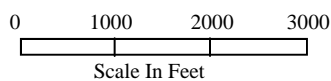
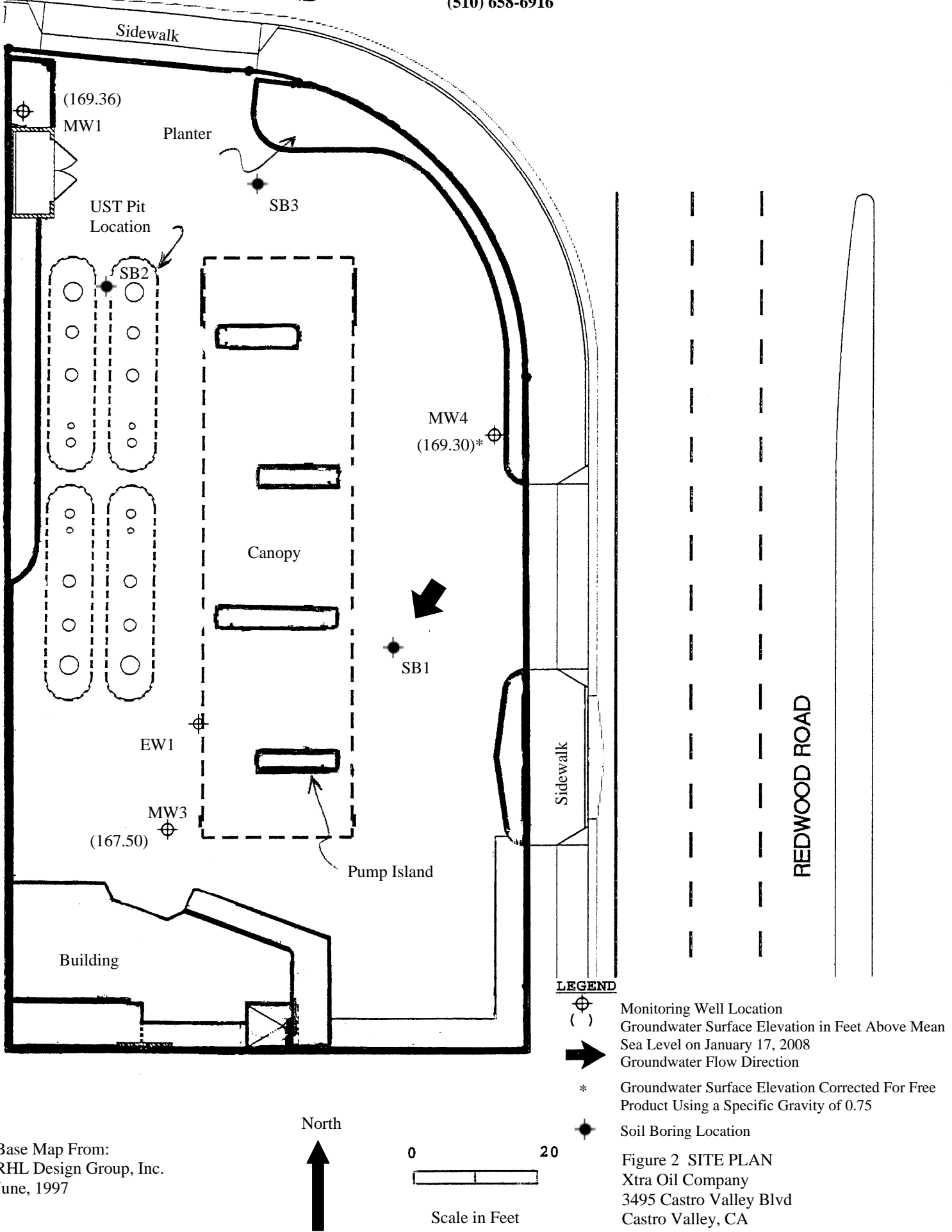

Figure 1
SITE LOCATION MAP
Xtra Oil Company
3495 Castro Valley Blvd.
Castro Valley, California

P&D ENVIRONMENTAL, INC.

55 Santa Clara Avenue, Suite 240
Oakland, CA 94610
(510) 658-6916

CASTRO VALLEY BOULEVARD



Base Map From:
RHL Design Group, Inc.
June, 1997

North

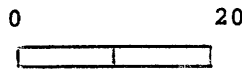

Scale in Feet

LEGEND

- Monitoring Well Location
- Groundwater Surface Elevation in Feet Above Mean Sea Level on January 17, 2008
- Groundwater Flow Direction
- * Groundwater Surface Elevation Corrected For Free Product Using a Specific Gravity of 0.75
- Soil Boring Location

Figure 2 SITE PLAN
Xtra Oil Company
3495 Castro Valley Blvd
Castro Valley, CA

P&D ENVIRONMENTAL, INC.

55 Santa Clara Avenue, Suite 240

Oakland, CA 94610

(510) 658-6916

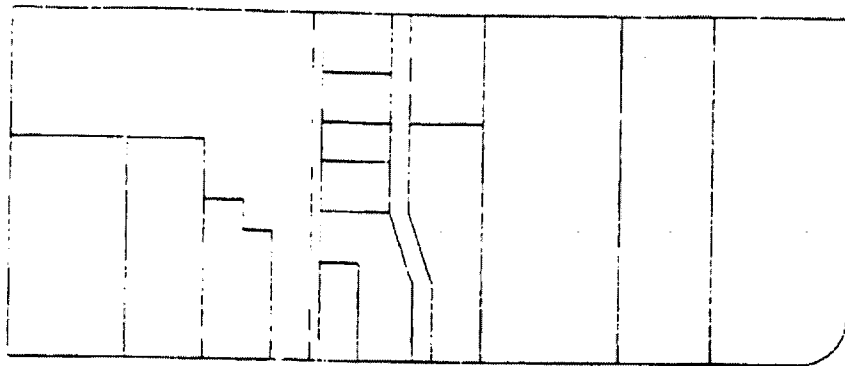

CASTRO VALLEY BOULEVARD

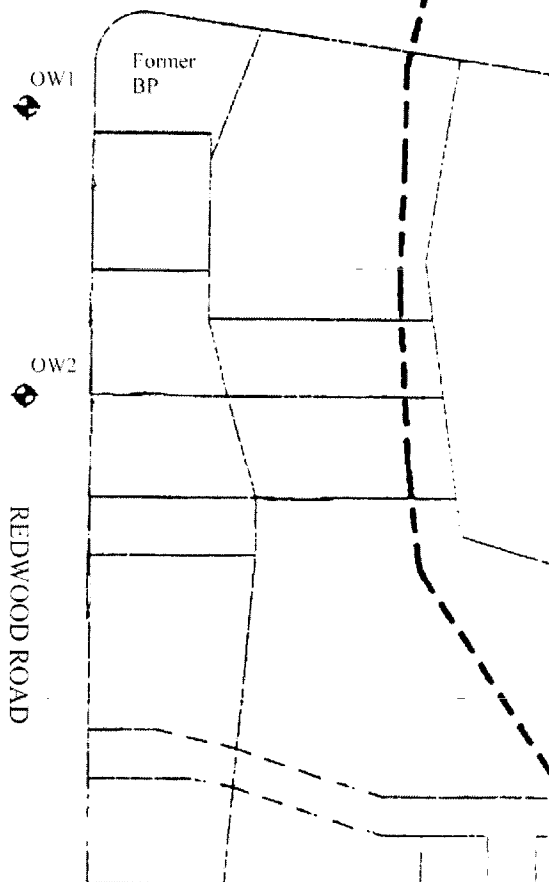
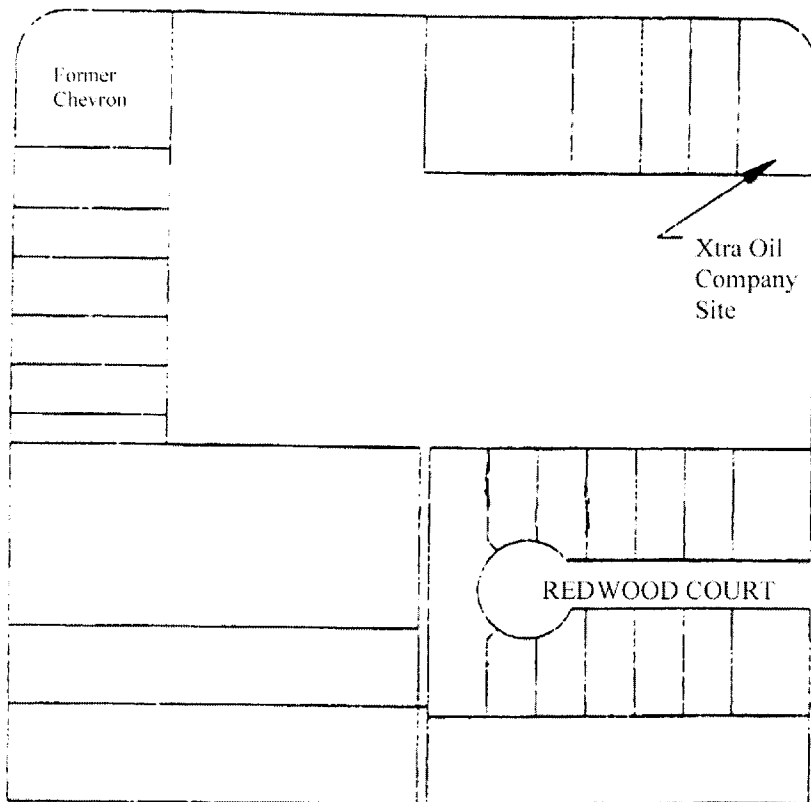
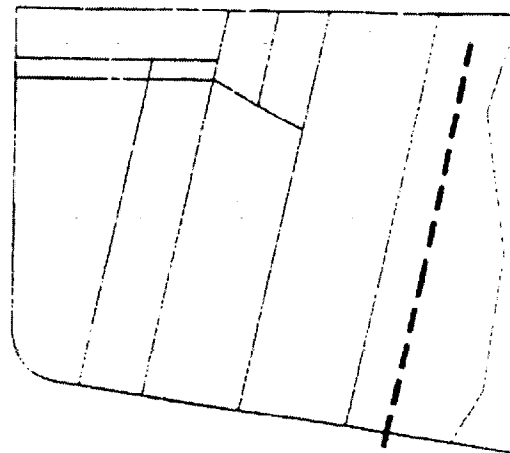

LEGEND



Observation Well Location



Approximate Creek Location

Base Map From:
Castro Valley Sanitation District
Undated



Scale In Feet

North



Figure 3
SITE VICINITY MAP
Xtra Oil Company
3495 Castro Valley Blvd.
Castro Valley, CA

**WELL MONITORING AND
PURGE DATA SHEETS**

1

P&D ENVIRONMENTAL
GROUNDWATER MONITORING/WELL PURGING
DATA SHEET

Site Name Xtra Oil / Castro Valley
Job No. 0014
TOC to Water (ft.) 8.01
Well Depth (ft.) 20.0
Well Diameter 4" (0.641)
Gal./Casing Vol. 7.8

Well No. MW1
Date 1/17/08
Sheen Yes
Free Product Thickness 0
Sample Collection Method Disposable bailer

TIME	GAL. PURGED	DH	TEMPERATURE °F	ELECTRICAL CONDUCTIVITY $\mu S/cm$
1518	2.6	6.90	58.7	915
1522	5.2	6.81	58.6	905 911
1526	7.8	6.73	57.9	902
1530	10.4	6.72	56.9	905
1533	13.0	6.74	57.1	901
1536	15.6	6.72	56.8	907
1539	18.2	6.64	56.5	912
1542	20.8	6.66	56.4	926
	23.4	6.64	56.3	944

NOTES: Some sheen on purge water moderate phos
Sample time @ 1455

(3)

P&D ENVIRONMENTAL
GROUNDWATER MONITORING/WELL PURGING
DATA SHEET

Site Name Xtra Oil / Castro Valley
Job No. 0014
TOC to Water (ft.) 8.90
Well Depth (ft.) 18.6
Well Diameter 4" (0.646)
Gal./Casing Vol. 6.3

Well No. MW3
Date 1/17/08
Sheen No
Free Product Thickness Ø
Sample Collection Method Disposable bailer

3rd = 18.9

TIME	GAL. PURGED	DH	TEMPERATURE	ELECTRICAL CONDUCTIVITY $\mu\text{s/cm}$
1627	2.1	6.57	53.7	1,430
1629	4.2	6.57	53.4	1,662
1633	6.3	6.57	52.8	1,583
1635	8.4	6.55	52.9	1,523
1637	10.5	6.54	52.6	1,499
1639	12.6	6.52	52.6	1,552
1641	14.7	6.42	52.6	1,694
1643	16.8 18.9			

Well diameter @ 14.8 gal/min

NOTES: No sheen, 1+ phos on
sample time @ 1520

Sph ✓

P&D ENVIRONMENTAL
GROUNDWATER MONITORING/WELL PURGING
DATA SHEET

Site Name Xtra Oil/Castro Valley
Job No. 0014
TOC to Water (ft.) 7.05 (corrected) 7.50
Well Depth (ft.) —
Well Diameter 4"
Gal./Casing Vol. N/A

Well No. MW4
Date 1/17/08
Sheen N/A 0.13
Free Product Thickness 0.12
Sample Collection Method No Sample Collected - Sph encountered

TIME GAL. PURGED DH TEMPERATURE ELECTRICAL CONDUCTIVITY

No Sample Collected - Sph encountered

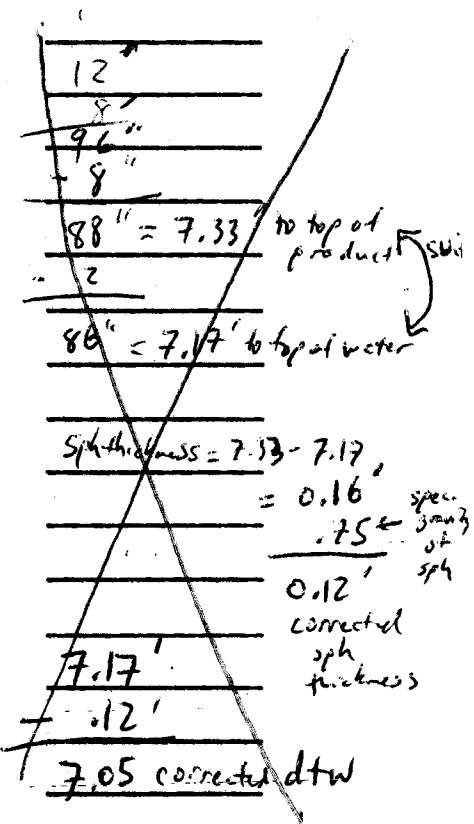
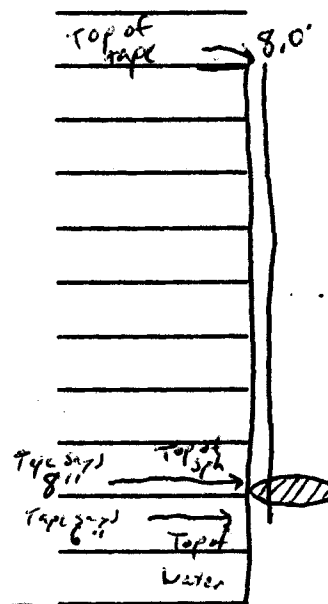

$8' - 8'' = 7.33'$

$8' - 6'' = 7.50'$

FP thickness = $0.17'$

FP correction = $0.17 \times 0.75 = 0.13$

NOTES: corrected water level = $7.50 - 0.13 = 7.37$ ft TOC to H₂O

-PHK

2

P&D ENVIRONMENTAL
GROUNDWATER MONITORING/WELL PURGING
DATA SHEET

Site Name Xtrac. / Castro Valley
Job No. 0014
TOC to Water (ft.) 11.41
Well Depth (ft.) 13.2
Well Diameter 8" (2.584)
Gal./Casing Vol. 4.6

Well No. EW1
Date 1/17/08
Sheen No
Free Product Thickness Ø
Sample Collection Method Disposable bailer

3 vol = 13.8

TIME	GAL. PURGED	DH	TEMPERATURE °F	ELECTRICAL CONDUCTIVITY µs/cm
1602	1.5	6.61	56.5	997
1604	3.0	6.48	56.4	981
1606	4.6	6.49	56.2	954
1608	6.1	6.48	56.3	928
1610	7.6	6.46	56.2	931
1612	9.2	6.46	56.4	925
1614	10.7	6.45	56.7	918
1616	12.2	6.45	56.6	921
1618	13.8	6.45	56.7	916

NOTES: No sheen; lt-mod phc odor
sample time => 1510

P&D ENVIRONMENTAL
GROUNDWATER MONITORING/WELL PURGING
DATA SHEET

Site Name Xtra Oil/Castro Valley
 Job No. 0014
 TOC to Water (ft.) 4.0
 Well Depth (ft.) 7.4
 Well Diameter 1"
 Gal./Casing Vol. NO Purge

Well No. OW1
 Date 1/17/08
 Sheen YES
 Free Product Thickness _____
 Sample Collection Method _____
Vacuum purging PET tubing

<u>TIME</u>	<u>GAL. PURGED</u>	<u>DH</u>	<u>TEMPERATURE</u>	<u>ELECTRICAL CONDUCTIVITY</u>
	<u>No Purge collected 1L + 50ccs</u>			
	<u>Water from well box drained into piezo meter - part of sample</u>			

NOTES: sample time -> 1500hrs Mod pH c. o da

**P&D ENVIRONMENTAL
GROUNDWATER MONITORING/WELL PURGING
DATA SHEET**

Site Name Xtra Oil / Castro Valley Well No. OW 2
 Job No. 0014 Date 1/17/08
 TOC to Water (ft.) No water collected 7.3 Sheen No
 Well Depth (ft.) 7.3 Free Product Thickness _____
 Well Diameter 1 1/2 Sample Collection Method _____
 Gal./Casing Vol. No Purge Vacuum Purge with PE tubing

<u>TIME</u>	<u>GAL. PURGED</u>	<u>pH</u>	<u>TEMPERATURE</u>	<u>ELECTRICAL CONDUCTIVITY</u>
		<u>SPH</u>		
	<u>No Purge - collected 5 vars</u>			

NOTES: No sheen - no pH or odor
Sample time = 1445

**LABORATORY REPORTS
AND CHAIN OF CUSTODY
DOCUMENTATION**



McC Campbell Analytical, Inc.

"When Quality Counts"

1534 Willow Pass Road, Pittsburg, CA 94565-1701
Web: www.mcccampbell.com E-mail: main@mcccampbell.com
Telephone: 877-252-9262 Fax: 925-252-9269

P & D Environmental 55 Santa Clara, Ste.240 Oakland, CA 94610	Client Project ID: #0014; Xtra Oil/Castro Valley	Date Sampled: 01/17/08
	Client Contact: Steve Carmack	Date Received: 01/18/08
	Client P.O.:	Date Reported: 01/28/08
		Date Completed: 01/28/08

WorkOrder: 0801484

January 28, 2008

Dear Steve:

Enclosed within are:

- 1) The results of the 5 analyzed samples from your project: **#0014; Xtra Oil/Castro Valley,**
- 2) A QC report for the above samples,
- 3) A copy of the chain of custody, and
- 4) An invoice for analytical services.

All analyses were completed satisfactorily and all QC samples were found to be within our control limits.

If you have any questions or concerns, please feel free to give me a call. Thank you for choosing

McC Campbell Analytical Laboratories for your analytical needs.

Best regards,

Angela Rydelius
Laboratory Manager
McC Campbell Analytical, Inc.

pdco 0801484

P & D ENVIRONMENTAL, INC.
 55 Santa Clara Ave, Suite 240
 Oakland, CA 94610
 (510) 658-6916

CHAIN OF CUSTODY RECORD

YS + Pb analysis

PROJECT NUMBER: <u>0014</u>		PROJECT NAME: <u>Xtra Oil/ Castro Valley</u>			NUMBER OF CONTAINERS	ANALYSIS(ES):				PRESERVATIVE	REMARKS
SAMPLED BY: (PRINTED AND SIGNATURE) <u>Steve Carmack</u>						<u>TPH/Mk/Hexane</u>	<u>MBTEX, including</u>				
SAMPLE NUMBER	DATE	TIME	TYPE	SAMPLE LOCATION							
<u>MW1</u>	<u>1/17/08</u>	<u>1455</u>	<u>Water</u>	<u>1655 hrs</u>	<u>7</u>	<u>X</u>	<u>X</u>			<u>ICE</u>	<u>Normal Turnaround Time</u>
<u>MWS</u>		<u>1710</u>			<u>7</u>	<u>X</u>	<u>X</u>				
<u>EW1</u>		<u>1720</u>			<u>7</u>	<u>X</u>	<u>X</u>				
<u>OW1</u>		<u>1500</u>	<u>1445</u>		<u>6</u>	<u>X</u>	<u>X</u>				
<u>OW2</u>		<u>1445</u>	<u>1500</u>		<u>5</u>	<u>X</u>	<u>X</u>				
ICE / I* <input type="checkbox"/> GOOD CONDITION <input type="checkbox"/> APPROPRIATE HEAD SPACE ABSENT <input type="checkbox"/> CONTAINERS DECHLORINATED IN LAB <input type="checkbox"/> PRESERVED IN LAB <input type="checkbox"/> PRESERVATION <input type="checkbox"/> VOAS <input type="checkbox"/> O & G <input type="checkbox"/> METALS <input type="checkbox"/> OTHER <input type="checkbox"/>											
RELINQUISHED BY: (SIGNATURE) <u>[Signature]</u>		DATE <u>1/18/08</u>	TIME <u>2:55</u>	RECEIVED BY: (SIGNATURE) <u>[Signature]</u>		TOTAL NO. OF SAMPLES (THIS SHIPMENT) <u>5</u>		LABORATORY: <u>McCampbell Analytical</u>			
RELINQUISHED BY: (SIGNATURE) <u>[Signature]</u>		DATE <u>1/18/08</u>	TIME <u>9:10</u>	RECEIVED BY: (SIGNATURE) <u>[Signature]</u>		TOTAL NO. OF CONTAINERS (THIS SHIPMENT) <u>32</u>		LABORATORY CONTACT: <u>Angela Rydelin</u> LABORATORY PHONE NUMBER: <u>(877) 352-9262</u>			
RELINQUISHED BY: (SIGNATURE) <u>[Signature]</u>		DATE	TIME	RECEIVED FOR LABORATORY BY: (SIGNATURE)		SAMPLE ANALYSIS REQUEST SHEET ATTACHED: () YES (X) NO					
Results and billing to: P&D Environmental, Inc. lab@pdenviro.com <u>+ billing to Xtraoil</u>				REMARKS: <u>All preserved w/ HCL except bottom round canisters (narrow necked)</u>							

McC Campbell Analytical, Inc.



1534 Willow Pass Rd
 Pittsburg, CA 94565-1701
 (925) 252-9262

CHAIN-OF-CUSTODY RECORD

WorkOrder: 0801484

ClientID: PDEO

EDF Excel Fax Email HardCopy ThirdParty

Report to:

Steve Carmack
 P & D Environmental
 55 Santa Clara, Ste.240
 Oakland, CA 94610

Email: lab@pdenviro.com
 TEL: (510) 658-6916 FAX: 510-834-0152
 ProjectNo: #0014; Xtra Oil/Castro Valley
 PO:

Bill to:

Accounts Payable
 Xtra Oil Company
 2307 Pacific Avenue
 Oakland, CA 94501
 constanza.rodriquez@pdenviro.com

Requested TAT: 5 days

Date Received: 01/18/2008

Date Printed: 01/28/2008

Sample ID	ClientSampID	Matrix	Collection Date	Hold	Requested Tests (See legend below)												
					1	2	3	4	5	6	7	8	9	10	11	12	
0801484-001	MW1	Water	01/17/08 4:55:00	<input type="checkbox"/>	A	B											
0801484-002	MW3	Water	01/17/08 5:10:00	<input type="checkbox"/>	A	B											
0801484-003	EW1	Water	01/17/08 5:20:00	<input type="checkbox"/>	A	B											
0801484-004	OW1	Water	01/17/08 3:00:00	<input type="checkbox"/>	A	B											
0801484-005	OW2	Water	01/17/08 2:45:00	<input type="checkbox"/>	A	B											

Test Legend:

1	G-MBTEX_W	2	MBTEXOXY-8260B_W	3		4		5	
6		7		8		9		10	
11		12							

The following SampIDs: 001A, 002A, 003A, 004A, 005A contain testgroup.

Prepared by: Melissa Valles

Comments:

NOTE: Samples are discarded 60 days after results are reported unless other arrangements are made. Hazardous samples will be returned to client or disposed of at client expense.



Sample Receipt Checklist

Client Name: **P & D Environmental**

Date and Time Received: **1/18/08 6:01:26 PM**

Project Name: **#0014; Xtra Oil/Castro Valley**

Checklist completed and reviewed by: **Melissa Valles**

WorkOrder N°: **0801484** Matrix Water

Carrier: Rob Pringle (MAI Courier)

Chain of Custody (COC) Information

- Chain of custody present? Yes No
- Chain of custody signed when relinquished and received? Yes No
- Chain of custody agrees with sample labels? Yes No
- Sample IDs noted by Client on COC? Yes No
- Date and Time of collection noted by Client on COC? Yes No
- Sampler's name noted on COC? Yes No

Sample Receipt Information

- Custody seals intact on shipping container/cooler? Yes No NA
- Shipping container/cooler in good condition? Yes No
- Samples in proper containers/bottles? Yes No
- Sample containers intact? Yes No
- Sufficient sample volume for indicated test? Yes No

Sample Preservation and Hold Time (HT) Information

- All samples received within holding time? Yes No
- Container/Temp Blank temperature Cooler Temp: 4.4°C NA
- Water - VOA vials have zero headspace / no bubbles? Yes No No VOA vials submitted
- Sample labels checked for correct preservation? Yes No
- TTLC Metal - pH acceptable upon receipt (pH<2)? Yes No NA

Client contacted:

Date contacted:

Contacted by:

Comments:



McC Campbell Analytical, Inc.

"When Quality Counts"

1534 Willow Pass Road, Pittsburg, CA 94565-1701
Web: www.mcccampbell.com E-mail: main@mcccampbell.com
Telephone: 877-252-9262 Fax: 925-252-9269

P & D Environmental 55 Santa Clara, Ste.240 Oakland, CA 94610	Client Project ID: #0014; Xtra Oil/Castro Valley	Date Sampled: 01/17/08
	Client Contact: Steve Carmack	Date Received: 01/18/08
	Client P.O.:	Date Extracted: 01/22/08-01/23/08
		Date Analyzed 01/22/08-01/23/08

Gasoline Range (C6-C12) Volatile Hydrocarbons as Gasoline*

Extraction method SW5030B

Analytical methods SW8015Cm

Work Order: 0801484

Lab ID	Client ID	Matrix	TPH(g)	DF	% SS
001A	MW1	W	22,000,a	10	110
002A	MW3	W	110,000,a,h	50	90
003A	EW1	W	24,000,a	20	99
004A	OW1	W	6900,a,g,h	5	102
005A	OW2	W	140,m	1	108

Reporting Limit for DF =1; ND means not detected at or above the reporting limit	W	50	µg/L
	S	NA	NA

* water and vapor samples and all TCLP & SPLP extracts are reported in ug/L, soil/sludge/solid samples in mg/kg, wipe samples in µg/wipe, product/oil/non-aqueous liquid samples in mg/L.

cluttered chromatogram; sample peak coelutes with surrogate peak.

+The following descriptions of the TPH chromatogram are cursory in nature and McC Campbell Analytical is not responsible for their interpretation: a) unmodified or weakly modified gasoline is significant; b) heavier gasoline range compounds are significant(aged gasoline?); c) lighter gasoline range compounds (the most mobile fraction) are significant; d) gasoline range compounds having broad chromatographic peaks are significant; biologically altered gasoline?; e) TPH pattern that does not appear to be derived from gasoline (stoddard solvent / mineral spirit?); f) one to a few isolated non-target peaks present; g) strongly aged gasoline or diesel range compounds are significant; h) lighter than water immiscible sheen/product is present; i) liquid sample that contains greater than ~1 vol. % sediment; j) reporting limit raised due to high MTBE content; k) TPH pattern that does not appear to be derived from gasoline (aviation gas). m) no recognizable pattern; n) TPH(g) range non-target isolated peaks subtracted out of the TPH(g) concentration at the client's request; p) see attached narrative.



McC Campbell Analytical, Inc.

"When Quality Counts"

1534 Willow Pass Road, Pittsburg, CA 94565-1701
Web: www.mcccampbell.com E-mail: main@mcccampbell.com
Telephone: 877-252-9262 Fax: 925-252-9269

P & D Environmental 55 Santa Clara, Ste.240 Oakland, CA 94610	Client Project ID: #0014; Xtra Oil/Castro Valley	Date Sampled: 01/17/08
	Client Contact: Steve Carmack	Date Received: 01/18/08
	Client P.O.:	Date Extracted: 01/19/08-01/23/08
		Date Analyzed: 01/19/08-01/23/08

Oxygenates and BTEX by GC/MS*

Extraction Method: SW5030B

Analytical Method: SW8260B

Work Order: 0801484

Lab ID	0801484-001B	0801484-002B	0801484-003B	0801484-004B	Reporting Limit for DF =1	
Client ID	MW1	MW3	EW1	OW1		
Matrix	W	W	W	W		
DF	100	1000	500	20		

Compound	Concentration				ug/kg	ug/L
tert-Amyl methyl ether (TAME)	ND<50	ND<500	ND<250	ND<10	NA	0.5
Benzene	310	34,000	4600	480	NA	0.5
t-Butyl alcohol (TBA)	ND<200	8000	19,000	97	NA	2.0
1,2-Dibromoethane (EDB)	ND<50	ND<500	ND<250	ND<10	NA	0.5
1,2-Dichloroethane (1,2-DCA)	ND<50	ND<500	ND<250	ND<10	NA	0.5
Diisopropyl ether (DIPE)	ND<50	ND<500	ND<250	ND<10	NA	0.5
Ethylbenzene	1200	2500	520	41	NA	0.5
Ethyl tert-butyl ether (ETBE)	ND<50	ND<500	ND<250	ND<10	NA	0.5
Methyl-t-butyl ether (MTBE)	74	9300	16,000	ND<10	NA	0.5
Toluene	220	ND<500	1200	ND<10	NA	0.5
Xylenes	1700	9500	3700	23	NA	0.5

Surrogate Recoveries (%)

%SS1:	102	96	97	103	
%SS2:	99	94	95	100	
%SS3:	103	105	106	103	
Comments		h		h	

* water and vapor samples are reported in µg/L, soil/sludge/solid samples in mg/kg, product/oil/non-aqueous liquid samples and all TCLP & SPLP extracts are reported in mg/L, wipe samples in µg/wipe.

ND means not detected above the reporting limit; N/A means analyte not applicable to this analysis.

surrogate diluted out of range or coelutes with another peak; &) low surrogate due to matrix interference.

h) lighter than water immiscible sheen/product is present; i) liquid sample that contains greater than ~1 vol. % sediment; j) sample diluted due to high organic content/matrix interference; k) reporting limit near, but not identical to our standard reporting limit due to variable Encore sample weight; m) reporting limit raised due to insufficient sample amount; n) results are reported on a dry weight basis; p) see attached narrative.



McC Campbell Analytical, Inc.

"When Quality Counts"

1534 Willow Pass Road, Pittsburg, CA 94565-1701
Web: www.mcccampbell.com E-mail: main@mcccampbell.com
Telephone: 877-252-9262 Fax: 925-252-9269

P & D Environmental 55 Santa Clara, Ste.240 Oakland, CA 94610	Client Project ID: #0014; Xtra Oil/Castro Valley	Date Sampled: 01/17/08
	Client Contact: Steve Carmack	Date Received: 01/18/08
	Client P.O.:	Date Extracted: 01/19/08-01/23/08
		Date Analyzed: 01/19/08-01/23/08

Oxygenates and BTEX by GC/MS*

Extraction Method: SW5030B

Analytical Method: SW8260B

Work Order: 0801484

Lab ID	0801484-005B				Reporting Limit for DF =1
Client ID	OW2				
Matrix	W				
DF	1				

Compound	Concentration				ug/kg	ug/L
	tert-Amyl methyl ether (TAME)	ND				NA
Benzene	ND				NA	0.5
t-Butyl alcohol (TBA)	11				NA	2.0
1,2-Dibromoethane (EDB)	ND				NA	0.5
1,2-Dichloroethane (1,2-DCA)	ND				NA	0.5
Diisopropyl ether (DIPE)	ND				NA	0.5
Ethylbenzene	ND				NA	0.5
Ethyl tert-butyl ether (ETBE)	ND				NA	0.5
Methyl-t-butyl ether (MTBE)	2.2				NA	0.5
Toluene	ND				NA	0.5
Xylenes	ND				NA	0.5

Surrogate Recoveries (%)

%SS1:	113			
%SS2:	80			
%SS3:	103			

Comments

* water and vapor samples are reported in µg/L, soil/sludge/solid samples in mg/kg, product/oil/non-aqueous liquid samples and all TCLP & SPLP extracts are reported in mg/L, wipe samples in µg/wipe.

ND means not detected above the reporting limit; N/A means analyte not applicable to this analysis.

surrogate diluted out of range or coelutes with another peak; &) low surrogate due to matrix interference.

h) lighter than water immiscible sheen/product is present; i) liquid sample that contains greater than ~1 vol. % sediment; j) sample diluted due to high organic content/matrix interference; k) reporting limit near, but not identical to our standard reporting limit due to variable Encore sample weight; m) reporting limit raised due to insufficient sample amount; n) results are reported on a dry weight basis; p) see attached narrative.



McC Campbell Analytical, Inc.

"When Quality Counts"

1534 Willow Pass Road, Pittsburg, CA 94565-1701
Web: www.mcccampbell.com E-mail: main@mcccampbell.com
Telephone: 877-252-9262 Fax: 925-252-9269

P & D Environmental 55 Santa Clara, Ste.240 Oakland, CA 94610	Client Project ID: #0014; Xtra Oil/Castro Valley	Date Sampled: 01/17/08
	Client Contact: Steve Carmack	Date Received: 01/18/08
	Client P.O.:	Date Analyzed 01/18/08-01/23/08
		Date Extracted: 01/18/08

Diesel (C10-23) and Oil (C18+) Range Extractable Hydrocarbons as Diesel and Motor Oil*

Extraction method: SW3510C

Analytical methods: SW8015C

Work Order: 0801484

Lab ID	Client ID	Matrix	TPH(d)	TPH(mo)	DF	% SS
0801484-001A	MW1	W	3800,d,b	ND	1	107
0801484-002A	MW3	W	9900,d,a,h	1700	1	108
0801484-003A	EW1	W	13,000,a,d	4600	10	98
0801484-004A	OW1	W	29,000,a,d,h	8800	10	117
0801484-005A	OW2	W	330,d,b,g	270	1	102

Reporting Limit for DF =1; ND means not detected at or above the reporting limit	W	50	250	µg/L
	S	NA	NA	mg/Kg

* water samples are reported in µg/L, wipe samples in µg/wipe, soil/solid/sludge samples in mg/kg, product/oil/non-aqueous liquid samples in mg/L, and all DISTLC / STLC / SPLP / TCLP extracts are reported in µg/L.

cluttered chromatogram resulting in coeluted surrogate and sample peaks, or; surrogate peak is on elevated baseline, or; surrogate has been diminished by dilution of original extract.

+The following descriptions of the TPH chromatogram are cursory in nature and McC Campbell Analytical is not responsible for their interpretation: a) unmodified or weakly modified diesel is significant; b) diesel range compounds are significant; no recognizable pattern; c) aged diesel? is significant; d) gasoline range compounds are significant; e) unknown medium boiling point pattern that does not appear to be derived from diesel; f) one to a few isolated peaks present; g) oil range compounds are significant (cooking oil?); h) lighter than water immiscible sheen/product is present; i) liquid sample that contains greater than ~1 vol. % sediment; k) kerosene/kerosene range; l) bunker oil range (?); no recognizable pattern; m) fuel oil; n) stoddard solvent/mineral spirits; p) see attached narrative.



QC SUMMARY REPORT FOR SW8021B/8015Cm

W.O. Sample Matrix: Water

QC Matrix: Water

WorkOrder 0801484

Analyte	EPA Method SW8015Cm		Extraction SW5030B			BatchID: 33276			Spiked Sample ID: 0801476-004A			
	Sample	Spiked	MS	MSD	MS-MSD	LCS	LCSD	LCS-LCSD	Acceptance Criteria (%)			
	µg/L	µg/L	% Rec.	% Rec.	% RPD	% Rec.	% Rec.	% RPD	MS / MSD	RPD	LCS/LCSD	RPD
TPH(btex)£	ND	60	108	99.7	8.13	122	118	3.17	70 - 130	30	70 - 130	30
MTBE	ND	10	107	111	3.64	94.4	96.7	2.41	70 - 130	30	70 - 130	30
Benzene	ND	10	97.8	101	3.48	95.2	96.8	1.63	70 - 130	30	70 - 130	30
Toluene	ND	10	98.2	100	2.25	94.5	96.3	1.84	70 - 130	30	70 - 130	30
Ethylbenzene	ND	10	102	103	1.63	97.4	101	3.72	70 - 130	30	70 - 130	30
Xylenes	ND	30	110	110	0	110	110	0	70 - 130	30	70 - 130	30
%SS:	92	10	92	95	2.73	90	92	1.94	70 - 130	30	70 - 130	30

All target compounds in the Method Blank of this extraction batch were ND less than the method RL with the following exceptions:
NONE

BATCH 33276 SUMMARY

Sample ID	Date Sampled	Date Extracted	Date Analyzed	Sample ID	Date Sampled	Date Extracted	Date Analyzed
0801484-001A	01/17/08 4:55 PM	01/22/08	01/22/08 11:36 AM	0801484-002A	01/17/08 5:10 PM	01/22/08	01/22/08 12:06 PM
0801484-002A	01/17/08 5:10 PM	01/23/08	01/23/08 7:43 PM	0801484-003A	01/17/08 5:20 PM	01/22/08	01/22/08 12:36 PM
0801484-003A	01/17/08 5:20 PM	01/23/08	01/23/08 9:13 PM	0801484-004A	01/17/08 3:00 PM	01/23/08	01/23/08 9:44 PM
0801484-005A	01/17/08 2:45 PM	01/22/08	01/22/08 1:37 PM				

MS = Matrix Spike; MSD = Matrix Spike Duplicate; LCS = Laboratory Control Sample; LCSD = Laboratory Control Sample Duplicate; RPD = Relative Percent Deviation.

% Recovery = 100 * (MS-Sample) / (Amount Spiked); RPD = 100 * (MS - MSD) / ((MS + MSD) / 2).

MS / MSD spike recoveries and / or %RPD may fall outside of laboratory acceptance criteria due to one or more of the following reasons: a) the sample is inhomogenous AND contains significant concentrations of analyte relative to the amount spiked, or b) the spiked sample's matrix interferes with the spike recovery.

£ TPH(btex) = sum of BTEX areas from the FID.

cluttered chromatogram; sample peak coelutes with surrogate peak.



QC SUMMARY REPORT FOR SW8015C

W.O. Sample Matrix: Water

QC Matrix: Water

WorkOrder 0801484

EPA Method SW8015C		Extraction SW3510C			BatchID: 33280			Spiked Sample ID: N/A				
Analyte	Sample	Spiked	MS	MSD	MS-MSD	LCS	LCSD	LCS-LCSD	Acceptance Criteria (%)			
	µg/L	µg/L	% Rec.	% Rec.	% RPD	% Rec.	% Rec.	% RPD	MS / MSD	RPD	LCS/LCSD	RPD
TPH(d)	N/A	1000	N/A	N/A	N/A	117	120	2.43	N/A	N/A	70 - 130	30
%SS:	N/A	2500	N/A	N/A	N/A	111	112	1.07	N/A	N/A	70 - 130	30

All target compounds in the Method Blank of this extraction batch were ND less than the method RL with the following exceptions:
NONE

BATCH 33280 SUMMARY

Sample ID	Date Sampled	Date Extracted	Date Analyzed	Sample ID	Date Sampled	Date Extracted	Date Analyzed
0801484-001A	01/17/08 4:55 PM	01/18/08	01/18/08 10:15 PM	0801484-002A	01/17/08 5:10 PM	01/18/08	01/18/08 11:23 PM
0801484-003A	01/17/08 5:20 PM	01/18/08	01/22/08 4:27 PM	0801484-004A	01/17/08 3:00 PM	01/18/08	01/23/08 4:58 PM
0801484-005A	01/17/08 2:45 PM	01/18/08	01/22/08 6:44 PM				

MS = Matrix Spike; MSD = Matrix Spike Duplicate; LCS = Laboratory Control Sample; LCSD = Laboratory Control Sample Duplicate; RPD = Relative Percent Deviation.

% Recovery = 100 * (MS-Sample) / (Amount Spiked); RPD = 100 * (MS - MSD) / ((MS + MSD) / 2).

MS / MSD spike recoveries and / or %RPD may fall outside of laboratory acceptance criteria due to one or more of the following reasons: a) the sample is inhomogenous AND contains significant concentrations of analyte relative to the amount spiked, or b) the spiked sample's matrix interferes with the spike recovery.

N/A = not enough sample to perform matrix spike and matrix spike duplicate.

NR = analyte concentration in sample exceeds spike amount for soil matrix or exceeds 2x spike amount for water matrix or sample diluted due to high matrix or analyte content.



QC SUMMARY REPORT FOR SW8260B

W.O. Sample Matrix: Water

QC Matrix: Water

WorkOrder 0801484

Analyte	EPA Method SW8260B		Extraction SW5030B			BatchID: 33281			Spiked Sample ID: 0801474-005B			
	Sample	Spiked	MS	MSD	MS-MSD	LCS	LCSD	LCS-LCSD	Acceptance Criteria (%)			
	µg/L	µg/L	% Rec.	% Rec.	% RPD	% Rec.	% Rec.	% RPD	MS / MSD	RPD	LCS/LCSD	RPD
tert-Amyl methyl ether (TAME)	ND	10	111	111	0	113	112	0.817	70 - 130	30	70 - 130	30
Benzene	ND	10	96.9	96.6	0.316	101	103	1.61	70 - 130	30	70 - 130	30
t-Butyl alcohol (TBA)	ND	50	80.1	81.4	1.55	86.4	84.2	2.63	70 - 130	30	70 - 130	30
1,2-Dibromoethane (EDB)	ND	10	98.3	96.3	2.01	102	101	0.492	70 - 130	30	70 - 130	30
1,2-Dichloroethane (1,2-DCA)	ND	10	124	126	0.979	120	123	3.06	70 - 130	30	70 - 130	30
Diisopropyl ether (DIPE)	ND	10	109	110	0.234	110	112	1.52	70 - 130	30	70 - 130	30
Ethyl tert-butyl ether (ETBE)	ND	10	108	107	1.66	108	107	0.207	70 - 130	30	70 - 130	30
Methyl-t-butyl ether (MTBE)	ND	10	115	114	0.825	115	116	0.936	70 - 130	30	70 - 130	30
Toluene	ND	10	85.2	85	0.204	91.3	91.1	0.252	70 - 130	30	70 - 130	30
%SS1:	105	10	116	115	0.628	111	108	2.33	70 - 130	30	70 - 130	30
%SS2:	99	10	96	96	0	95	95	0	70 - 130	30	70 - 130	30
%SS3:	100	10	100	102	1.19	101	100	0.653	70 - 130	30	70 - 130	30

All target compounds in the Method Blank of this extraction batch were ND less than the method RL with the following exceptions:
NONE

BATCH 33281 SUMMARY

Sample ID	Date Sampled	Date Extracted	Date Analyzed	Sample ID	Date Sampled	Date Extracted	Date Analyzed
0801484-001B	01/17/08 4:55 PM	01/19/08	01/19/08 2:47 AM	0801484-002B	01/17/08 5:10 PM	01/22/08	01/22/08 6:54 PM
0801484-003B	01/17/08 5:20 PM	01/22/08	01/22/08 7:38 PM	0801484-004B	01/17/08 3:00 PM	01/23/08	01/23/08 10:47 AM
0801484-005B	01/17/08 2:45 PM	01/19/08	01/19/08 7:12 AM				

MS = Matrix Spike; MSD = Matrix Spike Duplicate; LCS = Laboratory Control Sample; LCSD = Laboratory Control Sample Duplicate; RPD = Relative Percent Deviation.

% Recovery = 100 * (MS-Sample) / (Amount Spiked); RPD = 100 * (MS - MSD) / ((MS + MSD) / 2).

MS / MSD spike recoveries and / or %RPD may fall outside of laboratory acceptance criteria due to one or more of the following reasons: a) the sample is inhomogenous AND contains significant concentrations of analyte relative to the amount spiked, or b) the spiked sample's matrix interferes with the spike recovery.

N/A = not enough sample to perform matrix spike and matrix spike duplicate.

NR = analyte concentration in sample exceeds spike amount for soil matrix or exceeds 2x spike amount for water matrix or sample diluted due to high matrix or analyte content.

APPENDIX A

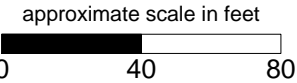
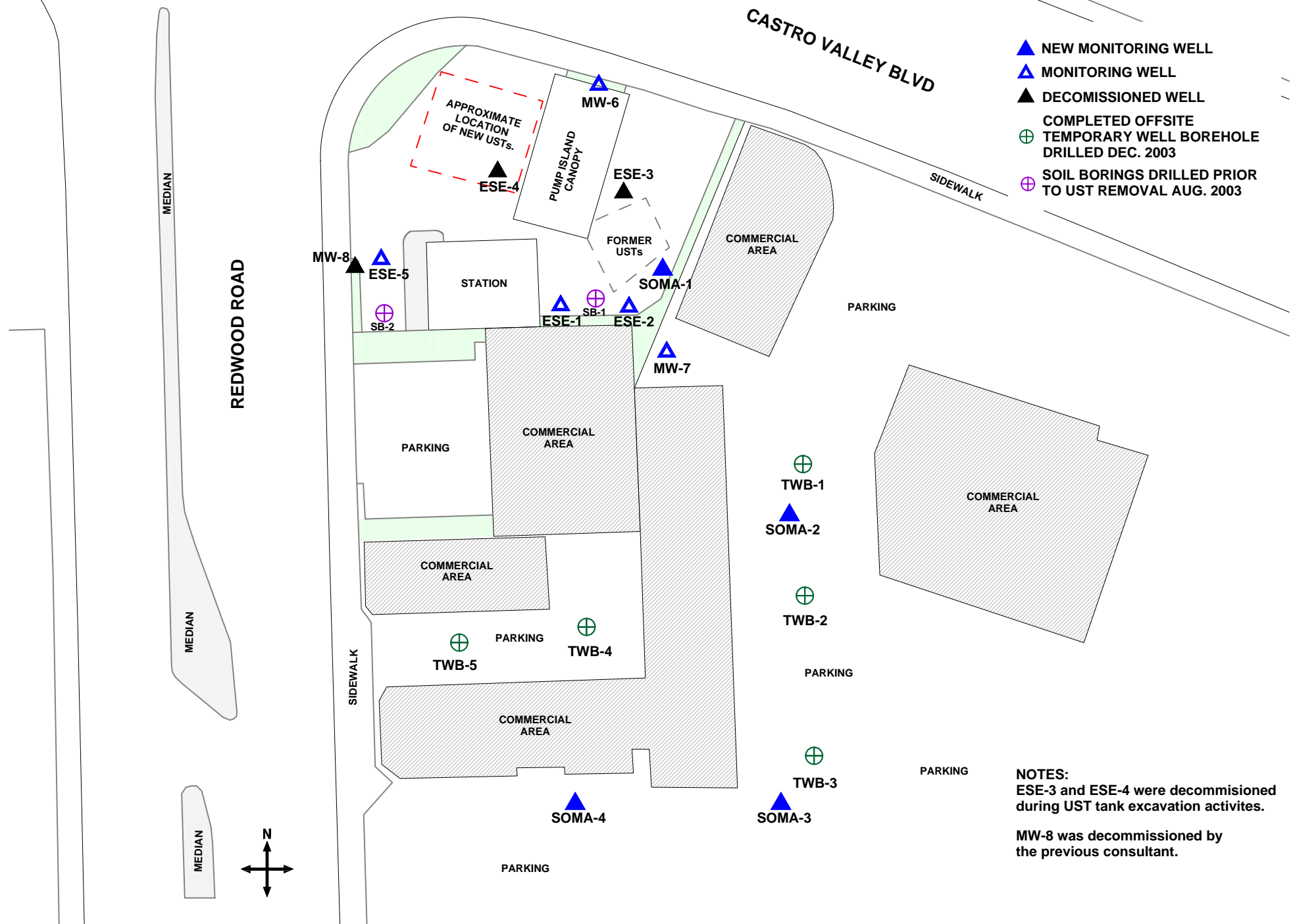

Figure 2: Site map showing locations of existing monitoring wells, decommissioned wells, offsite temporary well boreholes, and monitoring wells installed by SOMA.



Table 1
Historical Groundwater Elevations & Analytical Data
TPH-g, BTEX, MtBE
3519 Castro Valley Blvd, Castro Valley, CA

Monitoring Well	Date	Top of casing elevation ¹ (feet)	Depth to Groundwater (feet)	Groundwater Elevation (feet)	TPH-g (µg/L)	Benzene (µg/L)	Toluene (µg/L)	Ethyl benzene (µg/L)	Total Xylenes (µg/L)	MtBE (µg/L) 8260B
ESE-1	10/5/1992	177.69	11.22	166.47	2100	370	150	17	110	NA
	10/5/1992	177.69	NM	NM	2300	370	160	16	110	NA
	4/1/1993	177.69	8.79	168.90	5900	1500	410	110	390	NA
	6/29/1993	177.69	10.34	167.35	7600	2900	390	130	460	NA
	9/23/1993	177.69	10.91	166.78	2000	490	40	20	56	600
	9/23/1993	177.69	NM	NM	1500	420	39	19	56	550
	12/10/1993	177.69	9.93	167.76	1800	480	42	19	66	921
	12/10/1993	177.69	NM	NM	1500	380	38	17	55	770
	2/17/1994	177.69	9.64	168.05	1900	380	48	24	80	585
	2/17/1994	177.69	NM	NM	2200	430	42	19	65	491
	8/8/1994	177.69	11.72	165.97	2100	450	46	16	50	760
	10/12/1994	177.69	10.48	167.21	760	240	16	51	39	230
	1/19/1995	177.69	7.77	169.92	840	600	120	22	58	NA
	5/2/1995	177.69	8.69	169.00	2000	640	67	24	98	NA
	7/28/1995	177.69	10.12	167.57	190	<0.50	<0.50	<0.50	<1.0	NA
	11/17/1995	177.69	10.57	167.12	200	3.4	<1.0	1	<2.0	600
	2/7/1996	177.69	7.41	170.28	750	370	23	21	64	680
	4/23/1996	177.69	9.12	168.57	310	100	<1.0	<1.0	<1.0	1500
7/9/1996	177.69	10.12	167.57	730	230	74	13	63	750	
10/10/1996	177.69	10.80	166.89	420	26	1.6	7.3	12	430	

Table 1
Historical Groundwater Elevations & Analytical Data
TPH-g, BTEX, MtBE
3519 Castro Valley Blvd, Castro Valley, CA

Monitoring Well	Date	Top of casing elevation ¹ (feet)	Depth to Groundwater (feet)	Groundwater Elevation (feet)	TPH-g (µg/L)	Benzene (µg/L)	Toluene (µg/L)	Ethyl benzene (µg/L)	Total Xylenes (µg/L)	MtBE (µg/L) 8260B
ESE-1 cont.	1/20/1997	177.69	10.52	167.17	660	290	4.2	13	36	450
	4/25/1997	177.69	9.77	167.92	410	<0.5	<1.0	<1.0	<1.0	580
	7/18/1997	177.69	10.55	167.14	420	<0.5	<1.0	<1.0	<1.0	370
	10/27/1997	177.69	10.36	167.33	300	56	<1.0	6.5	<1.0	220
	1/22/1998	177.69	7.52	170.17	4200	440	9	15	17.7	1300
	4/23/1998	177.69	8.80	168.89	15000	3400	190	910	900	4900
	4/23/1998	177.69	NM	NM	15000	2800	140	730	730	4400
	7/29/1998	177.69	9.73	167.96	NA	NA	NA	NA	NA	NA
	7/30/1998	177.69	NM	NM	15000	<2.5	<5.0	<5.0	<5.0	15000
	12/17/1998	177.69	9.51	168.18	2400	73	1	2.8	4.6	2000
	3/19/1999	177.69	8.65	169.04	4700	58	<1.0	<1.0	<1.0	4700
	6/23/1999	177.69	10.51	167.18	600	170	<1.0	7.2	5	3900
	9/27/1999	177.69	10.32	167.37	920	200	<25	<25	<25	4900
	12/9/1999	177.69	10.24	167.45	460	130	1.2	5.2	1.5	5100
	3/9/2000	177.69	7.72	169.97	3000	1300	120	80	140	7300
	6/8/2000	177.69	9.40	168.29	2900	540	9.7	20	17	5200
	9/18/2000	177.69	10.05	167.64	890	3.4	<0.5	1.4	<0.5	2800
	12/14/2000	177.69	8.20	169.49	1600	11.1	<0.5	<0.5	<0.5	2730
	3/21/2001	177.69	9.75	167.94	5700	2.28	<0.5	0.51	<1.5	6810
	6/18/2001	177.69	10.21	167.48	2000	152	0.669	3.62	2.34	1980
	9/18/2001	177.69	10.30	167.39	2500	57.1	<5.0	6.25	<15	2090
	12/13/2001	177.69	9.82	167.87	2800	208	6.05	8.54	9.66	2030
	3/14/2002	177.69	9.10	168.59	1800	140	6.31	4.5	9.41	1970
6/19/2002	177.69	9.92	167.77	1100	220	2.02	4.23	3.8	1280	
9/10/2002	177.69	10.21	167.48	490	39	2.9	<2.0	4.9	670	
12/16/2002	177.69	8.56	169.13	730	140	6	3.2	9.1	670	

Table 1
Historical Groundwater Elevations & Analytical Data
TPH-g, BTEX, MtBE
3519 Castro Valley Blvd, Castro Valley, CA

Monitoring Well	Date	Top of casing elevation ¹ (feet)	Depth to Groundwater (feet)	Groundwater Elevation (feet)	TPH-g (µg/L)	Benzene (µg/L)	Toluene (µg/L)	Ethyl benzene (µg/L)	Total Xylenes (µg/L)	MtBE (µg/L) 8260B
ESE-1 cont.	3/11/2003	177.69	9.40	168.29	1700	490	21	22	41	530
	6/17/2003	177.69	9.86	167.83	1300	140	<10	<10	<10	480
	12/9/2003	177.69	9.32	168.37	1400	390	12	14	26.1	260
	2/26/2004	177.69	7.71	169.98	3200	880	50	44	89	200
	5/21/2004	177.69	10.19	167.50	1500	370	10	14	25.2	140
	8/10/2004	180.24	10.41	169.83	460	390	7	8.1	15.4	110
	10/19/2004	180.24	10.40	169.84	1600	490	13	12	25.3	110
	1/14/2005	180.24	8.26	171.98	790 Z	420	26	19	52	91
	4/14/2005	180.24	8.77	171.47	3020	766	25.6	21.3	25.26	88.2
	7/7/2005	180.24	9.94	170.30	1940	440	15.5	15.7	21	80.6
	11/15/2005	180.24	10.21	170.03	1260	259	6.2	8.2	10.81	45.8
	2/8/2006	180.24	9.01	171.23	1430	332	13.6	18.1	25.03	43
	4/27/2006	180.24	9.14	171.10	1,600	519	23.2	32.4	40.20	63.4
	8/1/2006	180.24	9.92	170.32	1,530	395	11.8	25.4	28.01	40
	10/19/2006	180.24	10.34	169.90	1,230	327	10.2	21.6	21.19	29.6
	1/12/2007	180.24	9.84	170.40	561	153	7.18	14.4	14.95	30.9
	4/17/2007	180.24	9.78	170.46	467	192	7.59	13.8	16.42	30.4
7/17/2007	180.24	9.82	170.42	755	271	8.6	17.8	22.06	26.7	
10/16/2007	180.24	8.99	171.25	164	80.2	<2.0	5.24	2.47	16.6	
	1/17/2008	180.24	9.35	170.89	70	10.8	<2.0	<0.50	<2.0	19.3
ESE-2	10/5/1992	178.23	11.68	166.55	300	5.4	16	3.9	45	NA
	4/1/1993	178.23	9.17	169.06	240	27	<0.5	17	2.6	123
	6/29/1993	178.23	10.88	167.35	1700	260	24	110	23	NA
	6/29/1993	178.23	NM	NM	1300	240	17	110	25	NA
	9/23/1993	178.23	11.56	166.67	240	3.1	0.5	0.6	2.5	643
	12/10/1993	178.23	10.48	167.75	250	2.4	2.4	1.5	11	940

Table 1
Historical Groundwater Elevations & Analytical Data
TPH-g, BTEX, MtBE
3519 Castro Valley Blvd, Castro Valley, CA

Monitoring Well	Date	Top of casing elevation ¹ (feet)	Depth to Groundwater (feet)	Groundwater Elevation (feet)	TPH-g (µg/L)	Benzene (µg/L)	Toluene (µg/L)	Ethyl benzene (µg/L)	Total Xylenes (µg/L)	MtBE (µg/L) 8260B
ESE-2 cont	2/17/1994	178.23	10.06	168.17	900	<0.5	<0.5	<0.5	<0.5	930
	8/8/1994	178.23	11.11	167.12	750	<0.5	<0.5	<0.5	<0.5	1400
	10/12/1994	178.23	11.31	166.92	1700	<0.5	<0.5	<0.5	<0.5	3000
	1/19/1995	178.23	8.25	169.98	300	2	0.9	0.7	1	NA
	5/2/1995	178.23	9.21	169.02	1200	4	<2.5	<2.5	<5	NA
	7/28/1995	178.23	10.64	167.59	2000	<2.5	<2.5	<2.5	<5	NA
	11/17/1995	178.23	11.13	167.10	3600	<25	<25	<25	<50	12000
	11/17/1995	178.23	NM	NM	3400	<25	<25	<25	<50	12000
	2/7/1996	178.23	7.94	170.29	450	<0.5	<1	<1	<1	2300
	4/23/1996	178.23	9.73	168.50	260	0.9	<1	<1	<1	8600
	7/9/1996	178.23	10.70	167.53	780	<2.5	<5	<5	<5	13393
	10/10/1996	178.23	11.39	166.84	2900	<0.5	<1	<1	<1	12000
	1/20/1997	178.23	9.04	169.19	<250	<2.5	<5	<5	<5	13000
	4/25/1997	178.23	10.31	167.92	2700	<0.5	<1	<1	<1	15000
	7/18/1997	178.23	11.02	167.21	11000	<5	<10	<10	<10	11000
	10/27/1997	178.23	10.93	167.30	6100	<2.5	<5.0	<5.0	<5.0	7100
	10/27/1997	178.23	NM	NM	6600	<2.5	<5.0	<5.0	<5.0	7400
	1/22/1998	178.23	7.93	170.30	13000	<0.5	<1	<1	<1	10000
	1/22/1998	178.23	NM	NM	13000	<0.5	<1	<1	<1	10000
	4/23/1998	178.23	9.34	168.89	19000	<5	<10	<10	<10	36000
	7/29/1998	178.23	10.29	167.94	NA	NA	NA	NA	NA	NA
	7/30/1998	178.23	NM	NM	19000	<5	<10	<10	<10	36000
	12/17/1998	178.23	10.20	168.03	12000	<5	<5	<5	<5	13000
3/19/1999	178.23	9.02	169.21	18000	160	<1	<1	<1	18000	
6/23/1999	178.23	9.99	168.24	280	<1	<1	<1	<1	16000	
9/27/1999	178.23	10.69	167.54	<500	<25	<25	<25	<25	12000	
12/9/1999	178.23	11.26	166.97	<50	<0.3	<0.3	<0.3	<0.6	12000	

Table 1
Historical Groundwater Elevations & Analytical Data
TPH-g, BTEX, MtBE
3519 Castro Valley Blvd, Castro Valley, CA

Monitoring Well	Date	Top of casing elevation ¹ (feet)	Depth to Groundwater (feet)	Groundwater Elevation (feet)	TPH-g (µg/L)	Benzene (µg/L)	Toluene (µg/L)	Ethyl benzene (µg/L)	Total Xylenes (µg/L)	MtBE (µg/L) 8260B
ESE-2 cont	3/9/2000	178.23	7.95	170.28	<50	1.6	<0.5	<0.5	<0.5	7900
	6/8/2000	178.23	9.66	168.57	1600	<0.5	0.73	<0.5	2.2	9400
	12/14/2000	178.23	11.15	167.08	6000	0.75	<0.5	<0.5	<0.5	11200
	3/21/2001	178.23	10.35	167.88	6900	786	45.7	37.7	71.5	3790
	6/18/2001	178.23	11.24	166.99	6400	<2.5	<2.5	<2.5	<7.5	9320
	9/18/2001	178.23	11.35	166.88	4800	<12.5	<12.5	<12.5	<37.5	6960
	12/13/2001	178.23	10.97	167.26	59000	0.592	<0.5	<0.5	<1	5940
	3/14/2002	178.23	10.13	168.10	4500	76	<0.5	<0.5	<1	6660
	6/19/2002	178.23	10.91	167.32	250	<12.5	<12.5	<12.5	<25	4900
	9/10/2002	178.23	10.82	167.41	1500	<5	<5	<5	6.3	3100
	12/16/2002	178.23	7.87	170.36	1400	<5	<5	<5	<5	2400
	3/11/2003	178.23	10.24	167.99	2800	<10	<10	<10	<10	4800
	6/17/2003	178.23	10.19	168.04	10000	<100	<100	<100	<100	4400
	12/9/2003	178.23	9.97	168.26	<50	<0.5	<0.5	<0.5	<0.5	3400
	2/26/2004	178.23	7.89	170.34	<50	<0.5	<0.5	<0.5	<0.5	3000
	5/21/2004	178.23	10.70	167.53	<50	<0.5	<0.5	<0.5	<0.5	1100
	8/10/2004	180.79	10.99	169.80	<50	<0.5	<0.5	<0.5	<0.5	550
	10/19/2004	180.79	10.46	170.33	<50	<0.5	<0.5	<0.5	<0.5	410
	1/14/2005	180.79	8.66	172.13	<50	<8.3	<8.3	<8.3	<8.3	1200
	4/14/2005	180.79	9.38	171.41	<860	<2.15	<2.15	<2.15	<4.30	1020
	7/7/2005	180.79	10.46	170.33	<860	<2.15	<8.60	<2.15	<4.30	378
	11/15/2005	180.79	10.55	170.24	<50	<0.5	<2.0	<0.5	<1.0	210
	2/8/2006	180.79	9.46	171.33	<215	<2.15	<8.6	<2.15	<4.3	419
4/27/2006	180.79	10.67	170.12	<100	1.71	<4.0	<1.0	<2.0	432	
8/1/2006	180.79	10.29	170.50	<100	2.83	<4.0	<1.0	<2.0	222	
10/19/2006	180.79	10.65	170.14	<50	0.8	<2.0	<0.5	<1.0	221	

Table 1
Historical Groundwater Elevations & Analytical Data
TPH-g, BTEX, MtBE
3519 Castro Valley Blvd, Castro Valley, CA

Monitoring Well	Date	Top of casing elevation ¹ (feet)	Depth to Groundwater (feet)	Groundwater Elevation (feet)	TPH-g (µg/L)	Benzene (µg/L)	Toluene (µg/L)	Ethyl benzene (µg/L)	Total Xylenes (µg/L)	MtBE (µg/L) 8260B
ESE-2 cont	1/12/2007	180.79	NM	NM	NA	NA	NA	NA	NA	NA
	4/17/2007	180.79	10.20	170.59	<50	3.17	<2.0	4.49	<2.0	158
	7/17/2007	180.79	10.31	170.48	<50	1.65	<2.0	<0.5	<2.0	105
	10/16/2007	180.79	9.22	171.57	<50	5.67	<2.0	<0.5	<2.0	73.9
	1/17/2008	180.79	9.88	170.91	<50.0	<0.50	<2.0	<0.50	<2.0	80.2
ESE-3	10/5/1992	178.20	10.58	167.62	430	57	31	3.6	34	NA
	4/1/1993	178.20	8.14	170.06	2400	460	220	74	210	NA
	6/29/1993	178.20	9.72	168.48	280	56	14	15	13	NA
	9/23/1993	178.20	10.46	167.74	72	13	3.5	1.7	4.1	NA
	12/10/1993	178.20	9.30	168.90	270	71	32	6.1	33	NA
	2/17/1994	178.20	8.97	169.23	520	140	10	20	33	5.74
	8/8/1994	178.20	10.02	168.18	<50	8.8	1.6	1.6	2.3	<5.0
	10/12/1994	178.20	10.32	167.88	470	190	6.4	15	18	<5.0
	1/19/1995	178.20	7.40	170.80	330	260	27	21	20	NA
	5/2/1995	178.20	8.26	169.94	530	180	30	23	44	NA
	7/28/1995	178.20	9.54	168.66	<50	<0.50	<0.50	<0.50	<1	NA
	11/17/1995	178.20	10.04	168.16	<50	1.7	<0.50	<0.50	<1	<5.0
	2/7/1996	178.20	7.08	171.12	<50	8.6	<1	<1	<1	<10
	4/1/2396	178.20	8.79	169.41	<50	7.6	<1	<1	<1	65
	7/9/1996	178.20	10.09	168.11	<50	12	2.6	2	3.9	26
	10/10/1996	178.20	10.48	167.72	NA	NA	NA	NA	NA	NA
	10/11/1996	178.20	NM	NM	260	140	<1	<1	2.6	<10
1/20/1997	178.20	8.65	169.55	<50	1.5	1.7	<1	<1	14	
4/25/1997	178.20	10.02	168.18	<50	<0.5	<1	<1	<1	14	
7/18/1997	178.20	10.66	167.54	10000	1400	1400	300	1280	<250	
10/27/1997	178.20	9.83	168.37	<250	<2.5	<5.0	<5.0	36	<50	

Table 1
Historical Groundwater Elevations & Analytical Data
TPH-g, BTEX, MtBE
3519 Castro Valley Blvd, Castro Valley, CA

Monitoring Well	Date	Top of casing elevation ¹ (feet)	Depth to Groundwater (feet)	Groundwater Elevation (feet)	TPH-g (µg/L)	Benzene (µg/L)	Toluene (µg/L)	Ethyl benzene (µg/L)	Total Xylenes (µg/L)	MtBE (µg/L) 8260B
ESE-3 cont.	1/22/1998	178.20	7.06	171.14	130	<0.5	<1.0	<1.0	<1.0	120
	4/23/1998	178.20	8.44	169.76	4800	560	<10	15	<10	4000
	7/29/1998	178.20	9.27	168.93	NA	NA	NA	NA	NA	NA
	7/30/1998	178.20	NM	NM	1800	6.2	<5.0	<5.0	<5.0	1700
	12/17/1998	178.20	9.15	169.05	600	54	<1.0	2.1	4.9	340/480
	3/19/1999	178.20	8.14	170.06	2000	260	4.4	13	28	870
	6/23/1999	178.20	9.44	168.76	290	91	<1.0	8.3	16	240
	9/27/1999	178.20	9.69	168.51	130	35	<1.0	2.7	3.8	100
	12/9/1999	178.20	10.99	167.21	380	84	1.7	8.7	6.3	160
	3/9/2000	178.20	7.12	171.08	950	190	4.6	39	62	350
	6/8/2000	178.20	10.92	167.28	300	37	<0.5	2.3	1.3	400
	9/18/2000	178.20	11.12	167.08	920	140	1.3	15	4.8	170
	12/14/2000	178.20	9.70	168.50	320	64	<0.5	6.24	1.76	201
	3/21/2001	178.20	10.07	168.13	680	80.5	0.546	21.1	18.2	398
	6/18/2001	178.20	11.42	166.78	380	47	<0.5	3.11	<1.5	242
	9/18/2001	178.20	11.55	166.65	340	54.8	<0.5	4.36	<1.5	79.7
	12/13/2001	178.20	10.12	168.08	270	31.4	<0.5	1.31	2.24	129
	3/14/2002	178.20	9.84	168.36	670	89.8	0.769	23.4	30.4	413
	6/19/2002	178.20	10.57	167.63	130	18.6	<0.5	<0.5	<1	166
	9/10/2002	178.20	9.90	168.30	88	12	<0.5	<0.5	<0.5	93
	12/16/2002	178.20	9.23	168.97	290	55	17	3.7	14	78
	3/11/2003	178.20	9.05	169.15	100	3.4	<0.5	0.54	<0.50	140
	6/17/2003	178.20	9.30	168.90	520	17	<5	5.3	<5	130

Table 1
Historical Groundwater Elevations & Analytical Data
TPH-g, BTEX, MtBE
3519 Castro Valley Blvd, Castro Valley, CA

Monitoring Well	Date	Top of casing elevation ¹ (feet)	Depth to Groundwater (feet)	Groundwater Elevation (feet)	TPH-g (µg/L)	Benzene (µg/L)	Toluene (µg/L)	Ethyl benzene (µg/L)	Total Xylenes (µg/L)	MtBE (µg/L) 8260B
ESE-4	10/5/1992	177.73	10.33	167.40	98	7.2	1.3	1.1	6.1	NA
	4/1/1993	177.73	7.88	169.85	550	93	20	23	33	NA
	6/29/1993	177.66	8.33	169.33	150	23	0.6	5.4	0.5	54
	9/23/1993	177.66	10.05	167.61	110	14	1.7	3.2	4.6	NA
	12/10/1993	177.66	8.95	168.71	110	21	7.2	4.2	10	28.75
	2/17/1994	177.66	8.65	169.01	210	26	1.2	4.7	11	113
	8/8/1994	177.66	9.76	167.90	76	9.6	<0.5	2	<0.5	62
	10/12/1994	177.66	9.62	168.04	<50	<0.5	<0.5	<0.5	<0.5	44
	1/19/1995	177.66	6.97	170.69	140	56	14	24	23	NA
	5/2/1995	177.66	7.85	169.81	130	21	2.8	8.6	8.2	NA
	7/28/1995	177.66	9.20	168.46	<50	<0.5	<0.5	<0.5	<1	NA
	11/17/1995	177.66	9.68	167.98	<50	<0.5	0.6	<0.5	<1	18
	2/7/1996	177.66	6.59	171.07	100	2.6	<1	1.6	4.1	42
	4/23/1996	177.66	8.30	169.36	160	37	15	16	31	43
	7/9/1996	177.66	9.21	168.45	60	17	1.5	6.8	11.6	27
	10/10/1996	177.66	9.97	167.69	NA	NA	NA	NA	NA	NA
	10/11/1996	177.66	NM	NM	<50	<0.5	<1.0	<1.0	<1.0	18
	1/20/1997	177.66	7.68	169.98	<50	<0.5	<1.0	<1.0	<1.0	130
	4/25/1997	177.66	9.15	168.51	<250	<2.5	<5.0	<5.0	<5.0	<50
	7/18/1997	177.66	9.71	167.95	<50	15	<10	<10	<10	<100
	10/27/1997	177.66	9.38	168.28	<250	<2.5	<5.0	<5.0	<5.0	<50
	1/22/1998	177.66	6.59	171.07	<50	<0.5	<1.0	<1.0	<1.0	<10
4/23/1998	177.66	7.90	169.76	<250	<2.5	<5.0	<5.0	<5.0	<50	
7/29/1998	177.66	8.96	168.70	NA	NA	NA	NA	NA	NA	
7/30/1998	177.66	NM	NM	<50	<0.5	<1.0	<1.0	<1.0	<10	
12/17/1998	177.66	8.32	169.34	NA	NA	NA	NA	NA	NA	

Table 1
Historical Groundwater Elevations & Analytical Data
TPH-g, BTEX, MtBE
3519 Castro Valley Blvd, Castro Valley, CA

Monitoring Well	Date	Top of casing elevation ¹ (feet)	Depth to Groundwater (feet)	Groundwater Elevation (feet)	TPH-g (µg/L)	Benzene (µg/L)	Toluene (µg/L)	Ethyl benzene (µg/L)	Total Xylenes (µg/L)	MtBE (µg/L) 8260B
ESE-4 cont.	3/19/1999	177.66	7.71	169.95	NA	NA	NA	NA	NA	NA
	6/23/1999	177.66	8.78	168.88	NA	NA	NA	NA	NA	NA
	9/27/1999	177.66	9.27	168.39	NA	NA	NA	NA	NA	NA
	12/9/1999	177.66	9.21	168.45	NA	NA	NA	NA	NA	NA
	3/9/2000	177.66	6.82	170.84	NA	NA	NA	NA	NA	NA
	6/8/2000	177.66	8.72	168.94	NA	NA	NA	NA	NA	NA
	9/18/2000	177.66	8.72	168.94	NA	NA	NA	NA	NA	NA
	12/14/2000	177.66	8.61	169.05	NA	NA	NA	NA	NA	NA
	3/21/2001	177.66	8.61	169.05	NA	NA	NA	NA	NA	NA
	6/18/2001	177.66	9.24	168.42	NA	NA	NA	NA	NA	NA
	9/18/2001	177.66	9.35	168.31	NA	NA	NA	NA	NA	NA
	12/13/2001	177.66	8.53	169.13	NA	NA	NA	NA	NA	NA
	3/14/2002	177.66	8.44	169.22	NA	NA	NA	NA	NA	NA
	6/19/2002	177.66	10.97	166.69	NA	NA	NA	NA	NA	NA
	9/10/2002	177.66	9.27	168.39	NA	NA	NA	NA	NA	NA
	12/16/2002	177.66	6.90	170.76	NA	NA	NA	NA	NA	NA
	3/11/2003	177.66	8.83	168.83	NA	NA	NA	NA	NA	NA
	6/17/2003	177.66	8.84	168.82	NA	NA	NA	NA	NA	NA
ESE-5	10/5/1992	176.08	9.22	166.86	1300	200	3.8	1.2	18	NA
	4/1/1993	176.08	7.02	169.06	13000	2200	26	730	1000	NA
	4/1/1993	176.08	NM	NM	13000	2500	25	740	1100	NA
	6/29/1993	176.08	10.21	165.87	7600	1500	9.3	170	100	NA
	9/23/1993	176.08	10.64	165.44	560	19	1.2	0.9	1.8	NA
	12/10/1993	176.08	9.42	166.66	1700	300	3	76	110	14.07

Table 1
Historical Groundwater Elevations & Analytical Data
TPH-g, BTEX, MtBE
3519 Castro Valley Blvd, Castro Valley, CA

Monitoring Well	Date	Top of casing elevation ¹ (feet)	Depth to Groundwater (feet)	Groundwater Elevation (feet)	TPH-g (µg/L)	Benzene (µg/L)	Toluene (µg/L)	Ethyl benzene (µg/L)	Total Xylenes (µg/L)	MtBE (µg/L) 8260B
ESE-5 cont	2/7/1994	176.08	9.35	166.73	3500	640	7.8	90	130	45.13
	8/8/1994	176.08	8.76	167.32	2600	210	4.6	9.4	4.4	33
	8/8/1994	176.08	NM	NM	2500	230	4.6	13	4.8	32
	10/12/1994	176.08	8.95	167.13	5600	560	9.5	75	21	79.2
	10/12/1994	176.08	NM	NM	6000	550	10	78	22	77
	1/19/1995	176.08	5.40	170.68	1900	620	<5	95	15	NA
	1/19/1995	176.08	NM	NM	1600	620	<5	93	17	NA
	5/2/1995	176.08	6.48	169.60	5700	1100	<10	180	58	NA
	5/2/1995	176.08	NM	NM	5300	1100	<10	180	58	NA
	7/28/1995	176.08	7.97	168.11	520	15	<0.50	1.7	1.3	NA
	7/28/1995	176.08	NM	NM	460	7.2	<0.50	1.9	1.5	NA
	11/17/1995	176.08	8.39	167.69	850	39	1.8	7.6	2.7	24
	2/7/1996	176.08	4.71	171.37	4100	670	6	190	140	<50
	4/23/1996	176.08	7.35	168.73	3000	570	<5	79	100	84
	7/9/1996	176.08	9.40	166.68	620	150	1.7	9.3	6.4	25
	10/10/1996	176.08	9.04	167.04	1100	29	<5	<5	<5	<50
	10/10/1996	176.08	NM	NM	1100	31	<5	<5	<5	<50
	1/20/1997	176.08	5.82	170.26	2100	980	<25	280	80	<250
	1/20/1997	176.08	NM	NM	2700	910	8.8	280	84	180
	4/25/1997	176.08	7.24	168.84	NA	NA	NA	NA	NA	NA
	4/28/1997	176.08	NM	NM	<250	7.9	<5.0	<5.0	<5.0	<50
	7/18/1997	176.08	7.86	168.22	1200	<5	<10	<10	<10	<100
	7/18/1997	176.08	NM	NM	630	31	<5.0	<5.0	<5.0	130
10/27/1997	176.08	7.91	168.17	<250	5.4	<5.0	<5.0	<5.0	<50	

Table 1
Historical Groundwater Elevations & Analytical Data
TPH-g, BTEX, MtBE
3519 Castro Valley Blvd, Castro Valley, CA

Monitoring Well	Date	Top of casing elevation ¹ (feet)	Depth to Groundwater (feet)	Groundwater Elevation (feet)	TPH-g (µg/L)	Benzene (µg/L)	Toluene (µg/L)	Ethyl benzene (µg/L)	Total Xylenes (µg/L)	MtBE (µg/L) 8260B
ESE-5 cont.	1/22/1998	176.08	4.64	171.44	170	7.7	<1.0	<1.0	<1.0	130
	4/23/1998	176.08	6.31	169.77	720	79	<5.0	9	<5.0	180
	7/29/1998	176.08	7.43	168.65	NA	NA	NA	NA	NA	NA
	7/30/1998	176.08	NM	NM	840	9.8	<1.0	4	<1.0	710
	12/17/1998	176.08	7.05	169.03	NA	NA	NA	NA	NA	NA
	3/19/1999	176.08	5.00	171.08	<250	<5.0	<5.0	<5.0	<5.0	<5.0
	6/23/1999	176.08	7.77	168.31	NA	NA	NA	NA	NA	NA
	9/27/1999	176.08	8.11	167.97	450	10	<5.0	6.3	<5.0	220
	12/9/1999	176.08	7.66	168.42	NA	NA	NA	NA	NA	NA
	3/9/2000	176.08	5.08	171.00	1700	170	2.5	45	6.4	140
	6/8/2000	176.08	7.36	168.72	NA	NA	NA	NA	NA	NA
	9/18/2000	176.08	7.71	168.37	130	0.65	<0.50	0.71	<0.50	51
	12/14/2000	176.08	2.36	173.72	NA	NA	NA	NA	NA	NA
	3/21/2001	176.08	7.42	168.66	1000	10.3	<2.5	11	<7.5	70.8
	6/18/2001	176.08	7.92	168.16	NA	NA	NA	NA	NA	NA
	9/18/2001	176.26	8.23	168.03	200	0.868	<0.50	0.55	<1.5	57.5
	12/13/2001	176.26	7.80	168.46	NA	NA	NA	NA	NA	NA
	3/14/2002	176.26	6.55	169.71	1300	17.1	1.35	15.4	1.42	37.4
	6/19/2002	176.26	7.83	168.43	NA	NA	NA	NA	NA	NA
	9/10/2002	176.26	8.22	168.04	680	9.9	<5.0	<5.0	<5.0	44
	12/16/2002	176.26	6.58	169.68	NA	NA	NA	NA	NA	NA
	3/11/2003	176.26	6.77	169.49	2100	14	<2.5	15	3	80
	6/17/2003	176.26	6.75	169.51	NA	NA	NA	NA	NA	NA
9/17/2003	176.26	8.48	167.78	970	10 C	<0.5	<0.5	5.3	34	
12/9/2003	176.26	7.32	168.94	700	6.5	<0.5	3.1	2.7 C	34	

Table 1
Historical Groundwater Elevations & Analytical Data
TPH-g, BTEX, MtBE
3519 Castro Valley Blvd, Castro Valley, CA

Monitoring Well	Date	Top of casing elevation ¹ (feet)	Depth to Groundwater (feet)	Groundwater Elevation (feet)	TPH-g (µg/L)	Benzene (µg/L)	Toluene (µg/L)	Ethyl benzene (µg/L)	Total Xylenes (µg/L)	MtBE (µg/L) 8260B
ESE-5 cont.	2/26/2004	176.26	5.21	171.05	2400 H	41	2.8 C	18	2.4 C	29
	5/21/2004	176.26	7.50	168.76	1500	2.6 C	<0.5	2.1 C	2.1 C	25
	8/10/2004	178.80	8.28	170.52	680	<0.5	<0.5	<0.5	<0.5	33
	10/19/2004	178.80	8.26	170.54	380	<0.5	<0.5	<0.5	1.4	39
	1/14/2005	178.80	5.16	173.64	2400	18	1.4	22	2.1	26
	4/14/2005	178.80	6.13	172.67	4800	7.75	1.26	14.3	<1.0	23.1
	7/7/2005	178.80	7.52	171.28	3240	0.78	<2.0	1.18	<1.0	36.6
	11/15/2005	178.80	7.85	170.95	1190	0.51	<2.0	<0.5	<1.0	30
	2/8/2006	178.80	5.83	172.97	2510	1.91	<2.0	2.82	<1.0	20.7
	4/27/2006	178.80	5.71	173.09	4,700	2.76	<2.0	4.77	<1.0	28.3
	8/1/2006	178.80	7.71	171.09	1,890	0.7	<2.0	0.75	<1.0	24.7
	10/19/2006	178.80	8.00	170.80	474	<0.5	<2.0	3.39	<1.0	29
	1/12/2007	178.80	7.41	171.39	868	2.18	<2.0	2.66	<2.0	16.3
	4/17/2007	178.80	7.51	171.29	1,240	10.2	<2.0	10.4	2.37	17.2
7/17/2007	178.80	7.47	171.33	836	3.1	<2.0	4.91	2.35	25.8	
10/16/2007	178.80	6.26	172.54	2,120	2.5	<2.0	6.19	2.61	17.5	
	1/17/2008	178.80	6.59	172.21	2,730	5.74	<2.0	14.3	<2.0	13.1
MW-6	7/28/1995	179.24	10.00	169.24	<50	<0.50	<0.50	<0.50	<1.0	NA
	11/17/1995	179.24	10.44	168.80	<50	<0.50	<0.50	<0.50	<1.0	<5.0
	2/7/1996	179.24	7.68	171.56	<50	<0.5	<1.0	<1.0	<1.0	<10
	4/23/1996	179.24	9.33	169.91	<50	<0.5	<1.0	<1.0	<1.0	<10
	7/9/1996	179.24	10.10	169.14	<50	<0.5	<1.0	<1.0	<1.0	<10
	10/10/1996	179.24	11.00	168.24	<50	<0.5	<1.0	<1.0	<1.0	<10
	1/20/1997	179.24	8.70	170.54	<50	<0.5	<1.0	<1.0	<1.0	<10
	4/25/1997	179.24	10.16	169.08	<50	<0.5	<1.0	<1.0	<1.0	<10
	7/18/1997	179.24	10.66	168.58	<50	<0.5	<1.0	<1.0	<1.0	<10
	10/27/1997	179.24	10.25	168.99	<50	<0.5	<1.0	<1.0	<1.0	<10

Table 1
Historical Groundwater Elevations & Analytical Data
TPH-g, BTEX, MtBE
3519 Castro Valley Blvd, Castro Valley, CA

Monitoring Well	Date	Top of casing elevation ¹ (feet)	Depth to Groundwater (feet)	Groundwater Elevation (feet)	TPH-g (µg/L)	Benzene (µg/L)	Toluene (µg/L)	Ethyl benzene (µg/L)	Total Xylenes (µg/L)	MtBE (µg/L) 8260B
MW-6 cont.	1/22/1998	179.24	7.76	171.48	<50	<0.5	<1.0	<1.0	<1.0	<10
	4/23/1998	179.24	9.10	170.14	<50	<0.5	<1.0	<1.0	<1.0	<10
	7/29/1998	179.24	10.40	168.84	NA	NA	NA	NA	NA	NA
	7/30/1998	179.24	NM	NM	<50	<0.5	<1.0	<1.0	<1.0	<10
	12/17/1998	179.24	9.40	169.84	NA	NA	NA	NA	NA	NA
	3/19/1999	179.24	9.10	170.14	NA	NA	NA	NA	NA	NA
	6/23/1999	179.24	9.79	169.45	NA	NA	NA	NA	NA	NA
	9/27/1999	179.24	10.10	169.14	NA	NA	NA	NA	NA	NA
	12/9/1999	179.24	9.97	169.27	NA	NA	NA	NA	NA	NA
	3/9/2000	179.24	8.56	170.68	NA	NA	NA	NA	NA	NA
	6/8/2000	179.24	9.11	170.13	NA	NA	NA	NA	NA	NA
	9/18/2000	179.24	9.77	169.47	NA	NA	NA	NA	NA	NA
	12/14/2000	179.24	9.17	170.07	NA	NA	NA	NA	NA	NA
	3/21/2001	179.24	9.82	169.42	NA	NA	NA	NA	NA	NA
	6/18/2001	179.24	10.19	169.05	NA	NA	NA	NA	NA	NA
	9/18/2001	179.24	10.25	168.99	NA	NA	NA	NA	NA	NA
	12/13/2001	179.24	9.75	169.49	NA	NA	NA	NA	NA	NA
	3/14/2002	179.24	9.53	169.71	NA	NA	NA	NA	NA	NA
	6/19/2002	179.24	9.87	169.37	NA	NA	NA	NA	NA	NA
	9/10/2002	179.24	9.49	169.75	NA	NA	NA	NA	NA	NA
	12/16/2002	179.24	8.39	170.85	NA	NA	NA	NA	NA	NA
	3/11/2003	179.24	9.40	169.84	NA	NA	NA	NA	NA	NA
	6/17/2003	179.24	9.71	169.53	NA	NA	NA	NA	NA	NA
	9/17/2003	179.24	10.21	169.03	<50	<0.5	<0.5	<0.5	<0.5	<2.0
12/9/2003	179.24	9.66	169.58	<50	<0.5	<0.5	<0.5	<0.5	<0.5	

Table 1
Historical Groundwater Elevations & Analytical Data
TPH-g, BTEX, MtBE
3519 Castro Valley Blvd, Castro Valley, CA

Monitoring Well	Date	Top of casing elevation ¹ (feet)	Depth to Groundwater (feet)	Groundwater Elevation (feet)	TPH-g (µg/L)	Benzene (µg/L)	Toluene (µg/L)	Ethyl benzene (µg/L)	Total Xylenes (µg/L)	MtBE (µg/L) 8260B
MW-6 cont.	2/26/2004	179.24	7.83	171.41	<50	<0.5	<0.5	<0.5	<0.5	<0.5
	5/21/2004	179.24	9.75	169.49	<50	<0.5	<0.5	<0.5	<0.5	<0.5
	8/10/2004	181.80	10.28	171.52	<50	<0.5	<0.5	<0.5	<0.5	<0.5
	10/19/2004	181.80	9.91	171.89	<50	<0.5	<0.5	<0.5	<0.5	<0.5
	1/14/2005	181.80	8.40	173.40	<50	0.6	<0.5	<0.5	<0.5	<0.5
	4/14/2005	181.80	9.04	172.76	<200	<0.5	<0.5	<0.5	<1.0	<0.5
	7/7/2005	181.80	9.94	171.86	<200	<0.5	<2.00	<0.5	<1.00	<0.5
	11/15/2005	181.80	9.98	171.82	<50	<0.5	<2.0	<0.5	<1.0	<0.5
	2/8/2006	181.80	9.91	171.89	<50	<0.5	<2.0	<0.5	<1.0	<0.5
	4/27/2006	181.80	9.54	172.26	<50	<0.5	<2.0	<0.5	<1.0	<0.5
	8/1/2006	181.80	9.61	172.19	<50	<0.5	<2.0	<0.5	<1.0	0.51
	10/19/2006	181.80	10.23	171.57	<50	<0.5	<2.0	<0.5	<1.0	0.63
	1/12/2007	181.80	10.13	171.67	<50	<0.5	<2.0	<0.5	<2.0	<0.5
	4/17/2007	181.80	10.22	171.58	<50	<0.5	<2.0	<0.5	<2.0	<0.5
	7/17/2007	181.80	9.76	172.04	<50	<0.5	<2.0	<0.5	<2.0	<0.5
10/16/2007	181.80	9.82	171.98	<50	<0.5	<2.0	<0.5	<2.0	<0.5	
	1/17/2008	181.80	9.43	172.37	<50	<0.50	<2.0	<0.50	<2.0	<0.5
MW-7	7/28/1995	176.55	9.25	167.30	<50	0.54	0.54	<0.50	<1.0	NA
	11/17/1995	176.55	9.73	166.82	1100	<10	<10	<10	<20	4000
	2/7/1996	176.55	6.48	170.07	610	<0.50	<1.0	<1.0	<1.0	2500
	2/7/1996	176.55	NM	NM	280	<0.50	<1.0	<1.0	<1.0	2600
	4/23/1996	176.55	8.37	168.18	110	<0.50	<1.0	<1.0	<1.0	3500
	4/23/1996	176.55	NM	NM	230	<0.50	<1.0	<1.0	<1.0	3500
	7/9/1996	176.55	9.24	167.31	230	<0.50	<1.0	<1.0	<1.0	4296
	7/9/1996	176.55	NM	NM	220	<0.50	<1.0	<1.0	<1.0	4400
	10/10/1996	176.55	10.05	166.50	NA	NA	NA	NA	NA	NA
	10/11/1996	176.55	NM	NM	1600	<0.50	<1.0	<1.0	<1.0	3000

Table 1
Historical Groundwater Elevations & Analytical Data
TPH-g, BTEX, MtBE
3519 Castro Valley Blvd, Castro Valley, CA

Monitoring Well	Date	Top of casing elevation ¹ (feet)	Depth to Groundwater (feet)	Groundwater Elevation (feet)	TPH-g (µg/L)	Benzene (µg/L)	Toluene (µg/L)	Ethyl benzene (µg/L)	Total Xylenes (µg/L)	MtBE (µg/L) 8260B
MW-7 cont.	1/20/1997	176.55	7.51	169.04	<50	0.63	<1.0	<1.0	<1.0	2600
	4/25/1997	176.55	8.79	167.76	NA	NA	NA	NA	NA	NA
	4/28/1997	176.55	NM	NM	1500	<0.50	<1.0	<1.0	<1.0	3600
	4/28/1997	176.55	NM	NM	7700	3500	<25	74	37	<250
	7/18/1997	176.55	9.50	167.05	1400	<0.50	<1.0	<1.0	<1.0	2600
	10/27/1997	176.55	9.19	167.36	420	<0.50	<1.0	<1.0	<1.0	560
	1/22/1998	176.55	6.45	170.10	3100	<0.50	<1.0	<1.0	1.4	2300
	4/23/1998	176.55	8.02	168.53	3800	<0.50	<1.0	<1.0	<1.0	3800
	7/29/1998	176.55	8.88	167.67	NA	NA	NA	NA	NA	NA
	7/30/1998	176.55	NM	NM	500	<2.5	<5.0	<5.0	<5.0	<50
	7/30/1998	176.55	NM	NM	4700	<12	<25	<25	<25	4700
	12/17/1998	176.55	8.62	167.93	NA	NA	NA	NA	NA	NA
	3/19/1999	176.55	7.52	169.03	3800	<1.0	<1.0	<1.0	<1.0	3800
	6/23/1999	176.55	9.63	166.92	NA	NA	NA	NA	NA	NA
	9/27/1999	176.55	9.39	167.16	140	<10	<10	<10	<10	3800
	12/9/1999	176.55	9.94	166.61	NA	NA	NA	NA	NA	NA
	3/9/2000	176.55	6.72	169.83	<50	<0.50	<0.50	<0.50	<0.50	1400
	6/8/2000	176.55	7.38	169.17	NA	NA	NA	NA	NA	NA
	9/18/2000	176.55	9.18	167.37	190	<0.50	<0.50	<0.50	<0.50	580
	12/14/2000	176.55	8.13	168.42	NA	NA	NA	NA	NA	NA
	3/21/2001	176.55	8.98	167.57	1300	<0.50	<0.50	<0.50	<1.5	1460
	6/18/2001	176.55	9.68	166.87	NA	NA	NA	NA	NA	NA
	9/18/2001	176.55	9.80	166.75	<0.50	<0.50	<0.50	<0.50	<1.5	94.9
	12/13/2001	176.55	9.26	167.29	NA	NA	NA	NA	NA	NA
	3/14/2002	176.55	8.69	167.86	800	<0.50	<0.50	<0.50	<1.0	952
	6/19/2002	176.55	9.06	167.49	NA	NA	NA	NA	NA	NA
	9/10/2002	176.55	9.23	167.32	260	<2.0	<2.0	<2.0	<2.0	580
12/16/2002	176.55	7.77	168.78	NA	NA	NA	NA	NA	NA	

Table 1
Historical Groundwater Elevations & Analytical Data
TPH-g, BTEX, MtBE
3519 Castro Valley Blvd, Castro Valley, CA

Monitoring Well	Date	Top of casing elevation ¹ (feet)	Depth to Groundwater (feet)	Groundwater Elevation (feet)	TPH-g (µg/L)	Benzene (µg/L)	Toluene (µg/L)	Ethyl benzene (µg/L)	Total Xylenes (µg/L)	MtBE (µg/L) 8260B
MW-7 cont.	3/11/2003	176.55	8.30	168.25	620	<2.5	<2.5	<2.5	<2.5	1100
	6/17/2003	176.55	9.51	167.04	NA	NA	NA	NA	NA	NA
	9/17/2003	176.55	9.52	167.03	<50	<0.5	<0.5	<0.5	<0.5	460
	12/9/2003	176.55	8.99	167.56	<50	<0.5	<0.5	<0.5	<0.5	420
	2/26/2004	176.55	6.55	170.00	<50	<0.5	<0.5	<0.5	<0.5	330
	5/21/2004	176.55	8.90	167.65	<50	<0.5	<0.5	<0.5	<0.5	630
	8/10/2004	179.11	9.58	169.53	<50	<0.5	<0.5	<0.5	<0.5	750
	10/19/2004	179.11	9.20	169.91	<50	<0.5	<0.5	<0.5	<0.5	550
	1/14/2005	179.11	7.25	171.86	<50	<2.0	<2.0	<2.0	<2.0	250
	4/14/2005	179.11	7.94	171.17	<200	<0.5	<0.5	<0.5	<1.0	285
	7/7/2005	179.11	9.08	170.03	<400	<1.0	<4.0	<1.0	<2.0	452
	11/15/2005	179.11	9.14	169.97	<50	<0.5	<2.0	<0.5	<1.0	110
	2/8/2006	179.11	7.93	171.18	<50	<0.5	<2.0	<0.5	<1.0	101
	4/27/2006	179.11	8.40	170.71	<50	<0.5	<2.0	<0.5	<1.0	131
	8/1/2006	179.11	8.89	170.22	<50	<0.5	<2.0	<0.5	<1.0	68.6
	10/19/2006	179.11	9.44	169.67	<50	<0.5	<2.0	<0.5	<1.0	65.5
	1/12/2007	179.11	8.91	170.20	<50	<0.5	<2.0	<0.5	<2.0	38
	4/17/2007	179.11	8.58	170.53	<50	<0.5	<2.0	<0.5	<2.0	24.7
7/17/2007	179.11	9.04	170.07	<50	2.07	<2.0	<0.5	<2.0	29.3	
10/6/2007	179.11	7.88	171.23	<50	0.88	<2.0	<0.5	<2.0	5.26	
1/17/2008	179.11	NM	NM	NM	NA	NA	NA	NA	NA	NA
MW-8	7/28/1995	176.34	7.80	168.54	1,100	<2.5	<2.5	<2.5	<5.0	NA
	11/17/1995	176.34	8.29	168.05	8,300	75	5.3	670	240	140
	2/7/1996	176.34	4.99	171.35	2,300	33	<10	190	216	<100
	4/23/1996	176.34	6.09	170.25	2,000	390	<10	150	26	<250

Table 1
Historical Groundwater Elevations & Analytical Data
TPH-g, BTEX, MtBE
3519 Castro Valley Blvd, Castro Valley, CA

Monitoring Well	Date	Top of casing elevation ¹ (feet)	Depth to Groundwater (feet)	Groundwater Elevation (feet)	TPH-g (µg/L)	Benzene (µg/L)	Toluene (µg/L)	Ethyl benzene (µg/L)	Total Xylenes (µg/L)	MtBE (µg/L) 8260B
QC-2	4/1/1993	NM	NM	NM	<50	<0.5	<0.5	<0.5	<0.5	NA
	6/29/1993	NM	NM	NM	<50	<0.5	<0.5	<0.5	<0.5	NA
	9/23/1993	NM	NM	NM	<50	<0.5	<0.5	<0.5	<0.5	NA
	12/10/1993	NM	NM	NM	<50	<0.5	<0.5	<0.5	<0.5	<5.0
	2/17/1994	NM	NM	NM	<50	<0.5	<0.5	<0.5	<0.5	NA
	8/8/1994	NM	NM	NM	<50	<0.5	<0.5	<0.5	<0.5	NA
	10/12/1994	NM	NM	NM	<50	<0.5	<0.5	<0.5	<0.5	NA
	1/19/1995	NM	NM	NM	<50	<0.5	<0.5	<0.5	<1.0	NA
	5/2/1995	NM	NM	NM	<50	<0.50	<0.50	<0.50	<1.0	NA
	7/28/1995	NM	NM	NM	<50	<0.50	<0.50	<0.50	<1.0	NA
	11/17/1995	NM	NM	NM	<50	<0.50	<0.50	<0.50	<1.0	<5.0
	2/7/1996	NM	NM	NM	<50	<0.5	<1.0	<1.0	<1.0	<10
	4/23/1996	NM	NM	NM	<50	<0.5	<1.0	<1.0	<1.0	<10
	7/9/1996	NM	NM	NM	<50	<0.5	<1.0	<1.0	<1.0	<10
SOMA-1	8/10/2004	180.95	11.53	169.42	84	<0.5	<0.5	1.5 C	2.2	2100
	10/19/2004	180.95	10.41	170.54	56	<0.5	<0.5	1.3 C	1.4 C	1600
	1/14/2005	180.95	9.68	171.27	58	<3.1	<3.1	<3.1	<3.1	330
	4/14/2005	180.95	9.37	171.58	<2200	<5.5	<5.5	<5.5	<11	668
	7/7/2005	180.95	10.21	170.74	<860	<2.15	<8.6	<2.15	<4.3	591
	11/15/2005	180.95	10.70	170.25	<50	<0.5	<2.0	1.1	<1.0	256
	2/8/2006	180.95	9.30	171.65	127	1.56	<2.0	3.23	3.12	176
	4/27/2006	180.95	9.64	171.31	81.6	1.14	<2.0	2.8	<1.0	189
	8/1/2006	180.95	10.25	170.70	<50	1.07	<2.0	1.46	<1.0	122
10/19/2006	180.95	10.73	170.22	<50	0.68	<2.0	4.17	<1.0	116	

Table 1
Historical Groundwater Elevations & Analytical Data
TPH-g, BTEX, MtBE
3519 Castro Valley Blvd, Castro Valley, CA

Monitoring Well	Date	Top of casing elevation ¹ (feet)	Depth to Groundwater (feet)	Groundwater Elevation (feet)	TPH-g (µg/L)	Benzene (µg/L)	Toluene (µg/L)	Ethyl benzene (µg/L)	Total Xylenes (µg/L)	MtBE (µg/L) 8260B
SOMA-1 cont	1/12/2007	180.95	10.38	170.57	<50	<0.5	<2.0	<0.5	<2.0	68.7
	4/17/2007	180.95	10.09	170.86	<50	5.76	<2.0	4.33	2.59	33.4
	7/17/2007	180.95	10.35	170.60	<50	14.8	<2.0	4.63	3.32	39.4
	10/16/2007	180.95	9.71	171.24	<50	5.7	<2.0	<0.5	<2.0	14.2
	1/17/2008	180.95	10.01	170.94	<50	1.02	<2.0	<0.5	<2.0	12.8
SOMA-2	8/10/2004	178.99	10.69	168.30	<50	<0.5	<0.5	<0.5	<0.5	0.8
	10/19/2004	178.99	10.75	168.24	<50	<0.5	<0.5	<0.5	<0.5	2.4
	1/14/2005	178.99	9.45	169.54	<50	<0.5	<0.5	<0.5	<0.5	1.1
	4/14/2005	178.99	10.46	168.53	<200	<0.5	<0.5	<0.5	<1.0	<0.5
	7/7/2005	178.99	11.81	167.18	<200	<0.5	<2.0	<0.5	<1.0	<0.5
	11/15/2005	178.99	12.02	166.97	<50	<0.5	<2.0	<0.5	<1.0	1.61
	2/8/2006	178.99	11.88	167.11	<50	<0.5	<2.0	<0.5	<1.0	<0.5
	4/27/2006	178.99	10.95	168.04	<50	<0.5	<2.0	<0.5	<1.0	<0.5
	8/1/2006	178.99	11.85	167.14	<50	<0.5	<2.0	<0.5	<1.0	1.11
	10/19/2006	178.99	10.62	168.37	<50	<0.5	<2.0	<0.5	<1.0	1.36
	1/12/2007	178.99	10.26	168.73	<50	<0.5	<2.0	<0.5	<2.0	<0.5
	4/17/2007	178.99	11.88	167.11	<50	<0.5	<2.0	<0.5	<2.0	0.87
	7/17/2007	178.99	10.84	168.15	<50	<0.5	<2.0	<0.5	<2.0	<0.5
	10/16/2007	178.99	9.69	169.30	<50	<0.5	<2.0	<0.5	<2.0	<0.5
1/17/2008	178.99	9.62	169.37	<50	<0.5	<2.0	<0.5	<2.0	<0.5	

Table 1
Historical Groundwater Elevations & Analytical Data
TPH-g, BTEX, MtBE
3519 Castro Valley Blvd, Castro Valley, CA

Monitoring Well	Date	Top of casing elevation ¹ (feet)	Depth to Groundwater (feet)	Groundwater Elevation (feet)	TPH-g (µg/L)	Benzene (µg/L)	Toluene (µg/L)	Ethyl benzene (µg/L)	Total Xylenes (µg/L)	MtBE (µg/L) 8260B
SOMA-3	8/10/2004	176.81	9.97	166.84	<50	<0.5	<0.5	<0.5	<0.5	<0.5
	10/19/2004	176.81	9.59	167.22	<50	<0.5	<0.5	<0.5	<0.5	<0.5
	1/14/2005	176.81	8.23	168.58	<50	<0.5	<0.5	<0.5	<0.5	<0.5
	4/14/2005	176.81	8.64	168.17	<200	<0.5	<0.5	<0.5	<1.0	<0.5
	7/7/2005	176.81	9.60	167.21	<200	<0.5	<2.0	<0.5	<1.0	<0.5
	11/15/2005	176.81	10.01	166.80	<50	<0.5	<2.0	<0.5	<1.0	5.1
	2/8/2006	176.81	8.80	168.01	<50	<0.5	<2.0	<0.5	<1.0	7.16
	4/27/2006	176.81	9.00	167.81	<50	<0.5	<2.0	<0.5	<1.0	14.2
	8/1/2006	176.81	9.91	166.90	<50	<0.5	<2.0	<0.5	<1.0	7.29
	10/19/2006	176.81	10.21	166.60	<50	<0.5	<2.0	<0.5	<1.0	41.4
	1/12/2007	176.81	9.73	167.08	<50	<0.5	<2.0	<0.5	<2.0	20.9
	4/17/2007	176.81	9.81	167.00	<50	<0.5	<2.0	<0.5	<2.0	32.1
	7/17/2007	176.81	10.06	166.75	<50	<0.5	<2.0	<0.5	<2.0	23.6
	10/16/2007	176.81	9.54	167.27	<50	<0.5	<2.0	<0.5	<2.0	22.3
1/17/2008	176.81	9.06	167.75	<50	<0.5	<2.0	<0.5	<2.0	11.1	
SOMA-4	8/10/2004	176.94	9.44	167.50	140	0.98	<0.5	7.8	<0.5	11
	10/19/2004	176.94	9.91	167.03	150	<0.5	<0.5	10	<0.5	8.8
	1/14/2005	176.94	8.36	168.58	500	3.7	<0.5	53	<0.5	7.6
	4/14/2005	176.94	7.89	169.05	<200	0.74	<0.5	3.21	<1.0	5.65
	7/7/2005	176.94	11.62	165.32	<200	<0.5	<2.0	0.56	<1.0	7.09
	11/15/2005	176.94	9.33	167.61	<50	<0.5	<2.0	<0.5	<1.0	8.6
	2/8/2006	176.94	9.18	167.76	55.8	<0.5	<2.0	0.85	<1.0	10.4
	4/27/2006	176.94	8.75	168.19	172	1.35	<2.0	8.83	<1.0	11.7
	8/1/2006	176.94	9.52	167.42	<50	0.52	<2.0	1.53	<1.0	14.1
	10/19/2006	176.94	9.51	167.43	<50	<0.5	<2.0	<0.5	<1.0	19.2
	1/12/2007	176.94	8.98	167.96	<50	<0.5	<2.0	<0.5	<2.0	20.4
	4/17/2007	176.94	8.96	167.98	<50	<0.5	<2.0	4.33	<2.0	15.8
	7/17/2007	176.94	9.31	167.63	<50	<0.5	<2.0	4.47	<2.0	13.3
	10/16/2007	176.94	8.96	167.98	<50	<0.5	<2.0	4.5	<2.0	8.57
1/17/2008	176.94	8.84	168.10	<50	<0.5	<2.0	<0.5	<2.0	8.87	

Table 1
Historical Groundwater Elevations & Analytical Data
TPH-g, BTEX, MtBE
3519 Castro Valley Blvd, Castro Valley, CA

Monitoring Well	Date	Top of casing elevation ¹ (feet)	Depth to Groundwater (feet)	Groundwater Elevation (feet)	TPH-g (µg/L)	Benzene (µg/L)	Toluene (µg/L)	Ethyl benzene (µg/L)	Total Xylenes (µg/L)	MtBE (µg/L) 8260B
EB-PMP	1/17/2008				<50	<0.5	<2.0	<0.5	<2.0	<0.5
EB-PRB	1/17/2008				<50	<0.5	<2.0	<0.5	<2.0	<0.5
EB-PMP2	1/17/2008				<50	<0.5	<2.0	<0.5	<2.0	<0.5
EB-PRB2	1/17/2008				<50	<0.5	<2.0	<0.5	<2.0	<0.5

Table 1
Historical Groundwater Elevations & Analytical Data
TPH-g, BTEX, MtBE
3519 Castro Valley Blvd, Castro Valley, CA

Monitoring Well	Date	Top of casing elevation ¹ (feet)	Depth to Groundwater (feet)	Groundwater Elevation (feet)	TPH-g (µg/L)	Benzene (µg/L)	Toluene (µg/L)	Ethyl benzene (µg/L)	Total Xylenes (µg/L)	MtBE (µg/L) 8260B
------------------------	-------------	--	------------------------------------	-------------------------------------	---------------------	-----------------------	-----------------------	-----------------------------	-----------------------------	--------------------------

Notes:

< : Not detected above laboratory reporting limit.

1 Top of Casing Elevations were resurveyed by Kier & Wright Engineers Surveyors of Pleasanton, CA on June 21, 2004.

C: Presence confirmed, but RPD between columns exceeds 40%.

H: Heavier hydrocarbons contributed to the quantitation.

NA: Not Analyzed. Due to construction activities in the Third Quarter 2003, which consisted of the replacement of the USTs and dispensers, wells ESE-1 & ESE-2 were inaccessible. Well ESE-2 also inaccessible during the First Quarter 2008 monitoring event. Well MW-7 had a car parked over it and was inaccessible during the First Quarter 2008 monitoring event.

NM: Not Measured

Well ESE-2 was covered over with dirt during the First Quarter 2007 monitoring event.

Well MW-7 had a car parked over it and was inaccessible during the First Quarter 2008 monitoring event.

Equipment Blanks (EB-PRB & EB-PMP) were done to make sure decon efforts were adequate.

Z: Sample exhibits unknown single peak or peaks.

The Third Quarter 2003 was the first time that SOMA analyzed groundwater samples at the site.

The Third Quarter 2004 was the first time that SOMA analyzed groundwater samples at wells SOMA-1 to SOMA-4.

Table 2
Historical Groundwater Analytical Data
Gasoline Oxygenates & Lead Scavengers
3519 Castro Valley Blvd, Castro Valley, CA

Monitoring Well	Date	TBA (µg/L)	DIPE (µg/L)	ETBE (µg/L)	TAME (µg/L)	ETHANOL (µg/L)	1,2-DCA (µg/L)	EDB (µg/L)
ESE-1	6/17/2003	<400	<10	<10	18	NA	NA	NA
	9/17/2003	NA	NA	NA	NA	NA	NA	NA
	12/9/2003	290	<1.0	<1.0	9.5	<2,000	<1.0	<1.0
	2/26/2004	410	<0.5	<0.5	9.7	<1000	<0.5	<0.5
	5/21/2004	190	<0.5	<0.5	<0.5	<1000	<0.5	<0.5
	8/10/2004	180	<0.5	<0.5	<0.5	<1000	<0.5	<0.5
	10/19/2004	270	<0.7	<0.7	4.4	<1400	9.9	<0.7
	1/14/2005	280	<1.3	<1.3	<1.3	<2,500	<1.3	<1.3
	4/14/2005	144	<2.15	<2.15	<8.6	<4300	<2.15	<2.15
	7/7/2005	119	<2.15	<2.15	<8.6	<4300	<2.15	<2.15
	11/15/2005	107	<0.5	<0.5	<2.0	<1000	<0.5	<0.5
	2/8/2006	181	<2.15	<2.15	<8.6	<4300	<2.15	<2.15
	4/27/2006	261	<2.15	<2.15	<8.6	<4300	<2.15	<2.15
	8/1/2006	165	<1.0	<1.0	<4.0	<2000	<1.0	<1.0
	10/19/2006	154	<1.0	<1.0	<4.0	<2000	<1.0	<1.0
	1/12/2007	103	<0.5	<0.5	<2.0	<1000	<0.5	<0.5
	4/17/2007	80.5	<0.5	<0.5	<2.0	<1000	<0.5	<0.5
	7/17/2007	128	<0.5	<0.5	<2.0	<1000	<0.5	<0.5
	10/16/2007	98.7	<0.5	<0.5	<2.0	<1000	<0.5	<0.5
	1/17/2008	61.5	<0.5	<0.5	<0.5	2.52	<1000	<0.5

Table 2
Historical Groundwater Analytical Data
Gasoline Oxygenates & Lead Scavengers
3519 Castro Valley Blvd, Castro Valley, CA

Monitoring Well	Date	TBA (µg/L)	DIPE (µg/L)	ETBE (µg/L)	TAME (µg/L)	ETHANOL (µg/L)	1,2-DCA (µg/L)	EDB (µg/L)
ESE-2	6/17/2003	<4000	<100	<100	<100	NA	NA	NA
	9/17/2003	NA	NA	NA	NA	NA	NA	NA
	12/9/2003	500	<13	<13	77	<25,000	<13	<13
	2/26/2004	1200	<0.5	<0.5	92	<1000	<0.5	<0.5
	5/21/2004	2400	<10	<10	25	<20,000	<10	<10
	8/10/2004	2300	<2.5	<2.5	12	<5000	<2.5	<2.5
	10/19/2004	1800	<3.6	<3.6	8.6	<7100	<3.6	<3.6
	1/14/2005	470	<8.3	<8.3	28	<17,000	<8.3	<8.3
	4/14/2005	<10.8	<2.15	<2.15	17.9	<4300	<2.15	<2.15
	7/7/2005	109	<2.15	<2.15	9.7	<4300	<2.15	<2.15
	11/15/2005	64.7	<0.5	<0.5	3.43	<1000	<0.5	<0.5
	2/8/2006	46.4	<2.15	<2.15	11	<4300	<2.15	<2.15
	4/27/2006	47.7	<1.0	<1.0	8.29	<2000	<1.0	<1.0
	8/1/2006	20.6	<1.0	<1.0	4.67	<2000	<1.0	<1.0
	10/19/2006	28.9	<0.5	<0.5	4.55	<1000	<0.5	<0.5
	1/12/2007	NA	NA	NA	NA	NA	NA	NA
	4/17/2007	60.8	<0.5	<0.5	3.85	<1000	<0.5	<0.5
	7/17/2007	62.3	<0.5	<0.5	2.95	<1000	<0.5	<0.5
	10/16/2007	46	<0.5	<0.5	2.21	<1000	<0.5	<0.5
	1/17/2008	18.8	<0.5	<0.5	3.38	<1000	<0.5	<0.5
ESE-3	6/17/2003	<200	<5.0	<5.0	<5.0	NA	NA	NA
ESE-5	9/17/2003	<10	<0.5	<0.5	<0.5	<1000	<0.5	<0.5
	12/9/2003	<10	<0.5	<0.5	<0.5	<1,000	<0.5	<0.5
	2/26/2004	<10	<0.5	<0.5	<0.5	<1,000	<0.5	<0.5
	5/21/2004	<10	<0.5	<0.5	<0.5	<1,000	<0.5	<0.5
	8/10/2004	<10	<0.5	<0.5	<0.5	<1,000	<0.5	<0.5
	10/19/2004	<10	<0.5	<0.5	<0.5	<1000	<0.5	<0.5

Table 2
Historical Groundwater Analytical Data
Gasoline Oxygenates & Lead Scavengers
3519 Castro Valley Blvd, Castro Valley, CA

Monitoring Well	Date	TBA (µg/L)	DIPE (µg/L)	ETBE (µg/L)	TAME (µg/L)	ETHANOL (µg/L)	1,2-DCA (µg/L)	EDB (µg/L)
ESE-5 cont.	1/14/2005	<10	<0.5	<0.5	<0.5	<1000	<0.5	<0.5
	4/14/2005	17	<0.5	<0.5	<2.0	<1000	<0.5	<0.5
	7/7/2005	<10	<0.5	<0.5	<2.0	<1000	<0.5	<0.5
	11/15/2005	<10	<0.5	<0.5	<2.0	<1000	<0.5	<0.5
	2/8/2006	<10	<0.5	<0.5	<2.0	<1000	<0.5	<0.5
	4/27/2006	<10	<0.5	<0.5	<2.0	<1000	<0.5	<0.5
	8/1/2006	<10	<0.5	<0.5	<2.0	<1000	<0.5	<0.5
	10/19/2006	<10	<0.5	<0.5	<2.0	<1000	<0.5	<0.5
	1/12/2007	<2.0	<0.5	<0.5	<2.0	<1000	<0.5	<0.5
	4/17/2007	8.7	<0.5	<0.5	<2.0	<1000	<0.5	<0.5
	7/17/2007	15.4	<0.5	<0.5	<2.0	<1000	<0.5	<0.5
	10/16/2007	11.5	<0.5	<0.5	<2.0	<1000	<0.5	<0.5
	1/17/2008	17.2	<0.5	<0.5	<2.0	<1000	<0.5	<0.5
	MW-6	9/17/2003	<10	<0.5	<0.5	<0.5	<1000	<0.5
12/9/2003		<10	<0.5	<0.5	<0.5	<1,000	<0.5	<0.5
2/26/2004		<10	<0.5	<0.5	<0.5	<1,000	<0.5	<0.5
5/21/2004		<10	<0.5	<0.5	<0.5	<1,000	<0.5	<0.5
8/10/2004		<10	<0.5	<0.5	<0.5	<1,000	<0.5	<0.5
10/19/2004		<10	<0.5	<0.5	<0.5	<1000	<0.5	<0.5
1/14/2005		<10	<0.5	<0.5	<0.5	<1000	<0.5	<0.5
4/14/2005		<2.5	<0.5	<0.5	<2.0	<1000	<0.5	<0.5
7/7/2005		<10	<0.5	<0.5	<2.0	<1000	<0.5	<0.5
11/15/2005		<10	<0.5	<0.5	<2.0	<1000	<0.5	<0.5
2/8/2006		<10	<0.5	<0.5	<2.0	<1000	<0.5	<0.5
4/27/2006		<10	<0.5	<0.5	<2.0	<1000	<0.5	<0.5
8/1/2006		<10	<0.5	<0.5	<2.0	<1000	<0.5	<0.5
10/19/2006		<10	<0.5	<0.5	<2.0	<1000	<0.5	<0.5
1/12/2007		<2.0	<0.5	<0.5	<2.0	<1000	<0.5	<0.5
4/17/2007		<2.0	<0.5	<0.5	<2.0	<1000	<0.5	<0.5
7/17/2007		<2.0	<0.5	<0.5	<2.0	<1000	<0.5	<0.5
10/16/2007		<2.0	<0.5	<0.5	<2.0	<1000	<0.5	<0.5
1/17/2008	<2.0	<0.5	<0.5	<2.0	<1000	<0.5	<0.5	

Table 2
Historical Groundwater Analytical Data
Gasoline Oxygenates & Lead Scavengers
3519 Castro Valley Blvd, Castro Valley, CA

Monitoring Well	Date	TBA (µg/L)	DIPE (µg/L)	ETBE (µg/L)	TAME (µg/L)	ETHANOL (µg/L)	1,2-DCA (µg/L)	EDB (µg/L)
MW-7	9/17/2003	<10	<0.5	<0.5	9.8	<1000	<0.5	<0.5
	12/9/2003	<25	<1.3	<1.3	8.1	<2500	<1.3	<1.3
	2/26/2004	<10	<0.5	<0.5	9.9	<1000	<0.5	<0.5
	5/21/2004	<10	<0.5	<0.5	<0.5	<1,000	<0.5	<0.5
	8/10/2004	<25	<1.3	<1.3	19	<2500	<1.3	<1.3
	10/19/2004	<100	<5.0	<5.0	11	<10,000	<5.0	<5.0
	1/14/2005	<40	<2.0	<2.0	5.1	<4,000	<2.0	<2.0
	4/14/2005	2.62	<0.5	<0.5	4.57	<1000	<0.5	<0.5
	7/7/2005	55.6	<1.0	<1.0	10.2	<2000	<1.0	<1.0
	11/15/2005	10.6	<0.5	<0.5	2.07	<1000	<0.5	<0.5
	2/8/2006	<10	<0.5	<0.5	2.19	<1000	<0.5	<0.5
	4/27/2006	<10	<0.5	<0.5	2.63	<1000	<0.5	<0.5
	8/1/2006	<10	<0.5	<0.5	<2.0	<1000	<0.5	<0.5
	10/19/2006	<10	<0.5	<0.5	<2.0	<1000	<0.5	<0.5
	1/12/2007	<2.0	<0.5	<0.5	<2.0	<1000	<0.5	<0.5
	4/17/2007	11.6	<0.5	<0.5	<2.0	<1000	<0.5	<0.5
	7/17/2007	13.3	<0.5	<0.5	<2.0	<1000	<0.5	<0.5
10/16/2007	<2.0	<0.5	<0.5	<2.0	<1000	<0.5	<0.5	
1/17/2008	NA	NA	NA	NA	NA	NA	NA	
SOMA-1	8/10/2004	2300	<6.3	<6.3	53	<13000	<6.3	<6.3
	10/19/2004	2400	<13	<13	36	<25,000	<13	<13
	1/14/2005	530	<3.1	<3.1	7.1	<6,300	<3.1	<3.1
	4/14/2005	<27.5	<5.5	<5.5	<22	<11000	<5.5	<5.5
	7/7/2005	2180	<2.15	<2.15	12.9	<4300	<2.15	<2.15
	11/15/2005	792	<0.5	<0.5	5.01	<1000	<0.5	<0.5
	2/8/2006	618	<0.5	<0.5	3.67	<1000	<0.5	<0.5
	4/27/2006	983	<0.5	<0.5	3.48	<1000	<0.5	<0.5
	8/1/2006	639	<0.5	<0.5	2.27	<1000	<0.5	<0.5
	10/19/2006	603	<0.5	<0.5	2.25	<1000	<0.5	<0.5

Table 2
Historical Groundwater Analytical Data
Gasoline Oxygenates & Lead Scavengers
3519 Castro Valley Blvd, Castro Valley, CA

Monitoring Well	Date	TBA (µg/L)	DIPE (µg/L)	ETBE (µg/L)	TAME (µg/L)	ETHANOL (µg/L)	1,2-DCA (µg/L)	EDB (µg/L)
SOMA-1 cont.	1/12/2007	396	<0.5	<0.5	<2.0	<1000	<0.5	<0.5
	4/17/2007	148	<0.5	<0.5	<2.0	<1000	<0.5	<0.5
	7/17/2007	555	<0.5	<0.5	<2.0	<1000	<0.5	<0.5
	10/16/2007	65	<0.5	<0.5	<2.0	<1000	<0.5	<0.5
	1/17/2008	29.6	<0.5	<0.5	2.06	<1000	<0.5	<0.5
SOMA-2	8/10/2004	<10	<0.5	<0.5	<0.5	<1000	<0.5	<0.5
	10/19/2004	<10	<0.5	<0.5	<0.5	<1000	<0.5	<0.5
	1/14/2005	<10	<0.5	<0.5	<0.5	<1000	<0.5	<0.5
	4/14/2005	<2.5	<0.5	<0.5	<2.0	<1000	<0.5	<0.5
	7/7/2005	<10	<0.5	<0.5	<2.0	<1000	<0.5	<0.5
	11/15/2005	<10	<0.5	<0.5	<2.0	<1000	<0.5	<0.5
	2/8/2006	<10	<0.5	<0.5	<2.0	<1000	<0.5	<0.5
	4/27/2006	<10	<0.5	<0.5	<2.0	<1000	<0.5	<0.5
	8/1/2006	<10	<0.5	<0.5	<2.0	<1000	<0.5	<0.5
	10/19/2006	<10	<0.5	<0.5	<2.0	<1000	<0.5	<0.5
	1/12/2007	<2.0	<0.5	<0.5	<2.0	<1000	<0.5	<0.5
	4/17/2007	14.6	<0.5	<0.5	<2.0	<1000	<0.5	<0.5
	7/17/2007	2.58	<0.5	<0.5	<2.0	<1000	<0.5	<0.5
	10/16/2007	<2.0	<0.5	<0.5	<2.0	<1000	<0.5	<0.5
1/17/2008	<2.0	<0.5	<0.5	<2.0	<1000	<0.5	<0.5	
SOMA-3	8/10/2004	<10	<0.5	<0.5	<0.5	<1000	<0.5	<0.5
	10/19/2004	<10	<0.5	<0.5	<0.5	<1,000	<0.5	<0.5
	1/14/2005	<10	<0.5	<0.5	<0.5	<1,000	<0.5	<0.5
	4/14/2005	<2.5	<0.5	<0.5	<2.0	<1000	<0.5	<0.5
	7/7/2005	<10	<0.5	<0.5	<2.0	<1000	<0.5	<0.5
	11/15/2005	<10	<0.5	<0.5	<2.0	<1000	<0.5	<0.5
	2/8/2006	<10	<0.5	<0.5	<2.0	<1000	<0.5	<0.5
	4/27/2006	<10	<0.5	<0.5	<2.0	<1000	<0.5	<0.5
	8/1/2006	<10	<0.5	<0.5	<2.0	<1000	<0.5	<0.5
	10/19/2006	<10	<0.5	<0.5	<2.0	<1000	<0.5	<0.5
	1/12/2007	<2.0	<0.5	<0.5	<2.0	<1000	<0.5	<0.5
	4/17/2007	6.72	<0.5	<0.5	<2.0	<1000	<0.5	<0.5
	7/17/2007	7.6	<0.5	<0.5	<2.0	<1000	<0.5	<0.5
	10/16/2007	9.96	<0.5	<0.5	<2.0	<1000	<0.5	<0.5
1/17/2008	<2.0	<0.5	<0.5	<2.0	<1000	<0.5	<0.5	

Table 2
Historical Groundwater Analytical Data
Gasoline Oxygenates & Lead Scavengers
3519 Castro Valley Blvd, Castro Valley, CA

Monitoring Well	Date	TBA (µg/L)	DIPE (µg/L)	ETBE (µg/L)	TAME (µg/L)	ETHANOL (µg/L)	1,2-DCA (µg/L)	EDB (µg/L)
SOMA-4	8/10/2004	<10	<0.5	<0.5	<0.5	<1000	<0.5	<0.5
	10/19/2004	<10	<0.5	<0.5	<0.5	<1,000	<0.5	<0.5
	1/14/2005	<10	<0.5	<0.5	<0.5	<1,000	<0.5	<0.5
	4/14/2005	<2.5	<0.5	<0.5	<2.0	<1000	<0.5	<0.5
	7/7/2005	<10	<0.5	<0.5	<2.0	<1000	<0.5	<0.5
	11/15/2005	<10	<0.5	<0.5	<2.0	<1000	<0.5	<0.5
	2/8/2006	<10	<0.5	<0.5	<2.0	<1000	<0.5	<0.5
	4/27/2006	<10	<0.5	<0.5	<2.0	<1000	<0.5	<0.5
	8/1/2006	<10	<0.5	<0.5	<2.0	<1000	<0.5	<0.5
	10/19/2006	<10	<0.5	<0.5	<2.0	<1000	<0.5	<0.5
	1/12/2007	<2.0	<0.5	<0.5	<2.0	<1000	<0.5	<0.5
	4/17/2007	3.98	<0.5	<0.5	<2.0	<1000	<0.5	<0.5
	7/17/2007	6.31	<0.5	<0.5	<2.0	<1000	<0.5	<0.5
	10/16/2007	<2.0	<0.5	<0.5	<2.0	<1000	<0.5	<0.5
	1/17/2008	<2.0	<0.5	<0.5	<2.0	<1000	<0.5	<0.5
EB-PMP	1/17/2008	<2.0	<0.5	<0.5	<2.0	<1000	<0.5	<0.5
EB-PRB	1/17/2008	<2.0	<0.5	<0.5	<2.0	<1000	<0.5	<0.5
EB-PMP2	1/17/2008	<2.0	<0.5	<0.5	<2.0	<1000	<0.5	<0.5
EB-PRB2	1/17/2008	<2.0	<0.5	<0.5	<2.0	<1000	<0.5	<0.5

Notes:

< : Not detected above laboratory reporting limit.

NA: Not Analyzed. Due to construction activities in the Third Quarter 2003, which consisted of the replacement of the USTs and dispensers, wells ESE-1 & ESE-2 were inaccessible.

Well ESE-2 was inaccessible during the First Quarter 2007, dirt was covered over well

Well MW-7 had a car parked over it and was inaccessible during the First Quarter 2008 monitoring event.

The Third Quarter 2003 was the first time that SOMA analyzed groundwater samples at the Site.

The Third Quarter 2004 was the first time that SOMA analyzed groundwater samples at wells SOMA-1 to SOMA-4.

Gasoline Oxygenates:

TBA: tertiary butyl alcohol

DIPE: isopropyl ether

ETBE: ethyl tertiary butyl ether

TAME: methyl tertiary amyl ether

Ethanol

Lead Scavengers:

1,2-DCA: 1,2-Dichloroethane

EDB: 1,2-Dibromoethane