

RECEIVED

By dehloptoxic at 8:08 am, Mar 06, 2007

2307 Pacific Ave.
Alameda, CA 94552
Phone: 510-865-9503
Fax: 510-865-1889
E-Mail: xtraoil@sbeglobal.net

.....
Xtra Oil Company

February 2, 2007

Mr. Steven Plunkett
Alameda County Environmental Health Department
1131 Harbor Bay Parkway, Suite 250
Alameda, CA 94502

**SUBJECT: QUARTERLY GROUNDWATER MONITORING AND SAMPLING REPORT
(JUNE THROUGH NOVEMBER 2006) CERTIFICATION**
County Case # RO 285
Xtra Oil Company
3495 Castro Valley Blvd.
Castro Valley, CA

Dear Mr. Plunkett:

P&D Environmental, Inc. has prepared the following report:

- Quarterly Groundwater Monitoring and Sampling Report (June through November 2006) dated January 22, 2007 (document 0014.R62).

I declare under penalty of perjury that the contents and conclusions in the report are true and correct to the best of my knowledge.

Should you have any questions, please do not hesitate to contact me at (510) 865-9503.

Sincerely,

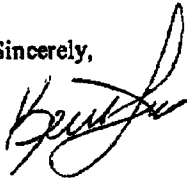

Keith Simas
Operations Supervisor

0014.L129

.....
Retail Fueling Convenience Stores

P & D ENVIRONMENTAL, INC.

55 Santa Clara Ave, Suite 240

Oakland, CA 94610

(510) 658-6916

January 22, 2007

Report 0014.R62

Mr. Ted Simas
Mr. Keith Simas
Xtra Oil Company
2307 Pacific Ave.
Alameda, CA 94501

SUBJECT: QUARTERLY GROUNDWATER MONITORING AND SAMPLING REPORT
(JUNE THROUGH NOVEMBER 2006)

Xtra Oil Company
3495 Castro Valley Blvd.
Castro Valley, California

Gentlemen:

P&D Environmental, Inc. (P&D) is pleased to present this report documenting the results of the most recent quarterly monitoring and sampling of both the on- and off-site wells for the subject property. This work was performed in accordance with P&D's proposal 020599.P1 dated February 5, 1999. Offsite observation wells OW1 and OW2 and onsite wells MW1, MW3, MW4, and EW1 were monitored and wells MW1, MW3, and EW1 were sampled on November 14, 2006. The reporting period is for June through November 2006. A Site Location Map (Figure 1), a Site Plan showing onsite well locations (Figure 2), and a Site Vicinity Map showing offsite observation well locations (Figure 3) are attached with this report.

BACKGROUND

The site is currently used as a gasoline station. Four 12,000 gallon underground fuel storage tanks are present at the site. Three of the tanks contain gasoline and the fourth tank contains diesel fuel. A 550 gallon waste oil tank was removed from the site in November 1988. The fuel tanks were replaced during August 1992.

Three monitoring wells, designated MW1, MW2 and MW3, were installed at the site on February 14 and 15, 1990 by Western Geo-Engineers. The subsurface materials encountered in the boreholes consisted primarily of silt and clay. The locations of the monitoring wells are shown on Figure 2. Soil samples collected during drilling of the boreholes for the monitoring wells revealed the presence of total petroleum hydrocarbons as gasoline (TPH-G) and total petroleum hydrocarbons as diesel (TPH-D). TPH-G was encountered in borehole MW1 at depths of 5 and 10 feet below grade at concentrations of 40 and 1,400 mg/kg, respectively; in borehole MW2 at depths of 10 and 15 feet below grade at concentrations of 230 and 95 mg/kg, respectively; and in borehole MW3 at depths of 5, 10, and 15 feet at concentrations of 140, 250 and 25 mg/kg, respectively. In addition, 120 mg/kg TPH-D was detected in borehole MW3 at a depth of 5 feet. Soil samples collected at a depth of 20 feet in borehole MW1 and at a depth of 18 feet in boreholes in MW2 and MW3 did not show any detectable concentrations of TPH-G or TPH-D. Groundwater was encountered in the boreholes at depths of approximately 15 to 16 feet below grade.

January 22, 2007
Report 0014.R62

On February 15, 1990 Western Geo-Engineers drilled three exploratory boreholes at the site designated as SB1, SB2 and SB3. The subsurface materials encountered in the boreholes consisted primarily of silt and clay. The approximate locations of the boreholes are shown on Figure 2. It is P&D's understanding that soil samples were collected from the exploratory boreholes at depths of 10 and 12 feet and evaluated in the field using a photoionization detector. In borehole SB1, TPH-G was detected at the depths of 10 and 12 feet at concentrations of 1,700 and 450 mg/kg, respectively. In boreholes SB2 and SB3, TPH-G was detected at the depths of 10 and 12 feet in both boreholes at concentrations of 800 mg/kg and greater than 2,000 mg/kg, respectively. A groundwater monitoring and sampling program was initiated at the site on February 20, 1990.

It is P&D's understanding that during fuel tank replacement activities in August, 1992 soil surrounding the tank pit was removed and disposed of offsite. An extraction well, designated as EW1, was designed and constructed in one corner of the new tank pit by K&B Environmental at the time of installation of the new tanks. The location of EW1 is shown on Figure 2.

On February 7, 1996 well MW2 was destroyed for the purpose of widening Redwood Road. The destruction was overseen by ACC Environmental Consultants of Oakland, California.

On August 15, 1997 P&D personnel oversaw the installation of one groundwater monitoring well, designated as MW4, at the subject site. The location of the monitoring well is shown on the attached Site Plan, Figure 2. This work was performed in accordance with P&D's work plan 0014.W4 dated June 27, 1997. The work plan was approved by the Alameda County Department of Environmental Health (ACDEH) in a telephone conversation with Mr. Scott Seery on August 14, 1997. During the conversation, Mr. Seery indicated that he would record his approval of the work plan in the county file for the site. In accordance with an October 25, 2002 letter from Mr. Seery, groundwater samples are to be analyzed for fuel oxygenates methyl tertiary-butyl ether (MTBE), tertiary amyl methyl ether (TAME), ethyl tertiary-butyl ether (ETBE), diisopropyl ether (DIPE), and tertiary-butyl alcohol (TBA), and lead scavengers ethylene dibromide (EDB), 1,2-dichloroethane (1,2-DCA) using EPA Method 8260; and data for observation wells OW1 and OW2, located in Redwood Road, are to be incorporated into monitoring and sampling reports for the subject site.

On May 31, 2005, P&D submitted an Interim Source Area Remediation Plan (ISARP) to ACDEH proposing free product removal at the site (document 0014.W9). P&D proposed using existing extraction well EW1 in the existing UST pit to dewater the existing pit and the previous UST pit. Monitoring of existing wells MW1, MW3, and MW4 to evaluate the effectiveness of water table drawdown at the site for plume control and associated free product recovery was also proposed.

FIELD ACTIVITIES

Offsite observation wells OW1 and OW2 and onsite wells MW1, MW3, MW4, and EW1 were monitored, and MW1, MW3, and EW1 were sampled on November 14, 2006. It is unknown if the monitoring of the wells at the neighboring site on the southeast corner of the intersection of Redwood Road and Castro Valley Boulevard was conducted by others during the quarter.

The wells at the subject site were monitored for depth to water and the presence of free product or sheen. In well MW4 the depth to water and depth to free product was measured to the nearest 1/32-inch with a steel tape and water-finding or product-finding paste. The passive hydrocarbon

collection device in well MW4 was removed by P&D personnel and placed in storage near MW1 during pressure transducer installation in well MW4 on November 2, 2006. In wells OW1, OW2, MW1, MW3, and EW1, the depth to water was measured to the nearest 0.01 foot using an electric water level indicator. The presence of free product and sheen was evaluated using a transparent bailer in wells MW1, MW3, and EW1. Approximately 0.25 feet of free product was measured in well MW4. Although no water was detected in well OW1, petroleum hydrocarbon sheen was detected on the electric water level indicator probe in well OW1.

After monitoring, wells OW1 and OW2 were not purged because inadequate water was present in the wells for sample collection. No sample was collected from MW4 due to the presence of free product in the well.

Prior to well sampling on November 14, 2006, onsite wells MW1, MW3, and EW1 were purged of a minimum of three casing volumes of water or until the wells had been purged dry. Petroleum hydrocarbon odors were detected from the purge water from all sampled wells, and petroleum hydrocarbon sheen was detected on the purge water from wells MW1 and MW3.

During purging operations, the field parameters of electrical conductivity, temperature, and pH were monitored. Once the field parameters were observed to stabilize, a minimum of three casing volumes had been purged, or the wells had purged dry and partially recovered, water samples were collected using a clean Teflon bailer. Records of the field parameters measured during well purging are included with this report.

The water samples were transferred to 40-milliliter glass VOA vials and 1-liter amber glass bottles that were sealed with Teflon-lined screw caps. The VOA vials were overturned and tapped to ensure that no air bubbles were present.

The VOA vials and bottles were then transferred to a cooler with ice, until they were transported to McCampbell Analytical, Inc. in Pittsburg, California. McCampbell Analytical, Inc. is a State-certified hazardous waste testing laboratory. Chain of custody documentation accompanied the samples to the laboratory.

HYDROGEOLOGY

Water levels were measured in all of the wells once during the reporting period. On November 14, 2006, the measured depth to water in wells MW1, MW3, MW4, and EW1 was 7.38, 7.53, 7.36, and 6.88 feet, respectively. A separate phase hydrocarbon layer measuring 0.25 feet in thickness was measured in well MW4. Using a specific gravity of 0.75, the corrected depth to water in well MW4 is 7.17 feet. No water was measured in wells OW1 or OW2. Since the previous monitoring on June 29, 2006 the groundwater elevations have increased in wells MW1, MW3, and EW1 by 0.42, 0.05 and 0.77 feet, respectively. It was not possible to determine the change in groundwater elevation for wells MW4, OW1, and OW2 because the depth to water was not measured in well MW4 during the previous monitoring and sampling event and no water was measured in wells OW1 and OW2 during the current monitoring and sampling event.

Based on the measured depth to groundwater in the groundwater monitoring wells, the apparent groundwater flow direction at the site on November 14, 2006 was calculated to be to the south-

southeast with a gradient of 0.0099. During the previous quarterly monitoring and sampling event on June 29, 2006, the groundwater flow direction was not calculated due to absence of water level information for well MW4. During the quarterly monitoring and sampling event on February 3, 2006, the groundwater flow direction was calculated to be to the southeast with a gradient of 0.0035. The groundwater flow direction at the site on November 14, 2006 is shown on Figure 2.

LABORATORY RESULTS

All of the groundwater samples collected on November 14, 2006 were analyzed for TPH Multirange (TPH-G, TPH-D, and TPH-MO) using EPA Methods 5030B and 3510C in conjunction with Modified EPA Method 8015C; and for benzene, toluene, ethylbenzene, and total xylenes (BTEX), fuel oxygenates MTBE, TAME, ETBE, TAME, and TBA, and for lead scavengers EDB and 1,2-DCA/EDC using EPA Method 5030B in conjunction with EPA Method 8260B.

The laboratory analytical results for the samples from onsite wells MW1, MW3, and EW1 show TPH-D concentrations of 7.2, 21, and 1.8 mg/L, respectively. Review of the laboratory analytical reports shows that the TPH-D results for all of these samples are described as consisting of both diesel- and gasoline-range compounds. Laboratory results for the samples from wells MW1, MW3, and EW1 show TPH-G concentrations of 30, 100, and 0.87 mg/L, respectively. Benzene was detected in wells MW1 and MW3 at concentrations of 2.2 and 37 respectively, and was not detected in well EW1. MTBE was detected in wells MW1, MW3, and EW1 at concentrations of 0.44, 23, and 0.17 mg/L, respectively. No other fuel oxygenates or lead scavengers were detected except for TBA in wells MW3 and EW1 at concentrations of 16 and 5.9 mg/L, respectively.

Since the previous sampling on June 29, 2006, concentrations of TPH-D, TPH-G, BTEX, fuel oxygenates and lead scavenger have either remained not detected or decreased in well MW1. In well MW3, all analyte concentrations have increased with the exception of MTBE, which decreased.

In well EW1, TPH-D, TPH-G, MTBE, and TBA concentrations have increased since the previous sampling event, while BTEX concentrations remained not detected. The laboratory analytical results for the groundwater samples are summarized in Table 2. Copies of the laboratory analytical reports and chain of custody documentation are included with this report.

DISCUSSION AND RECOMMENDATIONS

Offsite observation wells OW1 and OW2 and onsite wells MW1, MW3, MW4, and EW1 were monitored, and wells MW1, MW3, and EW1 were sampled on November 14, 2006. Separate phase hydrocarbons were detected in well MW4 at a thickness of approximately 0.25 feet. The passive hydrocarbon collection device in well MW4 was removed on November 2, 2006, by P & D personnel during pressure transducer installation.

The laboratory analytical results for the groundwater samples from onsite wells MW1, MW3, and EW1 showed TPH-D concentrations ranging from 1.8 to 21 mg/L, TPH-G concentrations ranging from 0.87 to 100 mg/L, and benzene concentrations ranging from not detected to 37 mg/L. Review of the results for the fuel oxygenate and lead scavenger analysis shows that MTBE was detected in wells MW1, MW3, and EW1, with concentrations ranging from 0.17 to 23 mg/L, and TBA was detected in wells MW3 and EW1 at a concentrations of 16 and 5.9 mg/L, respectively. No other fuel oxygenates were detected in any of the wells. BTEX concentrations ranged from not detected to 11

mg/L. Neither of offsite wells OW1 or OW2 contained sufficient water for sample collection.

Based on the laboratory analytical results of the water samples collected from the monitoring wells, P&D recommends that groundwater monitoring and sampling be continued. In addition, P&D recommends that future monitoring and sampling efforts be coordinated with other sites in the vicinity of the subject site that are presently being monitored and sampled.

DISTRIBUTION

A copy of this report will be uploaded to the ACDEH website, in accordance with ACDEH requirements. In addition, a copy of this report will be uploaded to the GeoTracker database.

LIMITATIONS

This report was prepared solely for the use of Xtra Oil Company. The content and conclusions provided by P&D in this assessment are based on information collected during our investigation, which may include, but not be limited to, visual site inspections; interviews with the site owner, regulatory agencies and other pertinent individuals; review of available public documents; subsurface exploration and our professional judgment based on said information at the time of preparation of this document. Any subsurface sample results and observations presented herein are considered to be representative of the area of investigation; however, geological conditions may vary between borings and may not necessarily apply to the general site as a whole. If future subsurface or other conditions are revealed which vary from these findings, the newly revealed conditions must be evaluated and may invalidate the findings of this report.

This report is issued with the understanding that it is the responsibility of the owner, or his representative, to ensure that the information contained herein is brought to the attention of the appropriate regulatory agencies, where required by law. Additionally, it is the sole responsibility of the owner to properly dispose of any hazardous materials or hazardous wastes left onsite, in accordance with existing laws and regulations.

This report has been prepared in accordance with generally accepted practices using standards of care and diligence normally practiced by recognized consulting firms performing services of a similar nature. P&D is not responsible for the accuracy or completeness of information provided by other individuals or entities which is used in this report. This report presents our professional judgment based upon data and findings identified in this report and interpretation of such data based upon our experience and background, and no warranty, either express or implied, is made. The conclusions presented are based upon the current regulatory climate and may require revision if future regulatory changes occur.

January 22, 2007
Report 0014.R62

Should you have any questions, please do not hesitate to contact us at (510) 658-6916.

Sincerely,

P&D Environmental, Inc.



David M. Gibbs
Geosciences Department Manager
Professional Geologist #7804
Expires: 2/28/07



Attachments: Tables 1 & 2
Site Location Map (Figure 1)
Site Plan (Figure 2)
Site Vicinity Map (Figure 3)
Well Monitoring and Purge Data Sheets
Laboratory Analytical Reports and
Chain of Custody Documentation

PHK/DMG/sjc
0014.R62

TABLES

TABLE 1
WELL MONITORING DATA

Well No.	Date Monitored	Top of Casing Elev. (ft.)	Depth to Water (ft.)	Water Table Elev. (ft.)
MW1	11/14/06	177.37*	7.38	169.99
	06/29/06		7.80	169.57
	02/03/06		6.65	170.72
	11/18/05		8.17	169.20
	07/28/05		7.98	169.39
	04/13/05		6.90	170.47
	01/31/05		7.20	170.17
	10/15/04		8.52	168.85
	07/13/04		8.33	169.04
	04/06/04		7.93	169.44
	12/18/03		7.65	169.72
	09/18/03		8.15	169.22
	06/19/03		8.13	169.24
	03/18/03		7.77	169.60
	12/21/02		5.74	171.63
	9/10/02		8.28	169.09
	3/30/02		7.43	169.94
	12/22/01		6.92	170.45
	9/23/01		8.53	168.84
	6/22/01		8.30	169.07
	4/22/01		7.77	169.60
	12/14/00		8.49	168.88
	9/18/00		8.56	168.81
	6/08/00		7.97	169.40
	3/09/00		6.68	170.69
	12/09/99		8.15	169.22
	8/31/99		8.36	169.01
	4/29/99		7.68	169.69

NOTES:

* = Surveyed on August 20, 1997

TABLE 1
 WELL MONITORING DATA

Well No.	Date Monitored	Top of Casing Elev. (ft.)	Depth to Water (ft.)	Water Table Elev. (ft.)
MW1 (Continued)	1/29/99	177.37*	6.99	170.38
	4/26/98		7.50	169.87
	1/24/98		6.61	170.76
	11/06/97		8.79	168.58
	8/26/97	177.37*	8.51	168.86
	7/24/97		8.71	168.72
	4/25/97		7.98	169.45
	1/20/97		7.12	170.31
	7/26/96		8.39	169.04
	7/09/96		8.16	169.27
	4/23/96		7.47	169.96
	2/07/96		6.09	171.34
	1/29/96		6.17	171.26
	10/26/95		8.45	168.98
	7/28/95		8.27	169.16
	5/02/95		6.96	170.47
	2/23/95		7.72	169.71
	11/18/94		7.14	170.29
	8/22/94		8.67	168.76
	5/19/94	177.43**	8.05	169.38
	2/28/94		7.44	169.99
	11/24/93		8.74	168.69
	8/30/93		8.78	168.65
	5/18/93		8.12	169.31
	2/23/93		7.34	170.09
	11/13/92	200.00***	9.13	190.87
	5/29/92	175.73	8.59	167.14
	1/14/92		8.57	167.16
	12/23/91		9.65	166.08
	11/25/91		9.41	166.32
10/10/91		9.70	166.03	
9/17/91		9.50	166.23	
8/19/91		9.31	166.42	

NOTES:

* = Surveyed on August 20, 1997

** = Surveyed on March 24, 1993

*** = Surveyed on December 5, 1992

TABLE 1
 WELL MONITORING DATA

Well No.	Date Monitored	Top of Casing Elev. (ft.)	Depth to Water (ft.)	Water Table Elev. (ft.)
MW2	NOT MEASURED (DESTROYED ON FEBRUARY 7, 1996)			
	2/07/96	176.04**	5.70	170.34
	1/29/96		5.16	170.88
	10/26/95		8.21	167.83
	7/28/95		7.99	168.05
	5/02/95		6.79	169.25
	2/23/95		7.51	168.53
	11/18/94		6.92	169.12
	8/22/94		8.59	167.45
	5/19/94		7.70	168.34
	2/28/94		6.99	169.05
	11/24/93		8.47	167.57
	8/30/93		8.64	167.40
	5/18/93		7.73	168.31
	2/23/93		6.39	169.65
	11/13/92	198.61***	8.70	189.91
	5/29/92	175.45	9.31	166.14
	1/14/92		8.97	166.48
	12/23/91		10.39	165.06
	11/25/91		9.81	165.64
	10/10/91		10.39	165.06
	9/17/91		10.23	165.22
	8/19/91		9.60	165.85

NOTES:

* = Surveyed on August 20, 1997

** = Surveyed on March 24, 1993

*** = Surveyed on December 5, 1992

TABLE 1
 WELL MONITORING DATA

Well No.	Date Monitored	Top of Casing Elev. (ft.)	Depth to Water (ft.)	Water Table Elev. (ft.)
MW3	11/14/06	176.40*	7.53	168.87
	06/29/06	7.58	168.82	
	02/03/06		6.10	170.30
	11/18/05		7.63	168.77
	07/28/05		7.58	168.82
	04/13/05		6.35	170.05
	01/31/05		6.79	169.61
	10/15/04		8.28	168.12
	07/13/04		8.11	168.29
	04/06/04		7.41	168.99
	12/18/03		6.99	169.41
	09/18/03		7.91	168.49
	06/19/03		7.60	168.80
	03/18/03		7.35	169.05
	12/21/02		5.43	170.97
	9/10/02		7.97	168.43
	3/30/02		6.97	169.43
	12/22/01		6.44	169.96
	9/23/01		8.17	168.23
	6/22/01		8.06	168.34
4/22/01		7.50	168.90	
12/14/00		8.13	168.27	
9/18/00		7.83	168.57	
9/26/00		7.77	168.63	
6/08/00		7.50	168.90	
3/09/00		6.08	170.32	
12/09/99		7.90	168.50	

NOTES:

- * = Surveyed on August 20, 1997
- ** = Surveyed on March 24, 1993
- *** = Surveyed on December 5, 1992

TABLE 1
WELL MONITORING DATA

Well No.	Date Monitored	Top of Casing Elev. (ft.)	Depth to Water (ft.)	Water Table Elev. (ft.)
MW3	8/31/99	176.41**	7.95	168.45
(Continued)	4/29/99		7.09	169.31
	1/29/99		6.42	169.98
	4/26/98		6.85	169.55
	1/24/98		5.90	170.50
	11/06/97		7.80	168.80
	8/26/97		7.67	168.93
	7/24/97	176.41**	7.90	168.51
	4/25/97		7.12	169.29
	1/20/97		6.35	170.06
	7/26/96		7.84	169.57
	7/09/96		7.61	168.80
	4/23/96		6.81	169.60
	2/07/96		5.05	170.36
	1/29/96		5.77	170.64
	10/26/95		7.72	168.69
	7/28/95		7.80	168.61
	5/02/95		6.50	169.91
	2/23/95		7.24	169.17
	11/18/94		6.05	170.36
	8/22/94	190.97***	7.65	168.76
	5/19/94		7.15	169.26
	2/24/94		6.68	169.73
	11/24/93		7.55	168.86
	8/30/93		7.64	168.77
	5/18/93		7.12	169.29
	2/23/93		8.01	168.40
	11/13/92		7.86	191.12
	5/29/92	175.00	8.45	166.55
	1/14/92		8.24	166.55
	12/23/91		9.37	165.63
	11/25/91		9.19	165.81
	10/10/91		9.43	165.57
	9/17/91		9.20	165.80
	8/19/91		8.95	166.05

NOTES:

* = Surveyed on August 20, 1997

** = Surveyed on March 24, 1993

*** = Surveyed on December 5, 1992

TABLE 1
WELL MONITORING DATA

Well No.	Date Monitored	Top of Casing Elev. (ft.)	Depth to Water (ft.)	Water Table Elev. (ft.)
MW4	11/14/06	176.35*	7.36 (0.25)#	169.18
	06/29/06		Unknown	Unknown
	02/03/06		5.86	170.49
	11/18/05		7.99 (0.51)#	168.36
	07/28/05		7.59	168.76
	04/13/05		6.78 (0.01)#	169.58
	01/31/05		7.34 (0.19)#	169.15
	10/15/04		8.73 (0.15)#	167.73
	07/13/04		8.44 (0.03)#	167.93
	04/06/04		9.58 (2.83)#	168.89
	02/11/04		9.43 (2.70)#	168.95
	12/18/03		9.75 (1.51)#	167.73
	9/18/03		9.13 (1.80)#	168.57
	6/19/03		8.56 (0.31)#	168.02
	3/18/03		7.49 (0.06)#	168.91
	12/21/02		8.58 (4.39)#	171.06
	9/10/02		9.09 (1.60)#	168.46
	3/30/02		9.86 (2.49)#	168.36
	12/22/01		7.79 (1.75)#	169.87
	9/23/01		8.97 (1.17)#	168.26
	6/22/01		7.79	168.56
	4/22/01		9.07 (2.20)#	168.93
	12/14/00		8.87 (0.72)#	168.02
	9/18/00		8.50 (0.45)#	168.19
	6/08/00		7.34	169.01
	3/09/00		6.61 (0.46)#	170.08
	12/09/99		8.80	167.55
	8/31/99		8.28	168.07
	4/29/99		7.14	169.21
	1/29/99		6.68	169.67
4/26/98	6.87	169.48		
1/24/98	6.61	169.74		
11/06/97	9.16	167.19		
8/26/97	8.92	167.43		
8/20/97	7.66 (prior to development)			

NOTES:

* = Surveyed on August 20, 1997

= Indicates free product thickness in feet. The water table elevation has been corrected for the presence of free product by assuming a free product specific gravity of 0.75.

TABLE 1
WELL MONITORING DATA

Well No.	Date Monitored	Top of Casing Elev. (ft.)	Depth to Water (ft.)
EW1	11/14/06	Not Surveyed	6.11
	06/29/06		6.88
	02/03/06		5.23
	11/18/05		6.63
	07/28/05		6.94
	04/13/05		5.23
	01/31/05		6.25
	10/15/04		7.65
	07/13/04		7.51
	04/06/04		6.63
	12/18/03		6.72
09/18/03	7.29		

TABLE 1
 WELL MONITORING DATA

Well No.	Date Monitored	Top of Casing Elev. (ft.)	Depth to Water (ft.)	Total Well Depth (ft.)
OW1	11/14/06	Not Surveyed	No Water (sheen)	7.41
	06/29/06		7.13	7.42
	02/03/06		6.97	7.45
	11/18/05		7.43 (0.13)#	7.50
	07/28/05		7.06 (0.01)#	7.45
	04/13/05		6.99	7.44
	01/31/05		7.03	7.44
	10/15/04		7.19 (0.08)#	7.44
	07/14/04		7.02	7.44
	04/06/04		7.01	7.44
	02/11/04		7.01	7.44
	10/06/03		7.07 (0.01)#	7.44
	11/02/00		7.12,+	
	12/09/99		7.27	
	01/29/99		7.12	
OW2	11/14/06	Not Surveyed	7.27	7.28
	06/29/06		7.30	7.33
	02/03/06		7.08	7.35
	11/18/05		7.33	7.35
	07/28/05		7.27	7.32
	04/13/05		7.06	7.35
	01/31/05		7.29	7.37
	10/15/04		No Water or Product	7.35
	07/14/04		No Water or Product	7.35
	04/06/04		7.27	7.33
	02/11/04		7.19	7.33
	10/06/03		7.29	7.34
	11/02/00		7.19	
	12/09/99		7.17	
	01/29/99		7.19	

NOTES:

= Indicates free product thickness in feet. The water table elevation has been corrected for the presence of free product by assuming a free product specific gravity of 0.75.

+ = Petroleum hydrocarbon odor reported on probe for water level indicator.

TABLE 2
SUMMARY OF LABORATORY ANALYTICAL RESULTS
Well MW1

Date	TPH-D	TPH-G	MTBE	Benzene	Toluene	Ethyl- benzene	Total Xylenes	Other Fuel Additives by 8260*
11/14/06	7.2, b	30	0.44	2.2	0.60	1.8	2.9	ND<0.05, except TBA ND<0.5, Ethanol ND<5.0, Methanol ND<50.0
6/29/06	22,b	45	1.2	3.1	0.94	2.0	3.9	ND<0.05, TBA ND<0.5
02/03/06	9.7,c	37	0.62	2.2	1.2	2.0	3.5	ND<0.05, TBA ND<0.5
11/18/05	4.3,b	25	0.14	1.6	0.43	1.8	2.7	ND<0.05, TBA ND<0.5
7/28/05	16,a,b	30,a	0.26,+	2.5	0.76	2.1	4.8	ND<0.05, TBA ND<0.5
4/13/05	9.3,b	30	0.3	1.9	0.6	1.7	3	ND<0.05, TBA ND<0.5
1/31/05	14,b	29	0.27	2.2	1.2	1.9	5.0	ND<0.05, TBA ND<0.5

NOTES:

TPH-G = Total Petroleum Hydrocarbons as Gasoline.

TPH-D = Total Petroleum Hydrocarbons as Diesel.

MTBE = Methyl tert-Butyl Ether.

ND = Not Detected.

-- = Not Analyzed.

a = Laboratory analytical report note: lighter than water immiscible sheen present on the sample.

b = Laboratory analytical report note: TPH-D results consist of both diesel-range and gasoline-range compounds.

c = Laboratory analytical report note: TPH-D results consist of gasoline-range compounds.

d = Laboratory analytical report note: TPH-D results consist of both oil-range and gasoline-range compounds.

+ = Analyzed by EPA Method 8260.

* = This column summarizes results for analysis using EPA Method 8260 for non-MTBE fuel oxygenates (TAME, DIPE, ETBE, and TBA) or lead scavengers (EDB, 1,2-DCA/EDC).

Results in milligrams per liter (mg/L), unless otherwise indicated.

TABLE 2
 SUMMARY OF LABORATORY ANALYTICAL RESULTS
 Well MW1 (Continued)

Date	TPH-D	TPH-G	MTBE	Benzene	Toluene	Ethyl- benzene	Total Xylenes	Other Fuel Additives by 8260*
10/15/04	16,a,b	36,a	ND<0.05	1.5	1.0	2.1	5.1	ND<0.05, TBA ND<0.5
7/13/04	22,a,b	34,a	0.053	2.1	0.59	2.1	4.4	ND<0.5, TBA ND<0.5
4/6/04	18,a,b	28,a	0.11	2.3	0.8	0.99	4.5	ND<0.1 TBA ND<1
12/18/03	13,b	33	0.038	2.1	0.77	1.8	4.4	ND<0.005 TBA ND<0.05
9/18/03	15,a,b	32	0.052	2.2	0.62	1.8	3.8	ND<0.017, TBA ND<0.17
6/26/03	67,a,b	45	ND<0.05	2.1	0.72	2.3	5.5	ND
3/18/03	7.3,a,b	33	ND<0.05	2.4	0.9	1.6	1.0	ND

NOTES:

TPH-G = Total Petroleum Hydrocarbons as Gasoline.

TPH-D = Total Petroleum Hydrocarbons as Diesel.

MTBE = Methyl tert-Butyl Ether.

ND = Not Detected.

-- = Not Analyzed.

a = Laboratory analytical report note: lighter than water immiscible sheen present on the sample.

b = Laboratory analytical report note: TPH-D results consist of both diesel-range and gasoline-range compounds.

c = Laboratory analytical report note: TPH-D results consist of gasoline-range compounds.

d = Laboratory analytical report note: TPH-D results consist of both oil-range and gasoline-range compounds.

+ = Analyzed by EPA Method 8260.

* = This column summarizes results for analysis using EPA Method 8260 for non-MTBE fuel oxygenates (TAME, DIPE, ETBE, and TBA) or lead scavengers (EDB, 1,2-DCA/EDC).

Results in milligrams per liter (mg/L), unless otherwise indicated.

TABLE 2
SUMMARY OF LABORATORY ANALYTICAL RESULTS
Well MW1 (Continued)

Date	TPH-D	TPH-G	MTBE	Benzene	Toluene	Ethyl- benzene	Total Xylenes	Other Fuel Additives by 8260*
12/21/02	11,a,b	32	ND<0.1	2.6	0.98	2.2	5.5	ND
9/10/02	18,c	31	ND<0.25	2.2	0.65	1.7	4.8	--
3/30/02	12,a,b	99	ND	4.1	1.2	2.5	6.4	--
12/22/01	22,a,b	60	ND	3.2	1.9	2	6.2	--
9/23/01	16,a,c	49	ND	4	1.4	2.2	6.2	--
6/22/01	85,a,b	35	ND	3.1	0.75	1.2	4.0	--
4/22/01	16,a	43	ND	3.6	1.2	1.6	5.8	--
12/14/00	11,a,d	49	ND	5.8	1.6	2	6.9	--
9/18/00	15,a,b	86	ND	7.2	2	3.2	13	--
6/8/00	6.5,a,c	50	ND	5.7	1.5	1.8	7	--
3/9/00	7.4,a,b	48	ND	5.3	3.1	1.6	8.1	--
12/9/99	12,a,b	65	ND	9.3	2.9	2.2	8.8	--
8/31/99	22,b	66	0.71	8.7	2.7	2.4	10	--
4/29/99	22,b	48	ND	8.4	2.8	2.0	8.1	--
1/29/99	9.1,b	47	ND	9.0	2.9	1.9	8.0	--
4/26/98	7.8,c	60	ND	9.3	5.7	2.1	9.1	--
1/24/98	24,b	57	ND	6.9	5.5	2.0	8.7	--
11/6/97	17,c	63	ND	7.4	6.7	2.3	9.9	--
7/27/97	28,c	66	1.8	8.6	8.1	2.2	10	--
4/25/97	170,b	77	ND	7.4	7.9	2.1	9.8	--
1/21/97	57,c	80	0.25	7.8	8.3	1.9	8.9	--
7/26/96	11,c	76	ND	11	13	2.4	10	--
4/23/96	5.7,c	73	ND	8.6	12	2.2	9.8	--
1/29/96	6.6,c	81	0.25	7.6	13	1.9	8.9	--
10/26/95	62,c	89	ND	7.8	12	2.4	11	--

NOTES:

TPH-G = Total Petroleum Hydrocarbons as Gasoline.

TPH-D = Total Petroleum Hydrocarbons as Diesel.

MTBE = Methyl tert-Butyl Ether.

ND = Not Detected.

-- = Not Analyzed.

a = Laboratory analytical report note: lighter than water immiscible sheen present on the sample.

b = Laboratory analytical report note: TPH-D results consist of both diesel-range and gasoline-range compounds.

c = Laboratory analytical report note: TPH-D results consist of gasoline-range compounds.

d = Laboratory analytical report note: TPH-D results consist of both oil-range and gasoline-range compounds.

* = This column summarizes results for analysis using EPA Method 8260 f

Results in milligrams per liter (mg/L), unless otherwise indicated.

TABLE 2
SUMMARY OF LABORATORY ANALYTICAL RESULTS
Well MW1 (Continued)

Date	TPH-D	TPH-G	MTBE	Benzene	Toluene	Ethyl- benzene	Total Xylenes	Other Fuel Additives by 8260*
7/28/95	2.0,c	35	--	3.8	8.7	1.1	6.5	--
5/2/95	6.5,c	86	--	8.9	14	2.3	11	--
2/24/95	9.1	90	--	7.5	12	1.5	11	--
11/18/94	10	96	--	9.3	14	2.5	11	--
8/22/94	8.3	100	--	9.0	11	2.1	9.4	--
5/19/94	30	100	--	12	14	3.5	17	--
2/28/94	110	90	--	11	9.6	2.1	9.9	--
11/24/93	8.2	66	--	8.3	8.9	2.0	121	--
8/30/93	9.4	77	--	6.4	11	2.2	12	--
5/18/93	30	92	--	4.0	11	2.5	15	--
2/23/93	14	100	--	4.5	11	2.1	12	--
11/13/92	4.4	120	--	5.8	10	2.1	13	--
5/27/92	11	120	--	8.8	16	2.3	15	--
1/24/92	19	39	--	7.3	8.7	1.3	8.9	--
12/23/91	34	78	--	9.3	7.3	0.54	13	--
11/25/91	36	170	--	5.5	5.6	1.6	8.4	--
10/10/91	19	28	--	4.1	4.7	1.0	4.8	--
9/17/91	19	39	--	4.9	4.1	1.2	5.9	--
8/19/91	47	48	--	13	8.4	0.99	29	--
7/20/91	49	100	--	11	14	2.3	17	--
6/20/91	42	76	--	4.7	7.1	1.5	9.8	--
5/17/91	26	72	--	7.7	9.9	ND	11	--
4/15/91	--	56	--	6.5	8.5	0.41	9.9	--
3/21/91	--	36	--	4.5	5.7	0.087	7.3	--
2/15/91	--	120	--	7.4	6.6	ND	13	--
1/15/91	--	33	--	3.9	2.9	0.21	5.3	--
9/27/90	--	28	--	3.7	3.5	0.01	6.5	--
8/23/90	--	40	--	5.1	4.9	0.35	6.0	--
7/20/90	44	--	--	5.1	4.2	ND	9.1	--
3/19/90	--	40	--	3.7	1.1	ND	3.3	--
2/20/90**	--	7.6	--	1.6	ND	ND	1.3	--

NOTES:

TPH-G = Total Petroleum Hydrocarbons as Gasoline.

TPH-D = Total Petroleum Hydrocarbons as Diesel.

MTBE = Methyl tert-Butyl Ether.

ND = Not Detected.

-- = Not Analyzed.

b = Laboratory analytical report note: TPH-D results consist of both diesel-range and gasoline-range compounds.

c = Laboratory analytical report note: TPH-D results consist of gasoline-range compounds.

* = This column summarizes results for analysis using EPA Method 8260 for non-MTBE fuel oxygenates (TAME, DIPE, ETBE, and TBA) or lead scavengers (EDB, 1,2-DCA/EDC).

** Inorganic lead not detected in sample.

Results in milligrams per liter (mg/L), unless otherwise indicated.

TABLE 2
SUMMARY OF LABORATORY ANALYTICAL RESULTS
Well MW2

Date	TPH-D	TPH-G	MTBE	Benzene	Toluene	Ethyl- benzene	Total Xylenes	Other Fuel Additives by 8260*
2/7/96				MW2 Destroyed				
1/29/96	4.6,c	38	0.0071	1.9	5.7	1.1	5.9	--
10/26/95	900	74	ND	2.9	5.9	2.0	10	--
7/28/95	2.0,c	15	--	1.4	2.3	0.62	3.2	--
5/2/95	6.6,b	55	--	3.3	10	1.8	10	--
2/24/95	22	67	--	4.9	11	1.8	11	--
11/18/94	5.0	86	--	11	17	1.8	12	--
8/22/94	4.1	91	--	10	13	1.5	9.0	--
5/19/94	5.8	62	--	92	13	1.3	8.4	--
2/28/94	13	91	--	13	16	1.5	9.0	--
11/24/93	79	12	--	13	17	2.5	17	--
8/30/93	110	110	--	11	14	1.8	11	--
5/18/93	44	67	--	9.2	12	1.4	9.3	--
2/23/93	7.0	76	--	12	17	1.6	9.6	--
11/13/92	8.2	79	--	10	13	1.4	8.6	--
5/27/92	130	89	--	18	19	1.7	14	--
1/14/92	1600	59	--	17	14	1.8	15	--
12/23/91	700	2100	--	36	130	79	560	--
11/25/91	130	230	--	11	9.7	1.4	9.7	--
10/10/91	360	85	--	21	25	2.1	14	--
9/17/91	56	74	--	10	11	1.4	8.1	--
8/19/91	19	69	--	26	22	2.1	18	--
7/20/91	100	51	--	9.9	7.7	1.2	7.5	--
6/20/91	69	87	--	8.1	8.4	1.1	8.9	--
5/17/91	33	62	--	5.9	6.3	1.2	9.0	--
4/15/91	--	82	--	5.3	7.4	1.0	9.4	--
3/21/91	--	62	--	9.3	11	0.35	9.7	--
2/15/91	--	200	--	12	12	1.7	14	--
1/14/91	--	78	--	11	8.7	0.58	8.0	--
9/27/90	--	59	--	8.4	12	0.88	9.0	--
8/23/90	--	96	--	8.1	8.4	1.5	8.6	--
7/20/90	86	--	--	9.1	14	0.94	13	--
3/19/90	--	50	--	7.7	8.7	0.075	5.6	--
2/20/90**	--	38	--	7.3	3.1	0.075	6.8	--

NOTES:

TPH-G = Total Petroleum Hydrocarbons as Gasoline.

TPH-D = Total Petroleum Hydrocarbons as Diesel.

MTBE = Methyl tert-Butyl Ether.

ND = Not Detected.

-- = Not Analyzed.

b = Laboratory analytical report note: TPH-D results consist of both diesel-range and gasoline-range compounds.

c = Laboratory analytical report note: TPH-D results consist of gasoline-range compounds.

* = This column summarizes results for analysis using EPA Method 8260 for non-MTBE fuel oxygenates (TAME, DIPE, ETBE, and TBA) or lead scavengers (EDB, 1,2-DCA/EDC).

** Inorganic lead not detected in sample.

January 22, 2007
Report 0014.R62

Results in milligrams per liter (mg/L), unless otherwise indicated.

TABLE 2
SUMMARY OF LABORATORY ANALYTICAL RESULTS
Well MW3

Date	TPH-D	TPH-G	MTBE	Benzene	Toluene	Ethyl- benzene	Total Xylenes	Other Fuel Additives by 8260*
11/14/06	21, a, b	100, a	23	37	1.0	2.2	11	ND<0.5 except, TBA= 16, Ethanol ND<5.0, Methanol ND<50.0
6/29/06	12,b	36	27	14	ND<0.5	ND<0.5	ND<0.5	ND<0.5, except TBA = 11
02/03/06	22,b	86	24	26	ND<0.5	1.7	6	ND<0.5, except TBA = 11
11/18/05	32,a,b	87,a	22	35	ND<1	2	11	ND<1.0, except TBA ND<10
7/28/05	77,a,b	100,a	32,+	30	1.1	2.3	12	ND<0.5, except TBA = 13
4/13/05	19,a,b	96,a	28	31	4	2.3	12	ND<0.5, except TBA = 12
1/31/05	13,a,b	93,a	31	36	1.5	2.5	11	ND<1, except TBA = 24
10/15/04	13,a,b	76,a	24	28	ND<0.5	1.1	3.6	ND<0.5, except TBA = 18
7/13/04	57,a,b	98,a	15	28	2.9	1.7	8.9	ND<0.5, except TBA = 11
4/6/04	32,a,b	81,a	17	34	5.9	1.5	9.9	ND<0.5, except TBA = 8.8
12/18/03	32,a,b	130,a	32	33	5.4	0.72	11	ND<0.5, except TBA = 17
9/18/03	140,a,b	130	23	34	11	2.5	14	ND<0.5, except TBA = 10

NOTES:

TPH-G = Total Petroleum Hydrocarbons as Gasoline.

TPH-D = Total Petroleum Hydrocarbons as Diesel.

MTBE = Methyl tert-Butyl Ether.

ND = Not Detected.

-- = Not Analyzed.

a = Laboratory analytical report note: lighter than water immiscible sheen present on the sample.

b = Laboratory analytical report note: TPH-D results consist of both diesel-range and gasoline-range compounds

c = Laboratory analytical report note: unmodified or weakly modified gasoline is significant.

+ = Analyzed by EPA Method 8260.

* = This column summarizes results for analysis using EPA Method 8260 for non-MTBE fuel oxygenates (TAME, DIPE, ETBE, and TBA) or lead scavengers (EDB, 1,2-DCA/EDC).

Results in milligrams per liter (mg/L), unless otherwise indicated.

TABLE 2
SUMMARY OF LABORATORY ANALYTICAL RESULTS
Well MW3 (Continued)

Date	TPH-D	TPH-G	MTBE	Benzene	Toluene	Ethyl-benzene	Total Xylenes	Other Fuel Additives by 8260*
6/26/03	27,a,b	96	21	29	5.2	2.0	10	ND, except TBA = 8.9
3/18/03	11,a,b	120	16	36	12	1.8	2.4	ND, except TBA = 5.1
12/21/02	21,a,b	110	33	34	9.3	2.0	13	ND, except TBA = 14
9/10/02	43,b	70	19	21	2.2	1.6	7.6	--
3/30/02	8.5,a,b	170	26	40	17	2.6	16	--
12/22/01	9.2,a,b	140	27	37	20	2.6	15	--
9/23/01	47,a,b	130	26	32	9.1	2.4	12	--
6/22/01	33,a,b	110	25	31	7.2	1.9	11	--
4/22/01	61,a	140	24	25	5.4	1.7	11	--
12/14/00	120,a,b	140	35	37	16	2.4	15	--
9/18/00	43,a,b	130	33	39	91	2.3	14	--
7/26/00	--	--	21	--	--	--	--	ND***, except tert-butanol = 19
6/8/00	74,a,b	130	23	41	16	1.9	13	--
3/9/00	14,a,b	180	24	39	22	2.5	16	--
12/9/99	17,a,b	120	16	35	6.7	2.4	12	--
8/31/99	22,b	120	4.7	35	3.7	2.4	14	--
4/29/99	48,b	100	2.5	33	8.0	2.1	14	--
1/29/99	240,b	84	1.3	31	2.8	1.8	12	--
4/26/98	380,b	100	9.7	29	7.1	1.8	14	--
1/24/98	77,b	97	ND	28	7.1	1.8	11	--
11/6/97	120,b	140	ND	37	19	2.4	14	--
7/24/97	91,c	120	1.4	33	17	2.2	12	--
4/25/97	760,b	240	1.6	24	18	4.1	24	--
1/21/97	34,c	150	1.3	40	14	2.6	12	--
7/26/96	24,c	130	0.89	40	22	2.4	12	--
4/23/96	280,c	170	0.72	34	22	2.2	14	--

NOTES:

TPH-G = Total Petroleum Hydrocarbons as Gasoline.

TPH-D = Total Petroleum Hydrocarbons as Diesel.

MTBE = Methyl tert-Butyl Ether.

ND = Not Detected.

-- = Not Analyzed.

a = Laboratory analytical report note: lighter than water immiscible sheen present on the sample.

b = Laboratory analytical report note: TPH-D results consist of both diesel-range and gasoline-range compounds.

c = Laboratory analytical report note: TPH-D results consist of gasoline-range compounds.

* = This column summarizes results for analysis using EPA Method 8260 for non-MTBE fuel oxygenates (TAME, DIPE, ETBE, and TBA) or lead scavengers (EDB, 1,2-DCA/EDC).

***Review of laboratory analytical reports indicate that oxygenated volatile organic compounds (including TAME, DIPE, ETBE, methanol, ethanol, EDB, and 1,2-DCA) were not detected except MTBE at 21 ppm and tert-butanol at 19 ppm.

Results in milligrams per liter (mg/L), unless otherwise indicated.

TABLE 2
SUMMARY OF LABORATORY ANALYTICAL RESULTS
Well MW3 (Continued)

Date	TPH-D	TPH-G	MTBE	Benzene	Toluene	Ethyl- benzene	Total Xylenes	Other Fuel Additives by 8260*
1/29/96	45,c	150	0.54	32	21	1.9	12	--
10/26/95	33	130	0.69	37	21	0.21	11	--
7/28/95	1.9,b	86	--	1.4	2.3	0.62	3.2	--
5/2/95	9.7,b	170	--	43	30	2.5	14	--
2/24/95	9.2	130	--	31	19	1.8	10	--
11/18/94	23	140	--	38	22	2.0	11	--
7/22/94	5.3	170	--	35	20	1.8	10	--
5/19/94	30	150	--	38	25	2.4	14	--
2/28/94	210	110	--	36	21	1.9	11	--
11/24/93	24	160	--	48	26	2.2	12	--
7/30/93	32	130	--	36	21	1.9	8.2	--
5/18/93	7.2	130	--	36	21	2.1	12	--
2/23/93	8.1	110	--	31	18	1.9	11	--
11/13/92	4.7	140	--	38	24	2.0	12	--
5/27/92	27	370	--	91	57	3.0	21	--
7/14/92	270	130	--	76	30	3.4	21	--
12/23/91	540	740	--	30	61	31	180	--
11/25/91	74	150	--	65	31	3.4	18	--
10/10/91	39	140	--	57	31	2.2	14	--
9/17/91	140	180	--	47	25	2.6	15	--
8/19/91	150	170	--	82	31	4.4	22	--
7/20/91	270	450	--	46	29	3.5	21	--
6/20/91	210	920	--	39	49	13	69	--
5/17/91	70	170	--	32	22	2.2	18	--
4/15/91	--	110	--	31	15	0.88	7.4	--
3/21/91	--	87	--	30	14	0.69	5.4	--
2/15/91	--	230	--	44	40	ND	31	--
1/14/91	--	160	--	48	25	1.0	16	--
9/27/90	--	25	--	7.2	6.4	0.42	3.4	--
8/23/90	--	220	--	67	46	27	18	--
7/20/90	86	--	--	9.1	14	0.94	13	--
3/19/90	--	210	--	38	28	1.8	12	--
2/20/90**	--	46	--	20	15	1.8	9.7	--

NOTES:

TPH-G = Total Petroleum Hydrocarbons as Gasoline.

TPH-D = Total Petroleum Hydrocarbons as Diesel.

MTBE = Methyl tert-Butyl Ether.

ND = Not Detected.

-- = Not Analyzed.

b = Laboratory analytical report note: TPH-D results consist of both diesel-range and gasoline-range compounds.

c = Laboratory analytical report note: TPH-D results consist of gasoline-range compounds.

* = This column summarizes results for analysis using EPA Method 8260 for non-MTBE fuel oxygenates (TAME, DIPE, ETBE, and TBA) or lead scavengers (EDB, 1,2-DCA/EDC).

** Inorganic lead not detected in sample.

Results in milligrams per liter (mg/L), unless otherwise indicated.

TABLE 2
 SUMMARY OF LABORATORY ANALYTICAL RESULTS
 Well MW4

Date	TPH-D	TPH-G	MTBE	Benzene	Toluene	Ethyl- benzene	Total Xylenes	Other Fuel Additives by 8260*
11/14/06			Not Sampled (Free Product Present in Well)					
6/29/06	83,a,b	140,a	31	44	13	2.6	19	ND<1.0, except TBA = ND<10
2/3/06	83,a,b	150,a	22	35	12	3.2	14	ND<0.5, except TBA = 7
11/18/05			Not Sampled (Free Product Present in Well)					
7/28/05	94,a,b	130,a	27,+	32	8.9	2.9	14	ND<0.5, except TBA = 8.4

NOTES:

TPH-G = Total Petroleum Hydrocarbons as Gasoline.

TPH-D = Total Petroleum Hydrocarbons as Diesel.

MTBE = Methyl tert-Butyl Ether.

ND = Not Detected.

a = Laboratory analytical report note: lighter than water immiscible sheen present on the sample.

b = Laboratory analytical report note: TPH-D results consist of both diesel-range and gasoline-range compounds.

+ = Analyzed by EPA Method 8260.

* = This column summarizes results for analysis using EPA Method 8260 for non-MTBE fuel oxygenates (TAME, DIPE, ETBE, and TBA) or lead scavengers (EDB, 1,2-DCA/EDC).

Results in milligrams per liter (mg/L), unless otherwise indicated.

TABLE 2
SUMMARY OF LABORATORY ANALYTICAL RESULTS
Well MW4 (Continued)

Date	TPH-D	TPH-G	MTBE	Benzene	Toluene	Ethyl- benzene	Total Xylenes	Other Fuel Additives by 8260*
4/13/05			Not Sampled (Free Product Present in Well)					
1/31/05			Not Sampled (Free Product Present in Well)					
10/15/04			Not Sampled (Free Product Present in Well)					
7/13/04			Not Sampled (Free Product Present in Well)					
2/11/04	Free Product sampled. Laboratory fuel fingerprint notes a pattern resembling diesel, with a less significant gasoline-range pattern.							
12/18/03			Not Sampled (Free Product Present in Well)					
9/18/03			Not Sampled (Free Product Present in Well)					
6/26/03			Not Sampled (Free Product Present in Well)					
3/18/03			Not Sampled (Free Product Present in Well)					
12/21/02			Not Sampled (Free Product Present in Well)					
9/10/02			Not Sampled (Free Product Present in Well)					
3/30/02			Not Sampled (Free Product Present in Well)					
12/22/01			Not Sampled (Free Product Present in Well)					
9/23/01			Not Sampled (Free Product Present in Well)					
6/22/01	440,a,b	140	15	35	19	2.0	10	--
4/22/01			Not Sampled (Free Product Present in Well)					
12/14/00			Not Sampled (Free Product Present in Well)					
9/18/00			Not Sampled (Free Product Present in Well)					
6/8/00			Not Sampled (Free Product Present in Well)					
3/9/00	2,100,a,b	130	6.9	35	13	2.1	11	--
12/9/99	9,000,a,b	120	8.1	33	6	2.4	12	--
8/31/99	9.4,b	190	4.4	46	30	2.8	15	--
4/29/99	9.4,b	210	3.2	42	35	2.8	15	--
1/29/99	7.3,b	190	2.4	44	40	3.1	17	--
4/26/98	13,b	190	ND	49	37	3.2	18	--
1/24/98	20,b	200	ND	50	40	3.1	17	--
11/6/97	110,b	160	ND	48	30	2.8	16	--
8/26/97	5.5,b	210	1.7	48	42	3.4	19	--
8/15/97			MW4 Installed					

NOTES:

TPH-G = Total Petroleum Hydrocarbons as Gasoline.

TPH-D = Total Petroleum Hydrocarbons as Diesel.

MTBE = Methyl tert-Butyl Ether.

ND = Not Detected.

-- = Not Analyzed.

a = Laboratory analytical report note: lighter than water immiscible sheen present on the sample.

b = Laboratory analytical report note: TPH-D results consist of both diesel-range and gasoline-range compounds.

+ = Analyzed by EPA Method 8260.

* = This column summarizes results for analysis using EPA Method 8260 for non-MTBE fuel oxygenates (TAME, DIPE, ETBE, and TBA) or lead scavengers (EDB, 1,2-DCA/EDC).

Results in milligrams per liter (mg/L), unless otherwise indicated.

TABLE 2
 SUMMARY OF LABORATORY ANALYTICAL RESULTS
 Well EW1

Date	TPH-D	TPH-G	MTBE	Benzene	Toluene	Ethyl- benzene	Total Xylenes	Other Fuel Additives by 8260*
11/14/06	1.8, b	0.87, i	0.17	ND<0.025	ND<0.025	ND<0.025	ND<0.025	ND<0.025, except TBA= 5.9, Ethanol ND<2.5, Methanol ND<25.0
6/29/06	0.71,b	0.29	0.021	ND<0.01	ND<0.01	ND<0.01	ND<0.01	ND<0.01, Except TBA = 2.0
2/3/06	1.2,b	0.79	3.1	ND<0.05	ND<0.05	ND<0.05	ND<0.05	ND<0.05, Except TBA = 13
11/18/05	1.2,a	0.9	2	ND<0.05	ND<0.05	ND<0.05	ND<0.05	ND<0.05, Except TBA = 18

NOTES:

TPH-G = Total Petroleum Hydrocarbons as Gasoline.

TPH-D = Total Petroleum Hydrocarbons as Diesel.

MTBE = Methyl tert-Butyl Ether.

ND = Not Detected.

-- = Not Analyzed.

+ = Analyzed by EPA Method 8260.

a = Laboratory analytical report note: lighter than water immiscible sheen present on the sample.

b = Laboratory analytical report note: TPH-D results consist of both diesel-range and gasoline-range compounds.

c = Laboratory analytical report note: TPH-D results consist of gasoline-range compounds.

i = Laboratory analytical report note: no recognizable pattern.

* = This column summarizes results for analysis using EPA Method 8260 for non-MTBE fuel oxygenates (TAME, DIPE, ETBE, and TBA) or lead scavengers (EDB, 1,2-DCA/EDC).

Results in milligrams per liter (mg/L), unless otherwise indicated.

TABLE 2
SUMMARY OF LABORATORY ANALYTICAL RESULTS
Well EW1 (Continued)

Date	TPH-D	TPH-G	MTBE	Benzene	Toluene	Ethyl- benzene	Total Xylenes	Other Fuel Additives by 8260*	
7/28/05	1.8,b	1.2	17,+	0.033	0.0051	0.00056	0.0059	ND<0.25, except TBA = 22	
4/13/05	2.2,b	0.38	2.7	ND<0.05	ND<0.05	ND<0.05	ND<0.05	ND<0.05, except TBA = 1.6	
1/31/05	3.4,b	1.9	38	ND<1	ND<1	ND<1	ND<1	ND<1, except TBA = 32	
10/15/04	4.1,a,b	ND<5.0,a,e	96	ND<1.7	ND<1.7	ND<1.7	ND<1.7	ND<1.7, except TBA = 97	
7/13/04	3.3,a,b	2.6,a	73	ND<1.2	ND<1.2	ND<1.2	ND<1.2	ND<1.2, except TBA = 40	
4/6/04	3.4,a,b	2.6,a	72	ND<1	ND<1	ND<1	ND<1	ND<1, except TBA = 34	
12/18/03	3.0,b	ND<5.0,e	160	0.22	ND<50	ND<50	0.073	ND<5, except TBA = 64	
9/18/03	8.2,a,b	7.5	220	0.33	ND<0.05	ND<0.05	ND<0.05	ND<2.5, except TBA = 51	
2/23/93	9.6	66	--	14	8.5	1.4	9.8	--	
11/13/92	13	62	--	11	9.2	1.1	9.6	--	
8/92				EW1 Installed					

NOTES:

TPH-G = Total Petroleum Hydrocarbons as Gasoline.

TPH-D = Total Petroleum Hydrocarbons as Diesel.

MTBE = Methyl tert-Butyl Ether.

ND = Not Detected.

-- = Not Analyzed.

+ = Analyzed by EPA Method 8260.

a = Laboratory analytical report note: lighter than water immiscible sheen present on the sample.

b = Laboratory analytical report note: TPH-D results consist of both diesel-range and gasoline-range compounds.

e = Laboratory analytical report note: reporting limit raised due to high MTBE content

* = This column summarizes results for analysis using EPA Method 8260 for non-MTBE fuel oxygenates (TAME, DIPE, ETBE, and TBA) or lead scavengers (EDB, 1,2-DCA/EDC).

Results in milligrams per liter (mg/L), unless otherwise indicated.

TABLE 2
SUMMARY OF LABORATORY ANALYTICAL RESULTS
Well OW1

Date	TPH-D	TPH-G	TPH-MO	Benzene	Toluene	Ethyl-benzene	Total Xylenes	Other Fuel Additives by 8260, including MTBE**
11/14/06				No sample recovered				
6/29/06	290,b	24	--	--	--	--	--	--
2/3/06	710a,g	31,a	210	--	--	--	--	--
11/18/05	820,b	370	--	0.13	ND<0.025	0.4	0.29	ND<0.025 TBA<0.25
7/28/05	230,a,b	10,a	--	1.3	0.03	0.19	0.072	ND<0.05, TBA ND<0.5
4/13/05	590a,b,d	35,a	--	2	ND<0.05	0.46	0.14	ND<0.05, TBA ND<0.5
1/31/05				No sample recovered				
10/15/04				No sample recovered				
7/14/04	240,a,b	66,a	ND<0.05	1.8	ND<0.05	1.8	0.056	ND<0.05, TBA ND<0.5
4/6/04	74,a,b	50,a	--	3.1	ND<0.1	0.21	0.14	ND<0.1, TBA ND<1
2/11/04	450,a,b	15,a	130	2.2	0.031	0.16	0.054	ND<0.025, TBA ND<0.25
11/21/03	1,900,a,b	38,f	570	2.0	0.059	0.19	0.095	ND<0.05, TBA ND<0.5
6/10/98				OW1 Installed				

NOTES:

TPH-G = Total Petroleum Hydrocarbons as Gasoline.

TPH-D = Total Petroleum Hydrocarbons as Diesel.

MTBE = Methyl tert-Butyl Ether.

ND = Not Detected.

-- = Not Analyzed.

a = Laboratory analytical report note: lighter than water immiscible sheen present on the sample.

b = Laboratory analytical report note: TPH-D results consist of both diesel-range and gasoline-range compounds.

d = Laboratory analytical report note: TPH-D results consist of both oil-range and gasoline-range compounds.

f = Laboratory analytical report note: unmodified or weakly modified gasoline is significant.

g = Fuel oil.

** = This column summarizes results for analysis using EPA Method 8260 for fuel oxygenates (MTBE, TAME, DIPE, ETBE, and TBA) or lead scavengers (EDB, 1,2-DCA/EDC).

Results in milligrams per liter (mg/L), unless otherwise indicated.

TABLE 2
SUMMARY OF LABORATORY ANALYTICAL RESULTS
Well OW2

Date	TPH-D	TPH-G	TPH-MO	Benzene	Toluene	Ethyl- benzene	Total Xylenes	Other Fuel Additives by 8260, incl. MTBE**	
11/14/06				No sample recovered					
6/29/06				No sample recovered					
2/3/06	0.37,b	0.14,h	ND<0.25	--	--	--	--	--	
11/18/05				No sample recovered					
7/28/05				No sample recovered					
4/13/05	0.22,b	0.065	--	ND <0.0005	ND <0.0005	ND <0.0005	ND <0.0005	ND<0.0005, except MTBE = 0.0097	
1/31/05				No sample recovered					
10/15/04				No sample recovered					
07/14/04				No sample recovered					
4/6/04	--	0.069,a	--	ND <0.00062	ND <0.00062	ND <0.00062	ND <0.00062	--	
2/11/04	--	0.21	--	ND <0.0005	ND <0.0005	ND <0.0005	ND <0.0005	ND<0.0005, except MTBE = 0.0064 TBA = 0.0070	
11/21/03				No sample recovered.					
6/10/98				OW2 Installed					

NOTES:

TPH-G = Total Petroleum Hydrocarbons as Gasoline.

TPH-D = Total Petroleum Hydrocarbons as Diesel.

MTBE = Methyl tert-Butyl Ether.

ND = Not Detected.

-- = Not Analyzed.

a = Laboratory analytical report note: lighter than water immiscible sheen present on the sample.

b = Laboratory analytical report note: TPH-D results consist of both diesel-range and gasoline-range compounds.

h = Laboratory analytical report note: heavier gasoline range compounds are significant (aged gasoline?).

* = This column summarizes results for analysis using EPA Method 8260 for fuel oxygenates (MTBE, TAME, DIPE, ETBE, and TBA) or lead scavengers (EDB, 1,2-DCA/EDC).

Results in milligrams per liter (mg/L), unless otherwise indicated.

FIGURES

P & D ENVIRONMENTAL, INC.

55 Santa Clara Avenue, Suite 240

Oakland, CA 94610

(510) 658-6916

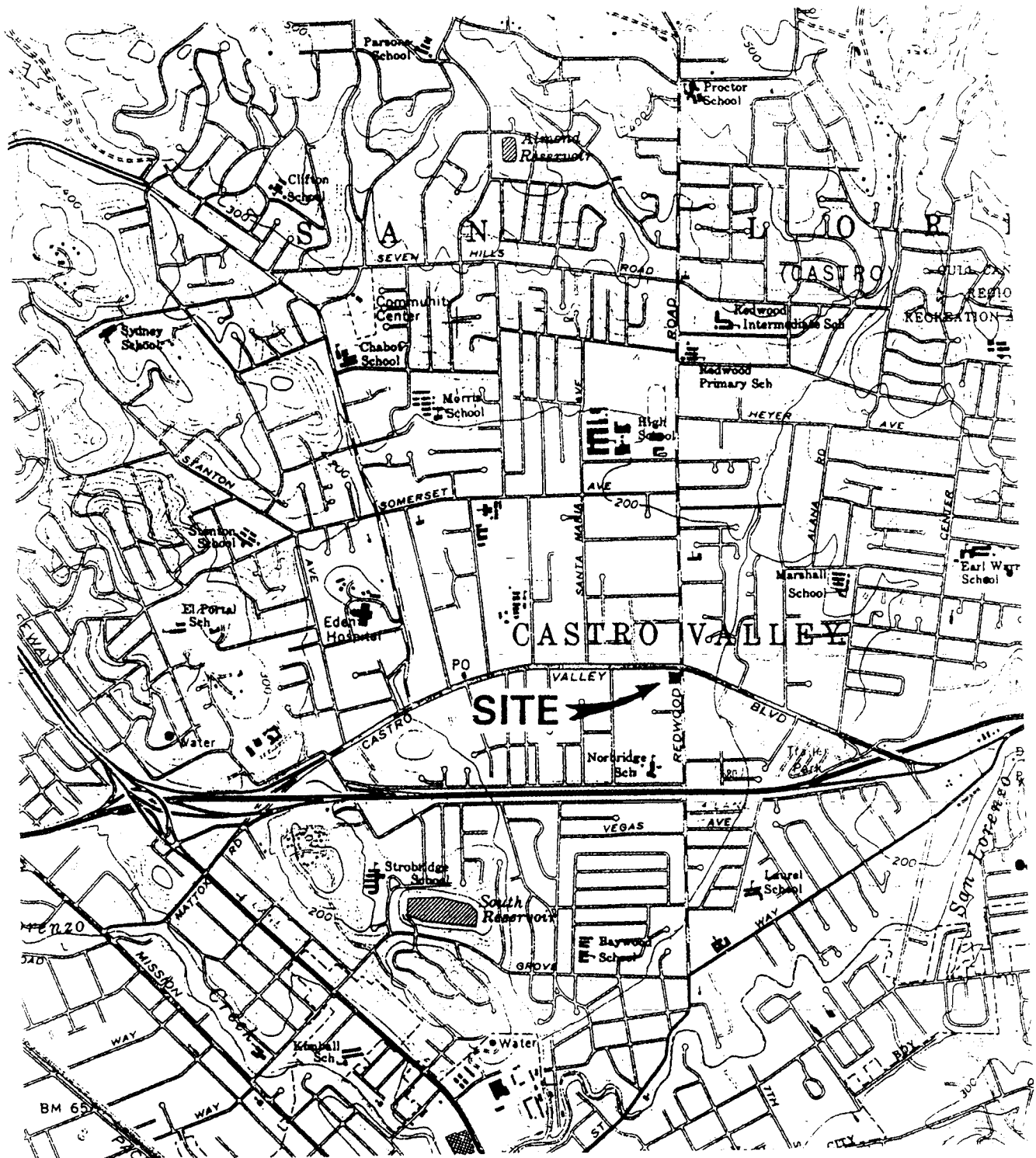

Base Map From:
U.S. Geological Survey
Hayward, Calif.
7.5 Minute Quadrangle
Photorevised 1980

North

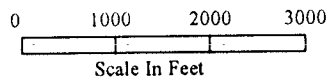
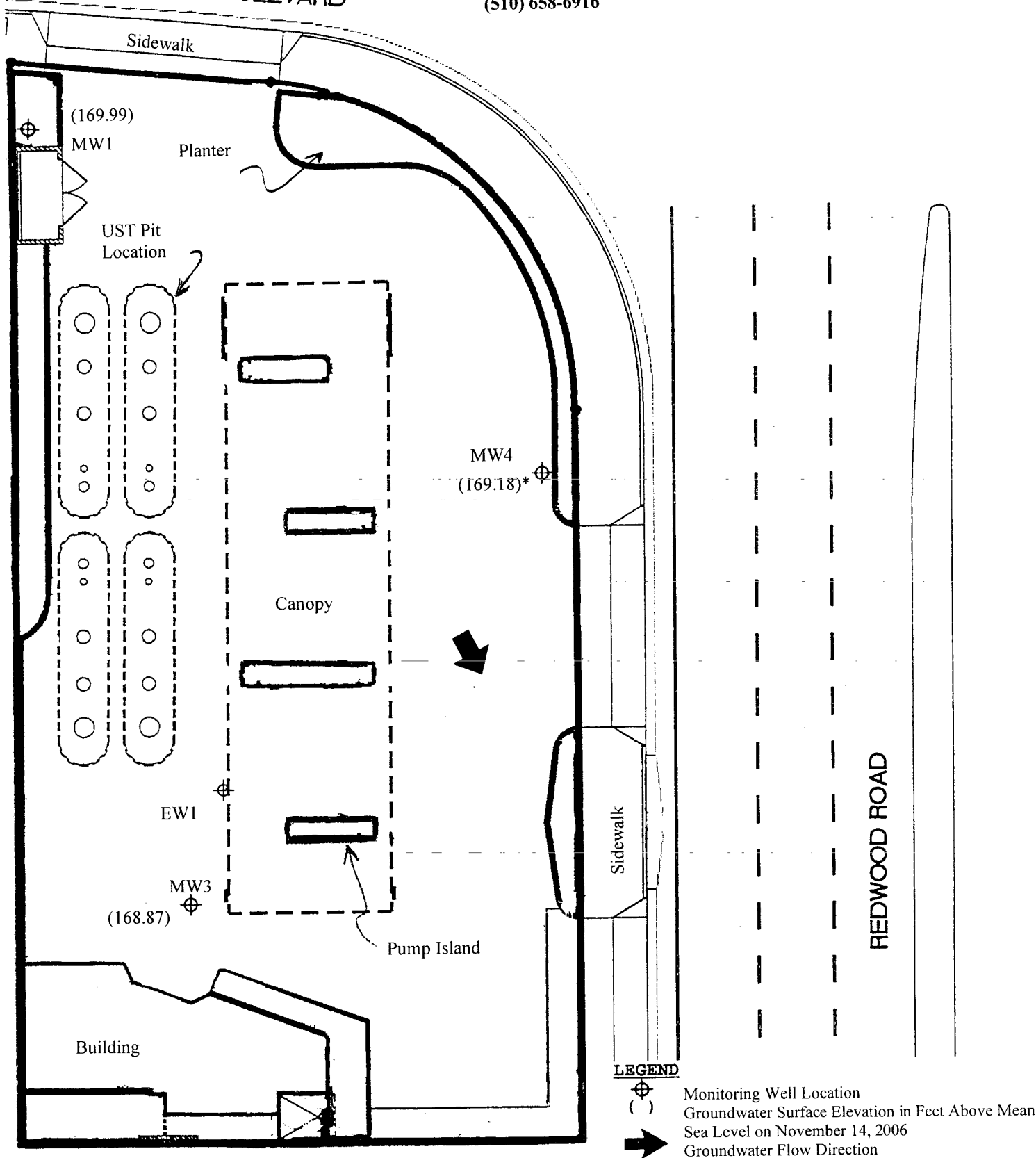

Figure 1
SITE LOCATION MAP
Xtra Oil Company
3495 Castro Valley Blvd.
Castro Valley, California

P & D ENVIRONMENTAL, INC.

55 Santa Clara Avenue, Suite 240
Oakland, CA 94610
(510) 658-6916

CASTRO VALLEY BOULEVARD



LEGEND

- ⊕ Monitoring Well Location
- () Groundwater Surface Elevation in Feet Above Mean Sea Level on November 14, 2006
- ➔ Groundwater Flow Direction

* Groundwater Surface Elevation Corrected For Free Product Using a Specific Gravity of 0.75

Base Map From:
RHL Design Group, Inc.
June, 1997

North



0 20

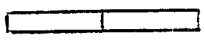

Scale in Feet

Figure 2
SITE PLAN
Xtra Oil Company
3495 Castro Valley Blvd
Castro Valley, CA

P & D ENVIRONMENTAL, INC.

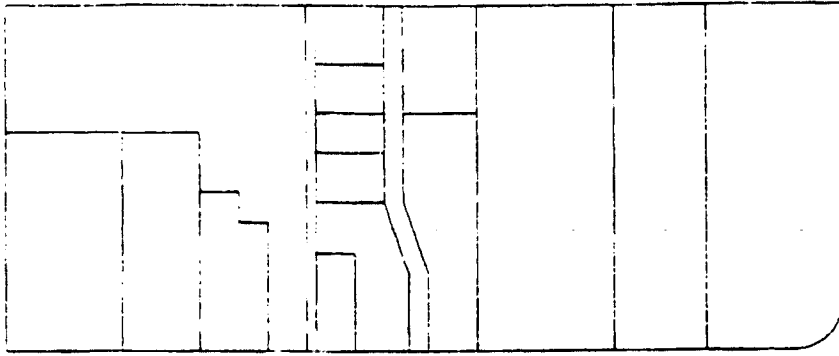

55 Santa Clara Avenue, Suite 240
Oakland, CA 94610
(510) 658-6916

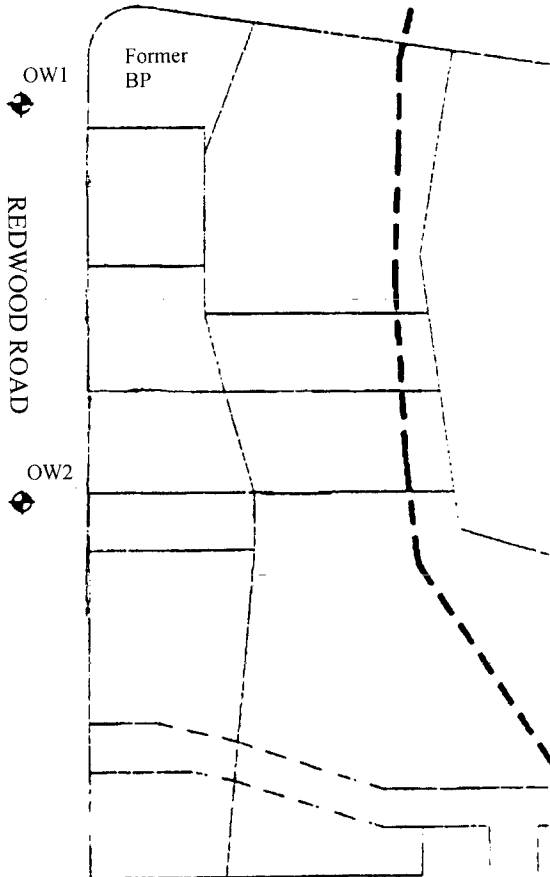
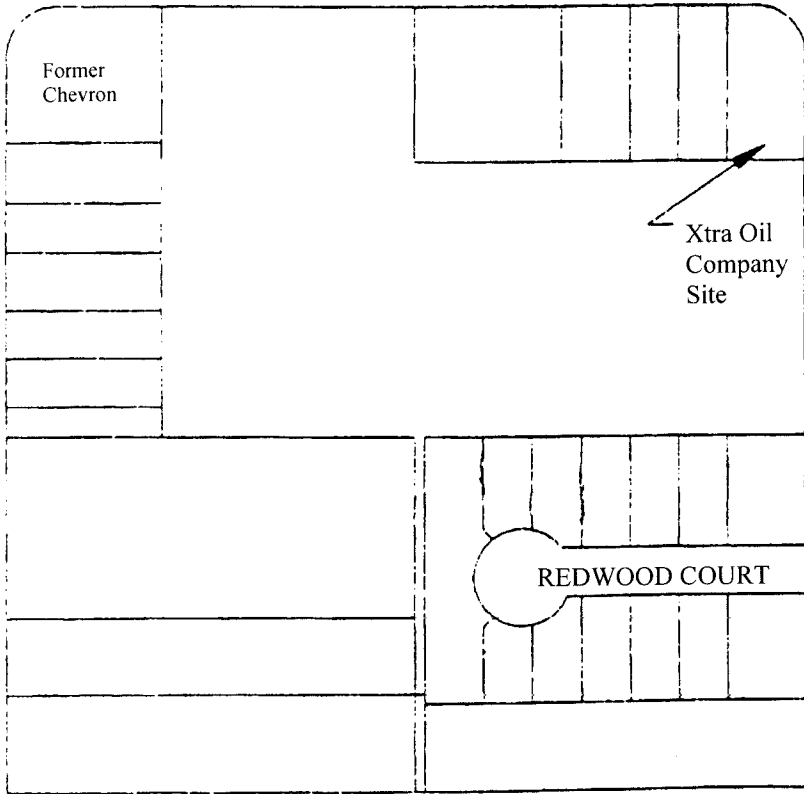
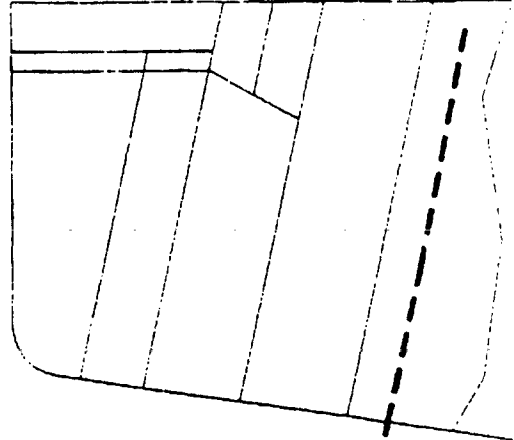

CASTRO VALLEY BOULEVARD



LEGEND

-  Observation Well Location
-  Approximate Creek Location

Base Map From:
Castro Valley Sanitation District
Undated

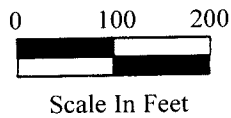

North



Figure 3
SITE VICINITY MAP
Xtra Oil Company
3495 Castro Valley Blvd.
Castro Valley, CA

**GROUNDWATER
MONITORING/WELL
PURGING DATA SHEETS**

P&D ENVIRONMENTAL
GROUNDWATER MONITORING/WELL PURGING
DATA SHEET

Site Name X.O Costa Valley
Job No. 0014
TOC to Water (ft.) 7.38
Well Depth (ft.) 20.02
Well Diameter 4"
Gal./Casing Vol. 82

Well No. MW-1
Date 11/14/06
Sheen light
Free Product Thickness _____
Sample Collection Method _____

TIME	GAL. PURGED	DH	TEMPERATURE	ELECTRICAL CONDUCTIVITY
1321	3.0	6.40	69.9	0.70
1327	6.0	6.68	67.8	0.70
1332	9.0	6.76	66.3	0.72
1336	12.0	6.81	65.2	0.73
1340	15.0	6.87	64.5	0.73
1346	18.0	6.83	63.8	0.73
1351	20.0	6.77	63.0	0.73
1356	22.0	6.73	62.8	0.73
1402	24.0	6.73	62.5	0.73

NOTES: light sheen traced phc also -
sample time => 1410

P&D ENVIRONMENTAL
GROUNDWATER MONITORING/WELL PURGING
DATA SHEET

Site Name N.O. Castro Valley
 Job No. 0014
 TOC to Water (ft.) 7.53
 Well Depth (ft.) 18.60
 Well Diameter 4"
 Gal./Casing Vol. 7.3

Well No. ~~1003~~ MW-3
 Date 11/14/06
 Sheen light
 Free Product Thickness Ø
 Sample Collection Method Teflon Baker

30 = 21.9

TIME	GAL. PURGED	DH	TEMPERATURE °F	ELECTRICAL CONDUCTIVITY µs/cm
1435	2.3	6.44	63.3	0.72
1439	4.6	6.64	64.2	0.72
1442	7.3	6.72	64.7	0.72
1447	9.6	6.68	65.1	0.72
1451	11.3	6.64	64.6	0.72
1455	13.6			
	15.6			
	18.0			
	20.0			
	21.9			

de watered @ 13.0 gallons
 will let recharge + then collect sample

NOTES: Sample Time => 1625
Light sheen; mod phc odor.

**P&D ENVIRONMENTAL
GROUNDWATER MONITORING/WELL PURGING
DATA SHEET**

Site Name Xo Castro Valley
 Job No. 0014
 TOC to Water (ft.) 7.36
 Well Depth (ft.)
 Well Diameter 2"
 Gal./Casing Vol. N/A

TOC
to
Sp^h → 7.11

Well No. MW-4
 Date 11/14/06
 Sheen yes
 Free Product Thickness NO. 25'
 Sample Collection Method No Sample Collected

<u>TIME</u>	<u>GAL. PURGED</u>	<u>pH</u>	<u>TEMPERATURE</u>	<u>ELECTRICAL CONDUCTIVITY</u>
	<u>Checked well for sp^h w/ type</u>			
	<u>+ (6") finding paste</u>			
	<u>Sp^h encountered - No Sample taken</u>			

NOTES:

P&D ENVIRONMENTAL
GROUNDWATER MONITORING/WELL PURGING
DATA SHEET

Site Name X.O Castro Valley
 Job No. 004
 TOC to Water (ft.) 6.11
 Well Depth (ft.) 13.19
 Well Diameter 8"
 Gal./Casing Vol. 18.3
30 = 54.9

Well No. ~~AA~~ ^{SSE} EN-1
 Date 11/14/06
 Sheen No
 Free Product Thickness 0
 Sample Collection Method Teflon Bailer

TIME	GAL. PURGED	pH	TEMPERATURE ^{°K}	ELECTRICAL CONDUCTIVITY ^{µS/cm}
1515	6.0	6.03	74.8	0.67
1521	12.0	6.48	76.1	0.67
1526	18.0	6.60	76.3	0.67
1531	24.0	6.72	72.2	0.67
1546	30.0	6.81	70.4	0.67
1551	36.0	6.75	68.1	0.67
1556	42.0	6.73	66.9	0.73
1601	48.0	6.76	66.5	0.73
1606	55.0	6.74	66.1	0.73

NOTES: No sheen; very light phc only -
Sample time -> 1615

**P&D ENVIRONMENTAL
GROUNDWATER MONITORING/WELL PURGING
DATA SHEET**

Site Name X.O. Castro Valley
 Job No. 0014
 TOC to Water (ft.) 7.41 sic N/A
 Well Depth (ft.) 7.41
 Well Diameter 1
 Gal./Casing Vol. No Purge

Well No. OW-1
 Date 11/14/06
 Sheen yes on stab
 Free Product Thickness N/A
 Sample Collection Method ~~vacuum pump~~

TIME	GAL. PURGED	DH	TEMPERATURE	ELECTRICAL CONDUCTIVITY
	No water to sample. Strong phc odor + sheen on b/w gauge probe			

NOTES:

P&D ENVIRONMENTAL
GROUNDWATER MONITORING/WELL PURGING
DATA SHEET

Site Name X.O Castro Valley
Job No. 0014
TOC to Water (ft.) 7.27
Well Depth (ft.) 7.28
Well Diameter 1
Gal./Casing Vol. No purge

Well No. OW-2
Date 11/19/06
Sheen N/A
Free Product Thickness N/A
Sample Collection Method None

TIME	GAL. PURGED	pH	TEMPERATURE	ELECTRICAL CONDUCTIVITY
	- Not enough water to sample			

NOTES: pbc odor

**LABORATORY REPORTS
AND CHAIN OF CUSTODY
DOCUMENTATION**



McC Campbell Analytical, Inc.

"When Quality Counts"

1534 Willow Pass Road, Pittsburg, CA 94565-1701
Web: www.mccampbell.com E-mail: main@mccampbell.com
Telephone: 877-252-9262 Fax: 925-252-9269

P & D Environmental 55 Santa Clara, Ste.240 Oakland, CA 94610	Client Project ID: #0014; Xtra Oil Castro Valley	Date Sampled: 11/14/06
		Date Received: 11/15/06
	Client Contact: Paul King	Date Reported: 11/22/06
	Client P.O.:	Date Completed: 11/22/06

WorkOrder: 0611336

November 22, 2006

Dear Paul:

Enclosed are:

- 1). the results of 3 analyzed samples from your **#0014; Xtra Oil Castro Valley project**,
- 2). a QC report for the above samples
- 3). a copy of the chain of custody, and
- 4). a bill for analytical services.

All analyses were completed satisfactorily and all QC samples were found to be within our control limits.

If you have any questions please contact me. McC Campbell Analytical Laboratories strives for excellence in quality, service and cost. Thank you for your business and I look forward to working with you again.

Best regards,

Angela Rydelius, Lab Manager



McC Campbell Analytical, Inc.

"When Quality Counts"

1534 Willow Pass Road, Pittsburg, CA 94565-1701
Web: www.mccampbell.com E-mail: main@mccampbell.com
Telephone: 877-252-9262 Fax: 925-252-9269

P & D Environmental 55 Santa Clara, Ste.240 Oakland, CA 94610	Client Project ID: #0014; Xtra Oil Castro Valley	Date Sampled: 11/14/06
		Date Received: 11/15/06
	Client Contact: Paul King	Date Extracted: 11/15/06
	Client P.O.:	Date Analyzed: 11/17/06

Diesel (C10-23) and Oil (C18+) Range Extractable Hydrocarbons as Diesel and Motor Oil*

Extraction method: SW3510C Analytical methods: SW8015C Work Order: 0611336

Lab ID	Client ID	Matrix	TPH(d)	TPH(mo)	DF	% SS
0611336-001A	MW-1	W	7200,d,b	730	1	105
0611336-002A	MW-3	W	21,000,d,a,h	4600	1	91
0611336-003A	EW-1	W	1800,a,d	670	1	97

Reporting Limit for DF = 1; ND means not detected at or above the reporting limit	W	50	250	µg/L
	S	NA	NA	mg/Kg

* water samples are reported in µg/L, wipe samples in µg/wipe, soil/solid/sludge samples in mg/kg, product/oil/non-aqueous liquid samples in mg/L, and all DISTLC / STLC / SPLP / TCLP extracts are reported in µg/L.

cluttered chromatogram resulting in coeluted surrogate and sample peaks, or; surrogate peak is on elevated baseline, or; surrogate has been diminished by dilution of original extract.

+The following descriptions of the TPH chromatogram are cursory in nature and McC Campbell Analytical is not responsible for their interpretation: a) unmodified or weakly modified diesel is significant; b) diesel range compounds are significant; no recognizable pattern; c) aged diesel? is significant; d) gasoline range compounds are significant; e) unknown medium boiling point pattern that does not appear to be derived from diesel; f) one to a few isolated peaks present; g) oil range compounds are significant; h) lighter than water immiscible sheen/product is present; i) liquid sample that contains greater than ~1 vol. % sediment; k) kerosene/kerosene range; l) bunker oil; m) fuel oil; n) stoddard solvent/mineral spirits; p) see attached narrative.

 Angela Rydelius, Lab Manager



McC Campbell Analytical, Inc.

"When Quality Counts"

1534 Willow Pass Road, Pittsburg, CA 94565-1701
Web: www.mccampbell.com E-mail: main@mccampbell.com
Telephone: 877-252-9262 Fax: 925-252-9269

P & D Environmental 55 Santa Clara, Ste.240 Oakland, CA 94610	Client Project ID: #0014; Xtra Oil Castro Valley	Date Sampled: 11/14/06
	Client Contact: Paul King	Date Received: 11/15/06
	Client P.O.:	Date Extracted: 11/17/06
		Date Analyzed 11/17/06

Gasoline Range (C6-C12) Volatile Hydrocarbons as Gasoline*

Extraction method: SW5030B

Analytical methods: SW8015Cm

Work Order: 0611336

Lab ID	Client ID	Matrix	TPH(g)	DF	% SS
001A	MW-1	W	30,000,a	50	109
002A	MW-3	W	100,000,a,h	100	94
003A	EW-1	W	870,a,m	1	101

Reporting Limit for DF =1; ND means not detected at or above the reporting limit	W	50	µg/L
	S	NA	NA

* water and vapor samples and all TCLP & SPLP extracts are reported in ug/L, soil/sludge/solid samples in mg/kg, wipe samples in µg/wipe, product/oil/non-aqueous liquid samples in mg/L.

cluttered chromatogram; sample peak coelutes with surrogate peak.

+The following descriptions of the TPH chromatogram are cursory in nature and McC Campbell Analytical is not responsible for their interpretation: a) unmodified or weakly modified gasoline is significant; b) heavier gasoline range compounds are significant(aged gasoline?); c) lighter gasoline range compounds (the most mobile fraction) are significant; d) gasoline range compounds having broad chromatographic peaks are significant; biologically altered gasoline?; e) TPH pattern that does not appear to be derived from gasoline (stoddard solvent / mineral spirit?); f) one to a few isolated non-target peaks present; g) strongly aged gasoline or diesel range compounds are significant; h) lighter than water immiscible sheen/product is present; i) liquid sample that contains greater than ~1 vol. % sediment; j) reporting limit raised due to high MTBE content; k) TPH pattern that does not appear to be derived from gasoline (aviation gas). m) no recognizable pattern; n) TPH(g) range non-target isolated peaks subtracted out of the TPH(g) concentration at the client's request; p) see attached narrative.



McC Campbell Analytical, Inc.

"When Quality Counts"

1534 Willow Pass Road, Pittsburg, CA 94565-1701
Web: www.mcccampbell.com E-mail: main@mcccampbell.com
Telephone: 877-252-9262 Fax: 925-252-9269

P & D Environmental 55 Santa Clara, Ste.240 Oakland, CA 94610	Client Project ID: #0014; Xtra Oil Castro Valley	Date Sampled: 11/14/06
	Client Contact: Paul King	Date Received: 11/15/06
	Client P.O.:	Date Extracted: 11/20/06
		Date Analyzed: 11/20/06

Oxygenates and BTEX by GC/MS*

Extraction Method: SW5030B

Analytical Method: SW8260B

Work Order: 0611336

Lab ID	0611336-001B	0611336-002B	0611336-003B		Reporting Limit for DF =1
Client ID	MW-1	MW-3	EW-1		
Matrix	W	W	W		
DF	100	1000	50		

Compound	Concentration			ug/kg	µg/L
tert-Amyl methyl ether (TAME)	ND<50	ND<500	ND<25	NA	0.5
Benzene	2200	37,000	ND<25	NA	0.5
t-Butyl alcohol (TBA)	ND<500	16,000	5900	NA	5.0
1,2-Dibromoethane (EDB)	ND<50	ND<500	ND<25	NA	0.5
1,2-Dichloroethane (1,2-DCA)	ND<50	ND<500	ND<25	NA	0.5
Diisopropyl ether (DIPE)	ND<50	ND<500	ND<25	NA	0.5
Ethanol	ND<5000	ND<50,000	ND<2500	NA	50
Ethylbenzene	1800	2200	ND<25	NA	0.5
Ethyl tert-butyl ether (ETBE)	ND<50	ND<500	ND<25	NA	0.5
Methanol	ND<50,000	ND<500,000	ND<25,000	NA	500
Methyl-t-butyl ether (MTBE)	440	23,000	170	NA	0.5
Toluene	600	1000	ND<25	NA	0.5
Xylenes	2900	11,000	ND<25	NA	0.5

Surrogate Recoveries (%)

%SS1:	104	105	108	
%SS2:	99	99	100	
%SS3:	96	94	98	

Comments h

* water and vapor samples are reported in µg/L, soil/sludge/solid samples in mg/kg, product/oil/non-aqueous liquid samples and all TCLP & SPLP extracts are reported in mg/L, wipe samples in µg/wipe.

ND means not detected above the reporting limit; N/A means analyte not applicable to this analysis.

surrogate diluted out of range or coelutes with another peak; &) low surrogate due to matrix interference.

h) lighter than water immiscible sheen/product is present; i) liquid sample that contains greater than ~1 vol. % sediment; j) sample diluted due to high organic content/matrix interference; k) reporting limit near, but not identical to our standard reporting limit due to variable Encore sample weight; m) reporting limit raised due to insufficient sample amount; n) results are reported on a dry weight basis; p) see attached narrative.



McC Campbell Analytical, Inc.

"When Quality Counts"

1534 Willow Pass Road, Pittsburg, CA 94565-1701
Web: www.mcccampbell.com E-mail: main@mcccampbell.com
Telephone: 877-252-9262 Fax: 925-252-9269

QC SUMMARY REPORT FOR SW8015C

W.O. Sample Matrix: Water

QC Matrix: Water

WorkOrder: 0611336

EPA Method SW8015C		Extraction SW3510C				BatchID: 24782			Spiked Sample ID: N/A			
Analyte	Sample	Spiked	MS	MSD	MS-MSD	LCS	LCSD	LCS-LCSD	Acceptance Criteria (%)			
	µg/L	µg/L	% Rec.	% Rec.	% RPD	% Rec.	% Rec.	% RPD	MS / MSD	RPD	LCS/LCSD	RPD
TPH(d)	N/A	1000	N/A	N/A	N/A	107	110	2.41	N/A	N/A	70 - 130	30
%SS:	N/A	2500	N/A	N/A	N/A	104	104	0	N/A	N/A	70 - 130	30

All target compounds in the Method Blank of this extraction batch were ND less than the method RL with the following exceptions:
NONE

BATCH 24782 SUMMARY

Sample ID	Date Sampled	Date Extracted	Date Analyzed	Sample ID	Date Sampled	Date Extracted	Date Analyzed
0611336-001	11/14/06 2:10 PM	11/15/06	11/17/06 1:27 PM	0611336-002	11/14/06 4:25 PM	11/15/06	11/17/06 2:34 PM
0611336-003	11/14/06 4:15 PM	11/15/06	11/17/06 3:41 PM				

MS = Matrix Spike; MSD = Matrix Spike Duplicate; LCS = Laboratory Control Sample; LCSD = Laboratory Control Sample Duplicate; RPD = Relative Percent Deviation.

% Recovery = 100 * (MS-Sample) / (Amount Spiked); RPD = 100 * (MS - MSD) / ((MS + MSD) / 2).

MS / MSD spike recoveries and / or %RPD may fall outside of laboratory acceptance criteria due to one or more of the following reasons: a) the sample is inhomogenous AND contains significant concentrations of analyte relative to the amount spiked, or b) the spiked sample's matrix interferes with the spike recovery.

N/A = not enough sample to perform matrix spike and matrix spike duplicate



McC Campbell Analytical, Inc.

"When Quality Counts"

1534 Willow Pass Road, Pittsburg, CA 94565-1701
Web: www.mccampbell.com E-mail: main@mccampbell.com
Telephone: 877-252-9262 Fax: 925-252-9269

QC SUMMARY REPORT FOR SW8021B/8015Cm

W.O. Sample Matrix: Water

QC Matrix: Water

WorkOrder: 0611336

EPA Method SW8015Cm		Extraction SW5030B				BatchID: 24787			Spiked Sample ID: 0611321-009A			
Analyte	Sample	Spiked	MS	MSD	MS-MSD	LCS	LCSD	LCS-LCSD	Acceptance Criteria (%)			
	µg/L	µg/L	% Rec.	% Rec.	% RPD	% Rec.	% Rec.	% RPD	MS / MSD	RPD	LCS/LCSD	RPD
TPH(btex) [£]	ND	60	105	106	0.900	102	108	6.26	70 - 130	30	70 - 130	30
MTBE	ND	10	101	98.6	2.62	102	106	4.24	70 - 130	30	70 - 130	30
Benzene	ND	10	98.3	98.1	0.258	95.4	98.5	3.17	70 - 130	30	70 - 130	30
Toluene	ND	10	90.9	90.5	0.477	89.1	91.3	2.37	70 - 130	30	70 - 130	30
Ethylbenzene	ND	10	97.4	98.7	1.40	97.9	101	3.30	70 - 130	30	70 - 130	30
Xylenes	ND	30	96.7	96.7	0	92	96.3	4.60	70 - 130	30	70 - 130	30
%SS:	102	10	94	95	1.03	94	96	2.96	70 - 130	30	70 - 130	30

All target compounds in the Method Blank of this extraction batch were ND less than the method RL with the following exceptions:
NONE

BATCH 24787 SUMMARY

Sample ID	Date Sampled	Date Extracted	Date Analyzed	Sample ID	Date Sampled	Date Extracted	Date Analyzed
0611336-001	11/14/06 2:10 PM	11/17/06	11/17/06 8:32 AM	0611336-002	11/14/06 4:25 PM	11/17/06	11/17/06 9:02 AM
0611336-003	11/14/06 4:15 PM	11/17/06	11/17/06 9:10 PM				

MS = Matrix Spike; MSD = Matrix Spike Duplicate; LCS = Laboratory Control Sample; LCSD = Laboratory Control Sample Duplicate; RPD = Relative Percent Deviation.

% Recovery = 100 * (MS-Sample) / (Amount Spiked); RPD = 100 * (MS - MSD) / ((MS + MSD) / 2).

MS / MSD spike recoveries and / or %RPD may fall outside of laboratory acceptance criteria due to one or more of the following reasons: a) the sample is inhomogenous AND contains significant concentrations of analyte relative to the amount spiked, or b) the spiked sample's matrix interferes with the spike recovery.

£ TPH(btex) = sum of BTEX areas from the FID.



McC Campbell Analytical, Inc.

"When Quality Counts"

1534 Willow Pass Road, Pittsburg, CA 94565-1701
Web: www.mccampbell.com E-mail: main@mccampbell.com
Telephone: 877-252-9262 Fax: 925-252-9269

QC SUMMARY REPORT FOR SW8260B

W.O. Sample Matrix: Water

QC Matrix: Water

WorkOrder: 0611336

EPA Method SW8260B	Extraction SW5030B			BatchID: 24786			Spiked Sample ID: 0611341-007b					
	Analyte	Sample	Spiked	MS	MSD	MS-MSD	LCS	LCSD	LCS-LCSD	Acceptance Criteria (%)		
	µg/L	µg/L	% Rec.	% Rec.	% RPD	% Rec.	% Rec.	% RPD	MS / MSD	RPD	LCS/LCSD	RPD
tert-Amyl methyl ether (TAME)	ND	10	93.8	91.2	2.82	83.9	87.7	4.44	70 - 130	30	70 - 130	30
Benzene	ND	10	117	114	2.46	112	115	2.63	70 - 130	30	70 - 130	30
t-Butyl alcohol (TBA)	ND	50	87	91.4	4.94	83.1	88.7	6.46	70 - 130	30	70 - 130	30
Diisopropyl ether (DIPE)	ND	10	117	113	3.69	104	109	4.44	70 - 130	30	70 - 130	30
Ethanol	ND	500	108	97.7	10.1	85	87	2.31	70 - 130	30	70 - 130	30
Ethyl tert-butyl ether (ETBE)	ND	10	94.2	90.6	3.97	85.3	87.7	2.82	70 - 130	30	70 - 130	30
Methanol	ND	2500	109	101	7.15	92.2	104	12.4	70 - 130	30	70 - 130	30
Methyl-t-butyl ether (MTBE)	ND	10	91.7	88.2	3.91	81.1	84.5	4.20	70 - 130	30	70 - 130	30
Toluene	ND	10	110	106	4.46	108	110	1.87	70 - 130	30	70 - 130	30
%SS1:	112	10	98	97	1.11	95	94	0.397	70 - 130	30	70 - 130	30
%SS2:	97	10	94	95	0.415	98	97	0.848	70 - 130	30	70 - 130	30
%SS3:	99	10	92	91	1.26	92	92	0	70 - 130	30	70 - 130	30

All target compounds in the Method Blank of this extraction batch were ND less than the method RL with the following exceptions:
NONE

BATCH 24786 SUMMARY

Sample ID	Date Sampled	Date Extracted	Date Analyzed	Sample ID	Date Sampled	Date Extracted	Date Analyzed
0611336-001	11/14/06 2:10 PM	11/20/06	11/20/06 7:16 PM	0611336-002	11/14/06 4:25 PM	11/20/06	11/20/06 8:02 PM
0611336-003	11/14/06 4:15 PM	11/20/06	11/20/06 8:50 PM				

MS = Matrix Spike; MSD = Matrix Spike Duplicate; LCS = Laboratory Control Sample; LCSD = Laboratory Control Sample Duplicate; RPD = Relative Percent Deviation.

% Recovery = 100 * (MS - Sample) / (Amount Spiked); RPD = 100 * (MS - MSD) / ((MS + MSD) / 2).

MS / MSD spike recoveries and / or %RPD may fall outside of laboratory acceptance criteria due to one or more of the following reasons: a) the sample is inhomogenous AND contains significant concentrations of analyte relative to the amount spiked, or b) the spiked sample's matrix interferes with the spike recovery.

N/A = not enough sample to perform matrix spike and matrix spike duplicate.

McCampbell Analytical, Inc.



1534 Willow Pass Rd
Pittsburg, CA 94565-1701
(925) 252-9262

CHAIN-OF-CUSTODY RECORD

WorkOrder: 0611336

ClientID: PDEO

EDF

Fax

Email

HardCopy

ThirdParty

Requested TAT: 5 days

Report to:

Paul King
P & D Environmental
55 Santa Clara, Ste.240
Oakland, CA 94610

Email: PDKing0000@aol.com
TEL: (510) 658-691 FAX: 510-834-0152
ProjectNo: #0014; Xtra Oil Castro Valley
PO:

Bill to

Accounts Payable
Xtra Oil
2307 Pacific Ave
Alameda, CA 94507

Date Received: 11/15/2006

Date Printed: 11/22/2006

Sample ID	ClientSampID	Matrix	Collection Date	Hold	Requested Tests (See legend below)												
					1	2	3	4	5	6	7	8	9	10	11	12	
0611336-001	MW-1	Water	11/14/06 2:10:00	<input type="checkbox"/>	A	B											
0611336-002	MW-3	Water	11/14/06 4:25:00	<input type="checkbox"/>	A	B											
0611336-003	EW-1	Water	11/14/06 4:15:00	<input type="checkbox"/>	A	B											

Test Legend:

1	G-MBTEX_W	2	MBTEXOXY-8260B_W	3		4		5	
6		7		8		9		10	
11		12							

The following SampIDs: 0611336-001A, 0611336-002A, 0611336-003A contain testgroup. Please make sure all relevant testcodes are reported. Many thanks.

Prepared by: Nickole White

Comments:

NOTE: Samples are discarded 60 days after results are reported unless other arrangements are made. Hazardous samples will be returned to client or disposed of at client expense.

