

RECEIVED

By Alameda County Environmental Health at 2:39 pm, Jul 29, 2013

Atlantic Richfield Company

Shannon Couch
Operations Project Manager

PO Box 1257
San Ramon, CA 94583
Phone: (925) 275-3804
Fax: (925) 275-3815
E-Mail: shannon.couch@bp.com

July 9, 2013

Re: Second Quarter 2013 Status Report
Former BP Service Station #11104
1716 Webster Street
Alameda, California
ACEH Case #RO0000281

"I declare, that to the best of my knowledge at the present time, that the information and/or recommendations contained in the attached document are true and correct.

Submitted by,



Shannon Couch
Operations Project Manager

Attachment

July 9, 2013

Project No. 06-88-644

Atlantic Richfield Company
P.O. Box 1257
San Ramon, CA 94583
Submitted via ENFOS

Attn.: Ms. Shannon Couch

Re: Second Quarter 2013 Status Report, Former ARCO Service Station #11104, 1716
Webster Street, Alameda, Alameda County, California; ACEH Case #RO0000281

Dear Ms. Couch:

Attached is the *Second Quarter 2013 Status Report* for former ARCO Service Station No. 11104, located at 1716 Webster Street, Alameda, Alameda County, California (Site). This report presents a summary of current developments at the Site through the Second Quarter of 2013. Should you have questions regarding the work performed or results obtained, please do not hesitate to contact us at (707) 455-7290.

Sincerely,
BROADBENT & ASSOCIATES, INC.



Alexander J. Martinez
Senior Staff Geologist



Kristene Tidwell, P.G., C.Hg.
Senior Geologist

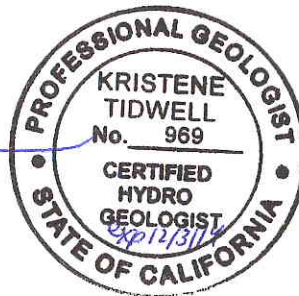

Enclosures

cc: Ms. Dilan Roe, Alameda County Environmental Health (submitted via ACEH ftp site)
Ms. Shelby Lathrop, ConocoPhillips, 76 Broadway, Sacramento, California 95818
Electronic copy uploaded to GeoTracker

**SECOND QUARTER 2013
STATUS REPORT
FORMER ARCO STATION #11104, ALAMEDA, CALIFORNIA**

Broadbent & Associates, Inc. (Broadbent) is pleased to present this *Second Quarter 2013 Status Report* on behalf of Atlantic Richfield Company (ARC, a BP affiliated company) for former ARCO Station #11104 located in Alameda, Alameda County, California. Monitoring activities at the site were performed in accordance with the reporting requirements issued by the Alameda County Environmental Health (ACEH). Details of work performed, discussion of results, and recommendations are provided below.

Facility Name / Address:	Station #11104 / 1716 Webster Street, Alameda, California
Client Project Manager / Title:	Ms. Shannon Couch, Remediation Management Project Manager
Broadbent Contact:	Kristene Tidwell, P.G., C.Hg., (707) 455-7290
Broadbent Project No.:	06-88-644
Primary Regulatory Agency / ID No.:	ACEH / Case #RO0000281
Current phase of project:	Monitoring
List of Acronyms / Abbreviations:	See end of report text for list of acronyms/abbreviations used in report.

WORK PERFORMED THIS QUARTER (Second Quarter 2013):

1. Submitted *First Quarter 2013 Monitoring Report* on April 15, 2013 (Q1 GWM Report).
2. No environmental field activities were scheduled for Second Quarter 2013.

WORK SCHEDULED FOR NEXT QUARTER (Third Quarter 2013):

1. Submit *Second Quarter 2013 Status Report* (contained herein).
2. Conduct Third Quarter 2013 groundwater monitoring and sampling event.

GROUNDWATER MONITORING PLAN SUMMARY:

Groundwater level gauging:	MW-1 through MW-5 and RW-1	(1Q & 3Q)
Groundwater sample collection:	MW-1 through MW-5 and RW-1	(1Q)
	MW-1 and RW-1	(3Q)
Biodegradation indicator parameter monitoring:	None	

QUARTERLY RESULTS SUMMARY:

LNAPL

LNAPL observed this quarter:	N/A	(yes/no)
LNAPL recovered this quarter:	N/A	(gal)
Cumulative LNAPL recovered:	N/A	(gal)

Groundwater Elevation and Gradient:

Depth to groundwater:	N/A	(ft below TOC)
Gradient direction:	N/A	(compass direction)
Gradient magnitude:	N/A	(ft/ft)
Average change in elevation:	N/A	(ft since last measurement)

Laboratory Analytical Data

Summary:	No environmental activities were conducted for Second Quarter 2013.
----------	---

DISCUSSION:

No environmental field activities were conducted by Broadbent & Associates at the Site during the Second Quarter of 2013. The most recent groundwater monitoring and sampling event occurred during the First Quarter of 2013, the results of which are contained within the Q1 GWM Report.

LIMITATIONS:

The findings presented in this report are based upon observations of field personnel, points investigated, results of laboratory tests performed by TestAmerica Laboratories, Inc. (Irvine, California), and our understanding of ACEH requirements. Our services were performed in accordance with the generally accepted standard of practice at the time this report was written. No other warranty, expressed or implied was made. This report has been prepared for the exclusive use of the Atlantic Richfield Company. It is possible that variations in soil or groundwater conditions could exist beyond points explored in this investigation. Also, changes in site conditions could occur in the future due to variations in rainfall, temperature, regional water usage, or other factors.

ATTACHMENTS:

Drawing 1: Site Location Map, Station #11104, 1716 Webster Street, Alameda, California

Drawing 2: Groundwater Elevation Contours and Analytical Summary Map, February 21, 2013, Station #11104, 1716 Webster Street, Alameda, California

LIST OF COMMONLY USED ACRONYMS/ABBREVIATIONS:

ACEH:	Alameda County Environmental Health	ft/ft:	feet per foot
Broadbent:	Broadbent & Associates, Inc.	gal:	Gallons
BTEX:	Benzene, Toluene, Ethylbenzene, Total Xylenes	GRO:	Gasoline-Range Organics
1,2-DCA:	1,2-Dichloroethane	LNAPL:	Light Non-Aqueous Phase Liquid
DIPE:	Di-Isopropyl Ether	MTBE:	Methyl Tertiary Butyl Ether
DO:	Dissolved Oxygen	NO ₃ :	Nitrate as Nitrogen
DRO:	Diesel-Range Organics	ppb:	parts per billion
EDB:	1,2-Dibromomethane	SO ₄ :	Sulfate
Eh:	Oxidation Reduction Potential	TAME:	Tert-Amyl Methyl Ether
EPA:	Environmental Protection Agency	TBA:	Tertiary Butyl Ether
ETBE:	Ethyl Tertiary Butyl Ether	TOC:	Top of Casing
Fe ²⁺ :	Ferrous Iron	µg/L:	micrograms per liter

DRAWINGS

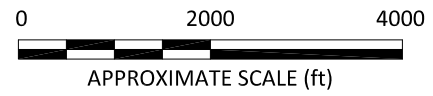
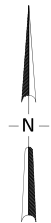
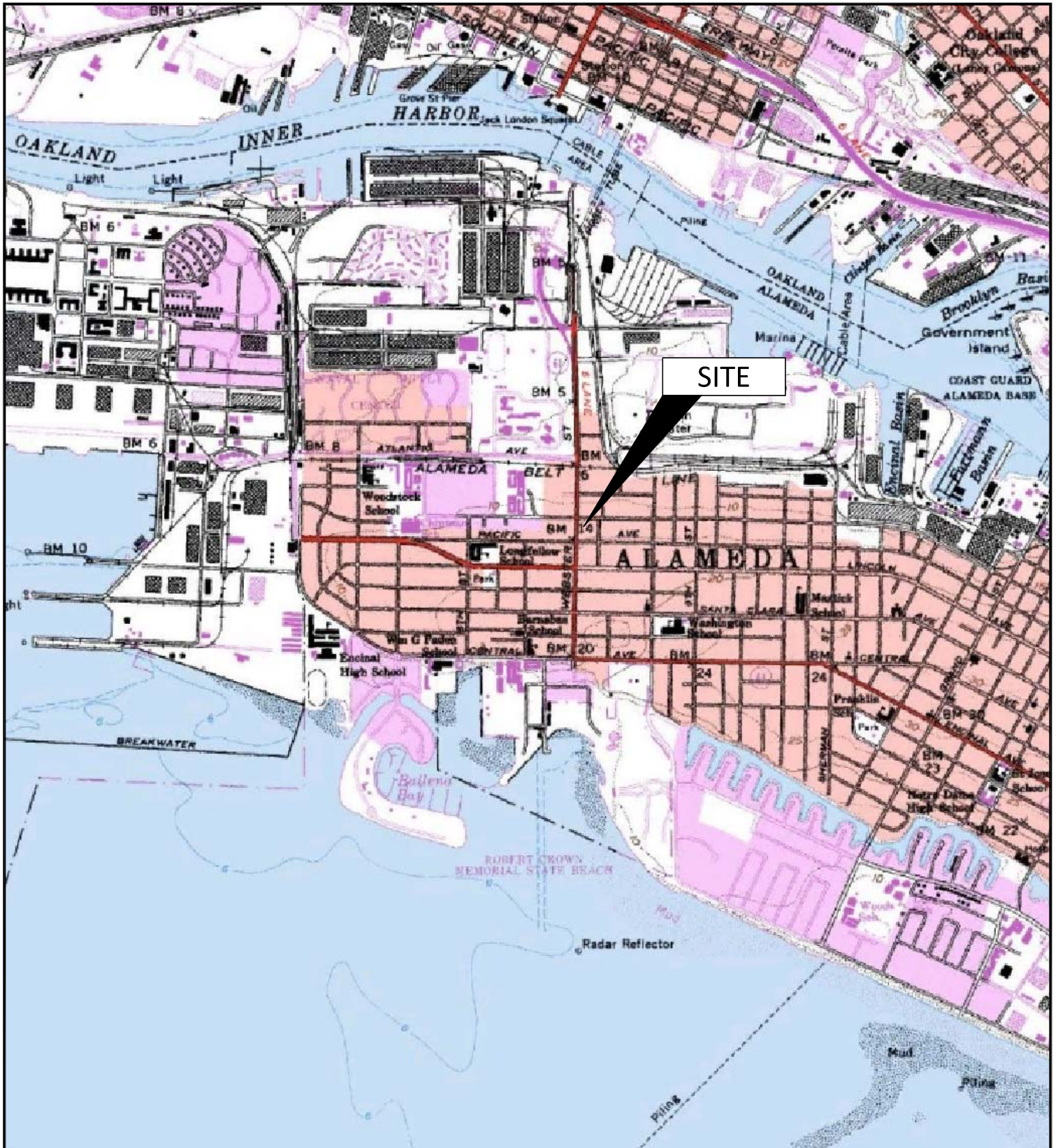

IMAGE SOURCE: USGS



Project No.: 06-88-644 Date: 3/22/2013

Station #11104
1716 Webster Street
Alameda, California

Site Location Map

Drawing

1

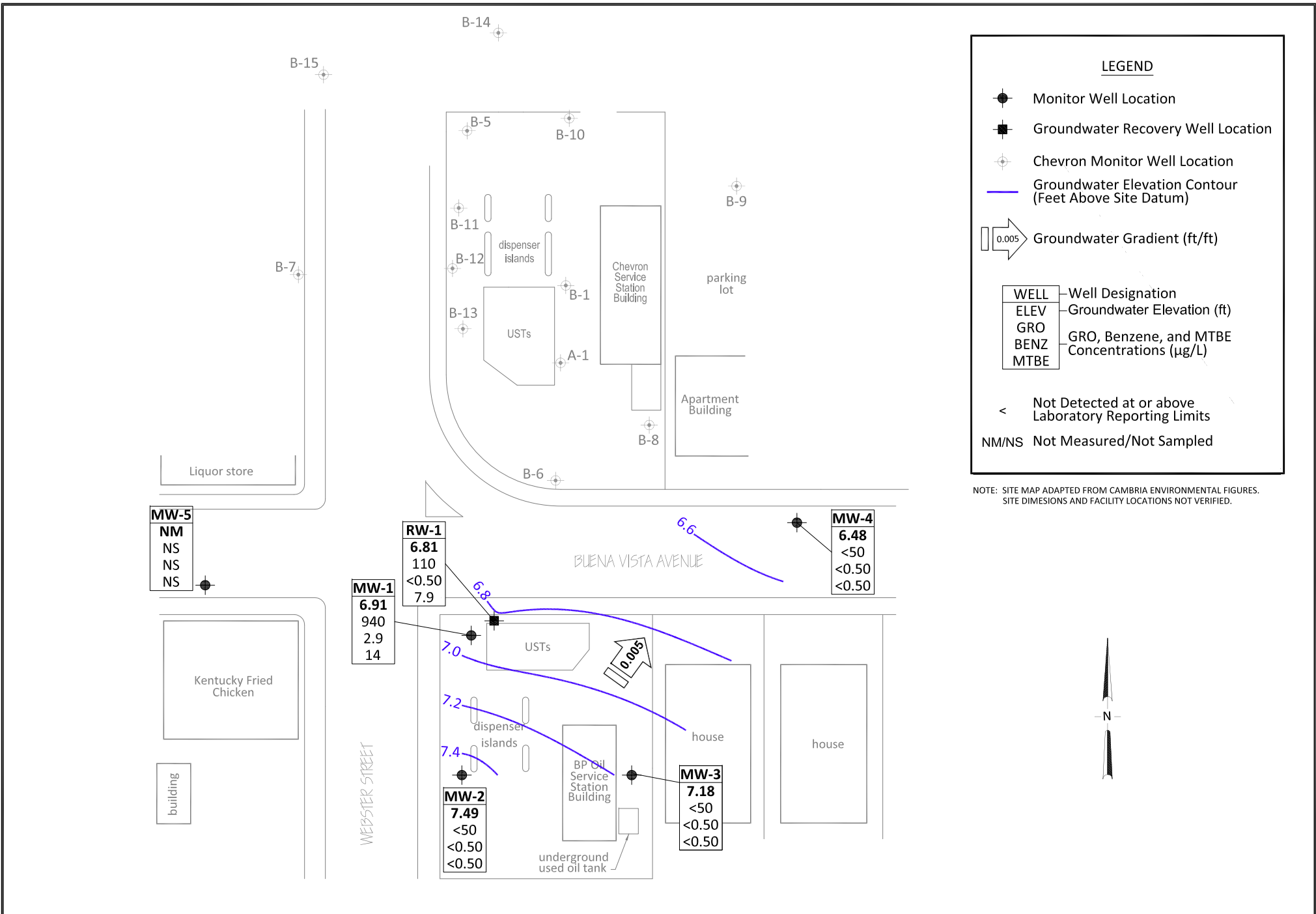

NOTE: SITE MAP ADAPTED FROM CAMBRIA ENVIRONMENTAL FIGURES. SITE DIMENSIONS AND FACILITY LOCATIONS NOT VERIFIED.



BROADBENT
875 Cotting Lane, Suite G
Vacaville, California 95688
Project No.: 06-88-644 Date: 3/22/2013

Station #11104
1716 Webster Street
Alameda, California

Groundwater Elevation Contour and
Analytical Summary Map
February 21, 2013

Drawing

2