

Atlantic Richfield Company

Chuck Carmel
Environmental Business Manager

RECEIVED

9:10 am, Feb 01, 2010

Alameda County
Environmental Health

PO Box 1257
San Ramon, CA 94583
Phone: (925) 275-3803
Fax: (925) 275-3815
E-Mail: charles.carmel@bp.com

22 January 2010

Re: Fourth Quarter 2009 Status Report
Former BP Service Station #11104
1716 Webster Street
Alameda, California
ACEH Case #RO0000281

"I declare, that to the best of my knowledge at the present time, that the information and/or recommendations contained in the attached document are true and correct.

Submitted by,



Chuck Carmel
Environmental Business Manager

Attachment

22 January 2010

Project No. 06-88-644

Atlantic Richfield Company
P.O. Box 1257
San Ramon, California 94583
Submitted via ENFOS

Attn.: Mr. Charles Carmel

Re: Fourth Quarter 2009 Status Report, Former BP Service Station #11104, 1716 Webster Street, Alameda, Alameda County, California; ACEH Case #RO0000281

Dear Mr. Carmel:

Provided herein is the *Fourth Quarter 2009 Status Report* for Former BP Service Station #11104 located at 1716 Webster Street, Alameda, California (Site). This report presents a summary of current developments at the Site through Fourth Quarter 2009.

Should you have questions regarding this submittal, please do not hesitate to contact me at (530) 566-1400.

Sincerely,

BROADBENT & ASSOCIATES, INC.



Thomas A. Venus, P.E.
Senior Engineer



Enclosures

cc: Mr. Paresh Khatri, Alameda County Environmental Health (Submitted via ACEH ftp Site)
Ms. Shelby Lathrop, ConocoPhillips, 76 Broadway, Sacramento, California 95818
Electronic copy uploaded to GeoTracker

STATION #11104 QUARTERLY STATUS REPORT

Facility: #11104	Address: 1716 Webster Street, Alameda
Environmental Business Manager:	Mr. Charles Carmel
Consulting Co./Contact Person:	Broadbent & Associates, Inc.(BAI)/Mr. Tom Venus, PE (530) 566-1400
Primary Agency/Regulatory ID No.:	Alameda County Environmental Health (ACEH) ACEH Case #RO0000281
Consultant Project No.:	06-88-644
Facility Permits/Permitting Agency:	NA

WORK PERFORMED THIS QUARTER (Fourth Quarter 2009):

1. Prepared and submitted *Third Quarter 2009 Semi-Annual Ground-Water Monitoring Report* (BAI, 10/30/2009).
2. No environmental field work was conducted at the Site during the Fourth Quarter of 2009.

WORK PROPOSED FOR NEXT QUARTER (First Quarter 2010):

1. Prepared and submitted this *Fourth Quarter 2009 Status Report* (contained herein).
2. Conduct semi-annual ground-water monitoring/sampling for First Quarter 2010.

QUARTERLY RESULTS SUMMARY:

Current phase of project:	Ground-Water Monitoring/Sampling
Frequency of ground-water monitoring:	Semi-Annually (1Q & 3Q): Wells MW-1 through MW-5 and RW-1
Frequency of ground-water sampling:	Semi-Annually (1Q & 3Q): Wells MW-1 and RW-1 Annually (1Q): Wells MW-2 through MW-5
Is free product (FP) present on-site:	No
FP recovered this quarter:	NA
Current remediation techniques:	NA
Depth to ground water (below TOC):	NA
General ground-water flow direction:	NA
Approximate hydraulic gradient:	NA

DISCUSSION:

No environmental field activities took place at the Site during the Fourth Quarter of 2009. The next ground-water monitoring event at the Site is scheduled for First Quarter 2010. The most recent quarterly data for the Site can be referenced in the *Third Quarter 2009 Semi-Annual Ground-Water Monitoring Report* (BAI, 10/30/2009). For further reference, a Site Location Map is provided as Drawing 1. A Ground-Water Elevation Contour and Analytical Summary Map from Third Quarter 2009 is provided as Drawing 2.

ATTACHMENTS:

- Drawing 1. Site Location Map, Station #11104, 1716 Webster Street, Alameda, California
- Drawing 2. Ground-Water Elevation Contour and Analytical Summary Map, 13 October 2009, Station #11104, 1716 Webster Street, Alameda, California

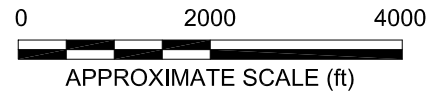
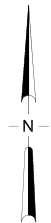
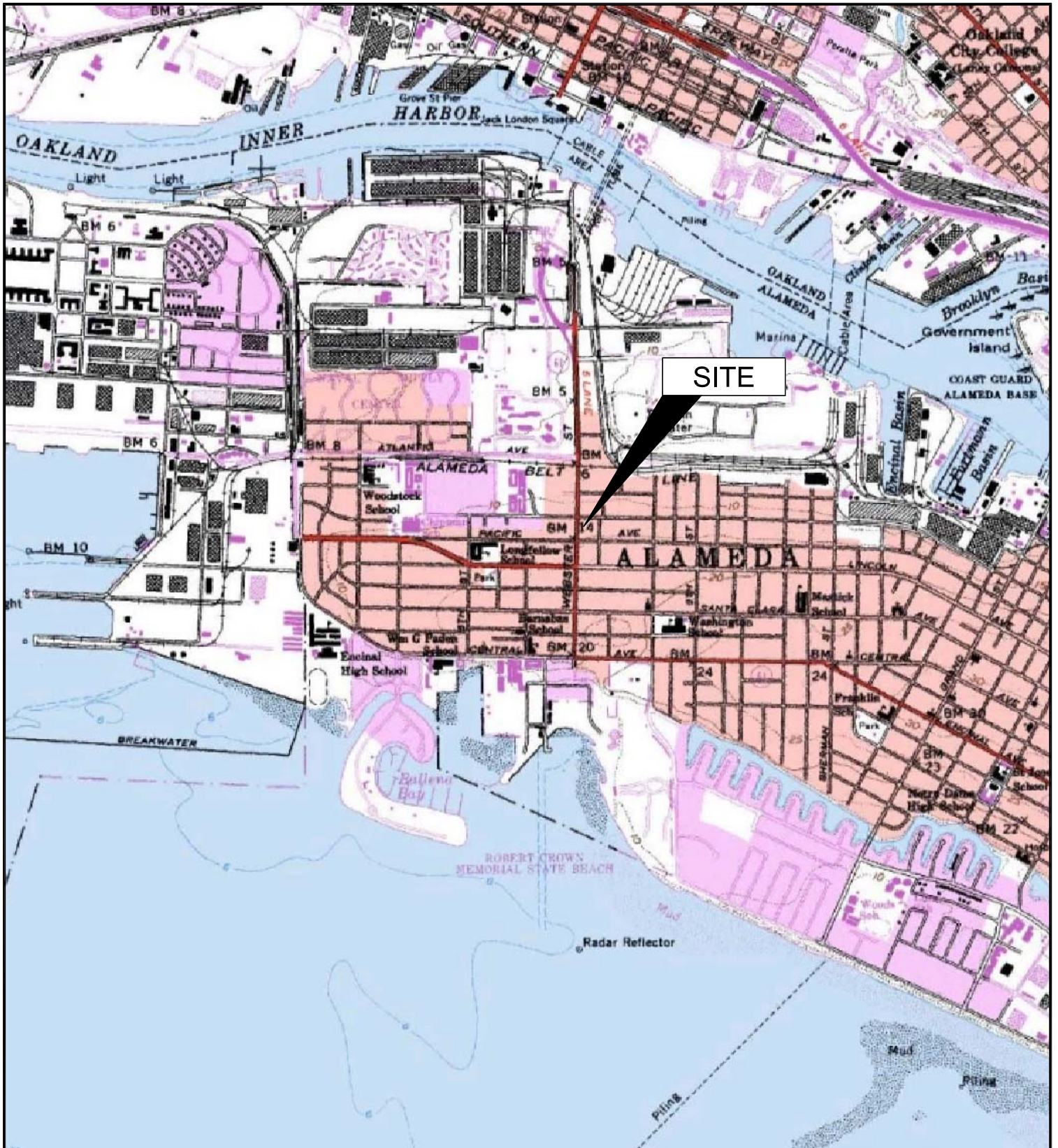

IMAGE SOURCE: USGS

BROADBENT & ASSOCIATES, INC
 ENGINEERING, WATER RESOURCES & ENVIRONMENTAL
 1324 Mangrove Ave. Suite 212, Chico, CA 95926
 Project No.: 06-88-644 Date: 9/1/09

Station #11104
 1716 Webster Street
 Alameda, California

Site Location Map

Drawing
1

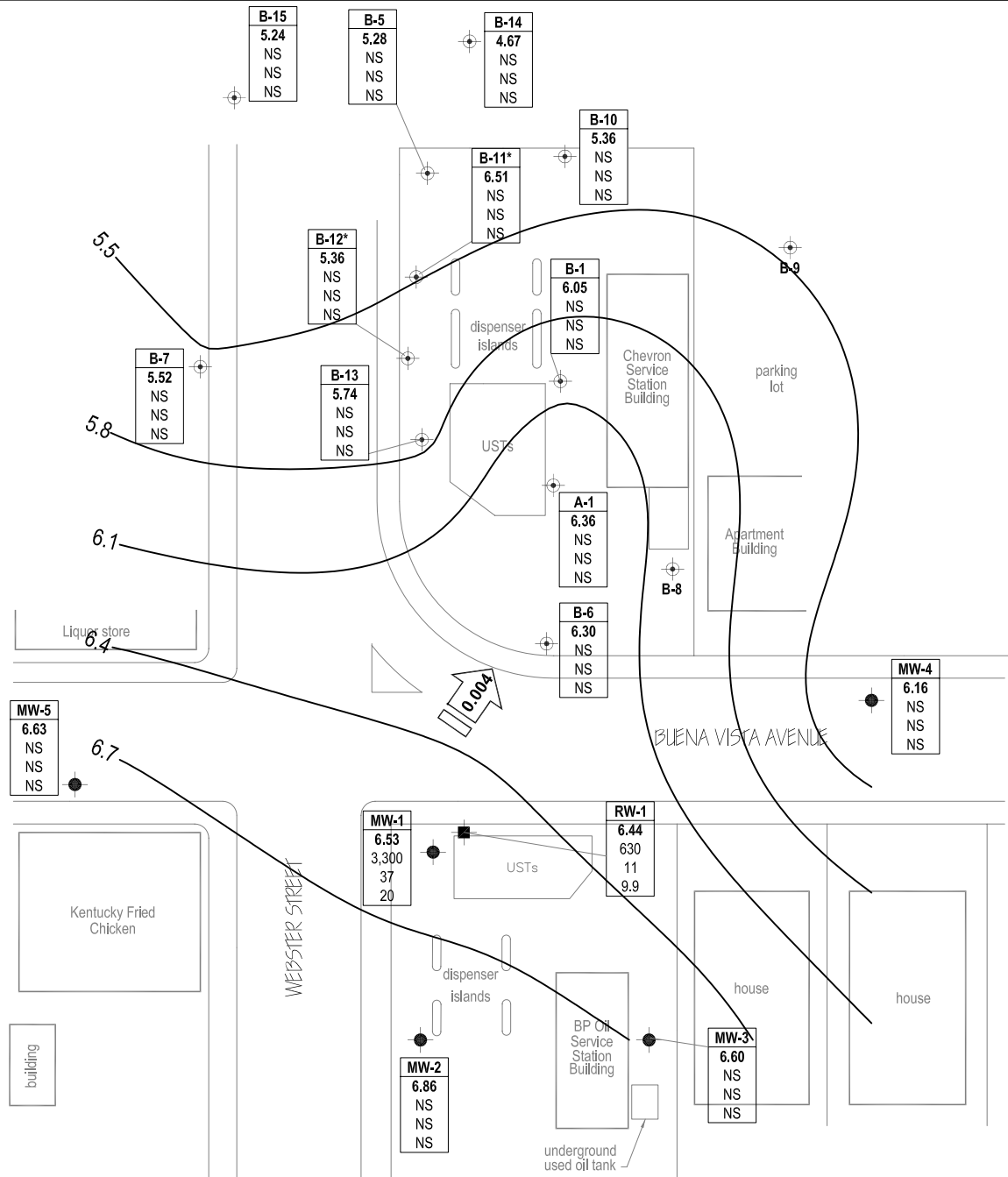

LEGEND

- Monitoring well
- Ground-water recovery well
- Chevron monitoring well
- Ground-water flow direction and gradient (ft/MSL)
- 5.5 Ground-water elevation contour (Feet above site datum)

Well	ELEV	GRO	Benzene	MTBE
	Well designation			
	Ground-water elevation (ft/MSL)			
	GRO, Benzene and MTBE concentrations in ground water (µg/L)			
<	Not detected at or above laboratory reporting limits			
NM/NS	Not Measured/Not sampled			
NA	Not Analyzed			
*	Elevation not used for contouring			

NOTE: SITE MAP ADAPTED FROM CAMBRIA ENVIRONMENTAL FIGURES. SITE DIMENSIONS AND FACILITY LOCATIONS NOT VERIFIED.



BROADBENT & ASSOCIATES, INC.
 ENGINEERING, WATER RESOURCES & ENVIRONMENTAL
 1324 Mangrove Ave. Suite 212, Chico, California
 Project No.: 06-88-644 Date: 10/13/09

Station #11104
 1716 Webster Street
 Alameda, California

Ground-Water Elevation Contour
 and Analytical Summary Map
 27 August 2009

Drawing
2