



Atlantic Richfield Company
(a BP affiliated company)

P.O. Box 1257
San Ramon, California 94583
Phone: (925) 275-3801
Fax: (925) 275-3815

7 July 2009

Re: Second Quarter 2009 Status Report
Former BP Service Station #11104
1716 Webster Street
Alameda, California
ACEH Case #RO0000281

RECEIVED

9:33 am, Jul 29, 2009

Alameda County
Environmental Health



"I declare, that to the best of my knowledge at the present time, that the information and/or recommendations contained in the attached document are true and correct."

Submitted by:

Paul Supple
Environmental Business Manager

7 July 2009

Project No. 06-88-644

Atlantic Richfield Company
P.O. Box 1257
San Ramon, California 94583
Submitted via ENFOS

Attn.: Mr. Paul Supple

Re: Second Quarter 2009 Status Report, Former BP Service Station #11104, 1716 Webster Street, Alameda, Alameda County, California; ACEH Case #RO0000281

Dear Mr. Supple:

Provided herein is the *Second Quarter 2009 Status Report* for Former BP Service Station #11104 (herein referred to as Station #11104) located at 1716 Webster Street, Alameda, California (Site). This report presents a summary of current developments at the Site through Second Quarter 2009.

Should you have questions regarding the work performed or results obtained, please do not hesitate to contact us at (530) 566-1400.

Sincerely,

BROADBENT & ASSOCIATES, INC.



Thomas A. Venus, P.E.
Senior Engineer



Robert H. Miller, P.G., C.HG.
Principal Hydrogeologist

Enclosures

cc: Mr. Paresh Khatri, Alameda County Environmental Health (Submitted via ACEH ftp Site)
Ms. Shelby Lathrop, ConocoPhillips, 76 Broadway, Sacramento, California 95818
Electronic copy uploaded to GeoTracker

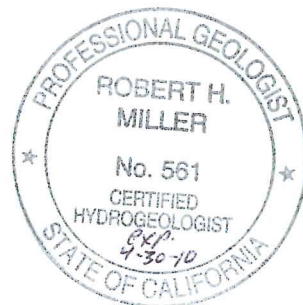

STATION #11104 QUARTERLY STATUS REPORT

Facility: #11104	Address: 1716 Webster Street, Alameda
Environmental Business Manager:	Mr. Paul Supple
Consulting Co./Contact Persons:	Broadbent & Associates, Inc.(BAI)/Rob Miller & Tom Venus (530) 566-1400
Primary Agency/Regulatory ID No.:	Alameda County Environmental Health (ACEH) ACEH Case #RO0000281
Consultant Project No.:	06-08-644
Facility Permits/Permitting Agency:	NA

WORK PERFORMED THIS QUARTER (Second Quarter 2009):

1. Prepared and submitted First Quarter 2009 Semi-Annual Ground-Water Monitoring Report (BAI, 4/30/2009).
2. No environmental work was conducted at the Site during the Second Quarter of 2009.

WORK PROPOSED FOR NEXT QUARTER (Third Quarter 2009):

1. Prepared and submitted this Second Quarter 2009 Status Report (contained herein).
2. Conduct semi-annual ground-water monitoring/sampling for Third Quarter 2009.

QUARTERLY RESULTS SUMMARY:

Current phase of project:	Ground-Water Monitoring/Sampling
Frequency of ground-water monitoring:	Semi-Annually (1Q & 3Q): Wells MW-1, MW-2, MW-3, MW-4, MW-5, RW-1
Frequency of ground-water sampling:	Semi-Annually (1Q & 3Q): Wells MW-1 and RW-1 Annually (3Q): Wells MW-2 through MW-5
Is free product (FP) present on-site:	No
FP recovered this quarter:	NA
Current remediation techniques:	NA
Depth to ground water (below TOC):	NA
General ground-water flow direction:	NA
Approximate hydraulic gradient:	NA

DISCUSSION:

No environmental activities took place at the Site during this quarter. The most recent quarterly data can be referenced in the *First Quarter 2009 Semi-Annual Ground-Water Monitoring Report* (BAI, 4/30/2009) for the Site. A Ground-Water Elevation Contour and Analytical Summary Map from First Quarter 2009 is provided as Drawing 1.

ATTACHMENTS:

- Drawing 1. Ground-Water Elevation Contour and Analytical Summary Map, 11 February 2009, Station #11104, 1716 Webster Street, Alameda, California

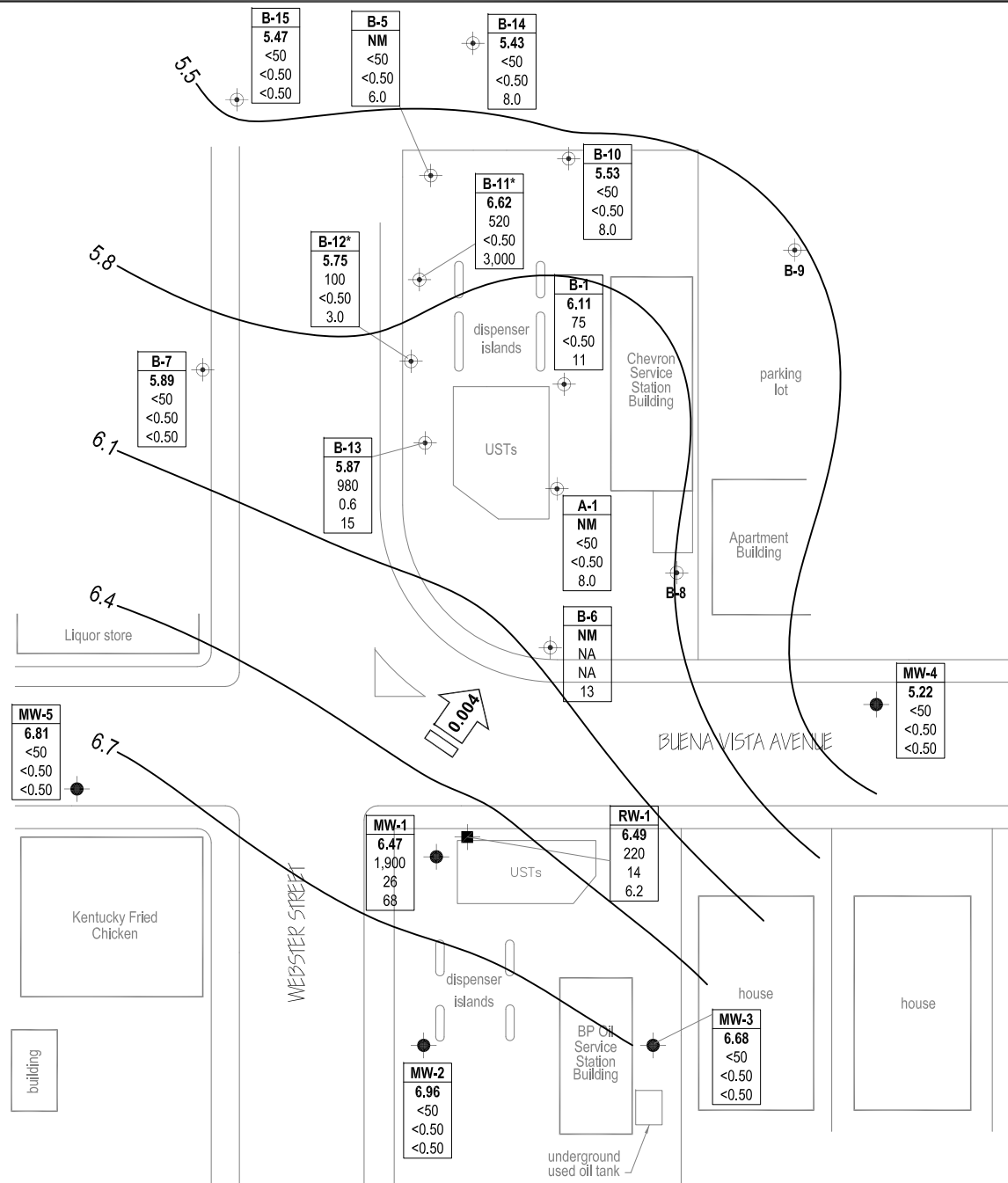

LEGEND

- Monitoring well
- Ground-water recovery well
- Chevron monitoring well
- Ground-water flow direction and gradient (ft/MSL)
- 5.5 Ground-water elevation contour (Feet above site datum)

Well	Well designation
ELEV	Ground-water elevation (ft/MSL)
GRO	GRO, Benzene and MTBE concentrations in ground water (µg/L)
Benzene	
MTBE	

- < Not detected at or above laboratory reporting limits
- NM/NS Not Measured/Not sampled
- NA Not Analyzed
- * Elevation not used for contouring

NOTE: SITE MAP ADAPTED FROM CAMBRIA ENVIRONMENTAL FIGURES. SITE DIMENSIONS AND FACILITY LOCATIONS NOT VERIFIED.



BROADBENT & ASSOCIATES, INC.
 ENGINEERING, WATER RESOURCES & ENVIRONMENTAL
 1324 Mangrove Ave., Suite 212, Chico, California
 Project No.: 06-88-644 Date: 4/16/08

Station #11104
 1716 Webster Street
 Alameda, California

Ground-Water Elevation Contour
 and Analytical Summary Map
 11 February 2009