



Atlantic Richfield Company  
(a BP affiliated company)

P.O. Box 1257  
San Ramon, California 94583  
Phone: (925) 275-3801  
Fax: (925) 275-3815

18 July 2008

Re: Second Quarter 2008 Status Report  
Former BP Service Station #11104  
1716 Webster Street  
Alameda, California  
ACEH Case #RO0000281

**RECEIVED**

2:26 pm, Jul 29, 2008

Alameda County  
Environmental Health



"I declare, that to the best of my knowledge at the present time, that the information and/or recommendations contained in the attached document are true and correct."

Submitted by:

Paul Supple  
Environmental Business Manager

18 July 2008

Project No. 06-08-644

Atlantic Richfield Company  
P.O. Box 1257  
San Ramon, California 94583  
Submitted via ENFOS

Attn.: Mr. Paul Supple

Re: Second Quarter 2008 Status Report, Former BP Service Station #11104, 1716 Webster Street, Alameda, Alameda County, California; ACEH Case #RO0000281

Dear Mr. Supple:

Provided herein is the *Second Quarter 2008 Status Report* for Former BP Service Station #11104 (herein referred to as Station #11104) located at 1716 Webster Street, Alameda, California (Site). This report presents a summary of current developments at the Site through Second Quarter 2008.

Should you have questions regarding the work performed or results obtained, please do not hesitate to contact us at (530) 566-1400.

Sincerely,

BROADBENT & ASSOCIATES, INC.

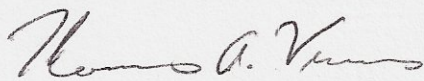

Thomas A. Venus, P.E.  
Senior Engineer

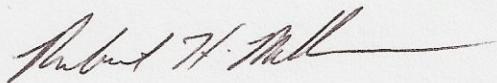

Robert H. Miller, P.G., C.HG.  
Principal Hydrogeologist

Enclosures

cc: Mr. Paresh Khatri, Alameda County Environmental Health (Submitted via ACEH ftp Site)  
Ms. Shelby Lathrop, ConocoPhillips, 76 Broadway, Sacramento, California 95818  
Electronic copy uploaded to GeoTracker

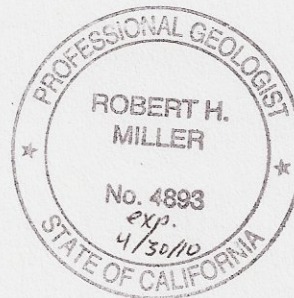

## STATION #11104 QUARTERLY STATUS REPORT

Facility: #11104	Address: 1716 Webster Street, Alameda
Environmental Business Manager:	Mr. Paul Supple
Consulting Co./Contact Persons:	Broadbent & Associates, Inc.(BAI)/Rob Miller & Tom Venus (530) 566-1400
Primary Agency/Regulatory ID No.:	Alameda County Environmental Health (ACEH) ACEH Case #RO0000281
Consultant Project No.:	06-08-644
Facility Permits/Permitting Agency:	NA

### WORK PERFORMED THIS QUARTER (Second Quarter 2008):

1. Prepared and submitted First Quarter 2008 Semi-Annual Ground-Water Monitoring Report.
2. No environmental work was conducted at the Site during the Second Quarter of 2008.

### WORK PROPOSED FOR NEXT QUARTER (Third Quarter 2008):

1. Prepared and submitted this Second Quarter 2008 Status Report (contained herein).
2. Conduct semi-annual ground-water monitoring/sampling for Third Quarter 2008.

### QUARTERLY RESULTS SUMMARY:

Current phase of project:	<b>Ground-Water Monitoring/Sampling</b>
Frequency of ground-water monitoring:	<b>Semi-Annually (1Q &amp; 3Q): Wells MW-1, MW-2, MW-3, MW-4, MW-5, RW-1</b>
Frequency of ground-water sampling:	<b>Semi-Annually (1Q &amp; 3Q): Wells MW-1 and RW-1 Annually (3Q): Wells MW-2 through MW-5</b>
Is free product (FP) present on-site:	<b>No</b>
FP recovered this quarter:	<b>NA</b>
Current remediation techniques:	<b>NA</b>
Depth to ground water (below TOC):	<b>NA</b>
General ground-water flow direction:	<b>NA</b>
Approximate hydraulic gradient:	<b>NA</b>

### DISCUSSION:

No environmental activities took place at the Site during this quarter. The most recent quarterly data can be referenced in the First Quarter 2008 Semi-Annual Ground-Water Monitoring Report for the Site. A Ground-Water Elevation Contour and Analytical Summary Map from First Quarter 2008 is provided as Drawing 1.

### ATTACHMENTS:

Drawing 1. Ground-Water Elevation Contour and Analytical Summary Map, 22 February 2008, Station #11104, 1716 Webster Street, Alameda, California

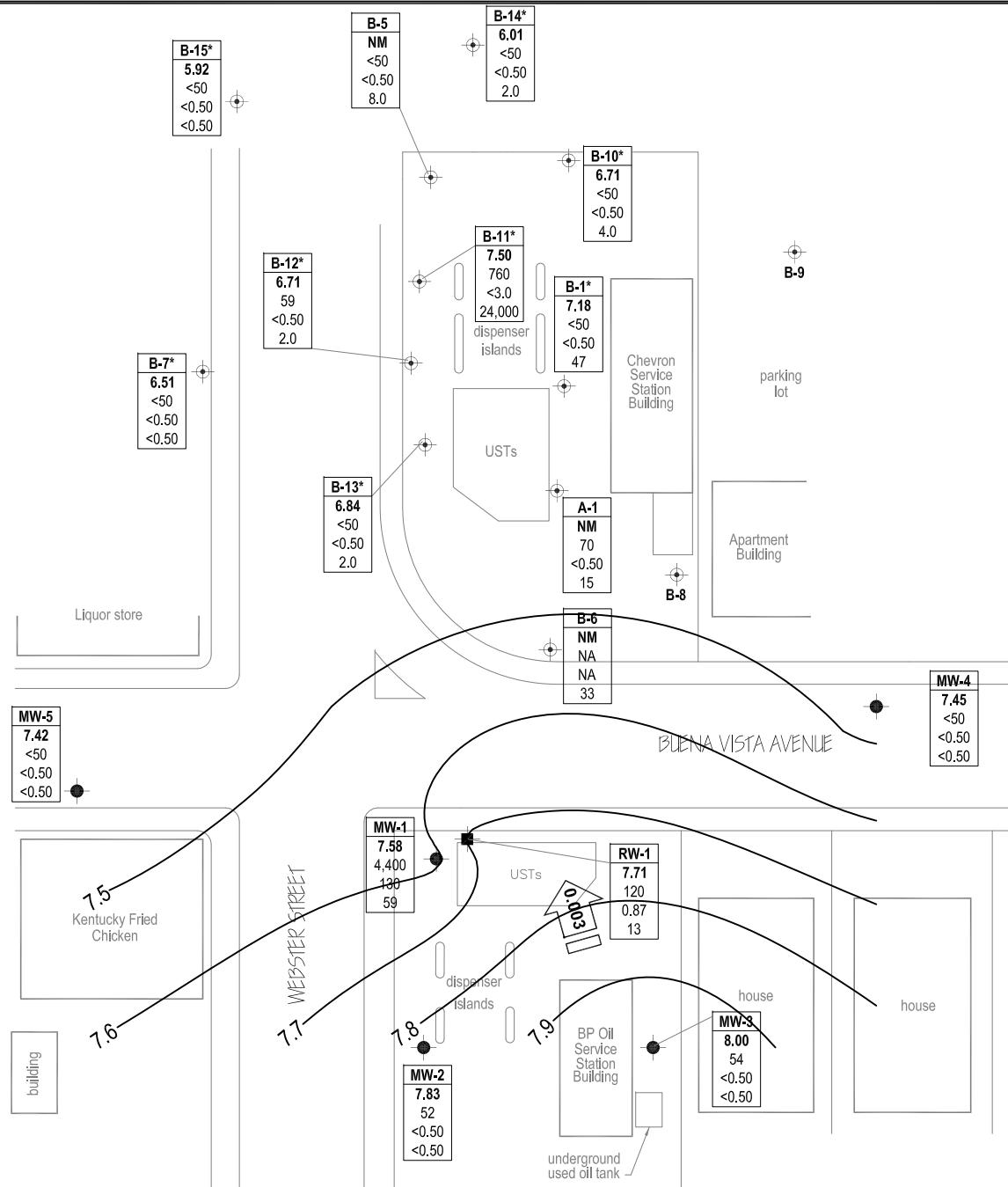

### LEGEND

- Monitoring well
- Ground-water recovery well
- Chevron monitoring well
- Ground-water flow direction and gradient (ft/MSL)
- 7.9 Ground-water elevation contour (Feet above site datum)

Well	
ELEV	Ground-water elevation (ft/MSL)
GRO	GRO, Benzene and MTBE concentrations in ground water (µg/L)
Benzene	
MTBE	
<	Not detected at or above laboratory reporting limits
NM/NS	Not Measured/Not sampled
NA	Not Analyzed
*	Elevation not used for contouring

NOTE: SITE MAP ADAPTED FROM CAMBRIA ENVIRONMENTAL FIGURES. SITE DIMENSIONS AND FACILITY LOCATIONS NOT VERIFIED.



**BROADBENT & ASSOCIATES, INC.**  
 ENGINEERING, WATER RESOURCES & ENVIRONMENTAL  
 1324 Mangrove Ave. Suite 212, Chico, California  
 Project No.: 06-08-644 Date: 4/16/08

Station #11104  
 1716 Webster Street  
 Alameda, California

Ground-Water Elevation Contour  
 and Analytical Summary Map  
 22 February 2008