



Atlantic Richfield Company  
(a BP affiliated company)

Paul Supple  
Environmental Business Manager

Alameda County  
FEB 21 2006  
Environmental Health



RO 281

P.O. Box 6549  
Moraga, California 94570  
Phone: (925) 299-8891  
Fax: (925) 299-8872  
Email: supplpv@bp.com

February 13, 2006

CERTIFIED MAIL  
RETURN RECEIPT REQUESTED

Ms. Donna Drogos  
Alameda County Environmental Health  
1131 Harbor Bay Parkway, S-250  
Alameda, CA 94502

Subject: **Arco Station No. 11104**  
1716 Webster Street  
Alameda, CA

Dear Ms. Drogos

Notification is being sent of a change in the primary consultant for ARCO Station No. 11104. Rob Miller of Broadbent and Associates, Inc. (BAI) will be replacing Lynelle Onishi of URS as the primary consultant for this site as of February 1, 2006. As the primary consultant, BAI will be responsible for all data interpretation and report writing for the site. A second consultant will also be retained for the site to oversee field activities (e.g., drilling, well gauging and sampling, remediation system O&M, etc.). URS will temporarily remain as the consultant overseeing field activities.

In addition, I am now the Atlantic Richfield Company project manager assigned to this site. My contact information is as follows:

Paul Supple  
Environmental Business Manager  
Atlantic Richfield Company  
P.O. Box 6549

Moraga, California 94570  
Phone: (925) 299-8891  
Fax: (925) 299-8872  
Email: [supplpv@bp.com](mailto:supplpv@bp.com)

Going forward, I will be your primary contact for any issues, questions or correspondence regarding this site.

Please do not hesitate to contact me with any questions.

Sincerely,



Paul Supple  
Environmental Business Manager  
Atlantic Richfield Company

CC: Rob Miller, Broadbent and Associates, Inc.

RECEIVED

FEB 17 2006

ENVIRONMENTAL HEALTH SERVICES

Ro 281



Atlantic Richfield Company  
(a BP affiliated company)

Atlantic Richfield Company  
(a BP affiliated company)

6 Centerpointe Drive, Room 172  
La Palma, CA 90623-1066  
Phone: (714) 670-5303  
Fax: (714) 670-5195

6 Centerpointe Drive, Room 172  
La Palma, CA 90623-1066  
Phone: (714) 670-5303  
Fax: (714) 670-5195

December 14, 2005

Re: Fourth Quarter 2005 Status Report  
Former BP Service Station #11104  
1716 Webster Street  
Alameda, California

I declare that, to the best of my knowledge at the present time, the information and/or recommendations contained in the attached document are true and correct.

Submitted by:

Submitted by:

Kyle Christie  
Environmental Business Manager

Kyle Christie  
Environmental Business Manager



December 14, 2005

Ms. Donna Drogos  
Alameda County Health Care Services Agency,  
Environmental Health Services  
1131 Harbor Bay Parkway, Suite 250  
Alameda, CA 94502

Re: **Fourth Quarter 2005 Status Report  
Former BP Service Station #11104  
1716 Webster Street  
Alameda, California**

Dear Ms. Drogos:

On behalf of Atlantic Richfield Company, a BP affiliated company, URS Corporation (URS) is submitting the *Fourth Quarter 2005 Status Report* for the Former BP Service Station #11104, located at 1716 Webster Street, Alameda, California.

If you have any questions regarding this submission, please call me at (510) 874-1758.

Sincerely,

**URS CORPORATION**

Lynelle T. Onishi  
Project Manager

Enclosure: Fourth Quarter 2005 Status Report

cc: Mr. Kyle Christie, Atlantic Richfield Company (RM), electronic copy uploaded to ENFOS  
Ms. Shelby Lathrop, ConocoPhillips, electronic copy uploaded to URS ftp server

Date: December 14, 2005

Quarter: 4Q05

### RM QUARTERLY STATUS REPORT

Facility No.: 11104

Address: 1716 Webster Street, Alameda, California

RM Environmental Engineer:

Kyle Christie

Consulting Co./Contact Person:

URS Corporation / Lynelle Onishi

Consultant Project No.:

38487120

Primary Agency:

Alameda County Environmental Health (ACEH)

#### WORK PERFORMED THIS QUARTER

(Fourth – 2005):

1. No environmental activities this quarter.
2. Prepared and submitted the Second Semi-Annual 2005 Groundwater Monitoring Report.
2. Prepared and submitted this Fourth Quarter 2005 Status Report.

#### WORK PROPOSED FOR NEXT QUARTER

(First – 2006):

1. Perform first semi-annual 2006 groundwater monitoring event.
2. Prepare and submit First Semi-Annual 2006 Groundwater Monitoring Report.

Current Phase of Project:

GW monitoring/sampling

Frequency of Groundwater Sampling:

Wells MW-1 and RW-1 semi-annually (1<sup>st</sup> & 3<sup>rd</sup> Quarter);

Wells MW-2 through MW-5 annually (1<sup>st</sup> Quarter).

Frequency of Groundwater Monitoring:

Biannual

Is Free Product (FP) Present On-Site:

No

Current Remediation Techniques:

NA

Approximate Depth to Groundwater:

NA

Groundwater Gradient (direction):

NA

Groundwater Gradient (magnitude):

NA

#### DISCUSSION:

No environmental activities took place at the Site during this quarter. The most recent quarterly data can be referenced in the Second Semi-Annual 2005 Groundwater Monitoring Report for the Site.

January 20, 2005

Mr. Robert Schultz  
Alameda County Health Care Services Agency,  
Environmental Health Services  
1131 Harbor Bay Parkway, Suite 250  
Alameda, CA 94502

Re: **Fourth Quarter 2004 Status Report**  
**Former BP Service Station #11104**  
**1716 Webster Street**  
**Alameda, California**  
**URS Project #38486810**

Dear Mr. Schultz:

On behalf of Atlantic Richfield Company (RM), a BP affiliated company, URS Corporation (URS) is submitting the *Fourth Quarter 2004 Status Report* for the Former BP Service Station #11104, located at 1716 Webster Street, Alameda, California.

If you have any questions regarding this submission, please call me at (510) 874-1720.

Sincerely,

**URS CORPORATION**



Leonard P. Niles, R.G./C.H.G.  
Project Manager / Senior Geologist

Enclosure: Fourth Quarter 2004 Status Report

cc: Mr. Kyle Christie, RM, (electronic copy uploaded to ENFOS)  
Ms. Liz Sewell, (electronic copy uploaded to FTP server)

Date: January 20, 2005

Quarter: 4Q 04

### RM QUARTERLY STATUS REPORT

Facility No.: 11104

Address: 1716 Webster Street, Alameda, California

RM Environmental Engineer:

Kyle Christie

Consulting Co./Contact Person:

URS Corporation / Leonard Niles

Consultant Project No.:

38486810

Primary Agency:

Alameda Country Environmental Health

#### WORK PERFORMED THIS QUARTER (Fourth – 2004):

1. No environmental activities this quarter.
2. Prepared and submitted Second semi-annual 2004 monitoring report.
3. Prepared and submitted fourth quarter 2004 status report.

#### WORK PROPOSED FOR NEXT QUARTER (First – 2005):

1. Perform first semi-annual 2005 groundwater monitoring event.
2. Prepare and submit first semi-annual 2005 groundwater monitoring report.

Current Phase of Project:

GW monitoring/sampling

Frequency of Groundwater Sampling:

Wells MW-1 and RW-1 semi-annually (1<sup>st</sup> & 3<sup>rd</sup> Quarter);

Wells MW-2 through MW-5 annually (1<sup>st</sup> Quarter).

Frequency of Groundwater Monitoring:

Biannual

Is Free Product (FP) Present On-Site:

No

Current Remediation Techniques:

None currently

Approximate Depth to Groundwater:

NA

Groundwater Gradient (direction):

NA

Groundwater Gradient (magnitude):

NA

#### DISCUSSION:

No environmental activities took place at this site during this quarter. The most recent quarterly data can be referenced in the third quarter 2004 semi-annual groundwater monitoring report for the site.





Atlantic Richfield Company  
(a BP affiliated company)

Atlantic Richfield Company  
4 Centerpointe Drive, Room 172  
La Palma, CA 90623-1066  
Phone: (714) 670-5303

Alameda County  
AUG 25 2004  
Environmental Health

August 13, 2004

Mr. Robert Shultz  
Alameda County Environmental Health  
1131 Harbor Bay Parkway, Suite 250  
Alameda, CA 94502

RE: BP Heritage Sites Environmental Project Responsibility

Dear Mr. Shultz:

The purpose of this letter is to inform you of the recent reorganization of Atlantic Richfield Company's (RM) environmental staff that manages retail facility environmental efforts in Northern California. Former BP retail sites 11102, 11104, 11107, 11109, 11117, 11120, 11126, 11132, 11133, 11266 and 11270 will now be managed by myself. Atlantic Richfield Company heritage sites will continue to be managed by Paul Supple. Please direct all correspondence for retail environmental issues regarding these sites to me at the following address:

Kyle Christie  
Atlantic Richfield Company  
4 Centerpointe Drive, Room 172  
La Palma, CA 90623-1066

I look forward to working closely with you on environmental issues affecting these projects and would appreciate meeting with you to discuss any of these projects at your convenience. Please feel free to call me at (714) 670-5303 with any questions. I can also be reached via email at [chriska@bp.com](mailto:chriska@bp.com).

Sincerely,

Kyle Christie  
Environmental Business Manager  
Remediation Management

cc: Liz Sewell, ConocoPhillips



January 30, 2004

RO 281

Mr. Amir Gholami  
Alameda County Health Services Agency  
1131 Harbor Bay Parkway, 2<sup>nd</sup> Floor  
Alameda, CA 94502

Alameda County  
FEB 04 2004  
Environmental Health

Re: **Fourth Quarter 2003 Status Report  
Former BP Service Station #11104  
1716 Webster Street  
Alameda, California  
URS Project #38486457**

Dear Mr. Gholami:

On behalf of Atlantic Richfield Company (ARCO –a BP affiliated company), URS Corporation (URS) is submitting the *Fourth Quarter 2003 Status Report* for the Former BP Service Station #11104, located at 1716 Webster Street, Alameda, California.

If you have any questions regarding this submission, please call me at (510) 874-1720.

Sincerely,

**URS CORPORATION**

*Leonard P. Niles*  
Leonard P. Niles, R.G./C.H.G.  
Senior Geologist

Attachment: Fourth Quarter 2003 Status Report

cc: Mr. Paul Supple, ARCO, P.O. Box 6549, Moraga, CA 94570  
Ms. Liz Sewell, ConocoPhillips, 76 Broadway, Sacramento, CA 95818

Date: January 30, 2004

Quarter: 4Q 03

### ATLANTIC RICHFIELD QUARTERLY STATUS REPORT

Facility No.: 11104

Address: 1716 Webster Street, Alameda, California

BP Environmental Engineer:

Paul Supple

Consulting Co./Contact Person:

URS Corporation / Leonard Niles

Consultant Project No.:

38486457

Primary Agency:

Alameda Country Department of Environmental Health

#### WORK PERFORMED THIS QUARTER

(Fourth – 2003):

1. No environmental activities this quarter.
2. Prepared and submitted fourth quarter 2003 status report.

#### WORK PROPOSED FOR NEXT QUARTER

(First – 2004):

1. Perform first quarter 2004 groundwater monitoring event.
2. Prepare and submit first quarter 2004 groundwater monitoring report.
3. Perform well head repairs.

Current Phase of Project:

GW monitoring/sampling

Frequency of Groundwater Sampling:

Wells MW-1 and RW-1 semi-annually (1<sup>st</sup> & 3<sup>rd</sup> Quarter);

Wells MW-2 through MW-5 annually (1<sup>st</sup> Quarter).

Frequency of Groundwater Monitoring:

Biannual

Is Free Product (FP) Present On-Site:

No

Current Remediation Techniques:

None currently

Approximate Depth to Groundwater:

NA

Groundwater Gradient (direction):

NA

Groundwater Gradient (magnitude):

NA

#### DISCUSSION:

No environmental activities took place at this site during this quarter. The most recent quarterly data can be referenced in the third quarter 2003 quarterly monitoring report for the site.

20281  
CHd



**Winston H. Hickox**  
Secretary for  
Environmental  
Protection

# State Water Resources Control Board

## Division of Clean Water Programs

1001 I Street • Sacramento, California 95814  
P.O. Box 944212 • Sacramento, California • 94244-2120  
(916) 341-5714 • FAX (916) 341-5806 • [www.swrcb.ca.gov/cwphome/ustcf](http://www.swrcb.ca.gov/cwphome/ustcf)



**Gray Davis**  
Governor

*The energy challenge facing California is real. Every Californian needs to take immediate action to reduce energy consumption. For a list of simple ways you can reduce demand and cut your energy costs, see our website at [www.swrcb.ca.gov](http://www.swrcb.ca.gov).*

**JUL 17 2001**

BP Oil Company  
Scott T. Hooton  
295 Sw 41st St  
Renton, WA 98055

**JUL 19 2001**

UNDERGROUND STORAGE TANK CLEANUP FUND (FUND), NOTICE OF ELIGIBILITY DETERMINATION: CLAIM NUMBER 016524; FOR SITE ADDRESS: 1716 WEBSTER ST, ALAMEDA

Your claim has been accepted for placement on the Priority List in Priority Class "D" with a deductible of \$10,000.

We have completed our initial review. The next step in the claim review process is to conduct a compliance review.

Compliance Review: Staff reviews, verifies, and processes claims based on the priority and rank within a priority class. After the Board adopts the Priority List, your claim will remain on the Priority List until your Priority Class and rank are reached. At that time, staff will conduct an extensive Compliance Review at the local regulatory agency or Regional Water Quality Control Board. During this Compliance Review, staff may request additional information needed to verify eligibility. Once the Compliance Review is completed, staff will determine if the claim is valid or must be rejected. If the claim is valid, a Letter of Commitment will be issued obligating funds toward the cleanup. If staff determine that you have not complied with regulations governing site cleanup, you have not supplied necessary information or documentation, or your claim application contains a material error, the claim will be rejected. In such event, you will be issued a Notice of Intended Removal from the Priority List, informed of the basis for the proposed removal of your claim, and provided an opportunity to correct the condition that is the basis for the proposed removal. Your claim will be barred from further participation in the Fund, if the claim application contains a material error resulting from fraud or intentional or negligent misrepresentation.

Record keeping: During your cleanup project you should keep complete and well organized records of all corrective action activity and payment transactions. If you are eventually issued a Letter of Commitment, you will be required to submit: (1) copies of detailed invoices for all corrective action activity performed (including subcontractor invoices), (2) copies of canceled checks used to pay for work shown on the invoices, (3) copies of technical documents (bids, narrative work description, reports), and (4) evidence that the claimant paid for the work performed (not paid by another party). These documents are necessary for reimbursement and failure to submit them could impact the amount of reimbursement made by the Fund. ***It is not necessary to submit these documents at this time; however, they will definitely be required prior to reimbursement.***

Compliance with Corrective Action Requirements: In order to be reimbursed for your eligible costs of cleanup incurred after December 2, 1991, you must have complied with corrective action requirements of Article 11, Chapter 16, Division 3, Title 23, California Code of Regulations. Article 11 categorized the corrective action process into **phases**. In addition, Article 11 requires the responsible party to submit an

**California Environmental Protection Agency**



*investigative workplan/Corrective Action Plan* (CAP) before performing any work. This phasing process and the workplan/CAP requirements were intended to:

1. help the responsible party undertake the necessary corrective action in a cost-effective, efficient and timely manner;
2. enable the regulatory agency to review and approve the proposed cost-effective corrective action alternative before any corrective action work was performed; and
3. ensure the Fund will only reimburse the most cost-effective corrective action alternative required by the regulatory agency to achieve the minimum cleanup necessary to protect human health, safety and the environment.

In some limited situations *interim cleanup* will be necessary to mitigate a demonstrated immediate hazard to public health, or the environment. Program regulations allow the responsible party to undertake interim remedial action after: (1) notifying the regulatory agency of the proposed action, and; (2) complying with any requirements that the regulatory agency may set. Interim remedial action should only be proposed when necessary to mitigate an immediate demonstrated hazard. ***Implementing interim remedial action does not eliminate the requirement for a CAP and an evaluation of the most cost-effective corrective action alternative.***

Three bids and Cost Preapproval: Only corrective action costs required by the regulatory agency to protect human health, safety and the environment can be claimed for reimbursement. You must comply with all regulatory agency time schedules and requirements and you must obtain three bids for any required corrective action. Unless waived in writing, you are required to obtain preapproval of costs for all future corrective action work. ***If you do not obtain three bids or a waiver of the three bid requirement, reimbursement is not assured and costs may be rejected as ineligible.***

If you have any questions, please contact me at (916) 341-5714.

Sincerely,

**ORIGINAL SIGNED BY**

Shari Knieriem  
Claims Review Unit  
Underground Storage Tank Cleanup Fund

cc: Mr. Steve Morse  
RWQCB, Region 2  
1515 Clay Street, Ste. 1400  
Oakland, CA 94612

Ms. Susan Hugo  
Alameda County EHD  
1131 Harbor Bay Pkway, 2nd Fl.  
Alameda, CA 94502-6577

bp



Scott T. Hooton  
Portfolio Manager

BP Oil Company  
Midwest Environmental Services  
295 SW 41<sup>st</sup> Street  
Bldg. 13, Suite N  
Renton, WA 98055

Switchboard: 425/251-0667  
Central Fax: 425/251-0736

June 6, 2001

Ms. Shari Knieriem  
State Water Resources Control Board  
PO Box 944212  
Sacramento, CA 94244-2120

Re: CLAIM No. 016524  
Former BP Site No. 11104  
1716 Webster Street  
Alameda, CA

Direct: 425/251-0689  
Cell: 206/335-0689  
hootonst@bp.com  
www.bp.com

Dear Ms. Knieriem:

The responds to your 14 May 2001 letter requesting further documentation for the above-referenced matter.

#### **1987 Waste Oil UST Removal**

Mobil Oil Corporation removed a waste-oil UST during 1987. Based on the results of soil testing performed at the time of the removal, Mobil's consultant<sup>1</sup> made the following conclusion: "The analytical results indicate that the concentrations of total hydrocarbons and Volatile Organic Compounds are within acceptable limits established by the regulatory agencies. Therefore, we recommend no further investigation at this time."

BP's files do not contain any correspondence from the Alameda County Health Care Services Agency requiring any follow-up work associated with the 1987 waste-oil tank removal. It seems reasonable, then, to conclude that no cleanup directives were issued.

#### **Pre-1990 Permits**

BP's consultants have been unable to locate documentation showing the underground tanks on this site were permitted prior to January 1, 1990. I understand that the Underground Storage Tank Cleanup Fund will accept reasonable documentation showing the underground tanks were permitted prior to January 1, 1990, including a signature from your agency to that effect.

BP understands that the Alameda County Health Care Services will provide this documentation in the near future. I expect to receive this sometime within the next 60 to 90 days, so please do not render BP's claim ineligible in the meantime.

---

<sup>1</sup> May 4, 1987 Soil Sampling Report for Mobil Service Station 1716 Webster Street Alameda California by Kaprealian Engineering, Inc.

**Cleanup Directive**

Enclosed find a copy of a 27 March 1992 Notice of Requirements to Reimburse as well as a 23 December 1992 workplan comment letter, both from the Alameda County Health Care Services Agency.

Please contact me at (425) 251-0689 if you have questions.

Sincerely,



Scott Hooton

Attachments

cc: site file

✓ Robert Weston, Alameda County Health Care Services Agency, 1131 Harbor Bay Parkway, STE 250, Alameda, CA 94502-6577

bp

EC 16-201



Scott T. Hooton  
Portfolio Manager

BP Oil Company  
Midwest Environmental Services  
295 SW 41<sup>st</sup> Street  
Bldg. 13, Suite N  
Renton, WA 98055

Switchboard: 425/251-0667  
Central Fax: 425/251-0736

June 6, 2001

Mr. Robert Weston  
Alameda County Health Care Services  
Agency  
1131 Harbor Bay Parkway, Room 250  
Alameda, CA 94502-6577

LOP  
COPY

Re: ~~BP Oil Site No. 11104~~  
~~1716 Webster Street~~  
Alameda, CA

Direct: 425/251-0689  
Cell: 206/335-0689  
hootonst@bp.com  
www.bp.com

Dear Mr. Weston:

BP Oil Company is applying to the California Underground Storage Tank Cleanup Fund for the above-captioned site. As you are aware, one of the eligibility requirements is that BP must have applied for or obtained a permit to store an underground gasoline or waste oil tank (UST permit) pursuant to Section 25284 of the California Health and Safety Code prior to January 1, 1990.

BP's consultants have been unable to locate documentation showing the underground tanks on this site were permitted prior to January 1, 1990. The Underground Storage Tank Cleanup Fund has said they will accept reasonable documentation showing the underground tanks were permitted prior to January 1, 1990, including a signature from your agency to that effect.

Please verify for the Cleanup Fund that the underground storage tanks were permitted prior to January 1, 1990, by signing the statement below. This will allow our application to be processed without further delay. Enclosed is a self addressed stamped envelope, and a duplicate of this letter for your files.

If you have questions, please contact me at (425) 251-0689.

Sincerely,

Scott Hooton



The permit to own or operate the underground storage tanks at the above site pursuant to Section 25284 of the California Health and Safety Code, was applied for or obtained prior to January 1, 1990.

*[Handwritten Signature]*      *6-21-01*

Signature

Date

*SA HHS*

Title

cc:    site file  
      Shari Knieriem, Claims Review Unit, Underground Storage Tank Cleanup Fund  
      1001 "I" Street, Sacramento, CA 95814

COPY

20221  
Cfd



# State Water Resources Control Board



**Winston H. Hickox**  
Secretary for  
Environmental  
Protection

## Division of Clean Water Programs

1001 I Street • Sacramento, California 95814  
P.O. Box 944212 • Sacramento, California • 94244-2120  
(916) 341-5714 ♦ FAX (916) 341-5806 ♦ [www.swrcb.ca.gov/cwphome/ustcf](http://www.swrcb.ca.gov/cwphome/ustcf)

**Gray Davis**  
Governor

*The energy challenge facing California is real. Every Californian needs to take immediate action to reduce energy consumption. For a list of simple ways you can reduce demand and cut your energy costs, see our website at [www.swrcb.ca.gov](http://www.swrcb.ca.gov).*

MAY 14 2001

Scott T. Hooton  
Bp Oil Company  
295 Sw 41st St  
Renton, WA 98055

**UNDERGROUND STORAGE TANK CLEANUP FUND (FUND), REQUEST FOR FURTHER DOCUMENTATION DURING INITIAL REVIEW: CLAIM NUMBER 016524; FOR SITE ADDRESS: 1716 WEBSTER ST, ALAMEDA**

After reviewing your claim application to the Cleanup Fund, we find that the following additional information is needed to determine your eligibility for placement on the Priority List:

- 1) Site history indicates that a waste oil UST was removed in 1987. If there was a release before January 1, 1988, provide documentation from the local regulatory agency indicating the cleanup was initiated on or prior to June 30, 1988. If the cleanup was not initiated on or before June 30, 1988, provide documentation from the local regulatory agency stating no direction was given before June 30, 1988 to begin cleanup.
- 2) A copy of the permit to own or operate the UST from the local implementing agency dated between January 1, 1984 and January 1, 1990 (pursuant to Chapter 6.7 of the Health and Safety Code).
- 3) Please provide a copy of the first directive letter from the local regulatory agency directing you to cleanup the contamination.

**NOTE:** Failure to respond to this request within thirty (30) calendar days from the date of this letter may result in an ineligibility determination of your claim.

If you have any questions, please contact me at (916) 341-5714.

Sincerely,

### ORIGINAL SIGNED BY

Shari Knieriem  
Claims Review Unit  
Underground Storage Tank Cleanup Fund

cc: Mr. Steve Morse  
RWQCB, Region 2  
1515 Clay Street, Ste. 1400  
Oakland, CA 94612

Ms. Susan Hugo (STID# 3723)  
Alameda County EHD  
1131 Harbor Bay Pkwy, 2nd Fl.  
Alameda, CA 94502-6577

*California Environmental Protection Agency*





ENVIRONMENTAL  
PROTECTION

MAR 19 PM 12:32

2000 Crow Canyon Place  
Suite 400  
San Ramon, CA 94583  
925.277.2305  
fax: 925.277.2361

**Environmental  
Compliance  
Department**

March 16, 1999

Ms. Eva Chu  
Alameda County Health Care Services - EHS  
1131 Harbor Bay Parkway, Suite 250  
Alameda, CA 94502-6577

Re: Review of maintenance records  
Tosco/BP Station #11104  
1716 Webster  
Alameda, CA

Dear Ms. Chu:

At your request, I have reviewed all the maintenance request records from this site during the time period December 1996 to the present (all the information that Tosco has). There were 27 requests during this period and of that group, all but one was isolated to single dispenser problems (typically a nozzle) or to errors related to the monitoring system (either programming or various circuit relays).

On 7-29-98, it was noted that a vehicle struck one of the dispensers. Gettler-Ryan, Inc. went to the site and replaced the filters and a bent arm of the shear valve. After the repair, the system was checked to make sure there were no leaks. There was no indication of a leak as a result of the accident.

It should be noted that the UST system is the original BP installation with **single-wall tanks and lines with fiber-trench secondary containment**. Last year, the system was upgraded to 1998 EPA standards by the addition of automatic tank gauges, positive line leak detection and positive shut-off.

I apologize for not responding sooner. If you have any questions or concerns of this information, please feel free to call me at 925-277-2384.

Sincerely,

A handwritten signature in black ink, appearing to read 'David B. De Witt'.

David B. De Witt  
Environmental Project Manager



**BP OIL**

BP Oil Company  
Environmental Remediation Management  
295 SW 41st Street  
Renton, Washington 98055-4931  
(425) 251-0667  
Fax No: (425) 251-0736

November 24, 1997

Alameda County Health Care Services Agency  
Attention Ms. Eva Chu  
1131 Harbor Bay Parkway, Room 250  
Alameda, CA 94502-6577

RE: Former BP Oil Site No. 11104  
1716 Webster Street (at Buena Vista)  
Alameda, CA

Dear Ms. Chu:

This letter follows-up the voice mail message that you left for me during the week of November 17, 1997. Your call was made in response to the 2 October 1997 groundwater monitoring and sampling report and my cover letter dated November 4, 1997. During that message, you raised the following concerns:

1. The groundwater monitoring report shows that some kind of release has occurred recently at this site since MTBE concentrations have increased – dramatically.
2. Make sure that someone checks the lines, dispensers, and pump islands for obvious leaks and perform repairs immediately.
3. Forward a status report within 10 days.

You also told me that the Alameda County Health Care Services Agency would follow-up your voice mail message with a formal request if you did not receive the information you requested within 10 working days. Further, that if a definitive leak was not identified, that the ACHCSA would then require the implementation of hydraulic control of the recent MTBE release.

As I explained in the voice mail message that I left for you today, BP transferred the site to Tosco during mid-1994. BP has been performing groundwater monitoring since that time for petroleum hydrocarbons present at the time of the asset transfer. Now that a new petroleum release has occurred, BP will look to Tosco to perform the actions outlined in your voice mail message. Below find contact information for Tosco:

Tosco Marketing Company  
Attention Ms. Tina Berry  
2000 Crow Canyon Place, STE 400  
San Ramon, CA 94583  
510/277-2321  
510/277-2361 (fax)

Please contact me at (425) 251-0689 to discuss any concerns that you may have regarding the assumption of corrective action activities to Tosco.

Sincerely,

  
Scott Hooton

*12/3/97 - left msg w/ T. Berry to follow per station investigation and to report findings to me.*

cc: site file  
K. Graves - RWQCB, SFBR  
T. Berry - Tosco

ALAMEDA COUNTY  
HEALTH CARE SERVICES



AGENCY  
DAVID J. KEARS, Agency Director

Alameda County CC4580  
Environmental Health Services  
1131 Harbor Bay Pkwy., #250  
Alameda CA 94502-6577  
(510)567-6700 FAX(510)337-9335

StID 3723

May 10, 1996

Mr. Scott Hooton  
BP Oil-Bldg 13, Suite N  
295 SW 41st Street  
Renton, WA 98055-4931

**RE: BP Oil Facility #11104, 1716 Webster St, Alameda, CA**

Dear Mr. Hooton:

Upon review of site specific data collected to date, it is not necessary at this time to install a soil and groundwater remediation system at the above referenced site. This decision is based on:

1. adequate source removal at dispenser/pump island;
2. site has been adequately characterized;
3. the dissolved plume is not migrating, and
4. no sensitive receptors are likely to be impacted.

The monitoring/sampling frequency of wells MW-1 and RW-1 may be reduced to a semi-annual basis (to be collected in the spring and fall quarters). The remaining wells should be sampled annually, in the spring quarter. Additional data (bio-indicators) should also be collected to verify that natural bioattenuation is occurring at the site. If oxygen is demonstrated to be a limiting factor, you may consider using an Oxygen Releasing Compound (ORC) in well MW-1.

If you have any questions, I can be reached at (510) 567-6762.

eva chu  
Hazardous Materials Specialist

cc: files



BP OIL

Rec'd 2/26/96  
by ACDEH

BP Oil Company  
Environmental Resources Management  
Building 13, Suite N  
295 SW 41st Street  
Renton, Washington 98055-4931  
(206) 251-0667  
Fax No: (206) 251-0736

February 22, 1996

Alameda County Health Care Services Agency  
Attention Ms. Eva Chu  
1131 Harbor Bay Parkway, Room 250  
Alameda, CA 94502-6577

RE: BP Oil Site No. 11104  
1716 Webster Street  
Alameda, CA

Dear Ms. Chu:

Enclosed please find a report titled Groundwater Monitoring and Sampling Report, dated September 15, 1995. I apologize for the delay in transmitting this report. Upon review of the results, you will note that petroleum hydrocarbons were detected in groundwater samples obtained from two of the monitoring wells. I understand that the extent of the release at this site has been defined to the satisfaction of the Alameda County Health Care Services Agency, based upon the results of coordinated monitoring with Chevron, and a cone penetrometer investigation performed in Webster Street and Buena Vista Avenue. If my understanding is not correct, I would appreciate your efforts to point this out. Please also note that Alisto had contacted Chevron's consultant (Blaine Tech.) several months in advance of mobilization in order to coordinate monitoring, however, Chevron's consultant was not able to meet on the appointed date.

As mentioned in my October 2, 1995 letter to you, we have received bids to complete the engineering design, permitting and bid procurement for the **installation of a soil and groundwater remediation system**. I subsequently received a letter (attached) from the California Regional Water Quality Control Board dated January 16, 1996. The Board's letter described certain changes to the approach advocated for addressing petroleum hydrocarbon releases, and may be germane to this site. In order to ensure that the approach proposed in my October 2 letter remains consistent with ACHCSA policy, and to ensure reimbursement from the UST cleanup fund, please confirm the district's requirements for the installation of a system at this location.

Please also note that the site is scheduled for sampling on February 23. I have asked Alisto to obtain additional samples for total dissolved solids testing to confirm that the groundwater would be considered to have present or future beneficial use. I believe that you can agree that this information is also necessary to evaluate the appropriateness of the installation of a remediation system at this site.

Please give me a call if you have any questions, comments or concerns regarding this matter. I can be reached at (206) 251-0689.

Sincerely,



Scott Hooton  
Environmental Remediation Management

attachments (2)

cc: site file  
B. Nagle/D. Swain - Alisto  
RWQCB-SFBR, Attention E. So, 2101 Webster Street, Ste. 500, Oakland, CA  
94612 (w/attachment)

## CALIFORNIA REGIONAL WATER QUALITY CONTROL BOARD

SAN FRANCISCO BAY REGION  
 2101 WEBSTER STREET, SUITE 500  
 OAKLAND, CA 94612  
 (510) 286-1255



January 16, 1996  
 FILE NO. 2198.15 (TAG)

MR SCOTT HOOTON  
 BP OIL COMPANY  
 ENVIRONMENTAL RESOURCES MANAGEMENT  
 295 SW 41ST STREET  
 BLDG 13, SITE N  
 RENTON, WA 98055-4931

Dear Mr. Hooton:

The enclosed information pertains to the following Alameda County  
 BP Oil Company sites:

RBFILENO	CASENO	STREETNO	STREET	CITY	SITENAME
01-0232		4997	STEVENSON BLVD	FREMONT	BP OIL
01-1001		46840	WARM SPRINGS BLVD	"	"
01-0228		35550	FREMONT BLVD	"	BP OIL/MOBIL
01-0229		37630	BLACOW RD	"	"
01-0230		4190	MOWRY AVE	"	"
01-0994		2492	WHIPPLE RD	HAYWARD	"
01-0273		35425	NEWARK BLVD	NEWARK	BP OIL
01-0225		31300	ALVARADO-NILES RD	UNION CITY	BP OIL/MOBIL
01-0226		31901	ALVARADO BLVD	"	"

JAN 19 1996

BP OIL CO.  
 ENVIRONMENTAL DEPT.  
 WEST COAST REGION OFFICE



Alameda County Department of Environmental Health  
Hazardous Materials Division

80 Swan Way, Rm. 200, Oakland, CA 94621  
Ph: 510-271-4320 FAX: 510-569-4757

Meeting Attendees

Subject BP Oil meeting  
Date 11-16-94  
Location 1131 Harbor Bay Pkwy, Alameda

	<u>Name</u>	<u>Affiliation</u>	<u>Phone #</u> / <u>FAX #</u>
1	<u>SCOTT SEERY</u>	<u>ACDEH - LOP</u>	<u>567-6783 / 337-9335</u>
2	<u>Julie Belmont</u>	<u>Fremont Fire - Hazmat</u>	<u>4044236 / 4044822</u>
3	<u>Jay Swander</u>	<u>Hayward Fire Dept - Hazmat</u>	<u>293-8695 / 293-5017</u>
4	<u>Ted Trenholme</u>	<u>Alameda Co. Water Dist</u>	<u>(510)6591970 / 651-1760</u>
5	<u>Scott Hooten</u>	<u>BP ex 80</u>	<u>206/251 0689/</u>
6	<u>Juan Lopez</u>	<u>ACDEH - LOP</u>	<u>567-6713 / 337-9335</u>
7	<u>JULIET SHIN</u>	<u>" "</u>	<u>567-6763 / 337-9335</u>
8	<u>eva chw</u>	<u>ACDEH - LOP</u>	<u>567-6762 / 337-9335</u>
9			<u> </u>
10			<u> </u>
11			<u> </u>
12			<u> </u>
13			<u> </u>
14			<u> </u>
15			<u> </u>
16			<u> </u>
17			<u> </u>

ALAMEDA COUNTY  
HEALTH CARE SERVICES

AGENCY

DAVID J. KEARS, Agency Director



RAFAT A. SHAHID, Assistant Agency Director

StID 3723

October 25, 1994

Mr. Scott Hooton  
BP Oil  
295 SW 41st Street  
Renton, WA 98055-4931

ALAMEDA COUNTY CC4580  
DEPT. OF ENVIRONMENTAL HEALTH  
ENVIRONMENTAL PROTECTION DIVISION  
1131 HARBOR BAY PKWY., #250  
ALAMEDA CA 94502-6577

**RE: Workplan Approval for BP #11104, 1716 Webster St, Alameda**

Dear Mr. Hooton:

I have completed review of Fugro West's October 1994 Limited Subsurface Investigation Workplan for the above referenced site. The proposal to advance four borings using a cone penetrometer to collect groundwater grab samples along the sewer lines on Webster Street and Buena Vista Avenue is acceptable. Field work should commence within 45 days of the date of this letter, or by **December 19, 1994**. Please notify this office at least 72 hours prior to the start of field activities.

If you have any questions, I can be reached at (510) 567-6762.

eva chu  
Hazardous Materials Specialist

cc: Paul Graff, Fugro, 1050 Melody Ln, #160, Roseville, CA  
95678  
files

## MEMORANDUM

DATE: October 20, 1994  
TO: LOP staff  
FROM: Scott Seery *SS*  
SUBJ: BP Oil Company site review meetings

---

Attached please find a copy of the revised BP Oil bimonthly site review meeting schedule. Such meetings are a stipulation of the settlement between BP and the Alameda County District Attorney's Office. Please note that an additional site (highlighted) will be discussed at the November 16, 1994 meeting.

Please mark your calendars for the date upon which your sites will be discussed. Please be prepared to attend each meeting and be present an in-depth discussion regarding case status, such as:

- o whether BP is adhering to the respective "timeline-to-closure"
- o direction in which the project should proceed
- o appropriateness of target analytes and monitoring/sampling schedules (i.e., should they occur more or less frequently?) *should analyze for total Pb in md-1*
- o whether BP is adhering to agency requests for specific tasks *on track now*
- o what's needed to close case, etc., etc.

Please note that each meeting is scheduled to begin at 9:00 AM.

## TABLE 2

### ANALYTICAL TESTING RESULTS

Montgomery Ward Auto Service Center  
 ENEA Properties  
 Dublin, California  
 Parts per billion (ppb)

Page 3 of 3

#### Well MW-102

Compounds	TPH-G	Benzene	Toluene	Ethylbenzene	Xylenes	Lead
05-13-93	3600	17	ND	130	63	NA
07-14-93	1500	13	ND	64	4.9	ND
10-14-93	24000	9.6	5.2	60	60	ND
01-13-94	2000	22	ND	26	55	ND
04-04-94	2100	16	2.5	15	35	ND

#### EFFLUENT

Compounds	TPH-G	Benzene	Toluene	Ethylbenzene	Xylenes	Lead
04-15-93	ND	ND	ND	ND	ND	ND
07-14-93	ND	ND	ND	ND	ND	ND
10-14-93	ND	ND	ND	ND	0.97	48
01-13-94	ND	ND	ND	ND	ND	ND
04-04-94	ND	ND	ND	ND	ND	33

#### ENEA MW-1

Compounds	TPH-G	Benzene	Toluene	Ethylbenzene	Xylenes	Lead
10-14-93	5700	76	19	160	460	ND
04-04-94*	7000	27	ND	260	49	ND

#### ENEA MW-2

Compounds	TPH-G	Benzene	Toluene	Ethylbenzene	Xylenes	Lead
10-14-93	ND	ND	ND	1.1	0.71	21
04-04-94*	ND	ND	ND	ND	ND	21

#### ENEA MW-3

Compounds	TPH-G	Benzene	Toluene	Ethylbenzene	Xylenes	Lead
10-14-93	2600	26	30	100	130	ND
04-04-94	2600	13	3.4	90	140	ND

#### ENEA MW-4

Compounds	TPH-G	Benzene	Toluene	Ethylbenzene	Xylenes	Lead
04-04-94	ND	ND	ND	ND	ND	23

**NOTE:**

ND Not Detected  
 NA Not Analyzed  
 \* The results for ENEA wells MW-1 & MW-2 have been interchanged for the April 1994 period since it is believed that these samples were mislabeled by EAI's field personnel.

DTP:1233:ANALYTIC.DOC

ALAMEDA COUNTY  
HEALTH CARE SERVICES

AGENCY

DAVID J. KEARS, Agency Director



RAFAT A. SHAHID, Assistant Agency Director

StID 3723

October 3, 1994

Mr. Scott Hooton  
BP Oil  
295 SW 41st Street  
Renton, WA 98055-4931

DEPARTMENT OF ENVIRONMENTAL HEALTH  
Hazardous Materials Division  
1131 HARBOR BAY PKWY., #250  
ALAMEDA CA 94502-6577  
(510)567-6700

NOTICE OF VIOLATION

Dear Mr. Hooton:

On July 13 and again on August 18, 1994 the Alameda County Department of Environmental Health, Hazardous Materials Division, sent you a letter requesting a timetable for the implementation, and a proposal detailing the work intended in the vicinity of utility lines to determine if the backfill around the sewer lines is acting as a preferential pathway for the migration of petroleum hydrocarbons away from **1716 Webster Street, Alameda**. As of the date of this letter, however, we have not received the requested workplan or timetable. Therefore, this letter constitutes a Notice that you are in violation of specific laws and that the technical report is due.

According to Section 25298 of the California Health and Safety Code, underground storage tank closure is incomplete until the responsible party characterizes and remediates the contamination resulting from product discharge. Therefore, BP Oil, as the responsible party is in violation of this section of the Code, for which Section 25299 specifies civil penalties of up to \$5,000, for each day of violation, upon conviction.

You are required to submit the technical reports for the site to this office **within 21 days** from the date of this letter. **Failure to respond may result in referral of this case to the RWQCB or Alameda County District Attorney to consider for enforcement action.** Modification of required tasks or extensions of stated deadlines must be confirmed in writing by either this agency or the RWQCB.

If you have any questions, I can be reached at (510) 567-6762.

eva chu  
Hazardous Materials Specialist

cc: Gil Jensen, Alameda County District Attorney's Office  
Kevin Graves, RWQCB  
files (bpwebster.1)

ALAMEDA COUNTY  
HEALTH CARE SERVICES



AGENCY

DAVID J. KEARS, Agency Director

RAFAT A. SHAHID, Assistant Agency Director

August 18, 1994

Ms. Scott Hooton  
BP Oil Company  
Environmental Resource Mgmt.  
295 Southwest 41st St., Ste N  
Renton, WA 98055

Alameda County CC 4580  
Health Care Services Agency  
Dept. Of Environmental Health  
1131 Harbor Bay Pkwy 2nd Flr.  
Alameda, CA 94502-6577

STID 3723

RE: Investigations at BP Oil Site No. 11104, located at 1716  
Webster St., Alameda, California

Dear Mr. Hooton,

This office has received your letter dated August 2, 1994 regarding the anticipated utility line investigations, and Alisto Engineering's Quarterly Ground Water Report, dated June 7, 1994, for the above site. Per your request, the sampling frequencies for monitoring wells MW-2, MW-3, MW-4, and MW-5 may be switched to a semi-annual basis, due to the fact that ground water samples collected from these wells have identified very low to Non Detect levels of contaminants. However, it was noted that the screened intervals for Wells MW-2 and MW-3 are generally below the water table (screened from 7- to 17-feet below ground surface). Therefore, one of the semi-annual sampling events should be conducted when lower water tables are anticipated.

In your cover letter to the monitoring report, you expressed interest in performing at least one quarterly ground water monitoring event in conjunction with the neighboring Chevron site. The Chevron contact for that site is Mark Miller, whose phone number is (510) 842-8134.

Lastly, per our conversation on August 16, 1994, BP will begin preparing a work plan to address utility line investigations near the site. It is the understanding of this office that BP will submit a timetable outlining the submittal date of the work plan and implementation schedule.

If you have any questions or comments, please contact me at (510) 567-6763.

Sincerely,

Juliet Shin  
Hazardous Materials Specialist

cc: Edgar Howell

ALAMEDA COUNTY  
HEALTH CARE SERVICES  
AGENCY

DAVID J. KEARS, Agency Director



RAFAT A. SHAHID, ASST. AGENCY DIRECTOR

DEPARTMENT OF ENVIRONMENTAL HEALTH  
State Water Resources Control Board  
Division of Clean Water Programs  
UST Local Oversight Program  
80 Swan Way, Rm 200  
Oakland, CA 94621  
(510) 271-4530

July 13, 1994

Scott Hooton  
BP Oil Company  
Environmental Resource Mgmt.  
16400 SouthCenter Pkwy., Ste 301  
Tukwila, WA 98188

STID 3723

RE: BP Oil Site No. 11104, located at 1716 Webster St., Alameda,  
California

Dear Mr. Hooton,

Per our conversation on May 5, 1994 this office requested you to submit a timetable for projected work related to the utility investigations for the above site. In your letter, dated May 5, 1994, you stated that cross-sections of the utility lines, which will be used to develop a scope of work, would be submitted by the end of May 1994. To this date this office has not received a timetable and details of projected work related to the utility lines, nor the cross-sections.

Please submit the above information **within 30 days** of the date of this letter. Lastly, please be reminded that the quarterly ground water report for the May 1994 sampling event is currently due to this office.

The Alameda County Health Department has recently moved to a new office. Our new address is: 1131 Harbor Bay Parkway, Ste 250, Alameda, California 94502. Unfortunately, the County does not yet have a phone system in place. However, we do have some temporary phone numbers that will be in use until about mid-August. My temporary phone number is (510) 337-2874.

Sincerely,

Juliet Shin  
Hazardous Materials Specialist

cc: Edgar Howell-File(JS)



BP OIL

ALCO  
HAZMAT

9 MAY -9 PM 2:05

BP Oil Company  
Environmental Resources Management  
Building 13, Suite N  
295 SW 41st Street  
Renton, Washington 98055-4931  
(206) 251-0667

May 5, 1994

Alameda County Health Care Services Agency  
Division of Hazardous Materials  
Attention Ms. Juliet Shin  
80 Swan Way, Room 200  
Oakland, CA 94621

RE: BP Oil Site No. 11104  
Buena Vista & Webster  
Alameda, CA

Dear Ms. Shin:

Following-up our conversation this morning, we plan to submit two cross-sections showing the orientation of sewer lines relative to soil types and historical groundwater elevations documented at the site. These cross-sections will be used to develop a scope of work which may be necessary to investigate whether the sewer lines are acting as a preferential pathway for the migration of petroleum hydrocarbons away from the site. I will send you the cross-sections by the end of the month.

Should you have any questions or concerns in the meantime, I hope that you will give me a call. I can be reached at (206) 251-0689.

Sincerely,

Scott T. Hooton  
Environmental Resources Management

attachment

cc: site file  
S. Kellstedt - HETI





BP OIL

ALCO  
HAZMAT

94 FEB 14 PM 2:59

BP Oil Company  
16400 Southcenter Parkway, Suite 301  
Tukwila, Washington 98188  
(206) 575-4077

251-0667

February 10, 1994

Alameda County Health Care Services Agency  
Attention Juliet Shin - Hazardous Materials Specialist  
80 Swan Way, Room 200  
Oakland, CA 94621

RE: BP Oil Site No. 11104  
1716 Webster Street  
Alameda, CA

Dear Ms. Shin:

I am writing in response to your letter dated October 14, 1993. In order to comply with your request, please provide copies of all available records regarding the sewer main in Buena Vista Avenue. Completion details, grading information and invert elevations, locations, and survey data proximate to our site will enable us to investigate the main in an appropriate manner. Please provide this information at your earliest convenience so that we may comply with your request.

Sincerely,

Scott T. Hooton  
Environmental Resources Management

cc: site file

*Returned Mr. Hooton to  
Alameda Public Works Dept.  
- JS*

ALAMEDA COUNTY  
HEALTH CARE SERVICES  
AGENCY

DAVID J. KEARS, Agency Director



Post-It™ brand fax transmittal memo 7671 # of pages ▶ 1

To	Public Health	From	Juliet Shin
Co.		Co.	Alameda County
Dept.		Phone #	1-925-71-4530
Fax #	1-925-71-5078	Fax #	

Oakland, CA 94612  
(510) 271-4530

October 14, 1993

Scott Hooton  
BP Oil Company  
Environmental Resource Mgmt.  
16400 SouthCenter Pkwy., Ste 301  
Tukwila, Washington 98188

STID 3723

Re: BP Oil Station No. 11104, located at 1716 Webster St.,  
Alameda, California

Dear Mr. Hooton,

It has recently come to our attention that an 8" sewer main runs along the center of Buena Vista Avenue. The top of this sewer main is located at approximately 5 feet to 6 feet below ground surface in the vicinity of the above site, according to the Alameda Public Works Dept. According to our files, the depth to ground water at the site averages about 5 to 6 feet below ground surface, therefore, this office is concerned that this sewer main may be acting as a conduit for some of the contaminants migrating off the site.

You are required to confirm whether this sewer main is or isn't providing a conduit for the migration of the ground water contaminant plume, in order to adequately address the delineation of ground water contamination resulting from the site.

If you have any questions or comments, please contact me at (510) 271-4530.

Sincerely,

A handwritten signature in cursive script, appearing to read "Juliet Shin".

Juliet Shin  
Hazardous Materials Specialist

cc: Brian Gwinn  
HydroEnvironmental Tech., Inc.  
2363 Mariner Square Drive, Ste 243  
Alameda, CA 94501

Edgar Howell-File(JS)

ALAMEDA COUNTY  
HEALTH CARE SERVICES  
AGENCY

DAVID J. KEARS, Agency Director



RAFAT A. SHAHID, ASST. AGENCY DIRECTOR

DEPARTMENT OF ENVIRONMENTAL HEALTH  
State Water Resources Control Board  
Division of Clean Water Programs  
UST Local Oversight Program  
80 Swan Way, Rm 200  
Oakland, CA 94621  
(510) 271-4530

July 22, 1993

Scott Hooton  
BP Oil Company  
Environmental Resource Mgmt.  
16400 SouthCenter Pkwy., Ste 301  
Tukwila, Washington 98188

STID 3723

Re: BP Oil Station No. 11104, located at 1716 Webster St.,  
Alameda, California

Dear Mr. Hooton,

Per our conversation on June 7, 1993, it appears that quarterly ground water monitoring has not been conducted out at the site since July 1992. No explanations have been given to date as to why quarterly monitoring has not been regularly conducted at the site. Strangely enough, depth-to-water has been measured on a quarterly basis from the site wells, according to Hydro Environmental's Problem Assessment Report, dated June 10, 1993. You are required to immediately start-up quarterly monitoring at the site. Please contact this office with an explanation as to why quarterly monitoring was ever discontinued at the site.

This office has received and reviewed Hydro Environmental's work plan for aquifer and soil vapor extraction testing, dated July 9, 1993. This work plan is acceptable to this office, and subsequent to obtaining appropriate permits, the proposed work can be implemented as scheduled.

If you have any questions or comments, please contact me at (510) 271-4530.

Sincerely,

Juliet Shin  
Hazardous Materials Specialist

cc: Richard Hiett, RWQCB

Francis Maroni  
HydroEnvironmental Tech., Inc.  
2363 Mariner Square Drive, Ste 243  
Alameda, CA 94501

~~Edgar Howell-File~~(JS)



**BP OIL**

BP Oil Company  
16400 Southcenter Parkway, Suite 301  
Tukwila, Washington 98188  
(206) 575-4077

June 23, 1993

Ms. Juliet Shin  
Alameda County Health Care Service Agency  
80 Swan Way, Room 200  
Oakland, CA 94621

Dear Ms. Shin:

RE: Site Prioritization

At your earliest convenience, I would like to request the following information:

- \* A list of major oil company sites with their ranking and prioritization
- \* A copy of our site ranking and prioritization procedure
- \* A list of acceptable cost ranges for contractors, laboratory analysis and consultants for Underground Storage Tank Cleanup Fund purposes.

If you have any questions regarding this request please call me at 206-394-5243.

Sincerely,

BP OIL COMPANY

Scott T. Hooton  
Environmental Resources Management

STH\jc



ALAMEDA COUNTY  
HEALTH CARE SERVICES  
AGENCY

DAVID J. KEARS, Agency Director



RAFAT A. SHAHID, ASST. AGENCY DIRECTOR

DEPARTMENT OF ENVIRONMENTAL HEALTH  
State Water Resources Control Board  
Division of Clean Water Programs  
UST Local Oversight Program  
80 Swan Way, Rm 200  
Oakland, CA 94621  
(510) 271-4530

December 23, 1992

Scott Hooton  
BP Oil Company  
Environmental Resource Mgmt.  
16400 SouthCenter Pkwy., Ste 301  
Tukwila, Washington 98188

STID 3723

RE: Work plan for BP Oil Station No. 11104, located at 1716  
Webster St., Alameda, California

Dear Mr. Hooton,

This office has received and reviewed Hydro Environmental Technologies' work plan, dated December 15, 1992, for the above site. The work plan is acceptable to this office with the following requirements:

- 1) There must be a minimum waiting period of 24 hours after developing the monitoring wells before you can collect ground water samples;
- 2) Since ground water levels have been observed to be as shallow as 5.9 feet below ground surface, it is advisable that the upper well screen limit be changed to 4 feet below ground surface.

Additionally, please be reminded that you will eventually be required to address the further delineation and remediation of the soil contamination observed at the site in 1990 beneath the area of the former dispensers.

Lastly, please be reminded to copy Richard Hiett, San Francisco Bay Region-Water Quality Control Board, on all correspondence and reports regarding the site.

If you have any questions or comments, please contact me at (510) 271-4530.

Sincerely,

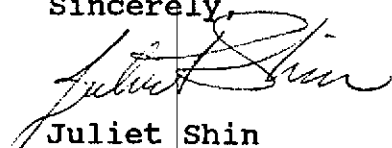
  
Juliet Shin  
Hazardous Materials Specialist

Mr. Scott Hooton  
RE: 1716 Webster St.  
December 23, 1992  
Page 2 of 2

cc: Richard Hiett, RWQCB

Brian Gwinn  
HydroEnvironmental Tech., Inc.  
2363 Mariner Square Drive, Ste 243  
Alameda, CA 94501

Edgar Howell-File (JS)





8. Contact Person for Investigation

Name Andrew Mulligan Title Construction Engineer

Phone 916-631-6917

9. Total No. of Tanks at facility 84

10. Have permit applications for all tanks been submitted to this office? Yes [] No []

11. State Registered Hazardous Waste Transporters/Facilities

a) Product/Waste Tranporter

Name NA EPA I.D. No. \_\_\_\_\_

Address \_\_\_\_\_

City \_\_\_\_\_ State \_\_\_\_\_ Zip \_\_\_\_\_

b) Rinsate Transporter

Name NA EPA I.D. No. \_\_\_\_\_

Address \_\_\_\_\_

City \_\_\_\_\_ State \_\_\_\_\_ Zip \_\_\_\_\_

c) Tank Transporter

Name NA EPA I.D. No. \_\_\_\_\_

Address \_\_\_\_\_

City \_\_\_\_\_ State \_\_\_\_\_ Zip \_\_\_\_\_

d) Tank Disposal Site

Name NA EPA I.D. No. \_\_\_\_\_

Address \_\_\_\_\_

City \_\_\_\_\_ State \_\_\_\_\_ Zip \_\_\_\_\_

e) Contaminated Soil Transporter

Name NA EPA I.D. No. \_\_\_\_\_

Address \_\_\_\_\_

City \_\_\_\_\_ State \_\_\_\_\_ Zip \_\_\_\_\_

12. Sample Collector

Name Chris

Company Mardo Kaprelian Kaprelian

Address P.O. Box 996

City Benecia State CA Zip \_\_\_\_\_ Phone (707) 746-6915

13. Sampling Information for each tank or area

Tank or Area		Material sampled	Location & Depth
Capacity	Historic Contents (past 5 years)		
Product Lines	Super Unleaded Gasoline	Soil	Along pump islands
Product Lines	Regular Unleaded Gasoline	Soil	Along pump islands
Product Lines	Regular Leaded Gasoline	Soil	Along pump islands
			<i>Samples to be collected along sections of removed piping, beneath removed dispensers and from stockpiled soil.</i>

14. Have tanks or pipes leaked in the past? Yes [ ] No [X]

If yes, describe. \_\_\_\_\_

15. NFPA methods used for rendering tank inert? Yes [ ] No [X]

If yes, describe. \_\_\_\_\_

NA

An explosion proof combustible gas meter shall be used to verify tank inertness.

16. Laboratories

Name Sequoia Analytical

Address 680 Chesapeake Drive

City Redwood City State CA Zip 94063

State Certification No. 145 (415) 364-9600

17. Chemical Methods to be used for Analyzing Samples

Contaminant Sought	EPA, DHS, or Other Sample Preparation Method Number	EPA, DHS, or Other Analysis Number
TPH as Gasoline	EPA 5030	Modified 8015 / GC/FID
BTXE		EPA 8020
Total Lead TEL		DHS-LUFT <i>Detection limits must meet RWQCB guidelines as follows:</i> TPH G 1.0 ppm (for soil) BTX+E 0.005 ppm (for soil)

18. Submit Site Safety Plan

19. Workman's Compensation: Yes  No

Copy of Certificate enclosed? Yes  No

Name of Insurer Nationwide Insurance

20. Plot Plan submitted? Yes  No

21. Deposit enclosed? Yes  No

22. Please forward to this office the following information within 60 days after receipt of sample results.

- a) Chain of Custody Sheets
- b) Original Signed Laboratory Reports
- c) TSD to Generator copies of wastes shipped and received
- d) Attachment A summarizing laboratory results

I declare that to the best of my knowledge and belief the statements and information provided above are correct and true. I understand that information in addition to that provided above may be needed in order to obtain an approval from the Department of Environmental Health and that no work is to begin on this project until this plan is approved.

I understand that any changes in design, materials or equipment will void this plan if prior approval is not obtained.

I understand that all work performed during this project will be done in compliance with all applicable OSHA (Occupational Safety and Health Administration) requirements concerning personnel and safety.

\* } I will notify the Department of Environmental Health at least two (2) working days (48 hours) after approval of this closure plan in advance to schedule any required inspections. I understand that site and worker safety are solely the responsibility of the property owner or his agent and that this responsibility is not shared nor assumed by the County of Alameda.

**Signature of Contractor**

Name (please type) \_\_\_\_\_

Signature \_\_\_\_\_

Date \_\_\_\_\_

**Signature of Site Owner or Operator**

Name (please type) A. G. MULLIGAN

Signature *A. G. Mulligan*

Date 4/3/90

I declare that to the best of my knowledge and belief the statements and information provided above are correct and true. I understand that information in addition to that provided above may be needed in order to obtain an approval from the Department of Environmental Health and that no work is to begin on this project until this plan is approved.

I understand that any changes in design, materials or equipment will void this plan if prior approval is not obtained.

I understand that all work performed during this project will be done in compliance with all applicable OSHA (Occupational Safety and Health Administration) requirements concerning personnel and safety.

I will notify the Department of Environmental Health at least two (2) working days (48 hours) after approval of this closure plan in advance to schedule any required inspections. I understand that site and worker safety are solely the responsibility of the property owner or his agent and that this responsibility is not shared nor assumed by the County of Alameda.

Signature of Contractor

Name (please type) W.M. E. GARD, DELTA/BAY BLDGS. INC.

Signature W.M. E. Gard

Date 6-8-90

Signature of Site Owner or Operator

Name (please type) A. G. MULLIGAN

Signature A.G. Mulligan

Date 4/3/90

**UNDERGROUND TANK CLOSURE/MODIFICATION PLANS**

**ATTACHMENT A  
SAMPLING RESULTS**

<b>Tank or Area</b>	<b>Contaminant</b>	<b>Location &amp; Depth</b>	<b>Results (specify units)</b>

## INSTRUCTIONS

**2. SITE ADDRESS**

Address at which closure or modification is taking place.

**5. EPA I.D. NO.**

This number may be obtained from the State Department of Health Services, 916/324-1781.

**6. CONTRACTOR**

Prime contractor for the project.

**7. OTHER**

List professional consultants here.

**12. SAMPLE COLLECTOR**

Persons who are collecting samples.

**13. SAMPLING INFORMATION**

Historic contents - the principal product(s) used in the last 5 years.

Material sampled - i.e., water, oil, sludge, soil, etc.

**16. LABORATORIES**

Laboratories used for chemical and geotechnical analyses.

**17. CHEMICAL METHODS:**

All sample collection methods and analyses should conform to EPA or DHS methods.

Contaminant - Specify the chemical to be analyzed.

Sample Preparation Method Number - The means used to prepare the sample prior to analyses - i.e., digestion techniques, solvent extraction, etc. Specify number of method and reference if not an EPA or DHS method.

Analysis Method Number - The means used to analyze the sample - i.e., GC, GC-MS, AA, etc. Specify number of method and reference if not a DHS or EPA method.

**NOTE:**

Method Numbers are available from certified laboratories.

**18. SITE SAFETY PLAN**

A plan outlining protective equipment and additional specialized personnel in the event that significant amount of hazardous materials are found. The plan should consider the availability of respirators, respirator cartridges, self-contained breathing apparatus (SCBA) and industrial hygienists.

**19. ATTACH COPY OF WORKMAN'S COMPENSATION**

**20. PLOT PLAN**

The plan should consists of a scaled view of the facility at which the tank(s) are located and should include the following information:

- a) Scale
- b) North Arrow
- c) Property Line
- d) Location of all Structures
- e) Location of all relevant existing equipment including tanks and piping to be removed
- f) Streets
- g) Underground conduits, sewers, water lines, utilities
- h) Existing wells (drinking, monitoring, etc.)
- i) Depth to ground water
- j) All existing tanks in addition to the ones being pulled

rev. 9/88  
mam





Majors Engineering

2535 Capitol Oaks Dr., Suite 140  
Sacramento, CA 95833  
FAX (916) 641-7572  
(916) 641-7570

May 22, 1990

Alameda County Health Agency  
Division of Hazardous Materials  
80 Swan Way, Room 200  
Oakland, CA 94621

Attention: Katherine Chesick

Reference: Job #3485-03  
BP Station  
Buena Vista/Webster  
Alameda, CA

Dear Katherine,

Pursuant to your request and our telephone conversation of May 17, this letter will address the six comments you had on the Underground Tank Modification Plan application.

1. Existing tanks are single wall fiberglass and were installed 1983.
2. Existing product piping is single wall.
3. New product piping will be fiberglass (A.O. Smith Red Thread II or Ameron Dualoy 3000).
4. New product piping will be land in secondary trench liner.
5. The EPA I.D. number (CAC000257-409) is provisional.
6. There is an existing computerized leak detection system and tank level sensing system at the site.

We have now addressed all comments with the exception of the contractors insurance information. A contractor has not yet been selected as we are currently in the bidding process. As soon as one is selected he will provide you with the required information.

Please contact me immediately with any questions you may have.

Sincerely,

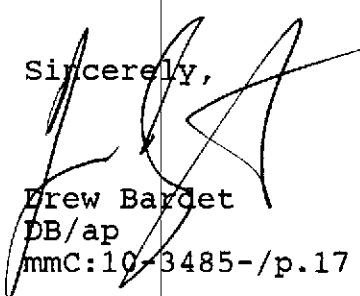
  
Drew Bardet  
DB/ap

mmC:10-3485-/p.17

*7. Note #2 on plans has been revised and referred to note #1.*

**DELTA/BAY BUILDERS, INC.**

P.O. BOX 99  
ANTIOCH, CA 94509

(415) 754-4334

SITE SAFETY PLAN

Project Location: 1541 Park Street, Alameda, Ca. 94501

Project Contractor: Delta Bay Builders, Inc.  
Post Office Box 99  
Antioch, Ca. 94509  
415/754-4334

Project Foreman & Safety Officer: David Gard, William E. Gard

Safety Equipment On Site: Security Barricades  
Two Fire Extinguishers  
Explosimeter  
Protective Clothing Including Gloves & Masks  
Industrial Use First Aid Kit, Each Vehicle

Additional Personnel: Mardo Kaprelian Services  
707/746-6915  
Soils Sampling Technician

Emergency Telephone Numbers: Alameda Fire Dept. - 911  
Alameda Police Dept. - 911

Hospital: Alameda Hospital - 415-522-3700

Ambulance Service: Bay Cities Ambulance  
415/530-7678

# ACORD CERTIFICATE OF INSURANCE

ISSUE DATE (MM/DD/YY)

6/8/90

PRODUCER

JOHN SPOERLE INSURANCE AGENCY  
 NATIONWIDE INSURANCE  
 15750 WINCHESTER BLVD. #203  
 LOS GATOS, CA 95030

CODE SUB-CODE

INSURED

DELTA BAY BUILDER'S, INC.  
 PO BOX 99  
 ANTIOCH, CA 94509

THIS CERTIFICATE IS ISSUED AS A MATTER OF INFORMATION ONLY AND CONFERS NO RIGHTS UPON THE CERTIFICATE HOLDER. THIS CERTIFICATE DOES NOT AMEND, EXTEND OR ALTER THE COVERAGE AFFORDED BY THE POLICIES BELOW

## COMPANIES AFFORDING COVERAGE

- COMPANY LETTER **A** NATIONWIDE INSURANCE
- COMPANY LETTER **B**
- COMPANY LETTER **C**
- COMPANY LETTER **D**
- COMPANY LETTER **E**

### COVERAGES

THIS IS TO CERTIFY THAT THE POLICIES OF INSURANCE LISTED BELOW HAVE BEEN ISSUED TO THE INSURED NAMED ABOVE FOR THE POLICY PERIOD INDICATED, NOTWITHSTANDING ANY REQUIREMENT, TERM OR CONDITION OF ANY CONTRACT OR OTHER DOCUMENT WITH RESPECT TO WHICH THIS CERTIFICATE MAY BE ISSUED OR MAY PERTAIN, THE INSURANCE AFFORDED BY THE POLICIES DESCRIBED HEREIN IS SUBJECT TO ALL THE TERMS, EXCLUSIONS AND CONDITIONS OF SUCH POLICIES. LIMITS SHOWN MAY HAVE BEEN REDUCED BY PAID CLAIMS.

CO LTR	TYPE OF INSURANCE	POLICY NUMBER	POLICY EFFECTIVE DATE (MM/DD/YY)	POLICY EXPIRATION DATE (MM/DD/YY)	ALL LIMITS IN THOUSANDS	
	GENERAL LIABILITY				GENERAL AGGREGATE	\$
	COMMERCIAL GENERAL LIABILITY				PRODUCTS-COMP/OPS AGGREGATE	\$
	CLAIMS MADE OCCUR.				PERSONAL & ADVERTISING INJURY	\$
	OWNER'S & CONTRACTOR'S PROT.				EACH OCCURRENCE	\$
					FIRE DAMAGE (Any one fire)	\$
					MEDICAL EXPENSE (Any one person)	\$
	AUTOMOBILE LIABILITY				COMBINED SINGLE LIMIT	\$
	ANY AUTO				BODILY INJURY (Per person)	\$
	ALL OWNED AUTOS				BODILY INJURY (Per accident)	\$
	SCHEDULED AUTOS				PROPERTY DAMAGE	\$
	HIRED AUTOS					
	NON-OWNED AUTOS					
	GARAGE LIABILITY					
	EXCESS LIABILITY				EACH OCCURRENCE	\$
	OTHER THAN UMBRELLA FORM				AGGREGATE	\$
A	WORKER'S COMPENSATION AND EMPLOYERS' LIABILITY	74WC-504386-0003	1-1-90	1-1-91	STATUTORY	\$
					100,	(EACH ACCIDENT)
					500,	(DISEASE-POLICY LIMIT)
					100,	(DISEASE-EACH EMPLOYEE)

Certificate holder is named as an additional insured.

### DESCRIPTION OF OPERATIONS/LOCATIONS/VEHICLES/RESTRICTIONS/SPECIAL ITEMS

1541 Park Street  
 Alameda, Ca.

### CERTIFICATE HOLDER

Alameda County Health Care Services  
 80 Swan Way, Room 200  
 Oakland, Ca. 94621

### CANCELLATION

SHOULD ANY OF THE ABOVE DESCRIBED POLICIES BE CANCELLED BEFORE THE EXPIRATION DATE THEREOF, THE ISSUING COMPANY WILL ENDEAVOR TO MAIL 30 DAYS WRITTEN NOTICE TO THE CERTIFICATE HOLDER NAMED TO THE LEFT, BUT FAILURE TO MAIL SUCH NOTICE SHALL IMPOSE NO OBLIGATION OR LIABILITY OF ANY KIND UPON THE COMPANY, ITS AGENTS OR REPRESENTATIVES.

AUTHORIZED REPRESENTATIVE  
 John Spørle (408) 395-2008

*Meeting BP + L.O.P.*

(6/26/92)

LIST OF BP OIL SITES WITH UGT CLEANUP

<u>STID#</u>	<u>ACHD CONTACT</u>	<u>BP FACILITY#</u>	<u>ADDRESS</u>
3723	Juliet Shin	Station 11104	1716 Webster Street Alameda 94501
624	Juliet Shin	Station 11126	1541 Park Street Alameda 94501
1809	Eva Chu	Station 11128	4707 First Street Livermore 94550
2043	Eva Chu	Station 11116	7197 Village Parkway Dublin 94568
102	Barney Chan	Station 11109	4280 Foothill Blvd. Oakland 94601
3878	Susan Hugo	Station 11132	3201 35th Avenue Oakland 94619
3877	Barney Chan	Station 11133	2220 98th Avenue Oakland 94603
3105	Susan Hugo	Station 11127	5425 Martin Luther King Oakland 94609
1108	Jennifer Eberle	Station 11102	100 MacArthur Blvd. Oakland 94610
1075	Susan Hugo	Station 11124	3315 High Street Oakland 94619
4050	Susan Hugo	Station 11126	1700 Powell Street Emeryville 94608

BP Meeting w/ L.O.P

8/26/92

Present: Peter De Santis - B.P. Representative  
Markus Niebanck - Hydro Environmental  
Technologies, Inc.

Susan Hong  
Barney Chan  
Juliet Shin  
Jennifer Eberle  
Eva Chu

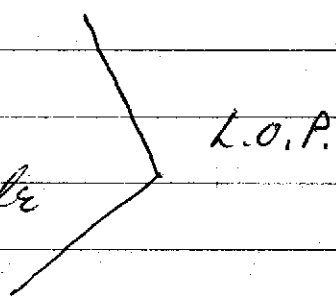

STID: 3723

1716 Webster St., Alameda

- 1) Mr. Shin stressed to B.P. and their consultant that one of the three proposed wells should be within 10 feet of where the contamination was identified beneath the piping in the past. Mr. Niebanck stated that one of the proposed locations for the wells is probably w/in 10 feet of the contamination. However, Ms. Shin stated that she cannot be certain of that fact unless B.P. sends a diagram showing where <sup>soil</sup> samples were collected and which ones were found to be contaminated. The well at corner of Webster and Burma Vista Ave. is closest to former contamination beneath the piping.
- 2) Mr. Shin stated that the work plan for the →

proposed wells did not mention monthly water level measurements, and Ms. Shin stated that she would want B.P. to conduct 12 consecutive monthly water level measurements to determine the ground water gradient behavior. B.P. and its consultants disagreed and stated that they think the only reason one would take 12 consecutive months of water level measurements is if the first several months of water level measurements indicate great fluctuations in the flow direction. Ms. Shin stated that they will be required to take monthly water level measurements for the first 3 months. If there is any indication of fluctuating groundwater flow, they will be required to continue monthly measurements until they have completed 12 months.

3) Ms. Shin requested that B.P. fill out the Unauthorized Leak/Release form for the site and submit it w/in 45 days.

4) Ms. Shin mentioned that his office has some information to indicate that a 550 gallon waste oil tank was removed from the site. B.P. stated that they know nothing about this tank removal, and suggested that they would try and find any information on it.

5) Mr. Shin requested that the site eventually submit a time-frame for closure once they begin receiving the results ~~on~~ for groundwater samples.

6) Alisto Engineering will be conducting the soil sampling for all the B.P. sites this year.

Al Sevilla, P.E.

Alisto Engineering Group  
1000 Burnett Ave., Ste. #420  
Concord, CA 94520

(510) 798-4070

(510) 798-4099 → FAX #

7) B.P. has until ~1995 to clean sites for Mobile (i.e. 7 years, since 1988).

June 24, 1992

Mr. Peter J. DeSantis  
BP Oil Company  
Aetna Building, Ste 360  
2868 Prospect Park Drive  
Rancho Cordova, CA 95670-6020

STID 3723

RE: The BP Oil site located at 1716 Webster Street, Alameda,  
California

Dear Mr. DeSantis,

In September 1990, underground product lines, connected to three underground storage tanks, were removed from the above site and replaced. Soil samples were collected from various points beneath the piping. Analysis of these soil samples identified Total Petroleum Hydrocarbons (TPH) as high as 3,500 parts per million (ppm). Additionally, a ground water sample was collected from the piping trench and analyzed. Laboratory results of this sample identified TPH as gasoline at 38,000 parts per billion (ppb) and benzene at 4,900 ppb.

Guidelines established by the California Regional Water Quality Control Board (RWQCB) require that a soil and ground water investigation be conducted whenever an unauthorized release of product is suspected from an underground storage tank. The above information would indicate that such an event may have occurred.

You are required to conduct a Preliminary Site Assessment (PSA) to determine the lateral and vertical extent and severity of latent soil and ground water contamination which may have resulted from the release at the site. The information gathered by the PSA will be used to determine an appropriate course of action to remediate the site, if deemed necessary. The PSA must be conducted in accordance with the RWQCB Staff Recommendations for the Initial Evaluation and Investigation of Underground Tanks, the State Water Board's LUFT Manual, and be consistent with requirements set forth in Article 11 of Title 23, California Code of Regulations. The major elements of such an investigation are summarized in the attached **Appendix A**. The major elements of the guidelines include, but are not limited to, the following:

- o At least one ground water monitoring well must be installed within 10 feet of the observed soil



Peter DeSantis  
RE: 1716 Webster St.  
June 24, 1992  
Page 3 of 3

- o Interpretation of results: water level contour maps showing gradients, free and dissolved product plume definition maps for each target component, geologic cross sections, etc.
- o Recommendations or plans for additional investigative work of remediation

Please be advised that this is a formal request for technical reports pursuant to **California Water Code Section 13267 (b)**. Any extensions of the stated deadlines, or modifications of the required tasks, must be confirmed in writing by either this agency or RWQCB.

Please be reminded to copy Richard Hiett, at the San Francisco Bay Region-Water Quality Control Board, on all correspondence and reports regarding this site.

This office has enclosed an Unauthorized Leak/Release form. Please complete this form and submit it to this office within 45 days of the receipt of this letter.

Lastly, this office has some information in its files to suggest that a 550-gallon waste oil tank was removed from the site. Please submit to this office any information regarding this removal.

If you have any questions or comments, please contact Juliet Shin at (510) 271-4320.

Sincerely,

Scott O. Seery, CHMM  
Senior Hazardous Materials Specialist

Attachment

cc: Richard Hiett, RWQCB  
Richard Quarante, Alameda Fire Dept.  
Mark Thompson, Alameda County District Attorney's Office  
Edgar Howell-File (JS)

DATE: Feb 27, 1992  
TO : Local Oversight Program  
FROM: Eoachs  
SUBJ: Transfer of Eligible Oversight Case

Site name: BP Oil  
Address: 1716 Webster city Alameda zip 94501  
Closure plan attached?  Y  N DepRef remaining \$ 15,30  
DepRef Project # 940 STID #(if any) 3723  
Number of Tanks: \_\_\_\_\_ removed? Y  N Date of removal 9  
Leak Report filed? Y  N Date of Discovery 9/21/990  
Samples received?  Y  N Contamination: Soil  
Petroleum Y  N Types: Avgas Jet leaded unleaded Diesel  
fuel oil waste oil kerosene solvents  
Monitoring wells on site No Monitoring schedule? Y  N

Briefly describe the following:

Preliminary Assessment \_\_\_\_\_

Remedial Action \_\_\_\_\_

Post Remedial Action Monitoring \_\_\_\_\_

Enforcement Action \_\_\_\_\_

Comments:

Installed 2ndary piping - soil is contaminated -  
Is mw required? Has soil been remediated?

ALAMEDA COUNTY  
HEALTH CARE SERVICES

AGENCY

DAVID J. KEARS, Agency Director



July 25, 1991

DEPARTMENT OF ENVIRONMENTAL HEALTH  
Hazardous Materials Program  
80 Swan Way, Rm. 200  
Oakland, CA 94621  
(415)

Mr. David Kim  
BP Oil Co.  
1716 Webster Street  
Alameda, CA 94501

RO281

NOTICE OF VIOLATION

SUBJ: Five-Year Permit to Operate Four Underground Storage Tanks  
at BP Oil Company Facility #11104, 1716 Webster St.,  
Alameda, California 94501

Dear Mr. Kim:

On July 23, 1991, Maria Mendoza from our office inspected the above premises. The inspection was performed to evaluate whether the conditions for the 5-year underground storage permit were being met prior to its issuance.

As you are aware, four underground storage tanks (three single-walled product and one double-walled waste oil) exist at the subject facility. During this inspection, Ms. Mendoza noted the following violations of Title 23, California Code of Regulations (CCR) and California Health and Safety Code (H&SC):

- 1) Section 2641 and 2644, Title 23, CCR and Section 25292(4) of H&SC - Per Section 2641, CCR, all owners of existing underground storage tanks are to select an appropriate monitoring alternative. If monitoring alternative #5 is selected, the following activities are required: daily inventory reconciliation, annual tank testing and continuous pipeline leak detection.
  - a) Inventory records are currently not maintained properly for the three product tanks. Monitoring alternative in Section 2641 which specifies inventory reconciliation shall take into account: separate daily underground storage tank quantity measurements for both the stored hazardous substance and any water layer, and daily meter readings for underground storage tank input and withdrawal.

Begin performing daily inventory reconciliation and keep records starting from the date of inspection (July 23, 1991). Compare inputs and metered throughputs to a stick reading and keep track of variations.

Submit copies of monthly inventory reconciliation records within 10 days of completion until further notice is given by our office.

- b) Quarterly summary reports have not been submitted to our office. The owner or operator, per Section 2644(e), CCR, shall on a quarterly basis, submit a summary report to the local agency, under penalty of perjury, that either: the data is within allowable variations or a listing of the dates and variations that exceed the allowable variations.

Initially submit quarterly summary report for the first month of doing daily inventory reconciliation until further notice is given by our office. Please find enclosed a sample of a quarterly summary report for your reference.

- 2) Section 2643, CCR and Section 25292 of H&SC - This office has not received copies of annual automatic line leak detector test and annual tightness test results for pressurized piping. Per the above sections, the underground storage tank owner is required to have the automatic line leak detector and underground pressurized piping tightness tested annually. Additionally, the last integrity tests on the product tanks is dated December 12, 1989. Please provide our office with the results of annual tank tightness tests, automatic line leak detection tests and pipeline leak detection tests.
- 3) For the double-walled waste oil tank which was installed in 1987, you are required to submit the following items:
- a) Correctly completed underground storage tank permit application - Form B. An application form is enclosed for your use;
  - b) Initial tank and pipeline precision test results, per Section 2635(7), CCR and Section 25289(b) of the Health and Safety Code;
  - c) A written routine monitoring procedure/plan per Section 2632(d)(1) or 2634(d)(2), Title 23, CCR, which includes, where applicable: the frequency of performing the monitoring method, the methods and equipment to be used for monitoring, where monitoring

will be performed, the location(s) from which the monitoring will be performed, the name(s) or title(s) of the person(s) responsible for performing the monitoring and/or maintaining the equipment, and the reporting format;

Please be advised that the written monitoring plan should include information about calibration and/or maintenance of continuous electronic leak detection system and automatic line leak detector.

- d) A written spill/leak response plan per Section 2632(d) (2), Title 23, CCR. This plan should demonstrate that in the event of an unauthorized release, product would be removed from the secondary container within the shortest possible time. It should include at least the following:
- 1) A description of the proposed methods and equipment to be used for removing the waste oil, including the location and availability of the required equipment, if not permanently on-site, and an equipment maintenance schedule for the equipment located on-site.
  - 2) The name(s) or title(s) of the person(s) responsible for authorizing the work to be performed.

Please note that copies of the documents requested above and other related tank/pipe integrity records shall be maintained on-site for at least three (3) years.

Submit all of the required materials to this office within 10 working days, i.e. no later than August 8, 1991. A follow-up inspection will be conducted upon receipt and review of the required documents, and a five-year operating permit will be issued when the above requirements are met.

Failure to respond in a timely manner could result in civil liabilities under Division 20, Chapter 6.7, Section 25299 of the Health and Safety Code, of not less than five hundred dollars (\$500) or more than five thousand dollars (\$5000) for each underground storage tank for each day of violation.

1716 Webster, Alameda  
July 25, 1991  
Page 4 of 4

Should you have any questions or concerns regarding the contents of this letter, please feel free to contact either Maria Mendoza or myself, at (415) 271-4320.

Sincerely,

*Cynthia Chapman*

*for* Thomas Peacock, Sr. Hazmat Specialist  
Hazardous Materials Division

MAM:mam

cc: Lou Parisi, BP Oil Company  
Gil Jensen, Alameda County District Attorney, Consumer and  
Environmental Protection Division  
Files

enclosures

1716 Webster St., Alameda

10/26/90

secondary ? K.C.

4:30 - 5:00 observed primary piping inspection

Cynthia Chapman

1716 Webster St, Alameda

10/25/90

9:00 Witnessed primary pressure test of 3 product lines +  
one vapor line (60 psi product; 5 psi vapor)

9:35 Left site.



1716 Webster St.

10/11/90

11:50 Arrived on site. The following tanks/piping found on site:  
Single walled fiberglass piping. Single walled tanks installed in 1983.

To be installed:

Double walled piping to connect w/ single walled piping (existing, from tanks). At point of attachment, secondary piping to drain into a sump to be visually monitored via an observation well.

Red jacket pressure monitor already in place.  
Vapor lines must have ball-check valves.

New lines to be pressure tested & soaped

- Precision test to be done on entire system.

3-5 on secondary + vent

24 hr flood test on sumps

60 psi (200% of operating pressure) on pressure lines

12:15 left site

1716 Webster St, Alameda

10/4/90

10:35 Arrived on site

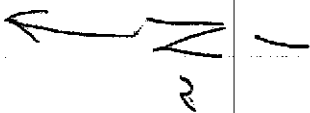

Buena Vista

S-1 (E) 5'  
11:51  
green grey  
silty sand,  
no odor

S-1 (S) 5'  
~~5'~~  
10:42  
Soil is green  
silty sand w/  
gas odor

S-1 (N) 5'  
11:04  
brown sandy silt

S-1 (B) 8.5'  
11:12  
green grey silty sand

S-1 (W) 5'  
11:35  
brown silty  
sand, no odor

Webster

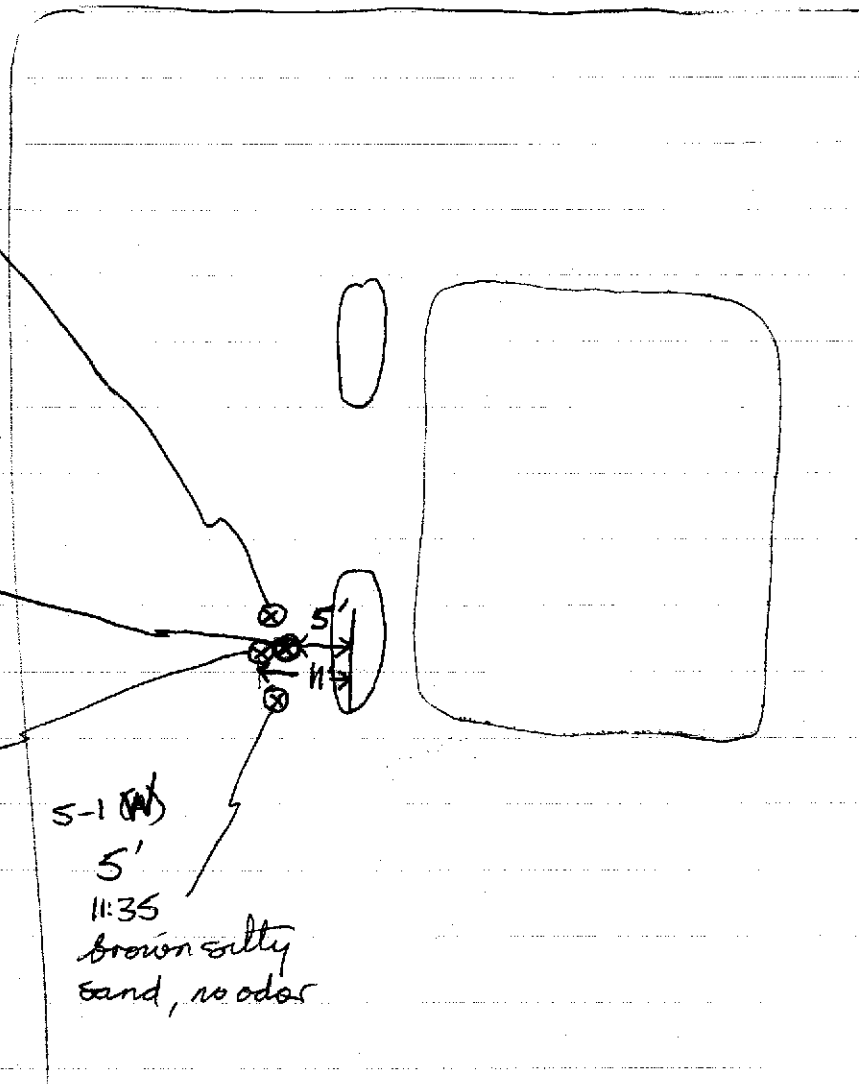

1716 Webster St, Alameda

10/2/90

11:35 Arrived on site. Excavation cleaned out/squared off.  
Water pumped out.

11:51 Soil sample collected. Additional water being  
pumped out before water sample being collected.  
1,000 gallon water pumped out total (fuel, oil + water)

12:48 Grab groundwater sample collected (4 VOA vials)

12:53 Grab groundwater sample collected (3 VOA vials)  
grab groundwater samples collected in the vicinity of  
B-6.

~~XXXXXXXXXXXXXXXXXXXXXXXXXXXX~~

10/2/90

Buena Vista Ave

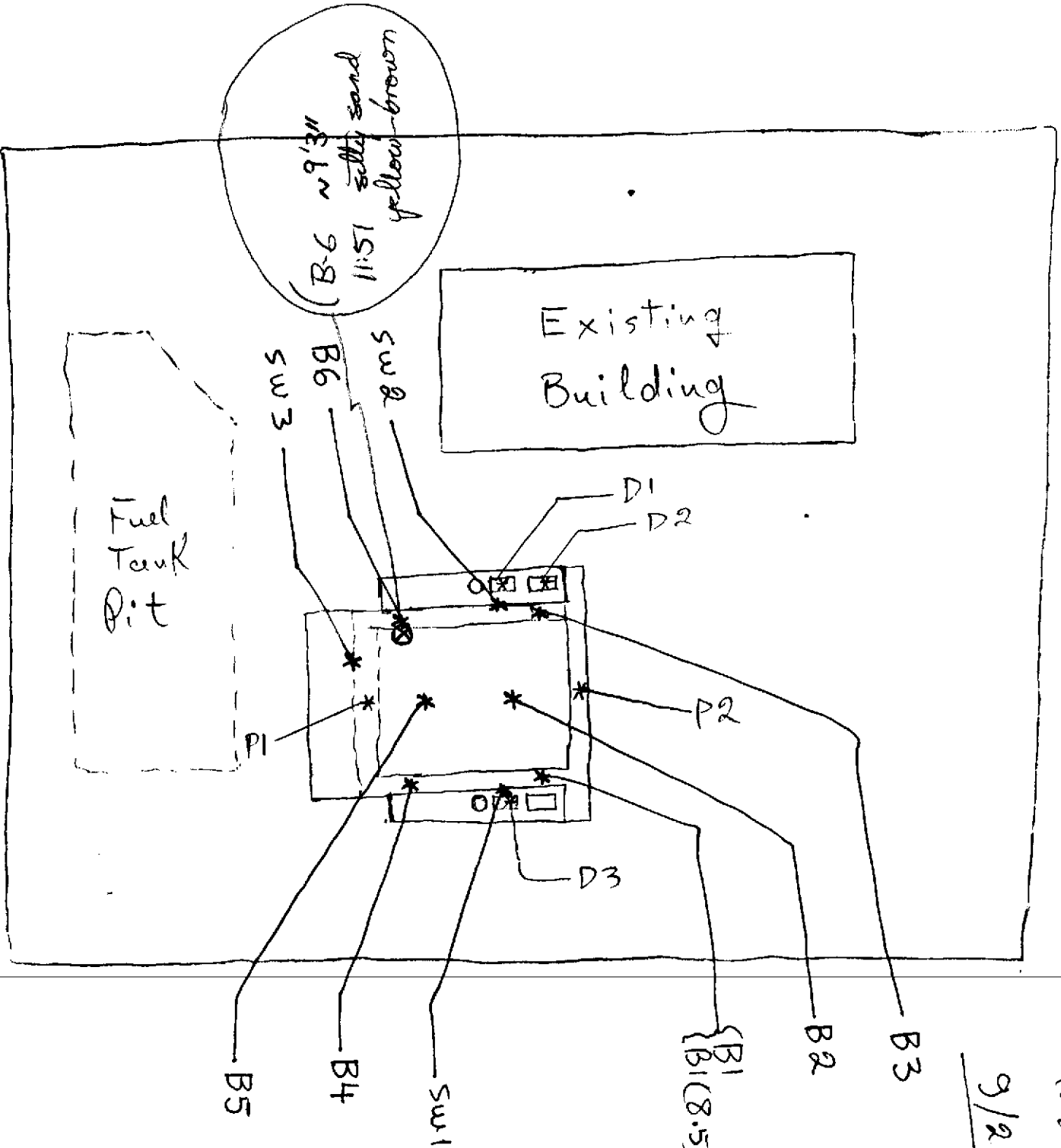

Webster Street

9/26/91

10 Samples

1761 Webster Street, Alameda

9/28/90

11:50 Arrived on site. Excavation underway.

- Next Wednesday
- water to be pumped out; ground water to be sampled after recharge.  
This to be done next week
  - center soil "peninsula" of soil to be excavated
  - additional soil to be excavated at B-6 (280 ppm)  
↓ sample to be taken

Excavation to be backfilled w/ clean ~~fill~~ fill. Then soil to be excavated on the other side of the column (B-1) to determine if contamination extends on the other side of the column.  
↓  
110 ppm

Hagop took photos

I suggested that a fence be put around the site for the weekend.

11:15 left site

1761 Park St., Alameda

9/26/90

Samples to be taken deeper than the excavation. The excavation will be deepened + widened to meet/exceed the sample locations.

2:40 Left site

~~BTB Hddy~~

1761 Webster St, Alameda (BP Station)

9/26/90

10:50 Arrived on site

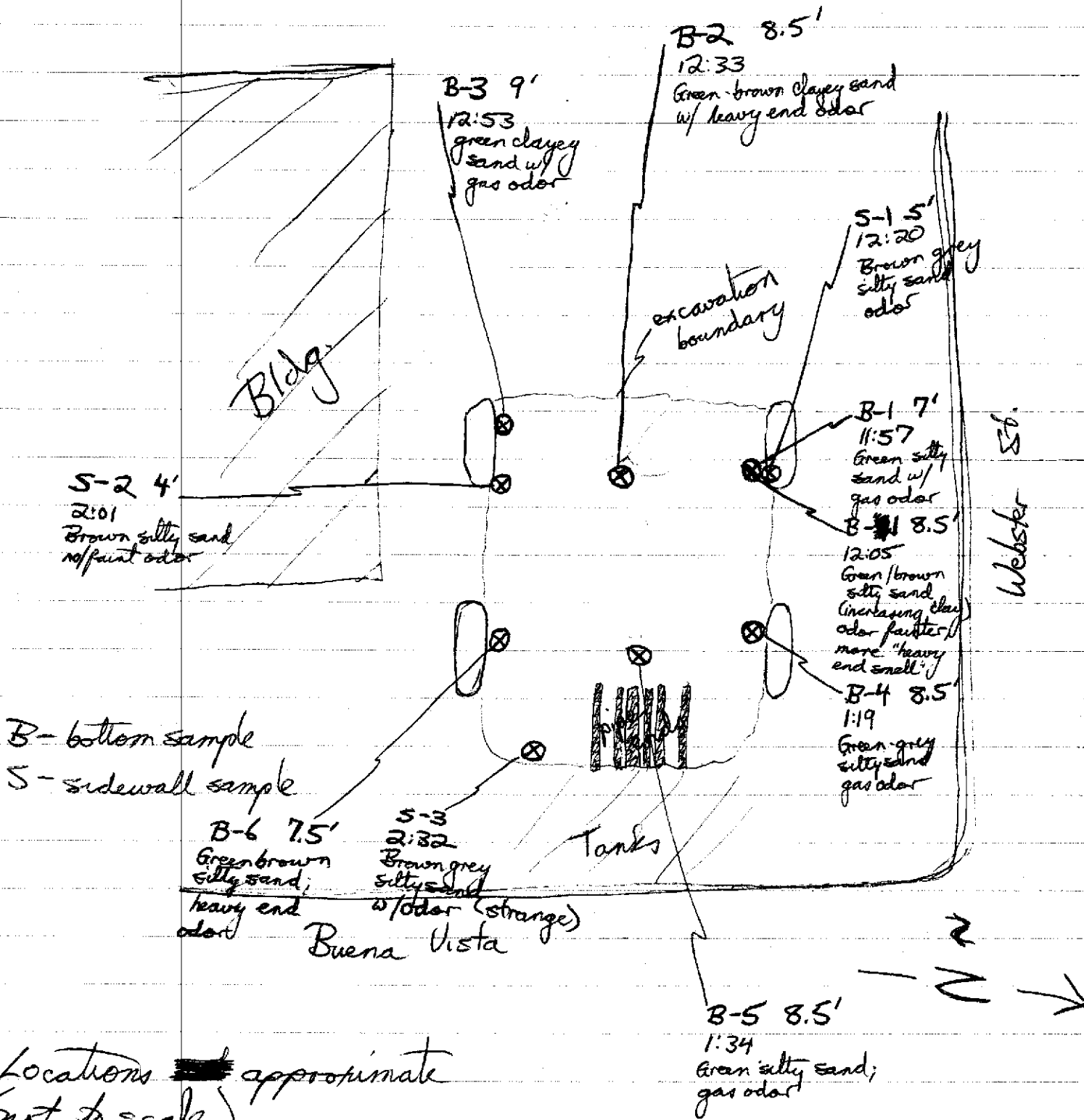

Locations ~~are~~ approximate (not to scale)

WATER RESOURCES CONTROL BOARD  
DIVISION OF WATER QUALITY - UST CLEANUP PROGRAM  
SITE SPECIFIC QUARTERLY REPORT  
01/01/92 THROUGH 03/31/92

AGENCY # : 10000 SOURCE OF FUNDS: F SUBSTANCE: 12034  
StID : 3723  
SITE NAME: BP Oil Facility #11104 DATE REPORTED : 09/21/90  
ADDRESS : 1716 Webster St. DATE CONFIRMED: 09/21/90  
CITY/ZIP : Alameda 94501 MULTIPLE RPs : Y

SITE STATUS  
-----

CASE TYPE: S	CONTRACT STATUS: 2	EMERGENCY RESP:
RP SEARCH: S		DATE COMPLETED:
PRELIMINARY ASMNT:	DATE UNDERWAY:	DATE COMPLETED:
REM INVESTIGATION:	DATE UNDERWAY:	DATE COMPLETED:
REMEDIAL ACTION:	DATE UNDERWAY:	DATE COMPLETED:
POST REMED ACT MON:	DATE UNDERWAY:	DATE COMPLETED:

ENFORCEMENT ACTION TYPE:	DATE ENFORCEMENT ACTION TAKEN:
LUFT FIELD MANUAL CONSID: 2,H,S,C,A	
CASE CLOSED:	DATE CASE CLOSED:
DATE EXCAVATION STARTED :	REMEDIAL ACTIONS TAKEN: NT

RESPONSIBLE PARTY INFORMATION  
-----

RP#1-CONTACT NAME: Alfred De Clercq  
COMPANY NAME:  
ADDRESS: 22455 South Ford Rd  
CITY/STATE: Sonora, C A 95370

---

RP#2-CONTACT NAME: Peter De Santis  
COMPANY NAME: B P Oil  
ADDRESS: 2868 Prospect Park, #360  
CITY/STATE: Rancho Cordova, C A 95670

---



1716 Webster St., Alameda

9/19/90

3:36 Arrived on site

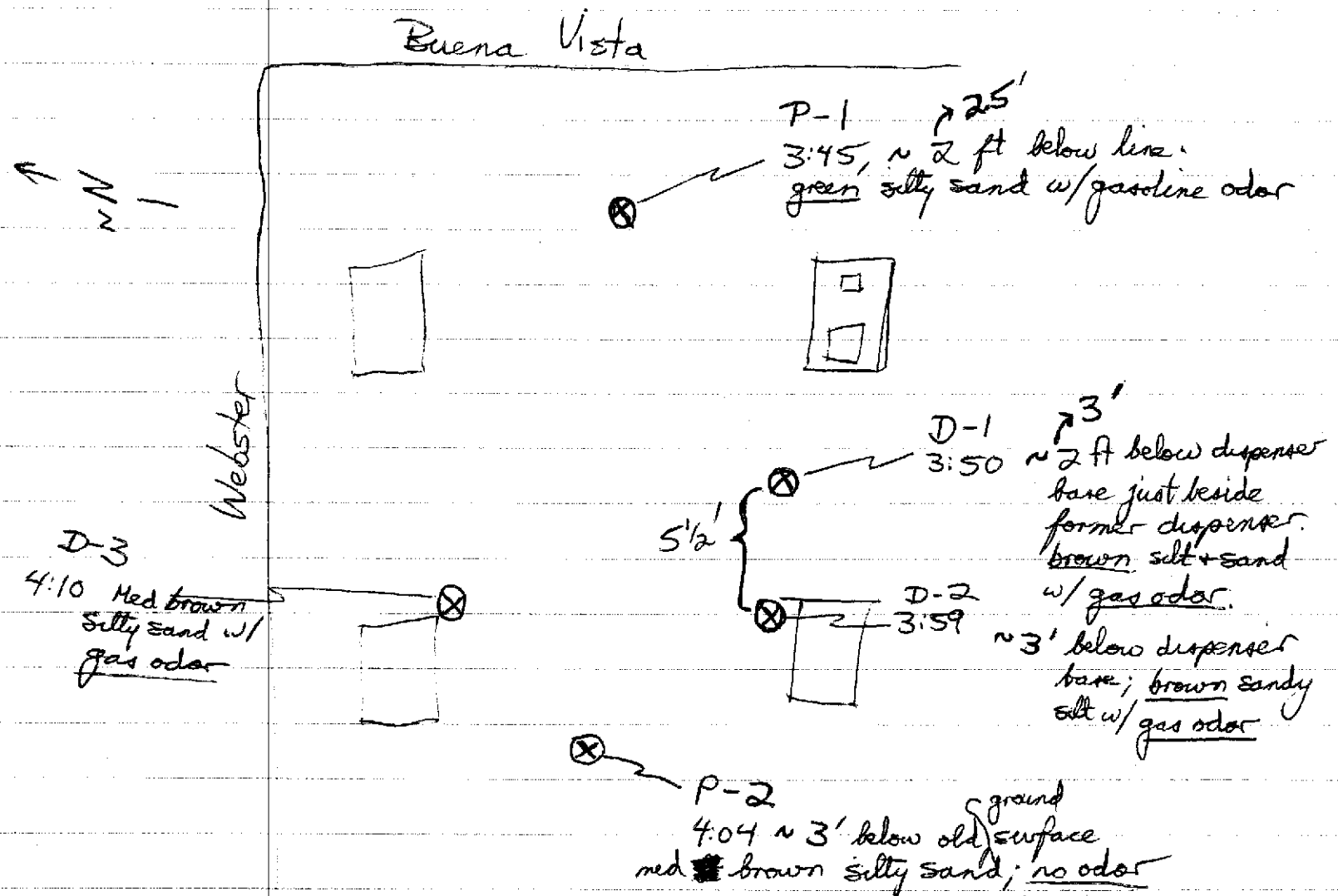

\* Total lead will be run on all samples \*

Stockpiled soil to be sampled (1 sample)

4:20 left site

1716 Webster St, Alameda

9/17/90

Piping exists on site which haven't been in use in "recent" times but which were used earlier. Dave Guard, the job supervisor, thinks the tanks have always been in the same location. Bill thought the tanks used to be in a Ask Alameda Fire Dept. about former/other tank locations different location.

Wednesday - piping sampling - at 1716 Webster



Majors Engineering

2535 Capitol Oaks Dr., Suite 140  
Sacramento, CA 95833  
FAX (916) 641-7572  
(916) 641-7570

May 30, 1990

Alameda County Health Agency  
Division of Hazardous Materials  
80 Swan Way, Room 200  
Oakland, CA 94621

Attention: Kathrine Chesick

Reference: Job #3486-02  
BP Station  
Park/Linear 1716 Webster St.  
Alameda, CA

Dear Catherine,

Pursuant to your request and our telephone conversation of May 17, this letter will address the six comments you had on the Underground Tank Modification Plan application.

1. Existing tanks are <sup>single</sup> ~~double~~ wall fiberglass and were installed in ~~1987-1988~~.
2. Existing product piping is single wall.
3. New product piping will be fiberglass (A.O. Smith Red Thread II or Ameron Dualoy 3000).
4. New product piping will be laid in secondary trench liner.
5. The EPA I.D. number (CAC000238-494) is provisional.
6. There are two existing observation wells at the site.
7. Note #2 on Plan and reference changed to note #1.

We have now addressed all comments with the exception of the contractors insurance information. A contractor has not yet been selected as we are currently in the bidding process. As soon as one is selected he will provide you with the required information.

Please contact me immediately with any questions you may have.

Sincerely,

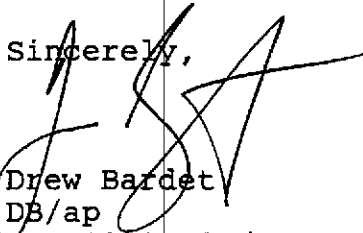
  
Drew Bardet  
DB/ap

mmC:10-3485-/p.17



Majors Engineering

2535 Capitol Oaks Dr., Suite 140  
Sacramento, CA 95833  
FAX (916) 641-7572  
(916) 641-7570

April 20, 1990

Alameda County Health Agency  
Dept. of Hazardous Materials  
80 Swan Way, Rm 200  
Oakland, CA 94621

Attention: Katherine Chesick

Reference: Job #10-3485-01  
                  10-3486-01  
                  BP Service Stations  
                  Buena Vista/Webster  
                  Park/Lincoln  
                  Alameda, CA

Dear Katherine,

Please find enclosed the revised drawings of the product piping plans for both Alameda sites. The first set was submitted to you by Drew Bardet from our office on 4/19/90. Please discard that set and use the new set.

The only change made was the addition of some general notes to clarify the drawings better.

Please feel free to call if you have any questions.

Sincerely,

MAJORS ENGINEERING, INC.

Mike Hogenboom

MH/ap

C:10-3485-/p.15

91 MAY 23 AM 11:33

ALAMEDA COUNTY HEALTH CARE SERVICES AGENCY  
MEMORANDUM

DATE : 5/19  
TO : Bureau of Environmental Health Services - North County 21504  
- South County 50725  
FROM : Public Health Billing Section, Finance Divison 20601 HAZ. MAT  
SUBJECT: Delinquent Environmental Health Accounts

The following Environmental Health account is delinquent in the payment of Environmental Health Service fees. This account may be transferred to Central Collections. Will you confirm that our information is current and correct? If an item has changed, please cross out the incorrect item and write in the correct information in the remarks section below:

C.T.# \_\_\_\_\_

Account # T 91220 7/6/89

\*\*\*\*\*

Premises Name B.P. Oil Co Site # 11104 IP 11/06/88

Premises Address 1716 WEBSTER ST A1A

Legal Owner of Business \_\_\_\_\_

Residential Address \_\_\_\_\_

Comments: any change since 3/16/90?

\*\*\*\*\*

Please indicate current status of

- 1. Current Owner \_\_\_\_\_
- 2. Out of business, no longer in operation \_\_\_\_\_  
Still in operation \_\_\_\_\_
- 3. Date of last inspection \_\_\_\_\_
- 4. Remarks: \_\_\_\_\_

*This just gotten their inferior permit lost 11/06/89 why you need to send it to the collecti agency.*

Completed by \_\_\_\_\_ Date \_\_\_\_\_

\*\*\*\*\*

Thank you in advance for your assistance. Please return completed form as soon as possible. To: Public Health Billing, Qic Code 21506. If you have any questions, please contact

Laudy 34375 (Name and Phone #)  
He

*Get a copy 3/23/90*

**ROBERT H. LEE & ASSOCIATES INC.**

900 Larkspur Landing Circle  
Suite 125  
LARKSPUR, CALIFORNIA 94939

(415) 461-8890

**LETTER OF TRANSMITTAL**

TO ALAMEDA CO. DEPT. OF ENVIRONMENTAL HEALTH  
470 27TH STREET ROOM 32A  
OAKLAND, CA. 94612

DATE	2/20/87	JOB NO.	7295
ATTENTION	MR. TED GEROW		
RE:	WASTE OIL TANK REPLACEMENT AT:		
	MOBIL OIL CORP. S.S.#10-073		
	1716 WEBSTER STREET		
	ALAMEDA, CA. 94501		

WE ARE SENDING YOU  Attached  Under separate cover via \_\_\_\_\_ the following items:

- Shop drawings     Prints     Plans     Samples     Specifications  
 Copy of letter     Change order     \_\_\_\_\_

COPIES	DATE	NO.	DESCRIPTION
(2)	2-11-87		COMPLETE SETS OF PLANS DRGGS. 1 OF 4 -> 4064

**RECEIVED**  
 FEB 22 1987  
 ENVIRONMENTAL HEALTH  
 ADMINISTRATION

THESE ARE TRANSMITTED as checked below:

- For approval     Approved as submitted     Resubmit \_\_\_\_\_ copies for approval  
 For your use     Approved as noted     Submit \_\_\_\_\_ copies for distribution  
 As requested     Returned for corrections     Return \_\_\_\_\_ corrected prints  
 For review and comment     \_\_\_\_\_  
 FOR BIDS DUE \_\_\_\_\_ 19 \_\_\_\_\_     PRINTS RETURNED AFTER LOAN TO US

REMARKS PEAR TED,

PLEASE CALL ME IF YOU HAVE ANY QUESTIONS OR AS SOON AS YOU HAVE COMPLETED YOUR REVIEW. WE WILL FORWARD AN APPROVED COPY TO THE CITY OF ALAMEDA BLDG. DEPT. THEY WILL NOTIFY THE FIRE DEPT. IT IS OUR UNDERSTANDING THAT WE WILL BE BILLED FOR ~~BY~~ YOUR DRAWING REVIEW FEE.

THANK YOU VERY MUCH!

COPY TO TIM ROSS (MOBIL OIL CORP.)  
FILE

SIGNED: Lawrence J. [Signature]