

STD 3160

November 10, 1994

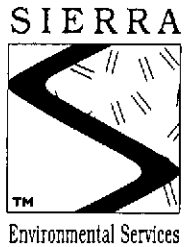

Susan Hugo  
Alameda County Department of Environmental Health  
1131 Harbor Bay Parkway  
Alameda, CA 94502

Re: Work Plan Addendum  
Telegraph Business Park  
5427 Telegraph Avenue  
Oakland, California  
SES Project #4-719-02

NOV 14 11:45 AM  
HAZMAT

Dear Ms. Hugo:

As per your requirements for the above-referenced site, and as discussed during our meeting of October 11, 1994, Sierra Environmental Services (SES) will complete additional subsurface investigation to further evaluate the extent of petroleum hydrocarbons in ground water. The required additional work is outlined below.

1. Drill five soil borings to be used as expedient ground water sampling points. The borings will be drilled to a depth of approximately five feet below the water table.
2. Collect "grab" ground water samples from each of the five soil borings. Analyze water samples for Stoddard Solvent, BTEX, VOCs (EPA method 8240) and Oil & Grease (EPA method 5520).
3. Properly dispose of drill cuttings and equipment rinseate.
4. Report results and make recommendations for future work.

SES will complete this work during the week of November 28, 1994. All work will be performed in accordance with procedures outlined in SES's work plan of May 11, 1993, and work plan addendum of December 6, 1993.<sup>1,2</sup>

<sup>1</sup> Sierra Environmental Services, Inc., 1993, Consultant's Subsurface Investigation Work Plan prepared for Telegraph Business Properties, May 11, 1993, 5 pages and 3 appendices.

<sup>2</sup> Sierra Environmental Services, Inc., Consultant's Work Plan Addendum prepared for Telegraph Business Properties, December 6, 1993, 2 pages and 2 appendices.

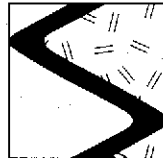

SIERRA

Susan Hugo  
November 10, 1994  
SES Project #4-719-02

Page 2

Please contact John Trigg or me if you have any questions regarding this work plan.

Sincerely,  
Sierra Environmental Services

A handwritten signature in black ink, appearing to read 'R. E. Hilton', written over a horizontal line.

Richard E. (Rick) Hilton  
Staff Environmental Scientist

A handwritten signature in black ink, appearing to read 'John M. Trigg', written over a horizontal line.

John M. Trigg, R.E.A.  
Project Geologist

REH/JMT/lmo  
71902L1.NO4

Attachments: Appendix A - Figures

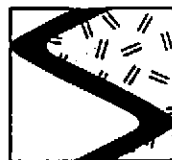

SIERRA

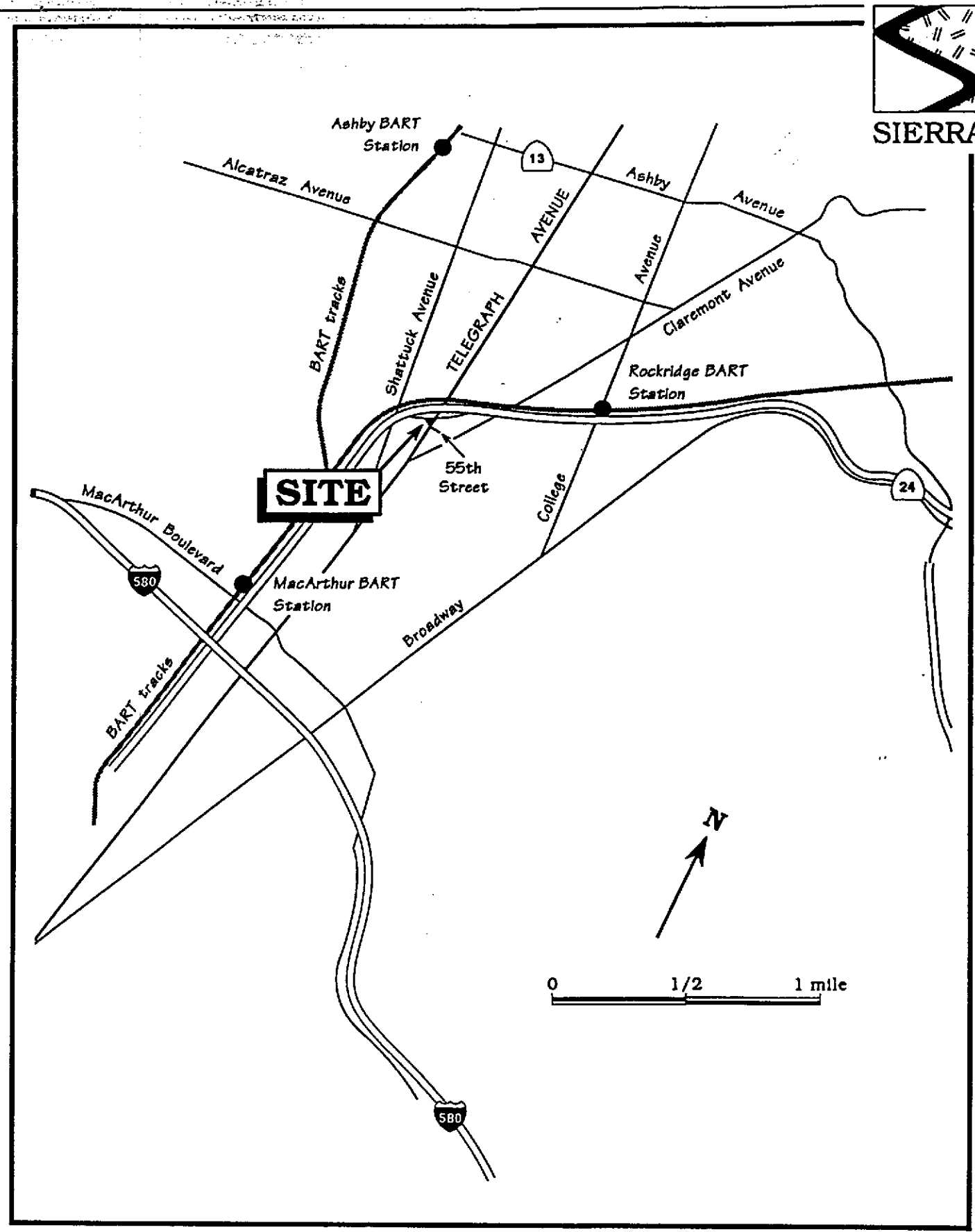

Figure 1. Site Location Map - Telegraph Business Park, Oakland, California



SIERRA

**EXPLANATION**

- ⊕ MW-3 Monitoring well
- B-9 Grab ground water sampling location
- ▲ B-14 Proposed grab ground water sampling location

Historic ground water flow direction

HIGHWAY 24 (elevated)

55TH STREET

TELEGRAPH AVENUE

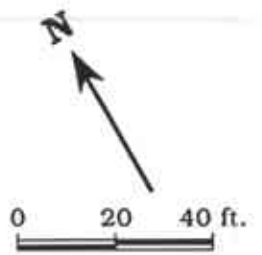
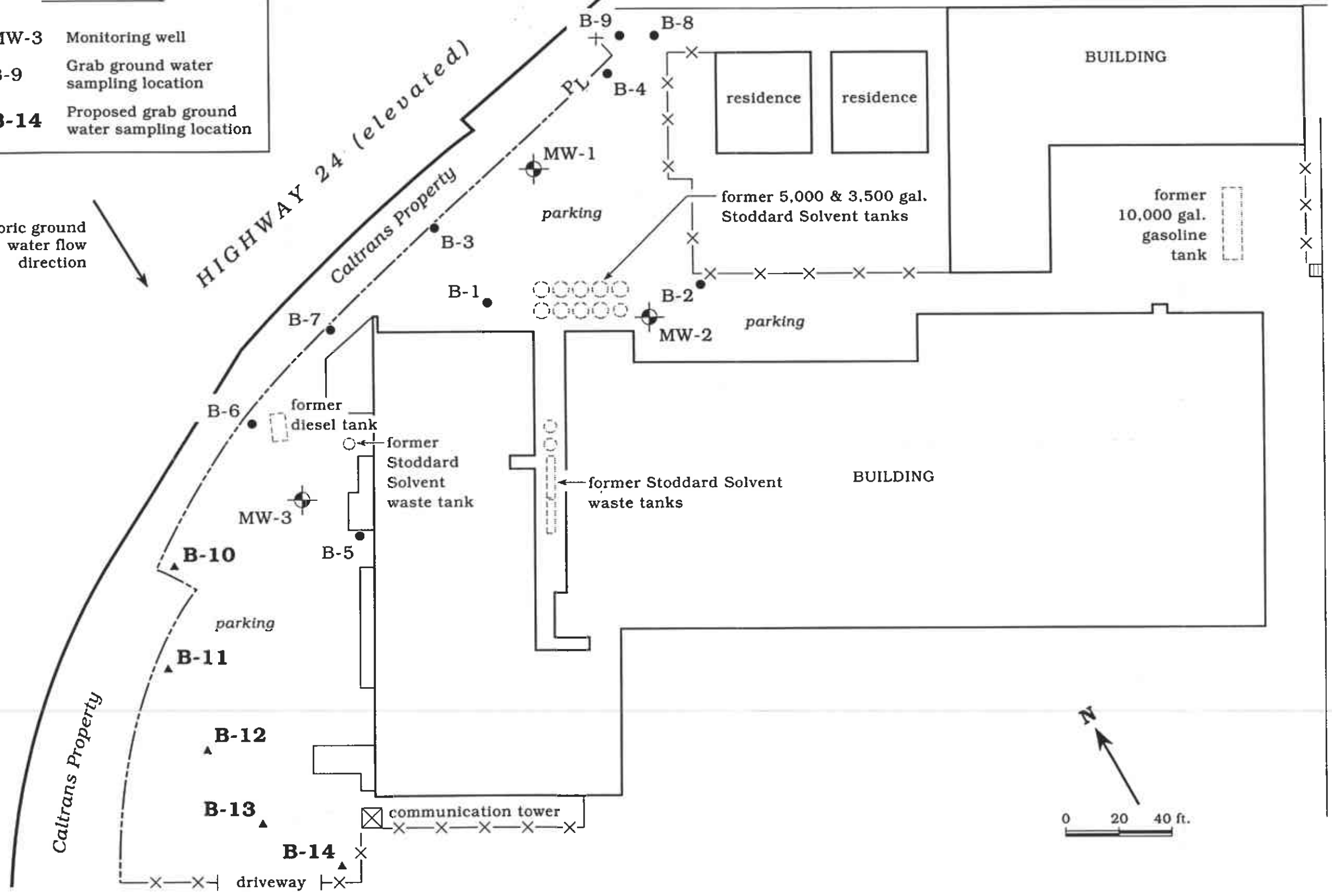

4-719-02 11/11/94

Figure 2. Monitoring Well and Existing and Proposed Grab Ground Water Sampling Locations - Telegraph Business Park, 5427 Telegraph Avenue, Oakland, California