

RECEIVED

2:50 pm, Feb 10, 2012

Alameda County  
Environmental Health

Mr. Jerry Wickham  
Alameda County  
Environmental Health Department  
1131 Harbor Bay Parkway, Suite 250  
Alameda, California 94702-6577

1/31/12

Re: B&C Gas Mini Mart, 2008 First Street, Livermore, California  
(ACEHD Case No. RO0000278)

Dear Mr. Wickham:

Stratus Environmental, Inc. (Stratus) has recently prepared a document titled *Quarterly Status Update Report, Fourth Quarter 2011* on my behalf. The report was prepared in regards to Alameda County Fuel Leak Case No. RO0000278, located at 2008 First Street, Livermore, California.

I have reviewed a copy of this report, sent to me by representatives of Stratus, and "I declare, under penalty of perjury, that the information and or recommendations contained in the attached document or report is true and correct to the best of my knowledge."

Sincerely,



1/31/12

Balaji Angle  
B&C Gas Mini Mart

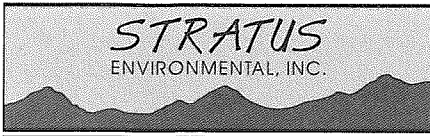

3330 Cameron Park Drive, Ste 550  
Cameron Park, California 95682  
(530) 676-6004 ~ Fax: (530) 676-6005

January 31, 2012  
Project No. 2146-2008-01

Mr. Jerry Wickham  
Alameda County  
Environmental Health Services  
1131 Harbor Bay Parkway, Suite 250  
Alameda, California 94502-6577

Re: Quarterly Status Update Report, Fourth Quarter 2011, for B&C Gas Mini Mart, located at 2008 First Street, Livermore, California (ACEHS Case No. RO0000278)

Dear Mr. Wickham:

Stratus Environmental, Inc. (Stratus) is submitting the attached report, on behalf of Mr. Balaji Angle, to document an update of work performed during the fourth quarter 2011 at the B&C Gas Mini Mart, located at 2008 First Street, Livermore, California. This report has been prepared in compliance with Alameda County Environmental Health Services (ACEHS) requirements for underground storage tank (UST) investigations.

If you have any questions regarding this report, please contact Scott Bittinger at (530) 676-2062 or Gowri Kowtha at (530) 676-6001.

Sincerely,

**STRATUS ENVIRONMENTAL, INC.**



Scott G. Bittinger, P.G.  
Project Manager

Gowri S. Kowtha, P.E.  
Principal Engineer

Attachment: Quarterly Status Update Report, Fourth Quarter 2011

cc: Mr. Balaji Angle, B&C Gas Mini Mart

**B&C GAS MINI MART  
QUARTERLY STATUS UPDATE REPORT**

Facility Address: 2008 First Street, Livermore, California  
Consulting Co./Contact Person: Stratus Environmental, Inc. / Scott Bittinger, P.G.  
Consultant Project No: 2146-2008-01  
Primary Agency/Regulatory ID No: Alameda County Environmental Health Department (ACEHD) / Case No. RO0000278

**WORK PERFORMED THIS PERIOD (Fourth Quarter 2011):**

1. In accordance with SWRCB Resolution No. 2009-0042, this site is under a semi-annual groundwater monitoring and sampling program, with these activities performed during the first and third quarters of each calendar year; therefore, no groundwater monitoring/sampling was conducted during the fourth quarter 2011.
2. Stratus and Mr. Angle met with ACEHD personnel on December 8, 2011 to discuss future management of the environmental case for the subject property.
3. Stratus visited the site on December 28, 2011 to check on the operational status of an ozone injection system installed and operated by a previous company representing Mr. Angle (Golder Associates). At the time of the visit, the ozone injection system was non-operational, apparently due to a mechanical failure (compressor motor failure). A field data sheet for the December 28, 2011 site visit is attached to this document. It is our understanding that Golder Associates did not visit the site during the fourth quarter 2011 in order to perform operation and maintenance on the ozone injection system

**WORK PROPOSED FOR NEXT PERIOD (First Quarter 2012):**

1. Stratus will conduct semi-annual groundwater monitoring and sampling activities during the first quarter 2012. During this event all monitoring wells will be gauged for depth to water and evaluated for the presence of free product. Following gauging, all wells will be purged and sampled. Samples will be forwarded to a state-certified analytical laboratory for analysis.
2. Stratus will repair and restart the ozone injection system. At least two site visits per month will be performed in order to verify operation of the system, and collect field parameter measurements, as appropriate.
3. During the December 8, 2011 meeting, ACEHD personnel indicated interest in expanding the ozone injection system offsite for connection to wells SP-5A/B/C and SP-6A/B/C, in order to allow for remediation of dissolved fuel contaminants across a larger area of the subsurface (see Figure 2 for well locations). Stratus concurs with ACEHD's assessment that the groundwater treatment area should be expanded. However, at this time, California's Underground Storage Tank Cleanup Fund (USTCF) has not allocated sufficient funds to cover costs associated with an expansion of the ozone injection system. We are hopeful that in the future, funding to perform offsite remediation work can become available, however, for the current fiscal year (2011/2012), cleanup efforts will likely be limited to injection of ozone through the wells currently connected to the system (SP-1A/B through SP-4A/B).

**ATTACHMENTS:**

Figure 1      Site Location Map  
Figure 2      Site Plan  
Figure 3      Site Vicinity Map  
December 28, 2011 Field Data Sheet

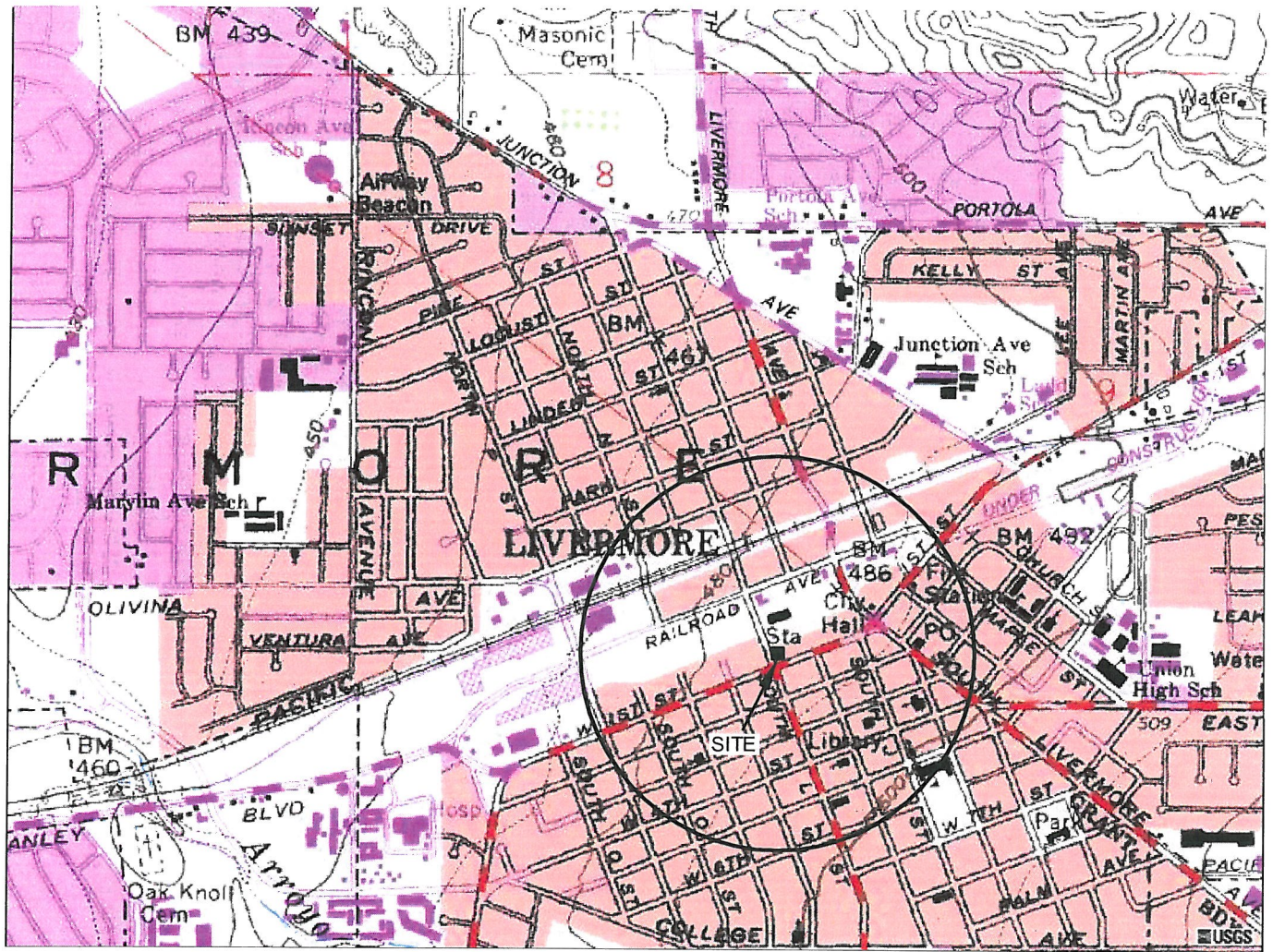

GENERAL NOTES:  
 BASE MAP FROM U.S.G.S.  
 LIVERMORE, CA.  
 7.5 MINUTE TOPOGRAPHIC  
 PHOTOREVISED 1999

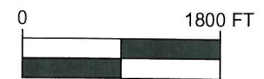

APPROXIMATE SCALE



QUADRANGLE LOCATION

*STRATUS*  
 ENVIRONMENTAL, INC.

B & C GAS MINI MART  
 2008 FIRST STREET  
 LIVERMOORE, CALIFORNIA

SITE LOCATION MAP

FIGURE

1

PROJECT NO.  
 2146-2008-01



- LEGEND:
- ⊕ MW-1 MONITORING WELL LOCATION
  - SV-MW-2 SOIL VAPOR EXTRACTION WELL
  - ⊗ SP-1A/B OZONE SPARGE WELL

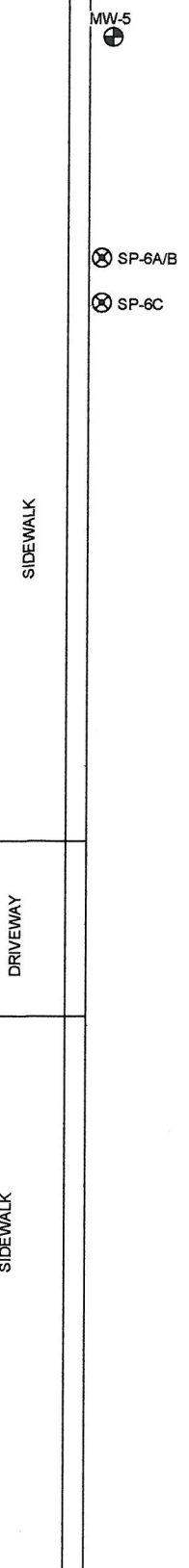
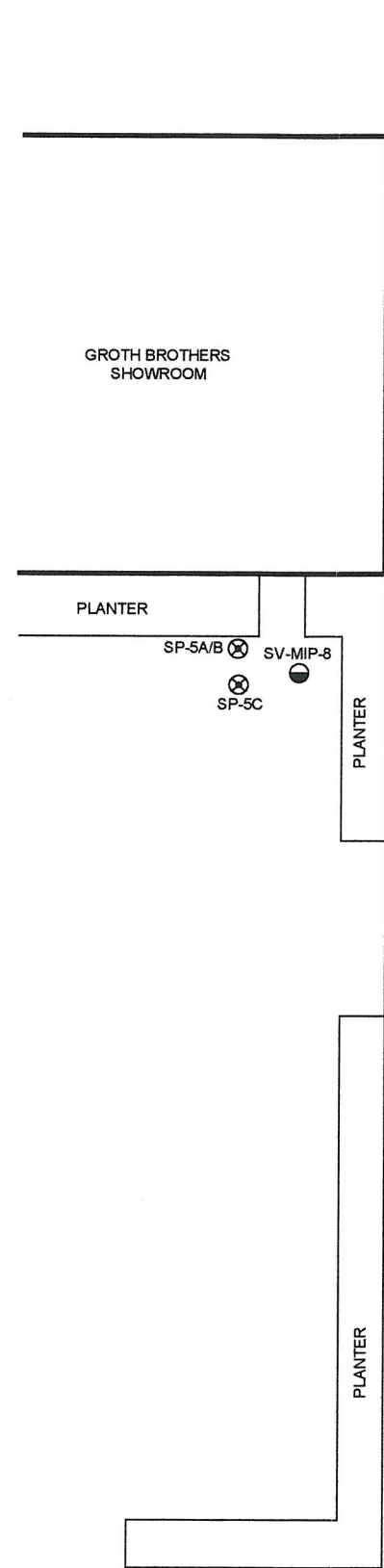

FIRST STREET

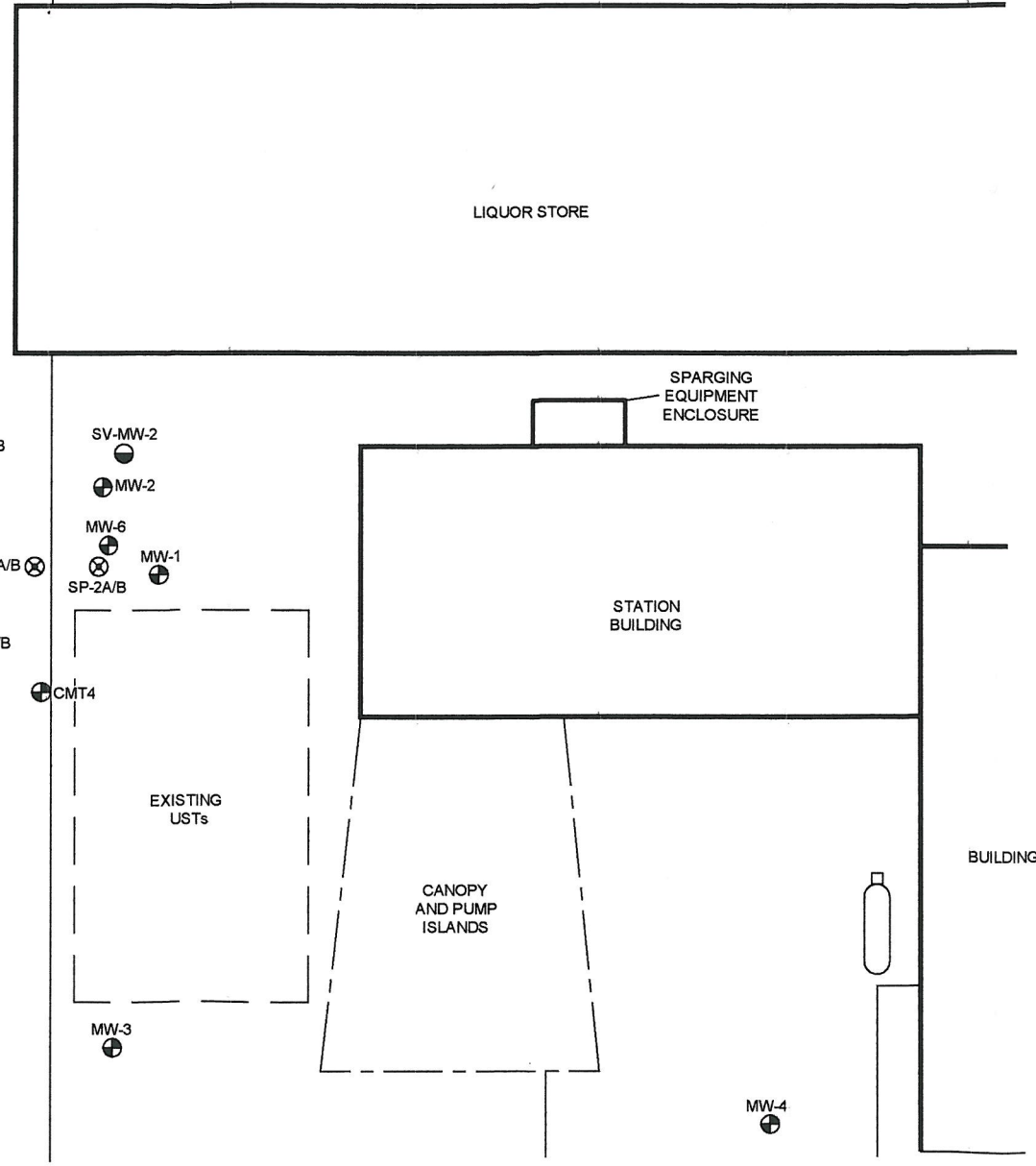
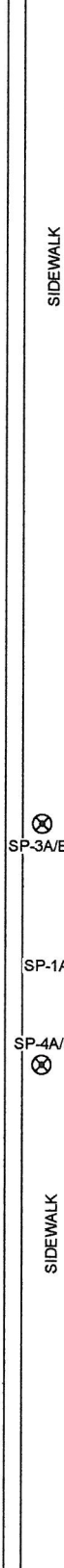

NOTE: LOCATIONS OF FEATURES DEPICTED ON THIS FIGURE ARE APPROXIMATE.



B & C GAS MINI MART  
2008 1st STREET  
LIVERMOORE, CALIFORNIA  
SITE PLAN

FIGURE  
**2**  
PROJECT NO.  
2146-2008-01



**LEGEND**

- MW-4 GROUNDWATER MONITORING WELL LOCATION (CMT-# DESIGNATES MULTI-LEVEL WELLS)
- D-1 DEEP GROUNDWATER MONITORING WELL LOCATION
- CWS#8 MUNICIPAL WATER SUPPLY WELL LOCATION

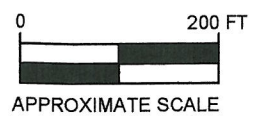
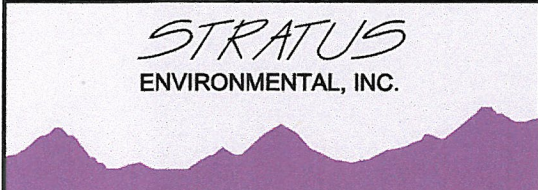

B & C GAS MINI MART  
2008 1st STREET  
LIVERMORE, CALIFORNIA

SITE VICINITY MAP

FIGURE  
**3**  
PROJECT NO.  
2146-2008-01





12-28-11  
CHILL

B+C GAS Maint Livermore

36

DATE NAME

0930 onsite check ozone system

8 Ports 6 Being Used - solutions Ready (16 Total)

\* System Down compressor off by switch

Cabinet for ozone Locked Need Key

MW-6 Block 29' well seal Bad Not sealed Install New seal

CMT-4 multiple wells chambered. Do we know what ports goes to what Depth



1010 offsite system off