



GETTLER-RYAN INC.

December 13, 2001

Mr. Thomas Bauhs
Chevron Products Company
P.O. Box 6004
San Ramon, California 94583-0904

Subject: Work Plan Addendum for Monitoring Well Installation and Soil Boring
Former Chevron Station #9-2960
2416 Grove Way, Castro Valley, CA
DG92960G.3C01

Dear Mr. Bauhs:

At the request of Chevron Products Company (Chevron), Delta Environmental Consultants, Inc. (Delta) network associate Gettler-Ryan Inc. (GR) is submitting this work plan addendum for the above mentioned site (Figure 1), as requested by Alameda County Health Care Service Agency (ACHCSA) personnel during a phone conversation on November 7, 2001. **The proposed changes** are in reference to the previously submitted Delta report, *Work Plan for Monitoring Well Installation*, dated November 6, 2001.

- In an effort to evaluate the dissolved hydrocarbon plume directly downgradient of the former UST complex and in the area of former groundwater monitoring wells C-1 and C-2, GR proposes moving proposed well C-8 southwest of the former UST area.
- GR proposes to advance one soil boring to groundwater and collect a grab groundwater sample at a location north of the property boundary as presented in Figure 2.
- Soil and grab groundwater samples will be analyzed as described in the original work plan, but will be submitted to Lancaster Laboratories (ELAP #2116) for analysis.

Based on low to non-detectable concentrations of dissolved hydrocarbon from years of groundwater sampling of wells C-4, C-6, and C-7, and verbal approval during the phone conversation with ACHCSA personnel, GR will postpone the semi-annual monitoring and sampling of the wells until further notified. The new proposed well will be monitored and sampled quarterly.

If you have any additional questions, please do not hesitate to call me in our Rancho Cordova office at (916) 631-1300.

Mr. Thomas Bauhs
December 13, 2001
Page 2

Sincerely,

DELTA ENVIRONMENTAL CONSULTANTS, INC.
Network Associate **GETTLER-RYAN INC.**



Tony P. Mikacich
Project Geologist

Attachment: Site Plan

CC: Mr. Amir Gholami, Alameda County Health Care Services Agency, 1131 Harbor Bay Parkway, Suite 250, Alameda, CA 94502-6577
Mr. Dean Nielsen, Business Administrator, First Presbyterian Church, 2490 Grove Way, Castro Valley, CA 94546
Mr. James Brownell, Delta Environmental Consultants, Inc., 3164 Gold Camp Drive, Suite 200, Rancho Cordova, CA 95670

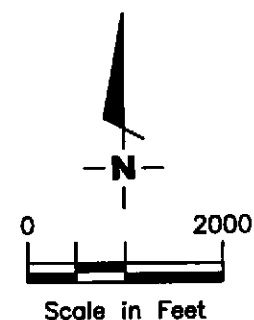
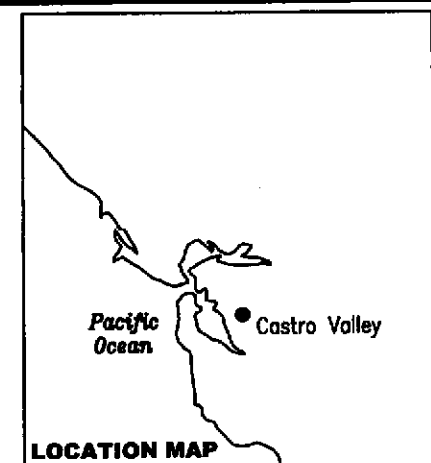

Source: National Geographic California Seamless USGS Topographic Maps on CD-ROM.

GETTLER - RYAN INC.
 6747 Sierra Ct., Suite J
 Dublin, CA 94568 (925) 551-7555

VICINITY MAP
 Former Chevron Service Station No. 9-2960
 2416 Grove Way
 Castro Valley, California

FIGURE
1

PROJECT NUMBER
 DG92960G.3C01

REVIEWED BY

DATE
 11/01

REVISED DATE

EXPLANATION

- ◆ Groundwater monitoring well
- ✕ Well unable to locate
- ⊗ Destroyed well
- ⊕ Proposed groundwater monitoring well
- ⊙ Proposed soil boring

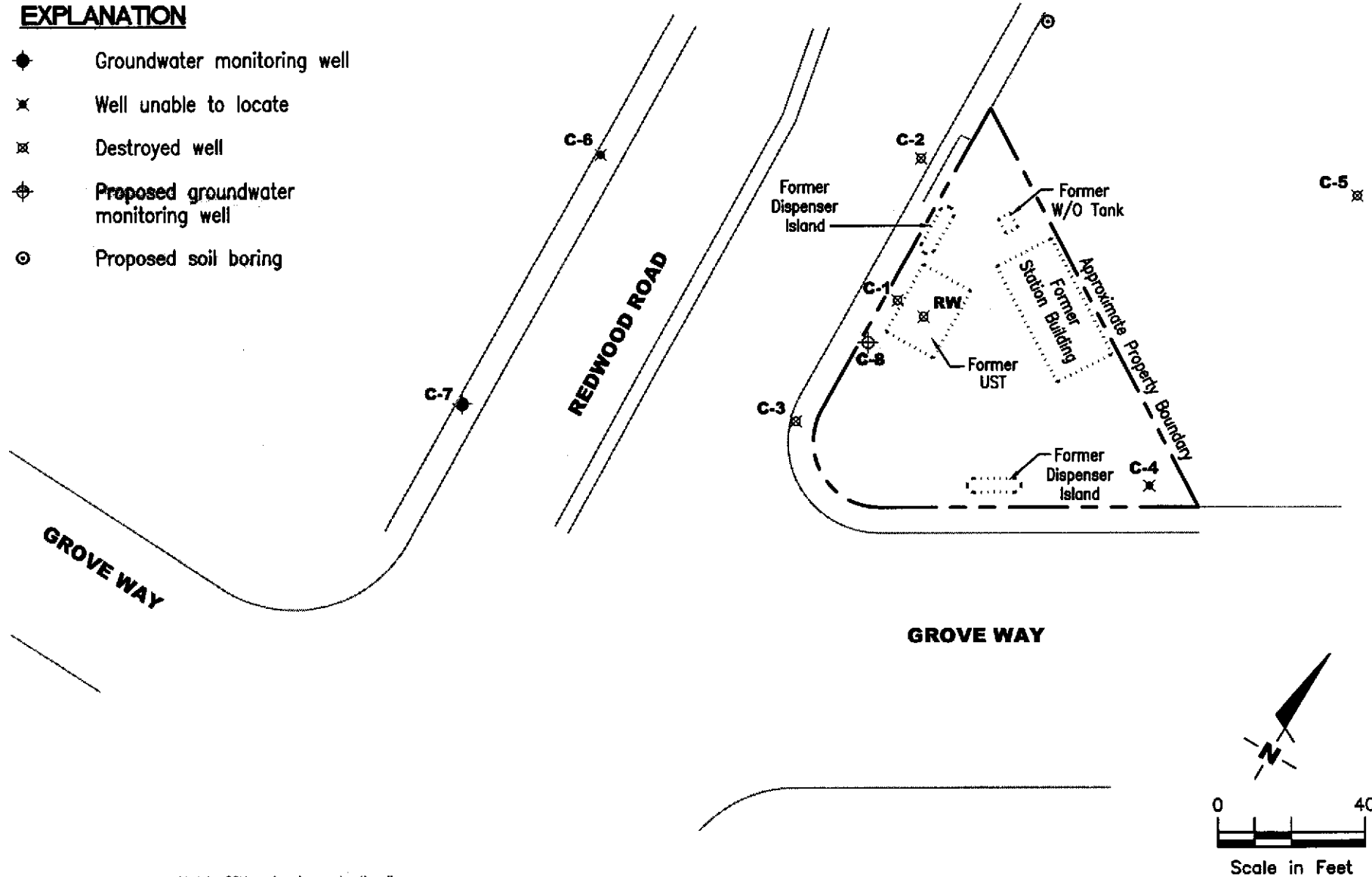

Source: Figure modified from drawing provided by RRM engineering contracting firm.

GETTLER - RYAN INC.
 6747 Sierra Ct., Suite J
 Dublin, CA 94568 (925) 551-7555

SITE PLAN
 Former Chevron Service Station No. 9-2960
 2416 Grove Way
 Castro Valley, California

FIGURE

2

PROJECT NUMBER
 DG92960G.3C01

REVIEWED BY

DATE
 11/01

REVISED DATE