



RECEIVED

9:49 am, May 05, 2010

Alameda County
Environmental Health

Stacie H. Frerichs
Team Lead
Marketing Business Unit

**Chevron Environmental
Management Company**
6001 Bollinger Canyon Road
San Ramon, CA 94583
Tel (925) 842-9655
Fax (925) 842-8370

May 3, 2010
(date)

Alameda County Environmental Health
1131 Harbor Bay Parkway, Suite 250
Alameda, CA 94502-6577

Re: Chevron Facility # 9-2960

Address: 2416 Grove Way, Castro Valley, California

I have reviewed the attached report titled First Semi-Annual 2010 Groundwater Monitoring Report and dated May 3, 2010.

I agree with the conclusions and recommendations presented in the referenced report. The information in this report is accurate to the best of my knowledge and all local Agency/Regional Board guidelines have been followed. This report was prepared by Conestoga-Rovers & Associates, upon whose assistance and advice I have relied.

This letter is submitted pursuant to the requirements of California Water Code Section 13267(b)(1) and the regulating implementation entitled Appendix A pertaining thereto.

I declare under penalty of perjury that the foregoing is true and correct.

Sincerely,

Stacie H. Frerichs
Project Manager

Enclosure: Report



**CONESTOGA-ROVERS
& ASSOCIATES**

10969 Trade Center Drive, Suite 106, Rancho Cordova, CA 95670
Telephone: 916889-8900 Facsimile: 916889-8999
www.CRAworld.com

May 3, 2010

Reference No. 611964

Mr. Mark Detterman, P.G., C.E.G.
Alameda County Environmental Health
1131 Harbor Bay Parkway, Suite 250
Alameda, California 94502-6577

Re: First Semi-Annual 2010 Groundwater Monitoring Report
Former Chevron Service Station No. 9-2960
2416 Grove Way
Castro Valley, California
LOP Case RO0000275

Dear Mr. Detterman:

Conestoga-Rovers & Associates (CRA) is submitting the attached *Groundwater Monitoring and Sampling Report* (report) to Alameda County Environmental Health (ACEH) on behalf of Chevron Environmental Management Company (Chevron) for the site referenced above. The report (prepared by Gettler-Ryan Inc. and dated April 13, 2010) presents the results of the monitoring and sampling of well C-8 during first quarter 2010. Well C-8 is sampled on a semi-annual basis during the first and third quarters. Wells C-4 and C-6 were paved over in 1999 and 2000, respectively, and have not been able to be re-located; and well C-7 is no longer monitored or sampled. Also attached are Figure 1 (Vicinity Map) showing the site location, and Figure 2 (Concentration Map) presenting the first semi-annual 2010 analytical results along with a rose diagram.

As outlined in the January 21, 2009 *Work Plan for Additional Subsurface Investigation*, additional investigation is planned to evaluate current groundwater quality in the area of former well C-6 and to evaluate groundwater quality between former well C-6 and well C-7 (Figure 2), and will be performed during second quarter 2010.

Equal
Employment
Opportunity Employer



**CONESTOGA-ROVERS
& ASSOCIATES**

May 3, 2010

Reference No. 611964

- 2 -

Please contact Mr. James Kiernan at (916) 889-8917 if you have any questions or require additional information.

Sincerely,

CONESTOGA-ROVERS & ASSOCIATES

Christopher J. Benedict

James P. Kiernan, P.E. #C68498



CB/jt/8
Encl.

Figure 1 Vicinity Map
Figure 2 Concentration Map - March 16, 2010

Attachment A First Semi-Annual 2010 Groundwater Monitoring and Sampling Report

cc: Ms. Stacie Frerichs, Chevron
Mr. Phil Conley, President Board of Trustees, First Presbyterian Church

FIGURES

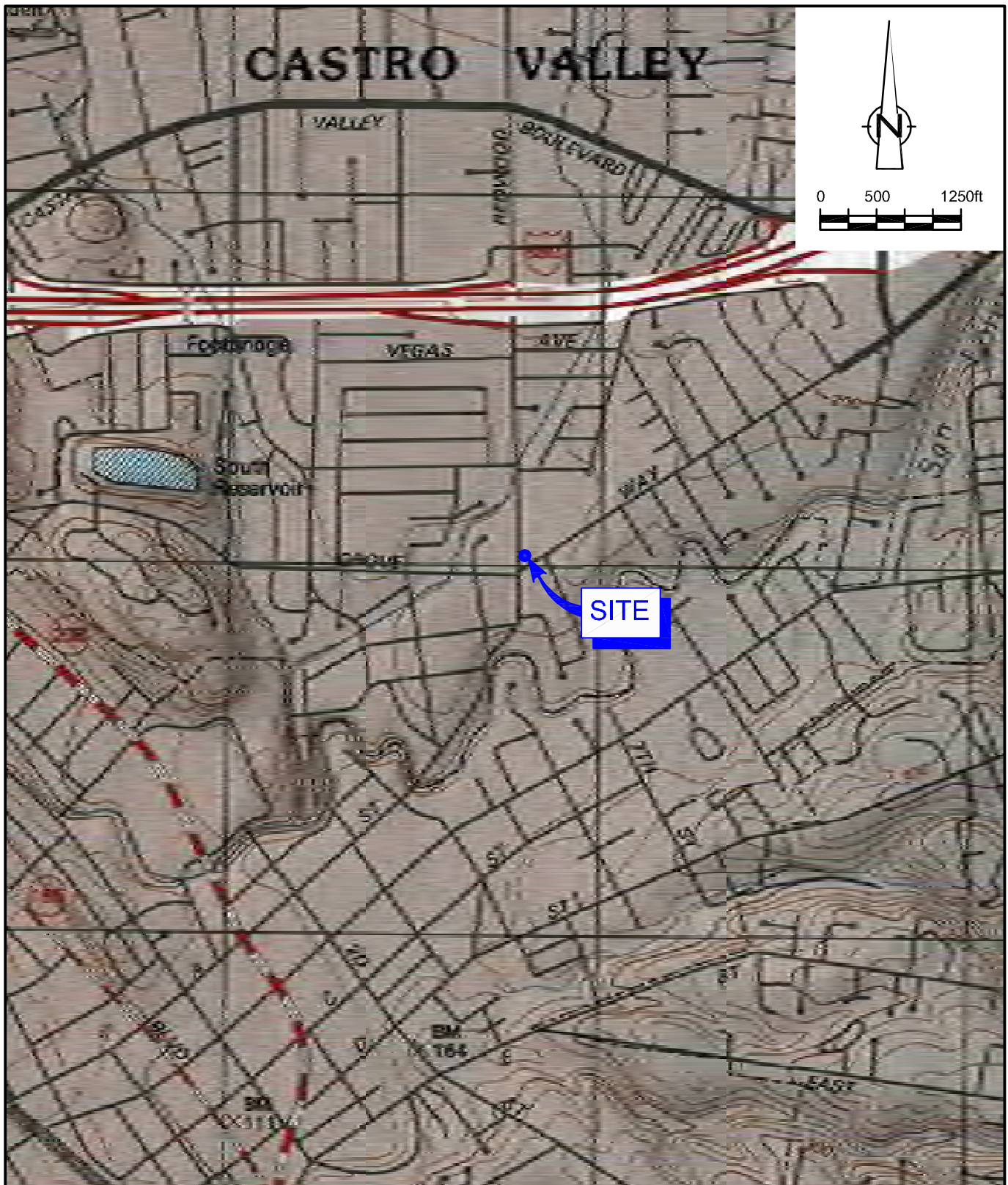

SOURCE: TOPO! MAPS.

figure 1

VICINITY MAP
 FORMER CHEVRON SERVICE STATION 9-2960
 2416 GROVE WAY
 Castro Valley, California



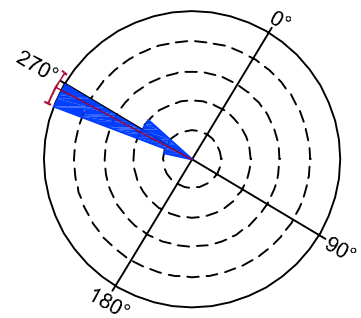

HISTORICAL GROUNDWATER FLOW DIRECTION

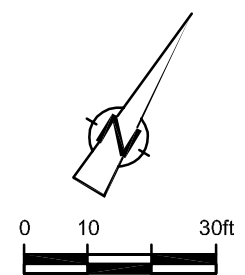

- LEGEND**
- GP-1 (■) PROPOSED GEOPROBE BORING LOCATION
 - ▲ VAPOR BORING LOCATION
 - MONITORING WELL LOCATION
 - SOIL BORING LOCATION
 - ⊠ SOIL BORING LOCATION (2004)
 - ⊗ ABANDONED WELL LOCATION
 - WELL LOCATION PAVED OVER
 - (440) TPHg CONCENTRATION (ug/L)
 - (0.9) BENZENE CONCENTRATION (ug/L)
 - (18) MTBE CONCENTRATION (ug/L)
 - (DISC) DISCONTINUED
 - < NOT DETECTED AT OR ABOVE STATED REPORTING LIMIT

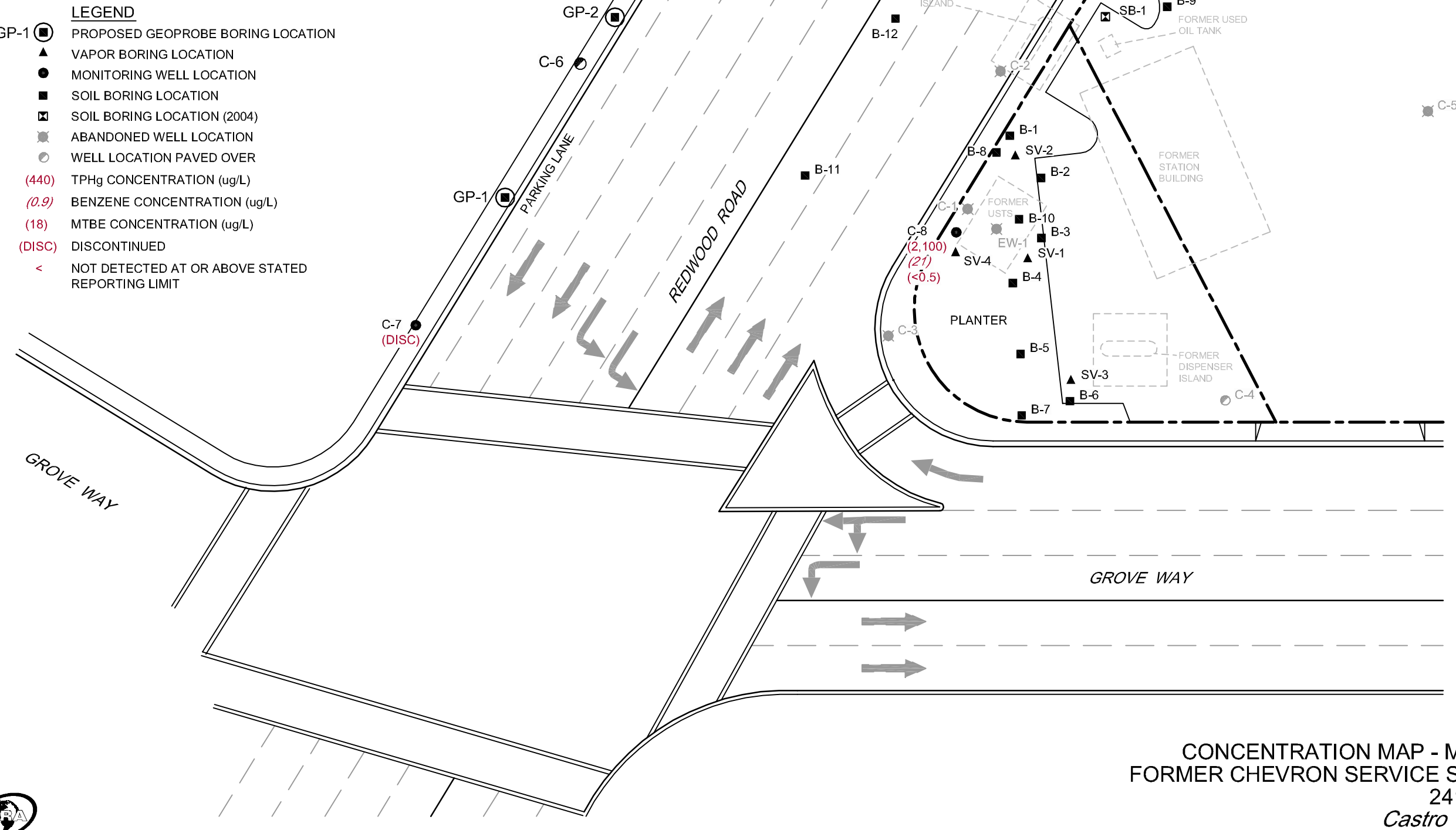

figure 2
 CONCENTRATION MAP - MARCH 16, 2010
 FORMER CHEVRON SERVICE STATION 9-2960
 2416 GROVE WAY
 Castro Valley, California



ATTACHMENT A

FIRST SEMI-ANNUAL 2010 GROUNDWATER MONITORING AND SAMPLING REPORT



TRANSMITTAL

April 16, 2010

G-R #386365

TO: Mr. James Kiernan
Conestoga-Rovers & Associates
10969 Trade Center Drive, Suite 107
Rancho Cordova, CA 95670

FROM: Deanna L. Harding
Project Coordinator
Gettler-Ryan Inc.
6747 Sierra Court, Suite J
Dublin, California 94568

RE: **Former Chevron Service Station
#9-2960 (MTI)
2416 Grove Way
Castro Valley, California
RO 0000275**

WE HAVE ENCLOSED THE FOLLOWING:

COPIES	DATED	DESCRIPTION
3	April 13, 2010	Groundwater Monitoring and Sampling Report First Semi-Annual Event of March 16, 2010

COMMENTS:

Pursuant to your request, we are providing you with copies of the above referenced items for your use and distribution (including PDF submittal of the entire report to GeoTracker):

- Ms. Stacie H. Frerichs, Chevron Environmental Management Company, 6111 Bollinger Canyon Road, Room 3596, San Ramon, CA 94583
- Mr. Phil Conley, President Board of Trustees, First Presbyterian Church, 2490 Grove Way, Castro Valley, CA 94546
- Mr. Steven Plunkett, Alameda County Health Care Services, Dept. of Environmental Health, 1131 Harbor Bay Parkway, Suite 250, Alameda, CA 94502-6577
(No Hard Copy-UPLOAD TO ALAMEDA CO.)

Enclosures

trans/9-2960-SHF



Stacie H. Frerichs
Team Lead
Marketing Business Unit

Chevron Environmental
Management Company
6001 Bollinger Canyon Road
San Ramon, CA 94583
Tel (925) 842-9655
Fax (925) 842-8370

April 16, 2010
(date)

Alameda County Health Care Services
1131 Harbor Bay Parkway, Suite 250
Alameda, CA 94502-6577

Re: Chevron Facility #9-2960

Address: 2416 Grove Way, Castro Valley, California

I have reviewed the attached routine groundwater monitoring report dated April 16, 2010.

I agree with the conclusions and recommendations presented in the referenced report. The information in this report is accurate to the best of my knowledge and all local Agency/Regional Board guidelines have been followed. This report was prepared by Gettler-Ryan, Inc., upon whose assistance and advice I have relied.

This letter is submitted pursuant to the requirements of California Water Code Section 13267(b)(1) and the regulating implementation entitled Appendix A pertaining thereto.

I declare under penalty of perjury that the foregoing is true and correct.

Sincerely,

A handwritten signature in black ink that reads "Stacie H. Frerichs".

Stacie H. Frerichs
Project Manager

Enclosure: Report



GETTLER-RYAN INC.



April 13, 2010
G-R Job #386365

Ms. Stacie H. Frerichs
Chevron Environmental Management Company
6111 Bollinger Canyon Road, Room 3596
San Ramon, CA 94583

RE: First Semi-Annual Event of March 16, 2010
Groundwater Monitoring & Sampling Report
Former Chevron Service Station #9-2960
2416 Grove Way
Castro Valley, California

Dear Ms. Frerichs:

This report documents the most recent groundwater monitoring and sampling event performed by Gettler-Ryan Inc. (G-R) at the referenced site. All field work was conducted in accordance with G-R Standard Operating Procedure - Groundwater Sampling (attached).

A static groundwater level was measured in one well (C-8) and the well was checked for the presence of separate-phase hydrocarbons. Static water level data, groundwater elevations, and separate-phase hydrocarbon thickness (if any) are presented in the attached Table 1. A Groundwater Elevation Map is included as Figure 1.

A Groundwater sample was collected from the monitoring well and submitted to a state certified laboratory for analyses. The field data sheet for this event is attached. Analytical results are presented in the table(s) listed below. The chain of custody document and the laboratory analytical reports are also attached. All groundwater and decontamination water generated during sampling activities was removed from the site, per the Standard Operating Procedure.

Please call if you have any questions or comments regarding this report. Thank you.

Sincerely,

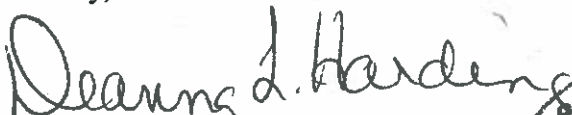
Deanna L. Harding
Project Coordinator



Douglas J. Lee
Senior Geologist, P.G. No. 6882



Figure 1: Groundwater Elevation Map
Table 1: Groundwater Monitoring Data and Analytical Results
Table 2: Groundwater Analytical Results - Oxygenate Compounds
Attachments: Standard Operating Procedure - Groundwater Sampling
Field Data Sheets
Chain of Custody Document and Laboratory Analytical Reports

EXPLANATION

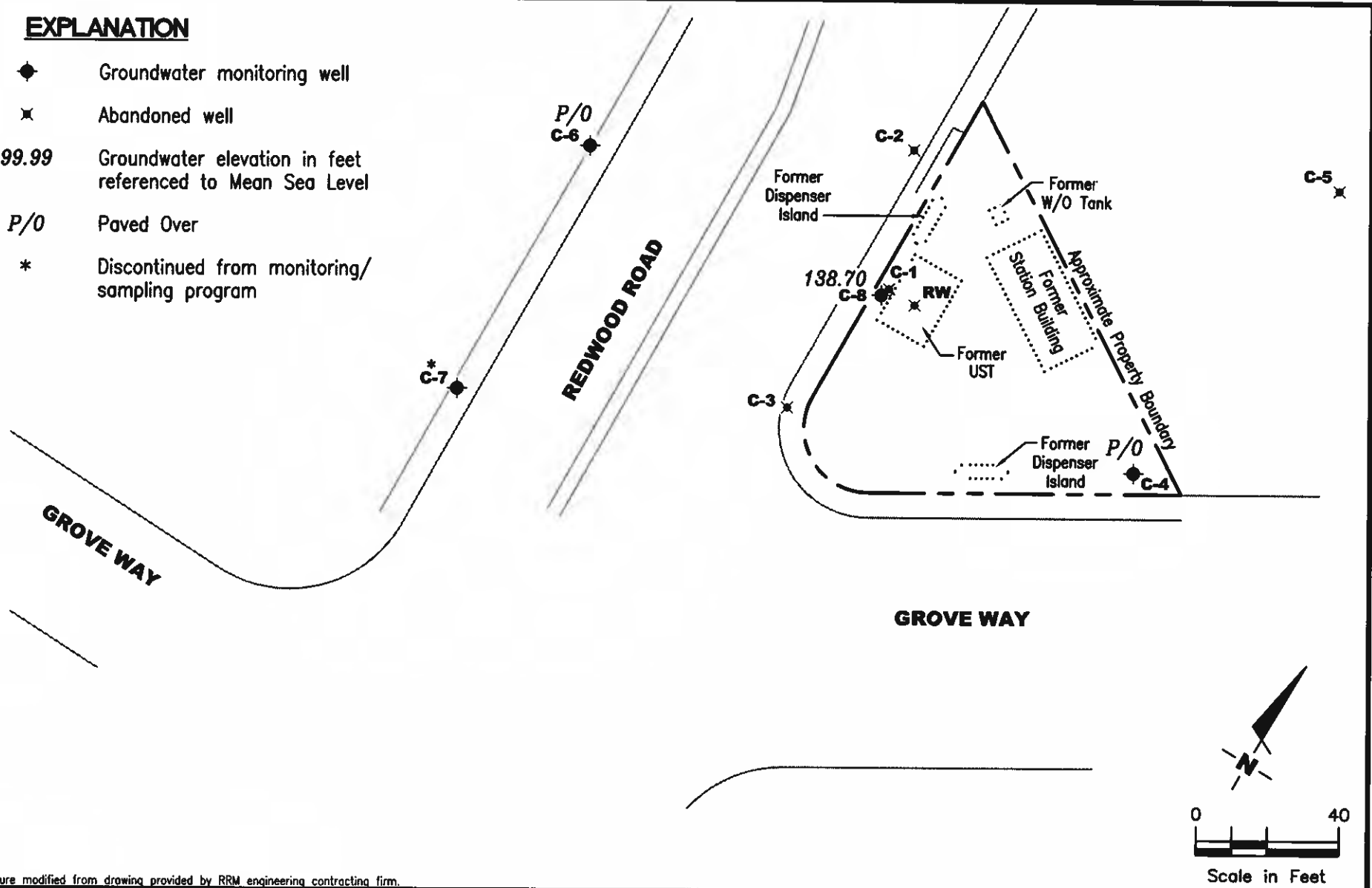
- ◆ Groundwater monitoring well
- × Abandoned well
- 99.99 Groundwater elevation in feet referenced to Mean Sea Level
- P/O Paved Over
- * Discontinued from monitoring/sampling program



Source: Figure modified from drawing provided by RRM engineering contracting firm.

GETTLER - RYAN INC.
 6747 Sierra Court, Suite J
 Dublin, CA 94568 (925) 551-7555

GROUNDWATER ELEVATION MAP
 Former Chevron Service Station #9-2960
 2416 Grove Way
 Castro Valley, California

FIGURE
1

PROJECT NUMBER 386365	REVIEWED BY	DATE March 16, 2010	REVISED DATE
---------------------------------	-------------	------------------------	--------------

Table 1
Groundwater Monitoring Data and Analytical Results
Former Chevron Service Station #9-2960
2416 Grove Way
Castro Valley, California

WELL ID/ DATE	TOC* (ft.)	GWE (msl)	DTW (ft.)	SPHT (ft.)	SPH REMOVED (gallons)	TPH- GRO (ug/L)	B (ug/L)	T (ug/L)	E (ug/L)	X (ug/L)	MTBE (ug/L)
C-8											
03/26/02 ²	153.41	137.96	15.45	0.00	0.00	11,000	380	130	120	530	<25/<2 ¹
06/17/02	153.41	137.03	16.38	0.00	0.00	11,000	490	65	170	470	<20/<2 ¹
09/17/02	153.41	136.71	16.70	0.00	0.00	6,800	410	12	70	130	46/<2 ¹
12/02/02	153.41	136.61	16.80	0.00	0.00	7,200	440	14	75	140	<20/<2 ¹
03/03/03	153.41	137.61	15.80	0.00	0.00	7,000	330	16	62	110	<10/<0.5 ¹
06/16/03 ³	153.41	137.52	15.89	0.00	0.00	7,400	400	17	71	120	<0.5
09/15/03 ⁴	153.41	136.87	16.54	0.00	0.00	2,500	200	5	56	16	<0.5
12/15/03 ⁴	153.41	137.07	16.34	0.00	0.00	5,900	320	18	51	140	<0.5
03/01/04 ⁴	153.41	138.55	14.86	0.00	0.00	7,800	250	14	61	55	<0.5
06/28/04 ⁴	153.41	137.05	16.36	0.00	0.00	5,700	280	11	46	53	<0.5
09/13/04 ⁴	153.41	136.39	17.02	0.00	0.00	2,200	180	5	33	8	<0.5
12/22/04 ⁴	153.41	137.29	16.12	0.00	0.00	1,700	170	4	15	5	<0.5
03/04/05 ⁴	153.41	138.63	14.78	0.00	0.00	5,400	180	8	43	30	<0.5
06/30/05 ⁴	153.41	137.97	15.44	0.00	0.00	3,900	160	6	16	19	<0.5
09/16/05 ⁴	153.41	137.21	16.20	0.00	0.00	3,500	160	6	10	18	<0.5
12/21/05 ⁴	153.41	137.31	16.10	0.00	0.00	2,300	110	4	10	18	<0.5
03/21/06 ⁴	153.41	139.03	14.38	0.00	0.00	6,200	130	6	32	36	<0.5
06/21/06 ⁴	153.41	138.17	15.24	0.00	0.00	6,100	100	11	38	120	<0.5
09/05/06 ⁴	153.41	137.25	16.16	0.00	0.00	5,400	130	11	29	96	<0.5
12/28/06 ⁴	153.41	137.60	15.81	0.00	0.00	2,600	110	4	12	12	<0.5
03/26/07 ⁴	153.41	137.74	15.67	0.00	0.00	2,700	91	3	13	5	<0.5
06/26/07 ⁴	153.41	137.19	16.22	0.00	0.00	3,900	71	4	8	15	<0.5
09/26/07 ⁴	153.41	136.85	16.56	0.00	0.00	3,600	83	4	18	31	<0.5
12/20/07 ⁴	153.41	137.38	16.03	0.00	0.00	2,600	69	4	15	26	<0.5
02/29/08 ⁴	153.41	138.63	14.78	0.00	0.00	2,400	52	3	16	9	<0.5
05/09/08 ⁴	153.41	137.86	15.55	0.00	0.00	2,300	40	3	6	5	<0.5
09/19/08 ⁴	153.41	136.85	16.56	0.00	0.00	1,300	43	1	3	5	<0.5
12/04/08 ⁴	153.41	137.04	16.37	0.00	0.00	1,700	34	2	4	8	<0.5
03/05/09 ⁴	153.41	138.40	15.01	0.00	0.00	1,200	14	0.7	2	1	<0.5
06/23/09 ⁴	153.41	137.50	15.91	0.00	0.00	1,300	14	0.6	1	1	<0.5
03/16/10 ⁴	153.41	138.70	14.71	0.00	0.00	2,100	21	3	8	6	<0.5

Table 1
Groundwater Monitoring Data and Analytical Results
Former Chevron Service Station #9-2960
2416 Grove Way
Castro Valley, California

WELL ID/ DATE	TOC* (ft.)	GWE (msl)	DTW (ft.)	SPHT (ft.)	SPH REMOVED (gallons)	TPH- GRO (ug/L)	B (ug/L)	T (ug/L)	E (ug/L)	X (ug/L)	MTBE (ug/L)
C-1											
10/23/86	153.36	--	--	--	--	3,100	6,400	3,700	--	4,300	--
09/10/87	153.36	--	--	--	--	120,000	25,000	60,000	13,000	56,000	--
10/03/90	153.36	134.69	18.67	--	--	--	--	--	--	--	--
10/25/90	153.36	135.22	18.71	0.71	--	--	--	--	--	--	--
01/22/91	153.36	135.22	18.70	0.70	--	--	--	--	--	--	--
02/21/91	153.36	135.44	18.62	0.88	--	--	--	--	--	--	--
04/01/91	153.36	136.47	16.91	0.03	--	--	--	--	--	--	--
04/11/91	153.36	136.49	16.90	0.04	--	--	--	--	--	--	--
07/01/91	153.36	135.75	17.61	0.00	--	--	--	--	--	--	--
09/24/91	153.36	135.17	18.98	0.99	--	--	--	--	--	--	--
10/23/91	153.36	135.03	19.32	1.24	--	--	--	--	--	--	--
11/22/91	153.36	134.53	18.83	0.97	--	--	--	--	--	--	--
01/09/92	153.36	136.10	17.26	--	--	--	--	--	--	--	--
03/06/92	153.36	137.16	16.69	0.61	--	--	--	--	--	--	--
06/04/92	153.36	136.44	17.10	0.22	--	--	--	--	--	--	--
09/28/92	153.36	--	18.71	0.77	--	--	--	--	--	--	--
12/17/92	153.36	--	17.54	0.45	--	--	--	--	--	--	--
04/29/93	153.36	137.50	16.40	0.68	--	--	--	--	--	--	--
07/26/93	153.36	136.92	16.85	0.51	--	--	--	--	--	--	--
10/22/93	153.36	135.55	17.83	0.03	--	--	--	--	--	--	--
01/24/94	153.36	--	--	--	--	--	--	--	--	--	--
04/11/94	153.36	136.01	17.76	0.51	--	--	--	--	--	--	--
07/01/94	153.36	135.95	17.46	0.06	--	--	--	--	--	--	--
10/06/94	153.36	135.24	18.18	0.08	--	--	--	--	--	--	--
01/11/95	153.36	136.63	16.79	0.08	0.039	--	--	--	--	--	--
04/07/95	153.36	139.23	14.13	--	--	44,000	410	100	130	5,400	--
07/20/95	153.36	136.84	16.52	--	--	16,000	96	81	53	1,000	--
09/22/95	153.36	137.22	16.14	--	--	59,000	150	36	16	56	--
04/26/96	153.36	137.31	16.05	--	--	7,200	1,300	340	130	390	--
07/22/96	153.36	143.14	10.22	--	--	7,300	2,500	170	360	520	--
10/17/96	153.36	137.64	15.72	--	--	19,000	3,400	59	360	430	--
01/23/97	153.36	138.91	14.45	--	--	15,000	2,900	390	250	480	--
07/10/97	153.36	137.19	16.17	--	--	13,000	2,100	69	200	380	--

Table 1
Groundwater Monitoring Data and Analytical Results
Former Chevron Service Station #9-2960
2416 Grove Way
Castro Valley, California

WELL ID/ DATE	TOC* (ft.)	GWE (msl)	DTW (ft.)	SPHT (ft.)	SPH REMOVED (gallons)	TFH- GRO (ug/L)	B (ug/L)	T (ug/L)	E (ug/L)	X (ug/L)	MTBE (ug/L)
C-1 (cont)											
01/15/98	153.36	INACCESSIBLE		--	--	--	--	--	--	--	--
01/16/98	153.36	138.63	14.73	--	--	4,700	1,200	<20	140	40	--
07/09/98	153.36	138.14	15.22	--	--	9,900	1,500	60	150	170	--
ABANDONED											
C-2											
10/23/86	151.84	--	--	--	--	30,000	2,700	1,900	--	1,500	--
09/10/87	151.84	--	--	--	--	14,000	2,600	2,900	500	1,200	--
10/16/89	151.84	--	--	--	--	600	260	34	1.7	41	--
01/04/90	151.84	--	--	--	--	2,600	470	150	23	130	--
04/05/90	151.84	--	--	--	--	500	280	29	6.3	19	--
07/02/90	151.84	--	--	--	--	2,400	670	110	17	76	--
10/03/90	151.84	--	--	--	--	--	--	--	--	--	--
10/25/90	151.84	135.24	16.60	--	--	1,300	390	47	9.0	58	--
01/22/91	151.84	135.15	16.69	--	--	2,600	680	88	29	130	--
02/21/91	151.84	135.53	16.31	--	--	--	--	--	--	--	--
04/01/91	151.84	136.76	15.08	--	--	--	--	--	--	--	--
09/24/91	151.84	135.33	16.51	--	--	3,600	1,400	63	6.9	63	--
10/23/91	151.84	135.18	16.66	--	--	--	--	--	--	--	--
11/22/91	151.84	135.47	16.37	--	--	--	--	--	--	--	--
01/09/92	151.84	136.28	15.56	--	--	7,100	770	740	190	690	--
03/06/92	151.84	137.47	14.37	--	--	3,200	250	230	59	220	--
06/04/92	151.84	136.80	15.04	--	--	1,500	<0.5	180	42	130	--
09/28/92	151.84	135.44	16.40	--	--	6,400	940	230	57	220	--
12/17/92	151.84	136.46	15.38	--	--	1,500	370	160	6.0	25	--
04/29/93	151.84	136.87	14.97	--	--	1,800	690	120	74	140	--
07/29/93	151.84	136.92	14.92	--	--	4,300	1,500	96	29	96	--
10/22/93	151.84	136.03	15.81	--	--	820	560	57	15	58	--
01/24/94	151.84	--	--	--	--	--	--	--	--	--	--
04/11/94	151.84	136.49	15.35	--	--	2,000	240	48	36	110	--
07/01/94	151.84	136.44	15.40	--	--	370	55	12	3.1	8.6	--
10/06/94	151.84	135.84	16.00	--	--	150	47	4.8	1.8	5.4	--
01/11/95	151.84	137.06	14.78	--	--	52	0.65	<0.5	<0.5	<0.5	--
04/07/95	151.84	138.93	12.91	--	--	1,500	260	64	52	85	--
07/20/95	151.84	136.81	15.03	--	--	3,000	500	100	96	110	--
09/22/95	151.84	137.05	14.79	--	--	2,000	630	120	20	79	--

Table 1
Groundwater Monitoring Data and Analytical Results
Former Chevron Service Station #9-2960
2416 Grove Way
Castro Valley, California

WELL ID/ DATE	TOC* (ft.)	GWE (msl)	DTW (ft.)	SPHT (ft.)	SPH REMOVED (gallons)	TPH- GRO (ug/L)	B (ug/L)	T (ug/L)	E (ug/L)	X (ug/L)	MTBE (ug/L)
C-2 (cont)											
01/02/96	151.84	137.37	14.47	--	--	1,900	240	110	58	180	<12
04/26/96	151.84	137.97	13.87	--	--	1,300	340	190	44	120	--
07/22/96	151.84	136.73	15.11	--	--	3,700	1,100	140	150	330	--
10/17/96	151.84	136.80	15.04	--	--	22,000	3,900	1,600	350	1,800	--
01/23/97	151.84	138.86	12.98	--	--	2,000	260	48	76	94	--
07/10/97	151.84	137.21	14.63	--	--	5,100	710	200	190	380	--
01/15/98	153.36	INACCESSIBLE		--	--	--	--	--	--	--	--
01/16/98	151.84	138.61	13.23	--	--	7,600	1,600	130	320	650	--
07/09/98	151.84	138.17	13.67	--	--	10,000	1,100	410	180	410	--
ABANDONED											
C-3											
10/23/86	154.13	--	--	--	--	3,300	49	24	--	20	--
09/10/87	154.13	--	--	--	--	200	110	2.6	<2.0	<2.0	--
10/16/89	154.13	--	--	--	--	900	640	4.2	1.6	16	--
01/04/90	154.13	--	--	--	--	920	430	7.0	6.0	7.0	--
04/05/90	154.13	--	--	--	--	930	690	3.4	5.1	4.8	--
07/02/90	154.13	--	--	--	--	1,700	590	11	4.8	9.4	--
10/03/90	154.13	134.97	19.16	--	--	--	--	--	--	--	--
10/25/90	154.13	134.85	19.28	--	--	750	510	2.0	6.0	5.0	--
01/22/91	154.13	134.95	19.18	--	--	430	260	2.0	2.0	5.0	--
01/22/91	154.13	134.95	19.18	--	--	400	250	2.0	2.0	5.0	--
02/21/91	154.13	135.25	18.88	--	--	--	--	--	--	--	--
04/01/91	154.13	136.54	17.59	--	--	--	--	--	--	--	--
04/11/91	154.13	136.32	17.81	--	--	--	--	--	--	--	--
07/01/91	154.13	135.57	18.56	--	--	--	--	--	--	--	--
09/24/91	154.13	135.01	19.12	--	--	260	52	0.7	0.8	2.2	--
10/23/91	154.13	134.89	19.24	--	--	--	--	--	--	--	--
11/22/91	154.13	135.10	19.03	--	--	--	--	--	--	--	--
01/09/92	154.13	135.90	18.23	--	--	240	120	0.9	<0.5	1.6	--
03/06/92	154.13	137.09	17.04	--	--	230	68	1.2	1.2	1.3	--
06/04/92	154.13	136.34	17.79	--	--	80	36	0.6	0.5	0.7	--
09/28/92	154.13	135.13	19.00	--	--	84	49	<0.5	<0.5	1.5	--
12/17/92	154.13	135.95	18.18	--	--	220	30	<0.5	<0.5	<0.5	--
04/29/93	154.13	135.35	18.78	--	--	380	12	0.6	<0.5	<1.5	--
07/26/93	154.13	136.41	17.72	--	--	800	38	1.1	<0.5	<1.5	--

Table 1
Groundwater Monitoring Data and Analytical Results
Former Chevron Service Station #9-2960
2416 Grove Way
Castro Valley, California

WELL ID/ DATE	TOC* (<i>µ</i> L)	GWE (<i>mst</i>)	DTW (<i>ft.</i>)	SPHT (<i>ft.</i>)	SPH REMOVED (<i>gallons</i>)	TPH- GRO (<i>ug/L</i>)	B (<i>ug/L</i>)	T (<i>ug/L</i>)	E (<i>ug/L</i>)	X (<i>ug/L</i>)	MTBE (<i>ug/L</i>)
C-3 (cont)											
10/22/93	154.13	135.63	18.50	--	--	200	64	0.6	<0.5	<1.5	--
01/24/94	154.13	135.62	18.51	--	--	<50	<0.5	<0.5	<0.5	<0.5	--
04/11/94	154.13	136.09	18.04	--	--	100	3.6	2.1	<0.5	2.3	--
07/01/94	154.13	136.01	18.12	--	--	140	3.7	1.2	<0.5	1.0	--
10/06/94	154.13	135.50	18.63	--	--	<50	<0.5	<0.5	<0.5	<0.5	--
01/11/95	154.13	137.01	17.12	--	--	<50	<0.5	<0.5	<0.5	<0.5	--
04/07/95	154.13	138.34	15.79	--	--	<50	<0.5	<0.5	<0.5	<0.5	--
07/20/95	154.13	136.37	17.76	--	--	<50	1.5	1.9	<0.5	3.5	--
09/22/95	154.13	136.58	17.55	--	--	<50	<0.5	<0.5	<0.5	<0.5	--
01/02/96	154.13	136.88	17.25	--	--	<50	<0.5	<0.5	<0.5	1.1	<2.5
04/26/96	154.13	137.42	16.71	--	--	<50	<0.5	<0.5	<0.5	<0.5	--
07/22/96	154.13	136.50	17.63	--	--	<50	<0.5	<0.5	<0.5	<0.5	--
10/17/96	154.13	136.33	17.80	--	--	<50	<0.5	<0.5	<0.5	<0.5	--
01/23/97	154.13	138.33	15.80	--	--	<50	<0.5	<0.5	<0.5	<0.5	--
07/10/97	154.13	136.63	17.50	--	--	<50	<0.5	<0.5	<0.5	<0.5	--
01/15/98	154.13	137.98	16.15	--	--	<50	<0.5	<0.5	<0.5	<0.5	--
01/16/98	154.13	138.04	16.09	--	--	REGAUGE	--	--	--	--	--
07/09/98	154.13	137.57	16.56	--	--	<50	<0.5	<0.5	<0.5	<0.5	--
ABANDONED											
C-4											
10/23/86	156.00	--	--	--	--	570	3.0	4.0	--	5.0	--
09/10/87	156.00	--	--	--	--	500	3.0	<0.5	<0.5	<0.5	--
10/16/89	156.00	--	--	--	--	<500	12	1.0	<0.5	0.8	--
01/04/90	156.00	--	--	--	--	<500	5.0	<0.5	<0.5	0.9	--
04/05/90	156.00	--	--	--	--	<50	6.6	<0.5	<0.5	0.7	--
07/02/90	156.00	--	--	--	--	71	4.1	<0.5	<0.5	<0.5	--
10/03/90	156.00	--	--	--	--	--	--	--	--	--	--
10/25/90	156.00	135.57	20.43	--	--	<50	2.0	<0.5	<0.5	<0.5	--
01/22/91	156.00	135.50	20.50	--	--	<50	3.0	<0.5	<0.5	<0.5	--
02/21/91	156.00	135.77	20.23	--	--	--	--	--	--	--	--
04/01/91	156.00	136.97	19.03	--	--	--	--	--	--	--	--
04/11/91	156.00	136.95	19.05	--	--	--	--	--	--	--	--
07/01/91	156.00	136.10	19.90	--	--	--	--	--	--	--	--
09/24/91	156.00	135.59	20.41	--	--	87	1.6	<0.5	<0.5	<0.5	--
10/23/91	156.00	135.47	20.53	--	--	--	--	--	--	--	--

Table 1
Groundwater Monitoring Data and Analytical Results
Former Chevron Service Station #9-2960
2416 Grove Way
Castro Valley, California

WELL ID/ DATE	TOC* (<i>ft.</i>)	GWE (<i>msl</i>)	DTW (<i>ft.</i>)	SPHT (<i>ft.</i>)	SPH REMOVED (<i>gallons</i>)	TFH- GRO (<i>ug/L</i>)	B (<i>ug/L</i>)	T (<i>ug/L</i>)	E (<i>ug/L</i>)	X (<i>ug/L</i>)	MTBE (<i>ug/L</i>)
C-4 (cont)											
11/22/91	156.00	135.65	20.35	--	--	--	--	--	--	--	--
01/09/92	156.00	136.46	19.54	--	--	51	4.3	<0.5	<0.5	<0.5	--
01/09/92	156.00	136.46	19.54	--	--	<50	4.8	<0.5	<0.5	<0.5	--
03/06/92	156.00	137.74	18.26	--	--	<50	0.8	<0.5	<0.5	<0.5	--
06/04/92	156.00	137.08	18.92	--	--	<50	<0.5	<0.5	<0.5	0.7	--
09/28/92	156.00	135.69	20.31	--	--	<50	<0.5	<0.5	<0.5	<0.5	--
12/17/92	156.00	136.43	19.57	--	--	<50	<0.5	<0.5	<0.5	<0.5	--
04/29/93	156.00	138.22	17.78	--	--	<50	<0.5	<0.5	<0.5	<1.5	--
07/26/93	156.00	--	--	--	--	--	--	--	--	--	--
08/18/93	156.00	137.09	18.91	--	--	<50	<0.5	<0.5	<0.5	<1.5	--
10/22/93	156.00	136.61	19.39	--	--	<50	2.9	2.1	1.1	4.3	--
01/24/94	156.00	136.58	19.42	--	--	<50	<0.5	<0.5	<0.5	<0.5	--
04/11/94	156.00	136.86	19.14	--	--	<50	<0.5	0.6	<0.5	0.5	--
07/01/94	156.00	136.80	19.20	--	--	<50	<0.5	<0.5	<0.5	<0.5	--
10/06/94	156.00	136.26	19.74	--	--	<50	<0.5	<0.5	<0.5	<0.5	--
01/11/95	156.00	139.70	16.30	--	--	<50	<0.5	<0.5	<0.5	<0.5	--
04/07/95	156.00	139.49	16.51	--	--	<50	<0.5	<0.5	<0.5	<0.5	--
07/20/95	156.00	137.20	18.80	--	--	<50	<0.5	<0.5	<0.5	<0.5	--
09/22/95	156.00	137.26	18.74	--	--	<50	<0.5	<0.5	<0.5	<0.5	--
01/02/96	156.00	137.65	18.35	--	--	<50	1.6	1.8	0.95	4.1	<2.5
04/26/96	156.00	138.43	17.57	--	--	<50	<0.5	<0.5	<0.5	<0.5	--
07/22/96	156.00	137.00	19.00	--	--	<50	<0.5	<0.5	<0.5	<0.5	--
10/17/96	156.00	136.96	19.04	--	--	<50	<0.5	<0.5	<0.5	<0.5	--
01/23/97	156.00	139.31	16.69	--	--	<50	<0.5	<0.5	<0.5	<0.5	--
07/10/97	156.00	137.46	18.54	--	--	SAMPLED ANNUALLY		--	--	--	--
01/15/98	156.00	143.92	12.08	--	--	<50	1.0	1.4	<0.5	3.5	--
01/16/98	156.00	138.84	17.16	--	--	REGAUGE		--	--	--	--
07/09/98	156.00	138.29	17.71	--	--	--	--	--	--	--	--
01/08/99	156.00	139.19	16.81	--	--	<50	<0.5	<0.5	<0.5	<0.5	--
07/09/99	156.00	UNABLE TO LOCATE		--	--	--	--	--	--	--	--
02/01/00	156.00	UNABLE TO LOCATE		--	--	--	--	--	--	--	--
08/21/00	156.00	UNABLE TO LOCATE - PAVED OVER		--	--	--	--	--	--	--	--
01/25/01	156.00	UNABLE TO LOCATE - PAVED OVER		--	--	--	--	--	--	--	--
07/10/01	156.00	UNABLE TO LOCATE - PAVED OVER		--	--	--	--	--	--	--	--

Table 1
Groundwater Monitoring Data and Analytical Results
Former Chevron Service Station #9-2960
2416 Grove Way
Castro Valley, California

WELL ID/ DATE	TOC* (<i>µ</i> L)	GWE (msl)	DTW (<i>ft</i>)	SPHT (<i>ft</i>)	SPH REMOVED (gallons)	TPH- GRO (<i>µ</i> g/L)	B (<i>µ</i> g/L)	T (<i>µ</i> g/L)	E (<i>µ</i> g/L)	X (<i>µ</i> g/L)	MTBE (<i>µ</i> g/L)
C-4 (cont)											
01/08/02	156.00	UNABLE TO LOCATE - PAVED OVER				--	--	--	--	--	--
03/26/02	156.00	UNABLE TO LOCATE - PAVED OVER				--	--	--	--	--	--
06/17/02	156.00	UNABLE TO LOCATE - PAVED OVER				--	--	--	--	--	--
PAVED OVER											
C-5											
10/03/90	153.38	135.60	17.78	--	--	<50	<0.5	<0.5	<0.5	<0.5	--
10/25/90	153.38	135.46	17.92	--	--	<50	<0.5	<0.5	<0.5	<0.5	--
11/09/90	153.38	135.46	17.92	--	--	<50	<0.5	<0.5	<0.5	<0.5	--
01/22/91	153.38	135.58	17.80	--	--	<50	<0.5	<0.5	<0.5	<0.5	--
02/21/91	153.38	135.87	17.51	--	--	--	--	--	--	--	--
04/01/91	153.38	137.07	16.31	--	--	--	--	--	--	--	--
04/11/91	153.38	137.02	16.36	--	--	--	--	--	--	--	--
07/01/91	153.38	136.26	17.12	--	--	--	--	--	--	--	--
09/24/91	153.38	135.68	17.70	--	--	<50	<0.5	<0.5	<0.5	<0.5	--
09/24/91	153.38	135.68	17.70	--	--	<50	<0.5	<0.5	<0.5	<0.5	--
10/23/91	153.38	135.56	17.82	--	--	--	--	--	--	--	--
11/22/91	153.38	135.77	17.61	--	--	--	--	--	--	--	--
01/09/92	153.38	136.34	17.04	--	--	<50	<0.5	0.7	<0.5	<0.5	--
03/06/92	153.38	137.62	15.76	--	--	<50	<0.5	<0.5	<0.5	<0.5	--
06/04/92	153.38	136.98	16.40	--	--	<50	<0.5	<0.5	<0.5	<0.5	--
09/28/92	153.38	135.80	17.58	--	--	<50	<0.5	<0.5	<0.5	<0.5	--
12/17/92	153.38	136.56	16.82	--	--	<50	<0.5	<0.5	<0.5	<0.5	--
04/29/93	153.38	138.14	15.24	--	--	<50	<0.5	<0.5	<0.5	<1.5	--
07/26/93	153.38	137.08	16.30	--	--	<50	<0.5	<0.5	<0.5	<1.5	--
10/22/93	153.38	136.30	17.08	--	--	52	2.3	2.7	1.1	5.2	--
01/24/94	153.38	136.25	17.13	--	--	<50	<0.5	<0.5	<0.5	<0.5	--
04/11/94	153.38	136.75	16.63	--	--	<50	<0.5	0.7	<0.5	0.6	--
07/01/94	153.38	136.73	16.65	--	--	<50	<0.5	<0.5	<0.5	<0.5	--
10/06/94	153.38	136.16	17.22	--	--	<50	<0.5	<0.5	<0.5	<0.5	--
01/11/95	153.38	137.41	15.97	--	--	<50	<0.5	<0.5	<0.5	<0.5	--
04/07/95	153.38	139.37	14.01	--	--	<50	<0.5	<0.5	<0.5	<0.5	--
07/20/95	153.38	137.17	16.21	--	--	<50	<0.5	<0.5	<0.5	0.61	--
09/22/95	153.38	137.07	16.31	--	--	62	<0.5	<0.5	<0.5	<0.5	--
01/02/96	153.38	137.56	15.82	--	--	<50	<0.5	<0.5	<0.5	<0.5	<2.5
04/26/96	153.38	138.41	14.97	--	--	<50	<0.5	<0.5	<0.5	<0.5	--

Table 1
Groundwater Monitoring Data and Analytical Results
Former Chevron Service Station #9-2960
2416 Grove Way
Castro Valley, California

WELL ID/ DATE	TOC* (ft.)	GWE (msf)	DTW (ft.)	SPHT (ft.)	SPH REMOVED (gallons)	TPH- GRO (ug/L)	B (ug/L)	T (ug/L)	E (ug/L)	X (ug/L)	MTBE (ug/L)
C-5 (cont)											
07/22/96	153.38	137.06	16.32	--	--	<50	<0.5	<0.5	<0.5	<0.5	--
10/17/96	153.38	136.88	16.50	--	--	<50	<0.5	<0.5	<0.5	<0.5	--
01/23/97	153.38	139.18	14.20	--	--	<50	<0.5	<0.5	<0.5	<0.5	--
ABANDONED											
C-6											
10/03/90	152.84	134.70	18.14	--	--	<50	<0.5	<0.5	<0.5	<0.5	--
10/25/90	152.84	134.55	18.29	--	--	<50	<0.5	1.0	<0.5	<0.5	--
11/09/90	152.84	134.58	18.26	--	--	<50	<0.5	<0.5	<0.5	<0.5	--
01/22/91	152.84	134.69	18.15	--	--	<50	<0.5	<0.5	<0.5	<0.5	--
02/21/91	152.84	134.92	17.92	--	--	--	--	--	--	--	--
04/01/91	152.84	135.73	17.11	--	--	--	--	--	--	--	--
04/11/91	152.84	135.83	17.01	--	--	--	--	--	--	--	--
07/01/91	152.84	135.12	17.72	--	--	--	--	--	--	--	--
09/24/91	152.84	135.72	17.12	--	--	<50	<0.5	<0.5	<0.5	<0.5	--
10/23/91	152.84	134.59	18.25	--	--	--	--	--	--	--	--
11/22/91	152.84	134.79	18.05	--	--	--	--	--	--	--	--
01/09/92	152.84	135.42	17.42	--	--	<50	<0.5	<0.5	<0.5	<0.5	--
03/06/92	152.84	136.33	16.51	--	--	<50	<0.5	<0.5	<0.5	<0.5	--
06/04/92	152.84	135.83	17.01	--	--	<50	<0.5	<0.5	<0.5	<0.5	--
09/28/92	152.84	134.84	18.00	--	--	<50	<0.5	<0.5	<0.5	<0.5	--
12/17/92	152.84	135.58	17.26	--	--	<50	<0.5	<0.5	<0.5	<0.5	--
04/29/93	152.84	136.61	16.23	--	--	<50	<0.5	<0.5	<0.5	<1.5	--
07/29/93	152.84	135.88	16.96	--	--	<50	<0.5	<0.5	<0.5	<1.5	--
10/22/93	152.84	135.38	17.46	--	--	74	7.4	6.1	3.3	9.7	--
01/24/94	152.84	135.38	17.46	--	--	<50	<0.5	<0.5	<0.5	<0.5	--
04/11/94	152.84	135.64	17.20	--	--	<50	<0.5	<0.5	<0.5	<0.5	--
07/01/94	152.84	135.66	17.18	--	--	<50	<0.5	<0.5	<0.5	<0.5	--
10/06/94	152.84	135.19	17.65	--	--	<50	<0.5	<0.5	<0.5	<0.5	--
01/11/95	152.84	136.18	16.66	--	--	<50	<0.5	<0.5	<0.5	<0.5	--
04/07/95	152.84	137.25	15.59	--	--	<50	<0.5	<0.5	<0.5	<0.5	--
07/20/95	152.84	135.80	17.04	--	--	<50	<0.5	<0.5	<0.5	<0.5	--
09/22/95	152.84	135.74	17.10	--	--	<50	<0.5	<0.5	<0.5	<0.5	--
01/02/96	152.84	136.08	16.76	--	--	<50	<0.5	<0.5	<0.5	<0.5	<2.5
04/26/96	152.84	136.64	16.20	--	--	<50	<0.5	<0.5	<0.5	<0.5	--
07/22/96	152.84	135.79	17.05	--	--	<50	<0.5	<0.5	<0.5	<0.5	--

Table 1
Groundwater Monitoring Data and Analytical Results
Former Chevron Service Station #9-2960
2416 Grove Way
Castro Valley, California

WELL ID/ DATE	TOC* (ft.)	GWE (msf)	DTW (ft.)	SPHT (ft.)	SPH REMOVED (gallons)	TPH- GRO (ug/L)	B (ug/L)	T (ug/L)	E (ug/L)	X (ug/L)	MTBE (ug/L)
C-6 (cont)											
10/17/96	152.84	135.62	17.22	--	--	<50	<0.5	<0.5	<0.5	<0.5	--
01/23/97	152.84	136.99	15.85	--	--	<50	<0.5	<0.5	<0.5	<0.5	--
07/10/97	152.84	135.95	16.89	--	--	<50	<0.5	<0.5	<0.5	<0.5	--
01/15/98	152.84	136.64	16.20	--	--	<50	<0.5	<0.5	<0.5	<0.5	--
01/16/98	152.84	136.74	16.10	--	--	REGAUGE	--	--	--	--	--
07/09/98	152.84	136.71	16.13	--	--	<50	<0.5	<0.5	<0.5	<0.5	--
01/08/99	152.84	137.57	15.27	--	--	<50	<0.5	<0.5	<0.5	<0.5	--
07/09/99	152.84	136.60	16.24	--	--	<50	<0.5	<0.5	<0.5	<0.5	<5.0
02/01/00	152.84	136.57	16.27	--	--	<50	<0.5	<0.5	<0.5	<0.5	<5.0
08/21/00	152.84	UNABLE TO LOCATE - PAVED OVER				--	--	--	--	--	--
01/25/01	152.84	UNABLE TO LOCATE - PAVED OVER				--	--	--	--	--	--
07/10/01	152.84	UNABLE TO LOCATE - PAVED OVER				--	--	--	--	--	--
01/08/02	152.84	UNABLE TO LOCATE - PAVED OVER				--	--	--	--	--	--
03/26/02	152.84	UNABLE TO LOCATE - PAVED OVER				--	--	--	--	--	--
06/17/02	152.84	UNABLE TO LOCATE - PAVED OVER				--	--	--	--	--	--
PAVED OVER											
C-7											
10/03/90	155.34	134.52	20.82	--	--	<50	<0.5	<0.5	<0.5	<0.5	--
10/25/90	155.34	134.43	20.91	--	--	<50	<0.5	1.0	<0.5	<0.5	--
11/09/90	155.34	134.40	20.94	--	--	<50	<0.5	<0.5	<0.5	<0.5	--
01/22/91	155.34	133.84	21.50	--	--	<50	4.0	<0.5	<0.5	<0.5	--
02/21/91	155.34	134.63	20.71	--	--	--	--	--	--	--	--
04/01/91	155.34	135.34	20.00	--	--	--	--	--	--	--	--
04/11/91	155.34	135.29	20.05	--	--	--	--	--	--	--	--
07/01/91	155.34	134.82	20.52	--	--	--	--	--	--	--	--
09/24/91	155.34	134.52	20.82	--	--	<50	<0.5	<0.5	<0.5	<0.5	--
10/23/91	155.34	134.43	20.91	--	--	--	--	--	--	--	--
11/22/91	155.34	134.55	20.79	--	--	--	--	--	--	--	--
01/09/92	155.34	135.18	20.16	--	--	<50	<0.5	<0.5	<0.5	0.9	--
03/06/92	155.34	135.92	19.42	--	--	<50	<0.5	<0.5	<0.5	<0.5	--
06/04/92	155.34	135.53	19.81	--	--	250	<0.5	<0.5	<0.5	<0.5	--
09/28/92	155.34	134.69	20.65	--	--	<50	<0.5	<0.5	<0.5	<0.5	--
12/17/92	155.34	135.32	20.02	--	--	<50	<0.5	<0.5	<0.5	<0.5	--
04/29/93	155.34	136.19	19.15	--	--	<50	<0.5	<0.5	<0.5	<1.5	--
07/26/93	155.34	135.57	19.77	--	--	<50	<0.5	<0.5	<0.5	<1.5	--

Table 1
Groundwater Monitoring Data and Analytical Results
Former Chevron Service Station #9-2960
2416 Grove Way
Castro Valley, California

WELL ID/ DATE	TOC* (fL)	GWE (msl)	DFW (ft.)	SPHT (fL)	SPH REMOVED (gallons)	TFH- GRO (ug/L)	B (ug/L)	T (ug/L)	E (ug/L)	X (ug/L)	MTBE (ug/L)
C-7 (cont)											
10/22/93	155.34	135.17	20.17	--	--	--	--	--	--	--	--
01/24/94	155.34	135.11	20.23	--	--	<50	<0.5	<0.5	<0.5	<0.5	--
04/11/94	155.34	135.39	19.95	--	--	<50	<0.5	<0.5	<0.5	<0.5	--
07/01/94	155.34	135.42	19.92	--	--	<50	<0.5	<0.5	<0.5	<0.5	--
10/06/94	155.34	135.03	20.31	--	--	<50	<0.5	<0.5	<0.5	<0.5	--
01/11/95	155.34	135.98	19.36	--	--	<50	<0.5	<0.5	<0.5	<0.5	--
04/07/95	155.34	136.84	18.50	--	--	<50	<0.5	<0.5	<0.5	<0.5	--
07/20/95	155.34	135.46	19.88	--	--	<50	<0.5	<0.5	<0.5	<0.5	--
09/22/95	155.34	135.38	19.96	--	--	<50	<0.5	<0.5	<0.5	<0.5	--
01/02/96	155.34	135.64	19.70	--	--	<50	<0.5	<0.5	<0.5	<0.5	<2.5
04/26/96	155.34	136.17	19.17	--	--	<50	<0.5	<0.5	<0.5	<0.5	--
07/22/96	155.34	135.49	19.85	--	--	<50	<0.5	<0.5	<0.5	<0.5	--
10/17/96	155.34	135.34	20.00	--	--	<50	<0.5	<0.5	<0.5	<0.5	--
01/23/97	155.34	136.44	18.90	--	--	<50	<0.5	<0.5	<0.5	<0.5	--
07/10/97	155.34	135.58	19.76	--	--	<50	<0.5	<0.5	<0.5	<0.5	--
01/15/98	155.34	136.02	19.32	--	--	<50	<0.5	<0.5	<0.5	<0.5	--
01/16/98	155.34	136.14	19.20	--	--	REGAUGE	--	--	--	--	--
07/09/98	155.34	136.02	19.32	--	--	<50	<0.5	<0.5	<0.5	<0.5	--
01/08/99	155.34	136.83	18.51	--	--	<50	<0.5	<0.5	<0.5	<0.5	--
07/09/99	155.34	136.16	19.18	--	--	<50	<0.5	<0.5	<0.5	<0.5	<5.0
02/01/00	155.34	136.21	19.13	--	--	<50	<0.5	<0.5	<0.5	<0.5	<5.0
08/21/00	155.34	136.16	19.18	0.00	0.00	<50	<0.50	<0.50	<0.50	<0.50	<2.5
01/25/01	155.34	136.09	19.25	0.00	0.00	<50.0	<0.500	<0.500	<0.500	<0.500	<2.50
07/10/01	155.34	136.17	19.17	0.00	0.00	<50	<0.50	<0.50	<0.50	<0.50	<2.5/<2.0 ¹
01/08/02	155.34	136.31	19.03	0.00	0.00	<50	<0.50	<0.50	<0.50	<1.5	<2.5
03/26/02	155.08	--	--	--	--	--	--	--	--	--	--
02/29/08 ⁴	155.34	136.77	18.57	0.00	0.00	<50	<0.5	<0.5	<0.5	<0.5	<0.5
DISCONTINUED MONITORING / SAMPLING											
TRIP BLANK											
04/26/96	--	--	--	--	--	<50	<0.5	<0.5	<0.5	<0.5	--
07/22/96	--	--	--	--	--	<50	<0.5	<0.5	<0.5	<0.5	--
10/17/96	--	--	--	--	--	<50	<0.5	<0.5	<0.5	<0.5	--
01/23/97	--	--	--	--	--	<50	<0.5	<0.5	<0.5	<0.5	--
07/10/97	--	--	--	--	--	<50	<0.5	<0.5	<0.5	<0.5	--
01/15/98	--	--	--	--	--	<50	<0.5	<0.5	<0.5	<0.5	--

Table 1
Groundwater Monitoring Data and Analytical Results
Former Chevron Service Station #9-2960
2416 Grove Way
Castro Valley, California

WELL ID/ DATE	TOC* (<i>ft.</i>)	GWE (<i>msf</i>)	DTW (<i>ft.</i>)	SPHT (<i>ft.</i>)	SPH REMOVED (<i>gallons</i>)	TPH- GRO (<i>ug/L</i>)	B (<i>ug/L</i>)	T (<i>ug/L</i>)	E (<i>ug/L</i>)	X (<i>ug/L</i>)	MTBE (<i>ug/L</i>)
TRIP BLANK (cont)											
07/09/98	--	--	--	--	--	<50	<0.5	<0.5	<0.5	<0.5	--
01/08/99	--	--	--	--	--	<50	<0.5	<0.5	<0.5	<0.5	--
02/01/00	--	--	--	--	--	<50	<0.5	<0.5	<0.5	<0.5	<5.0
08/21/00	--	--	--	--	--	<50	<0.50	<0.50	<0.50	<0.50	<2.5
01/25/01	--	--	--	--	--	<50.0	<0.500	<0.500	<0.500	<0.500	<2.50
07/10/01	--	--	--	--	--	<50	<0.50	<0.50	<0.50	<0.50	<2.5
QA											
01/08/02	--	--	--	--	--	<50	<0.50	<0.50	<0.50	<1.5	<2.5
03/26/02	--	--	--	--	--	<50	<0.50	<0.50	<0.50	<1.5	<2.5
06/17/02	--	--	--	--	--	<50	<0.50	<0.50	<0.50	<1.5	<2.5
09/17/02	--	--	--	--	--	<50	<0.50	<0.50	<0.50	<1.5	<2.5
12/02/02	--	--	--	--	--	<50	<0.50	<0.50	<0.50	<1.5	<2.5
03/03/03	--	--	--	--	--	<50	<0.50	<0.50	<0.50	<1.5	<2.5
06/16/03	--	--	--	--	--	<50	<0.5	<0.5	<0.5	<0.5	<0.5
09/15/03 ⁴	--	--	--	--	--	<50	<0.5	<0.5	<0.5	<0.5	<0.5
12/15/03 ⁴	--	--	--	--	--	<50	<0.5	<0.5	<0.5	<0.5	<0.5
03/01/04 ⁴	--	--	--	--	--	<50	<0.5	<0.5	<0.5	<0.5	<0.5
06/28/04 ⁴	--	--	--	--	--	<50	<0.5	<0.5	<0.5	<0.5	<0.5
09/13/04 ⁴	--	--	--	--	--	<50	<0.5	<0.5	<0.5	<0.5	<0.5
12/22/04 ⁴	--	--	--	--	--	<50	<0.5	<0.5	<0.5	<0.5	<0.5
03/04/05 ⁴	--	--	--	--	--	<50	<0.5	<0.5	<0.5	<0.5	<0.5
06/30/05 ⁴	--	--	--	--	--	<50	<0.5	<0.5	<0.5	<0.5	<0.5
09/16/05 ⁴	--	--	--	--	--	<50	<0.5	<0.5	<0.5	<0.5	<0.5
12/21/05 ⁴	--	--	--	--	--	<50	<0.5	<0.5	<0.5	<0.5	<0.5
03/21/06 ⁴	--	--	--	--	--	<50	<0.5	<0.5	<0.5	<0.5	<0.5
06/21/06 ⁴	--	--	--	--	--	<50	<0.5	<0.5	<0.5	<0.5	<0.5
09/05/06 ⁴	--	--	--	--	--	<50	<0.5	<0.5	<0.5	<0.5	<0.5
12/28/06 ⁴	--	--	--	--	--	<50	<0.5	<0.5	<0.5	<0.5	<0.5
03/26/07 ⁴	--	--	--	--	--	<50	<0.5	<0.5	<0.5	<0.5	<0.5
06/26/07 ⁴	--	--	--	--	--	<50	<0.5	<0.5	<0.5	<0.5	<0.5
09/26/07 ⁴	--	--	--	--	--	<50	<0.5	<0.5	<0.5	<0.5	<0.5
12/20/07 ⁴	--	--	--	--	--	<50	<0.5	<0.5	<0.5	<0.5	<0.5
02/29/08 ⁴	--	--	--	--	--	<50	<0.5	<0.5	<0.5	<0.5	<0.5
05/19/08 ⁴	--	--	--	--	--	<50	<0.5	<0.5	<0.5	<0.5	<0.5
09/19/08 ⁴	--	--	--	--	--	<50	<0.5	<0.5	<0.5	<0.5	<0.5

Table 1
Groundwater Monitoring Data and Analytical Results
Former Chevron Service Station #9-2960
2416 Grove Way
Castro Valley, California

WELL ID/ DATE	TOC* (ft.)	GWE (msl)	DTW (ft.)	SPHT (ft.)	SPH REMOVED (gallons)	TPH- GRO (ug/L)	B (ug/L)	T (ug/L)	E (ug/L)	X (ug/L)	MTBE (ug/L)
QA (cont)											
12/04/08 ⁴	--	--	--	--	--	<50	<0.5	<0.5	<0.5	<0.5	<0.5
03/05/09 ⁴	--	--	--	--	--	<50	<0.5	<0.5	<0.5	<0.5	<0.5
06/23/09 ⁴	--	--	--	--	--	<50	<0.5	<0.5	<0.5	<0.5	<0.5
DISCONTINUED											

Table 1
Groundwater Monitoring Data and Analytical Results
Former Chevron Service Station #9-2960
2416 Grove Way
Castro Valley, California

EXPLANATIONS:

Groundwater monitoring data and laboratory analytical results prior to August 21, 2000, were compiled from reports prepared by Blaine Tech Services, Inc.

TOC = Top of Casing

(ft.) = Feet

GWE = Groundwater Elevation

(msl) = Mean sea level

DTW = Depth to Water

SPHT = Separate Phase Hydrocarbons Thickness

TPH-G = Total Petroleum Hydrocarbons as Gasoline

TPH = Total Petroleum Hydrocarbons

GRO = Gasoline Range Organics

B = Benzene

T = Toluene

E = Ethylbenzene

X = Xylenes

MTBE = Methyl Tertiary Butyl Ether

-- = Not Measured/Not Analyzed

QA = Quality Assurance/Trip Blank

(µg/L) = Micrograms per liter

* TOC elevations were surveyed in April 2002, by Morrow Surveying. Elevations are based on Alameda County Benchmark No. 259, brass disc top of concrete guard rail & retaining wall abutment along east side "A" Street and on CL + N. 5th Street extended, (Elevation = 138.79 feet).

¹ MTBE by EPA Method 8260.

² Well development performed.

³ TPH-G, BTEX and MTBE by EPA Method 8260.

⁴ BTEX and MTBE by EPA Method 8260.

Table 2
Groundwater Analytical Results - Oxygenate Compounds
Former Chevron Service Station #9-2960
2416 Grove Way
Castro Valley, California

WELL ID	DATE	TBA (ug/L)	MTBE (ug/L)	DIPE (ug/L)	ETBE (ug/L)	TAME (ug/L)
C-8	03/26/02	<100	<2	<2	<2	<2
	06/17/02	<100	<2	<2	<2	<2
	09/17/02	<100	<2	<2	<2	<2
	12/02/02	<100	<2	<2	<2	<2
	03/03/03	<5	<0.5	<0.5	<0.5	<0.5
	06/16/03	<5	<0.5	<0.5	<0.5	<0.5
	09/15/03	5	<0.5	<0.5	<0.5	<0.5
	12/15/03	<5	<0.5	<0.5	<0.5	<0.5
	03/01/04	<5	<0.5	<0.5	<0.5	<0.5
	06/28/04	<5	<0.5	<0.5	<0.5	<0.5
	09/13/04	<5	<0.5	<0.5	<0.5	<0.5
	12/22/04	<5	<0.5	<0.5	<0.5	<0.5
	03/04/05	<5	<0.5	<0.5	<0.5	<0.5
	06/30/05	<5	<0.5	<0.5	<0.5	<0.5
	09/16/05	<5	<0.5	<0.5	<0.5	<0.5
	12/21/05	<5	<0.5	<0.5	<0.5	<0.5
	03/21/06	<5	<0.5	<0.5	<0.5	<0.5
	06/21/06	<5	<0.5	<0.5	<0.5	<0.5
	09/05/06	<5	<0.5	<0.5	<0.5	<0.5
	12/28/06	<2	<0.5	<0.5	<0.5	<0.5
	03/26/07	<2	<0.5	<0.5	<0.5	<0.5
	06/26/07	<2	<0.5	<0.5	<0.5	<0.5
	09/26/07	<2	<0.5	<0.5	<0.5	<0.5
	12/20/07	<2	<0.5	<0.5	<0.5	<0.5
	02/29/08	<2	<0.5	<0.5	<0.5	<0.5
	05/09/08	<2	<0.5	<0.5	<0.5	<0.5
	09/19/08	<2	<0.5	<0.5	<0.5	<0.5
	12/04/08	<2	<0.5	<0.5	<0.5	<0.5
	03/05/09	2	<0.5	<0.5	<0.5	<0.5
	06/23/09	<2	<0.5	<0.5	<0.5	<0.5
	03/16/10	<2	<0.5	<0.5	<0.5	<0.5

Table 2
Groundwater Analytical Results - Oxygenate Compounds
 Former Chevron Service Station #9-2960
 2416 Grove Way
 Castro Valley, California

WELL ID	DATE	TBA (ug/L)	MTBE (ug/L)	DIPE (ug/L)	ETBE (ug/L)	TAME (ug/L)
C-7	07/10/01	<20	<2.0	<2.0	<2.0	<2.0
	02/29/08	<2	<0.5	<0.5	<0.5	<0.5
DISCONTINUED MONITORING / SAMPLING						

Table 2
Groundwater Analytical Results - Oxygenate Compounds
Former Chevron Service Station #9-2960
2416 Grove Way
Castro Valley, California

EXPLANATIONS:

TBA = t-Butyl alcohol
MTBE = Methyl Tertiary Butyl Ether
DIPE = di-Isopropyl ether
ETBE = Ethyl t-butyl ether
TAME = t-Amyl methyl ether
($\mu\text{g/L}$) = Micrograms per liter

ANALYTICAL METHOD:

EPA Method 8260 for Oxygenate Compounds

STANDARD OPERATING PROCEDURE - GROUNDWATER SAMPLING

Gettler-Ryan Inc. (GR) field personnel adhere to the following procedures for the collection and handling of groundwater samples prior to analysis by the analytical laboratory. All work is performed in accordance with the GR Health & Safety Plan and all client-specific programs. The scope of work and type of analysis to be performed is determined prior to commencing field work.

Prior to sampling, the presence or absence of free-phase hydrocarbons is determined using an interface probe. Product thickness, if present, is measured to the nearest 0.01 foot and is noted in the field notes. In addition, all depth to water level measurements are collected with a static water level indicator and are also recorded in the field notes, prior to purging and sampling any wells.

After water levels are collected and prior to sampling, if purging is to occur, each well is purged a minimum of three well casing volumes of water using pre-cleaned pumps (stack, peristaltic or Grundfos), or disposable bailers. Temperature, pH and electrical conductivity are measured a minimum of three times during the purging (additional parameters such as dissolved oxygen, oxidation reduction potential, turbidity may also be measured, depending on specific scope of work.). Purging continues until these parameters stabilize.

Groundwater samples are collected using disposable bailers. The water samples are transferred from the bailer into appropriate containers. Pre-preserved containers, supplied by analytical laboratories, are used. When pre-preserved containers are not available, the laboratory is instructed to preserve the sample as appropriate. Duplicate samples are collected for the laboratory to use in maintaining quality assurance/quality control standards, as directed by the scope of work. The samples are labeled to include the job number, sample identification, collection date and time, analysis, preservation (if any), and the sample collector's initials. The water samples are placed in a cooler, maintained at 4°C for transport to the laboratory. Once collected in the field, all samples are maintained under chain of custody until delivered to the laboratory.

The chain of custody document includes the job number, type of preservation, if any, analysis requested, sample identification, date and time collected, and the sample collector's name. The chain of custody is signed and dated (including time of transfer) by each person who receives or surrenders the samples, beginning with the field personnel and ending with the laboratory personnel.

A laboratory supplied trip blank accompanies each sampling set. The trip blank is analyzed for some or all of the same compounds as the groundwater samples.

As requested by Chevron Environmental Management Company, the purge water and decontamination water generated during sampling activities is transported by IWM to Chemical Waste Management located in Kettleman Hills, California.



GETTLER - RYAN INC.

WELL MONITORING/SAMPLING FIELD DATA SHEET

Client/Facility#: Chevron #9-2960 Job Number: 386365
 Site Address: 2416 Grove Way Event Date: 3/16/10 (inclusive)
 City: Castro Valley, CA Sampler: JH

Well ID: C-8 Date Monitored: 3/16/10
 Well Diameter: 2 in.
 Total Depth: 24.55 ft.
 Depth to Water: 14.71 ft.

Volume	3/4"= 0.02	1"= 0.04	2"= 0.17	3"= 0.38
Factor (VF)	4"= 0.66	5"= 1.02	6"= 1.50	12"= 5.80

Check if water column is less than 0.50 ft.
 $9.84 \times VF .17 = 1.67$ x3 case volume = Estimated Purge Volume: 5.01 gal.
 Depth to Water w/ 80% Recharge [(Height of Water Column x 0.20) + DTW]: 16.67

Purge Equipment:
 Disposable Bailer X
 Stainless Steel Bailer _____
 Stack Pump _____
 Suction Pump _____
 Grundfos _____
 Peristaltic Pump _____
 QED Bladder Pump _____
 Other: _____

Sampling Equipment:
 Disposable Bailer X
 Pressure Bailer _____
 Discrete Bailer _____
 Peristaltic Pump _____
 QED Bladder Pump _____
 Other: _____

Time Started: _____ (2400 hrs)
 Time Completed: _____ (2400 hrs)
 Depth to Product: _____ ft
 Depth to Water: _____ ft
 Hydrocarbon Thickness: _____ ft
 Visual Confirmation/Description: _____
 Skimmer / Absorbant Sock (circle one)
 Amt Removed from Skimmer: _____ gal
 Amt Removed from Well: _____ gal
 Water Removed: _____
 Product Transferred to: _____

Start Time (purge): 0930 Weather Conditions: Clear
 Sample Time/Date: 1010 / 3/16/10 Water Color: cloudy Odor: (Y) Strong
 Approx. Flow Rate: _____ gpm. Sediment Description: 1.5 ft
 Did well de-water? No If yes, Time: _____ Volume: _____ gal. DTW @ Sampling: 16.31

Time (2400 hr.)	Volume (gal.)	pH	Conductivity (µmhos/cm - <u>US</u>)	Temperature (°C / F)	D.O. (mg/L)	ORP (mV)
<u>0934</u>	<u>1.5</u>	<u>7.42</u>	<u>1131</u>	<u>17.2</u>		
<u>0939</u>	<u>3.0</u>	<u>7.29</u>	<u>1180</u>	<u>17.6</u>		
<u>0945</u>	<u>5.0</u>	<u>7.15</u>	<u>1217</u>	<u>16.9</u>		

LABORATORY INFORMATION

SAMPLE ID	(#) CONTAINER	REFRIG.	PRESERV. TYPE	LABORATORY	ANALYSES
<u>C-8</u>	<u>6</u> x vov vial	<u>YES</u>	<u>HCL</u>	<u>LANCASTER</u>	<u>TPH-G(8015)/BTX+MTBE(8260)/ 5 OXYS (8260)</u>

COMMENTS: _____

Add/Replaced Lock: _____ Add/Replaced Plug: _____ Add/Replaced Bolt: _____

Chevron California Region Analysis Request/Chain of Custody



03 17 14-08

For Lancaster Laboratories use only
 Acct. #: 12099 Sample # 5930808 Group #: 017778
1186589

CRA MTI Project #: 61H-1964

Facility #: SS#9-2960 G-R#386365 Global ID#T0600100318
 Site Address: 2416 GROVE WAY, CASTRO VALLEY, CA
 Chevron PM: MTI CRAKJ
 Consultant/Office: G-R, Inc., 6747 Sierra Court, Suite J, Dublin, CA 94568
 Lead Consultant:
 Consultant Prj. Mgr.: Deanna L. Harding (deanna@grinc.com)
 Consultant Phone #: 925-551-7555 Fax #: 925-551-7899
 Sampler: J. Hooper

		Matrix		Analyses Requested																	
				Preservation Codes																	
Sample Identification	Date Collected	Time Collected	Grab	Composite	Soil	Water	Oil	Air	Total Number of Containers	H	H	A									
										BTEX + MTBE 8260	TPH 8015 MOD GRO	TPH 8015 MOD DRO	8260 full scan	Oxygenates	Total Lead Method	Dissolved Lead Method					
<u>C-8</u>	<u>3/16/10</u>	<u>1010</u>	<input checked="" type="checkbox"/>						<u>6</u>	<input checked="" type="checkbox"/>	<input checked="" type="checkbox"/>										

Preservative Codes
 H = HCl T = Thiosulfate
 N = HNO₃ B = NaOH
 S = H₂SO₄ O = Other

J value reporting needed
 Must meet lowest detection limits possible for 8260 compounds
 8021 MTBE Confirmation
 Confirm highest hit by 8260
 Confirm all hits by 8260
 Run ___ oxy's on highest hit
 Run ___ oxy's on all hits

Turnaround Time Requested (TAT) (please circle)

STD. TAT 72 hour 48 hour
 24 hour 4 day 5 day

Data Package Options (please circle if required) EDF/EDD

QC Summary Type I - Full
 Type VI (Raw Data) Coalt Deliverable not needed
 WIP (RWOCB)
 Disk

Relinquished by: <u>[Signature]</u>	Date: <u>3/17/10</u>	Time: <u>1430</u>	Received by: <u>[Signature]</u>	Date: <u>17 MAR 10</u>	Time: <u>1430</u>
Relinquished by: <u>[Signature]</u>	Date: <u>17 MAR 10</u>	Time: <u>1638</u>	Received by: <u>FEDEX</u>	Date:	Time:
Relinquished by: _____	Date:	Time:	Received by: _____	Date:	Time:
Relinquished by Commercial Carrier: UPS FedEx Other _____	Temperature Upon Receipt: <u>1.2.2.2</u> °C		Received by: <u>[Signature]</u>	Date: <u>3/17/10</u>	Time: <u>0740</u>
			Custody Seals Intact? <u>[Signature]</u>	Yes	No

ANALYTICAL RESULTS

RECEIVED

Prepared for:

MAR 25 2010

Chevron c/o CRA
Suite 110
2000 Opportunity Drive
Roseville CA 95678GETTLER-RYAN INC.
GENERAL CONTRACTORS

916-677-3407

Prepared by:

Lancaster Laboratories
2425 New Holland Pike
Lancaster, PA 17605-2425

March 26, 2010

Project: 92960

Samples arrived at the laboratory on Thursday, March 18, 2010. The PO# for this group is 92960 and the release number is MTI. The group number for this submittal is 1186589.

Client Sample Description

C-8-W-100316 Grab Water

Lancaster Labs (LLI) #

5930808

The specific methodologies used in obtaining the enclosed analytical results are indicated on the Laboratory Sample Analysis Record.

ELECTRONIC Gettler-Ryan, Inc.
COPY TO

Attn: Cheryl Hansen



Analysis Report

2425 New Holland Pike, PO Box 12425, Lancaster, PA 17605-2425 • 717-656-2300 Fax: 717-656-2661 • www.Lancasterlabs.com

Questions? Contact your Client Services Representative
Jill M Parker at (717) 656-2300

Respectfully Submitted,

A handwritten signature in cursive script that reads "Christine Duloney".

Christine Duloney
Senior Specialist



Analysis Report

2425 New Holland Pike, PO Box 12425, Lancaster, PA 17605-2425 • 717-656-2300 Fax: 717-656-2681 • www.lancasterlabs.com

Sample Description: C-8-W-100316 Grab Water
 Facility# 92960 Job# 386365 MTI# 61H-1964 GRD
 2416 Grove-Castro Valley T0600100318 C-8

LLI Sample # WW 5930808
 LLI Group # 1186589
 CA

Project Name: 92960

Collected: 03/16/2010 10:10 by JH

Account Number: 12099

Submitted: 03/18/2010 08:45

Chevron c/o CRA

Reported: 03/26/2010 at 10:02

Suite 110

Discard: 04/26/2010

2000 Opportunity Drive
 Roseville CA 95678

29608

CAT No.	Analysis Name	CAS Number	As Received Result	As Received Method Detection Limit	Dilution Factor
GC/MS Volatiles SW-846 8260B			ug/l	ug/l	
10943	t-Amyl methyl ether	994-05-8	N.D.	0.5	1
10943	Benzene	71-43-2	21	0.5	1
10943	t-Butyl alcohol	75-65-0	N.D.	2	1
10943	Ethyl t-butyl ether	637-92-3	N.D.	0.5	1
10943	Ethylbenzene	100-41-4	8	0.5	1
10943	di-Isopropyl ether	108-20-3	N.D.	0.5	1
10943	Methyl Tertiary Butyl Ether	1634-04-4	N.D.	0.5	1
10943	Toluene	108-88-3	3	0.5	1
10943	Xylene (Total)	1330-20-7	6	0.5	1
GC Volatiles SW-846 8015B			ug/l	ug/l	
01728	TPH-GRO N. CA water C6-C12	n.a.	2,100	250	5

General Sample Comments

State of California Lab Certification No. 2501
 Trip blank vials were not received by the laboratory for this sample group.

All QC is compliant unless otherwise noted. Please refer to the Quality Control Summary for overall QC performance data and associated samples.

Laboratory Sample Analysis Record

CAT No.	Analysis Name	Method	Trial#	Batch#	Analysis Date and Time	Analyst	Dilution Factor
01163	GC/MS VOA Water Prep	SW-846 5030B	1	Z100813AA	03/23/2010 05:12	Florida A Cimino	1
10943	BTEX + 5 Oxygenates 8260 Water	SW-846 8260B	1	Z100813AA	03/23/2010 05:12	Florida A Cimino	1
01146	GC VOA Water Prep	SW-846 5030B	1	10082A07A	03/23/2010 22:17	Elizabeth J Marin	5
01728	TPH-GRO N. CA water C6-C12	SW-846 8015B	1	10082A07A	03/23/2010 22:17	Elizabeth J Marin	5

Quality Control Summary

 Client Name: Chevron c/o CRA
 Reported: 03/26/10 at 10:02 AM

Group Number: 1186589

Matrix QC may not be reported if site-specific QC samples were not submitted. In these situations, to demonstrate precision and accuracy at a batch level, a LCS/LCSD was performed, unless otherwise specified in the method.

Laboratory Compliance Quality Control

Analysis Name	Blank Result	Blank MDL	Report Units	LCS %REC	LCSD %REC	LCS/LCSD Limits	RPD	RPD Max
Batch number: Z100813AA	Sample number(s): 5930808							
t-Amyl methyl ether	N.D.	0.5	ug/l	89		77-120		
Benzene	N.D.	0.5	ug/l	97		79-120		
t-Butyl alcohol	N.D.	2.	ug/l	89		73-120		
Ethyl t-butyl ether	N.D.	0.5	ug/l	93		76-120		
Ethylbenzene	N.D.	0.5	ug/l	97		79-120		
di-Isopropyl ether	N.D.	0.5	ug/l	99		71-124		
Methyl Tertiary Butyl Ether	N.D.	0.5	ug/l	100		76-120		
Toluene	N.D.	0.5	ug/l	98		79-120		
Xylene (Total)	N.D.	0.5	ug/l	101		80-120		
Batch number: 10082A07A	Sample number(s): 5930808							
TPH-GRO N. CA water C6-C12	N.D.	50.	ug/l	118	118	75-135	0	30

Sample Matrix Quality Control

Unspiked (UNSPK) = the sample used in conjunction with the matrix spike
 Background (BKG) = the sample used in conjunction with the duplicate

Analysis Name	MS %REC	MSD %REC	MS/MSD Limits	RPD	RPD MAX	BKG Conc	DUP Conc	DUP RPD	Dup RPD Max
Batch number: Z100813AA	Sample number(s): 5930808 UNSPK: P930803								
t-Amyl methyl ether	92	93	75-122	1	30				
Benzene	102	103	80-126	0	30				
t-Butyl alcohol	89	90	67-119	1	30				
Ethyl t-butyl ether	93	94	74-122	1	30				
Ethylbenzene	106	106	71-134	0	30				
di-Isopropyl ether	101	101	70-129	1	30				
Methyl Tertiary Butyl Ether	96	97	72-126	1	30				
Toluene	108	106	80-125	1	30				
Xylene (Total)	108	107	79-125	1	30				
Batch number: 10082A07A	Sample number(s): 5930808 UNSPK: P930800								
TPH-GRO N. CA water C6-C12	127		63-154						

Surrogate Quality Control

Surrogate recoveries which are outside of the QC window are confirmed unless attributed to dilution or otherwise noted on the Analysis Report.

Analysis Name: UST VOCs by 8260B - Water

*- Outside of specification

- (1) The result for one or both determinations was less than five times the LOQ.
- (2) The unspiked result was more than four times the spike added.

Quality Control Summary

Client Name: Chevron c/o CRA
Reported: 03/26/10 at 10:02 AM

Group Number: 1186589

Surrogate Quality Control

Batch number: Z100813AA

	Dibromofluoromethane	1,2-Dichloroethane-d4	Toluene-d8	4-Bromofluorobenzene
5930808	96	94	105	104
Blank	96	95	102	95
LCS	98	97	99	95
MS	96	95	101	99
MSD	96	96	101	96
Limits:	80-116	77-113	80-113	78-113

Analysis Name: TPH-GRO N. CA water C6-C12

Batch number: 10082A07A

Trifluorotoluene-F

5930808	123
Blank	105
LCS	116
LCSD	116
MS	116
Limits:	63-135

*- Outside of specification

- (1) The result for one or both determinations was less than five times the LOQ.
- (2) The unspiked result was more than four times the spike added.

Lancaster Laboratories Explanation of Symbols and Abbreviations

The following defines common symbols and abbreviations used in reporting technical data:

N.D.	none detected	BMQL	Below Minimum Quantitation Level
TNTC	Too Numerous To Count	MPN	Most Probable Number
IU	International Units	CP Units	cobalt-chloroplatinate units
umhos/cm	micromhos/cm	NTU	nephelometric turbidity units
C	degrees Celsius	F	degrees Fahrenheit
Cal	(diet) calories	lb.	pound(s)
meq	milliequivalents	kg	kilogram(s)
g	gram(s)	mg	milligram(s)
ug	microgram(s)	l	liter(s)
ml	milliliter(s)	ul	microliter(s)
m³	cubic meter(s)	fib >5 um/ml	fibers greater than 5 microns in length per ml
<	less than – The number following the sign is the <u>limit of quantitation</u> , the smallest amount of analyte which can be reliably determined using this specific test.		
>	greater than		
ppm	parts per million – One ppm is equivalent to one milligram per kilogram (mg/kg), or one gram per million grams. For aqueous liquids, ppm is usually taken to be equivalent to milligrams per liter (mg/l), because one liter of water has a weight very close to a kilogram. For gases or vapors, one ppm is equivalent to one microliter of gas per liter of gas.		
ppb	parts per billion		
Dry weight basis	Results printed under this heading have been adjusted for moisture content. This increases the analyte weight concentration to approximate the value present in a similar sample without moisture.		

U.S. EPA data qualifiers:

Organic Qualifiers	Inorganic Qualifiers
A TIC is a possible aldol-condensation product	B Value is <CRDL, but ≥IDL
B Analyte was also detected in the blank	E Estimated due to interference
C Pesticide result confirmed by GC/MS	M Duplicate injection precision not met
D Compound quantitated on a diluted sample	N Spike amount not within control limits
E Concentration exceeds the calibration range of the instrument	S Method of standard additions (MSA) used for calculation
J Estimated value	U Compound was not detected
N Presumptive evidence of a compound (TICs only)	W Post digestion spike out of control limits
P Concentration difference between primary and confirmation columns >25%	* Duplicate analysis not within control limits
U Compound was not detected	+ Correlation coefficient for MSA <0.995
X,Y,Z Defined in case narrative	

Analytical test results for methods listed on the laboratories' accreditation scope meet all requirements of NELAC unless otherwise noted under the individual analysis.

Tests results relate only to the sample tested. Clients should be aware that a critical step in a chemical or microbiological analysis is the collection of the sample. Unless the sample analyzed is truly representative of the bulk of material involved, the test results will be meaningless. If you have questions regarding the proper techniques of collecting samples, please contact us. We cannot be held responsible for sample integrity, however, unless sampling has been performed by a member of our staff. This report shall not be reproduced except in full, without the written approval of the laboratory.

WARRANTY AND LIMITS OF LIABILITY – In accepting analytical work, we warrant the accuracy of test results for the sample as submitted. THE FOREGOING EXPRESS WARRANTY IS EXCLUSIVE AND IS GIVEN IN LIEU OF ALL OTHER WARRANTIES, EXPRESSED OR IMPLIED. WE DISCLAIM ANY OTHER WARRANTIES, EXPRESSED OR IMPLIED, INCLUDING A WARRANTY OF FITNESS FOR PARTICULAR PURPOSE AND WARRANTY OF MERCHANTABILITY. IN NO EVENT SHALL LANCASTER LABORATORIES BE LIABLE FOR INDIRECT, SPECIAL, CONSEQUENTIAL, OR INCIDENTAL DAMAGES INCLUDING, BUT NOT LIMITED TO, DAMAGES FOR LOSS OF PROFIT OR GOODWILL REGARDLESS OF (A) THE NEGLIGENCE (EITHER SOLE OR CONCURRENT) OF LANCASTER LABORATORIES AND (B) WHETHER LANCASTER LABORATORIES HAS BEEN INFORMED OF THE POSSIBILITY OF SUCH DAMAGES. We accept no legal responsibility for the purposes for which the client uses the test results. No purchase order or other order for work shall be accepted by Lancaster Laboratories which includes any conditions that vary from the Standard Terms and Conditions of Lancaster Laboratories and we hereby object to any conflicting terms contained in any acceptance or order submitted by client.