

9-2960
 2416 Grove Way
 Castro Valley

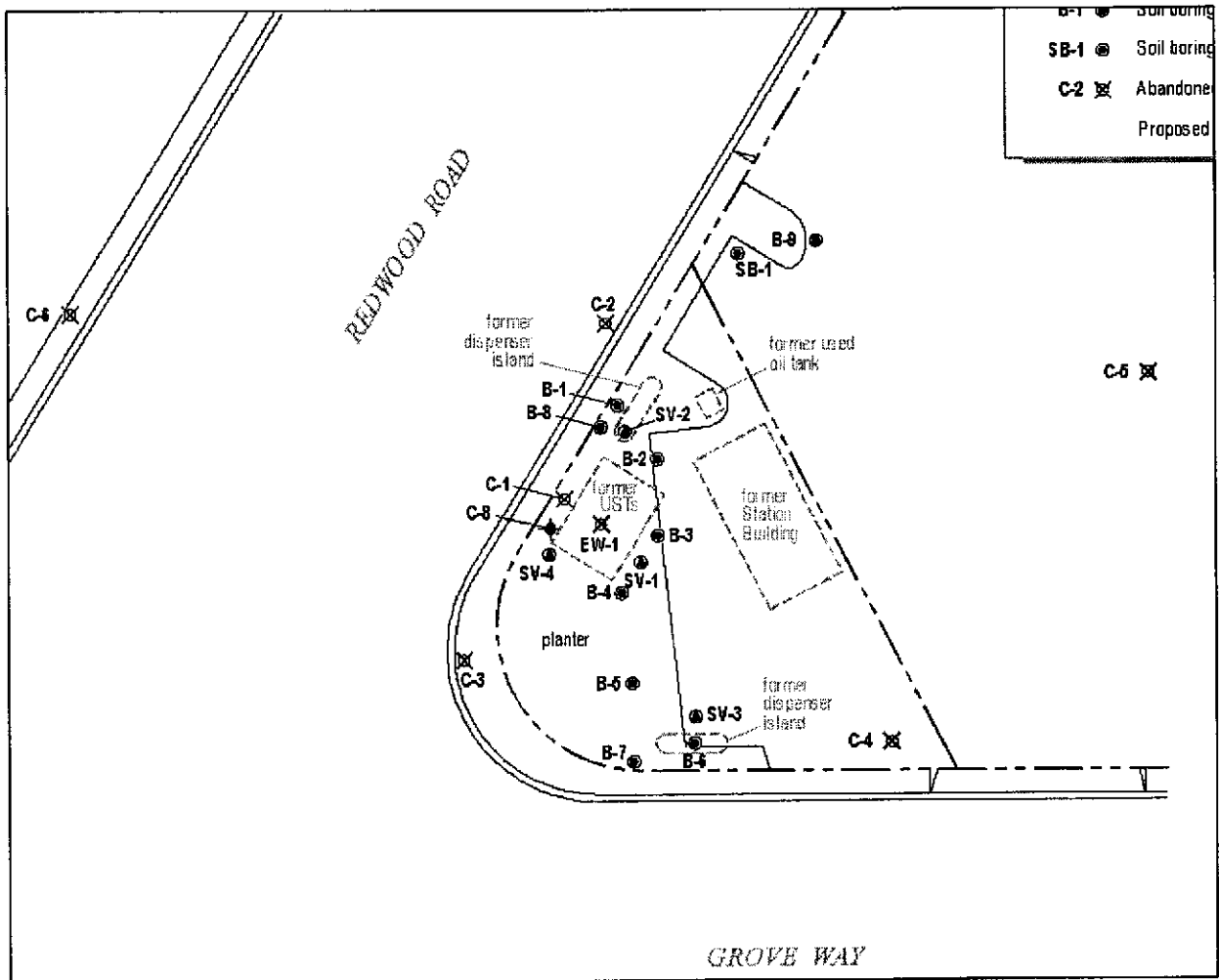

Site Number:

9-2960

Site Address:

2416 Grove Way, Castro Valley

Alameda County Case Worker:

Barney Chan

Soil Conditions:

Significant soil impact is present beneath the site mainly on the west side near the former UST pit, with minor impact in the southeast corner near the former dispenser island. Impact is present between 3 to 18.5 fbg. The highest concentrations of TPHg and benzene are 2,300 mg/kg and 13 mg/kg, respectively, present in boring B-1 located northwest of the former UST pit. Impact to soil appears to be defined laterally.

Groundwater Conditions:

A hydrocarbon plume is present beneath the site. The extent of the plume cannot be determined at this time as only one well, C-8, is being monitored and sampled. No other wells have been monitored or sampled since March 26, 2002. The maximum concentrations remaining on-site are: 6,100 ppb TPHg and 100 ppb benzene.

Alameda County Actions:

None to Date

Pending Cambria Actions:

None to Date



GETTLER-RYAN INC.

TRANSMITTAL

July 21, 2006
G-R #386365

TO: Mr. Bruce H. Eppler
Cambria Environmental Technology, Inc.
2000 Opportunity Drive, Suite 110
Roseville, California 95678

FROM: Deanna L. Harding
Project Coordinator
Gettler-Ryan Inc.
6747 Sierra Court, Suite J
Dublin, California 94568

RE: **Former Chevron Service Station
#9-2960
2416 Grove Way
Castro Valley, California
MTI: 61H-1964
RO 0000275**

WE HAVE ENCLOSED THE FOLLOWING:

COPIES	DATED	DESCRIPTION
2	July 21, 2006	Groundwater Monitoring and Sampling Report Second Quarter - Event of June 21, 2006

COMMENTS:

Pursuant to your request, we are providing you with copies of the above referenced report for your use and distribution to the following:

Mr. Dana Thurman, Chevron Environmental Management Company, P.O. Box 6012, Room K2236,
San Ramon, CA 94583

Please provide any comments/changes and propose any groundwater monitoring modifications for the next event prior to **August 9, 2006**, at which time the final report will be distributed to the following:

cc: Mr. Phil Conley, President Board of Trustees, First Presbyterian Church, 2490 Grove Way, Castro Valley, CA 94546
Mr. Barney Chan, Alameda County Health Care Services, Dept. of Environmental Health, 1131 Harbor Bay Parkway, Suite 250, Alameda, CA 94502-6577 (No Hard Copy-UPLOAD TO ALAMEDA CO.)

Enclosures

trans/9-2960-DT



GETTLER - RYAN INC.

July 21, 2006
G-R Job #386365

Mr. Dana Thurman
Chevron Environmental Management Company
P.O. Box 6012, Room K2236
San Ramon, CA 94583

RE: Second Quarter Event of June 21, 2006
Groundwater Monitoring & Sampling Report
Former Chevron Service Station #9-2960
2416 Grove Way
Castro Valley, California

Dear Mr. Thurman:

This report documents the most recent groundwater monitoring and sampling event performed by Gettler-Ryan Inc. (G-R) at the referenced site. All field work was conducted in accordance with G-R Standard Operating Procedure - Groundwater Sampling (attached).

The static groundwater level was measured and the well was checked for the presence of separate-phase hydrocarbons. Static water level data, groundwater elevations, and separate-phase hydrocarbon thickness (if any) are presented in the attached Table 1. A Groundwater Elevation Map is included as Figure 1.

Groundwater samples were collected from the monitoring well and submitted to a state certified laboratory for analyses. The field data sheets for this event are attached. Analytical results are presented in the table(s) listed below. The chain of custody document and laboratory analytical report are also attached.

Please call if you have any questions or comments regarding this report. Thank you.

Sincerely,

Deanna L. Harding
Project Coordinator

Robert A. Lauritzen
Senior Geologist, P.G. No. 7504



- Figure 1: Groundwater Elevation Map
- Table 1: Groundwater Monitoring Data and Analytical Results
- Table 2: Groundwater Analytical Results - Oxygenate Compounds
- Attachments: Standard Operating Procedure - Groundwater Sampling
Field Data Sheets
Chain of Custody Document and Laboratory Analytical Reports

EXPLANATION

- ◆ Groundwater monitoring well
- × Abandoned well
- 99.99 Groundwater elevation in feet referenced to Mean Sea Level
- P/O Paved Over
- * Discontinued from monitoring/sampling program

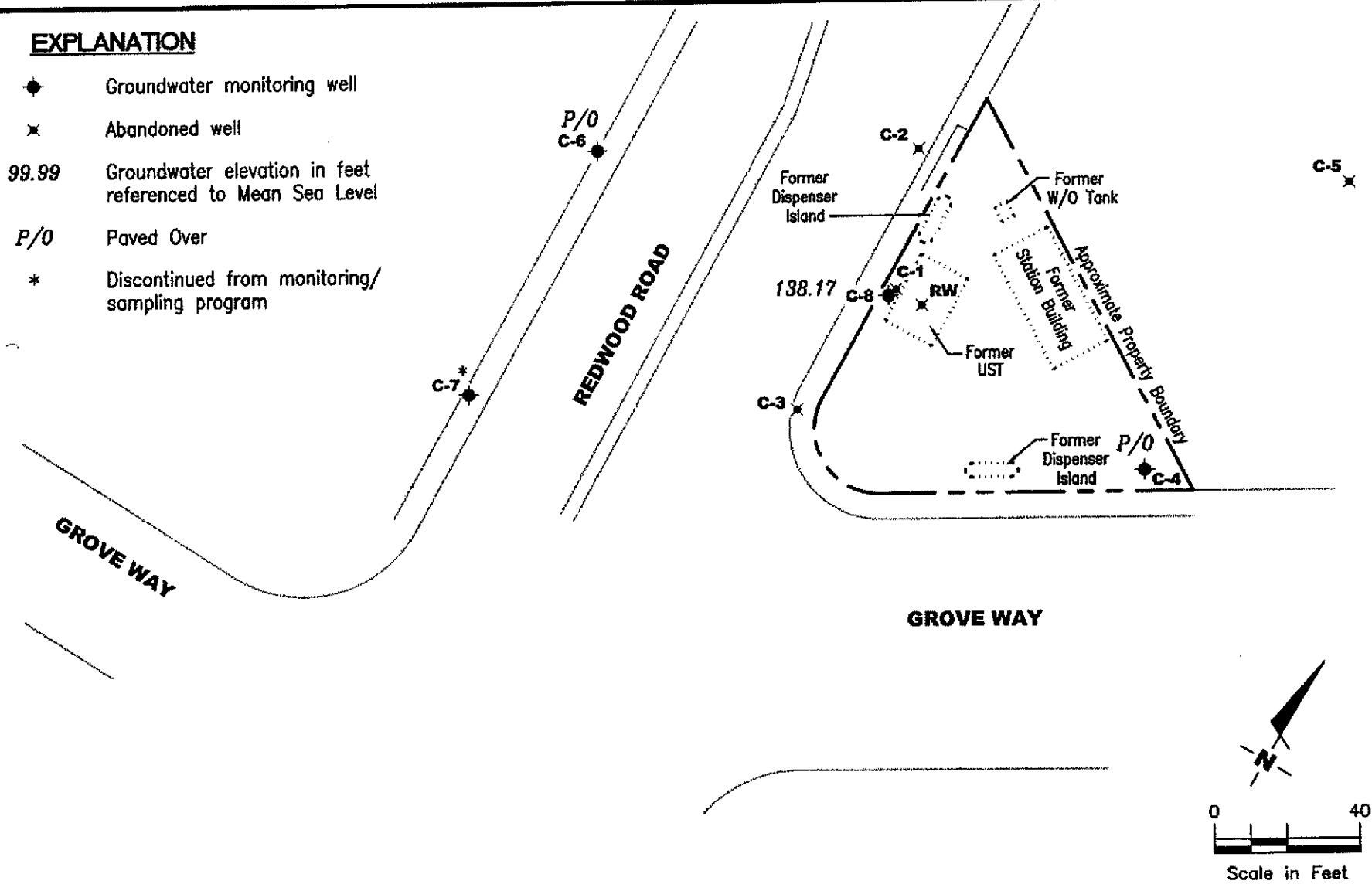

Source: Figure modified from drawing provided by RRM engineering contracting firm.

GETTLER - RYAN INC.
 6747 Sierra Court, Suite J
 Dublin, CA 94568 (925) 551-7555

GROUNDWATER ELEVATION MAP
 Former Chevron Service Station #9-2960
 2416 Grove Way
 Castro Valley, California

FIGURE

1

PROJECT NUMBER
 386365

REVIEWED BY

DATE
 June 21, 2006

REVISED DATE

Table 1
Groundwater Monitoring Data and Analytical Results
 Former Chevron Service Station #9-2960
 2416 Grove Way
 Castro Valley, California

WELL ID/ DATE	TOC* (ft.)	GWE (mst)	DTW (ft.)	SPHT (ft.)	SPH REMOVED (gallons)	TPH-G (ppb)	B (ppb)	T (ppb)	E (ppb)	X (ppb)	MTBE (ppb)
C-8											
03/26/02 ²	153.41	137.96	15.45	0.00	0.00	11,000	380	130	120	530	<25/<2 ¹
06/17/02	153.41	137.03	16.38	0.00	0.00	11,000	490	65	170	470	<20/<2 ¹
09/17/02	153.41	136.71	16.70	0.00	0.00	6,800	410	12	70	130	46/<2 ¹
12/02/02	153.41	136.61	16.80	0.00	0.00	7,200	440	14	75	140	<20/<2 ¹
03/03/03	153.41	137.61	15.80	0.00	0.00	7,000	330	16	62	110	<10/<0.5 ¹
06/16/03 ³	153.41	137.52	15.89	0.00	0.00	7,400	400	17	71	120	<0.5
09/15/03 ⁴	153.41	136.87	16.54	0.00	0.00	2,500	200	5	56	16	<0.5
12/15/03 ⁴	153.41	137.07	16.34	0.00	0.00	5,900	320	18	51	140	<0.5
03/01/04 ⁴	153.41	138.55	14.86	0.00	0.00	7,800	250	14	61	55	<0.5
06/28/04 ⁴	153.41	137.05	16.36	0.00	0.00	5,700	280	11	46	53	<0.5
09/13/04 ⁴	153.41	136.39	17.02	0.00	0.00	2,200	180	5	33	8	<0.5
12/22/04 ⁴	153.41	137.29	16.12	0.00	0.00	1,700	170	4	15	5	<0.5
03/04/05 ⁴	153.41	138.63	14.78	0.00	0.00	5,400	180	8	43	30	<0.5
06/30/05 ⁴	153.41	137.97	15.44	0.00	0.00	3,900	160	6	16	19	<0.5
09/16/05 ⁴	153.41	137.21	16.20	0.00	0.00	3,500	160	6	10	18	<0.5
12/21/05 ⁴	153.41	137.31	16.10	0.00	0.00	2,300	110	4	10	18	<0.5
03/21/06 ⁴	153.41	139.03	14.38	0.00	0.00	6,200	130	6	32	36	<0.5
06/21/06 ⁴	153.41	138.17	15.24	0.00	0.00	6,100	100	11	38	120	<0.5
C-1											
10/23/86	153.36	--	--	--	--	3,100	6,400	3,700	--	4,300	--
09/10/87	153.36	--	--	--	--	120,000	25,000	60,000	13,000	56,000	--
10/03/90	153.36	134.69	18.67	--	--	--	--	--	--	--	--
10/25/90	153.36	135.22	18.71	0.71	--	--	--	--	--	--	--
01/22/91	153.36	135.22	18.70	0.70	--	--	--	--	--	--	--
02/21/91	153.36	135.44	18.62	0.88	--	--	--	--	--	--	--
04/01/91	153.36	136.47	16.91	0.03	--	--	--	--	--	--	--
04/11/91	153.36	136.49	16.90	0.04	--	--	--	--	--	--	--
07/01/91	153.36	135.75	17.61	0.00	--	--	--	--	--	--	--
09/24/91	153.36	135.17	18.98	0.99	--	--	--	--	--	--	--
10/23/91	153.36	135.03	19.32	1.24	--	--	--	--	--	--	--
11/22/91	153.36	134.53	18.83	0.97	--	--	--	--	--	--	--
01/09/92	153.36	136.10	17.26	--	--	--	--	--	--	--	--
03/06/92	153.36	137.16	16.69	0.61	--	--	--	--	--	--	--
06/04/92	153.36	136.44	17.10	0.22	--	--	--	--	--	--	--

Table 1
Groundwater Monitoring Data and Analytical Results
 Former Chevron Service Station #9-2960
 2416 Grove Way
 Castro Valley, California

WELL ID/ DATE	TOC* (ft.)	GWE (msl)	DTW (ft.)	SPHT (ft.)	SPH REMOVED (gallons)	TPH-G (ppb)	B (ppb)	T (ppb)	E (ppb)	X (ppb)	MTBE (ppb)
C-1 (cont)											
09/28/92	153.36	--	18.71	0.77	--	--	--	--	--	--	--
12/17/92	153.36	--	17.54	0.45	--	--	--	--	--	--	--
04/29/93	153.36	137.50	16.40	0.68	--	--	--	--	--	--	--
07/26/93	153.36	136.92	16.85	0.51	--	--	--	--	--	--	--
10/22/93	153.36	135.55	17.83	0.03	--	--	--	--	--	--	--
01/24/94	153.36	--	--	--	--	--	--	--	--	--	--
04/11/94	153.36	136.01	17.76	0.51	--	--	--	--	--	--	--
07/01/94	153.36	135.95	17.46	0.06	--	--	--	--	--	--	--
10/06/94	153.36	135.24	18.18	0.08	--	--	--	--	--	--	--
01/11/95	153.36	136.63	16.79	0.08	0.039	--	--	--	--	--	--
04/07/95	153.36	139.23	14.13	--	--	44,000	410	100	130	5,400	--
07/20/95	153.36	136.84	16.52	--	--	16,000	96	81	53	1,000	--
09/22/95	153.36	137.22	16.14	--	--	59,000	150	36	16	56	--
01/02/96	153.36	137.43	15.93	--	--	29,000	4,500	1,100	520	1,900	<250
04/26/96	153.36	137.31	16.05	--	--	7,200	1,300	340	130	390	--
07/22/96	153.36	143.14	10.22	--	--	7,300	2,500	170	360	520	--
10/17/96	153.36	137.64	15.72	--	--	19,000	3,400	59	360	430	--
01/23/97	153.36	138.91	14.45	--	--	15,000	2,900	390	250	480	--
07/10/97	153.36	137.19	16.17	--	--	13,000	2,100	69	200	380	--
01/15/98	153.36	INACCESSIBLE	--	--	--	--	--	--	--	--	--
01/16/98	153.36	138.63	14.73	--	--	4,700	1,200	<20	140	40	--
07/09/98	153.36	138.14	15.22	--	--	9,900	1,500	60	150	170	--
ABANDONED											
C-2											
10/23/86	151.84	--	--	--	--	30,000	2,700	1,900	--	1,500	--
09/10/87	151.84	--	--	--	--	14,000	2,600	2,900	500	1,200	--
10/16/89	151.84	--	--	--	--	600	260	34	1.7	41	--
01/04/90	151.84	--	--	--	--	2,600	470	150	23	130	--
04/05/90	151.84	--	--	--	--	500	280	29	6.3	19	--
07/02/90	151.84	--	--	--	--	2,400	670	110	17	76	--
10/03/90	151.84	--	--	--	--	--	--	--	--	--	--
10/25/90	151.84	135.24	16.60	--	--	1,300	390	47	9.0	58	--
01/22/91	151.84	135.15	16.69	--	--	2,600	680	88	29	130	--
02/21/91	151.84	135.53	16.31	--	--	--	--	--	--	--	--
04/01/91	151.84	136.76	15.08	--	--	--	--	--	--	--	--
04/11/91	151.84	136.61	15.23	--	--	--	--	--	--	--	--

Table 1
Groundwater Monitoring Data and Analytical Results
 Former Chevron Service Station #9-2960
 2416 Grove Way
 Castro Valley, California

WELL ID/ DATE	TOC* (%)	GWE (msl)	DTW (ft.)	SPHT (ft.)	SPH REMOVED (gallons)	TPH-G (ppb)	B (ppb)	T (ppb)	E (ppb)	X (ppb)	MTBE (ppb)
C-2 (cont)											
07/01/91	151.84	135.88	15.96	--	--	--	--	--	--	--	--
09/24/91	151.84	135.33	16.51	--	--	3,600	1,400	63	6.9	63	--
10/23/91	151.84	135.18	16.66	--	--	--	--	--	--	--	--
11/22/91	151.84	135.47	16.37	--	--	--	--	--	--	--	--
01/09/92	151.84	136.28	15.56	--	--	7,100	770	740	190	690	--
03/06/92	151.84	137.47	14.37	--	--	3,200	250	230	59	220	--
06/04/92	151.84	136.80	15.04	--	--	1,500	<0.5	180	42	130	--
09/28/92	151.84	135.44	16.40	--	--	6,400	940	230	57	220	--
12/17/92	151.84	136.46	15.38	--	--	1,500	370	160	6.0	25	--
04/29/93	151.84	136.87	14.97	--	--	1,800	690	120	74	140	--
07/29/93	151.84	136.92	14.92	--	--	4,300	1,500	96	29	96	--
10/22/93	151.84	136.03	15.81	--	--	820	560	57	15	58	--
01/24/94	151.84	--	--	--	--	--	--	--	--	--	--
04/11/94	151.84	136.49	15.35	--	--	2,000	240	48	36	110	--
07/01/94	151.84	136.44	15.40	--	--	370	55	12	3.1	8.6	--
10/06/94	151.84	135.84	16.00	--	--	150	47	4.8	1.8	5.4	--
01/11/95	151.84	137.06	14.78	--	--	52	0.65	<0.5	<0.5	<0.5	--
04/07/95	151.84	138.93	12.91	--	--	1,500	260	64	52	85	--
07/20/95	151.84	136.81	15.03	--	--	3,000	500	100	96	110	--
09/22/95	151.84	137.05	14.79	--	--	2,000	630	120	20	79	--
01/02/96	151.84	137.37	14.47	--	--	1,900	240	110	58	180	<12
04/26/96	151.84	137.97	13.87	--	--	1,300	340	190	44	120	--
07/22/96	151.84	136.73	15.11	--	--	3,700	1,100	140	150	330	--
10/17/96	151.84	136.80	15.04	--	--	22,000	3,900	1,600	350	1,800	--
01/23/97	151.84	138.86	12.98	--	--	2,000	260	48	76	94	--
07/10/97	151.84	137.21	14.63	--	--	5,100	710	200	190	380	--
01/15/98	153.36	INACCESSIBLE	--	--	--	--	--	--	--	--	--
01/16/98	151.84	138.61	13.23	--	--	7,600	1,600	130	320	650	--
07/09/98	151.84	138.17	13.67	--	--	10,000	1,100	410	180	410	--
ABANDONED											
C-3											
10/23/86	154.13	--	--	--	--	3,300	49	24	--	20	--
09/10/87	154.13	--	--	--	--	200	110	2.6	<2.0	<2.0	--
10/16/89	154.13	--	--	--	--	900	640	4.2	1.6	16	--
01/04/90	154.13	--	--	--	--	920	430	7.0	6.0	7.0	--
04/05/90	154.13	--	--	--	--	930	690	3.4	5.1	4.8	--

Table 1
Groundwater Monitoring Data and Analytical Results
 Former Chevron Service Station #9-2960
 2416 Grove Way
 Castro Valley, California

WELL ID/ DATE	TOC* (%)	GWE (msl)	DTW (ft.)	SPHT (ft.)	SPH REMOVED (gallons)	TPH-G (ppb)	B (ppb)	T (ppb)	E (ppb)	X (ppb)	MTBE (ppb)
C-3 (cont)											
07/02/90	154.13	--	--	--	--	1,700	590	11	4.8	9.4	--
10/03/90	154.13	134.97	19.16	--	--	--	--	--	--	--	--
10/25/90	154.13	134.85	19.28	--	--	750	510	2.0	6.0	5.0	--
01/22/91	154.13	134.95	19.18	--	--	430	260	2.0	2.0	5.0	--
01/22/91	154.13	134.95	19.18	--	--	400	250	2.0	2.0	5.0	--
02/21/91	154.13	135.25	18.88	--	--	--	--	--	--	--	--
04/01/91	154.13	136.54	17.59	--	--	--	--	--	--	--	--
04/11/91	154.13	136.32	17.81	--	--	--	--	--	--	--	--
07/01/91	154.13	135.57	18.56	--	--	--	--	--	--	--	--
09/24/91	154.13	135.01	19.12	--	--	260	52	0.7	0.8	2.2	--
10/23/91	154.13	134.89	19.24	--	--	--	--	--	--	--	--
11/22/91	154.13	135.10	19.03	--	--	--	--	--	--	--	--
01/09/92	154.13	135.90	18.23	--	--	240	120	0.9	<0.5	1.6	--
03/06/92	154.13	137.09	17.04	--	--	230	68	1.2	1.2	1.3	--
06/04/92	154.13	136.34	17.79	--	--	80	36	0.6	0.5	0.7	--
09/28/92	154.13	135.13	19.00	--	--	84	49	<0.5	<0.5	1.5	--
12/17/92	154.13	135.95	18.18	--	--	220	30	<0.5	<0.5	<0.5	--
04/29/93	154.13	135.35	18.78	--	--	380	12	0.6	<0.5	<1.5	--
07/26/93	154.13	136.41	17.72	--	--	800	38	1.1	<0.5	<1.5	--
10/22/93	154.13	135.63	18.50	--	--	200	64	0.6	<0.5	<1.5	--
01/24/94	154.13	135.62	18.51	--	--	<50	<0.5	<0.5	<0.5	<0.5	--
04/11/94	154.13	136.09	18.04	--	--	100	3.6	2.1	<0.5	2.3	--
07/01/94	154.13	136.01	18.12	--	--	140	3.7	1.2	<0.5	1.0	--
10/06/94	154.13	135.50	18.63	--	--	<50	<0.5	<0.5	<0.5	<0.5	--
01/11/95	154.13	137.01	17.12	--	--	<50	<0.5	<0.5	<0.5	<0.5	--
04/07/95	154.13	138.34	15.79	--	--	<50	<0.5	<0.5	<0.5	<0.5	--
07/20/95	154.13	136.37	17.76	--	--	<50	1.5	1.9	<0.5	3.5	--
09/22/95	154.13	136.58	17.55	--	--	<50	<0.5	<0.5	<0.5	<0.5	--
01/02/96	154.13	136.88	17.25	--	--	<50	<0.5	<0.5	<0.5	1.1	<2.5
04/26/96	154.13	137.42	16.71	--	--	<50	<0.5	<0.5	<0.5	<0.5	--
07/22/96	154.13	136.50	17.63	--	--	<50	<0.5	<0.5	<0.5	<0.5	--
10/17/96	154.13	136.33	17.80	--	--	<50	<0.5	<0.5	<0.5	<0.5	--
01/23/97	154.13	138.33	15.80	--	--	<50	<0.5	<0.5	<0.5	<0.5	--
07/10/97	154.13	136.63	17.50	--	--	<50	<0.5	<0.5	<0.5	<0.5	--
01/15/98	154.13	137.98	16.15	--	--	<50	<0.5	<0.5	<0.5	<0.5	--
01/16/98	154.13	138.04	16.09	--	--	REGAUGE	--	--	--	--	--

Table 1
Groundwater Monitoring Data and Analytical Results
 Former Chevron Service Station #9-2960
 2416 Grove Way
 Castro Valley, California

WELL ID/ DATE	TOC* (ft.)	GWE (msf)	DTW (ft.)	SPHT (ft.)	SPH		B (ppb)	T (ppb)	E (ppb)	X (ppb)	M/TBE (ppb)
					REMOVED (gallons)	TPH-G (ppb)					
C-3 (cont)											
07/09/98	154.13	137.57	16.56	--	--	<50	<0.5	<0.5	<0.5	<0.5	--
ABANDONED											
C-4											
10/23/86	156.00	--	--	--	--	570	3.0	4.0	--	5.0	--
09/10/87	156.00	--	--	--	--	500	3.0	<0.5	<0.5	<0.5	--
10/16/89	156.00	--	--	--	--	<500	12	1.0	<0.5	0.8	--
01/04/90	156.00	--	--	--	--	<500	5.0	<0.5	<0.5	0.9	--
04/05/90	156.00	--	--	--	--	<50	6.6	<0.5	<0.5	0.7	--
07/02/90	156.00	--	--	--	--	71	4.1	<0.5	<0.5	<0.5	--
10/03/90	156.00	--	--	--	--	--	--	--	--	--	--
10/25/90	156.00	135.57	20.43	--	--	<50	2.0	<0.5	<0.5	<0.5	--
01/22/91	156.00	135.50	20.50	--	--	<50	3.0	<0.5	<0.5	<0.5	--
02/21/91	156.00	135.77	20.23	--	--	--	--	--	--	--	--
04/01/91	156.00	136.97	19.03	--	--	--	--	--	--	--	--
04/11/91	156.00	136.95	19.05	--	--	--	--	--	--	--	--
07/01/91	156.00	136.10	19.90	--	--	--	--	--	--	--	--
09/24/91	156.00	135.59	20.41	--	--	87	1.6	<0.5	<0.5	<0.5	--
10/23/91	156.00	135.47	20.53	--	--	--	--	--	--	--	--
11/22/91	156.00	135.65	20.35	--	--	--	--	--	--	--	--
01/09/92	156.00	136.46	19.54	--	--	51	4.3	<0.5	<0.5	<0.5	--
01/09/92	156.00	136.46	19.54	--	--	<50	4.8	<0.5	<0.5	<0.5	--
03/06/92	156.00	137.74	18.26	--	--	<50	0.8	<0.5	<0.5	<0.5	--
06/04/92	156.00	137.08	18.92	--	--	<50	<0.5	<0.5	<0.5	0.7	--
09/28/92	156.00	135.69	20.31	--	--	<50	<0.5	<0.5	<0.5	<0.5	--
12/17/92	156.00	136.43	19.57	--	--	<50	<0.5	<0.5	<0.5	<0.5	--
04/29/93	156.00	138.22	17.78	--	--	<50	<0.5	<0.5	<0.5	<1.5	--
07/26/93	156.00	--	--	--	--	--	--	--	--	--	--
08/18/93	156.00	137.09	18.91	--	--	<50	<0.5	<0.5	<0.5	<1.5	--
10/22/93	156.00	136.61	19.39	--	--	<50	2.9	2.1	1.1	4.3	--
01/24/94	156.00	136.58	19.42	--	--	<50	<0.5	<0.5	<0.5	<0.5	--
04/11/94	156.00	136.86	19.14	--	--	<50	<0.5	0.6	<0.5	0.5	--
07/01/94	156.00	136.80	19.20	--	--	<50	<0.5	<0.5	<0.5	<0.5	--
10/06/94	156.00	136.26	19.74	--	--	<50	<0.5	<0.5	<0.5	<0.5	--
01/11/95	156.00	139.70	16.30	--	--	<50	<0.5	<0.5	<0.5	<0.5	--
04/07/95	156.00	139.49	16.51	--	--	<50	<0.5	<0.5	<0.5	<0.5	--
07/20/95	156.00	137.20	18.80	--	--	<50	<0.5	<0.5	<0.5	<0.5	--

Table 1
Groundwater Monitoring Data and Analytical Results
 Former Chevron Service Station #9-2960
 2416 Grove Way
 Castro Valley, California

WELL ID/ DATE	TOC* (%)	GWE (msl)	DTW (ft.)	SPHT (ft.)	SPH REMOVED (gallons)	TPH-G (ppb)	B (ppb)	T (ppb)	E (ppb)	X (ppb)	MTBE (ppb)
C-4 (cont)											
09/22/95	156.00	137.26	18.74	--	--	<50	<0.5	<0.5	<0.5	<0.5	--
01/02/96	156.00	137.65	18.35	--	--	<50	1.6	1.8	0.95	4.1	<2.5
04/26/96	156.00	138.43	17.57	--	--	<50	<0.5	<0.5	<0.5	<0.5	--
07/22/96	156.00	137.00	19.00	--	--	<50	<0.5	<0.5	<0.5	<0.5	--
10/17/96	156.00	136.96	19.04	--	--	<50	<0.5	<0.5	<0.5	<0.5	--
01/23/97	156.00	139.31	16.69	--	--	<50	<0.5	<0.5	<0.5	<0.5	--
07/10/97	156.00	137.46	18.54	--	--	SAMPLED ANNUALLY		--	--	--	--
01/15/98	156.00	143.92	12.08	--	--	<50	1.0	1.4	<0.5	3.5	--
01/16/98	156.00	138.84	17.16	--	--	REGAUGE		--	--	--	--
07/09/98	156.00	138.29	17.71	--	--	--	--	--	--	--	--
01/08/99	156.00	139.19	16.81	--	--	<50	<0.5	<0.5	<0.5	<0.5	--
07/09/99	156.00	UNABLE TO LOCATE		--	--	--	--	--	--	--	--
02/01/00	156.00	UNABLE TO LOCATE		--	--	--	--	--	--	--	--
08/21/00	156.00	UNABLE TO LOCATE - PAVED OVER		--	--	--	--	--	--	--	--
01/25/01	156.00	UNABLE TO LOCATE - PAVED OVER		--	--	--	--	--	--	--	--
07/10/01	156.00	UNABLE TO LOCATE - PAVED OVER		--	--	--	--	--	--	--	--
01/08/02	156.00	UNABLE TO LOCATE - PAVED OVER		--	--	--	--	--	--	--	--
03/26/02	156.00	UNABLE TO LOCATE - PAVED OVER		--	--	--	--	--	--	--	--
06/17/02	156.00	UNABLE TO LOCATE - PAVED OVER		--	--	--	--	--	--	--	--
PAVED OVER											
C-5											
10/03/90	153.38	135.60	17.78	--	--	<50	<0.5	<0.5	<0.5	<0.5	--
10/25/90	153.38	135.46	17.92	--	--	<50	<0.5	<0.5	<0.5	<0.5	--
11/09/90	153.38	135.46	17.92	--	--	<50	<0.5	<0.5	<0.5	<0.5	--
01/22/91	153.38	135.58	17.80	--	--	<50	<0.5	<0.5	<0.5	<0.5	--
02/21/91	153.38	135.87	17.51	--	--	--	--	--	--	--	--
04/01/91	153.38	137.07	16.31	--	--	--	--	--	--	--	--
04/11/91	153.38	137.02	16.36	--	--	--	--	--	--	--	--
07/01/91	153.38	136.26	17.12	--	--	--	--	--	--	--	--
09/24/91	153.38	135.68	17.70	--	--	<50	<0.5	<0.5	<0.5	<0.5	--
09/24/91	153.38	135.68	17.70	--	--	<50	<0.5	<0.5	<0.5	<0.5	--
10/23/91	153.38	135.56	17.82	--	--	--	--	--	--	--	--
11/22/91	153.38	135.77	17.61	--	--	--	--	--	--	--	--
01/09/92	153.38	136.34	17.04	--	--	<50	<0.5	0.7	<0.5	<0.5	--
03/06/92	153.38	137.62	15.76	--	--	<50	<0.5	<0.5	<0.5	<0.5	--
06/04/92	153.38	136.98	16.40	--	--	<50	<0.5	<0.5	<0.5	<0.5	--

Table 1
Groundwater Monitoring Data and Analytical Results
 Former Chevron Service Station #9-2960
 2416 Grove Way
 Castro Valley, California

WELL ID/ DATE	TOC* (ft.)	GWE (msl)	DTW (ft.)	SPHT (ft.)	SPH REMOVED (gallons)	TPH-G (ppb)	B (ppb)	T (ppb)	E (ppb)	X (ppb)	MTBE (ppb)
C-5 (cont)											
09/28/92	153.38	135.80	17.58	--	--	<50	<0.5	<0.5	<0.5	<0.5	--
12/17/92	153.38	136.56	16.82	--	--	<50	<0.5	<0.5	<0.5	<0.5	--
04/29/93	153.38	138.14	15.24	--	--	<50	<0.5	<0.5	<0.5	<1.5	--
07/26/93	153.38	137.08	16.30	--	--	<50	<0.5	<0.5	<0.5	<1.5	--
10/22/93	153.38	136.30	17.08	--	--	52	2.3	2.7	1.1	5.2	--
01/24/94	153.38	136.25	17.13	--	--	<50	<0.5	<0.5	<0.5	<0.5	--
04/11/94	153.38	136.75	16.63	--	--	<50	<0.5	0.7	<0.5	0.6	--
07/01/94	153.38	136.73	16.65	--	--	<50	<0.5	<0.5	<0.5	<0.5	--
10/06/94	153.38	136.16	17.22	--	--	<50	<0.5	<0.5	<0.5	<0.5	--
01/11/95	153.38	137.41	15.97	--	--	<50	<0.5	<0.5	<0.5	<0.5	--
04/07/95	153.38	139.37	14.01	--	--	<50	<0.5	<0.5	<0.5	<0.5	--
07/20/95	153.38	137.17	16.21	--	--	<50	<0.5	<0.5	<0.5	0.61	--
09/22/95	153.38	137.07	16.31	--	--	62	<0.5	<0.5	<0.5	<0.5	--
01/02/96	153.38	137.56	15.82	--	--	<50	<0.5	<0.5	<0.5	<0.5	<2.5
04/26/96	153.38	138.41	14.97	--	--	<50	<0.5	<0.5	<0.5	<0.5	--
07/22/96	153.38	137.06	16.32	--	--	<50	<0.5	<0.5	<0.5	<0.5	--
10/17/96	153.38	136.88	16.50	--	--	<50	<0.5	<0.5	<0.5	<0.5	--
01/23/97	153.38	139.18	14.20	--	--	<50	<0.5	<0.5	<0.5	<0.5	--
ABANDONED											
C-6											
10/03/90	152.84	134.70	18.14	--	--	<50	<0.5	<0.5	<0.5	<0.5	--
10/25/90	152.84	134.55	18.29	--	--	<50	<0.5	1.0	<0.5	<0.5	--
11/09/90	152.84	134.58	18.26	--	--	<50	<0.5	<0.5	<0.5	<0.5	--
01/22/91	152.84	134.69	18.15	--	--	<50	<0.5	<0.5	<0.5	<0.5	--
02/21/91	152.84	134.92	17.92	--	--	--	--	--	--	--	--
04/01/91	152.84	135.73	17.11	--	--	--	--	--	--	--	--
04/11/91	152.84	135.83	17.01	--	--	--	--	--	--	--	--
07/01/91	152.84	135.12	17.72	--	--	--	--	--	--	--	--
09/24/91	152.84	135.72	17.12	--	--	<50	<0.5	<0.5	<0.5	<0.5	--
10/23/91	152.84	134.59	18.25	--	--	--	--	--	--	--	--
11/22/91	152.84	134.79	18.05	--	--	--	--	--	--	--	--
01/09/92	152.84	135.42	17.42	--	--	<50	<0.5	<0.5	<0.5	<0.5	--
03/06/92	152.84	136.33	16.51	--	--	<50	<0.5	<0.5	<0.5	<0.5	--
06/04/92	152.84	135.83	17.01	--	--	<50	<0.5	<0.5	<0.5	<0.5	--
09/28/92	152.84	134.84	18.00	--	--	<50	<0.5	<0.5	<0.5	<0.5	--
12/17/92	152.84	135.58	17.26	--	--	<50	<0.5	<0.5	<0.5	<0.5	--

Table 1
Groundwater Monitoring Data and Analytical Results
 Former Chevron Service Station #9-2960
 2416 Grove Way
 Castro Valley, California

WELL ID/ DATE	TOC* (ft.)	GWE (msl)	DTW (ft.)	SPHT (ft.)	SPH REMOVED (gallons)	TPH-G (ppb)	B (ppb)	T (ppb)	E (ppb)	X (ppb)	MTBE (ppb)	
C-6 (cont)												
04/29/93	152.84	136.61	16.23	--	--	<50	<0.5	<0.5	<0.5	<1.5	--	
07/29/93	152.84	135.88	16.96	--	--	<50	<0.5	<0.5	<0.5	<1.5	--	
10/22/93	152.84	135.38	17.46	--	--	74	7.4	6.1	3.3	9.7	--	
01/24/94	152.84	135.38	17.46	--	--	<50	<0.5	<0.5	<0.5	<0.5	--	
04/11/94	152.84	135.64	17.20	--	--	<50	<0.5	<0.5	<0.5	<0.5	--	
07/01/94	152.84	135.66	17.18	--	--	<50	<0.5	<0.5	<0.5	<0.5	--	
10/06/94	152.84	135.19	17.65	--	--	<50	<0.5	<0.5	<0.5	<0.5	--	
01/11/95	152.84	136.18	16.66	--	--	<50	<0.5	<0.5	<0.5	<0.5	--	
04/07/95	152.84	137.25	15.59	--	--	<50	<0.5	<0.5	<0.5	<0.5	--	
07/20/95	152.84	135.80	17.04	--	--	<50	<0.5	<0.5	<0.5	<0.5	--	
09/22/95	152.84	135.74	17.10	--	--	<50	<0.5	<0.5	<0.5	<0.5	<2.5	
01/02/96	152.84	136.08	16.76	--	--	<50	<0.5	<0.5	<0.5	<0.5	--	
04/26/96	152.84	136.64	16.20	--	--	<50	<0.5	<0.5	<0.5	<0.5	--	
07/22/96	152.84	135.79	17.05	--	--	<50	<0.5	<0.5	<0.5	<0.5	--	
10/17/96	152.84	135.62	17.22	--	--	<50	<0.5	<0.5	<0.5	<0.5	--	
01/23/97	152.84	136.99	15.85	--	--	<50	<0.5	<0.5	<0.5	<0.5	--	
07/10/97	152.84	135.95	16.89	--	--	<50	<0.5	<0.5	<0.5	<0.5	--	
01/15/98	152.84	136.64	16.20	--	--	<50	<0.5	<0.5	<0.5	<0.5	--	
01/16/98	152.84	136.74	16.10	--	--	REGAUGE	--	--	--	--	--	
07/09/98	152.84	136.71	16.13	--	--	<50	<0.5	<0.5	<0.5	<0.5	--	
01/08/99	152.84	137.57	15.27	--	--	<50	<0.5	<0.5	<0.5	<0.5	<5.0	
07/09/99	152.84	136.60	16.24	--	--	<50	<0.5	<0.5	<0.5	<0.5	<5.0	
02/01/00	152.84	136.57	16.27	--	--	<50	<0.5	<0.5	<0.5	<0.5	--	
08/21/00	152.84	UNABLE TO LOCATE - PAVED OVER				--	--	--	--	--	--	--
01/25/01	152.84	UNABLE TO LOCATE - PAVED OVER				--	--	--	--	--	--	--
07/10/01	152.84	UNABLE TO LOCATE - PAVED OVER				--	--	--	--	--	--	--
01/08/02	152.84	UNABLE TO LOCATE - PAVED OVER				--	--	--	--	--	--	--
03/26/02	152.84	UNABLE TO LOCATE - PAVED OVER				--	--	--	--	--	--	--
06/17/02	152.84	UNABLE TO LOCATE - PAVED OVER				--	--	--	--	--	--	--
PAVED OVER												
C-7												
10/03/90	155.34	134.52	20.82	--	--	<50	<0.5	<0.5	<0.5	<0.5	--	
10/25/90	155.34	134.43	20.91	--	--	<50	<0.5	1.0	<0.5	<0.5	--	
11/09/90	155.34	134.40	20.94	--	--	<50	<0.5	<0.5	<0.5	<0.5	--	
01/22/91	155.34	133.84	21.50	--	--	<50	4.0	<0.5	<0.5	<0.5	--	
02/21/91	155.34	134.63	20.71	--	--	--	--	--	--	--	--	

Table 1
Historical Soil Sample Results
 Former Chevron Station 9-2960, 2416 Grove Way, Castro Valley, CA

Sample ID	Sample Depth (fbg)	Sample Date	TPHg	Benzene	Toluene	Ethylbenzene	Xylenes	MTBE
Concentrations reported in milligrams per kilogram (mg/kg) = parts per million								
	18.5	2/5/1997	580	<0.5	0.83	5.1	32	--
B7	6.5	2/8/2002	<1	<0.005	<0.005	<0.005	<0.015	<0.05
	10	2/8/2002	<1	<0.005	<0.005	<0.005	<0.015	<0.05
	15	2/8/2002	<1	<0.005	<0.005	<0.005	<0.015	<0.05
B8	6	2/8/2002	<1	<0.005	<0.005	<0.005	<0.015	<0.05
	10	2/8/2002	24	<0.005	<0.005	<0.005	66	<0.05
B9	6.5	2/8/2002	<1	<0.005	<0.005	<0.005	<0.015	<0.05
	10	2/8/2002	<1	<0.005	<0.005	<0.005	<0.015	<0.05
	15	2/8/2002	<1	<0.005	<0.005	<0.005	<0.015	<0.05
C-8	6.5	2/8/2002	<1	<0.005	<0.005	<0.005	<0.015	<0.05
	10	2/8/2002	<1	<0.005	<0.005	<0.005	<0.015	<0.05
	14.5	2/8/2002	4.3	<0.005	<0.005	<0.005	<0.015	<0.05
SB-1	10	4/13/2004	<1.0	<0.0005	<0.001	<0.001	<0.001	<0.0005*
	18	4/13/2004	3.6	<0.0005	<0.001	<0.001	<0.001	<0.0005*
	22	4/13/2004	<1.0	<0.0005	<0.001	<0.001	<0.001	<0.0005*

Abbreviations/Notes:

Total petroleum hydrocarbons as gasoline (TPHg) by N. CA LUFT Gasoline Method

Benzene, toluene, ethylbenzene and xylenes (BTEX) by EPA Method 8260B

Methyl tertiary butyl ether (MTBE) by EPA Method 8021B

*MTBE by EPA Method 8260B

fbg = feet below grade

<x = Not detected above method detection limit

CAMBRIA

Table 2

Shallow Soil Vapor Sample Results

Former Chevron Station 9-2960, 2416 Grove Way, Castro Valley, CA

Sample ID	Sample Date	Benzene	Toluene	Ethylbenzene	Xylenes
		Concentrations reported in micrograms per cubic meter = $\mu\text{g}/\text{m}^3$			
SV-1	5/18/2004	<1,100*	<1,200*	<1,400*	<1,400*
SV-2	5/18/2004	100	16	5.1	<3.6
SV-3	5/18/2004	9.7	3.6	<3.6	6.3
SV-4	5/18/2004	<2.3	4.9	<3.2	9
ESL	Residential	84	83,000	2,200	21,000
ESL	Commercial	280	230,000	7,400	58,000

Abbreviations/Notes:

Benzene, toluene, ethylbenzene and xylenes (BTEX) by Modified EPA Method TO-14A

<x = Not detected above laboratory detection limit

* indicates laboratory detection limit raised due to presence of non-target species, 2-proponal

Bold value indicates concentration exceeding residential ESL for shallow soil gas

ESL= Environmental Screening Level from SFBRWQCB, Screening for Environmental Concerns at Sites with

Contaminated Soil and Groundwater, dated July 2003. ESL values from Table E-2.

Shallow soil gas screening levels for evaluation of potential indoor-air impacts (volatile chemicals only), using the lowest residential and carcinogenic effects for residential exposure value and the lowest commercial/industrial land use value.

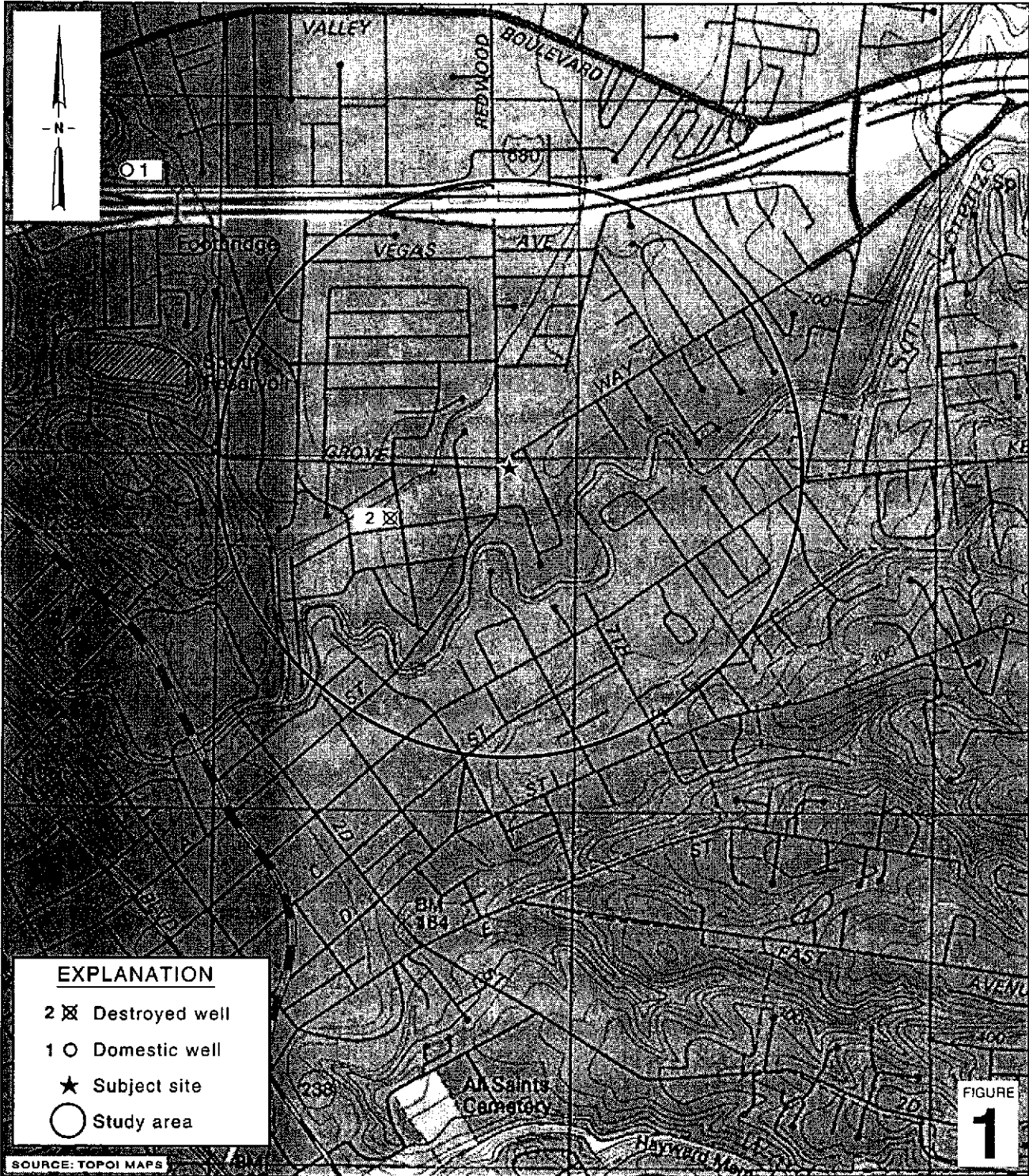

I:\9-2960 CASTRO VALLEY\FIGURES\WELL-SURVEY.AI

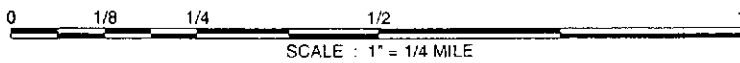

Former Chevron Station 9-2960
 2416 Grove Way
 Castro Valley, California



C A M B R I A

Area Well Survey

1/2 Mile Radius

CAMBRIA

Table 1. DWR Well Results - Former Chevron Station 9-2960, 2416 Grove Way, Castro Valley, California

ID #	Address/Location of Well	Well Owner	Use	Screened Interval (ft)	Total Well Depth (ft)	Date Installed
1	Tyee Ct.	Sam Wallace	Domestic	Unk.	52	7/4/1953
2	1783 Knox Street	Nancy Carter	Unknown	Unk.	Unk.	Unk.

Notes/Abbreviations:

Unk. = Unknown

ft. = feet

Benzene Concentration Trends (C-8)

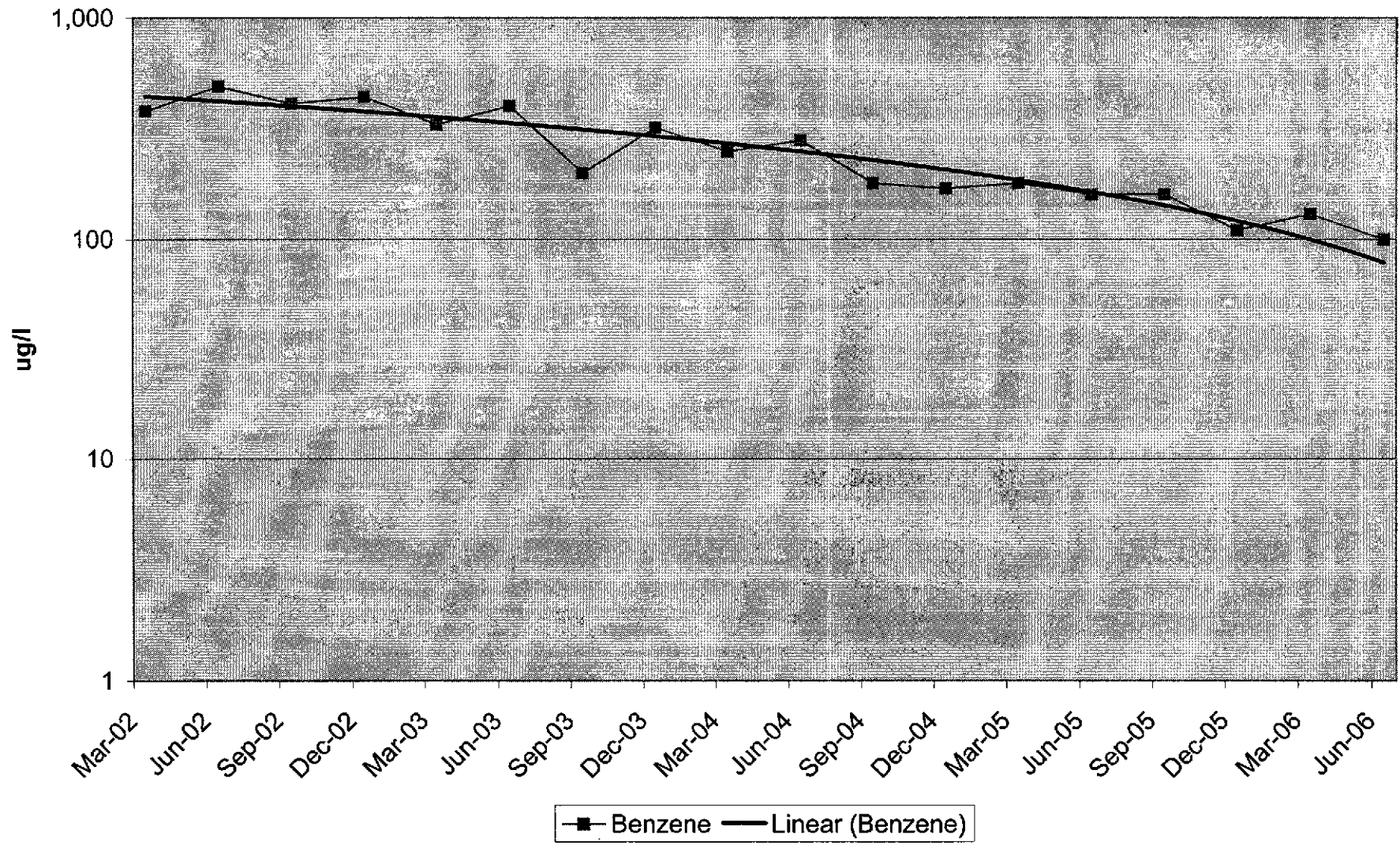

TPHg Concentration Trends (C-8)

