

PW-275



GETTLER-RYAN INC.

TRANSMITTAL

April 9, 2003
G-R #386365

TO: Mr. Robert Foss
Cambria Environmental Technology, Inc.
5900 Hollis Street, Suite A
Emeryville, CA 94608

CC: Ms. Karen Streich
Chevron Products Company
P.O. Box 6004
San Ramon, California 94583

FROM: Deanna L. Harding
Project Coordinator
Gettler-Ryan Inc.
6747 Sierra Court, Suite J
Dublin, California 94568

RE: Former Chevron Service Station
#9-2960
2416 Grove Way
Castro Valley, California

Alameda County
APR 29 2003
Environmental Health

WE HAVE ENCLOSED THE FOLLOWING:

COPIES	DATED	DESCRIPTION
1	April 3, 2003	Groundwater Monitoring and Sampling Report First Quarter - Event of March 3, 2003

COMMENTS:

Please provide any comments/changes and propose any groundwater monitoring modifications for the next event prior to **April 23, 2003**, at which time the final report will be distributed to the following:

- cc: Mr. Amir Gholami, Alameda County Health Care Services, Dept. of Environmental Health, 1131 Harbor Bay Parkway, Suite 250, Alameda, CA 94502-6577
- Mr. Phil Conley, President Board of Trustees, First Presbyterian Church, 2490 Grove Way, Castro Valley, CA 94546

Enclosures

trans/9-2960-KS



GETTLER-RYAN INC.

April 3, 2003
G-R Job #386365

Ms. Karen Streich
Chevron Products Company
P.O. Box 6004
San Ramon, CA 94583

RE: First Quarter Event of March 3, 2003
Groundwater Monitoring & Sampling Report
Former Chevron Service Station #9-2960
2416 Grove Way
Castro Valley, California

Dear Ms. Streich:

This report documents the most recent groundwater monitoring and sampling event performed by Gettler-Ryan Inc. (G-R) at the referenced site. All field work was conducted in accordance with G-R Standard Operating Procedure - Groundwater Sampling (attached).

The static groundwater level was measured and the well was checked for the presence of separate-phase hydrocarbons. Static water level data, groundwater elevations, and separate-phase hydrocarbon thickness (if any) are presented in the attached Table 1. A Groundwater Elevation Map is included as Figure 1.

Groundwater samples were collected from the monitoring well and submitted to a state certified laboratory for analyses. The field data sheets for this event are attached. Analytical results are presented in the table(s) listed below. The chain of custody document and laboratory analytical report are also attached.

Please call if you have any questions or comments regarding this report. Thank you.

Sincerely,

Deanna L. Harding
Project Coordinator

Hagop Kevork
P.E. No. C55734

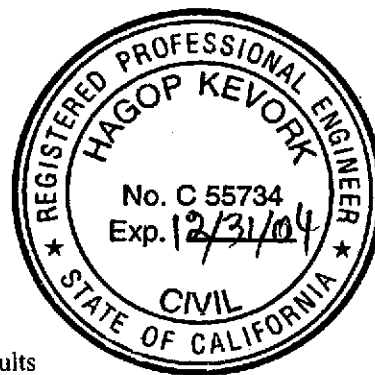
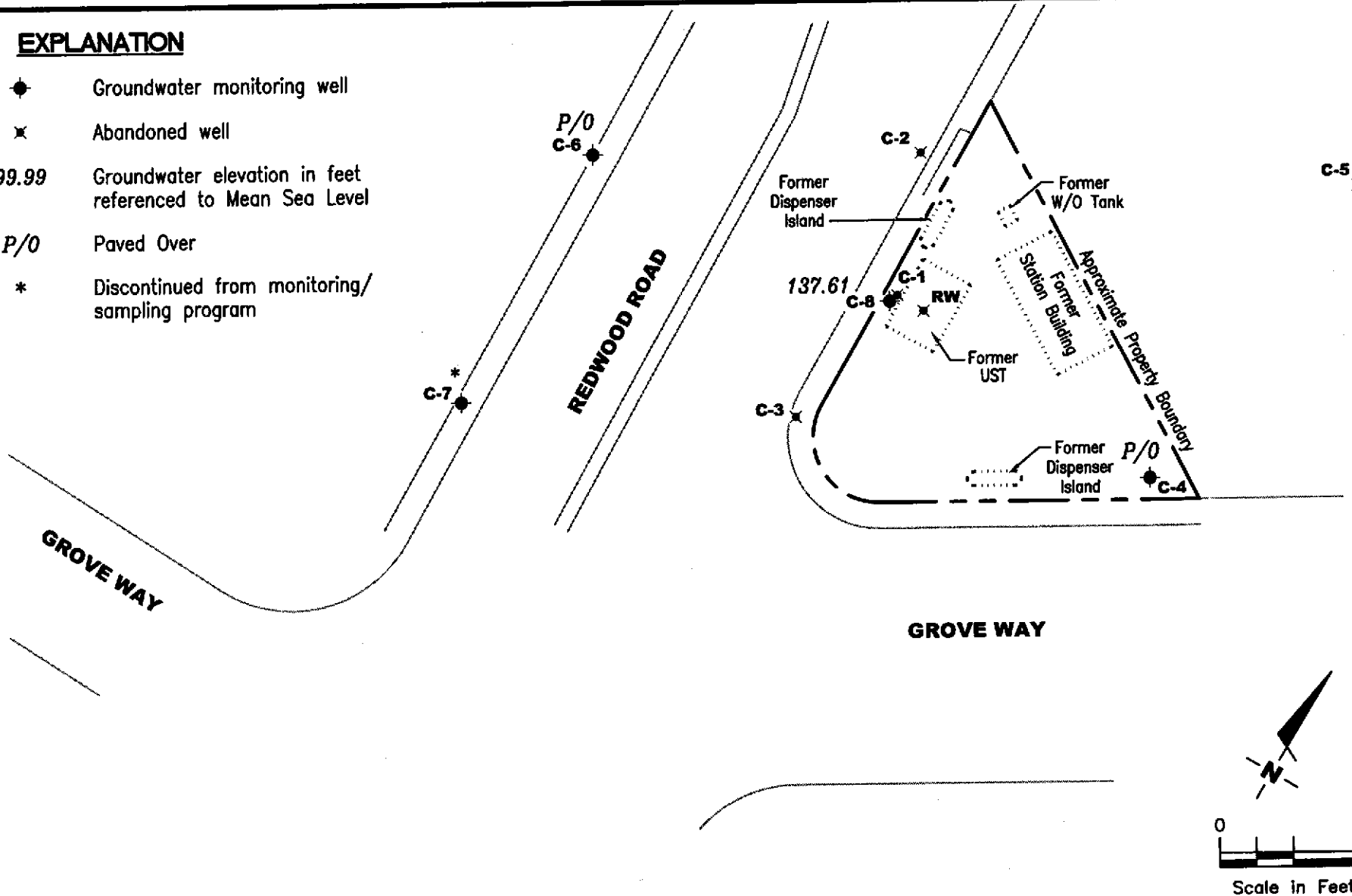

Figure 1: Groundwater Elevation Map
Table 1: Groundwater Monitoring Data and Analytical Results
Table 2: Groundwater Analytical Results - Oxygenate Compounds
Attachments: Standard Operating Procedure - Groundwater Sampling
Field Data Sheets
Chain of Custody Document and Laboratory Analytical Reports

EXPLANATION

- Groundwater monitoring well
- × Abandoned well
- 99.99 Groundwater elevation in feet referenced to Mean Sea Level
- P/O Paved Over
- * Discontinued from monitoring/sampling program



Source: Figure modified from drawing provided by RRM engineering contracting firm.

GETTLER - RYAN INC.
 6747 Sierra Ct., Suite J
 Dublin, CA 94568 (925) 551-7555

GROUNDWATER ELEVATION MAP
 Former Chevron Service Station #9-2960
 2416 Grove Way
 Castro Valley, California

FIGURE

1

PROJECT NUMBER
 386365

REVIEWED BY

DATE
 March 3, 2003

REVISED DATE

Table 1
Groundwater Monitoring Data and Analytical Results
Former Chevron Service Station #9-2960
2416 Grove Way
Castro Valley, California

WELL ID/ DATE	TOC* (ft.)	GWE (msl)	DTW (ft.)	SPHT (ft.)	SPH REMOVED (gallons)	TPH-G (ppb)	B (ppb)	T (ppb)	E (ppb)	X (ppb)	MTBE (ppb)
C-1											
10/23/86	153.36	--	--	--	--	3,100	6,400	3,700	--	4,300	--
09/10/87	153.36	--	--	--	--	120,000	25,000	60,000	13,000	56,000	--
10/03/90	153.36	134.69	18.67	--	--	--	--	--	--	--	--
10/25/90	153.36	135.22	18.71	0.71	--	--	--	--	--	--	--
01/22/91	153.36	135.22	18.70	0.70	--	--	--	--	--	--	--
02/21/91	153.36	135.44	18.62	0.88	--	--	--	--	--	--	--
04/01/91	153.36	136.47	16.91	0.03	--	--	--	--	--	--	--
04/11/91	153.36	136.49	16.90	0.04	--	--	--	--	--	--	--
07/01/91	153.36	135.75	17.61	0.00	--	--	--	--	--	--	--
09/24/91	153.36	135.17	18.98	0.99	--	--	--	--	--	--	--
10/23/91	153.36	135.03	19.32	1.24	--	--	--	--	--	--	--
11/22/91	153.36	134.53	18.83	0.97	--	--	--	--	--	--	--
01/09/92	153.36	136.10	17.26	--	--	--	--	--	--	--	--
03/06/92	153.36	137.16	16.69	0.61	--	--	--	--	--	--	--
06/04/92	153.36	136.44	17.10	0.22	--	--	--	--	--	--	--
09/28/92	153.36	--	18.71	0.77	--	--	--	--	--	--	--
12/17/92	153.36	--	17.54	0.45	--	--	--	--	--	--	--
04/29/93	153.36	137.50	16.40	0.68	--	--	--	--	--	--	--
07/26/93	153.36	136.92	16.85	0.51	--	--	--	--	--	--	--
10/22/93	153.36	135.55	17.83	0.03	--	--	--	--	--	--	--
01/24/94	153.36	--	--	--	--	--	--	--	--	--	--
04/11/94	153.36	136.01	17.76	0.51	--	--	--	--	--	--	--
07/01/94	153.36	135.95	17.46	0.06	--	--	--	--	--	--	--
10/06/94	153.36	135.24	18.18	0.08	--	--	--	--	--	--	--
01/11/95	153.36	136.63	16.79	0.08	0.039	--	--	--	--	--	--
04/07/95	153.36	139.23	14.13	--	--	44,000	410	100	130	5,400	--
07/20/95	153.36	136.84	16.52	--	--	16,000	96	81	53	1,000	--
09/22/95	153.36	137.22	16.14	--	--	59,000	150	36	16	56	--
01/02/96	153.36	137.43	15.93	--	--	29,000	4,500	1,100	520	1,900	<250
04/26/96	153.36	137.31	16.05	--	--	7,200	1,300	340	130	390	--
07/22/96	153.36	143.14	10.22	--	--	7,300	2,500	170	360	520	--
10/17/96	153.36	137.64	15.72	--	--	19,000	3,400	59	360	430	--

Table 1
Groundwater Monitoring Data and Analytical Results
Former Chevron Service Station #9-2960
2416 Grove Way
Castro Valley, California

WELL ID/ DATE	TOC* (ft.)	GWE (msl)	DTW (ft.)	SPHT (ft.)	SPH REMOVED (gallons)	TPH-G (ppb)	B (ppb)	T (ppb)	E (ppb)	X (ppb)	MTBE (ppb)
C-1 (cont)											
01/23/97	153.36	138.91	14.45	--	--	15,000	2,900	390	250	480	--
07/10/97	153.36	137.19	16.17	--	--	13,000	2,100	69	200	380	--
01/15/98	153.36	INACCESSIBLE		--	--	--	--	--	--	--	--
01/16/98	153.36	138.63	14.73	--	--	4,700	1,200	<20	140	40	--
07/09/98	153.36	138.14	15.22	--	--	9,900	1,500	60	150	170	--
ABANDONED											
C-2											
10/23/86	151.84	--	--	--	--	30,000	2,700	1,900	--	1,500	--
09/10/87	151.84	--	--	--	--	14,000	2,600	2,900	500	1,200	--
10/16/89	151.84	--	--	--	--	600	260	34	1.7	41	--
01/04/90	151.84	--	--	--	--	2,600	470	150	23	130	--
04/05/90	151.84	--	--	--	--	500	280	29	6.3	19	--
07/02/90	151.84	--	--	--	--	2,400	670	110	17	76	--
10/03/90	151.84	--	--	--	--	--	--	--	--	--	--
10/25/90	151.84	135.24	16.60	--	--	1,300	390	47	9.0	58	--
01/22/91	151.84	135.15	16.69	--	--	2,600	680	88	29	130	--
02/21/91	151.84	135.53	16.31	--	--	--	--	--	--	--	--
04/01/91	151.84	136.76	15.08	--	--	--	--	--	--	--	--
04/11/91	151.84	136.61	15.23	--	--	--	--	--	--	--	--
07/01/91	151.84	135.88	15.96	--	--	--	--	--	--	--	--
09/24/91	151.84	135.33	16.51	--	--	3,600	1,400	63	6.9	63	--
10/23/91	151.84	135.18	16.66	--	--	--	--	--	--	--	--
11/22/91	151.84	135.47	16.37	--	--	--	--	--	--	--	--
01/09/92	151.84	136.28	15.56	--	--	7,100	770	740	190	690	--
03/06/92	151.84	137.47	14.37	--	--	3,200	250	230	59	220	--
06/04/92	151.84	136.80	15.04	--	--	1,500	<0.5	180	42	130	--
09/28/92	151.84	135.44	16.40	--	--	6,400	940	230	57	220	--
12/17/92	151.84	136.46	15.38	--	--	1,500	370	160	6.0	25	--
04/29/93	151.84	136.87	14.97	--	--	1,800	690	120	74	140	--
07/29/93	151.84	136.92	14.92	--	--	4,300	1,500	96	29	96	--

Table 1
Groundwater Monitoring Data and Analytical Results
Former Chevron Service Station #9-2960
2416 Grove Way
Castro Valley, California

WELL ID/ DATE	TOC* (ft.)	GWE (msl)	DTW (ft.)	SPHT (ft.)	SPH REMOVED (gallons)	TPH-G (ppb)	B (ppb)	T (ppb)	E (ppb)	X (ppb)	MTBE (ppb)
C-2 (cont)											
10/22/93	151.84	136.03	15.81	--	--	820	560	57	15	58	--
01/24/94	151.84	--	--	--	--	--	--	--	--	--	--
04/11/94	151.84	136.49	15.35	--	--	2,000	240	48	36	110	--
07/01/94	151.84	136.44	15.40	--	--	370	55	12	3.1	8.6	--
10/06/94	151.84	135.84	16.00	--	--	150	47	4.8	1.8	5.4	--
01/11/95	151.84	137.06	14.78	--	--	52	0.65	<0.5	<0.5	<0.5	--
04/07/95	151.84	138.93	12.91	--	--	1,500	260	64	52	85	--
07/20/95	151.84	136.81	15.03	--	--	3,000	500	100	96	110	--
09/22/95	151.84	137.05	14.79	--	--	2,000	630	120	20	79	--
01/02/96	151.84	137.37	14.47	--	--	1,900	240	110	58	180	<12
04/26/96	151.84	137.97	13.87	--	--	1,300	340	190	44	120	--
07/22/96	151.84	136.73	15.11	--	--	3,700	1,100	140	150	330	--
10/17/96	151.84	136.80	15.04	--	--	22,000	3,900	1,600	350	1,800	--
01/23/97	151.84	138.86	12.98	--	--	2,000	260	48	76	94	--
07/10/97	151.84	137.21	14.63	--	--	5,100	710	200	190	380	--
01/15/98	153.36	INACCESSIBLE	--	--	--	--	--	--	--	--	--
01/16/98	151.84	138.61	13.23	--	--	7,600	1,600	130	320	650	--
07/09/98	151.84	138.17	13.67	--	--	10,000	1,100	410	180	410	--
ABANDONED											
C-3											
10/23/86	154.13	--	--	--	--	3,300	49	24	--	20	--
09/10/87	154.13	--	--	--	--	200	110	2.6	<2.0	<2.0	--
10/16/89	154.13	--	--	--	--	900	640	4.2	1.6	16	--
01/04/90	154.13	--	--	--	--	920	430	7.0	6.0	7.0	--
04/05/90	154.13	--	--	--	--	930	690	3.4	5.1	4.8	--
07/02/90	154.13	--	--	--	--	1,700	590	11	4.8	9.4	--
10/03/90	154.13	134.97	19.16	--	--	--	--	--	--	--	--
10/25/90	154.13	134.85	19.28	--	--	750	510	2.0	6.0	5.0	--
01/22/91	154.13	134.95	19.18	--	--	430	260	2.0	2.0	5.0	--
01/22/91	154.13	134.95	19.18	--	--	400	250	2.0	2.0	5.0	--

Table 1
Groundwater Monitoring Data and Analytical Results
Former Chevron Service Station #9-2960
2416 Grove Way
Castro Valley, California

WELL ID/ DATE	TOC* (ft.)	GWE (msl)	DTW (ft.)	SPHT (ft.)	SPH REMOVED (gallons)	TPH-G (ppb)	B (ppb)	T (ppb)	E (ppb)	X (ppb)	MTBE (ppb)
C-3 (cont)											
02/21/91	154.13	135.25	18.88	--	--	--	--	--	--	--	--
04/01/91	154.13	136.54	17.59	--	--	--	--	--	--	--	--
04/11/91	154.13	136.32	17.81	--	--	--	--	--	--	--	--
07/01/91	154.13	135.57	18.56	--	--	--	--	--	--	--	--
09/24/91	154.13	135.01	19.12	--	--	260	52	0.7	0.8	2.2	--
10/23/91	154.13	134.89	19.24	--	--	--	--	--	--	--	--
11/22/91	154.13	135.10	19.03	--	--	--	--	--	--	--	--
01/09/92	154.13	135.90	18.23	--	--	240	120	0.9	<0.5	1.6	--
03/06/92	154.13	137.09	17.04	--	--	230	68	1.2	1.2	1.3	--
06/04/92	154.13	136.34	17.79	--	--	80	36	0.6	0.5	0.7	--
09/28/92	154.13	135.13	19.00	--	--	84	49	<0.5	<0.5	1.5	--
12/17/92	154.13	135.95	18.18	--	--	220	30	<0.5	<0.5	<0.5	--
04/29/93	154.13	135.35	18.78	--	--	380	12	0.6	<0.5	<1.5	--
07/26/93	154.13	136.41	17.72	--	--	800	38	1.1	<0.5	<1.5	--
10/22/93	154.13	135.63	18.50	--	--	200	64	0.6	<0.5	<1.5	--
01/24/94	154.13	135.62	18.51	--	--	<50	<0.5	<0.5	<0.5	<0.5	--
04/11/94	154.13	136.09	18.04	--	--	100	3.6	2.1	<0.5	2.3	--
07/01/94	154.13	136.01	18.12	--	--	140	3.7	1.2	<0.5	1.0	--
10/06/94	154.13	135.50	18.63	--	--	<50	<0.5	<0.5	<0.5	<0.5	--
01/11/95	154.13	137.01	17.12	--	--	<50	<0.5	<0.5	<0.5	<0.5	--
04/07/95	154.13	138.34	15.79	--	--	<50	<0.5	<0.5	<0.5	<0.5	--
07/20/95	154.13	136.37	17.76	--	--	<50	1.5	1.9	<0.5	3.5	--
09/22/95	154.13	136.58	17.55	--	--	<50	<0.5	<0.5	<0.5	<0.5	--
01/02/96	154.13	136.88	17.25	--	--	<50	<0.5	<0.5	<0.5	1.1	<2.5
04/26/96	154.13	137.42	16.71	--	--	<50	<0.5	<0.5	<0.5	<0.5	--
07/22/96	154.13	136.50	17.63	--	--	<50	<0.5	<0.5	<0.5	<0.5	--
10/17/96	154.13	136.33	17.80	--	--	<50	<0.5	<0.5	<0.5	<0.5	--
01/23/97	154.13	138.33	15.80	--	--	<50	<0.5	<0.5	<0.5	<0.5	--
07/10/97	154.13	136.63	17.50	--	--	<50	<0.5	<0.5	<0.5	<0.5	--
01/15/98	154.13	137.98	16.15	--	--	<50	<0.5	<0.5	<0.5	<0.5	--

Table 1
Groundwater Monitoring Data and Analytical Results
Former Chevron Service Station #9-2960
2416 Grove Way
Castro Valley, California

WELL ID/ DATE	TOC* (ft.)	GWE (msl)	DTW (ft.)	SPHT (ft.)	SPH REMOVED (gallons)	TPH-G (ppb)	B (ppb)	T (ppb)	E (ppb)	X (ppb)	MTBE (ppb)
C-3 (cont)											
01/16/98	154.13	138.04	16.09	--	--	REGAUGE	--	--	--	--	--
07/09/98	154.13	137.57	16.56	--	--	<50	<0.5	<0.5	<0.5	<0.5	--
ABANDONED											
C-4											
10/23/86	156.00	--	--	--	--	570	3.0	4.0	--	5.0	--
09/10/87	156.00	--	--	--	--	500	3.0	<0.5	<0.5	<0.5	--
10/16/89	156.00	--	--	--	--	<500	12	1.0	<0.5	0.8	--
01/04/90	156.00	--	--	--	--	<500	5.0	<0.5	<0.5	0.9	--
04/05/90	156.00	--	--	--	--	<50	6.6	<0.5	<0.5	0.7	--
07/02/90	156.00	--	--	--	--	71	4.1	<0.5	<0.5	<0.5	--
10/03/90	156.00	--	--	--	--	--	--	--	--	--	--
10/25/90	156.00	135.57	20.43	--	--	<50	2.0	<0.5	<0.5	<0.5	--
01/22/91	156.00	135.50	20.50	--	--	<50	3.0	<0.5	<0.5	<0.5	--
02/21/91	156.00	135.77	20.23	--	--	--	--	--	--	--	--
04/01/91	156.00	136.97	19.03	--	--	--	--	--	--	--	--
04/11/91	156.00	136.95	19.05	--	--	--	--	--	--	--	--
07/01/91	156.00	136.10	19.90	--	--	--	--	--	--	--	--
09/24/91	156.00	135.59	20.41	--	--	87	1.6	<0.5	<0.5	<0.5	--
10/23/91	156.00	135.47	20.53	--	--	--	--	--	--	--	--
11/22/91	156.00	135.65	20.35	--	--	--	--	--	--	--	--
01/09/92	156.00	136.46	19.54	--	--	51	4.3	<0.5	<0.5	<0.5	--
01/09/92	156.00	136.46	19.54	--	--	<50	4.8	<0.5	<0.5	<0.5	--
03/06/92	156.00	137.74	18.26	--	--	<50	0.8	<0.5	<0.5	<0.5	--
06/04/92	156.00	137.08	18.92	--	--	<50	<0.5	<0.5	<0.5	<0.5	--
09/28/92	156.00	135.69	20.31	--	--	<50	<0.5	<0.5	<0.5	<0.5	--
12/17/92	156.00	136.43	19.57	--	--	<50	<0.5	<0.5	<0.5	<0.5	--
04/29/93	156.00	138.22	17.78	--	--	<50	<0.5	<0.5	<0.5	<1.5	--
07/26/93	156.00	--	--	--	--	--	--	--	--	--	--
08/18/93	156.00	137.09	18.91	--	--	<50	<0.5	<0.5	<0.5	<1.5	--
10/22/93	156.00	136.61	19.39	--	--	<50	2.9	2.1	1.1	4.3	--

Table 1
Groundwater Monitoring Data and Analytical Results
Former Chevron Service Station #9-2960
2416 Grove Way
Castro Valley, California

WELL ID/ DATE	TOC* (ft.)	GWE (msl)	DTW (ft.)	SPHT (ft.)	SPH REMOVED (gallons)	TPH-G (ppb)	B (ppb)	T (ppb)	E (ppb)	X (ppb)	MTBE (ppb)
C-4 (cont)											
01/24/94	156.00	136.58	19.42	--	--	<50	<0.5	<0.5	<0.5	<0.5	--
04/11/94	156.00	136.86	19.14	--	--	<50	<0.5	0.6	<0.5	0.5	--
07/01/94	156.00	136.80	19.20	--	--	<50	<0.5	<0.5	<0.5	<0.5	--
10/06/94	156.00	136.26	19.74	--	--	<50	<0.5	<0.5	<0.5	<0.5	--
01/11/95	156.00	139.70	16.30	--	--	<50	<0.5	<0.5	<0.5	<0.5	--
04/07/95	156.00	139.49	16.51	--	--	<50	<0.5	<0.5	<0.5	<0.5	--
07/20/95	156.00	137.20	18.80	--	--	<50	<0.5	<0.5	<0.5	<0.5	--
09/22/95	156.00	137.26	18.74	--	--	<50	<0.5	<0.5	<0.5	<0.5	--
01/02/96	156.00	137.65	18.35	--	--	<50	1.6	1.8	0.95	4.1	<2.5
04/26/96	156.00	138.43	17.57	--	--	<50	<0.5	<0.5	<0.5	<0.5	--
07/22/96	156.00	137.00	19.00	--	--	<50	<0.5	<0.5	<0.5	<0.5	--
10/17/96	156.00	136.96	19.04	--	--	<50	<0.5	<0.5	<0.5	<0.5	--
01/23/97	156.00	139.31	16.69	--	--	<50	<0.5	<0.5	<0.5	<0.5	--
07/10/97	156.00	137.46	18.54	--	--	SAMPLED ANNUALLY		--	--	--	--
01/15/98	156.00	143.92	12.08	--	--	<50	1.0	1.4	<0.5	3.5	--
01/16/98	156.00	138.84	17.16	--	--	REGAUGE		--	--	--	--
07/09/98	156.00	138.29	17.71	--	--	--	--	--	--	--	--
01/08/99	156.00	139.19	16.81	--	--	<50	<0.5	<0.5	<0.5	<0.5	--
07/09/99	156.00	UNABLE TO LOCATE		--	--	--	--	--	--	--	--
02/01/00	156.00	UNABLE TO LOCATE		--	--	--	--	--	--	--	--
08/21/00	156.00	UNABLE TO LOCATE - PAVED OVER		--	--	--	--	--	--	--	--
01/25/01	156.00	UNABLE TO LOCATE - PAVED OVER		--	--	--	--	--	--	--	--
07/10/01	156.00	UNABLE TO LOCATE - PAVED OVER		--	--	--	--	--	--	--	--
01/08/02	156.00	UNABLE TO LOCATE - PAVED OVER		--	--	--	--	--	--	--	--
03/26/02	156.00	UNABLE TO LOCATE - PAVED OVER		--	--	--	--	--	--	--	--
06/17/02	156.00	UNABLE TO LOCATE - PAVED OVER		--	--	--	--	--	--	--	--
PAVED OVER											

Table 1
Groundwater Monitoring Data and Analytical Results
Former Chevron Service Station #9-2960
2416 Grove Way
Castro Valley, California

WELL ID/ DATE	TOC* (ft.)	GWE (msl)	DTW (ft.)	SPHT (ft.)	SPH REMOVED (gallons)	TPH-G (ppb)	B (ppb)	T (ppb)	E (ppb)	X (ppb)	MTBE (ppb)
C-5											
10/03/90	153.38	135.60	17.78	--	--	<50	<0.5	<0.5	<0.5	<0.5	--
10/25/90	153.38	135.46	17.92	--	--	<50	<0.5	<0.5	<0.5	<0.5	--
11/09/90	153.38	135.46	17.92	--	--	<50	<0.5	<0.5	<0.5	<0.5	--
01/22/91	153.38	135.58	17.80	--	--	<50	<0.5	<0.5	<0.5	<0.5	--
02/21/91	153.38	135.87	17.51	--	--	--	--	--	--	--	--
04/01/91	153.38	137.07	16.31	--	--	--	--	--	--	--	--
04/11/91	153.38	137.02	16.36	--	--	--	--	--	--	--	--
07/01/91	153.38	136.26	17.12	--	--	--	--	--	--	--	--
09/24/91	153.38	135.68	17.70	--	--	<50	<0.5	<0.5	<0.5	<0.5	--
09/24/91	153.38	135.68	17.70	--	--	<50	<0.5	<0.5	<0.5	<0.5	--
10/23/91	153.38	135.56	17.82	--	--	--	--	--	--	--	--
11/22/91	153.38	135.77	17.61	--	--	--	--	--	--	--	--
01/09/92	153.38	136.34	17.04	--	--	<50	<0.5	0.7	<0.5	<0.5	--
03/06/92	153.38	137.62	15.76	--	--	<50	<0.5	<0.5	<0.5	<0.5	--
06/04/92	153.38	136.98	16.40	--	--	<50	<0.5	<0.5	<0.5	<0.5	--
09/28/92	153.38	135.80	17.58	--	--	<50	<0.5	<0.5	<0.5	<0.5	--
12/17/92	153.38	136.56	16.82	--	--	<50	<0.5	<0.5	<0.5	<1.5	--
04/29/93	153.38	138.14	15.24	--	--	<50	<0.5	<0.5	<0.5	<1.5	--
07/26/93	153.38	137.08	16.30	--	--	<50	<0.5	<0.5	<0.5	<1.5	--
10/22/93	153.38	136.30	17.08	--	--	52	2.3	2.7	1.1	5.2	--
01/24/94	153.38	136.25	17.13	--	--	<50	<0.5	<0.5	<0.5	<0.5	--
04/11/94	153.38	136.75	16.63	--	--	<50	<0.5	0.7	<0.5	0.6	--
07/01/94	153.38	136.73	16.65	--	--	<50	<0.5	<0.5	<0.5	<0.5	--
10/06/94	153.38	136.16	17.22	--	--	<50	<0.5	<0.5	<0.5	<0.5	--
01/11/95	153.38	137.41	15.97	--	--	<50	<0.5	<0.5	<0.5	<0.5	--
04/07/95	153.38	139.37	14.01	--	--	<50	<0.5	<0.5	<0.5	0.61	--
07/20/95	153.38	137.17	16.21	--	--	<50	<0.5	<0.5	<0.5	<0.5	--
09/22/95	153.38	137.07	16.31	--	--	62	<0.5	<0.5	<0.5	<0.5	<2.5
01/02/96	153.38	137.56	15.82	--	--	<50	<0.5	<0.5	<0.5	<0.5	--
04/26/96	153.38	138.41	14.97	--	--	<50	<0.5	<0.5	<0.5	<0.5	--
07/22/96	153.38	137.06	16.32	--	--	<50	<0.5	<0.5	<0.5	<0.5	--

Table 1
Groundwater Monitoring Data and Analytical Results
Former Chevron Service Station #9-2960
2416 Grove Way
Castro Valley, California

WELL ID/ DATE	TOC* (ft.)	GWE (msl)	DTW (ft.)	SPHT (ft.)	SPH REMOVED (gallons)	TPH-G (ppb)	B (ppb)	T (ppb)	E (ppb)	X (ppb)	MTBE (ppb)
C-5 (cont)											
10/17/96	153.38	136.88	16.50	--	--	<50	<0.5	<0.5	<0.5	<0.5	--
01/23/97	153.38	139.18	14.20	--	--	<50	<0.5	<0.5	<0.5	<0.5	--
ABANDONED											
C-6											
10/03/90	152.84	134.70	18.14	--	--	<50	<0.5	<0.5	<0.5	<0.5	--
10/25/90	152.84	134.55	18.29	--	--	<50	<0.5	1.0	<0.5	<0.5	--
11/09/90	152.84	134.58	18.26	--	--	<50	<0.5	<0.5	<0.5	<0.5	--
01/22/91	152.84	134.69	18.15	--	--	<50	<0.5	<0.5	<0.5	<0.5	--
02/21/91	152.84	134.92	17.92	--	--	--	--	--	--	--	--
04/01/91	152.84	135.73	17.11	--	--	--	--	--	--	--	--
04/11/91	152.84	135.83	17.01	--	--	--	--	--	--	--	--
07/01/91	152.84	135.12	17.72	--	--	--	--	--	--	--	--
09/24/91	152.84	135.72	17.12	--	--	<50	<0.5	<0.5	<0.5	<0.5	--
10/23/91	152.84	134.59	18.25	--	--	--	--	--	--	--	--
11/22/91	152.84	134.79	18.05	--	--	--	--	--	--	--	--
01/09/92	152.84	135.42	17.42	--	--	<50	<0.5	<0.5	<0.5	<0.5	--
03/06/92	152.84	136.33	16.51	--	--	<50	<0.5	<0.5	<0.5	<0.5	--
06/04/92	152.84	135.83	17.01	--	--	<50	<0.5	<0.5	<0.5	<0.5	--
09/28/92	152.84	134.84	18.00	--	--	<50	<0.5	<0.5	<0.5	<0.5	--
12/17/92	152.84	135.58	17.26	--	--	<50	<0.5	<0.5	<0.5	<0.5	--
04/29/93	152.84	136.61	16.23	--	--	<50	<0.5	<0.5	<0.5	<1.5	--
07/29/93	152.84	135.88	16.96	--	--	<50	<0.5	<0.5	<0.5	<1.5	--
10/22/93	152.84	135.38	17.46	--	--	74	7.4	6.1	3.3	9.7	--
01/24/94	152.84	135.38	17.46	--	--	<50	<0.5	<0.5	<0.5	<0.5	--
04/11/94	152.84	135.64	17.20	--	--	<50	<0.5	<0.5	<0.5	<0.5	--
07/01/94	152.84	135.66	17.18	--	--	<50	<0.5	<0.5	<0.5	<0.5	--
10/06/94	152.84	135.19	17.65	--	--	<50	<0.5	<0.5	<0.5	<0.5	--
01/11/95	152.84	136.18	16.66	--	--	<50	<0.5	<0.5	<0.5	<0.5	--
04/07/95	152.84	137.25	15.59	--	--	<50	<0.5	<0.5	<0.5	<0.5	--
07/20/95	152.84	135.80	17.04	--	--	<50	<0.5	<0.5	<0.5	<0.5	--

Table 1
Groundwater Monitoring Data and Analytical Results
Former Chevron Service Station #9-2960
2416 Grove Way
Castro Valley, California

WELL ID/ DATE	TOC* (ft.)	GWE (msl)	DTW (ft.)	SPHT (ft.)	SPH REMOVED (gallons)	TPH-G (ppb)	B (ppb)	T (ppb)	E (ppb)	X (ppb)	MTBE (ppb)
C-6 (cont)											
09/22/95	152.84	135.74	17.10	--	--	<50	<0.5	<0.5	<0.5	<0.5	--
01/02/96	152.84	136.08	16.76	--	--	<50	<0.5	<0.5	<0.5	<0.5	<2.5
04/26/96	152.84	136.64	16.20	--	--	<50	<0.5	<0.5	<0.5	<0.5	--
07/22/96	152.84	135.79	17.05	--	--	<50	<0.5	<0.5	<0.5	<0.5	--
10/17/96	152.84	135.62	17.22	--	--	<50	<0.5	<0.5	<0.5	<0.5	--
01/23/97	152.84	136.99	15.85	--	--	<50	<0.5	<0.5	<0.5	<0.5	--
07/10/97	152.84	135.95	16.89	--	--	<50	<0.5	<0.5	<0.5	<0.5	--
01/15/98	152.84	136.64	16.20	--	--	<50	<0.5	<0.5	<0.5	<0.5	--
01/16/98	152.84	136.74	16.10	--	--	REGAUGE	--	--	--	--	--
07/09/98	152.84	136.71	16.13	--	--	<50	<0.5	<0.5	<0.5	<0.5	--
01/08/99	152.84	137.57	15.27	--	--	<50	<0.5	<0.5	<0.5	<0.5	<5.0
07/09/99	152.84	136.60	16.24	--	--	<50	<0.5	<0.5	<0.5	<0.5	<5.0
02/01/00	152.84	136.57	16.27	--	--	<50	<0.5	<0.5	<0.5	<0.5	--
08/21/00	152.84	UNABLE TO LOCATE - PAVED OVER				--	--	--	--	--	--
01/25/01	152.84	UNABLE TO LOCATE - PAVED OVER				--	--	--	--	--	--
07/10/01	152.84	UNABLE TO LOCATE - PAVED OVER				--	--	--	--	--	--
01/08/02	152.84	UNABLE TO LOCATE - PAVED OVER				--	--	--	--	--	--
03/26/02	152.84	UNABLE TO LOCATE - PAVED OVER				--	--	--	--	--	--
06/17/02	152.84	UNABLE TO LOCATE - PAVED OVER				--	--	--	--	--	--
PAVED OVER											
C-7											
10/03/90	155.34	134.52	20.82	--	--	<50	<0.5	<0.5	<0.5	<0.5	--
10/25/90	155.34	134.43	20.91	--	--	<50	<0.5	1.0	<0.5	<0.5	--
11/09/90	155.34	134.40	20.94	--	--	<50	<0.5	<0.5	<0.5	<0.5	--
01/22/91	155.34	133.84	21.50	--	--	<50	4.0	<0.5	<0.5	<0.5	--
02/21/91	155.34	134.63	20.71	--	--	--	--	--	--	--	--
04/01/91	155.34	135.34	20.00	--	--	--	--	--	--	--	--
04/11/91	155.34	135.29	20.05	--	--	--	--	--	--	--	--
07/01/91	155.34	134.82	20.52	--	--	--	--	--	--	--	--
09/24/91	155.34	134.52	20.82	--	--	<50	<0.5	<0.5	<0.5	<0.5	--

Table 1
Groundwater Monitoring Data and Analytical Results
Former Chevron Service Station #9-2960
2416 Grove Way
Castro Valley, California

WELL ID/ DATE	TOC* (ft.)	GWE (msl)	DTW (ft.)	SPHT (ft.)	SPH REMOVED (gallons)	TPH-G (ppb)	B (ppb)	T (ppb)	E (ppb)	X (ppb)	MTBE (ppb)
C-7 (cont)											
10/23/91	155.34	134.43	20.91	--	--	--	--	--	--	--	--
11/22/91	155.34	134.55	20.79	--	--	--	--	--	--	--	--
01/09/92	155.34	135.18	20.16	--	--	<50	<0.5	<0.5	<0.5	0.9	--
03/06/92	155.34	135.92	19.42	--	--	<50	<0.5	<0.5	<0.5	<0.5	--
06/04/92	155.34	135.53	19.81	--	--	250	<0.5	<0.5	<0.5	<0.5	--
09/28/92	155.34	134.69	20.65	--	--	<50	<0.5	<0.5	<0.5	<0.5	--
12/17/92	155.34	135.32	20.02	--	--	<50	<0.5	<0.5	<0.5	<0.5	--
04/29/93	155.34	136.19	19.15	--	--	<50	<0.5	<0.5	<0.5	<1.5	--
07/26/93	155.34	135.57	19.77	--	--	<50	<0.5	<0.5	<0.5	<1.5	--
10/22/93	155.34	135.17	20.17	--	--	--	--	--	--	--	--
01/24/94	155.34	135.11	20.23	--	--	<50	<0.5	<0.5	<0.5	<0.5	--
04/11/94	155.34	135.39	19.95	--	--	<50	<0.5	<0.5	<0.5	<0.5	--
07/01/94	155.34	135.42	19.92	--	--	<50	<0.5	<0.5	<0.5	<0.5	--
10/06/94	155.34	135.03	20.31	--	--	<50	<0.5	<0.5	<0.5	<0.5	--
01/11/95	155.34	135.98	19.36	--	--	<50	<0.5	<0.5	<0.5	<0.5	--
04/07/95	155.34	136.84	18.50	--	--	<50	<0.5	<0.5	<0.5	<0.5	--
07/20/95	155.34	135.46	19.88	--	--	<50	<0.5	<0.5	<0.5	<0.5	--
09/22/95	155.34	135.38	19.96	--	--	<50	<0.5	<0.5	<0.5	<0.5	--
01/02/96	155.34	135.64	19.70	--	--	<50	<0.5	<0.5	<0.5	<0.5	<2.5
04/26/96	155.34	136.17	19.17	--	--	<50	<0.5	<0.5	<0.5	<0.5	--
07/22/96	155.34	135.49	19.85	--	--	<50	<0.5	<0.5	<0.5	<0.5	--
10/17/96	155.34	135.34	20.00	--	--	<50	<0.5	<0.5	<0.5	<0.5	--
01/23/97	155.34	136.44	18.90	--	--	<50	<0.5	<0.5	<0.5	<0.5	--
07/10/97	155.34	135.58	19.76	--	--	<50	<0.5	<0.5	<0.5	<0.5	--
01/15/98	155.34	136.02	19.32	--	--	<50	<0.5	<0.5	<0.5	<0.5	--
01/16/98	155.34	136.14	19.20	--	--	REGAUGE	--	--	--	--	--
07/09/98	155.34	136.02	19.32	--	--	<50	<0.5	<0.5	<0.5	<0.5	--
01/08/99	155.34	136.83	18.51	--	--	<50	<0.5	<0.5	<0.5	<0.5	--
07/09/99	155.34	136.16	19.18	--	--	<50	<0.5	<0.5	<0.5	<0.5	<5.0
02/01/00	155.34	136.21	19.13	--	--	<50	<0.5	<0.5	<0.5	<0.5	<5.0
08/21/00	155.34	136.16	19.18	0.00	0.00	<50	<0.50	<0.50	<0.50	<0.50	<2.5
01/25/01	155.34	136.09	19.25	0.00	0.00	<50.0	<0.500	<0.500	<0.500	<0.500	<2.50

Table 1
Groundwater Monitoring Data and Analytical Results
Former Chevron Service Station #9-2960
2416 Grove Way
Castro Valley, California

WELL ID/ DATE	TOC* (ft.)	GWE (msl)	DTW (ft.)	SPHT (ft.)	SPH REMOVED (gallons)	TPH-G (ppb)	B (ppb)	T (ppb)	E (ppb)	X (ppb)	MTBE (ppb)
C-7 (cont)											
07/10/01	155.34	136.17	19.17	0.00	0.00	<50	<0.50	<0.50	<0.50	<0.50	<2.5/<2.0 ¹
01/08/02	155.34	136.31	19.03	0.00	0.00	<50	<0.50	<0.50	<0.50	<1.5	<2.5
03/26/02	155.08	--	--	--	--	--	--	--	--	--	--
NOT MONITORED/SAMPLED											
C-8											
03/26/02 ²	153.41	137.96	15.45	0.00	0.00	11,000	380	130	120	530	<25/<2 ¹
06/17/02	153.41	137.03	16.38	0.00	0.00	11,000	490	65	170	470	<20/<2 ¹
09/17/02	153.41	136.71	16.70	0.00	0.00	6,800	410	12	70	130	46/<2 ¹
12/02/02	153.41	136.61	16.80	0.00	0.00	7,200	440	14	75	140	<20/<2 ¹
03/03/03	153.41	137.61	15.80	0.00	0.00	7,000	330	16	62	110	<10/<0.5 ¹
TRIP BLANK											
10/03/90	--	--	--	--	--	<50	<0.5	<0.5	<0.5	<0.5	--
10/25/90	--	--	--	--	--	<50	<0.5	<0.5	<0.5	<0.5	--
11/09/90	--	--	--	--	--	<50	<0.5	<0.5	<0.5	<0.5	--
01/22/91	--	--	--	--	--	<50	<0.5	<0.5	<0.5	<0.5	--
09/24/91	--	--	--	--	--	<50	<0.5	<0.5	<0.5	<0.5	--
01/09/92	--	--	--	--	--	<50	<0.5	<0.5	<0.5	<0.5	--
03/06/92	--	--	--	--	--	<50	<0.5	<0.5	<0.5	<0.5	--
06/04/92	--	--	--	--	--	<50	<0.5	<0.5	<0.5	<0.5	--
09/28/92	--	--	--	--	--	<50	<0.5	<0.5	<0.5	<0.5	--
12/17/92	--	--	--	--	--	<50	<0.5	<0.5	<0.5	<1.5	--
04/29/93	--	--	--	--	--	<50	<0.5	<0.5	<0.5	<1.5	--
07/26/93	--	--	--	--	--	<50	<0.5	<0.5	<0.5	<1.5	--
10/22/93	--	--	--	--	--	<50	<0.5	<0.5	<0.5	<0.5	--
01/24/94	--	--	--	--	--	<50	<0.5	<0.5	<0.5	<0.5	--
04/11/94	--	--	--	--	--	<50	<0.5	<0.5	<0.5	<0.5	--
07/01/94	--	--	--	--	--	<50	<0.5	<0.5	<0.5	<0.5	--
10/06/94	--	--	--	--	--	<50	<0.5	<0.5	<0.5	<0.5	--

Table 1
Groundwater Monitoring Data and Analytical Results
Former Chevron Service Station #9-2960
2416 Grove Way
Castro Valley, California

WELL ID/ DATE	TOC* (ft.)	GWE (msl)	DTW (ft.)	SPHT (ft.)	SPH REMOVED (gallons)	TPH-G (ppb)	B (ppb)	T (ppb)	E (ppb)	X (ppb)	MTBE (ppb)
TRIP BLANK (cont)											
01/11/95	--	--	--	--	--	<50	<0.5	<0.5	<0.5	<0.5	--
04/07/95	--	--	--	--	--	<50	<0.5	<0.5	<0.5	<0.5	--
07/20/95	--	--	--	--	--	<50	<0.5	<0.5	<0.5	<0.5	--
09/22/95	--	--	--	--	--	<50	<0.5	<0.5	<0.5	<0.5	--
01/02/96	--	--	--	--	--	<50	<0.5	<0.5	<0.5	<0.5	--
04/26/96	--	--	--	--	--	<50	<0.5	<0.5	<0.5	<0.5	--
07/22/96	--	--	--	--	--	<50	<0.5	<0.5	<0.5	<0.5	--
10/17/96	--	--	--	--	--	<50	<0.5	<0.5	<0.5	<0.5	--
01/23/97	--	--	--	--	--	<50	<0.5	<0.5	<0.5	<0.5	--
07/10/97	--	--	--	--	--	<50	<0.5	<0.5	<0.5	<0.5	--
01/15/98	--	--	--	--	--	<50	<0.5	<0.5	<0.5	<0.5	--
07/09/98	--	--	--	--	--	<50	<0.5	<0.5	<0.5	<0.5	--
01/08/99	--	--	--	--	--	<50	<0.5	<0.5	<0.5	<0.5	<5.0
02/01/00	--	--	--	--	--	<50	<0.5	<0.5	<0.5	<0.5	<2.5
08/21/00	--	--	--	--	--	<50	<0.50	<0.50	<0.50	<0.50	<2.50
01/25/01	--	--	--	--	--	<50.0	<0.500	<0.500	<0.500	<0.500	<2.50
07/10/01	--	--	--	--	--	<50	<0.50	<0.50	<0.50	<0.50	<2.5
QA											
01/08/02	--	--	--	--	--	<50	<0.50	<0.50	<0.50	<1.5	<2.5
03/26/02	--	--	--	--	--	<50	<0.50	<0.50	<0.50	<1.5	<2.5
06/17/02	--	--	--	--	--	<50	<0.50	<0.50	<0.50	<1.5	<2.5
09/17/02	--	--	--	--	--	<50	<0.50	<0.50	<0.50	<1.5	<2.5
12/02/02	--	--	--	--	--	<50	<0.50	<0.50	<0.50	<1.5	<2.5
03/03/03	--	--	--	--	--	<50	<0.50	<0.50	<0.50	<1.5	<2.5

Table 1
Groundwater Monitoring Data and Analytical Results
Former Chevron Service Station #9-2960
2416 Grove Way
Castro Valley, California

EXPLANATIONS:

Groundwater monitoring data and laboratory analytical results prior to August 21, 2000, were compiled from reports prepared by Blaine Tech Services, Inc.

TOC = Top of Casing (ft.) = Feet	TPH-G = Total Petroleum Hydrocarbons as Gasoline B = Benzene T = Toluene E = Ethylbenzene X = Xylenes	(ppb) = Parts per billion -- = Not Measured/Not Analyzed QA = Quality Assurance/Trip Blank
GWE = Groundwater Elevation (msl) = Mean sea level DTW = Depth to Water SPHT = Separate Phase Hydrocarbons Thickness	MTBE = Methyl tertiary butyl ether	

* TOC elevations were surveyed in April 2002, by Morrow Surveying. Elevations are based on Alameda County Benchmark No. 259, brass disc top of concrete guard rail & retaining wall abutment along east side "A" Street and on CL + N. 5th Street extended, (Elevation = 138.79 feet).

¹ MTBE by EPA Method 8260.

² Well development performed.

Table 2
Groundwater Analytical Results - Oxygenate Compounds
Former Chevron Service Station #9-2960
2416 Grove Way
Castro Valley, California

WELL ID	DATE	TBA (ppb)	MTBE (ppb)	DIPE (ppb)	ETBE (ppb)	TAME (ppb)
C-7	07/10/01	<20	<2.0	<2.0	<2.0	<2.0
C-8	03/26/02	<100	<2	<2	<2	<2
	06/17/02	<100	<2	<2	<2	<2
	09/17/02	<100	<2	<2	<2	<2
	12/02/02	<100	<2	<2	<2	<2
	03/03/03	<5	<0.5	<0.5	<0.5	<0.5

EXPLANATIONS:

TBA = Tertiary butyl alcohol
MTBE = Methyl tertiary butyl ether
DIPE = Di-isopropyl ether
ETBE = Ethyl tertiary butyl ether
TAME = Tertiary amyl methyl ether
(ppb) = Parts per billion

ANALYTICAL METHOD:

EPA Method 8260 for Oxygenate Compounds

STANDARD OPERATING PROCEDURE - GROUNDWATER SAMPLING

Gettler-Ryan Inc. field personnel adhere to the following procedures for the collection and handling of groundwater samples prior to analysis by the analytical laboratory. Prior to sample collection, the type of analysis to be performed is determined. Loss prevention of volatile compounds is controlled and sample preservation for subsequent analysis is maintained.

Prior to sampling, the presence or absence of free-phase hydrocarbons is determined using an interface probe. Product thickness, if present, is measured to the nearest 0.01 foot and is noted in the field notes. In addition, all depth to water level measurements are collected with a static water level indicator and are also recorded in the field notes, prior to purging and sampling any wells.

After water levels are collected and prior to sampling, if purging is to occur, each well is purged a minimum of three well casing volumes of water using pre-cleaned pumps (stack, suction, Grundfos), or disposable bailers. Temperature, pH and electrical conductivity are measured a minimum of three times during the purging. Purging continues until these parameters stabilize.

Groundwater samples are collected using disposable bailers. The water samples are transferred from the bailer into appropriate containers. Pre-preserved containers, supplied by analytical laboratories, are used when possible. When pre-preserved containers are not available, the laboratory is instructed to preserve the sample as appropriate. Duplicate samples are collected for the laboratory to use in maintaining quality assurance/quality control standards. The samples are labeled to include the job number, sample identification, collection date and time, analysis, preservation (if any), and the sample collector's initials. The water samples are placed in a cooler, maintained at 4°C for transport to the laboratory. Once collected in the field, all samples are maintained under chain of custody until delivered to the laboratory.

The chain of custody document includes the job number, type of preservation, if any, analysis requested, sample identification, date and time collected, and the sample collector's name. The chain of custody is signed and dated (including time of transfer) by each person who receives or surrenders the samples, beginning with the field personnel and ending with the laboratory personnel.

A laboratory supplied trip blank accompanies each sampling set. For sampling sets greater than 20 samples, 5% trip blanks are included. The trip blank is analyzed for some or all of the same compounds as the groundwater samples.

As requested by Chevron Products Company, the purge water and decontamination water generated during sampling activities is transported by IWM to McKittrick Waste Management located in McKittrick, California.



GETTLER - RYAN INC.

WELL MONITORING/SAMPLING FIELD DATA SHEET

Client/Facility #: ChevronTexaco #9-2960 Job Number: 386365
 Site Address: 2416 Grove Way Event Date: 3-3-03 (inclusive)
 City: Castro Valley, CA Sampler: K. Kelly

Well ID: C-8 Date Monitored: 3-3-03 Well Condition: OK
 Well Diameter: 2 in.
 Total Depth: 24.83 ft.
 Depth to Water: 15.80 ft.
9.03 xVF 0.17 = 1.53 x3 (case volume) = Estimated Purge Volume: 4.60 gal.

Volume	3/4"= 0.02	1"= 0.04	2"= 0.17	3"= 0.38
Factor (VF)	4"= 0.66	5"= 1.02	6"= 1.50	12"= 5.80

Purge Equipment:
 Disposable Bailer
 Stainless Steel Bailer _____
 Stack Pump _____
 Suction Pump _____
 Grundfos _____
 Other: _____

Sampling Equipment:
 Disposable Bailer
 Pressure Bailer _____
 Discrete Bailer _____
 Other: _____

Time Started: _____ (2400 hrs)
 Time Bailed: _____ (2400 hrs)
 Depth to Product: _____ ft
 Depth to Water: _____ ft
 Hydrocarbon Thickness: _____ ft
 Visual Confirmation/Description: _____
 Skimmer / Absorbant Sock (circle one)
 Amt Removed from Skimmer: _____ gal
 Amt Removed from Well: _____ gal
 Product Transferred to: _____

Start Time (purge): 1133 Weather Conditions: overcast / Rain
 Sample Time/Date: 1050 13-3-03 Water Color: Grey Odor: yes
 Purging Flow Rate: _____ gpm. Sediment Description: _____
 Did well de-water? No If yes, Time: _____ Volume: _____ gal.

Time (2400 hr.)	Volume (gal.)	pH	Conductivity (umhos/cm)	Temperature (C/F)	D.O. (mg/L)	ORP (mV)
<u>1136</u>	<u>1.5</u>	<u>7.01</u>	<u>1580</u>	<u>15.8</u>	_____	_____
<u>1139</u>	<u>3.0</u>	<u>6.89</u>	<u>1578</u>	<u>17.3</u>	_____	_____
<u>1142</u>	<u>4.5</u>	<u>6.92</u>	<u>1561</u>	<u>17.6</u>	_____	_____
_____	_____	_____	_____	_____	_____	_____

LABORATORY INFORMATION

SAMPLE ID	(#) CONTAINER	REFRIG.	PRESERV. TYPE	LABORATORY	ANALYSES
<u>C-8</u>	<u>6</u> x voa vial	<u>YES</u>	<u>HCL</u>	<u>LANCASTER</u>	<u>TPH-G(8015)/BTEX+MTBE(8021)/ 5 OXYS(8260)</u>
_____	_____	_____	_____	_____	_____
_____	_____	_____	_____	_____	_____

COMMENTS: New Total Well Depth

Add/Replaced Lock: _____ Add/Replaced Plug: _____ Size: _____



ANALYTICAL RESULTS

Prepared for:

ChevronTexaco
6001 Bollinger Canyon Rd L4310

San Ramon CA 94583
925-842-8582

Prepared by:

Lancaster Laboratories
2425 New Holland Pike
Lancaster, PA 17605-2425

SAMPLE GROUP

The sample group for this submittal is 843761. Samples arrived at the laboratory on Thursday, March 06, 2003. The PO# for this group is 99011184 and the release number is STREICH.

Client Description

QA-T-030303	NA	Water
C-8-W-030303	Grab	Water

Lancaster Labs Number

4006551
4006552

1 COPY TO

Cambria C/O Gettler- Ryan

Attn: Deanna L. Harding

Questions? Contact your Client Services Representative
Teresa L Cunningham at (717) 656-2300.

Respectfully Submitted,

A handwritten signature in cursive script that reads "Victoria M. Martell".

Victoria M. Martell
Chemist





Lancaster Laboratories Sample No. WW 4006551

Collected: 03/03/2003 00:00

Account Number: 10904

Submitted: 03/06/2003 11:30

ChevronTexaco

Reported: 03/19/2003 at 17:03

6001 Bollinger Canyon Rd L4310

Discard: 04/19/2003

QA-T-030303

NA

Water

San Ramon CA 94583

Facility# 92960

Job# 386365

GRD

2416 Grove Way-Castro Val T0600100318 QA

CAT No.	Analysis Name	CAS Number	As Received Result	As Received Method Detection Limit	Units	Dilution Factor
01729	TPH-GRO - Waters					
01730	TPH-GRO - Waters	n.a.	N.D.	50.	ug/l	1
	The reported concentration of TPH-GRO does not include MTBE or other gasoline constituents eluting prior to the C6 (n-hexane) TPH-GRO range start time. A site-specific MSD sample was not submitted for the project. A LCS/LCSD was performed to demonstrate precision and accuracy at a batch level.					
02159	BTEX, MTBE					
02161	Benzene	71-43-2	N.D.	0.50	ug/l	1
02164	Toluene	108-88-3	N.D.	0.50	ug/l	1
02166	Ethylbenzene	100-41-4	N.D.	0.50	ug/l	1
02171	Total Xylenes	1330-20-7	N.D.	1.5	ug/l	1
02172	Methyl tert-Butyl Ether	1634-04-4	N.D.	2.5	ug/l	1
	A site-specific MSD sample was not submitted for the project. A LCS/LCSD was performed to demonstrate precision and accuracy at a batch level.					

State of California Lab Certification No. 2116

Laboratory Chronicle

CAT No.	Analysis Name	Method	Analysis		Analyst	Dilution Factor
			Trial#	Date and Time		
01729	TPH-GRO - Waters	N. CA LUFT Gasoline	1	03/08/2003 13:50	Melissa D Mann	1
02159	BTEX, MTBE	SW-846 8021B	1	03/08/2003 13:50	Melissa D Mann	1
01146	GC VOA Water Prep	SW-846 5030B	1	03/08/2003 13:50	Melissa D Mann	n.a.



Lancaster Laboratories, Inc.
2425 New Holland Pike
PO Box 12425
Lancaster, PA 17605-2425
717-656-2300 Fax: 717-656-2681



Lancaster Laboratories Sample No. WW 4006552

Collected: 03/03/2003 11:50 by KK

Account Number: 10904

Submitted: 03/06/2003 11:30
 Reported: 03/19/2003 at 17:03
 Discard: 04/19/2003
 C-8-W-030303

ChevronTexaco
 6001 Bollinger Canyon Rd L4310

Grab Water

San Ramon CA 94583

Facility# 92960 Job# 386365 GRD
 2416 Grove Way-Castro Val T0600100318 C-8

GWCV8

CAT No.	Analysis Name	CAS Number	As Received Result	As Received Method Detection Limit	Units	Dilution Factor
01729	TPH-GRO - Waters					
01730	TPH-GRO - Waters	n.a.	7,000.	250.	ug/l	5
The reported concentration of TPH-GRO does not include MTBE or other gasoline constituents eluting prior to the C6 (n-hexane) TPH-GRO range start time. A site-specific MSD sample was not submitted for the project. A LCS/LCSD was performed to demonstrate precision and accuracy at a batch level.						
02159	BTEX, MTBE					
02161	Benzene	71-43-2	330.	0.50	ug/l	1
02164	Toluene	108-88-3	16.	0.50	ug/l	1
02166	Ethylbenzene	100-41-4	62.	0.50	ug/l	1
02171	Total Xylenes	1330-20-7	110.	1.5	ug/l	1
02172	Methyl tert-Butyl Ether	1634-04-4	N.D.	10.	ug/l	1
A site-specific MSD sample was not submitted for the project. A LCS/LCSD was performed to demonstrate precision and accuracy at a batch level.						
Due to the presence of an interferent near its retention time, the normal reporting limit was not attained for MTBE. The presence or concentration of this compound cannot be determined due to the presence of this interferent.						
An elevated surrogate recovery was observed. The analysis was repeated and an elevated surrogate recovery was again observed indicating a significant matrix effect.						
01595	Oxygenates by 8260B					
02010	Methyl Tertiary Butyl Ether	1634-04-4	N.D.	0.5	ug/l	1
02011	di-Isopropyl ether	108-20-3	N.D.	0.5	ug/l	1
02013	Ethyl t-butyl ether	637-92-3	N.D.	0.5	ug/l	1
02014	t-Amyl methyl ether	994-05-8	N.D.	0.5	ug/l	1
02015	t-Butyl alcohol	75-65-0	N.D.	5.	ug/l	1

State of California Lab Certification No. 2116



Lancaster Laboratories, Inc.
 2425 New Holland Pike
 PO Box 12425
 Lancaster, PA 17605-2425
 717-656-2300 Fax: 717-656-2681



Lancaster Laboratories Sample No. **NW 4006552**

Collected: 03/03/2003 11:50 by **KK**

Account Number: 10904

Submitted: 03/06/2003 11:30

ChevronTexaco

Reported: 03/19/2003 at 17:03

6001 Bollinger Canyon Rd L4310

Discard: 04/19/2003

C-8-W-030303

Grab

Water

San Ramon CA 94583

Facility# 92960

Job# 386365

GRD

2416 Grove Way-Castro Val T0600100318 C-8

GWCV8

Laboratory Chronicle

CAT No.	Analysis Name	Method	Analysis		Analyst	Dilution Factor
			Trial#	Date and Time		
01729	TPH-GRO - Waters	N. CA LUFT Gasoline Method	1	03/11/2003 13:19	Melissa D Mann	5
02159	BTEX, MTBE	SW-846 8021B	1	03/11/2003 02:02	Melissa D Mann	1
01595	Oxygenates by 8260B	SW-846 8260B	1	03/11/2003 14:41	Matthew E Barton	1
01146	GC VOA Water Prep	SW-846 5030B	1	03/11/2003 13:19	Melissa D Mann	n.a.
01163	GC/MS VOA Water Prep	SW-846 5030B	1	03/11/2003 14:41	Matthew E Barton	n.a.





Quality Control Summary

Client Name: ChevronTexaco
 Reported: 03/19/03 at 05:03 PM

Group Number: 843761

Laboratory Compliance Quality Control

<u>Analysis Name</u>	<u>Blank Result</u>	<u>Blank MDL</u>	<u>Report Units</u>	<u>LCS %REC</u>	<u>LCSD %REC</u>	<u>LCS/LCSD Limits</u>	<u>RPD</u>	<u>RPD Max</u>
Batch number: 03066A56A								
TPH-GRO - Waters	N.D.	50.	ug/l	107	112	70-130	5	30
Benzene	N.D.	.5	ug/l	112	108	80-118	3	30
Toluene	N.D.	.5	ug/l	118	111	82-119	6	30
Ethylbenzene	N.D.	.5	ug/l	113	107	81-119	5	30
Total Xylenes	N.D.	1.5	ug/l	114	109	82-120	5	30
Methyl tert-Butyl Ether	N.D.	2.5	ug/l	116	108	79-127	7	30
Batch number: 03069A53A								
Benzene	N.D.	.5	ug/l	95	96	80-118	1	30
Toluene	N.D.	.5	ug/l	97	96	82-119	1	30
Ethylbenzene	N.D.	.5	ug/l	97	97	81-119	0	30
Total Xylenes	N.D.	1.5	ug/l	100	100	82-120	1	30
Methyl tert-Butyl Ether	N.D.	2.5	ug/l	107	106	79-127	0	30
Batch number: 03069A53B								
TPH-GRO - Waters	N.D.	50.	ug/l	88	88	70-130	1	30
Batch number: N030701AA								
Methyl Tertiary Butyl Ether	N.D.	.5	ug/l	107		77-127		
di-Isopropyl ether	N.D.	.5	ug/l	105		74-125		
Ethyl t-butyl ether	N.D.	.5	ug/l	100		74-120		
t-Amyl methyl ether	N.D.	.5	ug/l	97		79-113		
t-Butyl alcohol	N.D.	5.	ug/l	93		53-147		

Sample Matrix Quality Control

<u>Analysis Name</u>	<u>MS %REC</u>	<u>MSD %REC</u>	<u>MS/MSD Limits</u>	<u>RPD</u>	<u>BKG MAX</u>	<u>DUP Conc</u>	<u>DUP RPD</u>	<u>Dup RPD Max</u>
Batch number: 03066A56A								
TPH-GRO - Waters	108		70-130					
Benzene	103		67-136					
Toluene	110		78-129					
Ethylbenzene	108		75-133					
Total Xylenes	108		86-132					
Methyl tert-Butyl Ether	104		66-136					
Batch number: 03069A53A								
Benzene	104		67-136					
Toluene	104		78-129					
Ethylbenzene	105		75-133					
Total Xylenes	107		86-132					
Methyl tert-Butyl Ether	104		66-136					
Batch number: 03069A53B								
TPH-GRO - Waters	102		70-130					
Batch number: N030701AA								
Methyl Tertiary Butyl Ether	106	104	69-134	1	30			
di-Isopropyl ether	105	103	75-130	2	30			
Ethyl t-butyl ether	100	99	73-123	1	30			

*- Outside of specification

- (1) The result for one or both determinations was less than five times the LOQ.
- (2) The background result was more than four times the spike added.





Quality Control Summary

Client Name: ChevronTexaco
 Reported: 03/19/03 at 05:03 PM

Group Number: 843761

Sample Matrix Quality Control

Analysis Name	MS	MSD	MS/MSD	RPD	BKG	DUP	DUP	Dup RPD
	<u>%REC</u>	<u>%REC</u>	<u>Limits</u>	<u>RPD</u>	<u>MAX</u>	<u>Conc</u>	<u>Conc</u>	<u>Max</u>
t-Amyl methyl ether	97	97	77-117	1	30			
t-Butyl alcohol	91	89	39-155	3	30			

Surrogate Quality Control

Analysis Name: BTEX, MTBE
 Batch number: 03066A56A

Trifluorotoluene-F Trifluorotoluene-P

4006551	82	106
Blank	90	109
LCS	99	110
LCSD	92	110
MS	101	107
Limits: 57-146		66-136

Analysis Name: BTEX, MTBE
 Batch number: 03069A53A

Trifluorotoluene-F Trifluorotoluene-P

4006552		334*
Blank	85	98
LCS	89	101
LCSD	89	101
MS	88	100
Limits: 57-146		66-136

Analysis Name: TPH-GRO - Waters
 Batch number: 03069A53B

Trifluorotoluene-F Trifluorotoluene-P

4006552	130	
Blank	89	102
LCS	89	101
LCSD	89	101
MS	88	100
Limits: 57-146		66-136

Analysis Name: Oxygenates by 8260B
 Batch number: N030701AA

Dibromofluoromethane 1,2-Dichloroethane-d4 Toluene-d8 4-Bromofluorobenzene

4006552	107	102	103	106
Blank	108	103	104	101
LCS	106	103	106	107
MS	107	104	106	108
MSD	108	106	106	108

*- Outside of specification

- (1) The result for one or both determinations was less than five times the LOQ.
- (2) The background result was more than four times the spike added.





Quality Control Summary

Client Name: ChevronTexaco
Reported: 03/19/03 at 05:03 PM

Group Number: 843761

Surrogate Quality Control

Limits: 81-120

82-112

85-112

83-113

*- Outside of specification

- (1) The result for one or both determinations was less than five times the LOQ.
- (2) The background result was more than four times the spike added.



Lancaster Laboratories, Inc.
2425 New Holland Pike
PO Box 12425
Lancaster, PA 17605-2425
717-656-2300 Fax: 717-656-2681