



# GETTLER-RYAN INC.

20275

## TRANSMITTAL

Alameda County

NOV 22 2002

November 6, 2002

G-R #386365

Environmental Health

TO: Mr. James Brownell  
Delta Environmental Consultants, Inc.  
3164 Gold Camp Drive, Suite 200  
Rancho Cordova, California 95670

CC: Ms. Karen Streich  
Chevron Products Company  
P.O. Box 6004  
San Ramon, California 94583

FROM: Deanna L. Harding  
Project Coordinator  
Gettler-Ryan Inc.  
6747 Sierra Court, Suite J  
Dublin, California 94568

RE: Former Chevron Service Station  
#9-2960  
2416 Grove Way  
Castro Valley, California

WE HAVE ENCLOSED THE FOLLOWING:

| COPIES | DATED            | DESCRIPTION   |
|--------|------------------|---|
| 1      | October 28, 2002 | Groundwater Monitoring and Sampling Report<br>Third Quarter - Event of September 17, 2002 |

### COMMENTS:

Please provide any comments/changes and propose any groundwater monitoring modifications for the next event prior to **November 19, 2002**, at which time the final report will be distributed to the following:

- cc: Mr. Amir Gholami, Alameda County Health Care Services, Dept. of Environmental Health, 1131 Harbor Bay Parkway, Suite 250, Alameda, CA 94502-6577
- Mr. Phil Conley, President Board of Trustees, First Presbyterian Church, 2490 Grove Way, Castro Valley, CA 94546
- Mr. Greg Gurs, Gettler-Ryan Inc., 3140 Gold Camp Drive, Suite 170, Rancho Cordova, CA 95670

Enclosures



# GETTLER - RYAN INC.

October 28, 2002  
G-R Job #386365

Ms. Karen Streich  
Chevron Products Company  
P.O. Box 6004  
San Ramon, CA 94583

**RE: Third Quarter Event of September 17, 2002**  
Groundwater Monitoring & Sampling Report  
Former Chevron Service Station #9-2960  
2416 Grove Way  
Castro Valley, California

Alameda County  
NOV 22 2002  
Environmental Health

Dear Ms. Streich:

This report documents the most recent groundwater monitoring and sampling event performed by Gettler-Ryan Inc. (G-R) at the referenced site. All field work was conducted in accordance with G-R Standard Operating Procedure - Groundwater Sampling (attached).

The static groundwater level was measured and the well was checked for the presence of separate-phase hydrocarbons. Static water level data, groundwater elevations, and separate-phase hydrocarbon thickness (if any) are presented in the attached Table 1. A Groundwater Elevation Map is included as Figure 1.

Groundwater samples were collected from the monitoring well and submitted to a state certified laboratory for analyses. The field data sheets for this event are attached. Analytical results are presented in the table(s) listed below. The chain of custody document and laboratory analytical report are also attached.

Please call if you have any questions or comments regarding this report. Thank you.

Sincerely,

Deanna L. Harding  
Project Coordinator

Douglas J. Lee  
Senior Geologist, R.G. No. 6882

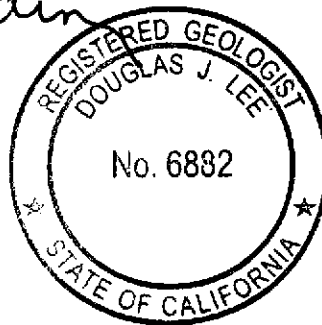
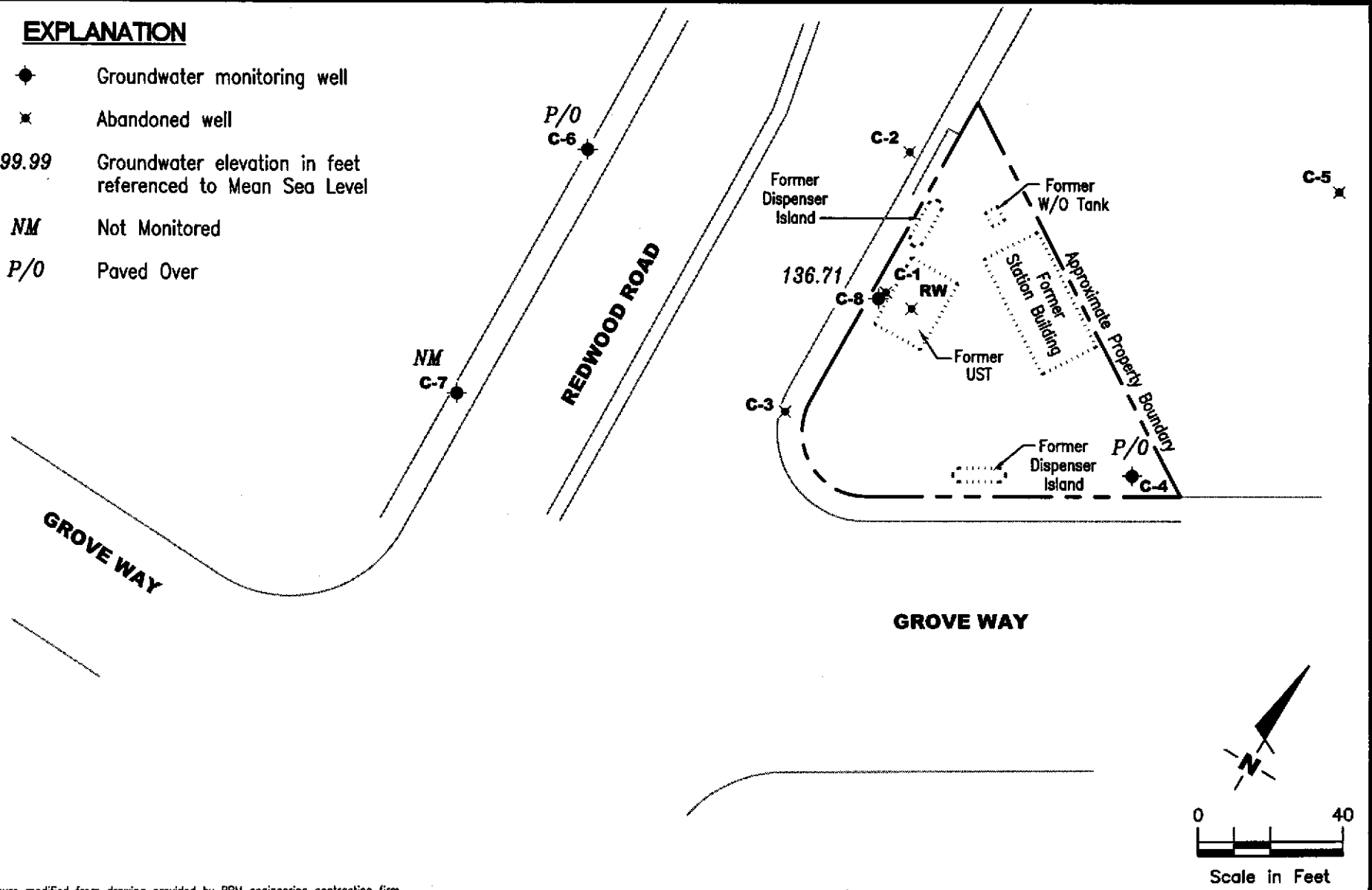

Figure 1: Groundwater Elevation Map  
Table 1: Groundwater Monitoring Data and Analytical Results  
Table 2: Groundwater Analytical Results - Oxygenate Compounds  
Attachments: Standard Operating Procedure - Groundwater Sampling  
Field Data Sheets  
Chain of Custody Document and Laboratory Analytical Reports

**EXPLANATION**

- ◆ Groundwater monitoring well
- ✖ Abandoned well
- 99.99 Groundwater elevation in feet referenced to Mean Sea Level
- NM Not Monitored
- P/O Paved Over



Source: Figure modified from drawing provided by RRM engineering contracting firm.

**GETTLER - RYAN INC.**  
 6747 Sierra Ct., Suite J  
 Dublin, CA 94568 (925) 551-7555

**GROUNDWATER ELEVATION MAP**  
 Former Chevron Service Station #9-2960  
 2416 Grove Way  
 Castro Valley, California

FIGURE

1

PROJECT NUMBER  
 386365

REVIEWED BY

DATE  
 September 17, 2002

REVISED DATE

**Table 1**  
**Groundwater Monitoring Data and Analytical Results**  
Former Chevron Service Station #9-2960  
2416 Grove Way  
Castro Valley, California

| WELL ID/<br>DATE | TOC*<br>(ft.) | GWE<br>(mst) | DTW<br>(ft.) | SPHT<br>(ft.) | SPH<br>REMOVED<br>(gallons) | TPH-G<br>(ppb) | B<br>(ppb) | T<br>(ppb) | E<br>(ppb) | X<br>(ppb) | MTBE<br>(ppb) |
|------------------|---------------|--------------|--------------|---------------|-----------------------------|----------------|------------|------------|------------|------------|---------------|
| C-1              |               |              |              |               |                             |                |            |            |            |            |               |
| 10/23/86         | 153.36        | --           | --           | --            | --                          | 3,100          | 6,400      | 3,700      | --         | 4,300      | --            |
| 09/10/87         | 153.36        | --           | --           | --            | --                          | 120,000        | 25,000     | 60,000     | 13,000     | 56,000     | --            |
| 10/03/90         | 153.36        | 134.69       | 18.67        | --            | --                          | --             | --         | --         | --         | --         | --            |
| 10/25/90         | 153.36        | 135.22       | 18.71        | 0.71          | --                          | --             | --         | --         | --         | --         | --            |
| 01/22/91         | 153.36        | 135.22       | 18.70        | 0.70          | --                          | --             | --         | --         | --         | --         | --            |
| 02/21/91         | 153.36        | 135.44       | 18.62        | 0.88          | --                          | --             | --         | --         | --         | --         | --            |
| 04/01/91         | 153.36        | 136.47       | 16.91        | 0.03          | --                          | --             | --         | --         | --         | --         | --            |
| 04/11/91         | 153.36        | 136.49       | 16.90        | 0.04          | --                          | --             | --         | --         | --         | --         | --            |
| 07/01/91         | 153.36        | 135.75       | 17.61        | 0.00          | --                          | --             | --         | --         | --         | --         | --            |
| 09/24/91         | 153.36        | 135.17       | 18.98        | 0.99          | --                          | --             | --         | --         | --         | --         | --            |
| 10/23/91         | 153.36        | 135.03       | 19.32        | 1.24          | --                          | --             | --         | --         | --         | --         | --            |
| 11/22/91         | 153.36        | 134.53       | 18.83        | 0.97          | --                          | --             | --         | --         | --         | --         | --            |
| 01/09/92         | 153.36        | 136.10       | 17.26        | --            | --                          | --             | --         | --         | --         | --         | --            |
| 03/06/92         | 153.36        | 137.16       | 16.69        | 0.61          | --                          | --             | --         | --         | --         | --         | --            |
| 06/04/92         | 153.36        | 136.44       | 17.10        | 0.22          | --                          | --             | --         | --         | --         | --         | --            |
| 09/28/92         | 153.36        | --           | 18.71        | 0.77          | --                          | --             | --         | --         | --         | --         | --            |
| 12/17/92         | 153.36        | --           | 17.54        | 0.45          | --                          | --             | --         | --         | --         | --         | --            |
| 04/29/93         | 153.36        | 137.50       | 16.40        | 0.68          | --                          | --             | --         | --         | --         | --         | --            |
| 07/26/93         | 153.36        | 136.92       | 16.85        | 0.51          | --                          | --             | --         | --         | --         | --         | --            |
| 10/22/93         | 153.36        | 135.55       | 17.83        | 0.03          | --                          | --             | --         | --         | --         | --         | --            |
| 01/24/94         | 153.36        | --           | --           | --            | --                          | --             | --         | --         | --         | --         | --            |
| 04/11/94         | 153.36        | 136.01       | 17.76        | 0.51          | --                          | --             | --         | --         | --         | --         | --            |
| 07/01/94         | 153.36        | 135.95       | 17.46        | 0.06          | --                          | --             | --         | --         | --         | --         | --            |
| 10/06/94         | 153.36        | 135.24       | 18.18        | 0.08          | --                          | --             | --         | --         | --         | --         | --            |
| 01/11/95         | 153.36        | 136.63       | 16.79        | 0.08          | 0.039                       | --             | --         | --         | --         | --         | --            |
| 04/07/95         | 153.36        | 139.23       | 14.13        | --            | --                          | 44,000         | 410        | 100        | 130        | 5,400      | --            |
| 07/20/95         | 153.36        | 136.84       | 16.52        | --            | --                          | 16,000         | 96         | 81         | 53         | 1,000      | --            |
| 09/22/95         | 153.36        | 137.22       | 16.14        | --            | --                          | 59,000         | 150        | 36         | 16         | 56         | --            |
| 01/02/96         | 153.36        | 137.43       | 15.93        | --            | --                          | 29,000         | 4,500      | 1,100      | 520        | 1,900      | <250          |
| 04/26/96         | 153.36        | 137.31       | 16.05        | --            | --                          | 7,200          | 1,300      | 340        | 130        | 390        | --            |

**Table 1**  
**Groundwater Monitoring Data and Analytical Results**  
Former Chevron Service Station #9-2960  
2416 Grove Way  
Castro Valley, California

| WELL ID/<br>DATE  | TOC*<br>(ft.) | GWE<br>(msl) | DTW<br>(ft.) | SPHT<br>(ft.) | SPH                  |                | B<br>(ppb) | T<br>(ppb) | E<br>(ppb) | X<br>(ppb) | MTBE<br>(ppb) |
|-------------------|---------------|--------------|--------------|---------------|----------------------|----------------|------------|------------|------------|------------|---------------|
|                   |               |              |              |               | REMOVED<br>(gallons) | TPH-G<br>(ppb) |            |            |            |            |               |
| <b>C-1 (cont)</b> |               |              |              |               |                      |                |            |            |            |            |               |
| 07/22/96          | 153.36        | 143.14       | 10.22        | --            | --                   | 7,300          | 2,500      | 170        | 360        | 520        | --            |
| 10/17/96          | 153.36        | 137.64       | 15.72        | --            | --                   | 19,000         | 3,400      | 59         | 360        | 430        | --            |
| 01/23/97          | 153.36        | 138.91       | 14.45        | --            | --                   | 15,000         | 2,900      | 390        | 250        | 480        | --            |
| 07/10/97          | 153.36        | 137.19       | 16.17        | --            | --                   | 13,000         | 2,100      | 69         | 200        | 380        | --            |
| 01/15/98          | 153.36        | INACCESSIBLE |              | --            | --                   | --             | --         | --         | --         | --         | --            |
| 01/16/98          | 153.36        | 138.63       | 14.73        | --            | --                   | 4,700          | 1,200      | <20        | 140        | 40         | --            |
| 07/09/98          | 153.36        | 138.14       | 15.22        | --            | --                   | 9,900          | 1,500      | 60         | 150        | 170        | --            |
| ABANDONED         |               |              |              |               |                      |                |            |            |            |            |               |
| <b>C-2</b>        |               |              |              |               |                      |                |            |            |            |            |               |
| 10/23/86          | 151.84        | --           | --           | --            | --                   | 30,000         | 2,700      | 1,900      | --         | 1,500      | --            |
| 09/10/87          | 151.84        | --           | --           | --            | --                   | 14,000         | 2,600      | 2,900      | 500        | 1,200      | --            |
| 10/16/89          | 151.84        | --           | --           | --            | --                   | 600            | 260        | 34         | 1.7        | 41         | --            |
| 01/04/90          | 151.84        | --           | --           | --            | --                   | 2,600          | 470        | 150        | 23         | 130        | --            |
| 04/05/90          | 151.84        | --           | --           | --            | --                   | 500            | 280        | 29         | 6.3        | 19         | --            |
| 07/02/90          | 151.84        | --           | --           | --            | --                   | 2,400          | 670        | 110        | 17         | 76         | --            |
| 10/03/90          | 151.84        | --           | --           | --            | --                   | --             | --         | --         | --         | --         | --            |
| 10/25/90          | 151.84        | 135.24       | 16.60        | --            | --                   | 1,300          | 390        | 47         | 9.0        | 58         | --            |
| 01/22/91          | 151.84        | 135.15       | 16.69        | --            | --                   | 2,600          | 680        | 88         | 29         | 130        | --            |
| 02/21/91          | 151.84        | 135.53       | 16.31        | --            | --                   | --             | --         | --         | --         | --         | --            |
| 04/01/91          | 151.84        | 136.76       | 15.08        | --            | --                   | --             | --         | --         | --         | --         | --            |
| 04/11/91          | 151.84        | 136.61       | 15.23        | --            | --                   | --             | --         | --         | --         | --         | --            |
| 07/01/91          | 151.84        | 135.88       | 15.96        | --            | --                   | --             | --         | --         | --         | --         | --            |
| 09/24/91          | 151.84        | 135.33       | 16.51        | --            | --                   | 3,600          | 1,400      | 63         | 6.9        | 63         | --            |
| 10/23/91          | 151.84        | 135.18       | 16.66        | --            | --                   | --             | --         | --         | --         | --         | --            |
| 11/22/91          | 151.84        | 135.47       | 16.37        | --            | --                   | --             | --         | --         | --         | --         | --            |
| 01/09/92          | 151.84        | 136.28       | 15.56        | --            | --                   | 7,100          | 770        | 740        | 190        | 690        | --            |
| 03/06/92          | 151.84        | 137.47       | 14.37        | --            | --                   | 3,200          | 250        | 230        | 59         | 220        | --            |
| 06/04/92          | 151.84        | 136.80       | 15.04        | --            | --                   | 1,500          | <0.5       | 180        | 42         | 130        | --            |

**Table 1**  
**Groundwater Monitoring Data and Analytical Results**  
Former Chevron Service Station #9-2960  
2416 Grove Way  
Castro Valley, California

| WELL ID/<br>DATE  | TOC*<br>(ft.) | GWE<br>(msl) | DTW<br>(ft.) | SPHT<br>(ft.) | SPH<br>REMOVED<br>(gallons) | TPH-G<br>(ppb) | B<br>(ppb) | T<br>(ppb) | E<br>(ppb) | X<br>(ppb) | MTBE<br>(ppb) |
|-------------------|---------------|--------------|--------------|---------------|-----------------------------|----------------|------------|------------|------------|------------|---------------|
| <b>C-2 (cont)</b> |               |              |              |               |                             |                |            |            |            |            |               |
| 09/28/92          | 151.84        | 135.44       | 16.40        | --            | --                          | 6,400          | 940        | 230        | 57         | 220        | --            |
| 12/17/92          | 151.84        | 136.46       | 15.38        | --            | --                          | 1,500          | 370        | 160        | 6.0        | 25         | --            |
| 04/29/93          | 151.84        | 136.87       | 14.97        | --            | --                          | 1,800          | 690        | 120        | 74         | 140        | --            |
| 07/29/93          | 151.84        | 136.92       | 14.92        | --            | --                          | 4,300          | 1,500      | 96         | 29         | 96         | --            |
| 10/22/93          | 151.84        | 136.03       | 15.81        | --            | --                          | 820            | 560        | 57         | 15         | 58         | --            |
| 01/24/94          | 151.84        | --           | --           | --            | --                          | --             | --         | --         | --         | --         | --            |
| 04/11/94          | 151.84        | 136.49       | 15.35        | --            | --                          | 2,000          | 240        | 48         | 36         | 110        | --            |
| 07/01/94          | 151.84        | 136.44       | 15.40        | --            | --                          | 370            | 55         | 12         | 3.1        | 8.6        | --            |
| 10/06/94          | 151.84        | 135.84       | 16.00        | --            | --                          | 150            | 47         | 4.8        | 1.8        | 5.4        | --            |
| 01/11/95          | 151.84        | 137.06       | 14.78        | --            | --                          | 52             | 0.65       | <0.5       | <0.5       | <0.5       | --            |
| 04/07/95          | 151.84        | 138.93       | 12.91        | --            | --                          | 1,500          | 260        | 64         | 52         | 85         | --            |
| 07/20/95          | 151.84        | 136.81       | 15.03        | --            | --                          | 3,000          | 500        | 100        | 96         | 110        | --            |
| 09/22/95          | 151.84        | 137.05       | 14.79        | --            | --                          | 2,000          | 630        | 120        | 20         | 79         | --            |
| 01/02/96          | 151.84        | 137.37       | 14.47        | --            | --                          | 1,900          | 240        | 110        | 58         | 180        | <12           |
| 04/26/96          | 151.84        | 137.97       | 13.87        | --            | --                          | 1,300          | 340        | 190        | 44         | 120        | --            |
| 07/22/96          | 151.84        | 136.73       | 15.11        | --            | --                          | 3,700          | 1,100      | 140        | 150        | 330        | --            |
| 10/17/96          | 151.84        | 136.80       | 15.04        | --            | --                          | 22,000         | 3,900      | 1,600      | 350        | 1,800      | --            |
| 01/23/97          | 151.84        | 138.86       | 12.98        | --            | --                          | 2,000          | 260        | 48         | 76         | 94         | --            |
| 07/10/97          | 151.84        | 137.21       | 14.63        | --            | --                          | 5,100          | 710        | 200        | 190        | 380        | --            |
| 01/15/98          | 153.36        | INACCESSIBLE |              | --            | --                          | --             | --         | --         | --         | --         | --            |
| 01/16/98          | 151.84        | 138.61       | 13.23        | --            | --                          | 7,600          | 1,600      | 130        | 320        | 650        | --            |
| 07/09/98          | 151.84        | 138.17       | 13.67        | --            | --                          | 10,000         | 1,100      | 410        | 180        | 410        | --            |
| <b>ABANDONED</b>  |               |              |              |               |                             |                |            |            |            |            |               |
| <b>C-3</b>        |               |              |              |               |                             |                |            |            |            |            |               |
| 10/23/86          | 154.13        | --           | --           | --            | --                          | 3,300          | 49         | 24         | --         | 20         | --            |
| 09/10/87          | 154.13        | --           | --           | --            | --                          | 200            | 110        | 2.6        | <2.0       | <2.0       | --            |
| 10/16/89          | 154.13        | --           | --           | --            | --                          | 900            | 640        | 4.2        | 1.6        | 16         | --            |
| 01/04/90          | 154.13        | --           | --           | --            | --                          | 920            | 430        | 7.0        | 6.0        | 7.0        | --            |

**Table 1**  
**Groundwater Monitoring Data and Analytical Results**  
Former Chevron Service Station #9-2960  
2416 Grove Way  
Castro Valley, California

| WELL ID/<br>DATE  | TOC*<br>(ft.) | GWE<br>(msl) | DTW<br>(ft.) | SPHT<br>(ft.) | SPH<br>REMOVED<br>(gallons) | TPH-G<br>(ppb) | B<br>(ppb) | T<br>(ppb) | E<br>(ppb) | X<br>(ppb) | MTBE<br>(ppb) |
|-------------------|---------------|--------------|--------------|---------------|-----------------------------|----------------|------------|------------|------------|------------|---------------|
| <b>C-3 (cont)</b> |               |              |              |               |                             |                |            |            |            |            |               |
| 04/05/90          | 154.13        | --           | --           | --            | --                          | 930            | 690        | 3.4        | 5.1        | 4.8        | --            |
| 07/02/90          | 154.13        | --           | --           | --            | --                          | 1,700          | 590        | 11         | 4.8        | 9.4        | --            |
| 10/03/90          | 154.13        | 134.97       | 19.16        | --            | --                          | --             | --         | --         | --         | --         | --            |
| 10/25/90          | 154.13        | 134.85       | 19.28        | --            | --                          | 750            | 510        | 2.0        | 6.0        | 5.0        | --            |
| 01/22/91          | 154.13        | 134.95       | 19.18        | --            | --                          | 430            | 260        | 2.0        | 2.0        | 5.0        | --            |
| 01/22/91          | 154.13        | 134.95       | 19.18        | --            | --                          | 400            | 250        | 2.0        | 2.0        | 5.0        | --            |
| 02/21/91          | 154.13        | 135.25       | 18.88        | --            | --                          | --             | --         | --         | --         | --         | --            |
| 04/01/91          | 154.13        | 136.54       | 17.59        | --            | --                          | --             | --         | --         | --         | --         | --            |
| 04/11/91          | 154.13        | 136.32       | 17.81        | --            | --                          | --             | --         | --         | --         | --         | --            |
| 07/01/91          | 154.13        | 135.57       | 18.56        | --            | --                          | --             | --         | --         | --         | --         | --            |
| 09/24/91          | 154.13        | 135.01       | 19.12        | --            | --                          | 260            | 52         | 0.7        | 0.8        | 2.2        | --            |
| 10/23/91          | 154.13        | 134.89       | 19.24        | --            | --                          | --             | --         | --         | --         | --         | --            |
| 11/22/91          | 154.13        | 135.10       | 19.03        | --            | --                          | --             | --         | --         | --         | --         | --            |
| 01/09/92          | 154.13        | 135.90       | 18.23        | --            | --                          | 240            | 120        | 0.9        | <0.5       | 1.6        | --            |
| 03/06/92          | 154.13        | 137.09       | 17.04        | --            | --                          | 230            | 68         | 1.2        | 1.2        | 1.3        | --            |
| 06/04/92          | 154.13        | 136.34       | 17.79        | --            | --                          | 80             | 36         | 0.6        | 0.5        | 0.7        | --            |
| 09/28/92          | 154.13        | 135.13       | 19.00        | --            | --                          | 84             | 49         | <0.5       | <0.5       | 1.5        | --            |
| 12/17/92          | 154.13        | 135.95       | 18.18        | --            | --                          | 220            | 30         | <0.5       | <0.5       | <0.5       | --            |
| 04/29/93          | 154.13        | 135.35       | 18.78        | --            | --                          | 380            | 12         | 0.6        | <0.5       | <1.5       | --            |
| 07/26/93          | 154.13        | 136.41       | 17.72        | --            | --                          | 800            | 38         | 1.1        | <0.5       | <1.5       | --            |
| 10/22/93          | 154.13        | 135.63       | 18.50        | --            | --                          | 200            | 64         | 0.6        | <0.5       | <1.5       | --            |
| 01/24/94          | 154.13        | 135.62       | 18.51        | --            | --                          | <50            | <0.5       | <0.5       | <0.5       | <0.5       | --            |
| 04/11/94          | 154.13        | 136.09       | 18.04        | --            | --                          | 100            | 3.6        | 2.1        | <0.5       | 2.3        | --            |
| 07/01/94          | 154.13        | 136.01       | 18.12        | --            | --                          | 140            | 3.7        | 1.2        | <0.5       | 1.0        | --            |
| 10/06/94          | 154.13        | 135.50       | 18.63        | --            | --                          | <50            | <0.5       | <0.5       | <0.5       | <0.5       | --            |
| 01/11/95          | 154.13        | 137.01       | 17.12        | --            | --                          | <50            | <0.5       | <0.5       | <0.5       | <0.5       | --            |
| 04/07/95          | 154.13        | 138.34       | 15.79        | --            | --                          | <50            | <0.5       | <0.5       | <0.5       | <0.5       | --            |
| 07/20/95          | 154.13        | 136.37       | 17.76        | --            | --                          | <50            | 1.5        | 1.9        | <0.5       | 3.5        | --            |
| 09/22/95          | 154.13        | 136.58       | 17.55        | --            | --                          | <50            | <0.5       | <0.5       | <0.5       | <0.5       | --            |
| 01/02/96          | 154.13        | 136.88       | 17.25        | --            | --                          | <50            | <0.5       | <0.5       | <0.5       | 1.1        | <2.5          |

**Table 1**  
**Groundwater Monitoring Data and Analytical Results**  
Former Chevron Service Station #9-2960  
2416 Grove Way  
Castro Valley, California

| WELL ID/<br>DATE  | TOC*<br>(ft.) | GWE<br>(msl) | DTW<br>(ft.) | SPHT<br>(ft.) | SPH<br>REMOVED<br>(gallons) | TPH-G<br>(ppb) | B<br>(ppb) | T<br>(ppb) | E<br>(ppb) | X<br>(ppb) | MTBE<br>(ppb) |
|-------------------|---------------|--------------|--------------|---------------|-----------------------------|----------------|------------|------------|------------|------------|---------------|
| <b>C-3 (cont)</b> |               |              |              |               |                             |                |            |            |            |            |               |
| 04/26/96          | 154.13        | 137.42       | 16.71        | --            | --                          | <50            | <0.5       | <0.5       | <0.5       | <0.5       | --            |
| 07/22/96          | 154.13        | 136.50       | 17.63        | --            | --                          | <50            | <0.5       | <0.5       | <0.5       | <0.5       | --            |
| 10/17/96          | 154.13        | 136.33       | 17.80        | --            | --                          | <50            | <0.5       | <0.5       | <0.5       | <0.5       | --            |
| 01/23/97          | 154.13        | 138.33       | 15.80        | --            | --                          | <50            | <0.5       | <0.5       | <0.5       | <0.5       | --            |
| 07/10/97          | 154.13        | 136.63       | 17.50        | --            | --                          | <50            | <0.5       | <0.5       | <0.5       | <0.5       | --            |
| 01/15/98          | 154.13        | 137.98       | 16.15        | --            | --                          | <50            | <0.5       | <0.5       | <0.5       | <0.5       | --            |
| 01/16/98          | 154.13        | 138.04       | 16.09        | --            | --                          | REGAUGE        | --         | --         | --         | --         | --            |
| 07/09/98          | 154.13        | 137.57       | 16.56        | --            | --                          | <50            | <0.5       | <0.5       | <0.5       | <0.5       | --            |
| ABANDONED         |               |              |              |               |                             |                |            |            |            |            |               |
| <b>C-4</b>        |               |              |              |               |                             |                |            |            |            |            |               |
| 10/23/86          | 156.00        | --           | --           | --            | --                          | 570            | 3.0        | 4.0        | --         | 5.0        | --            |
| 09/10/87          | 156.00        | --           | --           | --            | --                          | 500            | 3.0        | <0.5       | <0.5       | <0.5       | --            |
| 10/16/89          | 156.00        | --           | --           | --            | --                          | <500           | 12         | 1.0        | <0.5       | 0.8        | --            |
| 01/04/90          | 156.00        | --           | --           | --            | --                          | <500           | 5.0        | <0.5       | <0.5       | 0.9        | --            |
| 04/05/90          | 156.00        | --           | --           | --            | --                          | <50            | 6.6        | <0.5       | <0.5       | 0.7        | --            |
| 07/02/90          | 156.00        | --           | --           | --            | --                          | 71             | 4.1        | <0.5       | <0.5       | <0.5       | --            |
| 10/03/90          | 156.00        | --           | --           | --            | --                          | --             | --         | --         | --         | --         | --            |
| 10/25/90          | 156.00        | 135.57       | 20.43        | --            | --                          | <50            | 2.0        | <0.5       | <0.5       | <0.5       | --            |
| 01/22/91          | 156.00        | 135.50       | 20.50        | --            | --                          | <50            | 3.0        | <0.5       | <0.5       | <0.5       | --            |
| 02/21/91          | 156.00        | 135.77       | 20.23        | --            | --                          | --             | --         | --         | --         | --         | --            |
| 04/01/91          | 156.00        | 136.97       | 19.03        | --            | --                          | --             | --         | --         | --         | --         | --            |
| 04/11/91          | 156.00        | 136.95       | 19.05        | --            | --                          | --             | --         | --         | --         | --         | --            |
| 07/01/91          | 156.00        | 136.10       | 19.90        | --            | --                          | --             | --         | --         | --         | --         | --            |
| 09/24/91          | 156.00        | 135.59       | 20.41        | --            | --                          | 87             | 1.6        | <0.5       | <0.5       | <0.5       | --            |
| 10/23/91          | 156.00        | 135.47       | 20.53        | --            | --                          | --             | --         | --         | --         | --         | --            |
| 11/22/91          | 156.00        | 135.65       | 20.35        | --            | --                          | --             | --         | --         | --         | --         | --            |
| 01/09/92          | 156.00        | 136.46       | 19.54        | --            | --                          | 51             | 4.3        | <0.5       | <0.5       | <0.5       | --            |
| 01/09/92          | 156.00        | 136.46       | 19.54        | --            | --                          | <50            | 4.8        | <0.5       | <0.5       | <0.5       | --            |



**Table 1**  
**Groundwater Monitoring Data and Analytical Results**  
Former Chevron Service Station #9-2960  
2416 Grove Way  
Castro Valley, California

| WELL ID/<br>DATE | TOC*<br>(ft.) | GWE<br>(msl)                  | DTW<br>(ft.) | SPHT<br>(ft.) | SPH                  |                  | B<br>(ppb) | T<br>(ppb) | E<br>(ppb) | X<br>(ppb) | MTBE<br>(ppb) |
|------------------|---------------|-------------------------------|--------------|---------------|----------------------|------------------|------------|------------|------------|------------|---------------|
|                  |               |                               |              |               | REMOVED<br>(gallons) | TPH-G<br>(ppb)   |            |            |            |            |               |
| C-4 (cont)       |               |                               |              |               |                      |                  |            |            |            |            |               |
| 03/06/92         | 156.00        | 137.74                        | 18.26        | --            | --                   | <50              | 0.8        | <0.5       | <0.5       | <0.5       | --            |
| 06/04/92         | 156.00        | 137.08                        | 18.92        | --            | --                   | <50              | <0.5       | <0.5       | <0.5       | 0.7        | --            |
| 09/28/92         | 156.00        | 135.69                        | 20.31        | --            | --                   | <50              | <0.5       | <0.5       | <0.5       | <0.5       | --            |
| 12/17/92         | 156.00        | 136.43                        | 19.57        | --            | --                   | <50              | <0.5       | <0.5       | <0.5       | <0.5       | --            |
| 04/29/93         | 156.00        | 138.22                        | 17.78        | --            | --                   | <50              | <0.5       | <0.5       | <0.5       | <1.5       | --            |
| 07/26/93         | 156.00        | --                            | --           | --            | --                   | --               | --         | --         | --         | --         | --            |
| 08/18/93         | 156.00        | 137.09                        | 18.91        | --            | --                   | <50              | <0.5       | <0.5       | <0.5       | <1.5       | --            |
| 10/22/93         | 156.00        | 136.61                        | 19.39        | --            | --                   | <50              | 2.9        | 2.1        | 1.1        | 4.3        | --            |
| 01/24/94         | 156.00        | 136.58                        | 19.42        | --            | --                   | <50              | <0.5       | <0.5       | <0.5       | <0.5       | --            |
| 04/11/94         | 156.00        | 136.86                        | 19.14        | --            | --                   | <50              | <0.5       | 0.6        | <0.5       | 0.5        | --            |
| 07/01/94         | 156.00        | 136.80                        | 19.20        | --            | --                   | <50              | <0.5       | <0.5       | <0.5       | <0.5       | --            |
| 10/06/94         | 156.00        | 136.26                        | 19.74        | --            | --                   | <50              | <0.5       | <0.5       | <0.5       | <0.5       | --            |
| 01/11/95         | 156.00        | 139.70                        | 16.30        | --            | --                   | <50              | <0.5       | <0.5       | <0.5       | <0.5       | --            |
| 04/07/95         | 156.00        | 139.49                        | 16.51        | --            | --                   | <50              | <0.5       | <0.5       | <0.5       | <0.5       | --            |
| 07/20/95         | 156.00        | 137.20                        | 18.80        | --            | --                   | <50              | <0.5       | <0.5       | <0.5       | <0.5       | --            |
| 09/22/95         | 156.00        | 137.26                        | 18.74        | --            | --                   | <50              | <0.5       | <0.5       | <0.5       | <0.5       | --            |
| 01/02/96         | 156.00        | 137.65                        | 18.35        | --            | --                   | <50              | 1.6        | 1.8        | 0.95       | 4.1        | <2.5          |
| 04/26/96         | 156.00        | 138.43                        | 17.57        | --            | --                   | <50              | <0.5       | <0.5       | <0.5       | <0.5       | --            |
| 07/22/96         | 156.00        | 137.00                        | 19.00        | --            | --                   | <50              | <0.5       | <0.5       | <0.5       | <0.5       | --            |
| 10/17/96         | 156.00        | 136.96                        | 19.04        | --            | --                   | <50              | <0.5       | <0.5       | <0.5       | <0.5       | --            |
| 01/23/97         | 156.00        | 139.31                        | 16.69        | --            | --                   | <50              | <0.5       | <0.5       | <0.5       | <0.5       | --            |
| 07/10/97         | 156.00        | 137.46                        | 18.54        | --            | --                   | SAMPLED ANNUALLY | --         | --         | --         | --         | --            |
| 01/15/98         | 156.00        | 143.92                        | 12.08        | --            | --                   | <50              | 1.0        | 1.4        | <0.5       | 3.5        | --            |
| 01/16/98         | 156.00        | 138.84                        | 17.16        | --            | --                   | REGAUGE          | --         | --         | --         | --         | --            |
| 07/09/98         | 156.00        | 138.29                        | 17.71        | --            | --                   | --               | --         | --         | --         | --         | --            |
| 01/08/99         | 156.00        | 139.19                        | 16.81        | --            | --                   | <50              | <0.5       | <0.5       | <0.5       | <0.5       | --            |
| 07/09/99         | 156.00        | UNABLE TO LOCATE              | --           | --            | --                   | --               | --         | --         | --         | --         | --            |
| 02/01/00         | 156.00        | UNABLE TO LOCATE              | --           | --            | --                   | --               | --         | --         | --         | --         | --            |
| 08/21/00         | 156.00        | UNABLE TO LOCATE - PAVED OVER | --           | --            | --                   | --               | --         | --         | --         | --         | --            |

**Table 1**  
**Groundwater Monitoring Data and Analytical Results**  
Former Chevron Service Station #9-2960  
2416 Grove Way  
Castro Valley, California

| WELL ID/<br>DATE  | TOC*<br>(ft.) | GWE<br>(msl)                  | DTW<br>(ft.) | SPHT<br>(ft.) | SPH<br>REMOVED<br>(gallons) | TPH-G<br>(ppb) | B<br>(ppb) | T<br>(ppb) | E<br>(ppb) | X<br>(ppb) | MTBE<br>(ppb) |
|-------------------|---------------|-------------------------------|--------------|---------------|-----------------------------|----------------|------------|------------|------------|------------|---------------|
| <b>C-4 (cont)</b> |               |                               |              |               |                             |                |            |            |            |            |               |
| 01/25/01          | 156.00        | UNABLE TO LOCATE - PAVED OVER |              |               |                             | --             | --         | --         | --         | --         | --            |
| 07/10/01          | 156.00        | UNABLE TO LOCATE - PAVED OVER |              |               |                             | --             | --         | --         | --         | --         | --            |
| 01/08/02          | 156.00        | UNABLE TO LOCATE - PAVED OVER |              |               |                             | --             | --         | --         | --         | --         | --            |
| 03/26/02          | 156.00        | UNABLE TO LOCATE - PAVED OVER |              |               |                             | --             | --         | --         | --         | --         | --            |
| 06/17/02          | 156.00        | UNABLE TO LOCATE - PAVED OVER |              |               |                             | --             | --         | --         | --         | --         | --            |
| PAVED OVER        |               |                               |              |               |                             |                |            |            |            |            |               |
| <b>C-5</b>        |               |                               |              |               |                             |                |            |            |            |            |               |
| 10/03/90          | 153.38        | 135.60                        | 17.78        | --            | --                          | <50            | <0.5       | <0.5       | <0.5       | <0.5       | --            |
| 10/25/90          | 153.38        | 135.46                        | 17.92        | --            | --                          | <50            | <0.5       | <0.5       | <0.5       | <0.5       | --            |
| 11/09/90          | 153.38        | 135.46                        | 17.92        | --            | --                          | <50            | <0.5       | <0.5       | <0.5       | <0.5       | --            |
| 01/22/91          | 153.38        | 135.58                        | 17.80        | --            | --                          | <50            | <0.5       | <0.5       | <0.5       | <0.5       | --            |
| 02/21/91          | 153.38        | 135.87                        | 17.51        | --            | --                          | --             | --         | --         | --         | --         | --            |
| 04/01/91          | 153.38        | 137.07                        | 16.31        | --            | --                          | --             | --         | --         | --         | --         | --            |
| 04/11/91          | 153.38        | 137.02                        | 16.36        | --            | --                          | --             | --         | --         | --         | --         | --            |
| 07/01/91          | 153.38        | 136.26                        | 17.12        | --            | --                          | --             | --         | --         | --         | --         | --            |
| 09/24/91          | 153.38        | 135.68                        | 17.70        | --            | --                          | <50            | <0.5       | <0.5       | <0.5       | <0.5       | --            |
| 09/24/91          | 153.38        | 135.68                        | 17.70        | --            | --                          | <50            | <0.5       | <0.5       | <0.5       | <0.5       | --            |
| 10/23/91          | 153.38        | 135.56                        | 17.82        | --            | --                          | --             | --         | --         | --         | --         | --            |
| 11/22/91          | 153.38        | 135.77                        | 17.61        | --            | --                          | --             | --         | --         | --         | --         | --            |
| 01/09/92          | 153.38        | 136.34                        | 17.04        | --            | --                          | <50            | <0.5       | 0.7        | <0.5       | <0.5       | --            |
| 03/06/92          | 153.38        | 137.62                        | 15.76        | --            | --                          | <50            | <0.5       | <0.5       | <0.5       | <0.5       | --            |
| 06/04/92          | 153.38        | 136.98                        | 16.40        | --            | --                          | <50            | <0.5       | <0.5       | <0.5       | <0.5       | --            |
| 09/28/92          | 153.38        | 135.80                        | 17.58        | --            | --                          | <50            | <0.5       | <0.5       | <0.5       | <0.5       | --            |
| 12/17/92          | 153.38        | 136.56                        | 16.82        | --            | --                          | <50            | <0.5       | <0.5       | <0.5       | <0.5       | --            |
| 04/29/93          | 153.38        | 138.14                        | 15.24        | --            | --                          | <50            | <0.5       | <0.5       | <0.5       | <1.5       | --            |
| 07/26/93          | 153.38        | 137.08                        | 16.30        | --            | --                          | <50            | <0.5       | <0.5       | <0.5       | <1.5       | --            |
| 10/22/93          | 153.38        | 136.30                        | 17.08        | --            | --                          | 52             | 2.3        | 2.7        | 1.1        | 5.2        | --            |
| 01/24/94          | 153.38        | 136.25                        | 17.13        | --            | --                          | <50            | <0.5       | <0.5       | <0.5       | <0.5       | --            |
| 04/11/94          | 153.38        | 136.75                        | 16.63        | --            | --                          | <50            | <0.5       | 0.7        | <0.5       | 0.6        | --            |

**Table 1**  
**Groundwater Monitoring Data and Analytical Results**  
Former Chevron Service Station #9-2960  
2416 Grove Way  
Castro Valley, California

| WELL ID/<br>DATE | TOC*<br>( <i>ft.</i> ) | GWE<br>( <i>msl</i> ) | DTW<br>( <i>ft.</i> ) | SPHT<br>( <i>ft.</i> ) | SPH<br>REMOVED<br>( <i>gallons</i> ) | TPH-G<br>( <i>ppb</i> ) | B<br>( <i>ppb</i> ) | T<br>( <i>ppb</i> ) | E<br>( <i>ppb</i> ) | X<br>( <i>ppb</i> ) | MTBE<br>( <i>ppb</i> ) |
|------------------|------------------------|-----------------------|-----------------------|------------------------|--------------------------------------|-------------------------|---------------------|---------------------|---------------------|---------------------|------------------------|
| C-5 (cont)       |                        |                       |                       |                        |                                      |                         |                     |                     |                     |                     |                        |
| 07/01/94         | 153.38                 | 136.73                | 16.65                 | --                     | --                                   | <50                     | <0.5                | <0.5                | <0.5                | <0.5                | --                     |
| 10/06/94         | 153.38                 | 136.16                | 17.22                 | --                     | --                                   | <50                     | <0.5                | <0.5                | <0.5                | <0.5                | --                     |
| 01/11/95         | 153.38                 | 137.41                | 15.97                 | --                     | --                                   | <50                     | <0.5                | <0.5                | <0.5                | <0.5                | --                     |
| 04/07/95         | 153.38                 | 139.37                | 14.01                 | --                     | --                                   | <50                     | <0.5                | <0.5                | <0.5                | <0.5                | --                     |
| 07/20/95         | 153.38                 | 137.17                | 16.21                 | --                     | --                                   | <50                     | <0.5                | <0.5                | <0.5                | 0.61                | --                     |
| 09/22/95         | 153.38                 | 137.07                | 16.31                 | --                     | --                                   | 62                      | <0.5                | <0.5                | <0.5                | <0.5                | --                     |
| 01/02/96         | 153.38                 | 137.56                | 15.82                 | --                     | --                                   | <50                     | <0.5                | <0.5                | <0.5                | <0.5                | <2.5                   |
| 04/26/96         | 153.38                 | 138.41                | 14.97                 | --                     | --                                   | <50                     | <0.5                | <0.5                | <0.5                | <0.5                | --                     |
| 07/22/96         | 153.38                 | 137.06                | 16.32                 | --                     | --                                   | <50                     | <0.5                | <0.5                | <0.5                | <0.5                | --                     |
| 10/17/96         | 153.38                 | 136.88                | 16.50                 | --                     | --                                   | <50                     | <0.5                | <0.5                | <0.5                | <0.5                | --                     |
| 01/23/97         | 153.38                 | 139.18                | 14.20                 | --                     | --                                   | <50                     | <0.5                | <0.5                | <0.5                | <0.5                | --                     |
| ABANDONED        |                        |                       |                       |                        |                                      |                         |                     |                     |                     |                     |                        |
| C-6              |                        |                       |                       |                        |                                      |                         |                     |                     |                     |                     |                        |
| 10/03/90         | 152.84                 | 134.70                | 18.14                 | --                     | --                                   | <50                     | <0.5                | <0.5                | <0.5                | <0.5                | --                     |
| 10/25/90         | 152.84                 | 134.55                | 18.29                 | --                     | --                                   | <50                     | <0.5                | 1.0                 | <0.5                | <0.5                | --                     |
| 11/09/90         | 152.84                 | 134.58                | 18.26                 | --                     | --                                   | <50                     | <0.5                | <0.5                | <0.5                | <0.5                | --                     |
| 01/22/91         | 152.84                 | 134.69                | 18.15                 | --                     | --                                   | <50                     | <0.5                | <0.5                | <0.5                | <0.5                | --                     |
| 02/21/91         | 152.84                 | 134.92                | 17.92                 | --                     | --                                   | --                      | --                  | --                  | --                  | --                  | --                     |
| 04/01/91         | 152.84                 | 135.73                | 17.11                 | --                     | --                                   | --                      | --                  | --                  | --                  | --                  | --                     |
| 04/11/91         | 152.84                 | 135.83                | 17.01                 | --                     | --                                   | --                      | --                  | --                  | --                  | --                  | --                     |
| 07/01/91         | 152.84                 | 135.12                | 17.72                 | --                     | --                                   | --                      | --                  | --                  | --                  | --                  | --                     |
| 09/24/91         | 152.84                 | 135.72                | 17.12                 | --                     | --                                   | <50                     | <0.5                | <0.5                | <0.5                | <0.5                | --                     |
| 10/23/91         | 152.84                 | 134.59                | 18.25                 | --                     | --                                   | --                      | --                  | --                  | --                  | --                  | --                     |
| 11/22/91         | 152.84                 | 134.79                | 18.05                 | --                     | --                                   | --                      | --                  | --                  | --                  | --                  | --                     |
| 01/09/92         | 152.84                 | 135.42                | 17.42                 | --                     | --                                   | <50                     | <0.5                | <0.5                | <0.5                | <0.5                | --                     |
| 03/06/92         | 152.84                 | 136.33                | 16.51                 | --                     | --                                   | <50                     | <0.5                | <0.5                | <0.5                | <0.5                | --                     |
| 06/04/92         | 152.84                 | 135.83                | 17.01                 | --                     | --                                   | <50                     | <0.5                | <0.5                | <0.5                | <0.5                | --                     |
| 09/28/92         | 152.84                 | 134.84                | 18.00                 | --                     | --                                   | <50                     | <0.5                | <0.5                | <0.5                | <0.5                | --                     |

**Table 1**  
**Groundwater Monitoring Data and Analytical Results**  
Former Chevron Service Station #9-2960  
2416 Grove Way  
Castro Valley, California

| WELL ID/<br>DATE | TOC*<br>(ft.) | GWE<br>(msl)                  | DTW<br>(ft.) | SPHT<br>(ft.) | SPH<br>REMOVED<br>(gallons) | TPH-G<br>(ppb) | B<br>(ppb) | T<br>(ppb) | E<br>(ppb) | X<br>(ppb) | MTBE<br>(ppb) |
|------------------|---------------|-------------------------------|--------------|---------------|-----------------------------|----------------|------------|------------|------------|------------|---------------|
| C-6 (cont)       |               |                               |              |               |                             |                |            |            |            |            |               |
| 12/17/92         | 152.84        | 135.58                        | 17.26        | --            | --                          | <50            | <0.5       | <0.5       | <0.5       | <0.5       | --            |
| 04/29/93         | 152.84        | 136.61                        | 16.23        | --            | --                          | <50            | <0.5       | <0.5       | <0.5       | <1.5       | --            |
| 07/29/93         | 152.84        | 135.88                        | 16.96        | --            | --                          | <50            | <0.5       | <0.5       | <0.5       | <1.5       | --            |
| 10/22/93         | 152.84        | 135.38                        | 17.46        | --            | --                          | 74             | 7.4        | 6.1        | 3.3        | 9.7        | --            |
| 01/24/94         | 152.84        | 135.38                        | 17.46        | --            | --                          | <50            | <0.5       | <0.5       | <0.5       | <0.5       | --            |
| 04/11/94         | 152.84        | 135.64                        | 17.20        | --            | --                          | <50            | <0.5       | <0.5       | <0.5       | <0.5       | --            |
| 07/01/94         | 152.84        | 135.66                        | 17.18        | --            | --                          | <50            | <0.5       | <0.5       | <0.5       | <0.5       | --            |
| 10/06/94         | 152.84        | 135.19                        | 17.65        | --            | --                          | <50            | <0.5       | <0.5       | <0.5       | <0.5       | --            |
| 01/11/95         | 152.84        | 136.18                        | 16.66        | --            | --                          | <50            | <0.5       | <0.5       | <0.5       | <0.5       | --            |
| 04/07/95         | 152.84        | 137.25                        | 15.59        | --            | --                          | <50            | <0.5       | <0.5       | <0.5       | <0.5       | --            |
| 07/20/95         | 152.84        | 135.80                        | 17.04        | --            | --                          | <50            | <0.5       | <0.5       | <0.5       | <0.5       | --            |
| 09/22/95         | 152.84        | 135.74                        | 17.10        | --            | --                          | <50            | <0.5       | <0.5       | <0.5       | <0.5       | --            |
| 01/02/96         | 152.84        | 136.08                        | 16.76        | --            | --                          | <50            | <0.5       | <0.5       | <0.5       | <0.5       | <2.5          |
| 04/26/96         | 152.84        | 136.64                        | 16.20        | --            | --                          | <50            | <0.5       | <0.5       | <0.5       | <0.5       | --            |
| 07/22/96         | 152.84        | 135.79                        | 17.05        | --            | --                          | <50            | <0.5       | <0.5       | <0.5       | <0.5       | --            |
| 10/17/96         | 152.84        | 135.62                        | 17.22        | --            | --                          | <50            | <0.5       | <0.5       | <0.5       | <0.5       | --            |
| 01/23/97         | 152.84        | 136.99                        | 15.85        | --            | --                          | <50            | <0.5       | <0.5       | <0.5       | <0.5       | --            |
| 07/10/97         | 152.84        | 135.95                        | 16.89        | --            | --                          | <50            | <0.5       | <0.5       | <0.5       | <0.5       | --            |
| 01/15/98         | 152.84        | 136.64                        | 16.20        | --            | --                          | <50            | <0.5       | <0.5       | <0.5       | <0.5       | --            |
| 01/16/98         | 152.84        | 136.74                        | 16.10        | --            | --                          | REGAUGE        | --         | --         | --         | --         | --            |
| 07/09/98         | 152.84        | 136.71                        | 16.13        | --            | --                          | <50            | <0.5       | <0.5       | <0.5       | <0.5       | --            |
| 01/08/99         | 152.84        | 137.57                        | 15.27        | --            | --                          | <50            | <0.5       | <0.5       | <0.5       | <0.5       | --            |
| 07/09/99         | 152.84        | 136.60                        | 16.24        | --            | --                          | <50            | <0.5       | <0.5       | <0.5       | <0.5       | <5.0          |
| 02/01/00         | 152.84        | 136.57                        | 16.27        | --            | --                          | <50            | <0.5       | <0.5       | <0.5       | <0.5       | <5.0          |
| 08/21/00         | 152.84        | UNABLE TO LOCATE - PAVED OVER |              |               |                             | --             | --         | --         | --         | --         | --            |
| 01/25/01         | 152.84        | UNABLE TO LOCATE - PAVED OVER |              |               |                             | --             | --         | --         | --         | --         | --            |
| 07/10/01         | 152.84        | UNABLE TO LOCATE - PAVED OVER |              |               |                             | --             | --         | --         | --         | --         | --            |
| 01/08/02         | 152.84        | UNABLE TO LOCATE - PAVED OVER |              |               |                             | --             | --         | --         | --         | --         | --            |
| 03/26/02         | 152.84        | UNABLE TO LOCATE - PAVED OVER |              |               |                             | --             | --         | --         | --         | --         | --            |
| 06/17/02         | 152.84        | UNABLE TO LOCATE - PAVED OVER |              |               |                             | --             | --         | --         | --         | --         | --            |

PAVED OVER

**Table 1**  
**Groundwater Monitoring Data and Analytical Results**  
Former Chevron Service Station #9-2960  
2416 Grove Way  
Castro Valley, California

| WELL ID/<br>DATE | TOC*<br>(ft.) | GWE<br>(msl) | DTW<br>(ft.) | SPHT<br>(ft.) | SPH<br>REMOVED<br>(gallons) | TPH-G<br>(ppb) | B<br>(ppb) | T<br>(ppb) | E<br>(ppb) | X<br>(ppb) | MTBE<br>(ppb) |
|------------------|---------------|--------------|--------------|---------------|-----------------------------|----------------|------------|------------|------------|------------|---------------|
| C-7              |               |              |              |               |                             |                |            |            |            |            |               |
| 10/03/90         | 155.34        | 134.52       | 20.82        | --            | --                          | <50            | <0.5       | <0.5       | <0.5       | <0.5       | --            |
| 10/25/90         | 155.34        | 134.43       | 20.91        | --            | --                          | <50            | <0.5       | 1.0        | <0.5       | <0.5       | --            |
| 11/09/90         | 155.34        | 134.40       | 20.94        | --            | --                          | <50            | <0.5       | <0.5       | <0.5       | <0.5       | --            |
| 01/22/91         | 155.34        | 133.84       | 21.50        | --            | --                          | <50            | 4.0        | <0.5       | <0.5       | <0.5       | --            |
| 02/21/91         | 155.34        | 134.63       | 20.71        | --            | --                          | --             | --         | --         | --         | --         | --            |
| 04/01/91         | 155.34        | 135.34       | 20.00        | --            | --                          | --             | --         | --         | --         | --         | --            |
| 04/11/91         | 155.34        | 135.29       | 20.05        | --            | --                          | --             | --         | --         | --         | --         | --            |
| 07/01/91         | 155.34        | 134.82       | 20.52        | --            | --                          | --             | --         | --         | --         | --         | --            |
| 09/24/91         | 155.34        | 134.52       | 20.82        | --            | --                          | <50            | <0.5       | <0.5       | <0.5       | <0.5       | --            |
| 10/23/91         | 155.34        | 134.43       | 20.91        | --            | --                          | --             | --         | --         | --         | --         | --            |
| 11/22/91         | 155.34        | 134.55       | 20.79        | --            | --                          | --             | --         | --         | --         | --         | --            |
| 01/09/92         | 155.34        | 135.18       | 20.16        | --            | --                          | <50            | <0.5       | <0.5       | <0.5       | 0.9        | --            |
| 03/06/92         | 155.34        | 135.92       | 19.42        | --            | --                          | <50            | <0.5       | <0.5       | <0.5       | <0.5       | --            |
| 06/04/92         | 155.34        | 135.53       | 19.81        | --            | --                          | 250            | <0.5       | <0.5       | <0.5       | <0.5       | --            |
| 09/28/92         | 155.34        | 134.69       | 20.65        | --            | --                          | <50            | <0.5       | <0.5       | <0.5       | <0.5       | --            |
| 12/17/92         | 155.34        | 135.32       | 20.02        | --            | --                          | <50            | <0.5       | <0.5       | <0.5       | <0.5       | --            |
| 04/29/93         | 155.34        | 136.19       | 19.15        | --            | --                          | <50            | <0.5       | <0.5       | <0.5       | <1.5       | --            |
| 07/26/93         | 155.34        | 135.57       | 19.77        | --            | --                          | <50            | <0.5       | <0.5       | <0.5       | <1.5       | --            |
| 10/22/93         | 155.34        | 135.17       | 20.17        | --            | --                          | --             | --         | --         | --         | --         | --            |
| 01/24/94         | 155.34        | 135.11       | 20.23        | --            | --                          | <50            | <0.5       | <0.5       | <0.5       | <0.5       | --            |
| 04/11/94         | 155.34        | 135.39       | 19.95        | --            | --                          | <50            | <0.5       | <0.5       | <0.5       | <0.5       | --            |
| 07/01/94         | 155.34        | 135.42       | 19.92        | --            | --                          | <50            | <0.5       | <0.5       | <0.5       | <0.5       | --            |
| 10/06/94         | 155.34        | 135.03       | 20.31        | --            | --                          | <50            | <0.5       | <0.5       | <0.5       | <0.5       | --            |
| 01/11/95         | 155.34        | 135.98       | 19.36        | --            | --                          | <50            | <0.5       | <0.5       | <0.5       | <0.5       | --            |
| 04/07/95         | 155.34        | 136.84       | 18.50        | --            | --                          | <50            | <0.5       | <0.5       | <0.5       | <0.5       | --            |
| 07/20/95         | 155.34        | 135.46       | 19.88        | --            | --                          | <50            | <0.5       | <0.5       | <0.5       | <0.5       | --            |
| 09/22/95         | 155.34        | 135.38       | 19.96        | --            | --                          | <50            | <0.5       | <0.5       | <0.5       | <0.5       | --            |
| 01/02/96         | 155.34        | 135.64       | 19.70        | --            | --                          | <50            | <0.5       | <0.5       | <0.5       | <0.5       | <2.5          |
| 04/26/96         | 155.34        | 136.17       | 19.17        | --            | --                          | <50            | <0.5       | <0.5       | <0.5       | <0.5       | --            |
| 07/22/96         | 155.34        | 135.49       | 19.85        | --            | --                          | <50            | <0.5       | <0.5       | <0.5       | <0.5       | --            |

**Table 1**  
**Groundwater Monitoring Data and Analytical Results**  
Former Chevron Service Station #9-2960  
2416 Grove Way  
Castro Valley, California

| WELL ID/<br>DATE        | TOC*<br>(ft.) | GWE<br>(msl) | DTW<br>(ft.) | SPHT<br>(ft.) | SPH<br>REMOVED<br>(gallons) | TPH-G<br>(ppb) | B<br>(ppb) | T<br>(ppb) | E<br>(ppb) | X<br>(ppb) | MTBE<br>(ppb)          |
|-------------------------|---------------|--------------|--------------|---------------|-----------------------------|----------------|------------|------------|------------|------------|------------------------|
| <b>C-7 (cont)</b>       |               |              |              |               |                             |                |            |            |            |            |                        |
| 10/17/96                | 155.34        | 135.34       | 20.00        | --            | --                          | <50            | <0.5       | <0.5       | <0.5       | <0.5       | --                     |
| 01/23/97                | 155.34        | 136.44       | 18.90        | --            | --                          | <50            | <0.5       | <0.5       | <0.5       | <0.5       | --                     |
| 07/10/97                | 155.34        | 135.58       | 19.76        | --            | --                          | <50            | <0.5       | <0.5       | <0.5       | <0.5       | --                     |
| 01/15/98                | 155.34        | 136.02       | 19.32        | --            | --                          | <50            | <0.5       | <0.5       | <0.5       | <0.5       | --                     |
| 01/16/98                | 155.34        | 136.14       | 19.20        | --            | --                          | REGAUGE        | --         | --         | --         | --         | --                     |
| 07/09/98                | 155.34        | 136.02       | 19.32        | --            | --                          | <50            | <0.5       | <0.5       | <0.5       | <0.5       | --                     |
| 01/08/99                | 155.34        | 136.83       | 18.51        | --            | --                          | <50            | <0.5       | <0.5       | <0.5       | <0.5       | --                     |
| 07/09/99                | 155.34        | 136.16       | 19.18        | --            | --                          | <50            | <0.5       | <0.5       | <0.5       | <0.5       | <5.0                   |
| 02/01/00                | 155.34        | 136.21       | 19.13        | --            | --                          | <50            | <0.5       | <0.5       | <0.5       | <0.5       | <5.0                   |
| 08/21/00                | 155.34        | 136.16       | 19.18        | 0.00          | 0.00                        | <50            | <0.50      | <0.50      | <0.50      | <0.50      | <2.5                   |
| 01/25/01                | 155.34        | 136.09       | 19.25        | 0.00          | 0.00                        | <50.0          | <0.500     | <0.500     | <0.500     | <0.500     | <2.50                  |
| 07/10/01                | 155.34        | 136.17       | 19.17        | 0.00          | 0.00                        | <50            | <0.50      | <0.50      | <0.50      | <0.50      | <2.5/<2.0 <sup>1</sup> |
| 01/08/02                | 155.34        | 136.31       | 19.03        | 0.00          | 0.00                        | <50            | <0.50      | <0.50      | <0.50      | <1.5       | <2.5                   |
| 03/26/02                | 155.08        | --           | --           | --            | --                          | --             | --         | --         | --         | --         | --                     |
| NOT MONITORED / SAMPLED |               |              |              |               |                             |                |            |            |            |            |                        |
| <b>C-8</b>              |               |              |              |               |                             |                |            |            |            |            |                        |
| 03/26/02 <sup>2</sup>   | 153.41        | 137.96       | 15.45        | 0.00          | 0.00                        | 11,000         | 380        | 130        | 120        | 530        | <25/<2 <sup>1</sup>    |
| 06/17/02                | 153.41        | 137.03       | 16.38        | 0.00          | 0.00                        | 11,000         | 490        | 65         | 170        | 470        | <20/<2 <sup>1</sup>    |
| 09/17/02                | 153.41        | 136.71       | 16.70        | 0.00          | 0.00                        | 6,800          | 410        | 12         | 70         | 130        | 46/<2 <sup>1</sup>     |
| <b>TRIP BLANK</b>       |               |              |              |               |                             |                |            |            |            |            |                        |
| 10/03/90                | --            | --           | --           | --            | --                          | <50            | <0.5       | <0.5       | <0.5       | <0.5       | --                     |
| 10/25/90                | --            | --           | --           | --            | --                          | <50            | <0.5       | <0.5       | <0.5       | <0.5       | --                     |
| 11/09/90                | --            | --           | --           | --            | --                          | <50            | <0.5       | <0.5       | <0.5       | <0.5       | --                     |
| 01/22/91                | --            | --           | --           | --            | --                          | <50            | <0.5       | <0.5       | <0.5       | <0.5       | --                     |
| 09/24/91                | --            | --           | --           | --            | --                          | <50            | <0.5       | <0.5       | <0.5       | <0.5       | --                     |
| 01/09/92                | --            | --           | --           | --            | --                          | <50            | <0.5       | <0.5       | <0.5       | <0.5       | --                     |
| 03/06/92                | --            | --           | --           | --            | --                          | <50            | <0.5       | <0.5       | <0.5       | <0.5       | --                     |

**Table 1**  
**Groundwater Monitoring Data and Analytical Results**  
Former Chevron Service Station #9-2960  
2416 Grove Way  
Castro Valley, California

| WELL ID/<br>DATE         | TOC*<br>(ft.) | GWE<br>(msl) | DTW<br>(ft.) | SPHT<br>(ft.) | SPH<br>REMOVED<br>(gallons) | TPH-G<br>(ppb) | B<br>(ppb) | T<br>(ppb) | E<br>(ppb) | X<br>(ppb) | MTBE<br>(ppb) |
|--------------------------|---------------|--------------|--------------|---------------|-----------------------------|----------------|------------|------------|------------|------------|---------------|
| <b>TRIP BLANK (cont)</b> |               |              |              |               |                             |                |            |            |            |            |               |
| 06/04/92                 | --            | --           | --           | --            | --                          | <50            | <0.5       | <0.5       | <0.5       | <0.5       | --            |
| 09/28/92                 | --            | --           | --           | --            | --                          | <50            | <0.5       | <0.5       | <0.5       | <0.5       | --            |
| 12/17/92                 | --            | --           | --           | --            | --                          | <50            | <0.5       | <0.5       | <0.5       | <0.5       | --            |
| 04/29/93                 | --            | --           | --           | --            | --                          | <50            | <0.5       | <0.5       | <0.5       | <1.5       | --            |
| 07/26/93                 | --            | --           | --           | --            | --                          | <50            | <0.5       | <0.5       | <0.5       | <1.5       | --            |
| 10/22/93                 | --            | --           | --           | --            | --                          | <50            | <0.5       | <0.5       | <0.5       | <1.5       | --            |
| 01/24/94                 | --            | --           | --           | --            | --                          | <50            | <0.5       | <0.5       | <0.5       | <1.5       | --            |
| 04/11/94                 | --            | --           | --           | --            | --                          | <50            | <0.5       | <0.5       | <0.5       | <0.5       | --            |
| 07/01/94                 | --            | --           | --           | --            | --                          | <50            | <0.5       | <0.5       | <0.5       | <0.5       | --            |
| 10/06/94                 | --            | --           | --           | --            | --                          | <50            | <0.5       | <0.5       | <0.5       | <0.5       | --            |
| 01/11/95                 | --            | --           | --           | --            | --                          | <50            | <0.5       | <0.5       | <0.5       | <0.5       | --            |
| 04/07/95                 | --            | --           | --           | --            | --                          | <50            | <0.5       | <0.5       | <0.5       | <0.5       | --            |
| 07/20/95                 | --            | --           | --           | --            | --                          | <50            | <0.5       | <0.5       | <0.5       | <0.5       | --            |
| 09/22/95                 | --            | --           | --           | --            | --                          | <50            | <0.5       | <0.5       | <0.5       | <0.5       | --            |
| 01/02/96                 | --            | --           | --           | --            | --                          | <50            | <0.5       | <0.5       | <0.5       | <0.5       | --            |
| 04/26/96                 | --            | --           | --           | --            | --                          | <50            | <0.5       | <0.5       | <0.5       | <0.5       | --            |
| 07/22/96                 | --            | --           | --           | --            | --                          | <50            | <0.5       | <0.5       | <0.5       | <0.5       | --            |
| 10/17/96                 | --            | --           | --           | --            | --                          | <50            | <0.5       | <0.5       | <0.5       | <0.5       | --            |
| 01/23/97                 | --            | --           | --           | --            | --                          | <50            | <0.5       | <0.5       | <0.5       | <0.5       | --            |
| 07/10/97                 | --            | --           | --           | --            | --                          | <50            | <0.5       | <0.5       | <0.5       | <0.5       | --            |
| 01/15/98                 | --            | --           | --           | --            | --                          | <50            | <0.5       | <0.5       | <0.5       | <0.5       | --            |
| 07/09/98                 | --            | --           | --           | --            | --                          | <50            | <0.5       | <0.5       | <0.5       | <0.5       | --            |
| 01/08/99                 | --            | --           | --           | --            | --                          | <50            | <0.5       | <0.5       | <0.5       | <0.5       | --            |
| 02/01/00                 | --            | --           | --           | --            | --                          | <50            | <0.5       | <0.5       | <0.5       | <0.5       | <5.0          |
| 08/21/00                 | --            | --           | --           | --            | --                          | <50            | <0.50      | <0.50      | <0.50      | <0.50      | <2.5          |
| 01/25/01                 | --            | --           | --           | --            | --                          | <50.0          | <0.500     | <0.500     | <0.500     | <0.500     | <2.50         |
| 07/10/01                 | --            | --           | --           | --            | --                          | <50            | <0.50      | <0.50      | <0.50      | <0.50      | <2.5          |

**Table 1**  
**Groundwater Monitoring Data and Analytical Results**  
Former Chevron Service Station #9-2960  
2416 Grove Way  
Castro Valley, California

| WELL ID/<br>DATE | TOC*<br>(ft.) | GWE<br>(msl) | DTW<br>(ft.) | SPHT<br>(ft.) | SPH<br>REMOVED<br>(gallons) | TPH-G<br>(ppb) | B<br>(ppb) | T<br>(ppb) | E<br>(ppb) | X<br>(ppb) | MTBE<br>(ppb) |
|------------------|---------------|--------------|--------------|---------------|-----------------------------|----------------|------------|------------|------------|------------|---------------|
| QA               |               |              |              |               |                             |                |            |            |            |            |               |
| 01/08/02         | --            | --           | --           | --            | --                          | <50            | <0.50      | <0.50      | <0.50      | <1.5       | <2.5          |
| 03/26/02         | --            | --           | --           | --            | --                          | <50            | <0.50      | <0.50      | <0.50      | <1.5       | <2.5          |
| 06/17/02         | --            | --           | --           | --            | --                          | <50            | <0.50      | <0.50      | <0.50      | <1.5       | <2.5          |
| 09/17/02         | --            | --           | --           | --            | --                          | <50            | <0.50      | <0.50      | <0.50      | <1.5       | <2.5          |



**Table 1**  
**Groundwater Monitoring Data and Analytical Results**  
Former Chevron Service Station #9-2960  
2416 Grove Way  
Castro Valley, California

---

**EXPLANATIONS:**

Groundwater monitoring data and laboratory analytical results prior to August 21, 2000, were compiled from reports prepared by Blaine Tech Services, Inc.

TOC = Top of Casing  
(ft.) = Feet

GWE = Groundwater Elevation  
(msl) = Mean sea level

DTW = Depth to Water

SPHT = Separate Phase Hydrocarbons Thickness

TPH-G = Total Petroleum Hydrocarbons as Gasoline

B = Benzene

T = Toluene

E = Ethylbenzene

X = Xylenes

MTBE = Methyl tertiary butyl ether

(ppb) = Parts per billion

-- = Not Measured/Not Analyzed

QA = Quality Assurance

\* TOC elevations were surveyed in April 2002, by Morrow Surveying. Elevations are based on Alameda County Benchmark No. 259, brass disc top of concrete guard rail & retaining wall abutment along east side "A" Street and on CL + N. 5th Street extended, (Elevation = 138.79 feet).

<sup>1</sup> MTBE by EPA Method 8260.

<sup>2</sup> Well development performed.

**Table 2**  
**Groundwater Analytical Results - Oxygenate Compounds**  
Former Chevron Service Station #9-2960  
2416 Grove Way  
Castro Valley, California

| <b>WELL ID</b> | <b>DATE</b> | <b>TBA<br/>(ppb)</b> | <b>MTBE<br/>(ppb)</b> | <b>DIPE<br/>(ppb)</b> | <b>ETBE<br/>(ppb)</b> | <b>TAME<br/>(ppb)</b> |
|----------------|-------------|----------------------|-----------------------|-----------------------|-----------------------|-----------------------|
| C-7            | 07/10/01    | <20                  | <2.0                  | <2.0                  | <2.0                  | <2.0                  |
| C-8            | 03/26/02    | <100                 | <2                    | <2                    | <2                    | <2                    |
|                | 06/17/02    | <100                 | <2                    | <2                    | <2                    | <2                    |
|                | 09/17/02    | <100                 | <2                    | <2                    | <2                    | <2                    |

**EXPLANATIONS:**

TBA = Tertiary butyl alcohol  
MTBE = Methyl tertiary butyl ether  
DIPE = Di-isopropyl ether  
ETBE = Ethyl tertiary butyl ether  
TAME = Tertiary amyl methyl ether  
(ppb) = Parts per billion

**ANALYTICAL METHOD:**

EPA Method 8260 for Oxygenate Compounds

## STANDARD OPERATING PROCEDURE - GROUNDWATER SAMPLING

Gettler-Ryan Inc. field personnel adhere to the following procedures for the collection and handling of groundwater samples prior to analysis by the analytical laboratory. Prior to sample collection, the type of analysis to be performed is determined. Loss prevention of volatile compounds is controlled and sample preservation for subsequent analysis is maintained.

Prior to sampling, the presence or absence of free-phase hydrocarbons is determined using an interface probe. Product thickness, if present, is measured to the nearest 0.01 foot and is noted in the field notes. In addition, static water level measurements are collected with the interface probe and are also recorded in the field notes.

After water levels are collected and prior to sampling, each well is purged a minimum of three well casing volumes of water using pre-cleaned pumps (stack, suction, Grundfos), or polyvinyl chloride bailers. Temperature, pH and electrical conductivity are measured a minimum of three times during the purging. Purging continues until these parameters stabilize.

Groundwater samples are collected using Chevron-designated disposable bailers. The water samples are transferred from the bailer into appropriate containers. Pre-preserved containers, supplied by analytical laboratories, are used when possible. When pre-preserved containers are not available, the laboratory is instructed to preserve the sample as appropriate. Duplicate samples are collected for the laboratory to use in maintaining quality assurance/quality control standards. The samples are labeled to include the job number, sample identification, collection date and time, analysis, preservation (if any), and the sample collector's initials. The water samples are placed in a cooler, maintained at 4°C for transport to the laboratory. Once collected in the field, all samples are maintained under chain of custody until delivered to the laboratory.

The chain of custody document includes the job number, type of preservation, if any, analysis requested, sample identification, date and time collected, and the sample collector's name. The chain of custody is signed and dated (including time of transfer) by each person who receives or surrenders the samples, beginning with the field personnel and ending with the laboratory personnel.

A laboratory supplied trip blank accompanies each sampling set. For sampling sets greater than 20 samples, 5% trip blanks are included. The trip blank is analyzed for some or all of the same compounds as the groundwater samples.

As requested by Chevron Products Company, the purge water and decontamination water generated during sampling activities is transported by IWM to McKittrick Waste Management located in McKittrick, California.



# GETTLER-RYAN INC.

## WELL MONITORING/SAMPLING FIELD DATA SHEET

Client/Facility #: ChevronTexaco #9-2960 Job Number: 386365  
 Site Address: 2416 Grove Way Event Date: 9.17.02  
 City: Castro Valley, CA Sampler: FT

Well ID: C-8 Well Condition: OK'  
 Well Diameter: 2 in.  
 Total Depth: 24.65 ft.  
 Depth to Water: 16.70 ft.  
 Volume Factor (VF) table:  

|             |            |          |          |           |
|-------------|------------|----------|----------|-----------|
| Volume      | 3/4"= 0.02 | 1"= 0.04 | 2"= 0.17 | 3"= 0.38  |
| Factor (VF) | 4"= 0.66   | 5"= 1.02 | 6"= 1.50 | 12"= 5.80 |

 Purge Volume: 7.95 xVF .17 = 1.35 x3 (case volume) = Estimated Purge Volume: 4.05 gal.

**Purge Equipment:**  
 Disposable Bailer   
 Stainless Steel Bailer \_\_\_\_\_  
 Stack Pump \_\_\_\_\_  
 Suction Pump \_\_\_\_\_  
 Grundfos \_\_\_\_\_  
 Other: \_\_\_\_\_

**Sampling Equipment:**  
 Disposable Bailer   
 Pressure Bailer \_\_\_\_\_  
 Discrete Bailer \_\_\_\_\_  
 Other: \_\_\_\_\_

Time Started: \_\_\_\_\_ (2400 hrs)  
 Time Bailed: \_\_\_\_\_ (2400 hrs)  
 Depth to Product: \_\_\_\_\_ ft  
 Depth to Water: \_\_\_\_\_ ft  
 Hydrocarbon Thickness: \_\_\_\_\_ ft  
 Visual Confirmation/Description: \_\_\_\_\_  
 Skimmer / Absorbant Sock (circle one)  
 Amt Removed from Skimmer: \_\_\_\_\_ gal  
 Amt Removed from Well: \_\_\_\_\_ gal  
 Product Transferred to: \_\_\_\_\_

Start Time (purge): 4:19 Weather Conditions: SUNNY  
 Sample Time/Date: 4:35 / 9.17.02 Water Color: CLOUDY / Gray Odor: YES / STRONG  
 Purging Flow Rate: no gpm. Sediment Description: SILTY  
 Did well de-water? NO If yes, Time: \_\_\_\_\_ Volume: \_\_\_\_\_ gal.

| Time (2400 hr.) | Volume (gal.) | pH          | Conductivity (u mhos/cm) | Temperature (°F) | D.O. (mg/L) | ORP (mV) |
|-----------------|---------------|-------------|--------------------------|------------------|-------------|----------|
| <u>4:22</u>     | <u>1.5</u>    | <u>7.02</u> | <u>123</u>               | <u>21.6</u>      |             |          |
| <u>4:26</u>     | <u>3.0</u>    | <u>7.08</u> | <u>151</u>               | <u>20.9</u>      |             |          |
| <u>4:30</u>     | <u>4.0</u>    | <u>7.11</u> | <u>152</u>               | <u>20.7</u>      |             |          |
|                 |               |             |                          |                  |             |          |
|                 |               |             |                          |                  |             |          |

### LABORATORY INFORMATION

| SAMPLE ID  | (#) CONTAINER       | REFRIG.    | PRESERV. TYPE | LABORATORY       | ANALYSES   |
|------------|---------------------|------------|---------------|------------------|--|
| <u>C-8</u> | <u>6</u> x vva vial | <u>YES</u> | <u>HCL</u>    | <u>LANCASTER</u> | <u>TPH-G(8015)/BTEX+MTBE(8021)/<br/>5 OXYS(8260)</u> |
|            |                     |            |               |                  |  |
|            |                     |            |               |                  |  |

COMMENTS: \_\_\_\_\_

Add/Replaced Lock: \_\_\_\_\_ Add/Replaced Plug: \_\_\_\_\_ Size: \_\_\_\_\_

# Chevron California Region Analysis Request/Chain of Custody



091802-004

For Lancaster Laboratories use only  
 Acct. #: 10905 Sample #: 39102029-30 SCR#: \_\_\_\_\_

gr 823495

Facility # 9-2960 Job # 386365 Global ID# T0600100318  
 Site Address: 2416 GROVE WAY, CASTRO VALLEY, CA  
 Chevron PM: Streich Lead Consultant: DELTA/G-R  
 Consultant/Office: G-R, Inc., 6747 Sierra Court, Dublin, Ca 94568  
 Consultant Prj. Mgr: Deanna L. Harding (Deanna@grinc.com)  
 Consultant Phone: 25-551-7555 Fax #: 925-551-7899  
 Sampler: FRANK TIZZINONI  
 Service Order #: \_\_\_\_\_  Non SAR: \_\_\_\_\_

| Analyses Requested |                                     |                          |     |          |     |                |          |      |                               |
|--------------------|-------------------------------------|--------------------------|-----|----------|-----|----------------|----------|------|-------------------------------|
| Preservation Codes |                                     |                          |     |          |     |                |          |      |                               |
| H                  | H                                   | F                        |     |          |     |                |          |      |                               |
| BTEX + MTBE        | 8260                                | 802                      | TPH | 8015 MOD | GRO | TPH            | 8015 MOD | DRO  | Silica Gel Cleanup            |
|                    | <input checked="" type="checkbox"/> | <input type="checkbox"/> |     |          |     |                |          |      |                               |
|                    |                                     |                          |     |          |     | 8260 full scan |          |      |                               |
|                    |                                     |                          |     |          |     | S Oxygenates   | 8260     |      |                               |
|                    |                                     |                          |     |          |     |                |          | Lead | 7420                          |
|                    |                                     |                          |     |          |     |                |          |      | <input type="checkbox"/> 7421 |

**Preservative Codes**  
 H = HCl      T = Thiosulfate  
 N = HNO<sub>3</sub>    B = NaOH  
 S = H<sub>2</sub>SO<sub>4</sub>    O = Other

J value reporting needed  
 Must meet lowest detection limits possible for 8260 compounds

**8021 MTBE Confirmation**  
 Confirm highest hit by 8260  
 Confirm all hits by 8260  
 Run \_\_\_ oxy s on highest hit  
 Run \_\_\_ oxy s on all hits

| Sample Identification | Date Collected | Time Collected | Grab | Composite | Soil | Water | Oil | Air | Total Number of Containers |
|-----------------------|----------------|----------------|------|-----------|------|-------|-----|-----|----------------------------|
| QA                    | 9-17-02        |                |      |           |      |       |     |     | 2                          |
| C-8                   | ↓              | 1635           | X    |           | W    |       |     |     | 6                          |
|                       |                |                |      |           |      |       |     |     |                            |
|                       |                |                |      |           |      |       |     |     |                            |
|                       |                |                |      |           |      |       |     |     |                            |
|                       |                |                |      |           |      |       |     |     |                            |
|                       |                |                |      |           |      |       |     |     |                            |
|                       |                |                |      |           |      |       |     |     |                            |
|                       |                |                |      |           |      |       |     |     |                            |
|                       |                |                |      |           |      |       |     |     |                            |

**Turnaround Time Requested (TAT) (please circle)**  
 24 hour      72 hour      48 hour  
 4 day      5 day

**Data Package Options (please circle if required)**  
 QC Summary      Type I — Full  
 Type VI (Raw Data)       Coelt Deliverable not needed  
 WIP (RWQCB)  
 Disk

|   |   |                   |                                 |                      |                   |
|---|---|-------------------|---------------------------------|----------------------|-------------------|
| Relinquished by: <u>Frank Tizzinoni</u>   | Date: <u>9-17-02</u>                    | Time: _____       | Received by: <u>[Signature]</u> | Date: <u>9/18</u>    | Time: <u>8315</u> |
| Relinquished by: <u>[Signature]</u>   | Date: <u>9/18/02</u>                    | Time: <u>1310</u> | Received by: <u>[Signature]</u> | Date: <u>9-18-02</u> | Time: <u>1315</u> |
| Relinquished by: <u>[Signature]</u>   | Date: <u>9-18-02</u>                    | Time: <u>1530</u> | Received by: <u>Airborne</u>    | Date: <u>9-18-02</u> | Time: _____       |
| Relinquished by Commercial Carrier:<br>UPS      FedEx      Other: <u>Airborne</u> | Temperature Upon Receipt: <u>2.5 °C</u> |                   | Received by: <u>[Signature]</u> | Date: <u>9/18/02</u> | Time: <u>0920</u> |
| Custody Seals Intact? <u>Yes</u> No   |   |                   |                                 |                      |                   |



**Lancaster Laboratories**

*Where quality is a science.*

RECEIVED

OCT 3 2002

GETTLER-RYAN INC.  
GENERAL CONTRACTORS

**ANALYTICAL RESULTS**

Prepared for:

ChevronTexaco  
6001 Bollinger Canyon Rd L4310  
San Ramon CA 94583

925-842-8582

Prepared by:

Lancaster Laboratories  
2425 New Holland Pike  
Lancaster, PA 17605-2425

SAMPLE GROUP

The sample group for this submittal is 823495. Samples arrived at the laboratory on Thursday, September 19, 2002. The PO# for this group is 99011184 and the release number is STREICH.

Client Description

|              |      |       |
|--------------|------|-------|
| QA-T-020917  | NA   | Water |
| C-8-W-020917 | Grab | Water |

Lancaster Labs Number

|         |
|---------|
| 3902029 |
| 3902030 |

1 COPY TO

Delta C/O Gettler-Ryan

Attn: Deanna L. Harding

Questions? Contact your Client Services Representative  
Teresa M Lis at (717) 656-2300.

Respectfully Submitted,

*Michele M. Turner*

Michele M. Turner  
Manager



Lancaster Laboratories, Inc.  
2425 New Holland Pike  
PO Box 12425  
Lancaster, PA 17605-2425  
717-656-2300 Fax: 717-656-2681



Lancaster Laboratories Sample No. WW 3902029

Collected: 09/17/2002 00:00

Account Number: 10905

Submitted: 09/19/2002 09:20  
 Reported: 10/01/2002 at 15:08  
 Discard: 11/01/2002

ChevronTexaco  
 6001 Bollinger Canyon Rd L4310  
 San Ramon CA 94583

QA-T-020917                      NA                      Water  
 Facility# 92960    Job# 386365                      GRD  
 2416 Grove Way                      T0600100318    QA

| CAT No.   | Analysis Name           | CAS Number | As Received Result | As Received Method Detection Limit | Units | Dilution Factor |
|---|-------------------------|------------|--------------------|------------------------------------|-------|-----------------|
| 01729   | TPH-GRO - Waters        |            |                    |                                    |       |                 |
| 01730   | TPH-GRO - Waters        | n.a.       | N.D.               | 50.                                | ug/l  | 1               |
| The reported concentration of TPH-GRO does not include MTBE or other gasoline constituents eluting prior to the C6 (n-hexane) TPH-GRO range start time.<br>A site-specific MSD sample was not submitted for the project. A LCS/LCSD was performed to demonstrate precision and accuracy at a batch level. |                         |            |                    |                                    |       |                 |
| 08214   | BTEX, MTBE (8021)       |            |                    |                                    |       |                 |
| 00776   | Benzene                 | 71-43-2    | N.D.               | 0.50                               | ug/l  | 1               |
| 00777   | Toluene                 | 108-88-3   | N.D.               | 0.50                               | ug/l  | 1               |
| 00778   | Ethylbenzene            | 100-41-4   | N.D.               | 0.50                               | ug/l  | 1               |
| 00779   | Total Xylenes           | 1330-20-7  | N.D.               | 1.5                                | ug/l  | 1               |
| 00780   | Methyl tert-Butyl Ether | 1634-04-4  | N.D.               | 2.5                                | ug/l  | 1               |
| A site-specific MSD sample was not submitted for the project. A LCS/LCSD was performed to demonstrate precision and accuracy at a batch level.  |                         |            |                    |                                    |       |                 |

State of California Lab Certification No. 2116

### Laboratory Chronicle

| CAT No. | Analysis Name     | Method                     | Trial# | Analysis Date and Time | Analyst        | Dilution Factor |
|---------|-------------------|----------------------------|--------|------------------------|----------------|-----------------|
| 01729   | TPH-GRO - Waters  | N. CA LUPT Gasoline Method | 1      | 09/21/2002 00:42       | Melissa D Mann | 1               |
| 08214   | BTEX, MTBE (8021) | SW-846 8021B               | 1      | 09/21/2002 00:42       | Melissa D Mann | 1               |
| 01146   | GC VOA Water Prep | SW-846 S030B               | 1      | 09/21/2002 00:42       | Melissa D Mann | n.a.            |

#=Laboratory Method Detection Limit exceeded target detection limit  
 N.D.=Not detected  
 M E M B E R



Lancaster Laboratories, Inc.  
 2425 New Holland Pike  
 Lancaster, PA 17605-2425  
 717-656-2300 Fax: 717-656-2681

Lancaster Laboratories Sample No. WW 3902030

Collected: 09/17/2002 16:35 by FT

Account Number: 10905

Submitted: 09/19/2002 09:20  
Reported: 10/01/2002 at 15:08  
Discard: 11/01/2002

ChevronTexaco  
6001 Bollinger Canyon Rd L4310  
San Ramon CA 94583

C-8-W-020917 Grab Water  
Facility# 92960 Job# 386365 GRD  
2416 Grove Way T0600100318 C-8

365C8

| CAT No.  | Analysis Name           | CAS Number | As Received Result | As Received Method Detection Limit | Units | Dilution Factor |
|--|-------------------------|------------|--------------------|------------------------------------|-------|-----------------|
| 01729  | TPH-GRO - Waters        |            |                    |                                    |       |                 |
| 01730  | TPH-GRO - Waters        | n.a.       | 6,800.             | 100.                               | ug/l  | 2               |
| <p>The reported concentration of TPH-GRO does not include MTBE or other gasoline constituents eluting prior to the C6 (n-hexane) TPH-GRO range start time.<br/>A site-specific MSD sample was not submitted for the project. A LCS/LCSD was performed to demonstrate precision and accuracy at a batch level.</p> <p>Due to the nature of the sample matrix, the surrogate standard recovery is above the range of specifications.</p> |                         |            |                    |                                    |       |                 |
| 08214  | BTEX, MTBE (8021)       |            |                    |                                    |       |                 |
| 00776  | Benzene                 | 71-43-2    | 410.               | 0.50                               | ug/l  | 2               |
| 00777  | Toluene                 | 108-88-3   | 12.                | 0.50                               | ug/l  | 2               |
| 00778  | Ethylbenzene            | 100-41-4   | 70.                | 0.50                               | ug/l  | 2               |
| 00779  | Total Xylenes           | 1330-20-7  | 130.               | 1.5                                | ug/l  | 2               |
| 00780  | Methyl tert-Butyl Ether | 1634-04-4  | 46.                | 2.5                                | ug/l  | 2               |
| <p>A site-specific MSD sample was not submitted for the project. A LCS/LCSD was performed to demonstrate precision and accuracy at a batch level.</p> <p>Due to the nature of the sample matrix, the surrogate standard recovery is above the range of specifications.</p>   |                         |            |                    |                                    |       |                 |
| 01595  | Oxygenates by 8260B     |            |                    |                                    |       |                 |
| 02010  | Methyl t-butyl ether    | 1634-04-4  | N.D.               | 2.                                 | ug/l  | 1               |
| 02011  | di-Isopropyl ether      | 108-20-3   | N.D.               | 2.                                 | ug/l  | 1               |
| 02013  | Ethyl t-butyl ether     | 637-92-3   | N.D.               | 2.                                 | ug/l  | 1               |
| 02014  | t-Amyl methyl ether     | 994-05-8   | N.D.               | 2.                                 | ug/l  | 1               |
| 02015  | t-Butyl alcohol         | 75-65-0    | N.D.               | 100.                               | ug/l  | 1               |

State of California Lab Certification No. 2116

### Laboratory Chronicle

#=Laboratory Method Detection Limit exceeds target detection limit  
N.D.=Not detected above the Reporting Limit



Lancaster Laboratories, Inc.  
MEMBER  
Lancaster, PA 17605-2425  
717-656-2300 Fax: 717-656-2681



Lancaster Laboratories Sample No. WW 3902030

Collected: 09/17/2002 16:35 by FT

Account Number: 10905

Submitted: 09/19/2002 09:20

Reported: 10/01/2002 at 15:08

Discard: 11/01/2002

C-8-W-020917

Grab Water

Facility# 92960 Job# 386365

GRD

2416 Grove Way

T0600100318 C-8

ChevronTexaco

6001 Bollinger Canyon Rd L4310

San Ramon CA 94583

365C8

CAT

| No.   | Analysis Name        | Method                     | Trial# | Analysis   |       | Analyst        | Dilution Factor |
|-------|----------------------|----------------------------|--------|------------|-------|----------------|-----------------|
|       |                      |                            |        | Date       | Time  |                |                 |
| 01729 | TPH-GRO - Waters     | N. CA LUFT Gasoline Method | 1      | 09/20/2002 | 16:31 | Melissa D Mann | 2               |
| 08214 | BTEX, MTBE (8021)    | SW-846 8021B               | 1      | 09/20/2002 | 16:31 | Melissa D Mann | 2               |
| 01595 | Oxygenates by 8260B  | SW-846 8260B               | 1      | 09/28/2002 | 18:37 | John B Kiser   | 1               |
| 01146 | GC VOA Water Prep    | SW-846 5030B               | 1      | 09/20/2002 | 16:31 | Melissa D Mann | n.a.            |
| 01163 | GC/MS VOA Water Prep | SW-846 5030B               | 1      | 09/28/2002 | 18:37 | John B Kiser   | n.a.            |

#=Laboratory Method Detection Limit exceeded target detection limit  
N.D.=Not detected above the Reporting Limit



Lancaster Laboratories, Inc.  
2425 New Holland Pike  
Lancaster, PA 17605-2425  
717-656-2300 Fax: 717-656-2681



## Quality Control Summary

Client Name: ChevronTexaco  
 Reported: 10/01/02 at 03:08 PM

Group Number: 823495

### Laboratory Compliance Quality Control

| <u>Analysis Name</u>    | <u>Blank Result</u> | <u>Blank MDL</u>                  | <u>Report Units</u> | <u>LCS %REC</u> | <u>LCSD %REC</u> | <u>LCS/LCSD Limits</u> | <u>RPD</u> | <u>RPD Max</u> |
|-------------------------|---------------------|-----------------------------------|---------------------|-----------------|------------------|------------------------|------------|----------------|
| Batch number: 02263A56A |                     | Sample number(s): 3902029-3902030 |                     |                 |                  |                        |            |                |
| Benzene                 | N.D.                | .2                                | ug/l                | 93              | 90               | 80-118                 | 3          | 30             |
| Toluene                 | N.D.                | .2                                | ug/l                | 100             | 96               | 82-119                 | 4          | 30             |
| Ethylbenzene            | N.D.                | .2                                | ug/l                | 105             | 100              | 81-119                 | 5          | 30             |
| Total Xylenes           | N.D.                | .6                                | ug/l                | 106             | 102              | 82-120                 | 4          | 30             |
| Methyl tert-Butyl Ether | N.D.                | .3                                | ug/l                | 98              | 98               | 79-127                 | 0          | 30             |
| TPH-GRO - Waters        | N.D.                | 50.                               | ug/l                | 86              | 84               | 74-116                 | 3          | 30             |
| Batch number: N022711AA |                     | Sample number(s): 3902030         |                     |                 |                  |                        |            |                |
| Methyl t-butyl ether    | N.D.                | .5                                | ug/l                | 98              |                  | 77-127                 |            |                |
| di-Isopropyl ether      | N.D.                | .5                                | ug/l                | 100             |                  | 74-125                 |            |                |
| Ethyl t-butyl ether     | N.D.                | .5                                | ug/l                | 99              |                  | 74-120                 |            |                |
| t-Amyl methyl ether     | N.D.                | .5                                | ug/l                | 99              |                  | 71-114                 |            |                |
| t-Butyl alcohol         | N.D.                | 5.                                | ug/l                | 90              |                  | 59-139                 |            |                |

### Sample Matrix Quality Control

| <u>Analysis Name</u>    | <u>MS %REC</u> | <u>MSD %REC</u>                   | <u>MS/MSD Limits</u> | <u>RPD</u> | <u>BKG MAX</u> | <u>Conc</u> | <u>DUP Conc</u> | <u>DUP RPD</u> | <u>Dup RPD Max</u> |
|-------------------------|----------------|-----------------------------------|----------------------|------------|----------------|-------------|-----------------|----------------|--------------------|
| Batch number: 02263A56A |                | Sample number(s): 3902029-3902030 |                      |            |                |             |                 |                |                    |
| Benzene                 | 95             |                                   | 83-130               |            |                |             |                 |                |                    |
| Toluene                 | 104            |                                   | 87-129               |            |                |             |                 |                |                    |
| Ethylbenzene            | 109            |                                   | 86-133               |            |                |             |                 |                |                    |
| Total Xylenes           | 109            |                                   | 86-132               |            |                |             |                 |                |                    |
| Methyl tert-Butyl Ether | 101            |                                   | 66-140               |            |                |             |                 |                |                    |
| TPH-GRO - Waters        | 99             |                                   | 74-132               |            |                |             |                 |                |                    |
| Batch number: N022711AA |                | Sample number(s): 3902030         |                      |            |                |             |                 |                |                    |
| Methyl t-butyl ether    | 98             | 101                               | 69-134               | 3          | 30             |             |                 |                |                    |
| di-Isopropyl ether      | 100            | 101                               | 68-133               | 1          | 30             |             |                 |                |                    |
| Ethyl t-butyl ether     | 99             | 101                               | 73-123               | 2          | 30             |             |                 |                |                    |
| t-Amyl methyl ether     | 98             | 99                                | 69-118               | 1          | 30             |             |                 |                |                    |
| t-Butyl alcohol         | 92             | 95                                | 51-148               | 3          | 30             |             |                 |                |                    |

### Surrogate Quality Control

Analysis Name: BTEX, MTBE (8021)  
 Batch number: 02263A56A

|         | Trifluorotoluene-F | Trifluorotoluene-P |
|---------|--------------------|--------------------|
| 3902029 | 75                 | 95                 |
| 3902030 | 176*               | 174*               |
| Blank   | 84                 | 94                 |
| LCS     | 91                 | 94                 |
| LCSD    | 92                 | 94                 |
| MS      | 90                 | 96                 |
| Limits: | 57-146             | 71-130             |

\*- Outside of specification

- (1) The result for one or both determinations was less than five times the LOQ.
- (2) The background result was more than four times the spike added.



Lancaster Laboratories, Inc.  
 2425 New Holland Pike  
 PO Box 12425  
 Lancaster, PA 17605-2425  
 717-656-2300 Fax: 717-656-2681



## Quality Control Summary

Client Name: ChevronTexaco  
Reported: 10/01/02 at 03:08 PM

Group Number: 823495

### Surrogate Quality Control

Analysis Name: Oxygenates by 8260B  
Batch number: N022711AA

|         | Dibromofluoromethane | 1,2-Dichloroethane-d4 | Toluene-d8 | 4-Bromofluorobenzene |
|---------|----------------------|-----------------------|------------|----------------------|
| 3902030 | 98                   | 96                    | 100        | 103                  |
| Blank   | 95                   | 97                    | 100        | 96                   |
| LCS     | 96                   | 96                    | 101        | 97                   |
| MS      | 95                   | 96                    | 101        | 99                   |
| MSD     | 95                   | 97                    | 102        | 98                   |
| Limits: | 86-118               | 80-120                | 88-110     | 86-115               |

\*- Outside of specification

- (1) The result for one or both determinations was less than five times the LOQ.
- (2) The background result was more than four times the spike added.



Lancaster Laboratories, Inc.  
2425 New Holland Pike  
PO Box 12425  
Lancaster, PA 17605-2425  
717-656-2300 Fax: 717-656-2681