

Chevron



Chevron

ENVIRONMENTAL
PROTECTION

99 AUG 26 PM 1:52

Chevron U.S.A. Products Company
6001 Bollinger Canyon Rd. Bldg. L
P. O. Box 6004
San Ramon, CA 94583-0804

Site Assessment and
Remediation Group
Phone (510) 842-9500
Fax (510) 842-5370

Date: August 6, 1999
To: Distribution
Re: Groundwater Monitoring Report

The enclosed groundwater monitoring report has been properly reviewed by a Chevron authorized representative. Agency guidelines have been followed. Blaine Tech Services is authorized to distribute the report directly to interested parties.

If you have any questions, please call me at ⁹²⁵~~(510)~~ 842-8695.

Sincerely,

Brett Hunter
Site Assessment and Remediation
Project Manager

BLAINE
TECH SERVICES INC.



1680 ROGERS AVENUE
SAN JOSE, CALIFORNIA 95112-1105
(408) 573-7771 FAX
(408) 573-0555 PHONE

August 6, 1999

Brett Hunter
Chevron U.S.A. Products Company
P.O. Box 6004
San Ramon, CA 94583-0904

3rd Quarter 1999 Monitoring at 9-2960

Third Quarter 1999 Groundwater Monitoring at
Former Chevron Service Station Number 9-2960
2416 Grove Way
Castro Valley, CA

Monitoring Performed on July 9, 1999

Groundwater Sampling Report 990709-M-2

This report covers the routine monitoring of groundwater wells at this Chevron facility. Blaine Tech Services, Inc.'s work at the site includes inspection, gauging, evacuation, purgewater containment, sample collection and sample handling in accordance with standard procedures that conform to Regional Water Quality Control Board requirements.

Routine field data collection includes depth to water, total well depth, thickness of any separate immiscible layer, water column volume, calculated volume of a three-case volume purge, elapsed evacuation time, total volume of water removed, and standard water parameter instrument readings. Sample material is collected, contained, stored, and transported to the laboratory in conformance with EPA standards. Purgewater is, likewise, collected and transported to McKittrick Waste Treatment Site for disposal.

Basic field information is presented alongside analytical values excerpted from the laboratory report in the cumulative table of **WELL DATA AND ANALYTICAL RESULTS**. The full analytical report for the most recent samples is located in the **Analytical Appendix**. The table also contains new groundwater elevation calculations taken from the computer plotted gradient

map which is located in the **Professional Engineering Appendix**.

At a minimum, Blaine Tech Services, Inc. field personnel are certified upon completion of a forty-hour Hazardous Materials and Emergency Response training course per 29 CFR 1910.120. Field personnel are also enrolled in annual eight hour refresher courses.

Blaine Tech Services, Inc. conducts sampling and documentation assignments of this type as an independent third party. In order to avoid compromising the objectivity necessary for the proper and disinterested performance of this work, Blaine Tech Services, Inc. concentrates on objective data collection and does not participate in the interpretation of analytical results, the definition of geological or hydrological conditions, the formulation of recommendations, or the marketing of remedial systems.

Please call if you have any questions.

Yours truly,

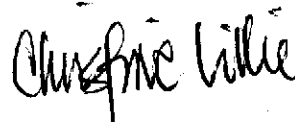

Christine Lillie
Project Coordinator

CAL/sb

attachments: Professional Engineering Appendix
Cumulative Table of Well Data and Analytical Results
Analytical Appendix
Field Data Sheets

cc: **Scott Seery, Alameda County Health Services**
Phil Conley, President, Board of Trustees, First Presbyterian Church
Bette Owen, Chevron Products Company (w/o enclosure)

Professional Engineering Appendix

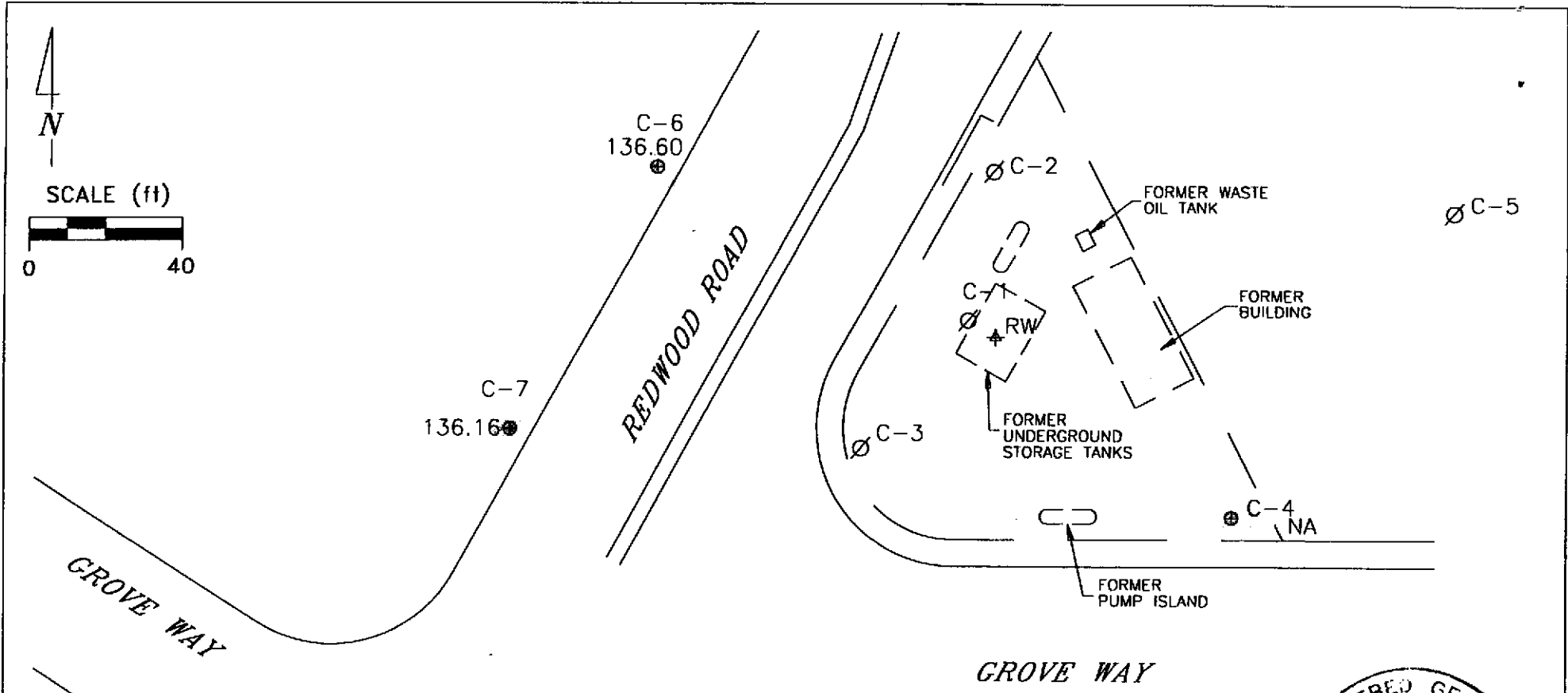

EXPLANATION

- ⊕ MONITORING WELL
- ⚡ RECOVERY WELL
- ∅ ABANDONED WELL
- 136.16 GROUNDWATER ELEVATION (FT, MSL)
- NA DATA NOT AVAILABLE



Basemap from Geoconsultants, Inc.

PREPARED BY

RRM
engineering contracting firm

Former Chevron Station 9-2960
2416 Grove Way
Castro Valley, California

GROUNDWATER ELEVATION MAP,
JULY 9, 1999

FIGURE:
1
PROJECT:
DAC04

Table of Well Data and Analytical Results

Cumulative Table of Well Data and Analytical Results

Vertical Measurements are in feet.			Volumetric Measurements are in gallons.				Analytical results are in parts per billion (ppb)						
DATE	Well Head Elev.	Ground Water Elev.	Depth To Water	SPH Thickness	SPH Removed	Total SPH Removed	Notes	TPH-Gasoline	Benzene	Toluene	Ethyl-Benzene	Xylene	MTBE
C-1													
10/23/86	153.36	--	--	--	--	--	--	3100	6400	3700	--	4300	--
09/10/87	153.36	--	--	--	--	--	--	120,000	25,000	60,000	13,000	56,000	--
10/03/90	153.36	134.69	18.67	--	--	--	--	--	--	--	--	--	--
10/25/90	153.36	135.22	18.71	0.71	--	--	--	--	--	--	--	--	--
01/22/91	153.36	135.22	18.70	0.70	--	--	--	--	--	--	--	--	--
02/21/91	153.36	135.44	18.62	0.88	--	--	--	--	--	--	--	--	--
04/01/91	153.36	136.47	16.91	0.03	--	--	--	--	--	--	--	--	--
04/11/91	153.36	136.49	16.90	0.04	--	--	--	--	--	--	--	--	--
07/01/91	153.36	135.75	17.61	0.00	--	--	--	--	--	--	--	--	--
09/24/91	153.36	135.17	18.98	0.99	--	--	--	--	--	--	--	--	--
10/23/91	153.36	135.03	19.32	1.24	--	--	--	--	--	--	--	--	--
11/22/91	153.36	134.53	18.83	0.97	--	--	--	--	--	--	--	--	--
01/09/92	153.36	136.10	17.26	--	--	--	--	--	--	--	--	--	--
03/06/92	153.36	137.16	16.69	0.61	--	--	--	--	--	--	--	--	--
06/04/92	153.36	136.44	17.10	0.22	--	--	--	--	--	--	--	--	--
09/28/92	153.36	--	18.71	0.77	--	--	--	--	--	--	--	--	--
12/17/92	153.36	--	17.54	0.45	--	--	--	--	--	--	--	--	--
04/29/93	153.36	137.50	16.40	0.68	--	--	--	--	--	--	--	--	--
07/26/93	153.36	136.92	16.85	0.51	--	--	--	--	--	--	--	--	--
10/22/93	153.36	135.55	17.83	0.03	--	--	--	--	--	--	--	--	--
01/24/94	153.36	--	--	--	--	--	--	--	--	--	--	--	--
04/11/94	153.36	136.01	17.76	0.51	--	--	--	--	--	--	--	--	--
07/01/94	153.36	135.95	17.46	0.06	--	--	--	--	--	--	--	--	--
10/06/94	153.36	135.24	18.18	0.08	--	--	--	--	--	--	--	--	--
01/11/95	153.36	136.63	16.79	0.08	0.039	0.039	--	--	--	--	--	--	--
04/07/95	153.36	139.23	14.13	--	--	0.039	--	44,000	410	100	130	5400	--
07/20/95	153.36	136.84	16.52	--	--	0.039	--	16,000	96	81	53	1000	--
09/22/95	153.36	137.22	16.14	--	--	0.039	--	59,000	150	36	16	56	--
01/02/96	153.36	137.43	15.93	--	--	0.039	--	29,000	4500	1100	520	1900	<250
04/26/96	153.36	137.31	16.05	--	--	0.039	--	7200	1300	340	130	390	--
07/22/96	153.36	143.14	10.22	--	--	0.039	--	7300	2500	170	360	520	--
10/17/96	153.36	137.64	15.72	--	--	0.039	--	19,000	3400	59	360	430	--

CONTINUED ON NEXT PAGE

Cumulative Table of Well Data and Analytical Results

Vertical Measurements are in feet.			Volumetric Measurements are in gallons.				Analytical results are in parts per billion (ppb)						
DATE	Well Head Elev.	Ground Water Elev.	Depth To Water	SPH Thickness	SPH Removed	Total SPH Removed	Notes	TPH-Gasoline	Benzene	Toluene	Ethyl-Benzene	Xylene	MTBE
C-1 (CONT'D)													
01/23/97	153.36	138.91	14.45	--	--	0.039	--	15,000	2900	390	250	480	--
07/10/97	153.36	137.19	16.17	--	--	0.039	--	13,000	2100	69	200	380	--
01/15/98	153.36	--	--	--	--	0.039	Inaccessible	--	--	--	--	--	--
01/16/98	153.36	138.63	14.73	--	--	0.039	--	4700	1200	<20	140	40	--
07/09/98	153.36	138.14	15.22	--	--	0.039	--	9900	1500	60	150	170	--
01/08/99	153.36	--	--	--	--	--	Abandoned	--	--	--	--	--	--

Cumulative Table of Well Data and Analytical Results

Vertical Measurements are in feet.				Volumetric Measurements are in gallons.			Analytical results are in parts per billion (ppb)						
DATE	Well Head Elev.	Ground Water Elev.	Depth To Water	SPH Thickness	SPH Removed	Total SPH Removed	Notes	TPH-Gasoline	Benzene	Toluene	Ethyl-Benzene	Xylene	MTBE
C-2													
10/23/86	151.84	--	--	--	--	--	--	30,000	2700	1900	--	1500	--
09/10/87	151.84	--	--	--	--	--	--	14,000	2600	2900	500	1200	--
10/16/89	151.84	--	--	--	--	--	--	600	260	34	1.7	41	--
01/04/90	151.84	--	--	--	--	--	--	2600	470	150	23	130	--
04/05/90	151.84	--	--	--	--	--	--	500	280	29	6.3	19	--
07/02/90	151.84	--	--	--	--	--	--	2400	670	110	17	76	--
10/03/90	151.84	--	--	--	--	--	--	--	--	--	--	--	--
10/25/90	151.84	135.24	16.60	--	--	--	--	1300	390	47	9.0	58	--
01/22/91	151.84	135.15	16.69	--	--	--	--	2600	680	88	29	130	--
02/21/91	151.84	135.53	16.31	--	--	--	--	--	--	--	--	--	--
04/01/91	151.84	136.76	15.08	--	--	--	--	--	--	--	--	--	--
04/11/91	151.84	136.61	15.23	--	--	--	--	--	--	--	--	--	--
07/01/91	151.84	135.88	15.96	--	--	--	--	--	--	--	--	--	--
09/24/91	151.84	135.33	16.51	--	--	--	--	--	--	--	--	--	--
10/23/91	151.84	135.18	16.66	--	--	--	--	3600	1400	63	6.9	63	--
11/22/91	151.84	135.47	16.37	--	--	--	--	--	--	--	--	--	--
01/09/92	151.84	136.28	15.56	--	--	--	--	7100	770	740	190	690	--
03/06/92	151.84	137.47	14.37	--	--	--	--	3200	250	230	59	220	--
06/04/92	151.84	136.80	15.04	--	--	--	--	1500	<0.5	180	42	130	--
09/28/92	151.84	135.44	16.40	--	--	--	--	6400	940	230	57	220	--
12/17/92	151.84	136.46	15.38	--	--	--	--	1500	370	160	6.0	25	--
04/29/93	151.84	136.87	14.97	--	--	--	--	1800	690	120	74	140	--
07/29/93	151.84	136.92	14.92	--	--	--	--	4300	1500	96	29	96	--
10/22/93	151.84	136.03	15.81	--	--	--	--	820	560	57	15	58	--
01/24/94	151.84	--	--	--	--	--	--	--	--	--	--	--	--
04/11/94	151.84	136.49	15.35	--	--	--	--	2000	240	48	36	110	--
07/01/94	151.84	136.44	15.40	--	--	--	--	370	55	12	3.1	8.6	--
10/06/94	151.84	135.84	16.00	--	--	--	--	150	47	4.8	1.8	5.4	--
01/11/95	151.84	137.06	14.78	--	--	--	--	52	0.65	<0.5	<0.5	<0.5	--
04/07/95	151.84	138.93	12.91	--	--	--	--	1500	260	64	52	85	--
07/20/95	151.84	136.81	15.03	--	--	--	--	3000	500	100	96	110	--
09/22/95	151.84	137.05	14.79	--	--	--	--	2000	630	120	20	79	--

CONTINUED ON NEXT PAGE

Cumulative Table of Well Data and Analytical Results

Vertical Measurements are in feet.			Volumetric Measurements are in gallons.				Analytical results are in parts per billion (ppb)						
DATE	Well Head Elev.	Ground Water Elev.	Depth To Water	SPH Thickness	SPH Removed	Total SPH Removed	Notes	TPH-Gasoline	Benzene	Toluene	Ethyl-Benzene	Xylene	MTBE
C-2 (CONT'D)													
01/02/96	151.84	137.37	14.47	--	--	--	--	1900	240	110	58	180	<12
04/26/96	151.84	137.97	13.87	--	--	--	--	1300	340	190	44	120	--
07/22/96	151.84	136.73	15.11	--	--	--	--	3700	1100	140	150	330	--
10/17/96	151.84	136.80	15.04	--	--	--	--	22,000	3900	1600	350	1800	--
01/23/97	151.84	138.86	12.98	--	--	--	--	2000	260	48	76	94	--
07/10/97	151.84	137.21	14.63	--	--	--	--	5100	710	200	190	380	--
01/15/98	153.36	--	--	--	--	--	Inaccessible	--	--	--	--	--	--
01/16/98	151.84	138.61	13.23	--	--	--	--	7600	1600	130	320	650	--
07/09/98	151.84	138.17	13.67	--	--	--	--	10,000	1100	410	180	410	--
01/08/99	151.84	--	--	--	--	--	Abandoned	--	--	--	--	--	--

Cumulative Table of Well Data and Analytical Results

Vertical Measurements are in feet.			Volumetric Measurements are in gallons.				Analytical results are in parts per billion (ppb).						
DATE	Well Head Elev.	Ground Water Elev.	Depth To Water	SPH Thickness	SPH Removed	Total SPH Removed	Notes	TPH-Gasoline	Benzene	Toluene	Ethyl-Benzene	Xylene	MTBE
C-3													
10/23/86	154.13	--	--	--	--	--	--	3300	49	24	--	20	--
09/10/87	154.13	--	--	--	--	--	--	200	110	2.6	<2.0	<2.0	--
10/16/89	154.13	--	--	--	--	--	--	900	640	4.2	1.6	16	--
01/04/90	154.13	--	--	--	--	--	--	920	430	7.0	6.0	7.0	--
04/05/90	154.13	--	--	--	--	--	--	930	690	3.4	5.1	4.8	--
07/02/90	154.13	--	--	--	--	--	--	1700	590	11	4.8	9.4	--
10/03/90	154.13	134.97	19.16	--	--	--	--	--	--	--	--	--	--
10/25/90	154.13	134.85	19.28	--	--	--	--	750	510	2.0	6.0	5.0	--
01/22/91	154.13	134.95	19.18	--	--	--	--	430	260	2.0	2.0	5.0	--
01/22/91	154.13	134.95	19.18	--	--	--	--	400	250	2.0	2.0	5.0	--
02/21/91	154.13	135.25	18.88	--	--	--	--	--	--	--	--	--	--
04/01/91	154.13	136.54	17.59	--	--	--	--	--	--	--	--	--	--
04/11/91	154.13	136.32	17.81	--	--	--	--	--	--	--	--	--	--
07/01/91	154.13	135.57	18.56	--	--	--	--	--	--	--	--	--	--
09/24/91	154.13	135.01	19.12	--	--	--	--	260	52	0.7	0.8	2.2	--
10/23/91	154.13	134.89	19.24	--	--	--	--	--	--	--	--	--	--
11/22/91	154.13	135.10	19.03	--	--	--	--	--	--	--	--	--	--
01/09/92	154.13	135.90	18.23	--	--	--	--	240	120	0.9	<0.5	1.6	--
03/06/92	154.13	137.09	17.04	--	--	--	--	230	68	1.2	1.2	1.3	--
06/04/92	154.13	136.34	17.79	--	--	--	--	80	36	0.6	0.5	0.7	--
09/28/92	154.13	135.13	19.00	--	--	--	--	84	49	<0.5	<0.5	1.5	--
12/17/92	154.13	135.95	18.18	--	--	--	--	220	30	<0.5	<0.5	<0.5	--
04/29/93	154.13	135.35	18.78	--	--	--	--	380	12	0.6	<0.5	<1.5	--
07/26/93	154.13	136.41	17.72	--	--	--	--	800	38	1.1	<0.5	<1.5	--
10/22/93	154.13	135.63	18.50	--	--	--	--	200	64	0.6	<0.5	<1.5	--
01/24/94	154.13	135.62	18.51	--	--	--	--	<50	<0.5	<0.5	<0.5	<0.5	--
04/11/94	154.13	136.09	18.04	--	--	--	--	100	3.6	2.1	<0.5	2.3	--
07/01/94	154.13	136.01	18.12	--	--	--	--	140	3.7	1.2	<0.5	1.0	--
10/06/94	154.13	135.50	18.63	--	--	--	--	<50	<0.5	<0.5	<0.5	<0.5	--

CONTINUED ON NEXT PAGE

Cumulative Table of Well Data and Analytical Results

Vertical Measurements are in feet.				Volumetric Measurements are in gallons.			Analytical results are in parts per billion (ppb)						
DATE	Well Head Elev.	Ground Water Elev.	Depth To Water	SPH Thickness	SPH Removed	Total SPH Removed	Notes	TPH-Gasoline	Benzene	Toluene	Ethyl-Benzene	Xylene	MTBE
C-3 (CONT'D)													
01/11/95	154.13	137.01	17.12	--	--	--	--	<50	<0.5	<0.5	<0.5	<0.5	--
04/07/95	154.13	138.34	15.79	--	--	--	--	<50	<0.5	<0.5	<0.5	<0.5	--
07/20/95	154.13	136.37	17.76	--	--	--	--	<50	1.5	1.9	<0.5	3.5	--
09/22/95	154.13	136.58	17.55	--	--	--	--	<50	<0.5	<0.5	<0.5	<0.5	--
01/02/96	154.13	136.88	17.25	--	--	--	--	<50	<0.5	<0.5	<0.5	1.1	<2.5
04/26/96	154.13	137.42	16.71	--	--	--	--	<50	<0.5	<0.5	<0.5	<0.5	--
07/22/96	154.13	136.50	17.63	--	--	--	--	<50	<0.5	<0.5	<0.5	<0.5	--
10/17/96	154.13	136.33	17.80	--	--	--	--	<50	<0.5	<0.5	<0.5	<0.5	--
01/23/97	154.13	138.33	15.80	--	--	--	--	<50	<0.5	<0.5	<0.5	<0.5	--
07/10/97	154.13	136.63	17.50	--	--	--	--	<50	<0.5	<0.5	<0.5	<0.5	--
01/15/98	154.13	137.98	16.15	--	--	--	--	<50	<0.5	<0.5	<0.5	<0.5	--
01/16/98	154.13	138.04	16.09	--	--	--	Regauge	--	--	--	--	--	--
07/09/98	154.13	137.57	16.56	--	--	--	--	<50	<0.5	<0.5	<0.5	<0.5	--
01/08/99	154.13	--	--	--	--	--	Abandoned	--	--	--	--	--	--

Cumulative Table of Well Data and Analytical Results

Vertical Measurements are in feet.			Volumetric Measurements are in gallons.				Analytical results are in parts per billion (ppb)						
DATE	Well Head Elev.	Ground Water Elev.	Depth To Water	SPH Thickness	SPH Removed	Total SPH Removed	Notes	TPH-Gasoline	Benzene	Toluene	Ethyl-Benzene	Xylene	MTBE
C-4													
10/23/86	156.00	--	--	--	--	--	--	570	3.0	4.0	--	5.0	--
09/10/87	156.00	--	--	--	--	--	--	500	3.0	<0.5	<0.5	<0.5	--
10/16/89	156.00	--	--	--	--	--	--	<500	12	1.0	<0.5	0.8	--
01/04/90	156.00	--	--	--	--	--	--	<500	5.0	<0.5	<0.5	0.9	--
04/05/90	156.00	--	--	--	--	--	--	<50	6.6	<0.5	<0.5	0.7	--
07/02/90	156.00	--	--	--	--	--	--	71	4.1	<0.5	<0.5	<0.5	--
10/03/90	156.00	--	--	--	--	--	--	--	--	--	--	--	--
10/25/90	156.00	135.57	20.43	--	--	--	--	<50	2.0	<0.5	<0.5	<0.5	--
01/22/91	156.00	135.50	20.50	--	--	--	--	<50	3.0	<0.5	<0.5	<0.5	--
02/21/91	156.00	135.77	20.23	--	--	--	--	--	--	--	--	--	--
04/01/91	156.00	136.97	19.03	--	--	--	--	--	--	--	--	--	--
04/11/91	156.00	136.95	19.05	--	--	--	--	--	--	--	--	--	--
07/01/91	156.00	136.10	19.90	--	--	--	--	--	--	--	--	--	--
09/24/91	156.00	135.59	20.41	--	--	--	--	87	1.6	<0.5	<0.5	<0.5	--
10/23/91	156.00	135.47	20.53	--	--	--	--	--	--	--	--	--	--
11/22/91	156.00	135.65	20.35	--	--	--	--	--	--	--	--	--	--
01/09/92	156.00	136.46	19.54	--	--	--	--	51	4.3	<0.5	<0.5	<0.5	--
01/09/92	156.00	136.46	19.54	--	--	--	--	<50	4.8	<0.5	<0.5	<0.5	--
03/06/92	156.00	137.74	18.26	--	--	--	--	<50	0.8	<0.5	<0.5	<0.5	--
06/04/92	156.00	137.08	18.92	--	--	--	--	<50	<0.5	<0.5	<0.5	0.7	--
09/28/92	156.00	135.69	20.31	--	--	--	--	<50	<0.5	<0.5	<0.5	<0.5	--
12/17/92	156.00	136.43	19.57	--	--	--	--	<50	<0.5	<0.5	<0.5	<0.5	--
04/29/93	156.00	138.22	17.78	--	--	--	--	<50	<0.5	<0.5	<0.5	<1.5	--
07/26/93	156.00	--	--	--	--	--	--	--	--	--	--	--	--
08/18/93	156.00	137.09	18.91	--	--	--	--	<50	<0.5	<0.5	<0.5	<1.5	--
10/22/93	156.00	136.61	19.39	--	--	--	--	<50	2.9	2.1	1.1	4.3	--
01/24/94	156.00	136.58	19.42	--	--	--	--	<50	<0.5	<0.5	<0.5	<0.5	--
04/11/94	156.00	136.86	19.14	--	--	--	--	<50	<0.5	0.6	<0.5	0.5	--
07/01/94	156.00	136.80	19.20	--	--	--	--	<50	<0.5	<0.5	<0.5	<0.5	--
10/06/94	156.00	136.26	19.74	--	--	--	--	<50	<0.5	<0.5	<0.5	<0.5	--

CONTINUED ON NEXT PAGE

Cumulative Table of Well Data and Analytical Results

Vertical Measurements are in feet.			Volumetric Measurements are in gallons.				Analytical results are in parts per billion (ppb)						
DATE	Well Head Elev.	Ground Water Elev.	Depth To Water	SPH Thickness	SPH Removed	Total SPH Removed	Notes	TPH-Gasoline	Benzene	Toluene	Ethyl-Benzene	Xylene	MTBE
C-4 (CONT'D)													
01/11/95	156.00	139.70	16.30	--	--	--	--	<50	<0.5	<0.5	<0.5	<0.5	--
04/07/95	156.00	139.49	16.51	--	--	--	--	<50	<0.5	<0.5	<0.5	<0.5	--
07/20/95	156.00	137.20	18.80	--	--	--	--	<50	<0.5	<0.5	<0.5	<0.5	--
09/22/95	156.00	137.26	18.74	--	--	--	--	<50	<0.5	<0.5	<0.5	<0.5	--
01/02/96	156.00	137.65	18.35	--	--	--	--	<50	1.6	1.8	0.95	4.1	<2.5
04/26/96	156.00	138.43	17.57	--	--	--	--	<50	<0.5	<0.5	<0.5	<0.5	--
07/22/96	156.00	137.00	19.00	--	--	--	--	<50	<0.5	<0.5	<0.5	<0.5	--
10/17/96	156.00	136.96	19.04	--	--	--	--	<50	<0.5	<0.5	<0.5	<0.5	--
01/23/97	156.00	139.31	16.69	--	--	--	--	<50	<0.5	<0.5	<0.5	<0.5	--
07/10/97	156.00	137.46	18.54	--	--	--	Sampled annually	--	--	--	--	--	--
01/15/98	156.00	143.92	12.08	--	--	--	--	<50	1.0	1.4	<0.5	3.5	--
01/16/98	156.00	138.84	17.16	--	--	--	Regauge	--	--	--	--	--	--
07/09/98	156.00	138.29	17.71	--	--	--	--	--	--	--	--	--	--
01/08/99	156.00	139.19	16.81	--	--	--	--	<50	<0.5	<0.5	<0.5	<0.5	--
07/09/99	156.00	--	--	--	--	--	Unable to locate	--	--	--	--	--	--

Cumulative Table of Well Data and Analytical Results

Vertical Measurements are in feet.			Volumetric Measurements are in gallons.				Analytical results are in parts per billion (ppb)						
DATE	Well Head Elev.	Ground Water Elev.	Depth To Water	SPH Thickness	SPH Removed	Total SPH Removed	Notes	TPH-Gasoline	Benzene	Toluene	Ethyl-Benzene	Xylene	MTBE
C-5													
10/03/90	153.38	135.60	17.78	--	--	--	--	<50	<0.5	<0.5	<0.5	<0.5	--
10/25/90	153.38	135.46	17.92	--	--	--	--	<50	<0.5	<0.5	<0.5	<0.5	--
11/09/90	153.38	135.46	17.92	--	--	--	--	<50	<0.5	<0.5	<0.5	<0.5	--
01/22/91	153.38	135.58	17.80	--	--	--	--	<50	<0.5	<0.5	<0.5	<0.5	--
02/21/91	153.38	135.87	17.51	--	--	--	--	--	--	--	--	--	--
04/01/91	153.38	137.07	16.31	--	--	--	--	--	--	--	--	--	--
04/11/91	153.38	137.02	16.36	--	--	--	--	--	--	--	--	--	--
07/01/91	153.38	136.26	17.12	--	--	--	--	--	--	--	--	--	--
09/24/91	153.38	135.68	17.70	--	--	--	--	<50	<0.5	<0.5	<0.5	<0.5	--
09/24/91	153.38	135.68	17.70	--	--	--	--	<50	<0.5	<0.5	<0.5	<0.5	--
10/23/91	153.38	135.56	17.82	--	--	--	--	--	--	--	--	--	--
11/22/91	153.38	135.77	17.61	--	--	--	--	--	--	--	--	--	--
01/09/92	153.38	136.34	17.04	--	--	--	--	<50	<0.5	0.7	<0.5	<0.5	--
03/06/92	153.38	137.62	15.76	--	--	--	--	<50	<0.5	<0.5	<0.5	<0.5	--
06/04/92	153.38	136.98	16.40	--	--	--	--	<50	<0.5	<0.5	<0.5	<0.5	--
09/28/92	153.38	135.80	17.58	--	--	--	--	<50	<0.5	<0.5	<0.5	<0.5	--
12/17/92	153.38	136.56	16.82	--	--	--	--	<50	<0.5	<0.5	<0.5	<0.5	--
04/29/93	153.38	138.14	15.24	--	--	--	--	<50	<0.5	<0.5	<0.5	<1.5	--
07/26/93	153.38	137.08	16.30	--	--	--	--	<50	<0.5	<0.5	<0.5	<1.5	--
10/22/93	153.38	136.30	17.08	--	--	--	--	52	2.3	2.7	1.1	5.2	--
01/24/94	153.38	136.25	17.13	--	--	--	--	<50	<0.5	<0.5	<0.5	<0.5	--
04/11/94	153.38	136.75	16.63	--	--	--	--	<50	<0.5	0.7	<0.5	0.6	--
07/01/94	153.38	136.73	16.65	--	--	--	--	<50	<0.5	<0.5	<0.5	<0.5	--
10/06/94	153.38	136.16	17.22	--	--	--	--	<50	<0.5	<0.5	<0.5	<0.5	--
01/11/95	153.38	137.41	15.97	--	--	--	--	<50	<0.5	<0.5	<0.5	<0.5	--
04/07/95	153.38	139.37	14.01	--	--	--	--	<50	<0.5	<0.5	<0.5	<0.5	--
07/20/95	153.38	137.17	16.21	--	--	--	--	<50	<0.5	<0.5	<0.5	0.61	--
09/22/95	153.38	137.07	16.31	--	--	--	--	62	<0.5	<0.5	<0.5	<0.5	--
01/02/96	153.38	137.56	15.82	--	--	--	--	<50	<0.5	<0.5	<0.5	<0.5	--
04/26/96	153.38	138.41	14.97	--	--	--	--	<50	<0.5	<0.5	<0.5	<0.5	<2.5
07/22/96	153.38	137.06	16.32	--	--	--	--	<50	<0.5	<0.5	<0.5	<0.5	--
10/17/96	153.38	136.88	16.50	--	--	--	--	<50	<0.5	<0.5	<0.5	<0.5	--
01/23/97	153.38	139.18	14.20	--	--	--	--	<50	<0.5	<0.5	<0.5	<0.5	--
07/10/97	153.38	--	--	--	--	--	Abandoned	--	--	--	--	--	--

Cumulative Table of Well Data and Analytical Results

Vertical Measurements are in feet.			Volumetric Measurements are in gallons.				Analytical results are in parts per billion (ppb)						
DATE	Well Head Elev.	Ground Water Elev.	Depth To Water	SPH Thickness	SPH Removed	Total SPH Removed	Notes	TPH-Gasoline	Benzene	Toluene	Ethyl-Benzene	Xylene	MTBE
C-6													
10/03/90	152.84	134.70	18.14	--	--	--	--	<50	<0.5	<0.5	<0.5	<0.5	--
10/25/90	152.84	134.55	18.29	--	--	--	--	<50	<0.5	1.0	<0.5	<0.5	--
11/09/90	152.84	134.58	18.26	--	--	--	--	<50	<0.5	<0.5	<0.5	<0.5	--
01/22/91	152.84	134.69	18.15	--	--	--	--	<50	<0.5	<0.5	<0.5	<0.5	--
02/21/91	152.84	134.92	17.92	--	--	--	--	--	--	--	--	--	--
04/01/91	152.84	135.73	17.11	--	--	--	--	--	--	--	--	--	--
04/11/91	152.84	135.83	17.01	--	--	--	--	--	--	--	--	--	--
07/01/91	152.84	135.12	17.72	--	--	--	--	--	--	--	--	--	--
09/24/91	152.84	135.72	17.12	--	--	--	--	<50	<0.5	<0.5	<0.5	<0.5	--
10/23/91	152.84	134.59	18.25	--	--	--	--	--	--	--	--	--	--
11/22/91	152.84	134.79	18.05	--	--	--	--	--	--	--	--	--	--
01/09/92	152.84	135.42	17.42	--	--	--	--	<50	<0.5	<0.5	<0.5	<0.5	--
03/06/92	152.84	136.33	16.51	--	--	--	--	<50	<0.5	<0.5	<0.5	<0.5	--
06/04/92	152.84	135.83	17.01	--	--	--	--	<50	<0.5	<0.5	<0.5	<0.5	--
09/28/92	152.84	134.84	18.00	--	--	--	--	<50	<0.5	<0.5	<0.5	<0.5	--
12/17/92	152.84	135.58	17.26	--	--	--	--	<50	<0.5	<0.5	<0.5	<0.5	--
04/29/93	152.84	136.61	16.23	--	--	--	--	<50	<0.5	<0.5	<0.5	<1.5	--
07/29/93	152.84	135.88	16.96	--	--	--	--	<50	<0.5	<0.5	<0.5	<1.5	--
10/22/93	152.84	135.38	17.46	--	--	--	--	74	7.4	6.1	3.3	9.7	--
01/24/94	152.84	135.38	17.46	--	--	--	--	<50	<0.5	<0.5	<0.5	<0.5	--
04/11/94	152.84	135.64	17.20	--	--	--	--	<50	<0.5	<0.5	<0.5	<0.5	--
07/01/94	152.84	135.66	17.18	--	--	--	--	<50	<0.5	<0.5	<0.5	<0.5	--
10/06/94	152.84	135.19	17.65	--	--	--	--	<50	<0.5	<0.5	<0.5	<0.5	--
01/11/95	152.84	136.18	16.66	--	--	--	--	<50	<0.5	<0.5	<0.5	<0.5	--
04/07/95	152.84	137.25	15.59	--	--	--	--	<50	<0.5	<0.5	<0.5	<0.5	--
07/20/95	152.84	135.80	17.04	--	--	--	--	<50	<0.5	<0.5	<0.5	<0.5	--
09/22/95	152.84	135.74	17.10	--	--	--	--	<50	<0.5	<0.5	<0.5	<0.5	--
01/02/96	152.84	136.08	16.76	--	--	--	--	<50	<0.5	<0.5	<0.5	<0.5	<2.5
04/26/96	152.84	136.64	16.20	--	--	--	--	<50	<0.5	<0.5	<0.5	<0.5	--
07/22/96	152.84	135.79	17.05	--	--	--	--	<50	<0.5	<0.5	<0.5	<0.5	--
10/17/96	152.84	135.62	17.22	--	--	--	--	<50	<0.5	<0.5	<0.5	<0.5	--

CONTINUED ON NEXT PAGE

Cumulative Table of Well Data and Analytical Results

Vertical Measurements are in feet.			Volumetric Measurements are in gallons.				Analytical results are in parts per billion (ppb)						
DATE	Well Head Elev.	Ground Water Elev.	Depth To Water	SPH Thickness	SPH Removed	Total SPH Removed	Notes	TPH-Gasoline	Benzene	Toluene	Ethyl-Benzene	Xylene	MTBE
C-6 (CONT'D)													
01/23/97	152.84	136.99	15.85	--	--	--	--	<50	<0.5	<0.5	<0.5	<0.5	--
07/10/97	152.84	135.95	16.89	--	--	--	--	<50	<0.5	<0.5	<0.5	<0.5	--
01/15/98	152.84	136.64	16.20	--	--	--	--	<50	<0.5	<0.5	<0.5	<0.5	--
01/16/98	152.84	136.74	16.10	--	--	--	Regauge	--	--	--	--	--	--
07/09/98	152.84	136.71	16.13	--	--	--	--	<50	<0.5	<0.5	<0.5	<0.5	--
01/08/99	152.84	137.57	15.27	--	--	--	--	<50	<0.5	<0.5	<0.5	<0.5	--
07/09/99	152.84	136.60	16.24	--	--	--	--	<50	<0.5	<0.5	<0.5	<0.5	<5.0

Cumulative Table of Well Data and Analytical Results

Vertical Measurements are in feet.				Volumetric Measurements are in gallons.			Analytical results are in parts per billion (ppb)						
DATE	Well Head Elev.	Ground Water Elev.	Depth To Water	SPH Thickness	SPH Removed	Total SPH Removed	Notes	TPH-Gasoline	Benzene	Toluene	Ethyl-Benzene	Xylene	MTBE
C-7													
10/03/90	155.34	134.52	20.82	--	--	--	--	<50	<0.5	<0.5	<0.5	<0.5	--
10/25/90	155.34	134.43	20.91	--	--	--	--	<50	<0.5	1.0	<0.5	<0.5	--
11/09/90	155.34	134.40	20.94	--	--	--	--	<50	<0.5	<0.5	<0.5	<0.5	--
01/22/91	155.34	133.84	21.50	--	--	--	--	<50	4.0	<0.5	<0.5	<0.5	--
02/21/91	155.34	134.63	20.71	--	--	--	--	--	--	--	--	--	--
04/01/91	155.34	135.34	20.00	--	--	--	--	--	--	--	--	--	--
04/11/91	155.34	135.29	20.05	--	--	--	--	--	--	--	--	--	--
07/01/91	155.34	134.82	20.52	--	--	--	--	--	--	--	--	--	--
09/24/91	155.34	134.52	20.82	--	--	--	--	<50	<0.5	<0.5	<0.5	<0.5	--
10/23/91	155.34	134.43	20.91	--	--	--	--	--	--	--	--	--	--
11/22/91	155.34	134.55	20.79	--	--	--	--	--	--	--	--	--	--
01/09/92	155.34	135.18	20.16	--	--	--	--	<50	<0.5	<0.5	<0.5	0.9	--
03/06/92	155.34	135.92	19.42	--	--	--	--	<50	<0.5	<0.5	<0.5	<0.5	--
06/04/92	155.34	135.53	19.81	--	--	--	--	250	<0.5	<0.5	<0.5	<0.5	--
09/28/92	155.34	134.69	20.65	--	--	--	--	<50	<0.5	<0.5	<0.5	<0.5	--
12/17/92	155.34	135.32	20.02	--	--	--	--	<50	<0.5	<0.5	<0.5	<0.5	--
04/29/93	155.34	136.19	19.15	--	--	--	--	<50	<0.5	<0.5	<0.5	<1.5	--
07/26/93	155.34	135.57	19.77	--	--	--	--	<50	<0.5	<0.5	<0.5	<1.5	--
10/22/93	155.34	135.17	20.17	--	--	--	--	--	--	--	--	--	--
01/24/94	155.34	135.11	20.23	--	--	--	--	<50	<0.5	<0.5	<0.5	<0.5	--
04/11/94	155.34	135.39	19.95	--	--	--	--	<50	<0.5	<0.5	<0.5	<0.5	--
07/01/94	155.34	135.42	19.92	--	--	--	--	<50	<0.5	<0.5	<0.5	<0.5	--
10/06/94	155.34	135.03	20.31	--	--	--	--	<50	<0.5	<0.5	<0.5	<0.5	--
01/11/95	155.34	135.98	19.36	--	--	--	--	<50	<0.5	<0.5	<0.5	<0.5	--
04/07/95	155.34	136.84	18.50	--	--	--	--	<50	<0.5	<0.5	<0.5	<0.5	--
07/20/95	155.34	135.46	19.88	--	--	--	--	<50	<0.5	<0.5	<0.5	<0.5	--
09/22/95	155.34	135.38	19.96	--	--	--	--	<50	<0.5	<0.5	<0.5	<0.5	--
01/02/96	155.34	135.64	19.70	--	--	--	--	<50	<0.5	<0.5	<0.5	<0.5	<2.5
04/26/96	155.34	136.17	19.17	--	--	--	--	<50	<0.5	<0.5	<0.5	<0.5	--
07/22/96	155.34	135.49	19.85	--	--	--	--	<50	<0.5	<0.5	<0.5	<0.5	--
10/17/96	155.34	135.34	20.00	--	--	--	--	<50	<0.5	<0.5	<0.5	<0.5	--

CONTINUED ON NEXT PAGE

Cumulative Table of Well Data and Analytical Results

Vertical Measurements are in feet.			Volumetric Measurements are in gallons.				Analytical results are in parts per billion (ppb)						
DATE	Well Head Elev.	Ground Water Elev.	Depth To Water	SPH Thickness	SPH Removed	Total SPH Removed	Notes	TPH-Gasoline	Benzene	Toluene	Ethyl-Benzene	Xylene	MTBE
C-7 (CONT'D)													
01/23/97	155.34	136.44	18.90	--	--	--	--	<50	<0.5	<0.5	<0.5	<0.5	--
07/10/97	155.34	135.58	19.76	--	--	--	--	<50	<0.5	<0.5	<0.5	<0.5	--
01/15/98	155.34	136.02	19.32	--	--	--	--	<50	<0.5	<0.5	<0.5	<0.5	--
01/16/98	155.34	136.14	19.20	--	--	--	Regauge	--	--	--	--	--	--
07/09/98	155.34	136.02	19.32	--	--	--	--	<50	<0.5	<0.5	<0.5	<0.5	--
01/08/99	155.34	136.83	18.51	--	--	--	--	<50	<0.5	<0.5	<0.5	<0.5	--
07/09/99	155.34	136.16	19.18	--	--	--	--	<50	<0.5	<0.5	<0.5	<0.5	<5.0

Cumulative Table of Well Data and Analytical Results

Vertical Measurements are in feet.

Volumetric Measurements are in gallons.

Analytical results are in parts per billion (ppb)

DATE	Well Head Elev.	Ground Water Elev.	Depth To Water	SPH Thickness	SPH Removed	Total SPH Removed	Notes	TPH-Gasoline	Benzene	Toluene	Ethyl-Benzene	Xylene	MTBE
TRIP BLANK													
10/03/90	--	--	--	--	--	--	--	<50	<0.5	<0.5	<0.5	<0.5	--
10/25/90	--	--	--	--	--	--	--	<50	<0.5	<0.5	<0.5	<0.5	--
11/09/90	--	--	--	--	--	--	--	<50	<0.5	<0.5	<0.5	<0.5	--
01/22/91	--	--	--	--	--	--	--	<50	<0.5	<0.5	<0.5	<0.5	--
09/24/91	--	--	--	--	--	--	--	<50	<0.5	<0.5	<0.5	<0.5	--
01/09/92	--	--	--	--	--	--	--	<50	<0.5	<0.5	<0.5	<0.5	--
03/06/92	--	--	--	--	--	--	--	<50	<0.5	<0.5	<0.5	<0.5	--
06/04/92	--	--	--	--	--	--	--	<50	<0.5	<0.5	<0.5	<0.5	--
09/28/92	--	--	--	--	--	--	--	<50	<0.5	<0.5	<0.5	<0.5	--
12/17/92	--	--	--	--	--	--	--	<50	<0.5	<0.5	<0.5	<0.5	--
04/29/93	--	--	--	--	--	--	--	<50	<0.5	<0.5	<0.5	<1.5	--
07/26/93	--	--	--	--	--	--	--	<50	<0.5	<0.5	<0.5	<1.5	--
10/22/93	--	--	--	--	--	--	--	<50	<0.5	<0.5	<0.5	<1.5	--
01/24/94	--	--	--	--	--	--	--	<50	<0.5	<0.5	<0.5	<0.5	--
04/11/94	--	--	--	--	--	--	--	<50	<0.5	<0.5	<0.5	<0.5	--
07/01/94	--	--	--	--	--	--	--	<50	<0.5	<0.5	<0.5	<0.5	--
10/06/94	--	--	--	--	--	--	--	<50	<0.5	<0.5	<0.5	<0.5	--
01/11/95	--	--	--	--	--	--	--	<50	<0.5	<0.5	<0.5	<0.5	--
04/07/95	--	--	--	--	--	--	--	<50	<0.5	<0.5	<0.5	<0.5	--
07/20/95	--	--	--	--	--	--	--	<50	<0.5	<0.5	<0.5	<0.5	--
09/22/95	--	--	--	--	--	--	--	<50	<0.5	<0.5	<0.5	<0.5	--
01/02/96	--	--	--	--	--	--	--	<50	<0.5	<0.5	<0.5	<0.5	--
04/26/96	--	--	--	--	--	--	--	<50	<0.5	<0.5	<0.5	<0.5	--
07/22/96	--	--	--	--	--	--	--	<50	<0.5	<0.5	<0.5	<0.5	--
10/17/96	--	--	--	--	--	--	--	<50	<0.5	<0.5	<0.5	<0.5	--

CONTINUED ON NEXT PAGE

Cumulative Table of Well Data and Analytical Results

Vertical Measurements are in feet.			Volumetric Measurements are in gallons.				Analytical results are in parts per billion (ppb)						
DATE	Well Head Elev.	Ground Water Elev.	Depth To Water	SPH Thickness	SPH Removed	Total SPH Removed	Notes	TPH-Gasoline	Benzene	Toluene	Ethyl-Benzene	Xylene	MTBE
TRIP BLANK (CONT'D)													
01/23/97	--	--	--	--	--	--	--	<50	<0.5	<0.5	<0.5	<0.5	--
07/10/97	--	--	--	--	--	--	--	<50	<0.5	<0.5	<0.5	<0.5	--
01/15/98	--	--	--	--	--	--	--	<50	<0.5	<0.5	<0.5	<0.5	--
07/09/98	--	--	--	--	--	--	--	<50	<0.5	<0.5	<0.5	<0.5	--
01/08/99	--	--	--	--	--	--	--	<50	<0.5	<0.5	<0.5	<0.5	--

Note: Blaine Tech Services, Inc. began routine monitoring of the groundwater wells at this site on November 1, 1994.
 Earlier field data and analytical results are drawn from the September 27, 1994 Groundwater Technology, Inc. report.

ABBREVIATIONS:

TPH = Total Petroleum Hydrocarbons
 SPH = Separate-Phase Hydrocarbons
 MTBE = Methyl t-butyl ether

Analytical Appendix



July 23, 1999

Christine Lillie
Blaine Tech Services
1680 Rogers Avenue
San Jose, CA 95112

RE: Chevron(8)

Dear Christine Lillie

Enclosed are the results of analyses for sample(s) received by the laboratory on July 9, 1999. If you have any questions concerning this report, please feel free to contact me.

Sincerely,

for Wayne Stevenson
Project Manager





Blaine Tech Services 1680 Rogers Avenue San Jose, CA 95112	Project: Chevron(8) Project Number: Chevron 9-2960/990709-M2 Project Manager: Christine Lillie	Sampled: 7/9/99 Received: 7/9/99 Reported: 7/23/99 10:56
--	--	--

ANALYTICAL REPORT FOR SAMPLES:

Sample Description	Laboratory Sample Number	Sample Matrix	Date Sampled
C-6	L907114-01	Water	7/9/99
C-7	L907114-02	Water	7/9/99





Blaine Tech Services 1680 Rogers Avenue San Jose, CA 95112	Project: Chevron(8) Project Number: Chevron 9-2960/990709-M2 Project Manager: Christine Lillie	Sampled: 7/9/99 Received: 7/9/99 Reported: 7/23/99 10:56
--	--	--

**C-6
[L907114-01]**

Analyte	Batch Number	Date Prepared	Date Analyzed	Specific Method/ Surrogate Limits	Reporting Limit	Result	Units	Notes*
---------	--------------	---------------	---------------	--------------------------------------	-----------------	--------	-------	--------

Sequoia Analytical - San Carlos

Total Purgeable Hydrocarbons (C6-C12), BTEX and MTBE by DHS LUFT

Purgeable Hydrocarbons as Gasoline	9070064	7/16/99	7/16/99		50.0	ND	ug/l	
Benzene	"	"	"		0.500	ND	"	
Toluene	"	"	"		0.500	ND	"	
Ethylbenzene	"	"	"		0.500	ND	"	
Xylenes (total)	"	"	"		0.500	ND	"	
Methyl tert-butyl ether	"	"	"		5.00	ND	"	
Surrogate: <i>a,a,a</i> -Trifluorotoluene	"	"	"	70.0-130		97.5	%	





Blaine Tech Services 1680 Rogers Avenue San Jose, CA 95112	Project: Chevron(8) Project Number: Chevron 9-2960/990709-M2 Project Manager: Christine Lillie	Sampled: 7/9/99 Received: 7/9/99 Reported: 7/23/99 10:56
--	--	--

**C-7
[L907114-02]**

Analyte	Batch Number	Date Prepared	Date Analyzed	Specific Method/ Surrogate Limits	Reporting Limit	Result	Units	Notes*
---------	--------------	---------------	---------------	--------------------------------------	-----------------	--------	-------	--------

Sequoia Analytical - San Carlos

Total Purgeable Hydrocarbons (C6-C12), BTEX and MTBE by DHS LUFT

Purgeable Hydrocarbons as Gasoline	9070064	7/16/99	7/16/99		50.0	ND	ug/l	
Benzene	"	"	"		0.500	ND	"	
Toluene	"	"	"		0.500	ND	"	
Ethylbenzene	"	"	"		0.500	ND	"	
Xylenes (total)	"	"	"		0.500	ND	"	
Methyl tert-butyl ether	"	"	"		5.00	ND	"	
Surrogate: a,a,a-Trifluorotoluene	"	"	"	70.0-130		85.8	%	





Blaine Tech Services 1680 Rogers Avenue San Jose, CA 95112	Project: Chevron(8) Project Number: Chevron 9-2960/990709-M2 Project Manager: Christine Lillie	Sampled: 7/9/99 Received: 7/9/99 Reported: 7/23/99 10:56
--	--	--

Total Purgeable Hydrocarbons (C6-C12), BTEX and MTBE by DHS LUFT/Quality Control
Sequoia Analytical - San Carlos

Analyte	Date Analyzed	Spike Level	Sample Result	QC Result	Units	Reporting Limit Recov. Limits	Recov. %	RPD Limit	RPD %	Notes*
Batch: 9070064		Date Prepared: 7/16/99			Extraction Method: EPA 5030B [P/T]					
Blank		9070064-BLK1								
Purgeable Hydrocarbons as Gasoline	7/16/99			ND	ug/l	50.0				
Benzene	"			ND	"	0.500				
Toluene	"			ND	"	0.500				
Ethylbenzene	"			ND	"	0.500				
Xylenes (total)	"			ND	"	0.500				
Methyl tert-butyl ether	"			ND	"	5.00				
Surrogate: a,a,a-Trifluorotoluene	"	10.0		9.71	"	70.0-130	97.1			
LCS		9070064-BS1								
Benzene	7/16/99	10.0		8.87	ug/l	70.0-130	88.7			
Toluene	"	10.0		8.10	"	70.0-130	81.0			
Ethylbenzene	"	10.0		7.81	"	70.0-130	78.1			
Xylenes (total)	"	30.0		27.5	"	70.0-130	91.7			
Surrogate: a,a,a-Trifluorotoluene	"	10.0		8.91	"	70.0-130	89.1			
Matrix Spike		9070064-MS1		L907114-01						
Benzene	7/16/99	10.0	ND	8.52	ug/l	60.0-140	85.2			
Toluene	"	10.0	ND	9.59	"	60.0-140	95.9			
Ethylbenzene	"	10.0	ND	7.88	"	60.0-140	78.8			
Xylenes (total)	"	30.0	ND	26.3	"	60.0-140	87.7			
Surrogate: a,a,a-Trifluorotoluene	"	10.0		9.59	"	70.0-130	95.9			
Matrix Spike Dup		9070064-MSD1		L907114-01						
Benzene	7/16/99	10.0	ND	8.77	ug/l	60.0-140	87.7	25.0	2.89	
Toluene	"	10.0	ND	8.12	"	60.0-140	81.2	25.0	16.6	
Ethylbenzene	"	10.0	ND	7.71	"	60.0-140	77.1	25.0	2.18	
Xylenes (total)	"	30.0	ND	26.8	"	60.0-140	89.3	25.0	1.81	
Surrogate: a,a,a-Trifluorotoluene	"	10.0		9.43	"	70.0-130	94.3			





Blaine Tech Services 1680 Rogers Avenue San Jose, CA 95112	Project: Chevron(8) Project Number: Chevron 9-2960/990709-M2 Project Manager: Christine Lillie	Sampled: 7/9/99 Received: 7/9/99 Reported: 7/23/99 10:56
--	--	--

Notes and Definitions

#	Note
---	------

- DET Analyte DETECTED
- ND Analyte NOT DETECTED at or above the reporting limit
- NR Not Reported
- dry Sample results reported on a dry weight basis
- Recov. Recovery
- RPD Relative Percent Difference



Fax copy of Lab Report and COC to Chevron Contact: Yes No

Chain-of-Custody-Record

Chevron Products Co.
 P.O. BOX 6004
 San Ramon, CA 94583
 FAX (925)842-8370

Chevron Facility Number 9-2960 1910-7114
 Facility Address 2416 Grove Wy., Castro Valley
 Consultant Project Number 990709-m2
 Consultant Name BLAINE TECH SERVICE, INC.
 Address 1680 ROGERS AVE., SAN JOSE
 Project Contact (Name) CHRISTINE LILLIE
 (Phone) 408-573-0555 (Fax Number) 408-573-7771

Chevron Contact (Name) PHIL BRIGGS
 (Phone) (925) 842-9136
 Laboratory Name SEQUOIA
 Laboratory Service Order 9144488
 Laboratory Service Code Z202800
 Sample Collected by (Name) Mark Tomlinson
 Signature Mark Tomlinson

State Method: CA OR WA NW Series CO UT

Sample Number	Number of Containers	Matrix S = Soil A = Air W = Water C = Churnood	Sample Preservation	Date/Time	State Method													Remarks		
					BTX/MTBE/TPH GAS (8020 + 8015)	BTX + TPH GAS (8020 + 8015)	TPH Diesel (8015)	Oxygenates (8260)	Purgeable Hydrocarbons (8010)	Purgeable Organics (8280)	Extractable Organics (8270)	Oil and Grease (5520)	Metals (Cd, Cr, Pb, Zn, Ni) (3020)	BTX (8020)	BTX/MTBE/Naph. (8020)	TPH - HClD	TPH-D Extended			
C-6	3	W	Hcl	7-9-99 13:35		X														
C-7	3	W	Hcl	↓ 13:15		X														

SC

By (Signature) <u>[Signature]</u>	Organization <u>BTS</u>	Date/Time <u>7-9-99 15:30</u>	Received By (Signature) <u>[Signature]</u>	Organization <u>SIA</u>	Date/Time <u>7/9/99</u>	lead Y/N	Turn Around Time (Circle Choice) 24 hrs. 48 hrs. 5 Days 10 Days As Contracted
(Signature)	Organization	Date/Time	Received By (Signature) <u>T.J.T.</u>	Organization	Date/Time <u>7/9/99 15:30</u>	lead Y/N	
(Signature)	Organization	Date/Time	Received For Laboratory (Signature)		Date/Time	lead Y/N	

Field Data Sheets

CHEVRON WELL MONITORING DATA SHEET

Project #: 990709-md	Station #: 9-2960
Sampler: MT	Date: 7-9-89
Well I.D.: C-6	Well Diameter: <input checked="" type="radio"/> 3 <input type="radio"/> 4 <input type="radio"/> 6 <input type="radio"/> 8 <input type="radio"/> _____
Total Well Depth: 28.15	Depth to Water: 16.24
Depth to Free Product:	Thickness of Free Product (feet):
Referenced to: PVC Grade	D.O. Meter (if req'd): YSI HACH

Well Diameter	Multiplier	Well Diameter	Multiplier
2"	0.16	5"	1.02
3"	0.37	6"	1.47
4"	0.65	Other	radius ² * 0.165

Purge Method: Bailer
 ~~Disposable Bailer~~
 Middleburg
 Electric Submersible
 Extraction Pump

Sampling Method: Bailer
 ~~Disposable Bailer~~
 Extraction Port

Other: _____

<u>1.9</u>	x	<u>3</u>	=	<u>5.7</u>	Gals.
1 Case Volume (Gals.)		Specified Volumes		Calculated Volume	

Time	Temp (°F)	pH	Cond.	Gals. Removed	Observations
13:20	73.2	7.4	1461	2	
13:23	70.9	7.5	1484	4	
13:28	70.8	7.5	1480	5.75	

Did well dewater? Yes No Gallons actually evacuated: 5.75

Sampling Time: 1:35 Sampling Date: 7-9-89

Sample I.D.: C-6 Laboratory: Sequoia CORE N. Creek Assoc. Labs

Analyzed for: TPH-G BTEX MTBE TPH-D Other: _____

Duplicate I.D.: _____ Analyzed for: TPH-G BTEX MTBE TPH-D Other: _____

D.O. (if req'd):	Pre-purge:	mg/L	Post-purge:	mg/L
O.R.P. (if req'd):	Pre-purge:	mV	Post-purge:	mV

CHEVRON WELL MONITORING DATA SHEET

Project #: 990709-md	Station #: 9-2960
Sampler: MT	Date: 7-9-99
Well I.D.: C-7	Well Diameter: <u>2</u> 3 4 6 8
Total Well Depth: 33.21	Depth to Water: 19.18
Depth to Free Product:	Thickness of Free Product (feet):
Referenced to: PVC Grade	D.O. Meter (if req'd): YSI HACH

Well Diameter	Multitrier	Well Diameter	Multitrier
2"	0.16	5"	1.02
3"	0.37	6"	1.47
4"	0.65	Other	radius ² = 0.163

Purge Method: Bailer
 Disposable Bailer
 Middleburg
 Electric Submersible
 Extraction Pump

Other: _____

Sampling Method: Bailer
 Disposable Bailer
 Extraction Port

Other: _____

<u>2.2</u>	<u>x</u>	<u>3</u>	<u>=</u>	<u>6.6</u>	Gals.
1 Case Volume (Gals.)		Specified Volumes		Calculated Volume	

Time	Temp (°F)	pH	Cond.	Gals. Removed	Observations
B'02	74.1	7.4	1528	2.5	
B'06	72.9	7.4	1542	5	
B'10	71.8	7.3	1540	6.75	

Did well dewater? Yes No Gallons actually evacuated: 6.75

Sampling Time: 1:15 Sampling Date: 7-9-99

Sample I.D.: C-7 Laboratory: Sequoia CORE N. Creek Assoc. Labs

Analyzed for: TPH-G BTEX MTBE TPH-D Other:

Duplicate I.D.: Analyzed for: TPH-G BTEX MTBE TPH-D Other:

D.O. (if req'd):	Pre-purge:	mg/L	Post-purge:	mg/L
O.R.P. (if req'd):	Pre-purge:	mV	Post-purge:	mV