



**Chevron**

November 24, 1993

**Chevron U.S.A. Products Company**  
2410 Camino Ramon  
San Ramon, CA 94583  
P.O. Box 5004  
San Ramon, CA 94583-0804

**Marketing Department**  
Phone 510 842 9500

ALCO  
HAZMAT  
NOV 30 PM 12:59

Mr. Scott Seery  
Alameda County Environmental Health  
80 Swan Way, Room 200  
Oakland, CA 94621

Re : Former Chevron Service Station No. 9-2960  
2416 Grove Way, Castro Valley, CA 94546

Dear Mr. Seery :

All monitoring wells with the exception of well C-1 and C-7 detected traces of dissolved hydrocarbons. Well C-1 contained liquid hydrocarbons with a thickness of 0.03 feet and C-7 was not sampled because of a parked car. The traces of dissolved hydrocarbons in wells C-4, C-5, C-6, and C-7 is inconsistent and is probably anomaly.

The remediation system is currently operating. However, the soil vapor extraction system needs additional modifications.

Please refer to Groundwater Technology's November 23, 1993 quarterly monitoring and sampling report for additional information. If you have any questions or comments, please feel free to call me at (510) 842-8752.

Sincerely,

Chevron U.S.A. Products Co.

Kenneth Kan  
Engineer

LKAN/MacFile 9-2960R14

Enclosure

cc : Mr. Rich Hiatt, RWQCB-S.F.Bay Region  
2101 Webster Street, Suite 500, Oakland, CA 94612

Mr. Bob Yule, First Presbyterian Church  
2490 Grove Way, Castro Valley, CA 94546

Ms. Bette Owen, Chevron U.S.A. Products Co.

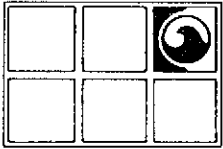

# GROUNDWATER TECHNOLOGY, INC.

4057 Port Chicago Highway, Concord, CA 94520 (415) 671-2387

FAX: (415) 685-9148

November 23, 1993

Project No. 020204087

Mr. Ken Kan  
Chevron U.S.A. Products Company  
2410 Camino Ramon  
San Ramon, CA 94583-0804

ALCO  
HAZMAT  
93 NOV 30 PM 12: 59

SUBJECT: *Groundwater Monitoring and Sampling Activities*  
Chevron Service Station No. 9-2960  
2416 Grove Way, Castro Valley, California

Dear Mr. Kan:

Groundwater Technology, Inc. presents the attached quarterly groundwater monitoring and sampling data collected on October 22, 1993. Six of the seven groundwater monitoring wells at the site were gauged to measure depth to groundwater (DTW) and to check for the presence of separate-phase hydrocarbons. Separate-phase hydrocarbons were detected in monitoring well C-1 at a thickness of 0.03 foot. Monitoring well C-7 was covered by a car. A potentiometric surface map (Figure 1) and a summary of groundwater monitoring data (Table 1) are presented in Attachments 1 and 2, respectively. After the DTW was measured, each monitoring well, except monitoring wells C-1 and C-7, was purged and sampled. The groundwater samples were analyzed for benzene, toluene, ethylbenzene, and xylenes, and for total petroleum hydrocarbons-as-gasoline. Results of the chemical analyses are summarized in Table 1. The laboratory report and chain-of-custody record are included in Attachment 3. Monitoring-well purge water was transported by Groundwater Technology to the Chevron Terminal in Richmond, California, for recycling.

Groundwater Technology is pleased to assist Chevron on this project. If you have any questions or comments, please contact our Concord office at (510) 671-2387.

Sincerely,  
**Groundwater Technology, Inc.**  
Written/Submitted by

**Groundwater Technology, Inc.**  
Reviewed/Approved by

*Tim Watchers*

Tim Watchers  
Project Geologist

*Michael C. Blundell*

Michael C. Blundell  
Registered Geologist  
No. 5146

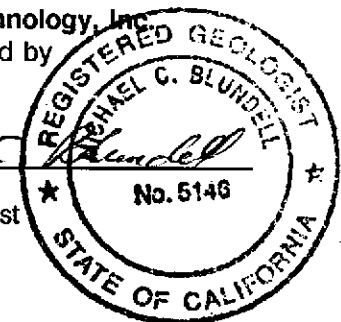

PR *gm*

Attachment 1 Figure  
Attachment 2 Table  
Attachment 3 Laboratory Report

For:  
Wendell W. Lattz  
Vice President, General Manager  
West Region

4087R043.020

**ATTACHMENT 1**

**Figure**

4087R043.020

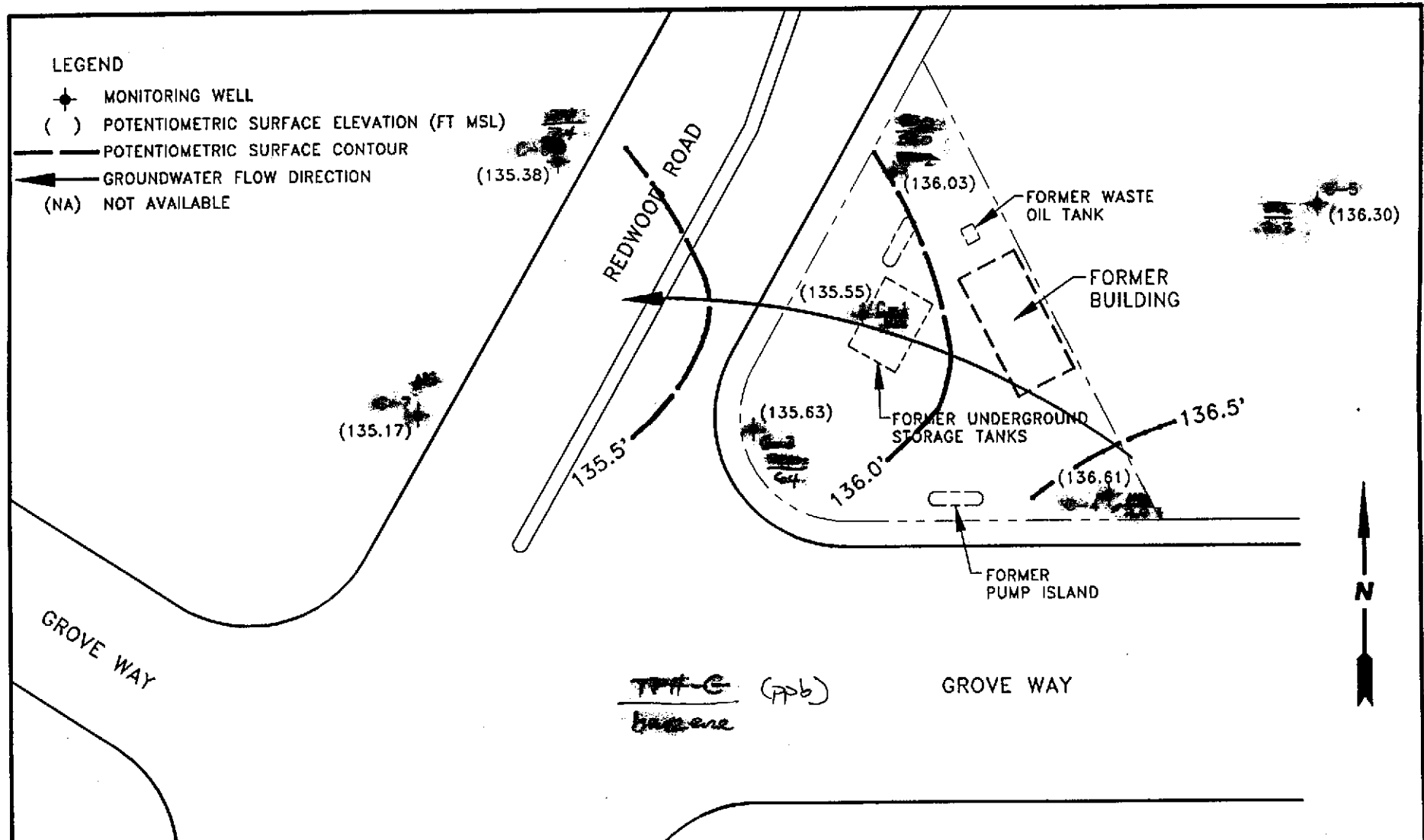

		<b>GROUNDWATER TECHNOLOGY</b> 4057 PORT CHICAGO HWY CONCORD, CA 94520 (510) 671-2387		<b>POTENTIOMETRIC SURFACE MAP</b> <b>(10/22/93)</b>			
CLIENT: CHEVRON U.S.A. PRODUCTS CO. SERVICE STATION No. 8-2960			LOCATION: 2416 GROVE WAY CASTRO VALLEY, CALIFORNIA			REV. NO.: 0	DATE: 11/17/93
PM <i>LHW</i>	PE/RG <i>mt</i>	DESIGNED TW	DETAILED CY	ACAD FILE: PSMN93	PROJECT NO.: 020204115	FIGURE: 1	

**ATTACHMENT 2**

**Table**

**TABLE 1**  
**HISTORICAL GROUNDWATER ANALYTICAL RESULTS AND MONITORING DATA**  
**Chevron Service Station No. 9-2960**  
**2416 Grove Way, Castro Valley, California**

Well ID/ Elev	Date	TPH-G	Benzene	Toluene	Ethyl- Benzene	Xylenes	DTW (ft)	SPT (ft)	WTE (ft)
C-1	10/23/86	3,100	6,400	3,700	--	4,300	--	--	--
	09/10/87	120,000	25,000	60,000	13,000	56,000	--	--	--
153.36	10/03/90	--	--	--	--	--	18.67	--	134.69
	10/25/90	--	--	--	--	--	18.71	0.71	135.22
	01/22/91	--	--	--	--	--	18.70	0.70	135.22
	02/21/91	--	--	--	--	--	18.62	0.65	135.44
	04/01/91	--	--	--	--	--	16.91	0.05	136.47
	04/11/91	--	--	--	--	--	16.90	0.05	136.49
	07/01/91	--	--	--	--	--	17.61	0.05	135.75
	09/24/91	--	--	--	--	--	18.98	0.99	135.17
	10/23/91	--	--	--	--	--	19.32	1.24	135.03
	11/22/91	--	--	--	--	--	18.83	0.97	134.53
	01/09/92	--	--	--	--	--	17.26	--	136.10
	03/06/92	--	--	--	--	--	16.69	0.51	137.16
	06/04/92	--	--	--	--	--	17.10	0.22	136.44
	09/28/92	--	--	--	--	--	18.71	0.77	--
	12/17/92	--	--	--	--	--	17.54	0.45	--
	04/29/93	--	--	--	--	--	16.40	0.88	137.50
07/26/93	--	--	--	--	--	16.85	0.51	136.92	
10/22/93	--	--	--	--	--	17.83	0.08	135.55	



**TABLE 1**  
**HISTORICAL GROUNDWATER ANALYTICAL RESULTS AND MONITORING DATA**  
**Chevron Service Station No. 9-2960**  
**2416 Grove Way, Castro Valley, California**

Well ID/ Elev	Date	TPH-G	Benzene	Toluene	Ethyl- Benzene	Xylenes	DTW (ft)	SPT (ft)	WTE (ft)
C-2	10/23/86	30,000	2,700	1,900	---	1,500	---	---	---
	09/10/87	14,000	2,600	2,900	500	1,200	---	---	---
151.84	10/16/89	600	260	34	1.7	41	---	---	---
	01/04/90	2,600	470	150	23	130	---	---	---
	04/05/90	500	280	29	6.3	19	---	---	---
	07/02/90	2,400	670	110	17	76	---	---	---
	10/03/90	---	---	---	---	---	---	---	---
	10/25/90	1,300	390	47	9	58	16.60	---	135.24
	01/22/91	2,600	680	88	29	130	16.69	---	135.15
	02/21/91	---	---	---	---	---	16.31	---	135.53
	04/01/91	---	---	---	---	---	15.08	---	136.76
	04/11/91	---	---	---	---	---	15.23	---	136.61
	07/01/91	---	---	---	---	---	15.96	---	135.88
	09/24/91	3,600	1,400	63	6.9	63	16.51	---	135.33
	10/23/91	---	---	---	---	---	16.66	---	135.18
	11/22/91	---	---	---	---	---	16.37	---	135.47
	01/09/92	7,100	770	740	190	690	15.56	---	136.28
	03/06/92	3,200	250	230	59	220	14.37	---	137.47
	06/04/92	1,500	<0.5	180	42	130	15.04	---	136.80
	09/28/92	6,400	940	230	57	220	16.40	---	135.44
	12/17/92	1,500	370	160	6	25	15.38	---	136.46
	04/29/93	1,800	690	120	74	140	14.97	0.00	136.87
	07/29/93	4,300	1,500	96	29	96	14.92	0.00	136.92
	10/22/93	820	560	57	15	58	15.81	0.00	136.03

**TABLE 1**  
**HISTORICAL GROUNDWATER ANALYTICAL RESULTS AND MONITORING DATA**  
**Chevron Service Station No. 9-2960**  
**2416 Grove Way, Castro Valley, California**

Well ID/ Elev	Date	TPH-G	Benzene	Toluene	Ethyl- Benzene	Xylenes	DTW (ft)	SPT (ft)	WTE (ft)
C-3	10/23/86	3,300	49	24	--	20	--	--	--
154.13	09/10/87	200	110	2.6	<2.0	<2.0	--	--	--
	10/16/89	900	640	4.2	1.6	16	--	--	--
	01/04/90	920	430	7	6	7	--	--	--
	04/05/90	930	690	3.4	5.1	4.8	--	--	--
	07/02/90	1,700	590	11	4.8	9.4	--	--	--
	10/03/90	--	--	--	--	--	19.16	--	134.97
	10/25/90	750	510	2	6	5	19.28	--	134.85
	01/22/91	430	260	2	2	5	19.18	--	134.95
	01/22/91	400	250	2	2	5	19.18	--	134.95
	02/21/91	--	--	--	--	--	18.88	--	135.25
	04/01/91	--	--	--	--	--	17.59	--	136.54
	04/11/91	--	--	--	--	--	17.81	--	136.32
	07/01/91	--	--	--	--	--	18.56	--	135.57
	09/24/91	260	52	0.7	0.8	2.2	19.12	--	135.01
	10/23/91	--	--	--	--	--	19.24	--	134.89
	11/22/91	--	--	--	--	--	19.03	--	135.10
	01/09/92	240	120	0.9	<0.5	1.6	18.23	--	135.90
	03/06/92	230	68	1.2	1.2	1.3	17.04	--	137.09
	06/04/92	80	36	0.6	0.5	0.7	17.79	--	136.34
	09/28/92	84	49	<0.5	<0.5	1.5	19.00	--	135.13
12/17/92	220	30	<0.5	<0.5	<0.5	18.18	--	135.95	
04/29/93	380	12	0.6	<0.5	<1.5	18.78	0.00	135.35	
07/26/93	800	38	1.1	<0.5	<1.5	17.72	0.00	136.41	
10/22/93	200	64	0.6	<0.5	<1.5	18.50	0.00	135.63	





**TABLE 1**  
**HISTORICAL GROUNDWATER ANALYTICAL RESULTS AND MONITORING DATA**  
**Chevron Service Station No. 9-2960**  
**2416 Grove Way, Castro Valley, California**

Well ID/ Elev	Date	TPH-G	Benzene	Toluene	Ethyl- Benzene	Xylenes	DTW (ft)	SPT (ft)	WTE (ft)
C-4  156.00	10/23/86	570	3	4	--	5	--	--	--
	09/10/87	500	3.0	<0.5	<0.5	<0.5	--	--	--
	10/16/89	<500	12	1.0	<0.5	0.8	--	--	--
	01/04/90	<500	5	<0.5	<0.5	0.9	--	--	--
	04/05/90	<50	6.6	<0.5	<0.5	0.7	--	--	--
	07/02/90	71	4.1	<0.5	<0.5	<0.5	--	--	--
	10/03/90	--	--	--	--	--	--	--	--
	10/25/90	<50	2	<0.5	<0.5	<0.5	20.43	--	135.57
	01/22/91	<50	3	<0.5	<0.5	<0.5	20.50	--	135.50
	02/21/91	--	--	--	--	--	20.23	--	135.77
	04/01/91	--	--	--	--	--	19.03	--	136.97
	04/11/91	--	--	--	--	--	19.05	--	136.95
	07/01/91	--	--	--	--	--	19.90	--	136.10
	09/24/91	87	1.6	<0.5	<0.5	<0.5	20.41	--	135.59
	10/23/91	--	--	--	--	--	20.53	--	135.47
	11/22/91	--	--	--	--	--	20.35	--	135.65
	01/09/92	51	4.3	<0.5	<0.5	<0.5	19.54	--	136.46
	01/09/92	<50	4.8	<0.5	<0.5	<0.5	19.54	--	136.46
	03/06/92	<50	0.8	<0.5	<0.5	<0.5	18.26	--	137.74
	06/04/92	<50	<0.5	<0.5	<0.5	0.7	18.92	--	137.08
	09/28/92	<50	<0.5	<0.5	<0.5	<0.5	20.31	--	135.69
	12/17/92	<50	<0.5	<0.5	<0.5	<0.5	19.57	--	136.43
	04/29/93	<50	<0.5	<0.5	<0.5	<1.5	17.78	0.00	138.22
07/26/93	--	--	--	--	--	--	--	--	
08/18/93	<50	<0.5	<0.5	<0.5	<1.5	18.91	0.00	137.09	
10/22/93	<50	2.9	2.1	1.1	4.3	19.39	0.00	136.61	



**TABLE 1**  
**HISTORICAL GROUNDWATER ANALYTICAL RESULTS AND MONITORING DATA**  
**Chevron Service Station No. 9-2960**  
**2416 Grove Way, Castro Valley, California**

Well ID/ Elev	Date	TPH-G	Benzene	Toluene	Ethyl- Benzene	Xylenes	DTW (ft)	SPT (ft)	WTE (ft)
C-5  153.38	10/03/90	<50	<0.5	<0.5	<0.5	<0.5	17.78	--	135.60
	10/25/90	<50	<0.5	<0.5	<0.5	<0.5	17.92	--	135.46
	11/09/90	<50	<0.5	<0.5	<0.5	<0.5	17.92	--	135.46
	01/22/91	<50	<0.5	<0.5	<0.5	<0.5	17.80	--	135.58
	02/21/91	--	--	--	--	--	17.51	--	135.87
	04/01/91	--	--	--	--	--	16.31	--	137.07
	04/11/91	--	--	--	--	--	16.36	--	137.02
	07/01/91	--	--	--	--	--	17.12	--	136.26
	09/24/91	<50	<0.5	<0.5	<0.5	<0.5	17.70	--	135.68
	09/24/91	<50	<0.5	<0.5	<0.5	<0.5	17.70	--	135.68
	10/23/91	--	--	--	--	--	17.82	--	135.56
	11/22/91	--	--	--	--	--	17.61	--	135.77
	01/09/92	<50	<0.5	0.7	<0.5	<0.5	17.04	--	136.34
	03/06/92	<50	<0.5	<0.5	<0.5	<0.5	15.76	--	137.62
	06/04/92	<50	<0.5	<0.5	<0.5	<0.5	16.40	--	136.98
	09/28/92	<50	<0.5	<0.5	<0.5	<0.5	17.58	--	135.80
	12/17/92	<50	<0.5	<0.5	<0.5	<0.5	16.82	--	136.56
	04/29/93	<50	<0.5	<0.5	<0.5	<0.5	15.24	0.00	138.14
	07/26/93	<50	<0.5	<0.5	<0.5	<1.5	16.30	0.00	137.08
	10/22/93	<50	<0.5	2.7	1.1	5.2	17.08	0.00	136.30



**TABLE 1**  
**HISTORICAL GROUNDWATER ANALYTICAL RESULTS AND MONITORING DATA**  
**Chevron Service Station No. 9-2960**  
**2416 Grove Way, Castro Valley, California**

Well ID/ Elev	Date	TPH-G	Benzene	Toluene	Ethyl- Benzene	Xylenes	DTW (ft)	SPT (ft)	WTE (ft)
C-6  152.84	10/03/90	<50	<0.5	<0.5	<0.5	<0.5	18.14	---	134.70
	10/25/90	<50	<0.5	1	<0.5	<0.5	18.29	---	134.55
	11/09/90	<50	<0.5	<0.5	<0.5	<0.5	18.26	---	134.58
	01/22/91	<50	<0.5	<0.5	<0.5	<0.5	18.15	---	134.69
	02/21/91	---	---	---	---	---	17.92	---	134.92
	04/01/91	---	---	---	---	---	17.11	---	135.73
	04/11/91	---	---	---	---	---	17.01	---	135.83
	07/01/91	---	---	---	---	---	17.72	---	135.12
	09/24/91	<50	<0.5	<0.5	<0.5	<0.5	18.12	---	134.72
	10/23/91	---	---	---	---	---	18.25	---	134.59
	11/22/91	---	---	---	---	---	18.05	---	134.79
	01/09/92	<50	<0.5	<0.5	<0.5	<0.5	17.42	---	135.42
	03/06/92	<50	<0.5	<0.5	<0.5	<0.5	16.51	---	136.33
	06/04/92	<50	<0.5	<0.5	<0.5	<0.5	17.01	---	135.83
	09/28/92	<50	<0.5	<0.5	<0.5	<0.5	18.00	---	134.84
	12/17/92	<50	<0.5	<0.5	<0.5	<0.5	17.26	---	135.58
	04/29/93	<50	<0.5	<0.5	<0.5	<1.5	16.23	---	136.61
07/29/93	<50	<0.5	<0.5	<0.5	<1.5	16.96	---	135.88	
10/22/93	74	---	---	6.1	3.3	9.7	17.46	0.00	135.38



**TABLE 1**  
**HISTORICAL GROUNDWATER ANALYTICAL RESULTS AND MONITORING DATA**  
**Chevron Service Station No. 9-2960**  
**2416 Grove Way, Castro Valley, California**

Well ID/ Elev	Date	TPH-G	Benzene	Toluene	Ethyl- Benzene	Xylenes	DTW (ft)	SPT (ft)	WTE (ft)
C-7  155.34	10/03/90	<50	<0.5	<0.5	<0.5	<0.5	20.82	---	134.52
	10/25/90	<50	<0.5	1	<0.5	<0.5	20.91	---	134.43
	11/09/90	<50	<0.5	<0.5	<0.5	<0.5	20.94	---	134.40
	01/22/91	<50	4	<0.5	<0.5	<0.5	21.50	---	133.84
	02/21/91	---	---	---	---	---	20.71	---	134.63
	04/01/91	---	---	---	---	---	20.00	---	135.34
	04/11/91	---	---	---	---	---	20.05	---	135.29
	07/01/91	---	---	---	---	---	20.52	---	134.82
	09/24/91	<50	<0.5	<0.5	<0.5	<0.5	20.82	---	134.52
	10/23/91	---	---	---	---	---	20.91	---	134.43
	11/22/91	---	---	---	---	---	20.79	---	134.55
	01/09/92	<50	<0.5	<0.5	<0.5	0.9	20.16	---	135.18
	03/06/92	<50	<0.5	<0.5	<0.5	<0.5	19.42	---	135.92
	06/04/92	<50	<0.5	<0.5	<0.5	<0.5	19.81	---	135.53
	09/28/92	<50	<0.5	<0.5	<0.5	<0.5	20.65	---	134.69
	12/17/92	<50	<0.5	<0.5	<0.5	<0.5	20.02	---	135.32
	04/29/93	<50	<0.5	<0.5	<0.5	<1.5	19.15	0.00	136.19
	07/26/93	<50	<0.5	<0.5	<0.5	<1.5	19.77	0.00	135.57
10/22/93	---	---	---	---	---	20.17	0.00	135.17	
TB/LB	10/03/90	<50	<0.5	<0.5	<0.5	<0.5	---	---	---
	10/25/90	<50	<0.5	<0.5	<0.5	<0.5	---	---	---
	11/09/90	<50	<0.5	<0.5	<0.5	<0.5	---	---	---
	01/22/91	<50	<0.5	<0.5	<0.5	<0.5	---	---	---
	09/24/91	<50	<0.5	<0.5	<0.5	<0.5	---	---	---
	01/09/92	<50	<0.5	<0.5	<0.5	<0.5	---	---	---
	03/06/92	<50	<0.5	<0.5	<0.5	<0.5	---	---	---
	06/04/92	<50	<0.5	<0.5	<0.5	<0.5	---	---	---
	09/28/92	<50	<0.5	<0.5	<0.5	<0.5	---	---	---
	12/17/92	<50	<0.5	<0.5	<0.5	<0.5	---	---	---
	04/29/93	<50	<0.5	<0.5	<0.5	<1.5	---	---	---
	07/26/93	<50	<0.5	<0.5	<0.5	<1.5	---	---	---
10/22/93	<50	<0.5	<0.5	<0.5	<1.5	---	---	---	

**TABLE 1**  
**HISTORICAL GROUNDWATER ANALYTICAL RESULTS AND MONITORING DATA**  
**Chevron Service Station No. 9-2960**  
**2416 Grove Way, Castro Valley, California**

Well ID/ Elev	Date	TPH-G	Benzene	Toluene	Ethyl- Benzene	Xylenes	DTW (ft)	SPT (ft)	WTE (ft)
Rinsate	09/10/87	<100	<0.5	<0.5	<0.5	<0.5	---	---	---
	10/25/90	<50	<0.5	<0.5	<0.5	<0.5	---	---	---
	09/24/90	<50	<0.5	<0.5	<0.5	<0.5	---	---	---
	01/09/92	<50	<0.5	<0.5	<0.5	<0.5	---	---	---
	03/06/92	<50	<0.5	<0.5	<0.5	<0.5	---	---	---
	06/04/92	<50	<0.5	<0.5	<0.5	<0.5	---	---	---
	09/28/92	<50	<0.5	<0.5	<0.5	<0.5	---	---	---

- DTW = Depth to water  
WTE = Water table elevations measured in feet above mean sea level  
--- = Not applicable/not measured/not sampled  
SPT = Separate-phase hydrocarbons  
TPH-G = Total petroleum hydrocarbons-as-gasoline  
TB/LB = Laboratory trip blank

Data before April 29, 1993, was provided by Alton GeoSciences.

**ATTACHMENT 3**  
**Laboratory Report**

4087R043.020



# Superior Precision Analytical, Inc.

1555 Burke, Unit I • San Francisco, California 94124 • (415) 647-2081 / fax (415) 821-7123

Groundwater Technology Inc.  
Attn: NICOLE MERCHANT

Project 020204087  
Reported 11/03/93

## TOTAL PETROLEUM HYDROCARBONS

Lab #	Sample Identification	Sampled	Analyzed Matrix
14884- 1	TB-LB	10/22/93	10/30/93 Water
14884- 2	C4	10/22/93	11/02/93 Water
14884- 3	C5	10/22/93	11/03/93 Water
14884- 4	C6	10/22/93	11/02/93 Water
14884- 5	C3	10/22/93	10/30/93 Water
14884- 6	C2	10/22/93	10/30/93 Water

## RESULTS OF ANALYSIS

Laboratory Number: 14884- 1 14884- 2 14884- 3 14884- 4 14884- 5

Gasoline:	ND<50	ND<50	52	74	200
Benzene:	ND<0.5	2.9	2.3	7.4	64
Toluene:	ND<0.5	2.1	2.7	6.1	0.6
Ethyl Benzene:	ND<0.5	1.1	1.1	3.3	ND<0.5
Xylenes:	ND<1.5	4.3	5.2	9.7	ND<1.5
Concentration:	ug/L	ug/L	ug/L	ug/L	ug/L

Laboratory Number: 14884- 6

Gasoline:	820
Benzene:	560
Toluene:	57
Ethyl Benzene:	15
Xylenes:	58
Concentration:	ug/L



C E R T I F I C A T E O F A N A L Y S I S

ANALYSIS FOR TOTAL PETROLEUM HYDROCARBONS

Page 2 of 2  
QA/QC INFORMATION  
SET: 14884

NA = ANALYSIS NOT REQUESTED  
ND = ANALYSIS NOT DETECTED ABOVE QUANTITATION LIMIT  
ug/L = parts per billion (ppb)

OIL AND GREASE ANALYSIS By Standard Methods Method 5520F:  
Minimum Detection Limit in Water: 5000ug/L

Modified EPA SW-846 Method 8015 for Extractable Hydrocarbons:  
Minimum Quantitation Limit for Diesel in Water: 50ug/L

EPA SW-846 Method 8015/5030 Total Purgable Petroleum Hydrocarbons:  
Minimum Quantitation Limit for Gasoline in Water: 50ug/L

EPA SW-846 Method 8020/BTXE  
Minimum Quantitation Limit in Water: 0.5ug/L

ANALYTE	MS/MSD RECOVERY	RPD	CONTROL LIMIT
Gasoline:	106/112	6%	75-125
Benzene:	105/99	6%	75-125
Toluene:	109/103	6%	75-125
Ethyl Benzene:	110/105	5%	75-125
Xylenes:	101/96	5%	75-125

*Cecilia G. Joaguer*  
Senior Chemist  
Account Manager



Fax copy of Lab Report and COC to Chevron Contact:  Yes  No

# Chain-of-Custody-Record

Chevron U.S.A. Inc.  
P.O. BOX 5004  
San Ramon, CA 94583  
FAX (415)842-9591

Chevron Facility Number: 9-29100  
Facility Address: 2416 Grove Way, Castro  
Consultant Project Number: 020204087  
Consultant Name: Groundwater Technology, Inc.  
Address: 4057 Port Chicago Hwy, Concord, CA 94520  
Project Contact (Name): Nicole Merchant  
(Phone): 671-2387 (Fax Number) 685-9148

Chevron Contact (Name): Ken Kan  
(Phone): 242-2752  
Laboratory Name: Superior  
Laboratory Release Number: 921-64161  
Samples Collected by (Name): Phil Hollenhorst  
Collection Date: 10/22/93  
Signature: *[Signature]*

Sample Number	Lab Sample Number	Number of Containers	Matrix S = Soil W = Water A = Air C = Charcoal	Type G = Grab C = Composite D = Discrete	Time	Sample Preservation	Iced (Yes or No)	Analytes To Be Performed												Remarks				
								BTEX + TPH GAS (8020 + 8015)	TPH Diesel (8015)	Oil and Grease (5520)	Purgeable Halocarbons (8010)	Purgeable Aromatics (8020)	Purgeable Organics (8240)	Extractable Organics (8270)	Metals Cd,Cr,Pb,Zn,Ni (ICAP or AA)									
TBLB	-1	2	W	G	1300	HCL	Y	X																Do not Bill TB-LB
<del>RBC4DA</del>																								
CU	-2	3		G	1304	HCL	Y	X																
<del>RBC5DA</del>																								
CS	-3	3			1330	HCL	X	X																
<del>RBC6DA</del>																								
CL	-4	3			1408	HCL	X	X																
<del>RBC7DA</del>																								
<del>RBC8DA</del>																								
<del>RBC9DA</del>																								
C3	-5	3		G	1500	HCL	Y	X																
<del>RBC10DA</del>																								
C2	-6	3						X																

Please initial:

Samples stored in ice.

Appropriate containers.

Samples preserved.

Without headspace.

VOID Comments:

Relinquished By (Signature): <i>[Signature]</i>	Organization: <u>GTE</u>	Date/Time: <u>10/22/93</u>	Received By (Signature): <i>[Signature]</i>	Organization: <u>CATL</u>	Date/Time: <u>10/22 3:10</u>	Turn Around Time (Circle Choice) 24 Hrs. 48 Hrs. 5 Days 10 Days As Contracted
Relinquished By (Signature): <i>[Signature]</i>	Organization: <u>GTE</u>	Date/Time: <u>10/25 4:10</u>	Received By (Signature): <i>[Signature]</i>	Organization: <u>Aero</u>	Date/Time: <u>10-25-93</u>	
Relinquished By (Signature): <i>[Signature]</i>	Organization: <u>Aero</u>	Date/Time: <u>10/25 5:40</u>	Received For Laboratory By (Signature): <i>[Signature]</i>	Organization: <u>Superior</u>	Date/Time: <u>10/25/93</u>	