



93 SEP 29 AM 11:31

September 28, 1993

Mr. Scott Seery  
Alameda County Environmental Health  
80 Swan Way, Room 200  
Oakland, CA 94621

Re: Former Chevron Service Station No. 9-2960  
2416 Grove Way, Castro Valley, CA 94546

Dear Mr. Seery:

Enclosed is the September 21, 1993 quarterly monitoring and sampling report from Groundwater Technology, Inc.

Monitoring wells C-4 through C-7 were below the detection limit for dissolved gasoline constituents. ~~Wells C-2 and C-3 contained dissolved gasoline, and well C-1 had 0.51 mg/l of liquid hydrocarbons.~~

Weiss Associates is awaiting Castro Valley Fire Department's approval on the remediation system.

If you have any questions or comments, please feel free to call me at (510) 842-8752.

Sincerely,

Chevron U.S.A. Products Co.

Kenneth Kan  
Engineer

LKAN/MacFile 9-2960R13

Enclosure

cc: Mr. Rich Hielt, RWQCB-S.F.Bay Region  
2101 Webster Street, Suite 500, Oakland, CA 94612

Mr. Bob Yule, First Presbyterian Church  
2490 Grove Way, Castro Valley, CA 94546

Ms. Bette Owen, Chevron U.S.A. Products Co.



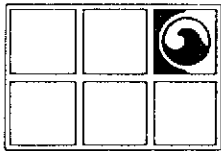

# GROUNDWATER TECHNOLOGY, INC.

4057 Port Chicago Highway, Concord, CA 94520 (415) 671-2387

FAX: (415) 685-9148

September 21, 1993

Project No. 020204087

Mr. Ken Kan  
Chevron U.S.A. Products Company  
2410 Camino Ramon  
San Ramon, CA 94583-0804

SUBJECT: *Groundwater Monitoring and Sampling Activities*  
Chevron Service Station No. 9-2960  
2416 Grove Way, Castro Valley, California

Dear Mr. Kan:

Groundwater Technology, Inc. presents the attached quarterly groundwater monitoring and sampling data collected on July 26, 1993. Six of the seven groundwater monitoring wells at the site were gauged to measure depth to groundwater (DTW) and to check for the presence of separate-phase hydrocarbons. Separate-phase hydrocarbons were detected in monitoring well C-1 at a thickness of 0.51 foot. **Approximately 0.4 gallons of product were removed from monitoring well C-1 (Table 1).** Monitoring well C-4 could not be located on July 26, 1993. Monitoring well C-4 was located and sampled on August 18, 1993. A potentiometric surface map (Figure 1) and a summary of groundwater monitoring data (Table 2) are presented in Attachments 1 and 2, respectively. After the DTW was measured, each monitoring well, except monitoring well C-1, was purged and sampled. The groundwater samples were analyzed for benzene, toluene, ethylbenzene, xylenes, and for total petroleum hydrocarbons-as-gasoline. Results of the chemical analyses are summarized in Table 2. The laboratory reports and chain-of-custody records are included in Attachment 3. Monitoring-well purge water was transported by Groundwater Technology to the Chevron Terminal in Richmond, California, for recycling.

Groundwater Technology is pleased to assist Chevron on this project. If you have any questions or comments, please contact our Concord office at (510) 671-2387.

Sincerely,  
Groundwater Technology, Inc.  
Written/Submitted by

Groundwater Technology, Inc.  
Reviewed/Approved by

  
\_\_\_\_\_  
Tim Watchers  
Project Geologist

  
David R. Kleesattel  
Registered Geologist  
No. 5136

PR 

Attachment 1 Figure  
Attachment 2 Table  
Attachment 3 Laboratory Report

For:  
Wendell A. Lattz  
Vice President, General  
West Region

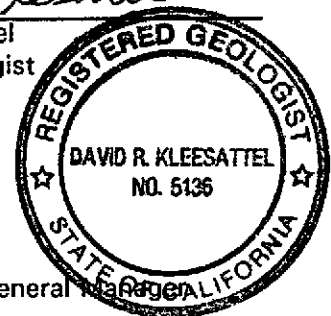

4087R033.020

**ATTACHMENT 1**

**Figure**

4087R033.020

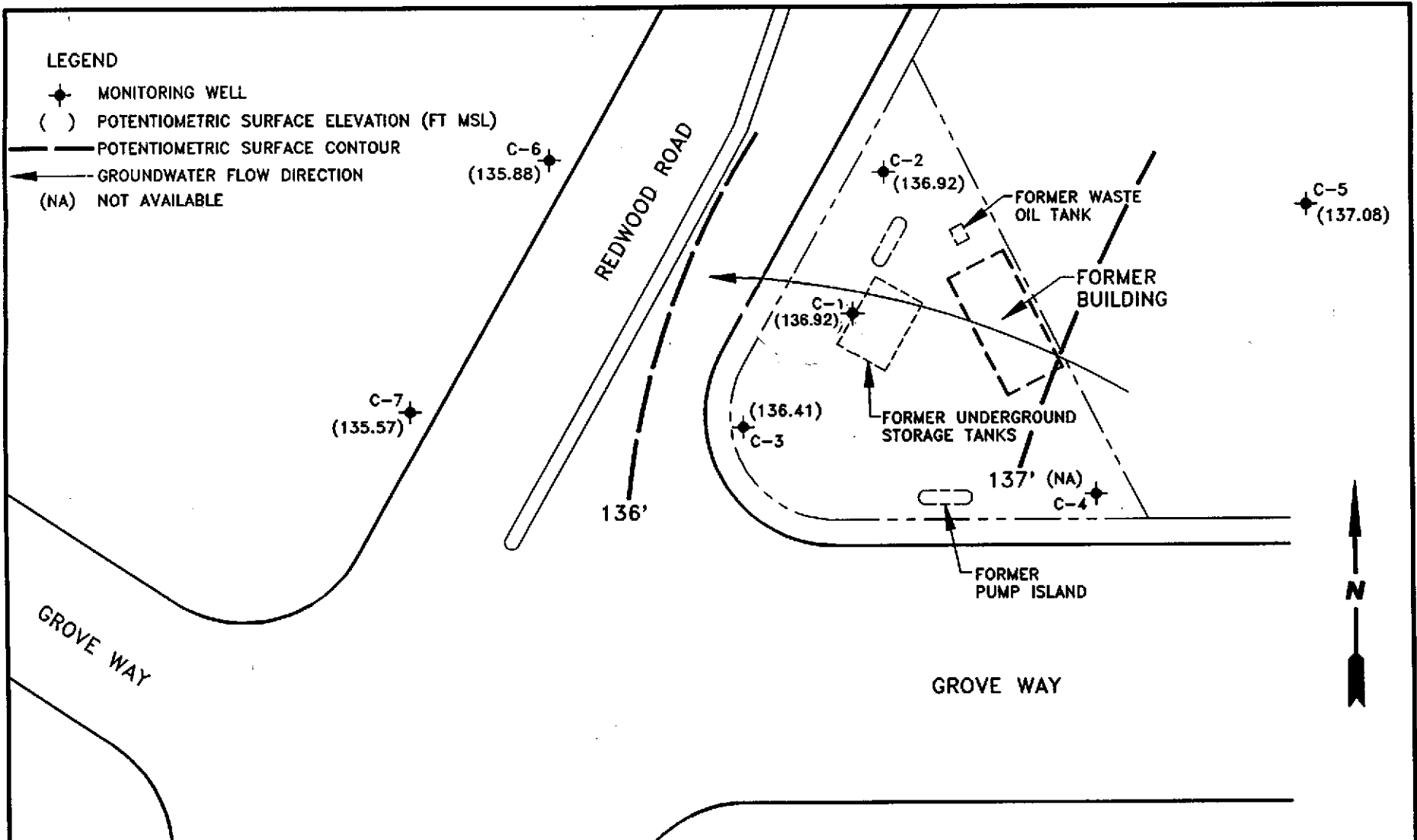

<b>GROUNDWATER TECHNOLOGY</b>				4057 PORT CHICAGO HWY CONCORD, CA 94520 (510) 671-2387		<b>POTENTIOMETRIC SURFACE MAP</b> <b>(7/26/93)</b>			
<b>CLIENT:</b> CHEVRON U.S.A. PRODUCTS CO. SERVICE STATION No. 9-2960				<b>LOCATION:</b> 2416 GROVE WAY CASTRO VALLEY, CALIFORNIA		<b>REV. NO.:</b> 0	<b>DATE:</b> 8/30/93		
<b>PM</b> <i>[Signature]</i>	<b>PE/RG</b> DRK	<b>DESIGNED</b> SCH	<b>DETAILED</b> ML	<b>ACAD FILE:</b> PSM72693/SP693		<b>PROJECT NO.:</b> 020204115		<b>FIGURE:</b> 1	

**ATTACHMENT 2**

**Tables**

**TABLE 1**  
**PRODUCT RECOVERY**  
Chevron Service Station No. 9-2960  
2416 Grove Way, Castro Valley, California

Date	Well ID	Amount Bailed (gallons)	Cumulative Product Amount Recovered
7/26/93	C-1	0.4	0.4

**TABLE 2**  
**HISTORICAL GROUNDWATER ANALYTICAL RESULTS AND MONITORING DATA**  
 Chevron Service Station No. 9-2960  
 2416 Grove Way, Castro Valley, California

Well ID/ Elev	Date	TPH-as- Gasoline	Benzene	Toluene	Ethyl- Benzene	Xylenes	DTW (ft)	SPT (ft)	WTE (ft)
C-1  153.36	10/23/86	3,100	6,400	3,700	---	4,300	---	---	---
	09/10/87	120,000	25,000	60,000	13,000	56,000	---	---	---
	10/03/90	---	---	---	---	---	18.67	---	134.69
	10/25/90	---	---	---	---	---	18.71	0.71	135.22
	01/22/91	---	---	---	---	---	18.70	0.70	135.22
	02/21/91	---	---	---	---	---	18.62	0.88	135.44
	04/01/91	---	---	---	---	---	16.91	0.03	136.47
	04/11/91	---	---	---	---	---	16.90	0.04	136.49
	07/01/91	---	---	---	---	---	17.61	0.00	135.75
	09/24/91	---	---	---	---	---	18.98	0.99	135.17
	10/23/91	---	---	---	---	---	19.32	1.24	135.03
	11/22/91	---	---	---	---	---	18.83	0.97	134.53
	01/09/92	---	---	---	---	---	17.26	---	136.10
	03/06/92	---	---	---	---	---	16.69	0.61	137.16
	06/04/92	---	---	---	---	---	17.10	0.22	136.44
	09/28/92	---	---	---	---	---	18.71	0.77	---
	12/17/92	---	---	---	---	---	17.54	0.45	---
04/29/93	---	---	---	---	---	16.40	0.68	137.50	
07/26/93	---	---	---	---	---	16.85	0.51	136.92	

**TABLE 2**  
**HISTORICAL GROUNDWATER ANALYTICAL RESULTS AND MONITORING DATA**  
Chevron Service Station No. 9-2960  
2416 Grove Way, Castro Valley, California

Well ID/ Elev	Date	TPH-as- Gasoline	Benzene	Toluene	Ethyl- Benzene	Xylenes	DTW (ft)	SPT (ft)	WTE (ft)
C-2  151.84	10/23/86	30,000	2,700	1,900	---	1,500	---	---	---
	09/10/87	14,000	2,600	2,900	500	1,200	---	---	---
	10/16/89	600	260	34	1.7	41	---	---	---
	01/04/90	2,600	470	150	23	130	---	---	---
	04/05/90	500	280	29	6.3	19	---	---	---
	07/02/90	2,400	670	110	17	76	---	---	---
	10/03/90	---	---	---	---	---	---	---	---
	10/25/90	1,300	390	47	9	58	16.60	---	135.24
	01/22/91	2,600	680	88	29	130	16.69	---	135.15
	02/21/91	---	---	---	---	---	16.31	---	135.53
	04/01/91	---	---	---	---	---	15.08	---	136.76
	04/11/91	---	---	---	---	---	15.23	---	136.61
	07/01/91	---	---	---	---	---	15.96	---	135.88
	09/24/91	3,600	1,400	63	6.9	63	16.51	---	135.33
	10/23/91	---	---	---	---	---	16.66	---	135.18
	11/22/91	---	---	---	---	---	16.37	---	135.47
	01/09/92	7,100	770	740	190	690	15.56	---	136.28
	03/06/92	3,200	250	230	59	220	14.37	---	137.47
	06/04/92	1,500	<0.5	180	42	130	15.04	---	136.80
	09/28/92	6,400	940	230	57	220	16.40	---	135.44
12/17/92	1,500	370	160	6	25	15.38	---	136.46	
04/29/93	1,800	690	120	74	140	14.97	0.00	136.87	
07/29/93	4,300	1,500	96	29	96	14.92	0.00	136.92	



**TABLE 2**  
**HISTORICAL GROUNDWATER ANALYTICAL RESULTS AND MONITORING DATA**  
**Chevron Service Station No. 9-2960**  
**2416 Grove Way, Castro Valley, California**

Well ID/ Elev	Date	TPH-as- Gasoline	Benzene	Toluene	Ethyl- Benzene	Xylenes	DTW (ft)	SPT (ft)	WTE (ft)
C-3  154.13	10/23/86	3,300	49	24	---	20	---	---	---
	09/10/87	200	110	2.6	<2.0	<2.0	---	---	---
	10/16/89	900	640	4.2	1.6	16	---	---	---
	01/04/90	920	430	7	6	7	---	---	---
	04/05/90	930	690	3.4	5.1	4.8	---	---	---
	07/02/90	1,700	590	11	4.8	9.4	---	---	---
	10/03/90	---	---	---	---	---	19.16	---	134.97
	10/25/90	750	510	2	6	5	19.28	---	134.85
	01/22/91	430	260	2	2	5	19.18	---	134.95
	01/22/91	400	250	2	2	5	19.18	---	134.95
	02/21/91	---	---	---	---	---	18.88	---	135.25
	04/01/91	---	---	---	---	---	17.59	---	136.54
	04/11/91	---	---	---	---	---	17.81	---	136.32
	07/01/91	---	---	---	---	---	18.56	---	135.57
	09/24/91	260	52	0.7	0.8	2.2	19.12	---	135.01
	10/23/91	---	---	---	---	---	19.24	---	134.89
	11/22/91	---	---	---	---	---	19.03	---	135.10
	01/09/92	240	120	0.9	<0.5	1.6	18.23	---	135.90
	03/06/92	230	68	1.2	1.2	1.3	17.04	---	137.09
	06/04/92	80	36	0.6	0.5	0.7	17.79	---	136.34
	09/28/92	84	49	<0.5	<0.5	1.5	19.00	---	135.13
	12/17/92	220	30	<0.5	<0.5	<0.5	18.18	---	135.95
	04/29/93	380	12	0.6	<0.5	<1.5	18.78	0.00	135.35
07/26/93	800	38	1.1	<0.5	<1.5	17.72	0.00	136.41	

**TABLE 2**  
**HISTORICAL GROUNDWATER ANALYTICAL RESULTS AND MONITORING DATA**  
 Chevron Service Station No. 9-2960  
 2416 Grove Way, Castro Valley, California

Well ID/ Elev	Date	TPH-as- Gasoline	Benzene	Toluene	Ethyl- Benzene	Xylenes	DTW (ft)	SPT (ft)	WTE (ft)
C-4  156.00	10/23/86	570	3	4	---	5	---	---	---
	09/10/87	500	3.0	<0.5	<0.5	<0.5	---	---	---
	10/16/89	<500	12	1.0	<0.5	0.8	---	---	---
	01/04/90	<500	5	<0.5	<0.5	0.9	---	---	---
	04/05/90	<50	6.6	<0.5	<0.5	0.7	---	---	---
	07/02/90	71	4.1	<0.5	<0.5	<0.5	---	---	---
	10/03/90	---	---	---	---	---	---	---	---
	10/25/90	<50	2	<0.5	<0.5	<0.5	20.43	---	135.57
	01/22/91	<50	3	<0.5	<0.5	<0.5	20.50	---	135.50
	02/21/91	---	---	---	---	---	20.23	---	135.77
	04/01/91	---	---	---	---	---	19.03	---	136.97
	04/11/91	---	---	---	---	---	19.05	---	136.95
	07/01/91	---	---	---	---	---	19.90	---	136.10
	09/24/91	87	1.6	<0.5	<0.5	<0.5	20.41	---	135.59
	10/23/91	---	---	---	---	---	20.53	---	135.47
	11/22/91	---	---	---	---	---	20.35	---	135.65
	01/09/92	51	4.3	<0.5	<0.5	<0.5	19.54	---	136.46
	01/09/92	<50	4.8	<0.5	<0.5	<0.5	19.54	---	136.46
	03/06/92	<50	0.8	<0.5	<0.5	<0.5	18.26	---	137.74
	06/04/92	<50	<0.5	<0.5	<0.5	0.7	18.92	---	137.08
	09/28/92	<50	<0.5	<0.5	<0.5	<0.5	20.31	---	135.69
	12/17/92	<50	<0.5	<0.5	<0.5	<0.5	19.57	---	136.43
	04/29/93	<50	<0.5	<0.5	<0.5	<1.5	17.78	0.00	138.22
07/26/93	---	---	---	---	---	---	---	---	
08/18/93	<50	<0.5	<0.5	<0.5	<1.5	18.91	0.00	137.09	



**TABLE 2**  
**HISTORICAL GROUNDWATER ANALYTICAL RESULTS AND MONITORING DATA**  
 Chevron Service Station No. 9-2960  
 2416 Grove Way, Castro Valley, California

Well ID/ Elev	Date	TPH-as- Gasoline	Benzene	Toluene	Ethyl- Benzene	Xylenes	DTW (ft)	SPT (ft)	WTE (ft)
C-5  153.38	10/03/90	<50	<0.5	<0.5	<0.5	<0.5	17.78	---	135.60
	10/25/90	<50	<0.5	<0.5	<0.5	<0.5	17.92	---	135.46
	11/09/90	<50	<0.5	<0.5	<0.5	<0.5	17.92	---	135.46
	01/22/91	<50	<0.5	<0.5	<0.5	<0.5	17.80	---	135.58
	02/21/91	---	---	---	---	---	17.51	---	135.87
	04/01/91	---	---	---	---	---	16.31	---	137.07
	04/11/91	---	---	---	---	---	16.36	---	137.02
	07/01/91	---	---	---	---	---	17.12	---	136.26
	09/24/91	<50	<0.5	<0.5	<0.5	<0.5	17.70	---	135.68
	09/24/91	<50	<0.5	<0.5	<0.5	<0.5	17.70	---	135.68
	10/23/91	---	---	---	---	---	17.82	---	135.56
	11/22/91	---	---	---	---	---	17.61	---	135.77
	01/09/92	<50	<0.5	0.7	<0.5	<0.5	17.04	---	136.34
	03/06/92	<50	<0.5	<0.5	<0.5	<0.5	15.76	---	137.62
	06/04/92	<50	<0.5	<0.5	<0.5	<0.5	16.40	---	136.98
	09/28/92	<50	<0.5	<0.5	<0.5	<0.5	17.58	---	135.80
	12/17/92	<50	<0.5	<0.5	<0.5	<0.5	16.82	---	136.56
	04/29/93	<50	<0.5	<0.5	<0.5	<0.5	15.24	0.00	138.14
07/26/93	<50	<0.5	<0.5	<0.5	<0.5	16.30	0.00	137.08	



**TABLE 2**  
**HISTORICAL GROUNDWATER ANALYTICAL RESULTS AND MONITORING DATA**  
 Chevron Service Station No. 9-2960  
 2416 Grove Way, Castro Valley, California

Well ID/ Elev	Date	TPH-as- Gasoline	Benzene	Toluene	Ethyl- Benzene	Xylenes	DTW (ft)	SPT (ft)	WTE (ft)
C-6  152.84	10/03/90	<50	<0.5	<0.5	<0.5	<0.5	18.14	---	134.70
	10/25/90	<50	<0.5	1	<0.5	<0.5	18.29	---	134.55
	11/09/90	<50	<0.5	<0.5	<0.5	<0.5	18.26	---	134.58
	01/22/91	<50	<0.5	<0.5	<0.5	<0.5	18.15	---	134.69
	02/21/91	---	---	---	---	---	17.92	---	134.92
	04/01/91	---	---	---	---	---	17.11	---	135.73
	04/11/91	---	---	---	---	---	17.01	---	135.83
	07/01/91	---	---	---	---	---	17.72	---	135.12
	09/24/91	<50	<0.5	<0.5	<0.5	<0.5	18.12	---	134.72
	10/23/91	---	---	---	---	---	18.25	---	134.59
	11/22/91	---	---	---	---	---	18.05	---	134.79
	01/09/92	<50	<0.5	<0.5	<0.5	<0.5	17.42	---	135.42
	03/06/92	<50	<0.5	<0.5	<0.5	<0.5	16.51	---	136.33
	06/04/92	<50	<0.5	<0.5	<0.5	<0.5	17.01	---	135.83
	09/28/92	<50	<0.5	<0.5	<0.5	<0.5	18.00	---	134.84
	12/17/92	<50	<0.5	<0.5	<0.5	<0.5	17.26	---	135.58
	04/29/93	<50	<0.5	<0.5	<0.5	<0.5	16.23	---	136.61
	07/29/93	<50	<0.5	<0.5	<0.5	<0.5	16.96	---	135.88

**TABLE 2**  
**HISTORICAL GROUNDWATER ANALYTICAL RESULTS AND MONITORING DATA**  
 Chevron Service Station No. 9-2960  
 2416 Grove Way, Castro Valley, California

Well ID/ Elev	Date	TPH-as- Gasoline	Benzene	Toluene	Ethyl- Benzene	Xylenes	DTW (ft)	SPT (ft)	WTE (ft)
C-7  155.34	10/03/90	<50	<0.5	<0.5	<0.5	<0.5	20.82	---	134.52
	10/25/90	<50	<0.5	1	<0.5	<0.5	20.91	---	134.43
	11/09/90	<50	<0.5	<0.5	<0.5	<0.5	20.94	---	134.40
	01/22/91	<50	4	<0.5	<0.5	<0.5	21.50	---	133.84
	02/21/91	---	---	---	---	---	20.71	---	134.63
	04/01/91	---	---	---	---	---	20.00	---	135.34
	04/11/91	---	---	---	---	---	20.05	---	135.29
	07/01/91	---	---	---	---	---	20.52	---	134.82
	09/24/91	<50	<0.5	<0.5	<0.5	<0.5	20.82	---	134.52
	10/23/91	---	---	---	---	---	20.91	---	134.43
	11/22/91	---	---	---	---	---	20.79	---	134.55
	01/09/92	<50	<0.5	<0.5	<0.5	0.9	20.16	---	135.18
	03/06/92	<50	<0.5	<0.5	<0.5	<0.5	19.42	---	135.92
	06/04/92	250	<0.5	<0.5	<0.5	<0.5	19.81	---	135.53
	09/28/92	<50	<0.5	<0.5	<0.5	<0.5	20.65	---	134.69
	12/17/92	<50	<0.5	<0.5	<0.5	<0.5	20.02	---	135.32
	04/29/93	<50	<0.5	<0.5	<0.5	<0.5	19.15	0.00	136.19
07/26/93	<50	<0.5	<0.5	<0.5	<0.5	19.77	0.00	135.57	



**TABLE 2**  
**HISTORICAL GROUNDWATER ANALYTICAL RESULTS AND MONITORING DATA**  
**Chevron Service Station No. 9-2960**  
**2416 Grove Way, Castro Valley, California**

Well ID/ Elev	Date	TPH-as- Gasoline	Benzene	Toluene	Ethyl- Benzene	Xylenes	DTW (ft)	SPT (ft)	WTE (ft)
TB-LB	10/03/90	<50	<0.5	<0.5	<0.5	<0.5	---	---	---
	10/25/90	<50	<0.5	<0.5	<0.5	<0.5	---	---	---
	11/09/90	<50	<0.5	<0.5	<0.5	<0.5	---	---	---
	01/22/91	<50	<0.5	<0.5	<0.5	<0.5	---	---	---
	09/24/91	<50	<0.5	<0.5	<0.5	<0.5	---	---	---
	01/09/92	<50	<0.5	<0.5	<0.5	<0.5	---	---	---
	03/06/92	<50	<0.5	<0.5	<0.5	<0.5	---	---	---
	06/04/92	<50	<0.5	<0.5	<0.5	<0.5	---	---	---
	09/28/92	<50	<0.5	<0.5	<0.5	<0.5	---	---	---
	12/17/92	<50	<0.5	<0.5	<0.5	<0.5	---	---	---
	04/29/93	<50	<0.5	<0.5	<0.5	<1.5	---	---	---
	07/26/93	<50	<0.5	<0.5	<0.5	<1.5	---	---	---
Rinsate	09/10/87	<100	<0.5	<0.5	<0.5	<0.5	---	---	---
	10/25/90	<50	<0.5	<0.5	<0.5	<0.5	---	---	---
	09/24/90	<50	<0.5	<0.5	<0.5	<0.5	---	---	---
	01/09/92	<50	<0.5	<0.5	<0.5	<0.5	---	---	---
	03/06/92	<50	<0.5	<0.5	<0.5	<0.5	---	---	---
	06/04/92	<50	<0.5	<0.5	<0.5	<0.5	---	---	---
	09/28/92	<50	<0.5	<0.5	<0.5	<0.5	---	---	---

DTW = Depth to water  
WTE = Water table elevations measured  
in feet above mean sea level  
--- = Not applicable/not measured/not sampled

SPT = Separate-phase hydrocarbons  
TPH = Total petroleum hydrocarbons  
TB-LB = Laboratory trip blank

Data before April 29, 1993, was provided by Alton GeoSciences.

**ATTACHMENT 3**

**Laboratory Report**



# Superior Precision Analytical, Inc.

825 Arnold Drive, Suite 114 • Martinez, California 94553 • (510) 229-1512 / fax (510) 229-1526

GROUNDWATER TECHNOLOGY, INC.  
Attn: Nicole Merchant

Project 020204087  
Reported 08/01/93

## TOTAL PETROLEUM HYDROCARBONS

Lab #	Sample Identification	Sampled	Analyzed Matrix
89386- 1	TB-LB	07/26/93	07/29/93 Water
89386- 3	C5	07/26/93	07/29/93 Water
89386- 5	C6	07/26/93	07/29/93 Water
89386- 7	C7	07/26/93	07/29/93 Water
89386- 9	C3	07/26/93	07/29/93 Water
89386-11	C2	07/26/93	07/29/93 Water

## RESULTS OF ANALYSIS

Laboratory Number: 89386- 1 89386- 3 89386- 5 89386- 7 89386- 9

Gasoline:	ND<50	ND<50	ND<50	ND<50	800
Benzene:	ND<0.5	ND<0.5	ND<0.5	ND<0.5	38
Toluene:	ND<0.5	ND<0.5	ND<0.5	ND<0.5	1.1
Ethyl Benzene:	ND<0.5	ND<0.5	ND<0.5	ND<0.5	ND<0.5
Xylenes:	ND<1.5	ND<1.5	ND<1.5	ND<1.5	ND<1.5
Concentration:	ug/L	ug/L	ug/L	ug/L	ug/L

Laboratory Number: 89386-11

Gasoline:	4300
Benzene:	1500
Toluene:	96
Ethyl Benzene:	29
Xylenes:	96
Concentration:	ug/L





C E R T I F I C A T E   O F   A N A L Y S I S

ANALYSIS FOR TOTAL PETROLEUM HYDROCARBONS

Page 2 of 2  
QA/QC INFORMATION  
SET: 89386

NA = ANALYSIS NOT REQUESTED  
ND = ANALYSIS NOT DETECTED ABOVE QUANTITATION LIMIT  
ug/L = parts per billion (ppb)

OIL AND GREASE ANALYSIS By Standard Methods Method 5520F:  
Minimum Detection Limit in Water: 5000ug/L

Modified EPA SW-846 Method 8015 for Extractable Hydrocarbons:  
Minimum Quantitation Limit for Diesel in Water: 50ug/L

EPA SW-846 Method 8015/5030 Total Purgable Petroleum Hydrocarbons:  
Minimum Quantitation Limit for Gasoline in Water: 50ug/L

EPA SW-846 Method 8020/BTXE  
Minimum Quantitation Limit in Water: 0.5ug/L

ANALYTE	MS/MSD RECOVERY	RPD	CONTROL LIMIT
Gasoline:	85/77	10%	70-130
Benzene:	106/118	11%	70-130
Toluene:	97/109	12%	70-130
Ethyl Benzene:	97/109	12%	70-130
Xylenes:	98/110	12%	70-130

*Steph Carroll*  
Senior Chemist



# Superior Precision Analytical, Inc.

825 Arnold Drive, Suite 114 ▪ Martinez, California 94553 ▪ (510) 229-1512 / fax (510) 229-1526

## MOCK INVOICE

Chevron USA  
P.O. Box 5004  
San Ramon, CA 94583

Date: 08/01/93  
Date Rcvd: 07/27/93  
Date Rptd: 08/01/93  
Our Job #: 89386  
Invoice #: 89386

GROUNDWATER TECHNOLOGY, INC. Job # 020204087  
Chevron USA Release # 9216461 Facility #: 9-2960

QTY/MATRIX	ANALYSIS	EXT. PRICE
5 Water sample(s) for HOLD	@ \$0.00 (NORMAL)	0.00
5 Water sample(s) for VPHBTXE	@ \$0.00 (NORMAL)	0.00
TOTAL INVOICE		0.00

Please Send Payment To:  
Superior Precision Analytical  
P.O. Box 1545  
Martinez, CA 94553

TERMS: NET 30  
A charge of 1.5% per month may be applied to unpaid balances.

Fax copy of Lab Report and COC to Chevron Contact:  Yes  No

Yes  No

89386

# Chain-of-Custody-Record

Chevron U.S.A. Inc.  
P.O. BOX 5004  
San Ramon, CA 94583  
FAX (415)842-9591

Chevron Facility Number: 9-2960  
Facility Address: 2416 Grove Wy, Castro Valley  
Consultant Project Number: 020204087  
Consultant Name: Groundwater Technology, Inc.  
Address: 4057 Port Chicago Hwy, Concord, CA 94520  
Project Contact (Name): Nicole Merchant  
(Phone) 671-2387 (Fax Number) 685-9148

Chevron Contact (Name): Ken Han  
(Phone) 842-8752  
Laboratory Name: Superior  
Laboratory Release Number: 921-6461  
Samples Collected by (Name): Gres Masad  
Collection Date: 7/26-93  
Signature: [Signature]

Sample Number	Lab Sample Number	Number of Containers	Media S = Soil W = Water A = Air C = Charcoal	Type G = Grab C = Composite D = Discrete	Time	Sample Preservation	Iced (Yes or No)	Analytes To Be Performed											Remarks					
								BTEX + TPH GAS (8020 + 8015)	TPH Diesel (8015)	Oil and Grease (5520)	Purgeable Halocarbons (8010)	Purgeable Aromatics (8020)	Purgeable Organics (8240)	Extractable Organics (8270)	Metals Cd, Cr, Pb, Zn, Ni (ICAP or AA)	Hold								
TB-LB	1	2	W	D	HCl		Y	X															Do not Bill TB-LB	
<del>RBC5</del>	<del>2</del>	<del>1</del>																						
RBC5	2	1																						
C5	3	3				3:25		X																
RBC6	4	1																						
C6	5	3				3:35		X																
RBC7	6	1																						
C7	7	3				3:45		X																
RBC3	8	1																						
C3	9	3				4:10		X																
RBC2	10	1																						
C2	11	3				4:25		X																

Please Initial: RP  
Samples Stored in ice: 48 4°C X  
Appropriate containers: 48  
Samples preserved: 48  
VOA's without headspace: 48 X  
Comments: (24)

Relinquished By (Signature) <u>[Signature]</u>	Organization <u>GTI</u>	Date/Time <u>7/27 1020</u>	Received By (Signature)	Organization	Date/Time	Turn Around Time (Circle Choice) 24 Hrs. 48 Hrs. 5 Days 10 Days <u>As Contracted</u>
Relinquished By (Signature)	Organization	Date/Time	Received By (Signature)	Organization	Date/Time	
Relinquished By (Signature)	Organization	Date/Time	Received For Laboratory By (Signature) <u>[Signature]</u>		Date/Time <u>7/27 1020</u>	



# Superior Precision Analytical, Inc.

825 Arnold Drive, Suite 114 • Martinez, California 94553 • (510) 229-1512 / fax (510) 229-1526

GROUNDWATER TECHNOLOGY, INC.  
Attn: Nicole Merchant

Project 020204087  
Reported 08/27/93

## TOTAL PETROLEUM HYDROCARBONS

Lab #	Sample Identification	Sampled	Analyzed Matrix
89700- 1	TB-LB	08/18/93	08/26/93 Water
89700- 3	C4	08/18/93	08/26/93 Water

## RESULTS OF ANALYSIS

Laboratory Number: 89700- 1 89700- 3

Gasoline:	ND<50	ND<50
Benzene:	ND<0.5	ND<0.5
Toluene:	ND<0.5	ND<0.5
Ethyl Benzene:	ND<0.5	ND<0.5
Total Xylenes:	ND<1.5	ND<1.5
Concentration:	ug/L	ug/L



# Superior Precision Analytical, Inc.

825 Arnold Drive, Suite 114 • Martinez, California 94553 • (510) 229-1512 / fax (510) 229-1526

## C E R T I F I C A T E   O F   A N A L Y S I S

### ANALYSIS FOR TOTAL PETROLEUM HYDROCARBONS

Page 2 of 2

QA/QC INFORMATION

SET: 89700

NA = ANALYSIS NOT REQUESTED

ND = ANALYSIS NOT DETECTED ABOVE QUANTITATION LIMIT

ug/L = parts per billion (ppb)

Modified EPA SW-846 Method 8015 for Extractable Hydrocarbons:  
Minimum Quantitation Limit for Diesel in Water: 50ug/L

EPA SW-846 Method 8020/BTXE  
Minimum Quantitation Limit in Water: 0.5ug/L

ANALYTE	MS/MSD RECOVERY	RPD	CONTROL LIMIT
Gasoline:	93/90	3%	70-130
Benzene:	98/93	5%	70-130
Toluene:	106/103	3%	70-130
Ethyl Benzene:	106/105	1%	70-130
Total Xylenes:	98/97	1%	70-130

*Alsanah D. Salimpo*

Senior Chemist

87/00  Yes  No  
 Fax copy of Lab Report and COC to Chevron Contact:

# Chain-of-Custody-Record

Chevron U.S.A. Inc.  
 P.O. BOX 5004  
 San Ramon, CA 94583  
 FAX (415)842-9591

Chevron Facility Number 9-2960  
 Facility Address 2416 Grove Way  
 Consultant Project Number 020204087  
 Consultant Name GTI  
 Address 4057 Port Chicago Hwy  
 Project Contact (Name) Nicole Mouchant  
 (Phone) 671-2387 (Fax Number) 685-9148

Chevron Contact (Name) Ken Kau  
 (Phone) 842-8752  
 Laboratory Name Superior  
 Laboratory Release Number 1921-6461  
 Samples Collected by (Name) John Munn  
 Collection Date 8/18/93  
 Signature [Handwritten Signature]

Sample Number	Lab Sample Number	Number of Containers	Matrix S = Soil W = Water A = Air C = Charcoal	Type G = Grab C = Composite D = Discrete	Time	Sample Preservation	Iced (Yes or No)	Analyses To Be Performed												Remarks			
								BTX + TPH GAS (8020 + 8015)	TPH Diesel (8015)	Oil and Grease (8520)	Purgeable Halocarbons (8010)	Purgeable Aromatics (8020)	Purgeable Organics (8240)	Extractable Organics (8270)	Metals Cd,Cr,Pb,Zn,Ni (ICAP or AA)								
TB-LB		2	W	G		no	X	X															
RB-C4		1	↓	↓		yes	↓																
C4		2	↓	↓		yes	↓	X															

Do not Bill TB-LB

Please Initial  
 Samples Stored in ice Hand delivered - cold  
 Appropriate containers  
 Samples preserved  
 GC/MS analysis in lab house  
 Comments:

Relinquished By (Signature) <u>[Signature]</u>	Organization <u>GTI</u>	Date/Time <u>8/20/93</u>	Received By (Signature)	Organization	Date/Time	Turn Around Time (Circle Choice) 24 Hrs. 48 Hrs. 5 Days 10 Days As Contracted
Relinquished By (Signature)	Organization	Date/Time	Received By (Signature)	Organization	Date/Time	
Relinquished By (Signature)	Organization	Date/Time	Received For Laboratory By (Signature) <u>K. Carlson</u>	Date/Time <u>8/20/93</u>		