



Chevron U.S.A. Products Company

2410 Camino Ramon, San Ramon, California • Phone (510) 842-9500
Mail Address: P.O. Box 5004, San Ramon, CA 94583-0804

92 JUL 23 10 14 AM

Marketing Department

July 20, 1992

Mr. Scott Seery
Alameda County Environmental Health
80 Swan Way, Room 200
Oakland, CA 94621

Re : Former Chevron Service Station No. 9-2960
2416 Grove Way, Castro Valley, CA 94546

Mr. Seery :

Enclosed is the quarterly monitoring and sampling report dated July 10, 1992.

During this sampling period, monitoring wells C-5 and C-6 were nondetect (ND) for total petroleum hydrocarbon as gasoline (TPH-G), benzene, toluene, ethylbenzene, and xylenes (BTEX). Well C-4 had only 0.7 ppb xylenes while C-7 detected only 250 ppb TPH-G which was a single peak in the gasoline range. Dissolved hydrocarbons were measured in C-2 and C-3. Approximately half a gallon of free product was recovered for all of April, May, and June. Depth to water ranged from 15.04 to 19.81 feet.

The air and encroachment permits for the remediation system will soon be submitted.

If you have any questions or comments, please feel free to call me at (510) 842-8752.

Sincerely,

Chevron U.S.A. Products Co.

Kenneth Kan
Engineer

LKAN/MacFile 9-2960R8

Enclosure

cc : Mr. Rich Hiett, RWQCB-S.F. Bay Region
2101 Webster Street, Suite 500, Oakland, CA 94612

Mr. Bob Yule, First Presbyterian Church
2490 Grove Way, Castro Valley, CA 94546

Ms. Bette Owen, Chevron U.S.A. Products Co.

JUL 16 '92 1ST

July 10, 1992

Mr. Kenneth Kan
Chevron U.S.A. Products Company
Post Office Box 5004
San Ramon, California 94583-0804

31-0563

Subject: Quarterly Ground Water Monitoring Report
Chevron Station No. 9-2960
2416 Grove Way,
Castro Valley, California

Dear Mr. Kan:

In accordance with our agreement, Alton Geoscience transmits this Quarterly Ground Water Monitoring and Sampling Report for Chevron Station No. 9-2960, located at 2416 Grove Way, Castro Valley, California. Figure 1 shows the site location.

Monitoring and sampling of the ground water monitoring wells were performed on June 4, 1992, in accordance with the requirements and procedures of the California Regional Water Quality Control Board (RWQCB) and local regulatory agencies.

FIELD PROCEDURES

Prior to purging and sampling the wells, each well was checked for liquid-phase hydrocarbons or sheen. The depth to ground water and, if present, free product in each well was measured from the top of casing using an electronic interface probe with 0.01 foot tolerance.

Ground water analytical samples were collected using a clean bailer after more than 3 casing volumes of ground water were purged from each well. Ground water samples were then decanted into the appropriate clean sample containers for delivery to a California-certified laboratory following proper preservation and chain of custody procedures. Purged ground water was transferred to a 600-gallon, trailer-mounted, steel tank (California Department of Health Services-registered), and delivered as non-hazardous to the Chevron Richmond Terminal for treatment.

Mr. Kenneth Kan
July 10, 1992
Page 2

31-0563

SAMPLING AND ANALYTICAL RESULTS

The results of the monitoring and laboratory analyses of the ground water samples for this quarter, as well as the results of previous monitoring and sampling events, are summarized in Table 1. Based on the previous wellhead elevation survey data and depth to water measurements collected during this monitoring event, ground water elevations and the general ground water gradient direction at this site are presented in Figure 2.

Free product was noted in monitoring well C-1. Approximately a total of 1/2 of gallon of free product was removed by bailing or skimming during the months of April, May and June of 1992. The official laboratory reports and chain of custody records are included in Appendix A.

Please call Todd B. Pearson at (510) 734-8134 if you have any questions concerning this report.

Sincerely,

ALTON GEOSCIENCE,

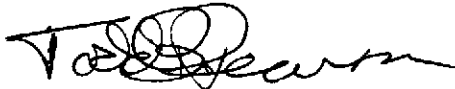

Todd B. Pearson
Staff Scientist

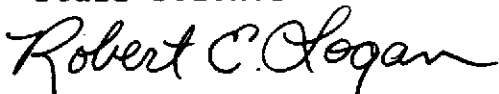

Robert E. Logan R.G. 5088
Manager, Northern California Operations

wp92960tp



0 1,000 2,000



SCALE (FEET)

Source: U.S.G.S. Map
Hayward Quadrangle
California
7.5 Minute Series



SITE VICINITY MAP

Former Chevron Station No. 9-2960
2416 Grove Way
Castro Valley, California

FIGURE 1



ALTON GEOSCIENCE
Pleasanton, California

Project No. 31-0563

LEGEND

- ⊕ C-7 Ground water monitoring well
- 135.53 Ground water elevation (feet above mean sea level [NGVD-1929])
- - - Ground water elevation contour
- ← General direction of ground water gradient
- P/L Property line

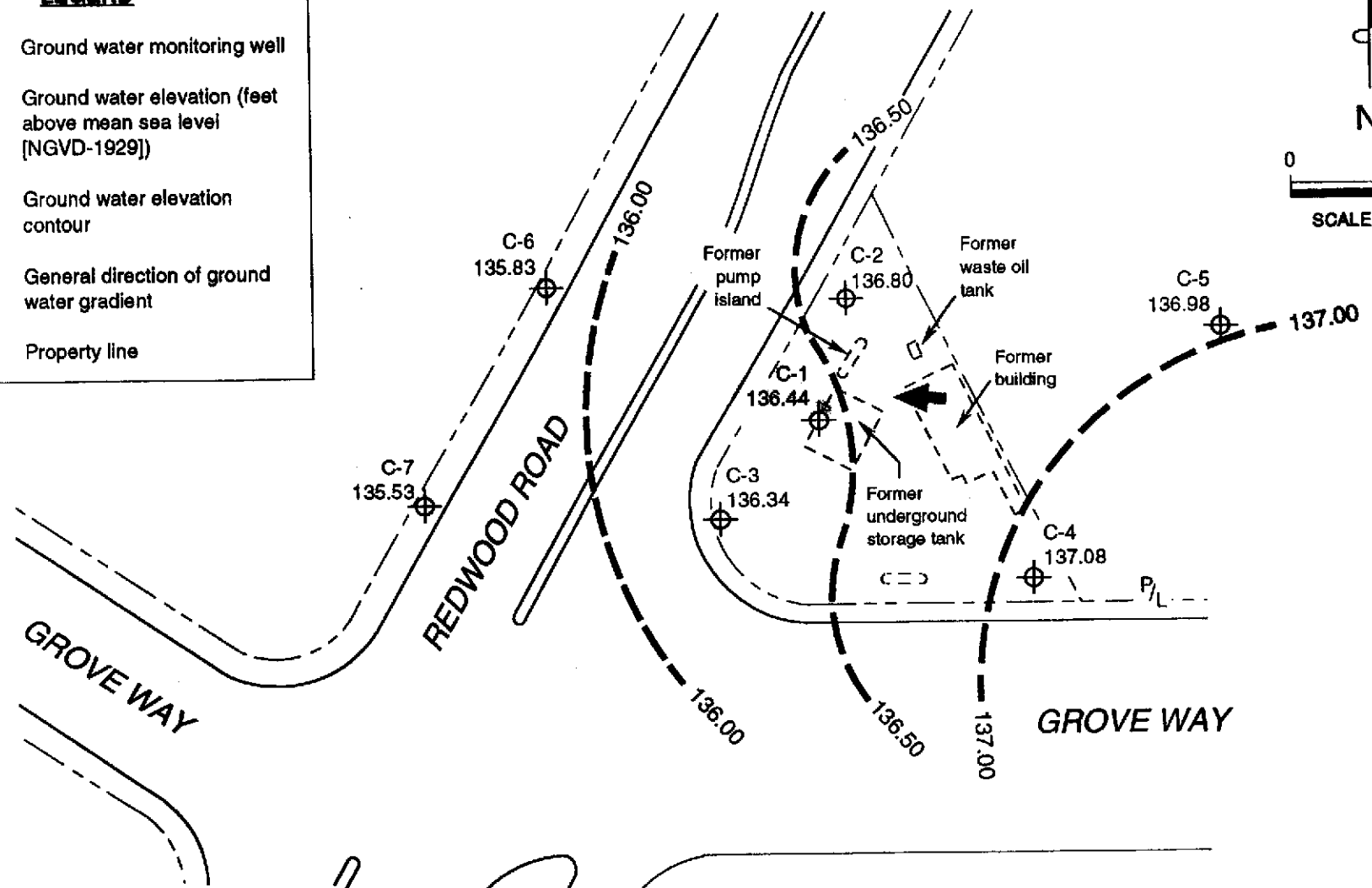
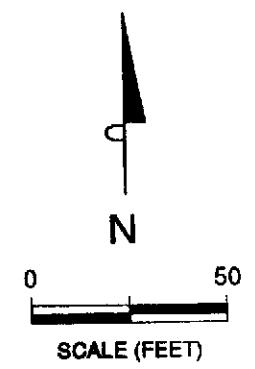

NOTES:
 Contour lines are interpretive based on fluid levels in monitoring wells measured on June 4, 1992

GROUND WATER ELEVATION CONTOUR MAP

Former Chevron Station No. 9-2960
 2416 Grove Way
 Castro Valley, California

FIGURE 2

ALTON GEOSCIENCE
 Pleasanton, California

Source: Geostrategies, Inc.

Table 1
 Summary of Results of Ground Water Sampling
 Former Chevron Service Station # 9-2960
 2416 Grove Way/Redwood Road, Castro Valley, California

Concentrations in parts per billion (ppb)

| WELL ID | DATE OF SAMPLING/ MONITORING | TOP OF WELL BOX ELEVATION | DEPTH TO WATER | FREE PRODUCT THICKNESS | GROUND WATER ELEVATION | TPH-G | B | T | E | X | LAB |
|---------|------------------------------|---------------------------|----------------|------------------------|------------------------|--------|--------|-------|-------|---------|-----|
| C-1 | 10/23/86 | --- | --- | --- | --- | 37000 | 6400 | 3700 | --- | 4300 | TMA |
| C-1 | 09/10/87 | --- | --- | --- | --- | 120000 | 25000 | 60000 | 13000 | 56000 * | ENS |
| C-1 | 10/03/90 | 153.36 | 18.67 | --- | 134.69 | --- | --- | --- | --- | --- | NA |
| C-1 | 10/25/90 | 153.36 | 18.71 | 0.71 | 135.22 | --- | --- | --- | --- | --- | NA |
| C-1 | 01/22/91 | 153.36 | 18.70 | 0.70 | 135.22 | --- | --- | --- | --- | --- | NA |
| C-1 | 02/21/91 | 153.36 | 18.62 | 0.88 | 135.44 | --- | --- | --- | --- | --- | NA |
| C-1 | 04/01/91 | 153.36 | 16.91 | 0.03 | 136.47 | --- | --- | --- | --- | --- | NA |
| C-1 | 04/11/91 | 153.36 | 16.90 | 0.04 | 136.49 | --- | --- | --- | --- | --- | NA |
| C-1 | 07/01/91 | 153.36 | 17.61 | 0.00 | 135.75 | --- | --- | --- | --- | --- | NA |
| C-1 | 09/24/91 | 153.36 | 18.98 | 0.99 | 135.17 | --- | --- | --- | --- | --- | NA |
| C-1 | 10/23/91 | 153.36 | 19.32 | 1.24 | 135.03 | --- | --- | --- | --- | --- | NA |
| C-1 | 11/22/91 | 153.36 | 18.83 | 0.97 | 134.53 | --- | --- | --- | --- | --- | NA |
| C-11 | 01/09/92 | 153.36 | 17.26 | --- | 136.10 | --- | --- | --- | --- | --- | NA |
| C-11 | 03/06/92 | 153.36 | 16.69 | 0.61 | 137.16 | --- | --- | --- | --- | --- | NA |
| C-11 | 06/04/92 | 153.36 | 17.10 | 0.22 | 136.44 | --- | --- | --- | --- | --- | NA |
| C-2 | 10/23/86 | --- | --- | --- | --- | 30000 | 2700 | 1900 | --- | 1500 | TMA |
| C-2 | 09/10/87 | --- | --- | --- | --- | 14000 | 2600 | 2900 | 500 | 1200 * | ENS |
| C-2 | 10/16/89 | --- | --- | --- | --- | 600 | 260 | 34 | 1.7 | 41 | NA |
| C-2 | 01/04/90 | --- | --- | --- | --- | 2600 | 470 | 150 | 23 | 130 | NA |
| C-2 | 04/05/90 | --- | --- | --- | --- | 500 | 280 | 29 | 6.3 | 19 | NA |
| C-2 | 07/02/90 | --- | --- | --- | --- | 2400 | 670 | 110 | 17 | 76 | NA |
| C-2 | 10/03/90 | --- | --- | --- | --- | --- | --- | --- | --- | --- | NA |
| C-2 | 10/25/90 | 151.84 | 16.60 | --- | 135.24 | 1300 | 390 | 47 | 9 | 58 | SAL |
| C-2 | 01/22/91 | 151.84 | 16.69 | --- | 135.15 | 2600 | 680 | 88 | 29 | 130 | SAL |
| C-2 | 02/21/91 | 151.84 | 16.31 | --- | 135.53 | --- | --- | --- | --- | --- | NA |
| C-2 | 04/01/91 | 151.84 | 15.08 | --- | 136.76 | --- | --- | --- | --- | --- | NA |
| C-2 | 04/11/91 | 151.84 | 15.23 | --- | 136.61 | --- | --- | --- | --- | --- | NA |
| C-2 | 07/01/91 | 151.84 | 15.96 | --- | 135.88 | --- | --- | --- | --- | --- | NA |
| C-2 | 09/24/91 | 151.84 | 16.51 | --- | 135.33 | 3600 | 1400 | 63 | 6.9 | 63 | SAL |
| C-2 | 10/23/91 | 151.84 | 16.66 | --- | 135.18 | --- | --- | --- | --- | --- | NA |
| C-2 | 11/22/91 | 151.84 | 16.37 | --- | 135.47 | --- | --- | --- | --- | --- | NA |
| C-2 | 01/09/92 | 151.84 | 15.56 | --- | 136.28 | 7100 | 770 | 740 | 190 | 690 | SAL |
| C-2 | 03/06/92 | 151.84 | 14.37 | --- | 137.47 | 3200 | 250 | 230 | 59 | 220 | SAL |
| C-2 | 06/04/92 | 151.84 | 15.04 | --- | 136.80 | 1500 | ND<0.5 | 180 | 42 | 130 | SAL |

Table 1
 Summary of Results of Ground Water Sampling
 Former Chevron Service Station # 9-2960
 2416 Grove Way/Redwood Road, Castro Valley, California

Concentrations in parts per billion (ppb)

| WELL ID | DATE OF SAMPLING/ MONITORING | TOP OF WELL BOX ELEVATION | DEPTH TO WATER | FREE PRODUCT THICKNESS | GROUND WATER ELEVATION | TPH-G | B | T | E | X | LAB |
|---------|---------------------------------|------------------------------|-------------------|------------------------------|------------------------------|-------|-----|-----|--------|--------|-----|
| C-3 | 10/23/86 | --- | --- | --- | --- | 3300 | 49 | 24 | --- | 20 | TMA |
| C-3 | 09/10/87 | --- | --- | --- | --- | 200 | 110 | 2.6 | ND<2.0 | ND<2.0 | ENS |
| C-3 | 10/16/89 | --- | --- | --- | --- | 900 | 640 | 4.2 | 1.6 | 16 | NA |
| C-3 | 01/04/90 | --- | --- | --- | --- | 920 | 430 | 7 | 6 | 7 | NA |
| C-3 | 04/05/90 | --- | --- | --- | --- | 930 | 690 | 3.4 | 5.1 | 4.8 | NA |
| C-3 | 07/02/90 | --- | --- | --- | --- | 1700 | 590 | 11 | 4.8 | 9.4 | NA |
| C-3 | 10/03/90 | 154.13 | 19.16 | --- | 134.97 | --- | --- | --- | --- | --- | NA |
| C-3 | 10/25/90 | 154.13 | 19.28 | --- | 134.85 | 750 | 510 | 2 | 6 | 5 | SAL |
| C-3 | 01/22/91 | 154.13 | 19.18 | --- | 134.95 | 430 | 260 | 2 | 2 | 5 | SAL |
| C-3D | 01/22/91 | 154.13 | 19.18 | --- | 134.95 | 400 | 250 | 2 | 2 | 5 | SAL |
| C-3 | 02/21/91 | 154.13 | 18.88 | --- | 135.25 | --- | --- | --- | --- | --- | NA |
| C-3 | 04/01/91 | 154.13 | 17.59 | --- | 136.54 | --- | --- | --- | --- | --- | NA |
| C-3 | 04/11/91 | 154.13 | 17.81 | --- | 136.32 | --- | --- | --- | --- | --- | NA |
| C-3 | 07/01/91 | 154.13 | 18.56 | --- | 135.57 | --- | --- | --- | --- | --- | NA |
| C-3 | 09/24/91 | 154.13 | 19.12 | --- | 135.01 | 260 | 52 | 0.7 | 0.8 | 2.2 | SAL |
| C-3 | 10/23/91 | 154.13 | 19.24 | --- | 134.89 | --- | --- | --- | --- | --- | NA |
| C-3 | 11/22/91 | 154.13 | 19.03 | --- | 135.10 | --- | --- | --- | --- | --- | NA |
| C-3 | 01/09/92 | 154.13 | 18.23 | --- | 135.90 | 240 | 120 | 0.9 | ND<0.5 | 1.6 | SAL |
| C-3 | 03/06/92 | 154.13 | 17.04 | --- | 137.09 | 230 | 68 | 1.2 | 1.2 | 1.3 | SAL |
| C-3 | 06/04/92 | 154.13 | 17.79 | --- | 136.34 | 80 | 36 | 0.6 | 0.5 | 0.7 | SAL |

Table 1
 Summary of Results of Ground Water Sampling
 Former Chevron Service Station # 9-2960
 2416 Grove Way/Redwood Road, Castro Valley, California
 Concentrations in parts per billion (ppb)

| WELL ID | DATE OF SAMPLING/ MONITORING | TOP OF WELL BOX ELEVATION | DEPTH TO WATER | FREE PRODUCT THICKNESS | GROUND WATER ELEVATION | TPH-G | B | T | E | X | LAB |
|---------|------------------------------|---------------------------|----------------|------------------------|------------------------|--------|--------|--------|--------|--------|-----|
| C-4 | 10/23/86 | --- | --- | --- | --- | 570 | 3 | 4 | --- | 5 | TMA |
| C-4 | 09/10/87 | --- | --- | --- | --- | 500 | 3.0 | ND<0.5 | ND<0.5 | ND<0.5 | ENS |
| C-4 | 10/16/89 | --- | --- | --- | --- | ND<500 | 12 | 1.0 | ND<0.5 | 0.8 | NA |
| C-4 | 01/04/90 | --- | --- | --- | --- | ND<500 | 5 | ND<0.5 | ND<0.5 | 0.9 | NA |
| C-4 | 04/05/90 | --- | --- | --- | --- | ND<50 | 6.6 | ND<0.5 | ND<0.5 | 0.7 | NA |
| C-4 | 07/02/90 | --- | --- | --- | --- | 71 | 4.1 | ND<0.5 | ND<0.5 | ND<0.5 | NA |
| C-4 | 10/03/90 | --- | --- | --- | --- | --- | --- | --- | --- | --- | NA |
| C-4 | 10/25/90 | 156.00 | 20.43 | --- | 135.57 | ND<50 | 2 | ND<0.5 | ND<0.5 | ND<0.5 | SAL |
| C-4 | 01/22/91 | 156.00 | 20.50 | --- | 135.50 | ND<50 | 3 | ND<0.5 | ND<0.5 | ND<0.5 | SAL |
| C-4 | 02/21/91 | 156.00 | 20.23 | --- | 135.77 | --- | --- | --- | --- | --- | NA |
| C-4 | 04/01/91 | 156.00 | 19.03 | --- | 136.97 | --- | --- | --- | --- | --- | NA |
| C-4 | 04/11/91 | 156.00 | 19.05 | --- | 136.95 | --- | --- | --- | --- | --- | NA |
| C-4 | 07/01/91 | 156.00 | 19.90 | --- | 136.10 | --- | --- | --- | --- | --- | NA |
| C-4 | 09/24/91 | 156.00 | 20.41 | --- | 135.59 | 87 ** | 1.6 | ND<0.5 | ND<0.5 | ND<0.5 | SAL |
| C-4 | 10/23/91 | 156.00 | 20.53 | --- | 135.47 | --- | --- | --- | --- | --- | NA |
| C-4 | 11/22/91 | 156.00 | 20.35 | --- | 135.65 | --- | --- | --- | --- | --- | NA |
| C-4 | 01/09/92 | 156.00 | 19.54 | --- | 136.46 | 51 *** | 4.3 | ND<0.5 | ND<0.5 | ND<0.5 | SAL |
| C-4D | 01/09/92 | 156.00 | 19.54 | --- | 136.46 | ND<50 | 4.8 | ND<0.5 | ND<0.5 | ND<0.5 | SAL |
| C-4 | 03/06/92 | 156.00 | 18.26 | --- | 137.74 | ND<50 | 0.8 | ND<0.5 | ND<0.5 | ND<0.5 | SAL |
| C-4 | 06/04/92 | 156.00 | 18.92 | --- | 137.08 | ND<50 | ND<0.5 | ND<0.5 | ND<0.5 | 0.7 | SAL |

Table 1
 Summary of Results of Ground Water Sampling
 Former Chevron Service Station # 9-2960
 2416 Grove Way/Redwood Road, Castro Valley, California

Concentrations in parts per billion (ppb)

| WELL ID | DATE OF SAMPLING/ MONITORING | TOP OF WELL BOX ELEVATION | DEPTH TO WATER | FREE PRODUCT THICKNESS | GROUND WATER ELEVATION | TPH-G | B | T | E | X | LAB |
|---------|---------------------------------|------------------------------|-------------------|------------------------------|------------------------------|-------|--------|--------|--------|--------|-----|
| C-5 | 10/03/90 | 153.38 | 17.78 | --- | 135.60 | ND<50 | ND<0.5 | ND<0.5 | ND<0.5 | ND<0.5 | SAL |
| C-5 | 10/25/90 | 153.38 | 17.92 | --- | 135.46 | ND<50 | ND<0.5 | ND<0.5 | ND<0.5 | ND<0.5 | SAL |
| C-5 | 11/09/90 | 153.38 | 17.92 | --- | 135.46 | ND<50 | ND<0.5 | ND<0.5 | ND<0.5 | ND<0.5 | SAL |
| C-5 | 01/22/91 | 153.38 | 17.80 | --- | 135.58 | ND<50 | ND<0.5 | ND<0.5 | ND<0.5 | ND<0.5 | SAL |
| C-5 | 02/21/91 | 153.38 | 17.51 | --- | 135.87 | --- | --- | --- | --- | --- | NA |
| C-5 | 04/01/91 | 153.38 | 16.31 | --- | 137.07 | --- | --- | --- | --- | --- | NA |
| C-5 | 04/11/91 | 153.38 | 16.36 | --- | 137.02 | --- | --- | --- | --- | --- | NA |
| C-5 | 07/01/91 | 153.38 | 17.12 | --- | 136.26 | --- | --- | --- | --- | --- | NA |
| C-5 | 09/24/91 | 153.38 | 17.70 | --- | 135.68 | ND<50 | ND<0.5 | ND<0.5 | ND<0.5 | ND<0.5 | SAL |
| C-5D | 09/24/91 | 153.38 | 17.70 | --- | 135.68 | ND<50 | ND<0.5 | ND<0.5 | ND<0.5 | ND<0.5 | SAL |
| C-5 | 10/23/91 | 153.38 | 17.82 | --- | 135.56 | --- | --- | --- | --- | --- | NA |
| C-5 | 11/22/91 | 153.38 | 17.61 | --- | 135.77 | --- | --- | --- | --- | --- | NA |
| C-5 | 01/09/92 | 153.38 | 17.04 | --- | 136.34 | ND<50 | ND<0.5 | 0.7 | ND<0.5 | ND<0.5 | SAL |
| C-5 | 03/06/92 | 153.38 | 15.76 | --- | 137.62 | ND<50 | ND<0.5 | ND<0.5 | ND<0.5 | ND<0.5 | SAL |
| C-5 | 06/04/92 | 153.38 | 16.40 | --- | 136.98 | ND<50 | ND<0.5 | ND<0.5 | ND<0.5 | ND<0.5 | SAL |
| C-6 | 10/03/90 | 152.84 | 18.14 | --- | 134.70 | ND<50 | ND<0.5 | ND<0.5 | ND<0.5 | ND<0.5 | SAL |
| C-6 | 10/25/90 | 152.84 | 18.29 | --- | 134.55 | ND<50 | ND<0.5 | 1 | ND<0.5 | ND<0.5 | SAL |
| C-6 | 11/09/90 | 152.84 | 18.26 | --- | 134.58 | ND<50 | ND<0.5 | ND<0.5 | ND<0.5 | ND<0.5 | SAL |
| C-6 | 01/22/91 | 152.84 | 18.15 | --- | 134.69 | ND<50 | ND<0.5 | ND<0.5 | ND<0.5 | ND<0.5 | SAL |
| C-6 | 02/21/91 | 152.84 | 17.92 | --- | 134.92 | --- | --- | --- | --- | --- | NA |
| C-6 | 04/01/91 | 152.84 | 17.11 | --- | 135.73 | --- | --- | --- | --- | --- | NA |
| C-6 | 04/11/91 | 152.84 | 17.01 | --- | 135.83 | --- | --- | --- | --- | --- | NA |
| C-6 | 07/01/91 | 152.84 | 17.72 | --- | 135.12 | --- | --- | --- | --- | --- | NA |
| C-6 | 09/24/91 | 152.84 | 18.12 | --- | 134.72 | ND<50 | ND<0.5 | ND<0.5 | ND<0.5 | ND<0.5 | SAL |
| C-6 | 10/23/91 | 152.84 | 18.25 | --- | 134.59 | --- | --- | --- | --- | --- | NA |
| C-6 | 11/22/91 | 152.84 | 18.05 | --- | 134.79 | --- | --- | --- | --- | --- | NA |
| C-6 | 01/09/92 | 152.84 | 17.42 | --- | 135.42 | ND<50 | ND<0.5 | ND<0.5 | ND<0.5 | ND<0.5 | SAL |
| C-6 | 03/06/92 | 152.84 | 16.51 | --- | 136.33 | ND<50 | ND<0.5 | ND<0.5 | ND<0.5 | ND<0.5 | SAL |
| C-6 | 06/04/92 | 152.84 | 17.01 | --- | 135.83 | ND<50 | ND<0.5 | ND<0.5 | ND<0.5 | ND<0.5 | SAL |

Table 1
 Summary of Results of Ground Water Sampling
 Former Chevron Service Station # 9-2960
 2416 Grove Way/Redwood Road, Castro Valley, California
 Concentrations in parts per billion (ppb)

| WELL ID | DATE OF SAMPLING/ MONITORING | TOP OF WELL BOX ELEVATION | DEPTH TO WATER | FREE PRODUCT THICKNESS | GROUND WATER ELEVATION | TPH-G | B | T | E | X | LAB |
|---------|------------------------------|---------------------------|----------------|------------------------|------------------------|---------|--------|--------|--------|--------|-----|
| C-7 | 10/03/90 | 155.34 | 20.82 | --- | 134.52 | ND<50 | ND<0.5 | ND<0.5 | ND<0.5 | ND<0.5 | SAL |
| C-7 | 10/25/90 | 155.34 | 20.91 | --- | 134.43 | ND<50 | ND<0.5 | 1 | ND<0.5 | ND<0.5 | SAL |
| C-7 | 11/09/90 | 155.34 | 20.94 | --- | 134.40 | ND<50 | ND<0.5 | ND<0.5 | ND<0.5 | ND<0.5 | SAL |
| C-7 | 01/22/91 | 155.34 | 21.50 | --- | 133.84 | ND<50 | 4 | ND<0.5 | ND<0.5 | ND<0.5 | SAL |
| C-7 | 02/21/91 | 155.34 | 20.71 | --- | 134.63 | --- | --- | --- | --- | --- | NA |
| C-7 | 04/01/91 | 155.34 | 20.00 | --- | 135.34 | --- | --- | --- | --- | --- | NA |
| C-7 | 04/11/91 | 155.34 | 20.05 | --- | 135.29 | --- | --- | --- | --- | --- | NA |
| C-7 | 07/01/91 | 155.34 | 20.52 | --- | 134.82 | --- | --- | --- | --- | --- | NA |
| C-7 | 09/24/91 | 155.34 | 20.82 | --- | 134.52 | ND<50 | ND<0.5 | ND<0.5 | ND<0.5 | ND<0.5 | SAL |
| C-7 | 10/23/91 | 155.34 | 20.91 | --- | 134.43 | --- | --- | --- | --- | --- | NA |
| C-7 | 11/22/91 | 155.34 | 20.79 | --- | 134.55 | --- | --- | --- | --- | --- | NA |
| C-7 | 01/09/92 | 155.34 | 20.16 | --- | 135.18 | ND<50 | ND<0.5 | ND<0.5 | ND<0.5 | 0.9 | SAL |
| C-7 | 03/06/92 | 155.34 | 19.42 | --- | 135.92 | ND<50 | ND<0.5 | ND<0.5 | ND<0.5 | ND<0.5 | SAL |
| C-7 | 06/04/92 | 155.34 | 19.81 | --- | 135.53 | 250 *** | ND<0.5 | ND<0.5 | ND<0.5 | ND<0.5 | SAL |
| TB | 10/03/90 | NA | NA | NA | NA | ND<50 | ND<0.5 | ND<0.5 | ND<0.5 | ND<0.5 | SAL |
| TB | 10/25/90 | NA | NA | NA | NA | ND<50 | ND<0.5 | ND<0.5 | ND<0.5 | ND<0.5 | SAL |
| TB | 11/09/90 | NA | NA | NA | NA | ND<50 | ND<0.5 | ND<0.5 | ND<0.5 | ND<0.5 | SAL |
| TB | 01/22/91 | NA | NA | NA | NA | ND<50 | ND<0.5 | ND<0.5 | ND<0.5 | ND<0.5 | SAL |
| TB | 09/24/91 | NA | NA | NA | NA | ND<50 | ND<0.5 | ND<0.5 | ND<0.5 | ND<0.5 | SAL |
| TB | 01/09/92 | NA | NA | NA | NA | ND<50 | ND<0.5 | ND<0.5 | ND<0.5 | ND<0.5 | SAL |
| TB | 03/06/92 | NA | NA | NA | NA | ND<50 | ND<0.5 | ND<0.5 | ND<0.5 | ND<0.5 | SAL |
| TB | 06/04/92 | NA | NA | NA | NA | ND<50 | ND<0.5 | ND<0.5 | ND<0.5 | ND<0.5 | SAL |

Table 1
 Summary of Results of Ground Water Sampling
 Former Chevron Service Station # 9-2960
 2416 Grove Way/Redwood Road, Castro Valley, California

Concentrations in parts per billion (ppb)

| WELL ID | DATE OF SAMPLING/ MONITORING | TOP OF WELL BOX ELEVATION | DEPTH TO WATER | FREE PRODUCT THICKNESS | GROUND WATER ELEVATION | TPH-G | B | T | E | X | LAB |
|---------|------------------------------|---------------------------|----------------|------------------------|------------------------|--------|--------|--------|--------|--------|-----|
| RINSATE | 09/10/87 | NA | NA | NA | NA | ND<100 | ND<0.5 | ND<0.5 | ND<0.5 | ND<0.5 | ENS |
| RINSATE | 10/25/90 | NA | NA | NA | NA | ND<50 | ND<0.5 | ND<0.5 | ND<0.5 | ND<0.5 | SAL |
| RINSATE | 09/24/90 | NA | NA | NA | NA | ND<50 | ND<0.5 | ND<0.5 | ND<0.5 | ND<0.5 | SAL |
| RINSATE | 01/09/92 | NA | NA | NA | NA | ND<50 | ND<0.5 | ND<0.5 | ND<0.5 | ND<0.5 | SAL |
| RINSATE | 03/06/92 | NA | NA | NA | NA | ND<50 | ND<0.5 | ND<0.5 | ND<0.5 | ND<0.5 | SAL |
| RINSATE | 06/04/92 | NA | NA | NA | NA | ND<50 | ND<0.5 | ND<0.5 | ND<0.5 | ND<0.5 | SAL |

EXPLANATION OF ABBREVIATIONS:

TPH-G :Total Petroleum Hydrocarbons as Gasoline
 (EPA method 8015 modified)
 B :Benzene (EPA method 8020 or 8240)
 T :Toluene (EPA method 8020 or 8240)
 E :Ethylbenzene (EPA method 8020 or 8240)
 X :Xylenes (EPA method 8020 or 8240)
 TB :Trip Blank
 D :Duplicate

--- :Not analyzed/Not measured
 NA :Not applicable/Not available
 TMA :Thermo Analytical Inc.
 ENS :Enseco
 SAL :Superior Analytical Laboratory
 * :Concentration for m-Xylene only.
 ** :Non-standard gasoline pattern observed
 in chromatogram.
 *** :The chromatogram shows only a single peak
 in the gasoline range.
 ! :Not sampled due to observed sheen.

Note: Top of casing and ground water elevations are expressed as feet above mean sea level (NGVD - 1929)

APPENDIX A
OFFICIAL LABORATORY RESULTS
AND
CHAIN OF CUSTODY FORMS



Alton Geoscience
Attn: TODD PEARSON

Project 31-0563
Reported 06/19/92

TOTAL PETROLEUM HYDROCARBONS

| Lab # | Sample Identification | Sampled | Analyzed Matrix |
|----------|-----------------------|----------|-----------------|
| 85962- 1 | TB-LB | 06/04/92 | 06/18/92 Water |
| 85962- 2 | RIN | 06/04/92 | 06/18/92 Water |
| 85962- 3 | C-6 | 06/04/92 | 06/18/92 Water |
| 85962- 4 | C-7 | 06/04/92 | 06/18/92 Water |
| 85962- 5 | C-5 | 06/04/92 | 06/18/92 Water |
| 85962- 6 | C-4 | 06/04/92 | 06/18/92 Water |
| 85962- 7 | C-3 | 06/04/92 | 06/18/92 Water |
| 85962- 8 | C-2 | 06/04/92 | 06/18/92 Water |

RESULTS OF ANALYSIS

Laboratory Number: 85962- 1 85962- 2 85962- 3 85962- 4 85962- 5

| | | | | | |
|----------------|--------|--------|--------|--------|--------|
| Gasoline: | ND<50 | ND<50 | ND<50 | 250 * | ND<50 |
| Benzene: | ND<0.5 | ND<0.5 | ND<0.5 | ND<0.5 | ND<0.5 |
| Toluene: | ND<0.5 | ND<0.5 | ND<0.5 | ND<0.5 | ND<0.5 |
| Ethyl Benzene: | ND<0.5 | ND<0.5 | ND<0.5 | ND<0.5 | ND<0.5 |
| Xylenes: | ND<0.5 | ND<0.5 | ND<0.5 | ND<0.5 | ND<0.5 |
| Concentration: | ug/L | ug/L | ug/L | ug/L | ug/L |

Laboratory Number: 85962- 6 85962- 7 85962- 8

| | | | |
|----------------|--------|------|--------|
| Gasoline: | ND<50 | 80 | 1500 |
| Benzene: | ND<0.5 | 36 | ND<0.5 |
| Toluene: | ND<0.5 | 0.6 | 180 |
| Ethyl Benzene: | ND<0.5 | 0.5 | 42 |
| Xylenes: | 0.7 | 0.7 | 130 |
| Concentration: | ug/L | ug/L | ug/L |

* Gasoline range concentration. Only a single peak was observed in the chromatogram.

JUN 25 1992



Superior Precision Analytical, Inc.

825 Arnold Drive, Suite 114 • Martinez, California 94553 • (510) 229-1512 / fax (510) 229-1526

C E R T I F I C A T E O F A N A L Y S I S

ANALYSIS FOR TOTAL PETROLEUM HYDROCARBONS

Page 2 of 2
 QA/QC INFORMATION
 SET: 85962

NA = ANALYSIS NOT REQUESTED
 ND = ANALYSIS NOT DETECTED ABOVE QUANTITATION LIMIT
 ug/L = parts per billion (ppb)

OIL AND GREASE ANALYSIS By Standard Methods Method 5520F:
 Minimum Detection Limit in Water: 5000ug/L

Modified EPA SW-846 Method 8015 for Extractable Hydrocarbons:
 Minimum Quantitation Limit for Diesel in Water: 50ug/L

EPA SW-846 Method 8015/5030 Total Purgable Petroleum Hydrocarbons:
 Minimum Quantitation Limit for Gasoline in Water: 50ug/L

EPA SW-846 Method 8020/BTXE
 Minimum Quantitation Limit in Water: 0.5ug/L

| ANALYTE | SPIKE LEVEL | MS/MSD RECOVERY | RPD | CONTROL LIMIT |
|----------------|-------------|-----------------|-----|---------------|
| Gasoline: | 200 ng | 95/95 | 0 | 70-130 |
| Benzene: | 200 ng | 99/100 | 2 | 70-130 |
| Toluene: | 200 ng | 95/97 | 2 | 70-130 |
| Ethyl Benzene: | 200 ng | 100/102 | 2 | 70-130 |
| Xylenes: | 200 ng | 90/93 | 4 | 70-130 |

Richard Srna, Ph.D.

Charles Srna
 Laboratory Director

Fax copy of Lab Report and COC to Chevron Contact:

Yes

No 85962

Chain-of-Custody-Record

| | | |
|--|---|--|
| Chevron U.S.A. Inc. P.O. BOX 5004 San Ramon, CA 94583 FAX (415)842-9591 | Chevron Facility Number <u>9-2960</u> Facility Address <u>2416 GROVEWAY, CASANO VALLEY</u> Consultant Project Number <u>31-0563</u> Consultant Name <u>ALTON Geoscience</u> Address <u>5870 Stoneridge Dr., Ste. G Pleasanton</u> Project Contact (Name) <u>Todd Pearson</u> (Phone) <u>510-734-8134</u> (Fax Number) <u>510-734-8420</u> | Chevron Contact (Name) <u>Ken Kan</u> (Phone) <u>510-842-9500</u> Laboratory Name <u>SAL</u> Laboratory Release Number <u>2512110</u> Samples Collected by (Name) <u>ANDREW BLOCK</u> Collection Date <u>6-4-92</u> Signature <u>[Signature]</u> |
|--|---|--|

| Sample Number | Lab Sample Number | Number of Containers | Media S = Soil W = Water A = Air C = Charcoal | Type G = Grab C = Composite D = Discrete | Time | Sample Preservation | Iced (Yes or No) | Analytes To Be Performed | | | | | | | | | | | Remarks | | | |
|---------------|-------------------|----------------------|---|---|------|---------------------|------------------|---------------------------------|----------------------|--------------------------|----------------------------------|-------------------------------|------------------------------|--------------------------------|--|--|--|--|---------|--|--|---|
| | | | | | | | | BTEX + TPH GAS (8020 + 8015) | TPH Diesel (8015) | Oil and Grease (8020) | Purgeable Hydrocarbons (8010) | Purgeable Aromatics (8020) | Purgeable Organics (8240) | Extractable Organics (8270) | Metals Cd, Cr, Pb, Zn, Ni (8040 or AA) | | | | | | | |
| TB-LB | 1 | 1 | W | G | 1325 | HCL | Yes | X | | | | | | | | | | | | | | DO NOT FILL FOR TB-LB SAMPLE 2512110 NOTE SAMPLE DATE AND MAX HOLDING TIME. |
| RIN | 2 | 1 | W | G | 1325 | HCL | Y | X | | | | | | | | | | | | | | |
| C-6 | 3 | 2 | W | G | 1330 | HCL | Y | X | | | | | | | | | | | | | | |
| C-7 | 4 | 2 | W | G | 1344 | HCL | Y | X | | | | | | | | | | | | | | |
| C-5 | 5 | 2 | W | G | 1357 | HCL | Y | X | | | | | | | | | | | | | | |
| C-4 | 6 | 2 | W | G | 1416 | HCL | Y | X | | | | | | | | | | | | | | |
| C-3 | 7 | 2 | W | G | 1452 | HCL | Y | X | | | | | | | | | | | | | | |
| C-2 | 8 | 2 | W | G | 1542 | HCL | Y | X | | | | | | | | | | | | | | |

Please initial: _____

Samples Stored in ice _____

Appropriate containers _____

Samples preserved _____

VOA's without headspace _____

Comments: _____

| | | | | | | |
|---|--|---|--|---|--|---|
| Relinquished By (Signature) <u>[Signature]</u> Relinquished By (Signature) <u>[Signature]</u> Relinquished By (Signature) _____ | Organization <u>ALTON</u> <u>EX-15</u> _____ | Date/Time <u>6-12-92/1210</u> <u>6-12-92 1335</u> _____ | Received By (Signature) <u>[Signature]</u> Received By (Signature) _____ Received For Laboratory By (Signature) <u>[Signature]</u> | Organization <u>EX-15</u> _____ _____ | Date/Time <u>6/12/92 1318</u> _____ <u>6/12/92 17:45</u> | Turn Around Time (Circle Choice) — 24 Hrs. 48 Hrs. 6 Days 10 Days All Unchecked Change to 10 days per A Block 6/12/92 |
|---|--|---|--|---|--|---|