

C A M B R I A



Transmittal

To: Mr. Don Huang
Company: ACHCSA - Environmental Health Division
Address: 1131 Harbor Bay Parkway, Suite 250
Alameda, CA 94502
Phone: (510) 567-6746

From: Robert Foss
Phone: (925) 973-3126
Pages: 34 (including cover page)
Date: September 1, 2000
Re: Subsurface Investigation Report
Chevron SS #9-3322
7225 Bancroft Avenue, Oakland 94605

RECEIVED
ENVIRONMENTAL
HEALTH DIVISION
SEP 6 10 59 AM '01

Mr. Huang:

Attached hereto you will find a copy of the Subsurface Investigation Report, dated August 31, 2000. This report documents recent environmental activities conducted at the above referenced Chevron site.

If you have any questions or comments pertaining to the data presented in this report, please contact me at (925) 973-3126.

Robert Foss
Senior Project Manager

cc: Mr. Tom Bauhs, Chevron Products Company
Mr. Greg Wanket, Chevron Products Company (2 copies)
Mr. Amar Sidhu, Chevron Dealer, SS #9-3322, 32875 Bluebird Loop, Fremont, CA 94555

C A M B R I A

August 31, 2000

Mr. Tom Bauhs
Chevron Products Company
6001 Bollinger Canyon Road, Bldg. L
San Ramon, California 94583

Re: **Subsurface Investigation Report**
Chevron Service Station #9-3322
7225 Bancroft Avenue
Oakland, California
Cambria Job No. 31A-1806



Dear Mr. Bauhs:

On behalf of Chevron Products Company (Chevron), Cambria Environmental Technology, Inc. (Cambria) has completed a subsurface investigation at the site referenced above. Our primary objective was to further define the extent of petroleum hydrocarbons in soil and groundwater beneath the Chevron facility. Presented below are a site summary, results of soil and groundwater sample analysis and Cambria's conclusions.

SITE SUMMARY

The site is located on a parcel bordered by Bancroft Avenue to the northeast, Halliday Avenue to the southwest and 73rd Avenue to the southeast in Oakland (Figure 1). The area surrounding the site is primarily residential with the Eastmont Mall north of the site across Bancroft Avenue. A 76 Products service station is located across the intersection on the northern corner of Bancroft and 73rd Avenues. The site elevation is approximately 40 feet (ft) above mean sea level and the topography slopes gently westward toward San Francisco Bay. The nearest surface water is Arroyo Viejo Creek approximately 1,300 ft south of the site.

Oakland, CA
San Ramon, CA
Sonoma, CA
Portland, OR

**Cambria
Environmental
Technology, Inc.**

Chevron owns the property and has operated a service station there from approximately 1961 to the present. The service station currently operates with three 10,000-gallon fuel underground storage tanks (USTs) and three dispenser islands. The single-walled fiberglass USTs were installed in 1981 and are located along the southeastern property boundary. Chevron records indicate that the facility is in its third configuration. No records were located indicating the original 1961 station layout.

2694 Bishop Drive
Suite 105
San Ramon, CA 94583
Tel (925) 275-3200
Fax (925) 275-3204

The product piping was removed and replaced in 1996 and a maximum of 500 ppm TPHg was detected beneath a first generation dispenser island. All other soil samples were either below detection limits or contained low concentrations of hydrocarbons. Groundwater monitoring wells MW-1 through MW-3 were installed in January 1998. ~~Separate-phase hydrocarbons (SPH)~~ were observed in well MW-1 from June through October 1999, at a maximum thickness of 0.40 ft. A sample of the SPH from well MW-1 has been fingerprinted as pre-1992 leaded gasoline.

A search of California DWR records to identify domestic and municipal supply wells within a 0.5 mile radius of the site was conducted in July 1998. Seven wells were located within the search area, but none were identified as domestic or municipal wells.



Wells MW-4 through MW-6 were installed in January 1999 to further define the extent of hydrocarbons in soil and groundwater beneath the site. No hydrocarbons were detected in any of the nine samples analyzed, thereby defining the downgradient extent of hydrocarbons in soil. MW-5 and MW-6 contained dissolved hydrocarbons apparently migrating northward from a source near the southwestern dispenser island.

REGIONAL GEOLOGY AND HYDROGEOLOGY

The site is situated on the East Bay Plain Groundwater Basin. The East Bay Plain overlies the eastern flank of a Franciscan bedrock depression, bounded by the San Andreas and Hayward faults on the west and east, respectively. The bedrock unit is overlain by unconsolidated Pleistocene and Holocene sediments. Groundwater in the vicinity of the site occurs in the shallow sediments approximately 15 to 20 feet below grade (fbg).

INVESTIGATION RESULTS

Boring locations were selected based on data gathered from previous investigations to further define hydrocarbon sources beneath the site.

The results of Cambria's subsurface investigation are summarized below. Analytical results for soil and groundwater are summarized in Tables 1 and 2, respectively. The boring logs for B-1 through B-3/MW-7 are presented as Attachment A. The laboratory analytic reports for soil and groundwater samples are presented as Attachment B. Historical groundwater analytic data are presented as Attachment C.

Soil Borings

Personnel Present: Cambria geologist Albert Simmons conducted fieldwork under the direction of Cambria Registered Geologist Scott MacLeod.

Permits: Work was conducted under Alameda County Public Works Agency Permit No. W00-393, issued 6/28/00.

Drilling Company: Vironex Environmental Services of Hayward, California.

Drilling Date: July 3, 2000

Drilling Method: GeoProbe.

Number of Borings: Three. Borings B-1, B-2 and B-3 were drilled up gradient (south) of the southwestern pump island and to the southwest and north of the USTs, respectively (Figure 2).

Sediment Description: Soils beneath the site are characterized primarily by interbedded clays, fine grained sands, and gravels. Soil from the surface to approximately 5 fbg consists of clay with minor fine grained sand. Between 5 and 11-15 fbg the soil is dominated by fine grained sandy clays with minor to moderate gravels. Deeper soils are dominated by well graded gravels containing varying percentages of sand and clay to approximately 24 fbg.

Sampling Technique: The borings were hydraulically driven. Cambria collected soil samples at approximately 5 foot intervals and at obvious lithologic changes. Samples collected for laboratory analysis were properly sealed, logged on the chain of custody forms, preserved on ice and released to Sequoia Analytical Laboratory of Walnut Creek, California for analysis.

Soil Disposal: A minimal amount of soil cuttings were generated during this investigation due to the drilling method. Soil from the sampling tubes not retained for analysis was placed in a 30-gallon barrel and stored onsite pending analytic results. Upon receipt of analytic results, the soil cuttings will be disposed of at a Chevron approved facility.

Groundwater Sampling: Indications of groundwater were encountered at depths from 20 to 25 fbg across the site and groundwater rose only slightly in borings B-1 and B-3 to approximately 23 fbg. A prepackaged well screen was installed in boring B-3 to construct well MW-7. Groundwater samples were collected from MW-7 and B-1. The samples were preserved with HCl, logged on the chain of custody form, preserved on ice and released to Sequoia Analytical of Walnut Creek, California for analysis.

Laboratory Analysis: Based on the screening, selected samples were analyzed for:

- TPHg by Modified EPA Method 8015,
- BTEX and MTBE by EPA Method 8020, and
- Confirmation of MTBE by EPA Method 8260A.

Groundwater Flow: Groundwater beneath the site has been calculated to flow north-northwesterly.

HYDROCARBON DISTRIBUTION IN SOIL

The highest TPHg and benzene concentrations were detected at 18 fbg in boring B-2 (Table 1). This sample contained 140 mg/kg TPHg and 0.88 mg/kg benzene. Although 1.7 mg/kg MTBE was also detected in this sample by EPA Method 8020, no MTBE was detected by EPA Method 8260 at a detection limit of 0.1 mg/kg. Therefore, the MTBE detection by EPA Method 8020 was a false positive. The highest hydrocarbon concentrations in all borings was detected near the water table. Because no hydrocarbons were detected in soil from down-gradient wells MW-4, MW-5 and MW-6, the down-gradient extent of hydrocarbons in soil is defined.

HYDROCARBON DISTRIBUTION IN GROUNDWATER

The highest hydrocarbon concentrations detected in groundwater during this investigation was 11,000 ug/l TPHg and 4,300 ug/l benzene in new well MW-7. Boring B-1 contained the highest MTBE concentrations, 2,000 ug/l by EPA Method 8260. Boring B-2 did not produce sufficient water to obtain a groundwater sample for analysis.

Based on data from this investigation and previous work, the likely source of hydrocarbons including MTBE is the dispenser islands. The extent of hydrocarbons is defined to the north by wells MW-4 and MW-5. The extent of hydrocarbons in groundwater west, south and east is not currently defined.

CONCLUSIONS



It appears that there are two generations of hydrocarbon releases at the site. The separate-phase hydrocarbons detected in well MW-1 were fingerprinted as pre-1992 leaded gasoline. However, MTBE has also been detected in groundwater, indicating a more recent release. Based on the MTBE concentrations detected, the release does not appear to be large. The MTBE data collected quarterly using EPA Method 8020 also indicates a stable MTBE plume. TPHg and benzene concentrations are also stable indicating a stable TPHg/benzene plume.

CLOSING

Please call Robert Foss at (925) 973-3126 if you have any questions or comments regarding this report. The new consultant for this site is Gettler-Ryan in the Rancho Cordova office. Please direct any future correspondence to Greg Gurs at Gettler-Ryan.

Sincerely,
Cambria Environmental Technology, Inc.

Robert Foss

Robert Foss
Senior Project Manager

James Perkins
James Perkins, R.G.
Principal Remediation Manager

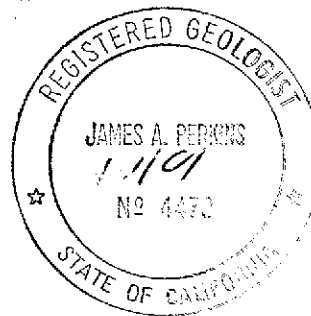

cc: Mr. Don Huang, Alameda County Health Care Services Agency
Mr. Greg Wanket, Chevron Products Company

- Figures: 1 - Vicinity Map
 2 - Site Plan with Geoprobe Boring Locations
- Tables: 1 - Analytic Results for Soil
 2 - Analytic Results for Groundwater
- Attachments: A - Boring Log
 B - Analytic Results For Soil/Groundwater
 C - Historical Groundwater Analytic Data



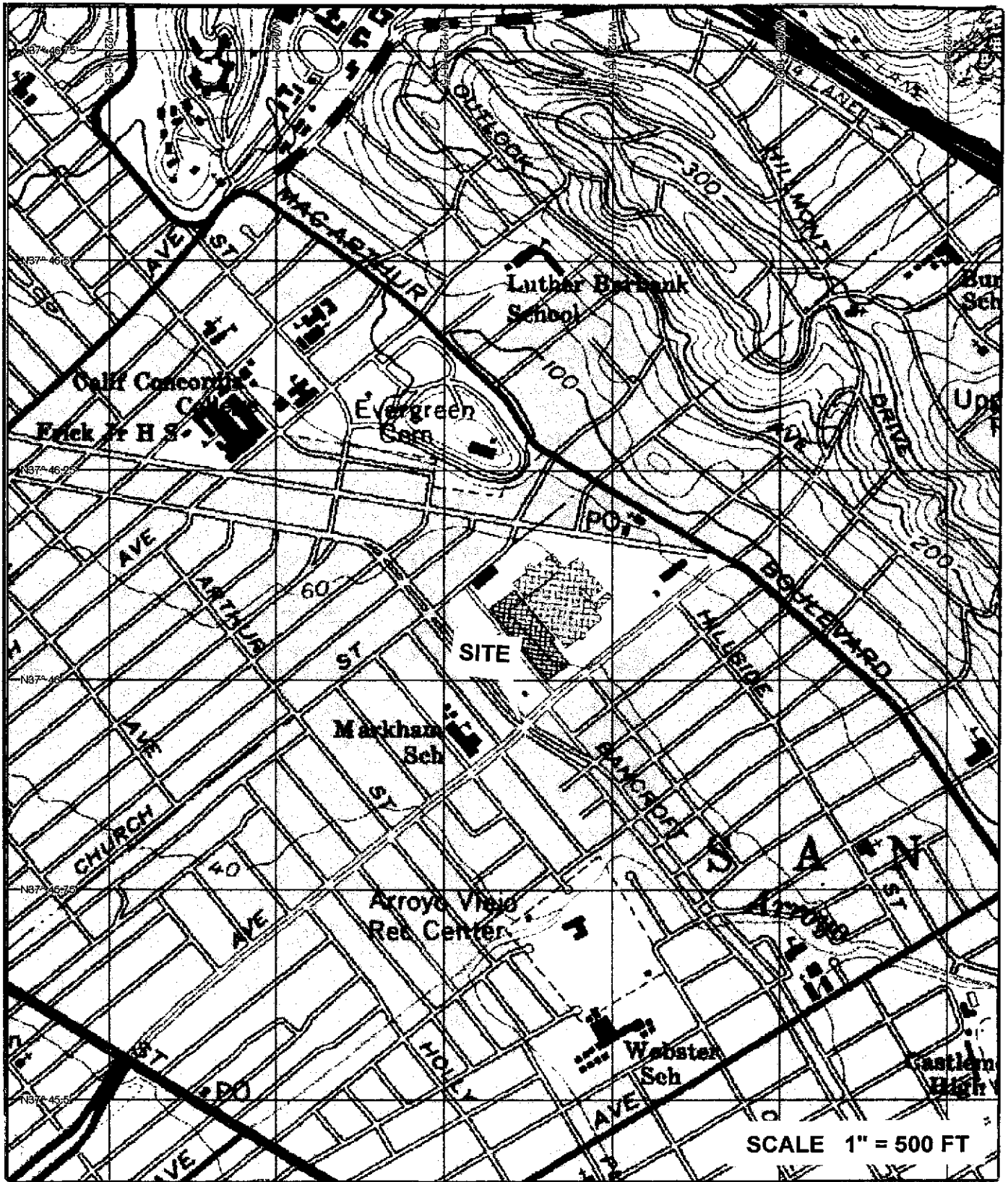

Chevron Service Station 9-3322

7225 Bancroft Avenue
Oakland, California



C A M B R I A

Vicinity Map

FIGURE

1

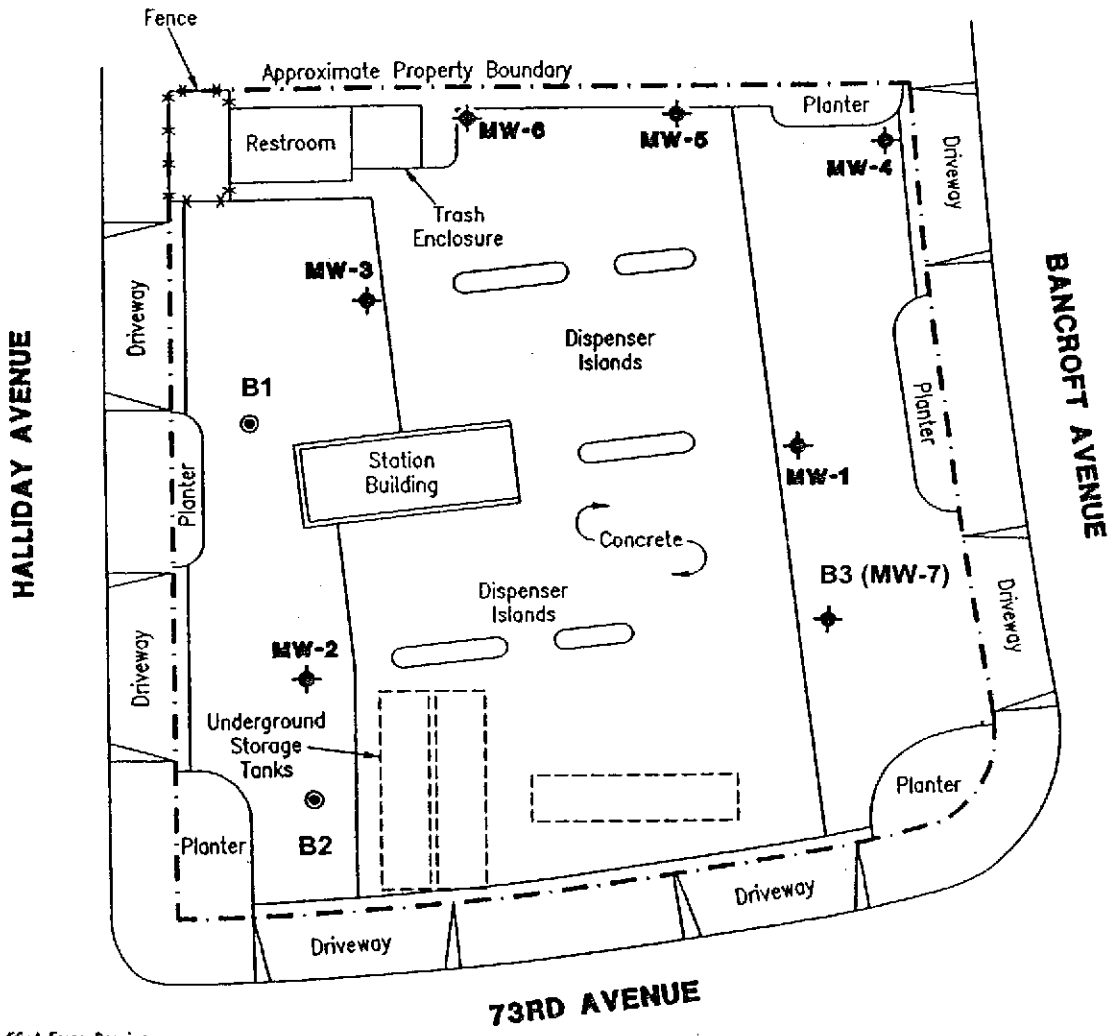

Source: Figure Modified From Drawing Provided By Chevron And Survey Provided By Vrail Chavez Land Surveying.

EXPLANATION

MW-1 ◆ Monitoring well location

● Boring location

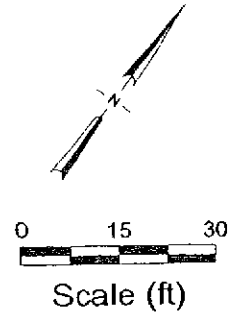

FIGURE
2

Chevron Service Station 9-3322
7225 Bancroft Avenue
Oakland, California



**Soil Boring
Location Map**

CAMBRIA

Table 1. Analytical Results for Soil - Chevron Station #9-3322, 7225 Bancroft Avenue, Oakland, California

Boring ID	Sampling Date	TPHg	Benzene (concentrations reported in mg/kg)	Toluene	Ethylbenzene	Xylenes	MTBE (8020/8260A)
B1-10'	7/3/00	<1.0	<0.005	<0.005	<0.005	<0.005	<0.050/NA
B1-17.5'	7/3/00	<1.0	<0.005	<0.005	<0.005	<0.005	0.083/NA
B2-5'	7/3/00	<1.0	<0.005	<0.005	<0.005	<0.005	<0.050/NA
B2-10'	7/3/00	<1.0	<0.005	<0.005	<0.005	<0.005	<0.050/NA
B2-18'	7/3/00	140	0.88	1.1	5.8	1.1	1.7/<0.10
B3-10'	7/3/00	<1.0	0.016	<0.005	<0.005	0.01	<0.050/NA
B3-15'	7/3/00	94	0.21	0.68	1.9	8.7	<0.050/NA
B3-19'	7/3/00	58	0.21	0.52	1.2	5.9	<0.050/NA

Abbreviations/Notes:

Total Petroleum Hydrocarbons as gasoline (TPHg) by EPA Method 8015M

Benzene, Toluene, Ethylbenzene, Xylenes and MTBE by EPA Method 8020

<x.xxx - Not detected above method detection limits

NA - Not analyzed

Table 2. Analytical Results for Groundwater - Chevron Station #9-3322, 7225 Bancroft Avenue, Oakland, California

Boring ID	Sampling Date	TPHg	Benzene (concentrations reported in ug/l)	Toluene	Ethylbenzene	Xylenes	MTBE (8020/8260)
B1-W	7/3/00	270	140	3.6	3.9	19	1,600/2,000
B3-W (MW-7)	7/5/00	11,000	4,300	2,900	590	2,800	260/NA

Abbreviations/Notes:

Total Petroleum Hydrocarbons as gasoline (TPHg) by EPA Method 8015M

Benzene, Toluene, Ethylbenzene, Xylenes and MTBE by EPA Method 8020

NA - Not analyzed

ATTACHMENT A

Boring Logs



Cambria Environmental Technology, Inc.
 1144 - 65th St.
 Oakland, CA 94608
 Telephone: (510) 420-0700
 Fax: (510) 420-9170

BORING/WELL LOG

CLIENT NAME	Chevron Products Company	BORING/WELL NAME	B1
JOB/SITE NAME	9-3322	DRILLING STARTED	03-Jul-00
LOCATION	7225 Bancroft Ave, Oakland, CA	DRILLING COMPLETED	03-Jul-00
PROJECT NUMBER	31A-1806	WELL DEVELOPMENT DATE (YIELD)	NA
DRILLER	Vironex	GROUND SURFACE ELEVATION	Not Surveyed
DRILLING METHOD	Hydraulic push	TOP OF CASING ELEVATION	NA
BORING DIAMETER	2"	SCREENED INTERVAL	NA
LOGGED BY	Albert Simmons	DEPTH TO WATER (First Encountered)	
REVIEWED BY	Bob Foss	DEPTH TO WATER (Static)	NA
REMARKS	Hand augered to five feet bgs		

TPHg (mg/kg)	BLOW COUNTS	SAMPLE ID	EXTENT	DEPTH (ft bgs)	U.S.C.S.	GRAPHIC LOG	LITHOLOGIC DESCRIPTION	CONTACT DEPTH (ft bgs)	WELL DIAGRAM
							ASPHALT Black CLAY w/trace sand, damp, stiff, 95% clay, 5% sand	0.5	
NA		B1-5'		5	CL		Brown Sandy CLAY , dry, very stiff, 80% clay, 20% sand	5.0	
					CL		Brown Sandy CLAY w/gravels, dry, stiff, 60% clay, 30% sand, 10% gravels	8.0	
<1.0		B1-10'		10	CL				
					CL				
NA		B1-15'		15	GC		Olive Clayey GRAVEL w/ sand, damp to moist, soft, 35% gravel, 30% clay, 20% sand	15.0	 ← Portland Type I/II
<1.0		B1-17.5'		17.5	CL		Light brown Sandy CLAY , moist, very stiff, 60% clay, 40% sand	18.0	
				20	CL				 Bottom of Boring @ 24 ft
				24.0					



Cambria Environmental Technology, Inc.
 1144 - 65th St.
 Oakland, CA 94608
 Telephone: (510) 420-0700
 Fax: (510) 420-9170

BORING/WELL LOG

CLIENT NAME	Chevron Products Company	BORING/WELL NAME	B2
JOB/SITE NAME	9-3322	DRILLING STARTED	03-Jul-00
LOCATION	7225 Bancroft Ave, Oakland, CA	DRILLING COMPLETED	03-Jul-00
PROJECT NUMBER	31A-1806	WELL DEVELOPMENT DATE (YIELD)	NA
DRILLER	Vironex	GROUND SURFACE ELEVATION	Not Surveyed
DRILLING METHOD	Hydraulic push	TOP OF CASING ELEVATION	NA
BORING DIAMETER	2"	SCREENED INTERVAL	NA
LOGGED BY	Albert Simmons	DEPTH TO WATER (First Encountered)	NA
REVIEWED BY	Bob Foss	DEPTH TO WATER (Static)	NA
REMARKS	Hand augered to five feet bgs		

TPHg (mg/kg)	BLOW COUNTS	SAMPLE ID	EXTENT	DEPTH (ft bgs)	U.S.C.S.	GRAPHIC LOG	LITHOLOGIC DESCRIPTION	CONTACT DEPTH (ft bgs)	WELL DIAGRAM
							CONCRETE	0.5	
<1.0		B2-5'		5	CL		Black CLAY w/trace sand, damp, stiff, 95% clay, 5% sand		
<1.0		B2-10'		10	CL		Dark brown Sandy CLAY , dry, very stiff, 60% clay, 40% sand		
NA		B2-15'		15	GC		Dark brown Clayey GRAVEL w/sand, dry, stiff, 45% gravel, 35% clay, 20% sand		
140		B2-18'		20	GC		Olive Sandy GRAVEL w/clay, moist, stiff, 50% gravel, 30% sand, 20% clay		
				20	GC		Olive Clayey GRAVEL w/sand, moist, stiff, 50% gravel, 30% clay, 20% sand		
								24.0	Bottom of Boring @ 24 ft

WELL LOG (TPH-G) I:\9-3322\GINT\9-3322.GPJ DEFAULT.GDT 7/28/00



Cambria Environmental Technology, Inc.
 1144 - 65th St.
 Oakland, CA 94608
 Telephone: (510) 420-0700
 Fax: (510) 420-9170

BORING/WELL LOG

CLIENT NAME	Chevron Products Company	BORING/WELL NAME	B3/MW-7
JOB/SITE NAME	9-3322	DRILLING STARTED	03-Jul-00
LOCATION	7225 Bancroft Ave, Oakland, CA	DRILLING COMPLETED	03-Jul-00
PROJECT NUMBER	31A-1806	WELL DEVELOPMENT DATE (YIELD)	NA
DRILLER	Vironex	GROUND SURFACE ELEVATION	Not Surveyed
DRILLING METHOD	Hydraulic push	TOP OF CASING ELEVATION	NA
BORING DIAMETER	3"	SCREENED INTERVAL	10 to 25 ft bgs
LOGGED BY	Albert Simmons	DEPTH TO WATER (First Encountered)	NA
REVIEWED BY	Bob Foss	DEPTH TO WATER (Static)	23.20 ft (05-Jul-00)
REMARKS	Hand augered to five feet bgs		

TPHg (mg/kg)	BLOW COUNTS	SAMPLE ID	EXTENT	DEPTH (ft bgs)	U.S.C.S.	GRAPHIC LOG	LITHOLOGIC DESCRIPTION	CONTACT DEPTH (ft bgs)	WELL DIAGRAM
NA		B3-5'		5	CL		ASPHALT Black CLAY w/trace sand, damp, stiff, 95% clay, 5% sand	0.5	
					CL		Dark brown Sandy CLAY , dry, very stiff, 60% clay, 40% sand Note: gravel zone from 8-9' ft bgs	5.0	
<1.0		B3-10'		10	SC		Mottled orange & brown Clayey SAND , dry, stiff, 60% sand, 40% clay	9.0	
					GW		Brown GRAVEL w/ sand, dry, stiff, 70% gravel, 30% sand	12.0	
94		B3-15'		15	SC		Light brown Clayey SAND , moist, stiff, 60% sand, 40% clay	15.0	
					GW		Brown GRAVEL w/sand, moist, stiff, 65% gravel, 35% sand	19.0	
58		B3-19'		20	GW				
NA		B3-25'		25				25.0	Bottom of Boring @ 25 ft

WELL LOG (TPH-G) I:9-3322(GINT)9-3322.GPJ DEFAULT.GDT 7/28/00

ATTACHMENT B

Analytic Results For Soil/Groundwater



Sequoia Analytical

404 N. Wiget Lane
Walnut Creek, CA 94598
(925) 988-9600
FAX (925) 988-9673
www.sequolalabs.com

26 July, 2000

Albert Simmons
Cambria - San Ramon
2694 Bishop Drive Suite 105
San Ramon, CA 94583

RE: Chevron
Sequoia Report: W007164

Enclosed are the results of analyses for samples received by the laboratory on 10-Jul-00 16:00. If you have any questions concerning this report, please feel free to contact me.

Sincerely,

Charlie Westwater
Project Manager

CA ELAP Certificate #1271





Cambria - San Ramon
2694 Bishop Drive Suite 105
San Ramon CA, 94583

Project: Chevron
Project Number: Chevron # 9-3322
Project Manager: Albert Simmons

Reported:
26-Jul-00 11:42

ANALYTICAL REPORT FOR SAMPLES

Sample ID	Laboratory ID	Matrix	Date Sampled	Date Received
B1-W	W007164-01	Water	03-Jul-00 15:50	10-Jul-00 16:00
B3-W	W007164-02	Water	05-Jul-00 08:40	10-Jul-00 16:00
B1-10'	W007164-03	Soil	03-Jul-00 09:35	10-Jul-00 16:00
B1-17.5'	W007164-04	Soil	03-Jul-00 10:05	10-Jul-00 16:00
B2-5'	W007164-05	Soil	03-Jul-00 10:45	10-Jul-00 16:00
B2-10'	W007164-06	Soil	03-Jul-00 11:00	10-Jul-00 16:00
B2-18'	W007164-07	Soil	03-Jul-00 11:45	10-Jul-00 16:00
B3-10'	W007164-08	Soil	03-Jul-00 13:05	10-Jul-00 16:00
B3-15'	W007164-09	Soil	03-Jul-00 13:30	10-Jul-00 16:00
B3-19'	W007164-10	Soil	03-Jul-00 14:10	10-Jul-00 16:00

Charlie Westwater, Project Manager





Cambria - San Ramon
2694 Bishop Drive Suite 105
San Ramon CA, 94583

Project: Chevron
Project Number: Chevron # 9-3322
Project Manager: Albert Simmons

Reported:
26-Jul-00 11:42

Total Purgeable Hydrocarbons (C6-C12), BTEX and MTBE by DHS LUFT Sequoia Analytical - Walnut Creek

Analyte	Result	Reporting Limit	Units	Dilution	Batch	Prepared	Analyzed	Method	Notes
B1-W (W007164-01) Water Sampled: 03-Jul-00 15:50 Received: 10-Jul-00 16:00 P-01									
Purgeable Hydrocarbons	270	50	ug/l	1	0G17001	17-Jul-00	17-Jul-00	EPA 8015M/8020	
Benzene	140	0.50	"	"	"	"	"	"	
Toluene	3.6	0.50	"	"	"	"	"	"	
Ethylbenzene	3.9	0.50	"	"	"	"	"	"	
Xylenes (total)	19	0.50	"	"	"	"	"	"	
Methyl tert-butyl ether	1600	2.5	"	"	"	"	"	"	OCR-1
Surrogate: a,a,a-Trifluorotoluene		104 %	70-130		"	"	"	"	
B3-W (W007164-02) Water Sampled: 05-Jul-00 08:40 Received: 10-Jul-00 16:00 P-01									
Purgeable Hydrocarbons	11000	1000	ug/l	20	0G18001	18-Jul-00	18-Jul-00	EPA 8015M/8020	
Benzene	4300	10	"	"	"	"	"	"	
Toluene	2900	10	"	"	"	"	"	"	
Ethylbenzene	590	10	"	"	"	"	"	"	
Xylenes (total)	2800	10	"	"	"	"	"	"	
Methyl tert-butyl ether	260	50	"	"	"	"	"	"	
Surrogate: a,a,a-Trifluorotoluene		92.7 %	70-130		"	"	"	"	
B1-10' (W007164-03) Soil Sampled: 03-Jul-00 09:35 Received: 10-Jul-00 16:00									
Purgeable Hydrocarbons	ND	1.0	mg/kg	20	0G17014	17-Jul-00	17-Jul-00	EPA 8015/8020	
Benzene	ND	0.0050	"	"	"	"	"	"	
Toluene	ND	0.0050	"	"	"	"	"	"	
Ethylbenzene	ND	0.0050	"	"	"	"	"	"	
Xylenes (total)	ND	0.0050	"	"	"	"	"	"	
Methyl tert-butyl ether	ND	0.050	"	"	"	"	"	"	
Surrogate: a,a,a-Trifluorotoluene		101 %	40-140		"	"	"	"	





Cambria - San Ramon
2694 Bishop Drive Suite 105
San Ramon CA, 94583

Project: Chevron
Project Number: Chevron # 9-3322
Project Manager: Albert Simmons

Reported:
26-Jul-00 11:42

**Total Purgeable Hydrocarbons (C6-C12), BTEX and MTBE by DHS LUFT
Sequoia Analytical - Walnut Creek**

Analyte	Result	Reporting Limit	Units	Dilution	Batch	Prepared	Analyzed	Method	Notes
B1-17.5' (W007164-04) Soil Sampled: 03-Jul-00 10:05 Received: 10-Jul-00 16:00									
Purgeable Hydrocarbons	ND	1.0	mg/kg	20	0G17014	17-Jul-00	17-Jul-00	EPA 8015/8020	
Benzene	ND	0.0050	"	"	"	"	"	"	
Toluene	ND	0.0050	"	"	"	"	"	"	
Ethylbenzene	ND	0.0050	"	"	"	"	"	"	
Xylenes (total)	ND	0.0050	"	"	"	"	"	"	
Methyl tert-butyl ether	0.083	0.050	"	"	"	"	"	"	
<i>Surrogate: a,a,a-Trifluorotoluene</i>		92.3 %	40-140		"	"	"	"	
B2-5' (W007164-05) Soil Sampled: 03-Jul-00 10:45 Received: 10-Jul-00 16:00									
Purgeable Hydrocarbons	ND	1.0	mg/kg	20	0G17014	17-Jul-00	17-Jul-00	EPA 8015/8020	
Benzene	ND	0.0050	"	"	"	"	"	"	
Toluene	ND	0.0050	"	"	"	"	"	"	
Ethylbenzene	ND	0.0050	"	"	"	"	"	"	
Xylenes (total)	ND	0.0050	"	"	"	"	"	"	
Methyl tert-butyl ether	ND	0.050	"	"	"	"	"	"	
<i>Surrogate: a,a,a-Trifluorotoluene</i>		98.0 %	40-140		"	"	"	"	
B2-10' (W007164-06) Soil Sampled: 03-Jul-00 11:00 Received: 10-Jul-00 16:00									
Purgeable Hydrocarbons	ND	1.0	mg/kg	20	0G17014	17-Jul-00	17-Jul-00	EPA 8015/8020	
Benzene	ND	0.0050	"	"	"	"	"	"	
Toluene	ND	0.0050	"	"	"	"	"	"	
Ethylbenzene	ND	0.0050	"	"	"	"	"	"	
Xylenes (total)	ND	0.0050	"	"	"	"	"	"	
Methyl tert-butyl ether	ND	0.050	"	"	"	"	"	"	
<i>Surrogate: a,a,a-Trifluorotoluene</i>		101 %	40-140		"	"	"	"	





Cambria - San Ramon
2694 Bishop Drive Suite 105
San Ramon CA, 94583

Project: Chevron
Project Number: Chevron # 9-3322
Project Manager: Albert Simmons

Reported:
26-Jul-00 11:42

Total Purgeable Hydrocarbons (C6-C12), BTEX and MTBE by DHS LUFT
Sequoia Analytical - Walnut Creek

Analyte	Result	Reporting Limit	Units	Dilution	Batch	Prepared	Analyzed	Method	Notes
B2-18' (W007164-07) Soil Sampled: 03-Jul-00 11:45 Received: 10-Jul-00 16:00									P-01
Purgeable Hydrocarbons	140	5.0	mg/kg	100	0G17014	17-Jul-00	17-Jul-00	EPA 8015/8020	
Benzene	0.88	0.025	"	"	"	"	"	"	
Toluene	1.1	0.025	"	"	"	"	"	"	
Ethylbenzene	5.8	0.025	"	"	"	"	"	"	
Xylenes (total)	1.1	0.025	"	"	"	"	"	"	
Methyl tert-butyl ether	1.7	0.25	"	"	"	"	"	"	
Surrogate: a,a,a-Trifluorotoluene		207 %	40-140		"	"	"	"	S-04
B3-10' (W007164-08) Soil Sampled: 03-Jul-00 13:05 Received: 10-Jul-00 16:00									A-01
Purgeable Hydrocarbons	ND	1.0	mg/kg	20	0G17014	17-Jul-00	19-Jul-00	EPA 8015/8020	
Benzene	0.016	0.0050	"	"	"	"	"	"	
Toluene	ND	0.0050	"	"	"	"	"	"	
Ethylbenzene	ND	0.0050	"	"	"	"	"	"	
Xylenes (total)	0.010	0.0050	"	"	"	"	"	"	
Methyl tert-butyl ether	ND	0.050	"	"	"	"	"	"	
Surrogate: a,a,a-Trifluorotoluene		91.0 %	40-140		"	"	"	"	
B3-15' (W007164-09) Soil Sampled: 03-Jul-00 13:30 Received: 10-Jul-00 16:00									P-01
Purgeable Hydrocarbons	94	10	mg/kg	200	0G17014	17-Jul-00	17-Jul-00	EPA 8015/8020	
Benzene	0.21	0.050	"	"	"	"	"	"	
Toluene	0.68	0.050	"	"	"	"	"	"	
Ethylbenzene	1.9	0.050	"	"	"	"	"	"	
Xylenes (total)	8.7	0.050	"	"	"	"	"	"	
Methyl tert-butyl ether	ND	0.50	"	"	"	"	"	"	
Surrogate: a,a,a-Trifluorotoluene		136 %	40-140		"	"	"	"	





Cambria - San Ramon
2694 Bishop Drive Suite 105
San Ramon CA, 94583

Project: Chevron
Project Number: Chevron # 9-3322
Project Manager: Albert Simmons

Reported:
26-Jul-00 11:42

Total Purgeable Hydrocarbons (C6-C12), BTEX and MTBE by DHS LUFT

Sequoia Analytical - Walnut Creek

Analyte	Result	Reporting Limit	Units	Dilution	Batch	Prepared	Analyzed	Method	Notes
B3-19' (W007164-10) Soil Sampled: 03-Jul-00 14:10 Received: 10-Jul-00 16:00									P-01
Purgeable Hydrocarbons	58	10	mg/kg	200	0G17014	17-Jul-00	17-Jul-00	EPA 8015/8020	
Benzene	0.21	0.050	"	"	"	"	"	"	
Toluene	0.52	0.050	"	"	"	"	"	"	
Ethylbenzene	1.2	0.050	"	"	"	"	"	"	
Xylenes (total)	5.9	0.050	"	"	"	"	"	"	
Methyl tert-butyl ether	ND	0.50	"	"	"	"	"	"	
Surrogate: a,a,a-Trifluorotoluene		134 %	40-140		"	"	"	"	





Cambria - San Ramon
2694 Bishop Drive Suite 105
San Ramon CA, 94583

Project: Chevron
Project Number: Chevron # 9-3322
Project Manager: Albert Simmons

Reported:
26-Jul-00 11:42

**Total Purgeable Hydrocarbons (C6-C12), BTEX and MTBE by DHS LUFT - Quality Control
Sequoia Analytical - Walnut Creek**

Analyte	Result	Reporting Limit	Units	Spike Level	Source Result	%REC	%REC Limits	RPD	RPD Limit	Notes
---------	--------	-----------------	-------	-------------	---------------	------	-------------	-----	-----------	-------

Batch 0G17001 - EPA 5030B [P/T]

Blank (0G17001-BLK1)

Prepared & Analyzed: 17-Jul-00

Purgeable Hydrocarbons	ND	50	ug/l							
Benzene	ND	0.50	"							
Toluene	ND	0.50	"							
Ethylbenzene	ND	0.50	"							
Xylenes (total)	ND	0.50	"							
Methyl tert-butyl ether	ND	2.5	"							
<i>Surrogate: a,a,a-Trifluorotoluene</i>	27.2		"	30.0		90.7	70-130			

LCS (0G17001-BS1)

Prepared & Analyzed: 17-Jul-00

Benzene	17.4	0.50	ug/l	20.0		87.0	70-130			
Toluene	19.2	0.50	"	20.0		96.0	70-130			
Ethylbenzene	20.4	0.50	"	20.0		102	70-130			
Xylenes (total)	62.4	0.50	"	60.0		104	70-130			
<i>Surrogate: a,a,a-Trifluorotoluene</i>	25.9		"	30.0		86.3	70-130			

Matrix Spike (0G17001-MS1)

Source: W007063-04

Prepared & Analyzed: 17-Jul-00

Benzene	17.5	0.50	ug/l	20.0	ND	87.5	70-130			
Toluene	19.7	0.50	"	20.0	ND	98.5	70-130			
Ethylbenzene	22.0	0.50	"	20.0	ND	110	70-130			
Xylenes (total)	63.6	0.50	"	60.0	ND	106	70-130			
<i>Surrogate: a,a,a-Trifluorotoluene</i>	25.9		"	30.0		86.3	70-130			

Matrix Spike Dup (0G17001-MSD1)

Source: W007063-04

Prepared & Analyzed: 17-Jul-00

Benzene	16.6	0.50	ug/l	20.0	ND	83.0	70-130	5.28	20	
Toluene	18.4	0.50	"	20.0	ND	92.0	70-130	6.82	20	
Ethylbenzene	21.5	0.50	"	20.0	ND	108	70-130	2.30	20	
Xylenes (total)	59.5	0.50	"	60.0	ND	99.2	70-130	6.66	20	
<i>Surrogate: a,a,a-Trifluorotoluene</i>	26.0		"	30.0		86.7	70-130			





Cambria - San Ramon
2694 Bishop Drive Suite 105
San Ramon CA, 94583

Project: Chevron
Project Number: Chevron # 9-3322
Project Manager: Albert Simmons

Reported:
26-Jul-00 11:42

Total Purgeable Hydrocarbons (C6-C12), BTEX and MTBE by DHS LUFT - Quality Control
Sequoia Analytical - Walnut Creek

Analyte	Result	Reporting Limit	Units	Spike Level	Source Result	%REC	%REC Limits	RPD	RPD Limit	Notes
---------	--------	-----------------	-------	-------------	---------------	------	-------------	-----	-----------	-------

Batch 0G17014 - EPA 5030B [MeOH]

Blank (0G17014-BLK1)

Prepared & Analyzed: 17-Jul-00

Purgeable Hydrocarbons	ND	1.0	mg/kg							
Benzene	ND	0.0050	"							
Toluene	ND	0.0050	"							
Ethylbenzene	ND	0.0050	"							
Xylenes (total)	ND	0.0050	"							
Methyl tert-butyl ether	ND	0.050	"							
<i>Surrogate: a,a,a-Trifluorotoluene</i>	<i>0.586</i>		<i>"</i>	<i>0.600</i>		<i>97.7</i>	<i>40-140</i>			

LCS (0G17014-BS1)

Prepared & Analyzed: 17-Jul-00

Benzene	0.632	0.0050	mg/kg	0.800		79.0	50-150			
Toluene	0.656	0.0050	"	0.800		82.0	50-150			
Ethylbenzene	0.704	0.0050	"	0.800		88.0	50-150			
Xylenes (total)	2.07	0.0050	"	2.40		86.2	50-150			
<i>Surrogate: a,a,a-Trifluorotoluene</i>	<i>0.632</i>		<i>"</i>	<i>0.600</i>		<i>105</i>	<i>40-140</i>			

Matrix Spike (0G17014-MS1)

Source: W007164-03

Prepared & Analyzed: 17-Jul-00

Benzene	0.678	0.0050	mg/kg	0.800	ND	84.7	50-150			
Toluene	0.708	0.0050	"	0.800	ND	88.5	50-150			
Ethylbenzene	0.758	0.0050	"	0.800	ND	94.8	50-150			
Xylenes (total)	2.26	0.0050	"	2.40	ND	94.2	50-150			
<i>Surrogate: a,a,a-Trifluorotoluene</i>	<i>0.684</i>		<i>"</i>	<i>0.600</i>		<i>114</i>	<i>40-140</i>			

Matrix Spike Dup (0G17014-MSD1)

Source: W007164-03

Prepared & Analyzed: 17-Jul-00

Benzene	0.688	0.0050	mg/kg	0.800	ND	86.0	50-150	1.46	20	
Toluene	0.728	0.0050	"	0.800	ND	91.0	50-150	2.79	20	
Ethylbenzene	0.770	0.0050	"	0.800	ND	96.2	50-150	1.57	20	
Xylenes (total)	2.28	0.0050	"	2.40	ND	95.0	50-150	0.881	20	
<i>Surrogate: a,a,a-Trifluorotoluene</i>	<i>0.672</i>		<i>"</i>	<i>0.600</i>		<i>112</i>	<i>40-140</i>			





Cambria - San Ramon
2694 Bishop Drive Suite 105
San Ramon CA, 94583

Project: Chevron
Project Number: Chevron # 9-3322
Project Manager: Albert Simmons

Reported:
26-Jul-00 11:42

Total Purgeable Hydrocarbons (C6-C12), BTEX and MTBE by DHS LUFT - Quality Control Sequoia Analytical - Walnut Creek

Analyte	Result	Reporting Limit	Units	Spike Level	Source Result	%REC	%REC Limits	RPD	RPD Limit	Notes
---------	--------	-----------------	-------	-------------	---------------	------	-------------	-----	-----------	-------

Batch 0G18001 - EPA 5030B [P/T]

Blank (0G18001-BLK1)

Prepared & Analyzed: 18-Jul-00

Purgeable Hydrocarbons	ND	50	ug/l							
Benzene	ND	0.50	"							
Toluene	ND	0.50	"							
Ethylbenzene	ND	0.50	"							
Xylenes (total)	ND	0.50	"							
Methyl tert-butyl ether	ND	2.5	"							
<i>Surrogate: a,a,a-Trifluorotoluene</i>	29.4		"	30.0		98.0	70-130			

LCS (0G18001-BS1)

Prepared & Analyzed: 18-Jul-00

Benzene	16.5	0.50	ug/l	20.0		82.5	70-130			
Toluene	18.6	0.50	"	20.0		93.0	70-130			
Ethylbenzene	20.6	0.50	"	20.0		103	70-130			
Xylenes (total)	59.8	0.50	"	60.0		99.7	70-130			
<i>Surrogate: a,a,a-Trifluorotoluene</i>	25.4		"	30.0		84.7	70-130			

Matrix Spike (0G18001-MS1)

Source: W007058-03

Prepared & Analyzed: 18-Jul-00

Benzene	16.9	0.50	ug/l	20.0	ND	84.5	70-130			
Toluene	18.0	0.50	"	20.0	ND	90.0	70-130			
Ethylbenzene	20.0	0.50	"	20.0	ND	100	70-130			
Xylenes (total)	58.7	0.50	"	60.0	ND	97.8	70-130			
<i>Surrogate: a,a,a-Trifluorotoluene</i>	26.8		"	30.0		89.3	70-130			

Matrix Spike Dup (0G18001-MSD1)

Source: W007058-03

Prepared & Analyzed: 18-Jul-00

Benzene	17.6	0.50	ug/l	20.0	ND	88.0	70-130	4.06	20	
Toluene	19.3	0.50	"	20.0	ND	96.5	70-130	6.97	20	
Ethylbenzene	17.4	0.50	"	20.0	ND	87.0	70-130	13.9	20	
Xylenes (total)	63.6	0.50	"	60.0	ND	106	70-130	8.01	20	
<i>Surrogate: a,a,a-Trifluorotoluene</i>	25.3		"	30.0		84.3	70-130			





Cambria - San Ramon
2694 Bishop Drive Suite 105
San Ramon CA, 94583

Project: Chevron
Project Number: Chevron # 9-3322
Project Manager: Albert Simmons

Reported:
26-Jul-00 11:42

Notes and Definitions

- A-01 Sample was initially analyzed at dilution within the EPA recommended holding time. Reported result was analyzed outside of the EPA recommended holding time.
- O-04 This sample was analyzed outside the EPA recommended holding time.
- OCR-1 The result as reported exceeds the linear range of calibration.
- P-01 Chromatogram Pattern: Gasoline C6-C12
- S-04 The surrogate recovery for this sample is outside of established control limits due to a sample matrix effect.
- DET Analyte DETECTED
- ND Analyte NOT DETECTED at or above the reporting limit
- NR Not Reported
- dry Sample results reported on a dry weight basis
- RPD Relative Percent Difference



Chevron U.S.A. Inc. P.O. BOX 5004 San Ramon, CA 94583 FAX (415)842-9591	Chevron Facility Number <u>9-3322</u> Facility Address <u>7225 Bancroft Ave, Oakland, CA</u> Consultant Project Number _____ Consultant Name <u>Robert Fass</u> Address <u>2694 Bishop dr #105 San Ramon, CA</u> Project Contact (Name) <u>Albert Simmons</u> (Phone) <u>925-773-3129</u> (Fax Number) <u>925 275-3204</u>	Chevron Contact (Name) <u>Ed Simmons</u> (Phone) <u>925 842-9103</u> Laboratory Name <u>SEGONA W007164</u> Laboratory Release Number <u>9144488</u> Samples Collected by (Name) <u>Albert Simmons</u> Collection Date <u>7/13/00 - 7/15/00</u> Signature <u>Robert Fass</u>
--	--	---

Sample Number	Lab Sample Number	Number of Containers	Matrix S = Soil W = Water C = Charcoal	Type G = Grab C = Composite D = Discrete	Time	Sample Preservation	Iced (Yes or No)	Analysis To Be Performed												Please confirm highest MTRs w/ 8260 in soil samples and in 420 samples <small>Remarks</small> through A.S.
								BTEX + TPH GAS + K (8020 + 8015)	TPH Diesel (8015)	Oil and Grease (5520)	Purgeable Halocarbons (8010)	Purgeable Aromatics (8020)	Purgeable Organics (8240)	Extractable Organics (8270)	Metals Cd, Cr, Pb, Zn, Ni (ICAP or AA)					
B1-W	O1A-C	3	W	G	3:50pm	Y	Y	X											7/13/00	
B3-W	O2A-C	3	W	G	8:40am	Y	Y	X											7/15/00	

Relinquished By (Signature) <i>[Signature]</i>	Organization <u>Cambridge</u>	Date/Time <u>7/15/00</u>	Received By (Signature) <i>[Signature]</i>	Organization <u>Seg</u>	Date/Time <u>7/10/15/00</u>	Turn Around Time (Circle Choice) 24 Hrs. 48 Hrs. 5 Days 10 Days As Contracted
Relinquished By (Signature) <i>[Signature]</i>	Organization <u>Seg</u>	Date/Time <u>7/10/16/00</u>	Received By (Signature) <i>[Signature]</i>	Organization <u>Seg</u>	Date/Time <u>7/10/16/00</u>	
Relinquished By (Signature) <i>[Signature]</i>	Organization <u>Seg</u>	Date/Time <u>7/10/16/00</u>	Received For Laboratory By (Signature) <i>[Signature]</i>	Organization <u>Seg</u>	Date/Time <u>7/10/16/00</u>	

COC-3.DWG/03 01/HCH

Chevron U.S.A. Inc.
P.O. BOX 5004
San Ramon, CA 94583
FAX (415)842-9591

Chevron Facility Number 9-3322
Facility Address 7225 Bancroft Ave, Oakland, CA

Chevron Contact (Name) Rod Simmens
(Phone) 925 842-9103

Consultant Project Number _____
Laboratory Name Sequa W007169

Consultant Name Robert Foss
Laboratory Release Number 9144488

Address 2624 Bishop Dr. #105, San Ramon, CA 94583
Samples Collected by (Name) Albert Simmens

Project Contact (Name) Albert Simmens
Collection Date 7/2/00 & 7/5/00

(Phone) 925 973-3129 (Fax Number) 925 295-3204
Signature Albert Simmens

Sample Number	Lab Sample Number	Number of Containers	Matrix S = Soil W = Water A = Air C = Charcoal	Type G = Grab C = Composite D = Discrete	Time	Sample Preservation	Iced (Yes or No)	Analytes To Be Performed											Please confirm highest MTBE w/8260 in soil samples and in H2O Remarks: Samples thrown A.S.		
								BTEX + TPH GAS + M (8020 + 8015)	TPH Diesel (8015)	Oil and Grease (5520)	Purgeable Halocarbons (8010)	Purgeable Aromatics (8020)	Purgeable Organics (8240)	Extractable Organics (8270)	Metals Cd, Cr, Pb, Zn, Ni (ICAP or AA)						
B1-5'		1	S	D	9:20	NO	Y	X											HOLD		7/3/00
B1-10'	03A				9:35			X											HOLD		
B1-15'					9:50			X													
B1-17.5'	04A				10:10			X													
B2-5'	05A				10:45			X													
B2-10'	06A				11:00			X													
B2-15'					11:20			X											HOLD		
B2-18'	07A				11:45			X													
B3-5'					12:40			X											HOLD		
B3-10'	08A				1:05			X													
B3-15'	09A				1:30			X													
B3-19'	10A				2:10			X													
B3-25'					2:50			X											HOLD		

Relinquished By (Signature) <i>[Signature]</i>	Organization <u>Lambria</u>	Date/Time <u>7/5/00</u>	Received By (Signature) <i>[Signature]</i>	Organization <u>Sequa</u>	Date/Time <u>7-10/00</u>	Turn Around Time (Circle Choice) 24 Hrs. 48 Hrs. 5 Days 10 Days <u>As Contracted</u>
Relinquished By (Signature) <i>[Signature]</i>	Organization <u>Sequa</u>	Date/Time <u>7/10/00</u>	Received By (Signature)	Organization	Date/Time	
Relinquished By (Signature)	Organization	Date/Time	Received For Laboratory By (Signature) <i>[Signature]</i>		Date/Time <u>7/10/00</u>	

ATTACHMENT C

Historical Groundwater Analytic Data

Table 1
Groundwater Monitoring Data and Analytical Results
Chevron Service Station #9-3322
7225 Bancroft Avenue
Oakland, California

Vertical Measurements are in feet.

Analytical results are in parts per billion (ppb)

DATE	Well Head Elev.	Ground Water Elev.	Depth To Water	SPH Thickness	SPH Removed	Total SPH Removed	Notes	TPH-Gasoline	Benzene	Toluene	Ethyl-Benzene	Xylenes	MTBE
MW-1													
02/08/98	40.41	26.53	13.88	--	--	--	--	130,000	9700	8200	3200	15,000	<250
06/16/98	40.41	26.18	14.23	--	--	--	--	96,000	15,000	12,000	2600	11,000	1300
07/29/98	40.41	22.59	17.82	--	--	--	--	370,000	19,000	14,000	5800	15,000	<2500
08/13/98	40.41	22.01	18.40	--	--	--	--	120,000	19,000	16,000	2900	14,000	<1000
11/24/98	40.41	19.61	20.80	--	--	--	--	100,000	26,000	18,000	4000	22,000	2000
02/03/99	40.41	22.96	17.45	--	--	--	--	110,000	27,000	16,000	3800	22,000	<2.5
06/07/99	40.41	24.29	16.44	0.40	0.03	0.03	--	--	--	--	--	--	--
09/07/99	40.41	19.97	20.71	0.34	0.01	0.04	--	--	--	--	--	--	--
10/27/99	40.41	18.93	21.75	0.34	0.03	0.07	--	--	--	--	--	--	--
02/08/00	40.41	22.44	17.97	0.00	0.00	0.07	--	147,000	19,600	13,700	4020	21,300	<2500
05/05/00	40.41	24.36	16.05	0.00	--	--	Sheen	150,000 ¹	28,000	17,000	4,400	23,000	<1,000
MW-2													
02/08/98	38.73	31.13	7.60	--	--	--	--	24,000	130	170	450	1900	2300
06/16/98	38.73	29.61	9.12	--	--	--	--	8900	31	46	310	1100	260
07/29/98	38.73	27.06	11.67	--	--	--	--	7600	15	21	150	480	82
08/13/98	38.73	26.32	12.41	--	--	--	--	14,000	26	80	500	2100	32
11/24/98	38.73	23.10	15.63	--	--	--	--	37,000	63	220	1300	7100	770
02/03/99	38.73	27.16	11.57	--	--	--	--	16,000	140	110	850	3100	900
06/07/99	38.73	27.78	10.95	--	--	--	--	4300	<10	<10	120	260	160
09/07/99	38.73	26.00	12.73	--	--	--	--	10,700	50.5	<25	297	1020	<250
10/27/99	38.73	26.02	12.71	--	--	--	--	7240	53.8	31.9	234	654	448
02/08/00	38.73	28.59	10.14	--	--	--	--	10,100	42.9	18.4	424	1480	206
05/05/00	38.73	28.61	10.12	0.00	--	--	--	7,800 ¹	34	22	320	1,100	170

FROM : GETTLER RYAN INC

FAX NO. : 9255517899

JUL 28 2000 11:31AM P3

Table 1
Groundwater Monitoring Data and Analytical Results
 Chevron Service Station #9-3322
 7225 Bancroft Avenue
 Oakland, California

Vertical Measurements are in feet.

Analytical results are in parts per billion (ppb)

DATE	Well Head Elev.	Ground Water Elev.	Depth To Water	SPH Thickness	SPH Removed	Total SPH Removed	Notes	TPH-Gasoline	Benzene	Toluene	Ethyl-Benzene	Xylenes	MTBE
MW-3													
02/08/98	39.51	24.91	14.60	--	--	--	--	94,000	12,000	4400	2000	10,000	8000
06/16/98	39.51	25.53	13.98	--	--	--	--	38,000	5600	1400	1200	4700	6300
06/16/98	39.51	25.53	13.98	--	--	--	Confirmation run	--	--	--	--	--	4600
07/29/98	39.51	22.14	17.37	--	--	--	--	58,000	4100	700	1300	4200	4100
08/13/98	39.51	21.29	18.22	--	--	--	--	43,000	6800	1900	1600	6800	2300
11/24/98	39.51	19.06	20.45	--	--	--	--	40,000	5000	800	1600	6800	6000
11/24/98	39.51	19.06	20.45	--	--	--	Confirmation run	--	--	--	--	--	4400
02/03/99	39.51	22.03	17.48	--	--	--	--	47,000	7100	1600	1900	9000	5000
06/07/99	39.51	23.76	15.75	--	--	--	--	27,000	2500	540	1200	3900	2800
09/07/99	39.51	19.80	19.71	--	--	--	--	44,000	3930	1170	1760	7130	3440
10/27/99	39.51	19.09	20.42	--	--	--	--	28,200	2030	620	1260	5080	1710
02/08/00	39.51	21.76	17.75	--	--	--	--	25,300	2000	668	1210	5330	1760
05/05/00	39.51	23.87	15.64	0.00	--	--	--	27,000 ¹	2,600	960	1,500	5,200	2,500
MW-4													
02/02/99	40.24	27.07	13.17	--	--	--	--	<50	0.52	<0.5	<0.5	<0.5	6.0
06/07/99	40.24	23.83	16.41	--	--	--	--	<50	<0.5	<0.5	<0.5	<0.5	<2.5
09/07/99	40.24	19.34	20.90	--	--	--	--	<50	<0.5	<0.5	<0.5	<0.5	<5.0
10/27/99	40.24	18.65	21.59	--	--	--	--	<50	<0.5	<0.5	<0.5	<0.5	<2.5
02/08/00	40.24	23.08	17.16	--	--	--	--	<50	<0.5	<0.5	<0.5	<0.5	<5.0
05/05/00	40.24	24.22	16.02	0.00	--	--	--	<50	<0.50	<0.50	<0.50	<0.50	<2.5
MW-5													
02/02/99	40.37	21.57	18.80	--	--	--	--	72	2.7	<0.5	<0.5	<0.5	11
06/07/99	40.37	23.39	16.98	--	--	--	--	<50	<0.5	<0.5	<0.5	<0.5	<2.5
09/07/99	40.37	19.24	21.13	--	--	--	--	<50	<0.5	<0.5	<0.5	<0.5	6.92
10/27/99	40.37	18.45	21.92	--	--	--	--	<50	2.39	<0.5	<0.5	<0.5	21.3
02/08/00	40.37	21.39	18.98	--	--	--	--	<50	10.6	<0.5	<0.5	<0.5	21.7
05/05/00	40.37	23.48	16.89	0.00	--	--	--	<50	<0.50	<0.50	<0.50	<0.50	3.8

Table 1
Groundwater Monitoring Data and Analytical Results
 Chevron Service Station #9-3322
 7225 Bancroft Avenue
 Oakland, California

Vertical Measurements are in feet.

Analytical results are in parts per billion (ppb)

DATE	Well Head Elev.	Ground Water Elev.	Depth To Water	SPH Thickness	SPH Removed	Total SPH Removed	Notes	TPH-Gasoline	Benzene	Toluene	Ethyl-Benzene	Xylenes	MTBE
MW-6													
02/02/99	39.84	21.36	18.48	--	--	--	--	14,000	5600	<50	150	160	<250
06/07/99	39.84	23.39	16.45	--	--	--	--	1500	1100	33	25	34	200
09/07/99	39.84	19.35	20.49	--	--	--	--	6550	2940	81.5	177	84	865
10/27/99	39.84	18.61	21.23	--	--	--	--	3680	1240	29.6	115	14.9	735
02/08/00	39.84	21.44	18.40	--	--	--	--	17,300	8920	<100	378	211	2610
05/05/00	39.84	23.48	16.36	0.00	--	--	--	4,200 ¹	1,900	98	170	290	1,300
TRIP BLANK													
02/08/98	--	--	--	--	--	--	--	<50	<0.5	<0.5	<0.5	<0.5	<2.5
06/16/98	--	--	--	--	--	--	--	<50	<0.5	<0.5	<0.5	<0.5	<2.5
07/29/98	--	--	--	--	--	--	--	<50	<0.5	<0.5	<0.5	<0.5	<2.5
08/13/98	--	--	--	--	--	--	--	<50	<0.5	<0.5	<0.5	<0.5	<2.5
11/24/98	--	--	--	--	--	--	--	<50	<0.5	<0.5	<0.5	<0.5	<2.5
02/02/99	--	--	--	--	--	--	--	<50	<0.5	<0.5	<0.5	<0.5	<2.5
02/03/99	--	--	--	--	--	--	--	<50	<0.5	<0.5	<0.5	<0.5	<2.5
06/07/99	--	--	--	--	--	--	--	<50	<0.5	<0.5	<0.5	<0.5	<2.5
09/07/99	--	--	--	--	--	--	--	<50	<0.5	<0.5	<0.5	<0.5	<5.0
10/27/99	--	--	--	--	--	--	--	<50	<0.5	<0.5	<0.5	<0.5	<2.5
02/08/00	--	--	--	--	--	--	--	<50	<0.5	<0.5	<0.5	<0.5	<5.0
05/05/00	--	--	--	--	--	--	--	<50	<0.50	<0.50	<0.50	<0.50	<2.5

EXPLANATIONS:

Groundwater monitoring data and analytical results prior to May 5, 2000, was compiled from reports prepared by Blaine Tech Services, Inc.

- SPH = Separate-Phase Hydrocarbons
- TPH = Total Petroleum Hydrocarbons
- MTBE = Methyl tertiary butyl ether

¹ Laboratory report indicates gasoline C6-C12.



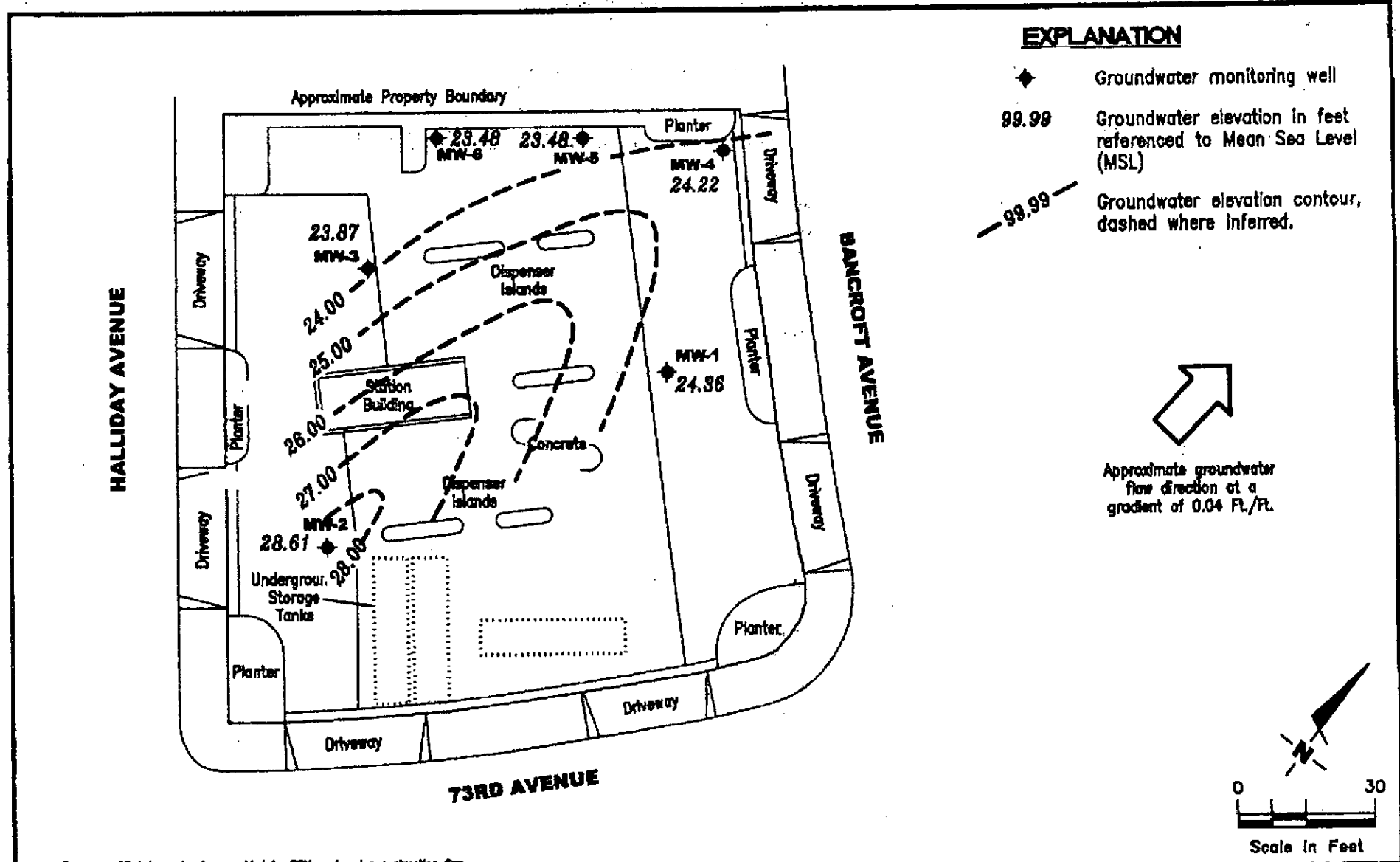

Source: Figure modified from drawing provided by REM engineering contracting firm.



Gettler - Ryan Inc.

6747 Sierra Ct., Suite J
Dublin, CA 94568 (925) 551-7555

POTENTIOMETRIC MAP
Chevron Service Station #9-3322
7225 Bancroft Avenue
Oakland, California

FIGURE
1

PROJECT NUMBER
386433

REVIEWED BY

DATE
May 5, 2000

REVISED DATE

FILE NAME: P:\ENVIRO\CHEVRON\9-3322\000-3322.DWG | Layout Tab: Pot2