



**Catalina Espino
Devine**
Project Manager
Marketing Business Unit

**Chevron Environmental
Management Company**
6101 Bollinger Canyon Road
San Ramon, CA 94583
Tel (925) 790-3949
espino@chevron.com

Alameda County Health Care Services
1131 Harbor Bay Parkway, Suite 250
Alameda, CA 94502-6577

RECEIVED

By Alameda County Environmental Health at 8:42 am, Feb 21, 2013

Re: Chevron Service Station No. 93322
7225 Bancroft Avenue
Oakland, CA

I have reviewed the attached report dated February 19, 2013.

I agree with the conclusions and recommendations presented in the referenced report. The information in this report is accurate to the best of my knowledge and all local Agency/Regional Board guidelines have been followed. This report was prepared by Conestoga-Rovers & Associates, upon whose assistance and advice I have relied.

This letter is submitted pursuant to the requirements of California Water Code Section 13267(b)(1) and the regulating implementation entitled Appendix A pertaining thereto.

I declare under penalty of perjury that the foregoing is true and correct to the best of my knowledge.

Sincerely,

A handwritten signature in blue ink, appearing to read "Catalina Espino Devine".

Catalina Espino Devine
Project Manager

Attachment: Report



**CONESTOGA-ROVERS
& ASSOCIATES**

5900 Hollis Street, Suite A
Emeryville, California 94608
Telephone: (510) 420-0700 Fax: (510) 420-9170
<http://www.craworld.com>

February 19, 2013

Reference No. 311806

Mr. Mark Detterman
Alameda County Environmental Health Services
1131 Harbor Bay Parkway, Suite 250
Alameda, California 94502-6577

Re: Fourth Quarter 2012
Groundwater Monitoring and Sampling Report
Former Chevron Service Station 93322
7225 Bancroft Avenue
Oakland, California
Agency Case RO0000274

Dear Mr. Detterman:

Conestoga-Rovers & Associates (CRA) is submitting this *Fourth Quarter 2012 Groundwater Monitoring and Sampling Report* for the site referenced above (Figure 1) on behalf of Chevron Environmental Management Company. Groundwater monitoring was performed by Blaine Tech Services (Blaine Tech) of San Jose, California. Blaine Tech's *Fourth Quarter Monitoring* report is included as Attachment A. Current and historical groundwater monitoring and sampling data are presented in Table 1. Eurofins-Lancaster Laboratories' *Analytical Results* is included as Attachment B.

Equal
Employment Opportunity
Employer



**CONESTOGA-ROVERS
& ASSOCIATES**

February 19, 2013

Reference No. 311806

- 2 -

Please contact Nathan Lee at (510) 420-3333 if you have any questions or require additional information.

Sincerely,

CONESTOGA-ROVERS & ASSOCIATES



Nathan Lee, PG 8486

NL/aa/16

Encl.

Figure 1	Vicinity Map
Figure 2	Groundwater Elevation and Hydrocarbon Concentration Map
Table 1	Groundwater Monitoring and Sampling Data
Attachment A	Monitoring Data Package
Attachment B	Laboratory Analytical Report

cc: Ms. Catalina Espino Devine, Chevron (*electronic copy*)
7225 Bancroft St, LP, Property Owner

FIGURES

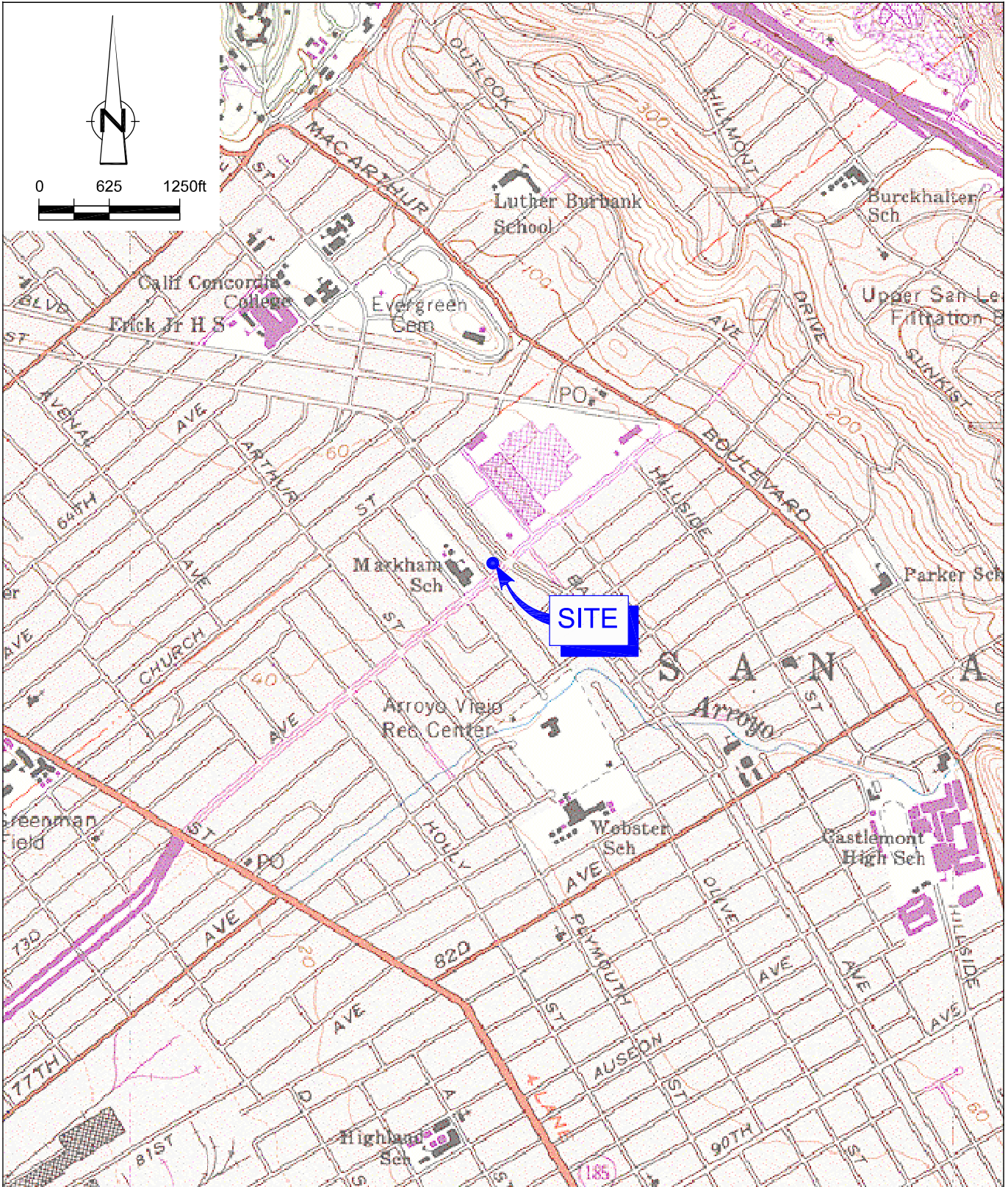

SOURCE: TOPO! MAPS.

Figure 1
 VICINITY MAP
 FORMER CHEVRON SERVICE STATION 93322
 7225 BANCROFT AVENUE
 Oakland, California



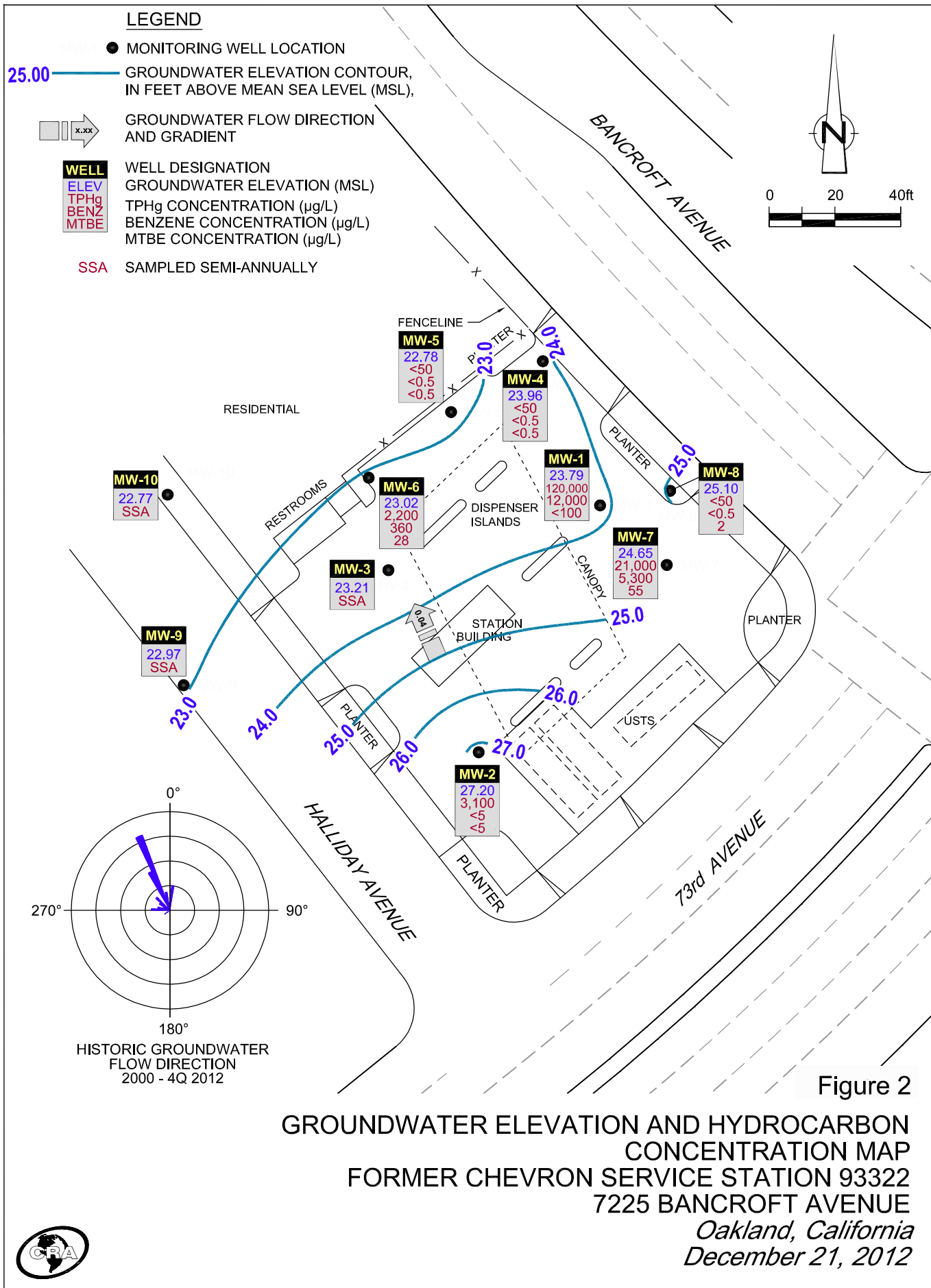

Figure 2
**GROUNDWATER ELEVATION AND HYDROCARBON
 CONCENTRATION MAP**
FORMER CHEVRON SERVICE STATION 93322
7225 BANCROFT AVENUE
Oakland, California
December 21, 2012



TABLE

TABLE 1

GROUNDWATER MONITORING AND SAMPLING DATA
 FORMER CHEVRON SERVICE STATION 93322
 7225 BANCROFT AVENUE
 OAKLAND, CALIFORNIA

Location	Date	TOC	DTW	GWE	LNAPLT	LNAPL REMOVED	HYDROCARBONS	PRIMARY VOCS					ADDITIONAL VOCS						
							TPH-GRO	B	T	E	X	MTBE by SW8260	MTBE by VOC	Ethanol	TBA	DIPE	ETBE	TAME	
	Units	ft	ft	ft-amsl	ft	gal	µg/L	µg/L	µg/L	µg/L	µg/L	µg/L	µg/L	µg/L	µg/L	µg/L	µg/L	µg/L	µg/L
MW-1	02/08/1998	40.41	13.88	26.53	0.00	0.00	130,000	9,700	8,200	3,200	15,000	-	<250.0	-	-	-	-	-	-
MW-1	06/16/1998	40.41	14.23	26.18	0.00	0.00	96,000	15,000	12,000	2,600	11,000	-	1,300	-	-	-	-	-	-
MW-1	07/29/1998	40.41	17.82	22.59	0.00	0.00	370,000	19,000	14,000	5,800	15,000	-	<2,500	-	-	-	-	-	-
MW-1	08/13/1998	40.41	18.40	22.01	0.00	0.00	120,000	19,000	16,000	2,900	14,000	-	<1,000	-	-	-	-	-	-
MW-1	11/24/1998	40.41	20.80	19.61	0.00	0.00	100,000	26,000	18,000	4,000	22,000	-	2,000	-	-	-	-	-	-
MW-1	02/03/1999	40.41	17.45	22.96	0.00	0.00	110,000	27,000	16,000	3,800	22,000	-	<2.5	-	-	-	-	-	-
MW-1	06/07/1999	40.41	16.44	24.29	0.40	0.03	-	-	-	-	-	-	-	-	-	-	-	-	-
MW-1	09/07/1999	40.41	20.71	19.97	0.34	0.01	-	-	-	-	-	-	-	-	-	-	-	-	-
MW-1	10/27/1999	40.41	21.75	18.93	0.34	0.03	-	-	-	-	-	-	-	-	-	-	-	-	-
MW-1	02/08/2000	40.41	17.97	22.44	0.00	0.00	147,000	19,600	13,700	4,020	21,300	-	<2,500	-	-	-	-	-	-
MW-1	05/05/2000	40.41	16.05	24.36	0.00	0.00	150,000 ²	28,000	17,000	4,400	23,000	-	<1,000	-	-	-	-	-	-
MW-1	07/28/2000	40.41	19.20	21.21	0.00	0.00	76,000 ²	20,000	15,000	3,400	23,000	-	1,200	-	-	-	-	-	-
MW-1	11/26/2000	40.41	20.18	20.44	0.26	0.26 ⁴	-	-	-	-	-	-	-	-	-	-	-	-	-
MW-1	02/09/2001	40.41	18.03	22.40	0.03	0.26 ⁴	-	-	-	-	-	-	-	-	-	-	-	-	-
MW-1	05/11/2001	40.41	15.10	25.31	0.00	0.00	89,000 ²	21,000	12,000	3,200	14,000	-	<500	-	-	-	-	-	-
MW-1	08/30/2001	40.41	20.42	20.05	0.07	0.26 ⁴	-	-	-	-	-	-	-	-	-	-	-	-	-
MW-1	11/21/2001	40.41	20.52	20.11	0.27	0.00	-	-	-	-	-	-	-	-	-	-	-	-	-
MW-1	02/05/2002	40.41	14.63	25.79	0.01	0.00	130,000	16,000	13,000	4,200	23,000	-	<30.0	-	-	-	-	-	-
MW-1	04/01/2002	37.40	12.37	25.03	0.00	0.00	-	-	-	-	-	-	-	-	-	-	-	-	-
MW-1	08/05/2002	37.40	12.94	24.46	0.00	0.00	230,000	12,000	9,000	5,500	28,000	-	280	-	-	-	-	-	-
MW-1	11/04/2002	37.40	20.03	17.37	0.00	0.00	130,000	24,000	15,000	3,900	20,000	-	<60	-	-	-	-	-	-
MW-1	02/03/2003	37.40	14.18	23.22	0.00	0.00	100,000	13,000	8,900	3,000	15,000	-	<130.0	-	-	-	-	-	-
MW-1	05/02/2003	37.40	13.28	24.12	0.00	0.00	140,000	9,900	5,900	4,200	21,000	-	<130	-	-	-	-	-	-

TABLE 1

GROUNDWATER MONITORING AND SAMPLING DATA
 FORMER CHEVRON SERVICE STATION 93322
 7225 BANCROFT AVENUE
 OAKLAND, CALIFORNIA

Location	Date	TOC	DTW	GWE	LNAPLT	LNAPL REMOVED	HYDROCARBONS	PRIMARY VOCS					ADDITIONAL VOCS						
							TPH-GRO	B	T	E	X	MTBE by SW8260	MTBE by VOC	Ethanol	TBA	DIPE	ETBE	TAME	
	Units	ft	ft	ft-amsl	ft	gal	µg/L	µg/L	µg/L	µg/L	µg/L	µg/L	µg/L	µg/L	µg/L	µg/L	µg/L	µg/L	µg/L
MW-1	08/01/2003 ⁷	37.40	16.82	20.58	0.00	0.00	250,000	16,000	7,300	3,700	19,000	45	-	-	-	-	-	-	-
MW-1	11/21/2003 ⁷	37.40	18.34	19.06	0.00	0.00	110,000	18,000	9,500	3,000	17,000	<10	-	-	-	-	-	-	-
MW-1	02/10/2004 ⁷	37.40	13.51	23.89	0.00	0.00	51,000	4,800	1,700	760	6,400	20	-	-	-	-	-	-	-
MW-1	05/11/2004 ⁷	37.40	14.35	23.05	0.00	0.00	80,000	13,000	6,500	2,800	14,000	61	-	-	-	-	-	-	-
MW-1	08/10/2004 ⁷	37.40	16.80	20.61	0.01	0.00	100,000	14,000	8,700	3,200	17,000	<25	-	-	-	-	-	-	-
MW-1	11/08/2004	37.40	15.63	21.89	0.15	1.30 ⁴	-	-	-	-	-	-	-	-	-	-	-	-	-
MW-1	02/21/2005	37.40	11.84	25.98	0.52	0.60 ⁴	-	-	-	-	-	-	-	-	-	-	-	-	-
MW-1	05/10/2005	37.40	11.49	26.11	0.25	1.11 ⁴	-	-	-	-	-	-	-	-	-	-	-	-	-
MW-1	05/12/2005	37.40	14.44	22.98	0.03	1.01 ⁴	-	-	-	-	-	-	-	-	-	-	-	-	-
MW-1	11/11/2005	37.40	18.58	19.13	0.39	0.75 ⁴	-	-	-	-	-	-	-	-	-	-	-	-	-
MW-1	02/20/2006	37.40	12.66	25.33	0.74	0.25 ⁴	-	-	-	-	-	-	-	-	-	-	-	-	-
MW-1	05/12/2006	37.40	10.71	26.92	0.29	0.05 ⁴	-	-	-	-	-	-	-	-	-	-	-	-	-
MW-1	08/14/2006	37.40	15.82	21.78	0.25	0.02 ⁴	-	-	-	-	-	-	-	-	-	-	-	-	-
MW-1	11/08/2006	37.40	18.49	19.21	0.38	0.55 ⁴	-	-	-	-	-	-	-	-	-	-	-	-	-
MW-1	02/07/2007	37.40	15.48	21.98	0.08	0.06 ¹⁰	-	-	-	-	-	-	-	-	-	-	-	-	-
MW-1	05/07/2007	37.40	4.83	32.77	0.25	0.39 ⁴	-	-	-	-	-	-	-	-	-	-	-	-	-
MW-1	08/03/2007	37.40	18.06	19.76	0.52	0.52 ⁴	-	-	-	-	-	-	-	-	-	-	-	-	-
MW-1	10/12/2007	37.40	19.29	18.13	0.03	0.16 ⁴	-	-	-	-	-	-	-	-	-	-	-	-	-
MW-1	11/02/2007 ⁷	37.40	19.18	18.22	0.00	0.00	140,000	9,800	9,500	4,100	20,000	<10	-	-	-	-	-	-	-
MW-1	12/07/2007 ⁷	37.40	19.06	18.34	0.00	0.00	130,000	11,000	11,000	3,800	20,000	10	-	-	-	-	-	-	-
MW-1	02/01/2008 ⁷	37.40	13.45	23.95	0.00	0.00	61,000	2,200	2,000	2,000	10,000	11	-	-	-	-	-	-	-
MW-1	05/09/2008 ⁷	37.40	15.10	22.30	0.00	0.00	81,000	13,000	10,000	3,500	18,000	30	-	-	-	-	-	-	-
MW-1	08/22/2008 ⁷	37.40	18.63	18.77	0.00	0.00	210,000	13,000	8,800	7,300	37,000	<50	-	-	-	-	-	-	-

TABLE 1

**GROUNDWATER MONITORING AND SAMPLING DATA
FORMER CHEVRON SERVICE STATION 93322
7225 BANCROFT AVENUE
OAKLAND, CALIFORNIA**

Location	Date	TOC	DTW	GWE	LNAPLT	LNAPL REMOVED	HYDROCARBONS		PRIMARY VOCS					ADDITIONAL VOCS					
							TPH-GRO	B	T	E	X	MTBE by SW8260	MTBE by VOC	Ethanol	TBA	DIPE	ETBE	TAME	
	Units	ft	ft	ft-amsl	ft	gal	µg/L	µg/L	µg/L	µg/L	µg/L	µg/L	µg/L	µg/L	µg/L	µg/L	µg/L	µg/L	µg/L
MW-1	11/26/2008 ⁷	37.40	20.09	17.31	0.00	0.00	68,000	15,000	9,100	3,600	17,000	<25	-	-	-	-	-	-	-
MW-1	05/20/2009	37.40	19.48	17.92	0.00	0.00	58,000	11,000	12,000	15,000	59,000	<50	-	<5,000	-	-	-	-	-
MW-1	08/26/2009	37.40	19.06	18.34	0.00	0.00	340,000	17,000	13,000	8,000	43,000	<25	-	<2,500	-	-	-	-	-
MW-1	11/12/2009	37.40	17.72	19.68	0.00	0.00	140,000	16,000	10,000	4,400	23,000	<10	-	<1,000	-	-	-	-	-
MW-1	02/01/2010	37.40	12.80	24.60	0.00	0.00	110,000	7,100	6,100	4,000	20,000	7 J	-	<500	-	-	-	-	-
MW-1	05/17/2010	37.40	11.14	26.26	0.00	0.00	75,000	7,200	3,600	2,700	12,000	31	-	<500	-	-	-	-	-
MW-1	08/26/2010	37.40	15.40	22.00	0.00	0.00	96,000	12,000	5,400	3,600	16,000	59	-	<500	-	-	-	-	-
MW-1	11/11/2010	37.40	17.70	19.70	0.00	0.00	120,000	13,000	6,600	2,700	13,000	26	-	<1,000	-	-	-	-	-
MW-1	02/10/2011	37.40	13.03	24.37	0.00	0.00	52,000	7,100	3,800	2,800	12,000	25	-	<1,000	-	-	-	-	-
MW-1	06/17/2011	37.40	12.35	25.05	0.00	0.00	30,000	3,600	940	1,000	3,200	52	-	<500	-	-	-	-	-
MW-1	09/08/2011	37.40	15.68	21.72	0.00	0.00	98,000	13,000	6,600	3,700	14,000	59	-	<1,000	-	-	-	-	-
MW-1	12/16/2011	37.40	16.47	20.93	0.00	0.00	140,000	14,000	6,500	2,900	12,000	47 J	-	<2,500	-	-	-	-	-
MW-1	03/02/2012	37.40	16.55	20.85	0.00	0.00	130,000	14,000	7,400	3,100	14,000	31	-	<1,000	-	-	-	-	-
MW-1	06/08/2012	37.40	14.11	23.29	0.00	0.00	120,000	8,900	2,900	2,600	11,000	86	-	<500	-	-	-	-	-
MW-1	09/14/2012	37.40	18.10	19.30	0.00	0.00	280,000	18,000	8,200	4,600	22,000	74	-	<2,500	110 J	<25	<25	<25	<25
MW-1	12/21/2012	37.40	13.61	23.79	0.00	0.00	120,000	12,000	6,800	3,000	15,000	<100	-	<10,000	-	-	-	-	-
MW-2	02/08/1998	38.73	7.60	31.13	0.00	0.00	24,000	130	170	450	1,900	-	2,300	-	-	-	-	-	-
MW-2	06/16/1998	38.73	9.12	29.61	0.00	0.00	8,900	31	46	310	1,100	-	260	-	-	-	-	-	-
MW-2	07/29/1998	38.73	11.67	27.06	0.00	0.00	7,600	15	21	150	480	-	82	-	-	-	-	-	-
MW-2	08/13/1998	38.73	12.41	26.32	0.00	0.00	14,000	26	80	500	2,100	-	32	-	-	-	-	-	-
MW-2	11/24/1998	38.73	15.63	23.10	0.00	0.00	37,000	63	220	1,300	7,100	-	770	-	-	-	-	-	-
MW-2	02/03/1999	38.73	11.57	27.16	0.00	0.00	16,000	140	110	850	3,100	-	900	-	-	-	-	-	-

TABLE 1

GROUNDWATER MONITORING AND SAMPLING DATA
 FORMER CHEVRON SERVICE STATION 93322
 7225 BANCROFT AVENUE
 OAKLAND, CALIFORNIA

Location	Date	TOC	DTW	GWE	LNAPLT	LNAPL REMOVED	HYDROCARBONS	PRIMARY VOCS					ADDITIONAL VOCS						
							TPH-GRO	B	T	E	X	MTBE by SW8260	MTBE by VOC	Ethanol	TBA	DIPE	ETBE	TAME	
	Units	ft	ft	ft-amsl	ft	gal	µg/L	µg/L	µg/L	µg/L	µg/L	µg/L	µg/L	µg/L	µg/L	µg/L	µg/L	µg/L	µg/L
MW-2	06/07/1999	38.73	10.95	27.78	0.00	0.00	4,300	<10	<10	120	260	-	160	-	-	-	-	-	-
MW-2	09/07/1999	38.73	12.73	26.00	0.00	0.00	10,700	50.5	<25	297	1,020	-	<250	-	-	-	-	-	-
MW-2	10/27/1999	38.73	12.71	26.02	0.00	0.00	7,240	53.8	31.9	234	654	-	448	-	-	-	-	-	-
MW-2	02/08/2000	38.73	10.14	28.59	0.00	0.00	10,100	42.9	18.4	424	1,480	-	206	-	-	-	-	-	-
MW-2	05/05/2000	38.73	10.12	28.61	0.00	0.00	7,800 ²	34	22	320	1,100	-	170	-	-	-	-	-	-
MW-2	07/28/2000	38.73	12.57	26.16	0.00	0.00	6,700 ²	40	13	490	540	-	190	-	-	-	-	-	-
MW-2	11/26/2000	38.73	11.90	26.83	0.00	0.00	8,200 ²	21	9.5	400	1,100	-	120	-	-	-	-	-	-
MW-2	02/09/2001	38.73	12.20	26.53	0.00	0.00	11,200 ³	<50.0	<50.0	629	1,380	-	282	-	-	-	-	-	-
MW-2	05/11/2001	38.73	8.98	29.75	0.00	0.00	6,800 ²	39	19	370	1,100	-	67	-	-	-	-	-	-
MW-2	08/30/2001	38.73	12.90	25.83	0.00	0.00	17,000	67	<25	750	2,100	-	360	-	-	-	-	-	-
MW-2	11/21/2001	38.73	13.12	25.61	0.00	0.00	3,500	14	<5.0	100	51	-	610	-	-	-	-	-	-
MW-2	02/05/2002	38.73	8.35	30.38	0.00	0.00	10,000	5.5	<10	330	960	-	63	-	-	-	-	-	-
MW-2	04/01/2002	35.72	7.81	27.91	0.00	0.00	-	-	-	-	-	-	-	-	-	-	-	-	-
MW-2	08/05/2002	35.72	15.91	19.81	0.00	0.00	8,800	18	8.2	220	630	-	220	-	-	-	-	-	-
MW-2	11/04/2002	35.72	14.14	21.58	0.00	0.00	14,000	28	10	670	1,600	-	440	-	-	-	-	-	-
MW-2	02/03/2003	35.72	10.00	25.72	0.00	0.00	7,200	6.2	2.7	140	430	-	50	-	-	-	-	-	-
MW-2	05/02/2003	35.72	8.31	27.41	0.00	0.00	12,000	<20	3.9	350	1,500	-	150	-	-	-	-	-	-
MW-2	08/01/2003 ⁷	35.72	12.66	23.06	0.00	0.00	12,000	14	4	330	730	140	-	-	-	-	-	-	-
MW-2	11/21/2003 ⁷	35.72	12.67	23.05	0.00	0.00	15,000	13	4	400	1,500	100	-	-	-	-	-	-	-
MW-2	02/10/2004 ⁷	35.72	5.20	30.52	0.00	0.00	17,000	9	3	420	1,600	72	-	-	-	-	-	-	-
MW-2	05/11/2004 ⁷	35.72	9.83	25.89	0.00	0.00	4,800	1	0.6	140	440	81	-	-	-	-	-	-	-
MW-2	08/10/2004 ⁷	35.72	11.81	23.91	0.00	0.00	11,000	8	1	340	1,100	35	-	-	-	-	-	-	-
MW-2	11/08/2004 ⁷	35.72	11.59	24.13	0.00	0.00	11,000	6	2	260	810	25	-	-	-	-	-	-	-

TABLE 1

**GROUNDWATER MONITORING AND SAMPLING DATA
FORMER CHEVRON SERVICE STATION 93322
7225 BANCROFT AVENUE
OAKLAND, CALIFORNIA**

Location	Date	TOC	DTW	GWE	LNAPLT	LNAPL REMOVED	HYDROCARBONS	PRIMARY VOCS					ADDITIONAL VOCS						
							TPH-GRO	B	T	E	X	MTBE by SW8260	MTBE by VOC	Ethanol	TBA	DIPE	ETBE	TAME	
	Units	ft	ft	ft-amsl	ft	gal	µg/L	µg/L	µg/L	µg/L	µg/L	µg/L	µg/L	µg/L	µg/L	µg/L	µg/L	µg/L	µg/L
MW-2	01/11/2005	-	-	-	-	-	4,500	4	1	120	310	7	-	-	-	-	-	-	-
MW-2	02/21/2005 ⁷	35.72	7.74	27.98	0.00	0.00	16,000	5	2	500	1,700	10	-	-	-	-	-	-	-
MW-2	05/10/2005 ⁷	35.72	8.11	27.61	0.00	0.00	8,400	3	<1	290	750	6	-	-	-	-	-	-	-
MW-2	08/12/2005 ⁷	35.72	11.32	24.40	0.00	0.00	5,800	4	0.7	150	370	30	-	-	-	-	-	-	-
MW-2	11/11/2005 ⁷	35.72	12.58	23.14	0.00	0.00	-	-	-	-	-	-	-	-	-	-	-	-	-
MW-2	02/20/2006 ⁷	35.72	7.41	28.31	0.00	0.00	5,700	1	<0.5	190	380	0.7	-	-	-	-	-	-	-
MW-2	05/12/2006 ⁷	35.72	7.02	28.70	0.00	0.00	9,100	2	<0.5	210	440	1	-	-	-	-	-	-	-
MW-2	08/14/2006 ⁷	35.72	11.38	24.34	0.00	0.00	2,400	2	<0.5	42	98	20	-	-	-	-	-	-	-
MW-2	11/08/2006 ⁷	35.72	13.42	22.30	0.00	0.00	5,700	4	0.9	87	190	7	-	-	-	-	-	-	-
MW-2	02/07/2007 ⁷	35.72	11.98	23.74	0.00	0.00	5,500	9	2	85	120	7	-	-	-	-	-	-	-
MW-2	05/07/2007 ⁷	35.72	11.22	24.50	0.00	0.00	8,700	1	<0.5	150	330	5	-	-	-	-	-	-	-
MW-2	08/03/2007 ⁷	35.72	17.19	18.53	0.00	0.00	2,600	<0.5	<0.5	10	28	2	-	-	-	-	-	-	-
MW-2	10/12/2007 ⁷	35.72	14.89	20.83	0.00	0.00	9,300	7	0.6	100	120	4	-	-	-	-	-	-	-
MW-2	11/02/2007 ⁷	35.72	15.58	20.14	0.00	0.00	11,000	3	0.7	220	590	2	-	-	-	-	-	-	-
MW-2	12/07/2007 ⁷	35.72	19.29	16.43	0.00	0.00	9,500	3	<1	210	480	2	-	-	-	-	-	-	-
MW-2	02/01/2008 ⁷	35.72	8.76	26.96	0.00	0.00	8,100	2	0.7	190	440	4	-	-	-	-	-	-	-
MW-2	05/09/2008 ⁷	35.72	11.22	24.50	0.00	0.00	4,000	1	<0.5	98	110	3	-	-	-	-	-	-	-
MW-2	08/22/2008 ⁷	35.72	13.87	21.85	0.00	0.00	9,600 ¹²	1	<0.5	230	360	0.9	-	-	-	-	-	-	-
MW-2	11/26/2008 ⁷	35.72	17.48	18.24	0.00	0.00	13,000	9	1	340	570	3	-	-	-	-	-	-	-
MW-2	05/20/2009	35.72	10.70	25.02	0.00	0.00	12,000	3	<1	250	290	2J	-	<130	-	-	-	-	-
MW-2	08/26/2009	35.72	12.98	22.74	0.00	0.00	-	-	-	-	-	-	-	-	-	-	-	-	-
MW-2	11/12/2009	35.72	12.13	23.59	0.00	0.00	14,000	3	0.8 J	180	250	13	-	<50	-	-	-	-	-
MW-2	05/17/2010	35.72	11.96	23.76	0.00	0.00	3,300	<0.5	<0.5	36	34	3	-	<50	-	-	-	-	-

TABLE 1

**GROUNDWATER MONITORING AND SAMPLING DATA
FORMER CHEVRON SERVICE STATION 93322
7225 BANCROFT AVENUE
OAKLAND, CALIFORNIA**

Location	Date	TOC	DTW	GWE	LNAPLT	LNAPL REMOVED	HYDROCARBONS	PRIMARY VOCS					ADDITIONAL VOCS						
							TPH-GRO	B	T	E	X	MTBE by SW8260	MTBE by VOC	Ethanol	TBA	DIPE	ETBE	TAME	
	Units	ft	ft	ft-amsl	ft	gal	µg/L	µg/L	µg/L	µg/L	µg/L	µg/L	µg/L	µg/L	µg/L	µg/L	µg/L	µg/L	µg/L
MW-2	08/26/2010 ¹¹	35.72	12.10	23.62	0.00	0.00	-	-	-	-	-	-	-	-	-	-	-	-	-
MW-2	11/11/2010	35.72	13.72	22.00	0.00	0.00	9,000	6	1 J	61	30	5	-	<50	-	-	-	-	-
MW-2	02/10/2011 ¹³	35.72	9.46	26.26	0.00	0.00	-	-	-	-	-	-	-	-	-	-	-	-	-
MW-2	06/17/2011	35.72	8.68	27.04	0.00	0.00	9,300	3	<1	92	55	4	-	<100	-	-	-	-	-
MW-2	09/08/2011	35.72	9.69	26.03	0.00	0.00	-	-	-	-	-	-	-	-	-	-	-	-	-
MW-2	12/16/2011	35.72	12.18	23.54	0.00	0.00	5,700	1	<0.5	36	19	<0.5	-	<50	-	-	-	-	-
MW-2	03/02/2012 ¹³	35.72	12.09	23.63	0.00	0.00	-	-	-	-	-	-	-	-	-	-	-	-	-
MW-2	06/08/2012	35.72	11.08	24.64	0.00	0.00	5,600	<5	<5	48	24	<5	-	<500	-	-	-	-	-
MW-2	09/14/2012 ¹³	35.72	13.57	22.15	0.00	0.00	-	-	-	-	-	-	-	-	-	-	-	-	-
MW-2	12/21/2012	35.72	8.52	27.20	0.00	0.00	3,100	<5	<5	23	12	<5	-	<500	-	-	-	-	-
MW-3	02/08/1998	39.51	14.60	24.91	0.00	0.00	94,000	12,000	4,400	2,000	10,000	-	8,000	-	-	-	-	-	-
MW-3	06/16/1998	39.51	13.98	25.53	0.00	0.00	38,000	5,600	1,400	1,200	4,700	-	4,600 ¹ /6,300	-	-	-	-	-	-
MW-3	07/29/1998	39.51	17.37	22.14	0.00	0.00	58,000	4,100	700	1,300	4,200	-	4,100	-	-	-	-	-	-
MW-3	08/13/1998	39.51	18.22	21.29	0.00	0.00	43,000	6,800	1,900	1,600	6,800	-	2,300	-	-	-	-	-	-
MW-3	11/24/1998	39.51	20.45	19.06	0.00	0.00	40,000	5,000	800	1,600	6,800	-	6,000/4,400 ¹	-	-	-	-	-	-
MW-3	02/03/1999	39.51	17.48	22.03	0.00	0.00	47,000	7,100	1,600	1,900	9,000	-	5,000	-	-	-	-	-	-
MW-3	06/07/1999	39.51	15.75	23.76	0.00	0.00	27,000	2,500	540	1,200	3,900	-	2,800	-	-	-	-	-	-
MW-3	09/07/1999	39.51	19.71	19.80	0.00	0.00	44,000	3,930	1,170	1,760	7,130	-	3,440	-	-	-	-	-	-
MW-3	10/27/1999	39.51	20.42	19.09	0.00	0.00	28,200	2,030	620	1,260	5,080	-	1,710	-	-	-	-	-	-
MW-3	02/08/2000	39.51	17.75	21.76	0.00	0.00	25,300	2,000	668	1,210	5,330	-	1,760	-	-	-	-	-	-
MW-3	05/05/2000	39.51	15.64	23.87	0.00	0.00	27,000 ²	2,600	960	1,500	5,200	-	2,500	-	-	-	-	-	-
MW-3	07/28/2000	39.51	18.23	21.28	0.00	0.00	7,400 ²	950	360	840	3,200	-	1,700	-	-	-	-	-	-

TABLE 1

GROUNDWATER MONITORING AND SAMPLING DATA
 FORMER CHEVRON SERVICE STATION 93322
 7225 BANCROFT AVENUE
 OAKLAND, CALIFORNIA

Location	Date	TOC	DTW	GWE	LNAPLT	LNAPL REMOVED	HYDROCARBONS	PRIMARY VOCS					ADDITIONAL VOCS						
							TPH-GRO	B	T	E	X	MTBE by SW8260	MTBE by VOC	Ethanol	TBA	DIPE	ETBE	TAME	
	Units	ft	ft	ft-amsl	ft	gal	µg/L	µg/L	µg/L	µg/L	µg/L	µg/L	µg/L	µg/L	µg/L	µg/L	µg/L	µg/L	µg/L
MW-3	11/26/2000	39.51	19.38	20.13	0.00	0.00	20,000 ²	1,800	690	1,400	5,500	-	1,600	-	-	-	-	-	-
MW-3	02/09/2001	39.51	17.72	21.79	0.00	0.00	31,200 ³	1,980	<50.0	1,770	7,220	-	2,170	-	-	-	-	-	-
MW-3	05/11/2001	39.51	14.65	24.86	0.00	0.00	18,000 ²	3,000	780	1,600	5,500	-	1,800	-	-	-	-	-	-
MW-3	08/30/2001	39.51	19.35	20.16	0.00	0.00	9,400	570	180	610	1,900	-	880	-	-	-	-	-	-
MW-3	11/21/2001	39.51	20.04	19.47	0.00	0.00	29,000	1,100	450	1,500	6,100	-	1,200	-	-	-	-	-	-
MW-3	02/05/2002	39.51	14.09	25.42	0.00	0.00	16,000	820	210	830	2,400	-	1,100	-	-	-	-	-	-
MW-3	04/01/2002	36.53	12.21	24.32	0.00	0.00	-	-	-	-	-	-	-	-	-	-	-	-	-
MW-3	08/05/2002	36.53	14.31	22.22	0.00	0.00	11,000	310	92	380	820	-	830	-	-	-	-	-	-
MW-3	11/04/2002	36.53	19.03	17.50	0.00	0.00	32,000	1,900	540	1,800	5,900	-	1,500	-	-	-	-	-	-
MW-3	02/03/2003	36.53	13.95	22.58	0.00	0.00	19,000	1,100	240	920	2,900	-	1,100	-	-	-	-	-	-
MW-3	05/02/2003	36.53	13.07	23.46	0.00	0.00	18,000	1,200	270	1,100	2,500	-	1,400	-	-	-	-	-	-
MW-3	08/01/2003 ⁷	36.53	16.31	20.22	0.00	0.00	7,700	300	79	410	820	780	-	-	-	-	-	-	-
MW-3	11/21/2003 ⁷	36.53	17.89	18.64	0.00	0.00	7,600	270	100	470	1,300	700	-	-	-	-	-	-	-
MW-3	02/10/2004 ⁷	36.53	13.06	23.47	0.00	0.00	3,800	250	28	170	300	650	-	-	-	-	-	-	-
MW-3	05/11/2004 ⁷	36.53	13.73	22.80	0.00	0.00	1,200	60	9	76	62	530	-	-	-	-	-	-	-
MW-3	08/10/2004 ⁷	36.53	16.09	20.44	0.00	0.00	1,600	70	9	86	62	500	-	-	-	-	-	-	-
MW-3	11/08/2004 ⁷	36.53	15.11	21.42	0.00	0.00	4,800	280	37	260	400	760	-	-	-	-	-	-	-
MW-3	02/21/2005 ⁷	36.53	11.45	25.08	0.00	0.00	450	0.8	<0.5	0.7	<0.5	200	-	-	-	-	-	-	-
MW-3	05/10/2005 ⁷	36.53	10.26	26.27	0.00	0.00	220	<0.5	<0.5	<0.5	<0.5	250	-	-	-	-	-	-	-
MW-3	08/12/2005 ⁷	36.53	16.42	20.11	0.00	0.00	2,800	94	32	150	390	370	-	-	-	-	-	-	-
MW-3	11/11/2005 ⁷	36.53	17.59	18.94	0.00	0.00	3,800	140	46	230	430	440	-	-	-	-	-	-	-
MW-3	02/20/2006 ⁷	36.53	11.92	24.61	0.00	0.00	390	4	0.9	5	4	290	-	-	-	-	-	-	-
MW-3	05/12/2006 ⁷	36.53	9.38	27.15	0.00	0.00	1,100	2	<0.5	3	2	91	-	-	-	-	-	-	-

TABLE 1

GROUNDWATER MONITORING AND SAMPLING DATA
 FORMER CHEVRON SERVICE STATION 93322
 7225 BANCROFT AVENUE
 OAKLAND, CALIFORNIA

Location	Date	TOC	DTW	GWE	LNAPLT	LNAPL REMOVED	HYDROCARBONS		PRIMARY VOCS					ADDITIONAL VOCS					
							TPH-GRO	B	T	E	X	MTBE by SW8260	MTBE by VOC	Ethanol	TBA	DIPE	ETBE	TAME	
	Units	ft	ft	ft-amsl	ft	gal	µg/L	µg/L	µg/L	µg/L	µg/L	µg/L	µg/L	µg/L	µg/L	µg/L	µg/L	µg/L	µg/L
MW-3	08/14/2006 ⁷	36.53	14.68	21.85	0.00	0.00	170	<0.5	<0.5	<0.5	0.8	21	-	-	-	-	-	-	-
MW-3	11/08/2006 ⁷	36.53	17.43	19.10	0.00	0.00	1,900	83	17	120	130	100	-	-	-	-	-	-	-
MW-3	02/07/2007 ⁷	36.53	15.07	21.46	0.00	0.00	7,400	340	42	310	530	170	-	-	-	-	-	-	-
MW-3	05/07/2007 ⁷	36.53	13.32	23.21	0.00	0.00	1,200	7	<0.5	5	6	17	-	-	-	-	-	-	-
MW-3	08/03/2007 ⁷	36.53	17.05	19.48	0.00	0.00	740	44	2	12	9	77	-	-	-	-	-	-	-
MW-3	10/12/2007 ⁷	36.53	18.70	17.83	0.00	0.00	5,800	250	28	240	290	170	-	-	-	-	-	-	-
MW-3	11/02/2007 ⁷	36.53	18.81	17.72	0.00	0.00	2,400	160	8	33	19	140	-	-	-	-	-	-	-
MW-3	12/07/2007 ⁷	36.53	18.65	17.88	0.00	0.00	2,100	180	11	41	33	160	-	-	-	-	-	-	-
MW-3	02/01/2008 ⁷	36.53	14.59	21.94	0.00	0.00	3,600	570	45	81	140	180	-	-	-	-	-	-	-
MW-3	05/09/2008 ⁷	36.53	14.75	21.78	0.00	0.00	460	49	3	5	2	35	-	-	-	-	-	-	-
MW-3	08/22/2008 ⁷	36.53	17.98	18.55	0.00	0.00	5,400	200	16	160	150	84	-	-	-	-	-	-	-
MW-3	11/26/2008 ⁷	36.53	19.41	17.12	0.00	0.00	2,600	80	4	20	7	55	-	-	-	-	-	-	-
MW-3	05/20/2009	36.53	14.50	22.03	0.00	0.00	6,600	510	33	200	170	130	-	<50	-	-	-	-	-
MW-3	08/26/2009	36.53	18.84	17.69	0.00	0.00	7,900	290	18	180	110	120	-	<50	-	-	-	-	-
MW-3	02/01/2010	36.53	13.10	23.43	0.00	0.00	9,700	1,600	65	230	220	260	-	<250	-	-	-	-	-
MW-3	08/26/2010	36.53	14.90	21.63	0.00	0.00	15,000	1,400	84	670	710	210	-	<100	-	-	-	-	-
MW-3	11/11/2010 ¹¹	36.53	17.08	19.45	0.00	0.00	-	-	-	-	-	-	-	-	-	-	-	-	-
MW-3	02/10/2011	36.53	12.88	23.65	0.00	0.00	6,700	710	35	270	230	130	-	<100	-	-	-	-	-
MW-3	06/17/2011 ¹¹	36.53	-	-	-	-	-	-	-	-	-	-	-	-	-	-	-	-	-
MW-3	09/08/2011 ¹¹	36.53	14.93	21.60	0.00	0.00	7,700	490	29	260	190	96	-	<500	-	-	-	-	-
MW-3	12/16/2011 ¹¹	36.53	16.06	20.47	0.00	0.00	-	-	-	-	-	-	-	-	-	-	-	-	-
MW-3	03/02/2012	36.53	15.98	20.55	0.00	0.00	7,500	490	28	240	150	89	-	<500	-	-	-	-	-
MW-3	06/08/2012 ¹¹	36.53	13.52	23.01	0.00	0.00	-	-	-	-	-	-	-	-	-	-	-	-	-

TABLE 1

GROUNDWATER MONITORING AND SAMPLING DATA
 FORMER CHEVRON SERVICE STATION 93322
 7225 BANCROFT AVENUE
 OAKLAND, CALIFORNIA

Location	Date	TOC	DTW	GWE	LNAPLT	LNAPL REMOVED	HYDROCARBONS		PRIMARY VOCS					ADDITIONAL VOCS					
							TPH-GRO	B	T	E	X	MTBE by SW8260	MTBE by VOC	Ethanol	TBA	DIPE	ETBE	TAME	
	Units	ft	ft	ft-amsl	ft	gal	µg/L	µg/L	µg/L	µg/L	µg/L	µg/L	µg/L	µg/L	µg/L	µg/L	µg/L	µg/L	µg/L
MW-3	09/14/2012	36.53	17.24	19.29	0.00	0.00	7,600	330	15	140	54	63	-	<500	110	<5	<5	16	
MW-3	12/21/2012¹¹	36.53	13.32	23.21	0.00	0.00	-	-	-	-	-	-	-	-	-	-	-	-	-
MW-4	02/02/1999	40.24	13.17	27.07	0.00	0.00	<50	0.52	<0.5	<0.5	<0.5	-	6.0	-	-	-	-	-	-
MW-4	06/07/1999	40.24	16.41	23.83	0.00	0.00	<50	<0.5	<0.5	<0.5	<0.5	-	<2.5	-	-	-	-	-	-
MW-4	09/07/1999	40.24	20.90	19.34	0.00	0.00	<50	<0.5	<0.5	<0.5	<0.5	-	<5.0	-	-	-	-	-	-
MW-4	10/27/1999	40.24	21.59	18.65	0.00	0.00	<50	<0.5	<0.5	<0.5	<0.5	-	<2.5	-	-	-	-	-	-
MW-4	02/08/2000	40.24	17.16	23.08	0.00	0.00	<50	<0.5	<0.5	<0.5	<0.5	-	<5.0	-	-	-	-	-	-
MW-4	05/05/2000	40.24	16.02	24.22	0.00	0.00	<50	<0.50	<0.50	<0.50	<0.50	-	<2.5	-	-	-	-	-	-
MW-4	07/28/2000	40.24	19.12	21.12	0.00	0.00	<50	<0.50	<0.50	<0.50	<0.50	-	<2.5	-	-	-	-	-	-
MW-4	11/26/2000	40.24	19.92	20.32	0.00	0.00	<50	<0.50	<0.50	<0.50	<0.50	-	<2.5	-	-	-	-	-	-
MW-4	02/09/2001	40.24	17.45	22.79	0.00	0.00	<50.0	<0.500	<0.500	<0.500	<0.500	-	<2.500	-	-	-	-	-	-
MW-4	05/11/2001	40.24	15.02	25.22	0.00	0.00	<50	<0.50	<0.50	<0.50	<0.50	-	<2.5	-	-	-	-	-	-
MW-4	08/30/2001	40.24	20.33	19.91	0.00	0.00	<50	<0.50	<0.50	<0.50	<0.50	-	<2.5	-	-	-	-	-	-
MW-4	11/21/2001	40.24	19.75	20.49	0.00	0.00	<50	<0.50	<0.50	<0.50	<1.5	-	<2.5	-	-	-	-	-	-
MW-4	02/05/2002	40.24	14.06	26.18	0.00	0.00	<50	<0.50	<0.50	<0.50	<1.5	-	<2.5	-	-	-	-	-	-
MW-4	04/01/2002	37.29	12.06	25.23	0.00	0.00	-	-	-	-	-	-	-	-	-	-	-	-	-
MW-4	08/05/2002	37.29	17.05	20.24	0.00	0.00	<50	<0.50	<0.50	<0.50	<1.5	-	<2.5	-	-	-	-	-	-
MW-4	11/04/2002	37.29	19.73	17.56	0.00	0.00	<50	<0.50	<0.50	<0.50	<1.5	-	<2.5	-	-	-	-	-	-
MW-4	02/03/2003	37.29	14.05	23.24	0.00	0.00	<50	<0.50	<0.50	<0.50	<1.5	-	<2.5	-	-	-	-	-	-
MW-4	05/02/2003	37.29	12.85	24.44	0.00	0.00	<50	<0.5	<0.5	<0.5	<1.5	-	<2.5	-	-	-	-	-	-
MW-4	08/01/2003 ⁷	37.29	16.94	20.35	0.00	0.00	<50	<0.5	<0.5	<0.5	<0.5	<0.5	-	-	-	-	-	-	-
MW-4	11/21/2003 ⁷	37.29	18.15	19.14	0.00	0.00	<50	<0.5	<0.5	<0.5	<0.5	<0.5	-	-	-	-	-	-	-

TABLE 1

**GROUNDWATER MONITORING AND SAMPLING DATA
FORMER CHEVRON SERVICE STATION 93322
7225 BANCROFT AVENUE
OAKLAND, CALIFORNIA**

Location	Date	TOC	DTW	GWE	LNAPL	LNAPL REMOVED	HYDROCARBONS	PRIMARY VOCS					ADDITIONAL VOCS						
							TPH-GRO	B	T	E	X	MTBE by SW8260	MTBE by VOC	Ethanol	TBA	DIPE	ETBE	TAME	
	Units	ft	ft	ft-amsl	ft	gal	µg/L	µg/L	µg/L	µg/L	µg/L	µg/L	µg/L	µg/L	µg/L	µg/L	µg/L	µg/L	µg/L
MW-4	02/10/2004 ⁷	37.29	13.02	24.27	0.00	0.00	<50	<0.5	<0.5	<0.5	<0.5	1	-	-	-	-	-	-	-
MW-4	05/11/2004 ⁷	37.29	14.15	23.14	0.00	0.00	<50	<0.5	<0.5	<0.5	<0.5	<0.5	-	-	-	-	-	-	-
MW-4	08/10/2004 ⁷	37.29	16.47	20.82	0.00	0.00	<50	<0.5	<0.5	<0.5	<0.5	<0.5	-	-	-	-	-	-	-
MW-4	11/08/2004 ⁷	37.29	14.86	22.43	0.00	0.00	<50	<0.5	<0.5	<0.5	<0.5	<0.5	-	-	-	-	-	-	-
MW-4	02/21/2005 ⁷	37.29	10.76	26.53	0.00	0.00	<50	<0.5	<0.5	<0.5	<0.5	<0.5	-	-	-	-	-	-	-
MW-4	05/10/2005 ⁷	37.29	10.25	27.04	0.00	0.00	<50	<0.5	<0.5	<0.5	<0.5	1	-	-	-	-	-	-	-
MW-4	08/12/2005 ⁷	37.29	15.25	22.04	0.00	0.00	<50	<0.5	<0.5	<0.5	<0.5	<0.5	-	-	-	-	-	-	-
MW-4	11/11/2005 ⁷	37.29	18.36	18.93	0.00	0.00	<50	<0.5	<0.5	<0.5	<0.5	<0.5	-	-	-	-	-	-	-
MW-4	02/20/2006 ⁷	37.29	11.59	25.70	0.00	0.00	<50	<0.5	<0.5	<0.5	<0.5	1	-	-	-	-	-	-	-
MW-4	05/12/2006 ⁷	37.29	9.87	27.42	0.00	0.00	<50	<0.5	<0.5	<0.5	<0.5	0.8	-	-	-	-	-	-	-
MW-4	08/14/2006 ⁷	37.29	15.35	21.94	0.00	0.00	<50	<0.5	<0.5	<0.5	<0.5	<0.5	-	-	-	-	-	-	-
MW-4	11/08/2006 ⁷	37.29	18.28	19.01	0.00	0.00	<50	<0.5	<0.5	<0.5	<0.5	<0.5	-	-	-	-	-	-	-
MW-4	02/07/2007 ⁷	37.29	15.40	21.89	0.00	0.00	<50	<0.5	<0.5	<0.5	<0.5	<0.5	-	-	-	-	-	-	-
MW-4	05/07/2007 ⁷	37.29	13.56	23.73	0.00	0.00	<50	<0.5	<0.5	<0.5	<0.5	<0.5	-	-	-	-	-	-	-
MW-4	08/03/2007 ⁷	37.29	17.70	19.59	0.00	0.00	<50	<0.5	<0.5	<0.5	<0.5	<0.5	-	-	-	-	-	-	-
MW-4	10/12/2007 ⁷	37.29	19.48	17.81	0.00	0.00	<50	<0.5	<0.5	<0.5	<0.5	<0.5	-	-	-	-	-	-	-
MW-4	11/02/2007 ⁷	37.29	19.41	17.88	0.00	0.00	<50	<0.5	<0.5	<0.5	<0.5	<0.5	-	-	-	-	-	-	-
MW-4	12/07/2007 ⁷	37.29	19.45	17.84	0.00	0.00	<50	<0.5	<0.5	<0.5	<0.5	<0.5	-	-	-	-	-	-	-
MW-4	02/01/2008 ⁷	37.29	13.15	24.14	0.00	0.00	<50	<0.5	<0.5	<0.5	<0.5	<0.5	-	-	-	-	-	-	-
MW-4	05/09/2008 ⁷	37.29	14.98	22.31	0.00	0.00	<50	<0.5	<0.5	<0.5	<0.5	<0.5	-	-	-	-	-	-	-
MW-4	08/22/2008 ⁷	37.29	18.67	18.62	0.00	0.00	<50	<0.5	<0.5	<0.5	<0.5	<0.5	-	-	-	-	-	-	-
MW-4	11/26/2008 ⁷	37.29	20.03	17.26	0.00	0.00	<50	<0.5	<0.5	<0.5	<0.5	<0.5	-	-	-	-	-	-	-
MW-4	05/20/2009	37.29	14.89	22.40	0.00	0.00	<50	<0.5	<0.5	<0.5	<0.5	<0.5	-	<50	-	-	-	-	-

TABLE 1

**GROUNDWATER MONITORING AND SAMPLING DATA
FORMER CHEVRON SERVICE STATION 93322
7225 BANCROFT AVENUE
OAKLAND, CALIFORNIA**

Location	Date	TOC	DTW	GWE	LNAPLT	LNAPL REMOVED	HYDROCARBONS	PRIMARY VOCS					ADDITIONAL VOCS						
							TPH-GRO	B	T	E	X	MTBE by SW8260	MTBE by VOC	Ethanol	TBA	DIPE	ETBE	TAME	
	Units	ft	ft	ft-amsl	ft	gal	µg/L	µg/L	µg/L	µg/L	µg/L	µg/L	µg/L	µg/L	µg/L	µg/L	µg/L	µg/L	µg/L
MW-4	08/26/2009	37.29	19.29	18.00	0.00	0.00	<50	<0.5	<0.5	<0.5	<0.5	<0.5	-	<50	-	-	-	-	-
MW-4	11/12/2009	37.29	17.70	19.59	0.00	0.00	<50	<0.5	<0.5	<0.5	<0.5	<0.5	-	<50	-	-	-	-	-
MW-4	02/01/2010	37.29	12.57	24.72	0.00	0.00	<50	<0.5	<0.5	<0.5	<0.5	<0.5	-	<50	-	-	-	-	-
MW-4	05/17/2010	37.29	11.15	26.14	0.00	0.00	<50	<0.5	<0.5	<0.5	<0.5	<0.5	-	<50	-	-	-	-	-
MW-4	08/26/2010	37.29	15.50	21.79	0.00	0.00	<50	<0.5	<0.5	<0.5	<0.5	<0.5	-	<50	-	-	-	-	-
MW-4	11/11/2010	37.29	17.34	19.95	0.00	0.00	<50	<0.5	<0.5	<0.5	<0.5	<0.5	-	<50	-	-	-	-	-
MW-4	02/10/2011	37.29	13.01	24.28	0.00	0.00	<50	<0.5	<0.5	<0.5	<0.5	<0.5	-	<50	-	-	-	-	-
MW-4	06/17/2011	37.29	12.07	25.22	0.00	0.00	<50	<0.5	<0.5	<0.5	<0.5	<0.5	-	<50	-	-	-	-	-
MW-4	09/08/2011	37.29	15.75	21.54	0.00	0.00	<50	<0.5	<0.5	<0.5	<0.5	<0.5	-	<50	-	-	-	-	-
MW-4	12/16/2011	37.29	16.80	20.49	0.00	0.00	<50	<0.5	<0.5	<0.5	<0.5	<0.5	-	<50	-	-	-	-	-
MW-4	06/08/2012	37.29	14.30	22.99	0.00	0.00	<50	<0.5	<0.5	<0.5	<0.5	<0.5	-	<50	-	-	-	-	-
MW-4	06/08/2012	37.29	14.30	22.99	0.00	0.00	<50	<0.5	<0.5	<0.5	<0.5	<0.5	-	<50	-	-	-	-	-
MW-4	09/14/2012	37.29	18.10	19.19	0.00	0.00	<50	<0.5	<0.5	<0.5	2	<0.5	-	<50	<2	<0.5	<0.5	<0.5	
MW-4	12/21/2012	37.29	13.33	23.96	0.00	0.00	<50	<0.5	<0.5	<0.5	<0.5	<0.5	-	<50	-	-	-	-	-
MW-5	02/02/1999	40.37	18.80	21.57	0.00	0.00	72	2.7	<0.5	<0.5	<0.5	-	11	-	-	-	-	-	-
MW-5	06/07/1999	40.37	16.98	23.39	0.00	0.00	<50	<0.5	<0.5	<0.5	<0.5	-	<2.5	-	-	-	-	-	-
MW-5	09/07/1999	40.37	21.13	19.24	0.00	0.00	<50	<0.5	<0.5	<0.5	<0.5	-	6.92	-	-	-	-	-	-
MW-5	10/27/1999	40.37	21.92	18.45	0.00	0.00	<50	2.39	<0.5	<0.5	<0.5	-	21.3	-	-	-	-	-	-
MW-5	02/08/2000	40.37	18.98	21.39	0.00	0.00	<50	10.6	<0.5	<0.5	<0.5	-	21.7	-	-	-	-	-	-
MW-5	05/05/2000	40.37	16.89	23.48	0.00	0.00	<50	<0.50	<0.50	<0.50	<0.50	-	3.8	-	-	-	-	-	-
MW-5	07/28/2000	40.37	19.49	20.88	0.00	0.00	<50	<0.50	<0.50	<0.50	<0.50	-	<2.5	-	-	-	-	-	-
MW-5	11/26/2000	40.37	20.69	19.68	0.00	0.00	<50	0.57	<0.50	<0.50	<0.50	-	15	-	-	-	-	-	-

TABLE 1

GROUNDWATER MONITORING AND SAMPLING DATA
 FORMER CHEVRON SERVICE STATION 93322
 7225 BANCROFT AVENUE
 OAKLAND, CALIFORNIA

Location	Date	TOC	DTW	GWE	LNAPLT	LNAPL REMOVED	HYDROCARBONS	PRIMARY VOCS					ADDITIONAL VOCS						
							TPH-GRO	B	T	E	X	MTBE by SW8260	MTBE by VOC	Ethanol	TBA	DIPE	ETBE	TAME	
	Units	ft	ft	ft-amsl	ft	gal	µg/L	µg/L	µg/L	µg/L	µg/L	µg/L	µg/L	µg/L	µg/L	µg/L	µg/L	µg/L	µg/L
MW-5	02/09/2001	40.37	18.87	21.50	0.00	0.00	<50.0	<0.500	<0.500	<0.500	<0.500	-	9.11	-	-	-	-	-	-
MW-5	05/11/2001	40.37	15.90	24.47	0.00	0.00	<50	<0.50	<0.50	<0.50	<0.50	-	<2.5	-	-	-	-	-	-
MW-5	08/30/2001	40.37	20.61	19.76	0.00	0.00	<50	<0.50	<0.50	<0.50	<0.50	-	9.5	-	-	-	-	-	-
MW-5	11/21/2001	40.37	21.04	19.33	0.00	0.00	<50	<0.50	<0.50	<0.50	<1.5	-	7.3	-	-	-	-	-	-
MW-5	02/05/2002	40.37	15.21	25.16	0.00	0.00	<50	<0.50	<0.50	<0.50	<1.5	-	<2.5	-	-	-	-	-	-
MW-5	04/01/2002	37.40	13.45	23.95	0.00	0.00	-	-	-	-	-	-	-	-	-	-	-	-	-
MW-5	08/05/2002	37.40	17.54	19.86	0.00	0.00	<50	<0.50	<0.50	<0.50	<1.5	-	2.7	-	-	-	-	-	-
MW-5	11/04/2002	37.40	20.07	17.33	0.00	0.00	<50	<0.50	<0.50	<0.50	<1.5	-	6.3	-	-	-	-	-	-
MW-5	02/03/2003	37.40	15.03	22.37	0.00	0.00	<50	<0.50	0.60	<0.50	<1.5	-	<2.5	-	-	-	-	-	-
MW-5	05/02/2003	37.40	13.96	23.44	0.00	0.00	<50	<0.5	<0.5	<0.5	<1.5	-	<2.5	-	-	-	-	-	-
MW-5	08/01/2003 ⁷	37.40	17.40	20.00	0.00	0.00	<50	<0.5	<0.5	<0.5	<0.5	<0.5	-	-	-	-	-	-	-
MW-5	11/21/2003 ⁷	37.40	18.57	18.83	0.00	0.00	<50	<0.5	<0.5	<0.5	<0.5	<0.5	-	-	-	-	-	-	-
MW-5	02/10/2004 ⁷	37.40	14.14	23.26	0.00	0.00	<50	<0.5	<0.5	<0.5	<0.5	<0.5	-	-	-	-	-	-	-
MW-5	05/11/2004 ⁷	37.40	14.70	22.70	0.00	0.00	<50	<0.5	<0.5	<0.5	<0.5	<0.5	-	-	-	-	-	-	-
MW-5	08/10/2004 ⁷	37.40	17.08	20.32	0.00	0.00	<50	<0.5	<0.5	<0.5	<0.5	<0.5	-	-	-	-	-	-	-
MW-5	11/08/2004 ⁷	37.40	15.98	21.42	0.00	0.00	<50	<0.5	<0.5	<0.5	<0.5	<0.5	-	-	-	-	-	-	-
MW-5	02/21/2005	37.40	-	-	-	-	-	-	-	-	-	-	-	-	-	-	-	-	-
MW-5	05/10/2005 ⁷	37.40	11.88	25.52	0.00	0.00	<50	<0.5	<0.5	<0.5	<0.5	1	-	-	-	-	-	-	-
MW-5	08/12/2005 ⁷	37.40	15.63	21.77	0.00	0.00	<50	<0.5	<0.5	<0.5	<0.5	<0.5	-	-	-	-	-	-	-
MW-5	11/11/2005 ⁷	37.40	18.68	18.72	0.00	0.00	<50	<0.5	<0.5	<0.5	<0.5	0.8	-	-	-	-	-	-	-
MW-5	02/20/2006 ⁷	37.40	12.57	24.83	0.00	0.00	<50	<0.5	<0.5	<0.5	<0.5	<0.5	-	-	-	-	-	-	-
MW-5	05/12/2006 ⁷	37.40	11.06	26.34	0.00	0.00	<50	<0.5	<0.5	<0.5	<0.5	0.9	-	-	-	-	-	-	-
MW-5	08/14/2006 ⁷	37.40	15.73	21.67	0.00	0.00	<50	<0.5	<0.5	<0.5	<0.5	0.9	-	-	-	-	-	-	-

TABLE 1

GROUNDWATER MONITORING AND SAMPLING DATA
 FORMER CHEVRON SERVICE STATION 93322
 7225 BANCROFT AVENUE
 OAKLAND, CALIFORNIA

Location	Date	TOC	DTW	GWE	LNAPL	LNAPL REMOVED	HYDROCARBONS	PRIMARY VOCS					ADDITIONAL VOCS						
							TPH-GRO	B	T	E	X	MTBE by SW8260	MTBE by VOC	Ethanol	TBA	DIPE	ETBE	TAME	
	Units	ft	ft	ft-amsl	ft	gal	µg/L	µg/L	µg/L	µg/L	µg/L	µg/L	µg/L	µg/L	µg/L	µg/L	µg/L	µg/L	µg/L
MW-5	11/08/2006 ⁷	37.40	18.51	18.89	0.00	0.00	<50	<0.5	<0.5	<0.5	<0.5	1	-	-	-	-	-	-	-
MW-5	02/07/2007 ⁷	37.40	16.02	21.38	0.00	0.00	<50	<0.5	<0.5	<0.5	<0.5	0.6	-	-	-	-	-	-	-
MW-5	05/07/2007 ⁷	37.40	14.32	23.08	0.00	0.00	<50	<0.5	<0.5	<0.5	<0.5	<0.5	-	-	-	-	-	-	-
MW-5	08/03/2007 ⁷	37.40	18.08	19.32	0.00	0.00	<50	<0.5	<0.5	<0.5	<0.5	0.6	-	-	-	-	-	-	-
MW-5	10/12/2007 ⁷	37.40	19.74	17.66	0.00	0.00	<50	<0.5	<0.5	<0.5	<0.5	0.8	-	-	-	-	-	-	-
MW-5	11/02/2007 ⁷	37.40	19.78	17.62	0.00	0.00	61	<0.5	<0.5	<0.5	<0.5	<0.5	-	-	-	-	-	-	-
MW-5	12/07/2007 ⁷	37.40	19.71	17.69	0.00	0.00	<50	<0.5	<0.5	<0.5	<0.5	<0.5	-	-	-	-	-	-	-
MW-5	02/01/2008 ⁷	37.40	14.34	23.06	0.00	0.00	<50	<0.5	<0.5	<0.5	<0.5	<0.5	-	-	-	-	-	-	-
MW-5	05/09/2008 ⁷	37.40	15.62	21.78	0.00	0.00	<50	<0.5	<0.5	<0.5	<0.5	<0.5	-	-	-	-	-	-	-
MW-5	08/22/2008 ⁷	37.40	18.96	18.44	0.00	0.00	<50	<0.5	<0.5	<0.5	<0.5	<0.5	-	-	-	-	-	-	-
MW-5	11/26/2008 ⁷	37.40	20.35	17.05	0.00	0.00	<50	<0.5	<0.5	<0.5	<0.5	0.9	-	-	-	-	-	-	-
MW-5	05/20/2009	37.40	15.56	21.84	0.00	0.00	<50	<0.5	<0.5	<0.5	<0.5	<0.5	-	<50	-	-	-	-	-
MW-5	08/26/2009	37.40	19.56	17.84	0.00	0.00	<50	<0.5	<0.5	<0.5	<0.5	0.5 J	-	<50	-	-	-	-	-
MW-5	11/12/2009	37.40	18.50	18.90	0.00	0.00	<50	<0.5	<0.5	<0.5	<0.5	<0.5	-	<50	-	-	-	-	-
MW-5	02/01/2010	37.40	14.41	22.99	0.00	0.00	<50	<0.5	<0.5	<0.5	<0.5	<0.5	-	<50	-	-	-	-	-
MW-5	05/17/2010	37.40	13.00	24.40	0.00	0.00	<50	<0.5	<0.5	<0.5	<0.5	<0.5	-	<50	-	-	-	-	-
MW-5	08/26/2010	37.40	15.90	21.50	0.00	0.00	<50	<0.5	<0.5	<0.5	<0.5	<0.5	-	<50	-	-	-	-	-
MW-5	11/11/2010	37.40	18.05	19.35	0.00	0.00	68 J	<0.5	<0.5	<0.5	<0.5	<0.5	-	<50	-	-	-	-	-
MW-5	02/10/2011	37.40	13.70	23.70	0.00	0.00	<50	<0.5	<0.5	<0.5	<0.5	<0.5	-	<50	-	-	-	-	-
MW-5	06/17/2011	37.40	13.37	24.03	0.00	0.00	<50	<0.5	<0.5	<0.5	<0.5	<0.5	-	<50	-	-	-	-	-
MW-5	09/08/2011	37.40	16.15	21.25	0.00	0.00	<50	<0.5	<0.5	<0.5	<0.5	<0.5	-	<50	-	-	-	-	-
MW-5	12/16/2011	37.40	17.20	20.20	0.00	0.00	<50	<0.5	<0.5	<0.5	<0.5	<0.5	-	<50	-	-	-	-	-
MW-5	03/02/2012	37.40	17.41	19.99	0.00	0.00	<50	<0.5	<0.5	<0.5	<0.5	<0.5	-	<50	-	-	-	-	-

TABLE 1

**GROUNDWATER MONITORING AND SAMPLING DATA
FORMER CHEVRON SERVICE STATION 93322
7225 BANCROFT AVENUE
OAKLAND, CALIFORNIA**

Location	Date	TOC	DTW	GWE	LNAPLT	LNAPL REMOVED	HYDROCARBONS	PRIMARY VOCS					ADDITIONAL VOCS						
							TPH-GRO	B	T	E	X	MTBE by SW8260	MTBE by VOC	Ethanol	TBA	DIPE	ETBE	TAME	
	Units	ft	ft	ft-amsl	ft	gal	µg/L	µg/L	µg/L	µg/L	µg/L	µg/L	µg/L	µg/L	µg/L	µg/L	µg/L	µg/L	µg/L
MW-5	06/08/2012	37.40	15.20	22.20	0.00	0.00	<50	<0.5	<0.5	<0.5	<0.5	<0.5	-	<50	-	-	-	-	-
MW-5	09/14/2012	37.40	18.40	19.00	0.00	0.00	130	<0.5	<0.5	4	22	<0.5	-	<50	<2	<0.5	<0.5	<0.5	<0.5
MW-5	12/21/2012	37.40	14.62	22.78	0.00	0.00	<50	<0.5	<0.5	<0.5	<0.5	<0.5	-	<50	-	-	-	-	-
MW-6	02/02/1999	39.84	18.48	21.36	0.00	0.00	14,000	5,600	<50	150	160	-	<250	-	-	-	-	-	-
MW-6	06/07/1999	39.84	16.45	23.39	0.00	0.00	1,500	1,100	33	25	34	-	200	-	-	-	-	-	-
MW-6	09/07/1999	39.84	20.49	19.35	0.00	0.00	6,550	2,940	81.5	177	84	-	865	-	-	-	-	-	-
MW-6	10/27/1999	39.84	21.23	18.61	0.00	0.00	3,680	1,240	29.6	115	14.9	-	735	-	-	-	-	-	-
MW-6	02/08/2000	39.84	18.40	21.44	0.00	0.00	17,300	8,920	<100	378	211	-	2,610	-	-	-	-	-	-
MW-6	05/05/2000	39.84	16.36	23.48	0.00	0.00	4,200 ²	1,900	98	170	290	-	1,300	-	-	-	-	-	-
MW-6	07/28/2000	39.84	18.94	20.90	0.00	0.00	1,200 ²	660	30	83	36	-	650	-	-	-	-	-	-
MW-6	11/26/2000	39.84	20.13	19.71	0.00	0.00	7,600 ²	4,300	63	360	110	-	2,000	-	-	-	-	-	-
MW-6	02/09/2001	39.84	18.40	21.44	0.00	0.00	18,200 ³	7,090	<100	457	169	-	2,930	-	-	-	-	-	-
MW-6	05/11/2001	39.84	15.45	24.39	0.00	0.00	2,600 ²	2,300	31	88	40	-	990	-	-	-	-	-	-
MW-6	08/30/2001	39.84	20.02	19.82	0.00	0.00	2,500	1,600	50	160	100	-	1,900	-	-	-	-	-	-
MW-6	11/21/2001	39.84	20.62	19.22	0.00	0.00	25,000	8,800	150	620	330	-	2,900	-	-	-	-	-	-
MW-6	02/05/2002	39.84	15.80	24.04	0.00	0.00	1,400	400	6.8	27	20	-	480	-	-	-	-	-	-
MW-6	04/01/2002	36.90	13.82	23.08	0.00	0.00	-	-	-	-	-	-	-	-	-	-	-	-	-
MW-6	08/05/2002	36.90	17.05	19.85	0.00	0.00	1,200	300	5.1	11	3.7	-	250	-	-	-	-	-	-
MW-6	11/04/2002	36.90	19.56	17.34	0.00	0.00	7,500	2,000	29	140	39	-	1,300	-	-	-	-	-	-
MW-6	02/03/2003	36.90	14.62	22.28	0.00	0.00	630	160	<5.0	9.2	2.7	-	260	-	-	-	-	-	-
MW-6	05/02/2003	36.90	-	-	-	-	-	-	-	-	-	-	-	-	-	-	-	-	-
MW-6	08/01/2003 ⁷	36.90	16.88	20.02	0.00	0.00	1,500	400	3	14	3	540	-	-	-	-	-	-	-

TABLE 1

**GROUNDWATER MONITORING AND SAMPLING DATA
FORMER CHEVRON SERVICE STATION 93322
7225 BANCROFT AVENUE
OAKLAND, CALIFORNIA**

Location	Date	TOC	DTW	GWE	LNAPLT	LNAPL REMOVED	HYDROCARBONS	PRIMARY VOCS					ADDITIONAL VOCS						
							TPH-GRO	B	T	E	X	MTBE by SW8260	MTBE by VOC	Ethanol	TBA	DIPE	ETBE	TAME	
	Units	ft	ft	ft-amsl	ft	gal	µg/L	µg/L	µg/L	µg/L	µg/L	µg/L	µg/L	µg/L	µg/L	µg/L	µg/L	µg/L	µg/L
MW-6	11/21/2003 ⁷	36.90	18.41	18.49	0.00	0.00	4,400	1,300	12	98	18	540	-	-	-	-	-	-	-
MW-6	02/10/2004 ⁷	36.90	13.70	23.20	0.00	0.00	430	110	1	4	0.7	150	-	-	-	-	-	-	-
MW-6	05/11/2004 ⁷	36.90	14.27	22.63	0.00	0.00	95	11	<0.5	1	0.6	120	-	-	-	-	-	-	-
MW-6	08/10/2004 ⁷	36.90	16.64	20.26	0.00	0.00	430	46	<0.5	3	<0.5	140	-	-	-	-	-	-	-
MW-6	11/08/2004 ⁷	36.90	15.63	21.27	0.00	0.00	750	50	<0.5	2	<0.5	81	-	-	-	-	-	-	-
MW-6	02/21/2005 ⁷	36.90	11.43	25.47	0.00	0.00	130	8	<0.5	<0.5	<0.5	60	-	-	-	-	-	-	-
MW-6	05/10/2005 ⁷	36.90	11.41	25.49	0.00	0.00	<50	<0.5	<0.5	<0.5	<0.5	<0.5	-	-	-	-	-	-	-
MW-6	08/12/2005 ⁷	36.90	15.08	21.82	0.00	0.00	75	<0.5	<0.5	<0.5	<0.5	82	-	-	-	-	-	-	-
MW-6	11/11/2005 ⁷	36.90	18.16	18.74	0.00	0.00	1,100	270	12	19	46	350	-	-	-	-	-	-	-
MW-6	02/20/2006 ⁷	36.90	12.15	24.75	0.00	0.00	1,100	250	3	22	9	130	-	-	-	-	-	-	-
MW-6	05/12/2006 ⁷	36.90	10.32	26.58	0.00	0.00	<50	<0.5	<0.5	<0.5	<0.5	84	-	-	-	-	-	-	-
MW-6	08/14/2006 ⁷	36.90	15.21	21.69	0.00	0.00	51	<0.5	<0.5	<0.5	<0.5	75	-	-	-	-	-	-	-
MW-6	11/08/2006 ⁷	36.90	17.97	18.93	0.00	0.00	200	3	<0.5	<0.5	<0.5	27	-	-	-	-	-	-	-
MW-6	02/07/2007 ⁷	36.90	15.60	21.30	0.00	0.00	1,500	120	0.8	5	1	54	-	-	-	-	-	-	-
MW-6	05/07/2007 ⁷	36.90	14.78	22.12	0.00	0.00	740	98	0.5	2	2	31	-	-	-	-	-	-	-
MW-6	08/03/2007 ⁷	36.90	17.57	19.33	0.00	0.00	1,600	410	4	2	3	80	-	-	-	-	-	-	-
MW-6	10/12/2007 ⁷	36.90	19.20	17.70	0.00	0.00	1,100	130	0.9	0.9	<0.5	79	-	-	-	-	-	-	-
MW-6	11/02/2007 ⁷	36.90	19.43	17.47	0.00	0.00	1,500	240	1	0.7	0.5	70	-	-	-	-	-	-	-
MW-6	12/07/2007 ⁷	36.90	19.11	17.79	0.00	0.00	770	84	<0.5	<0.5	<0.5	60	-	-	-	-	-	-	-
MW-6	02/01/2008 ⁷	36.90	14.03	22.87	0.00	0.00	650	89	<0.5	1	0.7	24	-	-	-	-	-	-	-
MW-6	05/09/2008 ⁷	36.90	15.22	21.68	0.00	0.00	680	87	<0.5	<0.5	<0.5	19	-	-	-	-	-	-	-
MW-6	08/22/2008 ⁷	36.90	18.46	18.44	0.00	0.00	950	43	<0.5	<0.5	<0.5	38	-	-	-	-	-	-	-
MW-6	11/26/2008 ⁷	36.90	19.87	17.03	0.00	0.00	1,500	190	1	0.6	0.5	71	-	-	-	-	-	-	-

TABLE 1

**GROUNDWATER MONITORING AND SAMPLING DATA
FORMER CHEVRON SERVICE STATION 93322
7225 BANCROFT AVENUE
OAKLAND, CALIFORNIA**

Location	Date	TOC	DTW	GWE	LNAPLT	LNAPL REMOVED	HYDROCARBONS		PRIMARY VOCS					ADDITIONAL VOCS					
							TPH-GRO	B	T	E	X	MTBE by SW8260	MTBE by VOC	Ethanol	TBA	DIPE	ETBE	TAME	
	Units	ft	ft	ft-amsl	ft	gal	µg/L	µg/L	µg/L	µg/L	µg/L	µg/L	µg/L	µg/L	µg/L	µg/L	µg/L	µg/L	µg/L
MW-6	05/20/2009	36.90	15.03	21.87	0.00	0.00	580	23	<0.5	0.7 J	<0.5	11	-	<50	-	-	-	-	-
MW-6	08/26/2009	36.90	19.00	17.90	0.00	0.00	1,100	88	0.8 J	0.6 J	<0.5	25	-	<50	-	-	-	-	-
MW-6	11/12/2009	36.90	18.19	18.71	0.00	0.00	980	95	0.8 J	1	1	20	-	<50	-	-	-	-	-
MW-6	02/01/2010	36.90	13.30	23.60	0.00	0.00	530	28	<0.5	0.9 J	<0.5	6	-	<50	-	-	-	-	-
MW-6	05/17/2010	36.90	11.67	25.23	0.00	0.00	450	14	<0.5	1	<0.5	4	-	<50	-	-	-	-	-
MW-6	08/26/2010	36.90	15.42	21.48	0.00	0.00	860	29	<0.5	2	<0.5	4	-	<50	-	-	-	-	-
MW-6	11/11/2010 ¹²	36.90	-	-	-	-	-	-	-	-	-	-	-	-	-	-	-	-	-
MW-6	02/10/2011	36.90	13.00	23.90	0.00	0.00	370	10	<0.5	<0.5	<0.5	3	-	<50	-	-	-	-	-
MW-6	06/17/2011	36.90	12.35	24.55	0.00	0.00	690	22	<0.5	2	<0.5	4	-	<50	-	-	-	-	-
MW-6	09/08/2011	36.90	15.68	21.22	0.00	0.00	880	92	<0.5	2	<0.5	6	-	<50	-	-	-	-	-
MW-6	12/16/2011	36.90	16.63	20.27	0.00	0.00	3,200	620	4	10	8	11	-	<50	-	-	-	-	-
MW-6	03/02/2012	36.90	16.55	20.35	0.00	0.00	2,900	510	<5	<5	5 J	13	-	<500	-	-	-	-	-
MW-6	06/08/2012	36.90	14.03	22.87	0.00	0.00	3,000	750	<5	<5	<5	12	-	<500	-	-	-	-	-
MW-6	09/14/2012	36.90	17.84	19.06	0.00	0.00	4,300	930	<5	<5	<5	10	-	<500	81	<5	<5	<5	<5
MW-6	12/21/2012	36.90	13.88	23.02	0.00	0.00	2,200	360	<5	<5	<5	28	-	<500	-	-	-	-	-
MW-7	02/21/2005 ⁷	36.84	10.41	26.43	0.00	0.00	7,600	2,200	6	210	920	53	-	<100	130	<1	<1	<1	<1
MW-7	05/10/2005 ⁷	36.84	9.59	27.25	0.00	0.00	3,900	700	<0.5	<0.5	650	77	-	<50	140	<0.5	<0.5	<0.5	<0.5
MW-7	08/12/2005 ⁷	36.84	12.83	24.01	0.00	0.00	18,000	7,300	12	1,100	2,500	80	-	<500	280	<5	<5	<5	<5
MW-7	11/11/2005 ⁷	36.84	16.64	20.20	0.00	0.00	39,000	11,000	38	1,700	2,900	100	-	<1,000	340	<10	<10	<10	<10
MW-7	02/20/2006 ⁷	36.84	10.39	26.45	0.00	0.00	17,000	4,400	18	470	1,500	62	-	<500	200	<5	<5	<5	<5
MW-7	05/12/2006 ⁷	36.84	8.79	28.05	0.00	0.00	15,000	5,100	12	370	880	73	-	<500	200	<5	<5	<5	<5
MW-7	08/14/2006 ⁷	36.84	13.88	22.96	0.00	0.00	30,000	8,100	18	1,500	3,600	74	-	<1,000	280	<10	<10	<10	<10

TABLE 1

**GROUNDWATER MONITORING AND SAMPLING DATA
FORMER CHEVRON SERVICE STATION 93322
7225 BANCROFT AVENUE
OAKLAND, CALIFORNIA**

Location	Date	TOC	DTW	GWE	LNAPL	LNAPL REMOVED	HYDROCARBONS		PRIMARY VOCS					ADDITIONAL VOCS					
							TPH-GRO	B	T	E	X	MTBE by SW8260	MTBE by VOC	Ethanol	TBA	DIPE	ETBE	TAME	
	Units	ft	ft	ft-amsl	ft	gal	µg/L	µg/L	µg/L	µg/L	µg/L	µg/L	µg/L	µg/L	µg/L	µg/L	µg/L	µg/L	µg/L
MW-7	11/08/2006 ⁷	36.84	16.87	19.97	0.00	0.00	39,000	10,000	28	1,400	2,300	89	-	<1,000	330	<10	<10	<10	
MW-7	02/07/2007 ⁷	36.84	14.43	22.41	0.00	0.00	43,000	9,400	51	1,800	4,400	80	-	<500	280	<5	<5	<5	
MW-7	05/07/2007 ⁷	36.84	12.57	24.27	0.00	0.00	50,000	8,800	35	1,700	3,700	72	-	<1,000	240	<10	<10	<10	
MW-7	08/03/2007 ⁷	36.84	16.10	20.74	0.00	0.00	57,000	12,000	41	2,400	4,400	84	-	<2,500	300	<25	<25	<25	
MW-7	10/12/2007 ⁷	36.84	18.16	18.68	0.00	0.00	15,000	2,300	63	270	730	58	-	<1,000	290	<10	<10	<10	
MW-7	11/02/2007 ⁷	36.84	18.01	18.83	0.00	0.00	21,000	5,000	120	820	2,300	59	-	<500	280	<5	<5	<5	
MW-7	12/07/2007	36.84	18.92	17.92	0.00	0.00	-	-	-	-	-	-	-	-	-	-	-	-	
MW-7	02/01/2008	36.84	12.78	24.06	0.00	0.00	-	-	-	-	-	-	-	-	-	-	-	-	
MW-7	05/09/2008 ⁷	36.84	13.98	22.86	0.00	0.00	24,000	4,600	99	1,000	3,400	57	-	<250	240	<3	<3	<3	
MW-7	08/22/2008 ⁷	36.84	17.19	19.65	0.00	0.00	32,000	9,500	240	1,900	4,800	76	-	<1,000	270	<10	<10	<10	
MW-7	11/26/2008 ⁷	36.84	19.01	17.83	0.00	0.00	39,000	9,700	840	1,600	5,700	62	-	<1,300	280	<13	<13	<13	
MW-7	05/20/2009	36.84	13.71	23.13	0.00	0.00	24,000	5,400	190	810	2,800	66	-	<250	260	<3	<3	<3	
MW-7	08/26/2009	36.84	19.00	17.84	0.00	0.00	-	-	-	-	-	-	-	-	-	-	-	-	
MW-7	11/12/2009	36.84	16.43	20.41	0.00	0.00	19,000	5,900	190	540	1,800	57	-	<500	240	<5	<5	<5	
MW-7	05/17/2010	36.84	10.30	26.54	0.00	0.00	13,000	3,600	63	310	1,300	58	-	<250	220	<3	<3	<3	
MW-7	08/26/2010 ¹¹	36.84	14.40	22.44	0.00	0.00	-	-	-	-	-	-	-	-	-	-	-	-	
MW-7	11/11/2010	36.84	16.50	20.34	0.00	0.00	16,000	7,300	140	720	2,400	64	-	<500	280	<5	<5	<5	
MW-7	02/10/2011 ¹³	36.84	12.16	24.68	0.00	0.00	-	-	-	-	-	-	-	-	-	-	-	-	
MW-7	06/17/2011	36.84	11.25	25.59	0.00	0.00	12,000	3,800	22	460	1,600	56	-	<250	120	<3	<3	<3	
MW-7	09/08/2011	36.84	14.65	22.19	0.00	0.00	-	-	-	-	-	-	-	-	-	-	-	-	
MW-7	12/16/2011	36.84	17.36	19.48	0.00	0.00	35,000	8,100	370	1,000	3,900	78	-	<500	300	<5	<5	<5	
MW-7	03/02/2012 ¹³	36.84	15.42	21.42	0.00	0.00	-	-	-	-	-	-	-	-	-	-	-	-	
MW-7	06/08/2012	36.84	13.10	23.74	0.00	0.00	19,000	6,000	180	310	1,200	56	-	<500	-	-	-	-	

TABLE 1

**GROUNDWATER MONITORING AND SAMPLING DATA
FORMER CHEVRON SERVICE STATION 93322
7225 BANCROFT AVENUE
OAKLAND, CALIFORNIA**

Location	Date	TOC	DTW	GWE	LNAPLT	LNAPL REMOVED	HYDROCARBONS	PRIMARY VOCS					ADDITIONAL VOCS						
							TPH-GRO	B	T	E	X	MTBE by SW8260	MTBE by VOC	Ethanol	TBA	DIPE	ETBE	TAME	
	Units	ft	ft	ft-amsl	ft	gal	µg/L	µg/L	µg/L	µg/L	µg/L	µg/L	µg/L	µg/L	µg/L	µg/L	µg/L	µg/L	µg/L
MW-7	09/14/2012 ¹³	36.84	16.91	19.93	0.00	0.00	-	-	-	-	-	-	-	-	-	-	-	-	-
MW-7	12/21/2012	36.84	12.19	24.65	0.00	0.00	21,000	5,300	160	530	2,200	55	-	<2,500	240 J	<25	<25	<25	<25
MW-8	04/01/2002 ⁶	37.21	11.10	26.11	0.00	0.00	1,200	8.6	<0.50	2.5	2.5	-	<2.5/<2 ⁵	-	<100	<2	<2	<2	<2
MW-8	08/05/2002	37.21	16.14	21.07	0.00	0.00	560	11	<0.50	<0.50	<1.5	-	<2.5/<2 ⁵	-	<100	<2	<2	<2	<2
MW-8	11/04/2002	37.21	18.97	18.24	0.00	0.00	780	5.1	<0.50	1.1	1.9	-	<2 ⁵ / <lt;2.5< td=""> <td>-</td> <td><100</td> <td><2</td> <td><2</td> <td><2</td> <td><2</td> </lt;2.5<>	-	<100	<2	<2	<2	<2
MW-8	02/03/2003	37.21	13.21	24.00	0.00	0.00	230	3.7	<0.50	0.54	<1.5	-	<0.6 ⁵ / <lt;10< td=""> <td>-</td> <td><5</td> <td><0.5</td> <td><0.5</td> <td><0.5</td> <td><0.5</td> </lt;10<>	-	<5	<0.5	<0.5	<0.5	<0.5
MW-8	05/02/2003	37.21	12.12	25.09	0.00	0.00	180	2.5	<0.5	<0.5	<1.5	-	<0.5 ⁵ / <lt;2.5< td=""> <td>-</td> <td><5</td> <td><0.5</td> <td><0.5</td> <td><0.5</td> <td><0.5</td> </lt;2.5<>	-	<5	<0.5	<0.5	<0.5	<0.5
MW-8	08/01/2003 ⁷	37.21	16.11	21.10	0.00	0.00	220	2	<0.5	<0.5	<0.5	0.8	-	<50	<5	<0.5	<0.5	<0.5	<0.5
MW-8	11/21/2003 ⁷	37.21	17.17	20.04	0.00	0.00	140	<0.5	<0.5	<0.5	<0.5	0.7	-	<50	<5	<0.5	<0.5	<0.5	<0.5
MW-8	02/10/2004 ⁷	37.21	12.13	25.08	0.00	0.00	150	2	<0.5	<0.5	<0.5	0.8	-	<50	<5	<0.5	<0.5	<0.5	<0.5
MW-8	05/11/2004 ⁷	37.21	13.47	23.74	0.00	0.00	86	4	<0.5	<0.5	<0.5	1	-	<50	<5	<0.5	<0.5	<0.5	<0.5
MW-8	08/10/2004 ⁷	37.21	15.65	21.56	0.00	0.00	80	<0.5	<0.5	<0.5	<0.5	0.8	-	<50	<5	<0.5	<0.5	<0.5	<0.5
MW-8	11/08/2004 ⁷	37.21	13.98	23.23	0.00	0.00	110	<0.5	<0.5	<0.5	<0.5	1	-	<50	7	<0.5	<0.5	<0.5	<0.5
MW-8	02/21/2005 ⁷	37.21	10.09	27.12	0.00	0.00	<50	<0.5	<0.5	<0.5	<0.5	<0.5	-	<50	<5	<0.5	<0.5	<0.5	<0.5
MW-8	05/10/2005 ⁷	37.21	10.60	26.61	0.00	0.00	<50	<0.5	<0.5	<0.5	<0.5	1	-	<50	<5	<0.5	<0.5	<0.5	<0.5
MW-8	08/12/2005 ⁷	37.21	12.58	24.63	0.00	0.00	<50	<0.5	<0.5	<0.5	<0.5	<0.5	-	<50	<5	<0.5	<0.5	<0.5	<0.5
MW-8	11/11/2005 ⁷	37.21	17.41	19.80	0.00	0.00	96	<0.5	<0.5	<0.5	<0.5	2	-	<50	6	<0.5	<0.5	<0.5	<0.5
MW-8	02/20/2006 ⁷	37.21	10.79	26.42	0.00	0.00	81	<0.5	<0.5	<0.5	<0.5	0.6	-	<50	<5	<0.5	<0.5	<0.5	<0.5
MW-8	05/12/2006 ⁷	37.21	9.24	27.97	0.00	0.00	72	1	<0.5	<0.5	<0.5	2	-	<50	6	<0.5	<0.5	<0.5	<0.5
MW-8	08/14/2006 ⁷	37.21	14.67	22.54	0.00	0.00	110	3	<0.5	<0.5	<0.5	2	-	<50	7	<0.5	<0.5	<0.5	<0.5
MW-8	11/08/2006 ⁷	37.21	17.41	19.80	0.00	0.00	310	2	1	<0.5	2	3	-	<50	13	<0.5	<0.5	<0.5	<0.5
MW-8	02/07/2007 ⁷	37.21	14.58	22.63	0.00	0.00	310	0.6	<0.5	<0.5	<0.5	2	-	<50	7	<0.5	<0.5	<0.5	<0.5

TABLE 1

**GROUNDWATER MONITORING AND SAMPLING DATA
FORMER CHEVRON SERVICE STATION 93322
7225 BANCROFT AVENUE
OAKLAND, CALIFORNIA**

Location	Date	TOC	DTW	GWE	LNAPLT	LNAPL REMOVED	HYDROCARBONS	PRIMARY VOCS					ADDITIONAL VOCS						
							TPH-GRO	B	T	E	X	MTBE by SW8260	MTBE by VOC	Ethanol	TBA	DIPE	ETBE	TAME	
	Units	ft	ft	ft-amsl	ft	gal	µg/L	µg/L	µg/L	µg/L	µg/L	µg/L	µg/L	µg/L	µg/L	µg/L	µg/L	µg/L	µg/L
MW-8	05/07/2007 ⁷	37.21	12.78	24.43	0.00	0.00	95	0.5	<0.5	<0.5	<0.5	2	-	<50	6	<0.5	<0.5	<0.5	
MW-8	08/03/2007 ⁷	37.21	16.70	20.51	0.00	0.00	130	<0.5	<0.5	<0.5	<0.5	2	-	<50	8	<0.5	<0.5	<0.5	
MW-8	10/12/2007 ⁷	37.21	18.51	18.70	0.00	0.00	340	<0.5	<0.5	<0.5	<0.5	5	-	<50	20	<0.5	<0.5	<0.5	
MW-8	11/02/2007 ⁷	37.21	18.81	18.40	0.00	0.00	210	<0.5	<0.5	<0.5	<0.5	2	-	<50	5	<0.5	<0.5	<0.5	
MW-8	12/07/2007 ⁷	37.21	18.62	18.59	0.00	0.00	230	<0.5	<0.5	<0.5	<0.5	2	-	<50	5	<0.5	<0.5	<0.5	
MW-8	02/01/2008 ⁷	37.21	14.18	23.03	0.00	0.00	96	<0.5	<0.5	<0.5	<0.5	0.8	-	<50	<2	<0.5	<0.5	<0.5	
MW-8	05/09/2008 ⁷	37.21	14.33	22.88	0.00	0.00	120	2	<0.5	<0.5	<0.5	2	-	<50	6	<0.5	<0.5	<0.5	
MW-8	08/22/2008 ⁷	37.21	17.88	19.33	0.00	0.00	180	0.9	<0.5	<0.5	<0.5	4	-	<50	14	<0.5	<0.5	<0.5	
MW-8	11/26/2008 ⁷	37.21	19.52	17.69	0.00	0.00	350	<0.5	<0.5	<0.5	<0.5	1	-	<50	2	<0.5	<0.5	<0.5	
MW-8	05/20/2009	37.21	14.11	23.10	0.00	0.00	310	3	<0.5	<0.5	<0.5	0.7 J	-	<50	<2	<0.5	<0.5	<0.5	
MW-8	08/26/2009	37.21	18.19	19.02	0.00	0.00	-	-	-	-	-	-	-	-	-	-	-	-	
MW-8	11/12/2009	37.21	16.60	20.61	0.00	0.00	350	2	<0.5	<0.5	<0.5	1	-	<50	2 J	<0.5	<0.5	<0.5	
MW-8	05/17/2010	37.21	10.50	26.71	0.00	0.00	230	2	<0.5	<0.5	<0.5	0.5 J	-	<50	<2	<0.5	<0.5	<0.5	
MW-8	08/26/2010 ¹¹	37.21	14.72	22.49	0.00	0.00	-	-	-	-	-	-	-	-	-	-	-	-	
MW-8	11/11/2010	37.21	16.58	20.63	0.00	0.00	330	<0.5	<0.5	<0.5	<0.5	1	-	<50	3 J	<0.5	<0.5	<0.5	
MW-8	02/10/2011 ¹³	37.21	12.30	24.91	0.00	0.00	-	-	-	-	-	-	-	-	-	-	-	-	
MW-8	06/17/2011	37.21	11.43	25.78	0.00	0.00	<50	<0.5	<0.5	<0.5	<0.5	1	-	<50	<2	<0.5	<0.5	<0.5	
MW-8	09/08/2011	37.21	15.15	22.06	0.00	0.00	-	-	-	-	-	-	-	-	-	-	-	-	
MW-8	12/16/2011	37.21	15.00	22.21	0.00	0.00	<50	<0.5	<0.5	<0.5	<0.5	1	-	<50	4 J	<0.5	<0.5	<0.5	
MW-8	03/02/2012 ¹³	37.21	15.70	21.51	0.00	0.00	-	-	-	-	-	-	-	-	-	-	-	-	
MW-8	06/08/2012	37.21	13.42	23.79	0.00	0.00	100	2	<0.5	<0.5	<0.5	3	-	<50	-	-	-	-	
MW-8	09/14/2012 ¹³	37.21	17.20	20.01	0.00	0.00	-	-	-	-	-	-	-	-	-	-	-	-	
MW-8	12/21/2012	37.21	12.11	25.10	0.00	0.00	<50	<0.5	<0.5	<0.5	<0.5	2	-	<50	6	<0.5	<0.5	<0.5	

TABLE 1

**GROUNDWATER MONITORING AND SAMPLING DATA
FORMER CHEVRON SERVICE STATION 93322
7225 BANCROFT AVENUE
OAKLAND, CALIFORNIA**

Location	Date	TOC	DTW	GWE	LNAPL	LNAPL REMOVED	HYDROCARBONS		PRIMARY VOCS					ADDITIONAL VOCS					
							TPH-GRO	B	T	E	X	MTBE by SW8260	MTBE by VOC	Ethanol	TBA	DIPE	ETBE	TAME	
	Units	ft	ft	ft-amsl	ft	gal	µg/L	µg/L	µg/L	µg/L	µg/L	µg/L	µg/L	µg/L	µg/L	µg/L	µg/L	µg/L	µg/L
MW-9	04/01/2002 ⁶	35.03	10.62	24.41	0.00	0.00	94	1.5	<0.50	<0.50	<1.5	-	25/19 ⁵	-	<100	<2	<2	<2	
MW-9	08/05/2002	35.03	14.85	20.18	0.00	0.00	<50	<0.50	<0.50	<0.50	<1.5	-	15 ⁵ /18	-	<100	<2	<2	<2	
MW-9	11/04/2002	35.03	17.48	17.55	0.00	0.00	<50	<0.50	1.7	<0.50	2.1	-	24/21 ⁵	-	<100	<2	<2	<2	
MW-9	02/03/2003	35.03	12.51	22.52	0.00	0.00	<50	1.9	<0.50	<0.50	<1.5	-	17/16 ⁵	-	<5	<0.5	<0.5	0.8	
MW-9	05/02/2003	35.03	11.68	23.35	0.00	0.00	<50	0.6	<0.5	<0.5	<1.5	-	21/18 ⁵	-	<5	<0.5	<0.5	0.8	
MW-9	08/01/2003 ⁷	35.03	14.69	20.34	0.00	0.00	<50	<0.5	<0.5	<0.5	<0.5	22	-	<50	7	0.9	<0.5	1	
MW-9	11/21/2003 ⁷	35.03	16.35	18.68	0.00	0.00	<50	<0.5	<0.5	<0.5	<0.5	18	-	<50	<5	0.8	<0.5	1	
MW-9	02/10/2004 ⁷	35.03	11.69	23.34	0.00	0.00	210	7	0.5	1	1	31	-	<50	9	0.6	<0.5	2	
MW-9	05/11/2004 ⁷	35.03	12.12	22.91	0.00	0.00	230	17	<0.5	<0.5	<0.5	72	-	<50	16	<0.5	<0.5	4	
MW-9	08/10/2004 ⁷	35.03	14.58	20.45	0.00	0.00	250	5	<0.5	<0.5	<0.5	66	-	<50	<5	0.9	<0.5	3	
MW-9	11/08/2004	35.03	-	-	-	-	-	-	-	-	-	-	-	-	-	-	-	-	
MW-9	02/21/2005 ⁷	35.03	9.52	25.51	0.00	0.00	510	6	<0.5	1	3	79	-	<50	17	0.5	<0.5	4	
MW-9	05/10/2005 ⁷	35.03	8.85	26.18	0.00	0.00	670	11	0.7	0.5	2	100	-	<50	20	<0.5	<0.5	4	
MW-9	08/12/2005 ⁷	35.03	11.06	23.97	0.00	0.00	390	4	<0.5	<0.5	0.7	89	-	<50	18	<0.5	<0.5	4	
MW-9	11/11/2005 ⁷	35.03	15.98	19.05	0.00	0.00	2,500	48	5	21	33	140	-	<50	25	<0.5	<0.5	6	
MW-9	02/20/2006 ⁷	35.03	10.08	24.95	0.00	0.00	3,200	47	5	30	32	130	-	<50	22	<0.5	<0.5	5	
MW-9	05/12/2006 ⁷	35.03	8.08	26.95	0.00	0.00	1,800	19	1	1	4	89	-	<50	14	<0.5	<0.5	4	
MW-9	08/14/2006	35.03	-	-	-	-	-	-	-	-	-	-	-	-	-	-	-	-	
MW-9	11/08/2006	35.03	-	-	-	-	-	-	-	-	-	-	-	-	-	-	-	-	
MW-9	02/07/2007 ⁷	35.03	13.57	21.46	0.00	0.00	2,000	22	2	1	8	78	-	<50	14	<0.5	<0.5	3	
MW-9	05/07/2007 ⁷	35.03	11.85	23.18	0.00	0.00	1,800	17	2	1	5	67	-	<50	13	<0.5	<0.5	3	
MW-9	08/03/2007	35.03	-	-	-	-	-	-	-	-	-	-	-	-	-	-	-	-	

TABLE 1

GROUNDWATER MONITORING AND SAMPLING DATA
 FORMER CHEVRON SERVICE STATION 93322
 7225 BANCROFT AVENUE
 OAKLAND, CALIFORNIA

Location	Date	TOC	DTW	GWE	LNAPLT	LNAPL REMOVED	HYDROCARBONS	PRIMARY VOCS					ADDITIONAL VOCS						
							TPH-GRO	B	T	E	X	MTBE by SW8260	MTBE by VOC	Ethanol	TBA	DIPE	ETBE	TAME	
	Units	ft	ft	ft-amsl	ft	gal	µg/L	µg/L	µg/L	µg/L	µg/L	µg/L	µg/L	µg/L	µg/L	µg/L	µg/L	µg/L	µg/L
MW-9	10/12/2007 ⁷	35.03	17.20	17.83	0.00	0.00	55	<0.5	<0.5	<0.5	<0.5	30	-	<50	4	<0.5	<0.5	1	
MW-9	11/02/2007 ⁷	35.03	17.28	17.75	0.00	0.00	72	<0.5	<0.5	<0.5	0.9	57	-	<50	8	<0.5	<0.5	2	
MW-9	12/07/2007 ⁷	35.03	17.12	17.91	0.00	0.00	<50	<0.5	<0.5	<0.5	<0.5	59	-	<50	9	<0.5	<0.5	2	
MW-9	02/01/2008 ⁷	35.03	12.23	22.80	0.00	0.00	61	<0.5	<0.5	<0.5	<0.5	50	-	<50	11	<0.5	<0.5	2	
MW-9	05/09/2008	35.03	-	-	-	-	-	-	-	-	-	-	-	-	-	-	-	-	
MW-9	05/16/2008 ⁷	35.03	13.34	21.69	0.00	0.00	51	0.5	6	0.5	3	35	-	<50	11	<0.5	<0.5	1	
MW-9	08/22/2008 ⁷	35.03	16.32	18.71	0.00	0.00	<50	<0.5	<0.5	<0.5	<0.5	35	-	<50	6	<0.5	<0.5	0.9	
MW-9	11/26/2008 ⁷	35.03	17.84	17.19	0.00	0.00	<50	<0.5	<0.5	<0.5	<0.5	33	-	<50	4	<0.5	<0.5	0.7	
MW-9	05/20/2009	35.03	13.18	21.85	0.00	0.00	<50	<0.5	<0.5	<0.5	<0.5	18	-	<50	7	<0.5	<0.5	<0.5	
MW-9	08/26/2009	35.03	17.03	18.00	0.00	0.00	<50	<0.5	<0.5	<0.5	<0.5	26	-	<50	<2	<0.5	<0.5	<0.5	
MW-9	02/01/2010	35.03	11.69	23.34	0.00	0.00	<50	<0.5	<0.5	<0.5	<0.5	19	-	<50	9	<0.5	<0.5	<0.5	
MW-9	08/26/2010	35.03	12.60	22.43	0.00	0.00	<50	<0.5	<0.5	<0.5	<0.5	17	-	<50	9	<0.5	<0.5	0.6 J	
MW-9	11/11/2010 ¹¹	35.03	15.74	19.29	0.00	0.00	-	-	-	-	-	-	-	-	-	-	-	-	
MW-9	02/10/2011 ¹¹	35.03	10.29	24.74	0.00	0.00	<50	<0.5	<0.5	<0.5	<0.5	12	-	<50	12	<0.5	<0.5	<0.5	
MW-9	06/17/2011 ¹¹	35.03	-	-	-	-	-	-	-	-	-	-	-	-	-	-	-	-	
MW-9	09/08/2011 ¹¹	35.03	12.74	22.29	0.00	0.00	60 J	<0.5	<0.5	<0.5	<0.5	15	-	<50	-	-	-	-	
MW-9	12/16/2011 ¹¹	35.03	14.60	20.43	0.00	0.00	-	-	-	-	-	-	-	-	-	-	-	-	
MW-9	03/02/2012	35.03	14.43	20.60	0.00	0.00	83 J	<0.5	<0.5	<0.5	<0.5	10	-	<50	15	<0.5	<0.5	<0.5	
MW-9	06/08/2012 ¹¹	35.03	11.42	23.61	0.00	0.00	-	-	-	-	-	-	-	-	-	-	-	-	
MW-9	09/14/2012	35.03	15.90	19.13	0.00	0.00	220	1	<0.5	<0.5	<0.5	17	-	<50	14	<0.5	<0.5	<0.5	
MW-9	12/21/2012¹¹	35.03	12.06	22.97	0.00	0.00	-	-	-	-	-	-	-	-	-	-	-	-	
MW-10	04/01/2002 ⁶	35.53	11.72	23.81	0.00	0.00	<50	<0.50	<0.50	<0.50	<1.5	-	5 ⁵ /6.1	-	<100	<2	<2.0	<2	

TABLE 1

GROUNDWATER MONITORING AND SAMPLING DATA
 FORMER CHEVRON SERVICE STATION 93322
 7225 BANCROFT AVENUE
 OAKLAND, CALIFORNIA

Location	Date	TOC	DTW	GWE	LNAPLT	LNAPL REMOVED	HYDROCARBONS	PRIMARY VOCS					ADDITIONAL VOCS						
							TPH-GRO	B	T	E	X	MTBE by SW8260	MTBE by VOC	Ethanol	TBA	DIPE	ETBE	TAME	
	Units	ft	ft	ft-amsl	ft	gal	µg/L	µg/L	µg/L	µg/L	µg/L	µg/L	µg/L	µg/L	µg/L	µg/L	µg/L	µg/L	µg/L
MW-10	08/05/2002	35.53	15.80	19.73	0.00	0.00	<50	<0.50	<0.50	<0.50	<1.5	-	5.1/5 ⁵	-	<100	<2	<2.0	<2	
MW-10	11/04/2002	35.53	18.31	17.22	0.00	0.00	<50	<0.50	<0.50	<0.50	<1.5	-	5.5/5 ⁵	-	<100	<2	<2.0	<2	
MW-10	02/03/2003	35.53	13.42	22.11	0.00	0.00	<50	<0.50	<0.50	<0.50	<1.5	-	2.8/3 ⁵	-	<5	<0.5	<0.5	<0.5	
MW-10	05/02/2003	35.53	12.45	23.08	0.00	0.00	<50	<0.5	<0.5	<0.5	<1.5	-	<2.5/<0.5 ⁵	-	<5	<0.5	<0.5	<0.5	
MW-10	08/01/2003 ⁷	35.53	15.62	19.91	0.00	0.00	<50	<0.5	<0.5	<0.5	<0.5	2	-	<50.0	<5	<0.5	<0.5	<0.5	
MW-10	11/21/2003 ⁷	35.53	17.26	18.27	0.00	0.00	<50	<0.5	<0.5	<0.5	<0.5	1	-	<50.0	<5	<0.50	<0.50	<0.5	
MW-10	02/10/2004 ⁷	35.53	12.52	23.01	0.00	0.00	<50	<0.5	<0.5	<0.5	<0.5	<0.5	-	<50.0	<5	<0.50	<0.5	<0.5	
MW-10	05/11/2004 ⁷	35.53	13.06	22.47	0.00	0.00	<50	<0.5	<0.5	<0.5	<0.5	1	-	<50	<5	<0.5	<0.5	<0.5	
MW-10	08/10/2004 ⁷	35.53	15.45	20.08	0.00	0.00	<50	<0.5	<0.5	<0.5	<0.5	3	-	<50.0	<5	<0.5	<0.5	<0.5	
MW-10	11/08/2004 ⁷	35.53	14.68	20.85	0.00	0.00	<50	<0.5	<0.5	0.9	5	<0.5	-	<50.0	<5	<0.5	<0.50	<0.5	
MW-10	02/21/2005 ⁷	35.53	10.32	25.21	0.00	0.00	<50	<0.5	<0.5	<0.5	<0.5	<0.5	-	<50.0	<5	<0.5	<0.50	<0.5	
MW-10	05/10/2005 ⁷	35.53	11.04	24.49	0.00	0.00	<50	<0.5	<0.5	<0.5	<0.5	1	-	<50.0	<5	<0.5	<0.50	<0.5	
MW-10	08/12/2005 ⁷	35.53	12.58	22.95	0.00	0.00	<50	<0.5	<0.5	<0.5	<0.5	1	-	<50.0	<5	<0.5	<0.50	<0.5	
MW-10	11/11/2005 ⁷	35.53	16.89	18.64	0.00	0.00	<50	<0.5	<0.5	<0.5	<0.5	5	-	<50.0	<5	<0.5	<0.50	<0.5	
MW-10	02/20/2006 ⁷	35.53	10.91	24.62	0.00	0.00	<50	<0.5	<0.5	<0.5	<0.5	<0.5	-	<50.0	<5	<0.5	<0.50	<0.5	
MW-10	05/12/2006 ⁷	35.53	9.26	26.27	0.00	0.00	<50	<0.5	<0.5	<0.5	<0.5	0.6	-	<50	<5	<0.5	<0.5	<0.5	
MW-10	08/14/2006 ⁷	35.53	13.96	21.57	0.00	0.00	<50	<0.5	<0.5	<0.5	<0.5	2	-	<50.0	<5	<0.5	<0.5	<0.5	
MW-10	11/08/2006	35.53	-	-	-	-	-	-	-	-	-	-	-	-	-	-	-	-	
MW-10	02/07/2007 ⁷	35.53	14.45	21.08	0.00	0.00	<50	<0.5	<0.5	<0.5	<0.5	2	-	<50.0	<2	<0.5	<0.5	<0.5	
MW-10	05/07/2007 ⁷	35.53	12.81	22.72	0.00	0.00	<50	<0.5	<0.5	<0.5	<0.5	0.9	-	<50.0	<2	<0.5	<0.5	<0.5	
MW-10	08/03/2007 ⁷	35.53	16.35	19.18	0.00	0.00	<50	<0.5	<0.5	<0.5	<0.5	3	-	<50	<2	<0.5	<0.5	<0.5	
MW-10	10/12/2007 ⁷	35.53	17.93	17.60	0.00	0.00	<50	<0.5	<0.5	<0.5	<0.5	5	-	<50	<2	<0.5	<0.5	<0.5	
MW-10	11/02/2007 ⁷	35.53	18.04	17.49	0.00	0.00	<50	<0.5	<0.5	<0.5	<0.5	4	-	<50	<2	<0.5	<0.5	<0.5	

TABLE 1

**GROUNDWATER MONITORING AND SAMPLING DATA
FORMER CHEVRON SERVICE STATION 93322
7225 BANCROFT AVENUE
OAKLAND, CALIFORNIA**

Location	Date	TOC	DTW	GWE	LNAPLT	LNAPL REMOVED	HYDROCARBONS	PRIMARY VOCS					ADDITIONAL VOCS						
							TPH-GRO	B	T	E	X	MTBE by SW8260	MTBE by VOC	Ethanol	TBA	DIPE	ETBE	TAME	
	Units	ft	ft	ft-amsl	ft	gal	µg/L	µg/L	µg/L	µg/L	µg/L	µg/L	µg/L	µg/L	µg/L	µg/L	µg/L	µg/L	µg/L
MW-10	12/07/2007 ⁷	35.53	17.81	17.72	0.00	0.00	<50	<0.5	<0.5	<0.5	<0.5	3	-	<50	<2	<0.5	<0.50	<0.5	
MW-10	02/01/2008 ⁷	35.53	13.35	22.18	0.00	0.00	<50	<0.5	<0.5	<0.5	<0.5	<0.5	-	<50	<2	<0.5	<0.50	<0.5	
MW-10	05/09/2008 ⁷	35.53	14.11	21.42	0.00	0.00	<50	<0.5	<0.5	<0.5	<0.5	2	-	<50	<2	<0.50	<0.50	<0.5	
MW-10	08/22/2008 ⁷	35.53	17.70	17.83	0.00	0.00	<50	<0.5	<0.5	<0.5	<0.5	5	-	<50	<2	<0.5	<0.50	<0.5	
MW-10	11/26/2008 ⁷	35.53	18.61	16.92	0.00	0.00	<50	<0.5	<0.5	<0.5	<0.5	4	-	<50	<2	<0.5	<0.5	<0.5	
MW-10	05/20/2009	35.53	14.03	21.50	0.00	0.00	<50	<0.5	<0.5	<0.5	<0.5	3	-	<50	<2	<0.5	<0.5	<0.5	
MW-10	08/26/2009	35.53	17.81	17.72	0.00	0.00	<50	<0.5	<0.5	<0.5	<0.5	4	-	<50	<2	<0.5	<0.5	<0.5	
MW-10	02/01/2010	35.53	12.36	23.17	0.00	0.00	<50	<0.5	<0.5	<0.5	<0.5	1	-	<50	<2	<0.5	<0.5	<0.5	
MW-10	08/26/2010	35.53	14.15	21.38	0.00	0.00	<50	<0.5	<0.5	<0.5	<0.5	1	-	<50	<2	<0.5	<0.5	<0.5	
MW-10	11/11/2010 ¹¹	35.53	16.09	19.44	0.00	0.00	-	-	-	-	-	-	-	-	-	-	-	-	
MW-10	02/10/2011 ¹¹	35.53	12.02	23.51	0.00	0.00	<50	<0.5	<0.5	<0.5	<0.5	0.7 J	-	<50	<2	<0.5	<0.5	<0.5	
MW-10	06/17/2011 ¹¹	35.53	-	-	-	-	-	-	-	-	-	-	-	-	-	-	-	-	
MW-10	09/08/2011 ¹¹	35.53	14.31	21.22	0.00	0.00	<50	<0.5	<0.5	<0.5	<0.5	0.5 J	-	<50	-	-	-	-	
MW-10	12/16/2011 ¹¹	35.53	15.41	20.12	0.00	0.00	-	-	-	-	-	-	-	-	-	-	-	-	
MW-10	03/02/2012	35.53	15.28	20.25	0.00	0.00	<50	<0.5	<0.5	<0.5	<0.5	1	-	<50	<2	<0.5	<0.5	<0.5	
MW-10	06/08/2012 ¹¹	35.53	12.84	22.69	0.00	0.00	-	-	-	-	-	-	-	-	-	-	-	-	
MW-10	09/14/2012	35.53	16.63	18.90	0.00	0.00	<50	<0.5	<0.5	1	6	2	-	<50	<2	<0.5	<0.5	<0.5	
MW-10	12/21/2012¹¹	35.53	12.76	22.77	0.00	0.00	-	-	-	-	-	-	-	-	-	-	-	-	
QA	11/21/2001	-	-	-	-	-	<50	<0.50	<0.50	<0.50	<1.5	-	<2.5	-	-	-	-	-	
QA	02/05/2002	-	-	-	-	-	<50	<0.50	<0.50	<0.50	<1.5	-	<2.5	-	-	-	-	-	
QA	04/01/2002	-	-	-	-	-	<50	<0.50	<0.50	<0.50	<1.5	-	<2.5	-	-	-	-	-	
QA	08/05/2002	-	-	-	-	-	<50	<0.50	<0.50	<0.50	<1.5	-	<2.5	-	-	-	-	-	

TABLE 1

**GROUNDWATER MONITORING AND SAMPLING DATA
FORMER CHEVRON SERVICE STATION 93322
7225 BANCROFT AVENUE
OAKLAND, CALIFORNIA**

Location	Date	TOC	DTW	GWE	LNAPLT	LNAPL REMOVED	HYDROCARBONS	PRIMARY VOCS					ADDITIONAL VOCS						
							TPH-GRO	B	T	E	X	MTBE by SW8260	MTBE by VOC	Ethanol	TBA	DIPE	ETBE	TAME	
	Units	ft	ft	ft-amsl	ft	gal	µg/L	µg/L	µg/L	µg/L	µg/L	µg/L	µg/L	µg/L	µg/L	µg/L	µg/L	µg/L	µg/L
QA	10/04/2002	-	-	-	-	-	<50	<0.50	<0.50	<0.50	<1.5	-	<2.5	-	-	-	-	-	-
QA	02/03/2003	-	-	-	-	-	<50	<0.50	<0.50	<0.50	<1.5	-	<2.5	-	-	-	-	-	-
QA	05/02/2003	-	-	-	-	-	<50	<0.5	<0.5	<0.5	<1.5	-	<2.5	-	-	-	-	-	-
QA	08/01/2003 ⁷	-	-	-	-	-	<50	<0.5	<0.5	<0.5	<0.5	<0.5	-	-	-	-	-	-	-
QA	11/21/2003 ⁷	-	-	-	-	-	<50	<0.5	<0.5	<0.5	<0.5	<0.5	-	-	-	-	-	-	-
QA	02/10/2004 ⁷	-	-	-	-	-	<50	<0.5	<0.5	<0.5	<0.5	<0.5	-	-	-	-	-	-	-
QA	05/11/2004 ⁷	-	-	-	-	-	<50	<0.5	<0.5	<0.5	<0.5	<0.5	-	-	-	-	-	-	-
QA	08/10/2004 ⁷	-	-	-	-	-	<50	<0.5	<0.5	<0.5	<0.5	<0.5	-	-	-	-	-	-	-
QA	11/08/2004 ⁷	-	-	-	-	-	<50	<0.5	<0.5	<0.5	<0.5	<0.5	-	-	-	-	-	-	-
QA	02/21/2005 ⁷	-	-	-	-	-	<50	<0.5	<0.5	<0.5	<0.5	<0.5	-	-	-	-	-	-	-
QA	05/10/2005 ⁷	-	-	-	-	-	<50	<0.5	<0.5	<0.5	<0.5	<0.5	-	-	-	-	-	-	-
QA	08/12/2005 ⁷	-	-	-	-	-	<50	<0.5	<0.5	<0.5	<0.5	<0.5	-	-	-	-	-	-	-
QA	11/11/2005 ⁷	-	-	-	-	-	<50	<0.5	<0.5	<0.5	<0.5	<0.5	-	-	-	-	-	-	-
QA	02/20/2006 ⁷	-	-	-	-	-	<50	<0.5	<0.5	<0.5	<0.5	<0.5	-	-	-	-	-	-	-
QA	05/12/2006 ⁷	-	-	-	-	-	<50	<0.5	0.5 ⁹	<0.5	<0.5	<0.5	-	-	-	-	-	-	-
QA	08/14/2006 ⁷	-	-	-	-	-	<50	<0.5	<0.5	<0.5	<0.5	<0.5	-	-	-	-	-	-	-
QA	11/08/2006 ⁷	-	-	-	-	-	<50	<0.5	<0.5	<0.5	<0.5	<0.5	-	-	-	-	-	-	-
QA	02/07/2007 ⁷	-	-	-	-	-	<50	<0.5	<0.5	<0.5	<0.5	<0.5	-	-	-	-	-	-	-
QA	05/07/2007 ⁷	-	-	-	-	-	<50	<0.5	<0.5	<0.5	<0.5	<0.5	-	-	-	-	-	-	-
QA	08/03/2007 ⁷	-	-	-	-	-	<50	<0.5	<0.5	<0.5	<0.5	<0.5	-	-	-	-	-	-	-
QA	10/12/2007 ⁷	-	-	-	-	-	<50	<0.5	<0.5	<0.5	<0.5	<0.5	-	-	-	-	-	-	-
QA	11/02/2007 ⁷	-	-	-	-	-	<50	<0.5	<0.5	<0.5	<0.5	<0.5	-	-	-	-	-	-	-
QA	12/07/2007 ⁷	-	-	-	-	-	<50	<0.5	<0.5	<0.5	<0.5	<0.5	-	-	-	-	-	-	-

TABLE 1

GROUNDWATER MONITORING AND SAMPLING DATA
FORMER CHEVRON SERVICE STATION 93322
7225 BANCROFT AVENUE
OAKLAND, CALIFORNIA

Location	Date	TOC	DTW	GWE	LNAPL	LNAPL REMOVED	HYDROCARBONS	PRIMARY VOCS					ADDITIONAL VOCS						
							TPH-GRO	B	T	E	X	MTBE by SW8260	MTBE by VOC	Ethanol	TBA	DIPE	ETBE	TAME	
	Units	ft	ft	ft-amsl	ft	gal	µg/L	µg/L	µg/L	µg/L	µg/L	µg/L	µg/L	µg/L	µg/L	µg/L	µg/L	µg/L	µg/L
QA	02/01/2008 ⁷	-	-	-	-	-	<50	<0.5	<0.5	<0.5	<0.5	<0.5	-	-	-	-	-	-	-
QA	05/09/2008 ⁷	-	-	-	-	-	<50	<0.5	<0.5	<0.5	<0.5	<0.5	-	-	-	-	-	-	-
QA	05/16/2008 ⁷	-	-	-	-	-	<50	<0.5	<0.5	<0.5	<0.5	<0.5	-	-	-	-	-	-	-
QA	08/22/2008 ⁷	-	-	-	-	-	<50	<0.5	<0.5	<0.5	<0.5	<0.5	-	-	-	-	-	-	-
QA	11/26/2008 ⁷	-	-	-	-	-	<50	<0.5	<0.5	<0.5	<0.5	<0.5	-	-	-	-	-	-	-
QA	05/20/2009	-	-	-	-	-	<50	<0.5	<0.5	<0.5	<0.5	<0.5	-	-	-	-	-	-	-
QA	08/26/2009	-	-	-	-	-	<50	<0.5	<0.5	<0.5	<0.5	<0.5	-	-	-	-	-	-	-
QA	11/12/2009	-	-	-	-	-	<50	<0.5	<0.5	<0.5	<0.5	<0.5	-	-	-	-	-	-	-
QA	02/01/2010	-	-	-	-	-	<50	<0.5	<0.5	<0.5	<0.5	<0.5	-	<50	-	-	-	-	-
QA	05/17/2010	-	-	-	-	-	<50	<0.5	<0.5	<0.5	<0.5	<0.5	-	-	-	-	-	-	-
QA	08/26/2010	-	-	-	-	-	<50	<0.5	<0.5	<0.5	<0.5	<0.5	-	-	-	-	-	-	-
QA	11/11/2010	-	-	-	-	-	<50	<0.5	<0.5	<0.5	<0.5	<0.5	-	-	-	-	-	-	-
QA	02/10/2011	-	-	-	-	-	<50	<0.5	<0.5	<0.5	<0.5	<0.5	-	-	-	-	-	-	-
QA	06/17/2011	-	-	-	-	-	<50	<0.5	<0.5	<0.5	<0.5	<0.5	-	-	-	-	-	-	-
QA	09/08/2011	-	-	-	-	-	<50	<0.5	<0.5	<0.5	<0.5	<0.5	-	<50	-	-	-	-	-
QA	12/16/2011	-	-	-	-	-	<50	<0.5	<0.5	<0.5	<0.5	<0.5	-	-	-	-	-	-	-
QA	03/02/2012	-	-	-	-	-	<50	<0.5	<0.5	<0.5	<0.5	<0.5	-	-	-	-	-	-	-
QA	06/08/2012	-	-	-	-	-	<50	<0.5	<0.5	<0.5	<0.5	<0.5	-	-	-	-	-	-	-
QA	09/14/2012	-	-	-	-	-	<50	<0.5	<0.5	<0.5	<0.5	<0.5	-	-	-	-	-	-	-
QA	12/21/2012	-	-	-	-	-	<50	<0.5	<0.5	<0.5	<0.5	<0.5	-	-	-	-	-	-	-
TRIP BLANK	02/08/1998	-	-	-	-	-	<50	<0.5	<0.5	<0.5	<0.5	-	<2.5	-	-	-	-	-	-
TRIP BLANK	06/16/1998	-	-	-	-	-	<50	<0.5	<0.5	<0.5	<0.5	-	<2.5	-	-	-	-	-	-

TABLE 1

GROUNDWATER MONITORING AND SAMPLING DATA
 FORMER CHEVRON SERVICE STATION 93322
 7225 BANCROFT AVENUE
 OAKLAND, CALIFORNIA

Location	Date	TOC	DTW	GWE	LNAPL	LNAPL REMOVED	HYDROCARBONS	PRIMARY VOCS					ADDITIONAL VOCS						
							TPH-GRO	B	T	E	X	MTBE by SW8260	MTBE by VOC	Ethanol	TBA	DIPE	ETBE	TAME	
	Units	ft	ft	ft-amsl	ft	gal	µg/L	µg/L	µg/L	µg/L	µg/L	µg/L	µg/L	µg/L	µg/L	µg/L	µg/L	µg/L	µg/L
TRIP BLANK	07/29/1998	-	-	-	-	-	<50	<0.5	<0.5	<0.5	<0.5	-	<2.5	-	-	-	-	-	-
TRIP BLANK	08/13/1998	-	-	-	-	-	<50	<0.5	<0.5	<0.5	<0.5	-	<2.5	-	-	-	-	-	-
TRIP BLANK	11/24/1998	-	-	-	-	-	<50	<0.5	<0.5	<0.5	<0.5	-	<2.5	-	-	-	-	-	-
TRIP BLANK	02/02/1999	-	-	-	-	-	<50	<0.5	<0.5	<0.5	<0.5	-	<2.5	-	-	-	-	-	-
TRIP BLANK	02/03/1999	-	-	-	-	-	<50	<0.5	<0.5	<0.5	<0.5	-	<2.5	-	-	-	-	-	-
TRIP BLANK	06/07/1999	-	-	-	-	-	<50	<0.5	<0.5	<0.5	<0.5	-	<2.5	-	-	-	-	-	-
TRIP BLANK	09/07/1999	-	-	-	-	-	<50	<0.5	<0.5	<0.5	<0.5	-	<5.0	-	-	-	-	-	-
TRIP BLANK	10/27/1999	-	-	-	-	-	<50	<0.5	<0.5	<0.5	<0.5	-	<2.5	-	-	-	-	-	-
TRIP BLANK	02/08/2000	-	-	-	-	-	<50	<0.5	<0.5	<0.5	<0.5	-	<5.0	-	-	-	-	-	-
TRIP BLANK	05/05/2000	-	-	-	-	-	<50	<0.50	<0.50	<0.50	<0.50	-	<2.5	-	-	-	-	-	-
TRIP BLANK	07/28/2000	-	-	-	-	-	<50	<0.50	<0.50	<0.50	<0.50	-	<2.5	-	-	-	-	-	-
TRIP BLANK	11/26/2000	-	-	-	-	-	<50	<0.50	<0.50	<0.50	<0.50	-	<2.5	-	-	-	-	-	-
TRIP BLANK	02/09/2001	-	-	-	-	-	<50.0	<0.500	<0.500	<0.500	<0.500	-	<2.50	-	-	-	-	-	-
TRIP BLANK	05/11/2001	-	-	-	-	-	<50	<0.50	<0.50	<0.50	<0.50	-	<2.5	-	-	-	-	-	-
TRIP BLANK	08/30/2001	-	-	-	-	-	<50	<0.50	<0.50	<0.50	<0.50	-	<2.5	-	-	-	-	-	-

Abbreviations and Notes:

TOC = Top of casing

DTW = Depth to water

GWE = Groundwater elevation

(ft-amsl) = Feet above mean sea level

ft = Feet

µg/L = Micrograms per liter

**GROUNDWATER MONITORING AND SAMPLING DATA
FORMER CHEVRON SERVICE STATION 93322
7225 BANCROFT AVENUE
OAKLAND, CALIFORNIA**

Location	Date	TOC	DTW	GWE	LNAPLT	LNAPL REMOVED	HYDROCARBONS	PRIMARY VOCS					ADDITIONAL VOCS					
							TPH-GRO	B	T	E	X	MTBE by SW8260	MTBE by VOC	Ethanol	TBA	DIPE	ETBE	TAME
Units		ft	ft	ft-amsl	ft	gal	µg/L	µg/L	µg/L	µg/L	µg/L	µg/L	µg/L	µg/L	µg/L	µg/L	µg/L	µg/L

TPH-GRO = Total petroleum hydrocarbons - gasoline range organics

VOCS = Volatile organic compounds

B = Benzene

T = Toluene

E = Ethylbenzene

X = Xylenes (Total)

MTBE = Methyl tert butyl ether

TBA = Tert-butyl alcohol

DIPE = Diisopropyl ether

ETBE = Tert-butyl ethyl ether

TAME = Tert-amyl methyl ether

J = Estimated concentration

-- = Not available / not applicable

<x = Not detected above laboratory method detection limit

* TOC elevations were re-surveyed on May 31, 2005, by Morrow Surveying Land Surveyors using the previous benchmark. TOC elevations were surveyed in April 2002, by Morrow Surveying. Ele based on City of Oakland Benchmark designated 3787 in field book 1595, page 50; cut square northerly curb on Krause Ave., approx. 37 feet westerly of PL westerly of 73rd Ave., (Elevation = 33.82

** GWE corrected for the presence of LNAPL; correction factor: [(TOC - DTW) + (LNAPLT x 0.8)].

1 Confirmation run.

2 Laboratory report indicates gasoline C6-C12.

3 Laboratory report indicates weathered gasoline C6-C12.

4 Product and water removed.

5 MTBE by EPA Method 8260.

6 Well development performed.

**GROUNDWATER MONITORING AND SAMPLING DATA
FORMER CHEVRON SERVICE STATION 93322
7225 BANCROFT AVENUE
OAKLAND, CALIFORNIA**

Location	Date	TOC	DTW	GWE	LNAPLT	LNAPL REMOVED	HYDROCARBONS	PRIMARY VOCS					ADDITIONAL VOCS					
							TPH-GRO	B	T	E	X	MTBE by SW8260	MTBE by VOC	Ethanol	TBA	DIPE	ETBE	TAME
Units	ft	ft	ft-amsl	ft	gal	μg/L	μg/L	μg/L	μg/L	μg/L	μg/L	μg/L	μg/L	μg/L	μg/L	μg/L	μg/L	μg/L

- 7 BTEX and MTBE by EPA Method 8260.
- 8 Laboratory report indicates the trip blank results were investigated and the source of contamination did not occur during analysis.
- 9 Product removed; no water removed.
- 10 Laboratory report indicates the value for the TPH-GRO is estimated because the value is over the calibration range of the system. The surrogate recovery is outside the upper statistical QC limit. The sample was not reanalyzed because the hold time had ex
- 11 Sampled semi-annually.
- 12 Unable to access well due to large donation bin located on well.
- 13 Guaged only.

ATTACHMENT A

MONITORING DATA PACKAGE



January 6, 2013

Chevron Environmental Management Company
Catalina Devine
6111 Bollinger Canyon Rd.
San Ramon, CA 94583

Fourth Quarter 2012 Monitoring at
Chevron Service Station 93322
7225 Bancroft Ave.
Oakland, CA

Monitoring performed on December 21, 2012

Blaine Tech Services, Inc. Groundwater Monitoring Event 121221-DR2

This submission covers the routine monitoring of groundwater wells conducted on December 21, 2012 at this location. Ten monitoring wells were measured for depth to groundwater (DTW). Seven monitoring wells were sampled. All sampling activities were performed in accordance with local, state and federal guidelines.

Water levels measurements were collected using an electronic slope indicator. All sampled wells were purged of three case volumes, depending on well recovery, or until water temperature, pH and conductivity stabilized. Purging was accomplished using electric submersible pumps, positive air displacement pumps, or stainless steel, Teflon, or disposable bailers. Subsequent sample collection and sample handling was performed in accordance with EPA protocols. Alternately, where applicable, wells were sampled utilizing no-purge methodology. All reused equipment was decontaminated in an integrated stainless steel sink with de-ionized water supplied Hotsy pressure washer and Liquinox or equivalent.

Fourth Quarter Groundwater Monitoring at Chevron 93322, 7225 Bancroft Ave., Oakland, CA

SAN JOSE

SACRAMENTO

LOS ANGELES

SAN DIEGO

1680 ROGERS AVENUE

SAN JOSE, CA 95112-1105

(408) 573-0555

FAX (408) 573-7771

LIC: 746684

www.blainetech.com

Samples were delivered under chain-of-custody to Lancaster Laboratories of Lancaster, Pennsylvania, for analysis. Monitoring well purgewater and equipment rinsate water was collected and transported under bill-of-lading to Blaine Tech of San Jose, California.

Enclosed documentation from this event includes copies of the Well Gauging Sheet, Well Monitoring Data Sheets, and Chain-of-Custody.

Blaine Tech Services, Inc.'s activities at this site consisted of objective data and sample collection only. No interpretation of analytical results, defining of hydrogeologic conditions or formulation of recommendations was performed.

Please call if you have any questions.

Sincerely,



Dustin Becker
Blaine Tech Services, Inc.
Senior Project Manager

attachments: SOP
Well Gauging Sheet
Individual Well Monitoring Data Sheets
Chain of Custody
Wellhead Inspection Form
Bill of Lading
Calibration Log

cc: CRA
Attn: Nathan Lee
5900 Hollis St. Suite A
Emeryville, CA 94608

Fourth Quarter Groundwater Monitoring at Chevron 93322, 7225 Bancroft Ave., Oakland, CA

SAN JOSE

SACRAMENTO

LOS ANGELES

SAN DIEGO

1680 ROGERS AVENUE

SAN JOSE, CA 95112-1105

(408) 573-0555

FAX (408) 573-7771

LIC: 746684

www.blainetech.com

BLAINE TECH SERVICES, INC. METHODS AND PROCEDURES FOR THE ROUTINE MONITORING OF GROUNDWATER WELLS AT CHEVRON SITES

Blaine Tech Services, Inc. performs environmental sampling and documentation as an independent third party. We specialize in groundwater monitoring assignments and intentionally limit the scope of our services to those centered on the generation of objective information.

To avoid conflicts of interest, Blaine Tech Services, Inc. personnel do not evaluate or interpret the information we collect. As a state licensed contractor (C-57 well drilling –water – 746684) performing strictly technical services, we do not make any professional recommendations and perform no consulting of any kind.

SAMPLING PROCEDURES OVERVIEW

SAFETY

All groundwater monitoring assignments performed for Chevron comply with Chevron's safety guidelines, 29 CFR 1910.120 and SB-198 Injury and Illness Prevention Program (IIPP). All Field Technicians receive the full 40-hour 29CFR 1910.120 OSHA SARA HAZWOPER course, medical clearance and on-the-job training prior to commencing any work on any Chevron site.

INSPECTION AND GAUGING

Wells are inspected prior to evacuation and sampling. The condition of the wellhead is checked and noted according to a wellhead inspection checklist.

Standard measurements include the depth to water (DTW) and the total well depth (TD) obtained with industry standard electronic water level indicators that are graduated in increments of hundredths of a foot.

The water in each well is inspected for the presence of immiscibles. When free product is suspected, its presence is confirmed using an electronic interface probe (e.g. GeoTech). No samples are collected from a well containing product.

TRADITIONAL PURGING & SAMPLING

Evacuation

Depth to water measurements are collected by our personnel prior to purging and minimum purge volumes are calculated anew for each well based on the height of the water column and the diameter of the well. Expected purge volumes are never less than three case volumes and are set at no less than four case volumes in some jurisdictions.

Well purging devices are selected on the basis of the well diameter and the total volume to be evacuated. In most cases the well will be purged using an electric submersible pump (i.e. Grundfos) suspended near (but not touching) the bottom of the well.

Parameter Stabilization

Well purging completion standards include minimum purge volumes, but additionally require stabilization of specific groundwater parameters prior to sample collection. Typical groundwater parameters used to measure stability are electrical conductivity, pH, and temperature. Instrument readings are obtained at regular intervals during the evacuation process (no less than once per case volume).

Stabilization standards for routine quarterly monitoring of fuel sites include the following: Temperature is considered to have stabilized when successive readings do not fluctuate more than +/- 1 degree Celsius. Electrical conductivity is considered stable when successive readings are within 10%. pH is considered to be stable when successive readings remain constant or vary no more than 0.2 of a pH unit.

Sample Collection

All samples are collected using disposable bailers.

Sample Containers

Sample material is decanted directly from the sampling bailer into sample containers provided by the laboratory that will analyze the samples. The transfer of sample material from the bailer to the sample container conforms to specifications contained in the USEPA T.E.G.D. The type of sample container, material of construction, method of closure and filling requirements are specific to the intended analysis. Chemicals needed to preserve the sample material are commonly placed inside the sample containers by the laboratory or glassware vendor prior to delivery of the bottle to our personnel. The laboratory sets the number of replicate containers.

Dewatered Wells

Normal evacuation removes no less than three case volumes of water from the well. However, less water may be removed in cases where the well dewateres and does not immediately recharge.

Measuring Recharge

Upon completion of well purging, a depth to water measurement is collected and notated to ensure that the well has recharged to within 80% of its static, pre-purge level prior to sampling.

Wells that do not immediately show 80% recharge or dewatered wells will be allowed approximately 2 hours to recharge prior to sampling or will be sampled at site departure. All wells requiring off-site traffic control in the public right-of-way, the 80% recharge rule may be disregarded in the interests of Health and Safety. The sample may be collected as soon as there is sufficient water. The water level at time of sampling will be noted.

Dissolved Oxygen Measurements

Dissolved Oxygen readings are taken pre- and/or post-purge using YSI meters (e.g. YSI Model 550) or HACH field test kits.

The YSI meters are able to collect accurate in-situ readings. The probe allows downhole measurements to be taken from wells with diameters as small as two inches. The probe and reel is decontaminated between wells as described above. The meter is calibrated

as per the instructions in the operating manual. The probe is lowered into the water column and the reading is allowed to stabilize prior to collection.

Oxidation Reduction Potential Measurements (ORP)

All readings are obtained with either Corning or Myron-L meters (e.g. Corning ORP-65 or a Myron-L Ultrameter). The meter is cleaned between wells as described above. The meter is calibrated at the start of each day according to the instruction manual.

LOW FLOW SAMPLING USING SAMPLE-PRO BLADDER PUMP

Calibration

Calibrate YSI Flow Cell as per manufacturer's specifications. Thoroughly rinse probe and cup between parameters. Calibration order as follows:

1. pH (use 3-point calibration of 7, 4, 10)
2. Oxygen Reduction Potential (ORP)
3. Specific Conductance
4. Dissolved Oxygen (DO) (calibrate simulating 100% oxygen saturation)

Purging & Sampling Collection

1. Insert new bladder into Sample-Pro pump housing.
2. Remove dedicated PE tubing from the well or start with new PE tubing cut to the required length.
3. Attach the PE tubing to the Sample-Pro Bladder Pump.
4. Gently lower the Sample-Pro Bladder Pump, and PE tubing into the well, placing the Sample-Pro Bladder Pump intake at the center of the screened interval. Take care to minimize disturbance to the water column.
5. Direct effluent line into YSI 556 Flow Cell.
6. Set Sample-Pro Bladder Pump speed at 100 - 500 ml/min.
7. Collect water quality parameter measurements for temperature, pH, conductivity, turbidity, DO and ORP every 3-5 minutes.
8. Monitor drawdown during purging with electronic water level meter. Record water level with each parameter measurement. **MAXIMUM DRAWDOWN IS 0.33 FEET.**
9. Collect parameter measurements until stability is achieved. Stability is defined as three consecutive measurements where:

Temp	± 1 ° Celsius
pH	± 0.1
Conductivity	± 3%
Turbidity	± 10% NTU
DO	± 0.3 mg/l
ORP	± 10 Mv

10. Sample may be collected once stability is achieved and at least one system volume of water removed from the well.
11. Disconnect effluent line from YSI 556 Flow Cell.
12. Sample through effluent line while maintaining constant flow rate.
13. Remove Sample-Pro Bladder Pump, and PE tubing from well.
14. Detach and reinstall dedicated PE tubing in well.

PURGEWATER CONTAINMENT

All non-hazardous purgewater evacuated from each groundwater monitoring well is captured and contained in on-board storage tanks on the Sampling Vehicle and/or special water hauling trailers. Effluent from the decontamination of reusable apparatus (sounders, electric pumps and hoses etc.), consisting of groundwater combined with deionized water and non-phosphate soap, is also captured and pumped into effluent tanks.

Non-hazardous purgewater is transported under standard Bill of Lading or Non-Hazardous Waste Manifest to a Blaine Tech Services, Inc. facility before being transported to a Chevron approved disposal facility

TRIP BLANKS

Trip Blanks, if requested, are taken to the site and kept inside the sample cooler for the duration of the event. They are turned over to the laboratory for analysis with the samples from that site.

DUPLICATES

Duplicates, if requested, may be collected at a site.

SAMPLE STORAGE

All sample containers are promptly placed in food grade ice chests for storage in the field and transport (direct or via our facility) to the designated analytical laboratory. These ice chests contain quantities of restaurant grade ice as a refrigerant material. The samples are maintained in either an ice chest or a refrigerator until relinquished into the custody of the laboratory or laboratory courier.

DOCUMENTATION CONVENTIONS

A label must be affixed to all sample containers. In most cases these labels are generated by our office personnel and are partially preprinted. Labels can also be hand written by our field personnel. The site is identified with the store number and site address, as is the particular groundwater well from which the sample is drawn (e.g. MW-1, MW-2, S-1 etc.). The time and date of sample collection along with the initials of the person who collects the sample are handwritten onto the label. Field documentation is contemporaneous.

DECONTAMINATION

All equipment is brought to the site in clean and serviceable condition and is cleaned after use in each well and before subsequent use in any other well. Equipment such as hose reels, pumps and bailers is decontaminated before leaving the site.

The primary decontamination device is a commercial steam cleaner. The steam cleaner is de-tuned to function as a hot pressure washer that is then operated with high quality deionized water that is produced at our facility and stored onboard our sampling vehicle. Cleaning is

facilitated by the use of proprietary fixtures and devices included in the patented workstation (U.S. Patent 5,535,775) that is incorporated in each sampling vehicle.

Any sensitive equipment or parts (i.e. Dissolved Oxygen sensor membrane, water level indicator, etc.) that cannot be washed using the high pressure water, will be sprayed with a non-phosphate soap and deionized water solution and rinsed with deionized water.

FERROUS IRON MEASUREMENTS

All field measurements are collected at time of sampling with a HACH test kit.

WELL GAUGING DATA

Project # 121221-3A2 Date 12/21/12 Client Chassis # 9-3322

Site 7225 Benicoff Ave. Oakland Ca.

Well ID	Time	Well Size (in.)	Sheen / Odor	Depth to Immiscible Liquid (ft.)	Thickness of Immiscible Liquid (ft.)	Volume of Immiscibles Removed (ml)	Depth to water (ft.)	Depth to well bottom (ft.)	Survey Point: TOB or TOC	Notes
MW-1	1044	2		—			13.61	32.92	↓	
MW-2	1049	2				8.52	29.78			
MW-3	1055	2				13.32	32.47			
MW-4	1014	2				13.33	30.00			
MW-5	1027	2				14.62	31.36			
MW-6	1022	2				13.88	31.65			
MW-7	1038	3/4				12.19	24.45			
MW-8	1033	2				12.11	29.66			
MW-9	1013	2				12.06	29.85			
MW-10	1017	2				12.76	29.58			

CHEVRON WELL MONITORING DATA SHEET

Project #: 121221-DR2	Station #: 9-3322
Sampler: DR	Date: 12/21/12
Weather: Cold	Ambient Air Temperature: 50°F
Well I.D.: MW-1	Well Diameter: (2) 3 4 6 8
Total Well Depth: 32.92	Depth to Water: 13.61
Depth to Free Product:	Thickness of Free Product (feet):
Referenced to: (PVE) Grade	D.O. Meter (if req'd): YSI HACH
DTW with 80% Recharge [(Height of Water Column x 0.20) + DTW]: 17.47	

Purge Method:

- Bailer
- Disposable Bailer
- Positive Air Displacement
- Electric Submersible
- Waterra
- Peristaltic
- Extraction Pump
- Other _____

Sampling Method:

- Bailer
- Disposable Bailer
- Extraction Port
- Dedicated Tubing
- Other: _____

3.1	(Gals.) X	3	=	9.3	Gals.
I Case Volume		Specified Volumes		Calculated Volume	

Well Diameter	Multiplier	Well Diameter	Multiplier
1"	0.04	4"	0.65
2"	0.16	6"	1.47
3"	0.37	Other	radius ² * 0.163

Time	Temp (°F)	pH	Cond. (mS or μS)	Turbidity (NTUs)	Gals. Removed	Observations
1305	63.3	6.92	1065	71000	3.1	strong odor
1309	66.0	6.65	1105	>1000	6.2	" "
1312	66.1	6.67	1107	>1000	9.3	" "

Did well dewater? Yes No Gallons actually evacuated: 9.3

Sampling Date: 12/21/12 Sampling Time: 1317 Depth to Water: 15.92

Sample I.D.: MW-1 Laboratory: Lancaster Other _____

Analyzed for: TPH-G BTEX MTBE OXYS Other: See Lab

Duplicate I.D.: Analyzed for: TPH-G BTEX MTBE OXYS Other:

D.O. (if req'd):	Pre-purge:	mg/L	Post-purge:	mg/L
	O.R.P. (if req'd):	Pre-purge:	mV	Post-purge:

CHEVRON WELL MONITORING DATA SHEET

Project #: 121221-DRI	Station #: 9-3322
Sampler: BW	Date: 12/21/12
Weather: Rain	Ambient Air Temperature: 52°F
Well I.D.: MW-2	Well Diameter: (2) 3 4 6 8
Total Well Depth: 29.78	Depth to Water: 8.52
Depth to Free Product:	Thickness of Free Product (feet):
Referenced to: (PVC) Grade	D.O. Meter (if req'd): YSI HACH
DTW with 80% Recharge [(Height of Water Column x 0.20) + DTW]: 12.77	

Purge Method:

- Bailer
- Disposable Bailer
- Positive Air Displacement
- Electric Submersible
- Waterra
- Peristaltic
- Extraction Pump
- Other _____

Sampling Method:

- Bailer
- Disposable Bailer
- Extraction Port
- Dedicated Tubing
- Other: _____

3.4	(Gals.) X	3	=	10.2	Gals.
1 Case Volume		Specified Volumes		Calculated Volume	

Well Diameter	Multiplier	Well Diameter	Multiplier
1"	0.04	4"	0.65
2"	0.16	6"	1.47
3"	0.37	Other	radius ² * 0.163

Time	Temp (°F)	pH	Cond. (mS or μS)	Turbidity (NTUs)	Gals. Removed	Observations
1310	66.5	6.81	400	71000	3.5	
1318	68.9	7.03	397	71000	7.0	
1325	67.9	7.11	392	71000	10.5	

Did well dewater? Yes No Gallons actually evacuated: 10.5

Sampling Date: 12/21/12 Sampling Time: 1330 Depth to Water: 10.32

Sample I.D.: MW-2 Laboratory: (Lancaster) Other _____

Analyzed for: TPH-G BTEX MTBE OXYS Other: See COC

Duplicate I.D.: Analyzed for: TPH-G BTEX MTBE OXYS Other:

D.O. (if req'd):	Pre-purge:	mg/L	Post-purge:	mg/L
------------------	------------	------	-------------	------

O.R.P. (if req'd):	Pre-purge:	mV	Post-purge:	mV
--------------------	------------	----	-------------	----

CHEVRON WELL MONITORING DATA SHEET

Project #: 121221-DK2	Station #: 9-3322
Sampler: Dk	Date: 12/21/12
Weather: Cloudy	Ambient Air Temperature: 50°F
Well I.D.: MW-4	Well Diameter: ② 3 4 6 8 _____
Total Well Depth: 30.00	Depth to Water: 17.33
Depth to Free Product:	Thickness of Free Product (feet):
Referenced to: PVC Grade	D.O. Meter (if req'd): YSI HACH
DTW with 80% Recharge [(Height of Water Column x 0.20) + DTW]: 11.66	

Purge Method:

- Bailer
- Disposable Bailer
- Positive Air Displacement
- Electric Submersible
- Waterra
- Peristaltic
- Extraction Pump
- Other _____

Sampling Method:

- Bailer
- Disposable Bailer
- Extraction Port
- Dedicated Tubing
- Other: _____

2.7 (Gals.) X 3 = 8.1 Gals.
 1 Case Volume Specified Volumes Calculated Volume

Well Diameter	Multiplier	Well Diameter	Multiplier
1"	0.04	4"	0.65
2"	0.16	6"	1.47
3"	0.37	Other	radius ² * 0.163

Time	Temp (°F)	pH	Cond. (mS or μ S)	Turbidity (NTUs)	Gals. Removed	Observations
1132	66.4	6.91	499	>1000	2.7	
1135	67.2	6.98	457	>1000	5.4	
1138	67.3	6.99	455	>1000	8.1	

Did well dewater? Yes No Gallons actually evacuated: 8.1

Sampling Date: 12/21/12 Sampling Time: 1142 Depth to Water: 15.42

Sample I.D.: MW-4 Laboratory: Lancaster Other _____

Analyzed for: TPH-G BTEX MTBE OXYS Other: See Col

~~Duplicate~~ I.D.: QA @ 1000 Analyzed for: TPH-G BTEX MTBE OXYS Other: See Col

D.O. (if req'd): Pre-purge: _____ mg/L Post-purge: _____ mg/L

O.R.P. (if req'd): Pre-purge: _____ mV Post-purge: _____ mV

CHEVRON WELL MONITORING DATA SHEET

Project #: 121221-DRI	Station #: 9-3322
Sampler: BW	Date: 12/21/12
Weather: Rain	Ambient Air Temperature: 52°F
Well I.D.: MW-5	Well Diameter: (2) 3 4 6 8
Total Well Depth: 31.36	Depth to Water: 14.62
Depth to Free Product:	Thickness of Free Product (feet):
Referenced to: PVC Grade	D.O. Meter (if req'd): YSI HACH
DTW with 80% Recharge [(Height of Water Column x 0.20) + DTW]: 17.97	

Purge Method:

- Bailer
- Disposable Bailer
- Positive Air Displacement
- Electric Submersible
- Waterra
- Peristaltic
- Extraction Pump
- Other _____

Sampling Method:

- Bailer
- Disposable Bailer
- Extraction Port
- Dedicated Tubing
- Other: _____

2.7	(Gals.) X	3	=	8.1	Gals.
I Case Volume		Specified Volumes		Calculated Volume	

Well Diameter	Multiplier	Well Diameter	Multiplier
1"	0.04	4"	0.65
2"	0.16	6"	1.47
3"	0.37	Other	radius ² * 0.163

Time	Temp (°F)	pH	Cond. (mS or μS)	Turbidity (NTUs)	Gals. Removed	Observations
1132	65.0	6.47	555	21000	3.0	
1136	64.1	6.88	522	71000	6.0	
1142	62.4	7.01	516	71000	8.5	

Did well dewater? Yes No Gallons actually evacuated: 8.5

Sampling Date: 12/21/12 Sampling Time: 1150 Depth to Water: 15.12'

Sample I.D.: MW-5 Laboratory: Lancaster Other _____

Analyzed for: TPH-G BTEX MTBE OXYS Other: See COC

Duplicate I.D.: Analyzed for: TPH-G BTEX MTBE OXYS Other:

D.O. (if req'd):	Pre-purge:	mg/l	Post-purge:	mg/l
O.R.P. (if req'd):	Pre-purge:	mV	Post-purge:	mV

CHEVRON WELL MONITORING DATA SHEET

Project #: 121221-DRI	Station #: 9-3322
Sampler: BW	Date: 12/21/12
Weather: Rain	Ambient Air Temperature: 52°F
Well I.D.: MW-6	Well Diameter: (2) 3 4 6 8
Total Well Depth: 31.65	Depth to Water: 13.88
Depth to Free Product:	Thickness of Free Product (feet):
Referenced to: PVC Grade	D.O. Meter (if req'd): YSI HACH
DTW with 80% Recharge [(Height of Water Column x 0.20) + DTW]: 17.43	

Purge Method:

- Bailer
 Disposable Bailer
 Positive Air Displacement
 Electric Submersible

- Waterra
 Peristaltic
 Extraction Pump
 Other _____

Sampling Method:

- Bailer
 Disposable Bailer
 Extraction Port
 Dedicated Tubing
 Other: _____

2.8	(Gals.) X	3	=	8.4	Gals.
1 Case Volume		Specified Volumes		Calculated Volume	

Well Diameter	Multiplier	Well Diameter	Multiplier
1"	0.04	4"	0.65
2"	0.16	6"	1.47
3"	0.37	Other	radius ² * 0.163

Time	Temp (°F)	pH	Cond. (mS or μS)	Turbidity (NTUs)	Gals. Removed	Observations
1205	63.3	6.65	1055	281	3.0	
1210	64.6	6.56	1097	352	6.0	
1215	61.6	6.89	1120	306	8.5	

Did well dewater? Yes No Gallons actually evacuated: 8.5

Sampling Date: 12/21/12 Sampling Time: 1220 Depth to Water: 14.56'

Sample I.D.: MW-6 Laboratory: Lancaster Other _____

Analyzed for: TPH-G BTEX MTBE OXYS Other: See LOC

Duplicate I.D.: Analyzed for: TPH-G BTEX MTBE OXYS Other:

D.O. (if req'd):	Pre-purge:	mg/L	Post-purge:	mg/L
O.R.P. (if req'd):	Pre-purge:	mV	Post-purge:	mV

CHEVRON WELL MONITORING DATA SHEET

Project #: 12121-D12	Station #: 9-3322
Sampler: DR	Date: 12/21/12
Weather: Cloudy	Ambient Air Temperature: 50°F
Well I.D.: MW-7	Well Diameter: 3 4 6 8 3/4
Total Well Depth: 24.45	Depth to Water: 12.19
Depth to Free Product:	Thickness of Free Product (feet):
Referenced to: PVC Grade	D.O. Meter (if req'd): YSI HACH
DTW with 80% Recharge [(Height of Water Column x 0.20) + DTW]: 14.64	

Purge Method:

- Bailer
- Disposable Bailer
- Positive Air Displacement
- Electric Submersible
- Waterra
- Peristaltic
- Extraction Pump
- Other: New Tubing w/ check valve

Sampling Method:

- Bailer
- Disposable Bailer
- Extraction Port
- Dedicated Tubing
- Other: New Tubing w/ check valve

0.2	(Gals.) X	3	=	0.6	Gals.
I Case Volume		Specified Volumes		Calculated Volume	

Well Diameter	Multiplier	Well Diameter	Multiplier
1"	0.04	4"	0.65
2"	0.16	6"	1.47
3"	0.37	Other	radius ² * 0.163

$3/4" = 0.02$

Time	Temp (°F)	pH	Cond. (mS or μ S)	Turbidity (NTUs)	Gals. Removed	Observations
1234	64.7	6.85	1405	574	0.2	
1235	66.1	6.63	1391	7100	0.4	
1236	66.1	6.64	1388	7100	0.6	

Did well dewater? Yes No Gallons actually evacuated: 0.6

Sampling Date: 12/21/12 Sampling Time: 1240 Depth to Water: 14.29

Sample I.D.: MW-7 Laboratory: Lancaster Other _____

Analyzed for: TPH-G BTEX MTBE OXYS Other: Seal

Duplicate I.D.: Analyzed for: TPH-G BTEX MTBE OXYS Other:

D.O. (if req'd): Pre-purge: mg/L Post-purge: mg/L

O.R.P. (if req'd): Pre-purge: mV Post-purge: mV

CHEVRON WELL MONITORING DATA SHEET

Project #: 121221-MZ	Station #: 9-3322
Sampler: MZ	Date: 12/21/12
Weather: Rain	Ambient Air Temperature: 50°F
Well I.D.: MW-8	Well Diameter: ② 3 4 6 8 _____
Total Well Depth: 29.66	Depth to Water: 12.11
Depth to Free Product:	Thickness of Free Product (feet):
Referenced to: <u>PVC</u> Grade	D.O. Meter (if req'd): YSI HACH
DTW with 80% Recharge [(Height of Water Column x 0.20) + DTW]: 15.62	

Purge Method:

- Bailer
 Disposable Bailer
 Positive Air Displacement
 Electric Submersible
- Waterra
 Peristaltic
 Extraction Pump
 Other _____

Sampling Method:

- Bailer
 Disposable Bailer
 Extraction Port
 Dedicated Tubing
 Other: _____

7.8	(Gals.) X	3	=	8.4	Gals.
1 Case Volume		Specified Volumes		Calculated Volume	

Well Diameter	Multiplier	Well Diameter	Multiplier
1"	0.04	4"	0.65
2"	0.16	6"	1.47
3"	0.37	Other	radius ² * 0.163

Time	Temp (°F)	pH	Cond. (mS or μ S)	Turbidity (NTUs)	Gals. Removed	Observations
1209	67.6	6.94	579	>1000	2.8	
1212	67.9	6.81	573	>1000	5.6	
1215	67.9	6.80	571	>1000	8.4	

Did well dewater? Yes No Gallons actually evacuated: 8.4

Sampling Date: 12/21/12 Sampling Time: 1220 Depth to Water: 14.74

Sample I.D.: MW-8 Laboratory: Lancaster Other _____

Analyzed for: TPH-G BTEX MTBE OXYS Other: See Col

Duplicate I.D.: Analyzed for: TPH-G BTEX MTBE OXYS Other:

D.O. (if req'd): Pre-purge: _____ mg/L Post-purge: _____ mg/L

O.R.P. (if req'd): Pre-purge: _____ mV Post-purge: _____ mV

CHAIN OF CUSTODY FORM

Chevron Environmental Management Company ■ 6111 Bollinger Canyon Rd. ■ San Ramon, CA 94583

COC / of /

Chevron Site Number: 93322
 Chevron Site Global ID: T0600102079
 Chevron Site Address: 7225 Bancroft Ave.
Oakland, CA
 Chevron PM: ~~DAVE PATTEN~~ CATALINA DEVINE
 Chevron PM Phone No.: (925)543-1740
 Retail and Terminal Business Unit (RTBU) Job
 Construction/Retail Job

Chevron Consultant: CRA
 Address: 5900 Hollis St. Suite A Emeryville,
 CA Consultant Contact: Nathan Lee
 Consultant Phone No. 510-420-3333
 Consultant Project No. 121221-DK1
 Sampling Company: Blaine Tech Services
 Sampled By (Print): Devin Reynard
 Sampler Signature: [Signature]

ANALYSES REQUIRED										
<input checked="" type="checkbox"/>	<input checked="" type="checkbox"/>									Preservation Codes H = HCL T = Thiosulfate N = HNO ₃ B = NaOH S = H ₂ SO ₄ O = Other
										Special Instructions Must meet lowest detection limits possible for 8260 Compounds

Charge Code: NWRTB-0093322-0-OML
 NWRTB 00SITE NUMBER-0- WBS
(WBS ELEMENTS:
 SITE ASSESSMENT: A1L REMEDIATION IMPLEMENTATION: R5L
 SITE MONITORING: OML OPERATION MAINTENANCE & MONITORING: M1L
THIS IS A LEGAL DOCUMENT. ALL FIELDS MUST BE FILLED OUT CORRECTLY AND COMPLETELY.

Lancaster Laboratories
 Lancaster, PA
 Lab Contact: Jill Parker
 2425 New Holland Pike,
 Lancaster, PA 17601
 Phone No: (717)656-2300

Other Lab	Temp. Blank Check Time	Temp.
	1000	20C
	1200	20C
	1300	20C

SAMPLE ID				Sample Time	# of Containers	Container Type	ANALYSES REQUIRED										Notes/Comments											
Field Point Name	Matrix	Top Depth	Date (yyymmdd)				EPA 8260B/GC/MS TPH-G	BTEX	MIBEX	OXYGENATES	HVOC	EPA 8015B GRO	DRO	ORO	HC-SCREEN	EPA 8021B BTEX		MTBE	EPA 6010 Ca, Fe, K, Mg, Mn, Na	EPA 6010/7000 TPH-L	22 METALS	TLC	STLC	EPA 150.1 PH	SM 2510B SPECIFIC CONDUCTIVITY	EPA 418.1 TRPH	EPA 8260 ETHANOL	EPA 8016 TPH-D
MW-1	W		121221	1317	6	HCL VOLS	X	X																				
MW-2	W		121221	1330	6	HCL VOLS	X	X																				
MW-4	W		121221	1142	6	HCL VOLS	X	X																				
MW-5	W		121221	1150	6	HCL VOLS	X	X																				
MW-6	W		121221	1220	6	HCL VOLS	X	X																				
MW-7	W		121221	1240	6	HCL VOLS	X	X																				
MW-8	W		121221	1220	6	HCL VOLS	X	X																				
QA	T		121221	1000	2	HCL VOLS	X	X																				

Relinquished By <u>Devin Reynard</u>	Company <u>BTS</u>	Date/Time: <u>12/12/21 1530</u>	Relinquished To <u>*</u>	Company	Date/Time	Turnaround Time: Standard <input checked="" type="checkbox"/> 24 Hours <input type="checkbox"/> 48 hours <input type="checkbox"/> 72 Hours <input type="checkbox"/> Other <input type="checkbox"/>
Relinquished By	Company	Date/Time	Relinquished To	Company	Date/Time	
Relinquished By	Company	Date/Time	Relinquished To	Company	Date/Time	Intact: _____ On Ice: _____ Temp: _____ COC # _____

* Shipped via Fed Ex

WELLHEAD INSPECTION CHECKLIST

Client Obvion Date 12/21/12

Site Address 7225 Ramcraft Ave. Oakland Ca.

Job Number 121221-DR2 Technician DR/BW

Well ID	Well Inspected - No Corrective Action Required	WELL IS SECURABLE BY DESIGN (12" or less)	WELL IS CLEARLY MARKED WITH THE WORDS "MONITORING WELL" (12" or less)	Water Bailed From Wellbox	Wellbox Components Cleaned	Cap Replaced	Lock Replaced	Other Action Taken (explain below)	Well Not Inspected (explain below)	Repair Order Submitted
mw-1		X	X	X				X		
mw-2		X	X	X						
mw-3		X	X					X		
mw-4		X	X					X		
mw-5		X	X	X				X		
mw-6		X	X	X				X		
mw-7	X	X	X					Proc. Malek		
mw-8	X	X	X							
mw-9		X	X	X				X		
mw-10		X	X	X				X		

NOTES: mw-4 - 2/3 bolts. No leak. Cap broken. mw-5 1/2 lbs stripped 1/2 lbs broken.
 mw-1 - 1/3 bolts. 3/3 stripped lbs. mw-9 2/2 stripped mw-10 1/2 stripped.
 mw-6 - 2/2 bolts. Cap broken. mw-3 3/3 stripped. mw-2 - 3/3 stripped

SOURCE RECORD **BILL OF LADING**

FOR PURGEWATER RECOVERED FROM GROUNDWATER WELLS AT CHEVRON FACILITIES IN THE STATE OF CALIFORNIA. THE PURGE-WATER WHICH HAS BEEN RECOVERED FROM GROUNDWATER WELLS IS COLLECTED BY THE CONTRACTOR AND HAULED TO THEIR FACILITY IN SAN JOSE, CALIFORNIA FOR TEMPORARILY HOLDING PENDING TRANSPORT BY OTHERS TO FINAL DESTINATION.

The contractor performing this work is BLAINE TECH SERVICES, INC. (BLAINE TECH), 1680 Rogers Ave. San Jose CA (408) 573-0555). BLAINE TECH. is authorized by Chevron Environmental Management Company (CHEVRON EMC) to recover, collect, apportion into loads, and haul the purgewater that is drawn from wells at the CHEVRON EMC facility indicated below and to deliver that purgewater to BLAINE TECH for temporarily holding. Transport routing of the purgewater may be direct from one CHEVRON EMC facility to BLAINE TECH; from one CHEVRON EMC facility to BLAINE TECH via another CHEVRON EMC facility; or any combination thereof. The well purgewater is and remains the property of CHEVRON EMC.

This Source Record **BILL OF LADING** was initiated to cover the recovery of Non-Hazardous Well Purgewater from wells at the Chevron facility described below:

<u>9-3322</u>	<u>Catalina Devine</u>
CHEVRON #	Chevron Engineer
<u>7225 Bancroft Ave.</u>	<u>Oakland Ca.</u>
street number	street name city state

WELL I.D.	GALS.	WELL I.D.	GALS.
<u>MW-1</u>	<u>1 9.3</u>	<u>/</u>	<u>/</u>
<u>MW-2</u>	<u>1 10.5</u>	<u>/</u>	<u>/</u>
<u>MW-4</u>	<u>1 8.1</u>	<u>/</u>	<u>/</u>
<u>MW-5</u>	<u>1 8.5</u>	<u>/</u>	<u>/</u>
<u>MW-6</u>	<u>1 8.5</u>	<u>/</u>	<u>/</u>
<u>MW-7</u>	<u>1 0.6</u>	<u>/</u>	<u>/</u>
<u>MW-8</u>	<u>1 8.4</u>	<u>/</u>	<u>/</u>
<u>/</u>	<u>/</u>	<u>/</u>	<u>/</u>

added equip. _____ any other adjustments / _____
 rinse water 1 2.0

TOTAL GALS. RECOVERED 56.0 loaded onto BTS vehicle # 89

BTS event # 121221-DR2 time 1345 date 12/21/12

Transporter signature D-2

 REC'D AT BTS-SJ time _____ date 12/21/12

Unloaded/received by signature D-2

ATTACHMENT B

LABORATORY ANALYTICAL REPORT

ANALYTICAL RESULTS

Prepared by:

Lancaster Laboratories
2425 New Holland Pike
Lancaster, PA 17605-2425

Prepared for:

Chevron
6001 Bollinger Canyon Rd L4310
San Ramon CA 94583

January 04, 2013

Project: 93322

Submittal Date: 12/22/2012

Group Number: 1358480

PO Number: 0015098202

Release Number: ESPINO DEVINE

State of Sample Origin: CA

Client Sample Description

MW-1-W-121221 NA Water
MW-2-W-121221 NA Water
MW-4-W-121221 NA Water
MW-5-W-121221 NA Water
MW-6-W-121221 NA Water
MW-7-W-121221 NA Water
MW-8-W-121221 NA Water
QA-T-121221 NA Water

Lancaster Labs (LLI)

6905701
6905702
6905703
6905704
6905705
6905706
6905707
6905708

The specific methodologies used in obtaining the enclosed analytical results are indicated on the Laboratory Sample Analysis Record.

ELECTRONIC COPY TO	Chevron c/o CRA	Attn: Report Contact
ELECTRONIC COPY TO	Blaine Tech Services, Inc.	Attn: Dustin Becker
ELECTRONIC COPY TO	Chevron	Attn: Anna Avina
ELECTRONIC COPY TO	CRA	Attn: Nathan Lee
ELECTRONIC COPY TO	CRA	Attn: Ian Hull

Respectfully Submitted,

Jill M. Parker

Jill M. Parker
Senior Specialist

(717) 556-7262

Sample Description: MW-1-W-121221 NA Water
Facility# 93322 BTST
7225 Bancroft Ave-Oakland T0600102079 MW-1

LLI Sample # WW 6905701
LLI Group # 1358480
Account # 10991

Project Name: 93322

Collected: 12/21/2012 13:17 by DR

Chevron

6001 Bollinger Canyon Rd L4310

Submitted: 12/22/2012 11:20

San Ramon CA 94583

Reported: 01/04/2013 22:35

BAOM1

CAT No.	Analysis Name	CAS Number	As Received Result	As Received Method Detection Limit*	As Received Limit of Quantitation	Dilution Factor
GC/MS Volatiles SW-846 8260B			ug/l	ug/l	ug/l	
10943	Benzene	71-43-2	12,000	100	200	200
10943	Ethanol	64-17-5	N.D.	10,000	50,000	200
10943	Ethylbenzene	100-41-4	3,000	100	200	200
10943	Methyl Tertiary Butyl Ether	1634-04-4	N.D.	100	200	200
10943	Toluene	108-88-3	6,800	100	200	200
10943	Xylene (Total)	1330-20-7	15,000	100	200	200
GC Volatiles SW-846 8015B			ug/l	ug/l	ug/l	
01728	TPH-GRO N. CA water C6-C12	n.a.	120,000	2,500	5,000	50

General Sample Comments

State of California Lab Certification No. 2501

All QC is compliant unless otherwise noted. Please refer to the Quality Control Summary for overall QC performance data and associated samples.

Laboratory Sample Analysis Record

CAT No.	Analysis Name	Method	Trial#	Batch#	Analysis Date and Time	Analyst	Dilution Factor
10943	UST VOCs by 8260B - Water	SW-846 8260B	1	P130022AA	01/02/2013 16:00	Anita M Dale	200
01163	GC/MS VOA Water Prep	SW-846 5030B	1	P130022AA	01/02/2013 16:00	Anita M Dale	200
01728	TPH-GRO N. CA water C6-C12	SW-846 8015B	1	12361A07A	12/28/2012 00:58	Marie D John	50
01146	GC VOA Water Prep	SW-846 5030B	1	12361A07A	12/28/2012 00:58	Marie D John	50

*=This limit was used in the evaluation of the final result

Sample Description: MW-2-W-121221 NA Water
Facility# 93322 BTST
7225 Bancroft Ave-Oakland T0600102079 MW-2

LLI Sample # WW 6905702
LLI Group # 1358480
Account # 10991

Project Name: 93322

Collected: 12/21/2012 13:30 by DR

Chevron

6001 Bollinger Canyon Rd L4310
 San Ramon CA 94583

Submitted: 12/22/2012 11:20

Reported: 01/04/2013 22:35

BAOM2

CAT No.	Analysis Name	CAS Number	As Received Result	As Received Method Detection Limit*	As Received Limit of Quantitation	Dilution Factor
GC/MS Volatiles SW-846 8260B			ug/l	ug/l	ug/l	
10943	Benzene	71-43-2	N.D.	5	10	10
10943	Ethanol	64-17-5	N.D.	500	2,500	10
10943	Ethylbenzene	100-41-4	23	5	10	10
10943	Methyl Tertiary Butyl Ether	1634-04-4	N.D.	5	10	10
10943	Toluene	108-88-3	N.D.	5	10	10
10943	Xylene (Total)	1330-20-7	12	5	10	10
GC Volatiles SW-846 8015B			ug/l	ug/l	ug/l	
01728	TPH-GRO N. CA water C6-C12	n.a.	3,100	250	500	5

General Sample Comments

State of California Lab Certification No. 2501

All QC is compliant unless otherwise noted. Please refer to the Quality Control Summary for overall QC performance data and associated samples.

Laboratory Sample Analysis Record

CAT No.	Analysis Name	Method	Trial#	Batch#	Analysis Date and Time	Analyst	Dilution Factor
10943	UST VOCs by 8260B - Water	SW-846 8260B	1	P130022AA	01/02/2013 16:28	Anita M Dale	10
01163	GC/MS VOA Water Prep	SW-846 5030B	1	P130022AA	01/02/2013 16:28	Anita M Dale	10
01728	TPH-GRO N. CA water C6-C12	SW-846 8015B	1	12361A07A	12/28/2012 01:23	Marie D John	5
01146	GC VOA Water Prep	SW-846 5030B	1	12361A07A	12/28/2012 01:23	Marie D John	5

*=This limit was used in the evaluation of the final result

Sample Description: MW-4-W-121221 NA Water
Facility# 93322 BTST
 7225 Bancroft Ave-Oakland T0600102079 MW-4

LLI Sample # WW 6905703
LLI Group # 1358480
Account # 10991

Project Name: 93322

Collected: 12/21/2012 11:42 by DR

Chevron

6001 Bollinger Canyon Rd L4310
 San Ramon CA 94583

Submitted: 12/22/2012 11:20

Reported: 01/04/2013 22:35

BAOM4

CAT No.	Analysis Name	CAS Number	As Received Result	As Received Method Detection Limit*	As Received Limit of Quantitation	Dilution Factor
GC/MS Volatiles SW-846 8260B			ug/l	ug/l	ug/l	
10943	Benzene	71-43-2	N.D.	0.5	1	1
10943	Ethanol	64-17-5	N.D.	50	250	1
10943	Ethylbenzene	100-41-4	N.D.	0.5	1	1
10943	Methyl Tertiary Butyl Ether	1634-04-4	N.D.	0.5	1	1
10943	Toluene	108-88-3	N.D.	0.5	1	1
10943	Xylene (Total)	1330-20-7	N.D.	0.5	1	1
GC Volatiles SW-846 8015B			ug/l	ug/l	ug/l	
01728	TPH-GRO N. CA water C6-C12	n.a.	N.D.	50	100	1

General Sample Comments

State of California Lab Certification No. 2501

All QC is compliant unless otherwise noted. Please refer to the Quality Control Summary for overall QC performance data and associated samples.

Laboratory Sample Analysis Record

CAT No.	Analysis Name	Method	Trial#	Batch#	Analysis Date and Time	Analyst	Dilution Factor
10943	UST VOCs by 8260B - Water	SW-846 8260B	1	P130022AA	01/02/2013 16:55	Anita M Dale	1
01163	GC/MS VOA Water Prep	SW-846 5030B	1	P130022AA	01/02/2013 16:55	Anita M Dale	1
01728	TPH-GRO N. CA water C6-C12	SW-846 8015B	1	12361A07A	12/27/2012 19:53	Marie D John	1
01146	GC VOA Water Prep	SW-846 5030B	1	12361A07A	12/27/2012 19:53	Marie D John	1

*=This limit was used in the evaluation of the final result

Sample Description: MW-5-W-121221 NA Water
Facility# 93322 BTST
 7225 Bancroft Ave-Oakland T0600102079 MW-5

LLI Sample # WW 6905704
LLI Group # 1358480
Account # 10991

Project Name: 93322

Collected: 12/21/2012 11:50 by DR

Chevron

6001 Bollinger Canyon Rd L4310
 San Ramon CA 94583

Submitted: 12/22/2012 11:20

Reported: 01/04/2013 22:35

BAOM5

CAT No.	Analysis Name	CAS Number	As Received Result	As Received Method Detection Limit*	As Received Limit of Quantitation	Dilution Factor
GC/MS Volatiles SW-846 8260B						
10943	Benzene	71-43-2	N.D.	0.5	1	1
10943	Ethanol	64-17-5	N.D.	50	250	1
10943	Ethylbenzene	100-41-4	N.D.	0.5	1	1
10943	Methyl Tertiary Butyl Ether	1634-04-4	N.D.	0.5	1	1
10943	Toluene	108-88-3	N.D.	0.5	1	1
10943	Xylene (Total)	1330-20-7	N.D.	0.5	1	1
GC Volatiles SW-846 8015B						
01728	TPH-GRO N. CA water C6-C12	n.a.	N.D.	50	100	1

General Sample Comments

State of California Lab Certification No. 2501

All QC is compliant unless otherwise noted. Please refer to the Quality Control Summary for overall QC performance data and associated samples.

Laboratory Sample Analysis Record

CAT No.	Analysis Name	Method	Trial#	Batch#	Analysis Date and Time	Analyst	Dilution Factor
10943	UST VOCs by 8260B - Water	SW-846 8260B	1	P130022AA	01/02/2013 17:23	Anita M Dale	1
01163	GC/MS VOA Water Prep	SW-846 5030B	1	P130022AA	01/02/2013 17:23	Anita M Dale	1
01728	TPH-GRO N. CA water C6-C12	SW-846 8015B	1	12361A07A	12/27/2012 20:18	Marie D John	1
01146	GC VOA Water Prep	SW-846 5030B	1	12361A07A	12/27/2012 20:18	Marie D John	1

*=This limit was used in the evaluation of the final result

Sample Description: MW-6-W-121221 NA Water
Facility# 93322 BTST
 7225 Bancroft Ave-Oakland T0600102079 MW-6

LLI Sample # WW 6905705
LLI Group # 1358480
Account # 10991

Project Name: 93322

Collected: 12/21/2012 12:20 by DR

Chevron

6001 Bollinger Canyon Rd L4310
 San Ramon CA 94583

Submitted: 12/22/2012 11:20

Reported: 01/04/2013 22:35

BAOM6

CAT No.	Analysis Name	CAS Number	As Received Result	As Received Method Detection Limit*	As Received Limit of Quantitation	Dilution Factor
GC/MS Volatiles			SW-846 8260B	ug/l	ug/l	
10943	Benzene	71-43-2	360	5	10	10
10943	Ethanol	64-17-5	N.D.	500	2,500	10
10943	Ethylbenzene	100-41-4	N.D.	5	10	10
10943	Methyl Tertiary Butyl Ether	1634-04-4	28	5	10	10
10943	Toluene	108-88-3	N.D.	5	10	10
10943	Xylene (Total)	1330-20-7	N.D.	5	10	10
GC Volatiles			SW-846 8015B	ug/l	ug/l	
01728	TPH-GRO N. CA water C6-C12	n.a.	2,200	250	500	5

General Sample Comments

State of California Lab Certification No. 2501

All QC is compliant unless otherwise noted. Please refer to the Quality Control Summary for overall QC performance data and associated samples.

Laboratory Sample Analysis Record

CAT No.	Analysis Name	Method	Trial#	Batch#	Analysis Date and Time	Analyst	Dilution Factor
10943	UST VOCs by 8260B - Water	SW-846 8260B	1	P130022AA	01/02/2013 17:50	Anita M Dale	10
01163	GC/MS VOA Water Prep	SW-846 5030B	1	P130022AA	01/02/2013 17:50	Anita M Dale	10
01728	TPH-GRO N. CA water C6-C12	SW-846 8015B	1	12361A07A	12/28/2012 01:48	Marie D John	5
01146	GC VOA Water Prep	SW-846 5030B	1	12361A07A	12/28/2012 01:48	Marie D John	5

*=This limit was used in the evaluation of the final result

Sample Description: MW-7-W-121221 NA Water
Facility# 93322 BTST
7225 Bancroft Ave-Oakland T0600102079 MW-7

LLI Sample # WW 6905706
LLI Group # 1358480
Account # 10991

Project Name: 93322

Collected: 12/21/2012 12:40 by DR

Chevron

6001 Bollinger Canyon Rd L4310

Submitted: 12/22/2012 11:20

San Ramon CA 94583

Reported: 01/04/2013 22:35

BAOM7

CAT No.	Analysis Name	CAS Number	As Received Result	As Received Method Detection Limit*	As Received Limit of Quantitation	Dilution Factor
GC/MS Volatiles SW-846 8260B			ug/l	ug/l	ug/l	
10943	t-Amyl methyl ether	994-05-8	N.D.	25	50	50
10943	Benzene	71-43-2	5,300	25	50	50
10943	t-Butyl alcohol	75-65-0	240	100	250	50
10943	Ethanol	64-17-5	N.D.	2,500	13,000	50
10943	Ethyl t-butyl ether	637-92-3	N.D.	25	50	50
10943	Ethylbenzene	100-41-4	530	25	50	50
10943	di-Isopropyl ether	108-20-3	N.D.	25	50	50
10943	Methyl Tertiary Butyl Ether	1634-04-4	55	25	50	50
10943	Toluene	108-88-3	160	25	50	50
10943	Xylene (Total)	1330-20-7	2,200	25	50	50
GC Volatiles SW-846 8015B			ug/l	ug/l	ug/l	
01728	TPH-GRO N. CA water C6-C12	n.a.	21,000	1,000	2,000	20

General Sample Comments

State of California Lab Certification No. 2501

All QC is compliant unless otherwise noted. Please refer to the Quality Control Summary for overall QC performance data and associated samples.

Laboratory Sample Analysis Record

CAT No.	Analysis Name	Method	Trial#	Batch#	Analysis Date and Time	Analyst	Dilution Factor
10943	UST VOCs by 8260B - Water	SW-846 8260B	1	F130031AA	01/03/2013 10:35	Anita M Dale	50
01163	GC/MS VOA Water Prep	SW-846 5030B	1	F130031AA	01/03/2013 10:35	Anita M Dale	50
01728	TPH-GRO N. CA water C6-C12	SW-846 8015B	1	12361A07A	12/28/2012 02:14	Marie D John	20
01146	GC VOA Water Prep	SW-846 5030B	1	12361A07A	12/28/2012 02:14	Marie D John	20

*=This limit was used in the evaluation of the final result

Sample Description: MW-8-W-121221 NA Water
Facility# 93322 BTST
7225 Bancroft Ave-Oakland T0600102079 MW-8

LLI Sample # WW 6905707
LLI Group # 1358480
Account # 10991

Project Name: 93322

Collected: 12/21/2012 12:20 by DR

Chevron

6001 Bollinger Canyon Rd L4310

Submitted: 12/22/2012 11:20

San Ramon CA 94583

Reported: 01/04/2013 22:35

BAOM8

CAT No.	Analysis Name	CAS Number	As Received Result	As Received Method Detection Limit*	As Received Limit of Quantitation	Dilution Factor
GC/MS Volatiles SW-846 8260B			ug/l	ug/l	ug/l	
10943	t-Amyl methyl ether	994-05-8	N.D.	0.5	1	1
10943	Benzene	71-43-2	N.D.	0.5	1	1
10943	t-Butyl alcohol	75-65-0	6	2	5	1
10943	Ethanol	64-17-5	N.D.	50	250	1
10943	Ethyl t-butyl ether	637-92-3	N.D.	0.5	1	1
10943	Ethylbenzene	100-41-4	N.D.	0.5	1	1
10943	di-Isopropyl ether	108-20-3	N.D.	0.5	1	1
10943	Methyl Tertiary Butyl Ether	1634-04-4	2	0.5	1	1
10943	Toluene	108-88-3	N.D.	0.5	1	1
10943	Xylene (Total)	1330-20-7	N.D.	0.5	1	1
GC Volatiles SW-846 8015B			ug/l	ug/l	ug/l	
01728	TPH-GRO N. CA water C6-C12	n.a.	N.D.	50	100	1

General Sample Comments

State of California Lab Certification No. 2501
The temperature of the GRO sample bottle(s) upon receipt at the lab was 5.2 - 7.8 C using an IR thermometer.

All QC is compliant unless otherwise noted. Please refer to the Quality Control Summary for overall QC performance data and associated samples.

Laboratory Sample Analysis Record

CAT No.	Analysis Name	Method	Trial#	Batch#	Analysis Date and Time	Analyst	Dilution Factor
10943	UST VOCs by 8260B - Water	SW-846 8260B	1	F130031AA	01/03/2013 10:57	Anita M Dale	1
01163	GC/MS VOA Water Prep	SW-846 5030B	1	F130031AA	01/03/2013 10:57	Anita M Dale	1
01728	TPH-GRO N. CA water C6-C12	SW-846 8015B	1	12361A07A	12/27/2012 20:44	Marie D John	1
01146	GC VOA Water Prep	SW-846 5030B	1	12361A07A	12/27/2012 20:44	Marie D John	1

*=This limit was used in the evaluation of the final result

Sample Description: QA-T-121221 NA Water
Facility# 93322 BTST
7225 Bancroft Ave-Oakland T0600102079 QA

LLI Sample # WW 6905708
LLI Group # 1358480
Account # 10991

Project Name: 93322

Collected: 12/21/2012 10:00

Chevron

Submitted: 12/22/2012 11:20

6001 Bollinger Canyon Rd L4310

Reported: 01/04/2013 22:35

San Ramon CA 94583

BAOQA

CAT No.	Analysis Name	CAS Number	As Received Result	As Received Method Detection Limit*	As Received Limit of Quantitation	Dilution Factor
GC/MS Volatiles SW-846 8260B						
10943	Benzene	71-43-2	N.D.	0.5	1	1
10943	Ethylbenzene	100-41-4	N.D.	0.5	1	1
10943	Methyl Tertiary Butyl Ether	1634-04-4	N.D.	0.5	1	1
10943	Toluene	108-88-3	N.D.	0.5	1	1
10943	Xylene (Total)	1330-20-7	N.D.	0.5	1	1
GC Volatiles SW-846 8015B						
01728	TPH-GRO N. CA water C6-C12	n.a.	N.D.	50	100	1

General Sample Comments

State of California Lab Certification No. 2501
 The temperature of the GRO sample bottle(s) upon receipt at the lab was 5.2 - 7.8 C using an IR thermometer.

All QC is compliant unless otherwise noted. Please refer to the Quality Control Summary for overall QC performance data and associated samples.

Laboratory Sample Analysis Record

CAT No.	Analysis Name	Method	Trial#	Batch#	Analysis Date and Time	Analyst	Dilution Factor
10943	BTEX/MTBE 8260 Water	SW-846 8260B	1	P130022AA	01/02/2013 08:36	Anita M Dale	1
01163	GC/MS VOA Water Prep	SW-846 5030B	1	P130022AA	01/02/2013 08:36	Anita M Dale	1
01728	TPH-GRO N. CA water C6-C12	SW-846 8015B	1	12361A07A	12/27/2012 19:01	Marie D John	1
01146	GC VOA Water Prep	SW-846 5030B	1	12361A07A	12/27/2012 19:01	Marie D John	1

*=This limit was used in the evaluation of the final result

Quality Control Summary

Client Name: Chevron

Group Number: 1358480

Reported: 01/04/13 at 10:35 PM

Matrix QC may not be reported if insufficient sample or site-specific QC samples were not submitted. In these situations, to demonstrate precision and accuracy at a batch level, a LCS/LCSD was performed, unless otherwise specified in the method.

All Inorganic Initial Calibration and Continuing Calibration Blanks met acceptable method criteria unless otherwise noted on the Analysis Report.

Laboratory Compliance Quality Control

<u>Analysis Name</u>	<u>Blank Result</u>	<u>Blank MDL**</u>	<u>Blank LOQ</u>	<u>Report Units</u>	<u>LCS %REC</u>	<u>LCSD %REC</u>	<u>LCS/LCSD Limits</u>	<u>RPD</u>	<u>RPD Max</u>
Batch number: F130031AA Sample number(s): 6905706-6905707									
t-Amyl methyl ether	N.D.	0.5	1	ug/l	92		66-120		
Benzene	N.D.	0.5	1	ug/l	93		77-121		
t-Butyl alcohol	N.D.	2.	5	ug/l	96		68-125		
Ethanol	N.D.	50.	250	ug/l	93		54-149		
Ethyl t-butyl ether	N.D.	0.5	1	ug/l	87		66-120		
Ethylbenzene	N.D.	0.5	1	ug/l	88		79-120		
di-Isopropyl ether	N.D.	0.5	1	ug/l	83		71-124		
Methyl Tertiary Butyl Ether	N.D.	0.5	1	ug/l	94		68-121		
Toluene	N.D.	0.5	1	ug/l	88		79-120		
Xylene (Total)	N.D.	0.5	1	ug/l	92		77-120		
Batch number: P130022AA Sample number(s): 6905701-6905705,6905708									
Benzene	N.D.	0.5	1	ug/l	88		77-121		
Ethanol	N.D.	50.	250	ug/l	82		54-149		
Ethylbenzene	N.D.	0.5	1	ug/l	88		79-120		
Methyl Tertiary Butyl Ether	N.D.	0.5	1	ug/l	83		68-121		
Toluene	N.D.	0.5	1	ug/l	91		79-120		
Xylene (Total)	N.D.	0.5	1	ug/l	94		77-120		
Batch number: 12361A07A Sample number(s): 6905701-6905708									
TPH-GRO N. CA water C6-C12	N.D.	50.	100	ug/l	102	112	75-135	9	30

Sample Matrix Quality Control

Unspiked (UNSPK) = the sample used in conjunction with the matrix spike
Background (BKG) = the sample used in conjunction with the duplicate

<u>Analysis Name</u>	<u>MS %REC</u>	<u>MSD %REC</u>	<u>MS/MSD Limits</u>	<u>RPD</u>	<u>RPD MAX</u>	<u>BKG Conc</u>	<u>DUP Conc</u>	<u>DUP RPD</u>	<u>Dup RPD Max</u>
Batch number: F130031AA Sample number(s): 6905706-6905707 UNSPK: P908516									
t-Amyl methyl ether	95	93	65-117	3	30				
Benzene	98	98	72-134	0	30				
t-Butyl alcohol	98	96	67-119	1	30				
Ethanol	96	101	53-146	5	30				
Ethyl t-butyl ether	97	91	74-122	7	30				
Ethylbenzene	94	95	71-134	1	30				
di-Isopropyl ether	101	85	70-129	17	30				
Methyl Tertiary Butyl Ether	111	97	72-126	14	30				
Toluene	96	96	80-125	1	30				
Xylene (Total)	99	104	79-125	5	30				

*- Outside of specification

** - This limit was used in the evaluation of the final result for the blank

- (1) The result for one or both determinations was less than five times the LOQ.
- (2) The unspiked result was more than four times the spike added.

Quality Control Summary

Client Name: Chevron
Reported: 01/04/13 at 10:35 PM

Group Number: 1358480

Sample Matrix Quality Control

Unspiked (UNSPK) = the sample used in conjunction with the matrix spike
Background (BKG) = the sample used in conjunction with the duplicate

<u>Analysis Name</u>	<u>MS</u> <u>%REC</u>	<u>MSD</u> <u>%REC</u>	<u>MS/MSD</u> <u>Limits</u>	<u>RPD</u> <u>RPD</u>	<u>BKG</u> <u>MAX</u> <u>Conc</u>	<u>DUP</u> <u>Conc</u>	<u>DUP</u> <u>RPD</u>	<u>Dup RPD</u> <u>Max</u>
Batch number: P130022AA	Sample number(s): 6905701-6905705,6905708 UNSPK: P905743							
Benzene	91	92	72-134	1	30			
Ethanol	78	79	53-146	2	30			
Ethylbenzene	93	93	71-134	1	30			
Methyl Tertiary Butyl Ether	84	85	72-126	0	30			
Toluene	96	96	80-125	0	30			
Xylene (Total)	98	99	79-125	1	30			

Surrogate Quality Control

Surrogate recoveries which are outside of the QC window are confirmed unless attributed to dilution or otherwise noted on the Analysis Report.

Analysis Name: UST VOCs by 8260B - Water
Batch number: F130031AA

	Dibromofluoromethane	1,2-Dichloroethane-d4	Toluene-d8	4-Bromofluorobenzene
6905706	105	97	94	94
6905707	107	100	106	92
Blank	108	98	95	92
LCS	106	100	94	94
MS	111	100	94	94
MSD	106	103	94	101
Limits:	80-116	77-113	80-113	78-113

Analysis Name: UST VOCs by 8260B - Water
Batch number: P130022AA

	Dibromofluoromethane	1,2-Dichloroethane-d4	Toluene-d8	4-Bromofluorobenzene
6905701	103	100	96	97
6905702	103	104	97	97
6905703	101	101	95	93
6905704	103	98	94	95
6905705	102	100	95	95
6905708	102	103	95	94
Blank	103	99	96	93
LCS	103	102	96	97
MS	101	101	96	97
MSD	100	100	94	95
Limits:	80-116	77-113	80-113	78-113

Analysis Name: TPH-GRO N. CA water C6-C12

Batch number: 12361A07A
Trifluorotoluene-F

6905701	105
---------	-----

*- Outside of specification

** - This limit was used in the evaluation of the final result for the blank

- (1) The result for one or both determinations was less than five times the LOQ.
- (2) The unspiked result was more than four times the spike added.

Quality Control Summary

Client Name: Chevron
Reported: 01/04/13 at 10:35 PM

Group Number: 1358480

Surrogate Quality Control

6905702	104
6905703	92
6905704	97
6905705	102
6905706	98
6905707	94
6905708	89
Blank	83
LCS	90
LCSD	93

Limits: 63-135

*- Outside of specification

** - This limit was used in the evaluation of the final result for the blank

- (1) The result for one or both determinations was less than five times the LOQ.
- (2) The unspiked result was more than four times the spike added.

Explanation of Symbols and Abbreviations

The following defines common symbols and abbreviations used in reporting technical data:

RL	Reporting Limit	BMQL	Below Minimum Quantitation Level
N.D.	none detected	MPN	Most Probable Number
TNTC	Too Numerous To Count	CP Units	cobalt-chloroplatinate units
IU	International Units	NTU	nephelometric turbidity units
umhos/cm	micromhos/cm	ng	nanogram(s)
C	degrees Celsius	F	degrees Fahrenheit
meq	milliequivalents	lb.	pound(s)
g	gram(s)	kg	kilogram(s)
µg	microgram(s)	mg	milligram(s)
mL	milliliter(s)	L	liter(s)
m3	cubic meter(s)	µL	microliter(s)
		pg/L	picogram/liter

< less than - The number following the sign is the limit of quantitation, the smallest amount of analyte which can be reliably determined using this specific test.

> greater than

J estimated value – The result is \geq the Method Detection Limit (MDL) and $<$ the Limit of Quantitation (LOQ).

ppm parts per million - One ppm is equivalent to one milligram per kilogram (mg/kg), or one gram per million grams. For aqueous liquids, ppm is usually taken to be equivalent to milligrams per liter (mg/l), because one liter of water has a weight very close to a kilogram. For gases or vapors, one ppm is equivalent to one microliter of gas per liter of gas.

ppb parts per billion

Dry weight basis Results printed under this heading have been adjusted for moisture content. This increases the analyte weight concentration to approximate the value present in a similar sample without moisture. All other results are reported on an as-received basis.

U.S. EPA CLP Data Qualifiers:

Organic Qualifiers	Inorganic Qualifiers
A TIC is a possible aldol-condensation product	B Value is $<$ CRDL, but \geq IDL
B Analyte was also detected in the blank	E Estimated due to interference
C Pesticide result confirmed by GC/MS	M Duplicate injection precision not met
D Compound quantitated on a diluted sample	N Spike sample not within control limits
E Concentration exceeds the calibration range of the instrument	S Method of standard additions (MSA) used for calculation
N Presumptive evidence of a compound (TICs only)	U Compound was not detected
P Concentration difference between primary and confirmation columns $>$ 25%	W Post digestion spike out of control limits
U Compound was not detected	* Duplicate analysis not within control limits
X,Y,Z Defined in case narrative	+ Correlation coefficient for MSA $<$ 0.995

Analytical test results meet all requirements of NELAC unless otherwise noted under the individual analysis.

Measurement uncertainty values, as applicable, are available upon request.

Tests results relate only to the sample tested. Clients should be aware that a critical step in a chemical or microbiological analysis is the collection of the sample. Unless the sample analyzed is truly representative of the bulk of material involved, the test results will be meaningless. If you have questions regarding the proper techniques of collecting samples, please contact us. We cannot be held responsible for sample integrity, however, unless sampling has been performed by a member of our staff. This report shall not be reproduced except in full, without the written approval of the laboratory.

Times are local to the area of activity. Parameters listed in the 40 CFR part 136 Table II as "analyze immediately" are not performed within 15 minutes.

WARRANTY AND LIMITS OF LIABILITY - In accepting analytical work, we warrant the accuracy of test results for the sample as submitted. THE FOREGOING EXPRESS WARRANTY IS EXCLUSIVE AND IS GIVEN IN LIEU OF ALL OTHER WARRANTIES, EXPRESSED OR IMPLIED. WE DISCLAIM ANY OTHER WARRANTIES, EXPRESSED OR IMPLIED, INCLUDING A WARRANTY OF FITNESS FOR PARTICULAR PURPOSE AND WARRANTY OF MERCHANTABILITY. IN NO EVENT SHALL LANCASTER LABORATORIES BE LIABLE FOR INDIRECT, SPECIAL, CONSEQUENTIAL, OR INCIDENTAL DAMAGES INCLUDING, BUT NOT LIMITED TO, DAMAGES FOR LOSS OF PROFIT OR GOODWILL REGARDLESS OF (A) THE NEGLIGENCE (EITHER SOLE OR CONCURRENT) OF LANCASTER LABORATORIES AND (B) WHETHER LANCASTER LABORATORIES HAS BEEN INFORMED OF THE POSSIBILITY OF SUCH DAMAGES. We accept no legal responsibility for the purposes for which the client uses the test results. No purchase order or other order for work shall be accepted by Lancaster Laboratories which includes any conditions that vary from the Standard Terms and Conditions, and Lancaster hereby objects to any conflicting terms contained in any acceptance or order submitted by client.