



**CONESTOGA-ROVERS  
& ASSOCIATES**

5900 Hollis Street, Suite A  
Emeryville, California 94608  
Telephone: (510) 420-0700 Fax: (510) 420-9170  
www.CRAworld.com

## TRANSMITTAL

DATE: May 4, 2012 REFERENCE NO.: 241513  
PROJECT NAME: 500 40<sup>th</sup> Street, Oakland  
TO: Jerry Wickham  
Alameda County Environmental Health  
1131 Harbor Bay Parkway, Suite 250  
Alameda, California 94502-6577

**RECEIVED**  
  
*4:50 pm, May 07, 2012*  
Alameda County  
Environmental Health

Please find enclosed:  Draft  Final  
 Originals  Other  
 Prints

Sent via:  Mail  Same Day Courier  
 Overnight Courier  Other GeoTracker and Alameda County FTP

QUANTITY	DESCRIPTION
1	Groundwater Monitoring Report - First Quarter 2012

As Requested  For Review and Comment  
 For Your Use  \_\_\_\_\_  
 \_\_\_\_\_

**COMMENTS:**

If you have any questions regarding the contents of this document, please call Peter Schaefer at (510) 420-3319.

Copy to: Denis Brown, Shell Oil Products US (electronic copy)  
Young Song and In Song, Trustees (property owners), 1015 Sanders Drive, Moraga, CA 94556

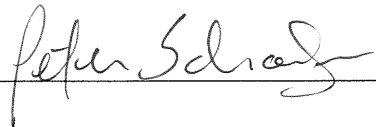
Completed by: Peter Schaefer Signed: 

Filing: **Correspondence File**



Jerry Wickham  
Alameda County Environmental Health  
1131 Harbor Bay Parkway, Suite 250  
Alameda, California 94502-6577

**Denis L. Brown**  
**Shell Oil Products US**  
HSE – Environmental Services  
20945 S. Wilmington Ave.  
Carson, CA 90810-1039  
Tel (707) 865 0251  
Fax (707) 865 2542  
Email [denis.l.brown@shell.com](mailto:denis.l.brown@shell.com)

Re: Former Shell Service Station  
500 40th Street  
Oakland, California  
SAP Code 129452  
Incident No. 97093400  
ACEH Case No. RO0000264

Dear Mr. Wickham:

The attached document is provided for your review and comment. Upon information and belief, I declare, under penalty of perjury, that the information contained in the attached document is true and correct.

As always, please feel free to contact me directly at (707) 865-0251 with any questions or concerns.

Sincerely,

A handwritten signature in black ink, appearing to read "Denis L. Brown", is written over a horizontal line.

Denis L. Brown  
Senior Program Manager



## **GROUNDWATER MONITORING REPORT - FIRST QUARTER 2012**

**FORMER SHELL SERVICE STATION  
500 40<sup>TH</sup> STREET  
OAKLAND, CALIFORNIA**

**SAP CODE           129452  
INCIDENT NO.    97093400  
AGENCY NO.      RO0000264**

**MAY 4, 2012  
REF. NO. 241513 (12)**  
This report is printed on recycled paper.

**Prepared by:  
Conestoga-Rovers  
& Associates**

5900 Hollis Street, Suite A  
Emeryville, California  
U.S.A. 94608

Office: (510) 420-0700  
Fax: (510) 420-9170

web: <http://www.CRAworld.com>

TABLE OF CONTENTS

	<u>Page</u>
1.0 INTRODUCTION.....	1
1.1 SITE INFORMATION .....	1
2.0 SITE ACTIVITIES AND FINDINGS .....	1
2.1 CURRENT QUARTER'S ACTIVITIES.....	1
2.2 CURRENT QUARTER'S FINDINGS .....	2
2.3 PROPOSED ACTIVITIES.....	2

LIST OF FIGURES  
(Following Text)

FIGURE 1	VICINITY MAP
FIGURE 2	GROUNDWATER CONTOUR AND CHEMICAL CONCENTRATION MAP

LIST OF TABLES  
(Following Text)

TABLE 1	GROUNDWATER DATA
---------	------------------

LIST OF APPENDICES

APPENDIX A	BLAINE TECH SERVICES, INC. - FIELD NOTES
APPENDIX B	TEST AMERICA - LABORATORY REPORT

## 1.0 INTRODUCTION

Conestoga-Rovers & Associates (CRA) prepared this report on behalf of Equilon Enterprises LLC dba Shell Oil Products US (Shell).

### 1.1 SITE INFORMATION

Site Address	500 40 <sup>th</sup> Street, Oakland
Site Use	Shopping center
Shell Project Manager	Denis Brown
CRA Project Manager	Peter Schaefer
Lead Agency and Contact	ACEH, Jerry Wickham
Agency Case No.	RO0000264
Shell SAP Code	129452
Shell Incident No.	97093400

Date of most recent agency correspondence was January 10, 2012 (electronic).

## 2.0 SITE ACTIVITIES AND FINDINGS

### 2.1 CURRENT QUARTER'S ACTIVITIES

Blaine Tech Services, Inc. (Blaine) gauged and sampled the wells according to the established monitoring program for this site.

CRA prepared a vicinity map (Figure 1), a groundwater contour and chemical concentration map (Figure 2), and a groundwater data table (Table 1). Blaine's field notes are presented in Appendix A, and the laboratory report is presented in Appendix B.

CRA submitted a *Subsurface Investigation Report* to Alameda County Environmental Health (ACEH) on March 27, 2012. Based on the soil vapor results included in this report and current soil and groundwater conditions, CRA recommended closure of this environmental case.

**2.2**      **CURRENT QUARTER'S FINDINGS**

Groundwater Flow Direction	Southwesterly
Hydraulic Gradient	Averages 0.02
Depth to Water	10.27 to 11.81 feet below top of well casing

**2.3**      **PROPOSED ACTIVITIES**

As stated above, CRA's March 27, 2012 report recommended closure of this environmental case. We request that ACEH suspend groundwater monitoring requirements during closure review. Unless directed otherwise, CRA will suspend the groundwater monitoring program during the closure review. No further groundwater monitoring events are scheduled.

All of Which is Respectfully Submitted,  
CONESTOGA-ROVERS & ASSOCIATES

*Peter Schaefer*  
Peter Schaefer, CEG, CHG

*Aubrey K. Cool*  
Aubrey K. Cool, PG

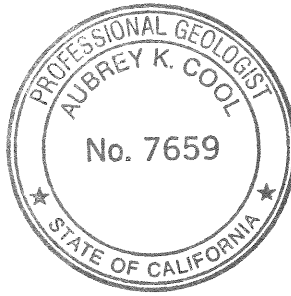



## FIGURES

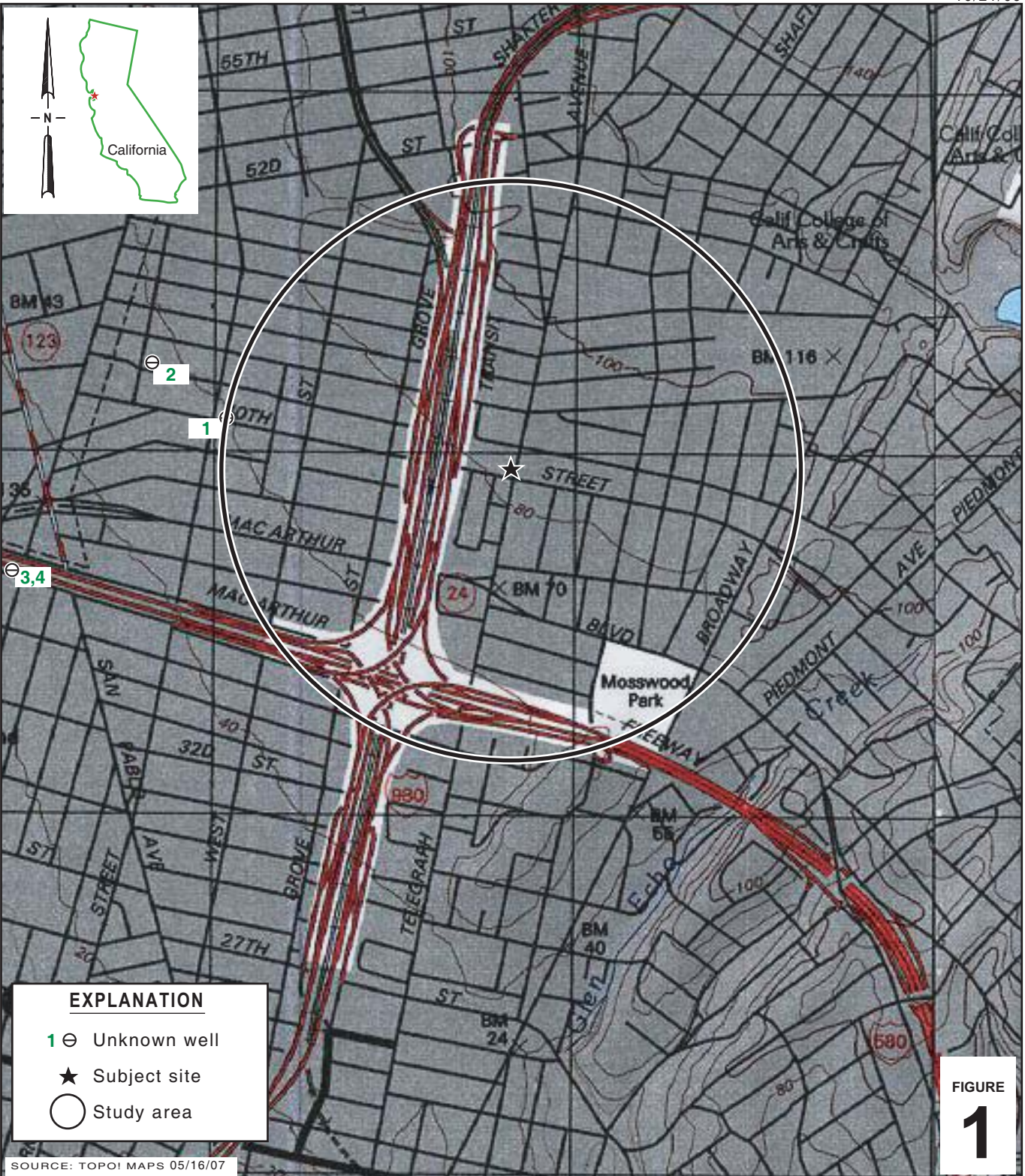

I:\Shell\6-chars\2415--\241513-Oakland 500 40th\241513-FIGURES\241513 VICINITY.A1

**EXPLANATION**

- 1 ⊖ Unknown well
- ★ Subject site
- Study area

FIGURE  
**1**

SOURCE: TOPOI MAPS 05/16/07

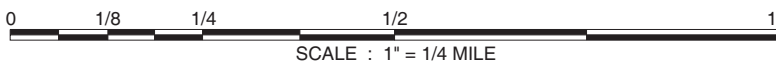

### Former Shell Service Station

500 40th Street  
Oakland, California



**CONESTOGA-ROVERS  
& ASSOCIATES**

### Vicinity Map

**EXPLANATION**

- SVP-1 Soil vapor probe location
- MW-2 Monitoring well location
- MW-4 Destroyed monitoring well location
- B-1 Monitoring wells paved over or built upon
- CSB-1 Soil boring location

Groundwater flow direction and gradient: xx.xx

Groundwater elevation contour, in feet above mean sea level (ft MSL):

Well designation:

Groundwater elevation, in ft MSL: **ELEV**

Benzene and MTBE concentrations are in micrograms per liter: **Benzene**, **MTBE**

**Notes:**  
 INACC = Well inaccessible  
 NA = Not available; well not surveyed  
 ND = Not detected  
 NS = Not sampled

- Electrical line (E)
- Telecommunication line (T)
- Unknown utility line (?)
- Gas line (G)
- Storm drain line (STM)
- Water line (W)

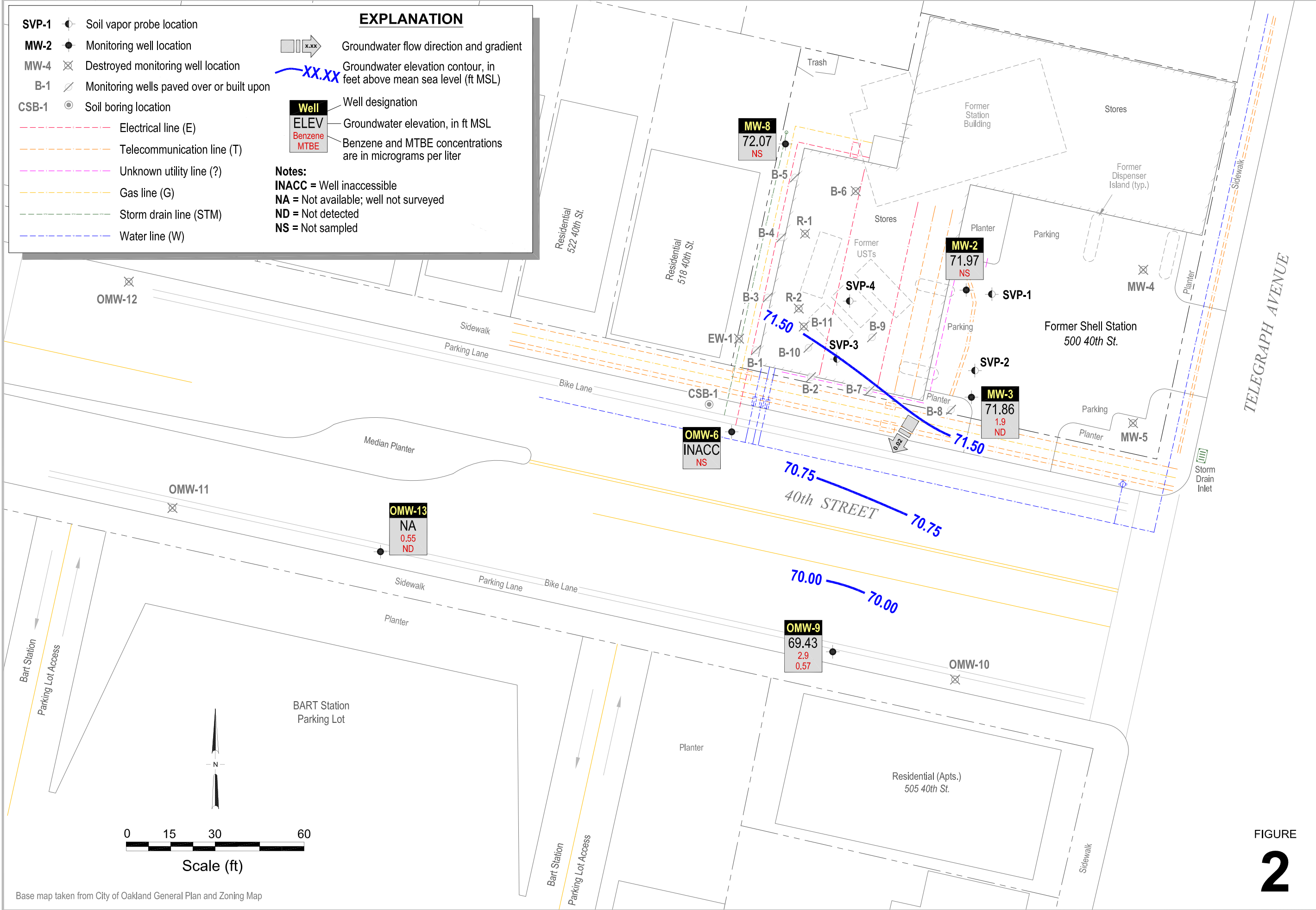

I:\Shell6-chars\2415-1-241513-Oakland 500 40th\241513-REPORTS\241513-RPT12-1Q12\241513\_10M12-GW.DWG

Base map taken from City of Oakland General Plan and Zoning Map

**Groundwater Contour and Chemical Concentration Map**

March 26, 2012



**Former Shell Service Station**

500 40th Street  
Oakland, California

FIGURE  
**2**

TABLE

TABLE 1

**GROUNDWATER DATA  
FORMER SHELL SERVICE STATION  
500 40TH STREET, OAKLAND, CALIFORNIA**

Well ID	Date	TPHd (µg/L)	TPHg (µg/L)	B (µg/L)	T (µg/L)	E (µg/L)	X (µg/L)	MTBE		TBA (µg/L)	DIPE (µg/L)	ETBE (µg/L)	TAME (µg/L)	1,2-		TOC (ft MSL)	Depth to Water (ft TOC)	GW Elevation (ft MSL)	DO Reading (mg/L)
								8020 (µg/L)	8260 (µg/L)					DCA (µg/L)	EDB (µg/L)				
EW-1	08/06/1991	<50	180	5.4	<0.5	0.9	0.7	---	---	---	---	---	---	---	---	78.26	---	---	---
EW-1	10/30/1991	<50	70	2.6	<0.5	<0.5	<0.5	---	---	---	---	---	---	---	---	78.26	12.72	65.54	---
EW-1	02/15/1992	---	<50	2.1	<0.5	<0.5	<0.5	---	---	---	---	---	---	---	---	78.26	---	---	---
EW-1	03/18/1992	---	---	---	---	---	---	---	---	---	---	---	---	---	---	78.26	11.71	66.55	---
EW-1	05/22/1992	---	99	4.1	<0.5	<0.5	<0.5	---	---	---	---	---	---	---	---	78.26	12.84	65.42	---
EW-1	08/19/1992	---	140	6.6	<0.5	<0.5	<0.5	---	---	---	---	---	---	---	---	78.26	13.04	65.22	---
EW-1	11/18/1992	---	56	<0.5	<0.5	<0.5	<0.5	---	---	---	---	---	---	---	---	78.26	12.90	65.36	---
EW-1	02/11/1993	---	63	<0.5	<0.5	<0.5	0.9	---	---	---	---	---	---	---	---	78.26	11.28	66.98	---
EW-1 (D)	02/11/1993	---	63	<0.5	<0.5	<0.5	0.8	---	---	---	---	---	---	---	---	78.26	---	---	---
EW-1	05/19/1993	---	60 n	<0.5	<0.5	<0.5	<0.5	---	---	---	---	---	---	---	---	78.26	12.52	65.74	---
EW-1	08/18/1993	---	---	---	---	---	---	---	---	---	---	---	---	---	---	78.26	12.48	65.78	---
EW-1	11/17/1993	---	170	17	<0.5	<0.5	<0.5	---	---	---	---	---	---	---	---	78.26	12.63	65.63	---
EW-1 (D)	11/17/1993	---	190	17	<0.5	<0.5	<0.5	---	---	---	---	---	---	---	---	78.26	---	---	---
EW-1	02/18/1994	---	---	---	---	---	---	---	---	---	---	---	---	---	---	78.26	11.38	66.88	---
EW-1	05/26/1994	---	<50	3.5	<0.5	<0.5	0.51	---	---	---	---	---	---	---	---	78.26	12.02	66.24	---
EW-1	08/29/1994	---	---	---	---	---	---	---	---	---	---	---	---	---	---	78.26	12.76	65.50	---
EW-1	11/11/1994	---	200	13	0.88	<0.5	<0.5	---	---	---	---	---	---	---	---	78.26	11.08	67.18	---
EW-1	02/03/1995	---	---	---	---	---	---	---	---	---	---	---	---	---	---	78.26	10.88	67.38	---
EW-1	05/07/1995	---	90	8.6	<0.5	<0.5	<0.5	---	---	---	---	---	---	---	---	78.26	11.32	66.94	---
EW-1	08/02/1995	---	---	---	---	---	---	---	---	---	---	---	---	---	---	78.26	11.76	66.50	---
EW-1	11/02/1995	---	240	12	1.5	0.6	1.9	---	---	---	---	---	---	---	---	78.26	12.80	65.46	---
EW-1	02/24/1996	---	---	---	---	---	---	---	---	---	---	---	---	---	---	78.26	10.15	68.11	---
EW-1	05/04/1996	---	<50	1.4	<0.50	<0.50	<0.50	4.1	---	---	---	---	---	---	---	78.26	12.26	66.00	---
EW-1	09/07/1996	---	---	---	---	---	---	---	---	---	---	---	---	---	---	78.26	13.43	64.83	---
EW-1	11/24/1996	---	<50	<0.50	<0.50	<0.50	<0.50	<2.5	---	---	---	---	---	---	---	78.26	12.24	66.02	---
EW-1	02/23/1997	---	---	---	---	---	---	---	---	---	---	---	---	---	---	78.26	12.20	66.06	---
EW-1	05/01/1997	---	<50	<0.50	<0.50	<0.50	<0.50	<2.5	---	---	---	---	---	---	---	78.26	12.97	65.29	---
EW-1	07/22/1997	---	---	---	---	---	---	---	---	---	---	---	---	---	---	78.26	13.43	64.83	---
EW-1	11/04/1997	---	<50	<0.50	<0.50	<0.50	<0.50	<5.0	---	---	---	---	---	---	---	78.26	13.20	65.06	---
EW-1	01/21/1998	---	---	---	---	---	---	---	---	---	---	---	---	---	---	78.26	10.52	67.74	---
EW-1	05/11/1998	---	<50	<0.50	<0.50	<0.50	<0.50	<2.5	---	---	---	---	---	---	---	78.26	12.35	65.91	---
EW-1	08/11/1998	---	---	---	---	---	---	---	---	---	---	---	---	---	---	78.26	12.90	65.36	---
EW-1	10/20/1998	---	<50	<0.50	<0.50	<0.50	<0.50	<2.5	---	---	---	---	---	---	---	78.26	13.34	64.92	---

TABLE 1

**GROUNDWATER DATA  
FORMER SHELL SERVICE STATION  
500 40TH STREET, OAKLAND, CALIFORNIA**

Well ID	Date	TPHd (µg/L)	TPHg (µg/L)	B (µg/L)	T (µg/L)	E (µg/L)	X (µg/L)	MTBE		TBA (µg/L)	DIPE (µg/L)	ETBE (µg/L)	TAME (µg/L)	1,2-		TOC (ft MSL)	Depth to Water (ft TOC)	GW Elevation (ft MSL)	DO Reading (mg/L)
								8020 (µg/L)	8260 (µg/L)					DCA (µg/L)	EDB (µg/L)				
EW-1	02/08/1999	---	---	---	---	---	---	---	---	---	---	---	---	---	---	78.26	9.28	68.98	---
EW-1	04/12/1999	---	<50.0	<0.500	<0.500	<0.500	<0.500	<5.00	---	---	---	---	---	---	---	78.26	10.28	67.98	---
EW-1	07/27/1999	---	---	---	---	---	---	---	---	---	---	---	---	---	---	78.26	13.04	65.22	---
EW-1	10/25/1999	---	<50.0	0.885	<0.500	<0.500	<0.500	<5.00	---	---	---	---	---	---	---	78.26	13.12	65.14	---
EW-1	01/24/2000	---	---	---	---	---	---	---	---	---	---	---	---	---	---	78.26	10.50	67.76	2.0
EW-1	04/24/2000	---	<50.0	<0.500	<0.500	<0.500	<0.500	<2.50	---	---	---	---	---	---	---	78.26	12.05	66.21	1.8
EW-1	07/24/2000	---	---	---	---	---	---	---	---	---	---	---	---	---	---	78.26	13.00	65.26	---
EW-1	11/01/2000	---	<50.0	<0.500	<0.500	<0.500	<0.500	<2.50	---	---	---	---	---	---	---	78.26	12.15	66.11	2.4
EW-1	01/19/2001	---	---	---	---	---	---	---	---	---	---	---	---	---	---	78.26	12.24	66.02	4.4
EW-1	04/13/2001	---	<50.0	<0.500	<0.500	<0.500	<0.500	<2.50	---	---	---	---	---	---	---	78.26	12.56	65.70	5.8
EW-1	07/09/2001	---	---	---	---	---	---	---	---	---	---	---	---	---	---	78.26	12.97	65.29	4.2
EW-1	10/18/2001	---	<50	<0.50	<0.50	<0.50	<0.50	---	<5.0	---	---	---	---	---	---	78.26	13.69	64.57	0.3
EW-1	01/24/2002	---	---	---	---	---	---	---	---	---	---	---	---	---	---	78.26	11.98	66.28	---
EW-1	05/10/2002	---	<50	<0.50	<0.50	<0.50	<0.50	---	<5.0	---	---	---	---	---	---	78.26	12.68	65.58	2.3
EW-1	07/18/2002	Well inaccessible		---	---	---	---	---	---	---	---	---	---	---	---	78.26	---	---	---
EW-1	10/31/2002	---	<50	<0.50	<0.50	<0.50	<0.50	---	<5.0	---	---	---	---	---	---	81.11	13.38	67.73	---
EW-1	01/30/2003	---	---	---	---	---	---	---	---	---	---	---	---	---	---	81.11	11.43	69.68	---
EW-1	04/17/2003	---	<50	<0.50	<0.50	<0.50	<1.0	---	<5.0	---	---	---	---	---	---	81.11	11.55	69.56	---
EW-1	07/17/2003	---	---	---	---	---	---	---	---	---	---	---	---	---	---	81.11	12.84	68.27	---
EW-1	10/16/2003	---	<50	<0.50	<0.50	<0.50	<1.0	---	<0.50	---	---	---	---	---	---	81.11	13.00	68.11	---
EW-1	01/14/2004	---	---	---	---	---	---	---	---	---	---	---	---	---	---	81.11	11.15	69.96	---
EW-1	04/14/2004	---	---	---	---	---	---	---	---	---	---	---	---	---	---	81.11	12.41	68.70	---
EW-1	10/29/2004	---	---	---	---	---	---	---	---	---	---	---	---	---	---	81.11	12.08	69.03	---
EW-1	04/14/2005	Well destroyed		---	---	---	---	---	---	---	---	---	---	---	---	---	---	---	---
MW-2	08/06/1991	230	1,200	59	1.1	38	56	---	---	---	---	---	---	---	---	80.80	12.12	68.68	---
MW-2	10/30/1991	300	520	56	<0.5	56	100	---	---	---	---	---	---	---	---	80.80	11.70	69.10	---
MW-2	02/15/1992	2,200 n	2,300	87	<2.5	88	150	---	---	---	---	---	---	---	---	80.80	---	---	---
MW-2	03/18/1992	---	---	---	---	---	---	---	---	---	---	---	---	---	---	80.80	11.10	69.70	---
MW-2	05/22/1992	---	700	24	1.0	34	48	---	---	---	---	---	---	---	---	80.80	12.12	68.68	---
MW-2	08/19/1992	---	740	21	<2.5	24	26	---	---	---	---	---	---	---	---	80.80	12.18	68.62	---
MW-2 (D)	08/19/1992	---	840	31	<2.5	36	43	---	---	---	---	---	---	---	---	80.80	---	---	---
MW-2	11/18/1992	---	920	19	<2.5	30	51	---	---	---	---	---	---	---	---	80.80	12.03	68.77	---

TABLE 1

**GROUNDWATER DATA  
FORMER SHELL SERVICE STATION  
500 40TH STREET, OAKLAND, CALIFORNIA**

Well ID	Date	TPHd (µg/L)	TPHg (µg/L)	B (µg/L)	T (µg/L)	E (µg/L)	X (µg/L)	MTBE		TBA (µg/L)	DIPE (µg/L)	ETBE (µg/L)	TAME (µg/L)	1,2- DCA		EDB (µg/L)	TOC (ft MSL)	Depth to Water (ft TOC)	GW Elevation (ft MSL)	DO Reading (mg/L)
								8020 (µg/L)	8260 (µg/L)					µg/L	µg/L					
MW-2 (D)	11/18/1992	---	870	25	<2.5	34	52	---	---	---	---	---	---	---	---	---	80.80	---	---	---
MW-2	02/11/1993	---	1,000	25	6.0	43	73	---	---	---	---	---	---	---	---	---	80.80	11.15	69.65	---
MW-2	05/19/1993	---	570	19	<0.5	37	42	---	---	---	---	---	---	---	---	---	80.80	11.80	69.00	---
MW-2	08/18/1993	Well inaccessible	---	---	---	---	---	---	---	---	---	---	---	---	---	---	80.80	---	---	---
MW-2	11/17/1993	---	250	10	<1.0	26	20	---	---	---	---	---	---	---	---	---	80.80	12.00	68.80	---
MW-2	02/18/1994	Well inaccessible	---	---	---	---	---	---	---	---	---	---	---	---	---	---	80.80	---	---	---
MW-2	05/26/1994	---	620	17	1.4	25	31	---	---	---	---	---	---	---	---	---	80.80	11.61	69.19	---
MW-2 (D)	05/26/1994	---	600	16	1.2	24	29	---	---	---	---	---	---	---	---	---	80.80	---	---	---
MW-2	08/29/1994	---	---	---	---	---	---	---	---	---	---	---	---	---	---	---	80.80	11.96	68.84	---
MW-2	11/11/1994	---	1,100	28	3.1	39	65	---	---	---	---	---	---	---	---	---	80.80	10.74	70.06	---
MW-2	02/03/1995	---	---	---	---	---	---	---	---	---	---	---	---	---	---	---	80.80	11.58	69.22	---
MW-2	05/07/1995	---	700	15	<0.5	35	39	---	---	---	---	---	---	---	---	---	80.80	10.98	69.82	---
MW-2	08/02/1995	---	---	---	---	---	---	---	---	---	---	---	---	---	---	---	80.80	11.90	68.90	---
MW-2	11/02/1995	---	140	2.3	<0.5	4.4	3.7	---	---	---	---	---	---	---	---	---	80.80	12.12	68.68	---
MW-2	02/24/1996	---	---	---	---	---	---	---	---	---	---	---	---	---	---	---	80.80	10.25	70.55	---
MW-2	05/04/1996	---	140	2.1	<0.50	4.6	4.9	6.2	---	---	---	---	---	---	---	---	80.80	11.30	69.50	---
MW-2	09/07/1996	---	---	---	---	---	---	---	---	---	---	---	---	---	---	---	80.80	15.10	65.70	---
MW-2	11/24/1996	---	620	9.7	<0.50	2.0	46	<2.5	---	---	---	---	---	---	---	---	80.80	12.13	68.67	---
MW-2	02/23/1997	---	---	---	---	---	---	---	---	---	---	---	---	---	---	---	80.80	12.01	68.79	---
MW-2	05/01/1997	---	<50	<0.50	<0.50	<0.50	<0.50	<2.5	---	---	---	---	---	---	---	---	80.80	12.94	67.86	---
MW-2	07/22/1997	---	---	---	---	---	---	---	---	---	---	---	---	---	---	---	80.80	13.22	67.58	---
MW-2	11/04/1997	---	<50	<0.50	<0.50	<0.50	<0.50	<5.0	---	---	---	---	---	---	---	---	80.80	13.00	67.80	---
MW-2	01/21/1998	---	---	---	---	---	---	---	---	---	---	---	---	---	---	---	80.80	10.47	70.33	---
MW-2	05/11/1998	---	59	0.56	<0.50	<0.50	<0.50	<2.5	---	---	---	---	---	---	---	---	80.80	12.49	68.31	---
MW-2	08/11/1998	---	---	---	---	---	---	---	---	---	---	---	---	---	---	---	80.80	12.82	67.98	---
MW-2	10/20/1998	---	<50	<0.50	<0.50	<0.50	<0.50	<2.5	---	---	---	---	---	---	---	---	80.80	13.13	67.67	---
MW-2	02/08/1999	---	---	---	---	---	---	---	---	---	---	---	---	---	---	---	80.80	9.10	71.70	---
MW-2	04/12/1999	---	<50.0	<0.500	<0.500	<0.500	<0.500	<5.00	---	---	---	---	---	---	---	---	80.80	10.06	70.74	---
MW-2	07/27/1999	---	---	---	---	---	---	---	---	---	---	---	---	---	---	---	80.80	12.81	67.99	---
MW-2	10/25/1999	---	<50.0	<0.500	<0.500	<0.500	<0.500	<5.00	---	---	---	---	---	---	---	---	80.80	12.89	67.91	---
MW-2	01/24/2000	Well inaccessible	---	---	---	---	---	---	---	---	---	---	---	---	---	---	80.80	---	---	---
MW-2	04/24/2000	---	<50.0	<0.500	<0.500	<0.500	<0.500	<2.50	---	---	---	---	---	---	---	---	80.80	19.35	61.45	1.8
MW-2	07/24/2000	---	---	---	---	---	---	---	---	---	---	---	---	---	---	---	80.80	12.83	67.97	---

TABLE 1

**GROUNDWATER DATA  
FORMER SHELL SERVICE STATION  
500 40TH STREET, OAKLAND, CALIFORNIA**

Well ID	Date	TPHd (µg/L)	TPHg (µg/L)	B (µg/L)	T (µg/L)	E (µg/L)	X (µg/L)	MTBE		TBA (µg/L)	DIPE (µg/L)	ETBE (µg/L)	TAME (µg/L)	1,2- DCA		EDB (µg/L)	TOC (ft MSL)	Depth to Water (ft TOC)	GW Elevation (ft MSL)	DO Reading (mg/L)
								8020 (µg/L)	8260 (µg/L)					µg/L	µg/L					
MW-2	11/01/2000	---	53.2	<0.500	<0.500	<0.500	<0.500	<2.50	---	---	---	---	---	---	---	---	80.80	11.75	69.05	2.4
MW-2	01/19/2001	---	---	---	---	---	---	---	---	---	---	---	---	---	---	---	80.80	12.22	68.58	5.8
MW-2	04/13/2001	---	<50.0	<0.500	<0.500	<0.500	<0.500	<2.50	---	---	---	---	---	---	---	---	80.80	12.40	68.40	3.0
MW-2	07/09/2001	---	---	---	---	---	---	---	---	---	---	---	---	---	---	---	80.80	12.98	67.82	3.4
MW-2	10/18/2001	---	71	<0.50	<0.50	<0.50	<0.50	---	<5.0	---	---	---	---	---	---	---	80.80	12.87	67.93	0.7
MW-2	01/24/2002	---	---	---	---	---	---	---	---	---	---	---	---	---	---	---	80.80	12.13	68.67	1.4
MW-2	05/10/2002	---	74	<0.50	<0.50	<0.50	<0.50	---	<5.0	---	---	---	---	---	---	---	80.80	12.69	68.11	1.4
MW-2	07/18/2002	---	---	---	---	---	---	---	---	---	---	---	---	---	---	---	80.80	12.84	67.96	1.2
MW-2	10/31/2002	---	<50	<0.50	<0.50	<0.50	<0.50	---	<5.0	---	---	---	---	---	---	---	83.66	13.15	70.51	---
MW-2	01/30/2003	---	---	---	---	---	---	---	---	---	---	---	---	---	---	---	83.78 d	11.97	71.81	---
MW-2	04/17/2003	---	85	<0.50	<0.50	<0.50	<1.0	---	<5.0	---	---	---	---	---	---	---	83.78	12.19	71.59	---
MW-2	07/17/2003	---	---	---	---	---	---	---	---	---	---	---	---	---	---	---	83.78	12.57	71.21	---
MW-2	10/16/2003	---	<50	<0.50	<0.50	<0.50	<1.0	---	<0.50	---	---	---	---	---	---	---	83.78	13.13	70.65	---
MW-2	01/14/2004	---	---	---	---	---	---	---	---	---	---	---	---	---	---	---	83.78	11.58	72.20	---
MW-2	04/14/2004	---	73	<0.50	<0.50	<0.50	<1.0	---	<0.50	---	---	---	---	---	---	---	83.78	12.65	71.13	---
MW-2	10/29/2004	---	180	<0.50	<0.50	<0.50	<1.0	---	<0.50	<5.0	<2.0	<2.0	<2.0	---	---	---	83.78	12.39	71.39	---
MW-2	04/14/2005	---	150	<0.50	<0.50	<0.50	<1.0	---	<0.50	---	---	---	---	---	---	---	83.78	12.14	71.64	---
MW-2	10/26/2005	---	<50	<0.50	<0.50	<0.50	<1.0	---	<0.50	<5.0	<2.0	<2.0	<2.0	---	---	---	83.78	12.98	70.80	---
MW-2	03/16/2006	64.3	<50.0	<0.500	<0.500	<0.500	<0.500	---	<0.500	<10.0	<0.500	<0.500	<0.500	<0.500	<0.500	---	83.78	11.72	72.06	---
MW-2	09/20/2006	<47.2 g,i	<50.0	<0.500	<0.500	<0.500	<0.500	---	<0.500	<10.0	<0.500	<0.500	<0.500	---	---	---	83.78	12.55	71.23	---
MW-2	03/26/2007	<47 g	<50	<0.50	<0.50	<0.50	<0.50	---	<0.50	---	---	---	---	---	---	---	83.78	12.28	71.50	---
MW-2	06/25/2007	---	---	---	---	---	---	---	---	---	---	---	---	---	---	---	83.78	12.94	70.84	---
MW-2	09/10/2007	<50 g	<50 l	<0.50	<1.0	<1.0	<1.0	---	<1.0	<10	<2.0	<2.0	<2.0	---	---	---	83.78	13.12	70.66	---
MW-2	12/10/2007	---	---	---	---	---	---	---	---	---	---	---	---	---	---	---	83.78	12.44	71.34	---
MW-2	03/10/2008	---	---	---	---	---	---	---	---	---	---	---	---	---	---	---	83.78	12.34	71.44	---
MW-2	06/23/2008	---	---	---	---	---	---	---	---	---	---	---	---	---	---	---	83.78	13.10	70.68	---
MW-2	09/22/2008	---	---	---	---	---	---	---	---	---	---	---	---	---	---	---	83.78	13.02	70.76	---
MW-2	12/22/2008	---	---	---	---	---	---	---	---	---	---	---	---	---	---	---	83.78	12.10	71.68	---
MW-2	03/23/2009	---	---	---	---	---	---	---	---	---	---	---	---	---	---	---	83.78	12.10	71.68	---
MW-2	09/21/2009	---	---	---	---	---	---	---	---	---	---	---	---	---	---	---	83.78	13.00	70.78	---
MW-2	03/08/2010	---	---	---	---	---	---	---	---	---	---	---	---	---	---	---	83.78	12.22	71.56	---
MW-2	09/27/2010	---	---	---	---	---	---	---	---	---	---	---	---	---	---	---	83.78	12.70	71.08	---
MW-2	03/21/2011	---	---	---	---	---	---	---	---	---	---	---	---	---	---	---	83.78	10.82	72.96	---



TABLE 1

**GROUNDWATER DATA  
FORMER SHELL SERVICE STATION  
500 40TH STREET, OAKLAND, CALIFORNIA**

Well ID	Date	TPHd (µg/L)	TPHg (µg/L)	B (µg/L)	T (µg/L)	E (µg/L)	X (µg/L)	MTBE		TBA (µg/L)	DIPE (µg/L)	ETBE (µg/L)	TAME (µg/L)	1,2- DCA		EDB (µg/L)	TOC (ft MSL)	Depth to Water (ft TOC)	GW Elevation (ft MSL)	DO Reading (mg/L)
								8020 (µg/L)	8260 (µg/L)					µg/L	µg/L					
MW-2	09/26/2011	---	---	---	---	---	---	---	---	---	---	---	---	---	---	---	83.78	12.79	70.99	---
MW-2	03/26/2012	---	---	---	---	---	---	---	---	---	---	---	---	---	---	---	83.78	11.81	71.97	---
MW-3	08/06/1991	470	1,900	220	57	57	260	---	---	---	---	---	---	---	---	---	79.60	11.12	68.48	---
MW-3	10/30/1991	480	1,900	160	28	63	180	---	---	---	---	---	---	---	---	---	79.60	10.93	68.67	---
MW-3	02/15/1992	780 n	2,300	170	31	59	180	---	---	---	---	---	---	---	---	---	79.60	---	---	---
MW-3	03/18/1992	---	---	---	---	---	---	---	---	---	---	---	---	---	---	---	79.60	10.54	69.06	---
MW-3	05/22/1992	---	1,500	160	20	44	140	---	---	---	---	---	---	---	---	---	79.60	10.79	68.81	---
MW-3	08/19/1992	---	4,500	210	64	89	310	---	---	---	---	---	---	---	---	---	79.60	11.23	68.37	---
MW-3	11/18/1992	---	2,400	81	14	39	140	---	---	---	---	---	---	---	---	---	79.60	11.20	68.40	---
MW-3	02/11/1993	---	3,000	200	47	90	260	---	---	---	---	---	---	---	---	---	79.60	11.00	68.60	---
MW-3	05/19/1993	---	2,100	240	44	100	330	---	---	---	---	---	---	---	---	---	79.60	11.16	68.44	---
MW-3	08/18/1993	---	---	---	---	---	---	---	---	---	---	---	---	---	---	---	79.60	11.35	68.25	---
MW-3	11/17/1993	---	1,000	110	13	60	150	---	---	---	---	---	---	---	---	---	79.60	11.10	68.50	---
MW-3	02/18/1994	---	---	---	---	---	---	---	---	---	---	---	---	---	---	---	79.60	10.76	68.84	---
MW-3	05/26/1994	---	1,100	200	17	29	58	---	---	---	---	---	---	---	---	---	79.60	11.85	67.75	---
MW-3	08/29/1994	---	---	---	---	---	---	---	---	---	---	---	---	---	---	---	79.60	10.40	69.20	---
MW-3	11/11/1994	---	870	130	10	38	87	---	---	---	---	---	---	---	---	---	79.60	10.04	69.56	---
MW-3 (D)	11/11/1994	---	1,000	120	10	42	92	---	---	---	---	---	---	---	---	---	79.60	---	---	---
MW-3	02/03/1995	---	---	---	---	---	---	---	---	---	---	---	---	---	---	---	79.60	10.06	69.54	---
MW-3	05/07/1995	---	1,300	180	7.5	54	110	---	---	---	---	---	---	---	---	---	79.60	10.11	69.49	---
MW-3	08/02/1995	---	---	---	---	---	---	---	---	---	---	---	---	---	---	---	79.60	11.02	68.58	---
MW-3	11/02/1995	---	370	36	1.8	16	21	---	---	---	---	---	---	---	---	---	79.60	10.97	68.63	---
MW-3	02/24/1996	---	---	---	---	---	---	---	---	---	---	---	---	---	---	---	79.60	9.61	69.99	---
MW-3	05/04/1996	---	460	54	1.9	18	28	20	---	---	---	---	---	---	---	---	79.60	10.40	69.20	---
MW-3	09/07/1996	---	---	---	---	---	---	---	---	---	---	---	---	---	---	---	79.60	13.55	66.05	---
MW-3	11/24/1996	---	2,800	290	<10	29	39	<50	---	---	---	---	---	---	---	---	79.60	11.83	67.77	---
MW-3	02/23/1997	---	---	---	---	---	---	---	---	---	---	---	---	---	---	---	79.60	11.81	67.79	---
MW-3	05/01/1997	---	2,000	120	<5.0	53	14	60	---	---	---	---	---	---	---	---	79.60	12.34	67.26	---
MW-3	07/22/1997	---	---	---	---	---	---	---	---	---	---	---	---	---	---	---	79.60	12.86	66.74	---
MW-3	11/04/1997	---	470	120	<2.5	<2.5	7.3	<25	---	---	---	---	---	---	---	---	79.60	12.62	66.98	---
MW-3	01/21/1998	---	---	---	---	---	---	---	---	---	---	---	---	---	---	---	79.60	10.78	68.82	---
MW-3	05/11/1998	---	4,400	260	<10	220	36	170	---	---	---	---	---	---	---	---	79.60	11.98	67.62	---

TABLE 1

GROUNDWATER DATA  
FORMER SHELL SERVICE STATION  
500 40TH STREET, OAKLAND, CALIFORNIA

Well ID	Date	TPHd (µg/L)	TPHg (µg/L)	B (µg/L)	T (µg/L)	E (µg/L)	X (µg/L)	MTBE		TBA (µg/L)	DIPE (µg/L)	ETBE (µg/L)	TAME (µg/L)	1,2- DCA		EDB (µg/L)	TOC (ft MSL)	Depth to Water (ft TOC)	GW Elevation (ft MSL)	DO Reading (mg/L)
								8020 (µg/L)	8260 (µg/L)					µg/L	µg/L					
MW-3	08/11/1998	---	---	---	---	---	---	---	---	---	---	---	---	---	---	---	79.60	12.38	67.22	---
MW-3	10/20/1998	---	1,700	120	<2.0	18	7.1	19	---	---	---	---	---	---	---	79.60	12.55	67.05	---	
MW-3 (D)	10/20/1998	---	1,400	120	<5.0	18	<5.0	80	---	---	---	---	---	---	---	79.60	---	---	---	
MW-3	02/08/1999	---	---	---	---	---	---	---	---	---	---	---	---	---	---	79.60	8.53	71.07	---	
MW-3	04/12/1999	---	8,040	554	30	436	624	160	---	---	---	---	---	---	---	79.60	10.19	69.41	---	
MW-3	07/27/1999	---	---	---	---	---	---	---	---	---	---	---	---	---	---	79.60	12.21	67.39	---	
MW-3	10/25/1999	---	827	31	2.23	14.5	6.71	<10.0	---	---	---	---	---	---	---	79.60	12.35	67.25	---	
MW-3	01/24/2000	Well inaccessible		---	---	---	---	---	---	---	---	---	---	---	---	79.60	---	---	---	
MW-3	04/24/2000	---	1,470	121	<5.00	63.8	14.1	<25.0	---	---	---	---	---	---	---	79.60	11.75	67.85	1.0	
MW-3	07/24/2000	---	---	---	---	---	---	---	---	---	---	---	---	---	---	79.60	12.56	67.04	---	
MW-3	11/01/2000	---	1,550	143	<1.25	36.4	35.3	24.4	---	---	---	---	---	---	---	79.60	11.48	68.12	2.2	
MW-3	01/19/2001	---	---	---	---	---	---	---	---	---	---	---	---	---	---	79.60	11.83	67.77	6.6	
MW-3	04/13/2001	---	2,560	250	<10.0	108	<10.0	92.1	---	---	---	---	---	---	---	79.60	12.08	67.52	3.6	
MW-3	07/09/2001	---	---	---	---	---	---	---	---	---	---	---	---	---	---	79.60	12.68	66.92	2.8	
MW-3	10/18/2001	---	2,300	150	0.90	42	11	---	<5.0	---	---	---	---	---	---	79.60	13.21	66.39	0.1	
MW-3	01/24/2002	---	---	---	---	---	---	---	---	---	---	---	---	---	---	79.60	11.83	67.77	2.3	
MW-3	05/10/2002	---	3,300	77	0.60	94	3.1	---	<5.0	---	---	---	---	---	---	79.60	12.24	67.36	1.5	
MW-3	07/18/2002	---	---	---	---	---	---	---	---	---	---	---	---	---	---	79.60	12.43	67.17	2.1	
MW-3	10/31/2002	---	2,100	89	0.57	26	5.7	---	<5.0	---	---	---	---	---	---	82.46	12.60	69.86	2.0	
MW-3	01/30/2003	---	---	---	---	---	---	---	---	---	---	---	---	---	---	82.46	11.76	70.70	4.6	
MW-3	04/17/2003	---	2,100	55	0.79	100	110	---	<5.0	---	---	---	---	---	---	82.46	11.80	70.66	1.8	
MW-3	07/17/2003	---	---	---	---	---	---	---	---	---	---	---	---	---	---	82.46	12.28	70.18	4.0	
MW-3	10/16/2003	---	120 n	<0.50	<0.50	<0.50	<1.0	---	<0.50	---	---	---	---	---	---	82.46	12.35	70.11	2.0	
MW-3	01/14/2004	---	---	---	---	---	---	---	---	---	---	---	---	---	---	82.46	11.35	71.11	2.9	
MW-3	04/14/2004	---	130	1.6	<0.50	1.5	<1.0	---	<0.50	---	---	---	---	---	---	82.46	12.12	70.34	3.4	
MW-3	10/29/2004	---	490	11	<0.50	19	18	---	<0.50	<5.0	<2.0	<2.0	<2.0	---	---	82.46	11.67	70.79	1.2	
MW-3	04/14/2005	---	<50	<0.50	<0.50	<0.50	<1.0	---	<0.50	---	---	---	---	---	---	82.46	11.65	70.81	0.1	
MW-3	10/26/2005	---	230	2.8	<0.50	0.52	<1.0	---	<0.50	<5.0	<2.0	<2.0	<2.0	---	---	82.46	12.43	70.03	0.2	
MW-3	03/16/2006	191	107	12.5	<0.500	1.27	0.960	---	<0.500	<10.0	<0.500	<0.500	<0.500	<0.500	<0.500	82.46	10.62	71.84	---	
MW-3	09/20/2006	55.2 g	671	4.23	<0.500	<0.500	<0.500	---	<0.500	<10.0	<0.500	<0.500	<0.500	---	---	82.46	12.03	70.43	4.83	
MW-3	03/26/2007	<47 g	120	2.6	<0.50	<0.50	<0.50 ij	---	<0.50	---	---	---	---	---	---	82.46	11.84	70.62	1.0	
MW-3	06/25/2007	---	---	---	---	---	---	---	---	---	---	---	---	---	---	82.46	12.21	70.25	0.04	
MW-3	09/10/2007	<50 g	3901	6.0	<1.0	1.1	1.4	---	<1.0	<10	<2.0	<2.0	<2.0	---	---	82.46	12.14	70.32	0.22	

TABLE 1

**GROUNDWATER DATA  
FORMER SHELL SERVICE STATION  
500 40TH STREET, OAKLAND, CALIFORNIA**

Well ID	Date	TPHd (µg/L)	TPHg (µg/L)	B (µg/L)	T (µg/L)	E (µg/L)	X (µg/L)	MTBE		TBA (µg/L)	DIPE (µg/L)	ETBE (µg/L)	TAME (µg/L)	1,2- DCA		EDB (µg/L)	TOC (ft MSL)	Depth to Water (ft TOC)	GW Elevation (ft MSL)	DO Reading (mg/L)
								8020 (µg/L)	8260 (µg/L)					µg/L	µg/L					
MW-3	12/10/2007	---	---	---	---	---	---	---	---	---	---	---	---	---	---	---	82.46	11.81	70.65	0.40
MW-3	03/10/2008	84 g	75	1.0	<1.0	<1.0	<1.0	---	<1.0	---	---	---	---	---	---	---	82.46	11.80	70.66	0.52
MW-3	06/23/2008	---	---	---	---	---	---	---	---	---	---	---	---	---	---	---	82.46	12.40	70.06	---
MW-3	09/22/2008	250 g,n	810	7.5	<1.0	<1.0	1.7	---	<1.0	<10	<2.0	<2.0	<2.0	---	---	---	82.46	12.65	69.81	0.25
MW-3	12/22/2008	---	---	---	---	---	---	---	---	---	---	---	---	---	---	---	82.46	11.51	70.95	---
MW-3	03/23/2009	610 g,n	2,000	14	<1.0	140	13	---	<1.0	---	---	---	---	---	---	---	82.46	11.44	71.02	0.33
MW-3	09/21/2009	350 g,n	1,100	4.6	<1.0	3.9	<1.0	---	<1.0	<10	<2.0	<2.0	<2.0	---	---	---	82.46	12.20	70.26	0.43
MW-3	03/08/2010	540 g,n	1,400	5.6	<1.0	50	<1.0	---	<1.0	---	---	---	---	---	---	---	82.46	10.95	71.51	0.52
MW-3	09/27/2010	300 g,n	1,000	2.0	<1.0	3.7	<1.0	---	<1.0	<10	<2.0	<2.0	<2.0	---	---	---	82.46	12.34	70.12	1.51
MW-3	03/21/2011	310 g,o	710	3.1	<0.50	5.2	<1.0	---	<1.0	---	---	---	---	---	---	---	82.46	10.63	71.83	1.42
MW-3	09/26/2011	200 g	750	2.9	<0.50	1.5	<1.0	---	<1.0	<10	<1.0	<1.0	<1.0	---	---	---	82.46	12.54	69.92	0.64
<b>MW-3</b>	<b>03/26/2012</b>	<b>210 g</b>	<b>510</b>	<b>1.9</b>	<b>&lt;0.50</b>	<b>12</b>	<b>&lt;1.0</b>	---	<b>&lt;0.50</b>	---	---	---	---	---	---	---	<b>82.46</b>	<b>10.60</b>	<b>71.86</b>	<b>1.16</b>
MW-4	08/06/1991	<50	<50	<0.5	<0.5	<0.5	<0.5	---	---	---	---	---	---	---	---	---	81.00	12.36	68.64	---
MW-4	10/30/1991	<50	50	<0.5	<0.5	<0.5	<0.5	---	---	---	---	---	---	---	---	---	81.00	12.02	68.98	---
MW-4	02/15/1992	---	90	0.9	<0.5	<0.5	<0.5	---	---	---	---	---	---	---	---	---	81.00	---	---	---
MW-4	03/18/1992	---	---	---	---	---	---	---	---	---	---	---	---	---	---	---	81.00	11.34	69.66	---
MW-4	05/22/1992	---	<50	<0.5	<0.5	<0.5	<0.5	---	---	---	---	---	---	---	---	---	81.00	12.35	68.65	---
MW-4	08/19/1992	---	82 n	<0.5	<0.5	<0.5	<0.5	---	---	---	---	---	---	---	---	---	81.00	12.41	68.59	---
MW-4	11/18/1992	---	85 n	<0.5	<0.5	<0.5	<0.5	---	---	---	---	---	---	---	---	---	81.00	12.28	68.72	---
MW-4	02/11/1993	---	62 n	<0.5	<0.5	<0.5	<0.5	---	---	---	---	---	---	---	---	---	81.00	11.65	69.35	---
MW-4	05/19/1993	---	<50	<0.5	<0.5	<0.5	<0.5	---	---	---	---	---	---	---	---	---	81.00	11.92	69.08	---
MW-4	08/18/1993	Well inaccessible		---	---	---	---	---	---	---	---	---	---	---	---	---	81.00	---	---	---
MW-4	11/17/1993	---	<50	<0.5	<0.5	<0.5	<0.5	---	---	---	---	---	---	---	---	---	81.00	12.24	68.76	---
MW-4	02/18/1994	---	---	---	---	---	---	---	---	---	---	---	---	---	---	---	81.00	11.69	69.31	---
MW-4	05/26/1994	---	<50	<0.5	<0.5	<0.5	<0.5	---	---	---	---	---	---	---	---	---	81.00	12.00	69.00	---
MW-4	11/11/1994	---	<50	<0.5	<0.5	<0.5	<0.5	---	---	---	---	---	---	---	---	---	81.00	11.30	69.70	---
MW-4	02/03/1995	---	---	---	---	---	---	---	---	---	---	---	---	---	---	---	81.00	10.99	70.01	---
MW-4	05/07/1995	---	<50	<0.5	<0.5	<0.5	<0.5	---	---	---	---	---	---	---	---	---	81.00	11.69	69.31	---
MW-4	08/02/1995	---	---	---	---	---	---	---	---	---	---	---	---	---	---	---	81.00	11.72	69.28	---
MW-4	11/02/1995	---	<50	<0.5	<0.5	<0.5	<0.5	---	---	---	---	---	---	---	---	---	81.00	12.23	68.77	---
MW-4	02/24/1996	---	---	---	---	---	---	---	---	---	---	---	---	---	---	---	81.00	11.13	69.87	---
MW-4	05/04/1996	---	<50	<0.50	<0.50	<0.50	<0.50	<2.5	---	---	---	---	---	---	---	---	81.00	11.80	69.20	---

TABLE 1

**GROUNDWATER DATA  
FORMER SHELL SERVICE STATION  
500 40TH STREET, OAKLAND, CALIFORNIA**

Well ID	Date	TPHd (µg/L)	TPHg (µg/L)	B (µg/L)	T (µg/L)	E (µg/L)	X (µg/L)	MTBE		TBA (µg/L)	DIPE (µg/L)	ETBE (µg/L)	TAME (µg/L)	1,2- DCA		EDB (µg/L)	TOC (ft MSL)	Depth to Water (ft TOC)	GW Elevation (ft MSL)	DO Reading (mg/L)
								8020 (µg/L)	8260 (µg/L)					µg/L	µg/L					
MW-4	09/07/1996	---	---	---	---	---	---	---	---	---	---	---	---	---	---	---	81.00	13.27	67.73	---
MW-4	11/24/1996	---	<50	<0.50	<0.50	<0.50	<0.50	<2.5	---	---	---	---	---	---	---	---	81.00	12.42	68.58	---
MW-4	02/23/1997	---	---	---	---	---	---	---	---	---	---	---	---	---	---	---	81.00	12.38	68.62	---
MW-4	05/01/1997	---	<50	<0.50	<0.50	<0.50	<0.50	<2.5	---	---	---	---	---	---	---	---	81.00	13.08	67.92	---
MW-4	07/22/1997	---	---	---	---	---	---	---	---	---	---	---	---	---	---	---	81.00	13.73	67.27	---
MW-4	11/04/1997	Well inaccessible		---	---	---	---	---	---	---	---	---	---	---	---	---	81.00	---	---	---
MW-4	01/21/1998	---	---	---	---	---	---	---	---	---	---	---	---	---	---	---	81.00	11.41	69.59	---
MW-4	05/11/1998	Well inaccessible		---	---	---	---	---	---	---	---	---	---	---	---	---	81.00	---	---	---
MW-4	08/11/1998	---	---	---	---	---	---	---	---	---	---	---	---	---	---	---	81.00	13.05	67.95	---
MW-4	10/20/1998	---	<50	<0.50	<0.50	<0.50	<0.50	<2.5	---	---	---	---	---	---	---	---	81.00	13.30	67.70	---
MW-4	02/08/1999	---	---	---	---	---	---	---	---	---	---	---	---	---	---	---	81.00	9.19	71.81	---
MW-4	04/12/1999	---	<50.0	<0.500	<0.500	<0.500	<0.500	<5.00	---	---	---	---	---	---	---	---	81.00	9.26	71.74	---
MW-4	07/27/1999	---	---	---	---	---	---	---	---	---	---	---	---	---	---	---	81.00	12.57	68.43	---
MW-4	10/25/1999	---	<50.0	<0.500	<0.500	<0.500	<0.500	<5.00	---	---	---	---	---	---	---	---	81.00	13.15	67.85	---
MW-4	01/24/2000	Well inaccessible		---	---	---	---	---	---	---	---	---	---	---	---	---	81.00	---	---	---
MW-4	04/24/2000	---	<50.0	<0.500	<0.500	<0.500	<0.500	14.5	---	---	---	---	---	---	---	---	81.00	12.55	68.45	2.5
MW-4	07/24/2000	---	---	---	---	---	---	---	---	---	---	---	---	---	---	---	81.00	13.31	67.69	---
MW-4	11/01/2000	---	<50.0	<0.500	<0.500	<0.500	<0.500	<2.50	---	---	---	---	---	---	---	---	81.00	12.09	68.91	2.8
MW-4	01/19/2001	---	---	---	---	---	---	---	---	---	---	---	---	---	---	---	81.00	12.58	68.42	8.4
MW-4	04/13/2001	---	<50.0	<0.500	<0.500	<0.500	<0.500	<2.50	---	---	---	---	---	---	---	---	81.00	12.75	68.25	2.6
MW-4	07/09/2001	---	---	---	---	---	---	---	---	---	---	---	---	---	---	---	81.00	13.30	67.70	4.2
MW-4	10/18/2001	---	<50	<0.50	<0.50	<0.50	<0.50	---	<5.0	---	---	---	---	---	---	---	81.00	13.45	67.55	1.4
MW-4	01/24/2002	---	---	---	---	---	---	---	---	---	---	---	---	---	---	---	81.00	12.55	68.45	---
MW-4	05/10/2002	---	<50	<0.50	<0.50	<0.50	<0.50	---	<5.0	---	---	---	---	---	---	---	81.00	12.93	68.07	1.5
MW-4	07/18/2002	---	---	---	---	---	---	---	---	---	---	---	---	---	---	---	81.00	13.13	67.87	1.4
MW-4	10/31/2002	---	<50	<0.50	<0.50	<0.50	<0.50	---	<5.0	---	---	---	---	---	---	---	83.92	13.40	70.52	---
MW-4	01/30/2003	---	---	---	---	---	---	---	---	---	---	---	---	---	---	---	83.92	12.44	71.48	---
MW-4	04/17/2003	---	<50	<0.50	<0.50	<0.50	<1.0	---	<5.0	---	---	---	---	---	---	---	83.92	12.24	71.68	---
MW-4	07/17/2003	---	---	---	---	---	---	---	---	---	---	---	---	---	---	---	83.92	13.02	70.90	---
MW-4	10/16/2003	---	<50	<0.50	<0.50	<0.50	<1.0	---	<0.50	---	---	---	---	---	---	---	83.92	13.15	70.77	---
MW-4	01/14/2004	---	---	---	---	---	---	---	---	---	---	---	---	---	---	---	83.92	12.20	71.72	---
MW-4	04/14/2004	---	---	---	---	---	---	---	---	---	---	---	---	---	---	---	83.92	12.80	71.12	---
MW-4	10/29/2004	---	---	---	---	---	---	---	---	---	---	---	---	---	---	---	83.92	12.41	71.51	---

TABLE 1

**GROUNDWATER DATA  
FORMER SHELL SERVICE STATION  
500 40TH STREET, OAKLAND, CALIFORNIA**

Well ID	Date	TPHd (µg/L)	TPHg (µg/L)	B (µg/L)	T (µg/L)	E (µg/L)	X (µg/L)	MTBE		TBA (µg/L)	DIPE (µg/L)	ETBE (µg/L)	TAME (µg/L)	1,2- DCA (µg/L)	EDB (µg/L)	TOC (ft MSL)	Depth to Water (ft TOC)	GW Elevation (ft MSL)	DO Reading (mg/L)
								8020 (µg/L)	8260 (µg/L)										
MW-4	04/14/2005	Well destroyed		---	---	---	---	---	---	---	---	---	---	---	---	---	---	---	---
MW-5	08/06/1991	<50	<50	<0.5	<0.5	<0.5	<0.5	---	---	---	---	---	---	---	---	81.50	13.02	68.48	---
MW-5	10/30/1991	<50	<50	<0.5	<0.5	<0.5	<0.5	---	---	---	---	---	---	---	---	81.50	12.73	68.77	---
MW-5	02/15/1992	---	<50	<0.5	<0.5	<0.5	<0.5	---	---	---	---	---	---	---	---	81.50	---	---	---
MW-5	03/18/1992	---	---	---	---	---	---	---	---	---	---	---	---	---	---	81.50	12.52	68.98	---
MW-5	05/22/1992	---	<50	<0.5	<0.5	<0.5	<0.5	---	---	---	---	---	---	---	---	81.50	13.05	68.45	---
MW-5	08/19/1992	---	55 n	<0.5	<0.5	<0.5	<0.5	---	---	---	---	---	---	---	---	81.50	13.04	68.46	---
MW-5	11/18/1992	---	<50	<0.5	<0.5	<0.5	<0.5	---	---	---	---	---	---	---	---	81.50	12.91	68.59	---
MW-5	02/11/1993	---	59 n	<0.5	<0.5	<0.5	<0.5	---	---	---	---	---	---	---	---	81.50	12.44	69.06	---
MW-5	05/19/1993	---	<50	<0.5	<0.5	<0.5	<0.5	---	---	---	---	---	---	---	---	81.50	12.84	68.66	---
MW-5 (D)	05/19/1993	---	<50	<0.5	<0.5	<0.5	<0.5	---	---	---	---	---	---	---	---	81.50	---	---	---
MW-5	11/17/1993	---	<50	<0.5	<0.5	<0.5	<0.5	---	---	---	---	---	---	---	---	81.50	12.89	68.61	---
MW-5	02/18/1994	---	---	---	---	---	---	---	---	---	---	---	---	---	---	81.50	12.30	69.20	---
MW-5	05/26/1994	---	<50	1.8	2.4	1.3	4.9	---	---	---	---	---	---	---	---	81.50	12.73	68.77	---
MW-5	08/29/1994	---	---	---	---	---	---	---	---	---	---	---	---	---	---	81.50	12.88	68.62	---
MW-5	11/11/1994	---	<50	<0.5	<0.5	<0.5	<0.5	---	---	---	---	---	---	---	---	81.50	12.20	69.30	---
MW-5	02/03/1995	---	---	---	---	---	---	---	---	---	---	---	---	---	---	81.50	11.78	69.72	---
MW-5	05/07/1995	---	<50	<0.5	<0.5	<0.5	<0.5	---	---	---	---	---	---	---	---	81.50	12.47	69.03	---
MW-5	08/02/1995	---	---	---	---	---	---	---	---	---	---	---	---	---	---	81.50	12.83	68.67	---
MW-5	11/02/1995	---	<50	<0.5	<0.5	<0.5	<0.5	---	---	---	---	---	---	---	---	81.50	13.02	68.48	---
MW-5	02/24/1996	---	---	---	---	---	---	---	---	---	---	---	---	---	---	81.50	12.11	69.39	---
MW-5	05/04/1996	---	<50	<0.50	<0.50	<0.50	<0.50	<2.5	---	---	---	---	---	---	---	81.50	13.20	68.30	---
MW-5	09/07/1996	---	---	---	---	---	---	---	---	---	---	---	---	---	---	81.50	14.24	67.26	---
MW-5	11/24/1996	---	<50	<0.50	<0.5	<0.50	<0.50	<2.5	---	---	---	---	---	---	---	81.50	13.58	67.92	---
MW-5	02/23/1997	---	---	---	---	---	---	---	---	---	---	---	---	---	---	81.50	13.54	67.96	---
MW-5	05/01/1997	---	<50	<0.50	<0.50	<0.50	<0.50	<2.5	---	---	---	---	---	---	---	81.50	14.17	67.33	---
MW-5	07/22/1997	---	---	---	---	---	---	---	---	---	---	---	---	---	---	81.50	14.35	67.15	---
MW-5	11/04/1997	---	<50	<0.50	<0.50	<0.50	<0.50	<2.5	---	---	---	---	---	---	---	81.50	14.30	67.20	---
MW-5 (D)	11/04/1997	---	<50	<0.50	<0.50	<0.50	<0.50	<2.5	---	---	---	---	---	---	---	81.50	---	---	---
MW-5	01/21/1998	---	---	---	---	---	---	---	---	---	---	---	---	---	---	81.50	12.86	68.64	---
MW-5	05/11/1998	---	<50	<0.50	<0.50	<0.50	<0.50	<2.5	---	---	---	---	---	---	---	81.50	13.89	67.61	---
MW-5	08/11/1998	---	---	---	---	---	---	---	---	---	---	---	---	---	---	81.50	14.20	67.30	---

TABLE 1

**GROUNDWATER DATA  
FORMER SHELL SERVICE STATION  
500 40TH STREET, OAKLAND, CALIFORNIA**

Well ID	Date	TPHd (µg/L)	TPHg (µg/L)	B (µg/L)	T (µg/L)	E (µg/L)	X (µg/L)	MTBE		TBA (µg/L)	DIPE (µg/L)	ETBE (µg/L)	TAME (µg/L)	1,2-		TOC (ft MSL)	Depth to Water (ft TOC)	GW Elevation (ft MSL)	DO Reading (mg/L)
								8020 (µg/L)	8260 (µg/L)					DCA (µg/L)	EDB (µg/L)				
MW-5	10/20/1998	---	<50	<0.50	<0.50	<0.50	<0.50	<2.5	---	---	---	---	---	---	---	81.50	14.41	67.09	---
MW-5	02/08/1999	---	---	---	---	---	---	---	---	---	---	---	---	---	---	81.50	10.31	71.19	---
MW-5	04/12/1999	---	<50.0	<0.500	<0.500	<0.500	<0.500	<5.00	---	---	---	---	---	---	---	81.50	11.30	70.20	---
MW-5	07/27/1999	---	---	---	---	---	---	---	---	---	---	---	---	---	---	81.50	12.63	68.87	---
MW-5	10/25/1999	---	<50.0	<0.500	<0.500	<0.500	<0.500	<5.00	---	---	---	---	---	---	---	81.50	14.15	67.35	---
MW-5	01/24/2000	---	---	---	---	---	---	---	---	---	---	---	---	---	---	81.50	11.65	69.85	1.8
MW-5	04/24/2000	---	<50.0	<0.500	<0.500	<0.500	<0.500	<2.50	---	---	---	---	---	---	---	81.50	13.71	67.79	2.1
MW-5	07/24/2000	---	---	---	---	---	---	---	---	---	---	---	---	---	---	81.50	14.48	67.02	---
MW-5	11/01/2000	---	<50.0	<0.500	<0.500	<0.500	<0.500	<2.50	---	---	---	---	---	---	---	81.50	13.26	68.24	3.2
MW-5	01/19/2001	---	---	---	---	---	---	---	---	---	---	---	---	---	---	81.50	13.68	67.82	7.8
MW-5	04/13/2001	---	<50.0	<0.500	<0.500	<0.500	<0.500	<2.50	---	---	---	---	---	---	---	81.50	13.90	67.60	3.2
MW-5	07/09/2001	---	---	---	---	---	---	---	---	---	---	---	---	---	---	81.50	14.72	66.78	4.8
MW-5	10/18/2001	---	<50	<0.50	<0.50	<0.50	<0.50	---	<5.0	---	---	---	---	---	---	81.50	14.41	67.09	1.1
MW-5	01/24/2002	---	---	---	---	---	---	---	---	---	---	---	---	---	---	81.50	13.69	67.81	1.4
MW-5	05/10/2002	---	<50	<0.50	<0.50	<0.50	<0.50	---	<5.0	---	---	---	---	---	---	81.50	14.05	67.45	2.2
MW-5	07/18/2002	---	---	---	---	---	---	---	---	---	---	---	---	---	---	81.50	14.23	67.27	1.2
MW-5	10/31/2002	---	<50	<0.50	<0.50	<0.50	<0.50	---	<5.0	---	---	---	---	---	---	84.36	14.36	70.00	2.8
MW-5	01/30/2003	---	---	---	---	---	---	---	---	---	---	---	---	---	---	84.36	13.70	70.66	2.4
MW-5	04/17/2003	---	<50	<0.50	<0.50	<0.50	<1.0	---	<5.0	---	---	---	---	---	---	84.36	13.52	70.84	2.6
MW-5	07/17/2003	---	---	---	---	---	---	---	---	---	---	---	---	---	---	84.36	14.13	70.23	1.6
MW-5	10/16/2003	---	<50	<0.50	<0.50	<0.50	<1.0	---	<0.50	---	---	---	---	---	---	84.36	14.21	70.15	2.1
MW-5	01/14/2004	---	---	---	---	---	---	---	---	---	---	---	---	---	---	84.36	14.15	70.21	3.1
MW-5	04/14/2004	---	---	---	---	---	---	---	---	---	---	---	---	---	---	84.36	13.95	70.41	2.5
MW-5	10/29/2004	---	---	---	---	---	---	---	---	---	---	---	---	---	---	84.36	13.63	70.73	0.8
MW-5	04/14/2005	Well destroyed		---	---	---	---	---	---	---	---	---	---	---	---	---	---	---	0.8
OMW-6	08/06/1991	3,600	26,000	910	420	560	1,900	---	---	---	---	---	---	---	---	77.90	10.71	67.19	---
OMW-6	10/30/1991	4,600	20,000	710	240	410	1,700	---	---	---	---	---	---	---	---	77.90	10.50	67.40	---
OMW-6	02/15/1992	27,000	35,000	690	420	650	3,000	---	---	---	---	---	---	---	---	77.90	---	---	---
OMW-6	03/18/1992	---	---	---	---	---	---	---	---	---	---	---	---	---	---	77.90	9.24	68.66	---
OMW-6	05/22/1992	---	15,000	460	110	300	1,600	---	---	---	---	---	---	---	---	77.90	10.13	67.77	---
OMW-6	08/19/1992	---	24,000	600	300	460	2,000	---	---	---	---	---	---	---	---	77.90	10.16	67.74	---
OMW-6	11/18/1992	---	29,000	480	250	450	2,300	---	---	---	---	---	---	---	---	77.90	9.94	67.96	---

**GROUNDWATER DATA  
FORMER SHELL SERVICE STATION  
500 40TH STREET, OAKLAND, CALIFORNIA**

Well ID	Date	TPHd (µg/L)	TPHg (µg/L)	B (µg/L)	T (µg/L)	E (µg/L)	X (µg/L)	MTBE		TBA (µg/L)	DIPE (µg/L)	ETBE (µg/L)	TAME (µg/L)	1,2- DCA		EDB (µg/L)	TOC (ft MSL)	Depth to Water (ft TOC)	GW Elevation (ft MSL)	DO Reading (mg/L)
								8020 (µg/L)	8260 (µg/L)					µg/L	µg/L					
OMW-6	02/11/1993	---	24,000	1,300	250	630	2,400	---	---	---	---	---	---	---	---	---	77.90	9.20	68.70	---
OMW-6	05/19/1993	---	18,000	750	180	520	2,500	---	---	---	---	---	---	---	---	---	77.90	10.64	67.86	---
OMW-6	08/18/1993	---	---	---	---	---	---	---	---	---	---	---	---	---	---	---	77.90	10.04	67.86	---
OMW-6	11/17/1993	---	14,000	260	64	430	1,900	---	---	---	---	---	---	---	---	---	77.90	10.12	67.78	---
OMW-6	02/18/1994	---	---	---	---	---	---	---	---	---	---	---	---	---	---	---	77.90	9.65	68.25	---
OMW-6	05/26/1994	Well inaccessible	---	---	---	---	---	---	---	---	---	---	---	---	---	---	77.90	---	---	---
OMW-6	08/29/1994	---	---	---	---	---	---	---	---	---	---	---	---	---	---	---	77.90	---	---	---
OMW-6	11/11/1994	Well inaccessible	---	---	---	---	---	---	---	---	---	---	---	---	---	---	77.90	---	---	---
OMW-6	02/03/1995	---	---	---	---	---	---	---	---	---	---	---	---	---	---	---	77.90	8.96	68.94	---
OMW-6	05/07/1995	---	11,000	460	82	280	540	---	---	---	---	---	---	---	---	---	77.90	8.64	69.26	---
OMW-6 (D)	05/07/1995	---	14,000	480	61	230	370	---	---	---	---	---	---	---	---	---	77.90	---	---	---
OMW-6	08/02/1995	---	---	---	---	---	---	---	---	---	---	---	---	---	---	---	77.90	12.09	65.81	---
OMW-6	02/24/1996	Well inaccessible	---	---	---	---	---	---	---	---	---	---	---	---	---	---	77.90	---	---	---
OMW-6	05/04/1996	Well inaccessible	---	---	---	---	---	---	---	---	---	---	---	---	---	---	77.90	---	---	---
OMW-6	09/07/1996	---	---	---	---	---	---	---	---	---	---	---	---	---	---	---	77.90	14.45	63.45	---
OMW-6	11/24/1996	Well inaccessible	---	---	---	---	---	---	---	---	---	---	---	---	---	---	77.90	---	---	---
OMW-6	02/23/1997	---	---	---	---	---	---	---	---	---	---	---	---	---	---	---	77.90	13.12	64.78	---
OMW-6	05/01/1997	---	17,000	630	52	610	1,300	380	---	---	---	---	---	---	---	---	77.90	13.19	64.71	---
OMW-6 (D)	05/01/1997	---	20,000	630	54	630	1,300	500	<20	---	---	---	---	---	---	---	77.90	---	---	---
OMW-6	07/22/1997	---	---	---	---	---	---	---	---	---	---	---	---	---	---	---	77.90	13.52	64.38	---
OMW-6	11/04/1997	---	10,000	610	23	410	820	<100	---	---	---	---	---	---	---	---	77.90	13.12	64.78	---
OMW-6	01/21/1998	---	---	---	---	---	---	---	---	---	---	---	---	---	---	---	77.90	12.19	65.71	---
OMW-6	05/11/1998	---	14,000	500	32	900	1,000	110	---	---	---	---	---	---	---	---	77.90	12.71	65.19	---
OMW-6 (D)	05/11/1998	---	14,000	490	<25	900	980	370	---	---	---	---	---	---	---	---	77.90	---	---	---
OMW-6	08/11/1998	---	---	---	---	---	---	---	---	---	---	---	---	---	---	---	77.90	13.18	64.72	---
OMW-6	10/20/1998	---	7,500	220	<20	290	130	120	---	---	---	---	---	---	---	---	77.90	13.11	64.79	---
OMW-6	02/08/1999	---	---	---	---	---	---	---	---	---	---	---	---	---	---	---	77.90	9.07	68.83	---
OMW-6	04/12/1999	---	11,300	818	67	600	690	342	---	---	---	---	---	---	---	---	77.90	10.10	67.80	---
OMW-6	07/27/1999	---	---	---	---	---	---	---	---	---	---	---	---	---	---	---	77.90	12.18	65.72	---
OMW-6	10/25/1999	---	11,100	559	21	329	75.7	<100	---	---	---	---	---	---	---	---	77.90	12.58	65.32	---
OMW-6	01/24/2000	Well inaccessible	---	---	---	---	---	---	---	---	---	---	---	---	---	---	77.90	---	---	---
OMW-6	04/24/2000	---	12,700	576	<10.0	452	141	556	---	---	---	---	---	---	---	---	77.90	12.35	65.55	1.1
OMW-6	07/24/2000	---	---	---	---	---	---	---	---	---	---	---	---	---	---	---	77.90	13.08	64.82	---

TABLE 1

**GROUNDWATER DATA  
FORMER SHELL SERVICE STATION  
500 40TH STREET, OAKLAND, CALIFORNIA**

Well ID	Date	TPHd (µg/L)	TPHg (µg/L)	B (µg/L)	T (µg/L)	E (µg/L)	X (µg/L)	MTBE		TBA (µg/L)	DIPE (µg/L)	ETBE (µg/L)	TAME (µg/L)	1,2- DCA		EDB (µg/L)	TOC (ft MSL)	Depth to Water (ft TOC)	GW Elevation (ft MSL)	DO Reading (mg/L)
								8020 (µg/L)	8260 (µg/L)					µg/L	µg/L					
OMW-6	11/01/2000	---	10,700	179	28	532	416	304	14.6	---	---	---	---	---	---	---	77.90	11.91	65.99	0.6
OMW-6	01/19/2001	---	---	---	---	---	---	---	---	---	---	---	---	---	---	---	77.90	12.08	65.82	6.0
OMW-6	04/13/2001	---	8,650	103	26	318	207	258	<1.00	---	---	---	---	---	---	---	77.90	12.00	65.90	4.2
OMW-6	07/09/2001	---	---	---	---	---	---	---	---	---	---	---	---	---	---	---	77.90	11.86	66.04	5.2
OMW-6	10/18/2001	Well inaccessible		---	---	---	---	---	---	---	---	---	---	---	---	---	77.90	---	---	---
OMW-6	11/01/2001	---	6,600	85	<2.0	160	53	---	<20	---	---	---	---	---	---	---	77.90	13.23	64.67	3.4
OMW-6	01/24/2002	---	---	---	---	---	---	---	---	---	---	---	---	---	---	---	77.90	12.63	65.27	4.2
OMW-6	05/10/2002	---	7,600	230	2.9	370	25	---	<20	---	---	---	---	---	---	---	77.90	13.07	64.83	1.2
OMW-6	07/18/2002	Well inaccessible		---	---	---	---	---	---	---	---	---	---	---	---	---	77.90	---	---	---
OMW-6	10/31/2002	Well inaccessible		---	---	---	---	---	---	---	---	---	---	---	---	---	---	---	---	---
OMW-6	11/11/2002	---	6,600	37	<5.0	42	<5.0	---	<50	---	---	---	---	---	---	---	---	12.82	---	1.0
OMW-6	01/30/2003	---	---	---	---	---	---	---	---	---	---	---	---	---	---	---	---	12.78	---	2.8
OMW-6	04/17/2003	---	5,500	89	1.4	61	20	---	<5.0	---	---	---	---	---	---	---	---	13.02	---	1.6
OMW-6	07/17/2003	---	---	---	---	---	---	---	---	---	---	---	---	---	---	---	---	13.08	---	2.0
OMW-6	10/16/2003	Well inaccessible		---	---	---	---	---	---	---	---	---	---	---	---	---	---	---	---	---
OMW-6	01/14/2004	---	---	---	---	---	---	---	---	---	---	---	---	---	---	---	---	12.69	---	8.9
OMW-6	04/14/2004	Well inaccessible		---	---	---	---	---	---	---	---	---	---	---	---	---	---	---	---	---
OMW-6	10/29/2004	---	---	---	---	---	---	---	---	---	---	---	---	---	---	---	---	12.21	---	0.1
OMW-6	04/14/2005	---	3,600	18	<0.50	160	13	---	<0.50	---	---	---	---	---	---	---	---	12.88	---	0.7
OMW-6	10/26/2005	---	---	---	---	---	---	---	---	---	---	---	---	---	---	---	80.77	13.11	67.66	0.2
OMW-6	03/16/2006	3,710	22,700	46.3	0.930	515	37.2	---	<0.500	<10.0	<0.500	<0.500	<0.500	<0.500	<0.500	80.77	11.98	68.79	---	
OMW-6	09/20/2006	3,730 g	9,130	11.4	<0.500	78.4	1.85	---	<0.500	---	---	---	---	---	---	80.77	13.01	67.76	2.78	
OMW-6	03/26/2007	2,200 g,n	7,100	25	<2.5	230	20	---	<2.5	---	---	---	---	---	---	80.77	12.77	68.00	1.4	
OMW-6	06/25/2007	2,700 g	7,800 l	13	0.57 m	99	6.92 m	---	<1.0	---	---	---	---	---	---	80.77	13.00	67.77	0.08	
OMW-6	09/10/2007	1,700 g,n	6,400 l	6.8	0.47 m	26	2.41 m	---	<1.0	13	<2.0	<2.0	<2.0	---	---	80.77	13.14	67.63	0.04	
OMW-6	12/10/2007	2,900 g,n	7,500 l	9.6	0.47 m	30	2.45 m	---	<1.0	---	---	---	---	---	---	80.77	12.83	67.94	0.10	
OMW-6	03/10/2008	480 g	6,400	13	<1.0	180	9.0	---	<1.0	---	---	---	---	---	---	80.77	12.70	68.07	0.23	
OMW-6	06/23/2008	3,300 g,n	10,000	6.4	<1.0	55	3.7	---	<1.0	---	---	---	---	---	---	80.77	13.00	67.77	0.03/0.06	
OMW-6	09/22/2008	3,900 g,n	7,700	3.8	<1.0	16	1.7	---	<1.0	11	<2.0	<2.0	<2.0	---	---	80.77	13.25	67.52	0.3	
OMW-6	12/22/2008	3,700 g,n	8,000	5.6	<1.0	12	<1.0	---	<1.0	---	---	---	---	---	---	80.77	12.88	67.89	---	
OMW-6	03/23/2009	3,000 g,n	8,400	9.5	<1.0	120	8.2	---	<1.0	---	---	---	---	---	---	80.77	12.62	68.15	0.49	
OMW-6	09/21/2009	2,500 g,n	7,600	33	<5.0	33	<5.0	---	<5.0	<50	<10	<10	<10	---	---	80.77	12.90	67.87	0.47	
OMW-6	03/08/2010	3,000 g,n	9,800	7.0	<2.0	90	4.7	---	<2.0	---	---	---	---	---	---	80.77	11.21	69.56	0.54	



TABLE 1

**GROUNDWATER DATA  
FORMER SHELL SERVICE STATION  
500 40TH STREET, OAKLAND, CALIFORNIA**

Well ID	Date	TPHd (µg/L)	TPHg (µg/L)	B (µg/L)	T (µg/L)	E (µg/L)	X (µg/L)	MTBE		TBA (µg/L)	DIPE (µg/L)	ETBE (µg/L)	TAME (µg/L)	1,2- DCA		EDB (µg/L)	TOC (ft MSL)	Depth to Water (ft TOC)	GW Elevation (ft MSL)	DO Reading (mg/L)
								8020 (µg/L)	8260 (µg/L)					µg/L	µg/L					
OMW-6	09/27/2010	3,200 g,n	8,800	<2.5	<5.0	6.4	<5.0	---	<5.0	<50	<10	<10	<10	---	---	80.77	12.95	67.82	0.57	
OMW-6	03/21/2011	3,100 g	6,400 j	3.1	0.94	43	2.0	---	<1.0	---	---	---	---	---	---	80.77	12.18	68.59	0.85	
OMW-6	09/26/2011	2,000 g	7,000	2.3	<1.0	40	<2.0	---	<2.0	<20	<2.0	<2.0	<2.0	---	---	80.77	12.71	68.06	0.61	
OMW-6	03/26/2012	Well inaccessible		---	---	---	---	---	---	---	---	---	---	---	---	80.77	---	---	---	
MW-8	08/06/1991	<50	90	<0.5	<0.5	<0.5	<0.5	---	---	---	---	---	---	---	---	79.91	13.08	66.83	---	
MW-8	10/30/1991	<50	<50	<0.5	<0.5	<0.5	<0.5	---	---	---	---	---	---	---	---	79.91	12.87	67.04	---	
MW-8	02/15/1992	---	<50	<0.5	<0.5	<0.5	<0.5	---	---	---	---	---	---	---	---	79.91	---	---	---	
MW-8	03/18/1992	---	---	---	---	---	---	---	---	---	---	---	---	---	---	79.91	11.54	68.37	---	
MW-8	05/22/1992	---	<50	<0.5	<0.5	<0.5	<0.5	---	---	---	---	---	---	---	---	79.91	12.32	67.59	---	
MW-8	08/19/1992	---	60	<0.5	<0.5	<0.5	<0.5	---	---	---	---	---	---	---	---	79.91	12.58	67.33	---	
MW-8	11/18/1992	---	<50	<0.5	<0.5	<0.5	<0.5	---	---	---	---	---	---	---	---	79.91	12.47	67.44	---	
MW-8	02/11/1993	---	76 n	<0.5	<0.5	<0.5	<0.5	---	---	---	---	---	---	---	---	79.91	11.02	68.89	---	
MW-8	05/19/1993	---	<50	<0.5	<0.5	<0.5	<0.5	---	---	---	---	---	---	---	---	79.91	11.78	68.13	---	
MW-8	08/18/1993	---	---	---	---	---	---	---	---	---	---	---	---	---	---	79.91	12.22	67.69	---	
MW-8	11/17/1993	---	<50	<0.5	<0.5	<0.5	<0.5	---	---	---	---	---	---	---	---	79.91	12.25	67.66	---	
MW-8	02/18/1994	---	---	---	---	---	---	---	---	---	---	---	---	---	---	79.91	10.56	69.35	---	
MW-8	05/26/1994	---	<50	<0.5	<0.5	<0.5	<0.5	---	---	---	---	---	---	---	---	79.91	11.30	68.61	---	
MW-8	08/29/1994	---	---	---	---	---	---	---	---	---	---	---	---	---	---	79.91	11.90	68.01	---	
MW-8	11/11/1994	---	<50	<0.5	<0.5	<0.5	<0.5	---	---	---	---	---	---	---	---	79.91	10.12	69.79	---	
MW-8	02/03/1995	---	---	---	---	---	---	---	---	---	---	---	---	---	---	79.91	11.64	68.27	---	
MW-8	05/07/1995	---	<50	<0.5	<0.5	<0.5	<0.5	---	---	---	---	---	---	---	---	79.91	10.77	69.14	---	
MW-8	08/02/1995	---	---	---	---	---	---	---	---	---	---	---	---	---	---	79.91	10.92	68.99	---	
MW-8	11/02/1995	---	<50	<0.5	<0.5	<0.5	<0.5	---	---	---	---	---	---	---	---	79.91	11.93	67.98	---	
MW-8	02/24/1996	Well inaccessible		---	---	---	---	---	---	---	---	---	---	---	---	79.91	---	---	---	
MW-8	05/04/1996	---	<50	<0.50	<0.50	<0.50	<0.50	<2.5	---	---	---	---	---	---	---	79.91	11.66	68.25	---	
MW-8	09/07/1996	---	---	---	---	---	---	---	---	---	---	---	---	---	---	79.91	9.84	70.07	---	
MW-8	11/24/1996	---	<50	<0.50	<0.50	<0.50	<0.50	<2.5	---	---	---	---	---	---	---	79.91	11.53	68.38	---	
MW-8	02/23/1997	---	---	---	---	---	---	---	---	---	---	---	---	---	---	79.91	11.54	68.37	---	
MW-8	05/01/1997	---	<50	<0.50	<0.50	<0.50	<0.50	<2.5	---	---	---	---	---	---	---	79.91	12.37	67.54	---	
MW-8	07/22/1997	---	---	---	---	---	---	---	---	---	---	---	---	---	---	79.91	12.73	67.18	---	
MW-8	11/04/1997	---	50	<0.50	<0.50	<0.50	<0.50	<5.0	---	---	---	---	---	---	---	79.91	12.60	67.31	---	
MW-8	01/21/1998	---	---	---	---	---	---	---	---	---	---	---	---	---	---	79.91	9.73	70.18	---	

TABLE 1

**GROUNDWATER DATA  
FORMER SHELL SERVICE STATION  
500 40TH STREET, OAKLAND, CALIFORNIA**

Well ID	Date	TPHd (µg/L)	TPHg (µg/L)	B (µg/L)	T (µg/L)	E (µg/L)	X (µg/L)	MTBE		TBA (µg/L)	DIPE (µg/L)	ETBE (µg/L)	TAME (µg/L)	1,2- DCA		EDB (µg/L)	TOC (ft MSL)	Depth to Water (ft TOC)	GW Elevation (ft MSL)	DO Reading (mg/L)
								8020 (µg/L)	8260 (µg/L)					µg/L	µg/L					
MW-8	05/11/1998	---	<50	<0.50	<0.50	<0.50	<0.50	<2.5	---	---	---	---	---	---	---	---	79.91	11.93	67.98	---
MW-8	08/11/1998	---	---	---	---	---	---	---	---	---	---	---	---	---	---	---	79.91	12.35	67.56	---
MW-8	10/20/1998	---	<50	<0.50	<0.50	<0.50	<0.50	<2.5	---	---	---	---	---	---	---	---	79.91	12.88	67.03	---
MW-8	02/08/1999	---	---	---	---	---	---	---	---	---	---	---	---	---	---	---	79.91	8.79	71.12	---
MW-8	04/12/1999	---	<50.0	<0.500	<0.500	<0.500	<0.500	<5.00	---	---	---	---	---	---	---	---	79.91	9.86	70.05	---
MW-8	07/27/1999	---	---	---	---	---	---	---	---	---	---	---	---	---	---	---	79.91	12.35	67.56	---
MW-8	10/25/1999	---	<50.0	<0.500	<0.500	<0.500	<0.500	<5.00	---	---	---	---	---	---	---	---	79.91	12.53	67.38	---
MW-8	01/24/2000	---	---	---	---	---	---	---	---	---	---	---	---	---	---	---	79.91	8.42	71.49	1.3
MW-8	04/24/2000	---	<50.0	<0.500	<0.500	<0.500	<0.500	<2.50	---	---	---	---	---	---	---	---	79.91	11.49	68.42	2.0
MW-8	07/24/2000	---	---	---	---	---	---	---	---	---	---	---	---	---	---	---	79.91	12.87	67.04	---
MW-8	11/01/2000	---	<50.0	<0.500	<0.500	<0.500	<0.500	<2.50	---	---	---	---	---	---	---	---	79.91	11.19	68.72	4.0
MW-8	01/19/2001	---	---	---	---	---	---	---	---	---	---	---	---	---	---	---	79.91	11.62	68.29	7.0
MW-8	04/13/2001	---	<50.0	<0.500	<0.500	<0.500	<0.500	<2.50	---	---	---	---	---	---	---	---	79.91	11.86	68.05	4.6
MW-8	07/09/2001	---	---	---	---	---	---	---	---	---	---	---	---	---	---	---	79.91	12.42	67.49	6.4
MW-8	10/18/2001	---	81	<0.50	<0.50	<0.50	<0.50	---	<5.0	---	---	---	---	---	---	---	79.91	13.24	66.67	2.3
MW-8	01/24/2002	---	---	---	---	---	---	---	---	---	---	---	---	---	---	---	79.91	11.39	68.52	3.1
MW-8	05/10/2002	---	95	<0.50	<0.50	<0.50	<0.50	---	<5.0	---	---	---	---	---	---	---	79.91	12.25	67.66	2.5
MW-8	07/18/2002	---	---	---	---	---	---	---	---	---	---	---	---	---	---	---	79.91	12.45	67.46	2.8
MW-8	10/31/2002	Well inaccessible		---	---	---	---	---	---	---	---	---	---	---	---	---	82.34	---	---	---
MW-8	11/11/2002	---	110	<0.50	<0.50	<0.50	<0.50	---	<5.0	---	---	---	---	---	---	---	82.34	12.03	70.31	---
MW-8	01/30/2003	---	---	---	---	---	---	---	---	---	---	---	---	---	---	---	82.34	11.85	70.49	---
MW-8	04/17/2003	---	<50	<0.50	<0.50	<0.50	<1.0	---	<5.0	---	---	---	---	---	---	---	82.34	11.30	71.04	---
MW-8	07/17/2003	---	---	---	---	---	---	---	---	---	---	---	---	---	---	---	82.34	12.40	69.94	---
MW-8	10/16/2003	---	<50	<0.50	<0.50	<0.50	<1.0	---	<0.50	---	---	---	---	---	---	---	82.34	12.62	69.72	---
MW-8	01/14/2004	---	---	---	---	---	---	---	---	---	---	---	---	---	---	---	82.34	11.85	70.49	---
MW-8	04/16/2004	---	<50	<0.50	<0.50	<0.50	<1.0	---	<0.50	---	---	---	---	---	---	---	82.34	12.00	70.34	---
MW-8	10/29/2004	---	---	---	---	---	---	---	---	---	---	---	---	---	---	---	82.34	11.66	70.68	---
MW-8	04/14/2005	---	<50	<0.50	<0.50	<0.50	<1.0	---	<0.50	---	---	---	---	---	---	---	82.34	10.81	71.53	---
MW-8	10/26/2005	---	---	---	---	---	---	---	---	---	---	---	---	---	---	---	82.34	12.23	70.11	---
MW-8	03/16/2006	52.8 g	<50.0	<0.500	<0.500	<0.500	<0.500	---	<0.500	<10.0	<0.500	<0.500	<0.500	<0.500	<0.500	---	82.34	10.47	71.87	---
MW-8	09/20/2006	<47.6 g,i	<50.0	<0.500	<0.500	<0.500	<0.500	---	<0.500	---	---	---	---	---	---	---	82.34	11.53	70.81	---
MW-8	03/26/2007	<47 g	<50	<0.50	<0.50	<0.50	<0.50	---	<0.50	---	---	---	---	---	---	---	82.34	12.10	70.24	---
MW-8	06/25/2007	---	---	---	---	---	---	---	---	---	---	---	---	---	---	---	82.34	12.69	69.65	---

TABLE 1

**GROUNDWATER DATA  
FORMER SHELL SERVICE STATION  
500 40TH STREET, OAKLAND, CALIFORNIA**

Well ID	Date	TPHd (µg/L)	TPHg (µg/L)	B (µg/L)	T (µg/L)	E (µg/L)	X (µg/L)	MTBE		TBA (µg/L)	DIPE (µg/L)	ETBE (µg/L)	TAME (µg/L)	1,2- DCA (µg/L)	EDB (µg/L)	TOC (ft MSL)	Depth to Water (ft TOC)	GW Elevation (ft MSL)	DO Reading (mg/L)
								8020 (µg/L)	8260 (µg/L)										
MW-8	09/10/2007	<50 g	<50 l	<0.50	<1.0	<1.0	<1.0	---	<1.0	---	---	---	---	---	---	82.34	13.05	69.29	---
MW-8	12/10/2007	---	---	---	---	---	---	---	---	---	---	---	---	---	---	82.34	12.10	70.24	---
MW-8	03/10/2008	---	---	---	---	---	---	---	---	---	---	---	---	---	---	82.34	11.97	70.37	---
MW-8	06/23/2008	---	---	---	---	---	---	---	---	---	---	---	---	---	---	82.34	12.97	69.37	---
MW-8	09/22/2008	---	---	---	---	---	---	---	---	---	---	---	---	---	---	82.34	12.89	69.45	---
MW-8	12/22/2008	---	---	---	---	---	---	---	---	---	---	---	---	---	---	82.34	12.41	69.93	---
MW-8	03/23/2009	---	---	---	---	---	---	---	---	---	---	---	---	---	---	82.34	11.72	70.62	---
MW-8	09/21/2009	---	---	---	---	---	---	---	---	---	---	---	---	---	---	82.34	12.45	69.89	---
MW-8	03/08/2010	---	---	---	---	---	---	---	---	---	---	---	---	---	---	82.34	11.38	70.96	---
MW-8	09/27/2010	---	---	---	---	---	---	---	---	---	---	---	---	---	---	82.34	12.54	69.80	---
MW-8	03/21/2011	---	---	---	---	---	---	---	---	---	---	---	---	---	---	82.34	10.21	72.13	---
MW-8	09/26/2011	---	---	---	---	---	---	---	---	---	---	---	---	---	---	82.34	12.69	69.65	---
<b>MW-8</b>	<b>03/26/2012</b>	---	---	---	---	---	---	---	---	---	---	---	---	---	---	<b>82.34</b>	<b>10.27</b>	<b>72.07</b>	---
OMW-9	08/06/1991	190	3,900	58	8.8	80	220	---	---	---	---	---	---	---	---	77.71	10.38	67.33	---
OMW-9	10/30/1991	Well inaccessible	---	---	---	---	---	---	---	---	---	---	---	---	---	77.71	---	---	---
OMW-9	03/18/1992	210	1,800 n	84	11	49	60	---	---	---	---	---	---	---	---	77.71	8.76	68.95	---
OMW-9	05/20/1992	Well inaccessible	---	---	---	---	---	---	---	---	---	---	---	---	---	77.71	---	---	---
OMW-9	08/19/1992	22 n	4,600	63	<25	48	70	---	---	---	---	---	---	---	---	77.71	9.98	67.73	---
OMW-9	11/18/1992	130 n	1,800	30	9.2	46	61	---	---	---	---	---	---	---	---	77.71	9.81	67.90	---
OMW-9	02/11/1993	Well inaccessible	---	---	---	---	---	---	---	---	---	---	---	---	---	77.71	---	---	---
OMW-9	05/19/1993	Well inaccessible	---	---	---	---	---	---	---	---	---	---	---	---	---	77.71	---	---	---
OMW-9	08/18/1993	---	---	---	---	---	---	---	---	---	---	---	---	---	---	77.71	9.75	67.96	---
OMW-9	11/17/1993	2,400 n	5,900	86	14	150	46	---	---	---	---	---	---	---	---	77.71	9.92	67.79	---
OMW-9	02/18/1994	Well inaccessible	---	---	---	---	---	---	---	---	---	---	---	---	---	77.71	---	---	---
OMW-9	05/26/1994	Well inaccessible	---	---	---	---	---	---	---	---	---	---	---	---	---	77.71	---	---	---
OMW-9	08/29/1994	---	---	---	---	---	---	---	---	---	---	---	---	---	---	77.71	---	---	---
OMW-9	11/11/1994	Well inaccessible	---	---	---	---	---	---	---	---	---	---	---	---	---	77.71	---	---	---
OMW-9	02/03/1995	---	---	---	---	---	---	---	---	---	---	---	---	---	---	77.71	---	---	---
OMW-9	05/07/1995	Well inaccessible	---	---	---	---	---	---	---	---	---	---	---	---	---	77.71	---	---	---
OMW-9	08/02/1995	Well inaccessible	---	---	---	---	---	---	---	---	---	---	---	---	---	77.71	---	---	---
OMW-9	02/24/1996	Well inaccessible	---	---	---	---	---	---	---	---	---	---	---	---	---	77.71	---	---	---
OMW-9	05/04/1996	Well inaccessible	---	---	---	---	---	---	---	---	---	---	---	---	---	77.71	---	---	---

TABLE 1

**GROUNDWATER DATA  
FORMER SHELL SERVICE STATION  
500 40TH STREET, OAKLAND, CALIFORNIA**

Well ID	Date	TPHd (µg/L)	TPHg (µg/L)	B (µg/L)	T (µg/L)	E (µg/L)	X (µg/L)	MTBE		TBA (µg/L)	DIPE (µg/L)	ETBE (µg/L)	TAME (µg/L)	1,2- DCA		EDB (µg/L)	TOC (ft MSL)	Depth to Water (ft TOC)	GW Elevation (ft MSL)	DO Reading (mg/L)
								8020 (µg/L)	8260 (µg/L)					µg/L	µg/L					
OMW-9	09/07/1996	Well inaccessible		---	---	---	---	---	---	---	---	---	---	---	---	---	77.71	---	---	---
OMW-9	11/24/1996	Well inaccessible		---	---	---	---	---	---	---	---	---	---	---	---	---	77.71	---	---	---
OMW-9	02/23/1997	Well inaccessible		---	---	---	---	---	---	---	---	---	---	---	---	---	77.71	---	---	---
OMW-9	05/01/1997	1,100	4,700	150	14	97	52	330	---	---	---	---	---	---	---	---	77.71	12.10	65.61	---
OMW-9	07/22/1997	Well inaccessible		---	---	---	---	---	---	---	---	---	---	---	---	---	77.71	---	---	---
OMW-9	11/04/1997	Well inaccessible		---	---	---	---	---	---	---	---	---	---	---	---	---	77.71	---	---	---
OMW-9	01/21/1998	---	---	---	---	---	---	---	---	---	---	---	---	---	---	---	77.71	11.32	66.39	---
OMW-9	05/11/1998	1,500	5,500	220	10	160	91	110	---	---	---	---	---	---	---	---	77.71	11.95	65.76	---
OMW-9	08/11/1998	---	---	---	---	---	---	---	---	---	---	---	---	---	---	---	77.71	12.08	65.63	---
OMW-9	10/20/1998	780	1,200	18	<5.0	14	6.0	48	---	---	---	---	---	---	---	---	77.71	12.03	65.68	---
OMW-9	11/23/1998	890	1,700	88	9.0	42	22	170	---	---	---	---	---	---	---	---	77.71	11.85	65.86	---
OMW-9	02/08/1999	---	---	---	---	---	---	---	---	---	---	---	---	---	---	---	77.71	8.01	69.70	---
OMW-9	04/12/1999	1,870	2,670	97	<5.00	111	54	401	---	---	---	---	---	---	---	---	77.71	9.55	68.16	---
OMW-9	07/27/1999	---	---	---	---	---	---	---	---	---	---	---	---	---	---	---	77.71	11.87	65.84	---
OMW-9	10/25/1999	606	2,670	31.3	<2.50	8.32	<2.50	107	---	---	---	---	---	---	---	---	77.71	11.93	65.78	---
OMW-9	01/24/2000	1,250	1,400	44.5	<1.00	12.6	8.66	69.8	23.5	---	---	---	---	---	---	---	77.71	10.32	67.39	1.2
OMW-9	04/24/2000	644	1,440	53.3	0.605	4.63	10.2	80.7	---	---	---	---	---	---	---	---	77.71	11.33	66.38	1.8
OMW-9	07/24/2000	---	---	---	---	---	---	---	---	---	---	---	---	---	---	---	77.71	11.82	65.89	---
OMW-9	11/01/2000	685	2,160	92.6	7.96	4.69	4.02	88.8	---	---	---	---	---	---	---	---	77.71	11.45	66.26	2.0
OMW-9	01/19/2001	---	---	---	---	---	---	---	---	---	---	---	---	---	---	---	77.71	11.83	65.88	4.2
OMW-9	04/13/2001	923	3,620	167	3.16	60.2	14.5	231	---	---	---	---	---	---	---	---	77.71	12.19	65.52	3.8
OMW-9	07/09/2001	---	---	---	---	---	---	---	---	---	---	---	---	---	---	---	77.71	12.04	65.67	3.8
OMW-9	10/18/2001	<500	1,400	23	0.77	1.8	1.4	---	10	---	---	---	---	---	---	---	77.71	12.90	64.81	0.4
OMW-9	01/24/2002	---	---	---	---	---	---	---	---	---	---	---	---	---	---	---	77.71	11.97	65.74	4.0
OMW-9	05/10/2002	380	3,900	84	2.9	120	23	---	11	---	---	---	---	---	---	---	77.71	12.27	65.44	1.1
OMW-9	07/18/2002	---	---	---	---	---	---	---	---	---	---	---	---	---	---	---	77.71	12.42	65.29	4.2
OMW-9	10/31/2002	<1,500	4,700	40	1.1	14	14	---	<5.0	---	---	---	---	---	---	---	12.60	---	---	2.4
OMW-9	01/30/2003	---	---	---	---	---	---	---	---	---	---	---	---	---	---	---	12.15	---	---	4.8
OMW-9	04/17/2003	120	<50	<0.50	<0.50	<0.50	<1.0	---	<5.0	---	---	---	---	---	---	---	11.61	---	---	1.8
OMW-9	07/17/2003	---	---	---	---	---	---	---	---	---	---	---	---	---	---	---	12.22	---	---	4.2
OMW-9	10/16/2003	Well inaccessible		---	---	---	---	---	---	---	---	---	---	---	---	---	---	---	---	---
OMW-9	01/14/2004	---	---	---	---	---	---	---	---	---	---	---	---	---	---	---	11.87	---	---	9.1
OMW-9	04/14/2004	470 n	460	6.1	<0.50	21	1.2	---	1.2	---	---	---	---	---	---	---	12.44	---	---	1.0

TABLE 1

**GROUNDWATER DATA  
FORMER SHELL SERVICE STATION  
500 40TH STREET, OAKLAND, CALIFORNIA**

Well ID	Date	TPHd (µg/L)	TPHg (µg/L)	B (µg/L)	T (µg/L)	E (µg/L)	X (µg/L)	MTBE		TBA (µg/L)	DIPE (µg/L)	ETBE (µg/L)	TAME (µg/L)	1,2- DCA		EDB (µg/L)	TOC (ft MSL)	Depth to Water (ft TOC)	GW Elevation (ft MSL)	DO Reading (mg/L)
								8020 (µg/L)	8260 (µg/L)					µg/L	µg/L					
OMW-9	10/29/2004	---	---	---	---	---	---	---	---	---	---	---	---	---	---	---	---	11.95	---	11.4
OMW-9	04/14/2005	210 n	<50	<0.50	<0.50	<0.50	<1.0	---	<0.50	---	---	---	---	---	---	---	---	11.82	---	1.9
OMW-9	10/26/2005	---	---	---	---	---	---	---	---	---	---	---	---	---	---	---	80.55	12.52	68.03	0.2
OMW-9	03/16/2006	1,600	10,500	26.2	0.670	105	4.38	---	1.06	<10.0	<0.500	<0.500	<0.500	<0.500	<0.500	---	80.55	11.17	69.38	---
OMW-9	09/20/2006	Well inaccessible		---	---	---	---	---	---	---	---	---	---	---	---	---	80.55	---	---	---
OMW-9	10/02/2006	3,990 g	11,300	18.0	1.81	74.4	6.18	---	0.860	---	---	---	---	---	---	---	80.55	12.40	68.15	0.29
OMW-9	03/26/2007	1,000 g,n	2,700	12	<2.5	15	2.8	---	<2.5	---	---	---	---	---	---	---	80.55	12.00	68.55	1.2
OMW-9	06/25/2007	1,000 g	4,000 l	8.4	0.44 m	25	2.9	---	<1.0	---	---	---	---	---	---	---	80.55	12.83	67.72	0.05
OMW-9	09/10/2007	480 g,n	2,800 l	3.9	<1.0	6.4	1.3	---	<1.0	---	---	---	---	---	---	---	80.55	13.02	67.53	0.06
OMW-9	12/10/2007	760 g,n	2,600 l	12	0.46 m	6.4	0.83	---	0.71 m	---	---	---	---	---	---	---	80.55	12.38	68.17	0.11
OMW-9	03/10/2008	Well inaccessible		---	---	---	---	---	---	---	---	---	---	---	---	---	80.55	---	---	---
OMW-9	06/23/2008	550 g,n	1,700	1.9	<1.0	2.0	<1.0	---	<1.0	---	---	---	---	---	---	---	80.55	13.30	67.25	0.01/0.02
OMW-9	09/22/2008	430 g,n	1,300	1.4	<1.0	<1.0	<1.0	---	<1.0	<10	<2.0	<2.0	<2.0	---	---	---	80.55	12.41	68.14	0.09
OMW-9	12/22/2008	550 g,n	1,000	1.4	<1.0	<1.0	<1.0	---	<1.0	---	---	---	---	---	---	---	80.55	12.18	68.37	---
OMW-9	03/23/2009	380 g,n	290	1.0	<1.0	1.1	<1.0	---	<1.0	---	---	---	---	---	---	---	80.55	11.42	69.13	0.47
OMW-9	09/21/2009	420 g,n	1,100	2.3	<1.0	<1.0	<1.0	---	<1.0	<10	<2.0	<2.0	<2.0	---	---	---	80.55	12.10	68.45	0.62
OMW-9	03/08/2010	200 g,n	510	2.0	<1.0	3.2	<1.0	---	<1.0	---	---	---	---	---	---	---	80.55	11.37	69.18	0.51
OMW-9	09/27/2010	80 g,n	1,600	2.8	<1.0	<1.0	<1.0	---	<1.0	<10	<2.0	<2.0	<2.0	---	---	---	80.55	12.96	67.59	0.88
OMW-9	03/21/2011	72 g	140	0.80	<0.50	0.88	<1.0	---	<1.0	---	---	---	---	---	---	---	80.55	11.90	68.65	0.78
OMW-9	09/26/2011	650 g	1,600	0.97	<0.50	0.62	<1.0	---	<1.0	<10	<1.0	<1.0	<1.0	---	---	---	80.55	13.35	67.20	0.94
OMW-9	03/26/2012	320 g	440	2.9	<0.50	0.50	<1.0	---	0.57	---	---	---	---	---	---	---	80.55	11.12	69.43	0.65
OMW-10	08/07/1991	<50	460	73	1.0	18	8.4	---	---	---	---	---	---	---	---	---	77.91	10.00	67.91	---
OMW-10	10/31/1991	150	630	100	<0.5	33	26	---	---	---	---	---	---	---	---	---	77.91	10.10	67.81	---
OMW-10	02/15/1992	570 n	810	85	2.5	44	38	---	---	---	---	---	---	---	---	---	77.91	---	---	---
OMW-10	03/18/1992	---	---	---	---	---	---	---	---	---	---	---	---	---	---	---	77.91	9.55	68.36	---
OMW-10	05/21/1992	---	280	47	0.7	4.0	3.1	---	---	---	---	---	---	---	---	---	77.91	10.41	67.50	---
OMW-10	08/19/1992	---	330	35	<1	6.0	4.1	---	---	---	---	---	---	---	---	---	77.91	10.46	67.45	---
OMW-10	11/18/1993	---	300	30	0.8	7.1	6.3	---	---	---	---	---	---	---	---	---	77.91	10.31	67.60	---
OMW-10	02/11/1993	---	510 n	49	3.8	18	18	---	---	---	---	---	---	---	---	---	77.91	9.68	68.23	---
OMW-10	05/19/1993	---	<50	96	<0.5	3.4	1.5	---	---	---	---	---	---	---	---	---	77.91	10.19	67.72	---
OMW-10	08/18/1993	---	---	---	---	---	---	---	---	---	---	---	---	---	---	---	77.91	10.29	67.62	---
OMW-10	11/17/1993	---	400	24	<1.0	2.8	1.9	---	---	---	---	---	---	---	---	---	77.91	10.32	67.59	---

**GROUNDWATER DATA  
FORMER SHELL SERVICE STATION  
500 40TH STREET, OAKLAND, CALIFORNIA**

Well ID	Date	TPHd (µg/L)	TPHg (µg/L)	B (µg/L)	T (µg/L)	E (µg/L)	X (µg/L)	MTBE		TBA (µg/L)	DIPE (µg/L)	ETBE (µg/L)	TAME (µg/L)	1,2-		TOC (ft MSL)	Depth to Water (ft TOC)	GW Elevation (ft MSL)	DO Reading (mg/L)
								8020 (µg/L)	8260 (µg/L)					DCA (µg/L)	EDB (µg/L)				
OMW-10	02/18/1994	---	---	---	---	---	---	---	---	---	---	---	---	---	---	77.91	9.30	68.61	---
OMW-10	05/26/1994	---	330	32	13	7.5	26	---	---	---	---	---	---	---	---	77.91	10.14	67.77	---
OMW-10	08/09/1994	---	---	---	---	---	---	---	---	---	---	---	---	---	---	77.91	10.38	67.53	---
OMW-10	11/11/1994	---	110	7.8	<0.5	2.3	1.5	---	---	---	---	---	---	---	---	77.91	9.34	68.57	---
OMW-10	02/03/1995	---	---	---	---	---	---	---	---	---	---	---	---	---	---	77.91	10.17	67.74	---
OMW-10	05/07/1995	---	1,600	110	3.1	17	12	---	---	---	---	---	---	---	---	77.91	9.63	68.28	---
OMW-10	08/02/1995	---	---	---	---	---	---	---	---	---	---	---	---	---	---	77.91	10.07	67.84	---
OMW-10	11/02/1995	---	1,200	47	0.8	1.4	2.4	---	---	---	---	---	---	---	---	77.91	9.74	68.17	---
OMW-10 (D)	11/02/1995	---	1,300	50	0.8	1.5	2.5	---	---	---	---	---	---	---	---	77.91	---	---	---
OMW-10	02/24/1996	Well inaccessible		---	---	---	---	---	---	---	---	---	---	---	---	77.91	---	---	---
OMW-10	05/04/1996	---	1,100	76	16	7.4	32	57	---	---	---	---	---	---	---	77.91	9.97	67.94	---
OMW-10 (D)	05/04/1996	---	700	63	13	6.4	25	21	---	---	---	---	---	---	---	77.91	---	---	---
OMW-10	09/07/1996	---	---	---	---	---	---	---	---	---	---	---	---	---	---	77.91	13.00	64.91	---
OMW-10	11/24/1996	---	540	13	2.7	1.3	1.7	16	---	---	---	---	---	---	---	77.91	12.56	65.35	---
OMW-10 (D)	11/24/1996	---	490	25	<2.0	<2.0	<2.0	66	---	---	---	---	---	---	---	77.91	---	---	---
OMW-10	02/23/1997	---	---	---	---	---	---	---	---	---	---	---	---	---	---	77.91	12.52	65.39	---
OMW-10	05/01/1997	---	910	1.3	10	4.1	5.9	4.1	---	---	---	---	---	---	---	77.91	13.13	64.78	---
OMW-10	07/22/1997	---	---	---	---	---	---	---	---	---	---	---	---	---	---	77.91	13.46	64.45	---
OMW-10	11/04/1997	---	460	5.0	<0.50	1.3	2.2	<5.0	---	---	---	---	---	---	---	77.91	12.08	65.83	---
OMW-10	01/21/1998	---	---	---	---	---	---	---	---	---	---	---	---	---	---	77.91	11.77	66.14	---
OMW-10	05/11/1998	---	370	4.1	0.7	<0.50	0.88	5.2	---	---	---	---	---	---	---	77.91	12.86	65.05	---
OMW-10	08/11/1998	---	---	---	---	---	---	---	---	---	---	---	---	---	---	77.91	13.20	64.71	---
OMW-10	10/20/1998	---	490	<0.50	<0.50	1.6	2.3	5.9	---	---	---	---	---	---	---	77.91	13.20	64.71	---
OMW-10	11/23/1998	790	150	3.2	0.72	<0.50	1.5	5	---	---	---	---	---	---	---	77.91	12.85	65.06	---
OMW-10	02/08/1999	---	---	---	---	---	---	---	---	---	---	---	---	---	---	77.91	9.18	68.73	---
OMW-10	04/12/1999	---	1,910	59.8	65.80	67	41.6	<100	---	---	---	---	---	---	---	77.91	10.25	67.66	---
OMW-10	07/27/1999	---	---	---	---	---	---	---	---	---	---	---	---	---	---	77.91	12.85	65.06	---
OMW-10	10/25/1999	---	130	1.08	<0.500	0.522	<0.500	<5.00	---	---	---	---	---	---	---	77.91	12.99	64.92	---
OMW-10	01/24/2000	---	---	---	---	---	---	---	---	---	---	---	---	---	---	77.91	10.61	67.30	0.6
OMW-10	04/24/2000	---	60.7	1.73	<0.500	<0.500	<0.500	<2.50	---	---	---	---	---	---	---	77.91	12.35	65.56	1.1
OMW-10	07/24/2000	---	---	---	---	---	---	---	---	---	---	---	---	---	---	77.91	12.76	65.15	---
OMW-10	11/01/2000	---	<50.0	0.664	<0.500	<0.500	<0.500	<2.50	---	---	---	---	---	---	---	77.91	11.96	65.95	2.2
OMW-10	01/19/2001	---	---	---	---	---	---	---	---	---	---	---	---	---	---	77.91	12.51	65.40	3.4

TABLE 1

**GROUNDWATER DATA  
FORMER SHELL SERVICE STATION  
500 40TH STREET, OAKLAND, CALIFORNIA**

Well ID	Date	TPHd (µg/L)	TPHg (µg/L)	B (µg/L)	T (µg/L)	E (µg/L)	X (µg/L)	MTBE		TBA (µg/L)	DIPE (µg/L)	ETBE (µg/L)	TAME (µg/L)	1,2- DCA		EDB (µg/L)	TOC (ft MSL)	Depth to Water (ft TOC)	GW Elevation (ft MSL)	DO Reading (mg/L)
								8020 (µg/L)	8260 (µg/L)					µg/L	µg/L					
OMW-10	04/13/2001	---	91.0	1.75	0.720	<0.500	0.718	6.11	---	---	---	---	---	---	---	---	77.91	12.95	64.96	6.2
OMW-10	07/09/2001	---	---	---	---	---	---	---	---	---	---	---	---	---	---	---	77.91	13.11	64.80	3.4
OMW-10	10/18/2001	---	<50	<0.50	<0.50	<0.50	<0.50	---	<5.0	---	---	---	---	---	---	---	77.91	19.69	58.22	0.2
OMW-10	01/24/2002	---	---	---	---	---	---	---	---	---	---	---	---	---	---	---	77.91	12.83	65.08	2.5
OMW-10	05/10/2002	---	<50	<0.50	<0.50	<0.50	<0.50	---	<5.0	---	---	---	---	---	---	---	77.91	13.20	64.71	1.1
OMW-10	07/18/2002	---	---	---	---	---	---	---	---	---	---	---	---	---	---	---	77.91	13.22	64.69	2.3
OMW-10	10/31/2002	---	<50	<0.50	<0.50	<0.50	<0.50	---	<5.0	---	---	---	---	---	---	---	81.14	13.55	67.59	---
OMW-10	01/30/2003	---	---	---	---	---	---	---	---	---	---	---	---	---	---	---	81.14	12.67	68.47	---
OMW-10	04/17/2003	---	<50	<0.50	<0.50	<0.50	<1.0	---	6.6	---	---	---	---	---	---	---	81.14	12.14	69.00	---
OMW-10	07/17/2003	---	---	---	---	---	---	---	---	---	---	---	---	---	---	---	81.14	13.08	68.06	---
OMW-10	10/16/2003	---	120 n	0.68	<0.50	<0.50	<1.0	---	0.99	---	---	---	---	---	---	---	81.14	13.27	67.87	---
OMW-10	01/14/2004	---	---	---	---	---	---	---	---	---	---	---	---	---	---	---	81.14	12.55	68.59	---
OMW-10	04/14/2004	---	---	---	---	---	---	---	---	---	---	---	---	---	---	---	81.14	13.04	68.10	---
OMW-10	10/29/2004	---	---	---	---	---	---	---	---	---	---	---	---	---	---	---	81.14	12.61	68.53	---
OMW-10	04/14/2005	Well destroyed		---	---	---	---	---	---	---	---	---	---	---	---	---	---	---	---	---
OMW-11	11/22/1991	240	450	1.1	<0.5	<0.5	<0.5	---	---	---	---	---	---	---	---	---	75.76	11.90	63.86	---
OMW-11	02/15/1992	Well inaccessible		---	---	---	---	---	---	---	---	---	---	---	---	---	75.76	---	---	---
OMW-11	03/18/1992	Well inaccessible		---	---	---	---	---	---	---	---	---	---	---	---	---	75.76	---	---	---
OMW-11	05/20/1992	Well inaccessible		---	---	---	---	---	---	---	---	---	---	---	---	---	75.76	---	---	---
OMW-11	08/19/1992	<50	270 n	<0.5	<0.5	<0.5	<0.5	---	---	---	---	---	---	---	---	---	75.76	12.06	63.70	---
OMW-11	11/18/1992	100	400 n	<0.5	<0.5	<0.5	<0.5	---	---	---	---	---	---	---	---	---	75.76	12.01	63.75	---
OMW-11	02/11/1993	Well inaccessible		---	---	---	---	---	---	---	---	---	---	---	---	---	75.76	---	---	---
OMW-11	05/20/1993	<0.5	200 n	<0.5	<0.5	<0.5	<0.5	---	---	---	---	---	---	---	---	---	75.76	11.90	63.86	---
OMW-11	08/18/1993	<50	180 n	<0.5	<0.5	<0.5	<0.5	---	---	---	---	---	---	---	---	---	75.76	11.90	63.86	---
OMW-11	11/17/1993	<50 n	150 n	<0.5	3.6	<0.5	<0.5	---	---	---	---	---	---	---	---	---	75.76	11.94	63.82	---
OMW-11	02/18/1994	Well inaccessible		---	---	---	---	---	---	---	---	---	---	---	---	---	75.76	---	---	---
OMW-11	05/26/1994	Well inaccessible		---	---	---	---	---	---	---	---	---	---	---	---	---	75.76	---	---	---
OMW-11	08/29/1994	---	---	---	---	---	---	---	---	---	---	---	---	---	---	---	75.76	11.98	63.78	---
OMW-11	11/11/1994	---	160	<0.5	<0.5	<0.5	<0.5	---	---	---	---	---	---	---	---	---	75.76	10.88	64.88	---
OMW-11	02/03/1995	---	---	---	---	---	---	---	---	---	---	---	---	---	---	---	75.76	10.62	65.14	---
OMW-11	03/05/1995	100	220	0.7	<0.5	<0.5	<0.5	---	---	---	---	---	---	---	---	---	75.76	---	---	---
OMW-11	05/07/1995	<50	160	<0.5	<0.5	<0.5	<0.5	---	---	---	---	---	---	---	---	---	75.76	11.49	64.27	---

TABLE 1

**GROUNDWATER DATA  
FORMER SHELL SERVICE STATION  
500 40TH STREET, OAKLAND, CALIFORNIA**

Well ID	Date	TPHd (µg/L)	TPHg (µg/L)	B (µg/L)	T (µg/L)	E (µg/L)	X (µg/L)	MTBE		TBA (µg/L)	DIPE (µg/L)	ETBE (µg/L)	TAME (µg/L)	1,2-		TOC (ft MSL)	Depth to Water (ft TOC)	GW Elevation (ft MSL)	DO Reading (mg/L)
								8020 (µg/L)	8260 (µg/L)					DCA (µg/L)	EDB (µg/L)				
OMW-11	08/02/1995	Well inaccessible		---	---	---	---	---	---	---	---	---	---	---	---	75.76	---	---	---
OMW-11	02/24/1996	Well inaccessible		---	---	---	---	---	---	---	---	---	---	---	---	75.76	---	---	---
OMW-11	05/04/1996	Well inaccessible		---	---	---	---	---	---	---	---	---	---	---	---	75.76	---	---	---
OMW-11	09/07/1996	Well inaccessible		---	---	---	---	---	---	---	---	---	---	---	---	75.76	---	---	---
OMW-11	11/24/1996	Well inaccessible		---	---	---	---	---	---	---	---	---	---	---	---	75.76	---	---	---
OMW-11	02/23/1997	Well inaccessible		---	---	---	---	---	---	---	---	---	---	---	---	75.76	---	---	---
OMW-11	05/01/1997	71	130	<0.50	<0.50	<0.50	0.61	<2.5	---	---	---	---	---	---	---	75.76	13.76	62.00	---
OMW-11	07/22/1997	Well inaccessible		---	---	---	---	---	---	---	---	---	---	---	---	75.76	---	---	---
OMW-11	11/04/1997	Well inaccessible		---	---	---	---	---	---	---	---	---	---	---	---	75.76	---	---	---
OMW-11	01/21/1998	Well inaccessible		---	---	---	---	---	---	---	---	---	---	---	---	75.76	---	---	---
OMW-11	05/11/1998	85	100	<0.50	<0.50	<0.50	<0.50	<2.5	---	---	---	---	---	---	---	75.76	13.18	62.58	---
OMW-11	08/11/1998	<50	110	<0.50	<0.50	<0.50	<0.50	<2.5	---	---	---	---	---	---	---	75.76	13.50	62.26	---
OMW-11	10/20/1998	Well inaccessible		---	---	---	---	---	---	---	---	---	---	---	---	75.76	---	---	---
OMW-11	04/12/1999	Well inaccessible		---	---	---	---	---	---	---	---	---	---	---	---	75.76	---	---	---
OMW-11	07/27/1999	Well inaccessible		---	---	---	---	---	---	---	---	---	---	---	---	75.76	---	---	---
OMW-11	10/25/1999	Well inaccessible		---	---	---	---	---	---	---	---	---	---	---	---	75.76	---	---	---
OMW-11	01/24/2000	Well inaccessible		---	---	---	---	---	---	---	---	---	---	---	---	75.76	---	---	---
OMW-11	04/24/2000	Well inaccessible		---	---	---	---	---	---	---	---	---	---	---	---	75.76	---	---	---
OMW-11	05/11/2000	<50.0	<50.0	<0.500	<0.500	<0.500	<0.500	<2.50	---	---	---	---	---	---	---	75.76	12.21	63.55	---
OMW-11	07/24/2000	Well inaccessible		---	---	---	---	---	---	---	---	---	---	---	---	75.76	---	---	---
OMW-11	07/29/2000	Well inaccessible		---	---	---	---	---	---	---	---	---	---	---	---	75.76	---	---	---
OMW-11	10/26/2000	b	<50.0	<0.500	<0.500	<0.500	<0.500	<2.50	---	---	---	---	---	---	---	75.76	12.47	63.29	1.5
OMW-11	11/01/2000	Well inaccessible		---	---	---	---	---	---	---	---	---	---	---	---	75.76	---	---	---
OMW-11	01/19/2001	Well inaccessible		---	---	---	---	---	---	---	---	---	---	---	---	75.76	12.29	63.47	---
OMW-11	04/13/2001	Well inaccessible		---	---	---	---	---	---	---	---	---	---	---	---	75.76	---	---	---
OMW-11	04/26/2001	Well inaccessible		---	---	---	---	---	---	---	---	---	---	---	---	75.76	---	---	---
OMW-11	04/27/2001	Well inaccessible		---	---	---	---	---	---	---	---	---	---	---	---	75.76	---	---	---
OMW-11	07/09/2001	<50	130	<0.50	<0.50	<0.50	<0.50	---	<5.0	---	---	---	---	---	---	75.76	13.00	62.76	3.6
OMW-11	10/18/2001	<50	200	<0.50	<0.50	<0.50	<0.50	---	<5.0	---	---	---	---	---	---	75.76	13.35	62.41	0.6
OMW-11	01/24/2002	170	<50	<0.50	<0.50	<0.50	<0.50	---	<5.0	---	---	---	---	---	---	75.76	12.18	63.58	1.7
OMW-11	05/10/2002	<50	180	<0.50	<0.50	<0.50	<0.50	---	<5.0	---	---	---	---	---	---	75.76	12.44	63.32	1.3
OMW-11	07/18/2002	68	230	<0.50	<0.50	<0.50	<0.50	---	<5.0	---	---	---	---	---	---	75.76	12.32	63.44	1.9
OMW-11	10/31/2002	<50	210	<0.50	<0.50	<0.50	<0.50	---	<5.0	---	---	---	---	---	---	78.67	12.70	65.97	---



TABLE 1

**GROUNDWATER DATA  
FORMER SHELL SERVICE STATION  
500 40TH STREET, OAKLAND, CALIFORNIA**

Well ID	Date	TPHd (µg/L)	TPHg (µg/L)	B (µg/L)	T (µg/L)	E (µg/L)	X (µg/L)	MTBE		TBA (µg/L)	DIPE (µg/L)	ETBE (µg/L)	TAME (µg/L)	1,2- DCA		EDB (µg/L)	TOC (ft MSL)	Depth to Water (ft TOC)	GW Elevation (ft MSL)	DO Reading (mg/L)
								8020 (µg/L)	8260 (µg/L)					µg/L	µg/L					
OMW-11	01/30/2003	Well inaccessible		---	---	---	---	---	---	---	---	---	---	---	---	---	78.67	---	---	---
OMW-11	04/17/2003	Well inaccessible		---	---	---	---	---	---	---	---	---	---	---	---	---	78.67	---	---	---
OMW-11	07/17/2003	<50	120 n	<0.50	<0.50	<0.50	<1.0	---	<0.50	---	---	---	---	---	---	---	78.67	12.56	66.11	---
OMW-11	10/16/2003	Well inaccessible		---	---	---	---	---	---	---	---	---	---	---	---	---	78.67	---	---	---
OMW-11	01/14/2004	<50	97 n	<0.50	0.67	<0.50	<1.0	---	<0.50	---	---	---	---	---	---	---	78.67	12.17	66.50	1.6
OMW-11	04/14/2004	---	---	---	---	---	---	---	---	---	---	---	---	---	---	---	78.67	12.41	66.26	---
OMW-11	10/29/2004	---	---	---	---	---	---	---	---	---	---	---	---	---	---	---	78.67	12.31	66.36	---
OMW-11	04/14/2005	Well destroyed		---	---	---	---	---	---	---	---	---	---	---	---	---	---	---	---	---
OMW-12	12/02/1991	<50	<1,000	<0.5	<0.5	<0.5	<0.5	---	---	---	---	---	---	---	---	---	75.65	10.31	65.34	---
OMW-12	03/18/1992	<50	<50	<0.5	<0.5	<0.5	<0.5	---	---	---	---	---	---	---	---	---	75.65	8.93	66.72	---
OMW-12	05/20/1992	---	180 n	<0.5	<0.5	<0.5	<0.5	---	---	---	---	---	---	---	---	---	75.65	10.26	65.39	---
OMW-12	08/19/1992	---	230 n	<0.5	<0.5	<0.5	<0.5	---	---	---	---	---	---	---	---	---	75.65	10.53	65.12	---
OMW-12	11/18/1992	---	220 n	<0.5	<0.5	<0.5	<0.5	---	---	---	---	---	---	---	---	---	75.65	10.45	65.20	---
OMW-12	02/11/1993	---	240	<0.5	<0.5	<0.5	<0.5	---	---	---	---	---	---	---	---	---	75.65	8.90	66.75	---
OMW-12	05/19/1993	---	110 n	<0.5	<0.5	<0.5	<0.5	---	---	---	---	---	---	---	---	---	75.65	10.60	65.05	---
OMW-12	08/18/1993	---	140 n	<0.5	<0.5	<0.5	<0.5	---	---	---	---	---	---	---	---	---	75.65	10.28	65.37	---
OMW-12	11/17/1993	---	120 n	<0.5	<0.5	<0.5	<0.5	---	---	---	---	---	---	---	---	---	75.65	10.24	65.41	---
OMW-12	02/18/1994	---	180 n	1.7	2.1	0.9	4.8	---	---	---	---	---	---	---	---	---	75.65	8.97	66.68	---
OMW-12	05/26/1994	---	150	<0.5	<0.5	<0.5	<0.5	---	---	---	---	---	---	---	---	---	75.65	9.62	66.03	---
OMW-12	08/29/1994	---	110	<0.5	<0.5	<0.5	<0.5	---	---	---	---	---	---	---	---	---	75.65	10.20	65.45	---
OMW-12	11/11/1994	---	90	<0.5	<0.5	<0.5	<0.5	---	---	---	---	---	---	---	---	---	75.65	8.54	67.11	---
OMW-12	02/03/1995	---	80	<0.5	<0.5	<0.5	<0.5	---	---	---	---	---	---	---	---	---	75.65	8.28	67.37	---
OMW-12 (D)	02/03/1995	---	100	0.6	<0.5	0.7	1.1	---	---	---	---	---	---	---	---	---	75.65	---	---	---
OMW-12	05/07/1995	---	110	<0.5	<0.5	<0.5	<0.5	---	---	---	---	---	---	---	---	---	75.65	9.17	66.48	---
OMW-12	08/02/1995	---	90	<0.5	<0.5	<0.5	<0.5	---	---	---	---	---	---	---	---	---	75.65	10.06	65.59	---
OMW-12 (D)	08/02/1995	---	120	<0.5	<0.5	<0.5	<0.5	---	---	---	---	---	---	---	---	---	75.65	---	---	---
OMW-12	11/02/1995	---	130	<0.5	<0.5	<0.5	<0.5	---	---	---	---	---	---	---	---	---	75.65	10.09	65.56	---
OMW-12	02/24/1996	---	80	<0.5	<0.5	<0.5	<0.5	---	---	---	---	---	---	---	---	---	75.65	7.81	67.84	---
OMW-12	05/04/1996	---	61	<0.50	<0.50	<0.50	<0.50	<2.5	---	---	---	---	---	---	---	---	75.65	11.72	63.93	---
OMW-12	09/07/1996	---	66	<0.50	<0.50	<0.50	<0.50	<2.5	---	---	---	---	---	---	---	---	75.65	12.65	63.00	---
OMW-12	11/24/1996	---	70	<0.50	<0.50	<0.50	<0.50	<2.5	---	---	---	---	---	---	---	---	75.65	11.54	64.11	---
OMW-12	02/23/1997	---	<50	<0.50	<0.50	<0.50	<0.50	<2.5	---	---	---	---	---	---	---	---	75.65	11.53	64.12	---

TABLE 1

**GROUNDWATER DATA  
FORMER SHELL SERVICE STATION  
500 40TH STREET, OAKLAND, CALIFORNIA**

Well ID	Date	TPHd (µg/L)	TPHg (µg/L)	B (µg/L)	T (µg/L)	E (µg/L)	X (µg/L)	MTBE		TBA (µg/L)	DIPE (µg/L)	ETBE (µg/L)	TAME (µg/L)	1,2-		TOC (ft MSL)	Depth to Water (ft TOC)	GW Elevation (ft MSL)	DO Reading (mg/L)
								8020 (µg/L)	8260 (µg/L)					DCA (µg/L)	EDB (µg/L)				
OMW-12	05/01/1997	---	79	<0.50	<0.50	<0.50	<0.50	<2.5	---	---	---	---	---	---	---	75.65	12.17	63.48	---
OMW-12	07/22/1997	---	<50	<0.50	<0.50	<0.50	<0.50	<2.5	---	---	---	---	---	---	---	75.65	12.48	63.17	---
OMW-12 (D)	07/22/1997	---	51	<0.50	<0.50	<0.50	<0.50	<2.5	---	---	---	---	---	---	---	75.65	---	---	---
OMW-12	11/04/1997	---	<50	<0.50	<0.50	<0.50	<0.50	<5.0	---	---	---	---	---	---	---	75.65	12.54	63.11	---
OMW-12	01/21/1998	---	<50	<0.50	<0.50	<0.50	<0.50	<2.5	---	---	---	---	---	---	---	75.65	9.82	65.83	---
OMW-12	05/11/1998	---	53	<0.50	<0.50	<0.50	<0.50	<2.5	---	---	---	---	---	---	---	75.65	11.63	64.02	---
OMW-12	08/11/1998	---	<50	<0.50	<0.50	<0.50	<0.50	<2.5	---	---	---	---	---	---	---	75.65	12.05	63.60	---
OMW-12	10/20/1998	---	<50	<0.50	<0.50	<0.50	<0.50	<2.5	---	---	---	---	---	---	---	75.65	12.31	63.34	---
OMW-12	02/08/1999	---	<50	<0.50	<0.50	<0.50	<0.50	<2.5	---	---	---	---	---	---	---	75.65	8.25	67.40	---
OMW-12	04/12/1999	Well inaccessible		---	---	---	---	---	---	---	---	---	---	---	---	75.65	---	---	---
OMW-12	07/27/1999	---	<50.0	<0.500	<0.500	<0.500	<0.500	<2.50	---	---	---	---	---	---	---	75.65	10.88	64.77	---
OMW-12	10/25/1999	---	<50.0	<0.500	<0.500	<0.500	<0.500	<5.00	---	---	---	---	---	---	---	75.65	11.00	64.65	---
OMW-12	01/24/2000	Well inaccessible		---	---	---	---	---	---	---	---	---	---	---	---	75.65	---	---	---
OMW-12	04/24/2000	---	<50.0	<0.500	<0.500	<0.500	<0.500	<2.50	---	---	---	---	---	---	---	75.65	10.53	65.12	2.0
OMW-12	07/24/2000	---	<50.0	<0.500	<0.500	<0.500	<0.500	<2.50	---	---	---	---	---	---	---	75.65	11.55	64.10	---
OMW-12	11/01/2000	---	<50.0	<0.500	<0.500	<0.500	<0.500	<2.50	---	---	---	---	---	---	---	75.65	10.34	65.31	2.6
OMW-12	01/19/2001	---	<50.0	<0.500	<0.500	<0.500	<0.500	<2.50	---	---	---	---	---	---	---	75.65	10.60	65.05	7.6
OMW-12	04/13/2001	---	<50.0	<0.500	<0.500	<0.500	<0.500	<2.50	---	---	---	---	---	---	---	75.65	10.75	64.90	2.8
OMW-12	07/09/2001	---	69	<0.50	<0.50	<0.50	<0.50	---	<5.0	---	---	---	---	---	---	75.65	11.64	64.01	4.8
OMW-12	10/18/2001	---	81	<0.50	<0.50	<0.50	<0.50	---	<5.0	---	---	---	---	---	---	75.65	11.95	63.70	1.3
OMW-12	01/24/2002	---	<50	<0.50	<0.50	<0.50	<0.50	---	<5.0	---	---	---	---	---	---	75.65	10.27	65.38	3.4
OMW-12	05/10/2002	---	73	<0.50	<0.50	<0.50	<0.50	---	<5.0	---	---	---	---	---	---	75.65	10.86	64.79	1.6
OMW-12	07/18/2002	---	71	<0.50	<0.50	<0.50	<0.50	---	<5.0	---	---	---	---	---	---	75.65	10.66	64.99	1.7
OMW-12	10/31/2002	---	76	<0.50	<0.50	<0.50	<0.50	---	<5.0	---	---	---	---	---	---	78.58	11.20	67.38	---
OMW-12	01/30/2003	---	58	<0.50	<0.50	<0.50	<0.50	---	<5.0	---	---	---	---	---	---	78.58	10.30	68.28	---
OMW-12	04/17/2003	---	<50	<0.50	<0.50	<0.50	<1.0	---	<5.0	---	---	---	---	---	---	78.58	10.17	68.41	---
OMW-12	07/17/2003	---	<50	<0.50	<0.50	<0.50	<1.0	---	<0.50	---	---	---	---	---	---	78.58	11.05	67.53	---
OMW-12	10/16/2003	---	<50	<0.50	<0.50	<0.50	<1.0	---	<0.50	---	---	---	---	---	---	78.58	11.33	67.25	---
OMW-12	01/14/2004	---	67 n	<0.50	0.87	<0.50	<1.0	---	<0.50	---	---	---	---	---	---	78.58	10.50	68.08	2.8
OMW-12	04/14/2004	---	---	---	---	---	---	---	---	---	---	---	---	---	---	78.58	10.85	67.73	---
OMW-12	10/29/2004	---	---	---	---	---	---	---	---	---	---	---	---	---	---	78.58	10.72	67.86	---
OMW-12	04/14/2005	Well destroyed		---	---	---	---	---	---	---	---	---	---	---	---	---	---	---	---

**GROUNDWATER DATA  
FORMER SHELL SERVICE STATION  
500 40TH STREET, OAKLAND, CALIFORNIA**

Well ID	Date	TPHd (µg/L)	TPHg (µg/L)	B (µg/L)	T (µg/L)	E (µg/L)	X (µg/L)	MTBE		TBA (µg/L)	DIPE (µg/L)	ETBE (µg/L)	TAME (µg/L)	1,2- DCA		EDB (µg/L)	TOC (ft MSL)	Depth to Water (ft TOC)	GW Elevation (ft MSL)	DO Reading (mg/L)
								8020 (µg/L)	8260 (µg/L)					µg/L	µg/L					
OMW-13	11/22/1991	1,000	900	37	9.5	74	130	---	---	---	---	---	---	---	---	---	76.36	11.96	64.40	---
OMW-13	03/18/1992	590 n	900 n	24	28	320	320	---	---	---	---	---	---	---	---	---	76.36	10.84	65.52	---
OMW-13	05/20/1992	Well inaccessible		---	---	---	---	---	---	---	---	---	---	---	---	---	76.36	---	---	---
OMW-13	08/19/1992	470 n	7,000	180	36	150	150	---	---	---	---	---	---	---	---	---	76.36	12.12	64.24	---
OMW-13	11/18/1992	Well inaccessible		---	---	---	---	---	---	---	---	---	---	---	---	---	76.36	12.00	64.36	---
OMW-13	02/11/1993	Well inaccessible		---	---	---	---	---	---	---	---	---	---	---	---	---	76.36	---	---	---
OMW-13	05/20/1993	---	9,200	320	83	490	950	---	---	---	---	---	---	---	---	---	76.36	12.26	64.10	---
OMW-13	08/18/1993	---	---	---	---	---	---	---	---	---	---	---	---	---	---	---	76.36	11.75	64.61	---
OMW-13	11/17/1993	3,800	38,000	210	<130	1,000	2,500	---	---	---	---	---	---	---	---	---	76.36	11.78	64.58	---
OMW-13	02/18/1994	Well inaccessible		---	---	---	---	---	---	---	---	---	---	---	---	---	76.36	---	---	---
OMW-13	05/26/1994	Well inaccessible		---	---	---	---	---	---	---	---	---	---	---	---	---	76.36	---	---	---
OMW-13	08/29/1994	---	---	---	---	---	---	---	---	---	---	---	---	---	---	---	76.36	---	---	---
OMW-13	11/11/1994	Well inaccessible		---	---	---	---	---	---	---	---	---	---	---	---	---	76.36	10.28	66.08	---
OMW-13	02/03/1995	---	1.0	---	---	---	---	---	---	---	---	---	---	---	---	---	76.36	10.01	66.35	---
OMW-13	03/05/1995	3,900	9,100	200	9.7	200	130	---	---	---	---	---	---	---	---	---	76.36	---	---	---
OMW-13	05/07/1995	Well inaccessible		---	---	---	---	---	---	---	---	---	---	---	---	---	76.36	---	---	---
OMW-13	08/02/1995	2,900	8,000	180	6.6	190	55	---	---	---	---	---	---	---	---	---	76.36	11.80	64.56	---
OMW-13	02/24/1996	Well inaccessible		---	---	---	---	---	---	---	---	---	---	---	---	---	76.36	---	---	---
OMW-13	05/04/1996	Well inaccessible		---	---	---	---	---	---	---	---	---	---	---	---	---	76.36	---	---	---
OMW-13	09/07/1996	Well inaccessible		---	---	---	---	---	---	---	---	---	---	---	---	---	76.36	---	---	---
OMW-13	11/24/1996	7,700	15,000	50	<20	74	60	<100	---	---	---	---	---	---	---	---	76.36	12.35	64.01	---
OMW-13	02/23/1997	Well inaccessible		---	---	---	---	---	---	---	---	---	---	---	---	---	76.36	---	---	---
OMW-13	05/01/1997	290	2,600	33	10	30	14	88	---	---	---	---	---	---	---	---	76.36	13.83	62.53	---
OMW-13	07/22/1997	Well inaccessible		---	---	---	---	---	---	---	---	---	---	---	---	---	76.36	---	---	---
OMW-13	11/04/1997	Well inaccessible		---	---	---	---	---	---	---	---	---	---	---	---	---	76.36	---	---	---
OMW-13	01/21/1998	Well inaccessible		---	---	---	---	---	---	---	---	---	---	---	---	---	76.36	---	---	---
OMW-13	05/11/1998	1,400	10,000	60	17	120	23	<50	---	---	---	---	---	---	---	---	76.36	13.21	63.15	---
OMW-13	08/11/1998	Well inaccessible		---	---	---	---	---	---	---	---	---	---	---	---	---	76.36	---	---	---
OMW-13	10/20/1998	Well inaccessible		---	---	---	---	---	---	---	---	---	---	---	---	---	76.36	---	---	---
OMW-13	02/08/1999	Well inaccessible		---	---	---	---	---	---	---	---	---	---	---	---	---	76.36	---	---	---
OMW-13	04/12/1999	Well inaccessible		---	---	---	---	---	---	---	---	---	---	---	---	---	76.36	---	---	---
OMW-13	07/27/1999	2,230	6,270	32.0	26.0	53.0	<5.00	33.0	---	---	---	---	---	---	---	---	76.36	11.87	64.49	---
OMW-13	10/25/1999	Well inaccessible		---	---	---	---	---	---	---	---	---	---	---	---	---	76.36	---	---	---

TABLE 1

**GROUNDWATER DATA  
FORMER SHELL SERVICE STATION  
500 40TH STREET, OAKLAND, CALIFORNIA**

Well ID	Date	TPHd (µg/L)	TPHg (µg/L)	B (µg/L)	T (µg/L)	E (µg/L)	X (µg/L)	MTBE		TBA (µg/L)	DIPE (µg/L)	ETBE (µg/L)	TAME (µg/L)	1,2- DCA		EDB (µg/L)	TOC (ft MSL)	Depth to Water (ft TOC)	GW Elevation (ft MSL)	DO Reading (mg/L)
								8020 (µg/L)	8260 (µg/L)					µg/L	µg/L					
OMW-13	01/24/2000	Well inaccessible		---	---	---	---	---	---	---	---	---	---	---	---	---	76.36	---	---	---
OMW-13	04/24/2000	Well inaccessible		---	---	---	---	---	---	---	---	---	---	---	---	---	76.36	---	---	---
OMW-13	05/11/2000	Well inaccessible		---	---	---	---	---	---	---	---	---	---	---	---	---	76.36	---	---	---
OMW-13	07/24/2000	Well inaccessible		---	---	---	---	---	---	---	---	---	---	---	---	---	76.36	---	---	---
OMW-13	07/29/2000	Well inaccessible		---	---	---	---	---	---	---	---	---	---	---	---	---	76.36	---	---	---
OMW-13	11/01/2000	Well inaccessible		---	---	---	---	---	---	---	---	---	---	---	---	---	76.36	---	---	---
OMW-13	11/15/2000	1,200	2,990	34.8	37.3	<10.0	<10.0	<50.0	---	---	---	---	---	---	---	---	76.36	12.35	64.01	1.4
OMW-13	01/19/2001	2,390	4,830	34.8	<5.00	93.1	<5.00	<25.0	---	---	---	---	---	---	---	---	76.36	12.17	64.19	7.0
OMW-13	04/13/2001	Well inaccessible		---	---	---	---	---	---	---	---	---	---	---	---	---	76.36	---	---	---
OMW-13	04/26/2001	Well inaccessible		---	---	---	---	---	---	---	---	---	---	---	---	---	76.36	---	---	---
OMW-13	04/27/2001	Well inaccessible		---	---	---	---	---	---	---	---	---	---	---	---	---	76.36	---	---	---
OMW-13	07/09/2001	<600	1,300	0.74	<0.50	<0.50	<0.50	---	<5.0	---	---	---	---	---	---	---	76.36	13.20	63.16	6.4
OMW-13	10/18/2001	Well inaccessible		---	---	---	---	---	---	---	---	---	---	---	---	---	76.36	---	---	---
OMW-13	11/01/2001	Well inaccessible		---	---	---	---	---	---	---	---	---	---	---	---	---	76.36	---	---	---
OMW-13	11/09/2001	<300	910	<0.50	<0.50	1.1	<0.50	---	<5.0	---	---	---	---	---	---	---	76.36	13.53	62.83	5.8
OMW-13	01/24/2002	<1,500	6,300	6.6	1.0	28	2.1	---	<10	---	---	---	---	---	---	---	76.36	12.23	64.13	2.9
OMW-13	05/10/2002	<400	2,800	3.5	<0.50	15	1.2	---	<5.0	---	---	---	---	---	---	---	76.36	12.59	63.77	1.0
OMW-13	07/18/2002	<1,000	3,300	4.3	0.70	29	1.8	---	<5.0	---	---	---	---	---	---	---	76.36	12.44	63.92	2.1
OMW-13	10/31/2002	<1,000	1,900	0.96	<0.50	7.5	<0.50	---	<5.0	---	---	---	---	---	---	---	---	12.86	---	---
OMW-13	01/30/2003	Well inaccessible		---	---	---	---	---	---	---	---	---	---	---	---	---	---	12.86	---	---
OMW-13	04/17/2003	1,800	5,800	11	1.3	34	2.9	---	<10	---	---	---	---	---	---	---	---	11.87	---	---
OMW-13	07/17/2003	930 n	5,100 n	3.1	<2.5	10	<5.0	---	<2.5	---	---	---	---	---	---	---	---	12.70	---	---
OMW-13	10/16/2003	740 n	3,100 n	<2.5	<2.5	<2.5	<5.0	---	<2.5	---	---	---	---	---	---	---	---	12.93	---	---
OMW-13	01/14/2004	2,100 n	7,800	6.3	<2.5	11	9.8	---	<2.5	---	---	---	---	---	---	---	---	12.57	---	1.2
OMW-13	04/14/2004	1,100 n	4,400	3.3	<2.5	7.6	<5.0	---	<2.5	---	---	---	---	---	---	---	---	12.50	---	---
OMW-13	10/29/2004	---	---	---	---	---	---	---	---	---	---	---	---	---	---	---	---	12.35	---	---
OMW-13	04/14/2005	2,000 f	4,900	5.0	<2.5	6.7	<5.0	---	<2.5	---	---	---	---	---	---	---	---	12.01	---	---
OMW-13	10/26/2005	Well inaccessible		---	---	---	---	---	---	---	---	---	---	---	---	---	---	---	---	---
OMW-13	03/16/2006	Well inaccessible		---	---	---	---	---	---	---	---	---	---	---	---	---	---	---	---	---
OMW-13	03/17/2006	Well inaccessible		---	---	---	---	---	---	---	---	---	---	---	---	---	---	---	---	---
OMW-13	03/27/2006	1,860 g	15,500	2.48	0.720	4.02	1.74	---	<0.500	<10.0	<0.500	<0.500	<0.500	<0.500	<0.500	---	---	11.23	---	---
OMW-13	09/20/2006	Well inaccessible		---	---	---	---	---	---	---	---	---	---	---	---	---	---	---	---	---
OMW-13	10/02/2006	1,110 g	4,660	<0.500	<0.500	0.510	<0.500	---	0.560	---	---	---	---	---	---	---	---	12.81	---	0.47

**GROUNDWATER DATA  
FORMER SHELL SERVICE STATION  
500 40TH STREET, OAKLAND, CALIFORNIA**

Well ID	Date	TPHd (µg/L)	TPHg (µg/L)	B (µg/L)	T (µg/L)	E (µg/L)	X (µg/L)	MTBE		TBA (µg/L)	DIPE (µg/L)	ETBE (µg/L)	TAME (µg/L)	1,2- DCA		EDB (µg/L)	TOC (ft MSL)	Depth to Water (ft TOC)	GW Elevation (ft MSL)	DO Reading (mg/L)
								8020 (µg/L)	8260 (µg/L)					µg/L	µg/L					
OMW-13	03/26/2007	730 g,n	1,800 i	<2.5 i	<2.5 i	<2.5 i	<2.5 i	---	<2.5 i	---	---	---	---	---	---	---	---	12.41	---	---
OMW-13	06/25/2007	440 g	1,800 l	<0.50	<1.0	0.33 m	0.41 m	---	<1.0	---	---	---	---	---	---	---	---	12.91	---	---
OMW-13	09/10/2007	Well inaccessible		---	---	---	---	---	---	---	---	---	---	---	---	---	---	---	---	---
OMW-13	09/24/2007	1,100 g,m	1,200 l	<0.50	<1.0	<1.0	<1.0	---	<1.0	---	---	---	---	---	---	---	---	12.93	---	---
OMW-13	12/10/2007	420 g,n	1,400 l	0.16 m	<1.0	<1.0	0.18 m	---	<1.0	---	---	---	---	---	---	---	---	12.50	---	---
OMW-13	03/10/2008	55 g	1,800	<0.50	<1.0	<1.0	<1.0	---	<1.0	---	---	---	---	---	---	---	---	12.35	---	---
OMW-13	06/23/2008	Well inaccessible		---	---	---	---	---	---	---	---	---	---	---	---	---	---	---	---	---
OMW-13	07/14/2008	Well inaccessible		---	---	---	---	---	---	---	---	---	---	---	---	---	---	---	---	---
OMW-13	07/16/2008	Well inaccessible		---	---	---	---	---	---	---	---	---	---	---	---	---	---	---	---	---
OMW-13	09/22/2008	180 n,g	460	<0.50	<1.0	<1.0	<1.0	---	<1.0	<10	<2.0	<2.0	<2.0	---	---	---	---	13.63	---	0.18
OMW-13	12/22/2008	610 n,g	1,700	<0.50	<1.0	<1.0	<1.0	---	<1.0	---	---	---	---	---	---	---	---	12.69	---	---
OMW-13	03/23/2009	Well inaccessible		---	---	---	---	---	---	---	---	---	---	---	---	---	---	---	---	---
OMW-13	09/21/2009	Well inaccessible		---	---	---	---	---	---	---	---	---	---	---	---	---	---	---	---	---
OMW-13	03/08/2010	1,400 g, n	5,300	0.60	<1.0	1.4	1.1	---	<1.0	---	---	---	---	---	---	---	---	11.90	---	---
OMW-13	09/27/2010	Well inaccessible		---	---	---	---	---	---	---	---	---	---	---	---	---	---	---	---	---
OMW-13	03/21/2011	Well inaccessible		---	---	---	---	---	---	---	---	---	---	---	---	---	---	---	---	---
OMW-13	09/26/2011	340 g	890	<0.50	<0.50	<0.50	<1.0	---	<1.0	<10	<1.0	<1.0	<1.0	---	---	---	---	13.39	---	0.71
OMW-13	03/26/2012	1,200 g	2,900	0.55	<0.50	0.57	<1.0	---	<0.50	---	---	---	---	---	---	---	---	11.67	---	1.21

Notes:

TPHd = Total petroleum hydrocarbons as diesel analyzed by modified EPA Method 8015

TPHg = Total petroleum hydrocarbons as gasoline by EPA Method 8260B; prior to July 9, 2001 analyzed by EPA Method 8015 unless otherwise noted.

BTEX = Benzene, toluene, ethylbenzene, and total xylenes analyzed by EPA Method 8260B

MTBE = Methyl tertiary-butyl ether analyzed by method indicated

TBA = Tertiary-butyl alcohol analyzed by EPA Method 8260B

DIPE = Di-isopropyl ether analyzed by EPA Method 8260B

ETBE = Ethyl tertiary-butyl ether analyzed by EPA Method 8260B

TAME = Tertiary-amyl methyl ether analyzed by EPA Method 8260B

1,2-DCA = 1,2-Dichloroethane analyzed by EPA Method 8260B

EDB = 1,2-Dibromoethane (ethylene dibromide) analyzed by EPA Method 8260B

TOC = Top of casing elevation, in feet relative to mean sea level

GW = Groundwater

DO = Dissolved oxygen

**GROUNDWATER DATA  
FORMER SHELL SERVICE STATION  
500 40TH STREET, OAKLAND, CALIFORNIA**

Well ID	Date	TPHd (µg/L)	TPHg (µg/L)	B (µg/L)	T (µg/L)	E (µg/L)	X (µg/L)	MTBE		TBA (µg/L)	DIPE (µg/L)	ETBE (µg/L)	TAME (µg/L)	1,2-		TOC (ft MSL)	Depth to Water (ft TOC)	GW Elevation (ft MSL)	DO Reading (mg/L)
								8020 (µg/L)	8260 (µg/L)					DCA (µg/L)	EDB (µg/L)				

µg/L = Micrograms per liter

ft = Feet

MSL = Mean sea level

mg/L = Milligrams per liter

<x = Not detected at reporting limit x

--- = Not analyzed or available

(D) = Duplicate sample

b = The TPHd analysis was not performed because the sample containers were broken in the laboratory.

d = TOC altered during wellhead maintenance.

f = Hydrocarbon reported is in the early diesel range, and does not match laboratory diesel standard.

g = Diesel with silica gel cleanup

i = Sample analyzed past method-specified hold time.

j = Sample container contained headspace.

l = Analyzed by EPA Method 8015B (M).

m = Analyte was detected at a concentration below the reporting limit and above the laboratory method detection limit. Reported value is estimated.

n = The sample chromatographic pattern for TPH does not match the chromatographic pattern of the specified standard. Quantitation of the unknown hydrocarbon(s) in the sample was based upon the specified standard.

o = Hydrocarbon result partly due to individual peak(s) in quantitation range.

DO readings are collected post-purge when wells are sampled and pre-purge in wells not sampled.

All wells except OMW-6, OMW-9, and OMW-13 surveyed March 18, 2002 by Virgil Chavez Land Surveying

Wells OMW-6 and OMW-9 surveyed October 25, 2005 by Virgil Chavez Land Surveying

APPENDIX A

BLAINE TECH SERVICES, INC. -  
FIELD NOTES

## WELL GAUGING DATA

Project # 120326-MM1 Date 3-26-12 Client Shell

Site 500 40<sup>th</sup> Telegraph, Oakland

Well ID	Time	Well Size (in.)	Sheen / Odor	Depth to Immiscible Liquid (ft.)	Thickness of Immiscible Liquid (ft.)	Volume of Immiscibles Removed (ml)	Depth to water (ft.)	Depth to well bottom (ft.)	Survey Point: TOB or <u>TOC</u>	Notes
MW-2	1220	4					11.81	19.60		
MW-3	0940	4					10.60	18.74		
MW-8	0930	4					10.27	38.80		
OMW-6			Parked Over				—	—		
OMW-9	1110	4					11.12	17.10		
OMW-13	1145	4					11.67	21.00	✓	STINGER





## SHELL WELL MONITORING DATA SHEET

BTS #: <u>120326-MMI</u>	Site: <u>500 40<sup>th</sup> Telegraph</u>
Sampler: <u>MM</u>	Date: <u>3-26-12</u>
Well I.D.: <u>OMW-6</u>	Well Diameter: 2 3 <u>4</u> 6 8 <u>    </u>
Total Well Depth (TD): <u>    </u>	Depth to Water (DTW): <u>    </u>
Depth to Free Product: <u>    </u>	Thickness of Free Product (feet): <u>    </u>
Referenced to: <u>PVC</u> Grade	D.O. Meter (if req'd): <u>YSL</u> HACH
DTW with 80% Recharge [(Height of Water Column x 0.20) + DTW]: <u>    </u>	

Purge Method: ~~Bailer~~ ~~Disposable Bailer~~ ~~Positive Air Displacement~~ ~~Electric Submersible~~ ~~Waterra~~ ~~Peristaltic~~ ~~Extraction Pump~~ ~~Other~~

Sampling Method: ~~Bailer~~ ~~Disposable Bailer~~ ~~Extraction Port~~ ~~Dedicated Tubing~~ ~~Other~~

NP @ 10.5'

\_\_\_\_\_ (Gals.) X \_\_\_\_\_ = \_\_\_\_\_ Gals.  
 1 Case Volume                      Specified Volumes                      Calculated Volume

Well Diameter	Multiplier	Well Diameter	Multiplier
1"	0.04	4"	0.65
2"	0.16	6"	1.47
3"	0.37	Other	radius <sup>2</sup> * 0.163

Time	Temp (°F)	pH	Cond. (mS or µS)	Turbidity (NTUs)	Gals. Removed	Observations
<u>WELL PARKED OVER</u>						
<u>- UNABLE TO ACCESS</u>						
<u>NO SAMPLE TAKEN</u>						

Did well dewater?    Yes    No                      Gallons actually evacuated: \_\_\_\_\_

Sampling Date: 3-26-12    Sampling Time: \_\_\_\_\_    Depth to Water: \_\_\_\_\_

Sample I.D.: OMW-6                      Laboratory: Test America    Other \_\_\_\_\_

Analyzed for:    TPH-G    BTEX    MTBE    TPH-D    Oxygenates (5)    Other: SEE COC

EB I.D. (if applicable): \_\_\_\_\_ @ \_\_\_\_\_ Time    Duplicate I.D. (if applicable): \_\_\_\_\_

Analyzed for:    TPH-G    BTEX    MTBE    TPH-D    Oxygenates (5)    Other: \_\_\_\_\_

D.O. (if req'd):	Pre-purge:	mg/L	Post-purge:	mg/L
O.R.P. (if req'd):	Pre-purge:	mV	Post-purge:	mV

## SHELL WELL MONITORING DATA SHEET

BTS #: 120326-MMI	Site: 500 40 <sup>th</sup> Telegraph
Sampler: MM	Date: 3-26-12
Well I.D.: OMW-9	Well Diameter: 2 3 <u>4</u> 6 8
Total Well Depth (TD): 17.10	Depth to Water (DTW): 11.12
Depth to Free Product: —	Thickness of Free Product (feet): —
Referenced to: <u>PVC</u> Grade	D.O. Meter (if req'd): <u>YSI</u> HACH
DTW with 80% Recharge [(Height of Water Column x 0.20) + DTW]: —	

Purge Method: Bailer ~~Disposable Bailer~~ ~~Positive Air Displacement~~ ~~Electric Submersible~~      Water ~~Peristaltic~~ ~~Extraction Pump~~ Other \_\_\_\_\_

Sampling Method: Bailer Disposable Bailer Extraction Port Dedicated Tubing

NP @ 7.5'

_____ (Gals.) X _____	= _____	Gals.
1 Case Volume	Specified Volumes	Calculated Volume

Well Diameter	Multiplier	Well Diameter	Multiplier
1"	0.04	4"	0.65
2"	0.16	6"	1.47
3"	0.37	Other	radius <sup>2</sup> * 0.163

Time	Temp (°F)	pH	Cond. (mS or <u>µS</u> )	Turbidity (NTUs)	Gals. Removed	Observations
1120	60.8	6.34	565.9	160	GRAB	

Did well dewater? Yes No Gallons actually evacuated: GRAB

Sampling Date: ~~3-26-12~~ <sup>MM 3-26-12</sup> Sampling Time: 1120 Depth to Water: 11.12

Sample I.D.: OMW-9 Laboratory: Test America Other \_\_\_\_\_

Analyzed for: TPH-G BTEX MTBE TPH-D Oxygenates (5) Other: see COC

EB I.D. (if applicable): @ \_\_\_\_\_ Time Duplicate I.D. (if applicable): \_\_\_\_\_

Analyzed for: TPH-G BTEX MTBE TPH-D Oxygenates (5) Other: \_\_\_\_\_

D.O. (if req'd):	Pre-purge:	mg/L	Post-purge:	0.65 mg/L
O.R.P. (if req'd):	Pre-purge:	mV	Post-purge:	mV



INCIDENT # 97093400

ADDRESS 500 40<sup>th</sup> Telegraph

DATE: 3-26-12

CITY & STATE Oakland CA

Well ID	Observations Upon Arrival													Note Repairs Made Detailed Explanation of Maintenance Recommended and Performed	Photos of Well Condition	Repair Date and PM Initials				
	Manway Cover, Type, Condition & Size					Well Labeled / Painted Properly*		Well Cap (Gripper) Condition		Well Lock Condition			Well Pad / Surface Condition							
MW-2	Standpipe	Flush	G	P	Size (inch) 12	Y	N	G	R	G	R	NL	G	P		Y	N			
MW-3	Standpipe	Flush	G	P	Size (inch) 12	Y	N	G	R	G	R	NL	G	P		Y	N			
MW-8	Standpipe	Flush	G	P	Size (inch) 8	Y	N	G	R	G	R	NL	G	P		Y	N			
OMW-6	Standpipe	Flush	G	P	Size (inch)	Y	N	G	R	G	R	NL	G	P	Unable to access well car park over well head	Y	N			
OMW-9	Standpipe	Flush	G	P	Size (inch) 8	Y	N	G	R	G	R	NL	G	P	city monument lid Christy box (style)	Y	N			
OMW-13	Standpipe	Flush	G	P	Size (inch) 8	Y	N	G	R	G	R	NL	G	P	Monument lid (Christy box (style))	Y	N			
	Standpipe	Flush	G	P	Size (inch)	Y	N	G	R	G	R	NL	G	P		Y	N			
	Standpipe	Flush	G	P	Size (inch)	Y	N	G	R	G	R	NL	G	P		Y	N			
	Standpipe	Flush	G	P	Size (inch)	Y	N	G	R	G	R	NL	G	P		Y	N			
	Standpipe	Flush	G	P	Size (inch)	Y	N	G	R	G	R	NL	G	P		Y	N			
TOTAL # CAPS REPLACED =									0	= TOTAL # OF LOCKS REPLACED										
Condition of Soil Boring Patches or Abandoned Monitoring Wells		G	P	N/A	IF POOR, Borings/Well IDs or Location Description:													Y	N	
Remediation Compound Type (Check boxes that apply)		Condition of Enclosure			Condition of Area Inside Enclosure			Compound Security			Emergency Contact Info. Visible			Cleaning / Repairs Recommended and Conducted			Photos of Condition	Repair Date and PM Initials		
NA		X																		
Building																				
Building w/ Fence Comp.		G	P	N/A	G	P	N/A	G	P	N/A	Y	N	N/A				Y	N		
Fenced Compound																				
Trailer																				
Number of Drums On-site	Does the Label Reveal the Source of the Contents	Labeled Correctly and Writing Legible			Drum Condition			Confirm Drums Related to Environmental		Drums Located to Min Business Interference			Detailed Explanation of Any Issues Resolved			Photos of Drum Condition	Date Drums Removed from Site and PM Initials			
0	Y	N	N/A	Y	N	N/A	G	P	N/A	Y	N	Y	N	N/A		Y	N			

G = Good (Acceptable) R = Replaced  
P = Poor (needs attention) NL = No Lock Required

Note: All repairs other than locks and grippers require Shell PM approval prior to repair.

All environmental wells and the remediation compound were in good condition, locked, and secured upon my departure (unless otherwise noted above).

\* = Groundwater monitoring well covers must be painted and labeled in accordance with applicable regulations.  
Version 2.4, March 2008

Mark McCulloch Blaine Tech Serv  
Print or type Name of Field Personnel & Consultant Company

APPENDIX B

TEST AMERICA -  
LABORATORY REPORT

# TestAmerica

THE LEADER IN ENVIRONMENTAL TESTING

## ANALYTICAL REPORT

TestAmerica Laboratories, Inc.

TestAmerica Irvine

17461 Derian Ave

Suite 100

Irvine, CA 92614-5817

Tel: (949)261-1022

TestAmerica Job ID: 440-7018-1

Client Project/Site: 500 40th St., Oakland, CA

For:

Conestoga-Rovers & Associates, Inc.

19449 Riverside Drive, Suite 230

Sonoma, California 95476

Attn: Peter Schaefer



Authorized for release by:

4/12/2012 2:20:24 PM

Philip Sanelle

Project Manager I

philip.sanelle@testamericainc.com

### LINKS

Review your project  
results through

Total Access

Have a Question?

Ask  
The  
Expert

Visit us at:

[www.testamericainc.com](http://www.testamericainc.com)

*The test results in this report meet all 2003 NELAC and 2009 TNI requirements for accredited parameters, exceptions are noted in this report. This report may not be reproduced except in full, and with written approval from the laboratory. For questions please contact the Project Manager at the e-mail address or telephone number listed on this page.*

*This report has been electronically signed and authorized by the signatory. Electronic signature is intended to be the legally binding equivalent of a traditionally handwritten signature.*

*Results relate only to the items tested and the sample(s) as received by the laboratory.*

# Table of Contents

Cover Page . . . . .	1
Table of Contents . . . . .	2
Sample Summary . . . . .	3
Client Sample Results . . . . .	4
Chronicle . . . . .	6
QC Sample Results . . . . .	7
QC Association . . . . .	11
Definitions . . . . .	12
Certification Summary . . . . .	13
Chain of Custody . . . . .	14
Receipt Checklists . . . . .	15



## Sample Summary

Client: Conestoga-Rovers & Associates, Inc.  
Project/Site: 500 40th St., Oakland, CA

TestAmerica Job ID: 440-7018-1

---

Lab Sample ID	Client Sample ID	Matrix	Collected	Received
440-7018-1	MW-3	Water	03/26/12 10:40	03/29/12 09:40
440-7018-2	OMW-9	Water	03/26/12 11:20	03/29/12 09:40
440-7018-3	OMW-13	Water	03/26/12 11:50	03/29/12 09:40

## Client Sample Results

Client: Conestoga-Rovers & Associates, Inc.  
Project/Site: 500 40th St., Oakland, CA

TestAmerica Job ID: 440-7018-1

**Client Sample ID: MW-3**

**Lab Sample ID: 440-7018-1**

Date Collected: 03/26/12 10:40

Matrix: Water

Date Received: 03/29/12 09:40

Method: 8260B/CA_LUFTMS - Volatile Organic Compounds by GC/MS									
Analyte	Result	Qualifier	RL	MDL	Unit	D	Prepared	Analyzed	Dil Fac
Volatile Fuel Hydrocarbons (C4-C12)	510		50		ug/L			04/07/12 15:52	1
Surrogate	%Recovery	Qualifier	Limits				Prepared	Analyzed	Dil Fac
Dibromofluoromethane (Surr)	103		80 - 120					04/07/12 15:52	1
4-Bromofluorobenzene (Surr)	103		80 - 120					04/07/12 15:52	1
Toluene-d8 (Surr)	102		80 - 120					04/07/12 15:52	1

Method: 8260B - Volatile Organic Compounds (GC/MS)									
Analyte	Result	Qualifier	RL	MDL	Unit	D	Prepared	Analyzed	Dil Fac
Benzene	1.9		0.50		ug/L			04/07/12 15:52	1
Ethylbenzene	12		0.50		ug/L			04/07/12 15:52	1
Toluene	ND		0.50		ug/L			04/07/12 15:52	1
Xylenes, Total	ND		1.0		ug/L			04/07/12 15:52	1
Methyl-t-Butyl Ether (MTBE)	ND		0.50		ug/L			04/07/12 15:52	1
Surrogate	%Recovery	Qualifier	Limits				Prepared	Analyzed	Dil Fac
4-Bromofluorobenzene (Surr)	103		80 - 120					04/07/12 15:52	1
Dibromofluoromethane (Surr)	103		80 - 120					04/07/12 15:52	1
Toluene-d8 (Surr)	102		80 - 120					04/07/12 15:52	1

Method: 8015B - Diesel Range Organics (DRO) (GC) Low Level - Silica Gel Cleanup									
Analyte	Result	Qualifier	RL	MDL	Unit	D	Prepared	Analyzed	Dil Fac
Diesel Range Organics [C10-C28]	210		48		ug/L		04/03/12 11:30	04/03/12 22:42	1
Surrogate	%Recovery	Qualifier	Limits				Prepared	Analyzed	Dil Fac
n-Octacosane	79		45 - 120				04/03/12 11:30	04/03/12 22:42	1

**Client Sample ID: OMW-9**

**Lab Sample ID: 440-7018-2**

Date Collected: 03/26/12 11:20

Matrix: Water

Date Received: 03/29/12 09:40

Method: 8260B/CA_LUFTMS - Volatile Organic Compounds by GC/MS									
Analyte	Result	Qualifier	RL	MDL	Unit	D	Prepared	Analyzed	Dil Fac
Volatile Fuel Hydrocarbons (C4-C12)	440		50		ug/L			04/07/12 16:20	1
Surrogate	%Recovery	Qualifier	Limits				Prepared	Analyzed	Dil Fac
Dibromofluoromethane (Surr)	100		80 - 120					04/07/12 16:20	1
4-Bromofluorobenzene (Surr)	102		80 - 120					04/07/12 16:20	1
Toluene-d8 (Surr)	102		80 - 120					04/07/12 16:20	1

Method: 8260B - Volatile Organic Compounds (GC/MS)									
Analyte	Result	Qualifier	RL	MDL	Unit	D	Prepared	Analyzed	Dil Fac
Benzene	2.9		0.50		ug/L			04/07/12 16:20	1
Ethylbenzene	0.50		0.50		ug/L			04/07/12 16:20	1
Toluene	ND		0.50		ug/L			04/07/12 16:20	1
Xylenes, Total	ND		1.0		ug/L			04/07/12 16:20	1
Methyl-t-Butyl Ether (MTBE)	0.57		0.50		ug/L			04/07/12 16:20	1
Surrogate	%Recovery	Qualifier	Limits				Prepared	Analyzed	Dil Fac
4-Bromofluorobenzene (Surr)	102		80 - 120					04/07/12 16:20	1
Dibromofluoromethane (Surr)	100		80 - 120					04/07/12 16:20	1

# Client Sample Results

Client: Conestoga-Rovers & Associates, Inc.  
 Project/Site: 500 40th St., Oakland, CA

TestAmerica Job ID: 440-7018-1

**Client Sample ID: OMW-9**

**Lab Sample ID: 440-7018-2**

Date Collected: 03/26/12 11:20

Matrix: Water

Date Received: 03/29/12 09:40

**Method: 8260B - Volatile Organic Compounds (GC/MS) (Continued)**

Surrogate	%Recovery	Qualifier	Limits	Prepared	Analyzed	Dil Fac
Toluene-d8 (Surr)	102		80 - 120		04/07/12 16:20	1

**Method: 8015B - Diesel Range Organics (DRO) (GC) Low Level - Silica Gel Cleanup**

Analyte	Result	Qualifier	RL	MDL	Unit	D	Prepared	Analyzed	Dil Fac
Diesel Range Organics [C10-C28]	320		47		ug/L		04/03/12 11:30	04/04/12 04:25	1

Surrogate	%Recovery	Qualifier	Limits	Prepared	Analyzed	Dil Fac
n-Octacosane	79		45 - 120	04/03/12 11:30	04/04/12 04:25	1

**Client Sample ID: OMW-13**

**Lab Sample ID: 440-7018-3**

Date Collected: 03/26/12 11:50

Matrix: Water

Date Received: 03/29/12 09:40

**Method: 8260B/CA\_LUFTMS - Volatile Organic Compounds by GC/MS**

Analyte	Result	Qualifier	RL	MDL	Unit	D	Prepared	Analyzed	Dil Fac
Volatile Fuel Hydrocarbons (C4-C12)	2900		50		ug/L			04/07/12 16:48	1

Surrogate	%Recovery	Qualifier	Limits	Prepared	Analyzed	Dil Fac
Dibromofluoromethane (Surr)	99		80 - 120		04/07/12 16:48	1
4-Bromofluorobenzene (Surr)	105		80 - 120		04/07/12 16:48	1
Toluene-d8 (Surr)	102		80 - 120		04/07/12 16:48	1

**Method: 8260B - Volatile Organic Compounds (GC/MS)**

Analyte	Result	Qualifier	RL	MDL	Unit	D	Prepared	Analyzed	Dil Fac
Benzene	0.55		0.50		ug/L			04/07/12 16:48	1
Ethylbenzene	0.57		0.50		ug/L			04/07/12 16:48	1
Toluene	ND		0.50		ug/L			04/07/12 16:48	1
Xylenes, Total	ND		1.0		ug/L			04/07/12 16:48	1
Methyl-t-Butyl Ether (MTBE)	ND		0.50		ug/L			04/07/12 16:48	1

Surrogate	%Recovery	Qualifier	Limits	Prepared	Analyzed	Dil Fac
4-Bromofluorobenzene (Surr)	105		80 - 120		04/07/12 16:48	1
Dibromofluoromethane (Surr)	99		80 - 120		04/07/12 16:48	1
Toluene-d8 (Surr)	102		80 - 120		04/07/12 16:48	1

**Method: 8015B - Diesel Range Organics (DRO) (GC) Low Level - Silica Gel Cleanup**

Analyte	Result	Qualifier	RL	MDL	Unit	D	Prepared	Analyzed	Dil Fac
Diesel Range Organics [C10-C28]	1200		48		ug/L		04/03/12 11:30	04/03/12 23:02	1

Surrogate	%Recovery	Qualifier	Limits	Prepared	Analyzed	Dil Fac
n-Octacosane	79		45 - 120	04/03/12 11:30	04/03/12 23:02	1

## Lab Chronicle

Client: Conestoga-Rovers & Associates, Inc.  
 Project/Site: 500 40th St., Oakland, CA

TestAmerica Job ID: 440-7018-1

**Client Sample ID: MW-3**

**Lab Sample ID: 440-7018-1**

Date Collected: 03/26/12 10:40

Matrix: Water

Date Received: 03/29/12 09:40

Prep Type	Batch Type	Batch Method	Run	Dil Factor	Initial Amount	Final Amount	Batch Number	Prepared or Analyzed	Analyst	Lab
Total/NA	Analysis	8260B		1	10 mL	10 mL	18157	04/07/12 15:52	AT	TAL IRV
Total/NA	Analysis	8260B/CA_LUFTMS		1	10 mL	10 mL	18158	04/07/12 15:52	WC	TAL IRV
Silica Gel Cleanup	Prep	3510C SGC			1040 mL	1 mL	17102	04/03/12 11:30	AB	TAL IRV
Silica Gel Cleanup	Analysis	8015B		1			17301	04/03/12 22:42	ES	TAL IRV

**Client Sample ID: OMW-9**

**Lab Sample ID: 440-7018-2**

Date Collected: 03/26/12 11:20

Matrix: Water

Date Received: 03/29/12 09:40

Prep Type	Batch Type	Batch Method	Run	Dil Factor	Initial Amount	Final Amount	Batch Number	Prepared or Analyzed	Analyst	Lab
Total/NA	Analysis	8260B		1	10 mL	10 mL	18157	04/07/12 16:20	AT	TAL IRV
Total/NA	Analysis	8260B/CA_LUFTMS		1	10 mL	10 mL	18158	04/07/12 16:20	WC	TAL IRV
Silica Gel Cleanup	Prep	3510C SGC			1060 mL	1 mL	17102	04/03/12 11:30	AB	TAL IRV
Silica Gel Cleanup	Analysis	8015B		1			17301	04/04/12 04:25	ES	TAL IRV

**Client Sample ID: OMW-13**

**Lab Sample ID: 440-7018-3**

Date Collected: 03/26/12 11:50

Matrix: Water

Date Received: 03/29/12 09:40

Prep Type	Batch Type	Batch Method	Run	Dil Factor	Initial Amount	Final Amount	Batch Number	Prepared or Analyzed	Analyst	Lab
Total/NA	Analysis	8260B		1	10 mL	10 mL	18157	04/07/12 16:48	AT	TAL IRV
Total/NA	Analysis	8260B/CA_LUFTMS		1	10 mL	10 mL	18158	04/07/12 16:48	WC	TAL IRV
Silica Gel Cleanup	Prep	3510C SGC			1050 mL	1 mL	17102	04/03/12 11:30	AB	TAL IRV
Silica Gel Cleanup	Analysis	8015B		1			17301	04/03/12 23:02	ES	TAL IRV

**Laboratory References:**

TAL IRV = TestAmerica Irvine, 17461 Derian Ave, Suite 100, Irvine, CA 92614-5817, TEL (949)261-1022

# QC Sample Results

Client: Conestoga-Rovers & Associates, Inc.  
 Project/Site: 500 40th St., Oakland, CA

TestAmerica Job ID: 440-7018-1

## Method: 8260B - Volatile Organic Compounds (GC/MS)

Lab Sample ID: MB 440-18157/4

Client Sample ID: Method Blank

Matrix: Water

Prep Type: Total/NA

Analysis Batch: 18157

Analyte	MB MB		RL	MDL	Unit	D	Prepared	Analyzed	Dil Fac
	Result	Qualifier							
Benzene	ND		0.50		ug/L			04/07/12 08:59	1
Ethylbenzene	ND		0.50		ug/L			04/07/12 08:59	1
Toluene	ND		0.50		ug/L			04/07/12 08:59	1
Xylenes, Total	ND		1.0		ug/L			04/07/12 08:59	1
Methyl-t-Butyl Ether (MTBE)	ND		0.50		ug/L			04/07/12 08:59	1

Surrogate	MB MB		Limits	Prepared	Analyzed	Dil Fac
	%Recovery	Qualifier				
4-Bromofluorobenzene (Surr)	101		80 - 120		04/07/12 08:59	1
Dibromofluoromethane (Surr)	100		80 - 120		04/07/12 08:59	1
Toluene-d8 (Surr)	101		80 - 120		04/07/12 08:59	1

Lab Sample ID: LCS 440-18157/5

Client Sample ID: Lab Control Sample

Matrix: Water

Prep Type: Total/NA

Analysis Batch: 18157

Analyte	Spike Added	LCS LCS		Unit	D	%Rec	%Rec. Limits
		Result	Qualifier				
Benzene	25.0	24.2		ug/L		97	70 - 120
Ethylbenzene	25.0	24.9		ug/L		100	75 - 125
Toluene	25.0	24.8		ug/L		99	70 - 120
m,p-Xylene	50.0	48.3		ug/L		97	75 - 125
Methyl-t-Butyl Ether (MTBE)	25.0	28.0		ug/L		112	60 - 135
o-Xylene	25.0	25.9		ug/L		104	75 - 125

Surrogate	LCS LCS		Limits
	%Recovery	Qualifier	
4-Bromofluorobenzene (Surr)	101		80 - 120
Dibromofluoromethane (Surr)	100		80 - 120
Toluene-d8 (Surr)	102		80 - 120

Lab Sample ID: 440-6946-C-10 MS

Client Sample ID: Matrix Spike

Matrix: Water

Prep Type: Total/NA

Analysis Batch: 18157

Analyte	Sample Result	Sample Qualifier	Spike Added	MS MS		Unit	D	%Rec	%Rec. Limits
				Result	Qualifier				
Benzene	ND		25.0	22.4		ug/L		90	65 - 125
Ethylbenzene	ND		25.0	22.9		ug/L		92	65 - 130
Toluene	ND		25.0	23.1		ug/L		92	70 - 125
m,p-Xylene	ND		50.0	44.0		ug/L		88	65 - 130
Methyl-t-Butyl Ether (MTBE)	ND		25.0	25.3		ug/L		101	55 - 145
o-Xylene	ND		25.0	23.9		ug/L		96	65 - 125

Surrogate	MS MS		Limits
	%Recovery	Qualifier	
4-Bromofluorobenzene (Surr)	102		80 - 120
Dibromofluoromethane (Surr)	104		80 - 120
Toluene-d8 (Surr)	101		80 - 120

## QC Sample Results

Client: Conestoga-Rovers & Associates, Inc.  
 Project/Site: 500 40th St., Oakland, CA

TestAmerica Job ID: 440-7018-1

### Method: 8260B - Volatile Organic Compounds (GC/MS) (Continued)

Lab Sample ID: 440-6946-C-10 MSD

Client Sample ID: Matrix Spike Duplicate

Matrix: Water

Prep Type: Total/NA

Analysis Batch: 18157

Analyte	Sample	Sample	Spike	MSD	MSD	Unit	D	%Rec	%Rec.	RPD	RPD
	Result	Qualifier	Added	Result	Qualifier				Limits		
Benzene	ND		25.0	22.0		ug/L		88	65 - 125	2	20
Ethylbenzene	ND		25.0	22.9		ug/L		92	65 - 130	0	20
Toluene	ND		25.0	23.0		ug/L		92	70 - 125	0	20
m,p-Xylene	ND		50.0	44.0		ug/L		88	65 - 130	0	25
Methyl-t-Butyl Ether (MTBE)	ND		25.0	24.2		ug/L		97	55 - 145	4	25
o-Xylene	ND		25.0	24.2		ug/L		97	65 - 125	1	20
<b>MSD MSD</b>											
Surrogate	%Recovery	Qualifier	Limits								
4-Bromofluorobenzene (Surr)	103		80 - 120								
Dibromofluoromethane (Surr)	102		80 - 120								
Toluene-d8 (Surr)	101		80 - 120								

### Method: 8260B/CA\_LUFTMS - Volatile Organic Compounds by GC/MS

Lab Sample ID: MB 440-18158/4

Client Sample ID: Method Blank

Matrix: Water

Prep Type: Total/NA

Analysis Batch: 18158

Analyte	MB	MB	RL	MDL	Unit	D	Prepared	Analyzed	Dil Fac
	Result	Qualifier							
Volatile Fuel Hydrocarbons (C4-C12)	ND		50		ug/L			04/07/12 08:59	1
<b>MB MB</b>									
Surrogate	%Recovery	Qualifier	Limits	Prepared	Analyzed	Dil Fac			
Dibromofluoromethane (Surr)	100		80 - 120		04/07/12 08:59	1			
4-Bromofluorobenzene (Surr)	101		80 - 120		04/07/12 08:59	1			
Toluene-d8 (Surr)	101		80 - 120		04/07/12 08:59	1			

Lab Sample ID: LCS 440-18158/6

Client Sample ID: Lab Control Sample

Matrix: Water

Prep Type: Total/NA

Analysis Batch: 18158

Analyte	Spike Added	LCS	LCS	Unit	D	%Rec	%Rec.
		Result	Qualifier				Limits
Volatile Fuel Hydrocarbons (C4-C12)	500	616		ug/L		123	55 - 130
<b>LCS LCS</b>							
Surrogate	%Recovery	Qualifier	Limits				
Dibromofluoromethane (Surr)	98		80 - 120				
4-Bromofluorobenzene (Surr)	102		80 - 120				
Toluene-d8 (Surr)	102		80 - 120				

Lab Sample ID: 440-6946-C-10 MS

Client Sample ID: Matrix Spike

Matrix: Water

Prep Type: Total/NA

Analysis Batch: 18158

Analyte	Sample	Sample	Spike	MS	MS	Unit	D	%Rec	%Rec.
	Result	Qualifier	Added	Result	Qualifier				Limits
Volatile Fuel Hydrocarbons (C4-C12)	ND		1730	1460		ug/L		85	50 - 145

## QC Sample Results

Client: Conestoga-Rovers & Associates, Inc.  
 Project/Site: 500 40th St., Oakland, CA

TestAmerica Job ID: 440-7018-1

### Method: 8260B/CA\_LUFTMS - Volatile Organic Compounds by GC/MS (Continued)

Lab Sample ID: 440-6946-C-10 MS  
 Matrix: Water  
 Analysis Batch: 18158

Client Sample ID: Matrix Spike  
 Prep Type: Total/NA

Surrogate	MS %Recovery	MS Qualifier	Limits
Dibromofluoromethane (Surr)	104		80 - 120
4-Bromofluorobenzene (Surr)	102		80 - 120
Toluene-d8 (Surr)	101		80 - 120

Lab Sample ID: 440-6946-C-10 MSD  
 Matrix: Water  
 Analysis Batch: 18158

Client Sample ID: Matrix Spike Duplicate  
 Prep Type: Total/NA

Analyte	Sample Result	Sample Qualifier	Spike Added	MSD Result	MSD Qualifier	Unit	D	%Rec	%Rec. Limits	RPD	RPD Limit
Volatile Fuel Hydrocarbons (C4-C12)	ND		1730	1410		ug/L		82	50 - 145	3	20

Surrogate	MSD %Recovery	MSD Qualifier	Limits
Dibromofluoromethane (Surr)	102		80 - 120
4-Bromofluorobenzene (Surr)	103		80 - 120
Toluene-d8 (Surr)	101		80 - 120

### Method: 8015B - Diesel Range Organics (DRO) (GC) Low Level

Lab Sample ID: MB 440-17102/1-A  
 Matrix: Water  
 Analysis Batch: 17301

Client Sample ID: Method Blank  
 Prep Type: Silica Gel Cleanup  
 Prep Batch: 17102

Analyte	MB Result	MB Qualifier	RL	MDL	Unit	D	Prepared	Analyzed	Dil Fac
Diesel Range Organics [C10-C28]	ND		50		ug/L		04/03/12 11:30	04/03/12 20:41	1

Surrogate	MB %Recovery	MB Qualifier	Limits	Prepared	Analyzed	Dil Fac
n-Octacosane	88		45 - 120	04/03/12 11:30	04/03/12 20:41	1

Lab Sample ID: LCS 440-17102/2-A  
 Matrix: Water  
 Analysis Batch: 17301

Client Sample ID: Lab Control Sample  
 Prep Type: Silica Gel Cleanup  
 Prep Batch: 17102

Analyte	Spike Added	LCS Result	LCS Qualifier	Unit	D	%Rec	%Rec. Limits
Diesel Range Organics [C10-C28]	1000	774		ug/L		77	40 - 115

Surrogate	LCS %Recovery	LCS Qualifier	Limits
n-Octacosane	84		45 - 120

Lab Sample ID: LCSD 440-17102/3-A  
 Matrix: Water  
 Analysis Batch: 17301

Client Sample ID: Lab Control Sample Dup  
 Prep Type: Silica Gel Cleanup  
 Prep Batch: 17102

Analyte	Spike Added	LCSD Result	LCSD Qualifier	Unit	D	%Rec	%Rec. Limits	RPD	RPD Limit
Diesel Range Organics [C10-C28]	1000	792		ug/L		79	40 - 115	2	25

# QC Sample Results

Client: Conestoga-Rovers & Associates, Inc.  
Project/Site: 500 40th St., Oakland, CA

TestAmerica Job ID: 440-7018-1

---

## Method: 8015B - Diesel Range Organics (DRO) (GC) Low Level (Continued)

---

Lab Sample ID: LCSD 440-17102/3-A

Matrix: Water

Analysis Batch: 17301

Client Sample ID: Lab Control Sample Dup

Prep Type: Silica Gel Cleanup

Prep Batch: 17102

<i>Surrogate</i>	<i>LCSD LCSD</i>		<i>Limits</i>
	<i>%Recovery</i>	<i>Qualifier</i>	
<i>n-Octacosane</i>	84		45 - 120



## QC Association Summary

Client: Conestoga-Rovers & Associates, Inc.  
 Project/Site: 500 40th St., Oakland, CA

TestAmerica Job ID: 440-7018-1

### GC/MS VOA

#### Analysis Batch: 18157

Lab Sample ID	Client Sample ID	Prep Type	Matrix	Method	Prep Batch
440-6946-C-10 MS	Matrix Spike	Total/NA	Water	8260B	
440-6946-C-10 MSD	Matrix Spike Duplicate	Total/NA	Water	8260B	
440-7018-1	MW-3	Total/NA	Water	8260B	
440-7018-2	OMW-9	Total/NA	Water	8260B	
440-7018-3	OMW-13	Total/NA	Water	8260B	
LCS 440-18157/5	Lab Control Sample	Total/NA	Water	8260B	
MB 440-18157/4	Method Blank	Total/NA	Water	8260B	

#### Analysis Batch: 18158

Lab Sample ID	Client Sample ID	Prep Type	Matrix	Method	Prep Batch
440-6946-C-10 MS	Matrix Spike	Total/NA	Water	8260B/CA_LUFT MS	
440-6946-C-10 MSD	Matrix Spike Duplicate	Total/NA	Water	8260B/CA_LUFT MS	
440-7018-1	MW-3	Total/NA	Water	8260B/CA_LUFT MS	
440-7018-2	OMW-9	Total/NA	Water	8260B/CA_LUFT MS	
440-7018-3	OMW-13	Total/NA	Water	8260B/CA_LUFT MS	
LCS 440-18158/6	Lab Control Sample	Total/NA	Water	8260B/CA_LUFT MS	
MB 440-18158/4	Method Blank	Total/NA	Water	8260B/CA_LUFT MS	

### GC Semi VOA

#### Prep Batch: 17102

Lab Sample ID	Client Sample ID	Prep Type	Matrix	Method	Prep Batch
440-7018-1	MW-3	Silica Gel Cleanup	Water	3510C SGC	
440-7018-2	OMW-9	Silica Gel Cleanup	Water	3510C SGC	
440-7018-3	OMW-13	Silica Gel Cleanup	Water	3510C SGC	
LCS 440-17102/2-A	Lab Control Sample	Silica Gel Cleanup	Water	3510C SGC	
LCSD 440-17102/3-A	Lab Control Sample Dup	Silica Gel Cleanup	Water	3510C SGC	
MB 440-17102/1-A	Method Blank	Silica Gel Cleanup	Water	3510C SGC	

#### Analysis Batch: 17301

Lab Sample ID	Client Sample ID	Prep Type	Matrix	Method	Prep Batch
440-7018-1	MW-3	Silica Gel Cleanup	Water	8015B	17102
440-7018-2	OMW-9	Silica Gel Cleanup	Water	8015B	17102
440-7018-3	OMW-13	Silica Gel Cleanup	Water	8015B	17102
LCS 440-17102/2-A	Lab Control Sample	Silica Gel Cleanup	Water	8015B	17102
LCSD 440-17102/3-A	Lab Control Sample Dup	Silica Gel Cleanup	Water	8015B	17102
MB 440-17102/1-A	Method Blank	Silica Gel Cleanup	Water	8015B	17102

## Definitions/Glossary

Client: Conestoga-Rovers & Associates, Inc.  
Project/Site: 500 40th St., Oakland, CA

TestAmerica Job ID: 440-7018-1

---

### Glossary

---

Abbreviation	These commonly used abbreviations may or may not be present in this report.
☆	Listed under the "D" column to designate that the result is reported on a dry weight basis
%R	Percent Recovery
CNF	Contains no Free Liquid
DL, RA, RE, IN	Indicates a Dilution, Reanalysis, Re-extraction, or additional Initial metals/anion analysis of the sample
EDL	Estimated Detection Limit
EPA	United States Environmental Protection Agency
MDL	Method Detection Limit
ML	Minimum Level (Dioxin)
ND	Not detected at the reporting limit (or MDL or EDL if shown)
PQL	Practical Quantitation Limit
QC	Quality Control
RL	Reporting Limit
RPD	Relative Percent Difference, a measure of the relative difference between two points
TEF	Toxicity Equivalent Factor (Dioxin)
TEQ	Toxicity Equivalent Quotient (Dioxin)

## Certification Summary

Client: Conestoga-Rovers & Associates, Inc.  
Project/Site: 500 40th St., Oakland, CA

TestAmerica Job ID: 440-7018-1

Laboratory	Authority	Program	EPA Region	Certification ID
TestAmerica Irvine	Arizona	State Program	9	AZ0671
TestAmerica Irvine	California	LA Cty Sanitation Districts	9	10256
TestAmerica Irvine	California	NELAC	9	1108CA
TestAmerica Irvine	California	State Program	9	2706
TestAmerica Irvine	Guam	State Program	9	Cert. No. 12.002r
TestAmerica Irvine	Hawaii	State Program	9	N/A
TestAmerica Irvine	Nevada	State Program	9	CA015312007A
TestAmerica Irvine	New Mexico	State Program	6	N/A
TestAmerica Irvine	Northern Mariana Islands	State Program	9	MP0002
TestAmerica Irvine	Oregon	NELAC	10	4005
TestAmerica Irvine	USDA	Federal		P330-09-00080

Accreditation may not be offered or required for all methods and analytes reported in this package. Please contact your project manager for the laboratory's current list of certified methods and analytes.

LAB (LOCATION)



Shell Oil Products Chain Of Custody Record

- CALSCIENCE ( )
- SPL Houston ( )
- XENCO ( )
- TEST AMERICA (IRVINE)
- OTHER ( )

Please Check Appropriate Box:

<input type="checkbox"/> ENV. SERVICES	<input type="checkbox"/> MOTIVA RETAIL	<input type="checkbox"/> SHELL RETAIL
<input type="checkbox"/> MOTIVA SD&CM	<input checked="" type="checkbox"/> CONSULTANT	<input type="checkbox"/> LUBES
<input type="checkbox"/> SHELL PIPELINE	<input type="checkbox"/> OTHER	

Print Bill To Contact Name: 241513 Peter Schaefer

INCIDENT # (ENV SERVICES) 9 7 0 9 3 4 0 0

PO # SAP #

DATE: 3-26-12

PAGE: 1 of 1

SAMPLING COMPANY: Blaine Tech Services

LOG CODE: BTSS

SITE ADDRESS: Street and City 500 40th St., Oakland

State: CA GLOBAL ID NO.: T0600101265

ADDRESS: 1680 Rogers Avenue, San Jose, CA

EDF DELIVERABLE TO (Name, Company, Office Location): Brenda Carter, CRA, Emeryville, CA

PHONE NO.: 510-420-3343

E-MAIL: ShellEDF@CRAWorld.com, Shell-US-LabDataManagement@CRAWorld.com

CONSULTANT PROJECT NO.: 241513-95-12.04

PROJECT CONTACT (Hardcopy or PDF Report to): Lorin King

TELEPHONE: (310) 885-4455 x 108 FAX: (310) 637-5802 E-MAIL: lking@blainetech.com

SAMPLER NAME(S) (Print): Mark McColloch

LAB USE ONLY: 440-7018

TURNAROUND TIME (CALENDAR DAYS):

STANDARD (14 DAY)  5 DAYS  3 DAYS  2 DAYS  24 HOURS  RESULTS NEEDED ON WEEKEND

LA - RWQCB REPORT FORMAT  UST AGENCY:

REQUESTED ANALYSIS

SPECIAL INSTRUCTIONS OR NOTES:

1) Please upload the "CRA EQUIS 4-file EDD" to the CRA Website (<http://cralabupload.craworld.com/equis/default.aspx>) and/or send it to the Shell-US-LabDataManagement@CRAWorld.com email folder. 2) Please indicate that you have uploaded the EDD by including "EDD Uploaded to CRA website" in the body of the email used to deliver the final PDF report to the Shell-US-LabDataManagement@CRAWorld.com email folder.

Copy final report to Shell.Lab.Billing@craworld.com, ShellEDF@craworld.com, Shell-US-LabDataManagement@CRAWorld.com, and pschaefer@craworld.com

Email invoice to Shell.Lab.Billing@craworld.com

TEMPERATURE ON RECEIPT: 3.5°

Container PID Readings or Laboratory Notes

Matrix Codes - WG (groundwater), WS (surface water), WP (drinking water source), W (Trip or Temp Blank)

LAB USE ONLY	PROJECT NUMBER	DATE (MMDDYY)	SAMPLER INITIALS	WELL ID	TIME	MATRIX	PRESERVATIVE					NO. OF CONT.	TPH-GRG, Purgeable (8260B)	TPH-DRO, Extractable (8015M)	BTEX (8260B)	BTEX + MTBE (8260B)	BTEX + MTBE + TBA (8260B)	BTEX + 5 OXYs (MTBE, TBA, DIPE, TAME, ETBE) (8260B)	VOCs Full list (8260B)	Single Compound: (8260B)	1,2 DCA (8260B)	EDB (8260B)	Ethanol (8260B)	Methanol (8015B)																									
							HCL	HNO3	H2SO4	NONE	OTHER																																						
	WG-120326-MMH	032612	MM	MW-31040	WG	X						X	X																																				
	WG-120326-MMH	032612	MM	OMW91120	WG	X						X	X																																				
	WG-120326-MMH	032612	MM	OMW131150	WG	X						X	X																																				

Requested by: (Signature) [Signature]

Received by: (Signature) [Signature] (sample Custodian)

Date: 3-26-12 Time: 16:30

Requested by: (Signature) [Signature] (Sample Custodian)

Received by: (Signature) [Signature]

Date: 3/28/12 Time: 1120

Requested by: (Signature) [Signature]

Received by: (Signature) [Signature]

Date: 3/29/12 Time: 9:40

4/22/2012

## Login Sample Receipt Checklist

Client: Conestoga-Rovers & Associates, Inc.

Job Number: 440-7018-1

Login Number: 7018

List Source: TestAmerica Irvine

List Number: 1

Creator: Escalante, Maria

Question	Answer	Comment
Radioactivity either was not measured or, if measured, is at or below background	N/A	
The cooler's custody seal, if present, is intact.	N/A	
The cooler or samples do not appear to have been compromised or tampered with.	True	
Samples were received on ice.	True	
Cooler Temperature is acceptable.	True	
Cooler Temperature is recorded.	True	
COC is present.	True	
COC is filled out in ink and legible.	True	
COC is filled out with all pertinent information.	True	
Is the Field Sampler's name present on COC?	True	
There are no discrepancies between the sample IDs on the containers and the COC.	True	
Samples are received within Holding Time.	True	
Sample containers have legible labels.	True	
Containers are not broken or leaking.	True	
Sample collection date/times are provided.	True	
Appropriate sample containers are used.	True	
Sample bottles are completely filled.	True	
Sample Preservation Verified.	True	
There is sufficient vol. for all requested analyses, incl. any requested MS/MSDs	True	
VOA sample vials do not have headspace or bubble is <6mm (1/4") in diameter.	N/A	
Multiphasic samples are not present.	True	
Samples do not require splitting or compositing.	N/A	
Residual Chlorine Checked.	N/A	