



**CONESTOGA-ROVERS
& ASSOCIATES**

5900 Hollis Street, Suite A
Emeryville, California 94608
Telephone: (510) 420-0700 Fax: (510) 420-9170
www.CRAworld.com

TRANSMITTAL

DATE: May 4, 2011 REFERENCE NO.: 241513
PROJECT NAME: 500 40th Street, Oakland

TO: Jerry Wickham
Alameda County Environmental Health
1131 Harbor Bay Parkway, Suite 250
Alameda, California 94502-6577

RECEIVED

1:29 pm, May 05, 2011
Alameda County
Environmental Health

Please find enclosed: Draft Final
 Originals Other
 Prints

Sent via: Mail Same Day Courier
 Overnight Courier Other GeoTracker and Alameda County FTP

QUANTITY	DESCRIPTION
1	Groundwater Monitoring Report - First Quarter 2011

As Requested For Review and Comment
 For Your Use _____

COMMENTS:
If you have any questions regarding the contents of this document, please call Peter Schaefer at (510) 420-3319.

Copy to: Denis Brown, Shell Oil Products US (electronic copy)
Young Song and In Song, Trustees, 1015 Sanders Drive, Moraga, CA 94556

Completed by: Peter Schaefer Signed: *Peter Schaefer*

Filing: **Correspondence File**



Mr. Jerry Wickham
Alameda County Environmental Health
1131 Harbor Bay Parkway, Suite 250
Alameda, California 94205-6577

Denis L. Brown
Shell Oil Products US
HSE – Environmental Services
20945 S. Wilmington Ave.
Carson, CA 90810-1039
Tel (707) 865 0251
Fax (707) 865 2542
Email denis.l.brown@shell.com

Re: Former Shell Service Station
500 40th Street
Oakland, California
SAP Code 129452
Incident No. 97093400
ACEH Case No. RO0000264

Dear Mr. Wickham:

The attached document is provided for your review and comment. Upon information and belief, I declare, under penalty of perjury, that the information contained in the attached document is true and correct.

As always, please feel free to contact me directly at (707) 865-0251 with any questions or concerns.

Sincerely,

A handwritten signature in black ink, appearing to read "Denis L. Brown", is written over a horizontal line.

Denis L. Brown
Senior Program Manager



GROUNDWATER MONITORING REPORT - FIRST QUARTER 2011

**FORMER SHELL SERVICE STATION
500 40TH STREET
OAKLAND, CALIFORNIA**

**SAP CODE 129452
INCIDENT NO. 97093400
AGENCY NO. RO0000264**

**MAY 4, 2011
REF. NO. 241513 (7)**
This report is printed on recycled paper.

**Prepared by:
Conestoga-Rovers
& Associates**

5900 Hollis Street, Suite A
Emeryville, California
U.S.A. 94608

Office: (510) 420-0700
Fax: (510) 420-9170

web: <http://www.CRAworld.com>

TABLE OF CONTENTS

	<u>Page</u>
1.0 INTRODUCTION.....	1
1.1 SITE INFORMATION	1
2.0 SITE ACTIVITIES AND FINDINGS.....	1
2.1 CURRENT QUARTER'S ACTIVITIES.....	1
2.2 CURRENT QUARTER'S FINDINGS	1
2.3 PROPOSED ACTIVITIES.....	2

LIST OF FIGURES
(Following Text)

- FIGURE 1 VICINITY MAP
FIGURE 2 GROUNDWATER CONTOUR AND CHEMICAL CONCENTRATION MAP

LIST OF TABLES
(Following Text)

- TABLE 1 GROUNDWATER DATA

LIST OF APPENDICES

- APPENDIX A BLAINE TECH SERVICES, INC. - FIELD NOTES
APPENDIX B TEST AMERICA - LABORATORY REPORT

1.0 INTRODUCTION

Conestoga-Rovers & Associates (CRA) prepared this report on behalf of Equilon Enterprises LLC dba Shell Oil Products US (Shell).

1.1 SITE INFORMATION

Site Address	500 40 th Street, Oakland
Site Use	Shopping center
Shell Project Manager	Denis Brown
CRA Project Manager	Peter Schaefer
Lead Agency and Contact	ACEH, Jerry Wickham
Agency Case No.	RO0000264
Shell SAP Code	129452
Shell Incident No.	97093400

Date of most recent agency correspondence was March 7, 2011.

2.0 SITE ACTIVITIES AND FINDINGS

2.1 CURRENT QUARTER'S ACTIVITIES

Blaine Tech Services, Inc. (Blaine) gauged and sampled the wells according to the established monitoring program for this site.

CRA prepared a vicinity map (Figure 1), a groundwater contour and chemical concentration map (Figure 2), and a groundwater data table (Table 1). Blaine's field notes are presented in Appendix A, and the laboratory report is presented in Appendix B.

2.2 CURRENT QUARTER'S FINDINGS

Groundwater Flow Direction	Southwesterly
Hydraulic Gradient	Averages 0.05

Depth to Water

10.21 to 12.18 feet below top of well casing

2.3 PROPOSED ACTIVITIES

Blaine will gauge and sample wells according to the established monitoring program for this site. This site is monitored semiannually during the first and third quarters, and CRA will issue groundwater monitoring reports semiannually following the sampling events.

As discussed in our February 17, 2011 meeting with Alameda County Environmental Health (ACEH) and requested in ACEH's March 7, 2011 letter, CRA will submit a soil vapor investigation work plan to ACEH by May 27, 2011.

All of Which is Respectfully Submitted,
CONESTOGA-ROVERS & ASSOCIATES

Peter Schaefer
Peter Schaefer, CEG, CHG

Aubrey K Cool
Aubrey K. Cool, PG

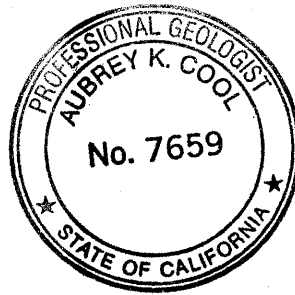

FIGURES

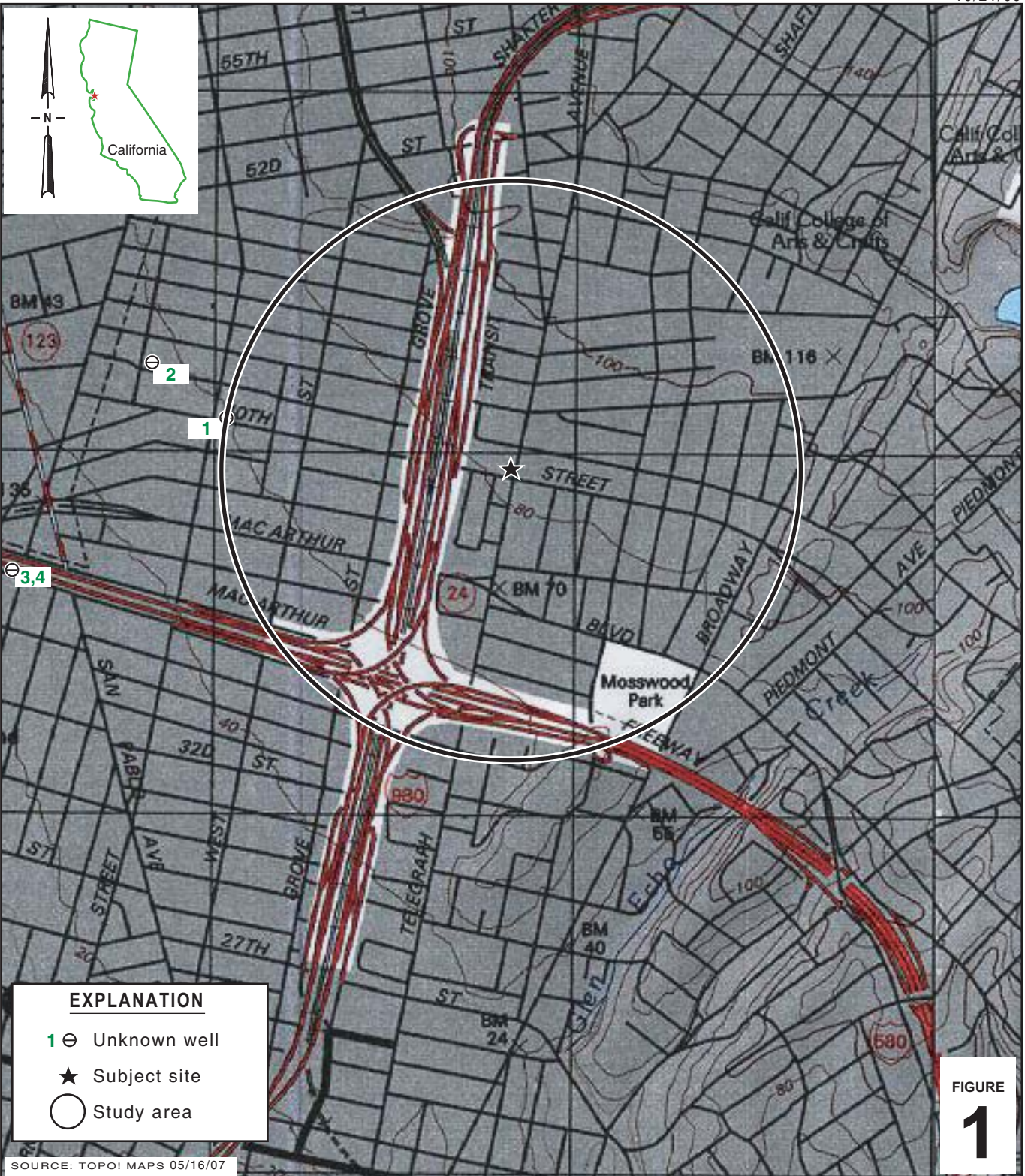

I:\Shell\6-chars\2415--\241513-Oakland 500 40th\241513-FIGURES\241513 VICINITY.A1

FIGURE 1

0 1/8 1/4 1/2 1
SCALE : 1" = 1/4 MILE

Former Shell Service Station
500 40th Street
Oakland, California



CONESTOGA-ROVERS & ASSOCIATES

Vicinity Map

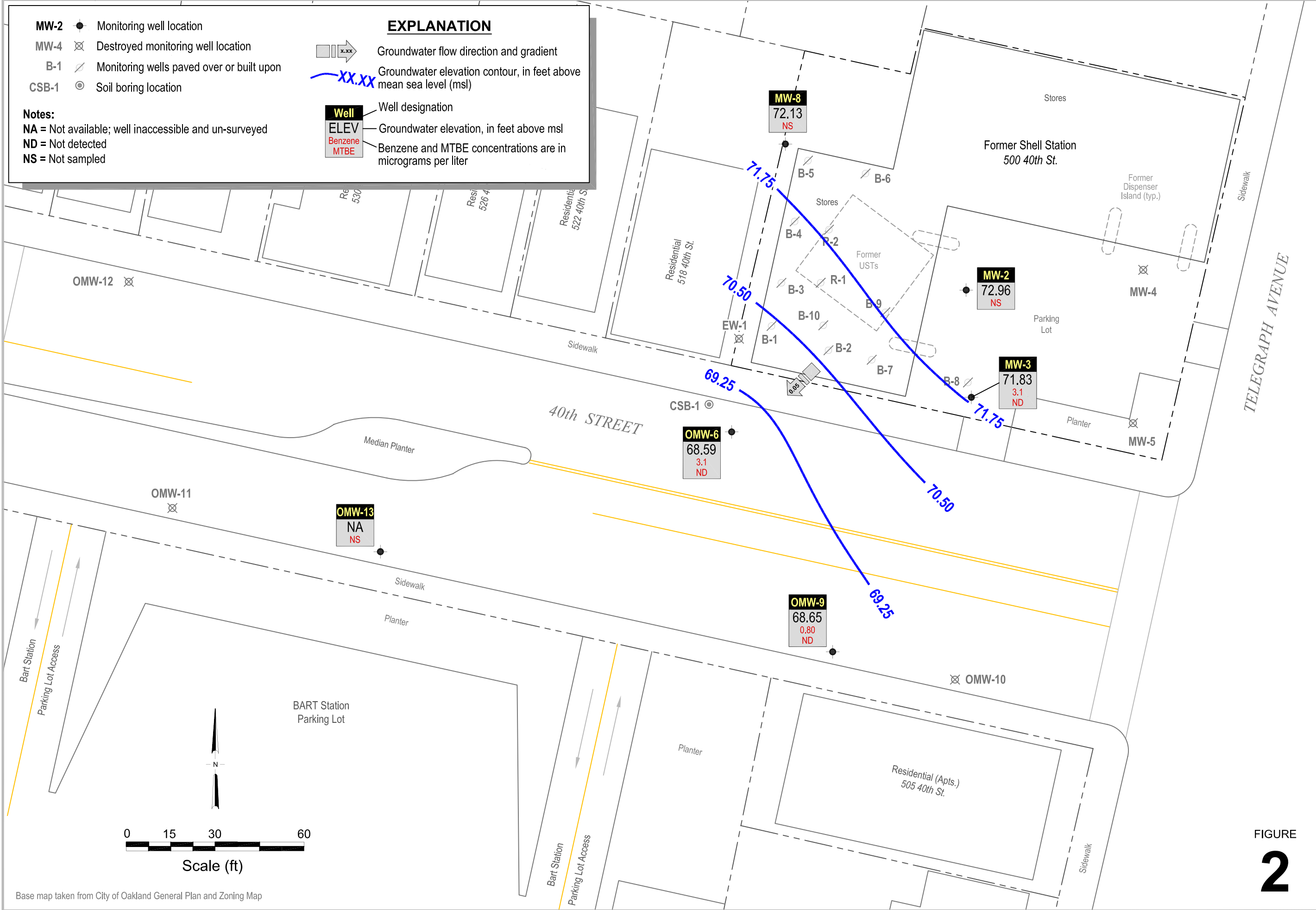

I:\Shell\6-chars\2415-1-241513-Oakland 500 40th\241513-REPORTS\241513-RPT7-10111241513 TOM11-GW.DWG

Base map taken from City of Oakland General Plan and Zoning Map

FIGURE 2

TABLE

TABLE 1

GROUNDWATER DATA
FORMER SHELL SERVICE STATION
500 40TH STREET, OAKLAND, CALIFORNIA

Well ID	Date	TPPH (ug/L)	TEPH (ug/L)	B (ug/L)	T ug/L	E ug/L	X ug/L	MTBE		DIPE ug/L	ETBE ug/L	TAME ug/L	TBA ug/L	1,2-		TOC MSL	Depth to Water ft	GW Elevation MSL	DO Reading pp,
								8020 ug/L	8260 ug/L					DCA ug/L	EDB ug/L				
EW-1	8/6/1991	180	<50	5.4	<0.5	0.9	0.7	--	--	--	--	--	--	--	--	78.26	--	--	--
EW-1	10/30/1991	70	<50	2.6	<0.5	<0.5	<0.5	--	--	--	--	--	--	--	--	78.26	12.72	65.54	--
EW-1	2/15/1992	<50	--	2.1	<0.5	<0.5	<0.5	--	--	--	--	--	--	--	--	78.26	--	--	--
EW-1	3/18/1992	--	--	--	--	--	--	--	--	--	--	--	--	--	--	78.26	11.71	66.55	--
EW-1	5/22/1992	99	--	4.1	<0.5	<0.5	<0.5	--	--	--	--	--	--	--	--	78.26	12.84	65.42	--
EW-1	8/19/1992	140	--	6.6	<0.5	<0.5	<0.5	--	--	--	--	--	--	--	--	78.26	13.04	65.22	--
EW-1	11/18/1992	56	--	<0.5	<0.5	<0.5	<0.5	--	--	--	--	--	--	--	--	78.26	12.90	65.36	--
EW-1	2/11/1993	63	--	<0.5	<0.5	<0.5	0.9	--	--	--	--	--	--	--	--	78.26	11.28	66.98	--
EW-1 (D)	2/11/1993	63	--	<0.5	<0.5	<0.5	0.8	--	--	--	--	--	--	--	--	78.26	--	--	--
EW-1	5/19/1993	60a	--	<0.5	<0.5	<0.5	<0.5	--	--	--	--	--	--	--	--	78.26	12.52	65.74	--
EW-1	8/18/1993	--	--	--	--	--	--	--	--	--	--	--	--	--	--	78.26	12.48	65.78	--
EW-1	11/17/1993	170	--	17	<0.5	<0.5	<0.5	--	--	--	--	--	--	--	--	78.26	12.63	65.63	--
EW-1 (D)	11/17/1993	190	--	17	<0.5	<0.5	<0.5	--	--	--	--	--	--	--	--	78.26	--	--	--
EW-1	2/18/1994	--	--	--	--	--	--	--	--	--	--	--	--	--	--	78.26	11.38	66.88	--
EW-1	5/26/1994	<50	--	3.5	<0.5	<0.5	0.51	--	--	--	--	--	--	--	--	78.26	12.02	66.24	--
EW-1	8/29/1994	--	--	--	--	--	--	--	--	--	--	--	--	--	--	78.26	12.76	65.50	--
EW-1	11/11/1994	200	--	13	0.88	<0.5	<0.5	--	--	--	--	--	--	--	--	78.26	11.08	67.18	--
EW-1	2/3/1995	--	--	--	--	--	--	--	--	--	--	--	--	--	--	78.26	10.88	67.38	--
EW-1	5/7/1995	90	--	8.6	<0.5	<0.5	<0.5	--	--	--	--	--	--	--	--	78.26	11.32	66.94	--
EW-1	8/2/1995	--	--	--	--	--	--	--	--	--	--	--	--	--	--	78.26	11.76	66.50	--
EW-1	11/2/1995	240	--	12	1.5	0.6	1.9	--	--	--	--	--	--	--	--	78.26	12.80	65.46	--
EW-1	2/24/1996	--	--	--	--	--	--	--	--	--	--	--	--	--	--	78.26	10.15	68.11	--
EW-1	5/4/1996	<50	--	1.4	<0.50	<0.50	<0.50	4.1	--	--	--	--	--	--	--	78.26	12.26	66.00	--
EW-1	9/7/1996	--	--	--	--	--	--	--	--	--	--	--	--	--	--	78.26	13.43	64.83	--
EW-1	11/24/1996	<50	--	<0.50	<0.50	<0.50	<0.50	<2.5	--	--	--	--	--	--	--	78.26	12.24	66.02	--
EW-1	2/23/1997	--	--	--	--	--	--	--	--	--	--	--	--	--	--	78.26	12.20	66.06	--
EW-1	5/1/1997	<50	--	<0.50	<0.50	<0.50	<0.50	<2.5	--	--	--	--	--	--	--	78.26	12.97	65.29	--
EW-1	7/22/1997	--	--	--	--	--	--	--	--	--	--	--	--	--	--	78.26	13.43	64.83	--
EW-1	11/4/1997	<50	--	<0.50	<0.50	<0.50	<0.50	<5.0	--	--	--	--	--	--	--	78.26	13.20	65.06	--
EW-1	1/21/1998	--	--	--	--	--	--	--	--	--	--	--	--	--	--	78.26	10.52	67.74	--
EW-1	5/11/1998	<50	--	<0.50	<0.50	<0.50	<0.50	<2.5	--	--	--	--	--	--	--	78.26	12.35	65.91	--
EW-1	8/11/1998	--	--	--	--	--	--	--	--	--	--	--	--	--	--	78.26	12.90	65.36	--
EW-1	10/20/1998	<50	--	<0.50	<0.50	<0.50	<0.50	<2.5	--	--	--	--	--	--	--	78.26	13.34	64.92	--

TABLE 1

GROUNDWATER DATA
FORMER SHELL SERVICE STATION
500 40TH STREET, OAKLAND, CALIFORNIA

Well ID	Date	TPPH (ug/L)	TEPH (ug/L)	B (ug/L)	T (ug/L)	E (ug/L)	X (ug/L)	MTBE 8020 (ug/L)	MTBE 8260 (ug/L)	DIPE (ug/L)	ETBE (ug/L)	TAME (ug/L)	TBA (ug/L)	1,2- DCA (ug/L)	EDB (ug/L)	TOC MSL	Depth to Water ft	GW Elevation MSL	DO Reading pp.
EW-1	2/8/1999	--	--	--	--	--	--	--	--	--	--	--	--	--	--	78.26	9.28	68.98	--
EW-1	4/12/1999	<50.0	--	<0.500	<0.500	<0.500	<0.500	<5.00	--	--	--	--	--	--	--	78.26	10.28	67.98	--
EW-1	7/27/1999	--	--	--	--	--	--	--	--	--	--	--	--	--	--	78.26	13.04	65.22	--
EW-1	10/25/1999	<50.0	--	0.885	<0.500	<0.500	<0.500	<5.00	--	--	--	--	--	--	--	78.26	13.12	65.14	--
EW-1	1/24/2000	--	--	--	--	--	--	--	--	--	--	--	--	--	--	78.26	10.50	67.76	2.0
EW-1	4/24/2000	<50.0	--	<0.500	<0.500	<0.500	<0.500	<2.50	--	--	--	--	--	--	--	78.26	12.05	66.21	1.8
EW-1	7/24/2000	--	--	--	--	--	--	--	--	--	--	--	--	--	--	78.26	13.00	65.26	--
EW-1	11/1/2000	<50.0	--	<0.500	<0.500	<0.500	<0.500	<2.50	--	--	--	--	--	--	--	78.26	12.15	66.11	2.4
EW-1	1/19/2001	--	--	--	--	--	--	--	--	--	--	--	--	--	--	78.26	12.24	66.02	4.4
EW-1	4/13/2001	<50.0	--	<0.500	<0.500	<0.500	<0.500	<2.50	--	--	--	--	--	--	--	78.26	12.56	65.70	5.8
EW-1	7/9/2001	--	--	--	--	--	--	--	--	--	--	--	--	--	--	78.26	12.97	65.29	4.2
EW-1	10/18/2001	<50	--	<0.50	<0.50	<0.50	<0.50	--	<5.0	--	--	--	--	--	--	78.26	13.69	64.57	0.3
EW-1	1/24/2002	--	--	--	--	--	--	--	--	--	--	--	--	--	--	78.26	11.98	66.28	c
EW-1	5/10/2002	<50	--	<0.50	<0.50	<0.50	<0.50	--	<5.0	--	--	--	--	--	--	78.26	12.68	65.58	2.3
EW-1	7/18/2002	Well inaccessible		--	--	--	--	--	--	--	--	--	--	--	--	78.26	--	--	--
EW-1	10/31/2002	<50	--	<0.50	<0.50	<0.50	<0.50	--	<5.0	--	--	--	--	--	--	81.11	13.38	67.73	--
EW-1	1/30/2003	--	--	--	--	--	--	--	--	--	--	--	--	--	--	81.11	11.43	69.68	--
EW-1	4/17/2003	<50	--	<0.50	<0.50	<0.50	<1.0	--	<5.0	--	--	--	--	--	--	81.11	11.55	69.56	--
EW-1	7/17/2003	--	--	--	--	--	--	--	--	--	--	--	--	--	--	81.11	12.84	68.27	--
EW-1	10/16/2003	<50	--	<0.50	<0.50	<0.50	<1.0	--	<0.50	--	--	--	--	--	--	81.11	13.00	68.11	--
EW-1	1/14/2004	--	--	--	--	--	--	--	--	--	--	--	--	--	--	81.11	11.15	69.96	--
EW-1	4/14/2004	--	--	--	--	--	--	--	--	--	--	--	--	--	--	81.11	12.41	68.70	--
EW-1	10/29/2004	--	--	--	--	--	--	--	--	--	--	--	--	--	--	81.11	12.08	69.03	--
EW-1	4/14/2005	Well destroyed		--	--	--	--	--	--	--	--	--	--	--	--	81.11	--	--	--
MW-2	8/6/1991	1200	230	59	1.1	38	56	--	--	--	--	--	--	--	--	80.80	12.12	68.68	--
MW-2	10/30/1991	520	300	56	<0.5	56	100	--	--	--	--	--	--	--	--	80.80	11.70	69.10	--
MW-2	2/15/1992	2300	2200a	87	<2.5	88	150	--	--	--	--	--	--	--	--	80.80	--	--	--
MW-2	3/18/1992	--	--	--	--	--	--	--	--	--	--	--	--	--	--	80.80	11.10	69.70	--
MW-2	5/22/1992	700	--	24	1.0	34	48	--	--	--	--	--	--	--	--	80.80	12.12	68.68	--
MW-2	8/19/1992	740	--	21	<2.5	24	26	--	--	--	--	--	--	--	--	80.80	12.18	68.62	--
MW-2 (D)	8/19/1992	840	--	31	<2.5	36	43	--	--	--	--	--	--	--	--	80.80	--	--	--
MW-2	11/18/1992	920	--	19	<2.5	30	51	--	--	--	--	--	--	--	--	80.80	12.03	68.77	--

TABLE 1

GROUNDWATER DATA
FORMER SHELL SERVICE STATION
500 40TH STREET, OAKLAND, CALIFORNIA

Well ID	Date	TPPH (ug/L)	TEPH (ug/L)	B (ug/L)	T (ug/L)	E (ug/L)	X (ug/L)	MTBE 8020 (ug/L)	MTBE 8260 (ug/L)	DIPE (ug/L)	ETBE (ug/L)	TAME (ug/L)	TBA (ug/L)	1,2- DCA (ug/L)	EDB (ug/L)	TOC MSL	Depth to Water ft	GW Elevation MSL	DO Reading pp,
MW-2 (D)	11/18/1992	870	--	25	<2.5	34	52	--	--	--	--	--	--	--	--	80.80	--	--	--
MW-2	2/11/1993	1000	--	25	6.0	43	73	--	--	--	--	--	--	--	--	80.80	11.15	69.65	--
MW-2	5/19/1993	570	--	19	<0.5	37	42	--	--	--	--	--	--	--	--	80.80	11.80	69.00	--
MW-2	8/18/1993	Well inaccessible	--	--	--	--	--	--	--	--	--	--	--	--	--	80.80	--	--	--
MW-2	11/17/1993	250	--	10	<1.0	26	20	--	--	--	--	--	--	--	--	80.80	12.00	68.80	--
MW-2	2/18/1994	Well inaccessible	--	--	--	--	--	--	--	--	--	--	--	--	--	80.80	--	--	--
MW-2	5/26/1994	620	--	17	1.4	25	31	--	--	--	--	--	--	--	--	80.80	11.61	69.19	--
MW-2 (D)	5/26/1994	600	--	16	1.2	24	29	--	--	--	--	--	--	--	--	80.80	--	--	--
MW-2	8/29/1994	--	--	--	--	--	--	--	--	--	--	--	--	--	--	80.80	11.96	68.84	--
MW-2	11/11/1994	1100	--	28	3.1	39	65	--	--	--	--	--	--	--	--	80.80	10.74	70.06	--
MW-2	2/3/1995	--	--	--	--	--	--	--	--	--	--	--	--	--	--	80.80	11.58	69.22	--
MW-2	5/7/1995	700	--	15	<0.5	35	39	--	--	--	--	--	--	--	--	80.80	10.98	69.82	--
MW-2	8/2/1995	--	--	--	--	--	--	--	--	--	--	--	--	--	--	80.80	11.90	68.90	--
MW-2	11/2/1995	140	--	2.3	<0.5	4.4	3.7	--	--	--	--	--	--	--	--	80.80	12.12	68.68	--
MW-2	2/24/1996	--	--	--	--	--	--	--	--	--	--	--	--	--	--	80.80	10.25	70.55	--
MW-2	5/4/1996	140	--	2.1	<0.50	4.6	4.9	6.2	--	--	--	--	--	--	--	80.80	11.30	69.50	--
MW-2	9/7/1996	--	--	--	--	--	--	--	--	--	--	--	--	--	--	80.80	15.10	65.70	--
MW-2	11/24/1996	620	--	9.7	<0.50	2.0	46	<2.5	--	--	--	--	--	--	--	80.80	12.13	68.67	--
MW-2	2/23/1997	--	--	--	--	--	--	--	--	--	--	--	--	--	--	80.80	12.01	68.79	--
MW-2	5/1/1997	<50	--	<0.50	<0.50	<0.50	<0.50	<2.5	--	--	--	--	--	--	--	80.80	12.94	67.86	--
MW-2	7/22/1997	--	--	--	--	--	--	--	--	--	--	--	--	--	--	80.80	13.22	67.58	--
MW-2	11/4/1997	<50	--	<0.50	<0.50	<0.50	<0.50	<5.0	--	--	--	--	--	--	--	80.80	13.00	67.80	--
MW-2	1/21/1998	--	--	--	--	--	--	--	--	--	--	--	--	--	--	80.80	10.47	70.33	--
MW-2	5/11/1998	59	--	0.56	<0.50	<0.50	<0.50	<2.5	--	--	--	--	--	--	--	80.80	12.49	68.31	--
MW-2	8/11/1998	--	--	--	--	--	--	--	--	--	--	--	--	--	--	80.80	12.82	67.98	--
MW-2	10/20/1998	<50	--	<0.50	<0.50	<0.50	<0.50	<2.5	--	--	--	--	--	--	--	80.80	13.13	67.67	--
MW-2	2/8/1999	--	--	--	--	--	--	--	--	--	--	--	--	--	--	80.80	9.10	71.70	--
MW-2	4/12/1999	<50.0	--	<0.500	<0.500	<0.500	<0.500	<5.00	--	--	--	--	--	--	--	80.80	10.06	70.74	--
MW-2	7/27/1999	--	--	--	--	--	--	--	--	--	--	--	--	--	--	80.80	12.81	67.99	--
MW-2	10/25/1999	<50.0	--	<0.500	<0.500	<0.500	<0.500	<5.00	--	--	--	--	--	--	--	80.80	12.89	67.91	--
MW-2	1/24/2000	Well inaccessible	--	--	--	--	--	--	--	--	--	--	--	--	--	80.80	--	--	--
MW-2	4/24/2000	<50.0	--	<0.500	<0.500	<0.500	<0.500	<2.50	--	--	--	--	--	--	--	80.80	19.35	61.45	1.8
MW-2	7/24/2000	--	--	--	--	--	--	--	--	--	--	--	--	--	--	80.80	12.83	67.97	--

GROUNDWATER DATA
FORMER SHELL SERVICE STATION
500 40TH STREET, OAKLAND, CALIFORNIA

Well ID	Date	TPPH (ug/L)	TEPH (ug/L)	B (ug/L)	T ug/L	E ug/L	X ug/L	MTBE		DIPE ug/L	ETBE ug/L	TAME ug/L	TBA ug/L	1,2- DCA ug/L	EDB ug/L	TOC MSL	Depth to Water ft	GW Elevation MSL	DO Reading pp.
								8020 ug/L	8260 ug/L										
MW-2	11/1/2000	53.2	--	<0.500	<0.500	<0.500	<0.500	<2.50	--	--	--	--	--	--	--	80.80	11.75	69.05	2.4
MW-2	1/19/2001	--	--	--	--	--	--	--	--	--	--	--	--	--	--	80.80	12.22	68.58	5.8
MW-2	4/13/2001	<50.0	--	<0.500	<0.500	<0.500	<0.500	<2.50	--	--	--	--	--	--	--	80.80	12.40	68.40	3.0
MW-2	7/9/2001	--	--	--	--	--	--	--	--	--	--	--	--	--	--	80.80	12.98	67.82	3.4
MW-2	10/18/2001	71	--	<0.50	<0.50	<0.50	<0.50	--	<5.0	--	--	--	--	--	--	80.80	12.87	67.93	0.7
MW-2	1/24/2002	--	--	--	--	--	--	--	--	--	--	--	--	--	--	80.80	12.13	68.67	1.4
MW-2	5/10/2002	74	--	<0.50	<0.50	<0.50	<0.50	--	<5.0	--	--	--	--	--	--	80.80	12.69	68.11	1.4
MW-2	7/18/2002	--	--	--	--	--	--	--	--	--	--	--	--	--	--	80.80	12.84	67.96	1.2
MW-2	10/31/2002	<50	--	<0.50	<0.50	<0.50	<0.50	--	<5.0	--	--	--	--	--	--	83.66	13.15	70.51	--
MW-2	01/30/2003 d	--	--	--	--	--	--	--	--	--	--	--	--	--	--	83.78	11.97	71.81	--
MW-2	4/17/2003	85	--	<0.50	<0.50	<0.50	<1.0	--	<5.0	--	--	--	--	--	--	83.78	12.19	71.59	--
MW-2	7/17/2003	--	--	--	--	--	--	--	--	--	--	--	--	--	--	83.78	12.57	71.21	--
MW-2	10/16/2003	<50	--	<0.50	<0.50	<0.50	<1.0	--	<0.50	--	--	--	--	--	--	83.78	13.13	70.65	--
MW-2	1/14/2004	--	--	--	--	--	--	--	--	--	--	--	--	--	--	83.78	11.58	72.20	--
MW-2	4/14/2004	73	--	<0.50	<0.50	<0.50	<1.0	--	<0.50	--	--	--	--	--	--	83.78	12.65	71.13	--
MW-2	10/29/2004	180	--	<0.50	<0.50	<0.50	<1.0	--	<0.50	<2.0	<2.0	<2.0	<5.0	--	--	83.78	12.39	71.39	--
MW-2	4/14/2005	150	--	<0.50	<0.50	<0.50	<1.0	--	<0.50	--	--	--	--	--	--	83.78	12.14	71.64	--
MW-2	10/26/2005	<50	--	<0.50	<0.50	<0.50	<1.0	--	<0.50	<2.0	<2.0	<2.0	<5.0	--	--	83.78	12.98	70.80	--
MW-2	3/16/2006	<50.0	64.3	<0.500	<0.500	<0.500	<0.500	--	<0.500	<0.500	<0.500	<0.500	<10.0	<0.500	<0.500	83.78	11.72	72.06	--
MW-2	9/20/2006	<50.0	<47.2 g,h	<0.500	<0.500	<0.500	<0.500	--	<0.500	<0.500	<0.500	<0.500	<10.0	--	--	83.78	12.55	71.23	--
MW-2	3/26/2007	<50	<47 g	<0.50	<0.50	<0.50	<0.50	--	<0.50	--	--	--	--	--	--	83.78	12.28	71.50	--
MW-2	6/25/2007	--	--	--	--	--	--	--	--	--	--	--	--	--	--	83.78	12.94	70.84	--
MW-2	9/10/2007	<50 l	<50 g	<0.50	<1.0	<1.0	<1.0	--	<1.0	<2.0	<2.0	<2.0	<10	--	--	83.78	13.12	70.66	--
MW-2	12/10/2007	--	--	--	--	--	--	--	--	--	--	--	--	--	--	83.78	12.44	71.34	--
MW-2	3/10/2008	--	--	--	--	--	--	--	--	--	--	--	--	--	--	83.78	12.34	71.44	--
MW-2	6/23/2008	--	--	--	--	--	--	--	--	--	--	--	--	--	--	83.78	13.10	70.68	--
MW-2	9/22/2008	--	--	--	--	--	--	--	--	--	--	--	--	--	--	83.78	13.02	70.76	--
MW-2	12/22/2008	--	--	--	--	--	--	--	--	--	--	--	--	--	--	83.78	12.10	71.68	--
MW-2	3/23/2009	--	--	--	--	--	--	--	--	--	--	--	--	--	--	83.78	12.10	71.68	--
MW-2	9/21/2009	--	--	--	--	--	--	--	--	--	--	--	--	--	--	83.78	13.00	70.78	--
MW-2	3/8/2010	--	--	--	--	--	--	--	--	--	--	--	--	--	--	83.78	12.22	71.56	--
MW-2	9/27/2010	--	--	--	--	--	--	--	--	--	--	--	--	--	--	83.78	12.70	71.08	--
MW-2	3/21/2011	--	--	--	--	--	--	--	--	--	--	--	--	--	--	83.78	10.82	72.96	--

TABLE 1

GROUNDWATER DATA
FORMER SHELL SERVICE STATION
500 40TH STREET, OAKLAND, CALIFORNIA

Well ID	Date	TPPH (ug/L)	TEPH (ug/L)	B (ug/L)	T ug/L	E ug/L	X ug/L	MTBE		DIPE ug/L	ETBE ug/L	TAME ug/L	TBA ug/L	1,2-		TOC MSL	Depth to Water ft	GW Elevation MSL	DO Reading pp,
								8020 ug/L	8260 ug/L					DCA ug/L	EDB ug/L				
MW-3	8/6/1991	1900	470	220	57	57	260	--	--	--	--	--	--	--	--	79.60	11.12	68.48	--
MW-3	10/30/1991	1900	480	160	28	63	180	--	--	--	--	--	--	--	--	79.60	10.93	68.67	--
MW-3	2/15/1992	2300	780a	170	31	59	180	--	--	--	--	--	--	--	--	79.60	--	--	--
MW-3	3/18/1992	--	--	--	--	--	--	--	--	--	--	--	--	--	--	79.60	10.54	69.06	--
MW-3	5/22/1992	1500	--	160	20	44	140	--	--	--	--	--	--	--	--	79.60	10.79	68.81	--
MW-3	8/19/1992	4500	--	210	64	89	310	--	--	--	--	--	--	--	--	79.60	11.23	68.37	--
MW-3	11/18/1992	2400	--	81	14	39	140	--	--	--	--	--	--	--	--	79.60	11.20	68.40	--
MW-3	2/11/1993	3000	--	200	47	90	260	--	--	--	--	--	--	--	--	79.60	11.00	68.60	--
MW-3	5/19/1993	2100	--	240	44	100	330	--	--	--	--	--	--	--	--	79.60	11.16	68.44	--
MW-3	8/18/1993	--	--	--	--	--	--	--	--	--	--	--	--	--	--	79.60	11.35	68.25	--
MW-3	11/17/1993	1000	--	110	13	60	150	--	--	--	--	--	--	--	--	79.60	11.10	68.50	--
MW-3	2/18/1994	--	--	--	--	--	--	--	--	--	--	--	--	--	--	79.60	10.76	68.84	--
MW-3	5/26/1994	1100	--	200	17	29	58	--	--	--	--	--	--	--	--	79.60	11.85	67.75	--
MW-3	8/29/1994	--	--	--	--	--	--	--	--	--	--	--	--	--	--	79.60	10.40	69.20	--
MW-3	11/11/1994	870	--	130	10	38	87	--	--	--	--	--	--	--	--	79.60	10.04	69.56	--
MW-3 (D)	11/11/1994	1000	--	120	10	42	92	--	--	--	--	--	--	--	--	79.60	--	--	--
MW-3	2/3/1995	--	--	--	--	--	--	--	--	--	--	--	--	--	--	79.60	10.06	69.54	--
MW-3	5/7/1995	1300	--	180	7.5	54	110	--	--	--	--	--	--	--	--	79.60	10.11	69.49	--
MW-3	8/2/1995	--	--	--	--	--	--	--	--	--	--	--	--	--	--	79.60	11.02	68.58	--
MW-3	11/2/1995	370	--	36	1.8	16	21	--	--	--	--	--	--	--	--	79.60	10.97	68.63	--
MW-3	2/24/1996	--	--	--	--	--	--	--	--	--	--	--	--	--	--	79.60	9.61	69.99	--
MW-3	5/4/1996	460	--	54	1.9	18	28	20	--	--	--	--	--	--	--	79.60	10.40	69.20	--
MW-3	9/7/1996	--	--	--	--	--	--	--	--	--	--	--	--	--	--	79.60	13.55	66.05	--
MW-3	11/24/1996	2800	--	290	<10	29	39	<50	--	--	--	--	--	--	--	79.60	11.83	67.77	--
MW-3	2/23/1997	--	--	--	--	--	--	--	--	--	--	--	--	--	--	79.60	11.81	67.79	--
MW-3	5/1/1997	2000	--	120	<5.0	53	14	60	--	--	--	--	--	--	--	79.60	12.34	67.26	--
MW-3	7/22/1997	--	--	--	--	--	--	--	--	--	--	--	--	--	--	79.60	12.86	66.74	--
MW-3	11/4/1997	470	--	120	<2.5	<2.5	7.3	<25	--	--	--	--	--	--	--	79.60	12.62	66.98	--
MW-3	1/21/1998	--	--	--	--	--	--	--	--	--	--	--	--	--	--	79.60	10.78	68.82	--
MW-3	5/11/1998	4400	--	260	<10	220	36	170	--	--	--	--	--	--	--	79.60	11.98	67.62	--
MW-3	8/11/1998	--	--	--	--	--	--	--	--	--	--	--	--	--	--	79.60	12.38	67.22	--
MW-3	10/20/1998	1700	--	120	<2.0	18	7.1	19	--	--	--	--	--	--	--	79.60	12.55	67.05	--

TABLE 1

GROUNDWATER DATA
FORMER SHELL SERVICE STATION
500 40TH STREET, OAKLAND, CALIFORNIA

Well ID	Date	TPPH (ug/L)	TEPH (ug/L)	B (ug/L)	T (ug/L)	E (ug/L)	X (ug/L)	MTBE		DIPE (ug/L)	ETBE (ug/L)	TAME (ug/L)	TBA (ug/L)	1,2- DCA		EDB (ug/L)	TOC MSL	Depth to Water ft	GW Elevation MSL	DO Reading pp,
								8020 (ug/L)	8260 (ug/L)					DCA (ug/L)	DCA (ug/L)					
MW-3 (D)	10/20/1998	1400	---	120	<5.0	18	<5.0	80	---	---	---	---	---	---	---	---	79.60	---	---	---
MW-3	2/8/1999	---	---	---	---	---	---	---	---	---	---	---	---	---	---	---	79.60	8.53	71.07	---
MW-3	4/12/1999	8040	---	554	30	436	624	160	---	---	---	---	---	---	---	---	79.60	10.19	69.41	---
MW-3	7/27/1999	---	---	---	---	---	---	---	---	---	---	---	---	---	---	---	79.60	12.21	67.39	---
MW-3	10/25/1999	827	---	31	2.23	14.5	6.71	<10.0	---	---	---	---	---	---	---	---	79.60	12.35	67.25	---
MW-3	1/24/2000	Well inaccessible		---	---	---	---	---	---	---	---	---	---	---	---	---	79.60	---	---	---
MW-3	4/24/2000	1470	---	121	<5.00	63.8	14.1	<25.0	---	---	---	---	---	---	---	---	79.60	11.75	67.85	1.0
MW-3	7/24/2000	---	---	---	---	---	---	---	---	---	---	---	---	---	---	---	79.60	12.56	67.04	---
MW-3	11/1/2000	1550	---	143	<1.25	36.4	35.3	24.4	---	---	---	---	---	---	---	---	79.60	11.48	68.12	2.2
MW-3	1/19/2001	---	---	---	---	---	---	---	---	---	---	---	---	---	---	---	79.60	11.83	67.77	6.6
MW-3	4/13/2001	2560	---	250	<10.0	108	<10.0	92.1	---	---	---	---	---	---	---	---	79.60	12.08	67.52	3.6
MW-3	7/9/2001	---	---	---	---	---	---	---	---	---	---	---	---	---	---	---	79.60	12.68	66.92	2.8
MW-3	10/18/2001	2300	---	150	0.90	42	11	---	<5.0	---	---	---	---	---	---	---	79.60	13.21	66.39	0.1
MW-3	1/24/2002	---	---	---	---	---	---	---	---	---	---	---	---	---	---	---	79.60	11.83	67.77	2.3
MW-3	5/10/2002	3300	---	77	0.60	94	3.1	---	<5.0	---	---	---	---	---	---	---	79.60	12.24	67.36	1.5
MW-3	7/18/2002	---	---	---	---	---	---	---	---	---	---	---	---	---	---	---	79.60	12.43	67.17	2.1
MW-3	10/31/2002	2100	---	89	0.57	26	5.7	---	<5.0	---	---	---	---	---	---	---	82.46	12.60	69.86	2.0
MW-3	1/30/2003	---	---	---	---	---	---	---	---	---	---	---	---	---	---	---	82.46	11.76	70.70	4.6
MW-3	4/17/2003	2100	---	55	0.79	100	110	---	<5.0	---	---	---	---	---	---	---	82.46	11.80	70.66	1.8
MW-3	7/17/2003	---	---	---	---	---	---	---	---	---	---	---	---	---	---	---	82.46	12.28	70.18	4.0
MW-3	10/16/2003	120 e	---	<0.50	<0.50	<0.50	<1.0	---	<0.50	---	---	---	---	---	---	---	82.46	12.35	70.11	2.0
MW-3	1/14/2004	---	---	---	---	---	---	---	---	---	---	---	---	---	---	---	82.46	11.35	71.11	2.9
MW-3	4/14/2004	130	---	1.6	<0.50	1.5	<1.0	---	<0.50	---	---	---	---	---	---	---	82.46	12.12	70.34	3.4
MW-3	10/29/2004	490	---	11	<0.50	19	18	---	<0.50	<2.0	<2.0	<2.0	<5.0	---	---	---	82.46	11.67	70.79	1.2
MW-3	4/14/2005	<50	---	<0.50	<0.50	<0.50	<1.0	---	<0.50	---	---	---	---	---	---	---	82.46	11.65	70.81	0.1
MW-3	10/26/2005	230	---	2.8	<0.50	0.52	<1.0	---	<0.50	<2.0	<2.0	<2.0	<5.0	---	---	---	82.46	12.43	70.03	0.2
MW-3	3/16/2006	107	191	12.5	<0.500	1.27	0.960	---	<0.500	<0.500	<0.500	<0.500	<10.0	<0.500	<0.500	---	82.46	10.62	71.84	---
MW-3	9/20/2006	671	55.2 g	4.23	<0.500	<0.500	<0.500	---	<0.500	<0.500	<0.500	<0.500	<10.0	---	---	---	82.46	12.03	70.43	4.83
MW-3	3/26/2007	120	<47 g	2.6	<0.50	<0.50	<0.50 i,j	---	<0.50	---	---	---	---	---	---	---	82.46	11.84	70.62	1.0
MW-3	6/25/2007	---	---	---	---	---	---	---	---	---	---	---	---	---	---	---	82.46	12.21	70.25	0.04
MW-3	9/10/2007	390 l	<50 g	6.0	<1.0	1.1	1.4	---	<1.0	<2.0	<2.0	<2.0	<10	---	---	---	82.46	12.14	70.32	0.22
MW-3	12/10/2007	---	---	---	---	---	---	---	---	---	---	---	---	---	---	---	82.46	11.81	70.65	0.40
MW-3	3/10/2008	75	84 g	1.0	<1.0	<1.0	<1.0	---	<1.0	---	---	---	---	---	---	---	82.46	11.80	70.66	0.52

TABLE 1

GROUNDWATER DATA
FORMER SHELL SERVICE STATION
500 40TH STREET, OAKLAND, CALIFORNIA

Well ID	Date	TPPH (ug/L)	TEPH (ug/L)	B (ug/L)	T ug/L	E ug/L	X ug/L	MTBE		DIPE ug/L	ETBE ug/L	TAME ug/L	TBA ug/L	1,2-		TOC MSL	Depth to Water ft	GW Elevation MSL	DO Reading pp,
								8020 ug/L	8260 ug/L					DCA ug/L	EDB ug/L				
MW-3	6/23/2008	--	--	--	--	--	--	--	--	--	--	--	--	--	--	82.46	12.40	70.06	--
MW-3	9/22/2008	810	250 g,n	7.5	<1.0	<1.0	1.7	--	<1.0	<2.0	<2.0	<2.0	<10	--	--	82.46	12.65	69.81	0.25
MW-3	12/22/2008	--	--	--	--	--	--	--	--	--	--	--	--	--	--	82.46	11.51	70.95	--
MW-3	3/23/2009	2000	610 g,n	14	<1.0	140	13	--	<1.0	--	--	--	--	--	--	82.46	11.44	71.02	0.33
MW-3	9/21/2009	1100	350 g,n	4.6	<1.0	3.9	<1.0	--	<1.0	<2.0	<2.0	<2.0	<10	--	--	82.46	12.20	70.26	0.43
MW-3	3/8/2010	1400	540 g,n	5.6	<1.0	50	<1.0	--	<1.0	--	--	--	--	--	--	82.46	10.95	71.51	0.52
MW-3	9/27/2010	1000	300 g,n	2.0	<1.0	3.7	<1.0	--	<1.0	<2.0	<2.0	<2.0	<10	--	--	82.46	12.34	70.12	1.51
MW-3	3/21/2011	710	310 g,o	3.1	<0.50	5.2	<1.0	--	<1.0	--	--	--	--	--	--	82.46	10.63	71.83	1.42
MW-4	8/6/1991	<50	<50	<0.5	<0.5	<0.5	<0.5	--	--	--	--	--	--	--	--	81.00	12.36	68.64	--
MW-4	10/30/1991	50	<50	<0.5	<0.5	<0.5	<0.5	--	--	--	--	--	--	--	--	81.00	12.02	68.98	--
MW-4	2/15/1992	90	--	0.9	<0.5	<0.5	<0.5	--	--	--	--	--	--	--	--	81.00	--	--	--
MW-4	3/18/1992	--	--	--	--	--	--	--	--	--	--	--	--	--	--	81.00	11.34	69.66	--
MW-4	5/22/1992	<50	--	<0.5	<0.5	<0.5	<0.5	--	--	--	--	--	--	--	--	81.00	12.35	68.65	--
MW-4	8/19/1992	82a	--	<0.5	<0.5	<0.5	<0.5	--	--	--	--	--	--	--	--	81.00	12.41	68.59	--
MW-4	11/18/1992	85a	--	<0.5	<0.5	<0.5	<0.5	--	--	--	--	--	--	--	--	81.00	12.28	68.72	--
MW-4	2/11/1993	62a	--	<0.5	<0.5	<0.5	<0.5	--	--	--	--	--	--	--	--	81.00	11.65	69.35	--
MW-4	5/19/1993	<50	--	<0.5	<0.5	<0.5	<0.5	--	--	--	--	--	--	--	--	81.00	11.92	69.08	--
MW-4	8/18/1993	Well inaccessible		--	--	--	--	--	--	--	--	--	--	--	--	81.00	--	--	--
MW-4	11/17/1993	<50	--	<0.5	<0.5	<0.5	<0.5	--	--	--	--	--	--	--	--	81.00	12.24	68.76	--
MW-4	2/18/1994	--	--	--	--	--	--	--	--	--	--	--	--	--	--	81.00	11.69	69.31	--
MW-4	5/26/1994	<50	--	<0.5	<0.5	<0.5	<0.5	--	--	--	--	--	--	--	--	81.00	12.00	69.00	--
MW-4	11/11/1994	<50	--	<0.5	<0.5	<0.5	<0.5	--	--	--	--	--	--	--	--	81.00	11.30	69.70	--
MW-4	2/3/1995	--	--	--	--	--	--	--	--	--	--	--	--	--	--	81.00	10.99	70.01	--
MW-4	5/7/1995	<50	--	<0.5	<0.5	<0.5	<0.5	--	--	--	--	--	--	--	--	81.00	11.69	69.31	--
MW-4	8/2/1995	--	--	--	--	--	--	--	--	--	--	--	--	--	--	81.00	11.72	69.28	--
MW-4	11/2/1995	<50	--	<0.5	<0.5	<0.5	<0.5	--	--	--	--	--	--	--	--	81.00	12.23	68.77	--
MW-4	2/24/1996	--	--	--	--	--	--	--	--	--	--	--	--	--	--	81.00	11.13	69.87	--
MW-4	5/4/1996	<50	--	<0.50	<0.50	<0.50	<0.50	<2.5	--	--	--	--	--	--	--	81.00	11.80	69.20	--
MW-4	9/7/1996	--	--	--	--	--	--	--	--	--	--	--	--	--	--	81.00	13.27	67.73	--
MW-4	11/24/1996	<50	--	<0.50	<0.50	<0.50	<0.50	<2.5	--	--	--	--	--	--	--	81.00	12.42	68.58	--
MW-4	2/23/1997	--	--	--	--	--	--	--	--	--	--	--	--	--	--	81.00	12.38	68.62	--
MW-4	5/1/1997	<50	--	<0.50	<0.50	<0.50	<0.50	<2.5	--	--	--	--	--	--	--	81.00	13.08	67.92	--

TABLE 1

GROUNDWATER DATA
FORMER SHELL SERVICE STATION
500 40TH STREET, OAKLAND, CALIFORNIA

Well ID	Date	TPPH (ug/L)	TEPH (ug/L)	B (ug/L)	T (ug/L)	E (ug/L)	X (ug/L)	MTBE		DIPE (ug/L)	ETBE (ug/L)	TAME (ug/L)	TBA (ug/L)	1,2- DCA (ug/L)	EDB (ug/L)	TOC MSL	Depth to Water ft	GW Elevation MSL	DO Reading pp,
								8020 (ug/L)	8260 (ug/L)										
MW-4	7/22/1997	--	--	--	--	--	--	--	--	--	--	--	--	--	--	81.00	13.73	67.27	--
MW-4	11/4/1997	Well inaccessible		--	--	--	--	--	--	--	--	--	--	--	--	81.00	--	--	--
MW-4	1/21/1998	--	--	--	--	--	--	--	--	--	--	--	--	--	--	81.00	11.41	69.59	--
MW-4	5/11/1998	Well inaccessible		--	--	--	--	--	--	--	--	--	--	--	--	81.00	--	--	--
MW-4	8/11/1998	--	--	--	--	--	--	--	--	--	--	--	--	--	--	81.00	13.05	67.95	--
MW-4	10/20/1998	<50	--	<0.50	<0.50	<0.50	<0.50	<2.5	--	--	--	--	--	--	--	81.00	13.30	67.70	--
MW-4	2/8/1999	--	--	--	--	--	--	--	--	--	--	--	--	--	--	81.00	9.19	71.81	--
MW-4	4/12/1999	<50.0	--	<0.500	<0.500	<0.500	<0.500	<5.00	--	--	--	--	--	--	--	81.00	9.26	71.74	--
MW-4	7/27/1999	--	--	--	--	--	--	--	--	--	--	--	--	--	--	81.00	12.57	68.43	--
MW-4	10/25/1999	<50.0	--	<0.500	<0.500	<0.500	<0.500	<5.00	--	--	--	--	--	--	--	81.00	13.15	67.85	--
MW-4	1/24/2000	Well inaccessible		--	--	--	--	--	--	--	--	--	--	--	--	81.00	--	--	--
MW-4	4/24/2000	<50.0	--	<0.500	<0.500	<0.500	<0.500	14.5	--	--	--	--	--	--	--	81.00	12.55	68.45	2.5
MW-4	7/24/2000	--	--	--	--	--	--	--	--	--	--	--	--	--	--	81.00	13.31	67.69	--
MW-4	11/1/2000	<50.0	--	<0.500	<0.500	<0.500	<0.500	<2.50	--	--	--	--	--	--	--	81.00	12.09	68.91	2.8
MW-4	1/19/2001	--	--	--	--	--	--	--	--	--	--	--	--	--	--	81.00	12.58	68.42	8.4
MW-4	4/13/2001	<50.0	--	<0.500	<0.500	<0.500	<0.500	<2.50	--	--	--	--	--	--	--	81.00	12.75	68.25	2.6
MW-4	7/9/2001	--	--	--	--	--	--	--	--	--	--	--	--	--	--	81.00	13.30	67.70	4.2
MW-4	10/18/2001	<50	--	<0.50	<0.50	<0.50	<0.50	--	<5.0	--	--	--	--	--	--	81.00	13.45	67.55	1.4
MW-4	1/24/2002	--	--	--	--	--	--	--	--	--	--	--	--	--	--	81.00	12.55	68.45	c
MW-4	5/10/2002	<50	--	<0.50	<0.50	<0.50	<0.50	--	<5.0	--	--	--	--	--	--	81.00	12.93	68.07	1.5
MW-4	7/18/2002	--	--	--	--	--	--	--	--	--	--	--	--	--	--	81.00	13.13	67.87	1.4
MW-4	10/31/2002	<50	--	<0.50	<0.50	<0.50	<0.50	--	<5.0	--	--	--	--	--	--	83.92	13.40	70.52	--
MW-4	1/30/2003	--	--	--	--	--	--	--	--	--	--	--	--	--	--	83.92	12.44	71.48	--
MW-4	4/17/2003	<50	--	<0.50	<0.50	<0.50	<1.0	--	<5.0	--	--	--	--	--	--	83.92	12.24	71.68	--
MW-4	7/17/2003	--	--	--	--	--	--	--	--	--	--	--	--	--	--	83.92	13.02	70.90	--
MW-4	10/16/2003	<50	--	<0.50	<0.50	<0.50	<1.0	--	<0.50	--	--	--	--	--	--	83.92	13.15	70.77	--
MW-4	1/14/2004	--	--	--	--	--	--	--	--	--	--	--	--	--	--	83.92	12.20	71.72	--
MW-4	4/14/2004	--	--	--	--	--	--	--	--	--	--	--	--	--	--	83.92	12.80	71.12	--
MW-4	10/29/2004	--	--	--	--	--	--	--	--	--	--	--	--	--	--	83.92	12.41	71.51	--
MW-4	4/14/2005	Well destroyed		--	--	--	--	--	--	--	--	--	--	--	--	83.92	--	--	--
MW-5	8/6/1991	<50	<50	<0.5	<0.5	<0.5	<0.5	--	--	--	--	--	--	--	--	81.50	13.02	68.48	--
MW-5	10/30/1991	<50	<50	<0.5	<0.5	<0.5	<0.5	--	--	--	--	--	--	--	--	81.50	12.73	68.77	--

TABLE 1

GROUNDWATER DATA
FORMER SHELL SERVICE STATION
500 40TH STREET, OAKLAND, CALIFORNIA

Well ID	Date	TPPH (ug/L)	TEPH (ug/L)	B (ug/L)	T ug/L	E ug/L	X ug/L	MTBE		DIPE ug/L	ETBE ug/L	TAME ug/L	TBA ug/L	1,2- DCA ug/L	EDB ug/L	TOC MSL	Depth to Water ft	GW Elevation MSL	DO Reading pp.
								8020 ug/L	8260 ug/L										
MW-5	2/15/1992	<50	--	<0.5	<0.5	<0.5	<0.5	--	--	--	--	--	--	--	--	81.50	--	--	--
MW-5	3/18/1992	--	--	--	--	--	--	--	--	--	--	--	--	--	--	81.50	12.52	68.98	--
MW-5	5/22/1992	<50	--	<0.5	<0.5	<0.5	<0.5	--	--	--	--	--	--	--	--	81.50	13.05	68.45	--
MW-5	8/19/1992	55a	--	<0.5	<0.5	<0.5	<0.5	--	--	--	--	--	--	--	--	81.50	13.04	68.46	--
MW-5	11/18/1992	<50	--	<0.5	<0.5	<0.5	<0.5	--	--	--	--	--	--	--	--	81.50	12.91	68.59	--
MW-5	2/11/1993	59a	--	<0.5	<0.5	<0.5	<0.5	--	--	--	--	--	--	--	--	81.50	12.44	69.06	--
MW-5	5/19/1993	<50	--	<0.5	<0.5	<0.5	<0.5	--	--	--	--	--	--	--	--	81.50	12.84	68.66	--
MW-5 (D)	5/19/1993	<50	--	<0.5	<0.5	<0.5	<0.5	--	--	--	--	--	--	--	--	81.50	--	--	--
MW-5	11/17/1993	<50	--	<0.5	<0.5	<0.5	<0.5	--	--	--	--	--	--	--	--	81.50	12.89	68.61	--
MW-5	2/18/1994	--	--	--	--	--	--	--	--	--	--	--	--	--	--	81.50	12.30	69.20	--
MW-5	5/26/1994	<50	--	1.8	2.4	1.3	4.9	--	--	--	--	--	--	--	--	81.50	12.73	68.77	--
MW-5	8/29/1994	--	--	--	--	--	--	--	--	--	--	--	--	--	--	81.50	12.88	68.62	--
MW-5	11/11/1994	<50	--	<0.5	<0.5	<0.5	<0.5	--	--	--	--	--	--	--	--	81.50	12.20	69.30	--
MW-5	2/3/1995	--	--	--	--	--	--	--	--	--	--	--	--	--	--	81.50	11.78	69.72	--
MW-5	5/7/1995	<50	--	<0.5	<0.5	<0.5	<0.5	--	--	--	--	--	--	--	--	81.50	12.47	69.03	--
MW-5	8/2/1995	--	--	--	--	--	--	--	--	--	--	--	--	--	--	81.50	12.83	68.67	--
MW-5	11/2/1995	<50	--	<0.5	<0.5	<0.5	<0.5	--	--	--	--	--	--	--	--	81.50	13.02	68.48	--
MW-5	2/24/1996	--	--	--	--	--	--	--	--	--	--	--	--	--	--	81.50	12.11	69.39	--
MW-5	5/4/1996	<50	--	<0.50	<0.50	<0.50	<0.50	<2.5	--	--	--	--	--	--	--	81.50	13.20	68.30	--
MW-5	9/7/1996	--	--	--	--	--	--	--	--	--	--	--	--	--	--	81.50	14.24	67.26	--
MW-5	11/24/1996	<50	--	<0.50	<0.5	<0.50	<0.50	<2.5	--	--	--	--	--	--	--	81.50	13.58	67.92	--
MW-5	2/23/1997	--	--	--	--	--	--	--	--	--	--	--	--	--	--	81.50	13.54	67.96	--
MW-5	5/1/1997	<50	--	<0.50	<0.50	<0.50	<0.50	<2.5	--	--	--	--	--	--	--	81.50	14.17	67.33	--
MW-5	7/22/1997	--	--	--	--	--	--	--	--	--	--	--	--	--	--	81.50	14.35	67.15	--
MW-5	11/4/1997	<50	--	<0.50	<0.50	<0.50	<0.50	<2.5	--	--	--	--	--	--	--	81.50	14.30	67.20	--
MW-5 (D)	11/4/1997	<50	--	<0.50	<0.50	<0.50	<0.50	<2.5	--	--	--	--	--	--	--	81.50	--	--	--
MW-5	1/21/1998	--	--	--	--	--	--	--	--	--	--	--	--	--	--	81.50	12.86	68.64	--
MW-5	5/11/1998	<50	--	<0.50	<0.50	<0.50	<0.50	<2.5	--	--	--	--	--	--	--	81.50	13.89	67.61	--
MW-5	8/11/1998	--	--	--	--	--	--	--	--	--	--	--	--	--	--	81.50	14.20	67.30	--
MW-5	10/20/1998	<50	--	<0.50	<0.50	<0.50	<0.50	<2.5	--	--	--	--	--	--	--	81.50	14.41	67.09	--
MW-5	2/8/1999	--	--	--	--	--	--	--	--	--	--	--	--	--	--	81.50	10.31	71.19	--
MW-5	4/12/1999	<50.0	--	<0.500	<0.500	<0.500	<0.500	<5.00	--	--	--	--	--	--	--	81.50	11.30	70.20	--
MW-5	7/27/1999	--	--	--	--	--	--	--	--	--	--	--	--	--	--	81.50	12.63	68.87	--

TABLE 1

GROUNDWATER DATA
FORMER SHELL SERVICE STATION
500 40TH STREET, OAKLAND, CALIFORNIA

Well ID	Date	TPPH (ug/L)	TEPH (ug/L)	B (ug/L)	T (ug/L)	E (ug/L)	X (ug/L)	MTBE		DIPE (ug/L)	ETBE (ug/L)	TAME (ug/L)	TBA (ug/L)	1,2- DCA (ug/L)	EDB (ug/L)	TOC MSL	Depth to Water ft	GW Elevation MSL	DO Reading pp.
								8020 (ug/L)	8260 (ug/L)										
MW-5	10/25/1999	<50.0	---	<0.500	<0.500	<0.500	<0.500	<5.00	---	---	---	---	---	---	---	81.50	14.15	67.35	---
MW-5	1/24/2000	---	---	---	---	---	---	---	---	---	---	---	---	---	---	81.50	11.65	69.85	1.8
MW-5	4/24/2000	<50.0	---	<0.500	<0.500	<0.500	<0.500	<2.50	---	---	---	---	---	---	---	81.50	13.71	67.79	2.1
MW-5	7/24/2000	---	---	---	---	---	---	---	---	---	---	---	---	---	---	81.50	14.48	67.02	---
MW-5	11/1/2000	<50.0	---	<0.500	<0.500	<0.500	<0.500	<2.50	---	---	---	---	---	---	---	81.50	13.26	68.24	3.2
MW-5	1/19/2001	---	---	---	---	---	---	---	---	---	---	---	---	---	---	81.50	13.68	67.82	7.8
MW-5	4/13/2001	<50.0	---	<0.500	<0.500	<0.500	<0.500	<2.50	---	---	---	---	---	---	---	81.50	13.90	67.60	3.2
MW-5	7/9/2001	---	---	---	---	---	---	---	---	---	---	---	---	---	---	81.50	14.72	66.78	4.8
MW-5	10/18/2001	<50	---	<0.50	<0.50	<0.50	<0.50	---	<5.0	---	---	---	---	---	---	81.50	14.41	67.09	1.1
MW-5	1/24/2002	---	---	---	---	---	---	---	---	---	---	---	---	---	---	81.50	13.69	67.81	1.4
MW-5	5/10/2002	<50	---	<0.50	<0.50	<0.50	<0.50	---	<5.0	---	---	---	---	---	---	81.50	14.05	67.45	2.2
MW-5	7/18/2002	---	---	---	---	---	---	---	---	---	---	---	---	---	---	81.50	14.23	67.27	1.2
MW-5	10/31/2002	<50	---	<0.50	<0.50	<0.50	<0.50	---	<5.0	---	---	---	---	---	---	84.36	14.36	70.00	2.8
MW-5	1/30/2003	---	---	---	---	---	---	---	---	---	---	---	---	---	---	84.36	13.70	70.66	2.4
MW-5	4/17/2003	<50	---	<0.50	<0.50	<0.50	<1.0	---	<5.0	---	---	---	---	---	---	84.36	13.52	70.84	2.6
MW-5	7/17/2003	---	---	---	---	---	---	---	---	---	---	---	---	---	---	84.36	14.13	70.23	1.6
MW-5	10/16/2003	<50	---	<0.50	<0.50	<0.50	<1.0	---	<0.50	---	---	---	---	---	---	84.36	14.21	70.15	2.1
MW-5	1/14/2004	---	---	---	---	---	---	---	---	---	---	---	---	---	---	84.36	14.15	70.21	3.1
MW-5	4/14/2004	---	---	---	---	---	---	---	---	---	---	---	---	---	---	84.36	13.95	70.41	2.5
MW-5	10/29/2004	---	---	---	---	---	---	---	---	---	---	---	---	---	---	84.36	13.63	70.73	0.8
MW-5	4/14/2005	Well destroyed		---	---	---	---	---	---	---	---	---	---	---	---	84.36	---	---	0.8
OMW-6	8/6/1991	26000	3600	910	420	560	1900	---	---	---	---	---	---	---	---	77.90	10.71	67.19	---
OMW-6	10/30/1991	20000	4600	710	240	410	1700	---	---	---	---	---	---	---	---	77.90	10.50	67.40	---
OMW-6	2/15/1992	35000	27000	690	420	650	3000	---	---	---	---	---	---	---	---	77.90	---	---	---
OMW-6	3/18/1992	---	---	---	---	---	---	---	---	---	---	---	---	---	---	77.90	9.24	68.66	---
OMW-6	5/22/1992	15000	---	460	110	300	1600	---	---	---	---	---	---	---	---	77.90	10.13	67.77	---
OMW-6	8/19/1992	24000	---	600	300	460	2000	---	---	---	---	---	---	---	---	77.90	10.16	67.74	---
OMW-6	11/18/1992	29000	---	480	250	450	2300	---	---	---	---	---	---	---	---	77.90	9.94	67.96	---
OMW-6	2/11/1993	24000	---	1300	250	630	2400	---	---	---	---	---	---	---	---	77.90	9.20	68.70	---
OMW-6	5/19/1993	18000	---	750	180	520	2500	---	---	---	---	---	---	---	---	77.90	10.64	67.86	---
OMW-6	8/18/1993	---	---	---	---	---	---	---	---	---	---	---	---	---	---	77.90	10.04	67.86	---
OMW-6	11/17/1993	14000	---	260	64	430	1900	---	---	---	---	---	---	---	---	77.90	10.12	67.78	---

TABLE 1

GROUNDWATER DATA
FORMER SHELL SERVICE STATION
500 40TH STREET, OAKLAND, CALIFORNIA

Well ID	Date	TPPH (ug/L)	TEPH (ug/L)	B (ug/L)	T ug/L	E ug/L	X ug/L	MTBE		DIPE ug/L	ETBE ug/L	TAME ug/L	TBA ug/L	1,2-		TOC MSL	Depth to Water ft	GW Elevation MSL	DO Reading pp,
								8020 ug/L	8260 ug/L					DCA ug/L	EDB ug/L				
OMW-6	2/18/1994	--	--	--	--	--	--	--	--	--	--	--	--	--	--	77.90	9.65	68.25	--
OMW-6	5/26/1994	Well inaccessible	--	--	--	--	--	--	--	--	--	--	--	--	--	77.90	--	--	--
OMW-6	8/29/1994	--	--	--	--	--	--	--	--	--	--	--	--	--	--	77.90	--	--	--
OMW-6	11/11/1994	Well inaccessible	--	--	--	--	--	--	--	--	--	--	--	--	--	77.90	--	--	--
OMW-6	2/3/1995	--	--	--	--	--	--	--	--	--	--	--	--	--	--	77.90	8.96	68.94	--
OMW-6	5/7/1995	11000	--	460	82	280	540	--	--	--	--	--	--	--	--	77.90	8.64	69.26	--
OMW-6 (D)	5/7/1995	14000	--	480	61	230	370	--	--	--	--	--	--	--	--	77.90	--	--	--
OMW-6	8/2/1995	--	--	--	--	--	--	--	--	--	--	--	--	--	--	77.90	12.09	65.81	--
OMW-6	2/24/1996	Well inaccessible	--	--	--	--	--	--	--	--	--	--	--	--	--	77.90	--	--	--
OMW-6	5/4/1996	Well inaccessible	--	--	--	--	--	--	--	--	--	--	--	--	--	77.90	--	--	--
OMW-6	9/7/1996	--	--	--	--	--	--	--	--	--	--	--	--	--	--	77.90	14.45	63.45	--
OMW-6	11/24/1996	Well inaccessible	--	--	--	--	--	--	--	--	--	--	--	--	--	77.90	--	--	--
OMW-6	2/23/1997	--	--	--	--	--	--	--	--	--	--	--	--	--	--	77.90	13.12	64.78	--
OMW-6	5/1/1997	17000	--	630	52	610	1300	380	--	--	--	--	--	--	--	77.90	13.19	64.71	--
OMW-6 (D)	5/1/1997	20000	--	630	54	630	1300	500	<20	--	--	--	--	--	--	77.90	--	--	--
OMW-6	7/22/1997	--	--	--	--	--	--	--	--	--	--	--	--	--	--	77.90	13.52	64.38	--
OMW-6	11/4/1997	10000	--	610	23	410	820	<100	--	--	--	--	--	--	--	77.90	13.12	64.78	--
OMW-6	1/21/1998	--	--	--	--	--	--	--	--	--	--	--	--	--	--	77.90	12.19	65.71	--
OMW-6	5/11/1998	14000	--	500	32	900	1000	110	--	--	--	--	--	--	--	77.90	12.71	65.19	--
OMW-6 (D)	5/11/1998	14000	--	490	<25	900	980	370	--	--	--	--	--	--	--	77.90	--	--	--
OMW-6	8/11/1998	--	--	--	--	--	--	--	--	--	--	--	--	--	--	77.90	13.18	64.72	--
OMW-6	10/20/1998	7500	--	220	<20	290	130	120	--	--	--	--	--	--	--	77.90	13.11	64.79	--
OMW-6	2/8/1999	--	--	--	--	--	--	--	--	--	--	--	--	--	--	77.90	9.07	68.83	--
OMW-6	4/12/1999	11300	--	818	67.2	600	690	342	--	--	--	--	--	--	--	77.90	10.10	67.80	--
OMW-6	7/27/1999	--	--	--	--	--	--	--	--	--	--	--	--	--	--	77.90	12.18	65.72	--
OMW-6	10/25/1999	11100	--	559	21.1	329	75.7	<100	--	--	--	--	--	--	--	77.90	12.58	65.32	--
OMW-6	1/24/2000	Well inaccessible	--	--	--	--	--	--	--	--	--	--	--	--	--	77.90	--	--	--
OMW-6	4/24/2000	12700	--	576	<10.0	452	141	556	--	--	--	--	--	--	--	77.90	12.35	65.55	1.1
OMW-6	7/24/2000	--	--	--	--	--	--	--	--	--	--	--	--	--	--	77.90	13.08	64.82	--
OMW-6	11/1/2000	10700	--	179	27.5	532	416	304	14.6	--	--	--	--	--	--	77.90	11.91	65.99	0.6
OMW-6	1/19/2001	--	--	--	--	--	--	--	--	--	--	--	--	--	--	77.90	12.08	65.82	6.0
OMW-6	4/13/2001	8650	--	103	25.6	318	207	258	<1.00	--	--	--	--	--	--	77.90	12.00	65.90	4.2
OMW-6	7/9/2001	--	--	--	--	--	--	--	--	--	--	--	--	--	--	77.90	11.86	66.04	5.2

**GROUNDWATER DATA
FORMER SHELL SERVICE STATION
500 40TH STREET, OAKLAND, CALIFORNIA**

Well ID	Date	TPPH (ug/L)	TEPH (ug/L)	B (ug/L)	T ug/L	E ug/L	X ug/L	MTBE		DIPE ug/L	ETBE ug/L	TAME ug/L	TBA ug/L	1,2- DCA ug/L	EDB ug/L	TOC MSL	Depth to Water ft	GW Elevation MSL	DO Reading pp.
								8020 ug/L	8260 ug/L										
OMW-6	10/18/2001	Well inaccessible		---	---	---	---	---	---	---	---	---	---	---	---	77.90	---	---	---
OMW-6	11/1/2001	6600	---	85	<2.0	160	53	---	<20	---	---	---	---	---	---	77.90	13.23	64.67	3.4
OMW-6	1/24/2002	---	---	---	---	---	---	---	---	---	---	---	---	---	---	77.90	12.63	65.27	4.2
OMW-6	5/10/2002	7600	---	230	2.9	370	25	---	<20	---	---	---	---	---	---	77.90	13.07	64.83	1.2
OMW-6	7/18/2002	Well inaccessible		---	---	---	---	---	---	---	---	---	---	---	---	77.90	---	---	---
OMW-6	10/31/2002	Well inaccessible		---	---	---	---	---	---	---	---	---	---	---	---	---	---	---	---
OMW-6	11/11/2002	6600	---	37	<5.0	42	<5.0	---	<50	---	---	---	---	---	---	---	12.82	---	1.0
OMW-6	1/30/2003	---	---	---	---	---	---	---	---	---	---	---	---	---	---	---	12.78	---	2.8
OMW-6	4/17/2003	5500	---	89	1.4	61	20	---	<5.0	---	---	---	---	---	---	---	13.02	---	1.6
OMW-6	7/17/2003	---	---	---	---	---	---	---	---	---	---	---	---	---	---	---	13.08	---	2.0
OMW-6	10/16/2003	Well inaccessible		---	---	---	---	---	---	---	---	---	---	---	---	---	---	---	---
OMW-6	1/14/2004	---	---	---	---	---	---	---	---	---	---	---	---	---	---	---	12.69	---	8.9
OMW-6	4/14/2004	Well inaccessible		---	---	---	---	---	---	---	---	---	---	---	---	---	---	---	---
OMW-6	10/29/2004	---	---	---	---	---	---	---	---	---	---	---	---	---	---	---	12.21	---	0.1
OMW-6	4/14/2005	3600	---	18	<0.50	160	13	---	<0.50	---	---	---	---	---	---	---	12.88	---	0.7
OMW-6	10/26/2005	---	---	---	---	---	---	---	---	---	---	---	---	---	---	80.77	13.11	67.66	0.2
OMW-6	3/16/2006	22700	3710	46.3	0.930	515	37.2	---	<0.500	<0.500	<0.500	<0.500	<10.0	<0.500	<0.500	80.77	11.98	68.79	---
OMW-6	9/20/2006	9130	3730 g	11.4	<0.500	78.4	1.85	---	<0.500	---	---	---	---	---	---	80.77	13.01	67.76	2.78
OMW-6	3/26/2007	7100	2200 g,k	25	<2.5	230	20	---	<2.5	---	---	---	---	---	---	80.77	12.77	68.00	1.4
OMW-6	6/25/2007	7800 l	2700 g	13	0.57 m	99	6.92 m.	---	<1.0	---	---	---	---	---	---	80.77	13.00	67.77	0.08
OMW-6	9/10/2007	6400 l	1700 g,n	6.8	0.47 m	26	2.41 m	---	<1.0	<2.0	<2.0	<2.0	13	---	---	80.77	13.14	67.63	0.04
OMW-6	12/10/2007	7500 l	2900 g,n	9.6	0.47 m	30	2.45 m	---	<1.0	---	---	---	---	---	---	80.77	12.83	67.94	0.10
OMW-6	3/10/2008	6400	480 g	13	<1.0	180	9.0	---	<1.0	---	---	---	---	---	---	80.77	12.70	68.07	0.23
OMW-6	6/23/2008	10000	3300 g,n	6.4	<1.0	55	3.7	---	<1.0	---	---	---	---	---	---	80.77	13.00	67.77	0.03/0.06
OMW-6	9/22/2008	7700	3900 g,n	3.8	<1.0	16	1.7	---	<1.0	<2.0	<2.0	<2.0	11	---	---	80.77	13.25	67.52	0.3
OMW-6	12/22/2008	8000	3700 g,n	5.6	<1.0	12	<1.0	---	<1.0	---	---	---	---	---	---	80.77	12.88	67.89	---
OMW-6	3/23/2009	8400	3000 g,n	9.5	<1.0	120	8.2	---	<1.0	---	---	---	---	---	---	80.77	12.62	68.15	0.49
OMW-6	9/21/2009	7600	2500 g,n	33	<5.0	33	<5.0	---	<5.0	<10	<10	<10	<50	---	---	80.77	12.90	67.87	0.47
OMW-6	3/8/2010	9800	3000 g,n	7.0	<2.0	90	4.7	---	<2.0	---	---	---	---	---	---	80.77	11.21	69.56	0.54
OMW-6	9/27/2010	8800	3200 g,n	<2.5	<5.0	6.4	<5.0	---	<5.0	<10	<10	<10	<50	---	---	80.77	12.95	67.82	0.57
OMW-6	3/21/2011	6400 j	3100 g	3.1	0.94	43	2.0	---	<1.0	---	---	---	---	---	---	80.77	12.18	68.59	0.85
MW-8	8/6/1991	90	<50	<0.5	<0.5	<0.5	<0.5	---	---	---	---	---	---	---	---	79.91	13.08	66.83	---

TABLE 1

GROUNDWATER DATA
FORMER SHELL SERVICE STATION
500 40TH STREET, OAKLAND, CALIFORNIA

Well ID	Date	TPPH (ug/L)	TEPH (ug/L)	B (ug/L)	T ug/L	E ug/L	X ug/L	MTBE		DIPE ug/L	ETBE ug/L	TAME ug/L	TBA ug/L	1,2-		TOC MSL	Depth to Water ft	GW Elevation MSL	DO Reading pp,
								8020 ug/L	8260 ug/L					DCA ug/L	EDB ug/L				
MW-8	10/30/1991	<50	<50	<0.5	<0.5	<0.5	<0.5	--	--	--	--	--	--	--	--	79.91	12.87	67.04	--
MW-8	2/15/1992	<50	--	<0.5	<0.5	<0.5	<0.5	--	--	--	--	--	--	--	--	79.91	--	--	--
MW-8	3/18/1992	--	--	--	--	--	--	--	--	--	--	--	--	--	--	79.91	11.54	68.37	--
MW-8	5/22/1992	<50	--	<0.5	<0.5	<0.5	<0.5	--	--	--	--	--	--	--	--	79.91	12.32	67.59	--
MW-8	8/19/1992	60	--	<0.5	<0.5	<0.5	<0.5	--	--	--	--	--	--	--	--	79.91	12.58	67.33	--
MW-8	11/18/1992	<50	--	<0.5	<0.5	<0.5	<0.5	--	--	--	--	--	--	--	--	79.91	12.47	67.44	--
MW-8	2/11/1993	76a	--	<0.5	<0.5	<0.5	<0.5	--	--	--	--	--	--	--	--	79.91	11.02	68.89	--
MW-8	5/19/1993	<50	--	<0.5	<0.5	<0.5	<0.5	--	--	--	--	--	--	--	--	79.91	11.78	68.13	--
MW-8	8/18/1993	--	--	--	--	--	--	--	--	--	--	--	--	--	--	79.91	12.22	67.69	--
MW-8	11/17/1993	<50	--	<0.5	<0.5	<0.5	<0.5	--	--	--	--	--	--	--	--	79.91	12.25	67.66	--
MW-8	2/18/1994	--	--	--	--	--	--	--	--	--	--	--	--	--	--	79.91	10.56	69.35	--
MW-8	5/26/1994	<50	--	<0.5	<0.5	<0.5	<0.5	--	--	--	--	--	--	--	--	79.91	11.30	68.61	--
MW-8	8/29/1994	--	--	--	--	--	--	--	--	--	--	--	--	--	--	79.91	11.90	68.01	--
MW-8	11/11/1994	<50	--	<0.5	<0.5	<0.5	<0.5	--	--	--	--	--	--	--	--	79.91	10.12	69.79	--
MW-8	2/3/1995	--	--	--	--	--	--	--	--	--	--	--	--	--	--	79.91	11.64	68.27	--
MW-8	5/7/1995	<50	--	<0.5	<0.5	<0.5	<0.5	--	--	--	--	--	--	--	--	79.91	10.77	69.14	--
MW-8	8/2/1995	--	--	--	--	--	--	--	--	--	--	--	--	--	--	79.91	10.92	68.99	--
MW-8	11/2/1995	<50	--	<0.5	<0.5	<0.5	<0.5	--	--	--	--	--	--	--	--	79.91	11.93	67.98	--
MW-8	2/24/1996	Well inaccessible	--	--	--	--	--	--	--	--	--	--	--	--	--	79.91	--	--	--
MW-8	5/4/1996	<50	--	<0.50	<0.50	<0.50	<0.50	<2.5	--	--	--	--	--	--	--	79.91	11.66	68.25	--
MW-8	9/7/1996	--	--	--	--	--	--	--	--	--	--	--	--	--	--	79.91	9.84	70.07	--
MW-8	11/24/1996	<50	--	<0.50	<0.50	<0.50	<0.50	<2.5	--	--	--	--	--	--	--	79.91	11.53	68.38	--
MW-8	2/23/1997	--	--	--	--	--	--	--	--	--	--	--	--	--	--	79.91	11.54	68.37	--
MW-8	5/1/1997	<50	--	<0.50	<0.50	<0.50	<0.50	<2.5	--	--	--	--	--	--	--	79.91	12.37	67.54	--
MW-8	7/22/1997	--	--	--	--	--	--	--	--	--	--	--	--	--	--	79.91	12.73	67.18	--
MW-8	11/4/1997	50	--	<0.50	<0.50	<0.50	<0.50	<5.0	--	--	--	--	--	--	--	79.91	12.60	67.31	--
MW-8	1/21/1998	--	--	--	--	--	--	--	--	--	--	--	--	--	--	79.91	9.73	70.18	--
MW-8	5/11/1998	<50	--	<0.50	<0.50	<0.50	<0.50	<2.5	--	--	--	--	--	--	--	79.91	11.93	67.98	--
MW-8	8/11/1998	--	--	--	--	--	--	--	--	--	--	--	--	--	--	79.91	12.35	67.56	--
MW-8	10/20/1998	<50	--	<0.50	<0.50	<0.50	<0.50	<2.5	--	--	--	--	--	--	--	79.91	12.88	67.03	--
MW-8	2/8/1999	--	--	--	--	--	--	--	--	--	--	--	--	--	--	79.91	8.79	71.12	--
MW-8	4/12/1999	<50.0	--	<0.500	<0.500	<0.500	<0.500	<5.00	--	--	--	--	--	--	--	79.91	9.86	70.05	--
MW-8	7/27/1999	--	--	--	--	--	--	--	--	--	--	--	--	--	--	79.91	12.35	67.56	--

GROUNDWATER DATA
FORMER SHELL SERVICE STATION
500 40TH STREET, OAKLAND, CALIFORNIA

Well ID	Date	TPPH (ug/L)	TEPH (ug/L)	B (ug/L)	T (ug/L)	E (ug/L)	X (ug/L)	MTBE		DIPE (ug/L)	ETBE (ug/L)	TAME (ug/L)	TBA (ug/L)	1,2-DCA		TOC MSL	Depth to Water ft	GW Elevation MSL	DO Reading pp,
								8020 ug/L	8260 ug/L					ug/L	ug/L				
MW-8	10/25/1999	<50.0	---	<0.500	<0.500	<0.500	<0.500	<5.00	---	---	---	---	---	---	---	79.91	12.53	67.38	---
MW-8	1/24/2000	---	---	---	---	---	---	---	---	---	---	---	---	---	---	79.91	8.42	71.49	1.3
MW-8	4/24/2000	<50.0	---	<0.500	<0.500	<0.500	<0.500	<2.50	---	---	---	---	---	---	---	79.91	11.49	68.42	2.0
MW-8	7/24/2000	---	---	---	---	---	---	---	---	---	---	---	---	---	---	79.91	12.87	67.04	---
MW-8	11/1/2000	<50.0	---	<0.500	<0.500	<0.500	<0.500	<2.50	---	---	---	---	---	---	---	79.91	11.19	68.72	4.0
MW-8	1/19/2001	---	---	---	---	---	---	---	---	---	---	---	---	---	---	79.91	11.62	68.29	7.0
MW-8	4/13/2001	<50.0	---	<0.500	<0.500	<0.500	<0.500	<2.50	---	---	---	---	---	---	---	79.91	11.86	68.05	4.6
MW-8	7/9/2001	---	---	---	---	---	---	---	---	---	---	---	---	---	---	79.91	12.42	67.49	6.4
MW-8	10/18/2001	81	---	<0.50	<0.50	<0.50	<0.50	---	<5.0	---	---	---	---	---	---	79.91	13.24	66.67	2.3
MW-8	1/24/2002	---	---	---	---	---	---	---	---	---	---	---	---	---	---	79.91	11.39	68.52	3.1
MW-8	5/10/2002	95	---	<0.50	<0.50	<0.50	<0.50	---	<5.0	---	---	---	---	---	---	79.91	12.25	67.66	2.5
MW-8	7/18/2002	---	---	---	---	---	---	---	---	---	---	---	---	---	---	79.91	12.45	67.46	2.8
MW-8	10/31/2002	Well inaccessible		---	---	---	---	---	---	---	---	---	---	---	---	82.34	---	---	---
MW-8	11/11/2002	110	---	<0.50	<0.50	<0.50	<0.50	---	<5.0	---	---	---	---	---	---	82.34	12.03	70.31	---
MW-8	1/30/2003	---	---	---	---	---	---	---	---	---	---	---	---	---	---	82.34	11.85	70.49	---
MW-8	4/17/2003	<50	---	<0.50	<0.50	<0.50	<1.0	---	<5.0	---	---	---	---	---	---	82.34	11.30	71.04	---
MW-8	7/17/2003	---	---	---	---	---	---	---	---	---	---	---	---	---	---	82.34	12.40	69.94	---
MW-8	10/16/2003	<50	---	<0.50	<0.50	<0.50	<1.0	---	<0.50	---	---	---	---	---	---	82.34	12.62	69.72	---
MW-8	1/14/2004	---	---	---	---	---	---	---	---	---	---	---	---	---	---	82.34	11.85	70.49	---
MW-8	4/16/2004	<50	---	<0.50	<0.50	<0.50	<1.0	---	<0.50	---	---	---	---	---	---	82.34	12.00	70.34	---
MW-8	10/29/2004	---	---	---	---	---	---	---	---	---	---	---	---	---	---	82.34	11.66	70.68	---
MW-8	4/14/2005	<50	---	<0.50	<0.50	<0.50	<1.0	---	<0.50	---	---	---	---	---	---	82.34	10.81	71.53	---
MW-8	10/26/2005	---	---	---	---	---	---	---	---	---	---	---	---	---	---	82.34	12.23	70.11	---
MW-8	3/16/2006	<50.0	52.8 g	<0.500	<0.500	<0.500	<0.500	---	<0.500	<0.500	<0.500	<0.500	<10.0	<0.500	<0.500	82.34	10.47	71.87	---
MW-8	9/20/2006	<50.0	<47.6 g,h	<0.500	<0.500	<0.500	<0.500	---	<0.500	---	---	---	---	---	---	82.34	11.53	70.81	---
MW-8	3/26/2007	<50	<47 g	<0.50	<0.50	<0.50	<0.50	---	<0.50	---	---	---	---	---	---	82.34	12.10	70.24	---
MW-8	6/25/2007	---	---	---	---	---	---	---	---	---	---	---	---	---	---	82.34	12.69	69.65	---
MW-8	9/10/2007	<50 l	<50 g	<0.50	<1.0	<1.0	<1.0	---	<1.0	---	---	---	---	---	---	82.34	13.05	69.29	---
MW-8	12/10/2007	---	---	---	---	---	---	---	---	---	---	---	---	---	---	82.34	12.10	70.24	---
MW-8	3/10/2008	---	---	---	---	---	---	---	---	---	---	---	---	---	---	82.34	11.97	70.37	---
MW-8	6/23/2008	---	---	---	---	---	---	---	---	---	---	---	---	---	---	82.34	12.97	69.37	---
MW-8	9/22/2008	---	---	---	---	---	---	---	---	---	---	---	---	---	---	82.34	12.89	69.45	---
MW-8	12/22/2008	---	---	---	---	---	---	---	---	---	---	---	---	---	---	82.34	12.41	69.93	---

GROUNDWATER DATA
FORMER SHELL SERVICE STATION
500 40TH STREET, OAKLAND, CALIFORNIA

Well ID	Date	TPPH (ug/L)	TEPH (ug/L)	B (ug/L)	T ug/L	E ug/L	X ug/L	MTBE		DIPE ug/L	ETBE ug/L	TAME ug/L	TBA ug/L	1,2- DCA ug/L	EDB ug/L	TOC MSL	Depth to Water ft	GW Elevation MSL	DO Reading pp.
								8020 ug/L	8260 ug/L										
MW-8	3/23/2009	--	--	--	--	--	--	--	--	--	--	--	--	--	--	82.34	11.72	70.62	--
MW-8	9/21/2009	--	--	--	--	--	--	--	--	--	--	--	--	--	--	82.34	12.45	69.89	--
MW-8	3/8/2010	--	--	--	--	--	--	--	--	--	--	--	--	--	--	82.34	11.38	70.96	--
MW-8	9/27/2010	--	--	--	--	--	--	--	--	--	--	--	--	--	--	82.34	12.54	69.80	--
MW-8	3/21/2011	--	--	--	--	--	--	--	--	--	--	--	--	--	--	82.34	10.21	72.13	--
OMW-9	8/6/1991	3900	190	58	8.8	80	220	--	--	--	--	--	--	--	--	77.71	10.38	67.33	--
OMW-9	10/30/1991	Well inaccessible	--	--	--	--	--	--	--	--	--	--	--	--	--	77.71	--	--	--
OMW-9	3/18/1992	1800a	210	84	11	49	60	--	--	--	--	--	--	--	--	77.71	8.76	68.95	--
OMW-9	5/20/1992	Well inaccessible	--	--	--	--	--	--	--	--	--	--	--	--	--	77.71	--	--	--
OMW-9	8/19/1992	4600	22a	63	<25	48	70	--	--	--	--	--	--	--	--	77.71	9.98	67.73	--
OMW-9	11/18/1992	1800	130a	30	9.2	46	61	--	--	--	--	--	--	--	--	77.71	9.81	67.90	--
OMW-9	2/11/1993	Well inaccessible	--	--	--	--	--	--	--	--	--	--	--	--	--	77.71	--	--	--
OMW-9	5/19/1993	Well inaccessible	--	--	--	--	--	--	--	--	--	--	--	--	--	77.71	--	--	--
OMW-9	8/18/1993	--	--	--	--	--	--	--	--	--	--	--	--	--	--	77.71	9.75	67.96	--
OMW-9	11/17/1993	5900	2400a	86	14	150	46	--	--	--	--	--	--	--	--	77.71	9.92	67.79	--
OMW-9	2/18/1994	Well inaccessible	--	--	--	--	--	--	--	--	--	--	--	--	--	77.71	--	--	--
OMW-9	5/26/1994	Well inaccessible	--	--	--	--	--	--	--	--	--	--	--	--	--	77.71	--	--	--
OMW-9	8/29/1994	--	--	--	--	--	--	--	--	--	--	--	--	--	--	77.71	--	--	--
OMW-9	11/11/1994	Well inaccessible	--	--	--	--	--	--	--	--	--	--	--	--	--	77.71	--	--	--
OMW-9	2/3/1995	--	--	--	--	--	--	--	--	--	--	--	--	--	--	77.71	--	--	--
OMW-9	5/7/1995	Well inaccessible	--	--	--	--	--	--	--	--	--	--	--	--	--	77.71	--	--	--
OMW-9	8/2/1995	Well inaccessible	--	--	--	--	--	--	--	--	--	--	--	--	--	77.71	--	--	--
OMW-9	2/24/1996	Well inaccessible	--	--	--	--	--	--	--	--	--	--	--	--	--	77.71	--	--	--
OMW-9	5/4/1996	Well inaccessible	--	--	--	--	--	--	--	--	--	--	--	--	--	77.71	--	--	--
OMW-9	9/7/1996	Well inaccessible	--	--	--	--	--	--	--	--	--	--	--	--	--	77.71	--	--	--
OMW-9	11/24/1996	Well inaccessible	--	--	--	--	--	--	--	--	--	--	--	--	--	77.71	--	--	--
OMW-9	2/23/1997	Well inaccessible	--	--	--	--	--	--	--	--	--	--	--	--	--	77.71	--	--	--
OMW-9	5/1/1997	4700	1100	150	14	97	52	330	--	--	--	--	--	--	--	77.71	12.10	65.61	--
OMW-9	7/22/1997	Well inaccessible	--	--	--	--	--	--	--	--	--	--	--	--	--	77.71	--	--	--
OMW-9	11/4/1997	Well inaccessible	--	--	--	--	--	--	--	--	--	--	--	--	--	77.71	--	--	--
OMW-9	1/21/1998	--	--	--	--	--	--	--	--	--	--	--	--	--	--	77.71	11.32	66.39	--

GROUNDWATER DATA
FORMER SHELL SERVICE STATION
500 40TH STREET, OAKLAND, CALIFORNIA

Well ID	Date	TPPH (ug/L)	TEPH (ug/L)	B (ug/L)	T ug/L	E ug/L	X ug/L	MTBE		DIPE ug/L	ETBE ug/L	TAME ug/L	TBA ug/L	1,2- DCA ug/L	EDB ug/L	TOC MSL	Depth to Water ft	GW Elevation MSL	DO Reading pp,
								8020 ug/L	8260 ug/L										
OMW-9	5/11/1998	5500.0	1500	220	10	160	91	110	--	--	--	--	--	--	--	77.71	11.95	65.76	--
OMW-9	8/11/1998	--	--	--	--	--	--	--	--	--	--	--	--	--	--	77.71	12.08	65.63	--
OMW-9	10/20/1998	1200	780	18	<5.0	14	6.0	48	--	--	--	--	--	--	--	77.71	12.03	65.68	--
OMW-9*	11/23/1998	1700	890	88	9.0	42	22	170	--	--	--	--	--	--	--	77.71	11.85	65.86	--
OMW-9	2/8/1999	--	--	--	--	--	--	--	--	--	--	--	--	--	--	77.71	8.01	69.70	--
OMW-9	4/12/1999	2670	1870	97	<5.00	111	54	401	--	--	--	--	--	--	--	77.71	9.55	68.16	--
OMW-9	7/27/1999	--	--	--	--	--	--	--	--	--	--	--	--	--	--	77.71	11.87	65.84	--
OMW-9	10/25/1999	2670	606	31.3	<2.50	8.32	<2.50	107	--	--	--	--	--	--	--	77.71	11.93	65.78	--
OMW-9	1/24/2000	1400	1250	44.5	<1.00	12.6	8.66	69.8	23.5	--	--	--	--	--	--	77.71	10.32	67.39	1.2
OMW-9	4/24/2000	1440	644	53.3	0.605	4.63	10.2	80.7	--	--	--	--	--	--	--	77.71	11.33	66.38	1.8
OMW-9	7/24/2000	--	--	--	--	--	--	--	--	--	--	--	--	--	--	77.71	11.82	65.89	--
OMW-9	11/1/2000	2160	685	92.6	7.96	4.69	4.02	88.8	--	--	--	--	--	--	--	77.71	11.45	66.26	2.0
OMW-9	1/19/2001	--	--	--	--	--	--	--	--	--	--	--	--	--	--	77.71	11.83	65.88	4.2
OMW-9	4/13/2001	3620	923	167	3.16	60.2	14.5	231	--	--	--	--	--	--	--	77.71	12.19	65.52	3.8
OMW-9	7/9/2001	--	--	--	--	--	--	--	--	--	--	--	--	--	--	77.71	12.04	65.67	3.8
OMW-9	10/18/2001	1400	<500	23	0.77	1.8	1.4	--	10	--	--	--	--	--	--	77.71	12.90	64.81	0.4
OMW-9	1/24/2002	--	--	--	--	--	--	--	--	--	--	--	--	--	--	77.71	11.97	65.74	4.0
OMW-9	5/10/2002	3900	380	84	2.9	120	23	--	11	--	--	--	--	--	--	77.71	12.27	65.44	1.1
OMW-9	7/18/2002	--	--	--	--	--	--	--	--	--	--	--	--	--	--	77.71	12.42	65.29	4.2
OMW-9	10/31/2002	4700	<1500	40	1.1	14	14	--	<5.0	--	--	--	--	--	--	--	12.60	--	2.4
OMW-9	1/30/2003	--	--	--	--	--	--	--	--	--	--	--	--	--	--	--	12.15	--	4.8
OMW-9	4/17/2003	<50	120	<0.50	<0.50	<0.50	<1.0	--	<5.0	--	--	--	--	--	--	--	11.61	--	1.8
OMW-9	7/17/2003	--	--	--	--	--	--	--	--	--	--	--	--	--	--	--	12.22	--	4.2
OMW-9	10/16/2003	Well inaccessible		--	--	--	--	--	--	--	--	--	--	--	--	--	--	--	--
OMW-9	1/14/2004	--	--	--	--	--	--	--	--	--	--	--	--	--	--	--	11.87	--	9.1
OMW-9	4/14/2004	460	470 e	6.1	<0.50	21	1.2	--	1.2	--	--	--	--	--	--	--	12.44	--	1.0
OMW-9	10/29/2004	--	--	--	--	--	--	--	--	--	--	--	--	--	--	--	11.95	--	11.4
OMW-9	4/14/2005	<50	210 e	<0.50	<0.50	<0.50	<1.0	--	<0.50	--	--	--	--	--	--	--	11.82	--	1.9
OMW-9	10/26/2005	--	--	--	--	--	--	--	--	--	--	--	--	--	--	80.55	12.52	68.03	0.2
OMW-9	3/16/2006	10500	1600	26.2	0.670	105	4.38	--	1.06	<0.500	<0.500	<0.500	<10.0	<0.500	<0.500	80.55	11.17	69.38	--
OMW-9	9/20/2006	Well inaccessible		--	--	--	--	--	--	--	--	--	--	--	--	80.55	--	--	--
OMW-9	10/2/2006	11300	3990 g	18.0	1.81	74.4	6.18	--	0.860	--	--	--	--	--	--	80.55	12.40	68.15	0.29

TABLE 1

**GROUNDWATER DATA
FORMER SHELL SERVICE STATION
500 40TH STREET, OAKLAND, CALIFORNIA**

Well ID	Date	TPPH (ug/L)	TEPH (ug/L)	B (ug/L)	T ug/L	E ug/L	X ug/L	MTBE		DIPE ug/L	ETBE ug/L	TAME ug/L	TBA ug/L	1,2- DCA ug/L	EDB ug/L	TOC MSL	Depth to Water ft	GW Elevation MSL	DO Reading pp.
								8020 ug/L	8260 ug/L										
OMW-9	3/26/2007	2700	1000 g,k	12	<2.5	15	2.8	--	<2.5	--	--	--	--	--	--	80.55	12.00	68.55	1.2
OMW-9	6/25/2007	4000 l	1000 g	8.4	0.44 m	25	2.9	--	<1.0	--	--	--	--	--	--	80.55	12.83	67.72	0.05
OMW-9	9/10/2007	2800 l	480 g,n	3.9	<1.0	6.4	1.3	--	<1.0	--	--	--	--	--	--	80.55	13.02	67.53	0.06
OMW-9	12/10/2007	2600 l	760 g,n	12	0.46 m	6.4	0.83	--	0.71 m	--	--	--	--	--	--	80.55	12.38	68.17	0.11
OMW-9	3/10/2008	Well inaccessible		--	--	--	--	--	--	--	--	--	--	--	--	80.55	--	--	--
OMW-9	6/23/2008	1700	550 g,n	1.9	<1.0	2.0	<1.0	--	<1.0	--	--	--	--	--	--	80.55	13.30	67.25	0.01/0.02
OMW-9	9/22/2008	1300	430 g,n	1.4	<1.0	<1.0	<1.0	--	<1.0	<2.0	<2.0	<2.0	<10	--	--	80.55	12.41	68.14	0.09
OMW-9	12/22/2008	1000	550 g,n	1.4	<1.0	<1.0	<1.0	--	<1.0	--	--	--	--	--	--	80.55	12.18	68.37	--
OMW-9	3/23/2009	290	380 g,n	1.0	<1.0	1.1	<1.0	--	<1.0	--	--	--	--	--	--	80.55	11.42	69.13	0.47
OMW-9	9/21/2009	1100	420 g,n	2.3	<1.0	<1.0	<1.0	--	<1.0	<2.0	<2.0	<2.0	<10	--	--	80.55	12.10	68.45	0.62
OMW-9	3/8/2010	510	200 g,n	2.0	<1.0	3.2	<1.0	--	<1.0	--	--	--	--	--	--	80.55	11.37	69.18	0.51
OMW-9	9/27/2010	1600	80 g,n	2.8	<1.0	<1.0	<1.0	--	<1.0	<2.0	<2.0	<2.0	<10	--	--	80.55	12.96	67.59	0.88
OMW-9	3/21/2011	140	72 g	0.80	<0.50	0.88	<1.0	--	<1.0	--	--	--	--	--	--	80.55	11.90	68.65	0.78
OMW-10	8/7/1991	460	<50	73	1.0	18	8.4	--	--	--	--	--	--	--	--	77.91	10.00	67.91	--
OMW-10	10/31/1991	630	150	100	<0.5	33	26	--	--	--	--	--	--	--	--	77.91	10.10	67.81	--
OMW-10	2/15/1992	810	570a	85	2.5	44	38	--	--	--	--	--	--	--	--	77.91	--	--	--
OMW-10	3/18/1992	--	--	--	--	--	--	--	--	--	--	--	--	--	--	77.91	9.55	68.36	--
OMW-10	5/21/1992	280	--	47	0.7	4.0	3.1	--	--	--	--	--	--	--	--	77.91	10.41	67.50	--
OMW-10	8/19/1992	330	--	35	<1	6.0	4.1	--	--	--	--	--	--	--	--	77.91	10.46	67.45	--
OMW-10	11/18/1993	300	--	30	0.8	7.1	6.3	--	--	--	--	--	--	--	--	77.91	10.31	67.60	--
OMW-10	2/11/1993	510a	--	49	3.8	18	18	--	--	--	--	--	--	--	--	77.91	9.68	68.23	--
OMW-10	5/19/1993	<50	--	96	<0.5	3.4	1.5	--	--	--	--	--	--	--	--	77.91	10.19	67.72	--
OMW-10	8/18/1993	--	--	--	--	--	--	--	--	--	--	--	--	--	--	77.91	10.29	67.62	--
OMW-10	11/17/1993	400	--	24	<1.0	2.8	1.9	--	--	--	--	--	--	--	--	77.91	10.32	67.59	--
OMW-10	2/18/1994	--	--	--	--	--	--	--	--	--	--	--	--	--	--	77.91	9.30	68.61	--
OMW-10	5/26/1994	330	--	32	13	7.5	26	--	--	--	--	--	--	--	--	77.91	10.14	67.77	--
OMW-10	8/9/1994	--	--	--	--	--	--	--	--	--	--	--	--	--	--	77.91	10.38	67.53	--
OMW-10	11/11/1994	110	--	7.8	<0.5	2.3	1.5	--	--	--	--	--	--	--	--	77.91	9.34	68.57	--
OMW-10	2/3/1995	--	--	--	--	--	--	--	--	--	--	--	--	--	--	77.91	10.17	67.74	--
OMW-10	5/7/1995	1600	--	110	3.1	17	12	--	--	--	--	--	--	--	--	77.91	9.63	68.28	--
OMW-10	8/2/1995	--	--	--	--	--	--	--	--	--	--	--	--	--	--	77.91	10.07	67.84	--
OMW-10	11/2/1995	1200	--	47	0.8	1.4	2.4	--	--	--	--	--	--	--	--	77.91	9.74	68.17	--

GROUNDWATER DATA
FORMER SHELL SERVICE STATION
500 40TH STREET, OAKLAND, CALIFORNIA

Well ID	Date	TPPH (ug/L)	TEPH (ug/L)	B (ug/L)	T (ug/L)	E (ug/L)	X (ug/L)	MTBE		DIPE (ug/L)	ETBE (ug/L)	TAME (ug/L)	TBA (ug/L)	1,2- DCA (ug/L)	EDB (ug/L)	TOC MSL	Depth to Water ft	GW Elevation MSL	DO Reading pp.
								8020 (ug/L)	8260 (ug/L)										
OMW-10 (D)	11/2/1995	1300	---	50	0.8	1.5	2.5	---	---	---	---	---	---	---	---	77.91	---	---	---
OMW-10	2/24/1996	Well inaccessible		---	---	---	---	---	---	---	---	---	---	---	---	77.91	---	---	---
OMW-10	5/4/1996	1100	---	76	16	7.4	32	57	---	---	---	---	---	---	---	77.91	9.97	67.94	---
OMW-10 (D)	5/4/1996	700	---	63	13	6.4	25	21	---	---	---	---	---	---	---	77.91	---	---	---
OMW-10	9/7/1996	---	---	---	---	---	---	---	---	---	---	---	---	---	---	77.91	13.00	64.91	---
OMW-10	11/24/1996	540	---	13	2.7	1.3	1.7	16	---	---	---	---	---	---	---	77.91	12.56	65.35	---
OMW-10 (D)	11/24/1996	490	---	25	<2.0	<2.0	<2.0	66	---	---	---	---	---	---	---	77.91	---	---	---
OMW-10	2/23/1997	---	---	---	---	---	---	---	---	---	---	---	---	---	---	77.91	12.52	65.39	---
OMW-10	5/1/1997	910	---	1.3	10	4.1	5.9	4.1	---	---	---	---	---	---	---	77.91	13.13	64.78	---
OMW-10	7/22/1997	---	---	---	---	---	---	---	---	---	---	---	---	---	---	77.91	13.46	64.45	---
OMW-10	11/4/1997	460	---	5.0	<0.50	1.3	2.2	<5.0	---	---	---	---	---	---	---	77.91	12.08	65.83	---
OMW-10	1/21/1998	---	---	---	---	---	---	---	---	---	---	---	---	---	---	77.91	11.77	66.14	---
OMW-10	5/11/1998	370	---	4.1	0.7	<0.50	0.88	5.2	---	---	---	---	---	---	---	77.91	12.86	65.05	---
OMW-10	8/11/1998	---	---	---	---	---	---	---	---	---	---	---	---	---	---	77.91	13.20	64.71	---
OMW-10	10/20/1998	490	---	<0.50	<0.50	1.6	2.3	5.9	---	---	---	---	---	---	---	77.91	13.20	64.71	---
OMW-10**	11/23/1998	150	790	3.2	0.72	<0.50	1.5	5	---	---	---	---	---	---	---	77.91	12.85	65.06	---
OMW-10	2/8/1999	---	---	---	---	---	---	---	---	---	---	---	---	---	---	77.91	9.18	68.73	---
OMW-10	4/12/1999	1910	---	59.8	65.80	67	41.6	<100	---	---	---	---	---	---	---	77.91	10.25	67.66	---
OMW-10	7/27/1999	---	---	---	---	---	---	---	---	---	---	---	---	---	---	77.91	12.85	65.06	---
OMW-10	10/25/1999	130	---	1.08	<0.500	0.522	<0.500	<5.00	---	---	---	---	---	---	---	77.91	12.99	64.92	---
OMW-10	1/24/2000	---	---	---	---	---	---	---	---	---	---	---	---	---	---	77.91	10.61	67.30	0.6
OMW-10	4/24/2000	60.7	---	1.73	<0.500	<0.500	<0.500	<2.50	---	---	---	---	---	---	---	77.91	12.35	65.56	1.1
OMW-10	7/24/2000	---	---	---	---	---	---	---	---	---	---	---	---	---	---	77.91	12.76	65.15	---
OMW-10	11/1/2000	<50.0	---	0.664	<0.500	<0.500	<0.500	<2.50	---	---	---	---	---	---	---	77.91	11.96	65.95	2.2
OMW-10	1/19/2001	---	---	---	---	---	---	---	---	---	---	---	---	---	---	77.91	12.51	65.40	3.4
OMW-10	4/13/2001	91.0	---	1.75	0.720	<0.500	0.718	6.11	---	---	---	---	---	---	---	77.91	12.95	64.96	6.2
OMW-10	7/9/2001	---	---	---	---	---	---	---	---	---	---	---	---	---	---	77.91	13.11	64.80	3.4
OMW-10	10/18/2001	<50	---	<0.50	<0.50	<0.50	<0.50	---	<5.0	---	---	---	---	---	---	77.91	19.69	58.22	0.2
OMW-10	1/24/2002	---	---	---	---	---	---	---	---	---	---	---	---	---	---	77.91	12.83	65.08	2.5
OMW-10	5/10/2002	<50	---	<0.50	<0.50	<0.50	<0.50	---	<5.0	---	---	---	---	---	---	77.91	13.20	64.71	1.1
OMW-10	7/18/2002	---	---	---	---	---	---	---	---	---	---	---	---	---	---	77.91	13.22	64.69	2.3
OMW-10	10/31/2002	<50	---	<0.50	<0.50	<0.50	<0.50	---	<5.0	---	---	---	---	---	---	81.14	13.55	67.59	---
OMW-10	1/30/2003	---	---	---	---	---	---	---	---	---	---	---	---	---	---	81.14	12.67	68.47	---

GROUNDWATER DATA
FORMER SHELL SERVICE STATION
500 40TH STREET, OAKLAND, CALIFORNIA

Well ID	Date	TPPH (ug/L)	TEPH (ug/L)	B (ug/L)	T ug/L	E ug/L	X ug/L	MTBE		DIPE ug/L	ETBE ug/L	TAME ug/L	TBA ug/L	1,2- DCA ug/L	EDB ug/L	TOC MSL	Depth to Water ft	GW Elevation MSL	DO Reading pp.
								8020 ug/L	8260 ug/L										
OMW-10	4/17/2003	<50	---	<0.50	<0.50	<0.50	<1.0	---	6.6	---	---	---	---	---	---	81.14	12.14	69.00	---
OMW-10	7/17/2003	---	---	---	---	---	---	---	---	---	---	---	---	---	---	81.14	13.08	68.06	---
OMW-10	10/16/2003	120 e	---	0.68	<0.50	<0.50	<1.0	---	0.99	---	---	---	---	---	---	81.14	13.27	67.87	---
OMW-10	1/14/2004	---	---	---	---	---	---	---	---	---	---	---	---	---	---	81.14	12.55	68.59	---
OMW-10	4/14/2004	---	---	---	---	---	---	---	---	---	---	---	---	---	---	81.14	13.04	68.10	---
OMW-10	10/29/2004	---	---	---	---	---	---	---	---	---	---	---	---	---	---	81.14	12.61	68.53	---
OMW-10	4/14/2005	Well destroyed		---	---	---	---	---	---	---	---	---	---	---	---	81.14	---	---	---
OMW-11	11/22/1991	450	240	1.1	<0.5	<0.5	<0.5	---	---	---	---	---	---	---	---	75.76	11.90	63.86	---
OMW-11	2/15/1992	Well inaccessible		---	---	---	---	---	---	---	---	---	---	---	---	75.76	---	---	---
OMW-11	3/18/1992	Well inaccessible		---	---	---	---	---	---	---	---	---	---	---	---	75.76	---	---	---
OMW-11	5/20/1992	Well inaccessible		---	---	---	---	---	---	---	---	---	---	---	---	75.76	---	---	---
OMW-11	8/19/1992	270a	<50	<0.5	<0.5	<0.5	<0.5	---	---	---	---	---	---	---	---	75.76	12.06	63.70	---
OMW-11	11/18/1992	400a	100	<0.5	<0.5	<0.5	<0.5	---	---	---	---	---	---	---	---	75.76	12.01	63.75	---
OMW-11	2/11/1993	Well inaccessible		---	---	---	---	---	---	---	---	---	---	---	---	75.76	---	---	---
OMW-11	5/20/1993	200a	<0.5	<0.5	<0.5	<0.5	<0.5	---	---	---	---	---	---	---	---	75.76	11.90	63.86	---
OMW-11	8/18/1993	180a	<50	<0.5	<0.5	<0.5	<0.5	---	---	---	---	---	---	---	---	75.76	11.90	63.86	---
OMW-11	11/17/1993	150a	<50a	<0.5	3.6	<0.5	<0.5	---	---	---	---	---	---	---	---	75.76	11.94	63.82	---
OMW-11	2/18/1994	Well inaccessible		---	---	---	---	---	---	---	---	---	---	---	---	75.76	---	---	---
OMW-11	5/26/1994	Well inaccessible		---	---	---	---	---	---	---	---	---	---	---	---	75.76	---	---	---
OMW-11	8/29/1994	---	---	---	---	---	---	---	---	---	---	---	---	---	---	75.76	11.98	63.78	---
OMW-11	11/11/1994	160	---	<0.5	<0.5	<0.5	<0.5	---	---	---	---	---	---	---	---	75.76	10.88	64.88	---
OMW-11	2/3/1995	---	---	---	---	---	---	---	---	---	---	---	---	---	---	75.76	10.62	65.14	---
OMW-11	3/5/1995	220	100	0.7	<0.5	<0.5	<0.5	---	---	---	---	---	---	---	---	75.76	---	---	---
OMW-11	5/7/1995	160	<50	<0.5	<0.5	<0.5	<0.5	---	---	---	---	---	---	---	---	75.76	11.49	64.27	---
OMW-11	8/2/1995	Well inaccessible		---	---	---	---	---	---	---	---	---	---	---	---	75.76	---	---	---
OMW-11	2/24/1996	Well inaccessible		---	---	---	---	---	---	---	---	---	---	---	---	75.76	---	---	---
OMW-11	5/4/1996	Well inaccessible		---	---	---	---	---	---	---	---	---	---	---	---	75.76	---	---	---
OMW-11	9/7/1996	Well inaccessible		---	---	---	---	---	---	---	---	---	---	---	---	75.76	---	---	---
OMW-11	11/24/1996	Well inaccessible		---	---	---	---	---	---	---	---	---	---	---	---	75.76	---	---	---
OMW-11	2/23/1997	Well inaccessible		---	---	---	---	---	---	---	---	---	---	---	---	75.76	---	---	---
OMW-11	5/1/1997	130	71	<0.50	<0.50	<0.50	0.61	<2.5	---	---	---	---	---	---	---	75.76	13.76	62.00	---
OMW-11	7/22/1997	Well inaccessible		---	---	---	---	---	---	---	---	---	---	---	---	75.76	---	---	---

TABLE 1

**GROUNDWATER DATA
FORMER SHELL SERVICE STATION
500 40TH STREET, OAKLAND, CALIFORNIA**

Well ID	Date	TPPH (ug/L)	TEPH (ug/L)	B (ug/L)	T ug/L	E ug/L	X ug/L	MTBE		DIPE ug/L	ETBE ug/L	TAME ug/L	TBA ug/L	1,2- DCA ug/L	EDB ug/L	TOC MSL	Depth to Water ft	GW Elevation MSL	DO Reading pp,
								8020 ug/L	8260 ug/L										
OMW-11	11/4/1997	Well inaccessible		--	--	--	--	--	--	--	--	--	--	--	--	75.76	--	--	--
OMW-11	1/21/1998	Well inaccessible		--	--	--	--	--	--	--	--	--	--	--	--	75.76	--	--	--
OMW-11	5/11/1998	100	85	<0.50	<0.50	<0.50	<0.50	<2.5	--	--	--	--	--	--	--	75.76	13.18	62.58	--
OMW-11	8/11/1998	110	<50	<0.50	<0.50	<0.50	<0.50	<2.5	--	--	--	--	--	--	--	75.76	13.50	62.26	--
OMW-11	10/20/1998	Well inaccessible		--	--	--	--	--	--	--	--	--	--	--	--	75.76	--	--	--
OMW-11	4/12/1999	Well inaccessible		--	--	--	--	--	--	--	--	--	--	--	--	75.76	--	--	--
OMW-11	7/27/1999	Well inaccessible		--	--	--	--	--	--	--	--	--	--	--	--	75.76	--	--	--
OMW-11	10/25/1999	Well inaccessible		--	--	--	--	--	--	--	--	--	--	--	--	75.76	--	--	--
OMW-11	1/24/2000	Well inaccessible		--	--	--	--	--	--	--	--	--	--	--	--	75.76	--	--	--
OMW-11	4/24/2000	Well inaccessible		--	--	--	--	--	--	--	--	--	--	--	--	75.76	--	--	--
OMW-11	5/11/2000	<50.0	<50.0	<0.500	<0.500	<0.500	<0.500	<2.50	--	--	--	--	--	--	--	75.76	12.21	63.55	--
OMW-11	7/24/2000	Well inaccessible		--	--	--	--	--	--	--	--	--	--	--	--	75.76	--	--	--
OMW-11	7/29/2000	Well inaccessible		--	--	--	--	--	--	--	--	--	--	--	--	75.76	--	--	--
OMW-11	10/26/2000	<50.0	b	<0.500	<0.500	<0.500	<0.500	<2.50	--	--	--	--	--	--	--	75.76	12.47	63.29	1.5
OMW-11	11/1/2000	Well inaccessible		--	--	--	--	--	--	--	--	--	--	--	--	75.76	--	--	--
OMW-11	1/19/2001	Well inaccessible		--	--	--	--	--	--	--	--	--	--	--	--	75.76	12.29	63.47	--
OMW-11	4/13/2001	Well inaccessible		--	--	--	--	--	--	--	--	--	--	--	--	75.76	--	--	--
OMW-11	4/26/2001	Well inaccessible		--	--	--	--	--	--	--	--	--	--	--	--	75.76	--	--	--
OMW-11	4/27/2001	Well inaccessible		--	--	--	--	--	--	--	--	--	--	--	--	75.76	--	--	--
OMW-11	7/9/2001	130	<50	<0.50	<0.50	<0.50	<0.50	--	<5.0	--	--	--	--	--	--	75.76	13.00	62.76	3.6
OMW-11	10/18/2001	200	<50	<0.50	<0.50	<0.50	<0.50	--	<5.0	--	--	--	--	--	--	75.76	13.35	62.41	0.6
OMW-11	1/24/2002	<50	170	<0.50	<0.50	<0.50	<0.50	--	<5.0	--	--	--	--	--	--	75.76	12.18	63.58	1.7
OMW-11	5/10/2002	180	<50	<0.50	<0.50	<0.50	<0.50	--	<5.0	--	--	--	--	--	--	75.76	12.44	63.32	1.3
OMW-11	7/18/2002	230	68	<0.50	<0.50	<0.50	<0.50	--	<5.0	--	--	--	--	--	--	75.76	12.32	63.44	1.9
OMW-11	10/31/2002	210	<50	<0.50	<0.50	<0.50	<0.50	--	<5.0	--	--	--	--	--	--	78.67	12.70	65.97	--
OMW-11	1/30/2003	Well inaccessible		--	--	--	--	--	--	--	--	--	--	--	--	78.67	--	--	--
OMW-11	4/17/2003	Well inaccessible		--	--	--	--	--	--	--	--	--	--	--	--	78.67	--	--	--
OMW-11	7/17/2003	120 e	<50	<0.50	<0.50	<0.50	<1.0	--	<0.50	--	--	--	--	--	--	78.67	12.56	66.11	--
OMW-11	10/16/2003	Well inaccessible		--	--	--	--	--	--	--	--	--	--	--	--	78.67	--	--	--
OMW-11	1/14/2004	97 e	<50	<0.50	0.67	<0.50	<1.0	--	<0.50	--	--	--	--	--	--	78.67	12.17	66.50	1.6
OMW-11	4/14/2004	--	--	--	--	--	--	--	--	--	--	--	--	--	--	78.67	12.41	66.26	--
OMW-11	10/29/2004	--	--	--	--	--	--	--	--	--	--	--	--	--	--	78.67	12.31	66.36	--
OMW-11	4/14/2005	Well destroyed		--	--	--	--	--	--	--	--	--	--	--	--	78.67	--	--	--

TABLE 1

GROUNDWATER DATA
FORMER SHELL SERVICE STATION
500 40TH STREET, OAKLAND, CALIFORNIA

Well ID	Date	TPPH (ug/L)	TEPH (ug/L)	B (ug/L)	T (ug/L)	E (ug/L)	X (ug/L)	MTBE 8020 (ug/L)	MTBE 8260 (ug/L)	DIPE (ug/L)	ETBE (ug/L)	TAME (ug/L)	TBA (ug/L)	1,2- DCA (ug/L)	EDB (ug/L)	TOC MSL	Depth to Water ft	GW Elevation MSL	DO Reading pp,
OMW-12	12/2/1991	<1000	<50	<0.5	<0.5	<0.5	<0.5	--	--	--	--	--	--	--	--	75.65	10.31	65.34	--
OMW-12	3/18/1992	<50	<50	<0.5	<0.5	<0.5	<0.5	--	--	--	--	--	--	--	--	75.65	8.93	66.72	--
OMW-12	5/20/1992	180a	--	<0.5	<0.5	<0.5	<0.5	--	--	--	--	--	--	--	--	75.65	10.26	65.39	--
OMW-12	8/19/1992	230a	--	<0.5	<0.5	<0.5	<0.5	--	--	--	--	--	--	--	--	75.65	10.53	65.12	--
OMW-12	11/18/1992	220a	--	<0.5	<0.5	<0.5	<0.5	--	--	--	--	--	--	--	--	75.65	10.45	65.20	--
OMW-12	2/11/1993	240	--	<0.5	<0.5	<0.5	<0.5	--	--	--	--	--	--	--	--	75.65	8.90	66.75	--
OMW-12	5/19/1993	110a	--	<0.5	<0.5	<0.5	<0.5	--	--	--	--	--	--	--	--	75.65	10.60	65.05	--
OMW-12	8/18/1993	140a	--	<0.5	<0.5	<0.5	<0.5	--	--	--	--	--	--	--	--	75.65	10.28	65.37	--
OMW-12	11/17/1993	120a	--	<0.5	<0.5	<0.5	<0.5	--	--	--	--	--	--	--	--	75.65	10.24	65.41	--
OMW-12	2/18/1994	180a	--	1.7	2.1	0.9	4.8	--	--	--	--	--	--	--	--	75.65	8.97	66.68	--
OMW-12	5/26/1994	150	--	<0.5	<0.5	<0.5	<0.5	--	--	--	--	--	--	--	--	75.65	9.62	66.03	--
OMW-12	8/29/1994	110	--	<0.5	<0.5	<0.5	<0.5	--	--	--	--	--	--	--	--	75.65	10.20	65.45	--
OMW-12	11/11/1994	90	--	<0.5	<0.5	<0.5	<0.5	--	--	--	--	--	--	--	--	75.65	8.54	67.11	--
OMW-12	2/3/1995	80	--	<0.5	<0.5	<0.5	<0.5	--	--	--	--	--	--	--	--	75.65	8.28	67.37	--
OMW-12 (D)	2/3/1995	100	--	0.6	<0.5	0.7	1.1	--	--	--	--	--	--	--	--	75.65	--	--	--
OMW-12	5/7/1995	110	--	<0.5	<0.5	<0.5	<0.5	--	--	--	--	--	--	--	--	75.65	9.17	66.48	--
OMW-12	8/2/1995	90	--	<0.5	<0.5	<0.5	<0.5	--	--	--	--	--	--	--	--	75.65	10.06	65.59	--
OMW-12 (D)	8/2/1995	120	--	<0.5	<0.5	<0.5	<0.5	--	--	--	--	--	--	--	--	75.65	--	--	--
OMW-12	11/2/1995	130	--	<0.5	<0.5	<0.5	<0.5	--	--	--	--	--	--	--	--	75.65	10.09	65.56	--
OMW-12	2/24/1996	80	--	<0.5	<0.5	<0.5	<0.5	--	--	--	--	--	--	--	--	75.65	7.81	67.84	--
OMW-12	5/4/1996	61	--	<0.50	<0.50	<0.50	<0.50	<2.5	--	--	--	--	--	--	--	75.65	11.72	63.93	--
OMW-12	9/7/1996	66	--	<0.50	<0.50	<0.50	<0.50	<2.5	--	--	--	--	--	--	--	75.65	12.65	63.00	--
OMW-12	11/24/1996	70	--	<0.50	<0.50	<0.50	<0.50	<2.5	--	--	--	--	--	--	--	75.65	11.54	64.11	--
OMW-12	2/23/1997	<50	--	<0.50	<0.50	<0.50	<0.50	<2.5	--	--	--	--	--	--	--	75.65	11.53	64.12	--
OMW-12	5/1/1997	79	--	<0.50	<0.50	<0.50	<0.50	<2.5	--	--	--	--	--	--	--	75.65	12.17	63.48	--
OMW-12	7/22/1997	<50	--	<0.50	<0.50	<0.50	<0.50	<2.5	--	--	--	--	--	--	--	75.65	12.48	63.17	--
OMW-12 (D)	7/22/1997	51	--	<0.50	<0.50	<0.50	<0.50	<2.5	--	--	--	--	--	--	--	75.65	--	--	--
OMW-12	11/4/1997	<50	--	<0.50	<0.50	<0.50	<0.50	<5.0	--	--	--	--	--	--	--	75.65	12.54	63.11	--
OMW-12	1/21/1998	<50	--	<0.50	<0.50	<0.50	<0.50	<2.5	--	--	--	--	--	--	--	75.65	9.82	65.83	--
OMW-12	5/11/1998	53	--	<0.50	<0.50	<0.50	<0.50	<2.5	--	--	--	--	--	--	--	75.65	11.63	64.02	--
OMW-12	8/11/1998	<50	--	<0.50	<0.50	<0.50	<0.50	<2.5	--	--	--	--	--	--	--	75.65	12.05	63.60	--
OMW-12	10/20/1998	<50	--	<0.50	<0.50	<0.50	<0.50	<2.5	--	--	--	--	--	--	--	75.65	12.31	63.34	--

TABLE 1

**GROUNDWATER DATA
FORMER SHELL SERVICE STATION
500 40TH STREET, OAKLAND, CALIFORNIA**

Well ID	Date	TPPH (ug/L)	TEPH (ug/L)	B (ug/L)	T (ug/L)	E (ug/L)	X (ug/L)	MTBE		DIPE (ug/L)	ETBE (ug/L)	TAME (ug/L)	TBA (ug/L)	1,2- DCA (ug/L)	EDB (ug/L)	TOC MSL	Depth to Water ft	GW Elevation MSL	DO Reading pp,
								8020 (ug/L)	8260 (ug/L)										
OMW-12	2/8/1999	<50	---	<0.50	<0.50	<0.50	<0.50	<2.5	---	---	---	---	---	---	---	75.65	8.25	67.40	---
OMW-12	4/12/1999	Well Inaccessible		---	---	---	---	---	---	---	---	---	---	---	---	75.65	---	---	---
OMW-12	7/27/1999	<50.0	---	<0.500	<0.500	<0.500	<0.500	<2.50	---	---	---	---	---	---	---	75.65	10.88	64.77	---
OMW-12	10/25/1999	<50.0	---	<0.500	<0.500	<0.500	<0.500	<5.00	---	---	---	---	---	---	---	75.65	11.00	64.65	---
OMW-12	1/24/2000	Well Inaccessible		---	---	---	---	---	---	---	---	---	---	---	---	75.65	---	---	---
OMW-12	4/24/2000	<50.0	---	<0.500	<0.500	<0.500	<0.500	<2.50	---	---	---	---	---	---	---	75.65	10.53	65.12	2.0
OMW-12	7/24/2000	<50.0	---	<0.500	<0.500	<0.500	<0.500	<2.50	---	---	---	---	---	---	---	75.65	11.55	64.10	---
OMW-12	11/1/2000	<50.0	---	<0.500	<0.500	<0.500	<0.500	<2.50	---	---	---	---	---	---	---	75.65	10.34	65.31	2.6
OMW-12	1/19/2001	<50.0	---	<0.500	<0.500	<0.500	<0.500	<2.50	---	---	---	---	---	---	---	75.65	10.60	65.05	7.6
OMW-12	4/13/2001	<50.0	---	<0.500	<0.500	<0.500	<0.500	<2.50	---	---	---	---	---	---	---	75.65	10.75	64.90	2.8
OMW-12	7/9/2001	69	---	<0.50	<0.50	<0.50	<0.50	---	<5.0	---	---	---	---	---	---	75.65	11.64	64.01	4.8
OMW-12	10/18/2001	81	---	<0.50	<0.50	<0.50	<0.50	---	<5.0	---	---	---	---	---	---	75.65	11.95	63.70	1.3
OMW-12	1/24/2002	<50	---	<0.50	<0.50	<0.50	<0.50	---	<5.0	---	---	---	---	---	---	75.65	10.27	65.38	3.4
OMW-12	5/10/2002	73	---	<0.50	<0.50	<0.50	<0.50	---	<5.0	---	---	---	---	---	---	75.65	10.86	64.79	1.6
OMW-12	7/18/2002	71	---	<0.50	<0.50	<0.50	<0.50	---	<5.0	---	---	---	---	---	---	75.65	10.66	64.99	1.7
OMW-12	10/31/2002	76	---	<0.50	<0.50	<0.50	<0.50	---	<5.0	---	---	---	---	---	---	78.58	11.20	67.38	---
OMW-12	1/30/2003	58	---	<0.50	<0.50	<0.50	<0.50	---	<5.0	---	---	---	---	---	---	78.58	10.30	68.28	---
OMW-12	4/17/2003	<50	---	<0.50	<0.50	<0.50	<1.0	---	<5.0	---	---	---	---	---	---	78.58	10.17	68.41	---
OMW-12	7/17/2003	<50	---	<0.50	<0.50	<0.50	<1.0	---	<0.50	---	---	---	---	---	---	78.58	11.05	67.53	---
OMW-12	10/16/2003	<50	---	<0.50	<0.50	<0.50	<1.0	---	<0.50	---	---	---	---	---	---	78.58	11.33	67.25	---
OMW-12	1/14/2004	67 e	---	<0.50	0.87	<0.50	<1.0	---	<0.50	---	---	---	---	---	---	78.58	10.50	68.08	2.8
OMW-12	4/14/2004	---	---	---	---	---	---	---	---	---	---	---	---	---	---	78.58	10.85	67.73	---
OMW-12	10/29/2004	---	---	---	---	---	---	---	---	---	---	---	---	---	---	78.58	10.72	67.86	---
OMW-12	4/14/2005	Well destroyed		---	---	---	---	---	---	---	---	---	---	---	---	78.58	---	---	---
OMW-13	11/22/1991	900	1000	37	9.5	74	130	---	---	---	---	---	---	---	---	76.36	11.96	64.40	---
OMW-13	3/18/1992	900a	590a	24	28	320	320	---	---	---	---	---	---	---	---	76.36	10.84	65.52	---
OMW-13	5/20/1992	Well inaccessible		---	---	---	---	---	---	---	---	---	---	---	---	76.36	---	---	---
OMW-13	8/19/1992	7000	470a	180	36	150	150	---	---	---	---	---	---	---	---	76.36	12.12	64.24	---
OMW-13	11/18/1992	Well inaccessible		---	---	---	---	---	---	---	---	---	---	---	---	76.36	12.00	64.36	---
OMW-13	2/11/1993	Well inaccessible		---	---	---	---	---	---	---	---	---	---	---	---	76.36	---	---	---
OMW-13	5/20/1993	9200	---	320	83	490	950	---	---	---	---	---	---	---	---	76.36	12.26	64.10	---
OMW-13	8/18/1993	---	---	---	---	---	---	---	---	---	---	---	---	---	---	76.36	11.75	64.61	---

GROUNDWATER DATA
FORMER SHELL SERVICE STATION
500 40TH STREET, OAKLAND, CALIFORNIA

Well ID	Date	TPPH (ug/L)	TEPH (ug/L)	B (ug/L)	T ug/L	E ug/L	X ug/L	MTBE		DIPE ug/L	ETBE ug/L	TAME ug/L	TBA ug/L	1,2- DCA ug/L	EDB ug/L	TOC MSL	Depth to Water ft	GW Elevation MSL	DO Reading pp,
								8020 ug/L	8260 ug/L										
OMW-13	11/17/1993	38000	3800	210	<130	1000	2500	--	--	--	--	--	--	--	--	76.36	11.78	64.58	--
OMW-13	2/18/1994	Well inaccessible	--	--	--	--	--	--	--	--	--	--	--	--	--	76.36	--	--	--
OMW-13	5/26/1994	Well inaccessible	--	--	--	--	--	--	--	--	--	--	--	--	--	76.36	--	--	--
OMW-13	8/29/1994	--	--	--	--	--	--	--	--	--	--	--	--	--	--	76.36	--	--	--
OMW-13	11/11/1994	Well inaccessible	--	--	--	--	--	--	--	--	--	--	--	--	--	76.36	10.28	66.08	--
OMW-13	2/3/1995	1.0	--	--	--	--	--	--	--	--	--	--	--	--	--	76.36	10.01	66.35	--
OMW-13	3/5/1995	9100	3900	200	9.7	200	130	--	--	--	--	--	--	--	--	76.36	--	--	--
OMW-13	5/7/1995	Well inaccessible	--	--	--	--	--	--	--	--	--	--	--	--	--	76.36	--	--	--
OMW-13	8/2/1995	8000	2900	180	6.6	190	55	--	--	--	--	--	--	--	--	76.36	11.80	64.56	--
OMW-13	2/24/1996	Well inaccessible	--	--	--	--	--	--	--	--	--	--	--	--	--	76.36	--	--	--
OMW-13	5/4/1996	Well inaccessible	--	--	--	--	--	--	--	--	--	--	--	--	--	76.36	--	--	--
OMW-13	9/7/1996	Well inaccessible	--	--	--	--	--	--	--	--	--	--	--	--	--	76.36	--	--	--
OMW-13	11/24/1996	15000	7700	50	<20	74	60	<100	--	--	--	--	--	--	--	76.36	12.35	64.01	--
OMW-13	2/23/1997	Well inaccessible	--	--	--	--	--	--	--	--	--	--	--	--	--	76.36	--	--	--
OMW-13	5/1/1997	2600	290	33	10	30	14	88	--	--	--	--	--	--	--	76.36	13.83	62.53	--
OMW-13	7/22/1997	Well inaccessible	--	--	--	--	--	--	--	--	--	--	--	--	--	76.36	--	--	--
OMW-13	11/4/1997	Well inaccessible	--	--	--	--	--	--	--	--	--	--	--	--	--	76.36	--	--	--
OMW-13	1/21/1998	Well inaccessible	--	--	--	--	--	--	--	--	--	--	--	--	--	76.36	--	--	--
OMW-13	5/11/1998	10000	1400	60	17	120	23	<50	--	--	--	--	--	--	--	76.36	13.21	63.15	--
OMW-13	8/11/1998	Well inaccessible	--	--	--	--	--	--	--	--	--	--	--	--	--	76.36	--	--	--
OMW-13	10/20/1998	Well inaccessible	--	--	--	--	--	--	--	--	--	--	--	--	--	76.36	--	--	--
OMW-13	2/8/1999	Well inaccessible	--	--	--	--	--	--	--	--	--	--	--	--	--	76.36	--	--	--
OMW-13	4/12/1999	Well inaccessible	--	--	--	--	--	--	--	--	--	--	--	--	--	76.36	--	--	--
OMW-13	7/27/1999	6270	2230	32.0	26.0	53.0	<5.00	33.0	--	--	--	--	--	--	--	76.36	11.87	64.49	--
OMW-13	10/25/1999	Well inaccessible	--	--	--	--	--	--	--	--	--	--	--	--	--	76.36	--	--	--
OMW-13	1/24/2000	Well inaccessible	--	--	--	--	--	--	--	--	--	--	--	--	--	76.36	--	--	--
OMW-13	4/24/2000	Well inaccessible	--	--	--	--	--	--	--	--	--	--	--	--	--	76.36	--	--	--
OMW-13	5/11/2000	Well inaccessible	--	--	--	--	--	--	--	--	--	--	--	--	--	76.36	--	--	--
OMW-13	7/24/2000	Well inaccessible	--	--	--	--	--	--	--	--	--	--	--	--	--	76.36	--	--	--
OMW-13	7/29/2000	Well inaccessible	--	--	--	--	--	--	--	--	--	--	--	--	--	76.36	--	--	--
OMW-13	11/1/2000	Well inaccessible	--	--	--	--	--	--	--	--	--	--	--	--	--	76.36	--	--	--
OMW-13	11/15/2000	2990	1200	34.8	37.3	<10.0	<10.0	<50.0	--	--	--	--	--	--	--	76.36	12.35	64.01	1.4
OMW-13	1/19/2001	4830	2390	34.8	<5.00	93.1	<5.00	<25.0	--	--	--	--	--	--	--	76.36	12.17	64.19	7.0

TABLE 1

**GROUNDWATER DATA
FORMER SHELL SERVICE STATION
500 40TH STREET, OAKLAND, CALIFORNIA**

Well ID	Date	TPPH (ug/L)	TEPH (ug/L)	B (ug/L)	T ug/L	E ug/L	X ug/L	MTBE		DIPE ug/L	ETBE ug/L	TAME ug/L	TBA ug/L	1,2- DCA ug/L	EDB ug/L	TOC MSL	Depth to Water ft	GW Elevation MSL	DO Reading pp,
								8020 ug/L	8260 ug/L										
OMW-13	4/13/2001	Well inaccessible		--	--	--	--	--	--	--	--	--	--	--	--	76.36	--	--	--
OMW-13	4/26/2001	Well inaccessible		--	--	--	--	--	--	--	--	--	--	--	--	76.36	--	--	--
OMW-13	4/27/2001	Well inaccessible		--	--	--	--	--	--	--	--	--	--	--	--	76.36	--	--	--
OMW-13	7/9/2001	1300	<600	0.74	<0.50	<0.50	<0.50	--	<5.0	--	--	--	--	--	--	76.36	13.20	63.16	6.4
OMW-13	10/18/2001	Well inaccessible		--	--	--	--	--	--	--	--	--	--	--	--	76.36	--	--	--
OMW-13	11/1/2001	Well inaccessible		--	--	--	--	--	--	--	--	--	--	--	--	76.36	--	--	--
OMW-13	11/9/2001	910	<300	<0.50	<0.50	1.1	<0.50	--	<5.0	--	--	--	--	--	--	76.36	13.53	62.83	5.8
OMW-13	1/24/2002	6300	<1500	6.6	1.0	28	2.1	--	<10	--	--	--	--	--	--	76.36	12.23	64.13	2.9
OMW-13	5/10/2002	2800	<400	3.5	<0.50	15	1.2	--	<5.0	--	--	--	--	--	--	76.36	12.59	63.77	1.0
OMW-13	7/18/2002	3300	<1000	4.3	0.70	29	1.8	--	<5.0	--	--	--	--	--	--	76.36	12.44	63.92	2.1
OMW-13	10/31/2002	1900	<1000	0.96	<0.50	7.5	<0.50	--	<5.0	--	--	--	--	--	--	--	12.86	--	--
OMW-13	1/30/2003	Well inaccessible		--	--	--	--	--	--	--	--	--	--	--	--	--	12.86	--	--
OMW-13	4/17/2003	5800	1800	11	1.3	34	2.9	--	<10	--	--	--	--	--	--	--	11.87	--	--
OMW-13	7/17/2003	5100 e	930 e	3.1	<2.5	10	<5.0	--	<2.5	--	--	--	--	--	--	--	12.70	--	--
OMW-13	10/16/2003	3100 e	740 e	<2.5	<2.5	<2.5	<5.0	--	<2.5	--	--	--	--	--	--	--	12.93	--	--
OMW-13	1/14/2004	7800	2100 e	6.3	<2.5	11	9.8	--	<2.5	--	--	--	--	--	--	--	12.57	--	1.2
OMW-13	4/14/2004	4400	1100 e	3.3	<2.5	7.6	<5.0	--	<2.5	--	--	--	--	--	--	--	12.50	--	--
OMW-13	10/29/2004	--	--	--	--	--	--	--	--	--	--	--	--	--	--	--	12.35	--	--
OMW-13	4/14/2005	4900	2000 f	5.0	<2.5	6.7	<5.0	--	<2.5	--	--	--	--	--	--	--	12.01	--	--
OMW-13	10/26/2005	Well inaccessible		--	--	--	--	--	--	--	--	--	--	--	--	--	--	--	--
OMW-13	3/16/2006	Well inaccessible		--	--	--	--	--	--	--	--	--	--	--	--	--	--	--	--
OMW-13	3/17/2006	Well inaccessible		--	--	--	--	--	--	--	--	--	--	--	--	--	--	--	--
OMW-13	3/27/2006	15500	1860 g	2.48	0.720	4.02	1.74	--	<0.500	<0.500	<0.500	<0.500	<10.0	<0.500	<0.500	--	11.23	--	--
OMW-13	9/20/2006	Well inaccessible		--	--	--	--	--	--	--	--	--	--	--	--	--	--	--	--
OMW-13	10/2/2006	4660	1110 g	<0.500	<0.500	0.510	<0.500	--	0.560	--	--	--	--	--	--	--	12.81	--	0.47
OMW-13	3/26/2007	1800 h	730 g,k	<2.5 h	<2.5 h	<2.5 h	<2.5 h	--	<2.5 h	--	--	--	--	--	--	--	12.41	--	--
OMW-13	6/25/2007	1800 l	440 g	<0.50	<1.0	0.33 m	0.41 m	--	<1.0	--	--	--	--	--	--	--	12.91	--	--
OMW-13	9/10/2007	Well inaccessible		--	--	--	--	--	--	--	--	--	--	--	--	--	--	--	--
OMW-13	9/24/2007	1200 l	1100 g,m	<0.50	<1.0	<1.0	<1.0	--	<1.0	--	--	--	--	--	--	--	12.93	--	--
OMW-13	12/10/2007	1400 l	420 g,n	0.16 m	<1.0	<1.0	0.18 m	--	<1.0	--	--	--	--	--	--	--	12.50	--	--
OMW-13	3/10/2008	1800	55 g	<0.50	<1.0	<1.0	<1.0	--	<1.0	--	--	--	--	--	--	--	12.35	--	--
OMW-13	6/23/2008	Well inaccessible		--	--	--	--	--	--	--	--	--	--	--	--	--	--	--	--
OMW-13	7/14/2008	Well inaccessible		--	--	--	--	--	--	--	--	--	--	--	--	--	--	--	--

TABLE 1

**GROUNDWATER DATA
FORMER SHELL SERVICE STATION
500 40TH STREET, OAKLAND, CALIFORNIA**

Well ID	Date	TPPH (ug/L)	TEPH (ug/L)	B (ug/L)	T (ug/L)	E (ug/L)	X (ug/L)	MTBE		DIPE (ug/L)	ETBE (ug/L)	TAME (ug/L)	TBA (ug/L)	1,2- DCA (ug/L)	EDB (ug/L)	TOC MSL	Depth to Water ft	GW Elevation MSL	DO Reading pp,
								8020 (ug/L)	8260 (ug/L)										
OMW-13	7/16/2008	Well inaccessible		---	---	---	---	---	---	---	---	---	---	---	---	---	---	---	---
OMW-13	9/22/2008	460	180 n,g	<0.50	<1.0	<1.0	<1.0	---	<1.0	<2.0	<2.0	<2.0	<10	---	---	---	13.63	---	0.18
OMW-13	12/22/2008	1700	610 n,g	<0.50	<1.0	<1.0	<1.0	---	<1.0	---	---	---	---	---	---	---	12.69	---	---
OMW-13	3/23/2009	Well inaccessible		---	---	---	---	---	---	---	---	---	---	---	---	---	---	---	---
OMW-13	9/21/2009	Well inaccessible		---	---	---	---	---	---	---	---	---	---	---	---	---	---	---	---
OMW-13	3/8/2010	5300	1400 g, n	0.60	<1.0	1.4	1.1	---	<1.0	---	---	---	---	---	---	---	11.90	---	---
OMW-13	9/27/2010	Well inaccessible		---	---	---	---	---	---	---	---	---	---	---	---	---	---	---	---
OMW-13	3/21/2011	Well inaccessible		---	---	---	---	---	---	---	---	---	---	---	---	---	---	---	---

Abbreviations:

TPPH = Total petroleum hydrocarbons as gasoline by EPA Method 8260B; prior to July 9, 2001 analyzed by EPA Method 8015.

TEPH = Total petroleum hydrocarbons as diesel by modified EPA Method 8015.

BTEX = Benzene, toluene, ethylbenzene, xylenes by EPA Method 8260B; prior July 9, 2001 analyzed by EPA Method 8020.

MTBE = Methyl tertiary-butyl ether

DIPE = Di-isopropyl ether, analyzed by EPA Method 8260B

ETBE = Ethyl tertiary-butyl ether, analyzed by EPA Method 8260B

TAME = Tertiary-amyl methyl ether, analyzed by EPA Method 8260B

TBA = Tertiary-butyl alcohol, analyzed by EPA Method 8260B

1,2-DCA = 1,2-Dichloroethane, analyzed by EPA Method 8260B

EDB = 1,2-Dibromoethane (ethylene dibromide) analyzed by EPA Method 8260B

TOC = Top of casing elevation

SPH = Separate-phase hydrocarbons

GW = Groundwater

DO = Dissolved oxygen

ug/L = Parts per billion

ppm = Parts per million

MSL = Mean sea level

ft. = Feet

<n = Below detection limit

(D) = Duplicate sample

--- = Not applicable

TABLE 1

**GROUNDWATER DATA
FORMER SHELL SERVICE STATION
500 40TH STREET, OAKLAND, CALIFORNIA**

Well ID	Date	TPPH (ug/L)	TEPH (ug/L)	B (ug/L)	T ug/L	E ug/L	X ug/L	MTBE		DIPE ug/L	ETBE ug/L	TAME ug/L	TBA ug/L	1,2-		TOC MSL	Depth to Water ft	GW Elevation MSL	DO Reading pp,
								8020 ug/L	8260 ug/L					DCA ug/L	EDB ug/L				

Notes:

a = Chromatogram indicated an unidentified hydrocarbon.

b = The TEPH analysis was not performed because the sample containers were broken in the laboratory.

c = Well was inaccessible, able to gauge but not able to take DO reading.

d = Top of casing elevation altered during wellhead maintenance.

e = Hydrocarbon does not match pattern of laboratory's standard.

f = Hydrocarbon reported is in the early Diesel range, and does not match our Diesel standard.

g = Diesel with Silica Gel cleanup

h = Initial analysis within holding time. Reanalysis for the required dilution or confirmation was past holding time.

i = Sample analysis performed past method-specified holding time.

j = Sample container contained headspace.

k = Does not match typical pattern.

l = Analyzed by EPA Method 8015B (M).

m = Analyte was detected at a concentration below the reporting limit and above the laboratory method detection limit. Reported value is estimated.

n = The sample chromatographic pattern for TPH does not match the chromatographic pattern of the specified standard. Quantitation of the unknown hydrocarbon(s) in the sample was based upon the specified standard.

o = Hydrocarbon result partly due to individual peak(s) in quantitation range.

* Field technician mistakenly sampled this well instead of OMW -11.

** Field technician mistakenly sampled this well instead of OMW-13.

DO readings are taken post-purge when wells are sampled and pre-purge in wells not sampled.

All wells except OMW-6, OMW-9, and OMW-13 surveyed March 18, 2002 by Virgil Chavez Land Surveying of Vallejo, CA.

Wells OMW-6 and OMW-9 surveyed October 25, 2005 by Virgil Chavez Land Surveying of Vallejo, CA.

APPENDIX A

BLAINE TECH SERVICES, INC. -
FIELD NOTES

WELL GAUGING DATA

Project # 110321-J01 Date 3-21-11 Client Shell

Site 110321-J01 500 offset geograph Oakland CA

Well ID	Time	Well Size (in.)	Sheen / Odor	Depth to Immiscible Liquid (ft.)	Thickness of Immiscible Liquid (ft.)	Volume of Immiscibles Removed (ml)	Depth to water (ft.)	Depth to well bottom (ft.)	Survey Point: TOB or <u>TOC</u>	Notes
MW-2	0954	4					10.82	19.58		
MW-3	0928	4				10.63	18.16			
MW-8	0858	4				10.21	38.62			
OMW-6	0902	4				12.18	20.11			
OMW-9	0958	4				11.90	17.11			
OMW-13			packed over			—	—			

SHELL WELL MONITORING DATA SHEET

BTS #: 110321-101	Site: 500 40 th / telegraph
Sampler: 10	Date: 3-21-11
Well I.D.: MW-3	Well Diameter: 2 3 (4) 6 8
Total Well Depth (TD): 18.61	Depth to Water (DTW): 10.63
Depth to Free Product: —	Thickness of Free Product (feet): —
Referenced to: PVC Grade	D.O. Meter (if req'd): YSI HACH
DTW with 80% Recharge [(Height of Water Column x 0.20) + DTW]:	

Purge Method: Bailer Waterra Sampling Method: Bailer
 Disposable Bailer Peristaltic Disposable Bailer
 Positive Air Displacement Extraction Pump Extraction Port
 Electric Submersible Other _____ Dedicated Tubing

Other: _____

NFO 10.5

_____ (Gals.) X _____	=	_____ Gals.
I Case Volume		Specified Volumes Calculated Volume

Well Diameter	Multiplier	Well Diameter	Multiplier
1"	0.04	4"	0.65
2"	0.16	6"	1.47
3"	0.37	Other	radius ² * 0.163

Time	Temp (°F)	pH	Cond. (mS or μ S)	Turbidity (NTUs)	Gals. Removed	Observations
0930	63.8	7.21	1176	41	—	

Did well dewater? Yes No Gallons actually evacuated: —

Sampling Date: 3-21-11 Sampling Time: 0930 Depth to Water: 10.63

Sample I.D.: MW-3 Laboratory: Test America Other: _____

Analyzed for: TPH-G BTEX MTBE TPH-D Oxygenates (5) Other: See COC

EB I.D. (if applicable): @ _____ Time Duplicate I.D. (if applicable):

Analyzed for: TPH-G BTEX MTBE TPH-D Oxygenates (5) Other:

D.O. (if req'd):	Pre-purge:	mg/L	Post-purge:	mg/L
O.R.P. (if req'd):	Pre-purge:	mV	Post-purge:	mV

1.42
4.48

SHELL WELL MONITORING DATA SHEET

BTS #: 110321-JO1	Site: 500 40th / telegraph
Sampler: JO	Date: 3-21-11
Well I.D.: OMW-6	Well Diameter: 2 3 (4) 6 8
Total Well Depth (TD): 20.11	Depth to Water (DTW): 12.18
Depth to Free Product: —	Thickness of Free Product (feet): —
Referenced to: PVC Grade	D.O. Meter (if req'd): YSI HACH
DTW with 80% Recharge [(Height of Water Column x 0.20) + DTW]: —	

Purge Method: ~~Bailer~~ ~~Disposable Bailer~~ ~~Positive Air Displacement~~ ~~Electric Submersible~~ ~~Waterra~~ ~~Peristaltic~~ ~~Extraction Pump~~ Other _____

Sampling Method: ~~Bailer~~ Disposable Bailer ~~Extraction Port~~ ~~Dedicated Tubing~~ Other: _____

N/A 10.5

— (Gals.) X	—	= — Gals.
1 Case Volume	Specified Volumes	Calculated Volume

Well Diameter	Multiplier	Well Diameter	Multiplier
1"	0.04	4"	0.65
2"	0.16	6"	1.47
3"	0.37	Other	radius ² * 0.163

Time	Temp (°F)	pH	Cond. (mS or μ S)	Turbidity (NTUs)	Gals. Removed	Observations
0910	63.5	7.35	1132	3.6	—	

Did well dewater? Yes No Gallons actually evacuated: —

Sampling Date: 3-21-11 Sampling Time: 0910 Depth to Water: 12.18

Sample I.D.: OMW-6 Laboratory: Test America Other: _____

Analyzed for: TPH-G BTEX MTBE TPH-D Oxygenates (5) Other: See COC

EB I.D. (if applicable): @ Time Duplicate I.D. (if applicable):

Analyzed for: TPH-G BTEX MTBE TPH-D Oxygenates (5) Other:

D.O. (if req'd):	Pre-purge:	mg/L	Post-purge:	0.85 mg/L
O.R.P. (if req'd):	Pre-purge:	mV	Post-purge:	mV

SHELL WELL MONITORING DATA SHEET

BTS #: 110321-101	Site: 500 40 th / telegraph
Sampler: JO	Date: 3-21-11
Well I.D.: OMW-9	Well Diameter: 2 3 (4) 6 8
Total Well Depth (TD): 17.11	Depth to Water (DTW): 11.90
Depth to Free Product: —	Thickness of Free Product (feet): —
Referenced to: PVC Grade	D.O. Meter (if req'd): YSI HACH
DTW with 80% Recharge [(Height of Water Column x 0.20) + DTW]: —	

Purge Method: Bailer Disposable Bailer Positive Air Displacement Electric Submersible

Waterra Peristaltic Extraction Pump Other _____

Sampling Method: Bailer Disposable Bailer Extraction Port Dedicated Tubing

Other: _____

NFO 7.5'

— (Gals.) X	— =	— Gals.
1 Case Volume	Specified Volumes	Calculated Volume

Well Diameter	Multiplier	Well Diameter	Multiplier
1"	0.04	4"	0.65
2"	0.16	6"	1.47
3"	0.37	Other	radius ² * 0.163

Time	Temp (°F)	pH	Cond. (mS or μ S)	Turbidity (NTUs)	Gals. Removed	Observations
1000	64.2	6.21	600.2	629	—	

Did well dewater? Yes No Gallons actually evacuated: —

Sampling Date: 3-21-11 Sampling Time: 1000 Depth to Water: 11.90

Sample I.D.: OMW-9 Laboratory: Test America Other _____

Analyzed for: TPH-G BTEX MTBE TPH-D Oxygenates (5) Other: See COC

EB I.D. (if applicable): @ Time Duplicate I.D. (if applicable):

Analyzed for: TPH-G BTEX MTBE TPH-D Oxygenates (5) Other:

D.O. (if req'd):	Pre-purge:		mg/L	<u>Post-purge:</u>	0.78	mg/L
O.R.P. (if req'd):	Pre-purge:		mV	<u>Post-purge:</u>	0.78 @	mV

SHELL WELL MONITORING DATA SHEET

BTS #: 110321-101	Site: 500 40 th / telegraph
Sampler: 10	Date: 3-21-11
Well I.D.: 0 MW-3	Well Diameter: 2 3 4 6 8 _____
Total Well Depth (TD):	Depth to Water (DTW):
Depth to Free Product:	Thickness of Free Product (feet):
Referenced to: <u>PVC</u> Grade	D.O. Meter (if req'd): <u>YSI</u> HACH
DTW with 80% Recharge [(Height of Water Column x 0.20) + DTW]:	

Purge Method: Bailer Disposable Bailer Positive Air Displacement Electric Submersible	Waterra Peristaltic Extraction Pump Other _____	Sampling Method: Bailer Disposable Bailer Extraction Port Dedicated Tubing Other: _____
--	--	---

MPC

_____ (Gals.) X _____	= _____ Gals.	
1 Case Volume	Specified Volumes	Calculated Volume

Well Diameter	Multiplier	Well Diameter	Multiplier
1"	0.04	4"	0.65
2"	0.16	6"	1.47
3"	0.37	Other	radius ² * 0.163

Time	Temp (°F)	pH	Cond. (mS or µS)	Turbidity (NTUs)	Gals. Removed	Observations
						well parked - UNABLE TO ACCESS
						NO SAMPLE TAKEN

Did well dewater? Yes No	Gallons actually evacuated: _____	
Sampling Date: 3-21-11	Sampling Time: _____	Depth to Water: _____
Sample I.D.:	Laboratory: <u>Test America</u> Other _____	
Analyzed for: TPH-G BTEX MTBE TPH-D Oxygenates (5) Other: <u>See COC</u>		
EB I.D. (if applicable): _____ @ _____ Time	Duplicate I.D. (if applicable): _____	
Analyzed for: TPH-G BTEX MTBE TPH-D Oxygenates (5) Other: _____		
D.O. (if req'd): Pre-purge: _____ mg/L	Post-purge: _____ mg/L	
O.R.P. (if req'd): Pre-purge: _____ mV	Post-purge: _____ mV	

APPENDIX B

TEST AMERICA -
LABORATORY REPORT

LABORATORY REPORT

Prepared For: Blaine Tech San Jose/CRA Shell
1680 Rogers Avenue
San Jose, CA 95112-1105
Attention: Lorin King

Project: 500 40th St., Oakland, CA

Sampled: 03/21/11
Received: 03/23/11
Issued: 04/05/11 19:34

NELAP #01108CA California ELAP#2706 CSDLAC #10256 AZ #AZ0671 NV #CA01531

The results listed within this Laboratory Report pertain only to the samples tested in the laboratory. The analyses contained in this report were performed in accordance with the applicable certifications as noted. All soil samples are reported on a wet weight basis unless otherwise noted in the report. This Laboratory Report is confidential and is intended for the sole use of TestAmerica and its client. This report shall not be reproduced, except in full, without written permission from TestAmerica. The Chain of Custody, 1 page, is included and is an integral part of this report.

This entire report was reviewed and approved for release.

SAMPLE CROSS REFERENCE

LABORATORY ID

IUC2508-01
IUC2508-02
IUC2508-03

CLIENT ID

MW-3
OMW-6
OMW-9

MATRIX

Water
Water
Water

Reviewed By:



TestAmerica Irvine

Pat Abe For Philip Sanelle
Project Manager

Blaine Tech San Jose/CRA Shell
 1680 Rogers Avenue
 San Jose, CA 95112-1105
 Attention: Lorin King

Project ID: 500 40th St., Oakland, CA

Report Number: IUC2508

Sampled: 03/21/11
 Received: 03/23/11

EXTRACTABLE FUEL HYDROCARBONS (EPA 8015B w/ Silica Gel Clean-up)

Analyte	Method	Batch	Reporting Limit	Sample Result	Dilution Factor	Date Extracted	Date Analyzed	Data Qualifiers
Sample ID: IUC2508-01 (MW-3 - Water)								
Reporting Units: ug/l								
DRO (C10-C28)	EPA 8015B	11C3397	47	310	0.943	3/25/2011	3/28/2011	QPI
Surrogate: n-Octacosane (45-120%)				86 %				
Sample ID: IUC2508-02 (OMW-6 - Water)								
Reporting Units: ug/l								
DRO (C10-C28)	EPA 8015B	11C3397	200	3100	4	3/25/2011	3/29/2011	Z3
Surrogate: n-Octacosane (45-120%)				72 %				
Sample ID: IUC2508-03 (OMW-9 - Water)								
Reporting Units: ug/l								
DRO (C10-C28)	EPA 8015B	11C3397	47	72	0.943	3/25/2011	3/28/2011	
Surrogate: n-Octacosane (45-120%)				71 %				

TestAmerica Irvine

Pat Abe For Philip Sanelle
 Project Manager

The results pertain only to the samples tested in the laboratory. This report shall not be reproduced, except in full, without written permission from TestAmerica.

Blaine Tech San Jose/CRA Shell
 1680 Rogers Avenue
 San Jose, CA 95112-1105
 Attention: Lorin King

Project ID: 500 40th St., Oakland, CA

Report Number: IUC2508

Sampled: 03/21/11
 Received: 03/23/11

VOLATILE FUEL HYDROCARBONS BY GC/MS (CA LUFT)

Analyte	Method	Batch	Reporting Limit	Sample Result	Dilution Factor	Date Extracted	Date Analyzed	Data Qualifiers
Sample ID: IUC2508-01 (MW-3 - Water)								
Reporting Units: ug/l								
Volatile Fuel Hydrocarbons (C4-C12)	TPH by GC/MS	11C3697	50	710	1	3/29/2011	3/29/2011	
Surrogate: Dibromofluoromethane (80-120%)				102 %				
Surrogate: Toluene-d8 (80-120%)				102 %				
Surrogate: 4-Bromofluorobenzene (80-120%)				94 %				
Sample ID: IUC2508-02 (OMW-6 - Water)								
Reporting Units: ug/l								
Volatile Fuel Hydrocarbons (C4-C12)	TPH by GC/MS	11C3911	500	6400	10	3/30/2011	3/31/2011	P-HS
Surrogate: Dibromofluoromethane (80-120%)				114 %				
Surrogate: Toluene-d8 (80-120%)				104 %				
Surrogate: 4-Bromofluorobenzene (80-120%)				97 %				
Sample ID: IUC2508-03 (OMW-9 - Water)								
Reporting Units: ug/l								
Volatile Fuel Hydrocarbons (C4-C12)	TPH by GC/MS	11C3697	50	140	1	3/29/2011	3/29/2011	
Surrogate: Dibromofluoromethane (80-120%)				102 %				
Surrogate: Toluene-d8 (80-120%)				102 %				
Surrogate: 4-Bromofluorobenzene (80-120%)				92 %				

TestAmerica Irvine

Pat Abe For Philip Sanelle
 Project Manager

The results pertain only to the samples tested in the laboratory. This report shall not be reproduced, except in full, without written permission from TestAmerica.

Blaine Tech San Jose/CRA Shell
 1680 Rogers Avenue
 San Jose, CA 95112-1105
 Attention: Lorin King

Project ID: 500 40th St., Oakland, CA

Report Number: IUC2508

Sampled: 03/21/11
 Received: 03/23/11

VOLATILE ORGANICS by GC/MS (EPA 5030B/8260B)

Analyte	Method	Batch	Reporting Limit	Sample Result	Dilution Factor	Date Extracted	Date Analyzed	Data Qualifiers
Sample ID: IUC2508-01 (MW-3 - Water)								
Reporting Units: ug/l								
Benzene	EPA 8260B	11C3697	0.50	3.1	1	3/29/2011	3/29/2011	
Ethylbenzene	EPA 8260B	11C3697	0.50	5.2	1	3/29/2011	3/29/2011	
Toluene	EPA 8260B	11C3697	0.50	ND	1	3/29/2011	3/29/2011	
Xylenes, Total	EPA 8260B	11C3697	1.0	ND	1	3/29/2011	3/29/2011	
Methyl-tert-butyl Ether (MTBE)	EPA 8260B	11C3697	1.0	ND	1	3/29/2011	3/29/2011	
Surrogate: 4-Bromofluorobenzene (80-120%)				94 %				
Surrogate: Dibromofluoromethane (80-120%)				102 %				
Surrogate: Toluene-d8 (80-120%)				102 %				
Sample ID: IUC2508-02 (OMW-6 - Water)								
Reporting Units: ug/l								
Benzene	EPA 8260B	11C3697	0.50	3.1	1	3/29/2011	3/29/2011	
Ethylbenzene	EPA 8260B	11C3697	0.50	43	1	3/29/2011	3/29/2011	
Toluene	EPA 8260B	11C3697	0.50	0.94	1	3/29/2011	3/29/2011	
Xylenes, Total	EPA 8260B	11C3697	1.0	2.0	1	3/29/2011	3/29/2011	
Methyl-tert-butyl Ether (MTBE)	EPA 8260B	11C3697	1.0	ND	1	3/29/2011	3/29/2011	
Surrogate: 4-Bromofluorobenzene (80-120%)				96 %				
Surrogate: Dibromofluoromethane (80-120%)				104 %				
Surrogate: Toluene-d8 (80-120%)				102 %				
Sample ID: IUC2508-03 (OMW-9 - Water)								
Reporting Units: ug/l								
Benzene	EPA 8260B	11C3697	0.50	0.80	1	3/29/2011	3/29/2011	
Ethylbenzene	EPA 8260B	11C3697	0.50	0.88	1	3/29/2011	3/29/2011	
Toluene	EPA 8260B	11C3697	0.50	ND	1	3/29/2011	3/29/2011	
Xylenes, Total	EPA 8260B	11C3697	1.0	ND	1	3/29/2011	3/29/2011	
Methyl-tert-butyl Ether (MTBE)	EPA 8260B	11C3697	1.0	ND	1	3/29/2011	3/29/2011	
Surrogate: 4-Bromofluorobenzene (80-120%)				92 %				
Surrogate: Dibromofluoromethane (80-120%)				102 %				
Surrogate: Toluene-d8 (80-120%)				102 %				

TestAmerica Irvine

Pat Abe For Philip Sanelle
 Project Manager

The results pertain only to the samples tested in the laboratory. This report shall not be reproduced, except in full, without written permission from TestAmerica.

Blaine Tech San Jose/CRA Shell
 1680 Rogers Avenue
 San Jose, CA 95112-1105
 Attention: Lorin King

Project ID: 500 40th St., Oakland, CA

Report Number: IUC2508

Sampled: 03/21/11
 Received: 03/23/11

METHOD BLANK/QC DATA

EXTRACTABLE FUEL HYDROCARBONS (EPA 8015B w/ Silica Gel Clean-up)

Analyte	Result	Reporting Limit	Units	Spike Level	Source Result	%REC	%REC Limits	RPD	RPD Limit	Data Qualifiers
Batch: 11C3397 Extracted: 03/25/11										
Blank Analyzed: 03/28/2011 (11C3397-BLK1)										
DRO (C10-C28)	ND	50	ug/l							
Surrogate: n-Octacosane	170		ug/l	200		85	45-120			
LCS Analyzed: 03/28/2011 (11C3397-BS1)										
DRO (C10-C28)	772	50	ug/l	1000		77	40-115			MNR1
Surrogate: n-Octacosane	169		ug/l	200		85	45-120			
LCS Dup Analyzed: 03/28/2011 (11C3397-BSD1)										
DRO (C10-C28)	828	50	ug/l	1000		83	40-115	7	25	
Surrogate: n-Octacosane	184		ug/l	200		92	45-120			

TestAmerica Irvine

Pat Abe For Philip Sanelle
 Project Manager

The results pertain only to the samples tested in the laboratory. This report shall not be reproduced, except in full, without written permission from TestAmerica.

Blaine Tech San Jose/CRA Shell
 1680 Rogers Avenue
 San Jose, CA 95112-1105
 Attention: Lorin King

Project ID: 500 40th St., Oakland, CA

Report Number: IUC2508

Sampled: 03/21/11
 Received: 03/23/11

METHOD BLANK/QC DATA

VOLATILE FUEL HYDROCARBONS BY GC/MS (CA LUFT)

Analyte	Result	Reporting Limit	Units	Spike Level	Source Result	%REC	%REC Limits	RPD	RPD Limit	Data Qualifiers
Batch: 11C3697 Extracted: 03/29/11										
Blank Analyzed: 03/29/2011 (11C3697-BLK1)										
Volatile Fuel Hydrocarbons (C4-C12)	ND	50	ug/l							
Surrogate: Dibromofluoromethane	25.9		ug/l	25.0		104	80-120			
Surrogate: Toluene-d8	24.6		ug/l	25.0		98	80-120			
Surrogate: 4-Bromofluorobenzene	23.5		ug/l	25.0		94	80-120			
LCS Analyzed: 03/29/2011 (11C3697-BS2)										
Volatile Fuel Hydrocarbons (C4-C12)	392	50	ug/l	500		78	55-130			
Surrogate: Dibromofluoromethane	25.4		ug/l	25.0		102	80-120			
Surrogate: Toluene-d8	24.7		ug/l	25.0		99	80-120			
Surrogate: 4-Bromofluorobenzene	23.7		ug/l	25.0		95	80-120			
Matrix Spike Analyzed: 03/29/2011 (11C3697-MS1) Source: IUC2513-05										
Volatile Fuel Hydrocarbons (C4-C12)	1100	50	ug/l	1720	ND	64	50-145			
Surrogate: Dibromofluoromethane	24.6		ug/l	25.0		98	80-120			
Surrogate: Toluene-d8	25.5		ug/l	25.0		102	80-120			
Surrogate: 4-Bromofluorobenzene	23.3		ug/l	25.0		93	80-120			
Matrix Spike Dup Analyzed: 03/29/2011 (11C3697-MSD1) Source: IUC2513-05										
Volatile Fuel Hydrocarbons (C4-C12)	1140	50	ug/l	1720	ND	66	50-145	4	20	
Surrogate: Dibromofluoromethane	24.7		ug/l	25.0		99	80-120			
Surrogate: Toluene-d8	25.6		ug/l	25.0		102	80-120			
Surrogate: 4-Bromofluorobenzene	23.6		ug/l	25.0		94	80-120			
Batch: 11C3911 Extracted: 03/30/11										
Blank Analyzed: 03/30/2011 (11C3911-BLK1)										
Volatile Fuel Hydrocarbons (C4-C12)	ND	50	ug/l							
Surrogate: Dibromofluoromethane	26.6		ug/l	25.0		107	80-120			
Surrogate: Toluene-d8	25.5		ug/l	25.0		102	80-120			
Surrogate: 4-Bromofluorobenzene	23.0		ug/l	25.0		92	80-120			

TestAmerica Irvine

Pat Abe For Philip Sanelle
 Project Manager

Blaine Tech San Jose/CRA Shell
 1680 Rogers Avenue
 San Jose, CA 95112-1105
 Attention: Lorin King

Project ID: 500 40th St., Oakland, CA

Report Number: IUC2508

Sampled: 03/21/11
 Received: 03/23/11

METHOD BLANK/QC DATA

VOLATILE FUEL HYDROCARBONS BY GC/MS (CA LUFT)

Analyte	Result	Reporting Limit	Units	Spike Level	Source Result	%REC	%REC Limits	RPD	RPD Limit	Data Qualifiers
Batch: 11C3911 Extracted: 03/30/11										
LCS Analyzed: 03/30/2011 (11C3911-BS2)										
Volatile Fuel Hydrocarbons (C4-C12)	407	50	ug/l	500		81	55-130			
Surrogate: Dibromofluoromethane	26.3		ug/l	25.0		105	80-120			
Surrogate: Toluene-d8	25.7		ug/l	25.0		103	80-120			
Surrogate: 4-Bromofluorobenzene	23.8		ug/l	25.0		95	80-120			
Matrix Spike Analyzed: 03/30/2011 (11C3911-MS1) Source: IUC2883-17										
Volatile Fuel Hydrocarbons (C4-C12)	1280	50	ug/l	1720	41.4	72	50-145			
Surrogate: Dibromofluoromethane	28.2		ug/l	25.0		113	80-120			
Surrogate: Toluene-d8	25.8		ug/l	25.0		103	80-120			
Surrogate: 4-Bromofluorobenzene	24.6		ug/l	25.0		99	80-120			
Matrix Spike Dup Analyzed: 03/30/2011 (11C3911-MSD1) Source: IUC2883-17										
Volatile Fuel Hydrocarbons (C4-C12)	1130	50	ug/l	1720	41.4	63	50-145	13	20	
Surrogate: Dibromofluoromethane	27.2		ug/l	25.0		109	80-120			
Surrogate: Toluene-d8	25.4		ug/l	25.0		102	80-120			
Surrogate: 4-Bromofluorobenzene	24.1		ug/l	25.0		96	80-120			

TestAmerica Irvine

Pat Abe For Philip Sanelle
 Project Manager

The results pertain only to the samples tested in the laboratory. This report shall not be reproduced, except in full, without written permission from TestAmerica.

Blaine Tech San Jose/CRA Shell
1680 Rogers Avenue
San Jose, CA 95112-1105
Attention: Lorin King

Project ID: 500 40th St., Oakland, CA

Report Number: IUC2508

Sampled: 03/21/11
Received: 03/23/11

METHOD BLANK/QC DATA

VOLATILE ORGANICS by GC/MS (EPA 5030B/8260B)

Analyte	Result	Reporting Limit	Units	Spike Level	Source Result	%REC	Limits	RPD	RPD Limit	Data Qualifiers
Batch: 11C3697 Extracted: 03/29/11										
Blank Analyzed: 03/29/2011 (11C3697-BLK1)										
Benzene	ND	0.50	ug/l							
Ethylbenzene	ND	0.50	ug/l							
Toluene	ND	0.50	ug/l							
m,p-Xylenes	ND	1.0	ug/l							
o-Xylene	ND	0.50	ug/l							
Xylenes, Total	ND	1.0	ug/l							
Methyl-tert-butyl Ether (MTBE)	ND	1.0	ug/l							
Surrogate: 4-Bromofluorobenzene	23.5		ug/l	25.0		94	80-120			
Surrogate: Dibromofluoromethane	25.9		ug/l	25.0		104	80-120			
Surrogate: Toluene-d8	24.6		ug/l	25.0		98	80-120			
LCS Analyzed: 03/29/2011 (11C3697-BS1)										
Benzene	22.6	0.50	ug/l	25.0		90	70-120			
Ethylbenzene	24.4	0.50	ug/l	25.0		98	75-125			
Toluene	24.1	0.50	ug/l	25.0		96	70-120			
m,p-Xylenes	47.4	1.0	ug/l	50.0		95	75-125			
o-Xylene	24.5	0.50	ug/l	25.0		98	75-125			
Xylenes, Total	72.0	1.0	ug/l	75.0		96	70-125			
Methyl-tert-butyl Ether (MTBE)	23.7	1.0	ug/l	25.0		95	60-135			
Surrogate: 4-Bromofluorobenzene	23.5		ug/l	25.0		94	80-120			
Surrogate: Dibromofluoromethane	24.8		ug/l	25.0		99	80-120			
Surrogate: Toluene-d8	25.2		ug/l	25.0		101	80-120			
Matrix Spike Analyzed: 03/29/2011 (11C3697-MS1)										
Source: IUC2513-05										
Benzene	19.4	0.50	ug/l	25.0	ND	77	65-125			
Ethylbenzene	21.1	0.50	ug/l	25.0	ND	84	65-130			
Toluene	21.1	0.50	ug/l	25.0	ND	84	70-125			
m,p-Xylenes	41.1	1.0	ug/l	50.0	ND	82	65-130			
o-Xylene	21.1	0.50	ug/l	25.0	ND	84	65-125			
Xylenes, Total	62.2	1.0	ug/l	75.0	ND	83	60-130			
Methyl-tert-butyl Ether (MTBE)	24.4	1.0	ug/l	25.0	3.26	84	55-145			
Surrogate: 4-Bromofluorobenzene	23.3		ug/l	25.0		93	80-120			
Surrogate: Dibromofluoromethane	24.6		ug/l	25.0		98	80-120			
Surrogate: Toluene-d8	25.5		ug/l	25.0		102	80-120			

TestAmerica Irvine

Pat Abe For Philip Sanelle
Project Manager

The results pertain only to the samples tested in the laboratory. This report shall not be reproduced, except in full, without written permission from TestAmerica.

Blaine Tech San Jose/CRA Shell
 1680 Rogers Avenue
 San Jose, CA 95112-1105
 Attention: Lorin King

Project ID: 500 40th St., Oakland, CA

Report Number: IUC2508

Sampled: 03/21/11
 Received: 03/23/11

METHOD BLANK/QC DATA

VOLATILE ORGANICS by GC/MS (EPA 5030B/8260B)

Analyte	Result	Reporting Limit	Units	Spike Level	Source Result	%REC	%REC Limits	RPD	RPD Limit	Data Qualifiers
Batch: 11C3697 Extracted: 03/29/11										
Matrix Spike Dup Analyzed: 03/29/2011 (11C3697-MSD1)					Source: IUC2513-05					
Benzene	20.4	0.50	ug/l	25.0	ND	82	65-125	5	20	
Ethylbenzene	22.3	0.50	ug/l	25.0	ND	89	65-130	5	20	
Toluene	21.8	0.50	ug/l	25.0	ND	87	70-125	3	20	
m,p-Xylenes	42.7	1.0	ug/l	50.0	ND	85	65-130	4	25	
o-Xylene	21.9	0.50	ug/l	25.0	ND	88	65-125	4	20	
Xylenes, Total	64.6	1.0	ug/l	75.0	ND	86	60-130	4	20	
Methyl-tert-butyl Ether (MTBE)	25.5	1.0	ug/l	25.0	3.26	89	55-145	5	25	
Surrogate: 4-Bromofluorobenzene	23.6		ug/l	25.0		94	80-120			
Surrogate: Dibromofluoromethane	24.7		ug/l	25.0		99	80-120			
Surrogate: Toluene-d8	25.6		ug/l	25.0		102	80-120			

TestAmerica Irvine

Pat Abe For Philip Sanelle
 Project Manager

The results pertain only to the samples tested in the laboratory. This report shall not be reproduced, except in full, without written permission from TestAmerica.

Blaine Tech San Jose/CRA Shell
1680 Rogers Avenue
San Jose, CA 95112-1105
Attention: Lorin King

Project ID: 500 40th St., Oakland, CA

Report Number: IUC2508

Sampled: 03/21/11

Received: 03/23/11

DATA QUALIFIERS AND DEFINITIONS

- MNR1** There was no MS/MSD analyzed with this batch due to insufficient sample volume. See Blank Spike/Blank Spike Duplicate.
- P-HS** Sample container contained headspace.
- QP1** Hydrocarbon result partly due to individual peak(s) in quantitation range.
- Z3** The sample required a dilution due to the nature of the sample matrix. Because of this dilution, the surrogate spike concentration in the sample was reduced to a level where the recovery calculation does not provide useful information.
- ND** Analyte NOT DETECTED at or above the reporting limit or MDL, if MDL is specified.
- RPD** Relative Percent Difference

ADDITIONAL COMMENTS

For Volatile Fuel Hydrocarbons (C4-C12):

Volatile Fuel Hydrocarbons (C4-C12) are quantitated against a gasoline standard. Quantitation begins immediately before TBA-d9.

For Extractable Fuel Hydrocarbons (EFH, DRO, ORO):

Unless otherwise noted, Extractable Fuel Hydrocarbons (EFH, DRO, ORO) are quantitated against a Diesel Fuel Standard.

TestAmerica Irvine

Pat Abe For Philip Sanelle
Project Manager

Blaine Tech San Jose/CRA Shell
1680 Rogers Avenue
San Jose, CA 95112-1105
Attention: Lorin King

Project ID: 500 40th St., Oakland, CA

Report Number: IUC2508

Sampled: 03/21/11

Received: 03/23/11

Certification Summary

TestAmerica Irvine

Method	Matrix	Nelac	California
EPA 8015B	Water	X	X
EPA 8260B	Water	X	X
TPH by GC/MS	Water	X	X

Nevada and NELAP provide analyte specific accreditations. Analyte specific information for TestAmerica may be obtained by contacting the laboratory or visiting our website at www.testamericainc.com

TestAmerica Irvine

Pat Abe For Philip Sanelle
Project Manager

The results pertain only to the samples tested in the laboratory. This report shall not be reproduced, except in full, without written permission from TestAmerica.

