

**RECEIVED**

By Alameda County Environmental Health 10:19 am, Jun 03, 2013

Alameda County Health Care Services Agency

1131 Harbor Bay Pkwy, Suite 250

Alameda, CA 94502

Subject: RO#0000262

Albany Hill Mini Mart

800 San Pablo Avenuc

Albany, CA

Attached please find a copy of the most recent groundwater sampling report for the above referenced site. I declare, under penalty of perjury, that the information and/or recommendations contained in the attached document or report is true and correct to the best of my knowledge.

Sincerely,

Jasminder Sikand





Aqua Science Engineers, Inc. 55 Oak Court, Suite 220, Danville, CA 94526  
(925) 820-9391 - Fax (925) 837-4853 - [www.aquascienceengineers.com](http://www.aquascienceengineers.com)

May 26, 2015

QUARTERLY GROUNDWATER MONITORING REPORT  
MARCH 2015 GROUNDWATER SAMPLING  
ASE JOB NO. 3934

at  
Albany Hill Mini Mart  
800 San Pablo Avenue  
Albany, CA 94706

Prepared by:  
AQUA SCIENCE ENGINEERS, INC.  
55 Oak Court, Suite 220  
Danville, CA 94526  
(925) 820-9391



Aqua Science Engineers, Inc. 55 Oak Court, Suite 220, Danville, CA 94526  
(925) 820-9391 - Fax (925) 837-4853 - www.aquascienceengineers.com

## 1.0 INTRODUCTION

### Site Location (Site), See Figure 1

Albany Hill Mini Mart  
800 San Pablo Avenue  
Albany, CA 94706

### Responsible Party

Jasminder & Sonia Sikand  
1066 Rock Harbor Point  
Haercules, CA 94547

### Environmental Consulting Firm

Aqua Science Engineers, Inc. (ASE)  
55 Oak Court, Suite 220  
Danville, CA 94526  
Contact: Robert Kitay, Senior Geologist  
(925) 820-9391

### Agency Review

Alameda County Health  
Care Services Agency (ACHCSA)  
1131 Harbor Bay Pkwy, Suite 250  
Alameda, CA 94502  
Contact: Mark Detterman  
(510) 567-6876

The following is a report detailing the results of the March 2015 quarterly groundwater sampling at the Albany Hill Mini Mart Property. This sampling was conducted as required by the ACHCSA. The sampling schedule was reverted to a quarterly monitoring schedule at the request of the ACHCSA to monitor for possible rebound from the discontinuation of groundwater remediation, which ceased on March 2, 2015. ASE prepared this report on behalf of Jasminder and Sonia Sikand, the responsible party.



Aqua Science Engineers, Inc. 55 Oak Court, Suite 220, Danville, CA 94526  
(925) 820-9391 - Fax (925) 837-4853 - www.aquascienceengineers.com

## **2.0 GROUNDWATER FLOW DIRECTION AND GRADIENT**

On March 31, 2015, ASE measured the depth to groundwater in all ten site monitoring wells using an electric water level sounder. The surface of the groundwater was also checked for the presence of free-floating hydrocarbons or sheen. No sheen or free-floating hydrocarbons were observed in any of the monitoring wells. Groundwater elevation data is presented in Table One. A groundwater potentiometric surface map is presented as Figure 2. The general groundwater flow direction is toward the east and north. The groundwater flow direction at the site varies significantly from quarter to quarter, and was likely previously effected by the ozone-sparging taking place at the site.

## **3.0 GROUNDWATER SAMPLE COLLECTION AND ANALYSIS**

On March 31, 2015, ASE collected groundwater samples from all ten monitoring wells. Prior to sampling, each monitoring well was purged of at least three well casing volumes of groundwater using disposable polyethylene bailers. The parameters pH, temperature and electrical conductivity were monitored during the well purging, and samples were not collected until these parameters stabilized. Monitoring wells MW-6 and MW-9 went dry prior to completion of the purging of three well casing volumes and were allowed to recover for two hours prior to sampling. Groundwater samples were collected from each well using the same polyethylene bailers and were decanted from the bottom of the bailers using low-flow emptying devices into 40-ml volatile organic analysis (VOA) vials, pre-preserved with hydrochloric acid. The samples were capped without headspace, labeled, and placed in coolers with wet ice for transport to McCampbell Analytical, Inc. of Pittsburg, California (ELAP #1644) under appropriate chain-of-custody documentation. Well sampling field logs are presented in Appendix A.

The well purge water was placed into a 55-gallon steel drum and labeled for temporary storage until proper disposal could be arranged.

The groundwater samples were analyzed by McCampbell Analytical for total petroleum hydrocarbons as gasoline (TPH-G), benzene, toluene, ethyl benzene, and total xylenes (collectively known as BTEX), fuel oxygenates including methyl tertiary-butyl ether (MTBE), and naphthalene by EPA Method 8260B. Analysis for total petroleum hydrocarbons as diesel (TPH-D) by EPA Method 8015M was discontinued as agreed upon by the Alameda County Health Care Services Agency. The analytical results for this and previous sampling events are summarized in Table Two. The most recent certified analytical report and chain-of-custody documentation are included as Appendix B.

## **4.0 RESULTS AND CONCLUSIONS**

- In groundwater samples collected from monitoring well MW-1, benzene was detected at a concentration of 0.77 parts per billion (ppb) and MTBE was detected at a concentration of 4.8 ppb. Overall, there has been a significant long-term decreasing trend of hydrocarbon concentrations in this well. Concentrations this quarter are generally very similar to last quarter.



Aqua Science Engineers, Inc. 55 Oak Court, Suite 220, Danville, CA 94526  
(925) 820-9391 - Fax (925) 837-4853 - [www.aquascienceengineers.com](http://www.aquascienceengineers.com)

- No TPH-G, BTEX, naphthalene or oxygenates were detected in groundwater samples collected from monitoring well MW-2. This is the 14th consecutive sampling event that no hydrocarbons or oxygenates were detected in this well.
- No TPH-G, BTEX, naphthalene or oxygenates were detected in groundwater samples collected from monitoring well MW-3. This is the 8th time in the last 9 sampling events that no hydrocarbons or oxygenates were detected in groundwater samples from this well.
- Groundwater samples collected from monitoring well MW-4 contained 170 ppb TPH-G, 25 ppb benzene, and 5.8 ppb total xylenes. These results slightly higher than the last sampling of this well, but similar to the previous couple sampling events prior to that. There has been as significant long-term decreasing trend in hydrocarbon concentrations from this well.
- Groundwater samples collected from monitoring well MW-5R contained 1,900 ppb TPH-G, 10 ppb benzene, 0.86 ppb toluene, 2.1 ppb ethyl benzene, and 1.0 ppb total xylenes. These results show a slight decrease in concentrations from the previous quarter, and there is a long-term decreasing trend in hydrocarbon concentrations from this well. No oxygenates or naphthalene were detected.
- No TPH-G, BTEX, naphthalene or oxygenates were detected in groundwater samples collected from monitoring well MW-6 during this sampling period, other than 5.8 ppb MTBE. There has been a long-term decreasing trend in hydrocarbon concentrations from this well.
- No TPH-G, BTEX, naphthalene, or oxygenates were detected in groundwater samples collected from monitoring well MW-7. This is the 14th time in the last 16 sampling events and the 7<sup>th</sup> consecutive sampling event, that no hydrocarbons or oxygenates were detected in groundwater samples collected from this well.
- No hydrocarbons or oxygenates were detected in groundwater samples collected from monitoring well MW-8 this quarter. This is the 15th consecutive sampling event that no hydrocarbons were detected in groundwater samples collected from this well.
- Groundwater samples collected from monitoring well MW-9 contained 970 ppb TPH-G, 38 ppb benzene, 3.0 ppb toluene, 67 ppb ethyl benzene, 270 ppb total xylenes, and 47 ppb naphthalene. These results show a decrease in hydrocarbon concentrations from the previous sampling event, and there appears to be a long-term decreasing trend in hydrocarbon concentrations in this well, with the TPH-G and all BTEX concentrations at historic lows.
- The only compounds detected in groundwater samples collected from monitoring well MW-10 during this sampling period were 130 ppb TPH-G and 1.5 ppb MTBE. These concentrations are very similar (slightly lower) than the previous sampling event.



Aqua Science Engineers, Inc. 55 Oak Court, Suite 220, Danville, CA 94526  
(925) 820-9391 - Fax (925) 837-4853 - www.aquascienceengineers.com

Concentrations exceeding Environmental Screening Levels<sup>1</sup> (ESLs):

- In MW-1, no concentrations exceeded ESLs.
- In MW-2, no concentrations exceeded ESLs.
- In MW-3, no concentrations exceeded ESLs.
- In MW-4, TPH-G, benzene and MTBE concentrations exceeded ESLs.
- In MW-5R, TPH-G and benzene concentrations exceeded ESLs.
- In MW-6, the MTBE concentration exceeded the ESL.
- In MW-7, no concentrations exceeded ESLs.
- In MW-8, no concentrations exceeded ESLs.
- In MW-9, TPH-G, benzene, ethyl benzene, total xylene and naphthalene concentrations exceeded ESLs.
- In MW-10, the TPH-G concentration exceeded the ESL.

TPH-G, benzene, and MTBE isoconcentration maps are presented as Figures 3, 4, and 5, respectively.

## **5.0 RECOMMENDATIONS**

As requested in the January 14, 2015 letter from the Alameda County Health Care Services Agency as well as the May 7, 2015 modified workplan approval letter, the following will take place during the next quarter:

- A soil vapor survey will take place with a submittal due date of July 31, 2015.
- A second quarter groundwater monitoring event will take place in June 2015. The report will be due on August 21, 2015.

## **6.0 REPORT LIMITATIONS**

The results presented in this report represent the conditions at the time of the groundwater sampling, at the specific locations where the groundwater samples were collected, and for the specific parameters analyzed by the laboratory. It does not fully characterize the site for contamination resulting from sources other than the former underground storage tanks and associated plumbing at the site, or for parameters not analyzed by the laboratory. All of the laboratory work cited in this report was prepared under the direction of an independent CAL-DHS certified laboratory. The independent laboratory is solely responsible for the contents and conclusions of the chemical analysis data.

---

<sup>1</sup> As presented in the "Screening For Environmental Concerns at Sites With Contaminated Soil and Groundwater" document prepared by the California Regional Water Quality Control Board, San Francisco Bay Region dated December 2013.



Aqua Science Engineers, Inc. 55 Oak Court, Suite 220, Danville, CA 94526  
(925) 820-9391 - Fax (925) 837-4853 - [www.aquascienceengineers.com](http://www.aquascienceengineers.com)

Aqua Science Engineers appreciates the opportunity to provide environmental consulting services for this project, and trust that this report meets your needs. Please feel free to call us at (925) 820-9391 if you have any questions or comments.

Respectfully submitted,

AQUA SCIENCE ENGINEERS, INC.

A handwritten signature in black ink that reads "Robert E. Kitay".



Robert E. Kitay, P.G.  
Senior Geologist

Attachments: Figures 1 through 5  
Tables One and Two  
Appendices A and B

cc: Mr. Mark Detterman, ACHCSA via upload to ACHCSA database  
RWQCB via Geotracker



Aqua Science Engineers, Inc. 55 Oak Court, Suite 220, Danville, CA 94526  
(925) 820-9391 - Fax (925) 837-4853 - [www.aquascienceengineers.com](http://www.aquascienceengineers.com)

## **FIGURES**





NORTH

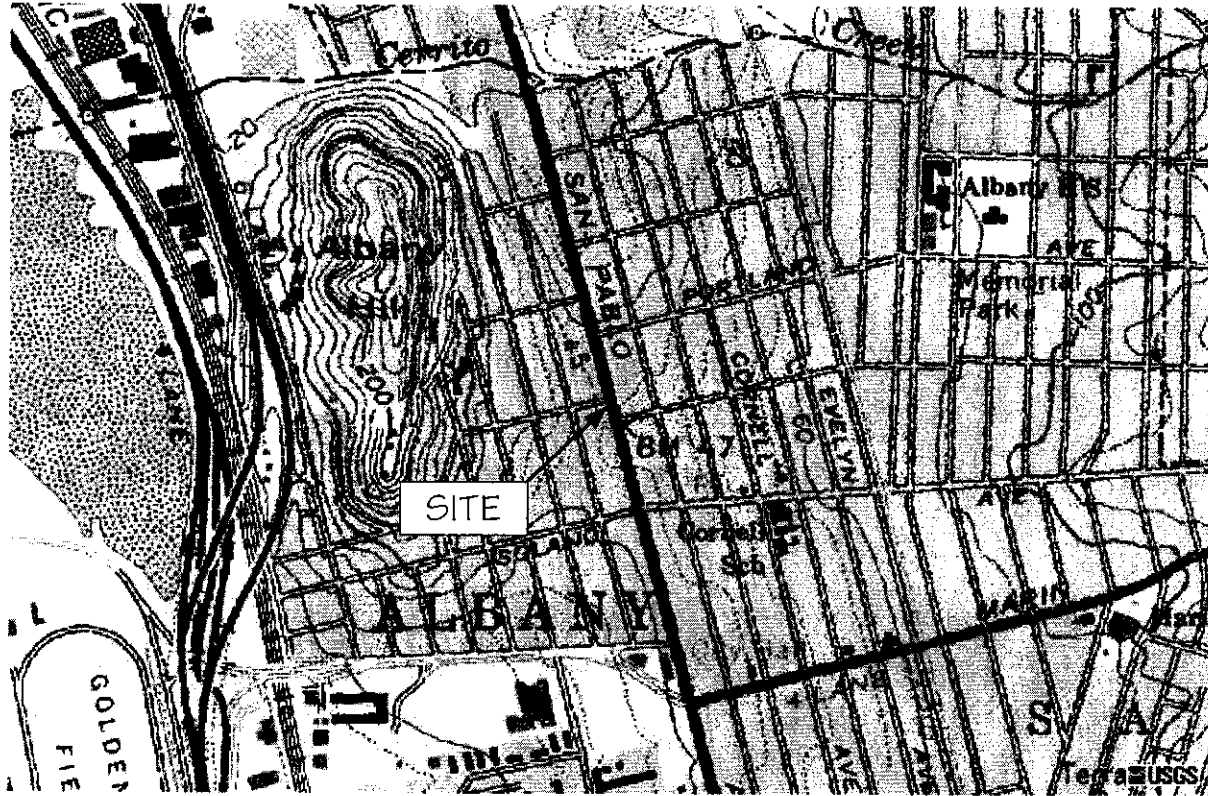

**LOCATION MAP**

ALBANY HILL MINI MART  
800 SAN PABLO AVENUE  
ALBANY, CALIFORNIA

AQUA SCIENCE ENGINEERS, INC.

Figure 1



NORTH

SCALE: 1" = 20'

WASHINGTON AVENUE

SAN PABLO AVENUE

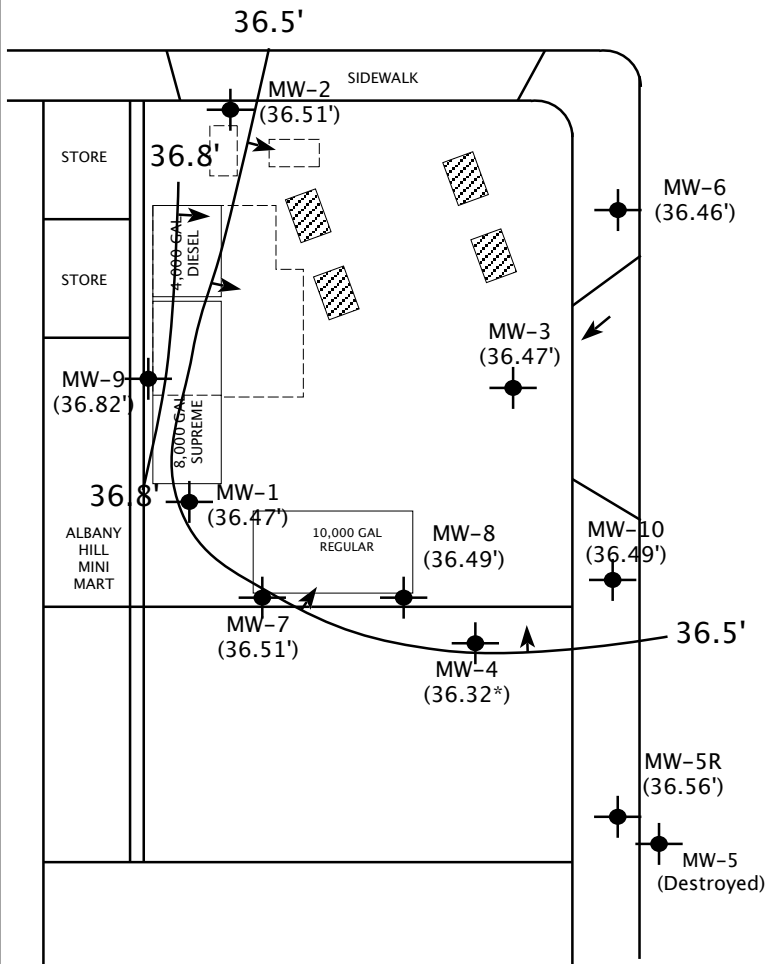

**LEGEND**

- MW-9 (36.82')
- MONITORING WELL WITH GROUNDWATER ELEVATION IN FEET
- GROUNDWATER ELEVATION CONTOUR LINE WITH FLOW DIRECTION
- \* ANOMALOUS GROUNDWATER ELEVATION: NOT USED FOR CONTOURING
- APPROXIMATE FORMER UST LOCATION AND AREA OF EXCAVATION

POTENTIOMETRIC SURFACE CONTOUR MAP  
March 31, 2015

ALBANY HILL MINI MART  
800 SAN PABLO AVENUE  
ALBANY, CALIFORNIA

AQUA SCIENCE ENGINEERS

Figure 2



NORTH

SCALE: 1" = 20'

WASHINGTON AVENUE

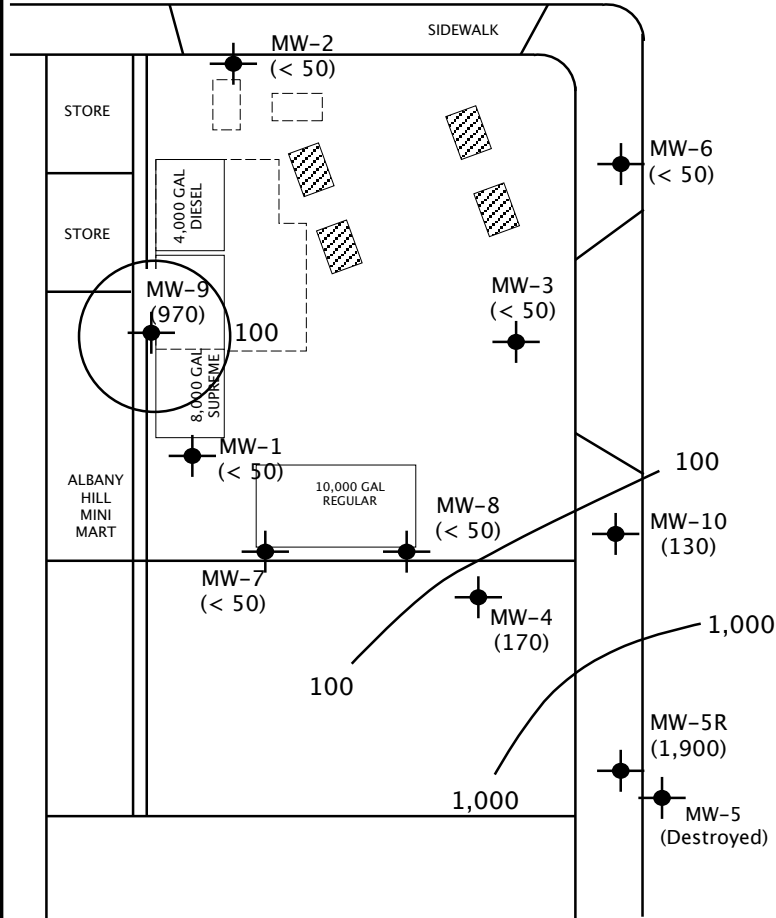

SAN PABLO AVENUE

**LEGEND**

- MW-9 (970)
- MONITORING WELL WITH TPH-G CONCENTRATION IN PPB
- TPH-G CONCENTRATION CONTOUR LINE
- APPROXIMATE FORMER UST LOCATION AND AREA OF EXCAVATION

TPH-G CONCENTRATION  
CONTOUR MAP  
MARCH 31, 2015

ALBANY HILL MINI MART  
800 SAN PABLO AVENUE  
ALBANY, CALIFORNIA

AQUA SCIENCE ENGINEERS

Figure 3



NORTH

SCALE: 1" = 20'

WASHINGTON AVENUE

SAN PABLO AVENUE

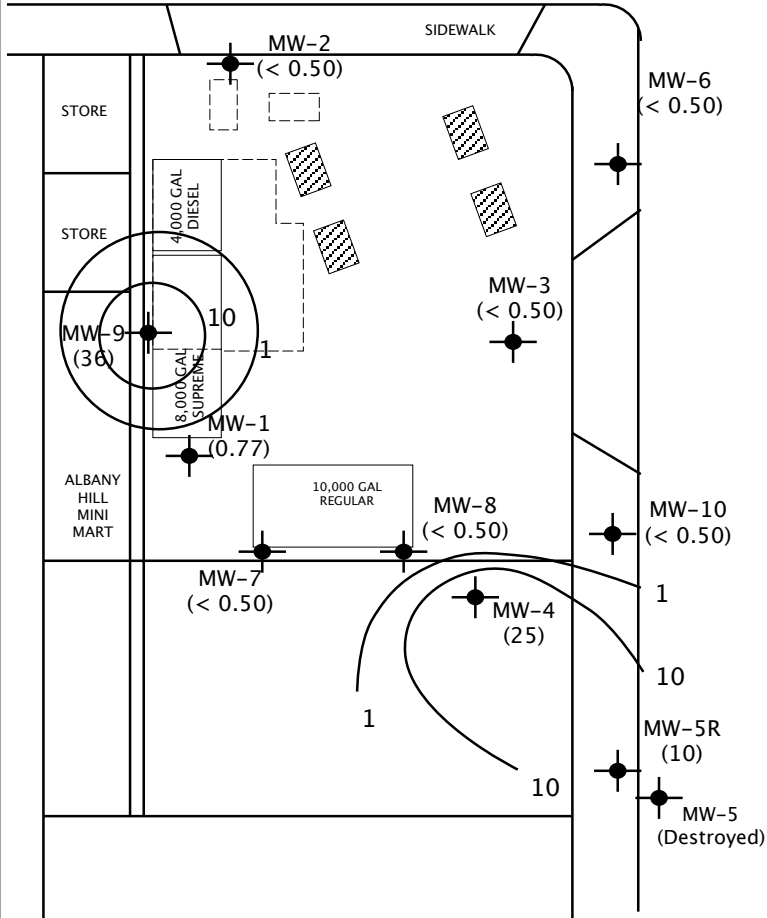

**LEGEND**

- MW-9 (36)
- MONITORING WELL WITH BENZENE CONCENTRATION IN PPB
- BENZENE CONCENTRATION CONTOUR LINE
- APPROXIMATE FORMER UST LOCATION AND AREA OF EXCAVATION

BENZENE CONCENTRATION  
CONTOUR MAP  
MARCH 31, 2015

ALBANY HILL MINI MART  
800 SAN PABLO AVENUE  
ALBANY, CALIFORNIA

AQUA SCIENCE ENGINEERS

Figure 4



NORTH

SCALE: 1" = 20'

WASHINGTON AVENUE

SAN PABLO AVENUE

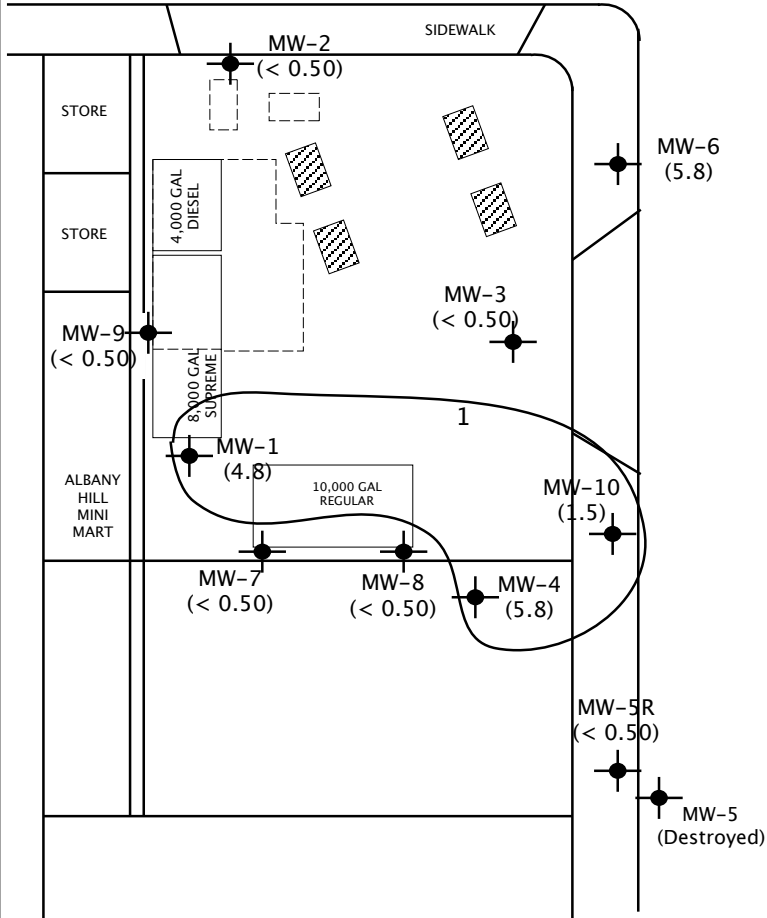

**LEGEND**

- MW-9 (< 0.50)
- MONITORING WELL WITH MTBE CONCENTRATION IN PPB
- MTBE CONCENTRATION CONTOUR LINE
- APPROXIMATE FORMER UST LOCATION AND AREA OF EXCAVATION

MTBE CONCENTRATION  
CONTOUR MAP  
MARCH 31, 2015

ALBANY HILL MINI MART  
800 SAN PABLO AVENUE  
ALBANY, CALIFORNIA

AQUA SCIENCE ENGINEERS

Figure 5



Aqua Science Engineers, Inc. 55 Oak Court, Suite 220, Danville, CA 94526  
(925) 820-9391 - Fax (925) 837-4853 - [www.aquascienceengineers.com](http://www.aquascienceengineers.com)

## **TABLES**

**TABLE ONE**  
 Groundwater Elevation Data  
**Albany Hill Mini Mart**  
 800 San Pablo Avenue, Albany, CA

Well ID	Date of Measurement	Top of Casing Elevation* (feet)	Depth to Water (feet)	Groundwater Elevation (feet)	
MW-1	8/6/99	101.68	11.95	89.73	
	11/5/99		12.72	88.96	
	2/7/00		10.34	91.34	
	5/5/00		10.59	91.09	
	8/3/00		11.75	89.93	
	11/8/00		11.67	90.01	
	2/8/01		11.20	90.48	
	6/7/01		11.35	90.33	
	9/7/01		11.71	89.97	
	12/13/01		10.67	91.01	
	6/13/02		11.42	90.26	
	9/11/02		12.42	89.26	
	2/14/03		46.42	10.69	35.73
	9/10/04			13.83	32.59
	12/7/04			12.18	34.24
	4/18/05	9.92		36.50	
	6/20/05	10.64		35.78	
	10/7/05	12.42		34.00	
	12/7/05	11.51		34.91	
	3/6/06	48.82		9.35	39.47
	6/27/06			10.07	38.75
	8/24/06			12.02	36.80
	11/20/06			12.02	36.80
	2/5/07			11.68	37.14
	5/7/07			10.91	37.91
	8/3/07			12.34	36.48
	12/5/07			12.68	36.14
	2/25/08		9.68	39.14	
	5/20/08		12.17	36.65	
	8/22/08		13.06	35.76	
	12/10/08		13.17	35.65	
	3/20/09		10.09	38.73	
	6/4/09		11.89	36.93	
12/3/09	12.91		35.91		
5/19/10	10.39	38.43			
12/21/10	10.72	38.10			
6/29/11	11.26	37.56			
12/13/11	12.15	36.67			
9/12/12	12.68	36.14			
3/30/13	11.63	37.19			
9/30/13	13.15	35.67			
3/31/14	10.81	38.01			
12/18/14	10.61	38.21			
<b>3/31/15</b>		<b>12.35</b>	<b>36.47</b>		

**TABLE ONE**  
Groundwater Elevation Data  
**Albany Hill Mini Mart**  
800 San Pablo Avenue, Albany, CA

Well ID	Date of Measurement	Top of Casing Elevation* (feet)	Depth to Water (feet)	Groundwater Elevation (feet)	
<b>MW-2</b>	8/6/99	101.57	10.83	90.74	
	11/5/99		11.66	89.91	
	2/7/00		9.23	92.34	
	5/5/00		9.54	92.03	
	8/3/00		10.69	90.88	
	11/8/00		10.62	90.95	
	2/8/01		10.17	91.40	
	6/7/01		10.30	91.27	
	9/7/01		10.65	90.92	
	12/13/01		9.65	91.92	
	6/13/02		10.37	91.20	
	9/11/02		11.32	90.25	
	2/14/03		45.31	9.59	35.72
	9/10/04			11.78	33.53
	12/7/04			11.13	34.18
	4/18/05	8.71		36.60	
	6/20/05	9.60		35.71	
	10/7/05	11.39		33.92	
	12/7/05	11.49		33.82	
	3/6/06	47.71		8.22	39.49
	6/27/06			9.45	38.26
	8/24/06			10.35	37.36
	11/20/06			10.87	36.84
	2/5/07			10.53	37.18
	5/7/07		9.72	37.99	
	8/3/07		11.47	36.24	
	12/5/07		11.98	35.73	
	2/25/08		8.93	38.78	
	5/20/08	11.78	35.93		
	8/22/08	12.21	35.50		
	12/10/08	11.35	36.36		
	3/20/09	9.26	38.45		
	6/4/09	11.09	36.62		
12/3/09	11.86	35.85			
5/19/10	9.37	38.34			
12/21/10	9.54	38.17			
6/29/11	10.27	37.44			
12/13/11	11.17	36.54			
9/12/12	11.75	35.96			
3/30/13	10.50	37.21			
9/30/13	12.17	35.54			
3/31/14	9.73	37.98			
12/18/14	9.25	38.46			
<b>3/31/15</b>		<b>11.35</b>	<b>36.36</b>		



**TABLE ONE**  
Groundwater Elevation Data  
**Albany Hill Mini Mart**  
800 San Pablo Avenue, Albany, CA

Well ID	Date of Measurement	Top of Casing Elevation* (feet)	Depth to Water (feet)	Groundwater Elevation (feet)	
<b>MW-3</b>	8/6/99	100.33	10.58	89.75	
	11/5/99		11.39	88.94	
	2/7/00		9.05	91.28	
	5/5/00		9.29	91.04	
	8/3/00		10.43	89.90	
	11/8/00		10.33	90.00	
	2/8/01		9.94	90.39	
	6/7/01		10.04	90.29	
	9/7/01		10.31	90.02	
	12/13/01		9.38	90.95	
	6/13/02		10.03	90.30	
	9/11/02		11.02	89.31	
	2/14/03		45.08	9.40	35.68
	9/10/04			12.51	32.57
	12/7/04			11.86	33.22
	4/18/05	8.49		36.59	
	6/20/05	9.34		35.74	
	10/7/05	11.11		33.97	
	12/7/05	47.49	10.22	34.86	
	3/6/06		8.84	38.65	
	6/27/06		6.07	41.42	
	8/24/06		10.26	37.23	
	11/20/06		10.52	36.97	
	2/5/07		10.41	37.08	
	5/7/07		9.57	37.92	
	8/3/07		11.06	36.43	
	12/5/07		11.26	36.23	
	2/25/08		8.33	39.16	
	5/20/08		10.83	36.66	
	8/22/08		11.74	35.75	
	12/10/08	11.93	35.56		
	3/20/09	8.46	39.03		
	6/4/09	10.97	36.52		
12/3/09	11.54	35.95			
5/19/10	9.11	38.38			
12/21/10	9.38	38.11			
6/29/11	10.02	37.47			
12/13/11	10.86	36.63			
9/12/12	8.98	38.51			
3/30/13	10.26	37.23			
9/30/13	11.88	35.61			
3/31/14	9.22	38.27			
12/18/14	9.41	38.08			
<b>3/31/15</b>	<b>11.02</b>	<b>36.47</b>			

**TABLE ONE**  
Groundwater Elevation Data  
**Albany Hill Mini Mart**  
800 San Pablo Avenue, Albany, CA

Well ID	Date of Measurement	Top of Casing Elevation* (feet)	Depth to Water (feet)	Groundwater Elevation (feet)
<b>MW-4</b>	6/13/02	100.05	10.18	89.87
	9/11/02		11.12	88.93
	2/14/03	45.20	9.51	35.69
	9/10/04		11.59	33.61
	12/7/04		10.91	34.29
	4/18/05		8.62	36.58
	6/20/05		9.45	35.75
	10/7/05		11.20	34.00
	12/7/05		10.30	34.90
	3/6/06	47.61	8.19	39.42
	6/27/06		9.71	37.90
	8/24/06		10.43	37.18
	11/20/06		10.70	36.91
	2/5/07		10.60	37.01
	5/7/07		9.52	38.09
	8/3/07		11.33	36.28
	12/5/07		11.37	36.24
	2/25/08		8.75	38.86
	5/20/08		11.07	36.54
	8/22/08		11.82	35.79
	12/10/08		12.05	35.56
	3/20/09		9.05	38.56
	6/4/09		10.68	36.93
	12/3/09		11.55	36.06
	5/19/10		9.21	38.40
	12/21/10		9.49	38.12
	6/29/11		9.79	37.82
	12/13/11		10.98	36.63
	9/12/12		11.41	36.20
	3/30/13		10.25	37.36
	9/30/13		11.91	35.70
3/31/14		9.65	37.96	
12/18/14			Not accessible	
<b>3/31/15</b>			<b>11.29</b>	<b>36.32</b>

**TABLE ONE**  
Groundwater Elevation Data  
**Albany Hill Mini Mart**  
800 San Pablo Avenue, Albany, CA

Well ID	Date of Measurement	Top of Casing Elevation* (feet)	Depth to Water (feet)	Groundwater Elevation (feet)
<b>MW-5</b>	6/13/02	98.37	8.88	89.49
	9/11/02		9.95	88.42
	2/14/03	44.12	8.66	35.46
	9/10/04		10.26	33.86
	12/7/04		10.79	33.33
	4/18/05	Well Destroyed by City During Street Construction		
<b>MW-5R</b>	10/7/05		10.94	
	12/7/05		9.97	
	3/6/06	47.36	4.93	42.43
	6/27/06		9.47	37.89
	8/24/06		10.10	37.26
	11/20/06		10.00	37.36
	2/5/07		10.21	37.15
	5/7/07		9.21	38.15
	8/3/07		10.60	36.76
	12/5/07		10.97	36.39
	2/25/08		8.64	38.72
	5/20/08		10.18	37.18
	8/22/08		11.08	36.28
	12/10/08		11.32	36.04
	3/20/09		8.46	38.90
	6/4/09		10.35	37.01
	12/3/09		10.83	36.53
	5/19/10		8.55	38.81
	12/21/10		9.00	38.36
	6/29/11		9.81	37.55
12/13/11		10.65	36.71	
9/12/12		11.21	36.15	
3/30/13		10.83	36.53	
9/30/13		11.60	35.76	
3/31/14		9.16	38.20	
12/18/14		8.85	38.51	
<b>3/31/15</b>			<b>10.80</b>	<b>36.56</b>

**TABLE ONE**  
Groundwater Elevation Data  
**Albany Hill Mini Mart**  
800 San Pablo Avenue, Albany, CA

Well ID	Date of Measurement	Top of Casing Elevation* (feet)	Depth to Water (feet)	Groundwater Elevation (feet)
<b>MW-6</b>	6/13/02	99.36	8.85	90.51
	9/11/02		9.82	89.54
	2/14/03	43.88	8.21	35.67
	9/10/04		10.33	33.55
	12/7/04		9.83	34.05
	4/18/05		7.08	36.80
	6/20/05		7.52	36.36
	10/7/05		10.92	32.96
	12/7/05		8.85	35.03
	3/6/06	46.27	6.22	40.05
	6/27/06		7.40	38.87
	8/24/06		9.15	37.12
	11/20/06		10.40	35.87
	2/5/07		9.20	37.07
	5/7/07		7.79	38.48
	8/3/07		9.96	36.31
	12/5/07		10.02	36.25
	2/25/08		6.77	39.50
	5/20/08		9.49	36.78
	8/22/08		10.49	35.78
	12/10/08		10.62	35.65
	3/20/09		7.65	38.62
	6/4/09		9.36	36.91
	12/3/09		10.14	36.13
	5/19/10		7.83	38.44
	12/21/10		6.35	39.92
	6/29/11		8.50	37.77
	12/13/11		9.60	36.67
	9/12/12		10.21	36.06
	3/30/13		9.50	36.77
	9/30/13		10.62	35.65
3/31/14		6.31	39.96	
12/18/14		6.31	39.96	
<b>3/31/15</b>			<b>9.81</b>	<b>36.46</b>

**TABLE ONE**  
Groundwater Elevation Data  
**Albany Hill Mini Mart**  
800 San Pablo Avenue, Albany, CA

Well ID	Date of Measurement	Top of Casing Elevation* (feet)	Depth to Water (feet)	Groundwater Elevation (feet)	
<b>MW-7</b>	6/13/02	100.96	10.95	90.01	
	9/11/02		11.90	89.06	
	2/14/03	45.59	10.25	35.34	
	9/10/04		12.35	33.24	
	12/7/04		11.42	34.17	
	4/18/05		9.34	36.25	
	6/20/05		10.19	35.40	
	10/7/05		12.96	32.63	
	12/7/05			not sampled	---
	3/6/06	48.36	8.92	39.44	
	6/27/06		10.41	37.95	
	8/24/06		11.21	37.15	
	11/20/06		11.46	36.90	
	2/5/07		11.34	37.02	
	5/7/07		10.39	37.97	
	8/3/07		12.09	36.27	
	12/5/07		12.18	36.18	
	2/25/08			Bubbling	---
	5/20/08			11.70	36.66
	8/22/08			12.66	35.70
	12/10/08			12.80	35.56
	3/20/09			Bubbling	---
	6/4/09			11.55	36.81
	12/3/09			12.41	35.95
	5/19/10			9.94	38.42
	12/21/10			10.77	37.59
	6/29/11			10.84	37.52
	12/13/11			11.71	36.65
	9/12/12			12.11	36.25
	3/30/13			11.04	37.32
	9/30/13			12.70	35.66
3/31/14			10.39	37.97	
12/18/14			11.05	37.31	
<b>3/31/15</b>			<b>11.85</b>	<b>36.51</b>	

**TABLE ONE**  
Groundwater Elevation Data  
**Albany Hill Mini Mart**  
800 San Pablo Avenue, Albany, CA

Well ID	Date of Measurement	Top of Casing Elevation* (feet)	Depth to Water (feet)	Groundwater Elevation (feet)
<b>MW-8</b>	6/13/02	100.54	10.57	89.97
	9/11/02		11.53	89.01
	2/14/03	45.59	9.98	35.61
	9/10/04		11.98	33.61
	12/7/04		11.42	34.17
	4/18/05		8.99	36.60
	6/20/05		9.83	35.76
	10/7/05		11.60	33.99
	12/7/05		11.69	33.90
	3/6/06	47.99	8.58	39.41
	6/27/06		10.06	37.93
	8/24/06		10.77	37.22
	11/20/06		11.12	36.87
	2/5/07		10.97	37.02
	5/7/07		9.94	38.05
	8/3/07		11.74	36.25
	12/5/07		11.80	36.19
	2/25/08		8.82	39.17
	5/20/08		11.38	36.61
	8/22/08		12.26	35.73
	12/10/08		12.49	35.50
	3/20/09		9.19	38.80
	6/4/09		11.29	36.70
	12/3/09		12.12	35.87
	5/19/10		9.64	38.35
	12/21/10		10.36	37.63
	6/29/11		10.48	37.51
	12/13/11		11.35	36.64
	9/12/12		11.57	36.42
	3/30/13		10.68	37.31
	9/30/13		12.32	35.67
3/31/14		10.01	37.98	
12/18/14		11.00	36.99	
<b>3/31/15</b>			<b>11.50</b>	<b>36.49</b>

**TABLE ONE**  
Groundwater Elevation Data  
**Albany Hill Mini Mart**  
800 San Pablo Avenue, Albany, CA

Well ID	Date of Measurement	Top of Casing Elevation* (feet)	Depth to Water (feet)	Groundwater Elevation (feet)	
<b>MW-9</b>	2/14/03	46.86	10.84	36.02	
	9/10/04		12.97	33.89	
	12/7/04		12.84	34.02	
	4/18/05		9.75	37.11	
	6/20/05		10.83	36.03	
	10/7/05		12.59	34.27	
	12/7/05		12.56	34.30	
	3/6/06		49.24	10.24	39.00
	6/27/06			9.83	39.41
	8/24/06			11.91	37.33
	11/20/06	12.42		36.82	
	2/5/07	11.95		37.29	
	5/7/07	11.20		38.04	
	8/3/07	12.67		36.57	
	12/5/07	12.96		36.28	
	2/25/08	10.71		38.53	
	5/20/08	12.15		37.09	
	8/22/08	13.18		36.06	
	12/10/08	13.32		35.92	
	3/20/09	11.39		37.85	
	6/4/09	11.82		37.42	
	12/3/09	12.93		36.31	
	5/19/10	10.26		38.98	
	12/21/10	11.66	37.58		
	6/29/11	11.50	37.74		
	12/13/11	12.38	36.86		
9/12/12	13.00	36.24			
3/30/13	12.05	37.19			
9/30/13	13.36	35.88			
3/31/14	11.80	37.44			
12/18/14	11.74	37.50			
<b>3/31/15</b>	<b>12.42</b>	<b>36.82</b>			

**TABLE ONE**  
 Groundwater Elevation Data  
**Albany Hill Mini Mart**  
 800 San Pablo Avenue, Albany, CA

Well ID	Date of Measurement	Top of Casing Elevation* (feet)	Depth to Water (feet)	Groundwater Elevation (feet)
<b>MW-10</b>	10/7/05		10.52	
	12/7/05	not sampled		
	3/6/06	46.90	7.46	39.44
	6/27/06		9.03	37.87
	8/24/06		9.75	37.15
	11/20/06		10.30	36.60
	2/5/07		9.83	37.07
	5/7/07		8.85	38.05
	8/3/07		11.00	35.90
	12/5/07		10.64	36.26
	2/25/08		8.03	38.87
	5/20/08		10.58	36.32
	8/22/08		11.48	35.42
	12/10/08		11.68	35.22
	3/20/09		8.83	38.07
	6/4/09		10.00	36.90
	12/3/09		11.16	35.74
	5/19/10		8.87	38.03
	12/21/10		8.67	38.23
	6/29/11		9.44	37.46
	12/13/11		10.25	36.65
	9/12/12		9.61	37.29
3/30/13		9.57	37.33	
9/30/13		11.20	35.70	
3/31/14		8.82	38.08	
12/18/14		8.71	38.19	
	<b>3/31/15</b>		<b>10.41</b>	<b>36.49</b>

Notes:

Data prior to September 10, 2004, including survey data, is based on tables compiled by AARS.

\* Top of casing elevations were initially surveyed to an arbitrary benchmark. The elevations were resurveyed on November 11, 2002 with respect mean sea level.



**TABLE TWO**  
Summary of Analytical Results for **GROUNDWATER** Samples  
**Albany Hill Mini Mart**  
800 San Pablo Avenue, Albany, CA  
All results are in **parts per billion (ppb)**

Well ID or Sample Point	Date Sampled	TPH Gasoline	TPH Diesel	Benzene	Toluene	Ethyl-benzene	Total Xylenes	TAME	TBA	MTBE	Other VOCs
MW-1	8/6/99	1,500	1,200	4.3	2.9	9.1	28	--	--	ND	--
	11/5/99	1,800	1,400	5.1	3.2	8.9	33	--	--	ND	--
	2/7/00	1,100	890	3.3	1.9	5.6	21	--	--	ND	--
	5/7/00	970	650	2.9	1.7	4.9	18	--	--	ND	--
	8/3/00	1,200	270*	190	43.0	41	160	--	--	360	--
	11/8/00	4,200	230*	990	200.0	130	560	--	--	840**	--
	2/8/01	2,800	380*	630	130.0	51	250	--	--	390	--
	6/7/01	650	190	97	13.0	20	62	--	--	320	--
	9/7/01	970	400	260	17.0	44	140	--	--	460	--
	12/13/01	291	< 50	91.7	1.4	17.4	7.2	--	--	499	--
	6/13/02	5,120	2,160*	1,860	22.0	316	318	--	--	325	--
	11/11/02	824	< 50	216	< 5	22	20	--	--	290	--
	2/14/03	1,783	590*	546	5.0	90	52	--	--	321	--
	9/10/04	900	82	210	8.4	52	23	< 0.5	5.1	220	< 0.5
	12/7/04	540	< 80	130	3.1	24	14	< 0.5	< 5.0	240	< 0.5
	4/18/05	1,600	< 200	390	3.6	32	57	< 0.5	< 5.0	240	0.53 1,2-DCA
	6/20/05	2,500	< 300	740	12.0	110	69	< 0.5	5.7	240	< 0.50
	10/7/05	520	130	97	26.0	11	28	< 0.50	< 5.0	190	< 0.50
	12/7/05	220	86	42	11.0	6.2	12	< 0.50	< 5.0	230	< 0.50
	3/6/06	180	69	63	1.6	3.8	2.3	< 0.50	< 0.50	180	< 0.50
	6/27/06	2,800	< 300	1,100	7.1	140	44	< 0.50	9.9	220	< 0.50
	8/24/06	3,200	< 200	1,100	6.6	170	16	< 2.0	< 9.0	250	< 2.0
	11/20/06	630	< 50	170	1.2	22	2.8	< 0.50	6.2	220	< 0.50
	2/5/07	570	< 50	180	1.0	23	3.4	< 0.50	< 5.0	180	< 0.50
	5/7/07	500	< 50	200	0.64	12	0.72	< 0.50	< 5.0	210	< 0.50
	8/3/07	930	< 80	300	2.8	49	6.8	< 0.50	7.1	160	< 0.50
	12/5/07	560	< 50	150	37	9.8	46	< 0.50	< 5.0	100	< 0.50
	2/25/08	1,000	100	340	11	14	23	< 0.50	11	170	< 0.50
	5/20/08	740	< 50	220	3.2	7.5	6.9	< 0.50	23	170	0.68 DIPE
	8/22/08	190	< 50	52	1.2	7.3	4.6	< 0.50	11	160	0.60 DIPE
	12/10/08	98	< 50	18	< 0.50	3.2	0.89	< 0.50	< 5.0	74	< 0.50
	3/20/09	61	< 50	1.8	< 0.50	< 0.50	< 0.50	< 0.50	< 5.0	65	< 0.50
	6/4/09	< 50	< 50	5.5	< 0.50	0.63	< 0.50	< 0.50	< 5.0	71	< 0.50
	12/3/09	75	< 50	2.8	< 0.50	< 0.50	< 0.50	< 0.50	< 5.0	30	< 0.50
	5/19/10	75	< 50	1.3	< 0.50	< 0.50	< 0.50	< 0.50	< 5.0	47	< 0.50
	12/21/10	< 50	< 50	0.86	< 0.50	< 0.50	< 0.50	< 0.50	< 5.0	19	< 0.50
	6/29/11	68	< 50	< 0.50	< 0.50	< 0.50	< 0.50	< 0.50	< 5.0	20	< 0.50
	12/13/11	< 50	< 50	2.4	< 0.50	< 0.50	< 0.50	< 0.50	< 5.0	20	< 0.50
	9/12/12	< 50	---	2.9	< 0.50	< 0.50	< 0.50	< 0.50	< 5.0	13	< 0.50
	3/30/13	< 50	---	< 0.50	< 0.50	< 0.50	< 0.50	< 0.50	< 5.0	13	< 0.50
	9/30/13	< 50	< 50	0.67	< 0.50	< 0.50	< 0.50	< 0.50	< 5.0	8.1	< 0.50
	3/31/14	< 50	---	1.5	< 0.50	< 0.50	< 0.50	< 0.50	< 5.0	5.8	< 0.50
	12/18/14	< 50	---	< 0.50	< 0.50	< 0.50	< 0.50	< 0.50	< 5.0	3.4	< 0.50
	<b>3/31/15</b>	<b>&lt; 50</b>	<b>---</b>	<b>0.77</b>	<b>&lt; 0.50</b>	<b>&lt; 0.50</b>	<b>&lt; 0.50</b>	<b>&lt; 0.50</b>	<b>&lt; 2.0</b>	<b>4.8</b>	<b>&lt; 0.50</b>

**TABLE TWO**  
Summary of Analytical Results for **GROUNDWATER** Samples  
**Albany Hill Mini Mart**  
800 San Pablo Avenue, Albany, CA  
All results are in **parts per billion (ppb)**

Well ID or Sample Point	Date Sampled	TPH Gasoline	TPH Diesel	Benzene	Toluene	Ethyl-benzene	Total Xylenes	TAME	TBA	MTBE	Other VOCs
MW-2	8/6/99	ND	340	ND	ND	ND	ND	--	--	ND	--
	11/5/99	ND	420	ND	ND	ND	0.7	--	--	ND	--
	2/7/00	ND	310	ND	ND	ND	0.6	--	--	ND	--
	5/7/00	ND	280	ND	ND	ND	< 1	--	--	ND	--
	8/3/00	460	70*	79	3.0	43	8	--	--	3,300	--
	11/8/00	200	120	57	2.0	13	8	--	--	3,000	--
	2/8/01	290	80	50	1.0	0.6	4	--	--	3,100	--
	6/7/01	210	80	18	0.6	3	5	--	--	2,000	--
	9/7/01	230	ND	51	ND	8	8	--	--	2,400	--
	12/13/01	172	ND	53	1.2	7.7	8.4	--	--	1,780	--
	6/13/02	86	< 50	6	6.7	1.1	4.5	--	--	1,830	--
	11/11/02	1,040	< 50	5	1.0	< 1	5	--	--	1,250	--
	2/14/03	82	< 50	8	< 1	1	< 3	--	--	1,520	--
	9/10/04	< 100	72	1.6	< 1.0	< 1.0	< 1.0	< 1.0	< 1.0	620	< 1.0
	12/7/04	< 150	86	17	< 1.5	< 1.5	< 1.5	< 1.5	< 7.0	540	< 1.5
	4/18/05	280	130	55	< 1.5	4.4	< 1.5	< 1.5	< 20	840	< 1.5
	6/20/05	200	100	34	< 0.90	2.4	2.7	< 0.90	5.2	540	< 0.90
	10/7/05	<90	150	11	<0.90	<0.90	<0.90	<0.90	<5.0	360	<0.90
	12/7/05	<90	110	1.5	<0.90	<0.90	<0.90	<0.90	<5.0	500	<0.90
	3/6/06	< 90	88	7.0	< 0.90	< 0.90	< 0.90	< 0.50	5.2	610	< 0.50
	6/27/06	270	150	49	< 0.50	5.1	3.4	0.58	8.9	540	< 0.50
	8/24/06	110	120	13	< 0.50	1.3	< 0.50	< 0.50	< 5.0	480	< 0.50
	11/20/06	56	< 50	5.6	< 0.50	< 0.50	< 0.50	< 0.50	< 5.0	330	< 0.50
	2/5/07	98	< 50	28	< 0.50	< 0.50	< 0.50	0.61	< 5.0	500	< 0.50
	5/7/07	< 90	< 50	22	< 0.90	< 0.90	< 0.90	< 0.90	6.0	450	< 0.90
	8/3/07	< 50	< 50	2.2	< 0.50	< 0.50	< 0.50	< 0.50	9.0	240	< 0.50
	12/5/07	< 50	< 50	< 0.50	< 0.50	< 0.50	< 0.50	< 0.50	37	82	< 0.50
	2/25/08	< 50	< 50	< 0.50	< 0.50	< 0.50	< 0.50	< 0.50	< 5.0	10	< 0.50
	5/20/08	< 50	< 50	< 0.50	< 0.50	< 0.50	< 0.50	< 0.50	< 5.0	0.71	< 0.50
	8/22/08	< 50	< 50	< 0.50	< 0.50	< 0.50	< 0.50	< 0.50	< 5.0	0.71	< 0.50
	12/10/08	< 50	< 50	< 0.50	< 0.50	< 0.50	< 0.50	< 0.50	< 5.0	< 0.50	< 0.50
	3/20/09	< 50	< 50	< 0.50	< 0.50	< 0.50	< 0.50	< 0.50	< 5.0	< 0.50	< 0.50
	6/4/09	< 50	< 50	< 0.50	< 0.50	< 0.50	< 0.50	< 0.50	< 5.0	< 0.50	< 0.50
	12/3/09	< 50	< 50	< 0.50	< 0.50	< 0.50	< 0.50	< 0.50	< 5.0	< 0.50	< 0.50
	5/19/10	< 50	< 50	< 0.50	< 0.50	< 0.50	< 0.50	< 0.50	< 5.0	< 0.50	< 0.50
	12/21/10	< 50	< 50	< 0.50	< 0.50	< 0.50	< 0.50	< 0.50	< 5.0	< 0.50	< 0.50
	6/29/11	< 50	< 50	< 0.50	< 0.50	< 0.50	< 0.50	< 0.50	< 5.0	< 0.50	< 0.50
	12/13/11	< 50	< 50	< 0.50	< 0.50	< 0.50	< 0.50	< 0.50	< 5.0	< 0.50	< 0.50
	9/12/12	< 50	---	< 0.50	< 0.50	< 0.50	< 0.50	< 0.50	< 5.0	< 0.50	< 0.50
	3/30/13	< 50	---	< 0.50	< 0.50	< 0.50	< 0.50	< 0.50	< 5.0	< 0.50	< 0.50
	9/30/13	< 50	< 50	< 0.50	< 0.50	< 0.50	< 0.50	< 0.50	< 5.0	< 0.50	< 0.50
	3/31/14	< 50	---	< 0.50	< 0.50	< 0.50	< 0.50	< 0.50	< 5.0	< 0.50	< 0.50
	12/18/14	< 50	---	< 0.50	< 0.50	< 0.50	< 0.50	< 0.50	< 5.0	< 0.50	< 0.50
	<b>3/31/15</b>	<b>&lt; 50</b>	<b>—</b>	<b>&lt; 0.50</b>	<b>&lt; 0.50</b>	<b>&lt; 0.50</b>	<b>&lt; 0.50</b>	<b>&lt; 0.50</b>	<b>&lt; 2.0</b>	<b>&lt; 0.50</b>	<b>&lt; 0.50</b>

**TABLE TWO**  
Summary of Analytical Results for **GROUNDWATER** Samples  
**Albany Hill Mini Mart**  
800 San Pablo Avenue, Albany, CA  
All results are in **parts per billion (ppb)**

Well ID or Sample Point	Date Sampled	TPH Gasoline	TPH Diesel	Benzene	Toluene	Ethyl-benzene	Total Xylenes	TAME	TBA	MTBE	Other VOCs
MW-3	8/6/99	ND	ND	ND	ND	ND	ND	--	--	ND	--
	11/5/99	92	54	ND	ND	0.6	1.7	--	--	ND	--
	2/7/00	120	71	ND	0.6	0.8	2.2	--	--	ND	--
	5/7/00	100	68	ND	ND	0.7	1.9	--	--	ND	--
	8/3/00	910	300*	220	9.0	35	16	--	--	11,000**	--
	11/8/00	990	200	320	0.8	18	9	--	--	8,000	--
	2/8/01	990	110	180	21.0	7	24	--	--	5,200**	--
	6/7/01	370	140	62	4.0	8	13	--	--	6,600**	--
	9/7/01	460	ND	87	1.0	11	25	--	--	9,400**	--
	12/13/01	251	ND	66.8	0.9	2.6	8.4	--	--	6,610	--
	6/13/02	3,630	< 50	41	60.0	41	187	--	--	8,820**	--
	11/11/02	6,210	< 50	150	< 1	5	< 3	--	--	7,770	--
	2/14/03	176	< 50	31	< 1	2	< 3	--	--	5,040	--
	9/10/04	< 1,000	140	110	< 10	< 10	21	20	200	4,400	< 10
	12/7/04	1,000	150	310	19.0	24	50	21	< 100	4,000	< 10
	4/18/05	750	150	170	16.0	33	36	6.1	< 50	1,700	< 5.0
	6/20/05	680	120	140	9.7	20	38	7.4	< 20	1,900	< 4.0
	10/7/05	630	160	140	10.0	11	34	9.2	< 20	2,000	< 4.0
	12/7/05	550	200	128	6.4	7.2	10	11	56	2,400	< 4.0
	3/6/06	88	36	< 2.0	5.3	2.1	4.2	13	1,000	1,000	< 2.0
	6/27/06	7,400	< 1,500	2,800	12	190	56	9.8	110	760	< 4.0
	8/24/06	< 400	130	24	< 4.0	< 4.0	14	9.0	40	2,800	< 4.0
	11/20/06	< 400	< 50	42	< 4.0	4.4	8.7	7.3	71	1,700	< 4.0
	2/5/07	440	< 50	110	4.2	< 4.0	16	7.3	39	1,600	< 4.0
	5/25/07	240	< 50	52	4.3	4.3	18	4.3	140	1,100	< 2.0
	8/3/07	500	< 50	190	7.2	12	40	4.4	320	860	< 1.5
	12/5/07	< 150	< 50	< 1.5	< 1.5	< 1.5	< 1.5	5.1	280	1,200	< 1.5
	2/25/08	< 200	< 50	< 2.0	< 2.0	< 2.0	< 2.0	5.0	13	1,300	< 2.0
	5/20/08	< 50	< 50	2.5	< 0.50	< 0.50	< 0.50	< 0.50	6.7	200	0.54 DIPE
	8/22/08	< 50	< 50	1.5	< 0.50	< 0.50	< 0.50	0.64	6.9	380	< 0.50
	12/10/08	< 50	< 50	< 0.50	< 0.50	< 0.50	< 0.50	< 0.50	< 5.0	7.2	< 0.50
	3/20/09	< 50	< 50	0.61	< 0.50	< 0.50	< 0.50	< 0.50	7.7	14	< 0.50
	6/4/09	< 50	< 50	< 0.50	< 0.50	< 0.50	< 0.50	< 0.50	< 0.50	4.0	< 0.50
	12/3/09	< 50	< 50	< 0.50	< 0.50	< 0.50	< 0.50	< 0.50	< 5.0	< 0.50	< 0.50
	5/19/10	< 50	< 50	< 0.50	< 0.50	< 0.50	< 0.50	< 0.50	< 5.0	26	< 0.50
	12/21/10	< 50	< 50	< 0.50	< 0.50	< 0.50	< 0.50	< 0.50	< 5.0	< 0.50	< 0.50
	6/29/11	< 50	< 50	< 0.50	< 0.50	< 0.50	< 0.50	< 0.50	< 5.0	2.9	< 0.50
	12/13/11	< 50	< 50	< 0.50	< 0.50	< 0.50	< 0.50	< 0.50	< 5.0	< 0.50	< 0.50
	9/12/12	< 50	---	< 0.50	< 0.50	< 0.50	< 0.50	< 0.50	< 5.0	< 0.50	< 0.50
	3/30/13	< 50	---	< 0.50	< 0.50	< 0.50	< 0.50	< 0.50	< 5.0	< 0.50	< 0.50
	9/30/13	< 50	< 50	< 0.50	< 0.50	< 0.50	< 0.50	< 0.50	< 5.0	< 0.50	< 0.50
	3/31/14	< 50	---	< 0.50	< 0.50	< 0.50	< 0.50	< 0.50	< 5.0	< 0.50	< 0.50
	12/18/14	< 50	---	< 0.50	< 0.50	< 0.50	< 0.50	< 0.50	< 5.0	< 0.50	< 0.50
	<b>3/31/15</b>	<b>&lt; 50</b>	<b>---</b>	<b>&lt; 0.50</b>	<b>&lt; 0.50</b>	<b>&lt; 0.50</b>	<b>&lt; 0.50</b>	<b>&lt; 0.50</b>	<b>&lt; 2.0</b>	<b>&lt; 0.50</b>	<b>&lt; 0.50</b>

**TABLE TWO**  
Summary of Analytical Results for **GROUNDWATER** Samples  
**Albany Hill Mini Mart**  
800 San Pablo Avenue, Albany, CA  
All results are in **parts per billion (ppb)**

Well ID or Sample Point	Date Sampled	TPH Gasoline	TPH Diesel	Benzene	Toluene	Ethyl-benzene	Total Xylenes	TAME	TBA	MTBE	Other VOCs
MW-4	6/13/02	4,460	1,500*	425	409.0	115	730	--	--	32	--
	11/11/02	5,150	2,380*	2,010	74.0	399	252	--	--	< 20	--
	2/14/03	6,360	2,410*	1,560	82.0	274	573	--	--	< 1	--
	9/10/04	1,600	180	370	6.5	68	93	< 1.0	10	13	1.1 (DIPE)
	12/7/04	1,900	< 200	450	8.2	72	100	< 0.9	5.4	9.5	< 0.9
	4/18/05	10,000	< 800	1,500	27.0	420	900	< 1.5	15	18	< 1.5
	6/20/05	6,100	< 600	830	19.0	280	400	< 1.5	17	22	< 1.5
	10/7/05	3,200	< 500	660	8.7	110	140	< 1.5	12	14	< 1.5
	12/7/05	1,000	< 200	220	2.5	48	37	< 0.5	< 5.0	12	< 0.5
	3/6/06	1,200	< 300	280	2.1	32	77	0.65	< 0.50	75	1.0 (DIPE) / 0.57(1,2-DCA)
	6/27/06	2,000	< 300	570	4.0	110	120	< 0.90	15	110	1.2(DIPE)
	8/24/06	2,500	< 300	830	6.5	120	120	< 0.90	18	95	< 0.90
	11/20/06	1,900	< 80	590	4.8	37	29	< 1.5	< 1.5	14	< 1.5
	2/5/07	2,700	< 80	970	4.4	53	62	< 1.5	< 12	45	< 1.5
	5/7/07	2,900	< 200	1,200	5.0	89	95	< 1.5	18	34	< 1.5
	8/3/07	1,800	< 200	610	3.4	36	25	0.62	9.3	25	1.4 DIPE
	12/5/07	1,300	< 200	530	3.4	3.4	20	< 0.90	6.0	32	0.98 DIPE
	2/25/08	800	< 50	180	6.0	15	35	< 0.50	30	44	0.76 DIPE
	5/20/08	560	< 50	130	3.6	5.7	14	< 0.50	21	34	0.85 DIPE
	8/22/08	110	< 50	7.3	< 0.50	< 0.50	0.79	< 0.50	12	28	1.0 DIPE
	12/10/08	190	< 50	38	0.53	2.7	1.8	< 0.50	6.6	20	0.76 DIPE
	3/20/09	86	< 50	8.7	< 0.50	1.1	3.6	< 0.50	< 5.0	14	0.73 DIPE
	6/4/09	160	< 50	28	< 0.50	1.5	1.9	< 0.50	< 5.0	12	0.72 DIPE
	12/3/09	280	< 50	46	0.61	0.93	1.9	< 0.50	< 5.0	12	0.65 DIPE
	5/19/10	200	< 50	20	< 0.50	< 0.50	< 0.50	< 0.50	9.3	13	0.94 DIPE
	12/21/10	200	< 50	32	< 0.50	1.1	3.3	< 0.50	< 5.0	9.5	0.64 DIPE
	6/29/11	120	< 50	13	< 0.50	< 0.50	< 0.50	< 0.50	6.7	9.8	0.85 DIPE
	12/13/11	520	< 80	92	0.96	1.1	1.7	< 0.50	7.8	14	1.1 DIPE
	9/12/12	350	---	51	0.76	0.94	2.0	< 0.50	< 5.0	9.8	0.76 DIPE
	3/30/13	86	---	7.3	< 0.50	< 0.50	< 0.50	< 0.50	< 5.0	8.1	0.55 DIPE
	9/30/13	130	< 50	17	< 0.50	< 0.50	< 0.50	< 0.50	< 5.0	8.8	0.63 DIPE
	3/31/14	53	---	3.5	< 0.50	< 0.50	< 0.50	< 0.50	< 5.0	0.55	< 0.50
	12/18/14				Not Sampled - Car Parked Over Well						
<b>3/31/15</b>		<b>170</b>	<b>—</b>	<b>25</b>	<b>&lt; 1.2</b>	<b>&lt; 1.2</b>	<b>&lt; 1.2</b>	<b>&lt; 1.2</b>	<b>&lt; 5.0</b>	<b>5.8</b>	<b>&lt; 1.2</b>

**TABLE TWO**  
Summary of Analytical Results for **GROUNDWATER** Samples  
**Albany Hill Mini Mart**  
800 San Pablo Avenue, Albany, CA  
All results are in **parts per billion (ppb)**

Well ID or Sample Point	Date Sampled	TPH Gasoline	TPH Diesel	Benzene	Toluene	Ethyl-benzene	Total Xylenes	TAME	TBA	MTBE	Other VOCs	
MW-5	6/13/02	536	< 50	6.4	0.6	22	23	--	--	11	--	
	11/11/02	3,270	1,230*	< 1	< 1	28	8	--	--	< 1	--	
	2/14/03	1,260	610*	9	7.0	22	5	--	--	< 1	--	
	9/10/04	1,300	150	2.4	< 0.50	0.77	< 0.50	< 0.50	< 5.0	< 0.50	< 0.50	
	12/7/04	1,000	< 200	4.1	< 0.50	1.4	< 0.50	< 0.50	< 5.0	< 0.50	< 0.50	
	4/18/05			Improperly Destroyed by City of Albany During Street Improvements								
MW-5R	10/7/05	760	<800	2	< 0.50	8.3	1.2	< 0.50	< 5.0	< 0.50	< 0.50	
	12/7/05	5,200	< 2,000	36	1.0	320	15	< 0.50	< 5.0	< 0.50	< 0.50	
	3/6/06	6,300	< 3,000	44	1.2	370	19	< 0.90	5.9	< 0.90	< 0.90	
	6/27/06	5,100	< 2,000	53	1.3	370	17	< 0.50	5.6	< 0.50	< 0.50	
	8/24/06	6,500	< 2,000	80	1.8	510	18	< 0.90	9.9	< 0.90	< 0.90	
	11/20/06	5,400	< 600	160	2.4	370	100	< 0.90	10	81	< 0.90	
	2/5/07	6,300	< 1,500	69	3.2	480	31	< 0.80	10	< 0.80	< 0.80	
	5/7/07	5,600	< 500	61	2.4	510	19	< 0.90	11	< 0.90	< 0.90	
	8/3/07	170	< 50	3.7	< 0.50	< 0.50	< 0.50	1.4	9.2	330	< 0.50	
	12/5/07	4,500	< 800	32	1.3	240	10	< 0.50	< 5.0	< 0.50	< 0.50	
	2/25/08	6,000	< 600	41	1.7	310	13	< 0.50	5.6	< 0.50	< 0.50	
	5/20/08	220	< 50	2.4	< 0.50	< 0.50	< 0.50	< 0.50	< 5.0	37	< 0.50	
	8/22/08	91	< 50	< 0.50	< 0.50	< 0.50	< 0.50	0.57	< 5.0	100	< 0.50	
	12/10/08	140	< 50	< 0.50	< 0.50	< 0.50	< 0.50	< 0.50	< 5.0	41	< 0.50	
	3/20/09	< 50	< 50	< 0.50	< 0.50	< 0.50	< 0.50	< 0.50	< 5.0	8.8	< 0.50	
	6/4/09	4,300	<800	35	2.2	130	5.7	< 0.50	< 5.0	6.9	< 0.50	
	12/3/09	55	< 50	< 0.50	< 0.50	< 0.50	< 0.50	< 0.50	< 5.0	13	< 0.50	
	5/19/10	< 50	< 50	< 0.50	< 0.50	< 0.50	< 0.50	< 0.50	< 5.0	2.2	< 0.50	
	12/21/10	2,700	< 50	16	1.4	29	1.6	< 0.50	< 5.0	< 0.50	< 0.50	
	6/29/11	1,900	< 300	12	1.1	6.0	0.85	< 0.50	< 5.0	< 0.50	< 0.50	
	12/13/11	3,200	< 400	15	1.2	10	1.3	< 0.50	< 5.0	< 0.50	< 0.50	
9/12/12	3,400	---	23	1.7	2.8	1.4	< 0.50	< 5.0	< 0.50	< 0.50		
3/30/13	2,200	---	5.7	0.85	4.2	0.62	< 0.50	< 5.0	< 0.50	< 0.50		
9/30/13	2,000	< 50	13	0.97	5.1	0.82	< 0.50	< 5.0	< 0.50	< 0.50		
3/31/14	3,200	---	22	1.4	12	1.2	< 0.50	< 5.0	< 0.50	< 0.50		
12/18/14	3,000	---	19	1.5	18	1.3	< 0.50	< 5.0	< 0.50	< 0.50		
<b>3/31/15</b>	<b>1,900</b>	<b>---</b>	<b>10</b>	<b>0.86</b>	<b>2.1</b>	<b>1.0</b>	<b>&lt; 0.50</b>	<b>&lt; 2.0</b>	<b>&lt; 0.50</b>	<b>&lt; 0.50</b>		

**TABLE TWO**  
Summary of Analytical Results for **GROUNDWATER** Samples  
**Albany Hill Mini Mart**  
800 San Pablo Avenue, Albany, CA  
All results are in **parts per billion (ppb)**

Well ID or Sample Point	Date Sampled	TPH Gasoline	TPH Diesel	Benzene	Toluene	Ethyl-benzene	Total Xylenes	TAME	TBA	MTBE	Other VOCs
MW-6	6/13/02	2,980	1,460*	31	2.3	3.8	12	--	--	310	--
	11/11/02	3,570	1,210*	336	5	< 5	< 15	--	--	95	--
	2/14/03	3,770	1,620*	429	12	7	10	--	--	122	--
	9/10/04	< 1,000	390	2.7	< 0.50	< 0.50	< 0.50	2.3	48	280	< 0.50
	12/7/04	1,800	< 600	32	1.7	< 0.50	1.1	2.2	49	160	< 0.50
	4/18/05	1,200	1,400	34	1.3	< 0.50	0.90	0.86	19	36	< 0.50
	6/20/05	590	1,300	3.3	< 0.50	< 0.50	< 0.50	< 0.50	5.5	8.5	< 0.50
	10/7/05	470	1,300	6.8	< 0.50	< 0.50	< 0.50	0.67	20	82	< 0.50
	12/7/05	420	910	10	< 0.50	< 0.50	< 0.50	< 0.50	7.3	22	< 0.50
	3/6/06	790	590	3.2	< 0.50	< 0.50	< 0.50	< 0.50	< 0.50	4.3	< 0.50
	6/27/06	2,600	980	100	4.0	0.96	2.2	1.0	49	78	< 0.50
	8/24/06	1,200	960	57	2.3	< 0.50	1.1	0.82	34	64	< 0.50
	11/20/06	1,300	< 200	58	1.7	< 0.50	1.3	< 0.50	18	26	< 0.50
	2/5/07	1,200	< 200	49	1.8	< 0.50	1.6	0.90	45	67	< 0.50
	5/7/07	290	< 50	3.1	< 0.50	< 0.50	< 0.50	< 0.50	< 0.50	5.0	< 0.50
	8/3/07	580	< 80	23	1.0	< 0.50	< 0.50	0.57	34	45	< 0.50
	12/5/07	870	< 800	2.8	< 0.50	< 0.50	< 0.50	0.58	20	54	< 0.50
	2/25/08	1,400	< 500	16	0.73	< 0.50	9.6	< 0.50	19	77	< 0.50
	5/20/08	1,600	< 200	42	2.0	< 0.50	1.1	0.72	59	58	< 0.50
	8/22/08	520	< 300	3.2	< 0.50	< 0.50	< 0.50	0.62	47	70	< 0.50
	12/10/08	1,000	< 6,000	0.53	< 0.50	< 0.50	< 0.50	< 0.50	24	21	< 0.50
	3/20/09	700	< 500	< 0.50	< 0.50	< 0.50	< 0.50	< 0.50	< 5.0	2.9	< 0.50
	6/4/09	160	< 1, 500	< 0.50	< 0.50	< 0.50	< 0.50	< 0.50	10	18	< 0.50
	12/3/09	750	< 1, 500	< 0.50	< 0.50	< 0.50	< 0.50	< 0.50	< 5.0	4.4	< 0.50
	5/19/10	210	< 200	< 0.50	< 0.50	< 0.50	< 0.50	< 0.50	< 5.0	2.8	< 0.50
	12/21/10	130	< 400	< 0.50	< 0.50	< 0.50	< 0.50	< 0.50	< 5.0	< 0.50	< 0.50
	6/29/11	390	< 200	< 0.50	< 0.50	< 0.50	< 0.50	< 0.50	< 5.0	0.5	< 0.50
	12/13/11	94	< 100	< 0.50	< 0.50	< 0.50	< 0.50	< 0.50	< 5.0	18	< 0.50
	9/12/12	270	---	< 0.50	< 0.50	< 0.50	< 0.50	< 0.50	< 5.0	13	< 0.50
	3/30/13	< 50	---	< 0.50	< 0.50	< 0.50	< 0.50	< 0.50	< 5.0	< 0.50	< 0.50
	9/30/13	300	850*	< 0.50	< 0.50	< 0.50	< 0.50	< 0.50	< 5.0	< 0.50	< 0.50
	3/31/14	< 50	---	< 0.50	< 0.50	< 0.50	< 0.50	< 0.50	< 5.0	< 0.50	< 0.50
	12/18/14	< 50	---	< 0.50	< 0.50	< 0.50	< 0.50	< 0.50	< 5.0	< 0.50	< 0.50
	<b>3/31/15</b>	<b>&lt; 50</b>	<b>---</b>	<b>&lt; 0.50</b>	<b>&lt; 0.50</b>	<b>&lt; 0.50</b>	<b>&lt; 0.50</b>	<b>&lt; 0.50</b>	<b>&lt; 2.0</b>	<b>5.8</b>	<b>&lt; 0.50</b>

**TABLE TWO**  
Summary of Analytical Results for **GROUNDWATER** Samples  
**Albany Hill Mini Mart**  
800 San Pablo Avenue, Albany, CA  
All results are in **parts per billion (ppb)**

Well ID or Sample Point	Date Sampled	TPH Gasoline	TPH Diesel	Benzene	Toluene	Ethyl-benzene	Total Xylenes	TAME	TBA	MTBE	Other VOCs	
MW-7	6/13/02	24,100	1,570*	2,310	657	945	5,430	--	--	951	--	
	11/11/02	4,760	2,160*	1,820	21	316	1,141	--	--	702	--	
	2/14/03	4,320	2,380*	1,020	7	223	293	--	--	1,410	--	
	9/10/04	4,800	< 300	640	16	250	490	< 1.5	31	590	< 1.5	
	12/7/04	990	< 300	140	3.4	49	70	4.0	< 20	960	< 2.0	
	4/18/05	1,400	< 300	260	1.3	96	16	< 1.0	20	370	< 1.0	
	6/20/05	1,900	< 200	320	1.0	130	24	< 0.50	17	370	< 0.50	
	10/7/05	2,600	<800	190	4.7	91	200	<0.73	8.0J	310	< 0.50	
	12/7/05						Not sampled.	Inaccessable				
	3/6/06	640	< 200	85	0.88	24	30	< 0.50	8.0	150	< 0.50	
	6/27/06	1,200	< 200	180	1.7	64	64	< 0.50	14	150	< 0.50	
	8/24/06	990	< 200	120	0.96	36	51	< 0.50	13	180	< 0.50	
	11/20/06	1,600	< 200	200	1.6	59	160	< 0.50	5.2	180	< 0.50	
	2/5/07	2,300	< 200	390	2.6	120	140	< 0.50	15	190	< 0.50	
	5/7/07	490	< 80	190	0.61	9.3	3.2	0.55	16	200	< 0.50	
	8/3/07	2,100	< 200	390	2.4	94	73	0.61	19	220	0.51 DIPE	
	12/5/07	140	< 50	7.2	0.67	3.0	18	0.98	150	180	< 0.50	
	2/25/08	< 50	< 50	0.98	< 0.50	0.69	2.4	< 0.50	< 5.0	100	< 0.50	
	5/20/08	< 50	< 50	< 0.50	< 0.50	< 0.50	< 0.50	< 0.50	< 5.0	1.3	< 0.50	
	8/22/08	< 50	< 50	< 0.50	< 0.50	< 0.50	< 0.50	< 0.50	< 5.0	< 0.50	< 0.50	
	12/10/08	< 50	< 50	< 0.50	< 0.50	< 0.50	< 0.50	< 0.50	< 5.0	< 0.50	< 0.50	
	3/20/09	< 50	< 50	< 0.50	< 0.50	< 0.50	< 0.50	< 0.50	< 5.0	< 0.50	< 0.50	
	6/4/09	< 50	< 50	< 0.50	< 0.50	< 0.50	< 0.50	< 0.50	< 5.0	< 0.50	< 0.50	
	12/3/09	< 50	< 50	< 0.50	< 0.50	< 0.50	< 0.50	< 0.50	< 5.0	< 0.50	< 0.50	
	5/19/10	< 50	< 50	< 0.50	< 0.50	< 0.50	< 0.50	< 0.50	< 5.0	0.55	< 0.50	
	12/21/10	< 50	< 50	< 0.50	< 0.50	< 0.50	< 0.50	< 0.50	< 5.0	< 0.50	< 0.50	
	6/29/11	180	< 80	< 0.50	< 0.50	2.8	14	< 0.50	< 5.0	< 0.50	< 0.50	
	12/13/11	< 50	< 50	< 0.50	< 0.50	< 0.50	< 0.50	< 0.50	< 5.0	< 0.50	< 0.50	
	9/12/12	< 50	---	< 0.50	< 0.50	< 0.50	< 0.50	< 0.50	< 5.0	< 0.50	< 0.50	
	3/30/13	< 50	---	< 0.50	< 0.50	< 0.50	< 0.50	< 0.50	< 5.0	< 0.50	< 0.50	
	9/30/13	< 50	< 50	< 0.50	< 0.50	< 0.50	< 0.50	< 0.50	< 5.0	< 0.50	< 0.50	
3/31/14	< 50	---	< 0.50	< 0.50	< 0.50	< 0.50	< 0.50	< 5.0	< 0.50	< 0.50		
12/18/14	< 50	---	< 0.50	< 0.50	< 0.50	< 0.50	< 0.50	< 5.0	< 0.50	< 0.50		
<b>3/31/15</b>	<b>&lt; 50</b>	<b>---</b>	<b>&lt; 0.50</b>	<b>&lt; 0.50</b>	<b>&lt; 0.50</b>	<b>&lt; 0.50</b>	<b>&lt; 0.50</b>	<b>&lt; 0.50</b>	<b>&lt; 2.0</b>	<b>&lt; 0.50</b>	<b>&lt; 0.50</b>	

**TABLE TWO**  
Summary of Analytical Results for **GROUNDWATER** Samples  
**Albany Hill Mini Mart**  
800 San Pablo Avenue, Albany, CA  
All results are in **parts per billion (ppb)**

Well ID or Sample Point	Date Sampled	TPH Gasoline	TPH Diesel	Benzene	Toluene	Ethyl-benzene	Total Xylenes	TAME	TBA	MTBE	Other VOCs	
MW-8	6/13/02	20,000	7,760*	2,200	1,140	1,050	4,090	--	--	12,000	--	
	11/11/02	5,010	2,010*	187	< 1	15	< 3	--	--	16,600	--	
	2/14/03	1,980	< 50	607	6	113	40	--	--	11,500	--	
	9/10/04	< 2,000	200	110	< 20	26	49	25	< 200	8,600	< 20	
	12/7/04	2,000	280	420	< 10	40	61	31	100	6,800	< 10	
	4/18/05	< 1000	250	76	< 10	23	< 10	17	< 100	3,700	< 10	
	6/20/05	1,300	300	190	< 7.0	21	40	19	< 40	3,400	< 7.0	
	10/7/05	<700	200	85	< 7.0	9.3	8.3	23	< 40	4,400	< 7.0	
	12/7/05	1,400	300	250	8.7	41	90	18	< 40	4,400	< 7.0	
	3/6/06						Not sampled. Inaccessible					
	6/27/06	710	250	100	< 5.0	7.8	26	16	30	3,100	< 5.0	
	8/24/06	540	260	74	< 5.0	5.4	45	15	< 25	2,700	< 5.0	
	11/20/06	2,100	< 100	380	4.4	18	170	10	530	1,900	< 4.0	
	2/5/07	1,700	< 100	560	3.9	7.5	80	2.7	970	630	< 1.0	
	5/7/07	510	< 50	170	0.61	2.1	5.4	0.57	460	110	< 0.50	
	8/3/07	840	< 80	240	1.6	7.0	18	< 0.50	100	100	< 0.50	
	12/5/07	1,400	< 300	9.2	3.9	36	310	1.5	210	370	< 0.50	
	2/25/08	< 50	< 50	< 0.50	< 0.50	< 0.50	< 0.50	< 0.50	< 0.50	130	< 0.50	
	5/20/08	< 50	< 50	< 0.50	< 0.50	< 0.50	1.5	< 0.50	< 0.50	6.1	< 0.50	
	8/22/08	< 50	< 50	< 0.50	< 0.50	< 0.50	< 0.50	< 0.50	< 0.50	< 0.50	< 0.50	
	12/10/08	< 50	< 50	< 0.50	< 0.50	< 0.50	< 0.50	< 0.50	< 0.50	< 0.50	< 0.50	
	3/20/09	< 50	< 50	< 0.50	< 0.50	< 0.50	< 0.50	< 0.50	< 0.50	< 0.50	< 0.50	
	6/4/09	< 50	< 50	< 0.50	< 0.50	< 0.50	< 0.50	< 0.50	< 0.50	< 0.50	< 0.50	
	12/3/09	< 50	< 50	< 0.50	< 0.50	< 0.50	< 0.50	< 0.50	< 0.50	< 0.50	< 0.50	
	5/19/10	< 50	< 50	< 0.50	< 0.50	< 0.50	< 0.50	< 0.50	< 0.50	< 0.50	< 0.50	
	12/21/10	< 50	< 50	< 0.50	< 0.50	< 0.50	< 0.50	< 0.50	< 0.50	< 0.50	< 0.50	
	6/29/11	< 50	< 50	< 0.50	< 0.50	< 0.50	< 0.50	< 0.50	< 0.50	< 0.50	< 0.50	
	12/13/11	< 50	< 50	< 0.50	< 0.50	< 0.50	< 0.50	< 0.50	< 0.50	< 0.50	< 0.50	
	9/12/12	< 50	---	< 0.50	< 0.50	< 0.50	< 0.50	< 0.50	< 0.50	< 0.50	< 0.50	
	3/30/13	< 50	---	< 0.50	< 0.50	< 0.50	< 0.50	< 0.50	< 0.50	< 0.50	< 0.50	
	9/30/13	< 50	< 50	< 0.50	< 0.50	< 0.50	< 0.50	< 0.50	< 0.50	< 0.50	< 0.50	
	3/31/14	< 50	---	< 0.50	< 0.50	< 0.50	< 0.50	< 0.50	< 0.50	< 0.50	< 0.50	
12/18/14	< 50	---	< 0.50	< 0.50	< 0.50	< 0.50	< 0.50	< 0.50	< 0.50	< 0.50		
<b>3/31/15</b>	<b>&lt; 50</b>	<b>---</b>	<b>&lt; 0.50</b>	<b>&lt; 0.50</b>	<b>&lt; 0.50</b>	<b>&lt; 0.50</b>	<b>&lt; 0.50</b>	<b>&lt; 0.50</b>	<b>&lt; 2.0</b>	<b>&lt; 0.50</b>	<b>&lt; 0.50</b>	



**TABLE TWO**  
 Summary of Analytical Results for **GROUNDWATER** Samples  
**Albany Hill Mini Mart**  
 800 San Pablo Avenue, Albany, CA  
 All results are in **parts per billion (ppb)**

Well ID or Sample Point	Date Sampled	TPH Gasoline	TPH Diesel	Benzene	Toluene	Ethyl-benzene	Total Xylenes	TAME	TBA	MTBE	Other VOCs
MW-9	6/27/02	19,000	--	1,430	1,750	501	5,410	--	--	< 0.5	--
	11/11/02	19,000	13,200*	3,390	4,540	1,020	9,050	--	--	549	--
	2/14/03	21,300	8,200*	1,700	2,200	701	4,970	--	--	< 1	--
	9/10/04	12,000	< 1,500	890	37	280	2,000	< 5.0	< 5.0	< 5.0	< 5.0
	12/7/04	13,000	< 1,500	950	580	480	2,900	< 5.0	< 5.0	< 5.0	< 5.0
	4/18/05	9,600	< 1,000	620	180	260	1,400	< 2.5	< 25	< 2.5	< 2.5
	6/20/05	9,800	< 1,500	760	260	430	1,400	< 2.0	< 9.0	< 2.0	< 2.0
	10/7/05	3,400	<1000	350	170	100	480	< 0.50	<5.0	< 0.50	< 0.50
	12/7/05	5,600	< 1000	320	97	200	580	< 0.90	<5.0	< 0.50	< 0.50
	3/6/06	4,200	< 800	460	120	97	600	< 0.90	< 5.0	< 0.90	< 0.50
	6/27/06	8,100	< 1,000	710	330	390	1,700	< 0.50	< 5.0	< 2.0	< 0.50
	8/24/06	6,100	< 800	550	220	280	1,200	< 2.0	< 9.0	< 2.0	< 2.0
	11/20/06	5,200	< 400	310	98	130	850	< 1.0	< 5.0	< 1.0	< 1.0
	2/5/07	4,500	< 400	370	120	190	720	< 1.0	< 5.0	< 1.0	< 1.0
	5/7/07	6,400	< 300	700	220	380	1,200	< 1.0	< 5.0	< 1.0	< 1.0
	8/3/07	5,300	< 300	380	140	290	830	< 0.90	< 5.0	< 0.90	< 0.90
	12/5/07	4,100	< 300	250	84	130	990	< 1.0	< 5.0	< 1.0	< 1.0
	2/25/08	2,600	< 300	250	20	120	290	< 0.50	< 5.0	< 0.50	< 0.50
	5/20/08	3,000	< 200	320	39	170	390	< 0.50	< 5.0	0.51	< 0.50
	8/22/08	3,700	< 600	220	68	190	610	< 0.50	< 5.0	0.72	< 0.50
	12/10/08	4,100	< 300	240	80	250	840	< 0.50	< 5.0	< 0.50	< 0.50
	3/20/09	1,800	< 200	170	22	81	250	< 0.50	< 5.0	< 0.50	< 0.50
	6/4/09	2,600	< 200	260	35	110	410	< 0.50	< 5.0	< 0.50	< 0.50
	12/3/09	5,200	< 300	260	63	320	970	< 0.50	< 5.0	< 0.50	< 0.50
	5/19/10	3,000	< 300	190	23	120	490	< 0.90	< 5.0	< 0.90	< 0.90
	12/21/10	4,900	< 300	200	35	260	1,000	< 0.90	< 5.0	< 0.90	< 0.90
	6/29/11	3,400	< 300	140	20	160	800	< 0.90	< 5.0	< 0.90	< 0.90
	12/13/11	7,300	< 400	170	32	340	1,600	< 0.50	< 5.0	< 0.50	< 0.50
	9/12/12	5,400	---	76	16	210	750	< 0.90	5.0	< 0.90	< 0.90
	3/30/13	3,400	---	46	8.2	130	500	< 0.50	< 5.0	< 0.50	< 0.50
	9/30/13	4,200	< 50	69	12	170	630	< 0.50	< 5.0	< 0.50	< 0.50
	3/31/14	3,700	---	63	8.0	140	480	< 0.50	< 5.0	< 0.50	< 0.50
	12/18/14	3,100	---	45	6.3	120	420	< 0.50	< 5.0	< 0.50	< 0.50
	<b>3/31/15</b>	<b>970</b>	<b>—</b>	<b>36</b>	<b>3.0</b>	<b>67</b>	<b>270</b>	<b>&lt; 0.50</b>	<b>&lt; 5.0</b>	<b>&lt; 0.50</b>	<b>47 Naphthalene</b>

**TABLE TWO**  
 Summary of Analytical Results for **GROUNDWATER** Samples  
**Albany Hill Mini Mart**  
 800 San Pablo Avenue, Albany, CA  
 All results are in **parts per billion (ppb)**

Well ID or Sample Point	Date Sampled	TPH Gasoline	TPH Diesel	Benzene	Toluene	Ethyl-benzene	Total Xylenes	TAME	TBA	MTBE	Other VOCs
<b>MW-10</b>	10/7/05	470	330	17	<0.50	2	11	1.2	9.4J	210	<0.50
	12/7/05					Not sampled. Inaccessible					
	3/6/06	130	130	4.2	< 0.50	< 0.50	< 0.50	4.9	13	820	0.55 (DIPE)
	6/27/06	< 400	140	4.4	< 0.50	< 0.50	< 0.50	8.9	21	1,300	0.60 (DIPE)
	8/24/06	< 400	140	< 4.0	< 4.0	< 4.0	< 4.0	7.0	< 20	1,400	< 4.0
	11/20/06	< 150	< 50	2.5	< 1.5	< 1.5	< 1.5	3.3	10	750	< 1.5
	2/5/07	170	< 50	3.0	< 0.90	< 0.90	< 0.90	2.4	6.5	440	< 0.90
	5/7/07	96	< 50	2.3	< 0.50	< 0.50	< 0.50	0.83	< 5.0	180	< 0.50
	8/3/07	5,000	< 1,000	67	2.3	410	14	< 0.50	6.7	< 0.50	< 0.50
	12/5/07	310	< 50	1.2	< 0.50	< 0.50	< 0.50	< 0.50	< 5.0	< 0.50	< 0.50
	2/25/08	240	240	5.3	< 0.50	< 0.50	< 0.50	< 0.50	9.3	57	< 0.50
	5/20/08	3,400	< 500	23	1.2	120	5.9	< 0.50	< 5.0	< 0.50	< 0.50
	8/22/08	1,900	< 500	22	0.89	3.8	2.1	< 0.50	5.1	< 0.50	< 0.50
	12/10/08	3,500	< 500	40	2.0	190	7.8	< 0.50	< 5.0	< 0.50	< 0.50
	3/20/09	4,100	< 600	40	1.7	150	5.8	< 0.50	5.9	< 0.50	< 0.50
	6/4/09	< 50	< 50	< 0.50	< 0.50	< 0.50	< 0.50	< 0.50	34	< 0.50	< 0.50
	12/3/09	4,500	< 800	36	2.5	140	4.3	< 0.50	< 5.0	< 0.50	< 0.50
	5/19/10	3,600	< 600	19	2.3	120	3.3	< 0.50	< 5.0	< 0.50	< 0.50
	12/21/10	< 50	< 50	< 0.50	< 0.50	< 0.50	< 0.50	< 0.50	< 5.0	7.2	< 0.50
	6/29/11	< 50	< 50	< 0.50	< 0.50	< 0.50	< 0.50	< 0.50	< 5.0	2.0	< 0.50
	12/13/11	< 50	< 50	< 0.50	< 0.50	< 0.50	< 0.50	< 0.50	< 5.0	3.5	< 0.50
	9/12/12	< 50	---	< 0.50	< 0.50	< 0.50	< 0.50	< 0.50	< 5.0	2.6	< 0.50
	3/30/13	< 50	---	< 0.50	< 0.50	< 0.50	< 0.50	< 0.50	< 5.0	0.67	< 0.50
9/30/13	< 50	< 50	< 0.50	< 0.50	< 0.50	< 0.50	< 0.50	< 5.0	1.4	< 0.50	
3/31/14	120	---	< 0.50	< 0.50	< 0.50	< 0.50	< 0.50	< 5.0	1.5	< 0.50	
12/18/14	280	---	< 0.50	< 0.50	< 0.50	< 0.50	< 0.50	< 5.0	2.2	< 0.50	
<b>3/31/15</b>	<b>130</b>	<b>---</b>	<b>&lt; 0.50</b>	<b>&lt; 0.50</b>	<b>&lt; 0.50</b>	<b>&lt; 0.50</b>	<b>&lt; 0.50</b>	<b>&lt; 0.50</b>	<b>&lt; 2.0</b>	<b>1.5</b>	<b>&lt; 0.50</b>
<b>ESL</b>		100	100	1.0	40	30	20	NE	12	5.0	Varies

Notes:

Data prior to August 2004 is based on a table compiled by AARS - ASE has not checked results against original laboratory reports.

\* Does not match diesel pattern

\*\* Confirmed by GC/MS method 8260

ESL = Environmental screening levels presented in the "Screening For Environmental Concerns at Sites With Contaminated Soil and Groundwater (May 2008)" document prepared by the California Regional Water Quality Control Board, San Francisco Bay Region for sites where groundwater is a current or potential source of

Most recent concentrations are in **Bold**.

Non-detectable concentrations noted by the less than sign (<) followed by the laboratory detection limit.

NE indicates that no ESL has been established for this compound.



Aqua Science Engineers, Inc. 55 Oak Court, Suite 220, Danville, CA 94526  
(925) 820-9391 - Fax (925) 837-4853 - [www.aquascienceengineers.com](http://www.aquascienceengineers.com)

## **APPENDIX A**

### **Well Sampling Field Logs**

# AQUA SCIENCE ENGINEERS

## WELL SAMPLING FIELD LOG

PROJECT NAME ACBANY HILL M.M.

JOB NUMBER 3934 DATE OF SAMPLING 3-31-15

WELL ID. MW-1 SAMPLER PK

TOTAL DEPTH OF WELL 24.2 WELL DIAMETER 2

DEPTH TO WATER PRIOR TO PURGING 12.35 TIME OF MEASUREMENT

PRODUCT THICKNESS 0

DEPTH OF WELL CASING IN WATER 11.85

NUMBER OF GALLONS PER WELL CASING VOLUME 2.0

NUMBER OF WELL CASING VOLUMES TO BE REMOVED 3

REQUIRED VOLUME OF GROUNDWATER TO BE PURGED PRIOR TO SAMPLING 6.0 gal

EQUIPMENT USED TO PURGE WELL NEW DISPOSABLE BAILER

TIME EVACUATION STARTED 1245 TIME EVACUATION COMPLETED 1305

TIME SAMPLES WERE COLLECTED 1310

DID WELL GO DRY No AFTER HOW MANY GALLONS —

VOLUME OF GROUNDWATER PURGED 6.0 gal

SAMPLING DEVICE NEW DISPOSABLE BAILER

SAMPLE COLOR gray ODOR/SEDIMENT None/gray silt

### CHEMICAL DATA

VOLUME PURGED	TEMPERATURE	PH	CONDUCTIVITY
1	18.0	7.4	980
2	17.9	7.4	820
3	17.9	7.4	820

### SAMPLES COLLECTED

SAMPLE	# OF CONTAINERS	SIZE AND TYPE OF CONTAINER	ANALYSIS	PRESERVED
MW-1	5	40ml vial	8260B	HCL

# AQUA SCIENCE ENGINEERS

## WELL SAMPLING FIELD LOG

PROJECT NAME ALBANY HILL M.M.

JOB NUMBER 3934 DATE OF SAMPLING 3-31-15

WELL ID. MW-2 SAMPLER PK

TOTAL DEPTH OF WELL 24.8 WELL DIAMETER 2

DEPTH TO WATER PRIOR TO PURGING 11.35 TIME OF MEASUREMENT

PRODUCT THICKNESS 0

DEPTH OF WELL CASING IN WATER 13.45

NUMBER OF GALLONS PER WELL CASING VOLUME 2.3

NUMBER OF WELL CASING VOLUMES TO BE REMOVED 3

REQUIRED VOLUME OF GROUNDWATER TO BE PURGED PRIOR TO SAMPLING 6.9

EQUIPMENT USED TO PURGE WELL NEW DISPOSABLE BAILER

TIME EVACUATION STARTED 11:20 TIME EVACUATION COMPLETED 1145

TIME SAMPLES WERE COLLECTED 1150

DID WELL GO DRY No AFTER HOW MANY GALLONS —

VOLUME OF GROUNDWATER PURGED 6.9 gal

SAMPLING DEVICE NEW DISPOSABLE BAILER

SAMPLE COLOR yellow brown ODOR/SEDIMENT None / yellow brown silt

### CHEMICAL DATA

VOLUME PURGED	TEMPERATURE	PH	CONDUCTIVITY
1	17.5	8.0	530 $\mu$ S
2	17.5	7.8	530
3	17.5	7.8	530

### SAMPLES COLLECTED

SAMPLE	# OF CONTAINERS	SIZE AND TYPE OF CONTAINER	ANALYSIS	PRESERVED
MW-2	5	40ml VOA	8260B	HCL

# AQUA SCIENCE ENGINEERS

## WELL SAMPLING FIELD LOG

PROJECT NAME ALBANY HILL M.M.

JOB NUMBER 3934 DATE OF SAMPLING 3-31-15

WELL ID. MW-3 SAMPLER PK

TOTAL DEPTH OF WELL 23.8 WELL DIAMETER 2

DEPTH TO WATER PRIOR TO PURGING 11.02 TIME OF MEASUREMENT

PRODUCT THICKNESS 0

DEPTH OF WELL CASING IN WATER 12.78

NUMBER OF GALLONS PER WELL CASING VOLUME 2.1

NUMBER OF WELL CASING VOLUMES TO BE REMOVED 3

REQUIRED VOLUME OF GROUNDWATER TO BE PURGED PRIOR TO SAMPLING 6.3 gal

EQUIPMENT USED TO PURGE WELL NEW DISPOSABLE BAILER

TIME EVACUATION STARTED 1210 TIME EVACUATION COMPLETED 1225

TIME SAMPLES WERE COLLECTED 12:30

DID WELL GO DRY NO AFTER HOW MANY GALLONS —

VOLUME OF GROUNDWATER PURGED 6.3 gal

SAMPLING DEVICE NEW DISPOSABLE BAILER

SAMPLE COLOR yellow brown ODOR/SEDIMENT None / yellow brown

### CHEMICAL DATA

VOLUME PURGED	TEMPERATURE	PH	CONDUCTIVITY
1	18.7°C	7.9	470µS
2	18.7	7.8	450
3	18.7	7.8	450

### SAMPLES COLLECTED

SAMPLE	# OF CONTAINERS	SIZE AND TYPE OF CONTAINER	ANALYSIS	PRESERVED
MW-3	5	40al VOA	8260B	HCL

# AQUA SCIENCE ENGINEERS

## WELL SAMPLING FIELD LOG

PROJECT NAME ALBANY HILL M.M.

JOB NUMBER 3934 DATE OF SAMPLING 3-31-15

WELL ID. MW-4 SAMPLER PK

TOTAL DEPTH OF WELL 24.5 WELL DIAMETER 2

DEPTH TO WATER PRIOR TO PURGING 11.29 TIME OF MEASUREMENT

PRODUCT THICKNESS 0

DEPTH OF WELL CASING IN WATER 13.2

NUMBER OF GALLONS PER WELL CASING VOLUME 2.2

NUMBER OF WELL CASING VOLUMES TO BE REMOVED 3

REQUIRED VOLUME OF GROUNDWATER TO BE PURGED PRIOR TO SAMPLING 6.6 gal

EQUIPMENT USED TO PURGE WELL NEW DISPOSABLE BAILER

TIME EVACUATION STARTED 1420 TIME EVACUATION COMPLETED 1445

TIME SAMPLES WERE COLLECTED 1450

DID WELL GO DRY No AFTER HOW MANY GALLONS 6.6 gal

VOLUME OF GROUNDWATER PURGED 6.6 gal

SAMPLING DEVICE NEW DISPOSABLE BAILER

SAMPLE COLOR gray ODOR/SEDIMENT None / gray slt

### CHEMICAL DATA

VOLUME PURGED	TEMPERATURE	PH	CONDUCTIVITY
1	18.5	7.6	1720
2	18.5	7.6	1670
3	18.5	7.4	1670

### SAMPLES COLLECTED

SAMPLE	# OF CONTAINERS	SIZE AND TYPE OF CONTAINER	ANALYSIS	PRESERVED
MW-4	5	40ml vial	8260B	HCL

# AQUA SCIENCE ENGINEERS

## WELL SAMPLING FIELD LOG

PROJECT NAME ALBANY HILL M.M.

JOB NUMBER 3934 DATE OF SAMPLING 3-31-15

WELL ID. MW-SR SAMPLER PK

TOTAL DEPTH OF WELL 19.58 WELL DIAMETER 2

DEPTH TO WATER PRIOR TO PURGING 10.80 TIME OF MEASUREMENT

PRODUCT THICKNESS 0

DEPTH OF WELL CASING IN WATER 8.78

NUMBER OF GALLONS PER WELL CASING VOLUME 1.5

NUMBER OF WELL CASING VOLUMES TO BE REMOVED 3

REQUIRED VOLUME OF GROUNDWATER TO BE PURGED PRIOR TO SAMPLING 4.5 gal

EQUIPMENT USED TO PURGE WELL NEW DISPOSABLE BAILER

TIME EVACUATION STARTED 1335 TIME EVACUATION COMPLETED 1355

TIME SAMPLES WERE COLLECTED 1400

DID WELL GO DRY NO AFTER HOW MANY GALLONS —

VOLUME OF GROUNDWATER PURGED 4.5 gal

SAMPLING DEVICE NEW DISPOSABLE BAILER

SAMPLE COLOR slight yellow brown ODOR/SEDIMENT slight hc / slight yellow brown

### CHEMICAL DATA

VOLUME PURGED	TEMPERATURE	PH	CONDUCTIVITY
1	19.1	7.5	780
2	18.7	7.5	750
3	18.9	7.5	750

### SAMPLES COLLECTED

SAMPLE	# OF CONTAINERS	SIZE AND TYPE OF CONTAINER	ANALYSIS	PRESERVED
MW-SR	5	40al VOA	8260B	HCL



# AQUA SCIENCE ENGINEERS

## WELL SAMPLING FIELD LOG

PROJECT NAME ACBANY HILL M.M.

---

JOB NUMBER 3934 DATE OF SAMPLING 3-31-15

---

WELL ID. MW-6 SAMPLER PK

---

TOTAL DEPTH OF WELL 24.7 WELL DIAMETER 2

---

DEPTH TO WATER PRIOR TO PURGING 9.81 TIME OF MEASUREMENT

---

PRODUCT THICKNESS 0

---

DEPTH OF WELL CASING IN WATER 14.89

---

NUMBER OF GALLONS PER WELL CASING VOLUME 2.5

---

NUMBER OF WELL CASING VOLUMES TO BE REMOVED 3

---

REQUIRED VOLUME OF GROUNDWATER TO BE PURGED PRIOR TO SAMPLING 7.5 gal

---

EQUIPMENT USED TO PURGE WELL NEW DISPOSABLE BAILER

---

TIME EVACUATION STARTED 950 TIME EVACUATION COMPLETED 1005

---

TIME SAMPLES WERE COLLECTED 1600

---

DID WELL GO DRY Yes AFTER HOW MANY GALLONS 3.0 gal

---

VOLUME OF GROUNDWATER PURGED 3.0 gal

---

SAMPLING DEVICE NEW DISPOSABLE BAILER

---

SAMPLE COLOR yellow brown ODOR/SEDIMENT None / yellow brown silt

### CHEMICAL DATA

VOLUME PURGED	TEMPERATURE	PH	CONDUCTIVITY
1	19.1	7.6	690
2	—	—	—
3	—	—	—

### SAMPLES COLLECTED

SAMPLE	# OF CONTAINERS	SIZE AND TYPE OF CONTAINER	ANALYSIS	PRESERVED
MW-6	5	40 ml vial	8260B	HCL

# AQUA SCIENCE ENGINEERS

## WELL SAMPLING FIELD LOG

PROJECT NAME ALBANY HILL M.M.

JOB NUMBER 3934 DATE OF SAMPLING 3-31-15

WELL ID. MW-7 SAMPLER PK

TOTAL DEPTH OF WELL 24.2 WELL DIAMETER 2

DEPTH TO WATER PRIOR TO PURGING 11.85 TIME OF MEASUREMENT

PRODUCT THICKNESS 0

DEPTH OF WELL CASING IN WATER 12.85

NUMBER OF GALLONS PER WELL CASING VOLUME 2.2

NUMBER OF WELL CASING VOLUMES TO BE REMOVED 3

REQUIRED VOLUME OF GROUNDWATER TO BE PURGED PRIOR TO SAMPLING 6.6 gal

EQUIPMENT USED TO PURGE WELL NEW DISPOSABLE BAILER

TIME EVACUATION STARTED 1020 TIME EVACUATION COMPLETED 1100

TIME SAMPLES WERE COLLECTED 1105

DID WELL GO DRY NO AFTER HOW MANY GALLONS —

VOLUME OF GROUNDWATER PURGED 6.6 gal

SAMPLING DEVICE NEW DISPOSABLE BAILER

SAMPLE COLOR yellow brown ODOR/SEDIMENT none / yellow brown

### CHEMICAL DATA

VOLUME PURGED	TEMPERATURE	PH	CONDUCTIVITY
1	17.2°C	8.0	570 mS
2	17.3	8.0	570
3	17.3	8.1	570

### SAMPLES COLLECTED

SAMPLE	# OF CONTAINERS	SIZE AND TYPE OF CONTAINER	ANALYSIS	PRESERVED
MW-7	5	40ml vial	8260B	HCL

# AQUA SCIENCE ENGINEERS

## WELL SAMPLING FIELD LOG

PROJECT NAME ALBANY HILL M.M.

JOB NUMBER 3934 DATE OF SAMPLING 3-31-15

WELL ID. MW-8 SAMPLER BE

TOTAL DEPTH OF WELL 19.1 WELL DIAMETER 2

DEPTH TO WATER PRIOR TO PURGING 11.50 TIME OF MEASUREMENT

PRODUCT THICKNESS 0

DEPTH OF WELL CASING IN WATER 7.6

NUMBER OF GALLONS PER WELL CASING VOLUME 1.3

NUMBER OF WELL CASING VOLUMES TO BE REMOVED 3

REQUIRED VOLUME OF GROUNDWATER TO BE PURGED PRIOR TO SAMPLING 3-99 gal

EQUIPMENT USED TO PURGE WELL NEW DISPOSABLE BAILER

TIME EVACUATION STARTED 910 TIME EVACUATION COMPLETED 925

TIME SAMPLES WERE COLLECTED 930

DID WELL GO DRY No AFTER HOW MANY GALLONS —

VOLUME OF GROUNDWATER PURGED 3-99 gal

SAMPLING DEVICE NEW DISPOSABLE BAILER

SAMPLE COLOR yellow brown ODOR/SEDIMENT None / yellow brown silt

### CHEMICAL DATA

VOLUME PURGED	TEMPERATURE	PH	CONDUCTIVITY
1	17.1 °C	7.4	550 uS
2	17.1	7.7	530
3	17.1	7.7	530

### SAMPLES COLLECTED

SAMPLE	# OF CONTAINERS	SIZE AND TYPE OF CONTAINER	ANALYSIS	PRESERVED
MW-8	5	40ml VOA	8260B	HCL

# AQUA SCIENCE ENGINEERS

## WELL SAMPLING FIELD LOG

PROJECT NAME ALBANY HILL M.M.

JOB NUMBER 3934 DATE OF SAMPLING 3-31-15

WELL ID. Mw-9 SAMPLER PK

TOTAL DEPTH OF WELL 16.8 WELL DIAMETER 2

DEPTH TO WATER PRIOR TO PURGING 12.42 TIME OF MEASUREMENT

PRODUCT THICKNESS 0

DEPTH OF WELL CASING IN WATER 4.38

NUMBER OF GALLONS PER WELL CASING VOLUME 0.7

NUMBER OF WELL CASING VOLUMES TO BE REMOVED 3

REQUIRED VOLUME OF GROUNDWATER TO BE PURGED PRIOR TO SAMPLING 2.1 gal

EQUIPMENT USED TO PURGE WELL NEW DISPOSABLE BAILER

TIME EVACUATION STARTED 842 TIME EVACUATION COMPLETED 845

TIME SAMPLES WERE COLLECTED 1615

DID WELL GO DRY Yes AFTER HOW MANY GALLONS 1.0 gal

VOLUME OF GROUNDWATER PURGED 1.0 gal

SAMPLING DEVICE NEW DISPOSABLE BAILER

SAMPLE COLOR gray ODOR/SEDIMENT Mod he / gray silt

### CHEMICAL DATA

VOLUME PURGED	TEMPERATURE	PH	CONDUCTIVITY
1	—	—	—
2	—	—	—
3	—	—	—

### SAMPLES COLLECTED

SAMPLE	# OF CONTAINERS	SIZE AND TYPE OF CONTAINER	ANALYSIS	PRESERVED
<u>Mw-9</u>	<u>5</u>	<u>40ml VOA</u>	<u>8260B</u>	<u>HCL</u>

# AQUA SCIENCE ENGINEERS

## WELL SAMPLING FIELD LOG

PROJECT NAME	ALBANY HILL M.M.		
JOB NUMBER	3934	DATE OF SAMPLING	3-31-15
WELL ID.	MW-10	SAMPLER	PK
TOTAL DEPTH OF WELL	24.7	WELL DIAMETER	2
DEPTH TO WATER PRIOR TO PURGING	10.41	TIME OF MEASUREMENT	
PRODUCT THICKNESS	0		
DEPTH OF WELL CASING IN WATER	14.29		
NUMBER OF GALLONS PER WELL CASING VOLUME	2.4		
NUMBER OF WELL CASING VOLUMES TO BE REMOVED	3		
REQUIRED VOLUME OF GROUNDWATER TO BE PURGED PRIOR TO SAMPLING	7.2 gal		
EQUIPMENT USED TO PURGE WELL	NEW DISPOSABLE BAILER		
TIME EVACUATION STARTED	15:10	TIME EVACUATION COMPLETED	15:30
TIME SAMPLES WERE COLLECTED	15:40		
DID WELL GO DRY	No	AFTER HOW MANY GALLONS	—
VOLUME OF GROUNDWATER PURGED	7.2 gal		
SAMPLING DEVICE	NEW DISPOSABLE BAILER		
SAMPLE COLOR	clear	ODOR/SEDIMENT	None/None

### CHEMICAL DATA

VOLUME PURGED	TEMPERATURE	PH	CONDUCTIVITY
1	19.2	7.9	750
2	19.3	7.8	800
3	19.3	7.8	790

### SAMPLES COLLECTED

SAMPLE	# OF CONTAINERS	SIZE AND TYPE OF CONTAINER	ANALYSIS	PRESERVED
MW-10	5	40ml vial	8260B	HCL



Aqua Science Engineers, Inc. 55 Oak Court, Suite 220, Danville, CA 94526  
(925) 820-9391 - Fax (925) 837-4853 - [www.aquascienceengineers.com](http://www.aquascienceengineers.com)

## **APPENDIX B**

Certified Analytical Report  
and  
Chain of Custody Documentation



# McC Campbell Analytical, Inc.

"When Quality Counts"

## Analytical Report

**WorkOrder:** 1504116

**Report Created for:** Aqua Science Engineers, Inc.  
55 Oak Court Suite 220  
Danville, CA 94526

**Project Contact:** Robert Kitay  
**Project P.O.:**  
**Project Name:** #3934; Albany Hill Mini Mart

**Project Received:** 04/02/2015

Analytical Report reviewed & approved for release on 04/10/2015 by:

Angela Rydelius,  
Laboratory Manager

*The report shall not be reproduced except in full, without the written approval of the laboratory. The analytical results relate only to the items tested. Results reported conform to the most current NELAP standards, where applicable, unless otherwise stated in the case narrative.*





## Glossary of Terms & Qualifier Definitions

**Client:** Aqua Science Engineers, Inc.  
**Project:** #3934; Albany Hill Mini Mart  
**WorkOrder:** 1504116

### Glossary Abbreviation

95% Interval	95% Confident Interval
DF	Dilution Factor
DI WET	(DISTLC) Waste Extraction Test using DI water
DISS	Dissolved (direct analysis of 0.45 µm filtered and acidified water sample)
DUP	Duplicate
EDL	Estimated Detection Limit
ITEF	International Toxicity Equivalence Factor
LCS	Laboratory Control Sample
MB	Method Blank
MB % Rec	% Recovery of Surrogate in Method Blank, if applicable
MDL	Method Detection Limit
ML	Minimum Level of Quantitation
MS	Matrix Spike
MSD	Matrix Spike Duplicate
N/A	Not Applicable
ND	Not detected at or above the indicated MDL or RL
NR	Data Not Reported due to matrix interference or insufficient sample amount.
PF	Prep Factor
RD	Relative Difference
RL	Reporting Limit (The RL is the lowest calibration standard in a multipoint calibration.)
RPD	Relative Percent Deviation
RRT	Relative Retention Time
SPK Val	Spike Value
SPKRef Val	Spike Reference Value
SPLP	Synthetic Precipitation Leachate Procedure
TCLP	Toxicity Characteristic Leachate Procedure
TEQ	Toxicity Equivalents
WET (STLC)	Waste Extraction Test (Soluble Threshold Limit Concentration)





## Analytical Report

**Client:** Aqua Science Engineers, Inc.  
**Project:** #3934; Albany Hill Mini Mart  
**Date Received:** 4/2/15 20:59  
**Date Prepared:** 4/9/15-4/10/15

**WorkOrder:** 1504116  
**Extraction Method:** SW5030B  
**Analytical Method:** SW8260B  
**Unit:** µg/L

### Oxygenated Volatile Organics & BTEX by P&T and GC/MS

Client ID	Lab ID	Matrix/ExtType	Date Collected	Instrument	Batch ID
MW-1	1504116-001A	Water	03/31/2015 13:10	GC16	103464

Analytes	Result	RL	DF	Date Analyzed
tert-Amyl methyl ether (TAME)	ND	0.50	1	04/09/2015 11:28
Benzene	<b>0.77</b>	0.50	1	04/09/2015 11:28
t-Butyl alcohol (TBA)	ND	2.0	1	04/09/2015 11:28
Diisopropyl ether (DIPE)	ND	0.50	1	04/09/2015 11:28
Ethylbenzene	ND	0.50	1	04/09/2015 11:28
Ethyl tert-butyl ether (ETBE)	ND	0.50	1	04/09/2015 11:28
Methyl-t-butyl ether (MTBE)	<b>4.8</b>	0.50	1	04/09/2015 11:28
Naphthalene	ND	0.50	1	04/09/2015 11:28
Toluene	ND	0.50	1	04/09/2015 11:28
Xylenes, Total	ND	0.50	1	04/09/2015 11:28

Surrogates	REC (%)	Limits	Date Analyzed
Dibromofluoromethane	101	70-130	04/09/2015 11:28
Toluene-d8	96	70-130	04/09/2015 11:28

Analyst(s): AK

Client ID	Lab ID	Matrix/ExtType	Date Collected	Instrument	Batch ID
MW-2	1504116-002A	Water	03/31/2015 11:50	GC16	103464

Analytes	Result	RL	DF	Date Analyzed
tert-Amyl methyl ether (TAME)	ND	0.50	1	04/09/2015 22:09
Benzene	ND	0.50	1	04/09/2015 22:09
t-Butyl alcohol (TBA)	ND	2.0	1	04/09/2015 22:09
Diisopropyl ether (DIPE)	ND	0.50	1	04/09/2015 22:09
Ethylbenzene	ND	0.50	1	04/09/2015 22:09
Ethyl tert-butyl ether (ETBE)	ND	0.50	1	04/09/2015 22:09
Methyl-t-butyl ether (MTBE)	ND	0.50	1	04/09/2015 22:09
Naphthalene	ND	0.50	1	04/09/2015 22:09
Toluene	ND	0.50	1	04/09/2015 22:09
Xylenes, Total	ND	0.50	1	04/09/2015 22:09

Surrogates	REC (%)	Limits	Date Analyzed
Dibromofluoromethane	101	70-130	04/09/2015 22:09
Toluene-d8	90	70-130	04/09/2015 22:09

Analyst(s): KF

(Cont.)



## Analytical Report

**Client:** Aqua Science Engineers, Inc.  
**Project:** #3934; Albany Hill Mini Mart  
**Date Received:** 4/2/15 20:59  
**Date Prepared:** 4/9/15-4/10/15

**WorkOrder:** 1504116  
**Extraction Method:** SW5030B  
**Analytical Method:** SW8260B  
**Unit:** µg/L

### Oxygenated Volatile Organics & BTEX by P&T and GC/MS

Client ID	Lab ID	Matrix/ExtType	Date Collected	Instrument	Batch ID
MW-3	1504116-003A	Water	03/31/2015 12:30	GC16	103464

Analytes	Result	RL	DF	Date Analyzed
tert-Amyl methyl ether (TAME)	ND	0.50	1	04/09/2015 12:53
Benzene	ND	0.50	1	04/09/2015 12:53
t-Butyl alcohol (TBA)	ND	2.0	1	04/09/2015 12:53
Diisopropyl ether (DIPE)	ND	0.50	1	04/09/2015 12:53
Ethylbenzene	ND	0.50	1	04/09/2015 12:53
Ethyl tert-butyl ether (ETBE)	ND	0.50	1	04/09/2015 12:53
Methyl-t-butyl ether (MTBE)	ND	0.50	1	04/09/2015 12:53
Naphthalene	ND	0.50	1	04/09/2015 12:53
Toluene	ND	0.50	1	04/09/2015 12:53
Xylenes, Total	ND	0.50	1	04/09/2015 12:53

Surrogates	REC (%)	Limits	Date Analyzed
Dibromofluoromethane	104	70-130	04/09/2015 12:53
Toluene-d8	95	70-130	04/09/2015 12:53

**Analyst(s):** AK

Client ID	Lab ID	Matrix/ExtType	Date Collected	Instrument	Batch ID
MW-4	1504116-004A	Water	03/31/2015 14:50	GC38	103464

Analytes	Result	RL	DF	Date Analyzed
tert-Amyl methyl ether (TAME)	ND	1.2	2.5	04/10/2015 13:11
Benzene	<b>25</b>	1.2	2.5	04/10/2015 13:11
t-Butyl alcohol (TBA)	ND	5.0	2.5	04/10/2015 13:11
Diisopropyl ether (DIPE)	ND	1.2	2.5	04/10/2015 13:11
Ethylbenzene	ND	1.2	2.5	04/10/2015 13:11
Ethyl tert-butyl ether (ETBE)	ND	1.2	2.5	04/10/2015 13:11
Methyl-t-butyl ether (MTBE)	<b>5.8</b>	1.2	2.5	04/10/2015 13:11
Naphthalene	ND	1.2	2.5	04/10/2015 13:11
Toluene	ND	1.2	2.5	04/10/2015 13:11
Xylenes, Total	ND	1.2	2.5	04/10/2015 13:11

Surrogates	REC (%)	Limits	Date Analyzed
Dibromofluoromethane	84	70-130	04/10/2015 13:11
Toluene-d8	91	70-130	04/10/2015 13:11

**Analyst(s):** KF

(Cont.)



## Analytical Report

**Client:** Aqua Science Engineers, Inc.  
**Project:** #3934; Albany Hill Mini Mart  
**Date Received:** 4/2/15 20:59  
**Date Prepared:** 4/9/15-4/10/15

**WorkOrder:** 1504116  
**Extraction Method:** SW5030B  
**Analytical Method:** SW8260B  
**Unit:** µg/L

### Oxygenated Volatile Organics & BTEX by P&T and GC/MS

Client ID	Lab ID	Matrix/ExtType	Date Collected	Instrument	Batch ID
MW-5R	1504116-005A	Water	03/31/2015 14:00	GC16	103464

Analytes	Result	RL	DF	Date Analyzed
tert-Amyl methyl ether (TAME)	ND	0.50	1	04/09/2015 14:21
Benzene	<b>10</b>	0.50	1	04/09/2015 14:21
t-Butyl alcohol (TBA)	ND	2.0	1	04/09/2015 14:21
Diisopropyl ether (DIPE)	ND	0.50	1	04/09/2015 14:21
Ethylbenzene	<b>2.1</b>	0.50	1	04/09/2015 14:21
Ethyl tert-butyl ether (ETBE)	ND	0.50	1	04/09/2015 14:21
Methyl-t-butyl ether (MTBE)	ND	0.50	1	04/09/2015 14:21
Naphthalene	ND	0.50	1	04/09/2015 14:21
Toluene	<b>0.86</b>	0.50	1	04/09/2015 14:21
Xylenes, Total	<b>1.0</b>	0.50	1	04/09/2015 14:21

Surrogates	REC (%)	Limits	Date Analyzed
Dibromofluoromethane	105	70-130	04/09/2015 14:21
Toluene-d8	95	70-130	04/09/2015 14:21

Analyst(s): AK

Client ID	Lab ID	Matrix/ExtType	Date Collected	Instrument	Batch ID
MW-6	1504116-006A	Water	03/31/2015 16:00	GC16	103464

Analytes	Result	RL	DF	Date Analyzed
tert-Amyl methyl ether (TAME)	ND	0.50	1	04/09/2015 15:04
Benzene	ND	0.50	1	04/09/2015 15:04
t-Butyl alcohol (TBA)	ND	2.0	1	04/09/2015 15:04
Diisopropyl ether (DIPE)	ND	0.50	1	04/09/2015 15:04
Ethylbenzene	ND	0.50	1	04/09/2015 15:04
Ethyl tert-butyl ether (ETBE)	ND	0.50	1	04/09/2015 15:04
Methyl-t-butyl ether (MTBE)	<b>5.8</b>	0.50	1	04/09/2015 15:04
Naphthalene	ND	0.50	1	04/09/2015 15:04
Toluene	ND	0.50	1	04/09/2015 15:04
Xylenes, Total	ND	0.50	1	04/09/2015 15:04

Surrogates	REC (%)	Limits	Date Analyzed
Dibromofluoromethane	102	70-130	04/09/2015 15:04
Toluene-d8	95	70-130	04/09/2015 15:04

Analyst(s): AK

(Cont.)



## Analytical Report

**Client:** Aqua Science Engineers, Inc.  
**Project:** #3934; Albany Hill Mini Mart  
**Date Received:** 4/2/15 20:59  
**Date Prepared:** 4/9/15-4/10/15

**WorkOrder:** 1504116  
**Extraction Method:** SW5030B  
**Analytical Method:** SW8260B  
**Unit:** µg/L

### Oxygenated Volatile Organics & BTEX by P&T and GC/MS

Client ID	Lab ID	Matrix/ExtType	Date Collected	Instrument	Batch ID
MW-7	1504116-007A	Water	03/31/2015 11:05	GC16	103464

Analytes	Result	RL	DF	Date Analyzed
tert-Amyl methyl ether (TAME)	ND	0.50	1	04/09/2015 15:46
Benzene	ND	0.50	1	04/09/2015 15:46
t-Butyl alcohol (TBA)	ND	2.0	1	04/09/2015 15:46
Diisopropyl ether (DIPE)	ND	0.50	1	04/09/2015 15:46
Ethylbenzene	ND	0.50	1	04/09/2015 15:46
Ethyl tert-butyl ether (ETBE)	ND	0.50	1	04/09/2015 15:46
Methyl-t-butyl ether (MTBE)	ND	0.50	1	04/09/2015 15:46
Naphthalene	ND	0.50	1	04/09/2015 15:46
Toluene	ND	0.50	1	04/09/2015 15:46
Xylenes, Total	ND	0.50	1	04/09/2015 15:46

Surrogates	REC (%)	Limits	Date Analyzed
Dibromofluoromethane	104	70-130	04/09/2015 15:46
Toluene-d8	95	70-130	04/09/2015 15:46

Analyst(s): AK

Client ID	Lab ID	Matrix/ExtType	Date Collected	Instrument	Batch ID
MW-8	1504116-008A	Water	03/31/2015 09:30	GC16	103464

Analytes	Result	RL	DF	Date Analyzed
tert-Amyl methyl ether (TAME)	ND	0.50	1	04/09/2015 16:29
Benzene	ND	0.50	1	04/09/2015 16:29
t-Butyl alcohol (TBA)	ND	2.0	1	04/09/2015 16:29
Diisopropyl ether (DIPE)	ND	0.50	1	04/09/2015 16:29
Ethylbenzene	ND	0.50	1	04/09/2015 16:29
Ethyl tert-butyl ether (ETBE)	ND	0.50	1	04/09/2015 16:29
Methyl-t-butyl ether (MTBE)	ND	0.50	1	04/09/2015 16:29
Naphthalene	ND	0.50	1	04/09/2015 16:29
Toluene	ND	0.50	1	04/09/2015 16:29
Xylenes, Total	ND	0.50	1	04/09/2015 16:29

Surrogates	REC (%)	Limits	Date Analyzed
Dibromofluoromethane	106	70-130	04/09/2015 16:29
Toluene-d8	95	70-130	04/09/2015 16:29

Analyst(s): AK

(Cont.)



## Analytical Report

**Client:** Aqua Science Engineers, Inc.  
**Project:** #3934; Albany Hill Mini Mart  
**Date Received:** 4/2/15 20:59  
**Date Prepared:** 4/9/15-4/10/15

**WorkOrder:** 1504116  
**Extraction Method:** SW5030B  
**Analytical Method:** SW8260B  
**Unit:** µg/L

### Oxygenated Volatile Organics & BTEX by P&T and GC/MS

Client ID	Lab ID	Matrix/ExtType	Date Collected	Instrument	Batch ID
MW-9	1504116-009A	Water	03/31/2015 16:15	GC38	103464

Analytes	Result	RL	DF	Date Analyzed
tert-Amyl methyl ether (TAME)	ND	1.2	2.5	04/10/2015 13:49
Benzene	<b>36</b>	1.2	2.5	04/10/2015 13:49
t-Butyl alcohol (TBA)	ND	5.0	2.5	04/10/2015 13:49
Diisopropyl ether (DIPE)	ND	1.2	2.5	04/10/2015 13:49
Ethylbenzene	<b>67</b>	1.2	2.5	04/10/2015 13:49
Ethyl tert-butyl ether (ETBE)	ND	1.2	2.5	04/10/2015 13:49
Methyl-t-butyl ether (MTBE)	ND	1.2	2.5	04/10/2015 13:49
Naphthalene	<b>47</b>	1.2	2.5	04/10/2015 13:49
Toluene	<b>3.0</b>	1.2	2.5	04/10/2015 13:49
Xylenes, Total	<b>270</b>	1.2	2.5	04/10/2015 13:49

Surrogates	REC (%)	Limits	Date Analyzed
Dibromofluoromethane	87	70-130	04/10/2015 13:49
Toluene-d8	91	70-130	04/10/2015 13:49

**Analyst(s):** KF

Client ID	Lab ID	Matrix/ExtType	Date Collected	Instrument	Batch ID
MW-10	1504116-010A	Water	03/31/2015 15:40	GC38	103464

Analytes	Result	RL	DF	Date Analyzed
tert-Amyl methyl ether (TAME)	ND	0.50	1	04/10/2015 12:33
Benzene	ND	0.50	1	04/10/2015 12:33
t-Butyl alcohol (TBA)	ND	2.0	1	04/10/2015 12:33
Diisopropyl ether (DIPE)	ND	0.50	1	04/10/2015 12:33
Ethylbenzene	ND	0.50	1	04/10/2015 12:33
Ethyl tert-butyl ether (ETBE)	ND	0.50	1	04/10/2015 12:33
Methyl-t-butyl ether (MTBE)	<b>1.5</b>	0.50	1	04/10/2015 12:33
Naphthalene	ND	0.50	1	04/10/2015 12:33
Toluene	ND	0.50	1	04/10/2015 12:33
Xylenes, Total	ND	0.50	1	04/10/2015 12:33

Surrogates	REC (%)	Limits	Date Analyzed
Dibromofluoromethane	80	70-130	04/10/2015 12:33
Toluene-d8	91	70-130	04/10/2015 12:33

**Analyst(s):** KF



## Analytical Report

**Client:** Aqua Science Engineers, Inc.  
**Project:** #3934; Albany Hill Mini Mart  
**Date Received:** 4/2/15 20:59  
**Date Prepared:** 4/9/15

**WorkOrder:** 1504116  
**Extraction Method:** SW5030B  
**Analytical Method:** SW8260B  
**Unit:** µg/L

### TPH(g) by Purge & Trap and GC/MS

Client ID	Lab ID	Matrix/ExtType	Date Collected	Instrument	Batch ID
MW-1	1504116-001A	Water	03/31/2015 13:10	GC16	103464

Analytes	Result	RL	DF	Date Analyzed
TPH(g)	ND	50	1	04/09/2015 11:28
Surrogates	REC (%)	Limits		
Dibromofluoromethane	104	80-124		04/09/2015 11:28

Analyst(s): AK

Client ID	Lab ID	Matrix/ExtType	Date Collected	Instrument	Batch ID
MW-2	1504116-002A	Water	03/31/2015 11:50	GC16	103464

Analytes	Result	RL	DF	Date Analyzed
TPH(g)	ND	50	1	04/09/2015 22:09
Surrogates	REC (%)	Limits		
Dibromofluoromethane	103	80-124		04/09/2015 22:09

Analyst(s): KF

Client ID	Lab ID	Matrix/ExtType	Date Collected	Instrument	Batch ID
MW-3	1504116-003A	Water	03/31/2015 12:30	GC16	103464

Analytes	Result	RL	DF	Date Analyzed
TPH(g)	ND	50	1	04/09/2015 12:53
Surrogates	REC (%)	Limits		
Dibromofluoromethane	106	80-124		04/09/2015 12:53

Analyst(s): AK

Client ID	Lab ID	Matrix/ExtType	Date Collected	Instrument	Batch ID
MW-4	1504116-004A	Water	03/31/2015 14:50	GC16	103464

Analytes	Result	RL	DF	Date Analyzed
TPH(g)	170	50	1	04/09/2015 13:38
Surrogates	REC (%)	Limits		
Dibromofluoromethane	103	80-124		04/09/2015 13:38

Analyst(s): AK

(Cont.)



## Analytical Report

**Client:** Aqua Science Engineers, Inc.  
**Project:** #3934; Albany Hill Mini Mart  
**Date Received:** 4/2/15 20:59  
**Date Prepared:** 4/9/15

**WorkOrder:** 1504116  
**Extraction Method:** SW5030B  
**Analytical Method:** SW8260B  
**Unit:** µg/L

### TPH(g) by Purge & Trap and GC/MS

Client ID	Lab ID	Matrix/ExtType	Date Collected	Instrument	Batch ID
MW-5R	1504116-005A	Water	03/31/2015 14:00	GC16	103464

<u>Analytes</u>	<u>Result</u>	<u>RL</u>	<u>DF</u>	<u>Date Analyzed</u>
TPH(g)	1900	50	1	04/09/2015 14:21
<u>Surrogates</u>	<u>REC (%)</u>	<u>Limits</u>		<u>Date Analyzed</u>
Dibromofluoromethane	106	80-124		04/09/2015 14:21

Analyst(s): AK

Client ID	Lab ID	Matrix/ExtType	Date Collected	Instrument	Batch ID
MW-6	1504116-006A	Water	03/31/2015 16:00	GC16	103464

<u>Analytes</u>	<u>Result</u>	<u>RL</u>	<u>DF</u>	<u>Date Analyzed</u>
TPH(g)	ND	50	1	04/09/2015 15:04
<u>Surrogates</u>	<u>REC (%)</u>	<u>Limits</u>		<u>Date Analyzed</u>
Dibromofluoromethane	104	80-124		04/09/2015 15:04

Analyst(s): AK

Client ID	Lab ID	Matrix/ExtType	Date Collected	Instrument	Batch ID
MW-7	1504116-007A	Water	03/31/2015 11:05	GC16	103464

<u>Analytes</u>	<u>Result</u>	<u>RL</u>	<u>DF</u>	<u>Date Analyzed</u>
TPH(g)	ND	50	1	04/09/2015 15:46
<u>Surrogates</u>	<u>REC (%)</u>	<u>Limits</u>		<u>Date Analyzed</u>
Dibromofluoromethane	107	80-124		04/09/2015 15:46

Analyst(s): AK

Client ID	Lab ID	Matrix/ExtType	Date Collected	Instrument	Batch ID
MW-8	1504116-008A	Water	03/31/2015 09:30	GC16	103464

<u>Analytes</u>	<u>Result</u>	<u>RL</u>	<u>DF</u>	<u>Date Analyzed</u>
TPH(g)	ND	50	1	04/09/2015 16:29
<u>Surrogates</u>	<u>REC (%)</u>	<u>Limits</u>		<u>Date Analyzed</u>
Dibromofluoromethane	108	80-124		04/09/2015 16:29

Analyst(s): AK

(Cont.)



## Analytical Report

**Client:** Aqua Science Engineers, Inc.  
**Project:** #3934; Albany Hill Mini Mart  
**Date Received:** 4/2/15 20:59  
**Date Prepared:** 4/9/15

**WorkOrder:** 1504116  
**Extraction Method:** SW5030B  
**Analytical Method:** SW8260B  
**Unit:** µg/L

### TPH(g) by Purge & Trap and GC/MS

Client ID	Lab ID	Matrix/ExtType	Date Collected	Instrument	Batch ID
MW-9	1504116-009A	Water	03/31/2015 16:15	GC16	103464

Analytes	Result	RL	DF	Date Analyzed
TPH(g)	970	50	1	04/09/2015 17:11

Surrogates	REC (%)	Limits	Date Analyzed
Dibromofluoromethane	105	80-124	04/09/2015 17:11

Analyst(s): KF

Client ID	Lab ID	Matrix/ExtType	Date Collected	Instrument	Batch ID
MW-10	1504116-010A	Water	03/31/2015 15:40	GC16	103464

Analytes	Result	RL	DF	Date Analyzed
TPH(g)	130	50	1	04/09/2015 17:54

Surrogates	REC (%)	Limits	Date Analyzed
Dibromofluoromethane	108	80-124	04/09/2015 17:54

Analyst(s): KF





## Quality Control Report

**Client:** Aqua Science Engineers, Inc.  
**Date Prepared:** 4/9/15  
**Date Analyzed:** 4/9/15  
**Instrument:** GC16  
**Matrix:** Water  
**Project:** #3934; Albany Hill Mini Mart

**WorkOrder:** 1504116  
**BatchID:** 103464  
**Extraction Method:** SW5030B  
**Analytical Method:** SW8260B  
**Unit:** µg/L  
**Sample ID:** MB/LCS-103464  
 1504116-008AMS/MSD

### QC Summary Report for SW8260B

Analyte	MB Result	LCS Result	RL	SPK Val	MB SS %REC	LCS %REC	LCS Limits
Acetone	ND	-	10	-	-	-	-
tert-Amyl methyl ether (TAME)	ND	10.9	0.50	10	-	109	54-140
Benzene	ND	10.4	0.50	10	-	104	47-158
Bromobenzene	ND	-	0.50	-	-	-	-
Bromochloromethane	ND	-	0.50	-	-	-	-
Bromodichloromethane	ND	-	0.50	-	-	-	-
Bromoform	ND	-	0.50	-	-	-	-
Bromomethane	ND	-	0.50	-	-	-	-
2-Butanone (MEK)	ND	-	2.0	-	-	-	-
t-Butyl alcohol (TBA)	ND	43.8	2.0	40	-	110	42-140
n-Butyl benzene	ND	-	0.50	-	-	-	-
sec-Butyl benzene	ND	-	0.50	-	-	-	-
tert-Butyl benzene	ND	-	0.50	-	-	-	-
Carbon Disulfide	ND	-	0.50	-	-	-	-
Carbon Tetrachloride	ND	-	0.50	-	-	-	-
Chlorobenzene	ND	-	0.50	-	-	-	-
Chloroethane	ND	-	0.50	-	-	-	-
Chloroform	ND	-	0.50	-	-	-	-
Chloromethane	ND	-	0.50	-	-	-	-
2-Chlorotoluene	ND	-	0.50	-	-	-	-
4-Chlorotoluene	ND	-	0.50	-	-	-	-
Dibromochloromethane	ND	-	0.50	-	-	-	-
1,2-Dibromo-3-chloropropane	ND	-	0.20	-	-	-	-
1,2-Dibromoethane (EDB)	ND	-	0.50	-	-	-	-
Dibromomethane	ND	-	0.50	-	-	-	-
1,2-Dichlorobenzene	ND	-	0.50	-	-	-	-
1,3-Dichlorobenzene	ND	-	0.50	-	-	-	-
1,4-Dichlorobenzene	ND	-	0.50	-	-	-	-
Dichlorodifluoromethane	ND	-	0.50	-	-	-	-
1,1-Dichloroethane	ND	-	0.50	-	-	-	-
1,2-Dichloroethane (1,2-DCA)	ND	-	0.50	-	-	-	-
1,1-Dichloroethene	ND	-	0.50	-	-	-	-
cis-1,2-Dichloroethene	ND	-	0.50	-	-	-	-
trans-1,2-Dichloroethene	ND	-	0.50	-	-	-	-
1,2-Dichloropropane	ND	-	0.50	-	-	-	-
1,3-Dichloropropane	ND	-	0.50	-	-	-	-
2,2-Dichloropropane	ND	-	0.50	-	-	-	-
1,1-Dichloropropene	ND	-	0.50	-	-	-	-
cis-1,3-Dichloropropene	ND	-	0.50	-	-	-	-
trans-1,3-Dichloropropene	ND	-	0.50	-	-	-	-

(Cont.)



## Quality Control Report

**Client:** Aqua Science Engineers, Inc.  
**Date Prepared:** 4/9/15  
**Date Analyzed:** 4/9/15  
**Instrument:** GC16  
**Matrix:** Water  
**Project:** #3934; Albany Hill Mini Mart

**WorkOrder:** 1504116  
**BatchID:** 103464  
**Extraction Method:** SW5030B  
**Analytical Method:** SW8260B  
**Unit:** µg/L  
**Sample ID:** MB/LCS-103464  
 1504116-008AMS/MSD

### QC Summary Report for SW8260B

Analyte	MB Result	LCS Result	RL	SPK Val	MB SS %REC	LCS %REC	LCS Limits
Diisopropyl ether (DIPE)	ND	9.14	0.50	10	-	91	57-136
Ethylbenzene	ND	-	0.50	-	-	-	-
Ethyl tert-butyl ether (ETBE)	ND	10.7	0.50	10	-	107	55-137
Freon 113	ND	-	0.50	-	-	-	-
Hexachlorobutadiene	ND	-	0.50	-	-	-	-
Hexachloroethane	ND	-	0.50	-	-	-	-
2-Hexanone	ND	-	0.50	-	-	-	-
Methanol	ND	-	500	-	-	-	-
Isopropylbenzene	ND	-	0.50	-	-	-	-
4-Isopropyl toluene	ND	-	0.50	-	-	-	-
Methyl-t-butyl ether (MTBE)	ND	10.9	0.50	10	-	109	53-139
Methylene chloride	ND	-	0.50	-	-	-	-
4-Methyl-2-pentanone (MIBK)	ND	-	0.50	-	-	-	-
Naphthalene	ND	-	0.50	-	-	-	-
n-Propyl benzene	ND	-	0.50	-	-	-	-
Styrene	ND	-	0.50	-	-	-	-
1,1,1,2-Tetrachloroethane	ND	-	0.50	-	-	-	-
1,1,2,2-Tetrachloroethane	ND	-	0.50	-	-	-	-
Tetrachloroethene	ND	-	0.50	-	-	-	-
Toluene	ND	9.73	0.50	10	-	97	52-137
1,2,3-Trichlorobenzene	ND	-	0.50	-	-	-	-
1,2,4-Trichlorobenzene	ND	-	0.50	-	-	-	-
1,1,1-Trichloroethane	ND	-	0.50	-	-	-	-
1,1,2-Trichloroethane	ND	-	0.50	-	-	-	-
Trichloroethene	ND	-	0.50	-	-	-	-
Trichlorofluoromethane	ND	-	0.50	-	-	-	-
1,2,3-Trichloropropane	ND	-	0.50	-	-	-	-
1,2,4-Trimethylbenzene	ND	-	0.50	-	-	-	-
1,3,5-Trimethylbenzene	ND	-	0.50	-	-	-	-
Vinyl Chloride	ND	-	0.50	-	-	-	-
Xylenes, Total	ND	-	0.50	-	-	-	-

**Surrogate Recovery**

Dibromofluoromethane	25.5	24.7		25	102	99	70-130
Toluene-d8	24.1	23.6		25	96	95	70-130
4-BFB	2.54	-		2.5	102	-	-

(Cont.)



## Quality Control Report

**Client:** Aqua Science Engineers, Inc.  
**Date Prepared:** 4/9/15  
**Date Analyzed:** 4/9/15  
**Instrument:** GC16  
**Matrix:** Water  
**Project:** #3934; Albany Hill Mini Mart

**WorkOrder:** 1504116  
**BatchID:** 103464  
**Extraction Method:** SW5030B  
**Analytical Method:** SW8260B  
**Unit:** µg/L  
**Sample ID:** MB/LCS-103464  
 1504116-008AMS/MSD

### QC Summary Report for SW8260B

Analyte	MS Result	MSD Result	SPK Val	SPKRef Val	MS %REC	MSD %REC	MS/MSD Limits	RPD	RPD Limit
tert-Amyl methyl ether (TAME)	12.1	11.6	10	ND	121	116	69-139	3.82	20
Benzene	10.6	10.2	10	ND	106	102	69-141	4.12	20
t-Butyl alcohol (TBA)	51.4	50.7	40	ND	128	127	41-152	1.41	20
Diisopropyl ether (DIPE)	9.38	9.12	10	ND	94	91	72-140	2.77	20
Ethyl tert-butyl ether (ETBE)	11.5	11.2	10	ND	115	112	71-140	2.97	20
Methyl-t-butyl ether (MTBE)	12.3	12.0	10	ND	123	119	73-139	3.03	20
Toluene	9.55	8.92	10	ND	95	89	71-128	6.75	20
<b>Surrogate Recovery</b>									
Dibromofluoromethane	25.7	26.2	25		103	105	70-130	2.06	20
Toluene-d8	23.3	23.1	25		93	92	70-130	0.976	20



## Quality Control Report

**Client:** Aqua Science Engineers, Inc.  
**Date Prepared:** 4/9/15  
**Date Analyzed:** 4/9/15  
**Instrument:** GC16  
**Matrix:** Water  
**Project:** #3934; Albany Hill Mini Mart

**WorkOrder:** 1504116  
**BatchID:** 103464  
**Extraction Method:** SW5030B  
**Analytical Method:** SW8260B  
**Unit:** µg/L  
**Sample ID:** MB/LCS-103464

### QC Summary Report for SW8260B

Analyte	MB Result	LCS Result	RL	SPK Val	MB SS %REC	LCS %REC	LCS Limits
VOC (C6-C12)	ND	546	50	644	-	85	75-105
<b>Surrogate Recovery</b>							
Dibromofluoromethane	26.0	25.3		25	104	101	65-135



1534 Willow Pass Rd  
Pittsburg, CA 94565-1701  
(925) 252-9262

# CHAIN-OF-CUSTODY RECORD

WorkOrder: 1504116

ClientCode: ASED

WaterTrax   
  WriteOn   
  EDF   
  Excel   
  EQUS   
  Email   
  HardCopy   
  ThirdParty   
  J-flag

**Report to:**  
 Robert Kitay  
 Aqua Science Engineers, Inc.  
 55 Oak Court Suite 220  
 Danville, CA 94526  
 (925) 820-9391    FAX: (925) 837-4853

Email: rkitay@aquascienceengineers.com  
 cc/3rd Party:  
 PO:  
 ProjectNo: #3934; Albany Hill Mini Mart

**Bill to:**  
 Diane Schiell  
 Aqua Science Engineers, Inc.  
 217 Wild Flower Drive  
 Roseville, CA 95678  
 deezthng22@yahoo.com

**Requested TAT: 5 days**  
  
**Date Received: 04/02/2015**  
**Date Printed: 04/10/2015**

Lab ID	Client ID	Matrix	Collection Date	Hold	Requested Tests (See legend below)												
					1	2	3	4	5	6	7	8	9	10	11	12	
1504116-001	MW-1	Water	3/31/2015 13:10	<input type="checkbox"/>	A	A	A										
1504116-002	MW-2	Water	3/31/2015 11:50	<input type="checkbox"/>	A	A											
1504116-003	MW-3	Water	3/31/2015 12:30	<input type="checkbox"/>	A	A											
1504116-004	MW-4	Water	3/31/2015 14:50	<input type="checkbox"/>	A	A											
1504116-005	MW-5R	Water	3/31/2015 14:00	<input type="checkbox"/>	A	A											
1504116-006	MW-6	Water	3/31/2015 16:00	<input type="checkbox"/>	A	A											
1504116-007	MW-7	Water	3/31/2015 11:05	<input type="checkbox"/>	A	A											
1504116-008	MW-8	Water	3/31/2015 9:30	<input type="checkbox"/>	A	A											
1504116-009	MW-9	Water	3/31/2015 16:15	<input type="checkbox"/>	A	A											
1504116-010	MW-10	Water	3/31/2015 15:40	<input type="checkbox"/>	A	A											

**Test Legend:**

1	8260B_5OXYBTEX_W	2	8260GAS_W	3	PREDF REPORT	4		5	
6		7		8		9		10	
11		12							

The following SampIDs: 001A, 002A, 003A, 004A, 005A, 006A, 007A, 008A, 009A, 010A contain testgroup.

**Prepared by: Shana Carter**

**Comments:**

NOTE: Soil samples are discarded 60 days after results are reported unless other arrangements are made (Water samples are 30 days). Hazardous samples will be returned to client or disposed of at client expense.



## WORK ORDER SUMMARY

**Client Name:** AQUA SCIENCE ENGINEERS, INC.

**QC Level:** LEVEL 2

**Work Order:** 1504116

**Project:** #3934; Albany Hill Mini Mart

**Client Contact:** Robert Kitay

**Date Received:** 4/2/2015

**Comments:**

**Contact's Email:** rkitay@aquascienceengineers.com

WaterTrax     WriteOn     EDF     Excel     Fax     Email     HardCopy     ThirdParty     J-flag

Lab ID	Client ID	Matrix	Test Name	Containers /Composites	Bottle & Preservative	De-chlorinated	Collection Date & Time	TAT	Sediment Content	Hold	SubOut
1504116-001A	MW-1	Water	TPH(g) & BTEX & 5-Oxys by 8260B	5	VOA w/ HCl	<input type="checkbox"/>	3/31/2015 13:10	5 days	Present	<input type="checkbox"/>	
1504116-002A	MW-2	Water	TPH(g) & BTEX & 5-Oxys by 8260B	5	VOA w/ HCl	<input type="checkbox"/>	3/31/2015 11:50	5 days	Present	<input type="checkbox"/>	
1504116-003A	MW-3	Water	TPH(g) & BTEX & 5-Oxys by 8260B	5	VOA w/ HCl	<input type="checkbox"/>	3/31/2015 12:30	5 days	Present	<input type="checkbox"/>	
1504116-004A	MW-4	Water	TPH(g) & BTEX & 5-Oxys by 8260B	5	VOA w/ HCl	<input type="checkbox"/>	3/31/2015 14:50	5 days	Present	<input type="checkbox"/>	
1504116-005A	MW-5R	Water	TPH(g) & BTEX & 5-Oxys by 8260B	5	VOA w/ HCl	<input type="checkbox"/>	3/31/2015 14:00	5 days	Present	<input type="checkbox"/>	
1504116-006A	MW-6	Water	TPH(g) & BTEX & 5-Oxys by 8260B	5	VOA w/ HCl	<input type="checkbox"/>	3/31/2015 16:00	5 days	Present	<input type="checkbox"/>	
1504116-007A	MW-7	Water	TPH(g) & BTEX & 5-Oxys by 8260B	5	VOA w/ HCl	<input type="checkbox"/>	3/31/2015 11:05	5 days	Present	<input type="checkbox"/>	
1504116-008A	MW-8	Water	TPH(g) & BTEX & 5-Oxys by 8260B	5	VOA w/ HCl	<input type="checkbox"/>	3/31/2015 9:30	5 days	Present	<input type="checkbox"/>	
1504116-009A	MW-9	Water	TPH(g) & BTEX & 5-Oxys by 8260B	5	VOA w/ HCl	<input type="checkbox"/>	3/31/2015 16:15	5 days	Present	<input type="checkbox"/>	
1504116-010A	MW-10	Water	TPH(g) & BTEX & 5-Oxys by 8260B	5	VOA w/ HCl	<input type="checkbox"/>	3/31/2015 15:40	5 days	Present	<input type="checkbox"/>	

**NOTES:** - STLC and TCLP extractions require 2 days to complete; therefore, all TATs begin after the extraction is completed (i.e., One-day TAT yields results in 3 days from sample submission).  
 - MAI assumes that all material present in the provided sampling container is considered part of the sample - MAI does not exclude any material from the sample prior to sample preparation unless requested in writing by the client.

Aqua Science Engineers, Inc.  
 55 Oak Court, Suite 220  
 Danville, CA 94526  
 (925) 820-9391  
 FAX (925) 837-4853

# Chain of Custody

1504116

PAGE 1 / 1

SAMPLER (SIGNATURE)

*Robert E. Kitzing*

PROJECT NAME

Albany Hill Mini Mart

JOB NO.

3934

ADDRESS

800 San Pablo Ave, Albany, CA

## ANALYSIS REQUEST

SPECIAL INSTRUCTIONS:

SAMPLE ID.	DATE	TIME	MATRIX	QUANTITY	TPH-GAS / MTBE & BTEX (EPA 5030/8015-8020)	TPH-DIESEL (EPA 3510/8015)	TPH-DIESEL & MOTOR OIL (EPA 3510/8015)	VOLATILE ORGANICS (EPA 624/8240/8260)	SEMI-VOLATILE ORGANICS (EPA 625/8270)	ORGANOCHLORINATED HERBICIDES (EPA 8151A)	LUFT METALS (5) (EPA 6010+7000)	Cadm 17 METALS (EPA 6010+7000)	PCBS (EPA 8082)	ORGANOCHLORINATED PESTICIDES (EPA 8081A)	FUEL OXYGENATES (EPA 8260)	Pb (TOTAL or DISSOLVED) (EPA 6010)	TPH-G, BTEX & 5 OXY's (EPA 8260) <i>+ naphthalene</i>	ARSENIC, LEAD & MERCURY (EPA 6010)	COMPOSITE	EDF	HOLD	
																						MW-1
MW-2		1150															X				X	
MW-3		1230															X				X	
MW-4		1450															X				X	
MW-5R		1400															X				X	
MW-6		1600															X				X	
MW-7		1105															X				X	
MW-8		930															X				X	
MW-9		1615															X				X	
MW-10		1540															X				X	

RELINQUISHED BY:

*Robert E. Kitzing*

(signature) (time)

Robert E. Kitzing (date)

Company-ASE, INC.

RECEIVED BY:

*Daniel Lora*

(signature) (time)

Daniel Lora 4/2/15 (date)

Company-

RELINQUISHED BY:

*Daniel Lora*

(signature) (time)

Daniel Lora 4/2/15 (date)

Company-

RECEIVED BY LABORATORY

*Shana Carter*

(signature) (time)

Shana Carter 4/2/15 (date)

Company- MAI

COMMENTS:

TURN AROUND TIME

STANDARD 24Hr 48Hr 72Hr

OTHER:





### Sample Receipt Checklist

Client Name: **Aqua Science Engineers, Inc.** Date and Time Received: **4/2/2015 8:59:29 PM**  
 Project Name: **#3934; Albany Hill Mini Mart** LogIn Reviewed by: **Shana Carter**  
 WorkOrder No: **1504116** Matrix: Water Carrier: Daniel (MAI Courier)

**Chain of Custody (COC) Information**

Chain of custody present? Yes  No   
 Chain of custody signed when relinquished and received? Yes  No   
 Chain of custody agrees with sample labels? Yes  No   
 Sample IDs noted by Client on COC? Yes  No   
 Date and Time of collection noted by Client on COC? Yes  No   
 Sampler's name noted on COC? Yes  No

**Sample Receipt Information**

Custody seals intact on shipping container/cooler? Yes  No  NA   
 Shipping container/cooler in good condition? Yes  No   
 Samples in proper containers/bottles? Yes  No   
 Sample containers intact? Yes  No   
 Sufficient sample volume for indicated test? Yes  No

**Sample Preservation and Hold Time (HT) Information**

All samples received within holding time? Yes  No   
 Sample/Temp Blank temperature Temp: 1°C NA   
 Water - VOA vials have zero headspace / no bubbles? Yes  No  NA   
 Sample labels checked for correct preservation? Yes  No   
 pH acceptable upon receipt (Metal: <2; 522: <4; 218.7: >8)? Yes  No  NA   
 Samples Received on Ice? Yes  No

(Ice Type: WET ICE )

**UCMR3 Samples:**

Total Chlorine tested and acceptable upon receipt for EPA 522? Yes  No  NA   
 Free Chlorine tested and acceptable upon receipt for EPA 218.7, 300.1, 537, 539? Yes  No  NA

\* NOTE: If the "No" box is checked, see comments below.

-----  
 Comments: