

**RECEIVED**

9:13 am, May 29, 2008

Alameda County  
Environmental Health



22 May 2008

Project No. 06-08-652

Mr. Paresh C. Khatri, Hazardous Materials Specialist  
Alameda County Environmental Health Services  
1131 Harbor Bay Parkway, Suite 250  
Alameda, California 94502-6577  
Submitted via email and ACEH FTP site

Re: Proposed Modifications to Ground-Water Monitoring and Sampling Schedule,  
Atlantic Richfield Company (a BP affiliated company) Station #608, 17601 Hesperian Blvd.,  
San Lorenzo, Alameda County, California; ACEH Case #RO0000255

Dear Mr. Khatri:

The purpose of this letter is to propose for your consideration modifications to the current ground-water monitoring and sampling schedule at Atlantic Richfield Company Station #608 (ACEH Case #RO0000255), located at 17601 Hesperian Blvd., San Lorenzo, California. In the letter dated 28 November 2007, ACEH authorized shutdown of the ground-water extraction and treatment system due to continued negligible remediation of residual low concentration ground-water contamination. In addition, contaminant concentrations in ground-water samples collected from the historic downgradient plume area have been quite low for some time. In fact, there are a significant number of wells from which contamination has not been detected during their long monitoring records. Although some of these wells may still be valuable from an ongoing but more limited monitoring perspective, Broadbent & Associates, Inc. (BAI) proposes that many of these wells be dropped from future monitoring altogether. This recommendation was initially submitted to you within the First Quarter 2008 Ground-Water Monitoring Report for Station #608 (BAI, 18 April 2008), and alluded to within the Fourth Quarter 2007 Ground-Water Monitoring and Remediation System Status Report for Station #608 (BAI, 29 January 2008).

To assist you with your evaluation, a map representing the well locations at Station #608 is provided as Drawing 1. Also provided as attachments are historic laboratory analytical results presented in Table 1 and Table 2. Attached Table 3 presents a summary of historic ground-water flow directions and gradients. Attached Table 4 presents the current sampling schedule. However, to more succinctly present our case for your evaluation, BAI has prepared a table summarizing proposed modifications by applicable well and location, recent or historic contaminant concentrations (if detected), the current sampling schedule of the applicable wells, and the sampling schedule changes that BAI and BP propose. In addition to the map provided as attached Drawing 1, locations of sampled wells are identified within the table as being in the Source Area (Source), Down-Gradient (DG), Upgradient (UG), or Cross-Gradient (CX). In several instances we have also indicated their relative distance from the source area as being relatively Close, Midrange, or Far downgradient within the historic ground-water contamination plume. To further assist in your review and evaluation, we have summarized recent or historic concentrations (as micrograms per Liter,  $\mu\text{g/L}$ ) or ND where Not Detected above their laboratory reporting limits. Proposed changes to the monitoring and sampling schedule are shown in the right column in bold italics.

**Proposed Modifications to Monitoring and Sampling Schedule  
Station #608, 17601 Hesperian Blvd., San Lorenzo, California**

Well	Location	Concentration Ranges	Current Schedule	Proposed Schedule
MW-9	Source/CX	Historically ND	Annual	<i>Discontinue</i>
MW-11	DG-Close	Historically ND	Annual	<i>Discontinue</i>
MW-14	DG/CX	Historically ND	Annual	<i>Discontinue</i>
MW-18	DG-Far	Historically ND	Annual	<i>Discontinue</i>
MW-21	DG-Far	Historically ND	Annual	<i>Discontinue</i>
MW-22	DG-Far	Historically ND	Annual	<i>Discontinue</i>
MW-23	DG-Far	Historically ND	Annual	<i>Discontinue</i>
MW-25	Source/UG	MTBE last year 2.8-6.0 µg/L	Quarterly	<i>Semi-Annual</i>
MW-26	DG/CX	Historically ND	Annual	<i>Discontinue</i>
642H	DG-Midrange	Historically ND	Quarterly	<i>Discontinue</i>
17372VM	DG-Midrange	Historically ND	Quarterly	<i>Discontinue</i>

Upon your review, we trust you will concur that the proposed modifications to the monitoring and sampling schedule will still be adequate to accurately represent subsurface conditions present at Station #608. Upon completion of your evaluation, the favor of a written reply or email would be appreciated. Should you have questions please do not hesitate to contact us at (530) 566-1400.

Sincerely,

BROADBENT & ASSOCIATES, INC.

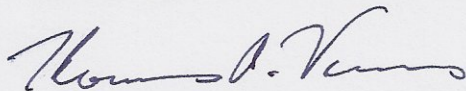

Thomas A. Venus, P.E.  
Senior Engineer



Robert H. Miller, P.G., C.HG.  
Principal Hydrogeologist

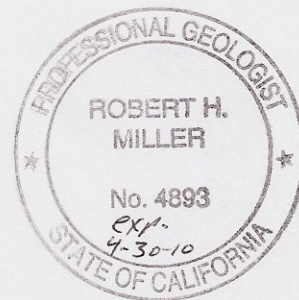

Attachments:

- Drawing 1. Ground-Water Elevation Contours and Analytical Summary Map, 10 March 2008
- Table 1. Summary of Ground-Water monitoring Data: Relative Water Elevations and Laboratory Analyses
- Table 2. Summary of Fuel Additives Analytical Data
- Table 3. Historical Ground-Water Flow Direction and Gradient
- Table 4. Ground-Water Sampling Schedule

cc: Mr. Paul Supple, Submitted via ENFOS  
Electronic copy uploaded to GeoTracker

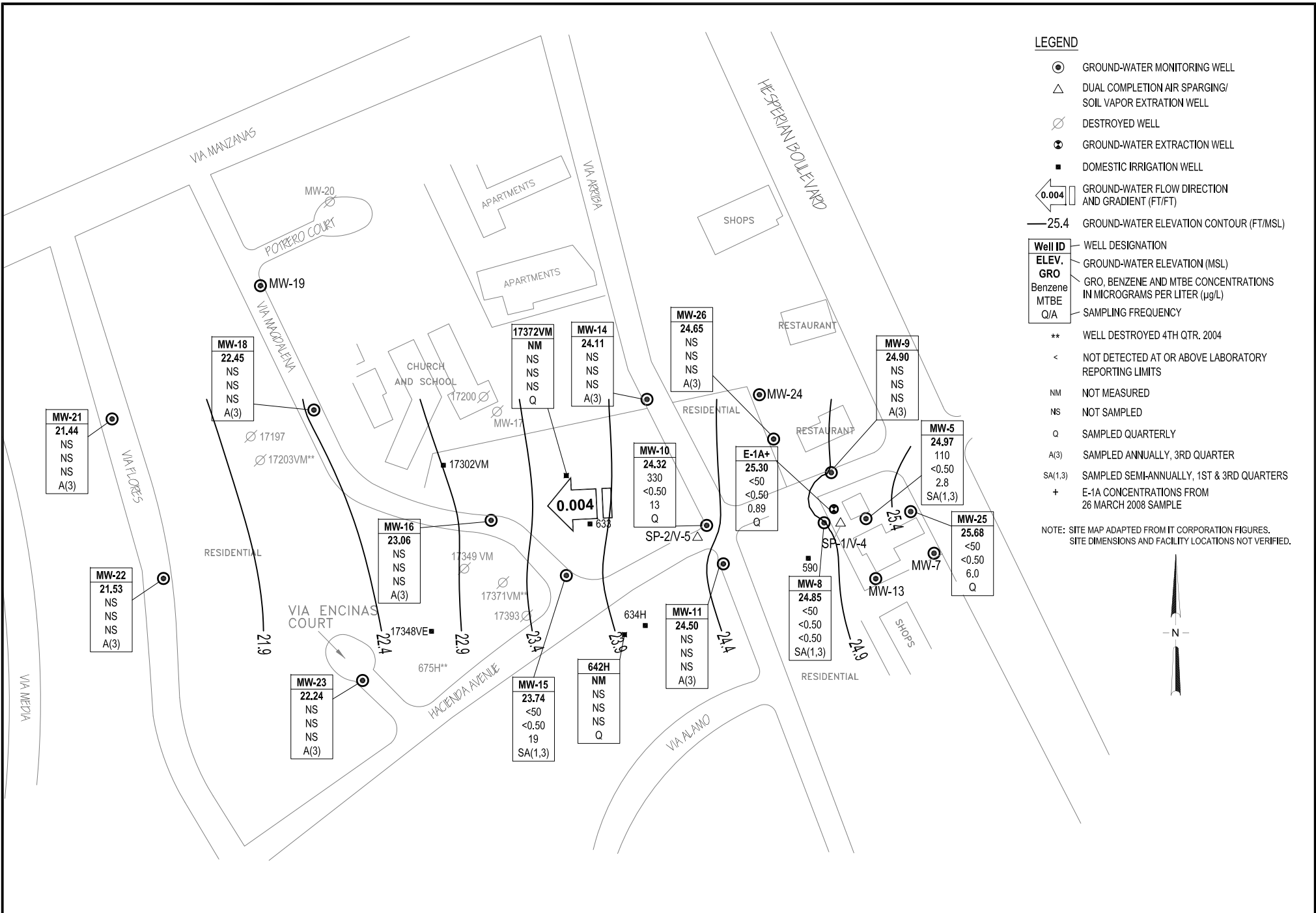

**BROADBENT & ASSOCIATES, INC.**  
 ENGINEERING, WATER RESOURCES & ENVIRONMENTAL  
 1324 Mangrove Ave. Suite 212, Chico, California 95926  
 Project No.: 06-08-606 Date: 4/3/08

ARCO Service Station #608  
 17601 Hesperian Boulevard  
 San Lorenzo, California

Ground-Water Elevation Contours  
 and Analytical Summary Map  
 10 March 2008

Drawing

1

**Table 1. Summary of Ground-Water Monitoring Data: Relative Water Elevations and Laboratory Analyses  
Station #608, 17601 Hesperian Boulevard, San Lorenzo, CA**

Well and Sample Date	P/NP	Comments	TOC (feet msl)	Top of Screen (ft bgs)	Bottom of Screen (ft bgs)	DTW (feet bgs)	Water Level Elevation (feet msl)	Concentrations in (µg/L)					DO (mg/L)	pH	
								GRO/TPHg	Benzene	Toluene	Ethyl-Benzene	Total Xylenes			MTBE
<b>17349 VM</b>															
3/13/2002	--		--	--	--	--	--	<50	1	<0.50	<0.50	<0.50	49	--	--
6/28/2002	--	l	--	--	--	--	--	66	0.50	<0.50	<0.50	<0.50	47/45	--	--
9/20/2002	--	k	--	--	--	--	--	--	--	--	--	--	--	--	--
<b>17372 VM</b>															
3/13/2002	--		--	--	--	--	--	<50	<0.50	<0.50	<0.50	<0.50	<2.5	--	--
6/28/2002	--		--	--	--	--	--	<50	<0.50	<0.50	<0.50	<0.50	<2.5	--	--
9/20/2002	--		--	--	--	--	--	<50	<0.50	<0.50	<0.50	<0.50	<2.5	--	--
12/30/2002	--		--	--	--	--	--	<50	<0.50	<0.50	<0.50	<0.50	<2.5	--	--
3/27/2003	--		--	--	--	--	--	<50	<0.50	<0.50	<0.50	<0.50	<0.50	--	--
9/15/2003	--		--	--	--	--	--	<50	<0.50	<0.50	<0.50	<0.50	<0.50	--	--
12/04/2003	NP		--	--	--	--	--	<50	<0.50	<0.50	<0.50	<0.50	<0.50	4.7	7.2
03/10/2004	--	m	--	--	--	--	--	<50	<0.50	<0.50	<0.50	<0.50	<0.50	--	--
06/10/2004	NP	m	--	--	--	--	--	<50	<0.50	<0.50	<0.50	<0.50	<0.50	4.1	6.9
09/22/2004	NP	m	--	--	--	--	--	<50	<0.50	<0.50	<0.50	<0.50	<0.50	3.6	7.2
12/13/2004	NP	m	--	--	--	--	--	<50	<0.50	<0.50	<0.50	<0.50	<0.50	3.76	7.6
03/10/2005	NP	m	--	--	--	--	--	<100	<0.50	<0.50	<0.50	<4.0	<0.50	7.5	8.0
06/29/2005	--	o	--	--	--	--	--	--	--	--	--	--	--	--	--
09/14/2005	--	o	--	--	--	--	--	--	--	--	--	--	--	--	--
12/13/2005	--	o	--	--	--	--	--	--	--	--	--	--	--	--	--
03/20/2006	--	o	--	--	--	--	--	--	--	--	--	--	--	--	--
6/22/2006	--	o	--	--	--	--	--	--	--	--	--	--	--	--	--
9/22/2006	--	o	--	--	--	--	--	--	--	--	--	--	--	--	--
12/7/2006	--	j	--	--	--	--	--	--	--	--	--	--	--	--	--
<b>642 H</b>															
3/13/2002	--	j	--	--	--	--	--	--	--	--	--	--	--	--	--
6/28/2002	--		--	--	--	--	--	<50	<0.50	<0.50	<0.50	<0.50	<2.5	--	--
9/20/2002	--		--	--	--	--	--	<50	<0.50	<0.50	<0.50	<0.50	<2.5	--	--
12/30/2002	--		--	--	--	--	--	<50	<0.50	<0.50	<0.50	<0.50	<2.5	--	--
3/27/2003	--		--	--	--	--	--	<50	<0.50	<0.50	<0.50	<0.50	<0.50	--	--

**Table 1. Summary of Ground-Water Monitoring Data: Relative Water Elevations and Laboratory Analyses**

**Station #608, 17601 Hesperian Boulevard, San Lorenzo, CA**

Well and Sample Date	P/NP	Comments	TOC (feet msl)	Top of Screen (ft bgs)	Bottom of Screen (ft bgs)	DTW (feet bgs)	Water Level Elevation (feet msl)	Concentrations in (µg/L)						DO (mg/L)	pH
								GRO/TPHg	Benzene	Toluene	Ethyl-Benzene	Total Xylenes	MTBE		
<b>642 H Cont.</b>															
6/30/2003	--	j	--	--	--	--	--	--	--	--	--	--	--	--	--
9/15/2003	--		--	--	--	--	--	<50	<0.50	<0.50	<0.50	<0.50	<0.50	--	--
12/04/2003	NP		--	--	--	14.75	--	<50	<0.50	<0.50	<0.50	<0.50	<0.50	3.2	7.1
06/10/2004	--	n	--	--	--	--	--	--	--	--	--	--	--	7.9	--
09/22/2004	--	o	--	--	--	--	--	--	--	--	--	--	--	--	--
12/13/2004	--	o	--	--	--	--	--	--	--	--	--	--	--	--	--
03/10/2005	--	n	--	--	--	--	--	--	--	--	--	--	--	--	--
06/29/2005	--	n	--	--	--	--	--	--	--	--	--	--	--	--	--
09/14/2005	--	n	--	--	--	--	--	--	--	--	--	--	--	--	--
12/13/2005	--	o	--	--	--	--	--	--	--	--	--	--	--	--	--
03/20/2006	--	o	--	--	--	--	--	--	--	--	--	--	--	--	--
6/22/2006	--	j	--	--	--	--	--	--	--	--	--	--	--	--	--
9/22/2006	--	j	--	--	--	--	--	--	--	--	--	--	--	--	--
12/7/2006	--	j	--	--	--	--	--	--	--	--	--	--	--	--	--
<b>E-1A</b>															
3/13/2002	--	a	33.06	--	--	21.75	11.31	200	<0.50	<0.50	<0.50	<0.50	310	--	--
6/28/2002	--	b	33.06	--	--	11.22	21.84	260	<0.50	11	1.2	1.2	150	--	--
9/20/2002	--		33.06	--	--	11.80	21.26	250	1.18	0.52	<0.5	<1.5	218	--	--
12/30/2002	--	c, e	33.06	--	--	16.33	16.73	190	<1.2	<1.2	<1.2	<1.2	190	--	--
3/27/2003	--	g	33.06	--	--	13.63	19.43	96	<0.50	<0.50	<0.50	<0.50	60	--	--
6/30/2003	P	h	33.06	--	--	9.60	23.46	140	<0.50	<0.50	<0.50	<0.50	37	--	--
9/15/2003	P	g	33.06	--	--	17.80	15.26	83	<0.50	<0.50	<0.50	<0.50	49	--	--
12/04/2003	NP	g	33.06	--	--	18.73	14.33	<50	<0.50	<0.50	<0.50	<0.50	19	4.3	7.0
03/10/2004	NP	g	34.30	--	--	16.78	17.52	<100	<1.0	<1.0	<1.0	<1.0	38	4.9	7.2
06/10/2004	NP	g, p	34.30	--	--	16.67	17.63	74	<0.50	<0.50	<0.50	<0.50	46	2.0	6.7
09/22/2004	NP		34.30	--	--	18.46	15.84	<50	<0.50	<0.50	<0.50	<0.50	17	--	7.0
12/13/2004	NP		34.30	--	--	17.56	16.74	<50	<0.50	<0.50	<0.50	<0.50	15	7.13	6.9
03/10/2005	NP		34.30	--	--	14.60	19.70	<100	<0.50	<0.50	<0.50	<4.0	22	6.6	8.0
06/29/2005	NP		34.30	--	--	15.13	19.17	<50	<0.50	0.91	<0.50	<0.50	14	6.73	7.3
09/14/2005	NP		34.30	--	--	16.90	17.40	<50	<0.50	<0.50	<0.50	<0.50	13	5.4	6.7

**Table 1. Summary of Ground-Water Monitoring Data: Relative Water Elevations and Laboratory Analyses**

**Station #608, 17601 Hesperian Boulevard, San Lorenzo, CA**

Well and Sample Date	P/NP	Comments	TOC (feet msl)	Top of Screen (ft bgs)	Bottom of Screen (ft bgs)	DTW (feet bgs)	Water Level Elevation (feet msl)	Concentrations in (µg/L)						DO (mg/L)	pH
								GRO/TPHg	Benzene	Toluene	Ethyl-Benzene	Total Xylenes	MTBE		
<b>E-1A Cont.</b>															
12/13/2005	NP		34.30	--	--	18.84	15.46	<50	<0.50	<0.50	<0.50	<0.50	12	8.3	7.1
03/20/2006	--	h	34.30	--	--	13.55	20.75	--	--	--	--	--	--	--	--
6/22/2006	NP		34.30	--	--	13.82	20.48	<50	<0.50	<0.50	<0.50	<0.50	13	5.2	7.5
9/22/2006	P		34.30	--	--	14.22	20.08	<50	<0.50	<0.50	<0.50	<0.50	12	2.65	7.7
12/7/2006	--	j	34.30	--	--	--	--	--	--	--	--	--	--	--	--
3/12/2007	P		34.30	--	--	11.72	22.58	61	<0.50	<0.50	<0.50	<0.50	5.6	--	--
6/20/2007	NP		34.30	--	--	18.71	15.59	<50	<0.50	<0.50	<0.50	<0.50	6.8	3.40	7.35
9/20/2007	NP		34.30	--	--	10.20	24.10	<50	<0.50	<0.50	<0.50	<0.50	0.80	1.21	7.47
12/14/2007	P		34.30	--	--	9.77	24.53	<50	<0.50	<0.50	<0.50	<0.50	2.0	2.87	7.27
<b>3/10/2008</b>	<b>NP</b>		<b>34.30</b>	<b>--</b>	<b>--</b>	<b>9.00</b>	<b>25.30</b>	<b>&lt;50</b>	<b>&lt;0.50</b>	<b>&lt;0.50</b>	<b>&lt;0.50</b>	<b>&lt;0.50</b>	<b>&lt;0.50</b>	<b>1.43</b>	<b>7.11</b>
<b>3/26/2008</b>	<b>P</b>	<b>s</b>	<b>34.30</b>	<b>--</b>	<b>--</b>	<b>9.21</b>	<b>25.09</b>	<b>&lt;50</b>	<b>&lt;0.50</b>	<b>&lt;0.50</b>	<b>&lt;0.50</b>	<b>&lt;0.50</b>	<b>0.89</b>	<b>4.20</b>	<b>7.26</b>
<b>MW-1</b>															
3/15/1996	--		175.04	--	--	14.24	160.80	--	--	--	--	--	--	--	--
<b>MW-5</b>															
3/13/2002	--		33.99	--	--	11.46	22.53	530	<2.5	<2.5	<2.5	<2.5	230	--	--
6/28/2002	--	b	33.99	--	--	11.75	22.24	180	<1.0	2.6	<1.0	1.2	230	--	--
9/20/2002	--		33.99	--	--	12.15	21.84	<50	<0.50	<0.50	<0.50	<1.50	333	--	--
12/30/2002	--		33.99	--	--	9.73	24.26	<50	<0.50	<0.50	<0.50	<0.50	<2.5	--	--
3/27/2003	--		33.99	--	--	11.24	22.75	100	<0.50	<0.50	<0.50	<0.50	59	--	--
6/30/2003	--		33.99	--	--	11.62	22.37	91	<0.50	<0.50	<0.50	<0.50	58	--	--
9/15/2003	--		33.99	--	--	12.13	21.86	<250	<2.5	<2.5	<2.5	<2.5	61	--	--
12/04/2003	P		33.99	--	--	11.85	22.14	81	<0.50	<0.50	<0.50	<0.50	42	1.7	7.0
03/10/2004	P		35.97	--	--	10.34	25.63	<50	<0.50	<0.50	<0.50	<0.50	9.5	1.2	6.6
06/10/2004	P		35.97	--	--	11.65	24.32	55	<0.50	<0.50	<0.50	<0.50	31	1.3	7.0
09/22/2004	P		35.97	--	--	12.23	23.74	<50	<0.50	<0.50	<0.50	<0.50	15	0.8	6.8
12/13/2004	P		35.97	--	--	11.16	24.81	<50	<0.50	<0.50	<0.50	<0.50	5.4	3.76	6.8
03/10/2005	P		35.97	--	--	9.90	26.07	<100	<0.50	<0.50	<0.50	<4.0	3.3	2.6	7.7
06/29/2005	P		35.97	--	--	11.35	24.62	<50	<0.50	<0.50	<0.50	<0.50	6.7	0.93	6.6
09/14/2005	P		35.97	--	--	11.80	24.17	<50	<0.50	0.91	<0.50	0.68	13	0.8	6.9

**Table 1. Summary of Ground-Water Monitoring Data: Relative Water Elevations and Laboratory Analyses**  
**Station #608, 17601 Hesperian Boulevard, San Lorenzo, CA**

Well and Sample Date	P/NP	Comments	TOC (feet msl)	Top of Screen (ft bgs)	Bottom of Screen (ft bgs)	DTW (feet bgs)	Water Level Elevation (feet msl)	Concentrations in (µg/L)						DO (mg/L)	pH
								GRO/TPHg	Benzene	Toluene	Ethyl-Benzene	Total Xylenes	MTBE		
<b>MW-5 Cont.</b>															
12/13/2005	--		35.97	--	--	11.60	24.37	--	--	--	--	--	--	--	--
03/20/2006	P		35.97	--	--	10.04	25.93	<50	<0.50	<0.50	<0.50	<0.50	3.8	0.8	7.1
6/22/2006	--		35.97	--	--	11.33	24.64	--	--	--	--	--	--	--	--
9/22/2006	P		35.97	--	--	11.57	24.40	<50	<0.50	<0.50	<0.50	<0.50	12	1.12	7.1
12/7/2006	--		35.97	--	--	11.71	24.26	--	--	--	--	--	--	--	--
3/12/2007	P		35.97	--	--	10.86	25.11	<50	<0.50	0.60	<0.50	<0.50	5.8	2.55	7.17
6/20/2007	--		35.97	--	--	11.82	24.15	--	--	--	--	--	--	--	--
9/20/2007	NP		35.97	--	--	12.20	23.77	<50	<0.50	0.77	<0.50	<0.50	4.3	1.18	7.30
12/14/2007	--		35.97	--	--	12.27	23.70	--	--	--	--	--	--	--	--
<b>3/10/2008</b>	<b>P</b>		<b>35.97</b>	<b>--</b>	<b>--</b>	<b>11.00</b>	<b>24.97</b>	<b>110</b>	<b>&lt;0.50</b>	<b>&lt;0.50</b>	<b>&lt;0.50</b>	<b>&lt;0.50</b>	<b>2.8</b>	<b>0.95</b>	<b>6.95</b>
<b>MW-8</b>															
3/13/2002	--		32.79	--	--	10.30	22.49	500	<2.5	<2.5	<2.5	<2.5	1,100	--	--
6/28/2002	--	b	32.79	--	--	10.30	22.49	150	<0.50	2.9	0.54	1.5	130	--	--
9/20/2002	--		32.79	--	--	10.84	21.95	<50	<0.50	<0.50	<0.50	<1.50	273	--	--
12/30/2002	--		32.79	--	--	8.31	24.48	<50	<0.50	<0.50	<0.50	<0.50	5.5	--	--
3/27/2003	--		32.79	--	--	9.85	22.94	63	<0.50	<0.50	<0.50	<0.50	33	--	--
6/30/2003	--		32.79	--	--	10.20	22.59	<50	<0.50	<0.50	<0.50	<0.50	15	--	--
9/15/2003	--		32.79	--	--	10.69	22.10	59	<0.50	<0.50	<0.50	<0.50	41	--	--
12/04/2003	P		32.79	--	--	10.43	22.36	<50	<0.50	<0.50	<0.50	<0.50	24	1.0	7.0
03/10/2004	P		34.47	--	--	9.04	25.43	<50	<0.50	<0.50	<0.50	<0.50	2.4	0.9	6.8
06/10/2004	P		34.47	--	--	10.40	24.07	<50	<0.50	<0.50	<0.50	<0.50	2.1	0.6	7.0
09/22/2004	P		34.47	--	--	10.74	23.73	84	<0.50	<0.50	<0.50	<0.50	18	0.9	6.9
12/13/2004	P		34.47	--	--	9.73	24.74	<50	<0.50	<0.50	<0.50	<0.50	7.1	0.95	6.8
03/10/2005	P		34.47	--	--	8.17	26.30	<100	<0.50	<0.50	<0.50	<4.0	1.4	2.0	7.4
06/29/2005	P		34.47	--	--	9.93	24.54	<50	<0.50	<0.50	<0.50	<0.50	1.7	1.72	7.0
09/14/2005	P		34.47	--	--	10.35	24.12	<50	<0.50	<0.50	<0.50	<0.50	<0.50	0.9	7.0
12/13/2005	--		34.47	--	--	10.18	24.29	--	--	--	--	--	--	--	--
03/20/2006	P		34.47	--	--	8.65	25.82	<50	<0.50	<0.50	<0.50	<0.50	0.60	1.8	7.1
6/22/2006	--		34.47	--	--	9.91	24.56	--	--	--	--	--	--	--	--
9/22/2006	P		34.47	--	--	10.25	24.22	<50	<0.50	<0.50	<0.50	<0.50	<0.50	3.10	7.0

**Table 1. Summary of Ground-Water Monitoring Data: Relative Water Elevations and Laboratory Analyses**  
**Station #608, 17601 Hesperian Boulevard, San Lorenzo, CA**

Well and Sample Date	P/NP	Comments	TOC (feet msl)	Top of Screen (ft bgs)	Bottom of Screen (ft bgs)	DTW (feet bgs)	Water Level Elevation (feet msl)	Concentrations in (µg/L)						DO (mg/L)	pH
								GRO/TPHg	Benzene	Toluene	Ethyl-Benzene	Total Xylenes	MTBE		
<b>MW-8 Cont.</b>															
12/7/2006	--		34.47	--	--	10.21	24.26	--	--	--	--	--	--	--	--
3/12/2007	P		34.47	--	--	9.46	25.01	<50	<0.50	<0.50	<0.50	<0.50	<0.50	1.96	7.54
6/20/2007	--		34.47	--	--	10.39	24.08	--	--	--	--	--	--	--	--
9/20/2007	P		34.47	--	--	10.75	23.72	<50	<0.50	<0.50	<0.50	<0.50	13	2.19	7.49
12/14/2007	--		34.47	--	--	10.71	23.76	--	--	--	--	--	--	--	--
<b>3/10/2008</b>	<b>P</b>		<b>34.47</b>	--	--	<b>9.62</b>	<b>24.85</b>	<b>&lt;50</b>	<b>&lt;0.50</b>	<b>&lt;0.50</b>	<b>&lt;0.50</b>	<b>&lt;0.50</b>	<b>&lt;0.50</b>	<b>0.67</b>	<b>7.08</b>
<b>MW-9</b>															
3/13/2002	--		32.11	--	--	9.49	22.62	<50	<0.50	<0.50	<0.50	<0.50	<2.5	--	--
6/28/2002	--		32.11	--	--	9.78	22.33	<50	<0.50	<0.50	<0.50	<0.50	<2.5	--	--
9/20/2002	--		32.11	--	--	10.29	21.82	<50	<0.50	<0.50	<0.50	<1.50	<0.500	--	--
12/30/2002	--		32.11	--	--	7.60	24.51	<50	<0.50	<0.50	<0.50	<0.50	<2.5	--	--
3/27/2003	--		32.11	--	--	9.14	22.97	<50	<0.50	<0.50	<0.50	<0.50	<0.50	--	--
6/30/2003	--	u	32.11	--	--	9.64	22.47	--	--	--	--	--	--	--	--
9/15/2003	--		32.11	--	--	10.12	21.99	<50	<0.50	<0.50	<0.50	<0.50	<0.50	--	--
12/04/2003	--	u	32.11	--	--	--	--	--	--	--	--	--	--	--	--
03/10/2004	P		34.00	--	--	8.46	25.54	<50	<0.50	<0.50	<0.50	<0.50	<0.50	1.6	7.3
06/10/2004	--	u	34.00	--	--	9.88	24.12	--	--	--	--	--	--	--	--
09/22/2004	P		34.00	--	--	10.05	23.95	<50	<0.50	<0.50	<0.50	<0.50	<0.50	1.0	7.0
12/13/2004	--	u	34.00	--	--	9.17	24.83	--	--	--	--	--	--	--	--
03/10/2005	P		34.00	--	--	8.17	25.83	<100	<0.50	<0.50	<0.50	<4.0	<0.50	2.2	7.7
06/29/2005	--		34.00	--	--	9.28	24.72	--	--	--	--	--	--	--	--
09/14/2005	P		34.00	--	--	9.70	24.30	<50	<0.50	<0.50	<0.50	<0.50	<0.50	1.2	6.8
12/13/2005	--		34.00	--	--	9.64	24.36	--	--	--	--	--	--	--	--
03/20/2006	--		34.00	--	--	8.23	25.77	--	--	--	--	--	--	--	--
6/22/2006	--		34.00	--	--	9.37	24.63	--	--	--	--	--	--	--	--
9/22/2006	P		34.00	--	--	9.74	24.26	<50	<0.50	<0.50	<0.50	<0.50	<0.50	2.38	7.2
12/7/2006	--		34.00	--	--	9.67	24.33	--	--	--	--	--	--	--	--
3/12/2007	--		34.00	--	--	8.93	25.07	--	--	--	--	--	--	--	--
6/20/2007	--		34.00	--	--	9.88	24.12	--	--	--	--	--	--	--	--
9/20/2007	P		34.00	--	--	10.21	23.79	<50	<0.50	<0.50	<0.50	<0.50	<0.50	10.67	7.25



**Table 1. Summary of Ground-Water Monitoring Data: Relative Water Elevations and Laboratory Analyses**

**Station #608, 17601 Hesperian Boulevard, San Lorenzo, CA**

Well and Sample Date	P/NP	Comments	TOC (feet msl)	Top of Screen (ft bgs)	Bottom of Screen (ft bgs)	DTW (feet bgs)	Water Level Elevation (feet msl)	Concentrations in (µg/L)						DO (mg/L)	pH
								GRO/TPHg	Benzene	Toluene	Ethyl-Benzene	Total Xylenes	MTBE		
<b>MW-9 Cont.</b>															
12/14/2007	--		34.00	--	--	10.28	23.72	--	--	--	--	--	--	--	--
<b>3/10/2008</b>	<b>--</b>		<b>34.00</b>	<b>--</b>	<b>--</b>	<b>9.10</b>	<b>24.90</b>	<b>--</b>	<b>--</b>	<b>--</b>	<b>--</b>	<b>--</b>	<b>--</b>	<b>--</b>	<b>--</b>
<b>MW-10</b>															
3/13/2002	--		31.67	--	--	9.68	21.99	680	<5.0	<5.0	<5.0	<5.0	570	--	--
6/28/2002	--	b	31.67	--	--	9.84	21.83	820	<2.0	<2.0	<2.0	<2.0	1,200	--	--
9/20/2002	--		31.67	--	--	10.37	21.30	194	<0.50	<0.50	<0.50	<1.50	575	--	--
12/30/2002	--		31.67	--	--	7.70	23.97	<50	<0.50	<0.50	<0.50	<0.50	490	--	--
3/27/2003	--		31.67	--	--	9.33	22.34	530	<5.0	<5.0	<5.0	<5.0	330	--	--
6/30/2003	--		31.67	--	--	9.75	21.92	<1,000	<10	<10	<10	<10	750	--	--
9/15/2003	P		31.67	--	--	10.17	21.50	<500	<5.0	<5.0	<5.0	<5.0	430	--	--
12/04/2003	P		31.67	--	--	9.95	21.72	<250	<2.5	<2.5	<2.5	<2.5	110	--	6.9
03/10/2004	P		33.50	--	--	8.57	24.93	420	<2.5	<2.5	<2.5	<2.5	140	1.2	6.5
06/10/2004	--		33.50	--	--	9.95	23.55	600	<5.0	<5.0	<5.0	<5.0	410	--	6.9
09/22/2004	P		33.50	--	--	10.23	23.27	560	<0.50	<0.50	<0.50	<0.50	87	0.8	6.9
12/13/2004	P		33.50	--	--	9.28	24.22	290	<1.0	<1.0	<1.0	<1.0	110	1.6	6.5
03/10/2005	P		33.50	--	--	7.97	25.53	280	<0.50	<0.50	<0.50	<4.0	86	3.2	7.3
06/29/2005	P		33.50	--	--	9.45	24.05	<250	<2.5	<2.5	<2.5	<2.5	160	1.13	6.8
09/14/2005	P		33.50	--	--	9.92	23.58	340	<2.5	<2.5	<2.5	<2.5	140	0.7	6.9
12/13/2005	P		33.50	--	--	9.73	23.77	270	<0.50	<0.50	<0.50	<0.50	47	1.8	6.5
03/20/2006	P		33.50	--	--	8.17	25.33	270	<0.50	<0.50	<0.50	<0.50	34	1.1	6.9
6/22/2006	P		33.50	--	--	9.42	24.08	250	<0.50	<0.50	<0.50	<0.50	21	1.74	7.0
9/22/2006	P		33.50	--	--	9.88	23.62	270	<0.50	<0.50	<0.50	<0.50	11	1.39	7.0
12/7/2006	P		33.50	--	--	9.78	23.72	360	<0.50	<0.50	<0.50	<0.50	10	0.89	7.10
3/12/2007	P		33.50	--	--	9.00	24.50	300	<0.50	<0.50	<0.50	<0.50	18	0.98	7.25
6/20/2007	P		33.50	--	--	9.94	23.56	300	<0.50	<0.50	<0.50	<0.50	5.9	6.47	7.18
9/20/2007	P		33.50	--	--	10.24	23.26	250	<0.50	<0.50	<0.50	<0.50	4.6	2.46	7.29
12/14/2007	P		33.50	--	--	9.90	23.60	280	<0.50	<0.50	<0.50	<0.50	6.9	1.80	6.98
<b>3/10/2008</b>	<b>P</b>		<b>33.50</b>	<b>--</b>	<b>--</b>	<b>9.18</b>	<b>24.32</b>	<b>330</b>	<b>&lt;0.50</b>	<b>&lt;0.50</b>	<b>&lt;0.50</b>	<b>&lt;0.50</b>	<b>13</b>	<b>0.27</b>	<b>6.88</b>
<b>MW-11</b>															

**Table 1. Summary of Ground-Water Monitoring Data: Relative Water Elevations and Laboratory Analyses**  
**Station #608, 17601 Hesperian Boulevard, San Lorenzo, CA**

Well and Sample Date	P/NP	Comments	TOC (feet msl)	Top of Screen (ft bgs)	Bottom of Screen (ft bgs)	DTW (feet bgs)	Water Level Elevation (feet msl)	Concentrations in (µg/L)						DO (mg/L)	pH
								GRO/TPHg	Benzene	Toluene	Ethyl-Benzene	Total Xylenes	MTBE		
<b>MW-11 Cont.</b>															
3/13/2002	--		32.54	--	--	10.38	22.16	<50	<0.50	<0.50	<0.50	<0.50	<2.5	--	--
6/28/2002	--		32.54	--	--	10.74	21.80	<50	<0.50	<0.50	<0.50	<0.50	<2.5	--	--
9/20/2002	--		32.54	--	--	11.27	21.27	<50	<0.50	<0.50	<0.50	<1.50	<0.500	--	--
12/30/2002	--		32.54	--	--	8.73	23.81	<50	<0.50	<0.50	<0.50	<0.50	<2.5	--	--
3/27/2003	--		32.54	--	--	10.25	22.29	<50	<0.50	<0.50	<0.50	<0.50	<0.50	--	--
6/30/2003	--		32.54	--	--	10.65	21.89	<50	<0.50	<0.50	<0.50	<0.50	<0.50	--	--
9/15/2003	--		32.54	--	--	11.03	21.51	<50	<0.50	<0.50	<0.50	<0.50	<0.50	--	--
12/04/2003	P		32.54	--	--	10.84	21.70	<50	<0.50	<0.50	<0.50	<0.50	<0.50	1.5	7.0
03/10/2004	P		34.55	--	--	9.41	25.14	<50	<0.50	<0.50	<0.50	<0.50	<0.50	1.3	6.9
06/10/2004	--		34.55	--	--	10.82	23.73	<50	<0.50	<0.50	<0.50	<0.50	<0.50	--	6.9
09/22/2004	P		34.55	--	--	11.10	23.45	<50	<0.50	<0.50	<0.50	<0.50	<0.50	1.2	6.9
12/13/2004	P		34.55	--	--	10.19	24.36	<50	<0.50	<0.50	<0.50	<0.50	<0.50	1.83	6.6
03/10/2005	P		34.55	--	--	8.87	25.68	<100	<0.50	<0.50	<0.50	<4.0	<0.50	2.3	7.7
06/29/2005	P		34.55	--	--	10.37	24.18	<50	<0.50	<0.50	<0.50	<0.50	<0.50	0.83	6.3
09/14/2005	P		34.55	--	--	10.78	23.77	<50	<0.50	<0.50	<0.50	<0.50	<0.50	0.8	6.9
12/13/2005	--		34.55	--	--	10.62	23.93	--	--	--	--	--	--	--	--
03/20/2006	--		34.55	--	--	9.04	25.51	--	--	--	--	--	--	--	--
6/22/2006	--		34.55	--	--	10.33	24.22	--	--	--	--	--	--	--	--
9/22/2006	P		34.55	--	--	10.75	23.80	<50	<0.50	<0.50	<0.50	<0.50	<0.50	1.53	7.2
12/7/2006	--		34.55	--	--	10.68	23.87	--	--	--	--	--	--	--	--
3/12/2007	--		34.55	--	--	9.89	24.66	--	--	--	--	--	--	--	--
6/20/2007	--		34.55	--	--	10.84	23.71	--	--	--	--	--	--	--	--
9/20/2007	P		34.55	--	--	11.15	23.40	<50	<0.50	<0.50	<0.50	<0.50	<0.50	2.32	7.26
12/14/2007	--		34.55	--	--	11.10	23.45	--	--	--	--	--	--	--	--
<b>3/10/2008</b>	<b>--</b>		<b>34.55</b>	<b>--</b>	<b>--</b>	<b>10.05</b>	<b>24.50</b>	<b>--</b>	<b>--</b>	<b>--</b>	<b>--</b>	<b>--</b>	<b>--</b>	<b>--</b>	<b>--</b>
<b>MW-14</b>															
3/13/2002	--		30.46	--	--	8.56	21.90	<50	<0.50	<0.50	<0.50	<0.50	<2.5	--	--
6/28/2002	--	q	30.46	--	--	9.12	21.34	--	--	--	--	--	--	--	--
9/20/2002	--	q	30.46	--	--	9.79	20.67	--	--	--	--	--	--	--	--
12/30/2002	--	q	30.46	--	--	7.13	23.33	--	--	--	--	--	--	--	--

**Table 1. Summary of Ground-Water Monitoring Data: Relative Water Elevations and Laboratory Analyses**

**Station #608, 17601 Hesperian Boulevard, San Lorenzo, CA**

Well and Sample Date	P/NP	Comments	TOC (feet msl)	Top of Screen (ft bgs)	Bottom of Screen (ft bgs)	DTW (feet bgs)	Water Level Elevation (feet msl)	Concentrations in (µg/L)						DO (mg/L)	pH
								GRO/TPHg	Benzene	Toluene	Ethyl-Benzene	Total Xylenes	MTBE		
<b>MW-14 Cont.</b>															
3/27/2003	--		30.46	--	--	8.53	21.93	<50	<0.50	0.86	<0.50	<0.50	<0.50	--	--
6/30/2003	--	q	30.46	--	--	9.05	21.41	--	--	--	--	--	--	--	--
9/15/2003	--	q	30.46	--	--	9.47	20.99	--	--	--	--	--	--	--	--
12/04/2003	--	q	30.46	--	--	9.20	21.26	--	--	--	--	--	--	--	--
03/10/2004	--	q	32.61	--	--	7.90	24.71	--	--	--	--	--	--	--	--
06/10/2004	--	q	32.61	--	--	9.25	23.36	--	--	--	--	--	--	--	--
09/22/2004	P		32.61	--	--	9.55	23.06	<50	<0.50	<0.50	<0.50	<0.50	<0.50	1.1	--
12/13/2004	--		32.61	--	--	8.46	24.15	--	--	--	--	--	--	--	--
03/10/2005	--		32.61	--	--	7.32	25.29	--	--	--	--	--	--	--	--
06/29/2005	--		32.61	--	--	8.77	23.84	--	--	--	--	--	--	--	--
09/14/2005	P		32.61	--	--	9.20	23.41	<50	<0.50	<0.50	<0.50	<0.50	<0.50	0.9	6.9
12/13/2005	--		32.61	--	--	8.96	23.65	--	--	--	--	--	--	--	--
03/20/2006	--		32.61	--	--	7.51	25.10	--	--	--	--	--	--	--	--
6/22/2006	--		32.61	--	--	8.75	23.86	--	--	--	--	--	--	--	--
9/22/2006	P		32.61	--	--	9.19	23.42	<50	<0.50	<0.50	<0.50	<0.50	<0.50	1.70	7.2
12/7/2006	--		32.61	--	--	9.05	23.56	--	--	--	--	--	--	--	--
3/12/2007	--		32.61	--	--	8.35	24.26	--	--	--	--	--	--	--	--
6/20/2007	--		32.61	--	--	9.33	23.28	--	--	--	--	--	--	--	--
9/20/2007	P		32.61	--	--	9.60	23.01	<50	<0.50	<0.50	<0.50	<0.50	<0.50	3.24	7.42
12/14/2007	--		32.61	--	--	9.53	23.08	--	--	--	--	--	--	--	--
<b>3/10/2008</b>	<b>--</b>		<b>32.61</b>	<b>--</b>	<b>--</b>	<b>8.50</b>	<b>24.11</b>	<b>--</b>	<b>--</b>	<b>--</b>	<b>--</b>	<b>--</b>	<b>--</b>	<b>--</b>	<b>--</b>
<b>MW-15</b>															
3/13/2002	--		31.41	--	--	10.03	21.38	<50	<0.50	<0.50	<0.50	<0.50	21	--	--
6/28/2002	--		31.41	--	--	10.41	21.00	<50	<0.50	<0.50	<0.50	<0.50	8.7	--	--
9/20/2002	--		31.41	--	--	11.00	20.41	<50	<0.50	<0.50	<0.50	<1.50	21.6	--	--
12/30/2002	--		31.41	--	--	8.33	23.08	<50	<0.50	<0.50	<0.50	<0.50	67	--	--
3/27/2003	--		31.41	--	--	9.83	21.58	<50	<0.50	<0.50	<0.50	<0.50	17	--	--
6/30/2003	--		31.41	--	--	10.00	21.41	<50	<0.50	<0.50	<0.50	<0.50	12	--	--
9/15/2003	--		31.41	--	--	10.67	20.74	<50	<0.50	<0.50	<0.50	<0.50	10	--	--
12/04/2003	P		31.41	--	--	10.47	20.94	<50	<0.50	<0.50	<0.50	<0.50	6.4	2.6	7.0

**Table 1. Summary of Ground-Water Monitoring Data: Relative Water Elevations and Laboratory Analyses**

**Station #608, 17601 Hesperian Boulevard, San Lorenzo, CA**

Well and Sample Date	P/NP	Comments	TOC (feet msl)	Top of Screen (ft bgs)	Bottom of Screen (ft bgs)	DTW (feet bgs)	Water Level Elevation (feet msl)	Concentrations in (µg/L)					DO (mg/L)	pH	
								GRO/TPHg	Benzene	Toluene	Ethyl-Benzene	Total Xylenes			MTBE
<b>MW-15 Cont.</b>															
03/10/2004	P		33.49	--	--	9.09	24.40	<50	<0.50	<0.50	<0.50	<0.50	11	1.5	6.9
06/10/2004	P		33.49	--	--	10.50	22.99	<50	<0.50	<0.50	<0.50	<0.50	5.7	0.5	6.9
09/22/2004	--	r	33.49	--	--	--	--	--	--	--	--	--	--	--	--
12/13/2004	--	r	33.49	--	--	--	--	--	--	--	--	--	--	--	--
03/10/2005	P		33.49	--	--	8.50	24.99	<100	<0.50	<0.50	<0.50	<4.0	5.4	2.7	7.7
06/29/2005	--	r	33.49	--	--	--	--	--	--	--	--	--	--	--	--
09/14/2005	--	r	33.49	--	--	--	--	--	--	--	--	--	--	--	--
12/13/2005	--		33.49	--	--	10.16	23.33	--	--	--	--	--	--	--	--
03/20/2006	P		33.49	--	--	8.72	24.77	<50	<0.50	<0.50	<0.50	<0.50	15	3.1	7.3
6/22/2006	--		33.49	--	--	10.00	23.49	--	--	--	--	--	--	--	--
9/22/2006	--	j	--	--	--	--	--	--	--	--	--	--	--	--	--
12/7/2006	--		33.49	--	--	10.32	23.17	--	--	--	--	--	--	--	--
3/12/2007	--	j	33.49	--	--	9.60	23.89	--	--	--	--	--	--	--	--
6/20/2007	--		33.49	--	--	10.52	22.97	--	--	--	--	--	--	--	--
9/20/2007	P		33.49	--	--	10.83	22.66	<50	<0.50	<0.50	<0.50	<0.50	11	0.64	7.19
12/14/2007	--		33.49	--	--	10.78	22.71	--	--	--	--	--	--	--	--
<b>3/10/2008</b>	<b>P</b>		<b>33.49</b>	<b>--</b>	<b>--</b>	<b>9.75</b>	<b>23.74</b>	<b>&lt;50</b>	<b>&lt;0.50</b>	<b>&lt;0.50</b>	<b>&lt;0.50</b>	<b>&lt;0.50</b>	<b>19</b>	<b>0.72</b>	<b>6.88</b>
<b>MW-16</b>															
3/13/2002	--		31.39	--	--	10.51	20.88	<50	<0.50	<0.50	<0.50	<0.50	<2.5	--	--
6/28/2002	--		31.39	--	--	10.96	20.43	<50	<0.50	<0.50	<0.50	<0.50	<2.5	--	--
9/20/2002	--		31.39	--	--	10.47	20.92	<50	<0.50	<0.50	<0.50	<1.50	1.67	--	--
12/30/2002	--		31.39	--	--	--	--	--	--	--	--	--	--	--	--
3/27/2003	--		31.39	--	--	10.28	21.11	<50	<0.50	<0.50	<0.50	<0.50	<0.50	--	--
6/30/2003	--	i, q	31.39	--	--	10.87	20.52	--	--	--	--	--	--	--	--
9/15/2003	--		31.39	--	--	11.25	20.14	<50	<0.50	<0.50	<0.50	<0.50	<0.50	--	--
12/04/2003	--	u	31.39	--	--	10.99	20.40	--	--	--	--	--	--	--	--
03/10/2004	P		33.41	--	--	9.66	23.75	<50	<0.50	<0.50	<0.50	<0.50	<0.50	2.1	6.5
06/10/2004	--		33.41	--	--	11.06	22.35	--	--	--	--	--	--	--	--
09/22/2004	P		33.41	--	--	11.40	22.01	<50	<0.50	<0.50	<0.50	<0.50	<0.50	1.2	7.0
12/13/2004	--		33.41	--	--	10.27	23.14	--	--	--	--	--	--	--	--

**Table 1. Summary of Ground-Water Monitoring Data: Relative Water Elevations and Laboratory Analyses**  
**Station #608, 17601 Hesperian Boulevard, San Lorenzo, CA**

Well and Sample Date	P/NP	Comments	TOC (feet msl)	Top of Screen (ft bgs)	Bottom of Screen (ft bgs)	DTW (feet bgs)	Water Level Elevation (feet msl)	Concentrations in (µg/L)						DO (mg/L)	pH
								GRO/TPHg	Benzene	Toluene	Ethyl-Benzene	Total Xylenes	MTBE		
<b>MW-16 Cont.</b>															
03/10/2005	P		33.41	--	--	9.03	24.38	<100	<0.50	<0.50	<0.50	<4.0	<0.50	3.9	7.0
06/29/2005	--		33.41	--	--	10.60	22.81	--	--	--	--	--	--	--	--
09/14/2005	P		33.41	--	--	11.02	22.39	<50	<0.50	<0.50	<0.50	<0.50	<0.50	0.9	7.0
12/13/2005	--		33.41	--	--	10.79	22.62	--	--	--	--	--	--	--	--
03/20/2006	--		33.41	--	--	9.25	24.16	--	--	--	--	--	--	--	--
6/22/2006	--	r	33.41	--	--	--	--	--	--	--	--	--	--	--	--
9/22/2006	P		33.41	--	--	10.95	22.46	<50	<0.50	<0.50	<0.50	<0.50	<0.50	1.69	7.3
12/7/2006	--	r	33.41	--	--	--	--	--	--	--	--	--	--	--	--
3/12/2007	--		33.41	--	--	10.18	23.23	--	--	--	--	--	--	--	--
6/20/2007	--		33.41	--	--	11.10	22.31	--	--	--	--	--	--	--	--
9/20/2007	P		33.41	--	--	11.44	21.97	<50	<0.50	<0.50	<0.50	<0.50	<0.50	0.55	7.30
12/14/2007	--		33.41	--	--	11.41	22.00	--	--	--	--	--	--	--	--
<b>3/10/2008</b>	<b>--</b>		<b>33.41</b>	<b>--</b>	<b>--</b>	<b>10.35</b>	<b>23.06</b>	<b>--</b>	<b>--</b>	<b>--</b>	<b>--</b>	<b>--</b>	<b>--</b>	<b>--</b>	<b>--</b>
<b>MW-18</b>															
3/13/2002	--		29.70	--	--	9.46	20.24	<50	<0.50	<0.50	<0.50	<0.50	<2.5	--	--
6/28/2002	--	q	29.70	--	--	10.05	19.65	--	--	--	--	--	--	--	--
9/20/2002	--	q	29.70	--	--	10.67	19.03	--	--	--	--	--	--	--	--
12/30/2002	--	q	29.70	--	--	7.98	21.72	--	--	--	--	--	--	--	--
3/27/2003	--		29.70	--	--	9.18	20.52	<50	<0.50	<0.50	<0.50	<0.50	<0.50	--	--
6/30/2003	--	q	29.70	--	--	9.68	20.02	--	--	--	--	--	--	--	--
9/15/2003	--	q	29.70	--	--	10.30	19.40	--	--	--	--	--	--	--	--
12/04/2003	--	q	29.70	--	--	9.99	19.71	--	--	--	--	--	--	--	--
03/10/2004	--	q	31.87	--	--	8.78	23.09	--	--	--	--	--	--	--	--
06/10/2004	--	q	31.87	--	--	10.12	21.75	--	--	--	--	--	--	--	--
09/22/2004	P		31.87	--	--	10.45	21.42	<50	<0.50	<0.50	<0.50	<0.50	<0.50	1.1	6.9
12/13/2004	--		31.87	--	--	9.25	22.62	--	--	--	--	--	--	--	--
03/10/2005	--		31.87	--	--	8.35	23.52	--	--	--	--	--	--	--	--
06/29/2005	--		31.87	--	--	9.65	22.22	--	--	--	--	--	--	--	--
09/14/2005	P		31.87	--	--	10.10	21.77	<50	<0.50	<0.50	<0.50	<0.50	<0.50	1.1	6.9
12/13/2005	--		31.87	--	--	9.90	21.97	--	--	--	--	--	--	--	--

**Table 1. Summary of Ground-Water Monitoring Data: Relative Water Elevations and Laboratory Analyses  
Station #608, 17601 Hesperian Boulevard, San Lorenzo, CA**

Well and Sample Date	P/NP	Comments	TOC (feet msl)	Top of Screen (ft bgs)	Bottom of Screen (ft bgs)	DTW (feet bgs)	Water Level Elevation (feet msl)	Concentrations in (µg/L)						DO (mg/L)	pH
								GRO/TPHg	Benzene	Toluene	Ethyl-Benzene	Total Xylenes	MTBE		
<b>MW-18 Cont.</b>															
03/20/2006	--		31.87	--	--	8.54	23.33	--	--	--	--	--	--	--	--
6/22/2006	--		31.87	--	--	9.68	22.19	--	--	--	--	--	--	--	--
9/22/2006	P		31.87	--	--	9.96	21.91	<50	<0.50	<0.50	<0.50	<0.50	<0.50	1.23	7.2
12/7/2006	--		31.87	--	--	--	--	--	--	--	--	--	--	--	--
3/12/2007	--		31.87	--	--	9.28	22.59	--	--	--	--	--	--	--	--
6/20/2007	--		31.87	--	--	10.15	21.72	--	--	--	--	--	--	--	--
9/20/2007	P		31.87	--	--	10.45	21.42	<50	<0.50	<0.50	<0.50	<0.50	<0.50	1.14	7.22
12/14/2007	--		31.87	--	--	10.47	21.40	--	--	--	--	--	--	--	--
<b>3/10/2008</b>	<b>--</b>		<b>31.87</b>	<b>--</b>	<b>--</b>	<b>9.42</b>	<b>22.45</b>	<b>--</b>	<b>--</b>	<b>--</b>	<b>--</b>	<b>--</b>	<b>--</b>	<b>--</b>	<b>--</b>
<b>MW-21</b>															
3/13/2002	--		28.72	--	--	9.40	19.32	<50	<0.50	<0.50	<0.50	<0.50	<5.0	--	--
6/28/2002	--	q	28.72	--	--	9.80	18.92	--	--	--	--	--	--	--	--
9/20/2002	--	q	28.72	--	--	10.27	18.45	--	--	--	--	--	--	--	--
12/30/2002	--	q	28.72	--	--	7.70	21.02	--	--	--	--	--	--	--	--
3/27/2003	--		28.72	--	--	9.05	19.67	<50	<0.50	<0.50	<0.50	<0.50	<0.50	--	--
6/30/2003	--	q	28.72	--	--	9.48	19.24	--	--	--	--	--	--	--	--
9/15/2003	--	q	28.72	--	--	10.06	18.66	--	--	--	--	--	--	--	--
12/04/2003	--	q	28.72	--	--	9.69	19.03	--	--	--	--	--	--	--	--
03/10/2004	--	q	30.67	--	--	8.60	22.07	--	--	--	--	--	--	--	--
06/10/2004	--	q	30.67	--	--	9.85	20.82	--	--	--	--	--	--	--	--
09/22/2004	P		30.67	--	--	10.17	20.50	<50	<0.50	<0.50	<0.50	<0.50	<0.50	2.2	6.9
12/13/2004	--		30.67	--	--	8.92	21.75	--	--	--	--	--	--	--	--
03/10/2005	--		30.67	--	--	8.10	22.57	--	--	--	--	--	--	--	--
06/29/2005	--		30.67	--	--	9.48	21.19	--	--	--	--	--	--	--	--
09/14/2005	P		30.67	--	--	9.88	20.79	<50	<0.50	<0.50	<0.50	<0.50	<0.50	0.8	6.9
12/13/2005	--		30.67	--	--	9.57	21.10	--	--	--	--	--	--	--	--
03/20/2006	--		30.67	--	--	8.26	22.41	--	--	--	--	--	--	--	--
6/22/2006	--		30.67	--	--	9.47	21.20	--	--	--	--	--	--	--	--
9/22/2006	P		30.67	--	--	9.83	20.84	<50	<0.50	<0.50	<0.50	<0.50	<0.50	1.88	5.9
12/7/2006	--		30.67	--	--	9.76	20.91	--	--	--	--	--	--	--	--

**Table 1. Summary of Ground-Water Monitoring Data: Relative Water Elevations and Laboratory Analyses  
Station #608, 17601 Hesperian Boulevard, San Lorenzo, CA**

Well and Sample Date	P/NP	Comments	TOC (feet msl)	Top of Screen (ft bgs)	Bottom of Screen (ft bgs)	DTW (feet bgs)	Water Level Elevation (feet msl)	Concentrations in (µg/L)						DO (mg/L)	pH
								GRO/TPHg	Benzene	Toluene	Ethyl-Benzene	Total Xylenes	MTBE		
<b>MW-21 Cont.</b>															
3/12/2007	--		30.67	--	--	9.08	21.59	--	--	--	--	--	--	--	--
6/20/2007	--		30.67	--	--	9.89	20.78	--	--	--	--	--	--	--	--
9/20/2007	P		30.67	--	--	10.20	20.47	<50	<0.50	<0.50	<0.50	<0.50	<0.50	4.28	7.56
12/14/2007	--		30.67	--	--	10.18	20.49	--	--	--	--	--	--	--	--
<b>3/10/2008</b>	<b>--</b>		<b>30.67</b>	<b>--</b>	<b>--</b>	<b>9.23</b>	<b>21.44</b>	<b>--</b>	<b>--</b>	<b>--</b>	<b>--</b>	<b>--</b>	<b>--</b>	<b>--</b>	<b>--</b>
<b>MW-22</b>															
3/13/2002	--		29.29	--	--	9.86	19.43	<50	<0.50	<0.50	<0.50	<0.50	<2.5	--	--
6/28/2002	--		29.29	--	--	10.65	18.64	<50	<0.50	<0.50	<0.50	<0.50	<2.5	--	--
9/20/2002	--		29.29	--	--	11.05	18.24	<50	<0.50	<0.50	<0.50	<1.50	<0.500	--	--
12/30/2002	--		29.29	--	--	8.28	21.01	<50	<0.50	<0.50	<0.50	<0.50	<2.5	--	--
3/27/2003	--		29.29	--	--	9.85	19.44	<50	<0.50	<0.50	<0.50	<0.50	<0.50	--	--
6/30/2003	--	i, q	29.29	--	--	10.20	19.09	--	--	--	--	--	--	--	--
9/15/2003	--		29.29	--	--	10.81	18.48	<500	<5.0	<5.0	<5.0	<5.0	<5.0	--	--
12/04/2003	--		29.29	--	--	10.49	18.80	--	--	--	--	--	--	--	--
03/10/2004	P		31.43	--	--	9.24	22.19	<50	<0.50	<0.50	<0.50	<0.50	<0.50	2.3	6.6
06/10/2004	--		31.43	--	--	10.60	20.83	--	--	--	--	--	--	--	--
09/22/2004	P		31.43	--	--	10.94	20.49	<50	<0.50	<0.50	<0.50	<0.50	<0.50	0.9	7.0
12/13/2004	--		31.43	--	--	9.73	21.70	--	--	--	--	--	--	--	--
03/10/2005	P		31.43	--	--	8.65	22.78	<100	<0.50	<0.50	<0.50	<4.0	<0.50	3.3	7.4
06/29/2005	--		31.43	--	--	10.25	21.18	--	--	--	--	--	--	--	--
09/14/2005	P		31.43	--	--	10.65	20.78	<50	<0.50	<0.50	<0.50	<0.50	<0.50	1.0	7.0
12/13/2005	--		31.43	--	--	10.39	21.04	--	--	--	--	--	--	--	--
03/20/2006	--		31.43	--	--	8.89	22.54	--	--	--	--	--	--	--	--
6/22/2006	--		31.43	--	--	10.21	21.22	--	--	--	--	--	--	--	--
9/22/2006	P		31.43	--	--	10.62	20.81	<50	<0.50	<0.50	<0.50	<0.50	<0.50	2.13	7.2
12/7/2006	--		31.43	--	--	10.44	20.99	--	--	--	--	--	--	--	--
3/12/2007	--		31.43	--	--	9.75	21.68	--	--	--	--	--	--	--	--
6/20/2007	--		31.43	--	--	10.64	20.79	--	--	--	--	--	--	--	--
9/20/2007	P		31.43	--	--	10.95	20.48	<50	<0.50	<0.50	<0.50	<0.50	<0.50	10.88	7.40
12/14/2007	--		31.43	--	--	11.03	20.40	--	--	--	--	--	--	--	--

**Table 1. Summary of Ground-Water Monitoring Data: Relative Water Elevations and Laboratory Analyses**

**Station #608, 17601 Hesperian Boulevard, San Lorenzo, CA**

Well and Sample Date	P/NP	Comments	TOC (feet msl)	Top of Screen (ft bgs)	Bottom of Screen (ft bgs)	DTW (feet bgs)	Water Level Elevation (feet msl)	Concentrations in (µg/L)						DO (mg/L)	pH
								GRO/TPHg	Benzene	Toluene	Ethyl-Benzene	Total Xylenes	MTBE		
<b>MW-22 Cont.</b>															
<b>3/10/2008</b>	--		<b>31.43</b>	--	--	<b>9.90</b>	<b>21.53</b>	--	--	--	--	--	--	--	--
<b>MW-23</b>															
3/13/2002	--		30.99	--	--	11.01	19.98	<50	<0.50	<0.50	<0.50	<0.50	<2.5	--	--
6/28/2002	--	q	30.99	--	--	11.59	19.40	--	--	--	--	--	--	--	--
9/20/2002	--	q	30.99	--	--	12.00	18.99	--	--	--	--	--	--	--	--
12/30/2002	--	q	30.99	--	--	9.42	21.57	--	--	--	--	--	--	--	--
3/27/2003	--		30.99	--	--	11.00	19.99	<50	<0.50	<0.50	<0.50	<0.50	<0.50	--	--
6/30/2003	--	q	30.99	--	--	11.47	19.52	--	--	--	--	--	--	--	--
9/15/2003	--	q	30.99	--	--	11.84	19.15	--	--	--	--	--	--	--	--
12/04/2003	--	q	30.99	--	--	11.61	19.38	--	--	--	--	--	--	--	--
03/10/2004	--	q	33.16	--	--	10.24	22.92	--	--	--	--	--	--	--	--
06/10/2004	--	q	33.16	--	--	11.60	21.56	--	--	--	--	--	--	--	--
09/22/2004	P		33.16	--	--	11.95	21.21	<50	<0.50	<0.50	<0.50	<0.50	<0.50	1.2	6.9
12/13/2004	--		33.16	--	--	10.88	22.28	--	--	--	--	--	--	--	--
03/10/2005	--		33.16	--	--	9.63	23.53	--	--	--	--	--	--	--	--
06/29/2005	--		33.16	--	--	11.28	21.88	--	--	--	--	--	--	--	--
09/14/2005	P		33.16	--	--	11.70	21.46	<50	<0.50	<0.50	<0.50	<0.50	<0.50	1.3	6.9
12/13/2005	--		33.16	--	--	11.44	21.72	--	--	--	--	--	--	--	--
03/20/2006	--		33.16	--	--	9.81	23.35	--	--	--	--	--	--	--	--
6/22/2006	--		33.16	--	--	11.25	21.91	--	--	--	--	--	--	--	--
9/22/2006	P		33.16	--	--	11.52	21.64	<50	<0.50	<0.50	<0.50	<0.50	<0.50	1.71	7.3
12/7/2006	--		33.16	--	--	11.50	21.66	--	--	--	--	--	--	--	--
3/12/2007	--		33.16	--	--	10.76	22.40	--	--	--	--	--	--	--	--
6/20/2007	--		33.16	--	--	11.68	21.48	--	--	--	--	--	--	--	--
9/20/2007	P		33.16	--	--	11.95	21.21	<50	<0.50	<0.50	<0.50	<0.50	<0.50	0.96	7.19
12/14/2007	--		33.16	--	--	12.05	21.11	--	--	--	--	--	--	--	--
<b>3/10/2008</b>	--		<b>33.16</b>	--	--	<b>10.92</b>	<b>22.24</b>	--	--	--	--	--	--	--	--
<b>MW-25</b>															
3/13/2002	--		33.81	--	--	10.99	22.82	<50	<0.50	<0.50	<0.50	<0.50	<2.5	--	--



**Table 1. Summary of Ground-Water Monitoring Data: Relative Water Elevations and Laboratory Analyses**

**Station #608, 17601 Hesperian Boulevard, San Lorenzo, CA**

Well and Sample Date	P/NP	Comments	TOC (feet msl)	Top of Screen (ft bgs)	Bottom of Screen (ft bgs)	DTW (feet bgs)	Water Level Elevation (feet msl)	Concentrations in (µg/L)					DO (mg/L)	pH	
								GRO/TPHg	Benzene	Toluene	Ethyl-Benzene	Total Xylenes			MTBE
<b>MW-25 Cont.</b>															
6/28/2002	--		33.81	--	--	11.26	22.55	<50	<0.50	<0.50	<0.50	<0.50	36	--	--
9/20/2002	--		33.81	--	--	11.65	22.16	117	<0.50	<0.50	<0.50	<1.50	259	--	--
12/30/2002	--	d, f	33.81	--	--	9.33	24.48	95	13	<0.50	<0.50	<0.50	98	--	--
3/27/2003	--		33.81	--	--	10.82	22.99	150	<0.50	<0.50	<0.50	<0.50	90	--	--
6/30/2003	--		33.81	--	--	11.20	22.61	<500	<5.0	<5.0	<5.0	<5.0	130	--	--
9/15/2003	--		33.81	--	--	11.62	22.19	220	<1.0	<1.0	<1.0	<1.0	140	--	--
12/04/2003	P		33.81	--	--	11.41	22.40	81	<0.50	<0.50	<0.50	<0.50	36	1.2	7.0
03/10/2004	P		36.33	--	--	10.04	26.29	<50	<0.50	<0.50	<0.50	<0.50	14	1.2	6.7
06/10/2004	P		36.33	--	--	11.40	24.93	<50	<0.50	<0.50	<0.50	<0.50	17	0.8	7.1
09/22/2004	P		36.33	--	--	11.74	24.59	<50	<0.50	<0.50	<0.50	<0.50	29	1.1	7.0
12/13/2004	P		36.33	--	--	10.72	25.61	<50	<0.50	<0.50	<0.50	<0.50	44	1.22	6.9
03/10/2005	P		36.33	--	--	9.45	26.88	<100	<0.50	<0.50	<0.50	<4.0	7.4	2.0	7.7
06/29/2005	P		36.33	--	--	10.91	25.42	<50	<0.50	<0.50	<0.50	<0.50	20	0.97	6.9
09/14/2005	P		36.33	--	--	11.35	24.98	<50	<0.50	<0.50	<0.50	<0.50	8.0	1.2	6.9
12/13/2005	P		36.33	--	--	11.14	25.19	<50	<0.50	<0.50	<0.50	<0.50	13	0.8	6.8
03/20/2006	P		36.33	--	--	9.71	26.62	<50	<0.50	<0.50	<0.50	<0.50	5.4	1.0	6.9
6/22/2006	P		36.33	--	--	10.89	25.44	<50	<0.50	<0.50	<0.50	<0.50	3.5	1.62	7.0
9/22/2006	P		36.33	--	--	11.33	25.00	<50	<0.50	<0.50	<0.50	<0.50	18	1.22	7.1
12/7/2006	P		36.33	--	--	11.22	25.11	<50	<0.50	<0.50	<0.50	<0.50	14	0.71	7.20
3/12/2007	P		36.33	--	--	10.47	25.86	<50	<0.50	<0.50	<0.50	<0.50	7.3	2.77	7.28
6/20/2007	P		36.33	--	--	11.40	24.93	<50	<0.50	<0.50	<0.50	<0.50	2.8	0.66	7.24
9/20/2007	P		36.33	--	--	11.74	24.59	<50	<0.50	<0.50	<0.50	<0.50	4.7	1.94	7.29
12/14/2007	P		36.33	--	--	11.36	24.97	<50	<0.50	<0.50	<0.50	<0.50	5.2	1.61	6.98
<b>3/10/2008</b>	<b>P</b>		<b>36.33</b>	<b>--</b>	<b>--</b>	<b>10.65</b>	<b>25.68</b>	<b>&lt;50</b>	<b>&lt;0.50</b>	<b>&lt;0.50</b>	<b>&lt;0.50</b>	<b>&lt;0.50</b>	<b>6.0</b>	<b>1.03</b>	<b>6.94</b>
<b>MW-26</b>															
3/13/2002	--		33.71	--	--	11.27	22.44	<50	<0.50	<0.50	<0.50	<0.50	<2.5	--	--
6/28/2002	--	q	33.71	--	--	11.70	22.01	--	--	--	--	--	--	--	--
9/20/2002	--	q	33.71	--	--	12.10	21.61	--	--	--	--	--	--	--	--
12/30/2002	--	q	33.71	--	--	9.60	24.11	--	--	--	--	--	--	--	--
3/27/2003	--		33.71	--	--	11.15	22.56	<50	<0.50	<0.50	<0.50	<0.50	<0.50	--	--

**Table 1. Summary of Ground-Water Monitoring Data: Relative Water Elevations and Laboratory Analyses  
Station #608, 17601 Hesperian Boulevard, San Lorenzo, CA**

Well and Sample Date	P/NP	Comments	TOC (feet msl)	Top of Screen (ft bgs)	Bottom of Screen (ft bgs)	DTW (feet bgs)	Water Level Elevation (feet msl)	Concentrations in (µg/L)						DO (mg/L)	pH
								GRO/TPHg	Benzene	Toluene	Ethyl-Benzene	Total Xylenes	MTBE		
<b>MW-26 Cont.</b>															
6/30/2003	--	q	33.71	--	--	11.61	22.10	--	--	--	--	--	--	--	--
9/15/2003	--	q	33.71	--	--	12.01	21.70	--	--	--	--	--	--	--	--
12/04/2003	--	q	33.71	--	--	11.78	21.93	--	--	--	--	--	--	--	--
03/10/2004	--	q	35.70	--	--	10.45	25.25	--	--	--	--	--	--	--	--
06/10/2004	--	q	35.70	--	--	11.82	23.88	--	--	--	--	--	--	--	--
09/22/2004	P		35.70	--	--	12.05	23.65	<50	<0.50	<0.50	<0.50	<0.50	<0.50	1.1	7.0
12/13/2004	--		35.70	--	--	11.08	24.62	--	--	--	--	--	--	--	--
03/10/2005	--		35.70	--	--	9.80	25.90	--	--	--	--	--	--	--	--
06/29/2005	--		35.70	--	--	11.30	24.40	--	--	--	--	--	--	--	--
09/14/2005	P		35.70	--	--	11.55	24.15	<50	<0.50	<0.50	<0.50	<0.50	<0.50	1.0	6.8
12/13/2005	--		35.70	--	--	11.54	24.16	--	--	--	--	--	--	--	--
03/20/2006	--		35.70	--	--	10.06	25.64	--	--	--	--	--	--	--	--
6/22/2006	--		35.70	--	--	11.29	24.41	--	--	--	--	--	--	--	--
9/22/2006	P		35.70	--	--	11.63	24.07	<50	<0.50	<0.50	<0.50	<0.50	<0.50	2.10	7.2
12/7/2006	--		35.70	--	--	11.11	24.59	--	--	--	--	--	--	--	--
3/12/2007	--		35.70	--	--	10.87	24.83	--	--	--	--	--	--	--	--
6/20/2007	--		35.70	--	--	11.80	23.90	--	--	--	--	--	--	--	--
9/20/2007	P		35.70	--	--	12.13	23.57	<50	<0.50	<0.50	<0.50	<0.50	<0.50	0.59	7.21
12/14/2007	--		35.70	--	--	12.14	23.56	--	--	--	--	--	--	--	--
<b>3/10/2008</b>	--		<b>35.70</b>	--	--	<b>11.05</b>	<b>24.65</b>	--	--	--	--	--	--	--	--

SYMBOLS & ABBREVIATIONS:

-- = Not analyzed/applicable/measured/available  
< = Not detected at or above laboratory reporting limit  
DO = Dissolved oxygen  
DTW = Depth to water in ft bgs  
ft bgs = feet below ground surface  
ft MSL = feet above mean sea level  
GRO = Gasoline range organics, range C4-C12  
GWE = Groundwater elevation measured in ft MSL  
mg/L = Milligrams per liter  
MTBE = Methyl tert butyl ether  
NP = Well not purged prior to sampling  
P = Well purged prior to sampling  
TOC = Top of casing measured in ft MSL  
TPH-g = Total petroleum hydrocarbons as gasoline  
µg/L = Micrograms per liter

NOTES:

a = Well elevation data obtained from Quarterly Groundwater Monitoring and Site Status Report, Fourth Quarter 1994.  
b = GRO/TPH-g Chromatogram Pattern: Unidentified Hydrocarbons C6-C10  
c = Hydrocarbon pattern for GRO/TPH-g is present in the requested fuel quantitation range but does not resemble the pattern of the requested fuel.  
d = GRO/TPH-g Chromatogram Pattern: C6-C10  
e = This sample was analyzed beyond the EPA recommended holding time. The results may still be useful for their intended purpose.  
f = The continuing calibration was outside the acceptance criteria. This should be considered in evaluating the result for its intended purpose.  
g = Groundwater extraction system pumping; inaccurate DTW.  
h = Groundwater extraction system not pumping.  
i = Sampling frequency changed from quarterly to annually per recommendations in first quarter 2003 groundwater monitoring report.  
j = Well not accessible this quarter.  
k = Well destroyed.  
l = MTBE confirmed by EPA Method 8260B (Method 8260B result is the second value.)  
m = No gauging port. Sample taken from spigot.  
n = Well inaccessible as homeowner not available.  
o = Pump not working or well dry.  
p = Gauged with pump in well. Opened cam lock fitting at wellhead.  
q = Well sampled annually.  
r = Well inaccessible--car parked over well.  
s = Well resampled on 3/26/2008; the initial sample on 3/10/2008 was meant to be purged.  
u = Well sampled semi-annually.

NOTES:

Site surveyed to NAVD'88 datum on March 2, 2004.  
Beginning in the fourth quarter 2003, the laboratory modified the reported analyte list. TPH-g was changed to GRO. The resulting data may be impacted by the potential of non-TPH-g analytes within the requested fuel range resulting in a higher concentration being reported. Beginning in the second quarter 2004, the carbon range for GRO was changed from C6-C10 to C4-C12  
Values for DO and pH were obtained through field measurements.

Note: The data within this table collected prior to April 2006 was provided to Broadbent & Associates, Inc. by Atlantic Richfield Company and their previous consultants. Broadbent & Associates, Inc. has not verified the accuracy of this information.

**Table 2. Summary of Fuel Additives Analytical Data  
Station #608, 17601 Hesperian Boulevard, San Lorenzo, CA**

Well and Sample Date	Concentrations in (µg/L)								Comments
	Ethanol	TBA	MTBE	DIPE	ETBE	TAME	1,2-DCA	EDB	
<b>17372 VM</b>									
3/27/2003	<100	<20	<0.50	<0.50	<0.50	<0.50	--	--	
9/15/2003	<100	<20	<0.50	<0.50	<0.50	<0.50	<0.50	<0.50	
12/04/2003	<100	<20	<0.50	<0.50	<0.50	<0.50	--	--	
03/10/2004	<100	<20	<0.50	<0.50	<0.50	<0.50	<0.50	<0.50	
06/10/2004	<100	<20	<0.50	<0.50	<0.50	<0.50	<0.50	<0.50	
09/22/2004	<100	<20	<0.50	<0.50	<0.50	<0.50	<0.50	<0.50	
12/13/2004	<100	<20	<0.50	<0.50	<0.50	<0.50	<0.50	<0.50	
03/10/2005	<100	<10	<0.50	<0.50	<0.50	<0.50	<0.50	<0.50	
<b>642 H</b>									
3/13/2002	<100	<20	--	<0.50	<0.50	<0.50	--	--	
3/27/2003	<100	<20	<0.50	<0.50	<0.50	<0.50	--	--	
6/30/2003	--	--	--	--	--	--	--	--	a
9/15/2003	<100	<20	<0.50	<0.50	<0.50	<0.50	<0.50	<0.50	
12/04/2003	<100	<20	<0.50	<0.50	<0.50	<0.50	--	--	
<b>E-1A</b>									
3/27/2003	<100	<20	60	<0.50	<0.50	2.3	--	--	
6/30/2003	<100	<20	37	<0.50	<0.50	1.6	<0.50	<0.50	
9/15/2003	<100	<20	49	<0.50	<0.50	2.4	<0.50	<0.50	
12/04/2003	<100	<20	19	<0.50	<0.50	0.89	--	--	
03/10/2004	<200	<40	38	<1.0	<1.0	2.3	<1.0	<1.0	
06/10/2004	<100	<20	46	<0.50	<0.50	2.2	<0.50	<0.50	
09/22/2004	<100	<20	17	<0.50	<0.50	0.98	<0.50	<0.50	
12/13/2004	<100	<20	15	<0.50	<0.50	0.75	<0.50	<0.50	
03/10/2005	<100	<10	22	<0.50	<0.50	0.95	<0.50	<0.50	
06/29/2005	<100	<20	14	<0.50	<0.50	0.74	<0.50	<0.50	
09/14/2005	<100	<20	13	<0.50	<0.50	<0.50	<0.50	<0.50	c
12/13/2005	<100	<20	12	<0.50	<0.50	0.61	<0.50	<0.50	
6/22/2006	<300	<20	13	<0.50	<0.50	<0.50	<0.50	<0.50	
9/22/2006	<300	<20	12	<0.50	<0.50	<0.50	<0.50	<0.50	
3/12/2007	<300	<20	5.6	<0.50	<0.50	<0.50	<0.50	<0.50	

**Table 2. Summary of Fuel Additives Analytical Data  
Station #608, 17601 Hesperian Boulevard, San Lorenzo, CA**

Well and Sample Date	Concentrations in (µg/L)								Comments
	Ethanol	TBA	MTBE	DIPE	ETBE	TAME	1,2-DCA	EDB	
<b>E-1A Cont.</b>									
6/20/2007	<300	<20	6.8	<0.50	<0.50	<0.50	<0.50	<0.50	
9/20/2007	<300	<20	0.80	<0.50	<0.50	<0.50	<0.50	<0.50	
12/14/2007	<300	<20	2.0	<0.50	<0.50	<0.50	<0.50	<0.50	c
<b>3/10/2008</b>	<b>&lt;300</b>	<b>&lt;10</b>	<b>&lt;0.50</b>	<b>&lt;0.50</b>	<b>&lt;0.50</b>	<b>&lt;0.50</b>	<b>&lt;0.50</b>	<b>&lt;0.50</b>	
<b>3/26/2008</b>	<b>&lt;300</b>	<b>&lt;10</b>	<b>0.89</b>	<b>&lt;0.50</b>	<b>&lt;0.50</b>	<b>&lt;0.50</b>	<b>&lt;0.50</b>	<b>&lt;0.50</b>	<b>d</b>
<b>MW-5</b>									
3/27/2003	<100	24	59	<0.50	<0.50	2.2	--	--	
6/30/2003	<100	22	58	<0.50	<0.50	2.1	<0.50	<0.50	
9/15/2003	<500	<100	61	<2.5	<2.5	2.5	--	--	
12/04/2003	<100	<20	42	<0.50	<0.50	1.9	--	--	
03/10/2004	<100	<20	9.5	<0.50	<0.50	<0.50	<0.50	<0.50	
06/10/2004	<100	<20	31	<0.50	<0.50	1.0	<0.50	<0.50	
09/22/2004	<100	<20	15	<0.50	<0.50	<0.50	<0.50	<0.50	
12/13/2004	<100	<20	5.4	<0.50	<0.50	<0.50	<0.50	<0.50	
03/10/2005	<100	<10	3.3	<0.50	<0.50	<0.50	<0.50	<0.50	b
06/29/2005	<100	<20	6.7	<0.50	<0.50	<0.50	<0.50	<0.50	
09/14/2005	<100	<20	13	<0.50	<0.50	<0.50	<0.50	<0.50	c
03/20/2006	<300	<20	3.8	<0.50	<0.50	<0.50	<0.50	<0.50	
9/22/2006	<300	<20	12	<0.50	<0.50	<0.50	<0.50	<0.50	
3/12/2007	<300	<20	5.8	<0.50	<0.50	<0.50	<0.50	<0.50	
9/20/2007	<300	<20	4.3	<0.50	<0.50	<0.50	<0.50	<0.50	
<b>3/10/2008</b>	<b>&lt;300</b>	<b>&lt;10</b>	<b>2.8</b>	<b>&lt;0.50</b>	<b>&lt;0.50</b>	<b>&lt;0.50</b>	<b>&lt;0.50</b>	<b>&lt;0.50</b>	
<b>MW-8</b>									
3/27/2003	<100	<20	33	<0.50	<0.50	0.53	--	--	
6/30/2003	<100	<20	15	<0.50	<0.50	0.85	<0.50	<0.50	
9/15/2003	<100	<20	41	<0.50	<0.50	5.3	--	--	
12/04/2003	<100	<20	24	<0.50	<0.50	3.7	--	--	
03/10/2004	<100	<20	2.4	<0.50	<0.50	<0.50	<0.50	<0.50	
06/10/2004	<100	<20	2.1	<0.50	<0.50	<0.50	<0.50	<0.50	
09/22/2004	<100	<20	18	<0.50	<0.50	1.5	<0.50	<0.50	

**Table 2. Summary of Fuel Additives Analytical Data  
Station #608, 17601 Hesperian Boulevard, San Lorenzo, CA**

Well and Sample Date	Concentrations in (µg/L)								Comments
	Ethanol	TBA	MTBE	DIPE	ETBE	TAME	1,2-DCA	EDB	
<b>MW-8 Cont.</b>									
12/13/2004	<100	<20	7.1	<0.50	<0.50	0.78	<0.50	<0.50	
03/10/2005	<100	<10	1.4	<0.50	<0.50	<0.50	<0.50	<0.50	b
06/29/2005	<100	<20	1.7	<0.50	<0.50	<0.50	<0.50	<0.50	
09/14/2005	<100	<20	<0.50	<0.50	<0.50	<0.50	<0.50	<0.50	c
03/20/2006	<300	<20	0.60	<0.50	<0.50	<0.50	<0.50	<0.50	
9/22/2006	<300	<20	<0.50	<0.50	<0.50	<0.50	<0.50	<0.50	
3/12/2007	<300	<20	<0.50	<0.50	<0.50	<0.50	<0.50	<0.50	
9/20/2007	<300	<20	13	<0.50	<0.50	1.2	<0.50	<0.50	
<b>3/10/2008</b>	<b>&lt;300</b>	<b>&lt;10</b>	<b>&lt;0.50</b>	<b>&lt;0.50</b>	<b>&lt;0.50</b>	<b>&lt;0.50</b>	<b>&lt;0.50</b>	<b>&lt;0.50</b>	
<b>MW-9</b>									
3/27/2003	<100	<20	<0.50	<0.50	<0.50	<0.50	--	--	
9/15/2003	<100	<20	<0.50	<0.50	<0.50	<0.50	<0.50	<0.50	
03/10/2004	<100	<20	<0.50	<0.50	<0.50	<0.50	<0.50	<0.50	
09/22/2004	<100	<20	<0.50	<0.50	<0.50	<0.50	<0.50	<0.50	
03/10/2005	<100	<10	<0.50	<0.50	<0.50	<0.50	<0.50	<0.50	b
09/14/2005	<100	<20	<0.50	<0.50	<0.50	<0.50	<0.50	<0.50	c
9/22/2006	<300	<20	<0.50	<0.50	<0.50	<0.50	<0.50	<0.50	
9/20/2007	<300	<20	<0.50	<0.50	<0.50	<0.50	<0.50	<0.50	
<b>MW-10</b>									
3/27/2003	<1,000	<200	330	<5.0	<5.0	15	--	--	
6/30/2003	<2,000	<400	750	<10	<10	28	<10	<10	
9/15/2003	<1,000	<200	430	<5.0	<5.0	15	<5.0	<5.0	
12/04/2003	<500	<100	110	<2.5	<2.5	4.8	--	--	
03/10/2004	<500	120	140	<2.5	<2.5	<2.5	<2.5	<2.5	
06/10/2004	<1,000	<200	410	<5.0	<5.0	11	<5.0	<5.0	
09/22/2004	<100	54	87	<0.50	<0.50	3.8	<0.50	<0.50	
12/13/2004	<200	220	110	<1.0	<1.0	4.5	<1.0	<1.0	
03/10/2005	<100	50	86	<0.50	<0.50	2.2	<0.50	<0.50	
06/29/2005	<500	110	160	<2.5	<2.5	4.6	<2.5	<2.5	
09/14/2005	<500	300	140	<2.5	<2.5	3.5	<2.5	<2.5	c

**Table 2. Summary of Fuel Additives Analytical Data  
Station #608, 17601 Hesperian Boulevard, San Lorenzo, CA**

Well and Sample Date	Concentrations in (µg/L)								Comments
	Ethanol	TBA	MTBE	DIPE	ETBE	TAME	1,2-DCA	EDB	
<b>MW-10 Cont.</b>									
12/13/2005	<100	190	47	<0.50	<0.50	1.9	<0.50	<0.50	
03/20/2006	<300	72	34	<0.50	<0.50	0.85	<0.50	<0.50	
6/22/2006	<300	130	21	<0.50	<0.50	0.56	<0.50	<0.50	c
9/22/2006	<300	51	11	<0.50	<0.50	<0.50	<0.50	<0.50	
12/7/2006	<300	24	10	<0.50	<0.50	<0.50	<0.50	<0.50	
3/12/2007	<300	46	18	<0.50	<0.50	<0.50	<0.50	<0.50	
6/20/2007	<300	<20	5.9	<0.50	<0.50	<0.50	<0.50	<0.50	
9/20/2007	<300	<20	4.6	<0.50	<0.50	<0.50	<0.50	<0.50	
12/14/2007	<300	<20	6.9	<0.50	<0.50	<0.50	<0.50	<0.50	c
<b>3/10/2008</b>	<b>&lt;300</b>	<b>22</b>	<b>13</b>	<b>&lt;0.50</b>	<b>&lt;0.50</b>	<b>&lt;0.50</b>	<b>&lt;0.50</b>	<b>&lt;0.50</b>	
<b>MW-11</b>									
3/27/2003	<100	<20	<0.50	<0.50	<0.50	<0.50	--	--	
6/30/2003	<100	<20	<0.50	<0.50	<0.50	<0.50	<0.50	<0.50	
9/15/2003	<100	<20	<0.50	<0.50	<0.50	<0.50	<0.50	<0.50	
12/04/2003	<100	<20	<0.50	<0.50	<0.50	<0.50	--	--	
03/10/2004	<100	<20	<0.50	<0.50	<0.50	<0.50	<0.50	<0.50	
06/10/2004	<100	<20	<0.50	<0.50	<0.50	<0.50	<0.50	<0.50	
09/22/2004	<100	<20	<0.50	<0.50	<0.50	<0.50	<0.50	<0.50	
12/13/2004	<100	<20	<0.50	<0.50	<0.50	<0.50	<0.50	<0.50	
03/10/2005	<100	<10	<0.50	<0.50	<0.50	<0.50	<0.50	<0.50	b
06/29/2005	<100	<20	<0.50	<0.50	<0.50	<0.50	<0.50	<0.50	
09/14/2005	<100	<20	<0.50	<0.50	<0.50	<0.50	<0.50	<0.50	c
9/22/2006	<300	<20	<0.50	<0.50	<0.50	<0.50	<0.50	<0.50	
9/20/2007	<300	<20	<0.50	<0.50	<0.50	<0.50	<0.50	<0.50	
<b>MW-14</b>									
3/27/2003	<100	<20	<0.50	<0.50	<0.50	<0.50	--	--	
03/10/2004	--	--	--	--	--	--	--	--	Not Sampled
09/22/2004	<100	<20	<0.50	<0.50	<0.50	<0.50	<0.50	<0.50	
09/14/2005	<100	<20	<0.50	<0.50	<0.50	<0.50	<0.50	<0.50	
9/22/2006	<300	<20	<0.50	<0.50	<0.50	<0.50	<0.50	<0.50	

**Table 2. Summary of Fuel Additives Analytical Data  
Station #608, 17601 Hesperian Boulevard, San Lorenzo, CA**

Well and Sample Date	Concentrations in (µg/L)								Comments
	Ethanol	TBA	MTBE	DIPE	ETBE	TAME	1,2-DCA	EDB	
<b>MW-14 Cont.</b>									
9/20/2007	<300	<20	<0.50	<0.50	<0.50	<0.50	<0.50	<0.50	
<b>MW-15</b>									
3/27/2003	<100	<20	17	<0.50	<0.50	<0.50	--	--	
6/30/2003	<100	<20	12	<0.50	<0.50	<0.50	<0.50	<0.50	
9/15/2003	<100	<20	10	<0.50	<0.50	<0.50	<0.50	<0.50	
12/04/2003	<100	<20	6.4	<0.50	<0.50	<0.50	--	--	
03/10/2004	<100	<20	11	<0.50	<0.50	<0.50	<0.50	<0.50	
06/10/2004	<100	<20	5.7	<0.50	<0.50	<0.50	<0.50	<0.50	
03/10/2005	<100	<10	5.4	<0.50	<0.50	<0.50	<0.50	<0.50	b
03/20/2006	<300	<20	15	<0.50	<0.50	<0.50	<0.50	<0.50	
9/20/2007	<300	<20	11	<0.50	<0.50	<0.50	<0.50	<0.50	
<b>3/10/2008</b>	<b>&lt;300</b>	<b>&lt;10</b>	<b>19</b>	<b>&lt;0.50</b>	<b>&lt;0.50</b>	<b>&lt;0.50</b>	<b>&lt;0.50</b>	<b>&lt;0.50</b>	
<b>MW-16</b>									
3/27/2003	<100	<20	<0.50	<0.50	<0.50	<0.50	--	--	
9/15/2003	<100	<20	<0.50	<0.50	<0.50	<0.50	<0.50	<0.50	
03/10/2004	<100	<20	<0.50	<0.50	<0.50	<0.50	<0.50	<0.50	
09/22/2004	<100	<20	<0.50	<0.50	<0.50	<0.50	<0.50	<0.50	
03/10/2005	<100	<10	<0.50	<0.50	<0.50	<0.50	<0.50	<0.50	b
09/14/2005	<100	<20	<0.50	<0.50	<0.50	<0.50	<0.50	<0.50	
9/22/2006	<300	<20	<0.50	<0.50	<0.50	<0.50	<0.50	<0.50	
9/20/2007	<300	<20	<0.50	<0.50	<0.50	<0.50	<0.50	<0.50	
<b>MW-18</b>									
3/27/2003	<100	<20	<0.50	<0.50	<0.50	<0.50	--	--	
03/10/2004	--	--	--	--	--	--	--	--	Not Sampled
09/22/2004	<100	<20	<0.50	<0.50	<0.50	<0.50	<0.50	<0.50	
09/14/2005	<100	<20	<0.50	<0.50	<0.50	<0.50	<0.50	<0.50	
9/22/2006	<300	<20	<0.50	<0.50	<0.50	<0.50	<0.50	<0.50	
9/20/2007	<300	<20	<0.50	<0.50	<0.50	<0.50	<0.50	<0.50	
<b>MW-21</b>									



**Table 2. Summary of Fuel Additives Analytical Data  
Station #608, 17601 Hesperian Boulevard, San Lorenzo, CA**

Well and Sample Date	Concentrations in (µg/L)								Comments
	Ethanol	TBA	MTBE	DIPE	ETBE	TAME	1,2-DCA	EDB	
<b>MW-21 Cont.</b>									
3/27/2003	<100	<20	<0.50	<0.50	<0.50	<0.50	--	--	
03/10/2004	--	--	--	--	--	--	--	--	Not Sampled
09/22/2004	<100	<20	<0.50	<0.50	<0.50	<0.50	<0.50	<0.50	
09/14/2005	<100	<20	<0.50	<0.50	<0.50	<0.50	<0.50	<0.50	
9/22/2006	<300	<20	<0.50	<0.50	<0.50	<0.50	<0.50	<0.50	
9/20/2007	<300	<20	<0.50	<0.50	<0.50	<0.50	<0.50	<0.50	
<b>MW-22</b>									
3/27/2003	<100	<20	<0.50	<0.50	<0.50	<0.50	--	--	
9/15/2003	<1,000	<200	<5.0	<5.0	<5.0	<5.0	<5.0	<5.0	
03/10/2004	<100	<20	<0.50	<0.50	<0.50	<0.50	<0.50	<0.50	
09/22/2004	<100	<20	<0.50	<0.50	<0.50	<0.50	<0.50	<0.50	
03/10/2005	<100	<10	<0.50	<0.50	<0.50	<0.50	<0.50	<0.50	b
09/14/2005	<100	<20	<0.50	<0.50	<0.50	<0.50	<0.50	<0.50	
9/22/2006	<300	<20	<0.50	<0.50	<0.50	<0.50	<0.50	<0.50	
9/20/2007	<300	<20	<0.50	<0.50	<0.50	<0.50	<0.50	<0.50	
<b>MW-23</b>									
3/27/2003	<100	<20	<0.50	<0.50	<0.50	<0.50	--	--	
03/10/2004	--	--	--	--	--	--	--	--	Not Sampled
09/22/2004	<100	<20	<0.50	<0.50	<0.50	<0.50	<0.50	<0.50	
09/14/2005	<100	<20	<0.50	<0.50	<0.50	<0.50	<0.50	<0.50	
9/22/2006	<300	<20	<0.50	<0.50	<0.50	<0.50	<0.50	<0.50	
9/20/2007	<300	<20	<0.50	<0.50	<0.50	<0.50	<0.50	<0.50	
<b>MW-25</b>									
3/27/2003	<100	<20	90	<0.50	<0.50	40	--	--	
6/30/2003	<1,000	<200	130	<5.0	<5.0	81	<5.0	<5.0	
9/15/2003	<200	<40	140	<1.0	<1.0	71	<1.0	<1.0	
12/04/2003	<100	<20	36	<0.50	<0.50	17	--	--	
03/10/2004	<100	<20	14	<0.50	<0.50	6.5	<0.50	<0.50	
06/10/2004	<100	<20	17	<0.50	<0.50	7.2	<0.50	<0.50	
09/22/2004	<100	<20	29	<0.50	<0.50	18	<0.50	<0.50	

**Table 2. Summary of Fuel Additives Analytical Data  
Station #608, 17601 Hesperian Boulevard, San Lorenzo, CA**

Well and Sample Date	Concentrations in (µg/L)								Comments
	Ethanol	TBA	MTBE	DIPE	ETBE	TAME	1,2-DCA	EDB	
<b>MW-25 Cont.</b>									
12/13/2004	<100	45	44	<0.50	<0.50	18	<0.50	<0.50	
03/10/2005	<100	<10	7.4	<0.50	<0.50	2.3	<0.50	<0.50	b
06/29/2005	<100	<20	20	<0.50	<0.50	12	<0.50	<0.50	
09/14/2005	<100	<20	8.0	<0.50	<0.50	4.1	<0.50	<0.50	
12/13/2005	<100	<20	13	<0.50	<0.50	5.5	<0.50	<0.50	
03/20/2006	<300	<20	5.4	<0.50	<0.50	2.4	<0.50	<0.50	
6/22/2006	<300	<20	3.5	<0.50	<0.50	1.7	<0.50	<0.50	c
9/22/2006	<300	<20	18	<0.50	<0.50	7.3	<0.50	<0.50	
12/7/2006	<300	<20	14	<0.50	<0.50	6.1	<0.50	<0.50	
3/12/2007	<300	<20	7.3	<0.50	<0.50	2.9	<0.50	<0.50	
6/20/2007	<300	<20	2.8	<0.50	<0.50	1.3	<0.50	<0.50	
9/20/2007	<300	<20	4.7	<0.50	<0.50	1.9	<0.50	<0.50	
12/14/2007	<300	<20	5.2	<0.50	<0.50	1.8	<0.50	<0.50	c
<b>3/10/2008</b>	<b>&lt;300</b>	<b>&lt;10</b>	<b>6.0</b>	<b>&lt;0.50</b>	<b>&lt;0.50</b>	<b>1.7</b>	<b>&lt;0.50</b>	<b>&lt;0.50</b>	
<b>MW-26</b>									
3/27/2003	<100	<20	<0.50	<0.50	<0.50	<0.50	--	--	
03/10/2004	--	--	--	--	--	--	--	--	Not Sampled
09/22/2004	<100	<20	<0.50	<0.50	<0.50	<0.50	<0.50	<0.50	
09/14/2005	<100	<20	<0.50	<0.50	<0.50	<0.50	<0.50	<0.50	
9/22/2006	<300	<20	<0.50	<0.50	<0.50	<0.50	<0.50	<0.50	
9/20/2007	<300	<20	<0.50	<0.50	<0.50	<0.50	<0.50	<0.50	

SYMBOLS & ABBREVIATIONS:

-- = Not analyzed/applicable/measured/available

< = Not detected at or above the laboratory reporting limit.

1,2-DCA = 1,2-Dichloroethane

DIPE = Di-isopropyl ether

EDB = 1,2-Dibromoethane

ETBE = Ethyl tert-butyl ether

MTBE = Methyl tert-butyl ether

TAME = tert-Amyl methyl ether

TBA = tert-Butyl alcohol

µg/L = Micrograms per Liter

FOOTNOTES:

a = Well was not accessible this quarter.

b = Possible high bias due to CCV falling outside acceptance criteria for TBA.

c = Calibration verification was within method limits but outside the contract limits for ethanol.

d = Well resampled on 3/26/2008; the initial sample on 3/10/2008 was meant to be purged.

NOTES:

Well E-1A was previously named MW-12.

All volatile organic compounds analyzed using EPA Method 8260B.

Note: The data within this table collected prior to April 2006 was provided to Broadbent & Associates, Inc. by Atlantic Richfield Company and their previous consultants. Broadbent & Associates, Inc. has not verified the accuracy of this information.

**Table 3. Historical Ground-Water Flow Direction and Gradient  
Station #608, 17601 Hesperian Boulevard, San Lorenzo, CA**

<b>Date Sampled</b>	<b>Approximate Flow Direction</b>	<b>Approximate Hydraulic Gradient</b>
6/28/2002	West	0.003
9/20/2002	West	0.00196
12/30/2002	West	0.003
3/27/2003	West	0.002
6/30/2003	West-Southwest	0.001
9/15/2003	West	0.003
12/4/2003	West-Southwest	0.003
3/10/2004	West	0.003
6/10/2004	West	0.006
9/22/2004	West	0.006
12/13/2004	West-Southwest	0.003
3/10/2005	West-Southwest	0.003
6/29/2005	West-Southwest	0.003
9/14/2005	West-Southwest	0.003
12/13/2005	West	0.003
3/20/2006	West-Southwest	0.003
6/22/2006	West-Southwest	0.003
9/22/2006	West-Southwest	0.003
12/7/2006	West	0.004
3/12/2007	West	0.003
6/20/2007	West	0.004
9/20/2007	West	0.003
12/14/2007	West	0.004
<b>3/10/2008</b>	<b>West</b>	<b>0.004</b>

Note: The data within this table collected prior to April 2006 was provided to Broadbent & Associates, Inc. by Atlantic Richfield Company and their previous consultants. Broadbent & Associates, Inc. has not verified the accuracy of this information.

**Table 4.**  
**Ground-Water Sampling Schedule**  
**Atlantic Richfield Company Station #608**  
**17601 Hesperian Boulevard, San Lorenzo, California**

Well Number	First Quarter	Second Quarter	Third Quarter	Fourth Quarter	Sampling Frequency
<b>Groundwater Monitoring Wells</b>					
MW-5	X		X		Semiannually (1st and 3rd Quarter)
MW-7	-----Removed from Program-----				
MW-8	X		X		Semiannually (1st and 3rd Quarter)
MW-9			X		Annually (3rd Quarter)
MW-10	X	X	X	X	Quarterly
MW-11			X		Annually (3rd Quarter)
E-1A	X	X	X	X	Quarterly
MW-13	-----Removed from Program-----				
MW-14			X		Annually (3rd Quarter)
MW-15	X		X		Semiannually (1st and 3rd Quarter)
MW-16			X		Annually (3rd Quarter)
MW-17	-----Destroyed-----				
MW-18			X		Annually (3rd Quarter)
MW-19	-----Removed from Program-----				
MW-20	-----Destroyed-----				
MW-21			X		Annually (3rd Quarter)
MW-22			X		Annually (3rd Quarter)
MW-23			X		Annually (3rd Quarter)
MW-24	-----Removed from Program-----				
MW-25	X	X	X	X	Quarterly
MW-26			X		Annually (3rd Quarter)
<b>Domestic Irrigation Wells</b>					
590H	-----Destroyed-----				
633H	Destroyed				
634H	-----Pump Not Functional, Well Not in Use-----				
642H	X	X	X	X	Quarterly
675H	-----Destroyed-----				
17197 VM	-----Destroyed-----				
17200 VM	-----Destroyed-----				
17203 VM	Destroyed				
17302 VM	-----Pump Not Functional, Well Not in Use-----				
17348 VE	-----Pump Not Functional, Well Not in Use-----				
17349 VM	-----Destroyed-----				
17371 VM	-----Destroyed-----				
17372 VM	X	X	X	X	Quarterly
17393 VM	-----Destroyed-----				

Notes: Beginning third quarter 2005, the sampling schedule was changed.