



76 Broadway
Sacramento, CA 95818
phone 916.558.7676
fax 916.558.7639

R0251

April 18, 2005

Mr. Don Hwang
Alameda County Health Agency
1131 Harbor Bay Parkway, Suite 250
Alameda, CA 94502

Alameda County
APR 20 2005
Environmental Services

Re: **Document Transmittal**
Fuel Leak Case
76 Station #3538
411 West MacArthur
Oakland, CA

Dear Mr. Hwang:

Please find attached TRC's *Quarterly Status Report, dated 4/15/05*, and TRC's *Quarterly Monitoring Report, dated 4/04/05* for the above referenced site. I declare, under penalty of perjury, that to the best of my knowledge the information and/or recommendations contained in the attached proposal or report is true and correct.

If you have any questions or need additional information, please call me at (916) 558-7666.

Sincerely,

Thomas H. Kosel
Site Manger, Risk Management and Remediation
ConocoPhillips
76 Broadway, Sacramento, CA 95818

Attachment

cc: Roger Batra, TRC



Customer-Focused Solutions

April 15, 2005

TRC Project No. 42014201

Mr. Don Hwang
Alameda County Health Services
1131 Harbor Bay Parkway
Alameda, CA 94502-6577

**RE: Quarterly Status Report - First Quarter 2005
76 Service Station #3538, 411 W. MacArthur Boulevard, Oakland, California
Alameda County**

Dear Mr. Hwang:

On behalf of ConocoPhillips Company (ConocoPhillips), TRC is submitting the First Quarter 2005 Quarterly Status Report for the subject site, shown on Figures 3 through 5.

PREVIOUS ASSESSMENTS

The subject site was a former Tosco (76) service station, and is located on the southwest corner of MacArthur Boulevard and Webster Street in Oakland, California. The site is currently a used car sales lot and is entirely fenced. All petroleum storage and dispensing equipment were removed in September of 1998 during station demolition activities. Six groundwater-monitoring wells are present at and in the site vicinity.

July 1989: One 10,000-gallon and one 12,000-gallon gasoline underground storage tanks (USTs) were removed and replaced with two new 12,000-gallon USTs. One 550-gallon waste oil UST and associated piping for all three tanks were also removed. No holes or cracks were observed in the gasoline USTs; however, holes were observed in the waste oil UST. Groundwater was encountered in the former UST pit at a depth of approximately 10.5 feet below ground surface (bgs), which prohibited the collection of soil samples below the former gasoline tanks. Confirmation soil samples from the sidewalls contained moderate maximum concentrations of total petroleum hydrocarbons as gasoline (TPH-g), and low maximum concentrations of benzene. These sample areas were subsequently removed during overexcavation. Soil samples from the base of the waste oil UST pit were non-detect for TPH-g and benzene, toluene, ethylbenzene, and xylenes (BTEX).

September 1989: Karpealian Engineering, Inc. (KEI) installed four groundwater-monitoring wells at the site. The four wells were installed to depths of approximately 30 feet bgs.

November 1992: Two additional groundwater-monitoring wells were installed offsite to a depth of 30 feet bgs.

September 1998: Two 12,000-gallon gasoline USTs and associated product piping and dispensers were removed from the site during station demolition activities. No holes or cracks were observed in the tanks. Confirmation soil samples contained low maximum concentrations of TPH-g and benzene, and methyl tertiary butyl ether (MTBE) was not detected.

October 2003: Site environmental consulting responsibilities were transferred to TRC.

SENSITIVE RECEPTORS

A sensitive receptor survey performed by the California Department of Water Resources (DWR) identified no water supply wells located within 2,000 feet of the site. The nearest well identified is a private water well located approximately 2,500 feet east-southeast of the site.

MONITORING AND SAMPLING

Currently, two wells (MW-2 and MW-3) are monitored semi-annually and four wells are monitored annually. Six wells were gauged and two wells were sampled this quarter. The groundwater gradient and flow direction were 0.02 foot/foot to the south.

CHARACTERIZATION STATUS

TPH-g was detected in the two monitoring wells sampled, with a maximum concentration of 99 µg/l in onsite well MW-2.

Benzene was detected in one of two monitoring wells sampled, with a maximum concentration of 26 µg/l in onsite well MW-2.

MTBE was detected in one of two monitoring wells sampled, with a maximum concentration of 140 µg/l in onsite well MW-3.

REMEDIATION STATUS

October 1998: A total of 516.44 tons (approximately 380 cubic yards) of soil generated during station demolition was transported from the site to Forward Landfill in Manteca, California for disposal.

Remediation is not currently being conducted at the site.

RECENT CORRESPONDENCE

No correspondence this quarter.

CURRENT QUARTER ACTIVITIES

March 2, 2005: TRC performed groundwater monitoring and sampling. Wastewater generated from well purging and equipment cleaning was stored at TRC's groundwater monitoring facility in Concord, California, and transported by Onyx to the ConocoPhillips Refinery in Rodeo, California, for treatment and disposal.

NEXT QUARTER ACTIVITIES

Site closure will be proposed based on a summary of site data through first quarter 2005.

Continue semi-annual monitoring and sampling until case closure is granted.

If you have any questions regarding this report, please call me at (925) 688-2466.

Sincerely,

TRC

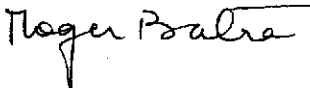

Roger Batra
Senior Project Manager

Attachments:

Figure 1 – Dissolved-Phase TPH-G Concentration Map, March 2, 2005, from Semi-Annual Monitoring Report, October through March 2005, dated April 4, 2005 by TRC.

Figure 2 – Dissolved-Phase Benzene Concentration Map, March 2, 2005, from Semi-Annual Monitoring Report, October through March 2005, dated April 4, 2005 by TRC.

Figure 3 – Dissolved-Phase MTBE Concentration Map, March 2, 2005, from Semi-Annual Monitoring Report, October through March 2005, dated April 4, 2005 by TRC.

cc: Thomas Kosel, ConocoPhillips (hard copy and electronic upload)

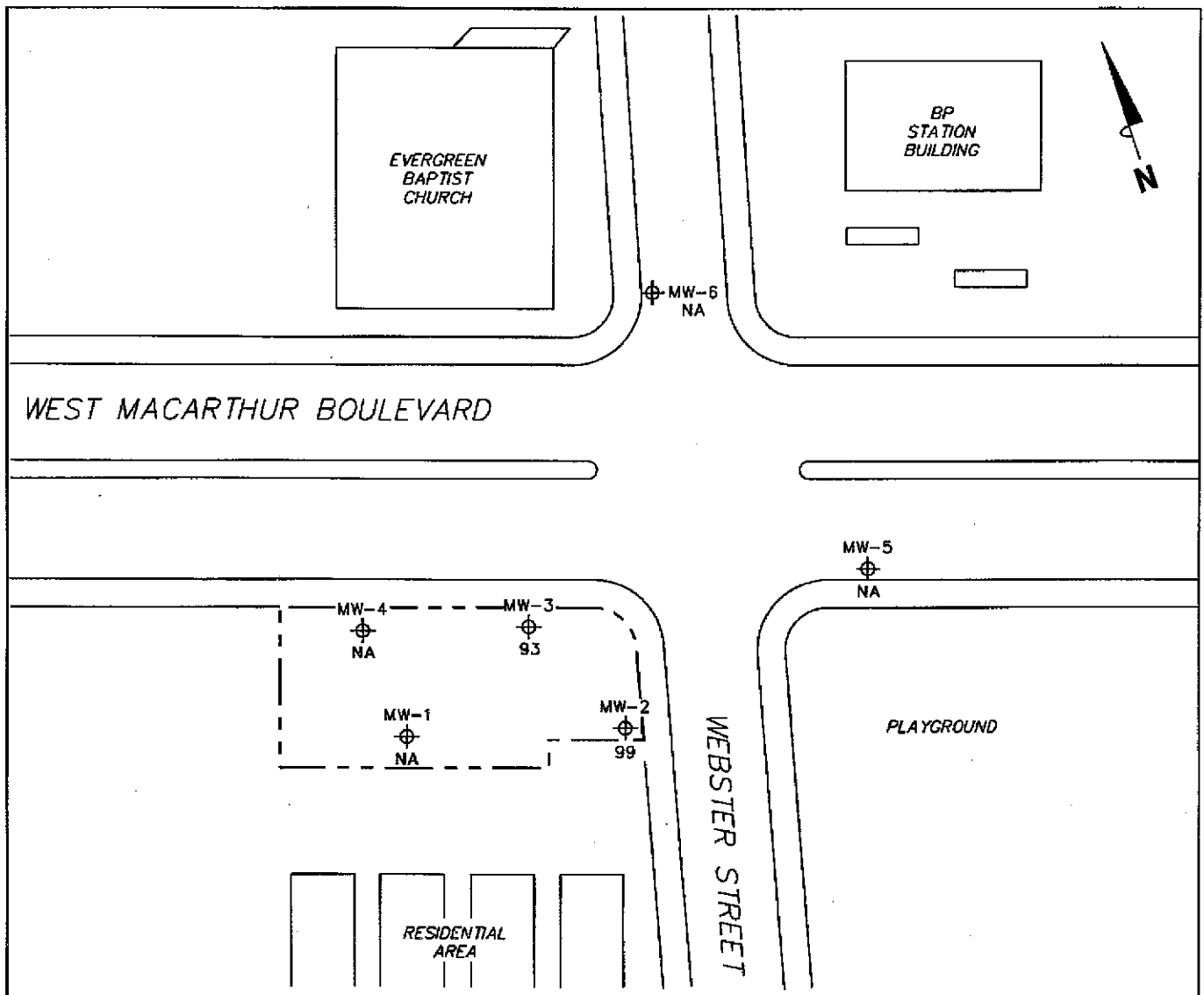

NOTES:

TPH-G = total petroleum hydrocarbons as gasoline.
 µg/l = micrograms per liter. ND = not detected at limit indicated on official laboratory report.
 NA = not analyzed, measured, or collected.
 UST = underground storage tank. Results obtained using EPA Method 8015.

LEGEND

MW-6 ⊕ Monitoring Well with Dissolved-Phase TPH-G Concentration (µg/l)

**DISSOLVED-PHASE TPH-G
 CONCENTRATION MAP
 March 2, 2005**

Former 76 Station 3538
 411 West MacArthur Boulevard
 Oakland, California

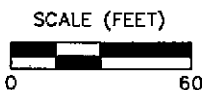
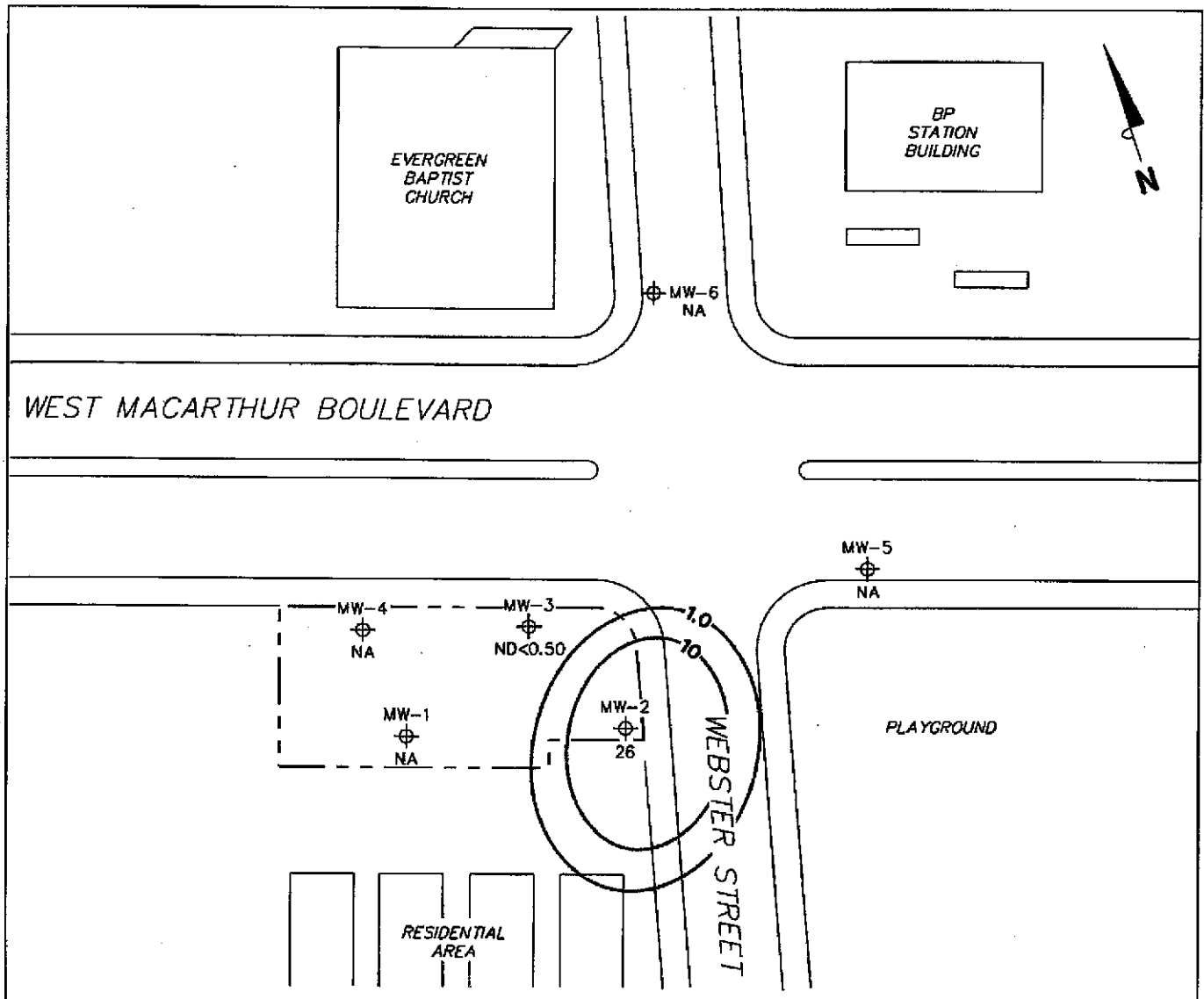

FIGURE 3

PS=1:1 3538-003



NOTES:

Contour lines are interpretive and based on laboratory analysis results of groundwater samples. µg/l = micrograms per liter. NA = not analyzed, measured, or collected.

LEGEND

MW-6 ⊕ Monitoring Well with Dissolved-Phase Benzene Concentration (µg/l)

—10— Dissolved-Phase Benzene Contour (µg/l)

**DISSOLVED-PHASE BENZENE
CONCENTRATION MAP
March 2, 2005**

Former 76 Station 3538
411 West MacArthur Boulevard
Oakland, California

TRC

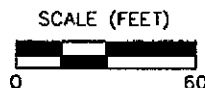
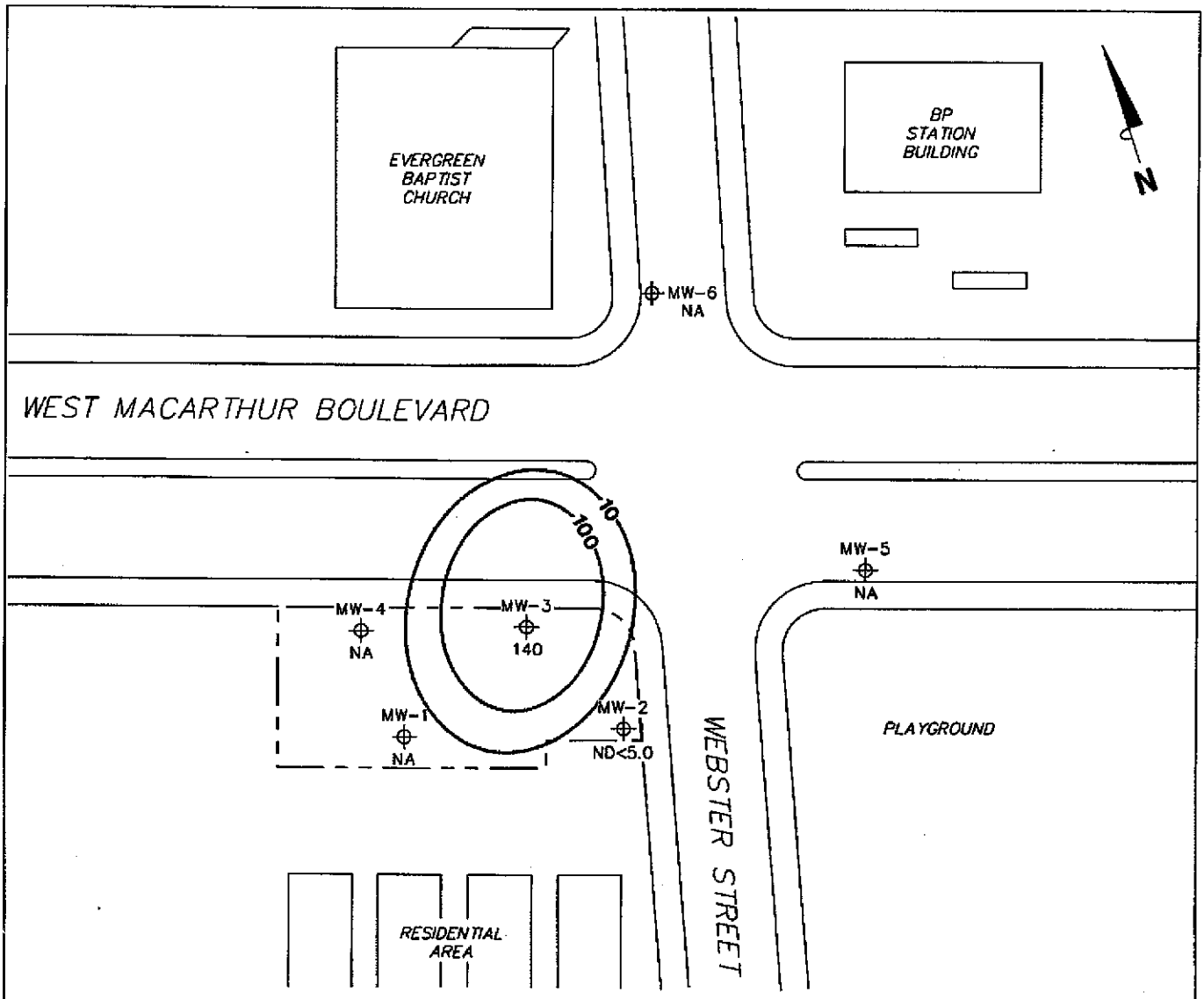

FIGURE 4

PS=1:1 3538-003



NOTES:

Contour lines are interpretive and based on laboratory analysis results of groundwater samples. MTBE = methyl tertiary butyl ether. µg/l = micrograms per liter. ND = not detected at limit indicated on official laboratory report. NA = not analyzed, measured, or collected. Results obtained using EPA Method 8021B.

LEGEND

MW-6 ⊕ Monitoring Well with Dissolved-Phase MTBE Concentration (µg/l)

—100— Dissolved-Phase MTBE Contour (µg/l)

DISSOLVED-PHASE MTBE CONCENTRATION MAP
March 2, 2005

Former 76 Station 3538
 411 West MacArthur Boulevard
 Oakland, California

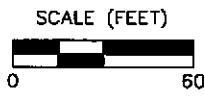

FIGURE 5

PS=1:1 3538-003

TRC

Customer-Focused Solutions

April 4, 2005

ConocoPhillips Company
76 Broadway
Sacramento, CA 95818

ATTN: MR. THOMAS H. KOSEL

SITE: FORMER 76 STATION 3538
411 WEST MACARTHUR BLVD.
OAKLAND, CALIFORNIA

RE: SEMI-ANNUAL MONITORING REPORT
OCTOBER 2004 THROUGH MARCH 2005

Dear Mr. Kosel:

Please find enclosed our Semi-Annual Monitoring Report for Former 76 Station 3538, located at 411 West MacArthur Blvd, Oakland, California. If you have any questions regarding this report, please call us at (949) 753-0101.

Sincerely,

TRC



Anju Farfan
QMS Operations Manager

CC: Ms. Roger Batra, TRC (2 copies)

Enclosures
20-0400/3538R03.QMS



Customer-Focused Solutions

**SEMI-ANNUAL MONITORING REPORT
OCTOBER 2004 THROUGH MARCH 2005**

Former 76 Station 3538
411 West MacArthur Blvd.
Oakland, California

Prepared For:

Mr. Thomas H. Kosel
CONOCOPHILLIPS COMPANY
76 Broadway
Sacramento, California 95818

By:



Senior Project Geologist, Irvine Operations
April 4, 2005

LIST OF ATTACHMENTS

Summary Sheet	Summary of Gauging and Sampling Activities
Tables	Table Key Table 1: Current Fluid Levels and Selected Analytical Results Table 2: Historic Fluid Levels and Selected Analytical Results Table 3: Additional Analytical Results Table 3b: Additional Analytical Results Table 3c: Additional Analytical Results
Figures	Figure 1: Vicinity Map Figure 2: Groundwater Elevation Contour Map Figure 3: Dissolved-Phase TPH-G Concentration Map Figure 4: Dissolved-Phase Benzene Concentration Map Figure 5: Dissolved-Phase MTBE Concentration Map
Graphs	Groundwater Elevations vs. Time Benzene Concentrations vs. Time
Field Activities	General Field Procedures Groundwater Sampling Field Notes
Laboratory Reports	Official Laboratory Reports Quality Control Reports Chain of Custody Records
Statements	Purge Water Disposal Limitations

Summary of Gauging and Sampling Activities
October 2004 through March 2005
Former 76 Station 3538
411 West MacArthur Blvd.
Oakland, CA

Project Coordinator: **Thomas H. Kosel**
Telephone: **916-588-7666**

Water Sampling Contractor: **TRC**
Compiled by: **Valentina Tobon**

Date(s) of Gauging/Sampling Event: **03/02/05**

Sample Points

Groundwater wells: **4 onsite, 2 offsite** Wells gauged: **6** Wells sampled: **2**
Purging method: **Diaphragm pump**
Purge water disposal: **Onyx/Rodeo Unit 100**
Other Sample Points: **0** Type: **n/a**

Liquid Phase Hydrocarbons (LPH)

Wells with LPH: **0** Maximum thickness (feet): **n/a**
LPH removal frequency: **n/a** Method: **n/a**
Treatment or disposal of water/LPH: **n/a**

Hydrogeologic Parameters

Depth to groundwater (below TOC): Minimum: **14.51 feet** Maximum: **16.63 feet**
Average groundwater elevation (relative to available local datum): **55.42 feet**
Average change in groundwater elevation since previous event: **0.99 feet**
Interpreted groundwater gradient and flow direction:
 Current event: **0.02 ft/ft, south**
 Previous event: **0.02 ft/ft, sw (07/29/04)**

Selected Laboratory Results

Wells with detected **Benzene**: **1** Wells above MCL (1.0 µg/l): **1**
 Maximum reported benzene concentration: **26 µg/l (MW-2)**

Wells with **TPH-G** **2** Maximum: **99 µg/l (MW-2)**
Wells with **MTBE** **1** Maximum: **140 µg/l (MW-3)**

Notes:

MW-1=Sampled Annually, MW-4=Sampled Annually, MW-5=Sampled Annually, MW-6=Sampled Annually,

TABLE KEY

STANDARD ABBREVIATIONS

--	=	not analyzed, measured, or collected
LPH	=	liquid-phase hydrocarbons
Trace	=	less than 0.01 foot of LPH in well
µg/l	=	micrograms per liter (approx. equivalent to parts per billion, ppb)
mg/l	=	milligrams per liter (approx. equivalent to parts per million, ppm)
ND <	=	not detected at or above laboratory detection limit
TOC	=	top of casing (surveyed reference elevation)

ANALYTES

BTEX	=	benzene, toluene, ethylbenzene, and (total) xylenes
DIPE	=	di-isopropyl ether
ETBE	=	ethyl tertiary butyl ether
MTBE	=	methyl tertiary butyl ether
PCB	=	polychlorinated biphenyls
PCE	=	tetrachloroethene
TBA	=	tertiary butyl alcohol
TCA	=	trichloroethane
TCE	=	trichloroethene
TPH-G	=	total petroleum hydrocarbons with gasoline distinction
TPH-D	=	total petroleum hydrocarbons with diesel distinction
TPPH	=	total purgeable petroleum hydrocarbons
TRPH	=	total recoverable petroleum hydrocarbons
TAME	=	tertiary amyl methyl ether
1,1-DCA	=	1,1-dichloroethane
1,2-DCA	=	1,2-dichloroethane (same as EDC, ethylene dichloride)
1,1-DCE	=	1,1-dichloroethene
1,2-DCE	=	1,2-dichloroethene (cis- and trans-)

NOTES

1. Elevations are in feet above mean sea level. Depths are in feet below surveyed top-of-casing.
2. Groundwater elevations for wells with LPH are calculated as: $\text{Surface Elevation} - \text{Measured Depth to Water} + (\text{Dp} \times \text{LPH Thickness})$, where Dp is the density of the LPH, if known. A value of 0.75 is used for gasoline and when the density is not known. A value of 0.83 is used for diesel.
3. Wells with LPH are generally not sampled for laboratory analysis (see General Field Procedures).
4. Comments shown on tables are general. Additional explanations may be included in field notes and laboratory reports, both of which are included as part of this report.
5. A "J" flag indicates that a reported analytical result is an estimated concentration value between the method detection limit (MDL) and the practical quantification limit (PQL) specified by the laboratory.
6. Other laboratory flags (qualifiers) may have been reported. See the official laboratory report (attached) for a complete list of laboratory flags.
7. Concentration graphs based on tables (presented following Figures) show non-detect results prior to the Second Quarter 2000 plotted at fixed values for graphical display. Non-detect results reported since that time are plotted at reporting limits stated in the official laboratory report.
8. Groundwater vs. Time graphs may be corrected for apparent level changes due to re-survey.

REFERENCE

TRC began groundwater monitoring and sampling for Former 76 Station 3538 in October 2003. Historical data compiled prior to that time were provided by Gettler-Ryan Inc.

Table 1
CURRENT FLUID LEVELS AND SELECTED ANALYTICAL RESULTS
March 2, 2005
Former 76 Station 3538

Date Sampled	TOC Elevation (feet)	Depth to Water (feet)	LPH Thickness (feet)	Ground-water Elevation (feet)	Change in Elevation (feet)	TPH-G (µg/l)	TPPH 8260B (µg/l)	Benzene (µg/l)	Toluene (µg/l)	Ethyl-benzene (µg/l)	Total Xylenes (µg/l)	MTBE 8021B (µg/l)	MTBE 8260B (µg/l)	Comments
MW-1														
03/02/05	72.12	16.15	0.00	55.97	1.97	--	--	--	--	--	--	--	--	Sampled Annually
MW-2														
03/02/05	71.34	16.63	0.00	54.71	--	99	--	26	ND<0.50	3.5	2.8	ND<5.0	--	
MW-3														
03/02/05	71.40	16.47	0.00	54.93	1.35	93	--	ND<0.50	ND<0.50	ND<0.50	ND<0.50	140	--	
MW-4														
03/02/05	71.54	16.25	0.00	55.29	1.56	--	--	--	--	--	--	--	--	Sampled Annually
MW-5														
03/02/05	71.16	16.43	0.00	54.73	-0.41	--	--	--	--	--	--	--	--	Sampled Annually
MW-6														
03/02/05	71.37	14.51	0.00	56.86	0.47	--	--	--	--	--	--	--	--	Sampled Annually

Table 2
HISTORIC FLUID LEVELS AND SELECTED ANALYTICAL RESULTS
September 1989 Through March 2005
Former 76 Station 3538

Date Sampled	TOC Elevation (feet)	Depth to Water (feet)	LPH Thickness (feet)	Ground-water Elevation (feet)	Change in Elevation (feet)	TPH-G (µg/l)	TPPH 8260B (µg/l)	Benzene (µg/l)	Toluene (µg/l)	Ethyl-benzene (µg/l)	Total Xylenes (µg/l)	MTBE 8021B (µg/l)	MTBE 8260B (µg/l)	Comments
MW-1														
09/15/89	--	--	--	--	--	ND	--	ND	0.61	ND	ND	--	--	
01/23/90	--	--	--	--	--	ND	--	1.5	2.3	ND	4.3	--	--	
04/19/90	--	--	--	--	--	ND	--	ND	ND	ND	ND	--	--	
07/17/90	--	--	--	--	--	ND	--	ND	ND	ND	ND	--	--	
10/16/90	--	--	--	--	--	ND	--	ND	ND	ND	ND	--	--	
01/15/91	--	--	--	--	--	ND	--	ND	ND	ND	ND	--	--	
04/12/91	--	--	--	--	--	ND	--	ND	ND	ND	ND	--	--	
07/15/91	--	--	--	--	--	ND	--	ND	ND	ND	ND	--	--	
07/14/92	--	--	--	--	--	ND	--	ND	ND	ND	ND	--	--	
04/13/93	72.43	17.70	0.00	54.73	--	--	--	--	--	--	--	--	--	SAMPLED ANNUALLY
07/14/93	72.43	18.49	0.00	53.94	-0.79	ND	--	2.2	2.1	1.1	6.2	--	--	
10/14/93	72.10	18.32	0.00	53.78	-0.16	--	--	--	--	--	--	--	--	
01/12/94	72.10	18.18	0.00	53.92	0.14	--	--	--	--	--	--	--	--	
04/11/94	72.10	17.80	0.00	54.30	--	--	--	--	--	--	--	--	--	
07/07/94	72.10	18.28	0.00	53.82	-0.48	ND	--	ND	ND	ND	ND	--	--	
10/05/94	72.10	18.55	0.00	53.55	-0.27	--	--	--	--	--	--	--	--	
01/09/95	72.10	17.90	0.00	54.20	0.65	--	--	--	--	--	--	--	--	
04/17/95	72.10	17.22	0.00	54.88	0.68	--	--	--	--	--	--	--	--	
07/19/95	72.10	18.03	0.00	54.07	-0.81	ND	--	ND	ND	ND	ND	--	--	
10/26/95	72.10	18.67	0.00	53.43	-0.64	--	--	--	--	--	--	--	--	
01/16/96	72.10	17.20	0.00	54.90	1.47	--	--	--	--	--	--	--	--	
04/15/96	72.10	17.40	0.00	54.70	-0.20	--	--	--	--	--	--	--	--	
07/11/96	72.10	18.03	0.00	54.07	-0.63	ND	--	ND	ND	ND	ND	ND	--	
01/17/97	72.10	16.54	0.00	55.56	1.49	--	--	--	--	--	--	--	--	

Table 2
HISTORIC FLUID LEVELS AND SELECTED ANALYTICAL RESULTS
September 1989 Through March 2005
Former 76 Station 3538

Date Sampled	TOC Elevation (feet)	Depth to Water (feet)	LPH Thickness (feet)	Ground-water Elevation (feet)	Change in Elevation (feet)	TPH-G (µg/l)	TPPH 8260B (µg/l)	Benzene (µg/l)	Toluene (µg/l)	Ethyl-benzene (µg/l)	Total Xylenes (µg/l)	MTBE 8021B (µg/l)	MTBE 8260B (µg/l)	Comments
MW-1 continued														
07/21/97	72.10	18.16	0.00	53.94	-1.62	ND	--	ND	ND	ND	ND	ND	--	
01/14/98	72.10	16.05	0.00	56.05	2.11	--	--	--	--	--	--	--	--	
07/06/98	72.10	16.46	0.00	55.64	-0.41	ND	--	ND	ND	ND	ND	ND	--	
01/13/99	72.10	17.37	0.00	54.73	-0.91	--	--	--	--	--	--	--	--	
08/31/99	72.12	17.00	0.00	55.12	0.39	ND	--	ND	ND	ND	ND	ND	--	
01/21/00	72.12	17.04	0.00	55.08	-0.04	--	--	--	--	--	--	--	--	
07/10/00	72.12	18.10	0.00	54.02	-1.06	ND	--	ND	ND	ND	ND	ND	--	
01/04/01	72.12	17.95	0.00	54.17	--	--	--	--	--	--	--	--	--	
07/16/01	72.12	18.03	0.00	54.09	-0.08	ND	--	ND	ND	ND	ND	ND	--	
01/28/02	72.12	17.31	0.00	54.81	0.72	--	--	--	--	--	--	--	--	SAMPLED ANNUALLY
07/12/02	72.12	18.15	0.00	53.97	-0.84	ND<50	--	ND<0.50	ND<0.50	ND<0.50	ND<0.50	ND<2.5	--	
01/14/03	72.12	17.66	0.00	54.46	0.49	--	--	--	--	--	--	--	--	SAMPLED ANNUALLY
07/10/03	72.12	17.86	0.00	54.26	-0.20	ND<50	--	ND<0.50	ND<0.50	ND<0.50	ND<0.50	ND<2.0	--	
02/04/04	72.12	17.43	0.00	54.69	0.43	--	--	--	--	--	--	--	--	Monitored Only
07/29/04	72.12	18.12	0.00	54.00	-0.69	ND<50	--	ND<0.3	0.38	ND<0.3	ND<0.6	ND<1	ND<0.5	
03/02/05	72.12	16.15	0.00	55.97	1.97	--	--	--	--	--	--	--	--	Sampled Annually
MW-2														
09/15/89	--	--	--	--	--	290	--	ND	12	ND	ND	--	--	
01/23/90	--	--	--	--	--	400	--	73	36	10	40	--	--	
04/19/90	--	--	--	--	--	3900	--	550	5.1	91	390	--	--	
07/17/90	--	--	--	--	--	490	--	76	0.59	11	46	--	--	
10/16/90	--	--	--	--	--	1400	--	430	2.0	48	240	--	--	
01/15/91	--	--	--	--	--	680	--	170	0.7	19	81	--	--	
04/12/91	--	--	--	--	--	2200	--	160	4.3	23	62	--	--	

Table 2
HISTORIC FLUID LEVELS AND SELECTED ANALYTICAL RESULTS
September 1989 Through March 2005
Former 76 Station 3538

Date Sampled	TOC Elevation (feet)	Depth to Water (feet)	LPH Thickness (feet)	Ground-water Elevation (feet)	Change in Elevation (feet)	TPH-G (µg/l)	TPPH 8260B (µg/l)	Benzene (µg/l)	Toluene (µg/l)	Ethyl-benzene (µg/l)	Total Xylenes (µg/l)	MTBE 8021B (µg/l)	MTBE 8260B (µg/l)	Comments
MW-2 continued														
07/15/91	--	--	--	--	--	2200	--	770	12	72	370	--	--	
10/15/91	--	--	--	--	--	140	--	44	0.56	1.5	12	--	--	
01/15/92	--	--	--	--	--	220	--	37	0.52	1.1	7	--	--	
04/14/92	--	--	--	--	--	150	--	6.2	ND	ND	1.4	--	--	
07/14/92	--	--	--	--	--	130	--	3.7	ND	ND	ND	--	--	
10/12/92	--	--	--	--	--	370	--	3.4	0.56	ND	11	--	--	
01/08/93	--	--	--	--	--	510	--	ND	ND	ND	ND	--	--	
04/13/93	71.63	17.86	0.00	53.77	--	410	--	42	7.7	6.4	28	200	--	
07/14/93	71.63	18.38	0.00	53.25	-0.52	110	--	6.5	ND	ND	1.1	250	--	
10/14/93	71.38	18.20	0.00	53.18	-0.07	230	--	5.3	ND	ND	2.1	--	--	
01/12/94	71.38	18.08	0.00	53.30	0.12	300	--	7.8	3.8	1.8	10	--	--	
04/09/94	71.38	17.97	0.00	53.41	0.11	120	--	10	0.88	1.1	4.9	--	--	
04/11/94	71.38	17.88	0.00	53.50	0.09	--	--	--	--	--	--	--	--	
07/07/94	71.38	17.81	0.00	53.57	0.07	110	--	4.4	ND	ND	ND	--	--	
10/05/94	71.38	18.33	0.00	53.05	-0.52	720	--	20	ND	ND	3.1	--	--	
01/09/95	71.38	17.40	0.00	53.98	0.93	ND	--	ND	ND	ND	ND	--	--	
04/17/95	71.38	17.50	0.00	53.88	-0.10	93	--	5.6	0.62	1.7	5.5	--	--	
07/19/95	71.38	18.01	0.00	53.37	-0.51	77	--	32	0.58	1.7	4.1	--	--	
10/26/95	71.38	18.21	0.00	53.17	-0.20	54	--	13	ND	ND	0.72	220	--	
01/16/96	71.38	16.58	0.00	54.80	1.63	120	--	23	ND	ND	0.99	--	--	
04/15/96	71.38	17.61	0.00	53.77	-1.03	340	--	21	ND	2.2	3.7	45	--	
07/11/96	71.38	17.98	0.00	53.40	-0.37	540	--	34	ND	4.3	12	150	--	
01/17/97	71.38	17.08	0.00	54.30	0.90	320	--	63	2.4	9.4	26	260	--	
07/21/97	71.38	18.06	0.00	53.32	-0.98	160	--	13	ND	1.3	1.6	180	--	

Table 2
HISTORIC FLUID LEVELS AND SELECTED ANALYTICAL RESULTS
September 1989 Through March 2005
Former 76 Station 3538

Date Sampled	TOC Elevation (feet)	Depth to Water (feet)	LPH Thickness (feet)	Ground-water Elevation (feet)	Change in Elevation (feet)	TPH-G (µg/l)	TPPH 8260B (µg/l)	Benzene (µg/l)	Toluene (µg/l)	Ethyl-benzene (µg/l)	Total Xylenes (µg/l)	MTBE 8021B (µg/l)	MTBE 8260B (µg/l)	Comments
MW-2 continued														
01/14/98	71.38	16.52	0.00	54.86	1.54	66	--	6.3	ND	ND	0.98	100	--	
07/06/98	71.38	16.87	0.00	54.51	-0.35	ND	--	2.3	ND	ND	ND	11	--	
01/13/99	71.38	17.88	0.00	53.50	-1.01	53	--	24	ND	0.52	0.98	120	--	
08/31/99	71.34	18.45	0.00	52.89	-0.61	86	--	14	ND	0.63	ND	21	--	
01/21/00	71.34	17.73	0.00	53.61	0.72	ND	--	1.94	ND	ND	ND	10.1	--	
07/10/00	71.34	18.14	0.00	53.20	-0.41	ND	--	ND	ND	ND	ND	46.6	--	
01/04/01	71.34	18.02	0.00	53.32	--	ND	--	0.925	ND	ND	ND	ND	--	
07/16/01	71.34	18.02	0.00	53.32	0.00	ND	--	ND	ND	ND	ND	ND	--	
01/28/02	71.34	17.57	0.00	53.77	0.45	ND<50	--	ND<0.50	ND<0.50	ND<0.50	ND<0.50	ND<2.5	--	
07/12/02	71.34	18.05	0.00	53.29	-0.48	ND<50	--	ND<0.50	ND<0.50	ND<0.50	ND<0.50	ND<2.5	--	
01/14/03	71.34	17.44	0.00	53.90	0.61	ND<50	--	ND<0.50	ND<0.50	ND<0.50	ND<0.50	ND<2.0	--	
07/10/03	71.34	--	--	--	--	--	--	--	--	--	--	--	--	INACCESSIBLE - VEHICLE PARKED OVER WELL
02/04/04	71.34	17.22	0.00	54.12	--	ND<50	--	ND<0.50	ND<0.50	ND<0.50	ND<0.50	ND<5.0	--	
07/29/04	71.34	--	--	--	--	--	--	--	--	--	--	--	--	Inaccessible-car parked on well
03/02/05	71.34	16.63	0.00	54.71	--	99	--	26	ND<0.50	3.5	2.8	ND<5.0	--	
MW-3														
09/15/89	--	--	--	--	--	32	--	ND	ND	ND	ND	--	--	
01/23/90	--	--	--	--	--	450	--	110	1.2	4.4	11	--	--	
04/19/90	--	--	--	--	--	3100	--	600	27	54	220	--	--	
07/17/90	--	--	--	--	--	4000	--	270	48	130	250	--	--	
10/16/90	--	--	--	--	--	740	--	210	1.4	2.5	82	--	--	
01/15/91	--	--	--	--	--	3200	--	460	1.5	120	270	--	--	
04/12/91	--	--	--	--	--	880	--	170	1.1	34	110	--	--	

Table 2
HISTORIC FLUID LEVELS AND SELECTED ANALYTICAL RESULTS
September 1989 Through March 2005
Former 76 Station 3538

Date Sampled	TOC Elevation (feet)	Depth to Water (feet)	LPH Thickness (feet)	Ground-water Elevation (feet)	Change in Elevation (feet)	TPH-G (µg/l)	TPPH 8260B (µg/l)	Benzenc (µg/l)	Toluene (µg/l)	Ethyl-benzene (µg/l)	Total Xylenes (µg/l)	MTBE 8021B (µg/l)	MTBE 8260B (µg/l)	Comments
MW-3 continued														
07/15/91	--	--	--	--	--	9200	--	1300	230	490	1900	--	--	
10/15/91	--	--	--	--	--	3100	--	390	34	150	390	--	--	
01/15/92	--	--	--	--	--	3000	--	590	14	310	750	--	--	
04/14/92	--	--	--	--	--	14000	--	660	48	560	2000	--	--	
07/14/92	--	--	--	--	--	21000	--	890	200	1200	4300	--	--	
10/12/92	--	--	--	--	--	3200	--	160	10	230	540	--	--	
01/08/93	--	--	--	--	--	1100	--	48	0.99	0.9	93	--	--	
04/13/93	72.06	17.96	0.00	54.10	--	12000	--	290	38	760	2300	1400	--	
07/14/93	72.06	18.54	0.00	53.52	-0.58	6300	--	190	ND	430	1000	860	--	
10/14/93	71.86	18.45	0.00	53.41	-0.11	2500	--	52	ND	110	250	--	--	
01/12/94	71.86	18.34	0.00	53.52	0.11	3800	--	78	ND	180	390	--	--	
04/09/94	71.86	18.19	0.00	53.67	0.15	1800	--	22	ND	140	280	--	--	
04/11/94	71.86	18.12	0.00	53.74	0.07	--	--	--	--	--	--	--	--	
07/07/94	71.86	18.21	0.00	53.65	-0.09	110	--	4.5	ND	ND	ND	--	--	
10/05/94	71.86	18.58	0.00	53.28	-0.37	ND	--	ND	ND	ND	ND	--	--	
01/09/95	71.86	17.69	0.00	54.17	0.89	ND	--	0.68	ND	ND	ND	--	--	
04/17/95	71.86	17.68	0.00	54.18	0.01	3700	--	80	10	270	510	--	--	
07/19/95	71.86	18.20	0.00	53.66	-0.52	15000	--	330	27	990	2400	--	--	
10/26/95	71.86	18.32	0.00	53.54	-0.12	14000	--	420	180	750	1600	4800	--	
01/16/96	71.86	17.95	0.00	53.91	0.37	920	--	38	ND	30	57	--	--	
04/15/96	71.86	17.78	0.00	54.08	0.17	9700	--	240	ND	570	860	3200	--	
07/11/96	71.86	18.19	0.00	53.67	-0.41	13000	--	69	5.5	430	900	740	--	
01/17/97	71.86	17.23	0.00	54.63	0.96	4400	--	25	ND	270	580	1600	--	
07/21/97	71.86	18.29	0.00	53.57	-1.06	9000	--	36	ND	450	800	950	--	

Table 2
HISTORIC FLUID LEVELS AND SELECTED ANALYTICAL RESULTS
September 1989 Through March 2005
Former 76 Station 3538

Date Sampled	TOC Elevation (feet)	Depth to Water (feet)	LPH Thickness (feet)	Ground-water Elevation (feet)	Change in Elevation (feet)	TPH-G (µg/l)	TPPH 8260B (µg/l)	Benzene (µg/l)	Toluene (µg/l)	Ethyl-benzene (µg/l)	Total Xylenes (µg/l)	MTBE 8021B (µg/l)	MTBE 8260B (µg/l)	Comments
MW-3 continued														
01/14/98	71.86	16.71	0.00	55.15	1.58	7100	--	40	ND	380	360	930	--	
07/06/98	71.86	17.03	0.00	54.83	-0.32	6800	--	39	ND	320	360	370	--	
01/13/99	71.86	18.00	0.00	53.86	-0.97	1800	--	9.4	ND	58	36	180	--	
08/31/99	71.40	--	0.00	--	--	--	--	--	--	--	--	--	--	Well obstructed at 0.5 feet.
01/21/00	71.40	17.58	0.00	53.82	--	ND	--	ND	ND	ND	ND	21.4	--	
07/10/00	71.40	18.05	0.00	53.35	-0.47	ND	--	ND	ND	ND	ND	162	--	
08/25/00	71.40	17.82	0.00	53.58	0.23	--	--	--	--	--	--	--	180	
01/04/01	71.40	18.16	0.00	53.24	-0.34	ND	--	ND	ND	ND	ND	193	--	
07/16/01	71.40	17.98	0.00	53.42	0.18	ND	--	ND	ND	ND	ND	660	--	
01/28/02	71.40	17.84	0.00	53.56	0.14	ND<50	--	ND<0.50	ND<0.50	ND<0.50	ND<0.50	34	--	
07/12/02	71.40	17.87	0.00	53.53	-0.03	ND<50	--	ND<0.50	ND<0.50	ND<0.50	ND<0.50	11	19	
01/14/03	71.40	17.28	0.00	54.12	0.59	ND<50	--	ND<0.50	ND<0.50	ND<0.50	ND<0.50	12	--	
07/10/03	71.40	17.64	0.00	53.76	-0.36	ND<50	--	ND<0.50	ND<0.50	ND<0.50	ND<0.50	23	--	
02/04/04	71.40	17.05	0.00	54.35	0.59	ND<50	--	ND<0.50	ND<0.50	ND<0.50	ND<0.50	26	--	
07/29/04	71.40	17.82	0.00	53.58	-0.77	ND<50	--	ND<0.3	ND<0.3	ND<0.3	ND<0.6	ND<1	--	
03/02/05	71.40	16.47	0.00	54.93	1.35	93	--	ND<0.50	ND<0.50	ND<0.50	ND<0.50	140	--	
MW-4														
09/15/89	--	--	--	--	--	ND	--	ND	ND	ND	ND	--	--	
01/23/90	--	--	--	--	--	ND	--	ND	0.4	ND	ND	--	--	
04/19/90	--	--	--	--	--	ND	--	ND	0.48	ND	ND	--	--	
07/17/90	--	--	--	--	--	ND	--	ND	ND	ND	ND	--	--	
10/16/90	--	--	--	--	--	ND	--	ND	ND	ND	ND	--	--	
01/15/91	--	--	--	--	--	ND	--	ND	ND	--	ND	--	--	
04/12/91	--	--	--	--	--	ND	--	ND	ND	ND	ND	--	--	

Table 2
HISTORIC FLUID LEVELS AND SELECTED ANALYTICAL RESULTS
September 1989 Through March 2005
Former 76 Station 3538

Date Sampled	TOC Elevation (feet)	Depth to Water (feet)	LPH Thickness (feet)	Ground-water Elevation (feet)	Change in Elevation (feet)	TPH-G (µg/l)	TPPH 8260B (µg/l)	Benzene (µg/l)	Toluene (µg/l)	Ethyl-benzene (µg/l)	Total Xylenes (µg/l)	MTBE 8021B (µg/l)	MTBE 8260B (µg/l)	Comments
MW-4 continued														
07/15/91	--	--	--	--	--	ND	--	ND	ND	ND	ND	--	--	
07/14/92	--	--	--	--	--	ND	--	1.3	2.5	ND	1.0	--	--	
04/13/93	71.98	17.67	0.00	54.31	--	--	--	--	--	--	--	--	--	SAMPLED ANNUALLY
07/14/93	71.98	18.31	0.00	53.67	-0.64	ND	--	ND	ND	ND	ND	--	--	
10/14/93	71.64	18.08	0.00	53.56	-0.11	--	--	--	--	--	--	--	--	
01/12/94	71.64	17.97	0.00	53.67	0.11	--	--	--	--	--	--	--	--	
04/11/94	71.64	17.70	0.00	53.94	--	--	--	--	--	--	--	--	--	
07/07/94	71.64	17.80	0.00	53.84	-0.10	ND	--	ND	ND	ND	ND	--	--	
10/05/94	71.64	18.28	0.00	53.36	-0.48	--	--	--	--	--	--	--	--	
01/09/95	71.64	17.38	0.00	54.26	0.90	--	--	--	--	--	--	--	--	
04/17/95	71.64	17.21	0.00	54.43	0.17	--	--	--	--	--	--	--	--	SAMPLED ANNUALLY
07/19/95	71.64	17.82	0.00	53.82	-0.61	ND	--	ND	ND	ND	ND	--	--	
10/26/95	71.64	18.17	0.00	53.47	-0.35	--	--	--	--	--	--	--	--	
01/16/96	71.64	16.45	0.00	55.19	1.72	--	--	--	--	--	--	--	--	
04/15/96	71.64	17.35	0.00	54.29	-0.90	--	--	--	--	--	--	--	--	
07/11/96	71.64	17.81	0.00	53.83	-0.46	ND	--	ND	ND	ND	ND	ND	--	
01/17/97	71.64	16.73	0.00	54.91	1.08	--	--	--	--	--	--	--	--	
07/21/97	71.64	17.91	0.00	53.73	-1.18	ND	--	ND	ND	ND	ND	ND	--	
01/14/98	71.64	16.18	0.00	55.46	1.73	--	--	--	--	--	--	--	--	
07/06/98	71.64	16.49	0.00	55.15	-0.31	ND	--	ND	ND	ND	ND	ND	--	
01/13/99	71.64	17.29	0.00	54.35	-0.80	--	--	--	--	--	--	--	--	
08/31/99	71.54	--	0.00	--	--	--	--	--	--	--	--	--	--	Well obstructed at 10.4 feet.
01/21/00	71.54	17.51	0.00	54.03	--	--	--	--	--	--	--	--	--	
07/10/00	71.54	17.93	0.00	53.61	-0.42	ND	--	ND	ND	ND	ND	ND	--	

Table 2
HISTORIC FLUID LEVELS AND SELECTED ANALYTICAL RESULTS
September 1989 Through March 2005
Former 76 Station 3538

Date Sampled	TOC Elevation (feet)	Depth to Water (feet)	LPH Thickness (feet)	Ground-water Elevation (feet)	Change in Elevation (feet)	TPH-G (µg/l)	TPPH 8260B (µg/l)	Benzene (µg/l)	Toluene (µg/l)	Ethyl-benzene (µg/l)	Total Xylenes (µg/l)	MTBE 8021B (µg/l)	MTBE 8260B (µg/l)	Comments
MW-4 continued														
01/04/01	71.54	18.10	0.00	53.44	--	--	--	--	--	--	--	--	--	
07/16/01	71.54	17.76	0.00	53.78	0.34	ND	--	ND	ND	ND	ND	ND	--	
01/28/02	71.54	17.20	0.00	54.34	0.56	--	--	--	--	--	--	--	--	SAMPLED ANNUALLY
07/12/02	71.54	17.81	0.00	53.73	-0.61	ND<50	--	ND<0.50	ND<0.50	ND<0.50	ND<0.50	ND<2.5	--	
01/14/03	71.54	17.30	0.00	54.24	0.51	--	--	--	--	--	--	--	--	SAMPLED ANNUALLY
07/10/03	71.54	17.58	0.00	53.96	-0.28	ND<50	--	ND<0.50	ND<0.50	ND<0.50	ND<0.50	ND<2.0	--	
02/04/04	71.54	17.07	0.00	54.47	0.51	--	--	--	--	--	--	--	--	Monitored Only
07/29/04	71.54	17.81	0.00	53.73	-0.74	ND<50	--	ND<0.3	ND<0.3	ND<0.3	ND<0.6	ND<1	--	
03/02/05	71.54	16.25	0.00	55.29	1.56	--	--	--	--	--	--	--	--	Sampled Annually
MW-5														
11/30/92	--	--	--	--	--	ND	--	ND	ND	ND	ND	--	--	
01/08/93	--	--	--	--	--	ND	--	ND	ND	ND	ND	--	--	
04/13/93	71.51	17.49	0.00	54.02	--	ND	--	ND	ND	ND	ND	--	--	
07/14/93	71.51	18.02	0.00	53.49	-0.53	ND	--	ND	0.57	ND	ND	--	--	
10/14/93	71.23	17.82	0.00	53.41	-0.08	ND	--	ND	ND	ND	ND	--	--	
01/12/94	71.23	17.74	0.00	53.49	0.08	ND	--	ND	0.84	ND	1.6	--	--	
04/11/94	71.23	17.56	0.00	53.67	--	--	--	--	--	--	--	--	--	SAMPLED ANNUALLY
07/07/94	71.23	17.50	0.00	53.73	0.06	ND	--	ND	ND	ND	ND	--	--	
10/05/94	71.23	17.98	0.00	53.25	-0.48	--	--	--	--	--	--	--	--	
01/09/95	71.23	17.13	0.00	54.10	0.85	--	--	--	--	--	--	--	--	
04/17/95	71.23	17.05	0.00	54.18	0.08	--	--	--	--	--	--	--	--	
07/19/95	71.23	17.59	0.00	53.64	-0.54	ND	--	ND	ND	ND	ND	--	--	
10/26/95	71.23	18.10	0.00	53.13	-0.51	--	--	--	--	--	--	--	--	
01/16/96	71.23	17.11	0.00	54.12	0.99	--	--	--	--	--	--	--	--	

Table 2
HISTORIC FLUID LEVELS AND SELECTED ANALYTICAL RESULTS
September 1989 Through March 2005
Former 76 Station 3538

Date Sampled	TOC Elevation (feet)	Depth to Water (feet)	LPH Thickness (feet)	Ground-water Elevation (feet)	Change in Elevation (feet)	TPH-G (µg/l)	TPPH 8260B (µg/l)	Benzene (µg/l)	Toluene (µg/l)	Ethyl-benzene (µg/l)	Total Xylenes (µg/l)	MTBE 8021B (µg/l)	MTBE 8260B (µg/l)	Comments
MW-5 continued														
04/15/96	71.23	17.22	0.00	54.01	-0.11	--	--	--	--	--	--	--	--	
07/11/96	71.23	17.59	0.00	53.64	-0.37	ND	--	ND	ND	ND	ND	ND	--	
01/17/97	71.23	16.75	0.00	54.48	0.84	--	--	--	--	--	--	--	--	SAMPLED ANNUALLY
07/21/97	71.23	17.59	0.00	53.64	-0.84	ND	--	ND	ND	ND	ND	ND	--	
01/14/98	71.23	16.16	0.00	55.07	1.43	--	--	--	--	--	--	--	--	
07/06/98	71.23	16.52	0.00	54.71	-0.36	ND	--	ND	ND	ND	ND	ND	--	
01/13/99	71.23	17.62	0.00	53.61	-1.10	--	--	--	--	--	--	--	--	
08/31/99	71.16	17.76	0.00	53.40	-0.21	ND	--	ND	ND	ND	ND	ND	--	
01/21/00	71.16	16.83	0.00	54.33	0.93	--	--	--	--	--	--	--	--	
07/10/00	71.16	17.46	0.00	53.70	-0.63	ND	--	ND	ND	ND	ND	ND	--	
01/04/01	71.16	17.51	0.00	53.65	--	--	--	--	--	--	--	--	--	
07/16/01	71.16	17.32	0.00	53.84	0.19	ND	--	ND	ND	ND	ND	ND	--	
01/28/02	71.16	17.12	0.00	54.04	0.20	--	--	--	--	--	--	--	--	SAMPLED ANNUALLY
07/12/02	71.16	17.12	0.00	54.04	0.00	ND<50	--	ND<0.50	ND<0.50	ND<0.50	ND<0.50	ND<2.5	--	
01/14/03	71.16	16.67	0.00	54.49	0.45	--	--	--	--	--	--	--	--	SAMPLED ANNUALLY
07/10/03	71.16	17.39	0.00	53.77	-0.72	ND<50	--	ND<0.50	ND<0.50	ND<0.50	ND<0.50	ND<2.0	--	
02/04/04	71.16	16.23	0.00	54.93	1.16	--	--	--	--	--	--	--	--	Monitored Only
07/29/04	71.16	16.02	0.00	55.14	0.21	ND<50	--	ND<0.3	0.64	ND<0.3	0.79	ND<1	--	
03/02/05	71.16	16.43	0.00	54.73	-0.41	--	--	--	--	--	--	--	--	Sampled Annually
MW-6														
11/30/92	--	--	--	--	--	ND	--	ND	ND	ND	ND	--	--	
01/08/93	--	--	--	--	--	ND	--	ND	ND	ND	ND	--	--	
04/13/93	71.79	11.94	0.00	59.85	--	ND	--	ND	ND	ND	ND	--	--	
07/14/93	71.79	17.20	0.00	54.59	-5.26	ND	--	0.99	2.4	ND	1.9	--	--	

Table 2
HISTORIC FLUID LEVELS AND SELECTED ANALYTICAL RESULTS
September 1989 Through March 2005
Former 76 Station 3538

Date Sampled	TOC Elevation (feet)	Depth to Water (feet)	LPH Thickness (feet)	Ground-water Elevation (feet)	Change in Elevation (feet)	TPH-G (µg/l)	TPPH 8260B (µg/l)	Benzene (µg/l)	Toluene (µg/l)	Ethyl-benzene (µg/l)	Total Xylenes (µg/l)	MTBE 8021B (µg/l)	MTBE 8260B (µg/l)	Comments
MW-6 continued														
10/14/93	71.44	17.21	0.00	54.23	-0.36	ND	--	ND	0.64	ND	ND	--	--	
01/12/94	71.44	17.44	0.00	54.00	-0.23	ND	--	ND	1.2	ND	2.9	--	--	
04/11/94	71.44	13.66	0.00	57.78	--	--	--	--	--	--	--	--	--	SAMPLED ANNUALLY
07/07/94	71.44	14.05	0.00	57.39	-0.39	ND	--	ND	ND	ND	ND	--	--	
10/05/94	71.44	14.16	0.00	57.28	-0.11	--	--	--	--	--	--	--	--	
01/09/95	71.44	13.73	0.00	57.71	0.43	--	--	--	--	--	--	--	--	
04/17/95	71.44	11.30	0.00	60.14	2.43	--	--	--	--	--	--	--	--	
07/19/95	71.44	12.32	0.00	59.12	-1.02	ND	--	ND	ND	ND	ND	--	--	
10/26/95	71.44	17.88	0.00	53.56	-5.56	--	--	--	--	--	--	--	--	
01/16/96	71.44	16.38	0.00	55.06	1.50	--	--	--	--	--	--	--	--	
04/15/96	71.44	14.00	0.00	57.44	2.38	--	--	--	--	--	--	--	--	
07/11/96	71.44	13.58	0.00	57.86	0.42	ND	--	ND	ND	ND	ND	ND	--	
01/17/97	71.44	15.42	0.00	56.02	-1.84	--	--	--	--	--	--	--	--	
07/21/97	71.44	13.78	0.00	57.66	1.64	ND	--	ND	ND	ND	ND	ND	--	
01/14/98	71.44	13.65	0.00	57.79	0.13	--	--	--	--	--	--	--	--	
07/06/98	71.44	13.90	0.00	57.54	-0.25	ND	--	ND	ND	ND	ND	ND	--	
01/13/99	71.44	14.93	0.00	56.51	-1.03	--	--	--	--	--	--	--	--	
08/31/99	71.37	15.81	0.00	55.56	-0.95	ND	--	ND	ND	ND	ND	ND	--	
01/21/00	71.37	16.13	0.00	55.24	-0.32	--	--	--	--	--	--	--	--	SAMPLED ANNUALLY
07/10/00	71.37	16.95	0.00	54.42	-0.82	ND	--	ND	ND	ND	ND	ND	--	
01/04/01	71.37	17.09	0.00	54.28	--	--	--	--	--	--	--	--	--	
07/16/01	71.37	16.83	0.00	54.54	0.26	ND	--	ND	ND	ND	ND	ND	--	
01/28/02	71.37	14.58	0.00	56.79	2.25	--	--	--	--	--	--	--	--	SAMPLED ANNUALLY
07/12/02	71.37	16.76	0.00	54.61	-2.18	ND<50	--	ND<0.50	ND<0.50	ND<0.50	ND<0.50	ND<2.5	--	

Table 2
HISTORIC FLUID LEVELS AND SELECTED ANALYTICAL RESULTS
September 1989 Through March 2005
Former 76 Station 3538

Date Sampled	TOC Elevation (feet)	Depth to Water (feet)	LPH Thickness (feet)	Ground-water Elevation (feet)	Change in Elevation (feet)	TPH-G (µg/l)	TPPH 8260B (µg/l)	Benzene (µg/l)	Toluene (µg/l)	Ethyl-benzene (µg/l)	Total Xylenes (µg/l)	MTBE 8021B (µg/l)	MTBE 8260B (µg/l)	Comments
MW-6 continued														
01/14/03	71.37	16.25	0.00	55.12	0.51	--	--	--	--	--	--	--	--	SAMPLED ANNUALLY
07/10/03	71.37	12.97	0.00	58.40	3.28	ND<50	--	ND<0.50	ND<0.50	ND<0.50	ND<0.50	ND<2.0	--	
02/04/04	71.37	16.20	0.00	55.17	-3.23	--	--	--	--	--	--	--	--	Monitored Only
07/29/04	71.37	14.98	0.00	56.39	1.22	ND<50	--	ND<0.3	ND<0.3	ND<0.3	ND<0.6	1.3	--	
03/02/05	71.37	14.51	0.00	56.86	0.47	--	--	--	--	--	--	--	--	Sampled Annually

Table 3
ADDITIONAL ANALYTICAL RESULTS
Former 76 Station 3538

Date Sampled	TPH-D (µg/l)	cis-1,3-dichloropropene (µg/l)	trans-1,3-Dichloropropene (µg/l)	1,4-Dichlorobenzene (µg/l)	EDC (µg/l)	Chlorobenzene (µg/l)	Dibromochloromethane (µg/l)	PCE (µg/l)	cis-1,2-Dichloroethene (µg/l)	trans-1,2-Dichloroethene (µg/l)	1,3-Dichlorobenzene (µg/l)	Carbon tetrachloride (µg/l)	Chloroform (µg/l)	1,1,1-Trichloroethane (µg/l)	Bromomethane (µg/l)
MW-1															
09/15/89	ND	--	--	--	--	--	--	2.7	--	--	--	--	--	--	--
01/23/90	ND	--	--	--	--	--	--	2.1	--	--	--	--	--	--	--
04/19/90	ND	--	--	--	--	--	--	2.2	--	--	--	--	--	--	--
07/17/90	ND	--	--	--	--	--	--	1.7	--	--	--	--	--	--	--
10/16/90	ND	--	--	--	--	--	--	2.0	--	--	--	--	--	--	--
01/15/91	ND	--	--	--	--	--	--	2.1	--	--	--	--	--	--	--
04/12/91	ND	--	--	--	--	--	--	2.0	--	--	--	--	--	--	--
07/15/91	ND	--	--	--	--	--	--	1.8	--	--	--	--	--	--	--
07/14/92	--	--	--	--	--	--	--	1.4	--	--	--	--	--	--	--
07/14/93	--	--	--	--	--	--	--	0.95	--	--	--	--	--	--	--
07/07/94	--	--	--	--	--	--	--	0.83	--	--	--	--	--	--	--
07/19/95	--	--	--	--	--	--	--	0.52	--	--	--	--	--	--	--
07/11/96	--	--	--	--	--	--	--	0.73	--	--	--	--	0.96	--	--
07/21/97	--	--	--	--	--	--	--	0.70	--	--	--	--	1.0	--	--
08/31/99	--	--	--	--	--	--	--	ND	--	--	--	--	--	--	--
07/16/01	--	--	--	--	--	--	--	ND	--	--	--	--	45	--	--
07/12/02	--	--	--	--	--	--	--	ND<0.60	--	--	--	--	--	--	--
07/10/03	--	--	--	--	--	--	--	ND<0.50	--	--	--	--	--	--	--
07/29/04	--	ND<0.5	ND<0.5	ND<0.5	ND<0.5	ND<0.5	ND<0.5	ND<0.5	ND<0.5	ND<0.5	ND<0.5	ND<0.5	ND<0.5	ND<0.5	ND<1
MW-3															
08/25/00	--	--	--	--	ND	--	--	--	--	--	--	--	--	--	--
07/12/02	--	--	--	--	ND<2.0	--	--	--	--	--	--	--	--	--	--

Table 3 b
ADDITIONAL ANALYTICAL RESULTS
Former 76 Station 3538

Date Sampled	Chloro- methane (µg/l)	Chloro- ethane (µg/l)	Vinyl chloride (µg/l)	Methylene chloride (µg/l)	Bromoform (µg/l)	Bromo- dichloro- methane (µg/l)	1,1- Dichloro- ethane (µg/l)	1,1- Dichloro- ethene (µg/l)	Trichloro- fluoro- methane (µg/l)	Trichloro- trifluoro- ethane (µg/l)	1,2- Dichloro- propane (µg/l)	1,1,2- Trichloro- ethane (µg/l)	TCE (µg/l)	1,1,2,2- Tetrachloro- ethane (µg/l)	1,2- Dichloro- benzene (µg/l)
MW-1															
07/16/01	--	--	--	--	--	1.7	--	--	--	--	--	--	--	--	--
07/12/02	--	--	--	--	--	--	--	1.8	--	--	--	--	--	--	--
07/10/03	--	--	--	--	--	--	--	0.89	--	--	--	--	--	--	--
07/29/04	ND<0.5	ND<0.5	ND<0.5	ND<1	ND<0.5	ND<0.5	ND<0.5	1.2	ND<0.5	13	ND<0.5	ND<0.5	ND<0.5	ND<0.5	ND<0.5

Table 3 c
ADDITIONAL ANALYTICAL RESULTS
Former 76 Station 3538

Date Sampled	Dichloro-difluoro-methane (µg/l)	EDB (µg/l)	TAME 8260B (µg/l)	TBA 8260B (µg/l)	DIPE 8260B (µg/l)	ETBE 8260B (µg/l)	Ethanol 8260B (µg/l)	TOG (mg/l)
MW-1								
09/15/89	--	--	--	--	--	--	--	ND
01/23/90	--	--	--	--	--	--	--	1.5
04/19/90	--	--	--	--	--	--	--	ND
07/17/90	--	--	--	--	--	--	--	ND
10/16/90	--	--	--	--	--	--	--	ND
01/15/91	--	--	--	--	--	--	--	ND
04/12/91	--	--	--	--	--	--	--	ND
07/15/91	--	--	--	--	--	--	--	ND
07/29/04	ND<0.5	--	--	--	--	--	--	--
MW-3								
08/25/00	--	ND	ND	ND	ND	ND	--	--
07/12/02	--	ND<2.0	ND<2.0	ND<20	ND<2.0	ND<2.0	ND<500	--

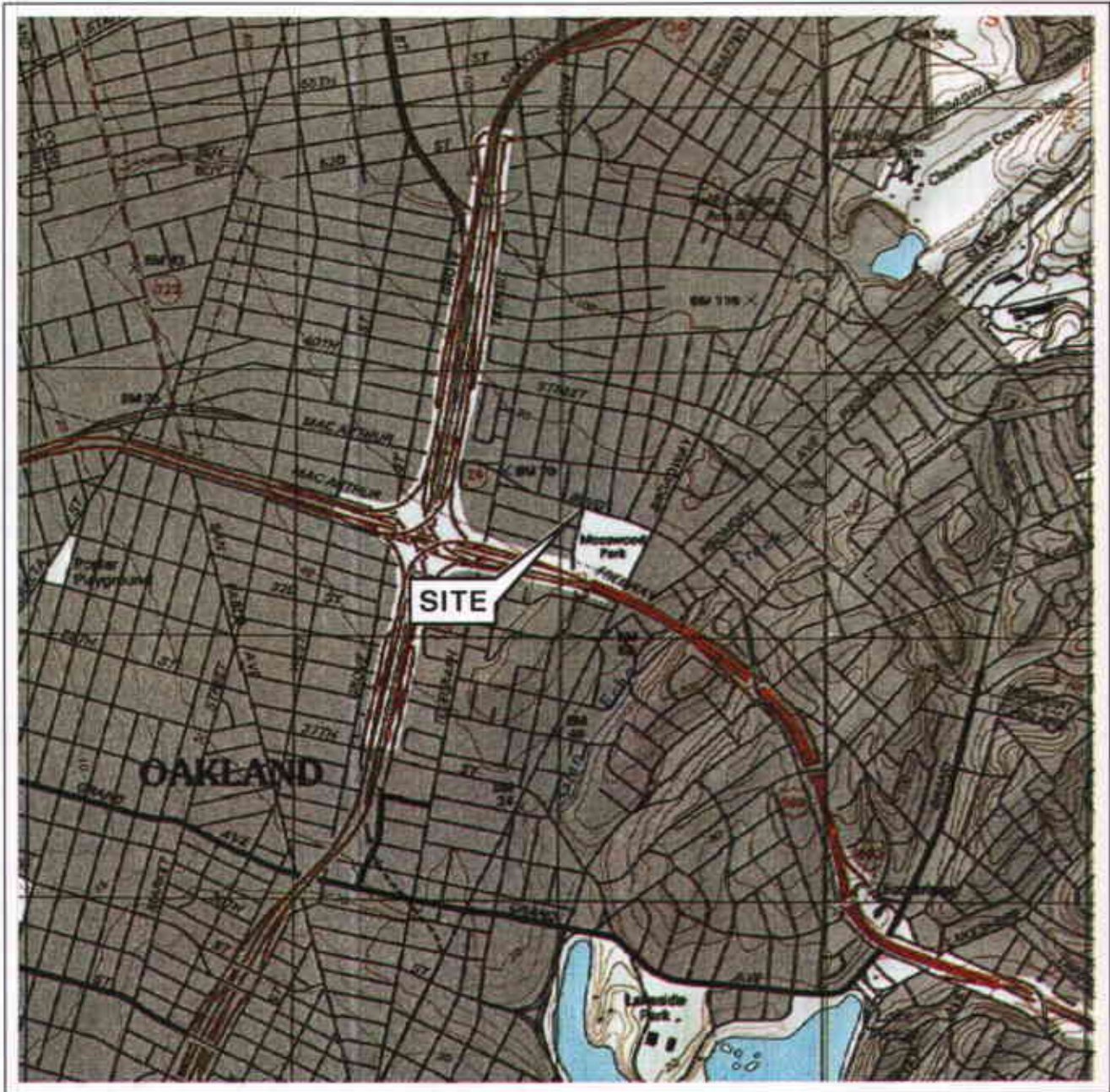

0 1/4 1/2 3/4 1 MILE



SCALE 1:24,000



QUADRANGLE
LOCATION

SOURCE:

United States Geological Survey
7.5 Minute Topographic Map:
Oakland East & Oakland West
Quadrangles

VICINITY MAP

Former 76 Station 3538
411 West MacArthur Boulevard
Oakland, California

TRC

FIGURE 1

PS = 1:1

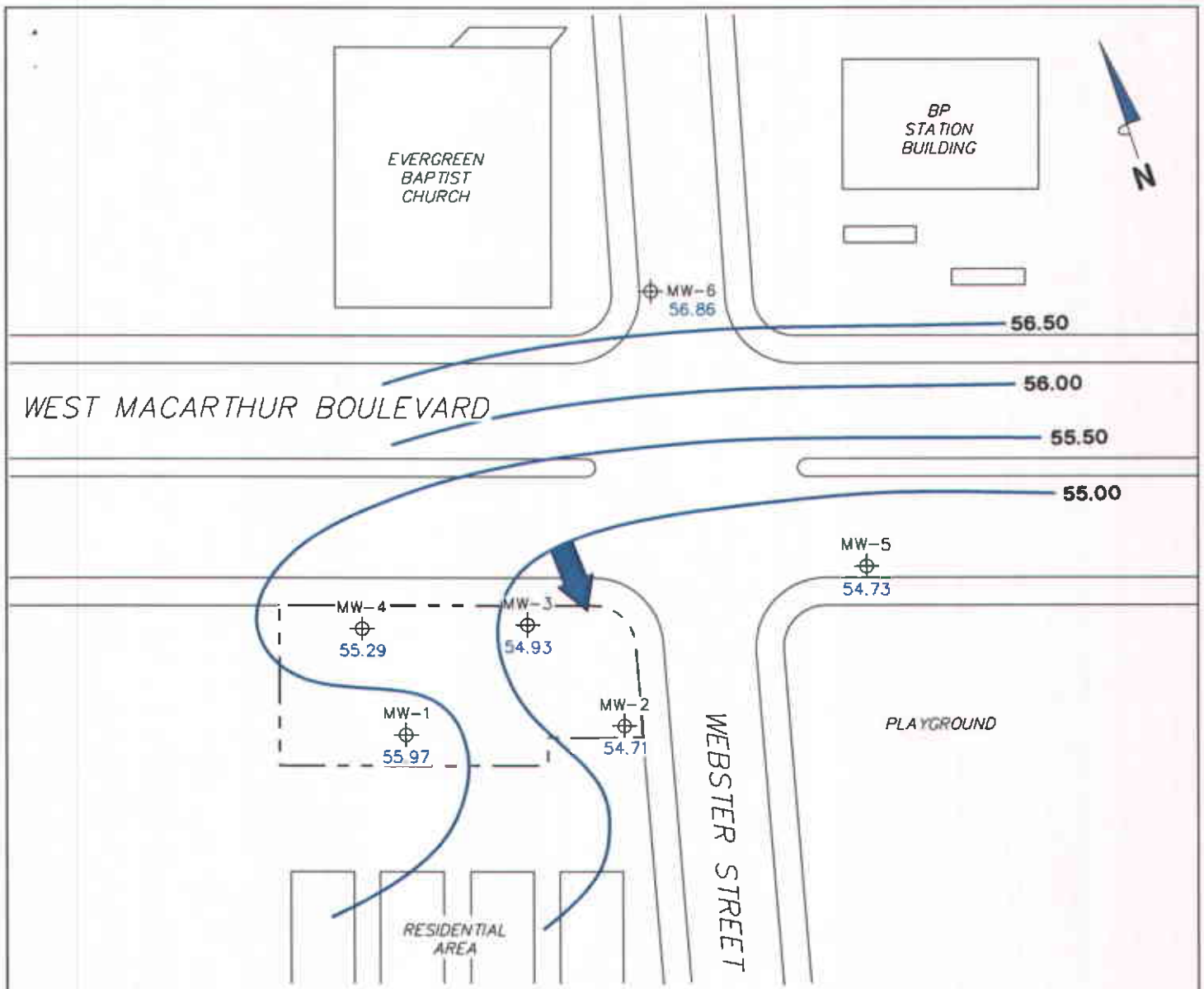

NOTES:

Contour lines are interpretive and based on fluid levels measured in monitoring wells. Elevations are in feet above mean sea level.

LEGEND

- MW-6 ⊕ Monitoring Well with Groundwater Elevation (feet)
- 56.50 — Groundwater Elevation Contour
- ➔ General Direction of Groundwater Flow

**GROUNDWATER ELEVATION
CONTOUR MAP
March 2, 2005**

Former 76 Station 3538
411 West MacArthur Boulevard
Oakland, California



FIGURE 2

PS=1:1 3538-003

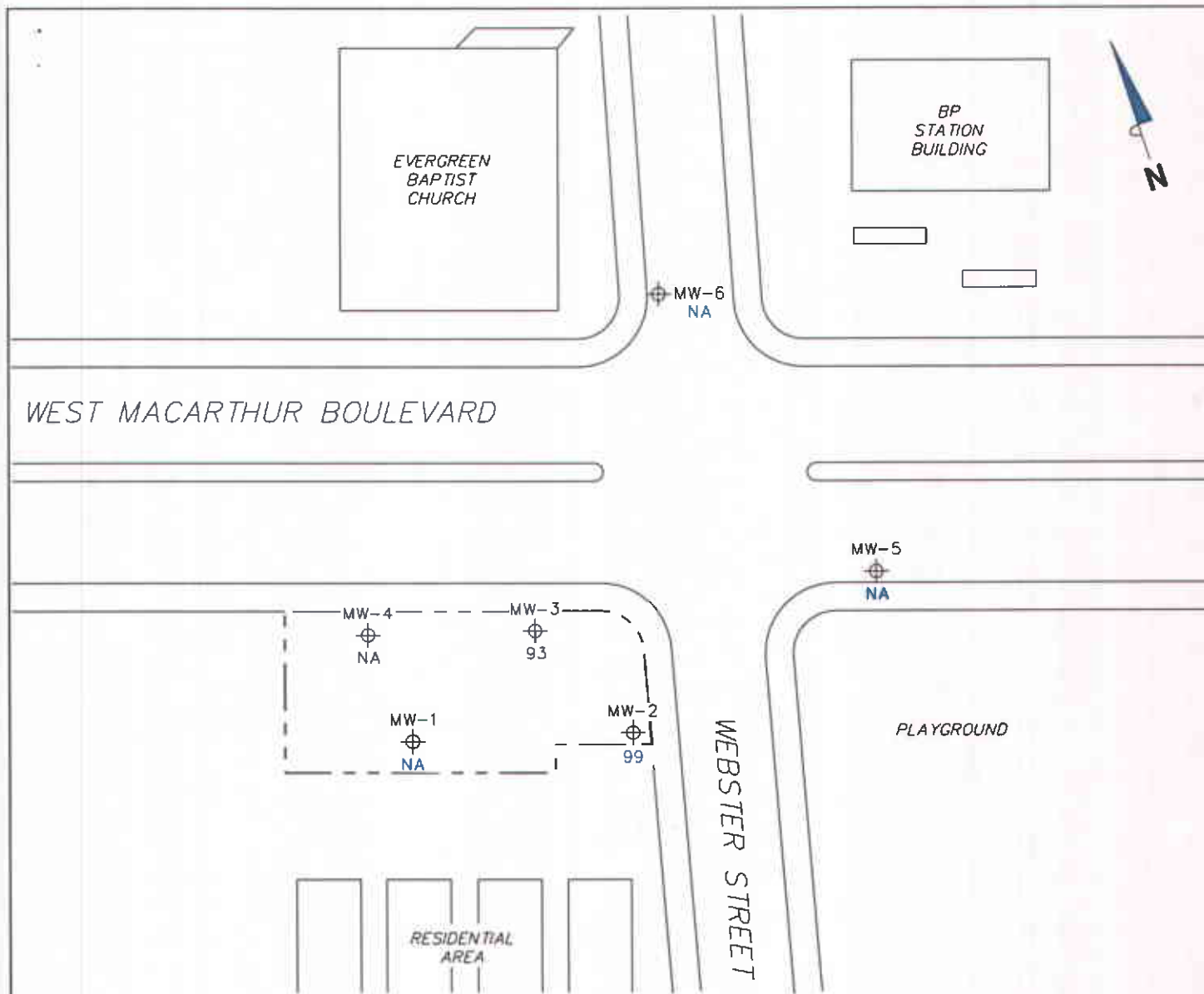

NOTES:

TPH-G = total petroleum hydrocarbons as gasoline.
 µg/l = micrograms per liter. ND = not detected at limit indicated on official laboratory report.
 NA = not analyzed, measured, or collected.
 UST = underground storage tank. Results obtained using EPA Method 8015.

LEGEND

MW-6 ⊕ Monitoring Well with Dissolved-Phase TPH-G Concentration (µg/l)

DISSOLVED-PHASE TPH-G CONCENTRATION MAP
March 2, 2005

Former 76 Station 3538
 411 West MacArthur Boulevard
 Oakland, California

FIGURE 3

SCALE (FEET)



PS-11 3538-003

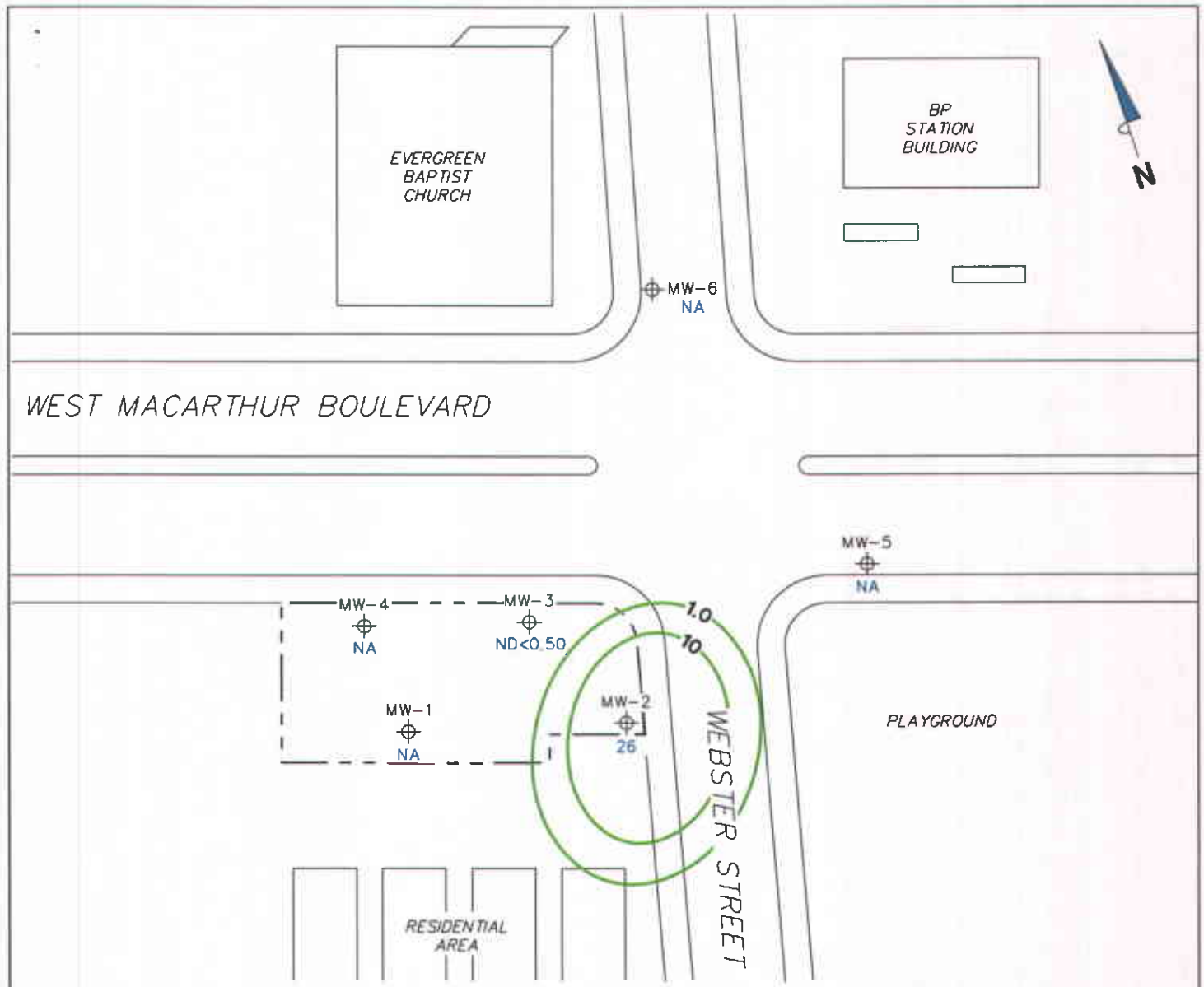

NOTES:

Contour lines are interpretive and based on laboratory analysis results of groundwater samples. µg/l = micrograms per liter. NA = not analyzed, measured, or collected.

LEGEND

MW-6 ⊕ Monitoring Well with Dissolved-Phase Benzene Concentration (µg/l)

10 — Dissolved-Phase Benzene Contour (µg/l)

**DISSOLVED-PHASE BENZENE
CONCENTRATION MAP
March 2, 2005**

Former 76 Station 3538
411 West MacArthur Boulevard
Oakland, California



SCALE (FEET)



FIGURE 4

P5:1:1 3538-003

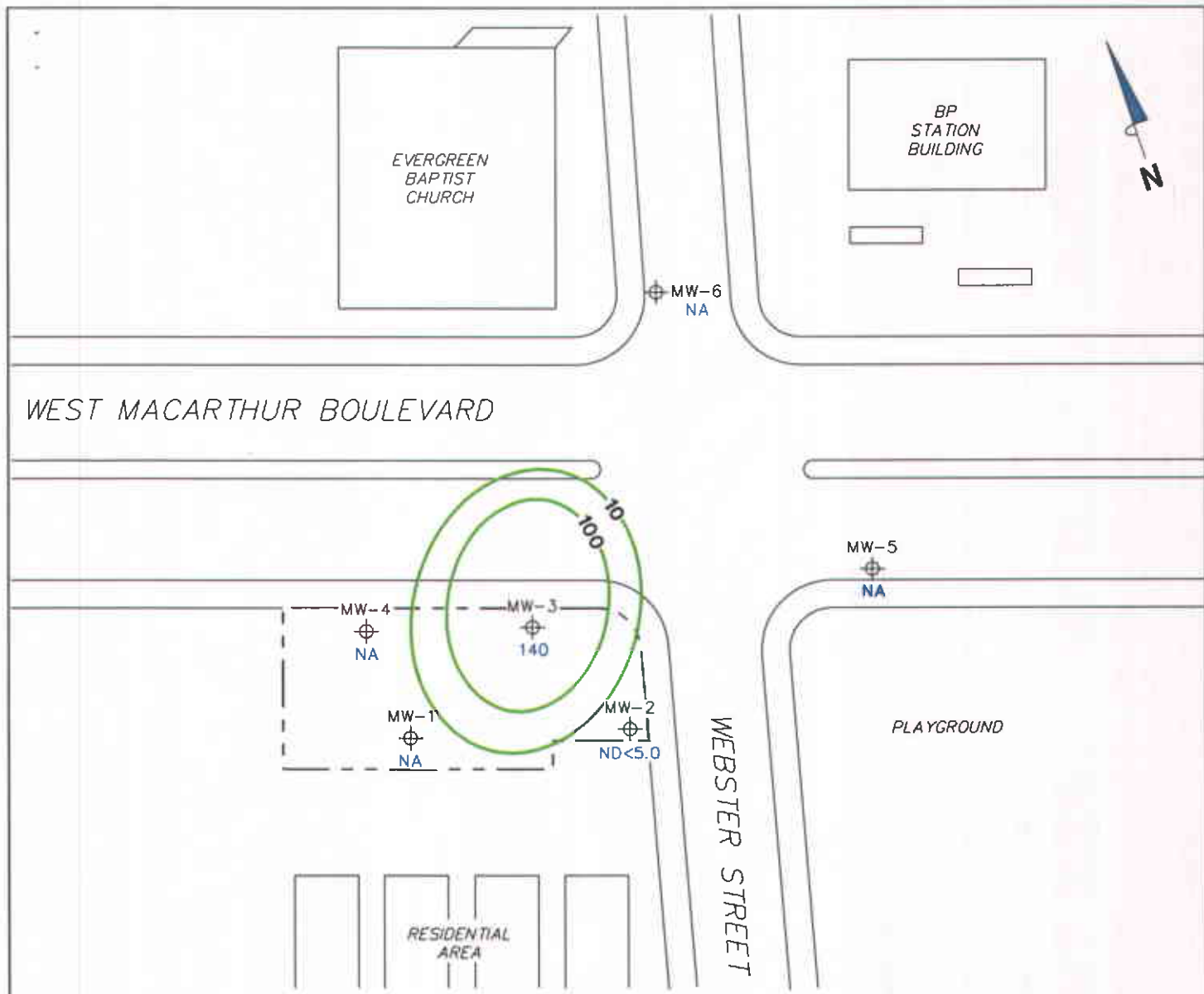

NOTES:

Contour lines are interpretive and based on laboratory analysis results of groundwater samples. MTBE = methyl tertiary butyl ether. µg/l = micrograms per liter. ND = not detected at limit indicated on official laboratory report. NA = not analyzed, measured, or collected. Results obtained using EPA Method 8021B.

LEGEND

- MW-6 ⊕ Monitoring Well with Dissolved-Phase MTBE Concentration (µg/l)
- 100 — Dissolved-Phase MTBE Contour (µg/l)

**DISSOLVED-PHASE MTBE
CONCENTRATION MAP
March 2, 2005**

Former 76 Station 3538
411 West MacArthur Boulevard
Oakland, California



SCALE (FEET)



FIGURE 5

PS=1:1 3538-003

Groundwater Elevations vs. Time
Former 76 Station 3538

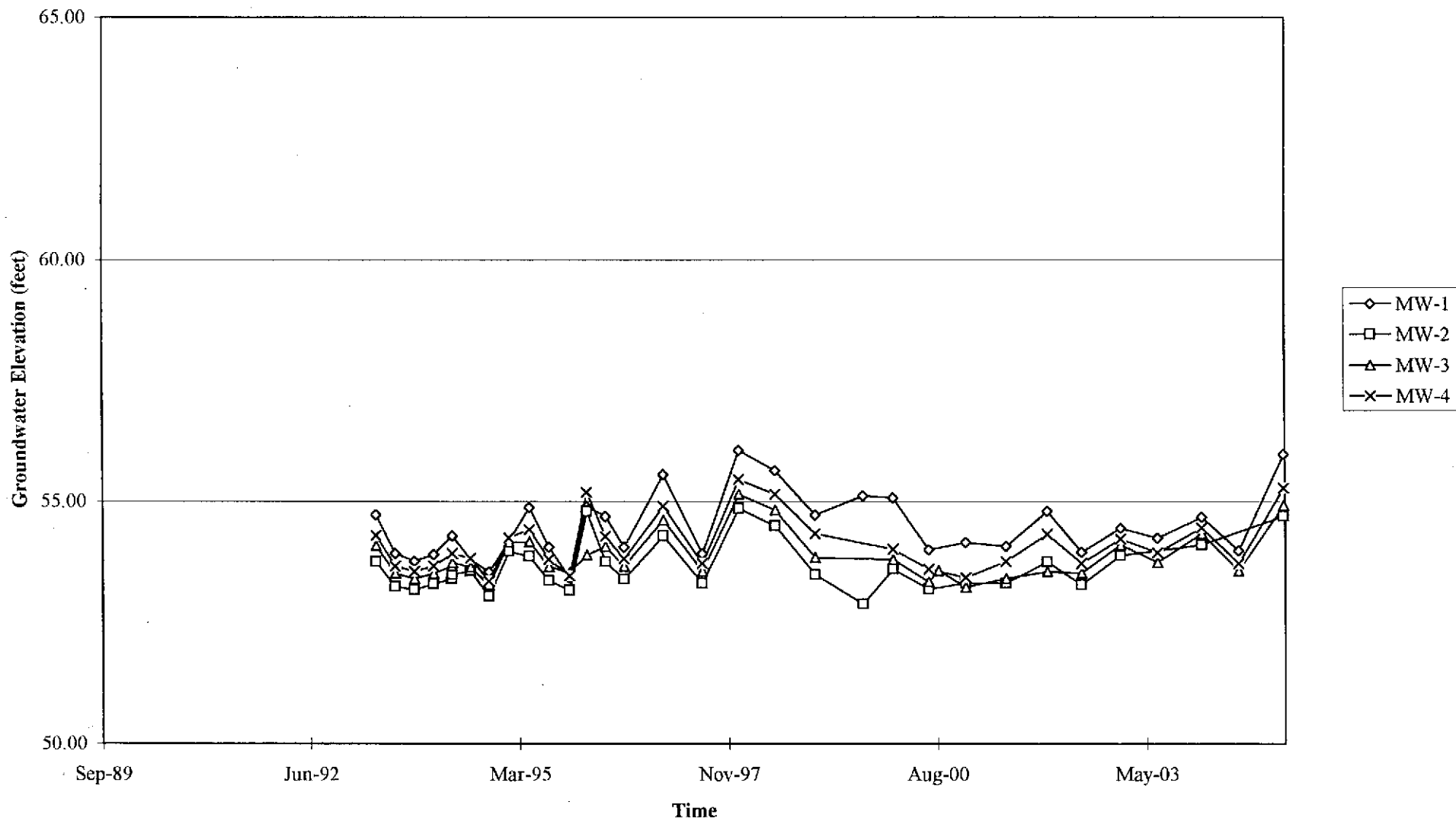

Groundwater Elevations vs. Time
Former 76 Station 3538

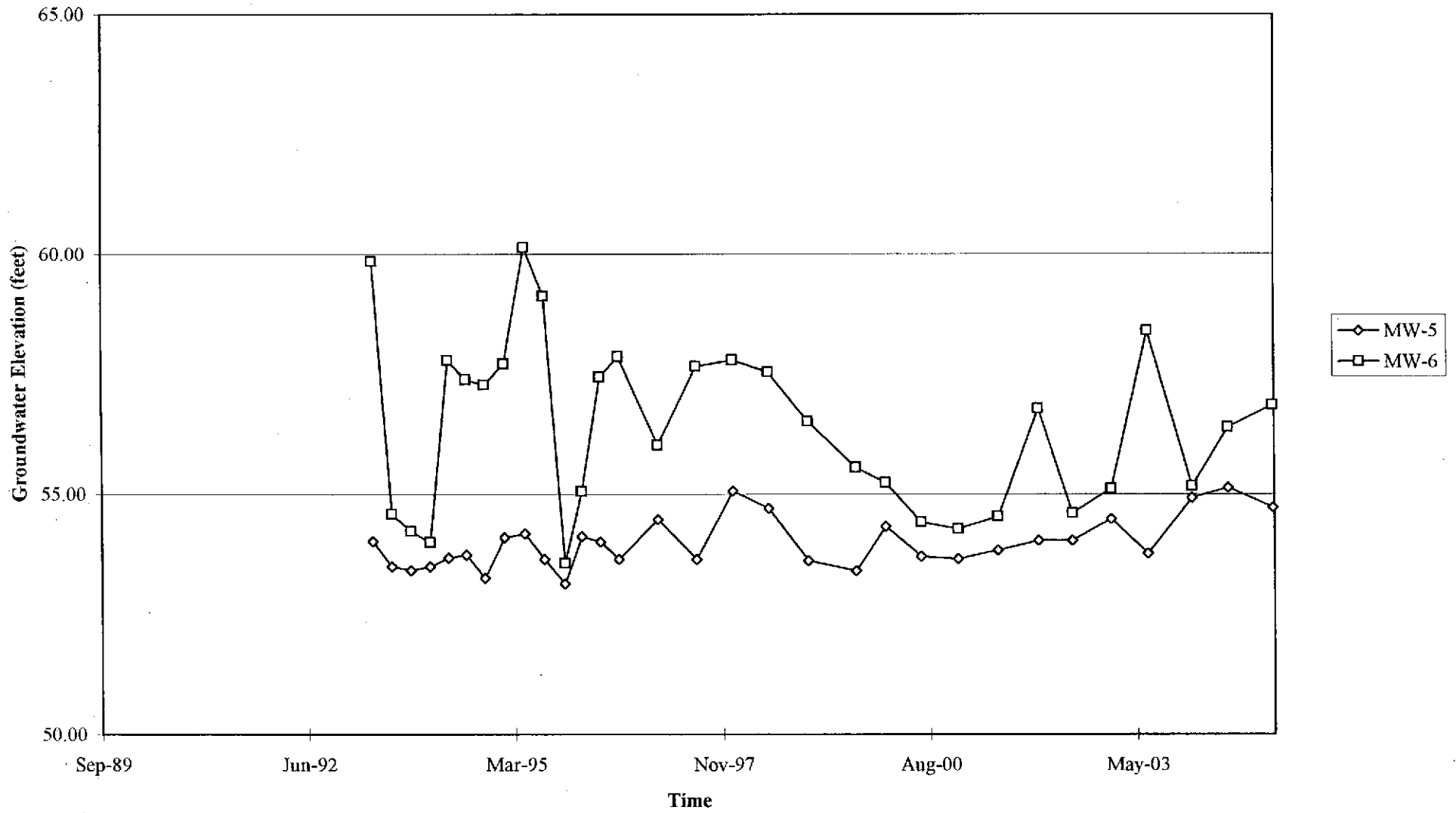

Benzene Concentrations vs Time Former 76 Station 3538

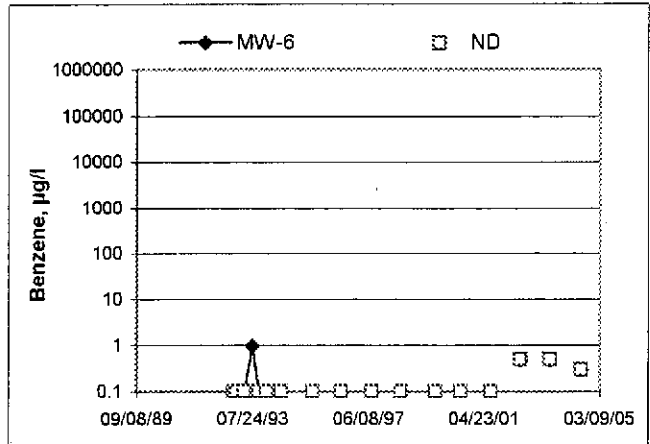
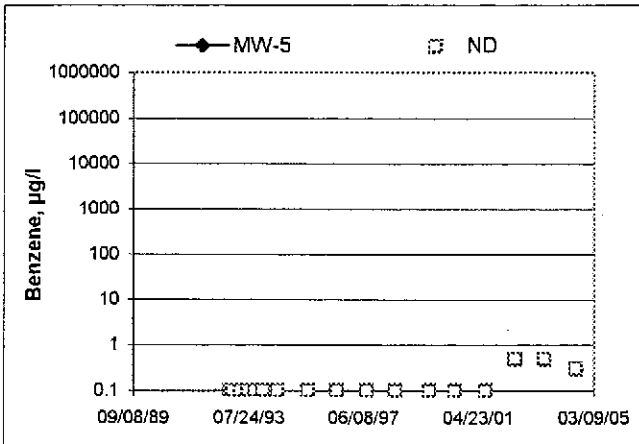
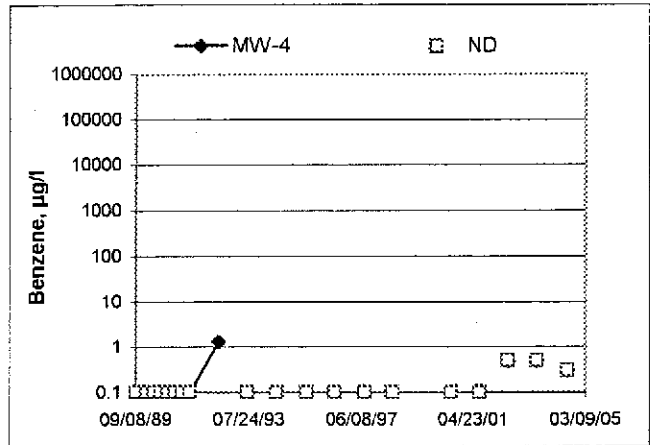
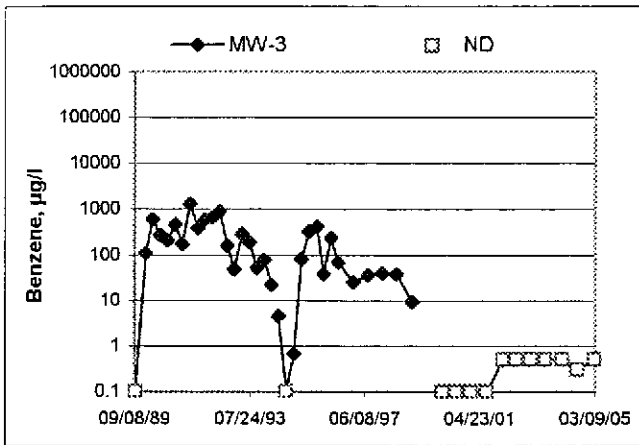
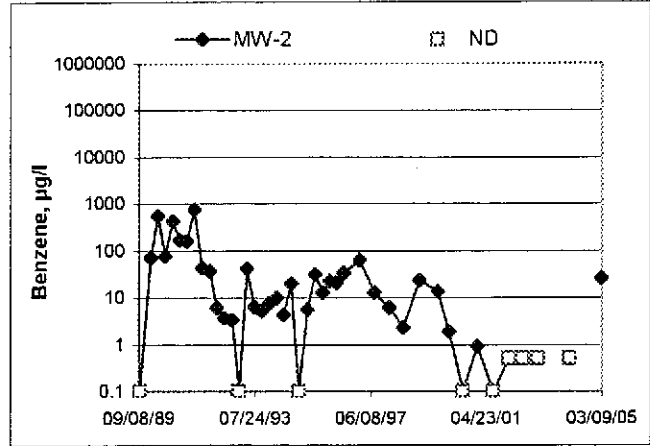
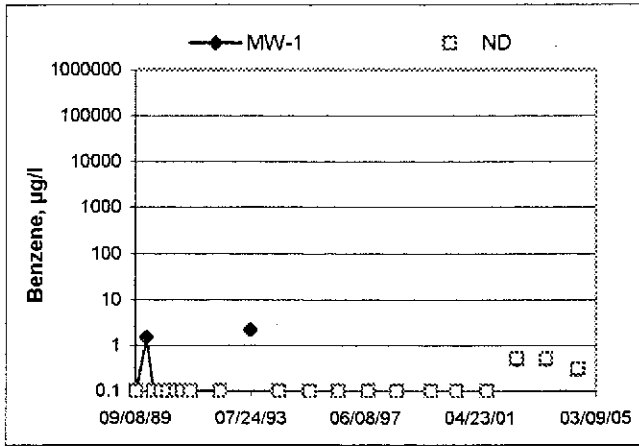

GENERAL FIELD PROCEDURES

Groundwater Monitoring and Sampling Assignments

For each site, TRC technicians are provided with a Technical Service Request (TSR) that specifies activities required to complete the groundwater monitoring and sampling assignment for the site. TSRs are based on client directives, instructions from the primary environmental consultant for the site, regulatory requirements, and TRC's previous experience with the site.

Fluid Level Measurements

Initial site activities include determination of well locations based on a site map provided with the TSR. Well boxes are opened and caps are removed. Indications of well or well box damage, or of pressure buildup in the well are noted.

Fluid levels in each well are measured using a coated cloth tape equipped with an electronic interface probe, which distinguishes between liquid phase hydrocarbon (LPH) and water. The depth to LPH (if it is present), to water, and to the bottom of the well are measured from the top of the well casing (surveyors mark or notch if present) to the nearest 0.01 foot. Unless otherwise instructed, a well with less than 0.67 foot between the measured top of water and the measured bottom of the well casing is considered dry, and is not sampled. If the well contains 0.67 foot or more of water, an attempt is made to bail and/or sample as specified on the TSR.

Wells that are found to contain LPH are not purged or sampled. Instead, one casing volume of fluid is bailed from the well and the well is re-sealed. Bailed fluids are placed in a container separate from normal purge water, and properly disposed.

Purging and Groundwater Parameter Measurement

TSR instructions may specify that a well not be purged (no-purge sampling), be purged using low-flow methods, or be purged using conventional pump and/or bail methods. Conventional purging generally consists of pumping or bailing until a minimum of three casing volumes of water have been removed or until the well has been pumped dry. Pumping is generally accomplished using submersible electric or pneumatic diaphragm pumps.

During conventional purging, three groundwater parameters (temperature, pH, and conductivity) are measured after removal of each casing volume. Stabilization of these parameters, to within 10 percent, confirm that sufficient purging has been completed. In some cases, the TSR indicates that other parameters are also to be measured during purging. TRC commonly measures dissolved oxygen (DO), oxidation-reduction potential (ORP), and/or turbidity. Instruments used for groundwater parameter measurement are calibrated daily according to manufacturer's instructions.

Low-flow purging utilizes a bladder or peristaltic pump to remove water from the well at a low rate. Groundwater parameters specified by the TSR are measured continuously until they become stable in general accordance with EPA guidelines.

Purge water is generally collected in labeled drums for disposal. Drums may be left on site for disposal by others, or transported to a collection location for eventual transfer to a licensed treatment or recycling facility. In some cases, purge water may be collected directly from the site by a licensed vacuum truck company, or may be treated on site by an active remediation system, if so directed.

Groundwater Sample Collection

After wells are purged, or not purged, according to TSR instructions, samples are collected for laboratory analysis. For wells that have been purged using conventional pump or bail methods, sampling is conducted after the well has recovered to 80 percent of its original volume or after two hours if the well does not recover to at least 80 percent. If there is insufficient recharge of water in the well after two hours, the well is not sampled.

Samples are collected by lowering a new, disposable, ½-inch to 4-inch polyethylene bottom-fill bailer to just below the water level in the well. The bailer is retrieved and the water sample is carefully transferred to containers specified for the laboratory analytical methods indicated by the TSR. Particular care is given to containers for volatile organic analysis (VOAs) which require filling to zero headspace and fitting with Teflon-sealed caps.

After filling, all containers are labeled with project number (or site number), well designation, sample date, and the samplers initials, and placed in an insulated chest with ice. Samples remain chilled prior to and during transport to a state-certified laboratory for analysis. Sample container descriptions and requested analyses are entered onto a chain-of-custody form in order to provide instructions to the laboratory. The chain-of-custody form accompanies the samples during transportation to provide a continuous record of possession from the field to the laboratory. If a freight or overnight carrier transports the samples, the carrier is noted on the form.

For wells that have been purged using low-flow methods, sample containers are filled from the effluent stream of the bladder or peristaltic pump. In some cases, if so specified by the TSR, samples are taken from the sample ports of actively pumping remediation wells.

Sequence of Gauging, Purging, and Sampling

The sequence in which monitoring activities are conducted are specified on the TSR. In general, wells are gauged beginning with the least-affected well and ending with the well that has highest concentration based on previous analytic results. After all gauging for the site is completed, wells are purged and/or sampled from the least-affected well to the most-affected well.

Decontamination

In order to reduce the possibility of cross-contamination between wells, strict isolation and decontamination procedures are observed. Portable pumps are not used in wells with LPH. Technicians wear nitrile gloves during all gauging, purging and sampling activities. Gloves are changed between wells and more often if warranted. Any equipment that could come in contact with fluids are either dedicated to a particular well, decontaminated prior to each use, or discarded after a single use. Decontamination consists of washing in a solution of Liqui-nox and water and rinsing twice. The final rinse is in deionized water.

Exceptions

Additional tasks or non-standard procedures, if any, that may be requested or required for a particular site, and noted on the site TSR, are documented in field notes on the following pages.

GROUNDWATER SAMPLING FIELD NOTES

Technician: Alex
 Site: 3538 Project No.: 4130001 Date: 030205

Well No.: MW-3 Purge Method: 17
 Depth to Water (feet): 16.47 Depth to Product (feet): 6
 Total Depth (feet): 27.15 LPH & Water Recovered (gallons): 6
 Water Column (feet): 10.68 Casing Diameter (Inches): 2"
 80% Recharge Depth (feet): 18.60 1 Well Volume (gallons): 2

Time Start	Time Stop	Depth To Water (feet)	Volume Purged (gallons)	Conductivity (uS/cm)	Temperature (F, C)	pH	Turbidity	D.O.
1034			2	697	19.5	6.31		
			4	736	19.4	6.48		
	1039		6	741	19.9	6.51		
Static at Time Sampled		Total Gallons Purged			Time Sampled			
1051		6			1046			
Comments:								

Well No.: MW-2 Purge Method: ~~B~~ D
 Depth to Water (feet): 16.63 Depth to Product (feet): 2
 Total Depth (feet): 24.25 LPH & Water Recovered (gallons): 2
 Water Column (feet): 7.62 Casing Diameter (Inches): 2"
 80% Recharge Depth (feet): 18.15 1 Well Volume (gallons): 1

Time Start	Time Stop	Depth To Water (feet)	Volume Purged (gallons)	Conductivity (uS/cm)	Temperature (F, C)	pH	Turbidity	D.O.
1055			1	717	18.4	6.94		
			2	725	18.7	6.75		
	1059		3	726	19.0	6.64		
Static at Time Sampled		Total Gallons Purged			Time Sampled			
16:10		3			1113			
Comments:								

TRC Alton Geoscience- Irvine

March 21, 2005

21 Technology Drive
Irvine, CA 92718

Attn.: Anju Farfan

Project#: 41050001FA20

Project: Conoco Phillips # 3538

Site: 411 West Mac Arthur Blvd., Oakland

Attached is our report for your samples received on 03/02/2005 16:00

This report has been reviewed and approved for release. Reproduction of this report is permitted only in its entirety.

Please note that any unused portion of the samples will be discarded after 04/16/2005 unless you have requested otherwise.

We appreciate the opportunity to be of service to you. If you have any questions, please call me at (925) 484-1919.

You can also contact me via email. My email address is: dsharma@stl-inc.com

Sincerely,

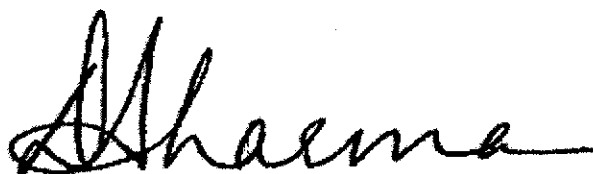

Dimple Sharma
Project Manager

Severn Trent Laboratories, Inc.

STL San Francisco * 1220 Quarry Lane, Pleasanton, CA 94566
Tel 925 484 1919 Fax 925 484 1096 * www.stl-inc.com * CA DHS ELAP# 2496

Gas/BTEX Compounds by 8015M/8021

TRC Alton Geoscience- Irvine

Attn.: Anju Farfan

21 Technology Drive

Irvine, CA 92718

Phone: (949) 341-7440 Fax: (949) 753-0111

Project: 41050001FA20

Conoco Phillips # 3538

Received: 03/02/2005 16:00

Site: 411 West Mac Arthur Blvd., Oakland

Samples Reported

Sample Name	Date Sampled	Matrix	Lab #
MW-2	03/02/2005 11:13	Water	1
MW-3	03/02/2005 10:46	Water	2

Severn Trent Laboratories, Inc.

STL San Francisco * 1220 Quarry Lane, Pleasanton, CA 94566

Tel 925 484 1919 Fax 925 484 1096 * www.stl-inc.com * CA DHS ELAP# 2496

03/18/2005 14:55

Gas/BTEX Compounds by 8015M/8021

TRC Alton Geoscience- Irvine

Attn.: Anju Farfan

21 Technology Drive

Irvine, CA 92718

Phone: (949) 341-7440 Fax: (949) 753-0111

Project: 41050001FA20

Conoco Phillips # 3538

Received: 03/02/2005 16:00

Site: 411 West Mac Arthur Blvd., Oakland

Prep(s): 5030
5030
Sample ID: MW-2
Sampled: 03/02/2005 11:13
Matrix: Water
Test(s): 8015M
8021B
Lab ID: 2005-03-0112 - 1
Extracted: 3/16/2005 19:59
QC Batch#: 2005/03/16-01.05

Compound	Conc.	RL	Unit	Dilution	Analyzed	Flag
GRO (C6-C12)	99	50	ug/L	1.00	03/16/2005 19:59	
Benzene	26	0.50	ug/L	1.00	03/16/2005 19:59	
Toluene	ND	0.50	ug/L	1.00	03/16/2005 19:59	
Ethyl benzene	3.5	0.50	ug/L	1.00	03/16/2005 19:59	
Xylene(s)	2.8	0.50	ug/L	1.00	03/16/2005 19:59	
MTBE	ND	5.0	ug/L	1.00	03/16/2005 19:59	
Surrogate(s)						
Trifluorotoluene	94.4	58-124	%	1.00	03/16/2005 19:59	
4-Bromofluorobenzene-FID	78.6	50-150	%	1.00	03/16/2005 19:59	

Gas/BTEX Compounds by 8015M/8021

TRC Alton Geoscience- Irvine
Attn.: Anju Farfan

21 Technology Drive
Irvine, CA 92718
Phone: (949) 341-7440 Fax: (949) 753-0111

Project: 41050001FA20
Conoco Phillips # 3538

Received: 03/02/2005 16:00

Site: 411 West Mac Arthur Blvd., Oakland

Prep(s): 5030	Test(s): 8015M
5030	8021B
Sample ID: MW-3	Lab ID: 2005-03-0112 - 2
Sampled: 03/02/2005 10:46	Extracted: 3/16/2005 20:33
	3/17/2005 11:04
Matrix: Water	QC Batch#: 2005/03/16-01.05
	2005/03/17-01.05

Compound	Conc.	RL	Unit	Dilution	Analyzed	Flag
GRO (C6-C12)	93	50	ug/L	1.00	03/16/2005 20:33	Q6
Benzene	ND	0.50	ug/L	1.00	03/16/2005 20:33	
Toluene	ND	0.50	ug/L	1.00	03/16/2005 20:33	
Ethyl benzene	ND	0.50	ug/L	1.00	03/16/2005 20:33	
Xylene(s)	ND	0.50	ug/L	1.00	03/16/2005 20:33	
MTBE	140	10	ug/L	2.00	03/17/2005 11:04	H2
Surrogate(s)						
Trifluorotoluene	95.5	58-124	%	1.00	03/16/2005 20:33	
Trifluorotoluene	109.1	58-124	%	1.00	03/17/2005 11:04	
4-Bromofluorobenzene-FID	81.2	50-150	%	1.00	03/16/2005 20:33	

Gas/BTEX Compounds by 8015M/8021

TRC Alton Geoscience- Irvine

Attn.: Anju Farfan

21 Technology Drive

Irvine, CA 92718

Phone: (949) 341-7440 Fax: (949) 753-0111

Project: 41050001FA20

Conoco Phillips # 3538

Received: 03/02/2005 16:00

Site: 411 West Mac Arthur Blvd., Oakland

Batch QC Report

Prep(s): 5030

5030

Method Blank

MB: 2005/03/16-01.05-003

Test(s): 8015M

8021B

Water

QC Batch # 2005/03/16-01.05

Date Extracted: 03/16/2005 08:13

Compound	Conc.	RL	Unit	Analyzed	Flag
GRO (C6-C12)	ND	50	ug/L	03/16/2005 08:13	
Benzene	ND	0.5	ug/L	03/16/2005 08:13	
Toluene	ND	0.5	ug/L	03/16/2005 08:13	
Ethyl benzene	ND	0.5	ug/L	03/16/2005 08:13	
Xylene(s)	ND	0.5	ug/L	03/16/2005 08:13	
MTBE	ND	5.0	ug/L	03/16/2005 08:13	
Surrogates(s)					
Trifluorotoluene	97.2	58-124	%	03/16/2005 08:13	
4-Bromofluorobenzene-FID	85.8	50-150	%	03/16/2005 08:13	

Gas/BTEX Compounds by 8015M/8021

TRC Alton Geoscience- Irvine

Attn.: Anju Farfan

21 Technology Drive

Irvine, CA 92718

Phone: (949) 341-7440 Fax: (949) 753-0111

Project: 41050001FA20

Conoco Phillips # 3538

Received: 03/02/2005 16:00

Site: 411 West Mac Arthur Blvd., Oakland

Batch QC Report

Prep(s): 5030

5030

Method Blank

MB: 2005/03/17-01.05-001

Test(s): 8015M

8021B

QC Batch # 2005/03/17-01.05

Date Extracted: 03/17/2005 07:01

Water

Compound	Conc.	RL	Unit	Analyzed	Flag
GRO (C6-C12)	ND	50	ug/L	03/17/2005 07:01	
Benzene	ND	0.5	ug/L	03/17/2005 07:01	
Toluene	ND	0.5	ug/L	03/17/2005 07:01	
Ethyl benzene	ND	0.5	ug/L	03/17/2005 07:01	
Xylene(s)	ND	0.5	ug/L	03/17/2005 07:01	
MTBE	ND	5.0	ug/L	03/17/2005 07:01	
Surrogates(s)					
Trifluorotoluene	101.0	58-124	%	03/17/2005 07:01	
4-Bromofluorobenzene-FID	85.2	50-150	%	03/17/2005 07:01	

Gas/BTEX Compounds by 8015M/8021

TRC Alton Geoscience- Irvine
Attn.: Anju Farfan

21 Technology Drive
Irvine, CA 92718
Phone: (949) 341-7440 Fax: (949) 753-0111
Project: 41050001FA20
Conoco Phillips # 3538

Received: 03/02/2005 16:00

Site: 411 West Mac Arthur Blvd., Oakland

Batch QC Report

Prep(s): 5030

Test(s): 8021B

Laboratory Control Spike

Water

QC Batch # 2005/03/16-01.05

LCS 2005/03/16-01.05-004
LCSD

Extracted: 03/16/2005

Analyzed: 03/16/2005 08:47

Compound	Conc. ug/L		Exp. Conc.	Recovery %		RPD	Ctrl. Limits %		Flags	
	LCS	LCSD		LCS	LCSD		%	Rec.	RPD	LCS
Benzene	56.7		50.0	113.4			77-123	20		
Toluene	58.3		50.0	116.6			78-122	20		
Ethyl benzene	58.1		50.0	116.2			70-130	20		
Xylene(s)	175		150	116.7			75-125	20		
Surrogates(s)										
Trifluorotoluene	455		500	91.0			58-124			

Severn Trent Laboratories, Inc.

STL San Francisco * 1220 Quarry Lane, Pleasanton, CA 94566

Tel 925 484 1919 Fax 925 484 1096 * www.stl-inc.com * CA DHS ELAP# 2496

03/18/2005 14:55

Gas/BTEX Compounds by 8015M/8021

TRC Alton Geoscience- Irvine
Attn.: Anju Farfan

21 Technology Drive
Irvine, CA 92718
Phone: (949) 341-7440 Fax: (949) 753-0111

Project: 41050001FA20
Conoco Phillips # 3538

Received: 03/02/2005 16:00

Site: 411 West Mac Arthur Blvd., Oakland

Batch QC Report

Prep(s): 5030

Test(s): 8015M

Laboratory Control Spike

Water

QC Batch # 2005/03/16-01.05

LCS 2005/03/16-01.05-005
LCSD

Extracted: 03/16/2005

Analyzed: 03/16/2005 09:20

Compound	Conc. ug/L		Exp.Conc.	Recovery %		RPD	Ctrl.Limits %		Flags	
	LCS	LCSD		LCS	LCSD		%	Rec.	RPD	LCS
GRO (C6-C12)	224		250	89.6			75-125	20		
<i>Surrogates(s)</i> 4-Bromofluorobenzene-FID	413		500	82.6			50-150			

Gas/BTEX Compounds by 8015M/8021

TRC Alton Geoscience- Irvine

Attn.: Anju Farfan

21 Technology Drive

Irvine, CA 92718

Phone: (949) 341-7440 Fax: (949) 753-0111

Project: 41050001FA20

Conoco Phillips # 3538

Received: 03/02/2005 16:00

Site: 411 West Mac Arthur Blvd., Oakland

Batch QC Report

Prep(s): 5030

Test(s): 8015M

Laboratory Control Spike

Water

QC Batch # 2005/03/17-01.05

LCS 2005/03/17-01.05-003

Extracted: 03/17/2005

Analyzed: 03/17/2005 08:08

LCSD

Compound	Conc. ug/L		Exp. Conc.	Recovery %		RPD	Ctri. Limits %		Flags	
	LCS	LCSD		LCS	LCSD		%	Rec.	RPD	LCS
GRO (C6-C12)	225		250	90.0			75-125	20		
Surrogates(s)										
4-Bromofluorobenzene-FID	436		500	87.2			50-150			

Severn Trent Laboratories, Inc.

STL San Francisco * 1220 Quarry Lane, Pleasanton, CA 94566

Tel 925 484 1919 Fax 925 484 1096 * www.stl-inc.com * CA DHS ELAP# 2496

03/18/2005 14:55

Gas/BTEX Compounds by 8015M/8021

TRC Alton Geoscience- Irvine
Attn.: Anju Farfan

21 Technology Drive
Irvine, CA 92718
Phone: (949) 341-7440 Fax: (949) 753-0111

Project: 41050001FA20
Conoco Phillips # 3538

Received: 03/02/2005 16:00

Site: 411 West Mac Arthur Blvd., Oakland

Batch QC Report

Prep(s): 5030

Test(s): 8021B

Laboratory Control Spike

Water

QC Batch # 2005/03/17-01.05

LCS 2005/03/17-01.05-004
LCSD

Extracted: 03/17/2005

Analyzed: 03/17/2005 08:54

Compound	Conc. ug/L		Exp.Conc.	Recovery %		RPD	Ctrl.Limits %		Flags	
	LCS	LCSD		LCS	LCSD		%	Rec.	RPD	LCS
Benzene	59.7		50.0	119.4			77-123	20		
Toluene	60.3		50.0	120.6			78-122	20		
Ethyl benzene	58.8		50.0	117.6			70-130	20		
Xylene(s)	179		150	119.3			75-125	20		
Surrogates(s)										
Trifluorotoluene	526		500	105.2			58-124			

Severn Trent Laboratories, Inc.

STL San Francisco * 1220 Quarry Lane, Pleasanton, CA 94566

Tel 925 484 1919 Fax 925 484 1096 * www.stl-inc.com * CA DHS ELAP# 2496

03/18/2005 14:55

Gas/BTEX Compounds by 8015M/8021

TRC Alton Geoscience- Irvine

Attn.: Anju Farfan

21 Technology Drive

Irvine, CA 92718

Phone: (949) 341-7440 Fax: (949) 753-0111

Project: 41050001FA20

Conoco Phillips # 3538

Received: 03/02/2005 16:00

Site: 411 West Mac Arthur Blvd., Oakland

Batch QC Report

Prep(s): 5030

Test(s): 8021B

Matrix Spike (MS / MSD)

Water

QC Batch # 2005/03/16-01.05

MW-2 >> MS

Lab ID: 2005-03-0112 - 001

MS: 2005/03/16-01.05-031

Extracted: 03/17/2005

Analyzed: 03/17/2005 02:41

Dilution: 1.00

MSD: 2005/03/16-01.05-032

Extracted: 03/17/2005

Analyzed: 03/17/2005 03:15

Dilution: 1.00

Compound	Conc. ug/L			Spk.Level ug/L	Recovery %			Limits %		Flags	
	MS	MSD	Sample		MS	MSD	RPD	Rec.	RPD	MS	MSD
Benzene	81.1	81.1	26.1	50.0	110.0	110.0	0.0	65-135	20		
Toluene	54.3	54.6	ND	50.0	108.6	109.2	0.6	65-135	20		
Ethyl benzene	54.6	57.3	3.46	50.0	102.3	107.7	5.1	65-135	20		
Xylene(s)	159	166	2.79	150	104.1	108.8	4.4	65-135	20		
Surrogate(s)											
Trifluorotoluene	445	451		500	89.0	90.2		58-124			

Sewern Trent Laboratories, Inc.

STL San Francisco * 1220 Quarry Lane, Pleasanton, CA 94566

Tel 925 484 1919 Fax 925 484 1096 * www.stl-inc.com * CA DHS ELAP# 2496

03/18/2005 14:55

Gas/BTEX Compounds by 8015M/8021

TRC Alton Geoscience- Irvine
Attn.: Anju Farfan

21 Technology Drive
Irvine, CA 92718
Phone: (949) 341-7440 Fax: (949) 753-0111

Project: 41050001FA20
Conoco Phillips # 3538

Received: 03/02/2005 16:00

Site: 411 West Mac Arthur Blvd., Oakland

Batch QC Report

Prep(s): 5030

Test(s): 8015M

Matrix Spike (MS / MSD)

Water

QC Batch # 2005/03/16-01.05

MS/MSD

Lab ID: 2005-03-0393 - 005

MS: 2005/03/16-01.05-033

Extracted: 03/17/2005

Analyzed: 03/17/2005 03:48

Dilution: 1.00

MSD: 2005/03/16-01.05-034

Extracted: 03/17/2005

Analyzed: 03/17/2005 04:21

Dilution: 1.00

Compound	Conc. ug/L			Spk. Level	Recovery %			Limits %		Flags	
	MS	MSD	Sample		ug/L	MS	MSD	RPD	Rec.	RPD	MS
GRO (C6-C12)	238	239	ND	250	95.2	95.6	0.4	65-135	20		
<i>Surrogate(s)</i> 4-Bromofluorobenzene-FID	385	348		500	77.0	69.6		50-150			

Gas/BTEX Compounds by 8015M/8021

TRC Alton Geoscience- Irvine
Attn.: Anju Farfan

21 Technology Drive
Irvine, CA 92718
Phone: (949) 341-7440 Fax: (949) 753-0111
Project: 41050001FA20
Conoco Phillips # 3538

Received: 03/02/2005 16:00

Site: 411 West Mac Arthur Blvd., Oakland

Batch QC Report

Prep(s): 5030 Test(s): 8021B

Matrix Spike (MS / MSD) **Water** **QC Batch # 2005/03/17-01.05**

MS/MSD		Lab ID: 2005-03-0207 - 003
MS: 2005/03/17-01.05-028	Extracted: 03/18/2005	Analyzed: 03/18/2005 00:14
		Dilution: 1.00
MSD: 2005/03/17-01.05-029	Extracted: 03/18/2005	Analyzed: 03/18/2005 00:48
		Dilution: 1.00

Compound	Conc. ug/L			Spk.Level ug/L	Recovery %			Limits %		Flags	
	MS	MSD	Sample		MS	MSD	RPD	Rec.	RPD	MS	MSD
Benzene	56.3	56.7	ND	50.0	112.6	113.4	0.7	65-135	20		
Toluene	54.7	54.7	ND	50.0	109.4	109.4	0.0	65-135	20		
Xylene(s)	151	152	ND	150	100.7	101.3	0.6	65-135	20		
Ethyl benzene	51.4	51.9	ND	50.0	102.8	103.8	1.0	65-135	20		
Surrogate(s)											
Trifluorotoluene	452	440		500	90.4	88.0		58-124			

Gas/BTEX Compounds by 8015M/8021

TRC Alton Geoscience- Irvine
Attn.: Anju Farfan

21 Technology Drive
Irvine, CA 92718
Phone: (949) 341-7440 Fax: (949) 753-0111

Project: 41050001FA20
Conoco Phillips # 3538

Received: 03/02/2005 16:00

Site: 411 West Mac Arthur Blvd., Oakland

Batch QC Report

Prep(s): 5030

Test(s): 8015M

Matrix Spike (MS / MSD)

Water

QC Batch # 2005/03/17-01.05

MS/MSD

Lab ID: 2005-03-0207 - 004

MS: 2005/03/17-01.05-030

Extracted: 03/18/2005

Analyzed: 03/18/2005 01:22

Dilution: 1.00

MSD: 2005/03/17-01.05-031

Extracted: 03/18/2005

Analyzed: 03/18/2005 01:55

Dilution: 1.00

Compound	Conc. ug/L			Spk.Level ug/L	Recovery %			Limits %		Flags	
	MS	MSD	Sample		MS	MSD	RPD	Rec.	RPD	MS	MSD
GRO (C6-C12)	220	218	ND	250	88.0	87.2	0.9	65-135	20		
<i>Surrogate(s)</i> 4-Bromofluorobenzene-FID	441	443		500	88.2	88.6		50-150			

Severn Trent Laboratories, Inc.

STL San Francisco * 1220 Quarry Lane, Pleasanton, CA 94566

Tel 925 484 1919 Fax 925 484 1096 * www.stl-inc.com * CA DHS ELAP# 2496

03/18/2005 14:55

Gas/BTEX Compounds by 8015M/8021

TRC Alton Geoscience- Irvine
Attn.: Anju Farfan

21 Technology Drive
Irvine, CA 92718
Phone: (949) 341-7440 Fax: (949) 753-0111

Project: 41050001FA20
Conoco Phillips # 3538

Received: 03/02/2005 16:00

Site: 411 West Mac Arthur Blvd., Oakland

Legend and Notes

Result Flag

H2

Analyzed out of holding time.

Q6

The concentration reported reflect(s) individual or discrete unidentified peaks not matching a typical fuel pattern.

STL-San Francisco

ConocoPhillips Chain Of Custody Record

102565

1220 Quarry Lane
Pleasanton, CA 94568

(925) 484-1919 (925) 484-1096 fax

ConocoPhillips Site Manager:

INVOICE REMITTANCE ADDRESS:

CONOCOPHILLIPS
Attn: Dee Hutchinson
3611 South Harbor, Suite 209
Santa Ana, CA 92704

2005-03-0112

ConocoPhillips Work Order Number

HTS TPC501

ConocoPhillips Cost Object

DATE: 03/02/05

PAGE: 1 of 1

SAMPLING COMPANY: TRC		CARD NUMBER:		CONOCOPHILLIPS SITE NUMBER: 3538		GLOBAL ID#: 70000101472										
ADDRESS: 21 Technology Drive, Irvine CA 92618		SITE ADDRESS (Street and City): 411 WEST MACARTHUR BLVD. CARLISLE		CONOCOPHILLIPS SITE MANAGER: THOMAS ROEHL												
PROJECT CONTACT (Individual or POP Agent ID): Anju Farfan		LEAD POLICEMAN (ID or Assignment): Peter Thomson, TRC		PHONE NO.: 949-341-7408		LAB USE ONLY:										
TELEPHONE: 949-341-7449	FAX: 949-753-0111	EMAIL: afarfan@trcsolutions.com		PROJECT CONTACT (Individual or POP Agent ID): Anju Farfan												
DAMPLER NAME(S) (None): AirX		CONSULTANT PROJECT NUMBER: 41050001FA20		REQUESTED ANALYSES												
TURNAROUND TIME (CALENDAR DAYS): <input type="checkbox"/> 1-3 DAYS <input type="checkbox"/> 7 DAYS <input type="checkbox"/> 72 HOURS <input type="checkbox"/> 48 HOURS <input type="checkbox"/> 24 HOURS <input type="checkbox"/> LESS THAN 24 HOURS																
SPECIAL INSTRUCTIONS OR NOTES: CHECK BOX IF PEST IS NEEDED <input checked="" type="checkbox"/>						FIELD NOTES: Contains Preservative or PID Readings or Laboratory Notes 20°C Gases by PID										
* Field Point name only required if different from Sample ID						TEMPERATURE ON RECEIPT:										
LAB USE ONLY	Sample Identification/Field Point Name*	SAMPLING		MATERIAL	NO. OF CONT.	8015m - TPHd Extractable	8260B - TPHg/BTEX	8260B - TPHg / BTEX / B Oxygenates	8260B - TPHg / BTEX / B Oxygenates + naphthalene (8015M)	8260B - Full Scan VOCs (does not include oxygenates)	8270C - Semi-Volatiles	8015M / 8021B - TPHg/BTEX/MBE	Lead UTotal GSTLC UTCLP			
		DATE	TIME											TEMP	PH	
	MW-2	03/02/05	11:30	Gas	6									X	X	
	MW-3	↓	10:45	↓	↓									X	X	
Requested by (Signature):		Received by (Signature):		Date:		Time:										
Requested by (Signature):		Received by (Signature):		Date:		Time:										
Requested by (Signature):		Received by (Signature):		Date:		Time:										

STATEMENTS

Purge Water Disposal

Non-hazardous groundwater produced during purging and sampling of monitoring was accumulated at TRC's groundwater monitoring facility at Concord, California, for transportation by Onyx Transportation, Inc., to the ConocoPhillips Refinery at Rodeo, California. Disposal at the Rodeo facility was authorized by ConocoPhillips in accordance with "ESD Standard Operating Procedures - Water Quality and Compliance", as revised on February 7, 2003. Documentation of compliance with ConocoPhillips requirements is provided by an ESD Form R-149, which is on file at TRC's Concord Office. Purge water containing a significant amount of liquid-phase hydrocarbons was accumulated separately in drums for transportation and disposal by Filter Recycling, Inc.

Limitations

The fluid level monitoring and groundwater sampling activities summarized in this report have been performed under the responsible charge of a California Registered Geologist or Registered Civil Engineer and have been conducted in accordance with current practice and the standard of care exercised by geologists and engineers performing similar tasks in this area. No warranty, express or implied, is made regarding the conclusions and professional opinions presented in this report. The conclusions are based solely upon an analysis of the observed conditions. If actual conditions differ from those described in this report, our office should be notified.