

ASSESSOR'S MAP I

Code Area Nos. (7-00)

221

Scale: 1" = 50'

OAKLAND (KELLERSBERGER'S)(BK.7 Pg.3)

Drawn: 10-67/R.H.S. Revised: 3-5-76 T.S.

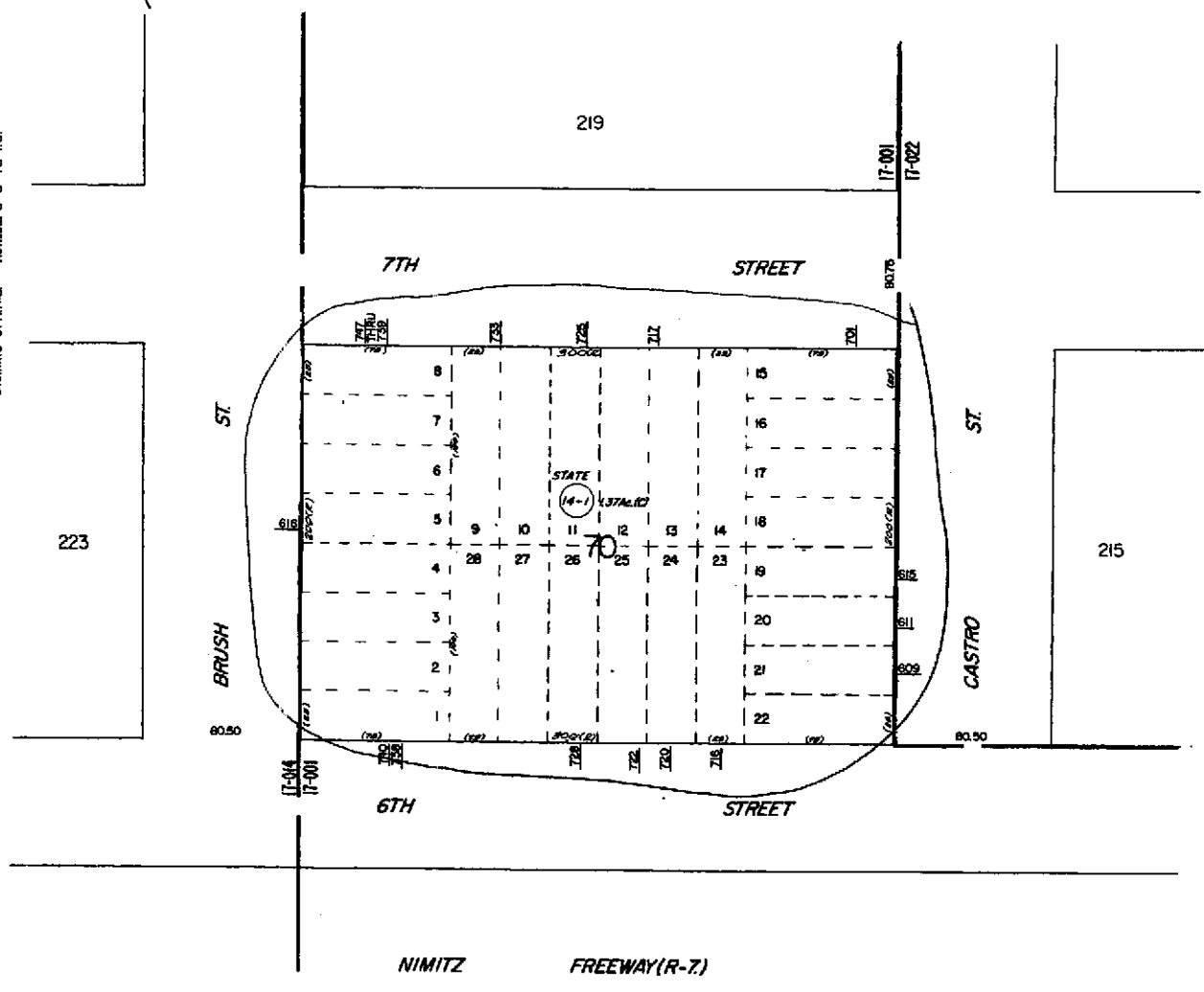

223

219

215

NIMITZ FREEWAY (R-7)

115

Formerly: 61A.70

A.C.M.

References:

H.P.N. 14-1

Property Detail

Alameda, CA RON THOMSEN, ASSESSOR

Parcel # (APN): **001 -0221-014-01**

Use Description:

Parcel Status:

Owner Name: **STATE OF CALIFORNIA**Mailing Address: **PO BOX 23440 OAKLAND CA 94623-0440**Situs Address: **CASTRO ST OAKLAND CA 94607**

Legal

Description:

ASSESSMENT

Total Value:

Use Code: **030**

Zoning:

Land Value:

Tax Rate Area: **17001**

Census Tract:

Impr Value:

Year Assd: **2004**

Improve Type:

Other Value:

Property Tax:

Price/SqFt:

% Improved

Delinquent Yr

Exempt Amt:

HO Exempt?: **N****SALES HISTORY**

| | <u>Sale 1</u> | <u>Sale 2</u> | <u>Sale 3</u> | <u>Transfer</u> |
|--------------------------|---------------|---------------|------------------|-------------------|
| Recording Date: | | | | 06/23/1969 |
| Recorded Doc #: | | | | 1969069809 |
| Recorded Doc Type: | | | | |
| Transfer Amount: | | | | |
| Sale 1 Seller (Grantor): | | | | |
| 1st Trst Dd Amt: | Code1: | | 2nd Trst Dd Amt: | Code2: |

PROPERTY CHARACTERISTICS

Lot Acres:

Year Built:

Fireplace:

Lot SqFt:

Effective Yr:

A/C:

Bldg/Liv Area:

Heating:

Units:

Total Rooms:

Pool:

Buildings:

Bedrooms:

Stories:

Baths (Full):

Park Type:

Style:

Baths (Half):

Spaces:

Construct:

Site Inflnce:

Quality:

Garage SqFt:

Building Class:

Timber Preserve:

Condition:

Ag Preserve:

Other Rooms: